

CONNECT LANDSCAPE ARCHITECTURE INC. DOES NOT  
GUARANTEE THE EXISTENCE, LOCATION, AND ELEVATION OF  
UTILITIES AND / OR CONCEALED STRUCTURES AT THE  
PROJECT SITE.

THE CONTRACTOR IS RESPONSIBLE FOR DETERMINING THE  
EXISTENCE, LOCATION, AND ELEVATION OF ALL UTILITIES AND /  
OR CONCEALED STRUCTURES, AND IS RESPONSIBLE FOR  
NOTIFYING THE APPROPRIATE COMPANY, DEPARTMENT OR  
PERSON(S) OF ITS INTENTION TO CARRY OUT ITS  
OPERATIONS.

KEY PLAN (NTS)

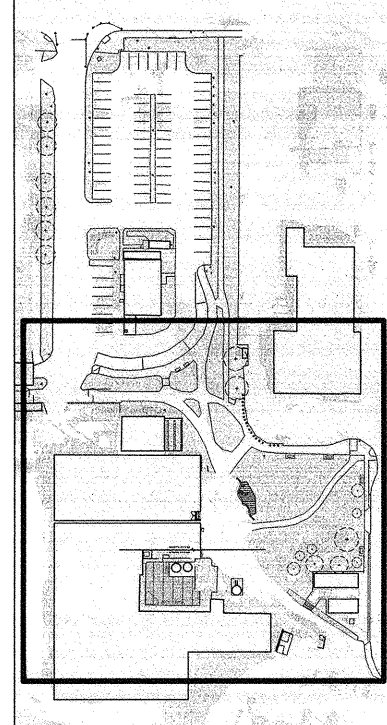

5		
4		
3		
2		
1		
0	Issued for Tender	16-11-14
Revision/ Revision	Description/Description	Date/Date
Client/Client		

GULF OF GEORGIA  
CANNERY  
RICHMOND, BC  
12138 FOURTH AVENUE  
GULF OF GEORGIA CANNERY

Project title/Titre du projet

GULF OF GEORGIA  
CANNERY  
NATIONAL HISTORIC SITE  
Building Site Rehabilitation

Consultant Signature Box Only

Designed by/Conçepé par  
CONNECT LANDSCAPE ARCHITECTURE, INC.

Drawn by/Dessiné par  
OREN MIZRAHI

PWGSC Project Manager/Administrateur de Projets TPSGC  
TOM DUNPHY

PWGSC Regional Manager, Architectural and Engineering Services/  
Gestionnaire régionale, Services d'architecture et de génie, TPSGC  
DALE REDFORD

Drawing title/Titre du dessin

PLANTING PLAN

Scale / Échelle

1 : 150

Project No./No. du projet

06-476

PWGSC Project No./No. du projet  
R060702.001

Sheet/ Feuille

L3.0

6 OF 16

Revision no./  
La Révision  
no.

0

PLANTING NOTES

1. PLANTING SHALL BE IN ACCORDANCE WITH BC LANDSCAPE STANDARD, LATEST EDITION. IN CASE OF DISCREPANCY BETWEEN PLANT NUMBERS THIS LIST AND ON THE PLAN, THE LATTER SHALL PREVAIL.
2. ALL PLANTING PLANS TO BE READ IN CONJUNCTION WITH THE LANDSCAPE DETAILS AND SPECIFICATION.
3. FINAL LANDSCAPE BERM / BED LAYOUTS, AS WELL AS ACTUAL SHRUB LOCATIONS AND SPACING, TO BE APPROVED BY THE DEPARTMENTAL REPRESENTATIVE PRIOR TO INSTALLATION.
4. CONTRACTOR TO LAYOUT TREES FOR APPROVAL BY THE CONSULTANT PRIOR TO COMMENCEMENT OF WORK.
5. ALL PLANTING BEDS TO BE MULCHED, SMOOTHED, AND RAKED IN ACCORDANCE WITH SPECIFICATIONS.
6. ALL UTILITIES ARE TO BE IDENTIFIED AND STAKED OUT BY CONTRACTOR BEFORE CONSTRUCTION. CONFLICTING UTILITIES TO BE PROTECTED BY CONTRACTOR PRIOR TO PLANTING.
7. CONTRACTOR TO NOTE ALL DAMAGE TO EXISTING TREES AND REPORT TO CONSULTANT PRIOR TO PLANTING. ANY DAMAGE OCCURRING TO EXISTING TREES BEYOND NOTED DAMAGE SHALL BE MADE GOOD TO THE SATISFACTION OF THE CONSULTANT AT THE CONTRACTOR'S EXPENSE. MINIMIZE DISTURBANCE TO EXISTING VEGETATION.
8. ALL EXISTING TREES ON TO BE PROTECTED AS NOTED IN DRAWINGS AND PER CITY OF RICHMOND REQUIREMENTS.
9. ALL PLANTING IS TO BE COMPLETED IN SUCH A MANNER AS TO PREVENT THE RELEASE OF SILT, SEDIMENT, OR SEDIMENT LADEN WATER, RAW CONCRETE OR CONCRETE LEACHATE OR ANY OTHER DELETERIOUS SUBSTANCES INTO ANY STREET, STORM SEWER, OR WATER BODY. INSTALL SEDIMENT EROSION CONTROL MEASURES PER CONTRACT SPECIFICATIONS, PRIOR TO SOIL PLACEMENT AND PLANTING.
10. GROWING MEDIUM TO MEET (AT MINIMUM) BCLNA STANDARD 3P (LEVEL 5 - BACKGROUND & NATURAL AREAS) LATEST EDITION AND THE CITY OF RICHMOND PARKS STANDARDS.
  - a. SHRUBS/GROUNDCOVERS = 450mm DEPTH
  - b. TERRASEED = 50mm DEPTH
11. ONE-YEAR MAINTENANCE TO MEET (AT MINIMUM) BCLNA STANDARD (LEVEL 6 - SERVICE AND INDUSTRIAL) LATEST EDITION.
12. REMOVE AND DISPOSE OF INVASIVE PLANT MATERIAL, INCLUDING HIMALAYAN BLACKBERRY (EXTENTS TBD ON-SITE).
  - a. EXCAVATE AND REMOVE SOIL TO 600mm.
  - b. INSTALL GROWING MEDIA AND AND RE-PLANT PER PLANS.
  - c. MAINTAIN AND REMOVE INVASIVES THROUGHOUT MAINTENANCE PERIOD
13. 1-YEAR MANUAL ESTABLISHMENT IRRIGATION TO BE PROVIDED

PLANTING SCHEDULE

SYMBOL	QTY.	BOTANICAL NAME	COMMON NAME	SIZE	SPACING	NOTES
FORESHORE RESTORATION PLANTING AREAS						
	130	Fragaria chiloensis	Coastal Strawberry	10cm pot	300mm o.c.	20% Coverage
	518	Leymus mollis	Dune Grass	Plugs	300mm o.c.	80% Coverage
	121	Achillea millefolium	Common Yarrow	10cm pot	300mm o.c.	+15% Coverage
	121	Lupinus littoralis	Seashore Lupine	10cm pot	300mm o.c.	+15% Coverage
	121	Solidago canadensis	Canada Goldenrod	10cm pot	300mm o.c.	+15% Coverage

TYPICAL PLANTING AREAS

SHRUBS

	96	Euonymus fortunei	Wintercreeper	#2 pot	18" o.c.
	70	Juniperus squamata 'Blue Star'	Blue Star Juniper	#2 pot	18" o.c.
	44	Potentilla 'Abbotswood White'	Abbotswood Potentilla	#2 pot	24" o.c.
	43	Vaccinium ovatum 'Thunderbird'	Evergreen Huckleberry	#2 pot	18" o.c.

GRASSES / GROUNDCOVERS / PERENNIALS

	168	Arctostaphylos uva-ursi	Kinnikinnick	4"(10cm) pot	12" o.c.
	109	Carex elata 'Aurea'	Bowles Golden Sedge	#1 pot	18" o.c.

