

10,000 N

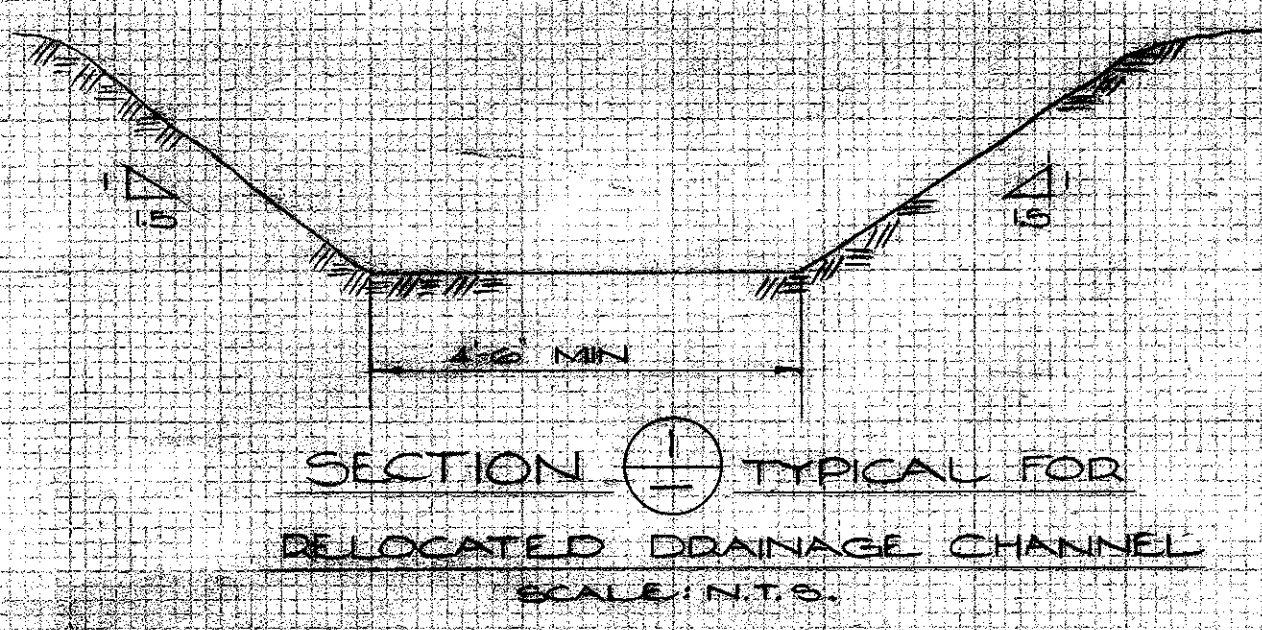
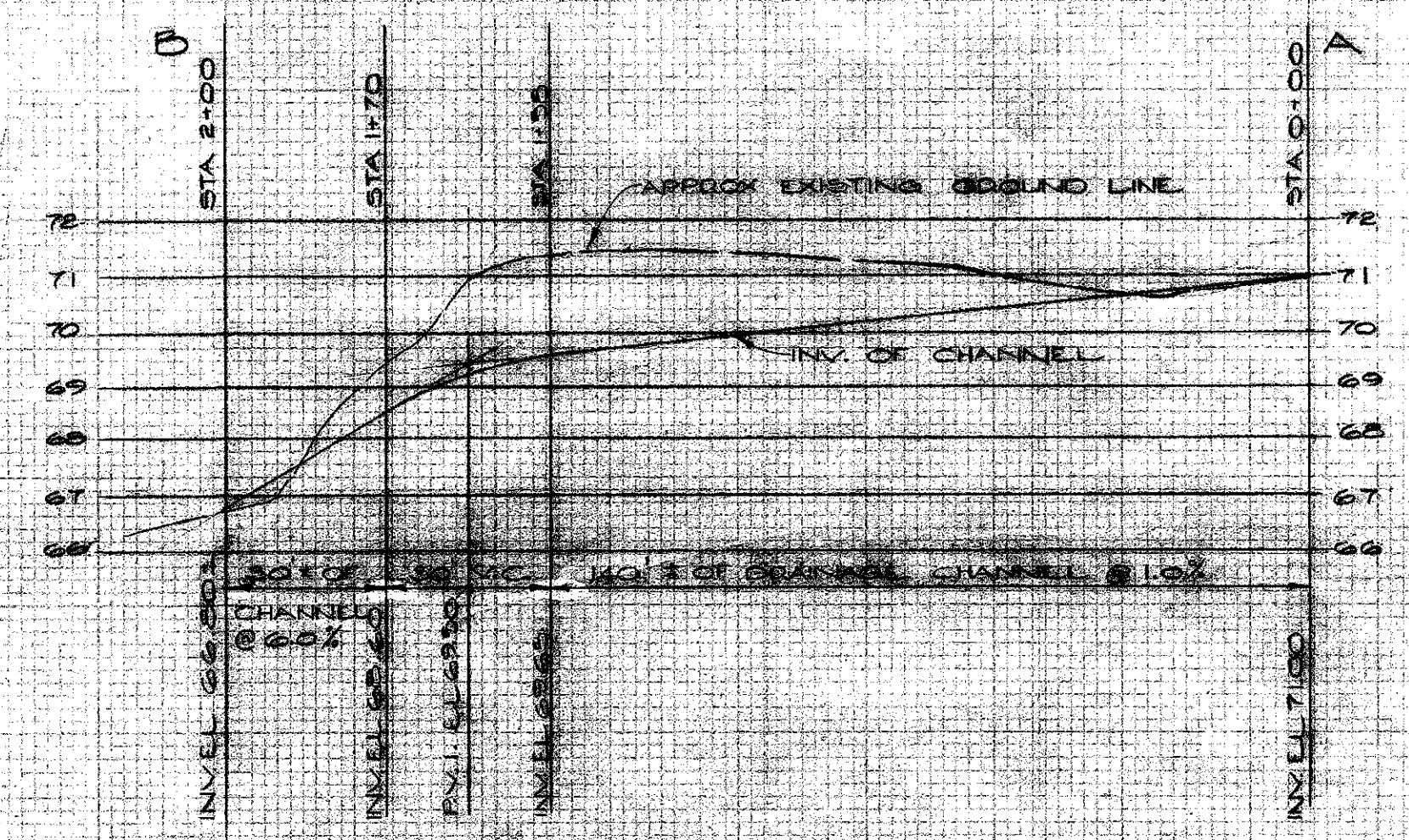
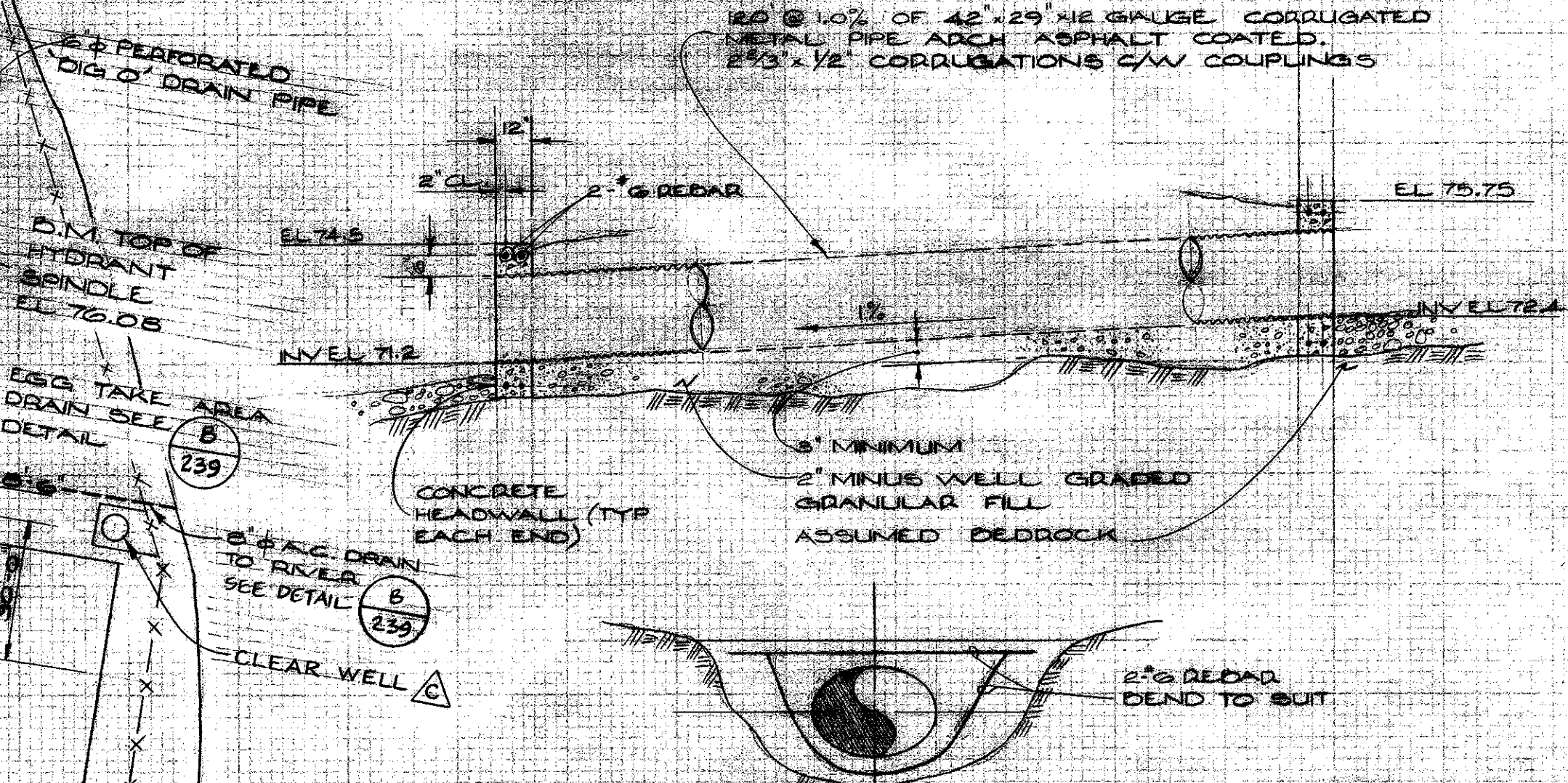
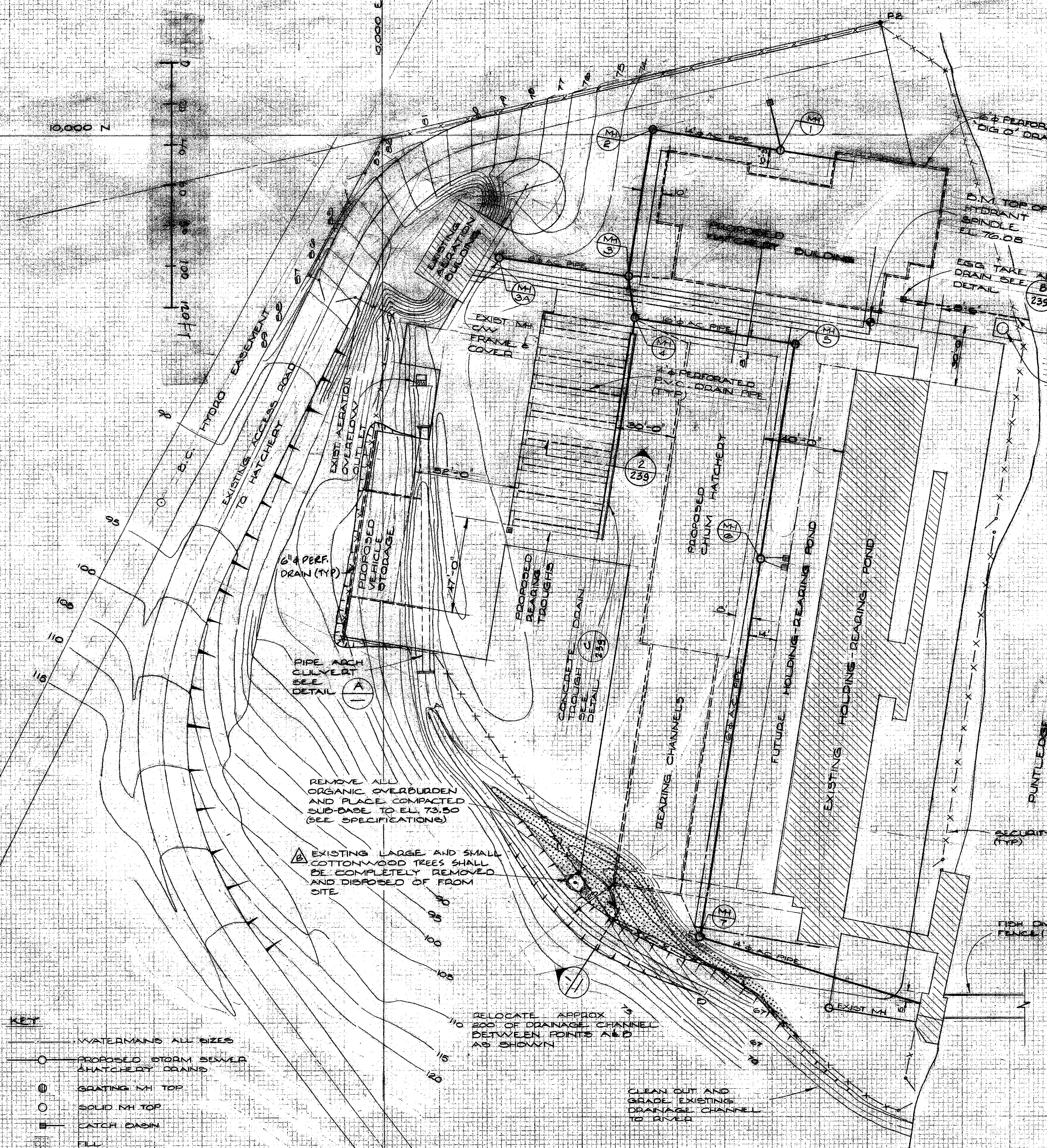

- KEY**
- WATERMANS ALL SIZES
 - PROPOSED STORM SEWER HATCHERY DRAINS
 - ⊙ GRATING MH TOP
 - SOLID MH TOP
 - ▣ CATCH BASIN
 - ▨ FILL

NOTE
HATCHERY SITE HAS BEEN GENERALLY ROUGH GRADED TO ELEVATION 75.00 EXCEPT WHERE CONTOURS ARE SHOWN.

REMOVE ALL ORGANIC OVERBURDEN AND PLACE COMPACTED SUB-BASE TO EL. 73.50 (SEE SPECIFICATIONS)

EXISTING LARGE AND SMALL COTTONWOOD TREES SHALL BE COMPLETELY REMOVED AND DISPOSED OF FROM SITE.

RELOCATE APPROX 200' OF DRAINAGE CHANNEL BETWEEN POINTS A AND D AS SHOWN

CLEAN OUT AND GRADE EXISTING DRAINAGE CHANNEL TO RIVER

SITE PLAN - DRAINAGE
SCALE: 1" = 30'-0"

REVISIONS	ISSUE	DATE	DRN	CHD	APPD	DESCRIPTION
B	MAY 16 79	SN				NOTE REVISED
A						CLEAR WELL CONSTRUCTED OCT. 1987

DEPARTMENT OF THE ENVIRONMENT
FISHERIES AND MARINE SERVICE

DESIGNED: [Signature]
DRAWN: [Signature]
CHECKED: [Signature]

RECOMMENDED: [Signature] APPROVED: [Signature] APPROVED: [Signature]

KERR WOOD LEIDAL ASSOCIATES LTD.
CONSULTING ENGINEERS

[Signature] April 6, 1979

DEPARTMENT OF THE ENVIRONMENT
PUNTLIDGE RIVER HATCHERY
DRAINAGE PLAN

K.W.L. DWG. NO: 1978-7

SCALE AS SHOWN
DRAWING NO: 31-6-237
SHEET 2 OF 68 ISSUE C

