

LOWER PENTHOUSE

FOURTH FLOOR

THIRD FLOOR

SECOND FLOOR

FIRST FLOOR

LOWER PENTHOUSE

FOURTH FLOOR

THIRD FLOOR

THIRD FLOOR

SECOND FLOOR

FIRST FLOOR

NOTES:  
 1. REFER TO DETAIL DRAWINGS FOR VALVES AND ACCESSORIES AT EACH UNIT.  
 2. REFER TO LAYOUT DRAWINGS FOR ADDITIONAL VALVES AND ACCESSORIES.

RECORD DRAWING  
 THESE RECORD DOCUMENTS HAVE BEEN PREPARED BASED ON INFORMATION PROVIDED BY OTHERS. GENIVAR HAS NOT VERIFIED THE ACCURACY AND/OR COMPLETENESS OF THIS INFORMATION AND SHALL NOT BE RESPONSIBLE FOR ANY ERRORS OR OMISSIONS THAT MAY BE INCORPORATED AS A RESULT OF ERRONEOUS INFORMATION PROVIDED BY OTHERS. GENIVAR RECOMMENDS THAT EXISTING INSTALLATIONS BE VERIFIED ON SITE.  
 17/AUG/2010

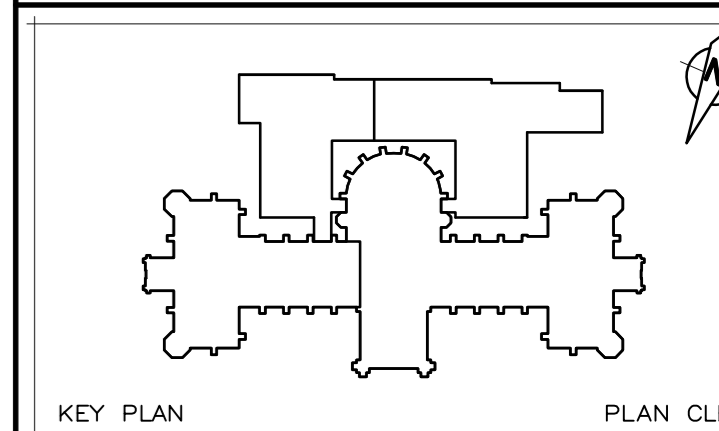

NO.	REVISION	DESCRIPTION	DATE
11	REVISED TO AS-BUILT		17 AUG 10
10	MS-259 ISSUED FOR MS COORDINATION		18 JULY 08
07	MS-142 ISSUED FOR MS COORDINATION		31 MAR 05
06b	ISSUED FOR MS-95		03 OCT 05
06	ISSUED FOR CONSTRUCTION		24 MAY 05
04d	MS-30		06 JAN 05
05	ISSUED FOR SITE DEVELOPMENT 50%		23 DEC 08
04c	TENDER ISSUE		25 NOV 04
04	ISSUED FOR TP4 TENDER READY		15 OCT 04
02	ISSUED FOR TP4 CONSTRUCTABILITY REVIEW		30 AUG 04
01	ISSUED FOR TP4 - 66%		2 APR 04

A	A detail no.	A
C	no. du détail	BC
	B location drawing no.	
	no. de localisation	
	C drawing no.	
	no. du dessin	

project: VICTORIA MEMORIAL MUSEUM BUILDING / PROJET DE RÉHABILITATION DE L'ÉDIFICE COMMÉMORATIF VICTORIA  
 Rebuilding project / Réhabilitation project

drawing: SCHEMATICS HVAC / dessin: HVAC

measured: / mesuré:  
 date: / date:  
 drawn: J.B./M.F.E. / dessiné:  
 date: 15 OCT 04 / date:  
 reviewed: E.W. / examiné:  
 date: 15 OCT 04 / date:  
 approved: M.C. / approuvé:  
 date: 15 OCT 04 / date:

tender: MARIA SOMJEN / soumission:  
 PWC Project Manager / Administrateur de projets TPC  
 project no.: / no. du projet:  
 436914

drawing no.: / no. du dessin:  
 TP4/C-M405 SHEET 4 OF 9