

THIS DRAWING IS A SYSTEM OVERVIEW  
ONLY. REFER TO DETAIL DRAWINGS  
SHOWING DETAILS OF EACH SECTION OF  
THIS DRAWINGS.

NOTES:  
1. REFER TO DETAIL DRAWINGS  
FOR VALVES AND ACCESSORIES  
AT EACH UNIT.  
2. REFER TO LAYOUT DRAWINGS  
FOR ADDITIONNAL VALVES AND  
ACCESSORIES.

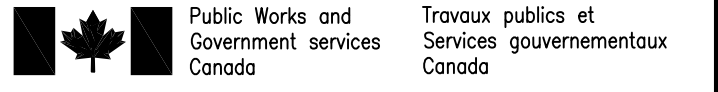

**JOYAT VENTURE ARCHITECTS** PKG  
BARRY PADOLSKY ASSOCIATES INC. ARCHITECTS  
KUWABARA PAYNE MCKENNA BLUMBERG ARCHITECTS  
GAGNON, LETELLIER, CYR ARCHITECTES  
377 Dohouse Street, Ottawa Ontario K1N 9N8  
Tel.: (613) 241-7199 Fax.: (613) 241-5782  
Email: email@podolsky-architects.com

**GENIVAR**  
CONSULTING GROUP LTD.  
15 Fitzgerald Road, Nepean, Ontario K2H 9G1  
Tel.: (613) 829-2800 Fax: (613) 829-8299  
Email: mail@genivar.com

**Halsall**  
ENGINEERS • CONSULTANTS  
210 GLAISTONE AVENUE, STE. 3001  
OTTAWA, ONTARIO, CANADA K2P 1Y6  
tel: (613) 237-2462 fax: (613) 237-2655  
e-mail: halsall.com

RECORD DRAWING

THESE RECORD DOCUMENTS HAVE BEEN  
PREPARED BASED ON INFORMATION  
PROVIDED BY OTHERS. GENIVAR HAS NOT  
VERIFIED THE ACCURACY AND/OR  
COMPLETENESS OF THIS INFORMATION  
AND SHALL NOT BE RESPONSIBLE FOR  
ANY ERRORS OR OMISSIONS THAT MAY  
BE INCORPORATED AS A RESULT OF  
ERRONEOUS INFORMATION PROVIDED BY  
OTHERS. GENIVAR RECOMMENDS THAT  
EXISTING INSTALLATIONS BE VERIFIED ON  
SITE. —

17/AUG/2010

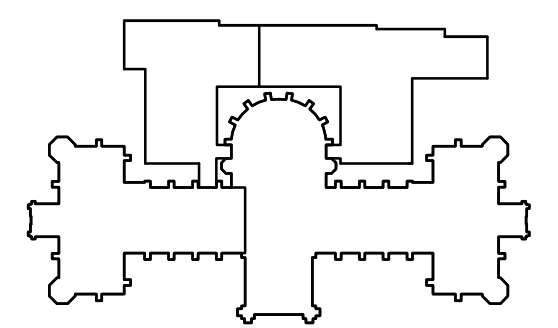

KEY PLAN PLAN CLE

11	REVISED TO AS-BUILT	17 AUG 10
10	MSI-259 ISSUED FOR MSI COORDINATION	18 JULY 08
07	MSI-142 ISSUED FOR MSI COORDINATION	31 MAR 05
06b	ISSUED FOR MSI-95	03 OCT 05
06	ISSUED FOR CONSTRUCTION	24 MAY 05
04d	MSI-30	08 JAN 05
05	ISSUED FOR SITE DEVELOPMENT 50%	23 DEC 08
04a	TENDER ISSUE	25 NOV 04
04	ISSUED FOR TP4 TENDER READY	15 OCT 04
02	ISSUED FOR TP4 CONSTRUCTABILITY REVIEW	30 AUG 04
01 00	ISSUED FOR TP4 - 66%	2 APR 04
revision	description	date

A detail no. no. du détail	A detail no. no. du détail
B location drawing no. no. de localisation	B location drawing no. no. de localisation
C drawing no. no. du dessin	C drawing no. no. du dessin

project VICTORIA MEMORIAL MUSEUM BUILDING Rehabilitation project	project PROJET DE RÉHABILITATION DE L'ÉDIFICE COMMÉMORATIF VICTORIA
---	--

drawing SCHEMATICS HVAC	dessin
-------------------------------	--------

measured	mesuré
date	date
drawn J.B./M.F.E. 15 OCT 04	dessiné
reviewed E.W. 15 OCT 04	examiné
approved M.C. 15 OCT 04	approuvé
tender MARIA SOMJEN PWG Project Manager	soumission Administrateur de projets TPC
project no. 436914	no. du projet