

#### CIP CONCRETE PAVING NOTES

- SANDBLAST FINISH
- SEE LAYOUT PLAN FOR SAWCUT JOINT PATTERN AND BAND WIDTH
- EXP. JOINTS @6M O.C. MAX (PLUMB, STRAIGHT AND SQUARE)  
(AT CHANGES IN MATERIALS, FURNISHINGS, CURB EDGES - SPACING TO COINCIDE WITH PATTERN)
- CONTROL JOINTS @ 1.5M O.C. (5'0") O.C. MAX (PLUMB, STRAIGHT AND SQUARE)
- FINAL LOCATION FOR JOINTS AND SAW CUTS TO BE CONFIRMED ON SITE WITH DEPARTMENTAL REPRESENTATIVE.
- ALL PAVING TO BE VEHICULAR RATED.
- FOR ALL HC ACCESSIBLE ROUTES ENSURE SAW CUT JOINTS RATHER THAN CONVEX TOOLED JOINTS.

#### EXISTING DIKE WORK NOTES

- ALL EXISTING INFORMATION APPROXIMATE ONLY. CONTRACTOR TO VERIFY AND REPORT ANY DISCREPENCIES PRIOR TO PROCEEDING WITH WORK.
- ENSURE DIKE INTEGRITY PROTECTED PER CITY OF RICHMOND GUIDELINES AND PROVINCIAL/MUNICIPAL DIKING AUTHORITY REQUIREMENTS.
- EXISTING ELEMENTS TO BE PROTECTED THROUGHOUT THE DURATION OF CONSTRUCTION INCLUDE (BUT ARE NOT LIMITED TO): GULF OF GEORGIA CANNERY BUILDING, STINKEROO, AND PLAZA SCULPTURES.
- ALL MATERIALS TO BE REMOVED FROM SITE AND DISPOSED OF PER CITY OF RICHMOND AND INDUSTRY REQUIREMENTS.

#### HARDSCAPE NOTES

- ENGINEERED SHOP DRAWINGS REQUIRED FOR CIP CONCRETE PAVING REINFORCEMENT DETAILS.
- REQUIRED SUBMITTALS INCLUDE:
  - DIKE COMPACTION TESTING
  - ON GRADE COMPACTION TESTING
  - GRANULAR BASE COURSE COMPACTION TESTING
  - CIP CONCRETE PAVING COMPRESSIVE STRENGTH TESTING
- WHERE SUBMITTALS DO NOT MEET SPECIFICATION CONTRACTOR TO REPAIR OR PROPOSE ALTERNATE SOLUTION WHICH MEETS STRUCTURAL INTEGRITY FOR APPROVAL BY DEPARTMENTAL REPRESENTATIVE.

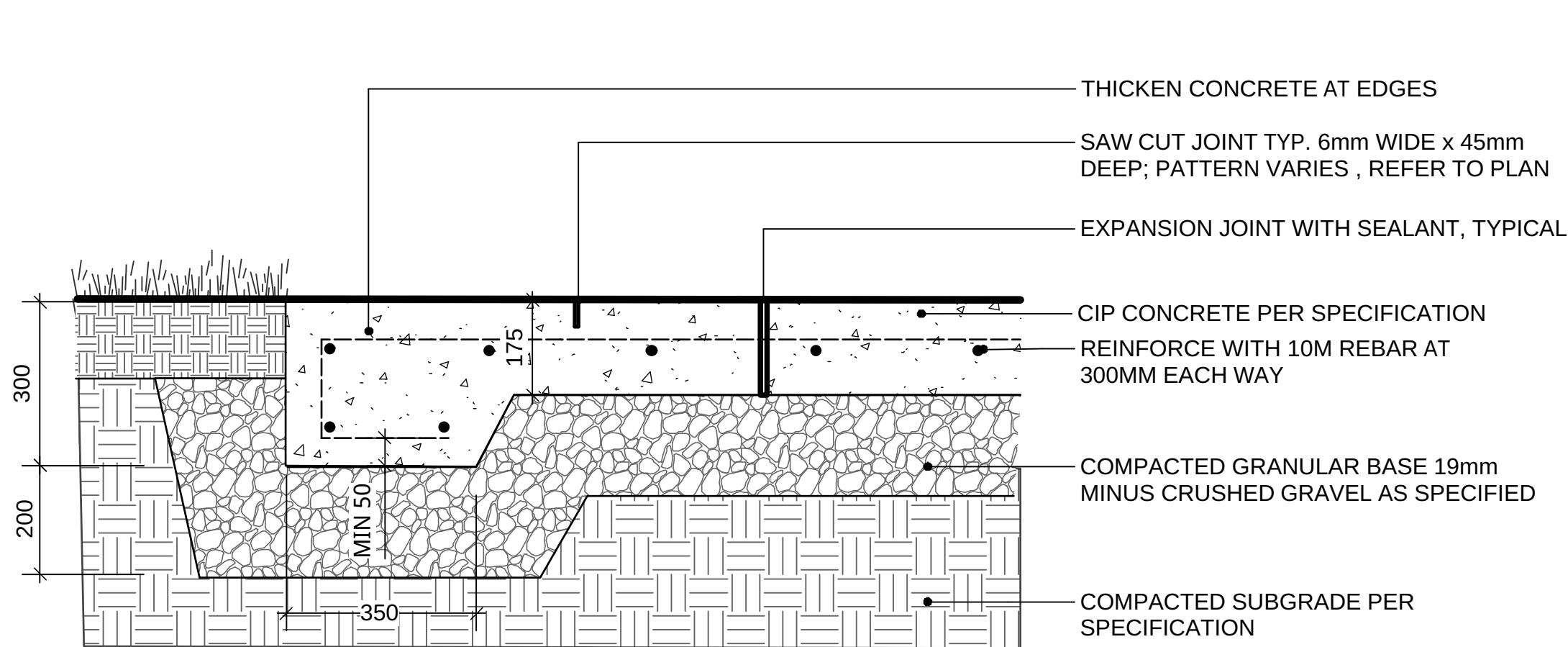

1 CIP CONCRETE ON GRADE (TYPICAL)  
Scale: 1:10

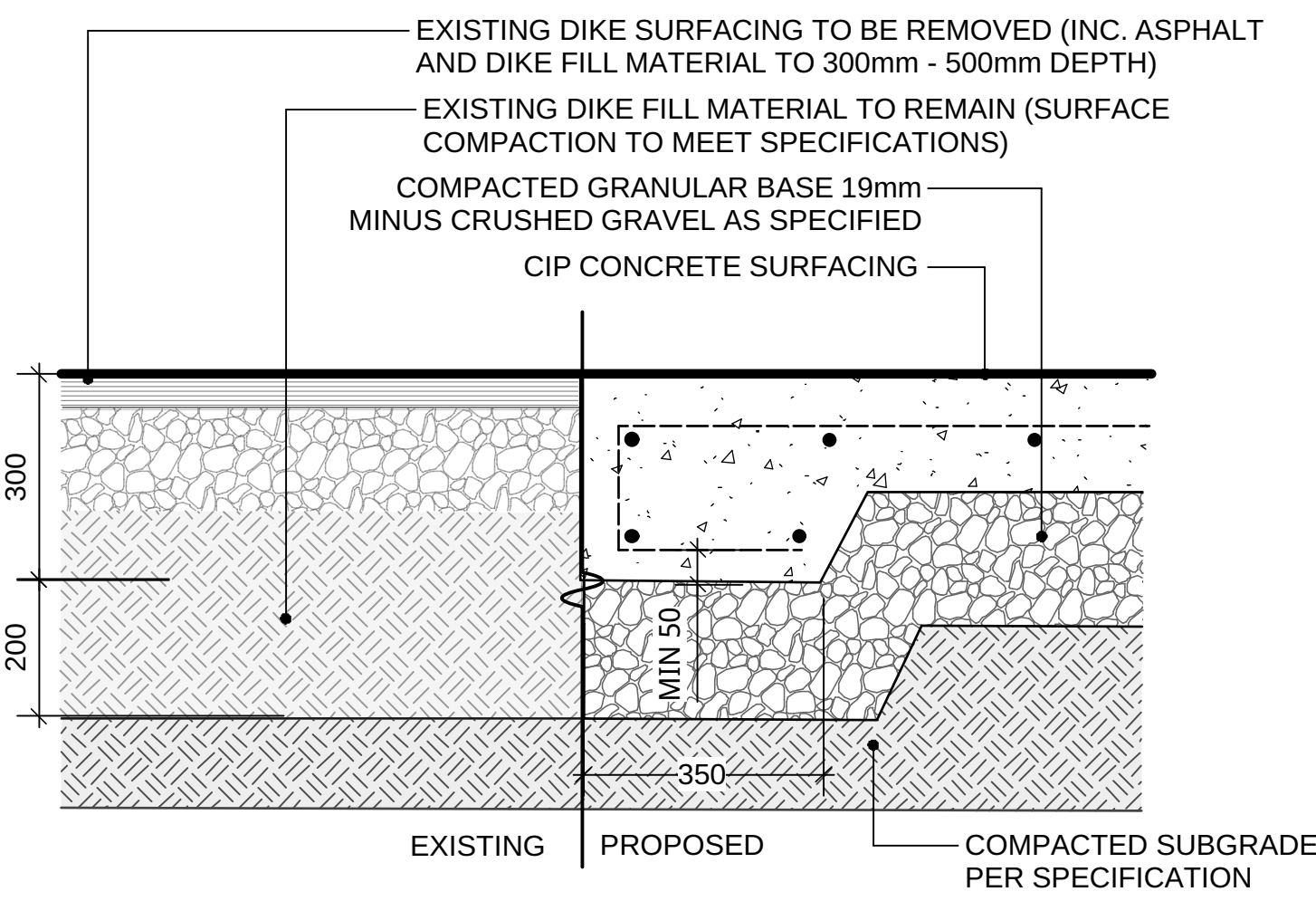

2 CIP CONCRETE ON EXISTING DIKE (TYPICAL)  
Scale: 1:10

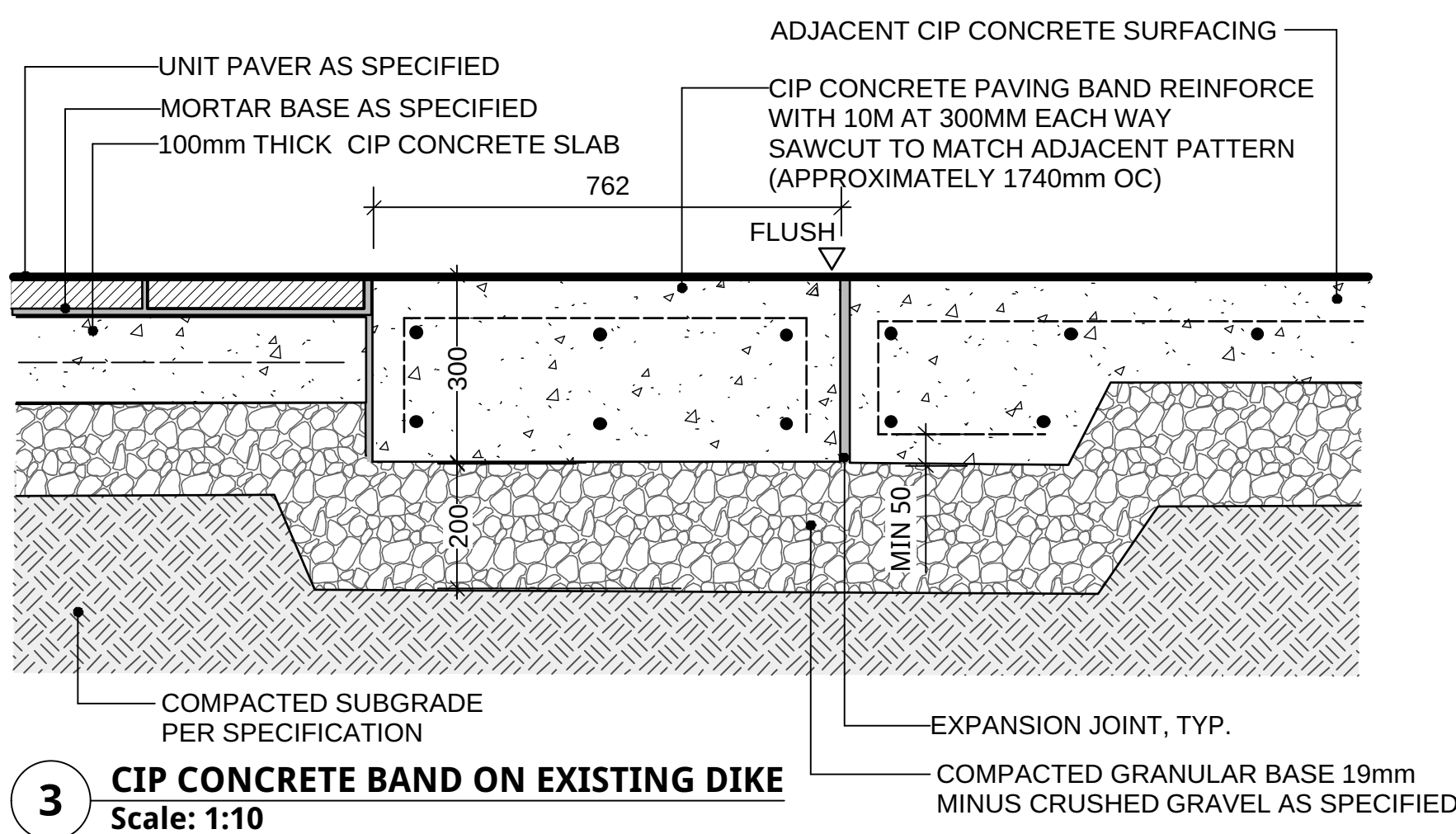

3 CIP CONCRETE BAND ON EXISTING DIKE  
Scale: 1:10

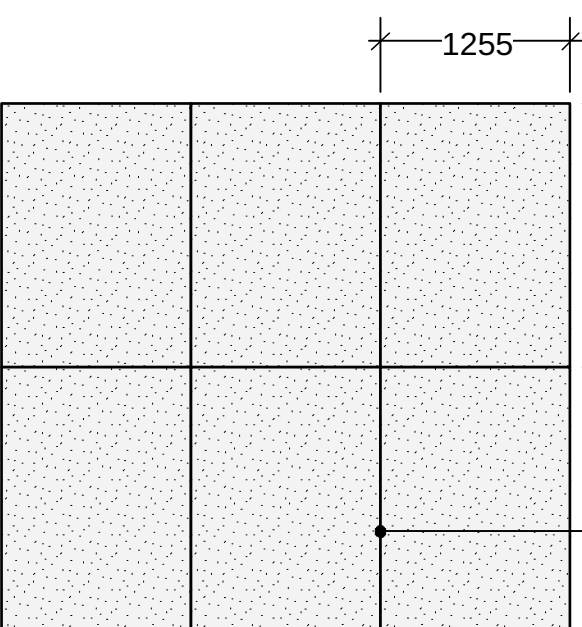

TYPICAL PLAZA SCORELINE PATTERN

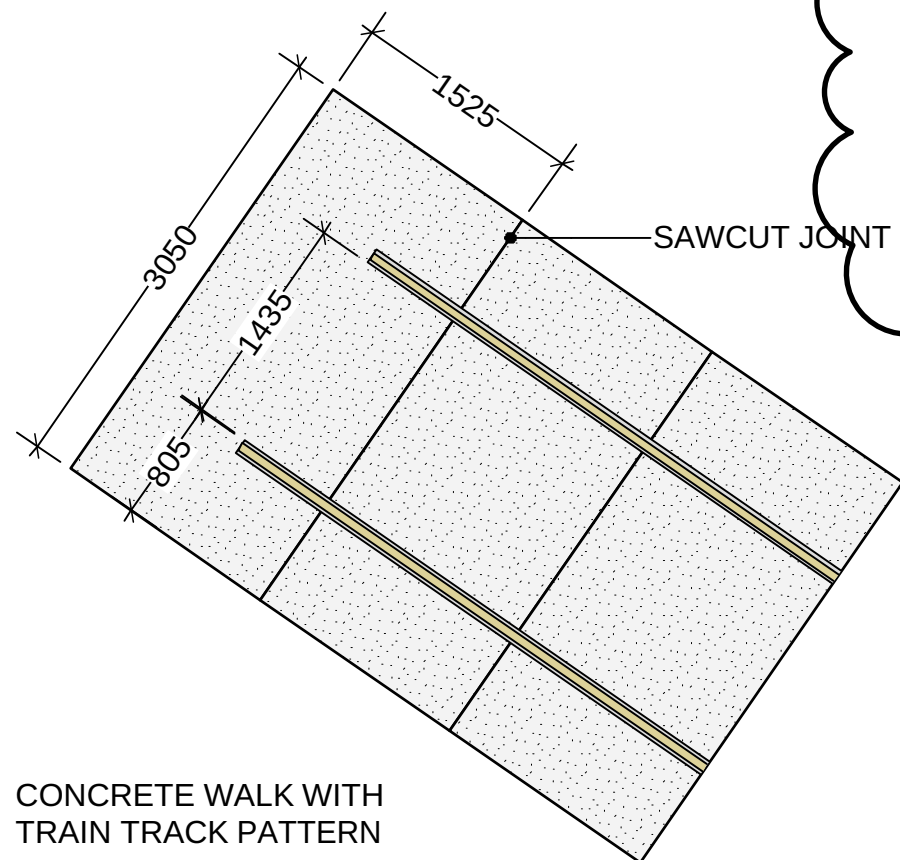

CONCRETE WALK WITH  
TRAIN TRACK PATTERN

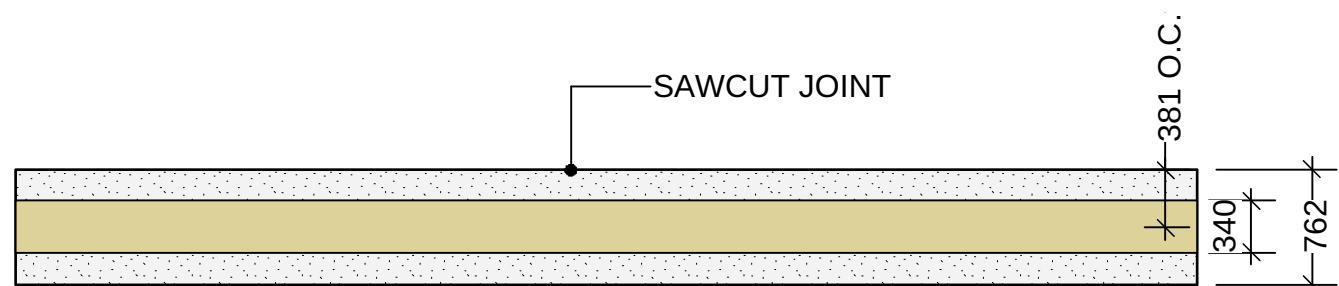

CONCRETE BAND PATTERN

4 CIP CONCRETE SCORELINE PATTERNS (PLAN ENLARGEMENTS)  
Scale: 1:50

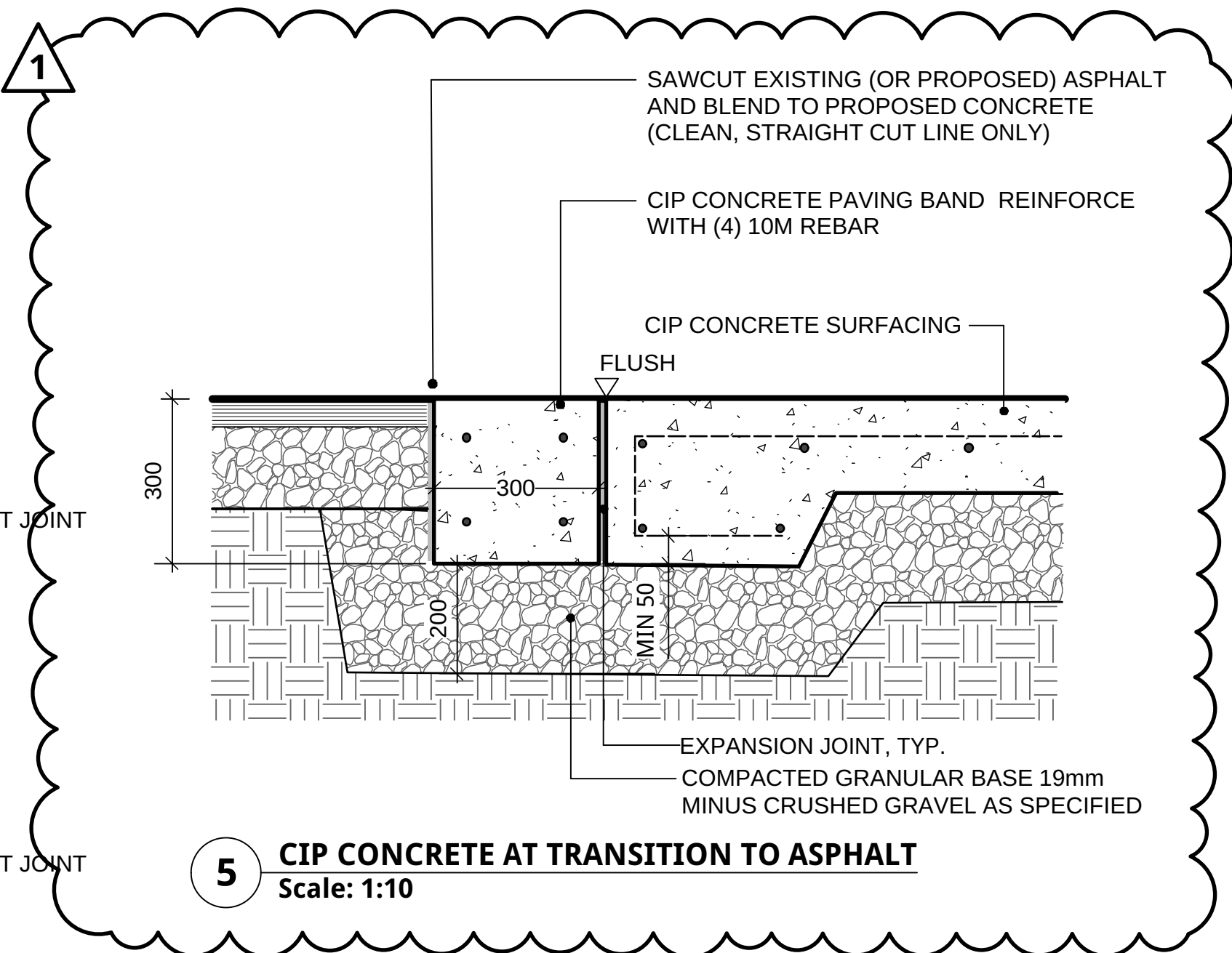

5 CIP CONCRETE AT TRANSITION TO ASPHALT  
Scale: 1:10

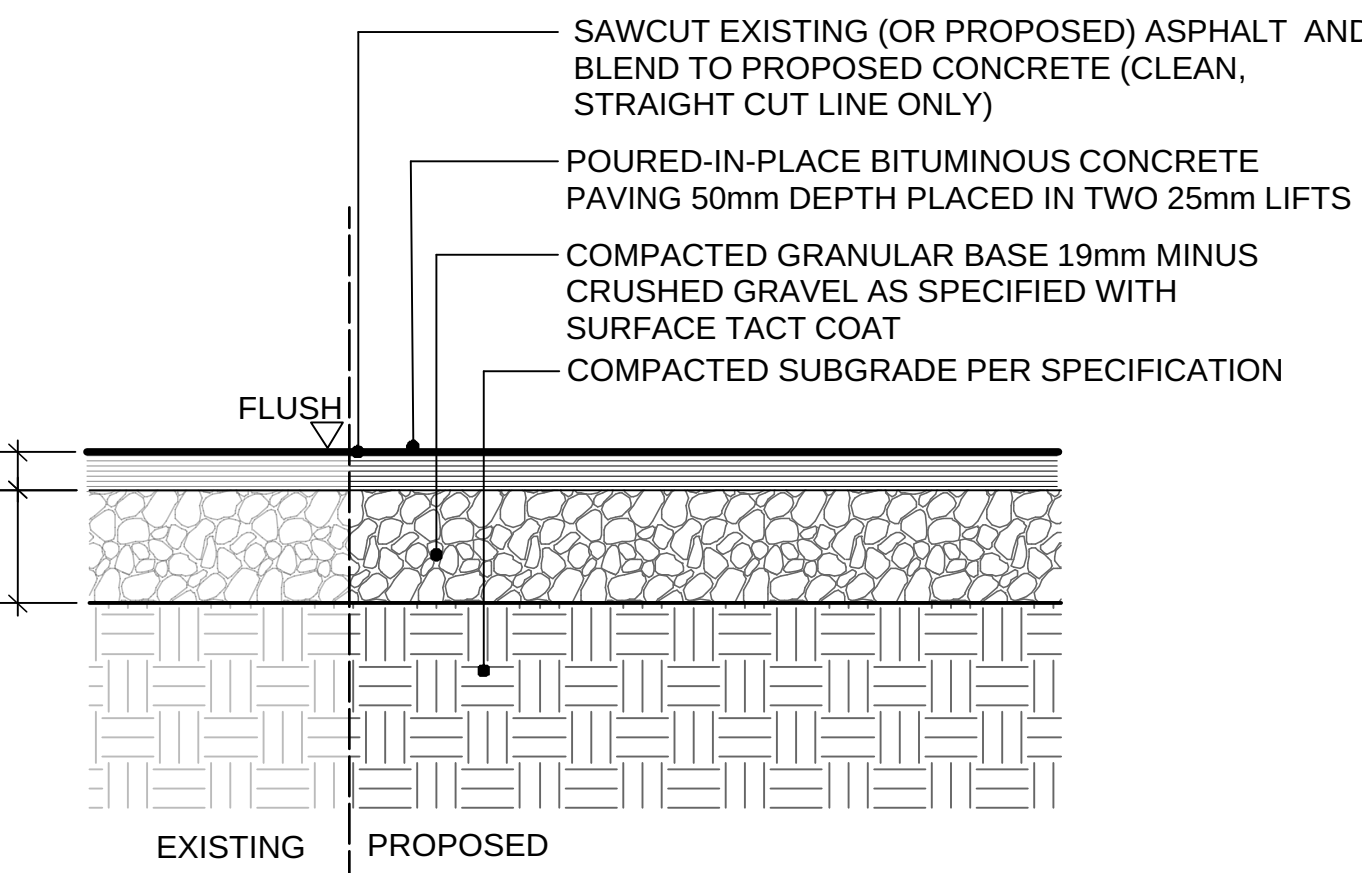

6 PROPOSED ASPHALT AT TRANSITION TO EXISTING  
Scale: 1:10

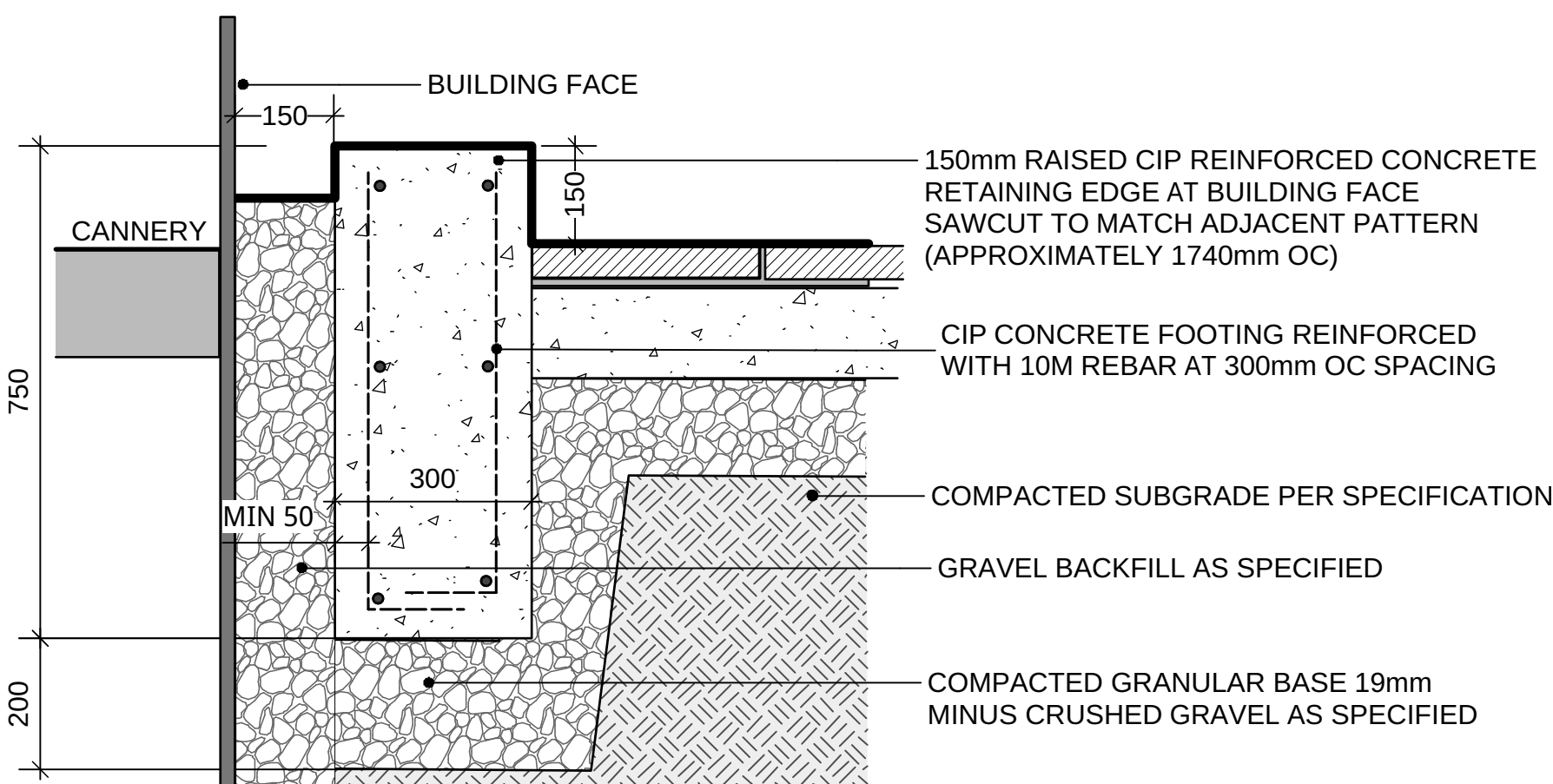

8 CIP CONCRETE EDGE AT BUILDING FACE  
Scale: 1:10

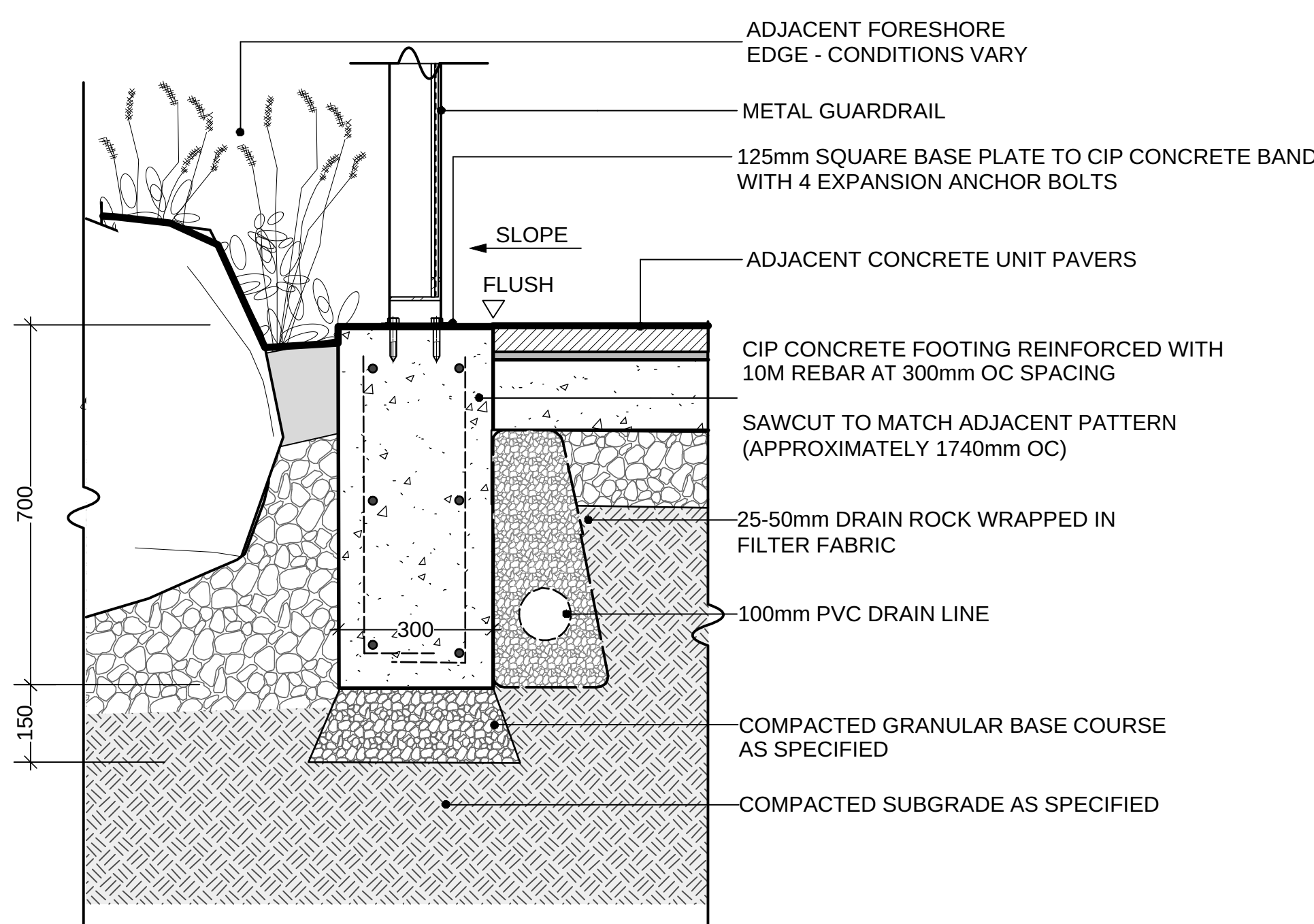

7 CIP CONCRETE BAND AT WATER EDGE  
Scale: 1:10

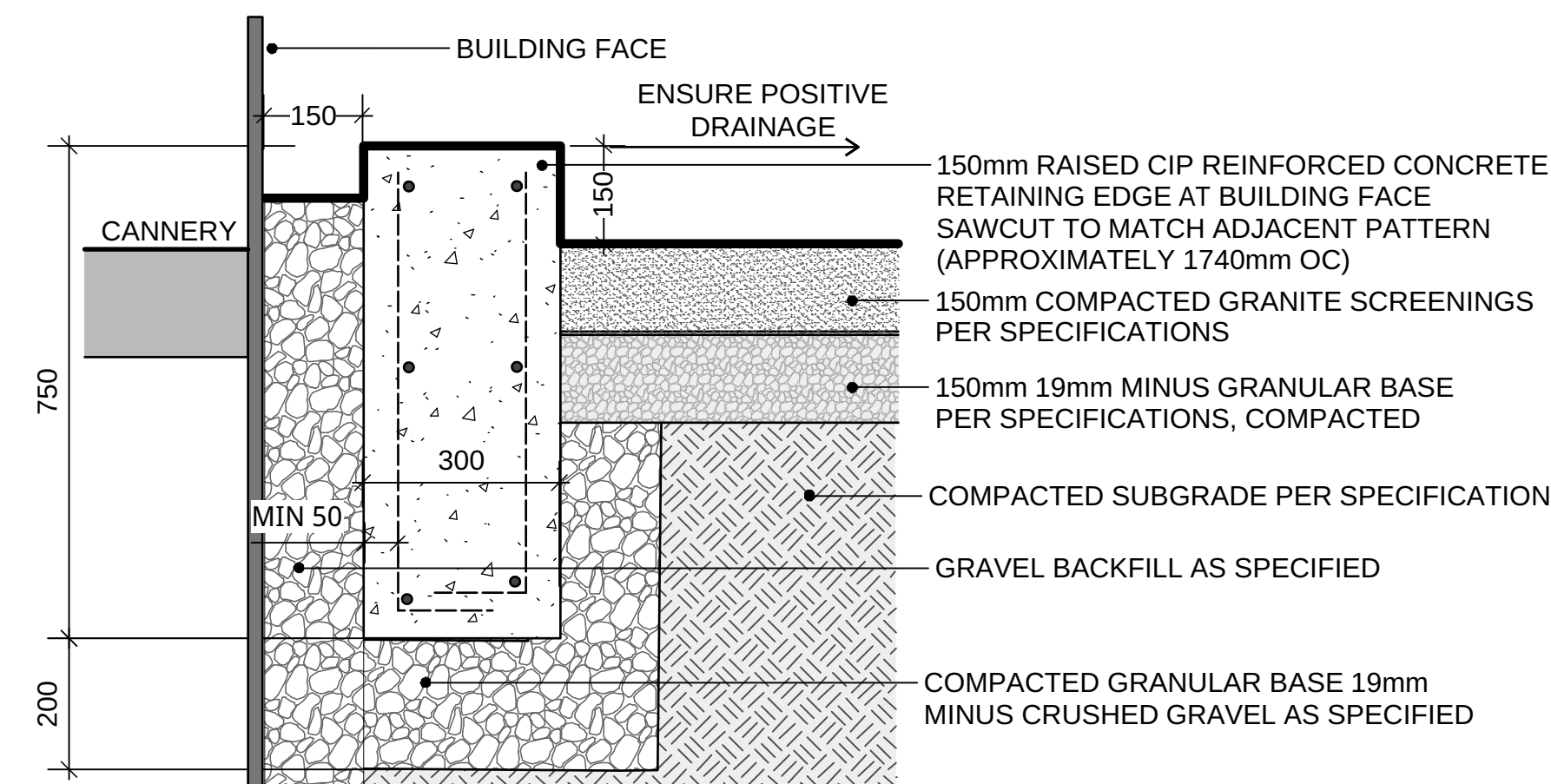

9 GRANULAR PATH AT ELECTRICAL ROOM  
Scale: 1:10

5		
4		
3		
2		
1	Issued for Addendum #2	17-01-09
0	Issued for Tender	16-11-14
Revision/	Description/Description	Date/Date
Revision		

GULF OF GEORGIA  
CANNERY  
RICHMOND, BC  
12138 FOURTH AVENUE  
GULF OF GEORGIA CANNERY

Project title/Titre du projet  
RICHMOND, BC  
12138 FOURTH AVENUE  
GULF OF GEORGIA CANNERY  
GULF OF GEORGIA  
CANNERY  
NATIONAL HISTORIC SITE  
Building Site Rehabilitation

Consultant Signature Box Only

Designed by/Concepté par  
CONNECT LANDSCAPE ARCHITECTURE, INC.

Drawn by/Dessiné par  
OREN MIZRAHI

PWGSSC Project Manager/Administrateur de Projets TPSSC  
TOM DUNPHY

PWGSSC Regional Manager, Architectural and Engineering Services/  
Gestionnaire régionale, Services d'architecture et de génie, TPSSC  
DALE REDFORD

Drawing title/Titre du dessin

DETAILS: TYPICAL PAVING

Scale / Echelle

AS SHOWN

Project No./No. du projet

06-476

PWGSSC Project No./No. du projet

R.060702.001

Sheet/ Feuille

L5.0

8 OF 16

Revision no./  
La Révision  
no.

1





5		
4		
3		
2		
1	Issued for Addendum #2	17-01-09
0	Issued for Tender	16-11-14
Revision/ Revision	Description/Description	Date/Date

GULF OF GEORGIA  
CANNERY  
RICHMOND, BC  
12138 FOURTH AVENUE  
GULF OF GEORGIA CANNERY

Project title/Titre du projet  
RICHMOND, BC  
12138 FOURTH AVENUE  
GULF OF GEORGIA CANNERY  
**GULF OF GEORGIA  
CANNERY**  
**NATIONAL HISTORIC SITE**  
Building Site Rehabilitation

Consultant Signature Box Only

Designed by/Concept par  
CONNECT LANDSCAPE ARCHITECTURE, INC.

Drawn by/Dessiné par  
OREN MIZRAHI

PWGSC Project Manager/Administrateur de Projets TFSGC  
TOM DUNPHY

PWGSC, Regional Manager, Architectural and Engineering Services/  
Gestionnaire régionale, Services d'architecture et de génie, TFSGC  
DALE REDFORD

Drawing title/Titre du dessin

**DETAILS: SPECIAL PAVING**

Scale / Echelle

AS SHOWN

Project No./No. du projet

**06-476**

PWGSC Project No./No. du projet

**R.060702.001**

Sheet / Feuille

**L5.1**

9 OF 16

Revision no./  
La Révision  
no.

**1**

**CIP CONCRETE PAVING NOTES**

- SANDBLAST FINISH
- SEE LAYOUT PLAN FOR SAWCUT JOINT PATTERN AND BAND WIDTH
- EXP. JOINTS @6M O.C. MAX (PLUMB, STRAIGHT AND SQUARE)  
(AT CHANGES IN MATERIALS, FURNISHINGS, CURB EDGES - SPACING TO COINCIDE WITH PATTERN)
- CONTROL JOINTS @ 1.5M O.C. (5'0") O.C. MAX (PLUMB, STRAIGHT AND SQUARE)
- FINAL LOCATION FOR JOINTS AND SAW CUTS TO BE CONFIRMED ON SITE WITH DEPARTMENTAL REPRESENTATIVE.
- ALL PAVING TO BE VEHICULAR RATED.
- FOR ALL HC ACCESSIBLE ROUTES ENSURE SAW CUT JOINTS RATHER THAN CONVEX TOOLED JOINTS.

**EXISTING DIKE WORK NOTES**

- ALL EXISTING INFORMATION APPROXIMATE ONLY. CONTRACTOR TO VERIFY AND REPORT ANY DISCREPENCIES PRIOR TO PROCEEDING WITH WORK.
- ENSURE DIKE INTEGRITY PROTECTED PER CITY OF RICHMOND GUIDELINES AND PROVINCIAL/MUNICIPAL DIKING AUTHORITY REQUIREMENTS.
- EXISTING ELEMENTS TO BE PROTECTED THROUGHOUT THE DURATION OF CONSTRUCTION INCLUDE (BUT ARE NOT LIMITED TO): GULF OF GEORGIA CANNERY BUILDING, STINKEROO, AND PLAZA SCULPTURES.
- ALL MATERIALS TO BE REMOVED FROM SITE AND DISPOSED OF PER CITY OF RICHMOND AND INDUSTRY REQUIREMENTS.

**HARDSCAPE NOTES**

- ENGINEERED SHOP DRAWINGS REQUIRED FOR CIP CONCRETE PAVING REINFORCEMENT DETAILS.
- REQUIRED SUBMITTALS INCLUDE:  
A. DIKE COMPACTION TESTING  
B. ON GRADE COMPACTION TESTING  
C. GRANULAR BASE COURSE COMPACTION TESTING  
D. CIP CONCRETE PAVING COMPRESSIVE STRENGTH TESTING
- WHERE SUBMITTALS DO NOT MEET SPECIFICATION CONTRACTOR TO REPAIR OR PROPOSE ALTERNATE SOLUTION WHICH MEETS STRUCTURAL INTEGRITY FOR APPROVAL BY DEPARTMENTAL REPRESENTATIVE.

NOTE:  
PROVIDE 2m x 2m MOCK-UP FOR REVIEW BY DEPARTMENTAL  
REPRESENTATIVE (PER SPECIFICATIONS)

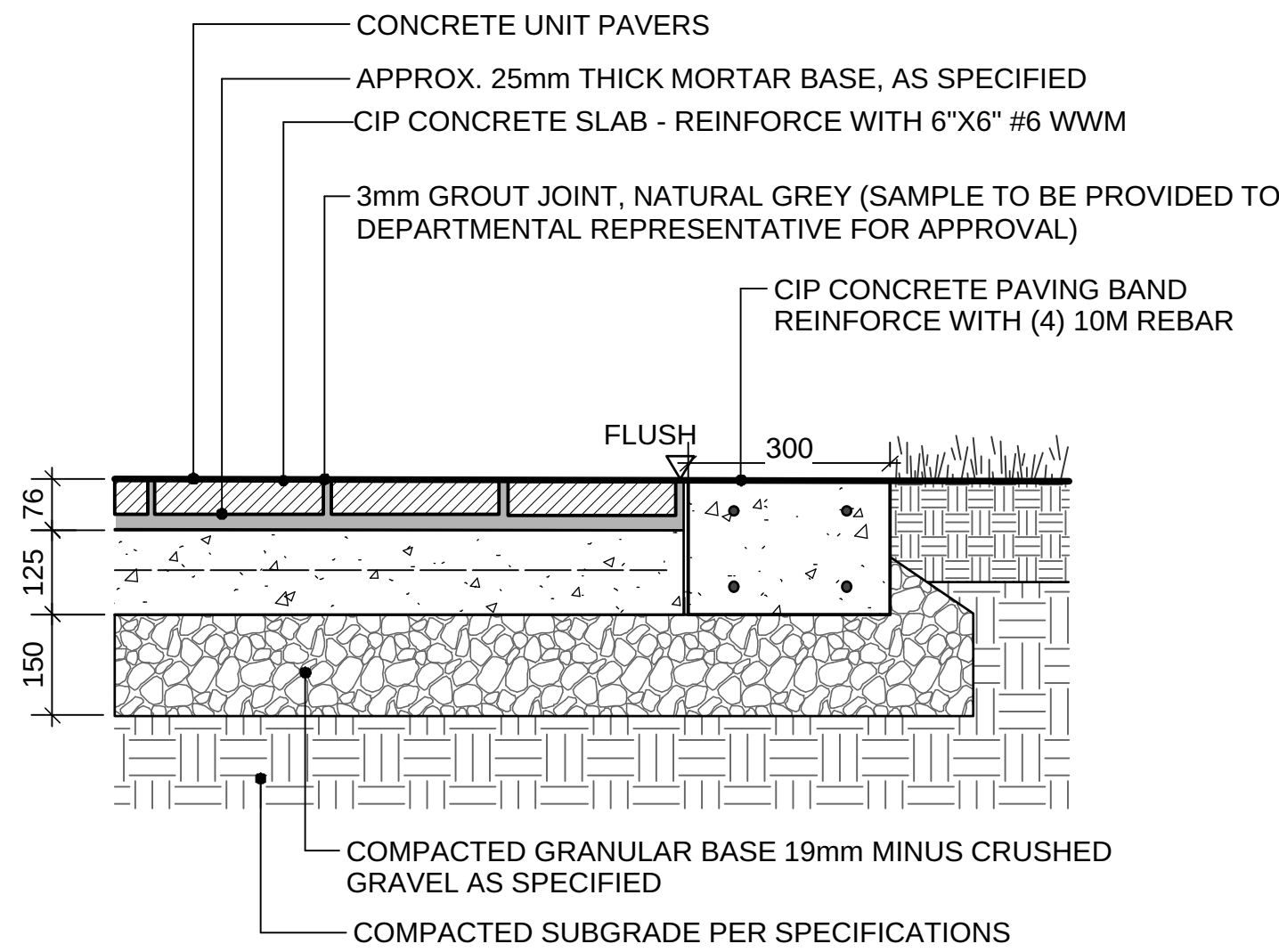

**1 CONCRETE UNIT PAVER ON GRADE**  
Scale: 1:10

EXISTING DIKE SURFACING TO BE REMOVED (INC. ASPHALT AND  
DIKE FILL MATERIAL TO 300mm - 500mm DEPTH)  
EXISTING DIKE FILL MATERIAL TO REMAIN (SURFACE  
COMPACTION TO MEET SPECIFICATIONS)

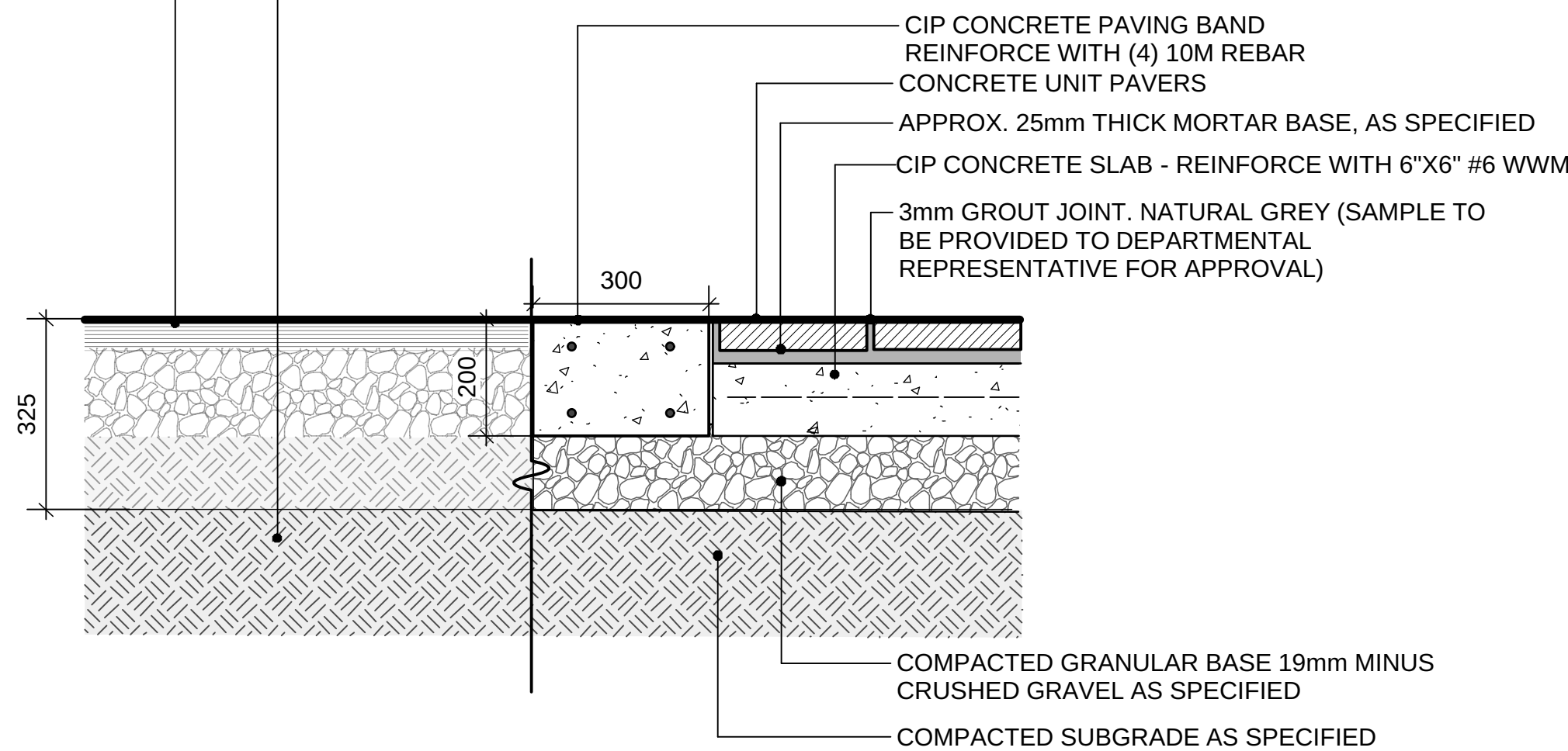

**2 CONCRETE UNIT PAVER ON EXISTING DIKE (TYPICAL)**  
Scale: 1:10

NOTE: UNIT PAVERS TO BE CONCRETE WITH REALISTIC WOOD TEXTURE PATTERNS  
OF VARIOUS LENGTHS (400MM - 1000MM) AND EQUAL WIDTH (250MM-300MM).  
COLOUR TO BE GREY / CHARCOAL. MINIMUM THICKNESS OF 51MM.

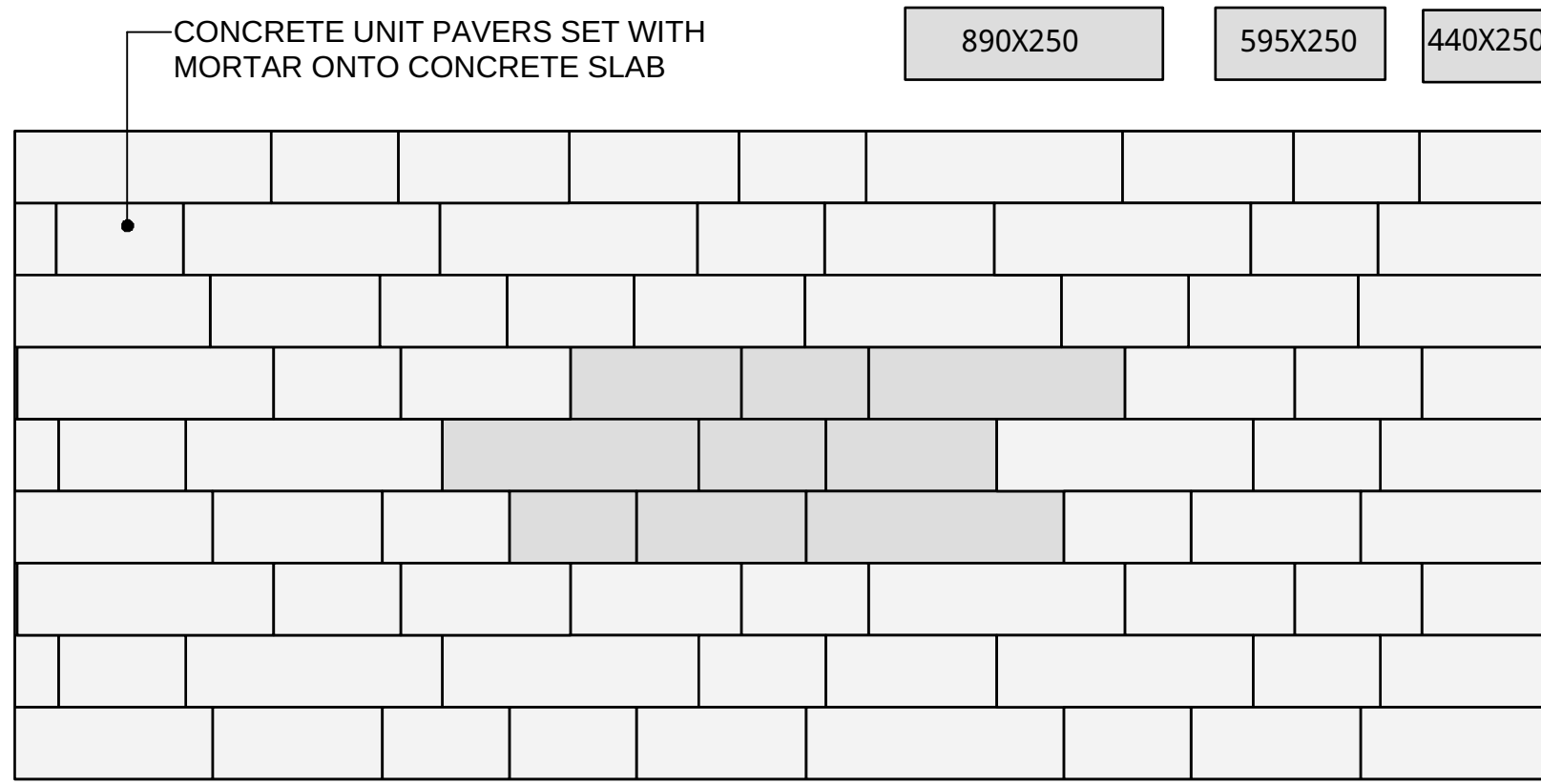

NOTE: POSSIBLE EXPANSION JOINT(S) TO BE INSTALLED PER DIRECTION OF DEPARTMENTAL REPRESENTATIVE.

**3 CONCRETE UNIT PAVER PATTERN**  
Scale: 1:25

BRIDGEWOOD SLAB  
MANUFACTURED BY  
BARKMAN CONCRETE

COLOUR: WEATHERED GREY  
SIZES: 890 X 250 X 51  
595 X 250 X 51  
440 X 250 X 51

PATTERN: AS SHOWN



INSET TRAIN TRACK LINE MORTARED IN-PLACE  
CONFIRM DIMENSIONS OF VOID FOR 'TRAIN' TRACK  
PRIOR TO FORMING CONCRETE WORKS

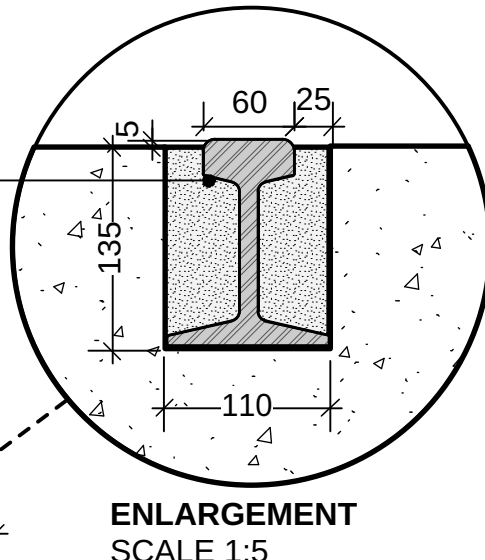

ENLARGEMENT  
SCALE 1:5

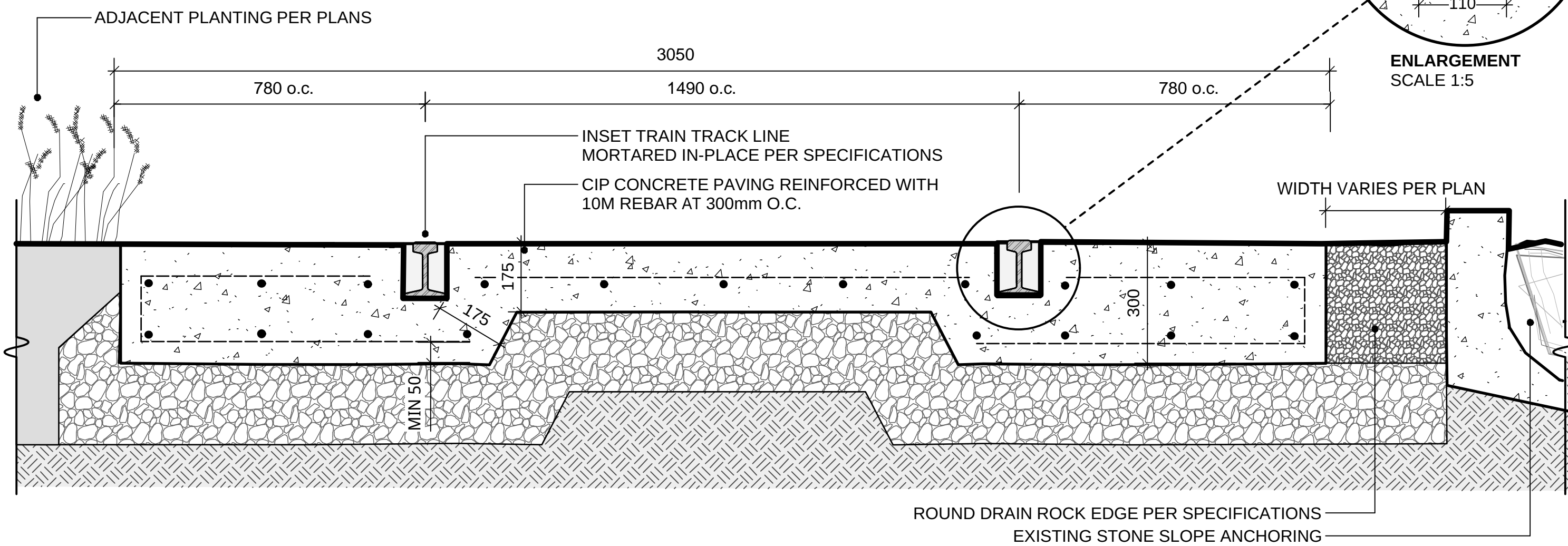

**4 INSET METAL 'TRAIN' TRACKS WITH GRANULAR EDGE**  
Scale: 1:10

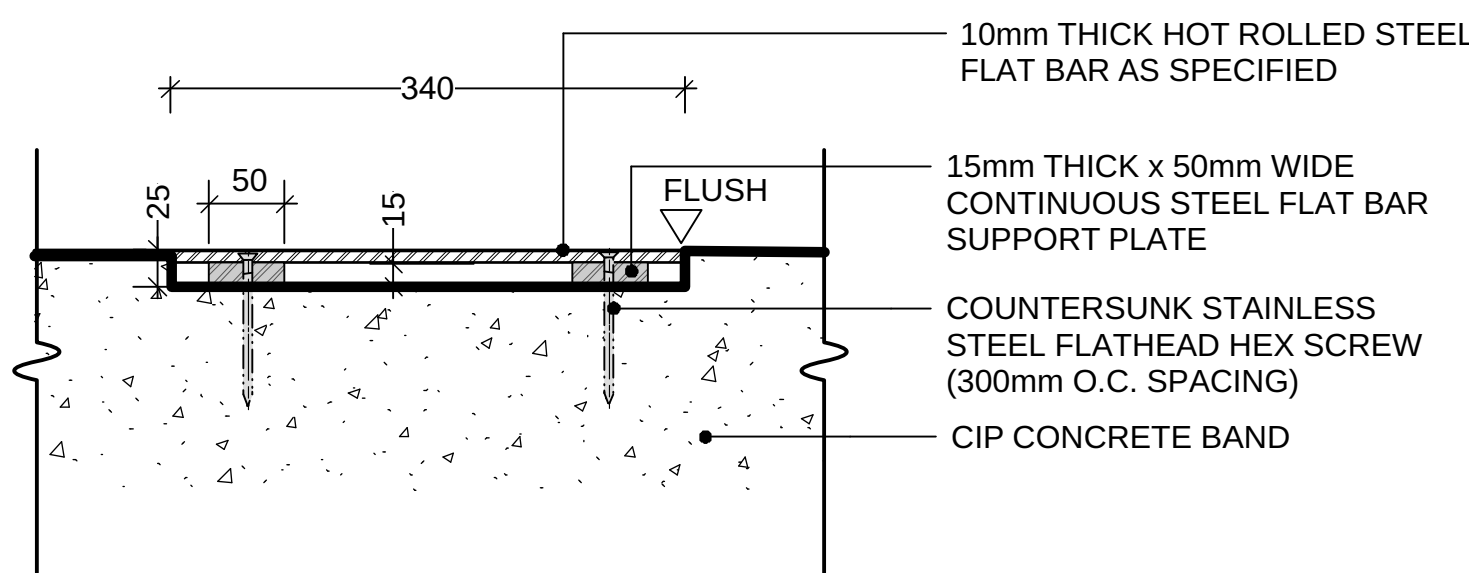

**6 INSET METAL TRACK WITH LASERJET TEXT**  
Scale: 1:5

LIGHT SANDBLAST FINISH

HEAVY SANDBLAST FINISH  
CUSTOM STEEL REUSABLE STENCIL TO MATCH  
GULF OF GEORGIA CANNERY SALMON ICON  
(FINAL STENCIL TO BE APPROVED BY  
DEPARTMENTAL REPRESENTATIVE)

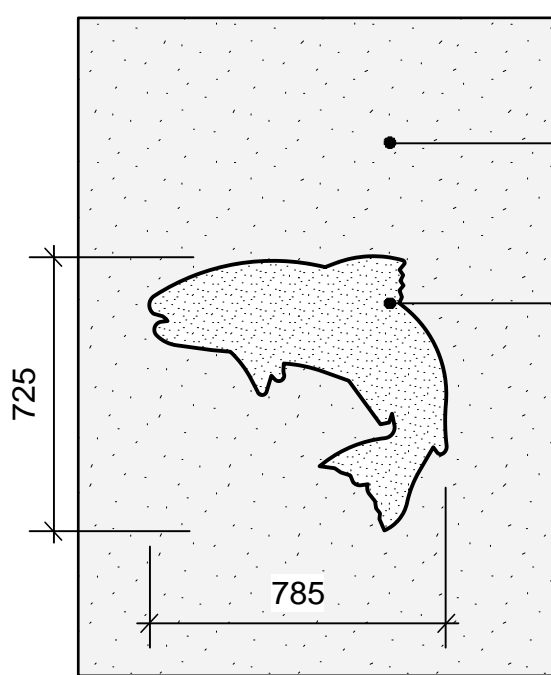

AT STEVESTON HARBOUR AUTHORITY  
ENTRANCE PER PLANS

**7 SALMON ICON**  
Scale: 1:20



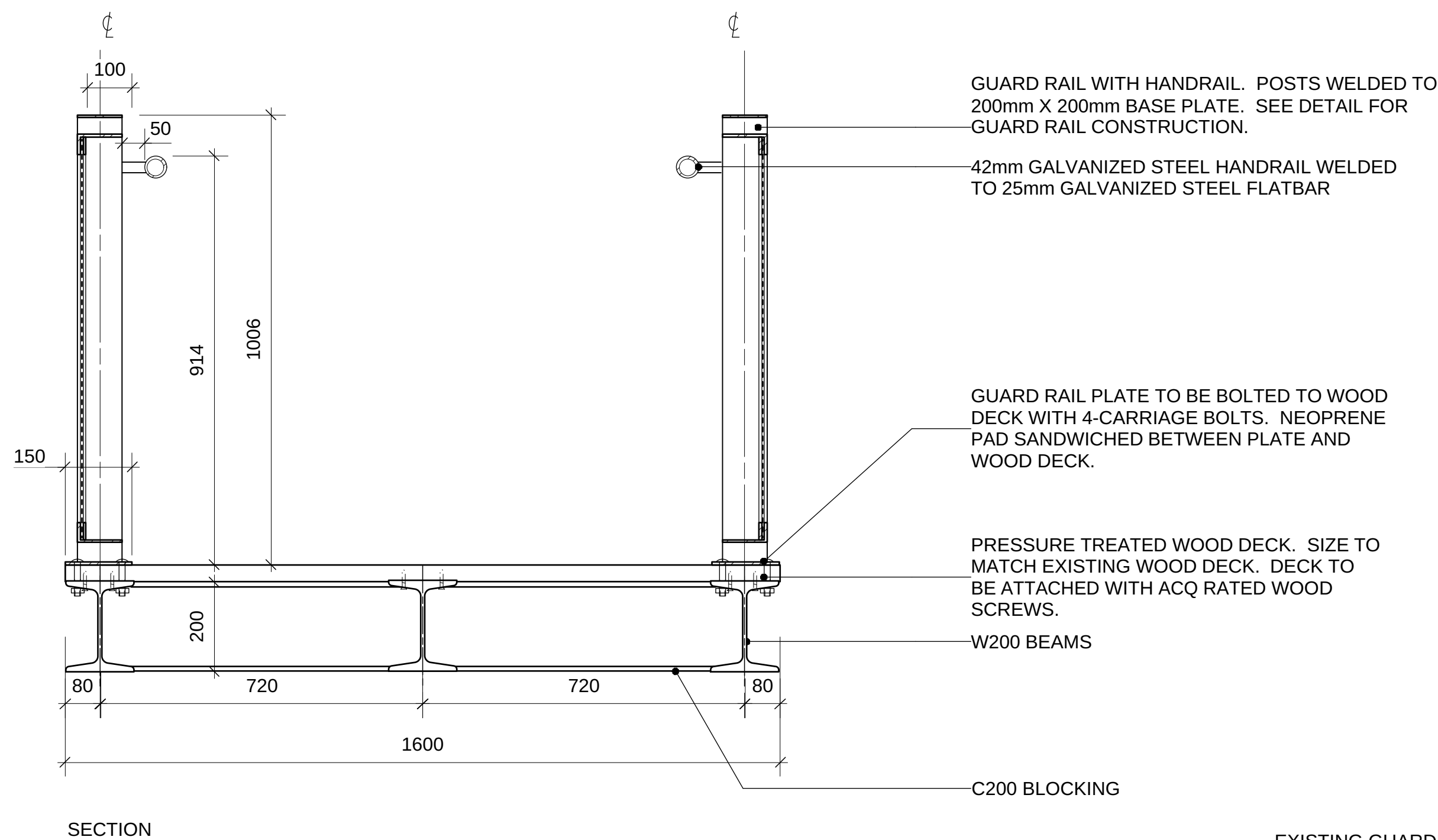

**1** **TIMBER/METAL PLANK CONNECTION SPAN AT DOCK (SECTION)**  
Scale: 1:10

- EXISTING GUARDRAIL TO BE REMOVED AND REPLACED
- EXISTING BOARDS TO BE REMOVED, REFINISHED AND RE-USED
- EXISTING TIMBER SPAN TO BE REMOVED AND REPLACED WITH TIMBER / METAL PLANK CONNECTION PER DETAILS
- EXISTING TIMBER DECK AND POST STRUCTURE TO REMAIN PROTECTED
- EMBANKMENT TO BE CLEARED OF INVASIVES AND DEBRIS AND PLANTED PER DRAWINGS

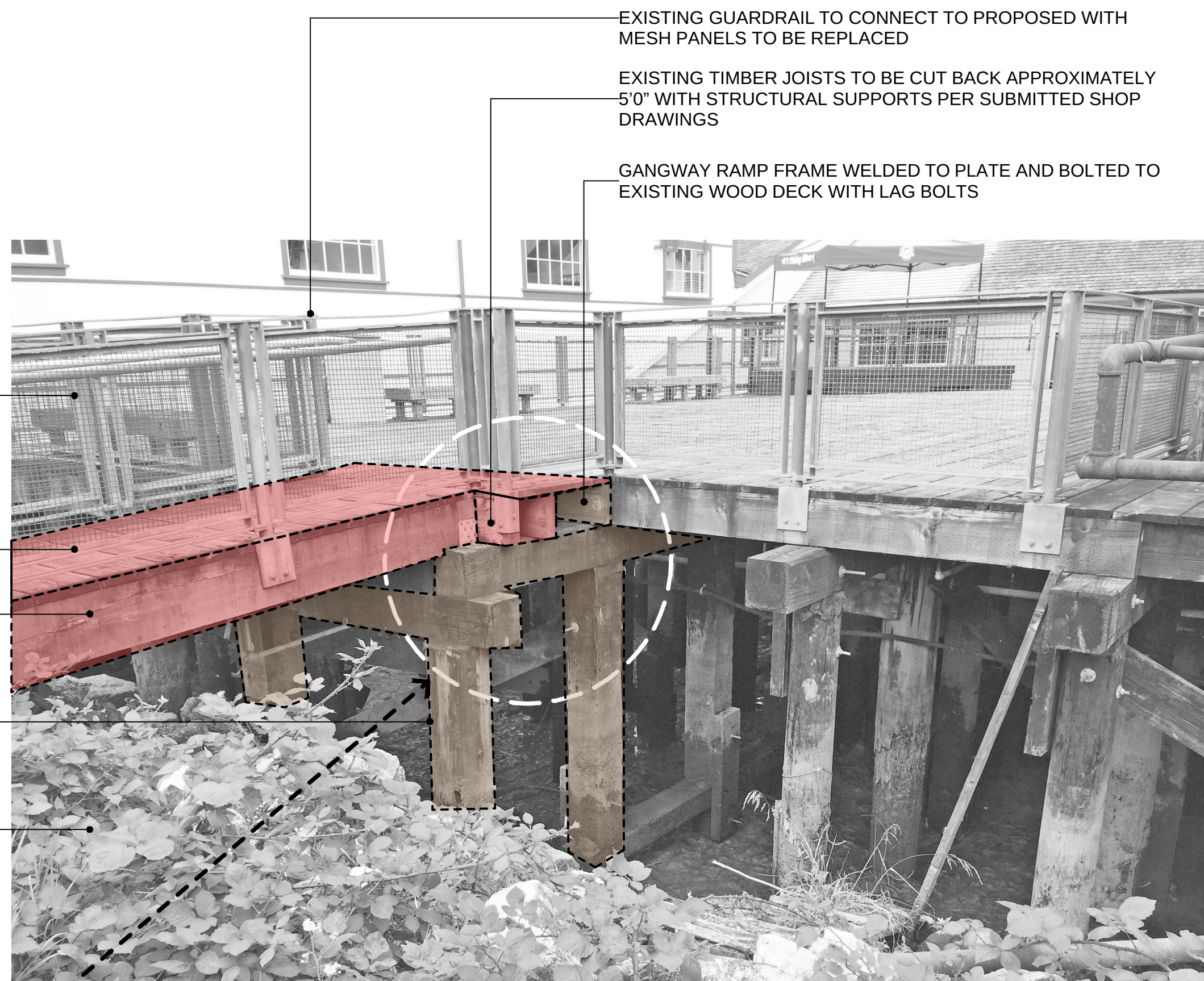

- TYPICAL NOTES:**
1. CONTRACTOR TO SUBMIT ENGINEERED SHOP DRAWINGS FOR APPROVAL BY DEPARTMENTAL REPRESENTATIVE PRIOR TO FABRICATION SHOWING ALL GATES AND SCREEN AND GANGWAY RAMP, INCLUDING ALL STEEL FRAMING CONNECTIONS AND ANCHOR BOLTS."
  2. PROVIDE DIMENSIONS OF ALL COMPONENTS AND DETAILS OF ALL HARDWARE AND FASTENINGS.
  3. ALL METAL JOINTS TO BE WELDED AND TO BE GROUND SMOOTH. WELDS/REPAIRS TO BE PAINTED TO MATCH.
  4. ALL METAL COMPONENTS TO BE HOT-DIP GALVANIZED AND PAINTED PER SPECIFICATION (EXCEPT GUY WIRES, FASTENINGS AND TURNBUCKLES NOT TO BE PAINTED).
  5. WOOD DECK TO BE PRESSURE TREATED. WOOD MEMBERS TO BE SMOOTH ALL EXPOSED FACES
  6. WOOD SCREWS AND BOLTS TO BE ACQ RATED CORROSION RESISTANT FASTENERS.
  8. GUARD RAIL AND HANDRAILS TO MEET LATEST BC BUILDING CODE AND NATIONAL BUILDING CODE OF CANDA 2015.

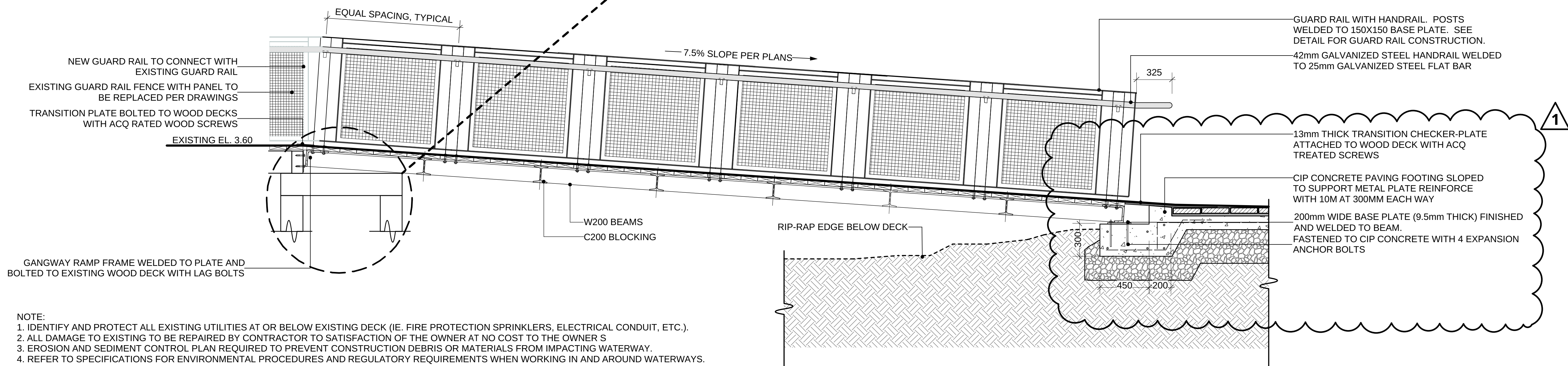

- NOTE:**
1. IDENTIFY AND PROTECT ALL EXISTING UTILITIES AT OR BELOW EXISTING DECK (IE. FIRE PROTECTION SPRINKLERS, ELECTRICAL CONDUIT, ETC.).
  2. ALL DAMAGE TO EXISTING TO BE REPAIRED BY CONTRACTOR TO SATISFACTION OF THE OWNER AT NO COST TO THE OWNER S
  3. EROSION AND SEDIMENT CONTROL PLAN REQUIRED TO PREVENT CONSTRUCTION DEBRIS OR MATERIALS FROM IMPACTING WATERWAY.
  4. REFER TO SPECIFICATIONS FOR ENVIRONMENTAL PROCEDURES AND REGULATORY REQUIREMENTS WHEN WORKING IN AND AROUND WATERWAYS.

**2** **TIMBER/METAL PLANK CONNECTION SPAN AT DOCK (ELEVATION)**  
Scale: 1:20

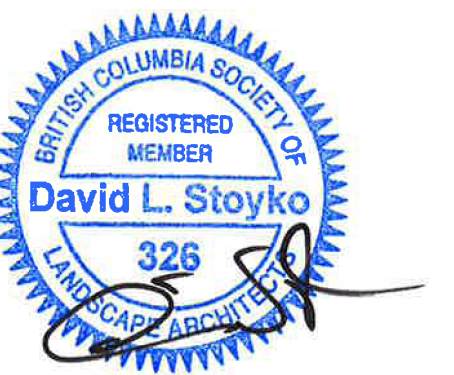

5		
4		
3		
2		
1	Issued for Addendum #2	17-01-09
0	Issued for Tender	16-11-14
Revision/ Revision	Description/Description	Date/Date

Client/client

**GULF OF GEORGIA  
CANNERY**  
RICHMOND, BC  
12138 FOURTH AVENUE  
GULF OF GEORGIA CANNERY

Project title/Titre du projet

RICHMOND, BC  
12138 FOURTH AVENUE  
GULF OF GEORGIA CANNERY  
**GULF OF GEORGIA  
CANNERY**  
**NATIONAL HISTORIC SITE**  
Building Site Rehabilitation

Consultant Signature Box Only

Designed by/Concept par  
CONNECT LANDSCAPE ARCHITECTURE, INC.

Drawn by/Dessiné par  
OREN MIZRAHI

PWGSC Project Manager/Administrateur de Projets TPWGC  
TOM DUNPHY

PWGSC Regional Manager/ Architectural and Engineering Services/  
Gestionnaire régional, Services d'architecture et de génie, TPWGC  
DALE REDFORD

Drawing title/Titre du dessin

**DETAILS: BRIDGE/RAMP (1)**

Scale / Echelle  
AS SHOWN

Project No./No. du projet <b>06-476</b> PWGSC Project No./No. du projet <b>R.060702.001</b>	Sheet/ Feuille <b>L5.6</b> 14 OF 16	Revision no./ La Révision no. <b>1</b>
--	---	---