

CONTRACTOR MUST CHECK & VERIFY ALL DIMENSIONS ON THE JOB.

DO NOT SCALE DRAWINGS.

ALL DRAWINGS, SPECIFICATIONS AND RELATED DOCUMENTS ARE THE COPYRIGHT PROPERTY OF THE ARCHITECT AND MUST BE RETURNED UPON REQUEST. REPRODUCTION OF DRAWINGS, SPECIFICATIONS AND RELATED DOCUMENTS IN PART OR IN WHOLE IS FORBIDDEN WITHOUT THE WRITTEN PERMISSION OF THE ARCHITECT.

THIS DRAWING IS NOT TO BE USED FOR CONSTRUCTION UNTIL SIGNED BY THE ARCHITECT.

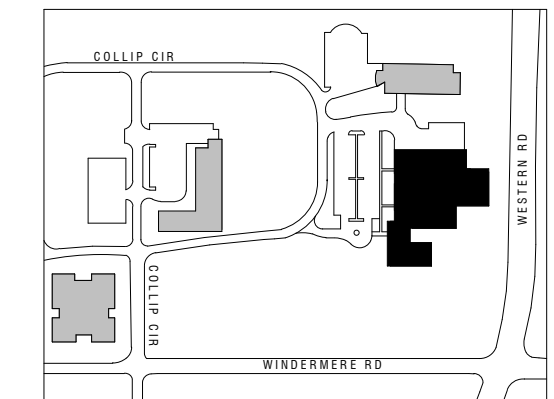

# NATIONAL RESEARCH COUNCIL CANADA

## LONDON ONTARIO CAMPUS

### IMC 0200 - NRC Factory of the Future Demolition Package 2

800 Collip Cir, London, ON N6G 4X8

ISSUED FOR TENDER - 2016-12-13

**CLIENT**  
 NATIONAL RESEARCH COUNCIL / GOVERNMENT OF CANADA  
 800 COLLIP CIRCLE  
 LONDON, ONTARIO  
 N6G 4X8  
 T: 1-877-672-2672

**ARCHITECT**  
 DIAMOND SCHMITT ARCHITECTS  
 384 ADELAIDE STREET WEST, SUITE 100  
 TORONTO, ONTARIO  
 M5V 1R7  
 T: 416-862-8800 F:416-862-5508 info@dsai.ca www.dsai.ca

**MECHANICAL ENGINEER**  
 SMITH + ANDERSEN  
 148 FULLARTON STREET, SUITE 1400  
 LONDON, ONTARIO  
 N6A 5P3  
 T: 519-963-8888 F:416-487-9104

**ELECTRICAL ENGINEER**  
 SMITH + ANDERSEN  
 148 FULLARTON STREET, SUITE 1400  
 LONDON, ONTARIO  
 N6A 5P3  
 T: 519-963-8888 F:416-487-9104

**ARCHITECTURAL DRAWINGS;**

- IMC0200 - CS1 - COVER SHEET
- IMC0200 - A01 - SITE PLAN
- IMC0200 - A02 - LEVEL 1 - REFERENCE PLAN
- IMC0200 - A03 - ROOF - REFERENCE PLAN
- IMC0200 - A04 - LEVEL 1 - DEMOLITION PLAN
- IMC0200 - A05 - LEVEL 1 - DEMOLITION PLAN
- IMC0200 - A06 - LEVEL 1 - DEMOLITION PLAN
- IMC0200 - A07 - ROOF - DEMOLITION PLAN
- IMC0200 - A08 - LEVEL 1 - DEMOLITION REFLECTED CEILING PLAN
- IMC0200 - A09 - LEVEL 1 - DEMOLITION REFLECTED CEILING PLAN
- IMC0200 - A10 - LEVEL 1 - DEMOLITION REFLECTED CEILING PLAN
- IMC0200 - A11 - PARTIAL FLOOR PLAN, DETAILS, DOOR SCHEDULE

**MECHANICAL DRAWINGS;**

- 0200 - M01 - MECHANICAL DRAWING LIST AND LEGENDS
- 0200 - M02 - MECHANICAL LEGENDS
- 0200 - M03 - RECEPTION AREA DEMOLITION
- 0200 - M04 - LEVEL 1 DEMOLITION PLUMBING
- 0200 - M05 - LEVEL 1 DEMOLITION HVAC
- 0200 - M06 - LEVEL 1 DEMOLITION FIRE PROTECTION
- 0200 - M07 - ROOF DEMOLITION HVAC

**ELECTRICAL DRAWINGS;**

- IMC0200 - E000 - ELECTRICAL COVER PAGE
- IMC0200 - E100 - KEYPLAN
- IMC0200 - E200 - LEVEL 1 DEMOLITION
- IMC0200 - E201 - LEVEL 1 DEMOLITION AND NEW
- IMC0200 - E202 - RECEPTION AREA REVISIONS
- IMC0200 - E300 - LEVEL 1 POWER AND LIGHTING

**Diamond Schmitt Architects**  
 384 Adelaide Street West, Suite 300, Toronto, Canada M5V1R7  
 Tel: 416 862 8800 Fax: 416 862 5508 info@dsai.ca www.dsai.ca

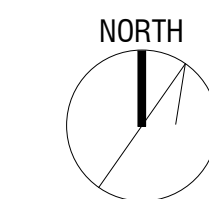

1552

**NRC Factory of the Future**  
**Demolition Package 2**

800 Collip Cir, London, ON N6G 4X8

drawing dessin

**COVER SHEET**

designed	conçu	date	date
DSAI		2016-12-13	
drawn	dessiné	scale:	échelle
DSAI			
checked	vérifié	sheet	feuille
approved	approuvé	W.O. no	D.T. no

dwg.no. dessin no.

**IMC0200-CS1**

C:\Users\ASCARLAT\Revit\_Files\1552 NRC-FOTF-BUILDING-DEM02\_ASCARLAT.rvt

12/19/2016 3:41:34 PM

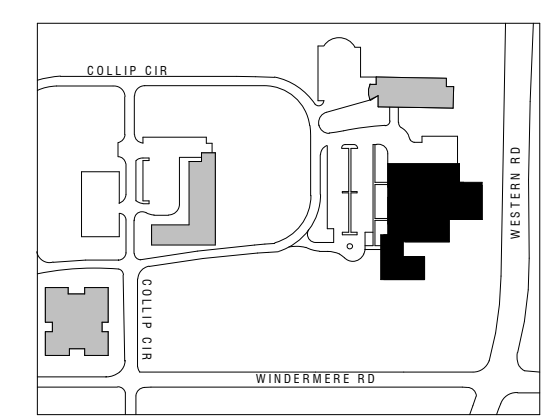
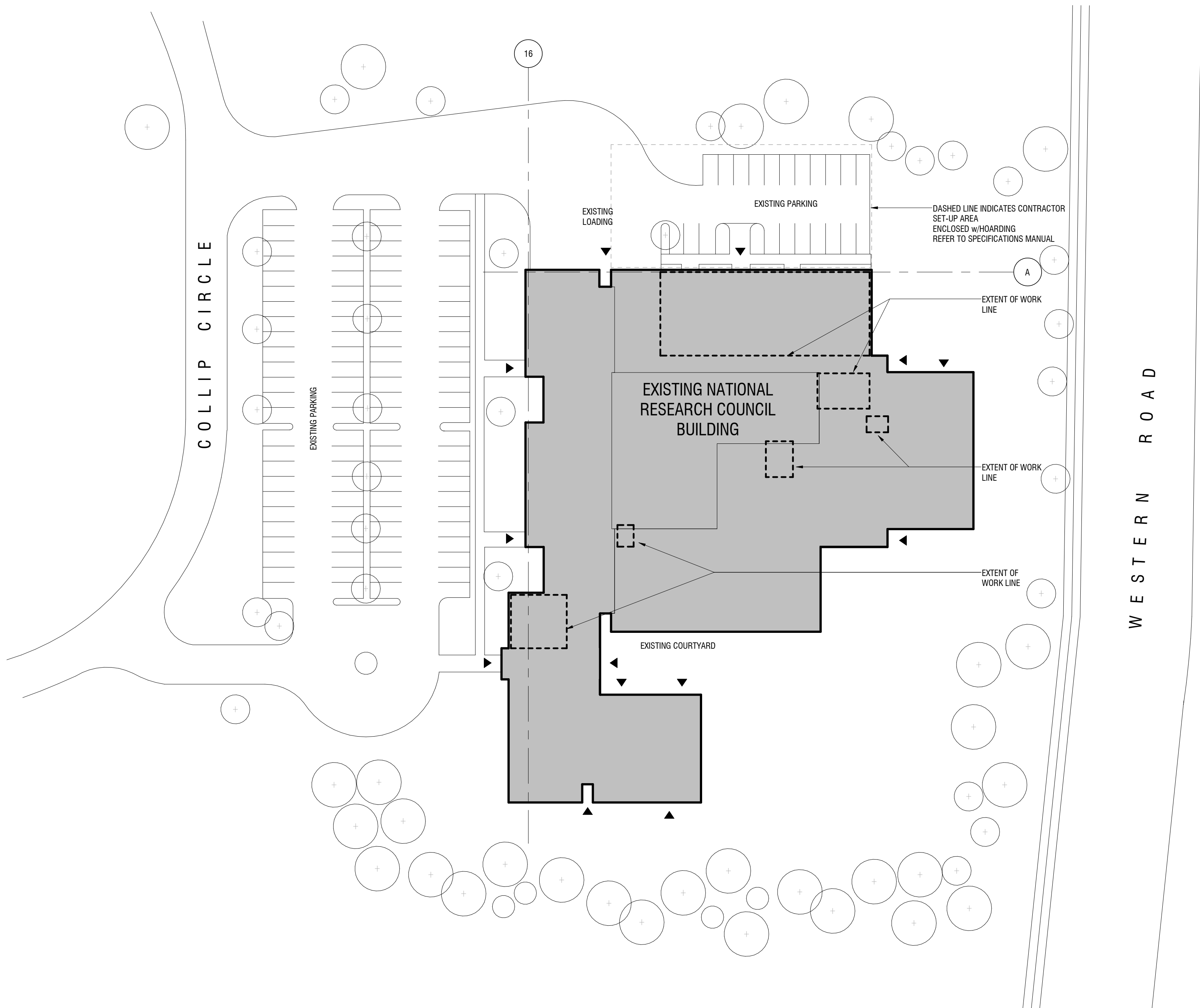

**ISSUED:**

No.	Date	Description
1	2016-11-23	ISSUED FOR TENDER

**GENERAL DEMOLITION NOTES:**

- REFER TO SPECIFICATIONS
- DASHED LINES INDICATE EXISTING BUILDING ELEMENTS TO BE REMOVED. PATCH AND MAKE GOOD WHERE CONNECTED TO EXISTING BUILDING ELEMENTS TO REMAIN.
- IT IS THE RESPONSIBILITY OF THE GENERAL CONTRACTOR TO COORDINATE ALL DEMOLITION w/ ALL PROPOSED WORK AS INDICATED ON THESE DRAWINGS AND AS REQUIRED TO PROVIDE A COMPLETE AND FINISHED PROJECT.
- REFER TO CONSTRUCTION DOCUMENTS OF ALL DISCIPLINES AND COORDINATE SCOPE OF WORK SHOWN ON ARCHITECTURAL DEMOLITION DRAWINGS WITH DEMOLITION DRAWINGS PREPARED BY ALL OTHER CONSULTING DISCIPLINES.
- DEMOLITION CONTRACTOR TO FIELD VERIFY & COORDINATE REMOVAL OF ELECTRICAL AND MECHANICAL COMPONENTS AS SHOWN ON ALL DRAWINGS WHICH PERTAIN TO THESE DISCIPLINES AND AS NECESSARY FOR PREPARATION FOR PROPOSED WORK. ASSUME ALL BUILDING SERVICES ARE ACTIVE AND ELECTRIFIED & ALL OTHER WIRES ARE LIVE PRIOR TO COMMENCEMENT OF ANY WORK. SEE ALL OTHER DRAWINGS FOR THIS PROJECT.
- UNLESS OTHERWISE NOTED, ALL DEMOLISHED MATERIAL IS TO BE DISPOSED OF AS PART OF THIS CONTRACT AND AS NOTED IN SPECIFICATIONS.
- GENERAL CONTRACTOR TO ENSURE THAT ALL EXISTING CONSTRUCTION WHICH IS TO REMAIN IS PROTECTED AND NOT DISTURBED OR DAMAGED BY THE DEMOLITION WORK.
- ALL EXISTING FIRE RESISTANCE RATINGS ARE TO BE MAINTAINED DURING DEMOLITION. IF ANY FIRE RATINGS ARE JEOPARDIZED DURING DEMOLITION, THE RECONSTRUCTION OF SAME IS THE RESPONSIBILITY OF THE GENERAL CONTRACTOR AND MUST BE INCLUDED AS A PART OF THIS CONTRACT.
- REMOVE ALL EXISTING ROOM NAME/NUMBER SIGNS. PATCH AND MAKE GOOD WALL FINISH AS REQUIRED TO MATCH EXISTING ADJACENT WALL FINISHES
- REMOVE ALL UNUSED AND EXPOSED NAILS AND SCREWS ON EXISTING WALLS; PATCH AND MAKE GOOD EXISTING WALL SURFACE BEFORE REPAINTING.
- REMOVE EXISTING WHITEBOARDS, BLACKBOARDS, TACKBOARDS AND ALL ASSOCIATED RAILINGS; TURN OVER TO OWNER AND WHERE ANY OF THE ABOVE ARE MOUNTED ON EXISTING WALLS THAT WILL REMAIN IN PLACE, PATCH AND MAKE GOOD EXISTING WALL SURFACE BEFORE REPAINTING
- PRIOR TO START OF DEMOLITION, THE GENERAL CONTRACTOR AND NRC DEPARTMENTAL REPRESENTATIVE SHALL TOUR ALL WORK AREAS FOR THE PURPOSE OF CONFIRMING ALL ITEMS TO BE SALVAGED BY THE CONTRACTOR AND TURNED OVER TO THE NRC DEPARTMENTAL REPRESENTATIVE.
- DEMOLITION SHALL BE UNDERTAKEN IN ACCORDANCE WITH NRC DEPARTMENTAL REPRESENTATIVE REQUIREMENTS FOR WORK WITHIN OCCUPIED BUILDINGS AND IN A MANNER THAT MINIMIZES DISRUPTION OF BUILDING INHABITANTS.
- EXISTING WINDOW TREATMENTS TO REMAIN

**Diamond Schmitt Architects**  
 384 Adelaide Street West, Suite 300, Toronto, Canada M5V1R7  
 Tel: 416 862 8800 Fax: 416 862 5508 info@dsai.ca www.dsai.ca

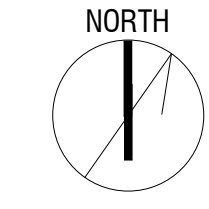

1552  
**NRC Factory of the Future  
 Demolition Package 2**  
 800 Collip Cir, London, ON N6G 4X8

drawing				dessin			
SITE PLAN							
designed	conçu	date	date	drawn	dessiné	scale:	échelle
Designer		2016-12-13		Designer		1 : 500	
checked	vérifié	sheet	feuille	approved	approuvé	W.O. no	D.T. no

dwg.no. 1  
 dessin no. A01  
**IMC0200-A01**

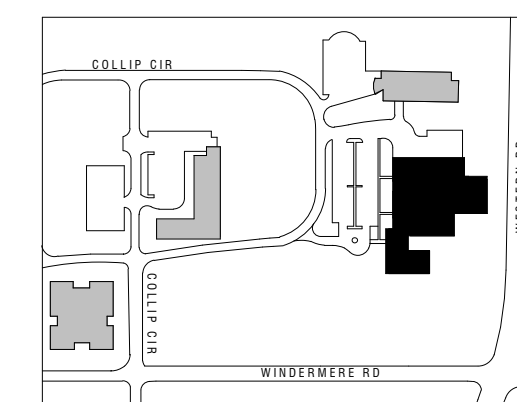

**ISSUED:**

No.	Date	Description
1	2016-11-23	ISSUED FOR TENDER

**GENERAL DEMOLITION NOTES:**

- REFER TO SPECIFICATIONS
- DASHED LINES INDICATE EXISTING BUILDING ELEMENTS TO BE REMOVED. PATCH AND MAKE GOOD WHERE CONNECTED TO EXISTING BUILDING ELEMENTS TO REMAIN.
- IT IS THE RESPONSIBILITY OF THE GENERAL CONTRACTOR TO COORDINATE ALL DEMOLITION WITH ALL PROPOSED WORK AS INDICATED ON THESE DRAWINGS AND AS REQUIRED TO PROVIDE A COMPLETE AND FINISHED PROJECT.
- REFER TO CONSTRUCTION DOCUMENTS OF ALL DISCIPLINES AND COORDINATE SCOPE OF WORK SHOWN ON ARCHITECTURAL DEMOLITION DRAWINGS WITH DEMOLITION DRAWINGS PREPARED BY ALL OTHER CONSULTING DISCIPLINES.
- DEMOLITION CONTRACTOR TO FIELD VERIFY & COORDINATE REMOVAL OF ELECTRICAL AND MECHANICAL COMPONENTS AS SHOWN ON ALL DRAWINGS WHICH PERTAIN TO THESE DISCIPLINES AND AS NECESSARY FOR PREPARATION FOR PROPOSED WORK. ASSUME ALL BUILDING SERVICES ARE ACTIVE AND ELECTRIFIED & ALL OTHER WIRES ARE LIVE PRIOR TO COMMENCEMENT OF ANY WORK. SEE ALL OTHER DRAWINGS FOR THIS PROJECT.
- UNLESS OTHERWISE NOTED, ALL DEMOLISHED MATERIAL IS TO BE DISPOSED OF AS PART OF THIS CONTRACT AND AS NOTED IN SPECIFICATIONS.
- GENERAL CONTRACTOR TO ENSURE THAT ALL EXISTING CONSTRUCTION WHICH IS TO REMAIN IS PROTECTED AND NOT DISTURBED OR DAMAGED BY THE DEMOLITION WORK.
- ALL EXISTING FIRE RESISTANCE RATINGS ARE TO BE MAINTAINED DURING DEMOLITION. IF ANY FIRE RATINGS ARE JEOPARDIZED DURING DEMOLITION, THE RECONSTRUCTION OF SAME IS THE RESPONSIBILITY OF THE GENERAL CONTRACTOR AND MUST BE INCLUDED AS A PART OF THIS CONTRACT.
- REMOVE ALL EXISTING FIRE RESISTANCE ROOM NAME/NUMBER SIGNS. PATCH AND MAKE GOOD WALL FINISH AS REQUIRED TO MATCH EXISTING ADJACENT WALL FINISHES.
- REMOVE ALL UNUSED AND EXPOSED NAILS AND SCREWS ON EXISTING WALLS. PATCH AND MAKE GOOD EXISTING WALL SURFACE BEFORE REPAINTING.
- REMOVE EXISTING WHITEBOARDS, BLACKBOARDS, TACKBOARDS AND ALL ASSOCIATED RAILINGS. TURN OVER TO OWNER AND WHERE ANY OF THE ABOVE ARE MOUNTED ON EXISTING WALLS THAT WILL REMAIN IN PLACE, PATCH AND MAKE GOOD EXISTING WALL SURFACE BEFORE REPAINTING.
- PRIOR TO START OF DEMOLITION, THE GENERAL CONTRACTOR AND NRC DEPARTMENTAL REPRESENTATIVE SHALL TOUR ALL WORK AREAS FOR THE PURPOSE OF CONFIRMING ALL ITEMS TO BE SALVAGED BY THE CONTRACTOR AND TURNED OVER TO THE NRC DEPARTMENTAL REPRESENTATIVE.
- DEMOLITION SHALL BE UNDERTAKEN IN ACCORDANCE WITH NRC DEPARTMENTAL REPRESENTATIVE REQUIREMENTS FOR WORK WITHIN OCCUPIED BUILDINGS AND IN A MANNER THAT MINIMIZES DISRUPTION OF BUILDING INHABITANTS.
- EXISTING WINDOW TREATMENTS TO REMAIN

**Diamond Schmitt Architects**

384 Adelaide Street West, Suite 300, Toronto, Canada M5V1R7  
 Tel: 416 862 8800 Fax: 416 862 5508 info@dsai.ca www.dsai.ca

NORTH

1552  
**NRC Factory of the Future  
 Demolition Package 2**

800 Collip Cir, London, ON N6G 4X8

drawing **LEVEL 1 - REFERENCE PLAN** dessin

designed	conçu	date	date
Designer		2016-12-13	
drawn	dessiné	scale:	échelle
Designer		1 : 300	
checked	vérifié	sheet	feuille
approved	approuvé	W.O. no	D.T. no

dwg.no. 1 dessin no. **IMC0200-A02**

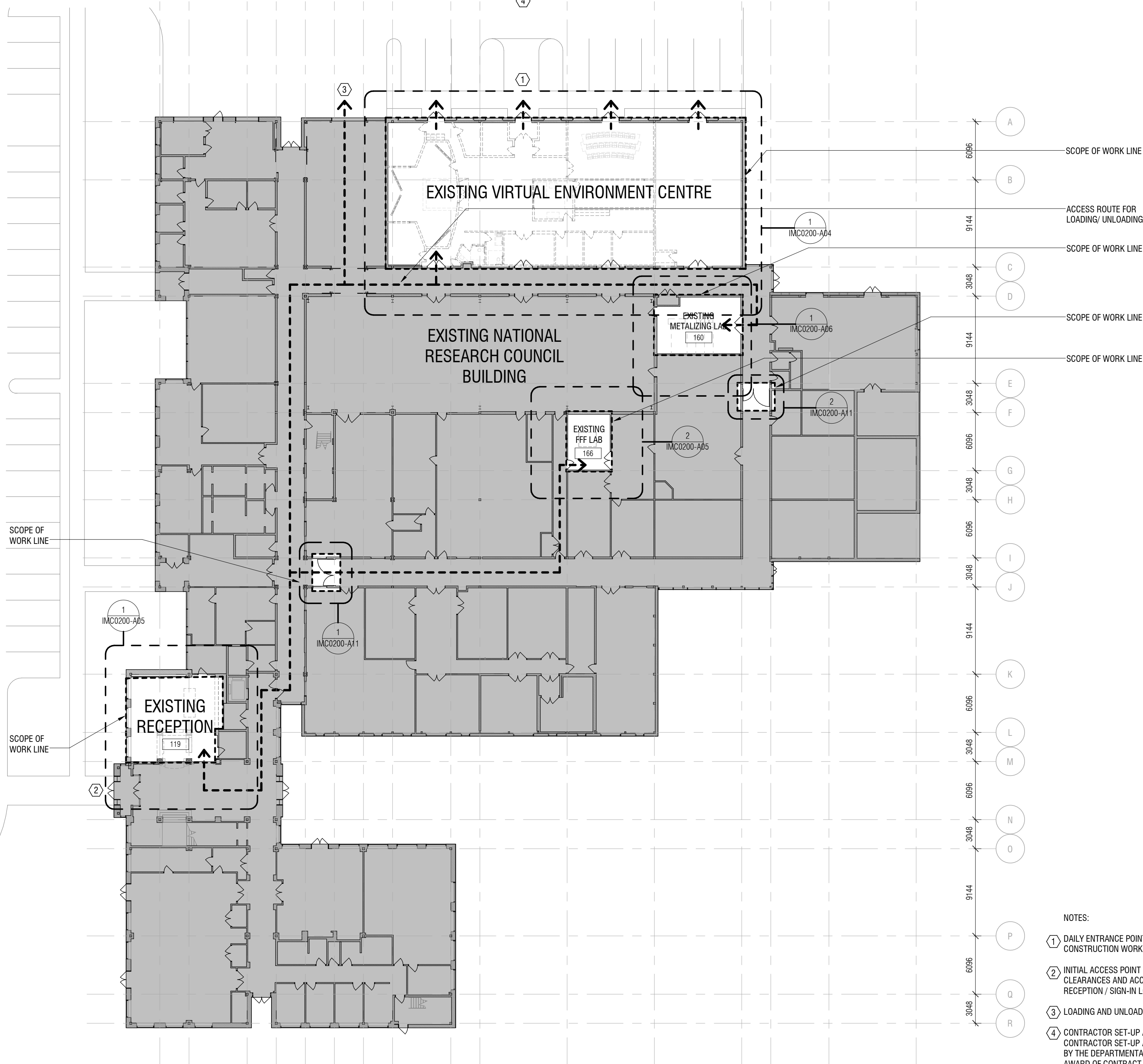
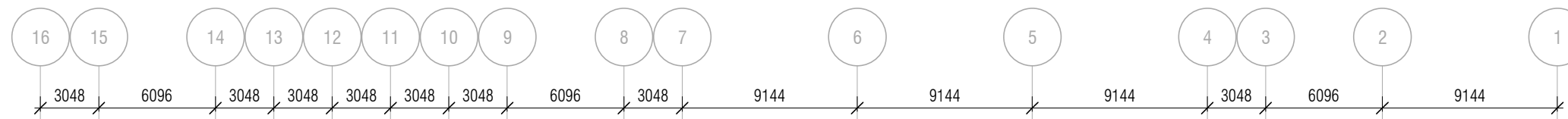

**NOTES:**

- DAILY ENTRANCE POINT FOR CONTRACTORS AND CONSTRUCTION WORKERS.
- INITIAL ACCESS POINT TO OBTAIN SECURITY CLEARANCES AND ACCESS CARDS (TEMPORARY RECEPTION / SIGN-IN LOCATION TBD)
- LOADING AND UNLOADING AREA.
- CONTRACTOR SET-UP AREA. EXTENTS OF CONTRACTOR SET-UP AREA TO BE DETERMINED BY THE DEPARTMENTAL REPRESENTATIVE UPON AWARD OF CONTRACT

**LEVEL 1 - DEMOLITION REFERENCE PLAN**

1 : 300

1 / A02

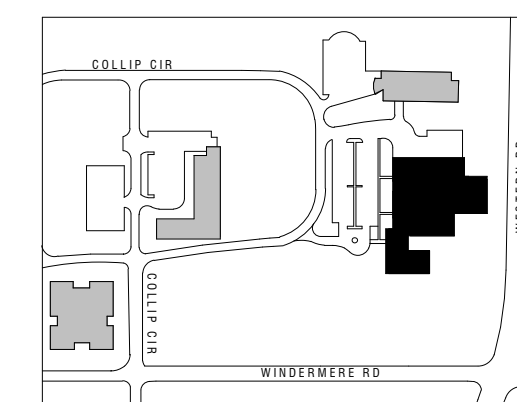

**ISSUED:**

No.	Date	Description
1	2016-11-23	ISSUED FOR TENDER

**GENERAL DEMOLITION NOTES:**

- REFER TO SPECIFICATIONS
- DASHED LINES INDICATE EXISTING BUILDING ELEMENTS TO BE REMOVED. PATCH AND MAKE GOOD WHERE CONNECTED TO EXISTING BUILDING ELEMENTS TO REMAIN.
- IT IS THE RESPONSIBILITY OF THE GENERAL CONTRACTOR TO COORDINATE ALL DEMOLITION WITH ALL PROPOSED WORK AS INDICATED ON THESE DRAWINGS AND AS REQUIRED TO PROVIDE A COMPLETE AND FINISHED PROJECT.
- REFER TO CONSTRUCTION DOCUMENTS OF ALL DISCIPLINES AND COORDINATE SCOPE OF WORK SHOWN ON ARCHITECTURAL DEMOLITION DRAWINGS WITH DEMOLITION DRAWINGS PREPARED BY ALL OTHER CONSULTING DISCIPLINES.
- DEMOLITION CONTRACTOR TO FIELD VERIFY & COORDINATE REMOVAL OF ELECTRICAL AND MECHANICAL COMPONENTS AS SHOWN ON ALL DRAWINGS WHICH PERTAIN TO THESE DISCIPLINES AND AS NECESSARY FOR PREPARATION FOR PROPOSED WORK. ASSUME ALL BUILDING SERVICES ARE ACTIVE AND ELECTRIFIED & ALL OTHER WIRES ARE LIVE PRIOR TO COMMENCEMENT OF ANY WORK. SEE ALL OTHER DRAWINGS FOR THIS PROJECT.
- UNLESS OTHERWISE NOTED, ALL DEMOLISHED MATERIAL IS TO BE DISPOSED OF AS PART OF THIS CONTRACT AND AS NOTED IN SPECIFICATIONS.
- GENERAL CONTRACTOR TO ENSURE THAT ALL EXISTING CONSTRUCTION WHICH IS TO REMAIN IS PROTECTED AND NOT DISTURBED OR DAMAGED BY THE DEMOLITION WORK.
- ALL EXISTING FIRE RESISTANCE RATINGS ARE TO BE MAINTAINED DURING DEMOLITION. IF ANY FIRE RATINGS ARE JEOPARDIZED DURING DEMOLITION, THE RECONSTRUCTION OF SAME IS THE RESPONSIBILITY OF THE GENERAL CONTRACTOR AND MUST BE INCLUDED AS A PART OF THIS CONTRACT.
- REMOVE ALL EXISTING ROOM NAME/NUMBER SIGNS. PATCH AND MAKE GOOD WALL FINISH AS REQUIRED TO MATCH EXISTING ADJACENT WALL FINISHES
- REMOVE ALL UNUSED AND EXPOSED NAILS AND SCREWS ON EXISTING WALLS. PATCH AND MAKE GOOD EXISTING WALL SURFACE BEFORE REPAINTING.
- REMOVE EXISTING WHITEBOARDS, BLACKBOARDS, TACKBOARDS AND ALL ASSOCIATED RAILINGS. TURN OVER TO OWNER AND WHERE ANY OF THE ABOVE ARE MOUNTED ON EXISTING WALLS THAT WILL REMAIN IN PLACE, PATCH AND MAKE GOOD EXISTING WALL SURFACE BEFORE REPAINTING
- PRIOR TO START OF DEMOLITION, THE GENERAL CONTRACTOR AND NRC DEPARTMENTAL REPRESENTATIVE SHALL TOUR ALL WORK AREAS FOR THE PURPOSE OF CONFIRMING ALL ITEMS TO BE SALVAGED BY THE CONTRACTOR AND TURNED OVER TO THE NRC DEPARTMENTAL REPRESENTATIVE.
- DEMOLITION SHALL BE UNDERTAKEN IN ACCORDANCE WITH NRC DEPARTMENTAL REPRESENTATIVE REQUIREMENTS FOR WORK WITHIN OCCUPIED BUILDINGS AND IN A MANNER THAT MINIMIZES DISRUPTION OF BUILDING INHABITANTS.
- EXISTING WINDOW TREATMENTS TO REMAIN

**Diamond Schmitt Architects**

384 Adelaide Street West, Suite 300, Toronto, Canada M5V1R7  
 Tel: 416 862 8800 Fax: 416 862 5508 info@dsai.ca www.dsai.ca

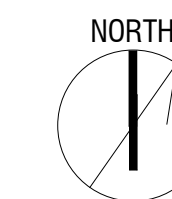

1552

**NRC Factory of the Future  
 Demolition Package 2**

800 Collip Cir, London, ON N6G 4X8

drawing **ROOF - REFERENCE PLAN** dessin

designed	conçu	date	date
DSAI		2016-12-13	
drawn	dessiné	scale:	échelle
DSAI		1 : 300	
checked	vérifié	sheet	feuille
approved	approuvé	W.O. no	D.T. no

dwg.no. dessin no.

**IMC0200-A03**

C:\Users\ASCARLAT\Revit\_Files\1552 NRC-FOTF-BUILDING-DEM02\_ASCARLAT.rvt

12/19/2016 3:41:37 PM

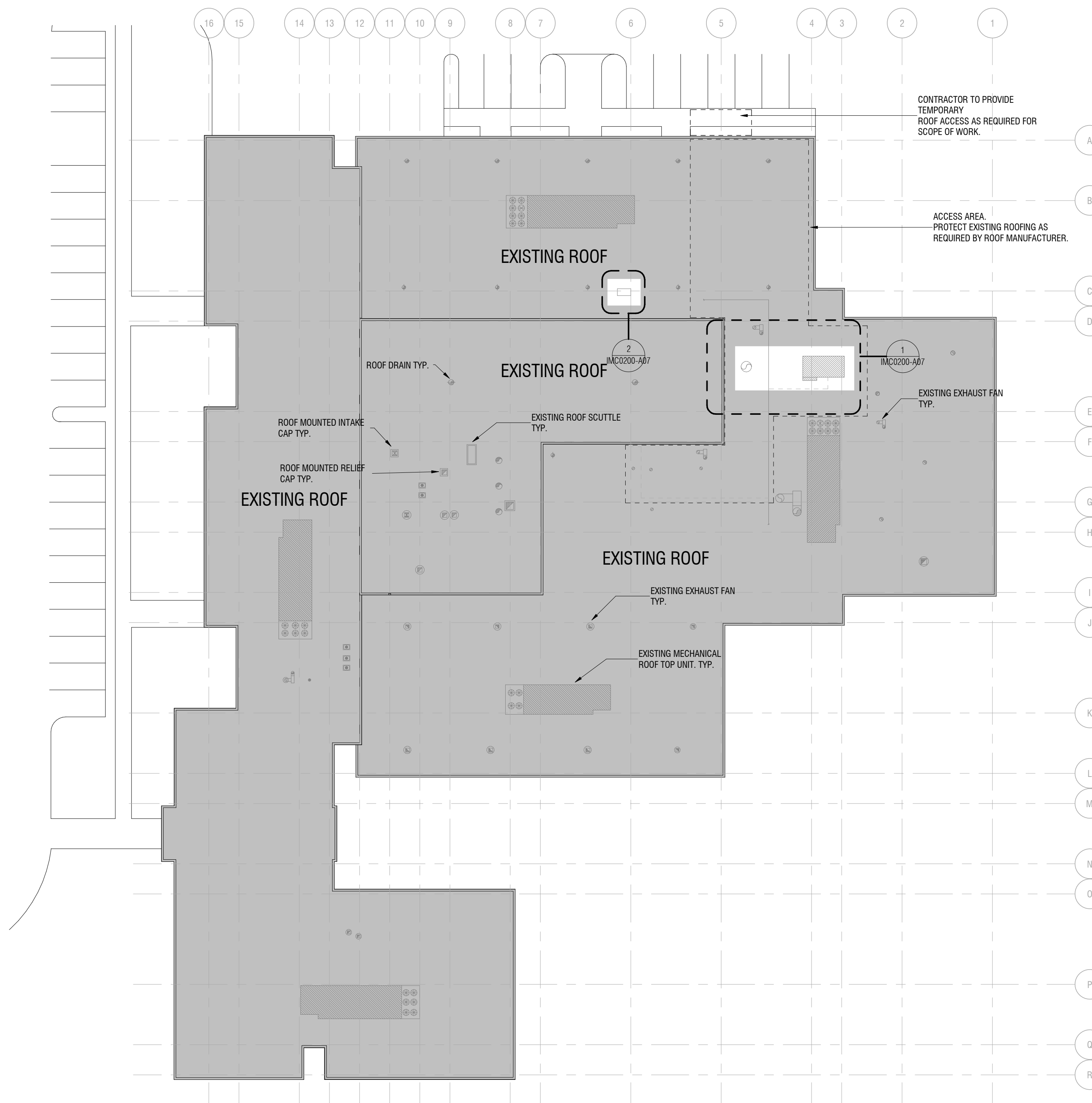

**ROOF - DEMOLITION REFERENCE PLAN**

1  
 1 : 300  
 A03

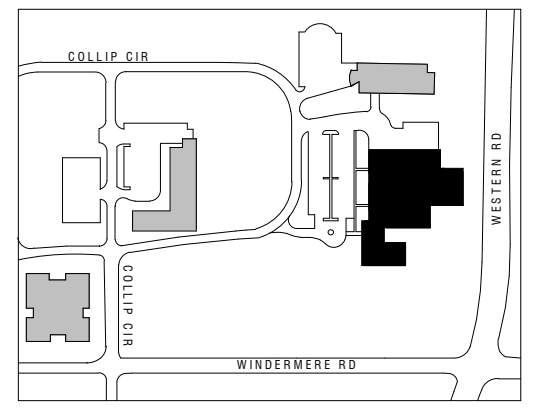

LEGEND:

- EXISTING PARTITION TO REMAIN
- EXISTING PARTITION TO BE REMOVED
- EXISTING DOOR/FRAME TO REMAIN
- EXISTING DOOR/DRAPE TO BE REMOVED
- EXISTING WINDOW TO REMAIN
- EXISTING FLOOR DRAIN TO REMAIN, REFER TO MECHANICAL
- EXISTING PULL ALARM TO BE RELOCATED

NOTES:

- ① REMOVE EXISTING WOOD SHELVING.
- ② EXISTING ELECTRICAL WIRE RACEWAY TO REMAIN. REFER TO ELECTRICAL DRAWINGS.
- ③ REMOVE EXISTING RADIANT HEATER. REFER TO MECHANICAL DRAWINGS.
- ④ REMOVE EXISTING CARPET FLOOR FINISH, ASSOCIATED TRANSITIONS STRIPS, ADJACENT RESILIENT WALL BASE AND ASSOCIATED ADHESIVE. REMOVE RESIDUAL ADHESIVE AND PREPARE CONCRETE FLOOR SURFACE FOR FUTURE CLEAR COAT. REMOVE RESIDUAL ADHESIVE AND PREP CONCRETE BLOCK WALLS FOR FUTURE PAINT FINISH.
- ⑤ REMOVE EXISTING INTERIOR PARTITIONS, ASSOCIATED WALL BASE, DOORS, AND FRAMES. REFER TO MECHANICAL AND ELECTRICAL DRAWINGS FOR DEVICES TO BE REMOVED AND/OR RELOCATED. PATCH AND MAKE GOOD EXISTING TO REMAIN SURFACES.
- ⑥ EXISTING FIRE EXTINGUISHER TO BE RELOCATED, REFER TO MECHANICAL DRAWINGS.
- ⑦ REMOVE EXISTING UPPER AND LOWER MILLWORK.
- ⑧ EXISTING ELECTRICAL PANEL TO REMAIN. REFER TO ELECTRICAL DRAWINGS.
- ⑩ REMOVE EXISTING LARGE GLASS PANEL.
- ⑪ REMOVE EXISTING THEATRE SEATING AND BUILT UP PLATFORMS.
- ⑫ EXISTING ELECTRICAL FLOOR BOXES TO REMAIN. REFER TO ELECTRICAL DRAWINGS.
- ⑬ REMOVE EXISTING FLOOR TILE FINISH, ASSOCIATED TRANSITIONS STRIPS, ADJACENT TILE WALL BASE AND ASSOCIATED MORTAR / GROUT / ADHESIVE. REMOVE RESIDUAL MORTAR / GROUT / ADHESIVE AND PREPARE CONCRETE FLOOR SURFACE FOR FUTURE CLEAR COAT.
- ⑭ REMOVE EXISTING MILLWORK. REFER TO MECHANICAL DRAWINGS FOR PLUMBING SERVICES REMOVAL.
- ⑮ REMOVE EXISTING RADIANT HEATER. REFER TO MECHANICAL DRAWINGS.
- ⑯ REMOVE EXISTING SCREEN AND ASSOCIATED FRAMING SYSTEM.
- ⑰ REMOVE EXISTING MIRROR PANEL AND ASSOCIATED MOUNTING SYSTEM.
- ⑱ REMOVE RAISED FLOORING AND ASSOCIATED SUPPORT SYSTEM.
- ⑲ REMOVE SLOPPED CONCRETE BUILD-UP TOPPING. PREPARE CONCRETE FLOOR SURFACE FOR FUTURE CLEAR COAT.
- ⑳ REMOVE EXISTING PLUMBING FIXTURES, VANITIES, WASHROOM ACCESSORIES, AND GRAB BARS. REFER TO MECHANICAL DRAWINGS FOR PLUMBING REMOVAL.
- ㉑ RELOCATED PULL STATION, REFER TO ELECTRICAL DRAWINGS.
- ㉒ REMOVE EXISTING COMMUNICATION RACK AND BACK BOARD TO BE REMOVED, REFER TO ELECTRICAL.
- ㉓ EXISTING FIRE ALARM SIGNAL TO REMAIN, REFER TO ELECTRICAL DRAWINGS.
- ㉔ REMOVE EXISTING HVAC UNIT. REFER TO MECHANICAL AND ELECTRICAL DRAWINGS.

ISSUED:

No.	Date	Description
1	2016-11-23	ISSUED FOR TENDER

GENERAL DEMOLITION NOTES:

1. REFER TO SPECIFICATIONS
2. DASHED LINES INDICATE EXISTING BUILDING ELEMENTS TO BE REMOVED. PATCH AND MAKE GOOD WHERE CONNECTED TO EXISTING BUILDING ELEMENTS TO REMAIN.
3. IT IS THE RESPONSIBILITY OF THE GENERAL CONTRACTOR TO COORDINATE ALL DEMOLITION WITH ALL PROPOSED WORK AS INDICATED ON THESE DRAWINGS AND AS REQUIRED TO PROVIDE A COMPLETE AND FINISHED PROJECT.
4. REFER TO CONSTRUCTION DOCUMENTS OF ALL DISCIPLINES AND COORDINATE SCOPE OF WORK SHOWN ON ARCHITECTURAL DEMOLITION DRAWINGS WITH DEMOLITION DRAWINGS PREPARED BY ALL OTHER CONSULTING DISCIPLINES.
5. DEMOLITION CONTRACTOR TO FIELD VERIFY & COORDINATE REMOVAL OF ELECTRICAL AND MECHANICAL COMPONENTS AS SHOWN ON ALL DRAWINGS WHICH PERTAIN TO THESE DISCIPLINES AND AS NECESSARY FOR PREPARATION FOR PROPOSED WORK. ASSUME ALL BUILDING SERVICES ARE ACTIVE AND ELECTRIFIED & ALL OTHER WIRES ARE LIVE PRIOR TO COMMENCEMENT OF ANY WORK. SEE ALL OTHER DRAWINGS FOR THIS PROJECT.
6. UNLESS OTHERWISE NOTED, ALL DEMOLISHED MATERIAL IS TO BE DISPOSED OF AS PART OF THIS CONTRACT AND AS NOTED IN SPECIFICATIONS.
7. GENERAL CONTRACTOR TO ENSURE THAT ALL EXISTING CONSTRUCTION WHICH IS TO REMAIN IS PROTECTED AND NOT DISTURBED OR DAMAGED BY THE DEMOLITION WORK.
8. ALL EXISTING FIRE RESISTANCE RATINGS ARE TO BE MAINTAINED DURING DEMOLITION. IF ANY FIRE RATINGS ARE JEOPARDIZED DURING DEMOLITION, THE RECONSTRUCTION OF SAME IS THE RESPONSIBILITY OF THE GENERAL CONTRACTOR AND MUST BE INCLUDED AS A PART OF THIS CONTRACT.
9. REMOVE ALL EXISTING ROOM NAME/NUMBER SIGNS. PATCH AND MAKE GOOD WALL FINISH AS REQUIRED TO MATCH EXISTING ADJACENT WALL FINISHES.
10. REMOVE ALL UNUSED AND EXPOSED NAILS AND SCREWS ON EXISTING WALLS. PATCH AND MAKE GOOD EXISTING WALL SURFACE BEFORE REPAINTING.
11. REMOVE EXISTING WHITEBOARDS, BLACKBOARDS, TACKBOARDS AND ALL ASSOCIATED RAILINGS. TURN OVER TO OWNER AND WHERE ANY OF THE ABOVE ARE MOUNTED ON EXISTING WALLS THAT WILL REMAIN IN PLACE. PATCH AND MAKE GOOD EXISTING WALL SURFACE BEFORE REPAINTING.
12. PRIOR TO START OF DEMOLITION, THE GENERAL CONTRACTOR AND NRC DEPARTMENTAL REPRESENTATIVE SHALL TOUR ALL WORK AREAS FOR THE PURPOSE OF CONFIRMING ALL ITEMS TO BE SALVAGED BY THE CONTRACTOR AND TURNED OVER TO THE NRC DEPARTMENTAL REPRESENTATIVE.
13. DEMOLITION SHALL BE UNDERTAKEN IN ACCORDANCE WITH NRC DEPARTMENTAL REPRESENTATIVE REQUIREMENTS FOR WORK WITHIN OCCUPIED BUILDINGS AND IN A MANNER THAT MINIMIZES DISRUPTION OF BUILDING INHABITANTS.
14. EXISTING WINDOW TREATMENTS TO REMAIN

**Diamond Schmitt Architects**  
 384 Adelaide Street West, Suite 300, Toronto, Canada M5V1R7  
 Tel: 416 862 8800 Fax: 416 862 5508 info@dsai.ca www.dsai.ca

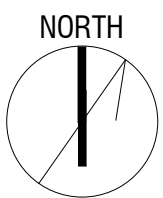

1552  
**NRC Factory of the Future  
 Demolition Package 2**  
 800 Collip Cir, London, ON N6G 4X8

drawing				dessin			
designed	conçu	date	date	drawn	dessiné	scale:	échelle
DSAI		2016-12-13		DSAI		1 : 100	
checked	vérifié	sheet	feuille	approved	approuvé	W.O. no	D.T. no

dwg.no. 1  
 dessin.no. A04  
**IMC0200-A04**

C:\Users\ASCARLAT\Revit\_Files\1552 NRC-FOTF-BUILDING-DEM02\_ASCARLAT.rvt

12/19/2016 3:41:38 PM

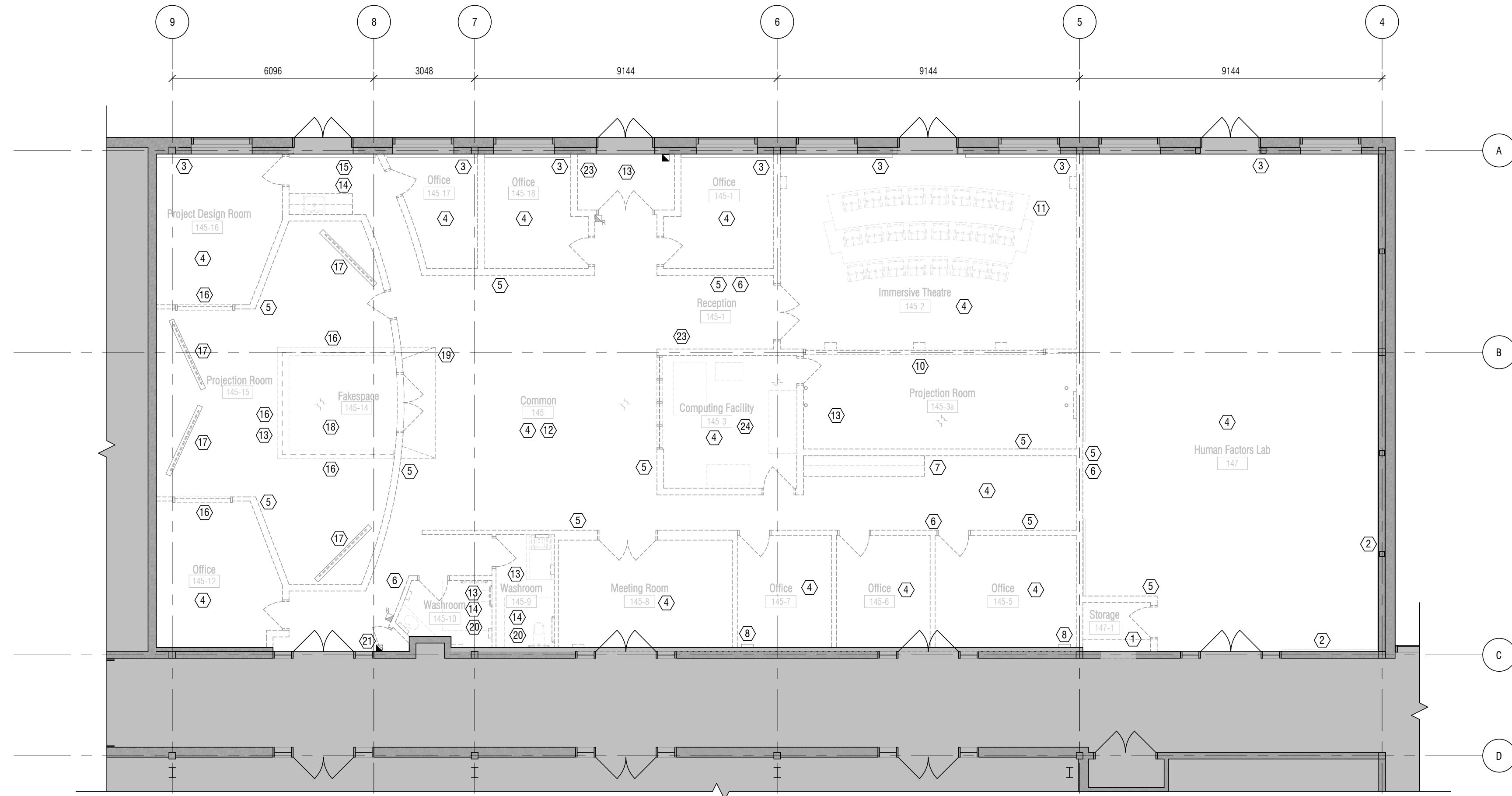

C:\Users\ASCARLAT\Revit\_Files\1552 NRC-FOTF-BUILDING-DEM02\_ASCARLAT.rvt

12/19/2016 3:41:39 PM

- LEGEND:**
- EXISTING PARTITION TO REMAIN
  - EXISTING PARTITION TO BE REMOVED
  - EXISTING DOOR/FRAME TO REMAIN
  - EXISTING DOOR/DRAPE TO BE REMOVED
  - EXISTING WINDOW TO REMAIN
  - EXISTING FLOOR RECEPTACLE TO REMAIN

- NOTES:**
- 1 REMOVE EXISTING MILLWORK DESKS AND SHELVING. PATCH AND MAKE GOOD EXISTING TO REMAIN SURFACES.
  - 2 REMOVE EXISTING MILLWORK ISLAND COUNTER AND SHELVING UNIT.
  - 3 REMOVE EXISTING RECEPTION DESK MILLWORK. REFER TO MECHANICAL AND ELECTRICAL DRAWINGS FOR DEVICES TO BE REMOVED AND/OR RELOCATED. PATCH AND MAKE GOOD EXISTING TO REMAIN SURFACES.
  - 4 REMOVE EXISTING FAUX COLUMN, WRAP, AND FRAMING.
  - 5 EXISTING OVERHEAD SHUTTER AND TRACKS TO REMAIN.
  - 6 REMOVE EXISTING CARPET FLOOR FINISH, ASSOCIATED TRANSITIONS STRIPS, ADJACENT RESILIENT WALL BASE AND ASSOCIATED ADHESIVE. REMOVE RESIDUAL ADHESIVE AND PREPARE CONCRETE FLOOR SURFACE FOR FUTURE CARPET INSTALLATION. REMOVE RESIDUAL ADHESIVE FROM WALL BASE AND PREP WALLS FOR PAINT FINISH.
  - 7 EXISTING A.E.D. AND CABINET TO REMAIN. ENSURE ACCESS TO THIS UNIT DURING DEMOLITION.
  - 8 EXISTING ELECTRICAL FLOOR BOXES TO REMAIN. REFER TO ELECTRICAL DRAWINGS.
  - 9 INSTALL TEMPORARY PLYWOOD HOARDING AND ACCESS DOOR IN FRAMED DOOR OPENING PRIOR TO START OF DEMOLITION WORK. TEMPORARY PLYWOOD HOARDING AND ACCESS DOOR TO REMAIN IN OPENING AFTER DEMOLITION WORK IS COMPLETED.
  - 10 PROTECT WINDOWS BY USE OF PLYWOOD HOARDING DURING DEMOLITION.
  - 11 INSTALL TEMPORARY PLYWOOD HOARDING OPENING PRIOR TO START OF DEMOLITION WORK. TEMPORARY PLYWOOD HOARDING TO REMAIN IN OPENING AFTER DEMOLITION WORK IS COMPLETED.
  - 12 PROVIDE PROTECTION FOR EXISTING FINISHES IN LOBBY AREA AS REQUIRED. REMOVE PROTECTION ONCE DEMOLITION WORK IS COMPLETE.
  - 13 EXISTING COPY ROOM 102 WILL NOT BE OCCUPIED DURING DEMOLITION.
  - 14 EXISTING OFFICE 119-1 WILL NOT BE OCCUPIED DURING DEMOLITION.
  - 15 EXISTING VIDEO SURVEILLANCE SYSTEM, DVR AND MONITOR TO BE PROTECTED/RELOCATED AS DIRECTED BY NRC DEPARTMENTAL REPRESENTATIVE.

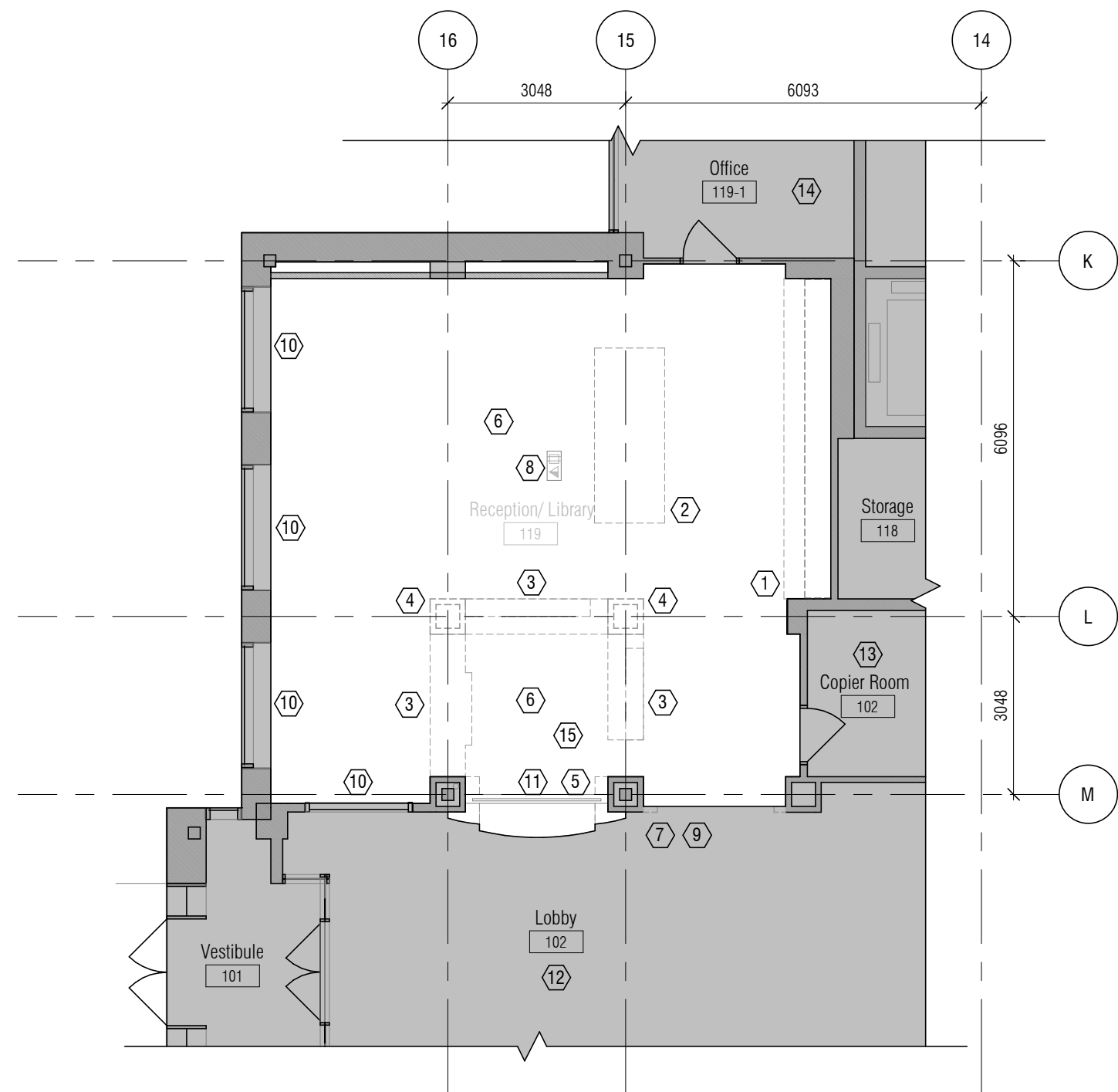

LEVEL 1 - DEMOLITION PLAN 1  
1 : 100 A05

- LEGEND:**
- EXISTING PARTITION TO REMAIN
  - EXISTING PARTITION TO BE REMOVED
  - EXISTING DOOR/FRAME TO REMAIN
  - EXISTING DOOR/DRAPE TO BE REMOVED

- NOTES:**
- 1 REMOVE EXISTING FURNACE. REFER TO MECHANICAL AND ELECTRICAL DRAWINGS. DISMANTLE FURNACE AS REQUIRED TO FIT THROUGH EXISTING DOORWAY.
  - 2 EXISTING CASEWORK TO REMAIN.
  - 3 REMOVE RECEPTACLE ON BACK OF FURNACE AND RELOCATE TO WALL. REFER TO ELECTRICAL DRAWINGS.

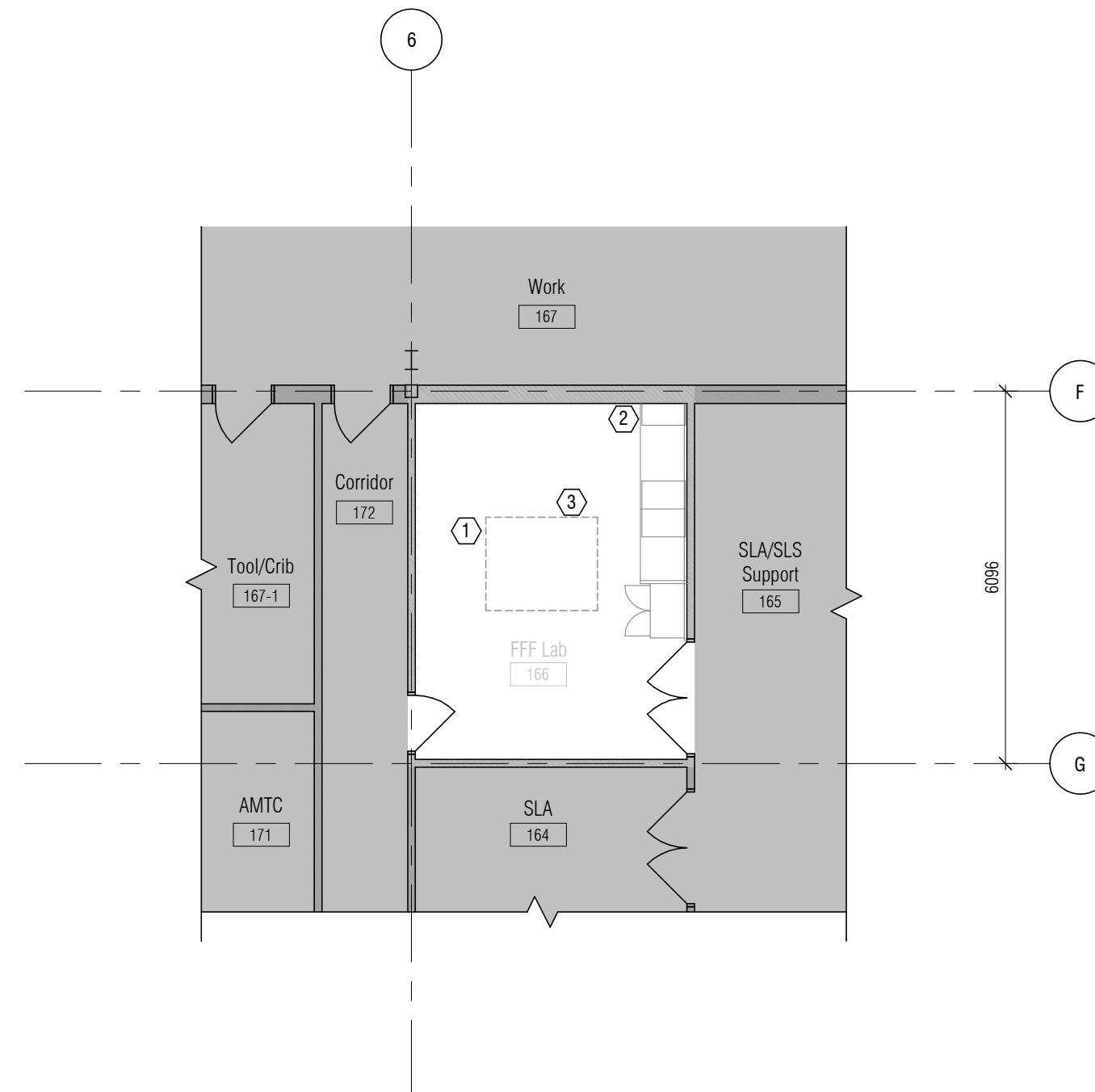

LEVEL 1 - DEMOLITION PLAN 2  
1 : 100 A05

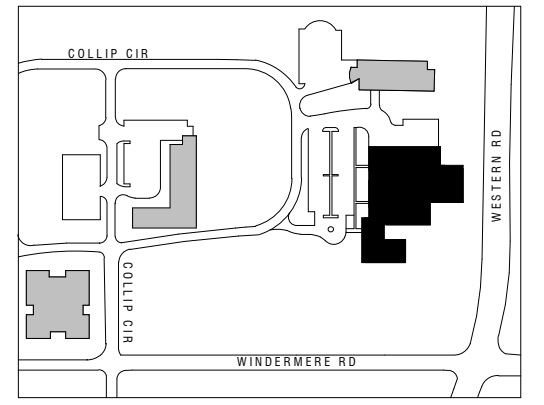

**ISSUED:**

No.	Date	Description
1	2016-11-23	ISSUED FOR TENDER

**GENERAL DEMOLITION NOTES:**

1. REFER TO SPECIFICATIONS
2. DASHED LINES INDICATE EXISTING BUILDING ELEMENTS TO BE REMOVED. PATCH AND MAKE GOOD WHERE CONNECTED TO EXISTING BUILDING ELEMENTS TO REMAIN.
3. IT IS THE RESPONSIBILITY OF THE GENERAL CONTRACTOR TO COORDINATE ALL DEMOLITION WORK SHOWN ON ARCHITECTURAL DEMOLITION DRAWINGS WITH DEMOLITION DRAWINGS PREPARED BY ALL OTHER CONSULTING DISCIPLINES.
4. REFER TO CONSTRUCTION DOCUMENTS OF ALL DISCIPLINES AND COORDINATE SCOPE OF WORK SHOWN ON ARCHITECTURAL DEMOLITION DRAWINGS WITH DEMOLITION DRAWINGS PREPARED BY ALL OTHER CONSULTING DISCIPLINES.
5. DEMOLITION CONTRACTOR TO FIELD VERIFY & COORDINATE REMOVAL OF ELECTRICAL AND MECHANICAL COMPONENTS AS SHOWN ON ALL DRAWINGS WHICH PERTAIN TO THESE DISCIPLINES AND AS NECESSARY FOR PREPARATION FOR PROPOSED WORK. ASSUME ALL BUILDING SERVICES ARE ACTIVE AND ELECTRIFIED & ALL OTHER WIRES ARE LIVE PRIOR TO COMMENCEMENT OF ANY WORK. SEE ALL OTHER DRAWINGS FOR THIS PROJECT.
6. UNLESS OTHERWISE NOTED, ALL DEMOLISHED MATERIAL IS TO BE DISPOSED OF AS PART OF THIS CONTRACT AND AS NOTED IN SPECIFICATIONS.
7. GENERAL CONTRACTOR TO ENSURE THAT ALL EXISTING CONSTRUCTION WHICH IS TO REMAIN IS PROTECTED AND NOT DISTURBED OR DAMAGED BY THE DEMOLITION WORK.
8. ALL EXISTING FIRE RESISTANCE RATINGS ARE TO BE MAINTAINED DURING DEMOLITION. IF ANY FIRE RATINGS ARE JEOPARDIZED DURING DEMOLITION, THE RECONSTRUCTION OF SAME IS THE RESPONSIBILITY OF THE GENERAL CONTRACTOR AND MUST BE INCLUDED AS A PART OF THIS CONTRACT.
9. REMOVE ALL EXISTING ROOM NAME/NUMBER SIGNS. PATCH AND MAKE GOOD WALL FINISH AS REQUIRED TO MATCH EXISTING ADJACENT WALL FINISHES
10. REMOVE ALL UNUSED AND EXPOSED NAILS AND SCREWS ON EXISTING WALLS. PATCH AND MAKE GOOD EXISTING WALL SURFACE BEFORE REPAINTING.
11. REMOVE EXISTING WHITEBOARDS, BLACKBOARDS, TACKBOARDS AND ALL ASSOCIATED RAILINGS. TURN OVER TO OWNER AND WHERE ANY OF THE ABOVE ARE MOUNTED ON EXISTING WALLS THAT WILL REMAIN IN PLACE, PATCH AND MAKE GOOD EXISTING WALL SURFACE BEFORE REPAINTING
12. PRIOR TO START OF DEMOLITION, THE GENERAL CONTRACTOR AND NRC DEPARTMENTAL REPRESENTATIVE SHALL TOUR ALL WORK AREAS FOR THE PURPOSE OF CONFIRMING ALL ITEMS TO BE SALVAGED BY THE CONTRACTOR AND TURNED OVER TO THE NRC DEPARTMENTAL REPRESENTATIVE.
13. DEMOLITION SHALL BE UNDERTAKEN IN ACCORDANCE WITH NRC DEPARTMENTAL REPRESENTATIVE REQUIREMENTS FOR WORK WITHIN OCCUPIED BUILDINGS AND IN A MANNER THAT MINIMIZES DISRUPTION OF BUILDING INHABITANTS.
14. EXISTING WINDOW TREATMENTS TO REMAIN

**Diamond Schmitt Architects**

384 Adelaide Street West, Suite 300, Toronto, Canada M5V1R7  
Tel: 416 862 8800 Fax: 416 862 5508 info@dsai.ca www.dsai.ca

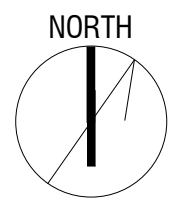

1552

**NRC Factory of the Future  
Demolition Package 2**

800 Collip Cir, London, ON N6G 4X8

drawing **LEVEL 1 - DEMOLITION PLAN** dessin





designed	conçu	date	date
DSAI		2016-12-13	
drawn	dessiné	scale:	échelle
DSAI		1 : 100	
checked	vérifié	sheet	feuille
approved	approuvé	W.O. no	D.T. no

dwg.no. **IMC0200-A05** dessin no.

C:\Users\ASCARLAT\Revit\_Files\1552 NRC-FOTF-BUILDING-DEM02\_ASCARLAT.rvt

12/19/2016 3:41:40 PM

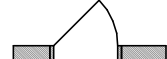
LEGEND:

-  EXISTING PARTITION TO REMAIN
-  EXISTING PARTITION TO BE REMOVED
-  EXISTING DOOR/FRAME TO REMAIN
-  EXISTING DOOR/DRAPE TO BE REMOVED

NOTES:

- ① REMOVE EXISTING SPRAY BOOTH. COORDINATE WITH MECHANICAL AND ELECTRICAL DRAWINGS. DISMANTLE SPRAY BOOTH AS REQUIRED TO FIT THROUGH EXISTING DOORWAYS
- ② REMOVE EXISTING PUMP. REFER TO MECHANICAL AND ELECTRICAL DRAWINGS.
- ③ EXISTING CASEWORK TO REMAIN.

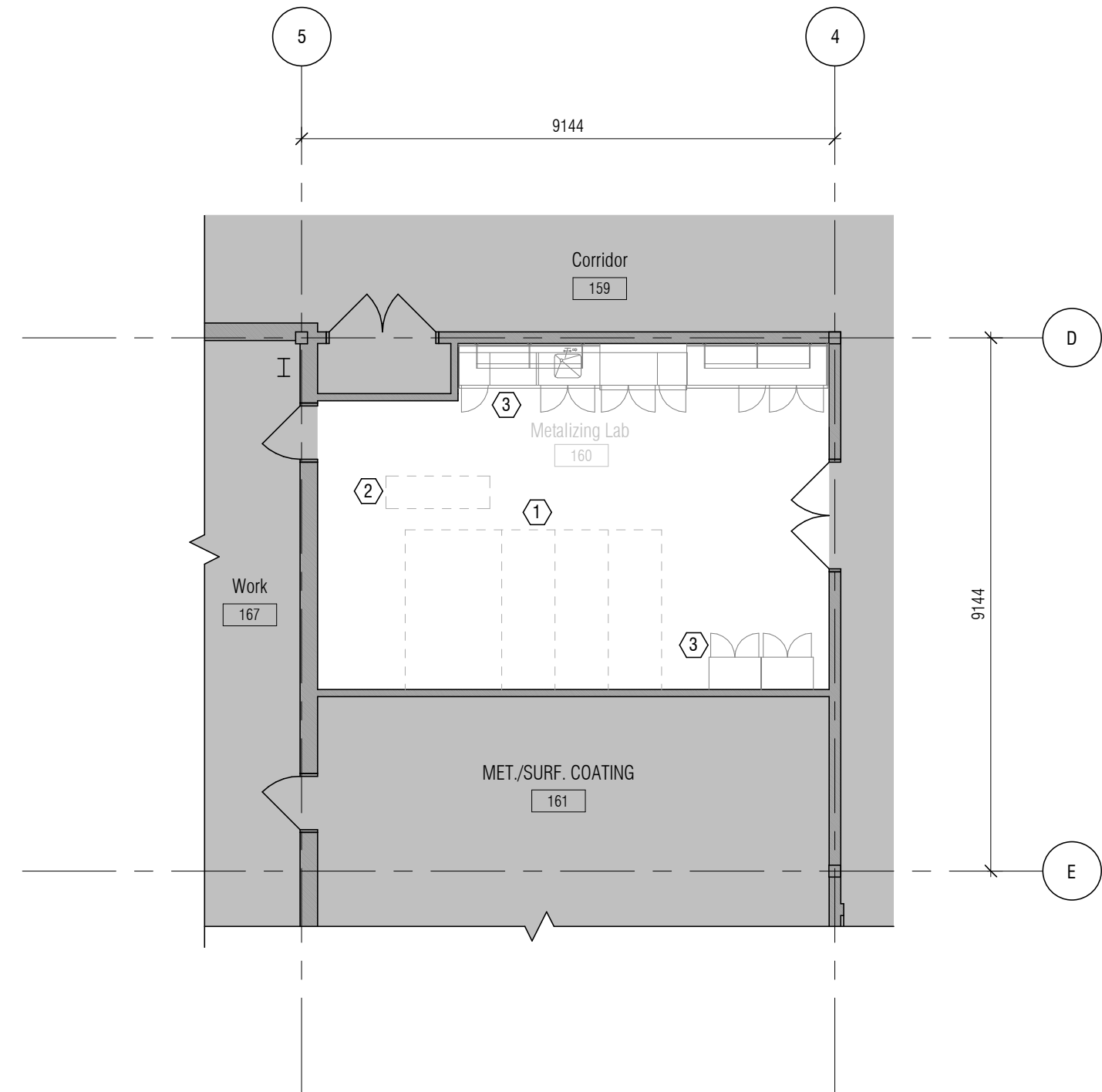

LEVEL 1 - DEMOLITION PLAN  
1 : 100

1  
A06

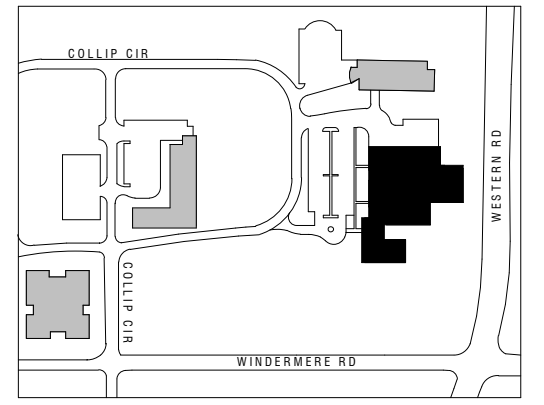

ISSUED:

No.	Date	Description
1	2016-11-23	ISSUED FOR TENDER

GENERAL DEMOLITION NOTES:

1. REFER TO SPECIFICATIONS
2. DASHED LINES INDICATE EXISTING BUILDING ELEMENTS TO BE REMOVED. PATCH AND MAKE GOOD WHERE CONNECTED TO EXISTING BUILDING ELEMENTS TO REMAIN.
3. IT IS THE RESPONSIBILITY OF THE GENERAL CONTRACTOR TO COORDINATE ALL DEMOLITION WITH ALL PROPOSED WORK AS INDICATED ON THESE DRAWINGS AND AS REQUIRED TO PROVIDE A COMPLETE AND FINISHED PROJECT.
4. REFER TO CONSTRUCTION DOCUMENTS OF ALL DISCIPLINES AND COORDINATE SCOPE OF WORK SHOWN ON ARCHITECTURAL DEMOLITION DRAWINGS WITH DEMOLITION DRAWINGS PREPARED BY ALL OTHER CONSULTING DISCIPLINES.
5. DEMOLITION CONTRACTOR TO FIELD VERIFY & COORDINATE REMOVAL OF ELECTRICAL AND MECHANICAL COMPONENTS AS SHOWN ON ALL DRAWINGS WHICH PERTAIN TO THESE DISCIPLINES AND AS NECESSARY FOR PREPARATION FOR PROPOSED WORK. ASSUME ALL BUILDING SERVICES ARE ACTIVE AND ELECTRIFIED & ALL OTHER WIRES ARE LIVE PRIOR TO COMMENCEMENT OF ANY WORK. SEE ALL OTHER DRAWINGS FOR THIS PROJECT.
6. UNLESS OTHERWISE NOTED, ALL DEMOLISHED MATERIAL IS TO BE DISPOSED OF AS PART OF THIS CONTRACT AND AS NOTED IN SPECIFICATIONS.
7. GENERAL CONTRACTOR TO ENSURE THAT ALL EXISTING CONSTRUCTION WHICH IS TO REMAIN IS PROTECTED AND NOT DISTURBED OR DAMAGED BY THE DEMOLITION WORK.
8. ALL EXISTING FIRE RESISTANCE RATINGS ARE TO BE MAINTAINED DURING DEMOLITION. IF ANY FIRE RATINGS ARE JEOPARDIZED DURING DEMOLITION, THE RECONSTRUCTION OF SAME IS THE RESPONSIBILITY OF THE GENERAL CONTRACTOR AND MUST BE INCLUDED AS A PART OF THIS CONTRACT.
9. REMOVE ALL EXISTING ROOM NAME/NUMBER SIGNS. PATCH AND MAKE GOOD WALL FINISH AS REQUIRED TO MATCH EXISTING ADJACENT WALL FINISHES
10. REMOVE ALL UNUSED AND EXPOSED NAILS AND SCREWS ON EXISTING WALLS. PATCH AND MAKE GOOD EXISTING WALL SURFACE BEFORE REPAINTING.
11. REMOVE EXISTING WHITEBOARDS, BLACKBOARDS, TACKBOARDS AND ALL ASSOCIATED RAILINGS. TURN OVER TO OWNER AND WHERE ANY OF THE ABOVE ARE MOUNTED ON EXISTING WALLS THAT WILL REMAIN IN PLACE, PATCH AND MAKE GOOD EXISTING WALL SURFACE BEFORE REPAINTING
12. PRIOR TO START OF DEMOLITION, THE GENERAL CONTRACTOR AND NRC DEPARTMENTAL REPRESENTATIVE SHALL TOUR ALL WORK AREAS FOR THE PURPOSE OF CONFIRMING ALL ITEMS TO BE SALVAGED BY THE CONTRACTOR AND TURNED OVER TO THE NRC DEPARTMENTAL REPRESENTATIVE.
13. DEMOLITION SHALL BE UNDERTAKEN IN ACCORDANCE WITH NRC DEPARTMENTAL REPRESENTATIVE REQUIREMENTS FOR WORK WITHIN OCCUPIED BUILDINGS AND IN A MANNER THAT MINIMIZES DISRUPTION OF BUILDING INHABITANTS.
14. EXISTING WINDOW TREATMENTS TO REMAIN

**Diamond Schmitt Architects**

384 Adelaide Street West, Suite 300, Toronto, Canada M5V1R7  
Tel: 416 862 8800 Fax: 416 862 5508 info@dsai.ca www.dsai.ca

NORTH

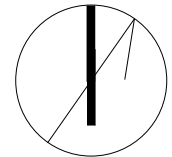

1552

**NRC Factory of the Future  
Demolition Package 2**

800 Collip Cir, London, ON N6G 4X8

drawing 1  
dessein 1  
**LEVEL 1 - DEMOLITION PLAN**

designed	conçu	date	date
Designer		2016-12-13	
drawn	dessiné	scale:	échelle
Designer		1 : 100	
checked	vérifié	sheet	feuille
approved	approuvé	W.O. no	D.T. no

dwg.no. 1  
dessein no. A06  
**IMC0200-A06**



C:\Users\ASCARLAT\Revit\_Files\1552 NRC-FOTF-BUILDING-DEM02\_ASCARLAT.rvt

12/19/2016 3:41:40 PM

- NOTES:
- ① REMOVE EXISTING MAKE-UP AIR ROOF TOP UNIT. REFER TO MECHANICAL AND ELECTRICAL DRAWINGS.
  - ② REMOVE BUILT-UP ROOFING CURBS.
  - ③ EXISTING PENETRATION THROUGH METAL DECK TO BE INFILLED WITH NEW METAL DECK. PROVIDE ENGINEERING FOR METAL DECK INFILL.
  - ④ CUT BACK EXISTING ROOFING AND INSULATION AS REQUIRED TO SUIT NEW ROOFING CONSTRUCTION.
  - ⑤ PROVIDE NEW ROOF CONSTRUCTION AS REQUIRED. TIE NEW ROOF CONSTRUCTION INTO EXISTING ADJACENT ROOF CONSTRUCTION AS PER MANUFACTURER RECOMMENDATION TO ENSURE PRESERVATION OF ROOFING WARRANTY. REFER TO SECTION DETAIL 3/A104.
  - ⑥ REMOVE EXISTING SPRAY BOOTH EXHAUST DUCT. REFER TO MECHANICAL DRAWINGS.
  - ⑦ EXISTING EXHAUST FAN TO REMAIN.
  - ⑧ EXISTING GAS LINE TO REMAIN.
  - ⑨ REMOVE EXISTING GAS CONNECTION AND ASSOCIATED PRV AND CAP AT GAS MAIN. REFER TO MECHANICAL DRAWINGS.

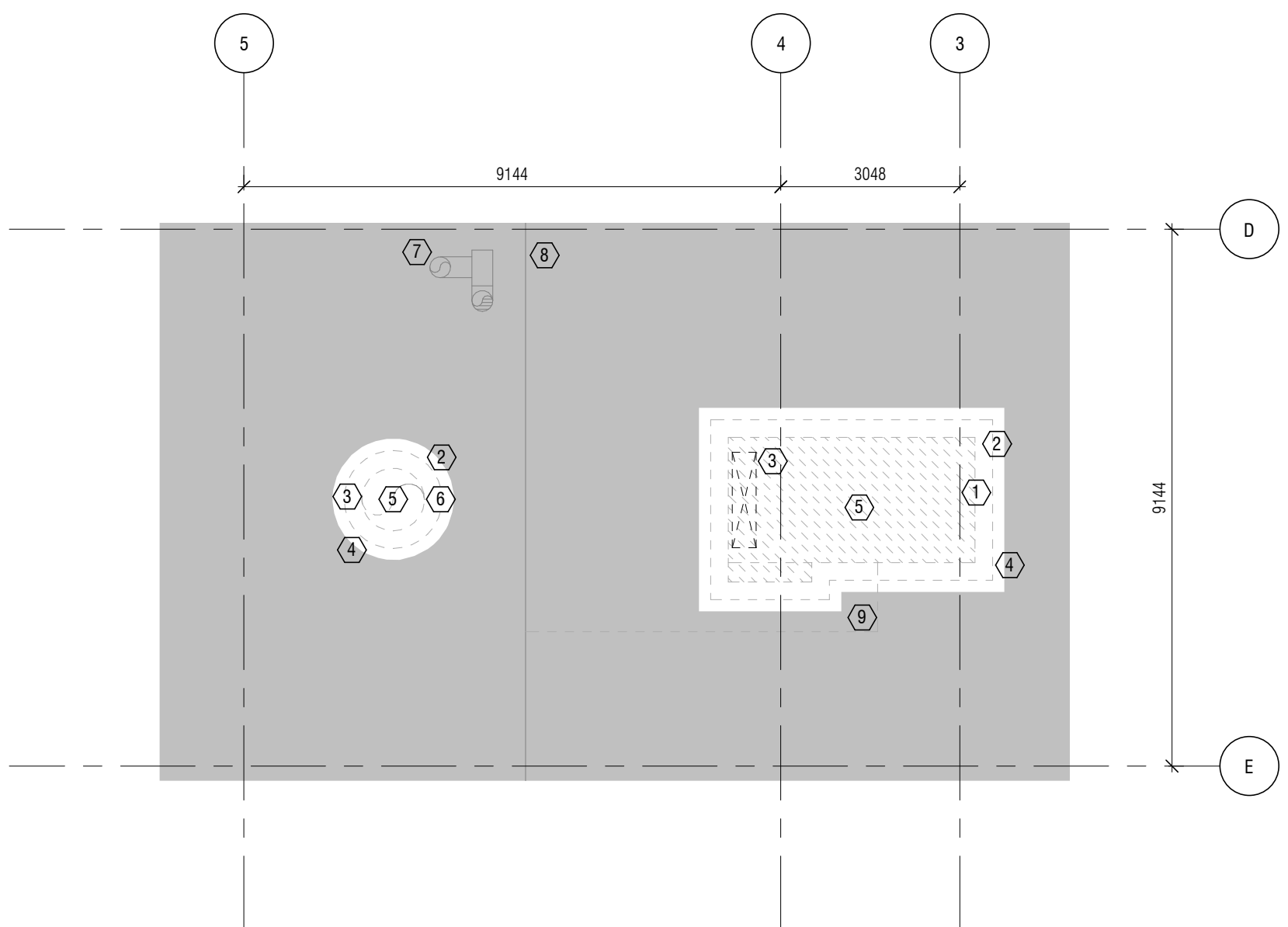

ROOF - DEMOLITION PLAN 1  
1 : 100 A07

- NOTES:
- ① REMOVE EXISTING MECHANICAL UNIT AND ASSOCIATED SERVICES. REFER TO MECHANICAL AND ELECTRICAL DRAWINGS.
  - ② PATCH AND MAKE GOOD EXISTING ROOF.

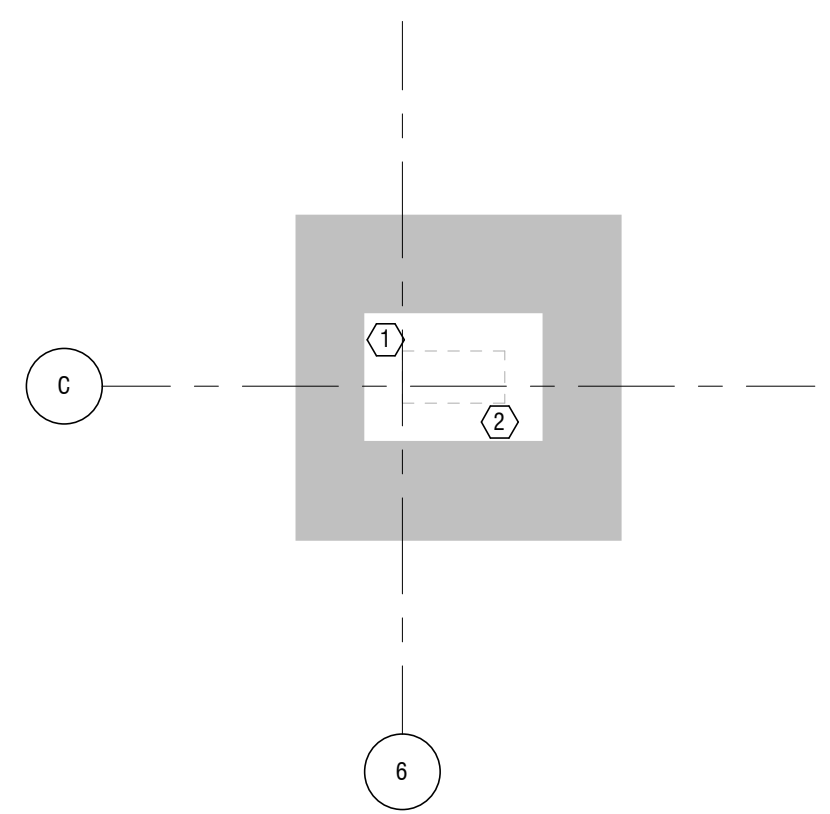

ROOF - DEMOLITION PLAN 2  
1 : 100 A07

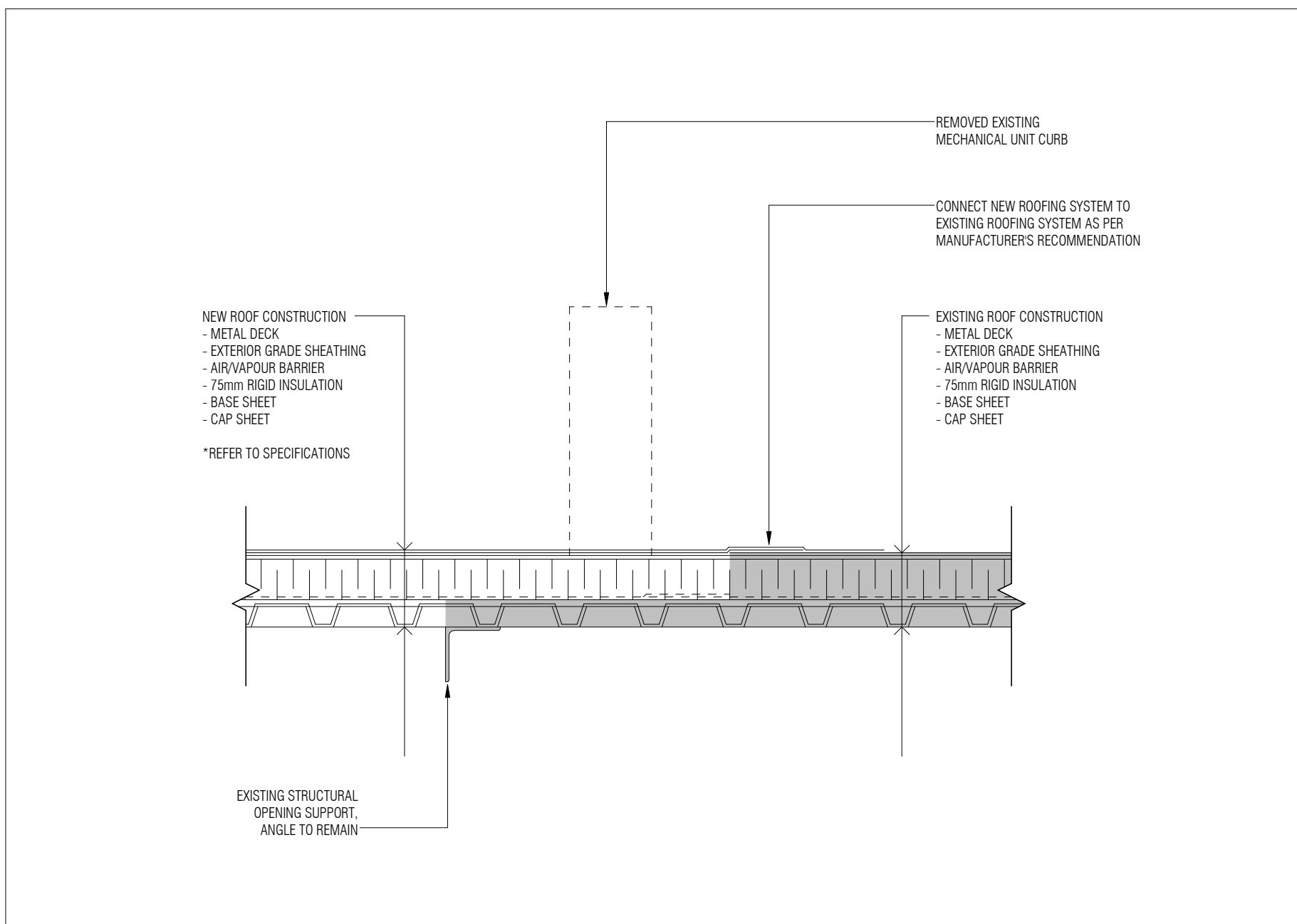

ROOF - SECTION DETAIL 3  
1 : 10 A07

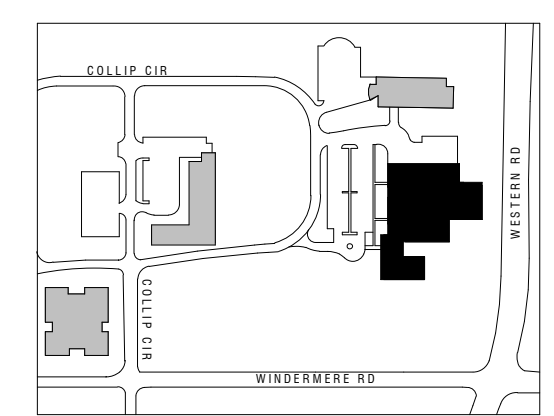

ISSUED:

No.	Date	Description
1	2016-11-23	ISSUED FOR TENDER

- GENERAL DEMOLITION NOTES:
1. REFER TO SPECIFICATIONS
  2. DASHED LINES INDICATE EXISTING BUILDING ELEMENTS TO BE REMOVED. PATCH AND MAKE GOOD WHERE CONNECTED TO EXISTING BUILDING ELEMENTS TO REMAIN.
  3. IT IS THE RESPONSIBILITY OF THE GENERAL CONTRACTOR TO COORDINATE ALL DEMOLITION WITH ALL PROPOSED WORK AS INDICATED ON THESE DRAWINGS AND AS REQUIRED TO PROVIDE A COMPLETE AND FINISHED PROJECT.
  4. REFER TO CONSTRUCTION DOCUMENTS OF ALL DISCIPLINES AND COORDINATE SCOPE OF WORK SHOWN ON ARCHITECTURAL DEMOLITION DRAWINGS WITH DEMOLITION DRAWINGS PREPARED BY ALL OTHER CONSULTING DISCIPLINES.
  5. DEMOLITION CONTRACTOR TO FIELD VERIFY & COORDINATE REMOVAL OF ELECTRICAL AND MECHANICAL COMPONENTS AS SHOWN ON ALL DRAWINGS WHICH PERTAIN TO THESE DISCIPLINES AND AS NECESSARY FOR PREPARATION FOR PROPOSED WORK. ASSUME ALL BUILDING SERVICES ARE ACTIVE AND ELECTRIFIED & ALL OTHER WIRES ARE LIVE PRIOR TO COMMENCEMENT OF ANY WORK. SEE ALL OTHER DRAWINGS FOR THIS PROJECT.
  6. UNLESS OTHERWISE NOTED, ALL DEMOLISHED MATERIAL IS TO BE DISPOSED OF AS PART OF THIS CONTRACT AND AS NOTED IN SPECIFICATIONS.
  7. GENERAL CONTRACTOR TO ENSURE THAT ALL EXISTING CONSTRUCTION WHICH IS TO REMAIN IS PROTECTED AND NOT DISTURBED OR DAMAGED BY THE DEMOLITION WORK.
  8. ALL EXISTING FIRE RESISTANCE RATINGS ARE TO BE MAINTAINED DURING DEMOLITION. IF ANY FIRE RATINGS ARE JEOPARDIZED DURING DEMOLITION, THE RECONSTRUCTION OF SAME IS THE RESPONSIBILITY OF THE GENERAL CONTRACTOR AND MUST BE INCLUDED AS A PART OF THIS CONTRACT.
  9. REMOVE ALL EXISTING ROOM NAME/NUMBER SIGNS. PATCH AND MAKE GOOD WALL FINISH AS REQUIRED TO MATCH EXISTING ADJACENT WALL FINISHES
  10. REMOVE ALL UNUSED AND EXPOSED NAILS AND SCREWS ON EXISTING WALLS. PATCH AND MAKE GOOD EXISTING WALL SURFACE BEFORE REPAINTING.
  11. REMOVE EXISTING WHITEBOARDS, BLACKBOARDS, TACKBOARDS AND ALL ASSOCIATED RAILINGS; TURN OVER TO OWNER AND WHERE ANY OF THE ABOVE ARE MOUNTED ON EXISTING WALLS THAT WILL REMAIN IN PLACE, PATCH AND MAKE GOOD EXISTING WALL SURFACE BEFORE REPAINTING
  12. PRIOR TO START OF DEMOLITION, THE GENERAL CONTRACTOR AND NRC DEPARTMENTAL REPRESENTATIVE SHALL TOUR ALL WORK AREAS FOR THE PURPOSE OF CONFIRMING ALL ITEMS TO BE SALVAGED BY THE CONTRACTOR AND TURNED OVER TO THE NRC DEPARTMENTAL REPRESENTATIVE.
  13. DEMOLITION SHALL BE UNDERTAKEN IN ACCORDANCE WITH NRC DEPARTMENTAL REPRESENTATIVE REQUIREMENTS FOR WORK WITHIN OCCUPIED BUILDINGS AND IN A MANNER THAT MINIMIZES DISRUPTION OF BUILDING INHABITANTS.
  14. EXISTING WINDOW TREATMENTS TO REMAIN

**Diamond Schmitt Architects**  
384 Adelaide Street West, Suite 300, Toronto, Canada M5V1R7  
Tel: 416 862 8800 Fax: 416 862 5508 info@dsai.ca www.dsai.ca

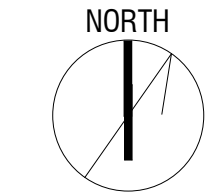

1552  
**NRC Factory of the Future Demolition Package 2**  
800 Collip Cir, London, ON N6G 4X8

drawing		dessin	
designed	conçu	date	date
Designer		2016-12-13	
drawn	dessiné	scale:	échelle
Designer		As indicated	
checked	vérifié	sheet	feuille
approved	approuvé	W.O. no	D.T. no

dwg.no. / dessin no.  
**IMC0200-A07**



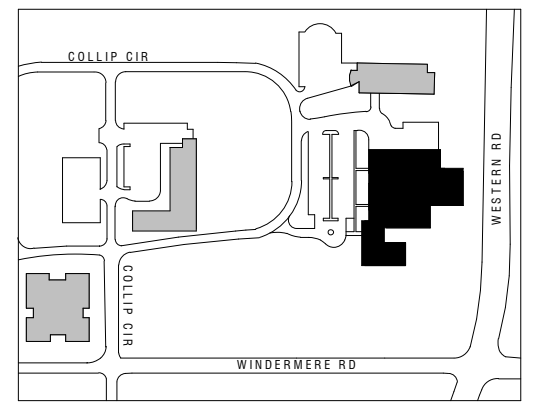

**ISSUED:**

No.	Date	Description
1	2016-11-23	ISSUED FOR TENDER

**GENERAL DEMOLITION NOTES:**

- REFER TO SPECIFICATIONS
- DASHED LINES INDICATE EXISTING BUILDING ELEMENTS TO BE REMOVED. PATCH AND MAKE GOOD WHERE CONNECTED TO EXISTING BUILDING ELEMENTS TO REMAIN.
- IT IS THE RESPONSIBILITY OF THE GENERAL CONTRACTOR TO COORDINATE ALL DEMOLITION WITH ALL PROPOSED WORK AS INDICATED ON THESE DRAWINGS AND AS REQUIRED TO PROVIDE A COMPLETE AND FINISHED PROJECT.
- REFER TO CONSTRUCTION DOCUMENTS OF ALL DISCIPLINES AND COORDINATE SCOPE OF WORK SHOWN ON ARCHITECTURAL DEMOLITION DRAWINGS WITH DEMOLITION DRAWINGS PREPARED BY ALL OTHER CONSULTING DISCIPLINES.
- DEMOLITION CONTRACTOR TO FIELD VERIFY & COORDINATE REMOVAL OF ELECTRICAL AND MECHANICAL COMPONENTS AS SHOWN ON ALL DRAWINGS WHICH PERTAIN TO THESE DISCIPLINES AND AS NECESSARY FOR PREPARATION FOR PROPOSED WORK. ASSUME ALL BUILDING SERVICES ARE ACTIVE AND ELECTRIFIED & ALL OTHER WIRES ARE LIVE PRIOR TO COMMENCEMENT OF ANY WORK. SEE ALL OTHER DRAWINGS FOR THIS PROJECT.
- UNLESS OTHERWISE NOTED, ALL DEMOLISHED MATERIAL IS TO BE DISPOSED OF AS PART OF THIS CONTRACT AND AS NOTED IN SPECIFICATIONS.
- GENERAL CONTRACTOR TO ENSURE THAT ALL EXISTING CONSTRUCTION WHICH IS TO REMAIN IS PROTECTED AND NOT DISTURBED OR DAMAGED BY THE DEMOLITION WORK.
- ALL EXISTING FIRE RESISTANCE RATINGS ARE TO BE MAINTAINED DURING DEMOLITION. IF ANY FIRE RATINGS ARE JEOPARDIZED DURING DEMOLITION, THE RECONSTRUCTION OF SAME IS THE RESPONSIBILITY OF THE GENERAL CONTRACTOR AND MUST BE INCLUDED AS A PART OF THIS CONTRACT.
- REMOVE ALL EXISTING FIRE RESISTANCE RATINGS. PATCH AND MAKE GOOD WALL FINISH AS REQUIRED TO MATCH EXISTING ADJACENT WALL FINISHES.
- REMOVE ALL UNUSED AND EXPOSED NAILS AND SCREWS ON EXISTING WALLS. PATCH AND MAKE GOOD EXISTING WALL SURFACE BEFORE REPAINTING.
- REMOVE EXISTING WHITEBOARDS, BLACKBOARDS, TACKBOARDS AND ALL ASSOCIATED RAILINGS. TURN OVER TO OWNER AND WHERE ANY OF THE ABOVE ARE MOUNTED ON EXISTING WALLS THAT WILL REMAIN IN PLACE, PATCH AND MAKE GOOD EXISTING WALL SURFACE BEFORE REPAINTING.
- PRIOR TO START OF DEMOLITION, THE GENERAL CONTRACTOR AND NRC DEPARTMENTAL REPRESENTATIVE SHALL TOUR ALL WORK AREAS FOR THE PURPOSE OF CONFIRMING ALL ITEMS TO BE SALVAGED BY THE CONTRACTOR AND TURNED OVER TO THE NRC DEPARTMENTAL REPRESENTATIVE.
- DEMOLITION SHALL BE UNDERTAKEN IN ACCORDANCE WITH NRC DEPARTMENTAL REPRESENTATIVE REQUIREMENTS FOR WORK WITHIN OCCUPIED BUILDINGS AND IN A MANNER THAT MINIMIZES DISRUPTION OF BUILDING INHABITANTS.
- EXISTING WINDOW TREATMENTS TO REMAIN

**Diamond Schmitt Architects**  
 384 Adelaide Street West, Suite 300, Toronto, Canada M5V1R7  
 Tel: 416 862 8800 Fax: 416 862 5508 info@dsai.ca www.dsai.ca

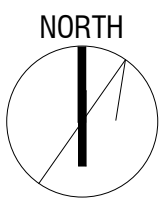

1552  
**NRC Factory of the Future  
 Demolition Package 2**  
 800 Collip Cir, London, ON N6G 4X8

drawing				dessin			
designed	conçu	date	date	drawn	dessiné	scale:	échelle
Designer		2016-12-13		Designer		1 : 100	
checked	vérifié	sheet	feuille	approved	approuvé	W.O. no	D.T. no

dwg. no. 1  
 dessin no. A08  
**IMC0200-A08**

- LEGEND:**
- EXISTING ACOUSTIC PANEL TO BE REMOVED
  - EXISTING LIGHT FIXTURE TO BE REMOVED
  - EXISTING LIGHT FIXTURE TO BE RELOCATED
  - EXISTING PENDANT LIGHT TO BE REMOVED
  - EXISTING POT LIGHT TO BE REMOVED
  - EXISTING DIFFUSER TO BE REMOVED
  - EXISTING DUCTWORK TO REMAIN
  - EXISTING SPRINKLER TO BE REMOVED
  - EXISTING SPRINKLER TO REMAIN
  - NEW SPRINKLER
  - EXISTING PULL ALARM TO BE RELOCATED
  - EXISTING EXIT DESIGN TO BE RELOCATED
  - EXISTING SMOKE DETECTOR TO REMAIN

- NOTES:**
- REMOVE PENDANT LIGHT FIXTURES AND SUPPORTING ASSEMBLY. REFER TO ELECTRICAL FOR LIGHT FIXTURE REMOVAL.
  - REMOVE EXISTING MIRROR PANEL AND ASSOCIATED MOUNTING SYSTEM.
  - REMOVE EXISTING SUSPENDED CEILING ASSEMBLY, LIGHT FIXTURES, GRILLES AND CEILING MOUNTED DEVICES AS REQUIRED. REFER TO MECHANICAL AND ELECTRICAL DRAWINGS.
  - REMOVE EXISTING GYPSUM BOARD CEILING ASSEMBLY, LIGHT FIXTURES, GRILLES AND CEILING MOUNTED DEVICES AS REQUIRED. REFER TO MECHANICAL AND ELECTRICAL DRAWINGS.
  - REMOVE EXISTING LIGHT FIXTURES, GRILLES AND CEILING MOUNTED DEVICES UNDER EXPOSED STRUCTURE AS REQUIRED. REFER TO MECHANICAL AND ELECTRICAL DRAWINGS.
  - REMOVE EXISTING BULKHEAD ASSEMBLY.
  - REMOVE EXISTING LIGHTING TRUSS AND RIGGING ASSEMBLY.
  - REMOVE SUSPENDED LIGHT FIXTURES AND SUPPORTING HANGING ASSEMBLY. REFER TO ELECTRICAL FOR LIGHT FIXTURE REMOVAL.
  - REMOVE EXISTING SUSPENDED BANNERS AND SUPPORTING ASSEMBLY.
  - REMOVE EXISTING AUDIO SPEAKER AND SUPPORTING ASSEMBLY.
  - RELOCATE EXISTING LIGHTING FIXTURE. PROVIDE APPROPRIATE SUSPENSION SYSTEM TO HANG RELOCATED LIGHTING FIXTURE AT NEW LOCATION. REFER TO ELECTRICAL.
  - REMOVE EXISTING CEILING FAN
  - RELOCATED EXIT SIGN, REFER TO ELECTRICAL
  - REMOVE EXISTING SECURITY CAMERA, REFER TO ELECTRICAL
  - NEW SPRINKLER HEAD, REFER TO MECHANICAL DRAWINGS

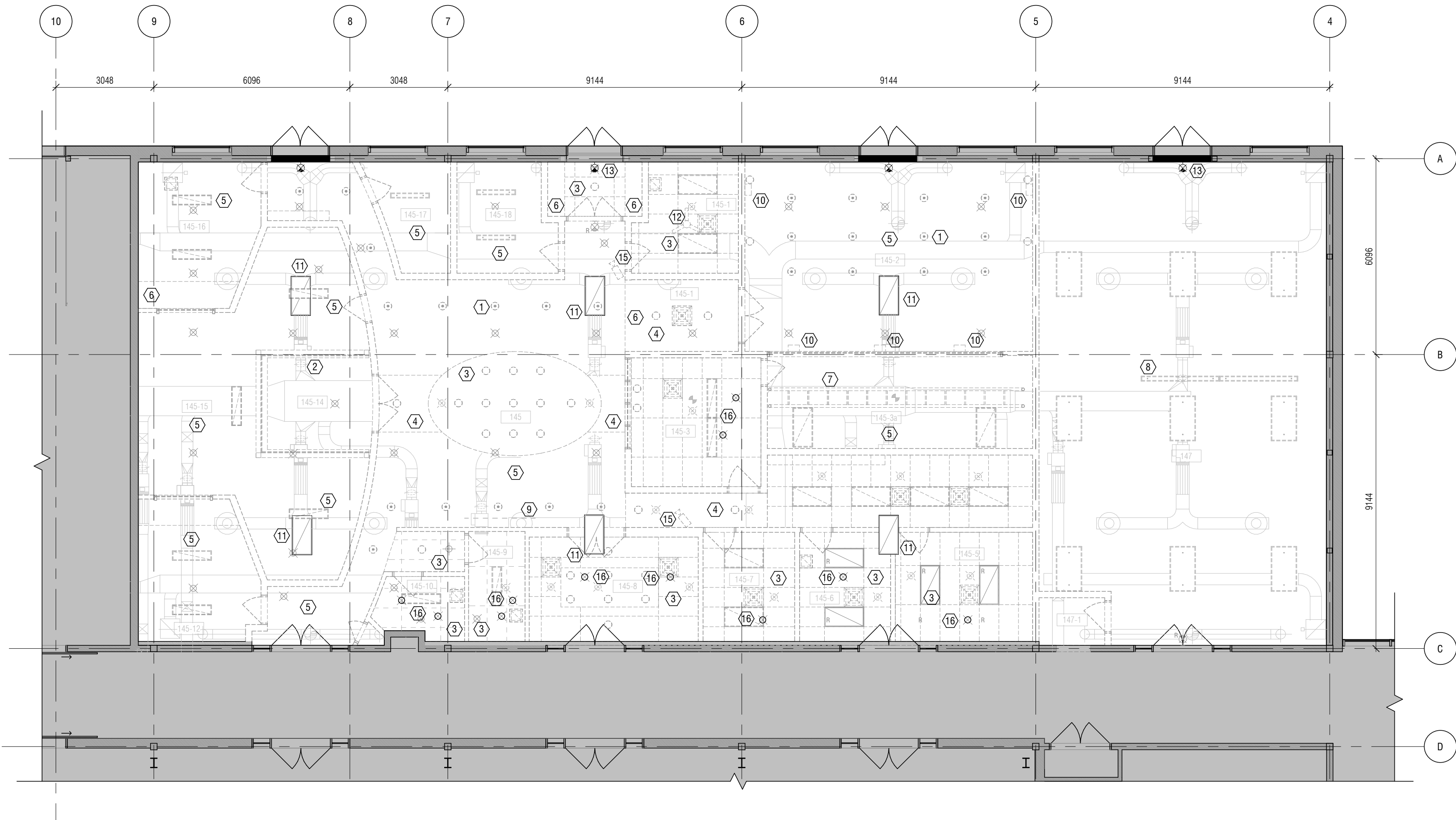

**LEVEL 1 - DEMOLITION REFLECTED CEILING PLAN**  
 1  
 1 : 100  
 A08

C:\Users\ASCARLAT\Revit\_Files\1552 NRC-FOTF-BUILDING-DEM02\_ASCARLAT.rvt

12/19/2016 3:41:42 PM

- LEGEND:**
- EXISTING ACCOUSTIC PANEL TO BE REMOVED
  - EXISTING LIGHT FIXTURE TO BE REMOVED
  - EXISTING LIGHT FIXTURE TO REMAIN
  - EXISTING DIFFUSER TO BE REMOVED
  - EXISTING DIFFUSER TO REMAIN
  - EXISTING SPRINKLER TO BE REMOVED
  - EXISTING SPRINKLER TO REMAIN
  - EXISTING RADIANT PANEL TO REMAIN

- NOTES:**
- ① REMOVE EXISTING SUSPENDED CEILING ASSEMBLY, LIGHT FIXTURES, GRILLES AND CEILING MOUNTED DEVICES AS REQUIRED. REFER TO MECHANICAL AND ELECTRICAL DRAWINGS.
  - ② REMOVE EXISTING BULKHEAD ASSEMBLY.
  - ③ EXISTING GYPSUM BOARD BULKHEAD AND OVERHEAD COUNTER SHUTTER TO REMAIN. PROVIDE ADDITIONAL SUPPORT AS REQUIRED FOR BULKHEAD TO REMAIN.
  - ④ NEW SPRINKLER HEAD, REFER TO MECHANICAL DRAWINGS.
  - ⑤ EXISTING SECURITY CAMERA TO REMIAN. PROVIDE PROTECTION AS REQUIRED.

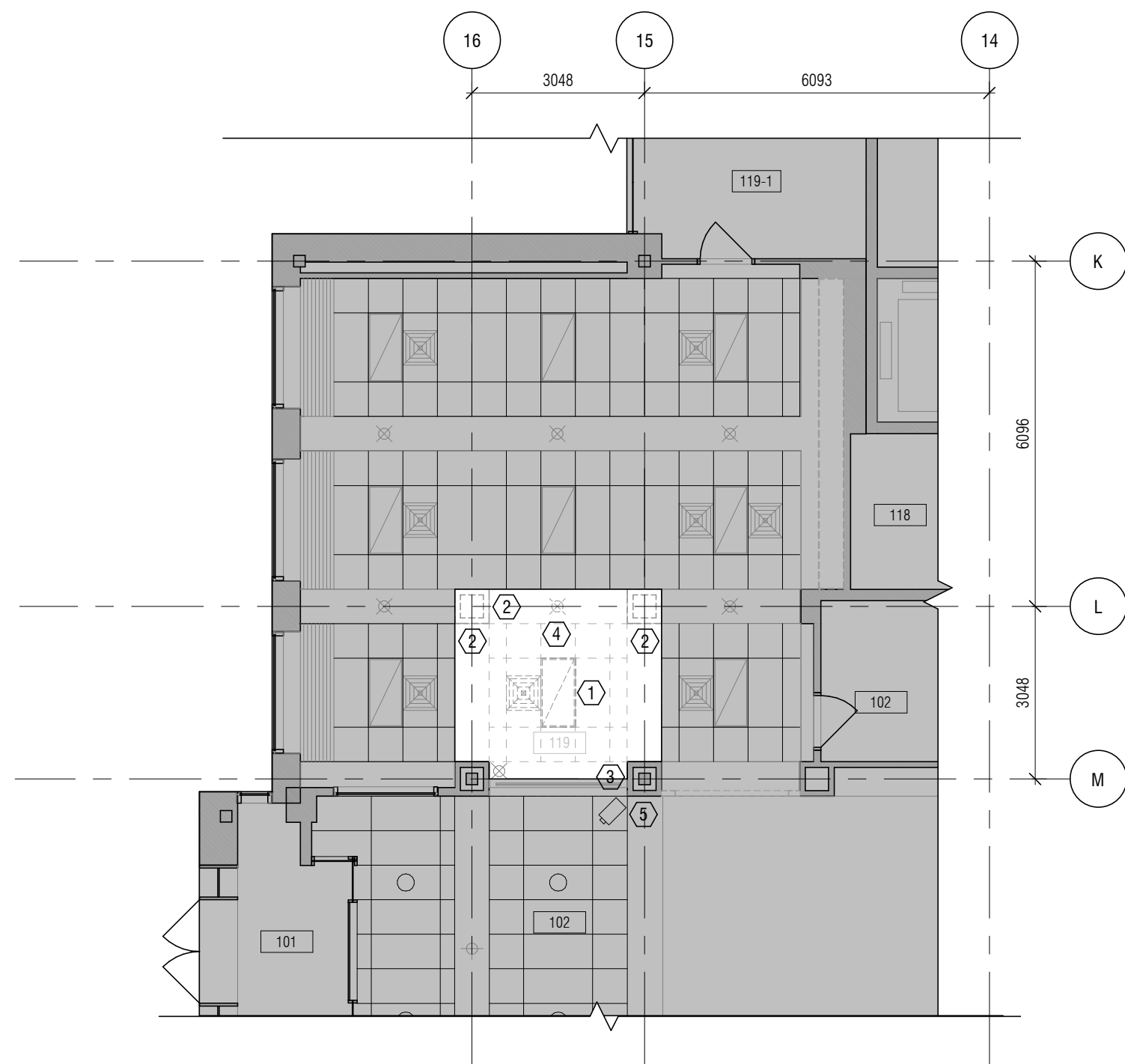

LEVEL 1 - DEMOLITION REFLECTED CEILING PLAN 1  
1 : 100 A09

- LEGEND:**
- EXISTING LIGHT FIXTURE TO BE REMOVED
  - EXISTING LIGHT FIXTURE TO REMAIN
  - EXISTING DIFFUSER TO BE REMOVED
  - EXISTING DIFFUSER TO REMAIN
  - EXISTING SPRINKLER TO BE REMOVED
  - EXISTING SPRINKLER TO REMAIN

- NOTES:**
- ① REMOVE EXISTING FURNACE EXHAUST DUCT RO EXHAUST FAN. REFER TO MECHANICAL DRAWINGS.
  - ② EXISTING DUCTWORK TO REMAIN.
  - ③ EXISTING LIGHT FIXTURES TO REMAIN.

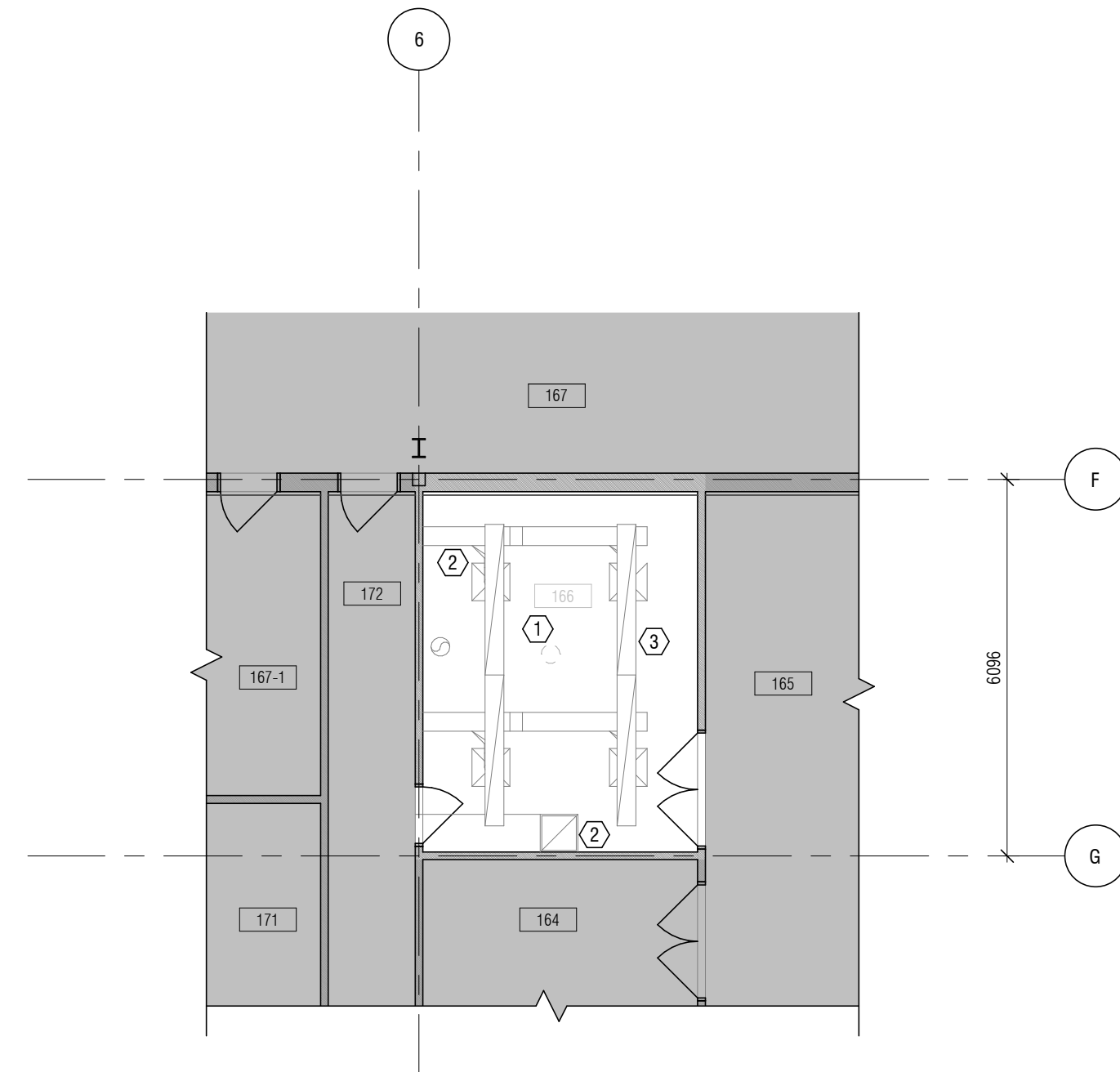

LEVEL 1 - DEMOLITION REFLECTED CEILING PLAN 2  
1 : 100 A09

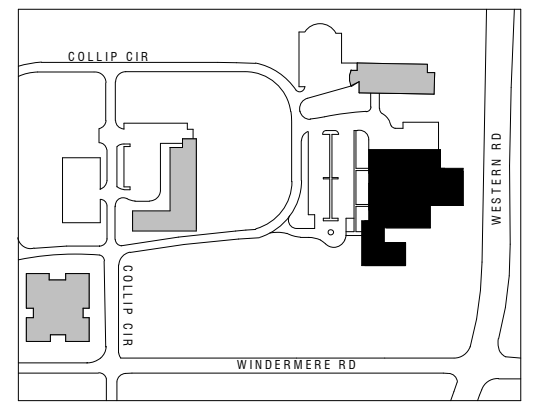

**ISSUED:**

No.	Date	Description
1	2016-11-23	ISSUED FOR TENDER

**GENERAL DEMOLITION NOTES:**

1. REFER TO SPECIFICATIONS
2. DASHED LINES INDICATE EXISTING BUILDING ELEMENTS TO BE REMOVED. PATCH AND MAKE GOOD WHERE CONNECTED TO EXISTING BUILDING ELEMENTS TO REMAIN.
3. IT IS THE RESPONSIBILITY OF THE GENERAL CONTRACTOR TO COORDINATE ALL DEMOLITION WITH ALL PROPOSED WORK AS INDICATED ON THESE DRAWINGS AND AS REQUIRED TO PROVIDE A COMPLETE AND FINISHED PROJECT.
4. REFER TO CONSTRUCTION DOCUMENTS OF ALL DISCIPLINES AND COORDINATE SCOPE OF WORK SHOWN ON ARCHITECTURAL DEMOLITION DRAWINGS WITH DEMOLITION DRAWINGS PREPARED BY ALL OTHER CONSULTING DISCIPLINES.
5. DEMOLITION CONTRACTOR TO FIELD VERIFY & COORDINATE REMOVAL OF ELECTRICAL AND MECHANICAL COMPONENTS AS SHOWN ON ALL DRAWINGS WHICH PERTAIN TO THESE DISCIPLINES AND AS NECESSARY FOR PREPARATION FOR PROPOSED WORK. ASSUME ALL BUILDING SERVICES ARE ACTIVE AND ELECTRIFIED & ALL OTHER WIRES ARE LIVE PRIOR TO COMMENCEMENT OF ANY WORK. SEE ALL OTHER DRAWINGS FOR THIS PROJECT.
6. UNLESS OTHERWISE NOTED, ALL DEMOLISHED MATERIAL IS TO BE DISPOSED OF AS PART OF THIS CONTRACT AND AS NOTED IN SPECIFICATIONS.
7. GENERAL CONTRACTOR TO ENSURE THAT ALL EXISTING CONSTRUCTION WHICH IS TO REMAIN IS PROTECTED AND NOT DISTURBED OR DAMAGED BY THE DEMOLITION WORK.
8. ALL EXISTING FIRE RESISTANCE RATINGS ARE TO BE MAINTAINED DURING DEMOLITION. IF ANY FIRE RATINGS ARE JEOPARDIZED DURING DEMOLITION, THE RECONSTRUCTION OF SAME IS THE RESPONSIBILITY OF THE GENERAL CONTRACTOR AND MUST BE INCLUDED AS A PART OF THIS CONTRACT.
9. REMOVE ALL EXISTING ROOM NAME/NUMBER SIGNS. PATCH AND MAKE GOOD WALL FINISH AS REQUIRED TO MATCH EXISTING ADJACENT WALL FINISHES
10. REMOVE ALL UNUSED AND EXPOSED NAILS AND SCREWS ON EXISTING WALLS; PATCH AND MAKE GOOD EXISTING WALL SURFACE BEFORE REPAINTING.
11. REMOVE EXISTING WHITEBOARDS, BLACKBOARDS, TACKBOARDS AND ALL ASSOCIATED RAILINGS; TURN OVER TO OWNER AND WHERE ANY OF THE ABOVE ARE MOUNTED ON EXISTING WALLS THAT WILL REMAIN IN PLACE, PATCH AND MAKE GOOD EXISTING WALL SURFACE BEFORE REPAINTING
12. PRIOR TO START OF DEMOLITION, THE GENERAL CONTRACTOR AND NRC DEPARTMENTAL REPRESENTATIVE SHALL TOUR ALL WORK AREAS FOR THE PURPOSE OF CONFIRMING ALL ITEMS TO BE SALVAGED BY THE CONTRACTOR AND TURNED OVER TO THE NRC DEPARTMENTAL REPRESENTATIVE.
13. DEMOLITION SHALL BE UNDERTAKEN IN ACCORDANCE WITH NRC DEPARTMENTAL REPRESENTATIVE REQUIREMENTS FOR WORK WITHIN OCCUPIED BUILDINGS AND IN A MANNER THAT MINIMIZES DISRUPTION OF BUILDING INHABITANTS.
14. EXISTING WINDOW TREATMENTS TO REMAIN

**Diamond Schmitt Architects**

384 Adelaide Street West, Suite 300, Toronto, Canada M5V1R7  
Tel: 416 862 8800 Fax: 416 862 5508 info@dsai.ca www.dsai.ca

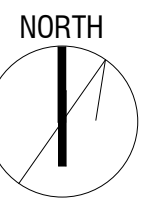

1552

**NRC Factory of the Future  
Demolition Package 2**







800 Collip Cir, London, ON N6G 4X8

drawing				dessin			
designed	conçu	date	date	drawn	dessiné	scale:	échelle
Designer		2016-12-13		Designer		1 : 100	
checked	vérifié	sheet	feuille				
approved	approuvé	W.O. no	D.T. no				

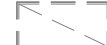
C:\Users\ASCARLAT\Revit\_Files\1552 NRC-FOTF-BUILDING-DEM02\_ASCARLAT.rvt

12/19/2016 3:41:42 PM

LEGEND:

-  EXISTING LIGHT FIXTURE TO BE REMOVED
-  EXISTING LIGHT FIXTURE TO REMAIN
-  EXISTING DIFFUSER TO BE REMOVED
-  EXISTING DIFFUSER TO REMAIN
-  EXISTING SPRINKLER TO BE REMOVED
-  EXISTING SPRINKLER TO REMAIN
-  EXISTING DIFFUSER TO BE REMOVED

NOTES:

- ① REMOVE EXISTING MAKE-UP AIR DUCT WORK. REFER TO MECHANICAL DRAWINGS. REFER TO DETAIL 3/A104 FOR ROOF REMEDIATION.
- ② REMOVE EXISTING SPRAY BOOTH EXHAUST DUCTWORK. REFER TO MECHANICAL DRAWINGS. REFER TO DETAIL 3/A104 FOR ROOF REMEDIATION.
- ③ EXISTING DUCT WORK TO REMAIN.
- ④ EXISTING LIGHT FIXTURE TO REMAIN.

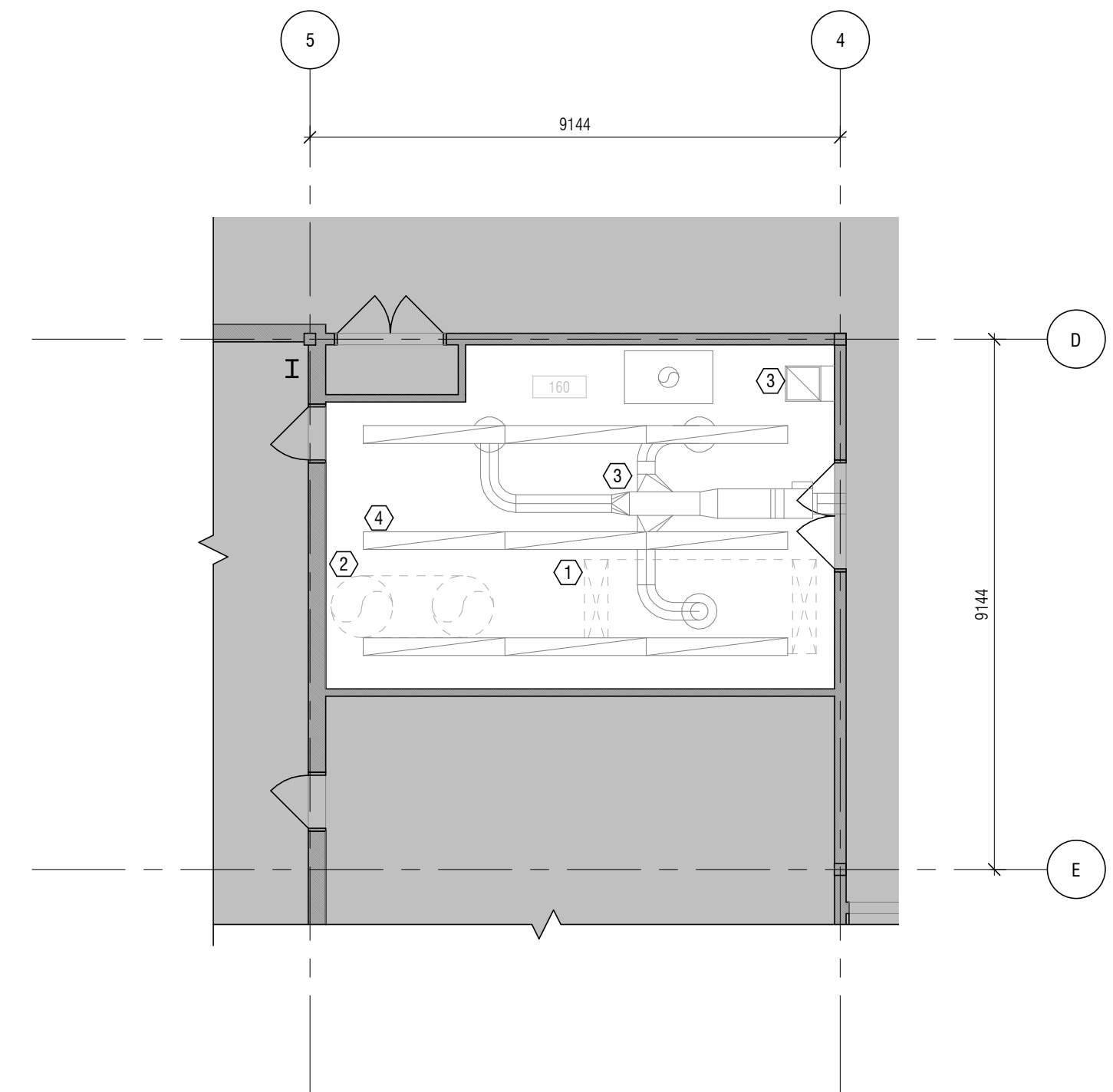

LEVEL 1 - DEMOLITION REFLECTED CEILING PLAN  
1 : 100

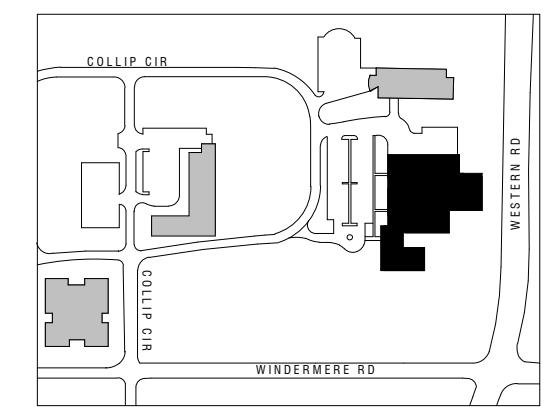

ISSUED:

No.	Date	Description
1	2016-11-23	ISSUED FOR TENDER

GENERAL DEMOLITION NOTES:

1. REFER TO SPECIFICATIONS
2. DASHED LINES INDICATE EXISTING BUILDING ELEMENTS TO BE REMOVED. PATCH AND MAKE GOOD WHERE CONNECTED TO EXISTING BUILDING ELEMENTS TO REMAIN.
3. IT IS THE RESPONSIBILITY OF THE GENERAL CONTRACTOR TO COORDINATE ALL DEMOLITION WITH ALL PROPOSED WORK AS INDICATED ON THESE DRAWINGS AND AS REQUIRED TO PROVIDE A COMPLETE AND FINISHED PROJECT.
4. REFER TO CONSTRUCTION DOCUMENTS OF ALL DISCIPLINES AND COORDINATE SCOPE OF WORK SHOWN ON ARCHITECTURAL DEMOLITION DRAWINGS WITH DEMOLITION DRAWINGS PREPARED BY ALL OTHER CONSULTING DISCIPLINES.
5. DEMOLITION CONTRACTOR TO FIELD VERIFY & COORDINATE REMOVAL OF ELECTRICAL AND MECHANICAL COMPONENTS AS SHOWN ON ALL DRAWINGS WHICH PERTAIN TO THESE DISCIPLINES AND AS NECESSARY FOR PREPARATION FOR PROPOSED WORK. ASSUME ALL BUILDING SERVICES ARE ACTIVE AND ELECTRIFIED & ALL OTHER WIRES ARE LIVE PRIOR TO COMMENCEMENT OF ANY WORK. SEE ALL OTHER DRAWINGS FOR THIS PROJECT.
6. UNLESS OTHERWISE NOTED, ALL DEMOLISHED MATERIAL IS TO BE DISPOSED OF AS PART OF THIS CONTRACT AND AS NOTED IN SPECIFICATIONS.
7. GENERAL CONTRACTOR TO ENSURE THAT ALL EXISTING CONSTRUCTION WHICH IS TO REMAIN IS PROTECTED AND NOT DISTURBED OR DAMAGED BY THE DEMOLITION WORK.
8. ALL EXISTING FIRE RESISTANCE RATINGS ARE TO BE MAINTAINED DURING DEMOLITION. IF ANY FIRE RATINGS ARE JEOPARDIZED DURING DEMOLITION, THE RECONSTRUCTION OF SAME IS THE RESPONSIBILITY OF THE GENERAL CONTRACTOR AND MUST BE INCLUDED AS A PART OF THIS CONTRACT.
9. REMOVE ALL EXISTING ROOM NAME/NUMBER SIGNS. PATCH AND MAKE GOOD WALL FINISH AS REQUIRED TO MATCH EXISTING ADJACENT WALL FINISHES
10. REMOVE ALL UNUSED AND EXPOSED NAILS AND SCREWS ON EXISTING WALLS. PATCH AND MAKE GOOD EXISTING WALL SURFACE BEFORE REPAINTING.
11. REMOVE EXISTING WHITEBOARDS, BLACKBOARDS, TACKBOARDS AND ALL ASSOCIATED RAILINGS. TURN OVER TO OWNER AND WHERE ANY OF THE ABOVE ARE MOUNTED ON EXISTING WALLS THAT WILL REMAIN IN PLACE, PATCH AND MAKE GOOD EXISTING WALL SURFACE BEFORE REPAINTING
12. PRIOR TO START OF DEMOLITION, THE GENERAL CONTRACTOR AND NRC DEPARTMENTAL REPRESENTATIVE SHALL TOUR ALL WORK AREAS FOR THE PURPOSE OF CONFIRMING ALL ITEMS TO BE SALVAGED BY THE CONTRACTOR AND TURNED OVER TO THE NRC DEPARTMENTAL REPRESENTATIVE.
13. DEMOLITION SHALL BE UNDERTAKEN IN ACCORDANCE WITH NRC DEPARTMENTAL REPRESENTATIVE REQUIREMENTS FOR WORK WITHIN OCCUPIED BUILDINGS AND IN A MANNER THAT MINIMIZES DISRUPTION OF BUILDING INHABITANTS.
14. EXISTING WINDOW TREATMENTS TO REMAIN

**Diamond Schmitt Architects**  
384 Adelaide Street West, Suite 300, Toronto, Canada M5V1R7  
Tel: 416 862 8800 Fax: 416 862 5508 info@dsai.ca www.dsai.ca

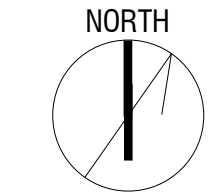

1552  
**NRC Factory of the Future  
Demolition Package 2**  
800 Collip Cir, London, ON N6G 4X8

drawing				dessin			
LEVEL 1 - DEMOLITION REFLECTED CEILING PLAN							
designed	conçu	date	date	drawn	dessiné	scale:	échelle
Designer		2016-12-13		Designer		1 : 100	
checked	vérifié	sheet	feuille	approved	approuvé	W.O. no	D.T. no

dwg.no. 1  
dessin no. A10  
**IMC0200-A10**

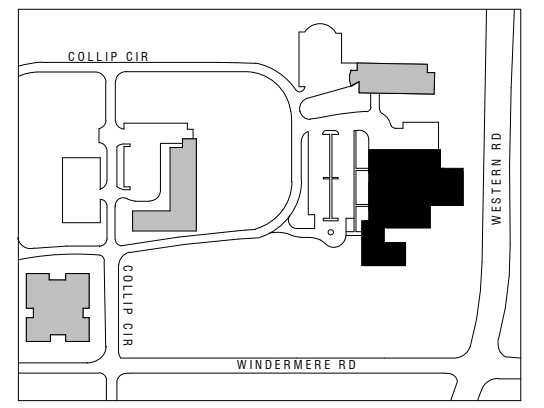

ISSUED:

No.	Date	Description
1	2016-11-23	ISSUED FOR TENDER

GENERAL DEMOLITION NOTES:

- REFER TO SPECIFICATIONS
- DASHED LINES INDICATE EXISTING BUILDING ELEMENTS TO BE REMOVED. PATCH AND MAKE GOOD WHERE CONNECTED TO EXISTING BUILDING ELEMENTS TO REMAIN.
- IT IS THE RESPONSIBILITY OF THE GENERAL CONTRACTOR TO COORDINATE ALL DEMOLITION WITH ALL PROPOSED WORK AS INDICATED ON THESE DRAWINGS AND AS REQUIRED TO PROVIDE A COMPLETE AND FINISHED PROJECT.
- REFER TO CONSTRUCTION DOCUMENTS OF ALL DISCIPLINES AND COORDINATE SCOPE OF WORK SHOWN ON ARCHITECTURAL DEMOLITION DRAWINGS WITH DEMOLITION DRAWINGS PREPARED BY ALL OTHER CONSULTING DISCIPLINES.
- DEMOLITION CONTRACTOR TO FIELD VERIFY & COORDINATE REMOVAL OF ELECTRICAL AND MECHANICAL COMPONENTS AS SHOWN ON ALL DRAWINGS WHICH PERTAIN TO THESE DISCIPLINES AND AS NECESSARY FOR PREPARATION FOR PROPOSED WORK. ASSUME ALL BUILDING SERVICES ARE ACTIVE AND ELECTRIFIED & ALL OTHER WIRES ARE LIVE PRIOR TO COMMENCEMENT OF ANY WORK. SEE ALL OTHER DRAWINGS FOR THIS PROJECT.
- UNLESS OTHERWISE NOTED, ALL DEMOLISHED MATERIAL IS TO BE DISPOSED OF AS PART OF THIS CONTRACT AND AS NOTED IN SPECIFICATIONS.
- GENERAL CONTRACTOR TO ENSURE THAT ALL EXISTING CONSTRUCTION WHICH IS TO REMAIN IS PROTECTED AND NOT DISTURBED OR DAMAGED BY THE DEMOLITION WORK.
- ALL EXISTING FIRE RESISTANCE RATINGS ARE TO BE MAINTAINED DURING DEMOLITION. IF ANY FIRE RATINGS ARE JEOPARDIZED DURING DEMOLITION, THE RECONSTRUCTION OF SAME IS THE RESPONSIBILITY OF THE GENERAL CONTRACTOR AND MUST BE INCLUDED AS A PART OF THIS CONTRACT.
- REMOVE ALL EXISTING ROOM NAME/NUMBER SIGNS. PATCH AND MAKE GOOD WALL FINISH AS REQUIRED TO MATCH EXISTING ADJACENT WALL FINISHES
- REMOVE ALL UNUSED AND EXPOSED NAILS AND SCREWS ON EXISTING WALLS. PATCH AND MAKE GOOD EXISTING WALL SURFACE BEFORE REPAINTING.
- REMOVE EXISTING WHITEBOARDS, BLACKBOARDS, TACKBOARDS AND ALL ASSOCIATED RAILINGS; TURN OVER TO OWNER AND WHERE ANY OF THE ABOVE ARE MOUNTED ON EXISTING WALLS THAT WILL REMAIN IN PLACE, PATCH AND MAKE GOOD EXISTING WALL SURFACE BEFORE REPAINTING
- PRIOR TO START OF DEMOLITION, THE GENERAL CONTRACTOR AND NRC DEPARTMENTAL REPRESENTATIVE SHALL TOUR ALL WORK AREAS FOR THE PURPOSE OF CONFIRMING ALL ITEMS TO BE SALVAGED BY THE CONTRACTOR AND TURNED OVER TO THE NRC DEPARTMENTAL REPRESENTATIVE.
- DEMOLITION SHALL BE UNDERTAKEN IN ACCORDANCE WITH NRC DEPARTMENTAL REPRESENTATIVE REQUIREMENTS FOR WORK WITHIN OCCUPIED BUILDINGS AND IN A MANNER THAT MINIMIZES DISRUPTION OF BUILDING INHABITANTS.
- EXISTING WINDOW TREATMENTS TO REMAIN

**Diamond Schmitt Architects**  
 384 Adelaide Street West, Suite 300, Toronto, Canada M5V1R7  
 Tel: 416 862 8800 Fax: 416 862 5508 info@dsai.ca www.dsai.ca

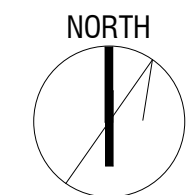

1552

**NRC Factory of the Future Demolition Package 2**

800 Collip Cir, London, ON N6G 4X8

drawing dessin

designed	conçu	date	date
DSAI		2016-12-13	
drawn	dessiné	scale:	échelle
DSAI		As indicated	
checked	vérifié	sheet	feuille
approved	approuvé	W.O. no	D.T. no

dwg.no. dessin no.

**IMC0200-A11**

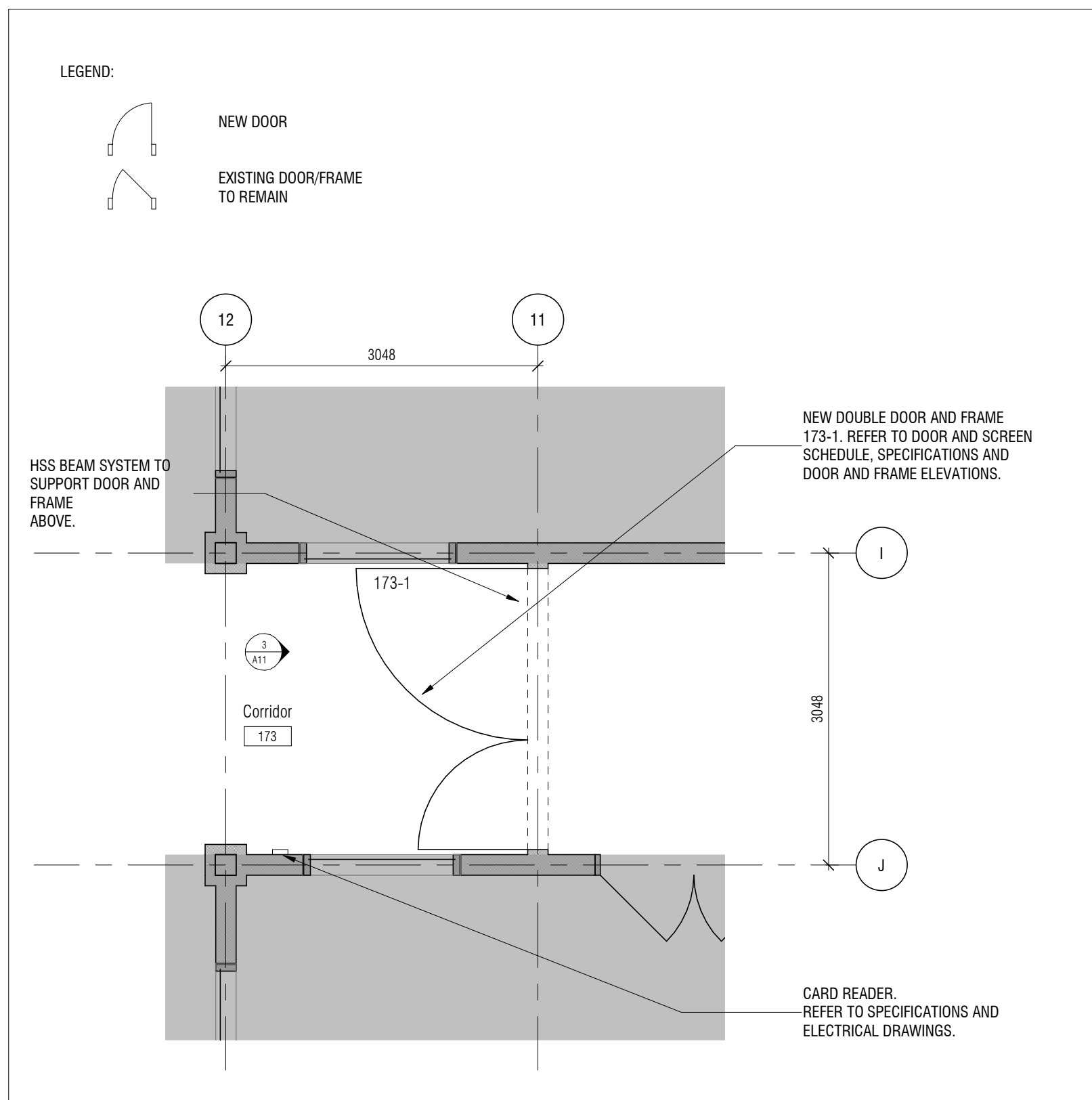

LEVEL 1 - PARTIAL GROUND FLOOR PLAN 1  
 1: 50 A11

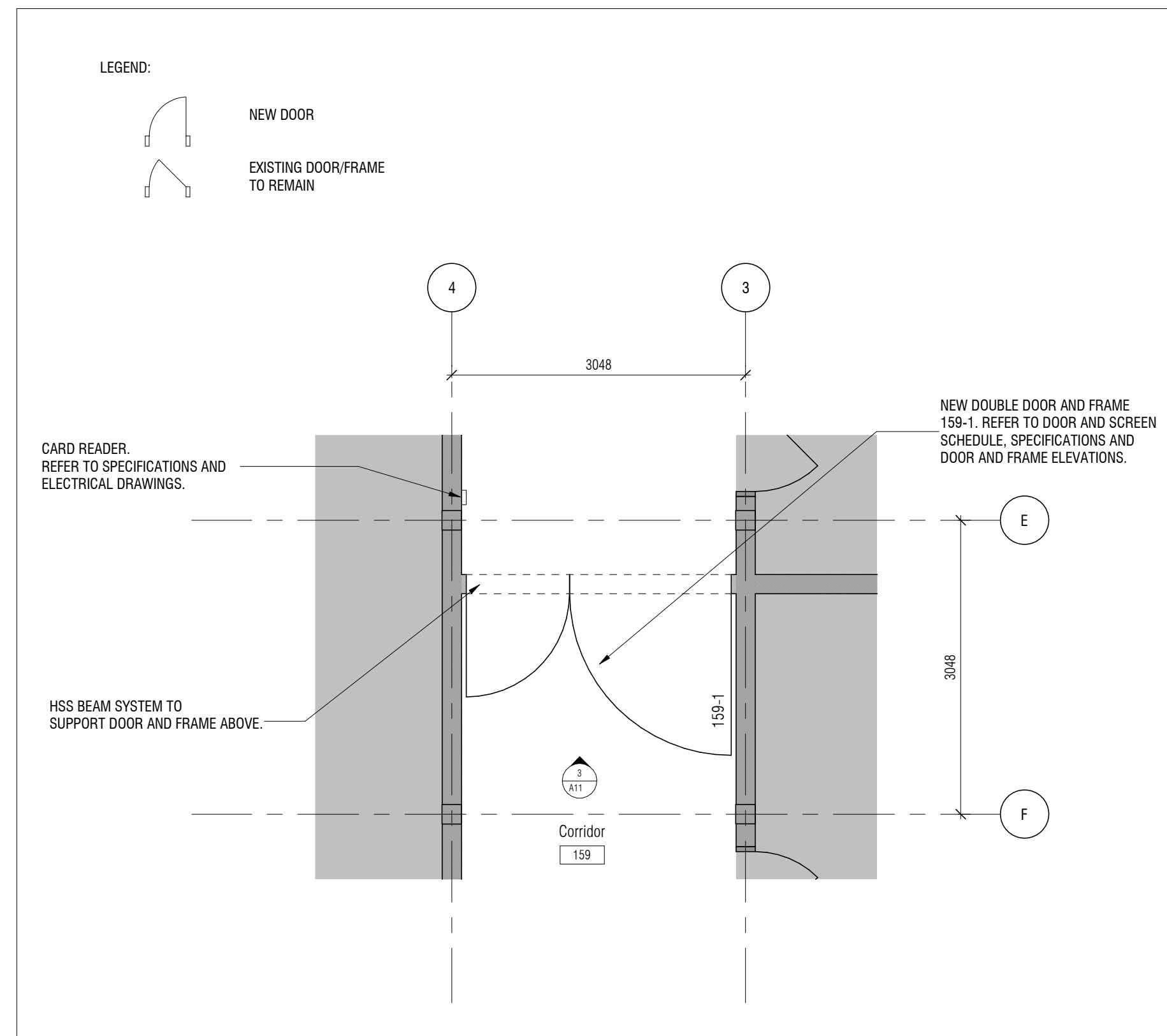

LEVEL 1 - PARTIAL GROUND FLOOR PLAN 2  
 1: 50 A11

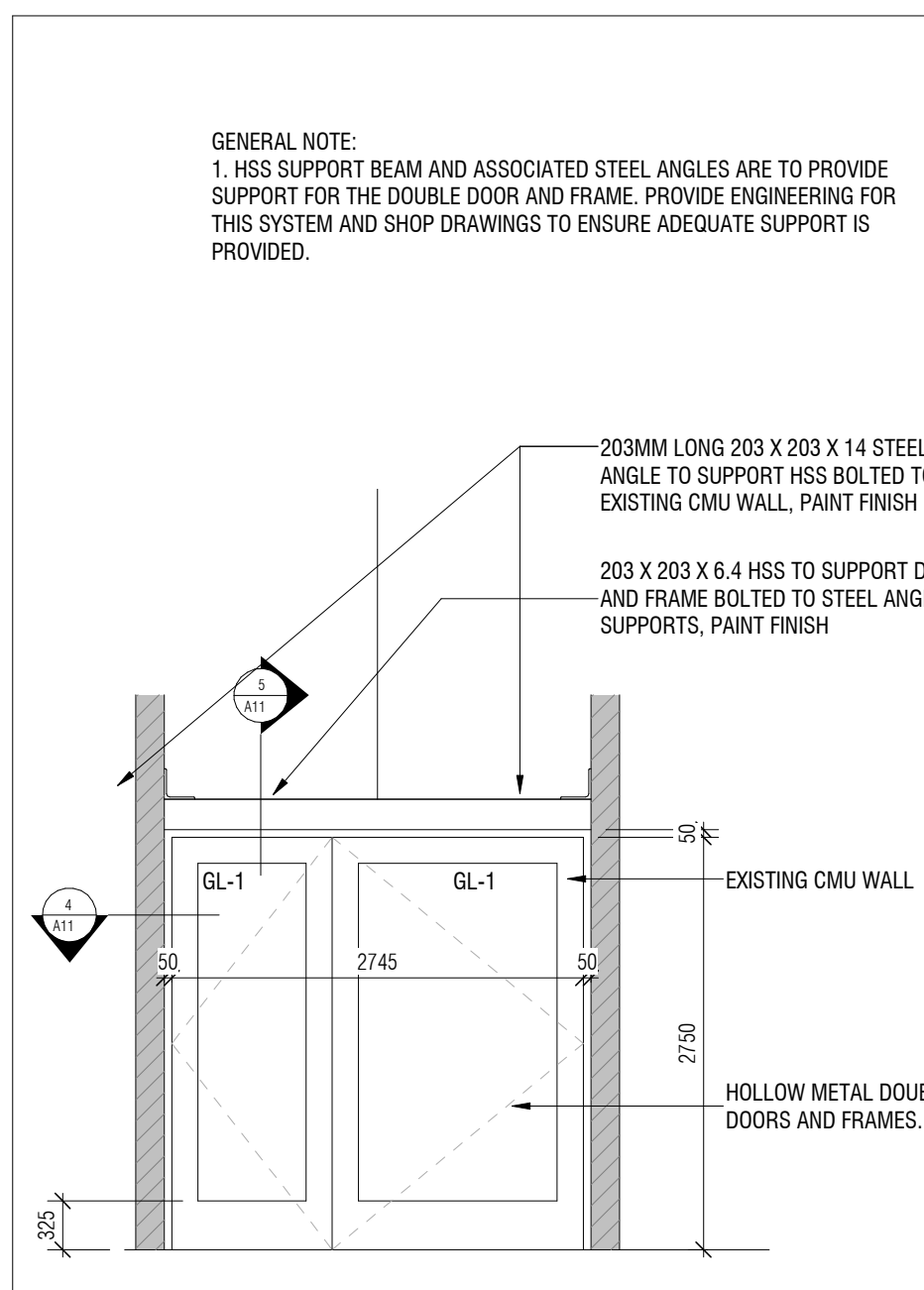

NEW DOOR ELEVATION @CORRIDOR 159 - MIRRORED VIEW @ CORRIDOR 173 3  
 1: 50 A11

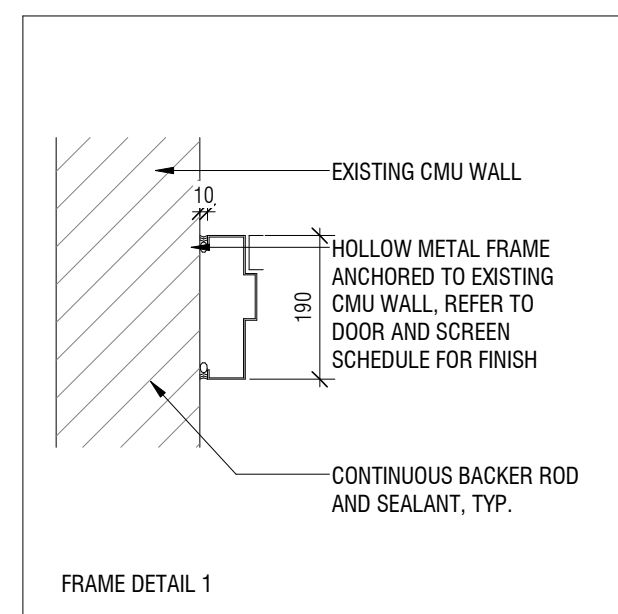

FRAME DETAIL 1 4  
 1: 10 A11

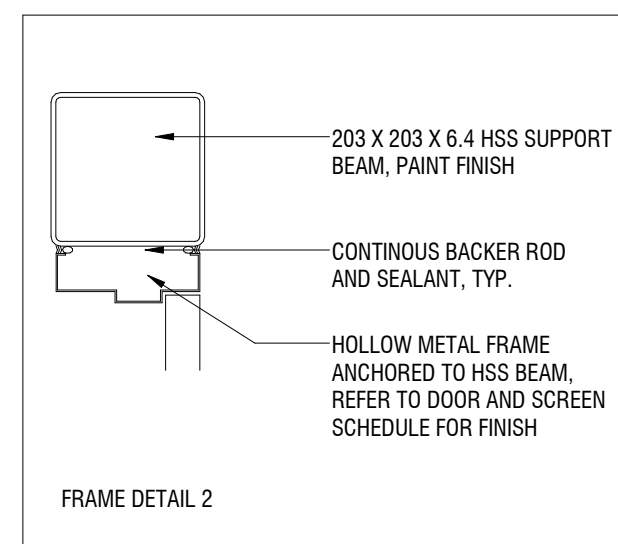

FRAME DETAIL 2 5  
 1: 10 A11

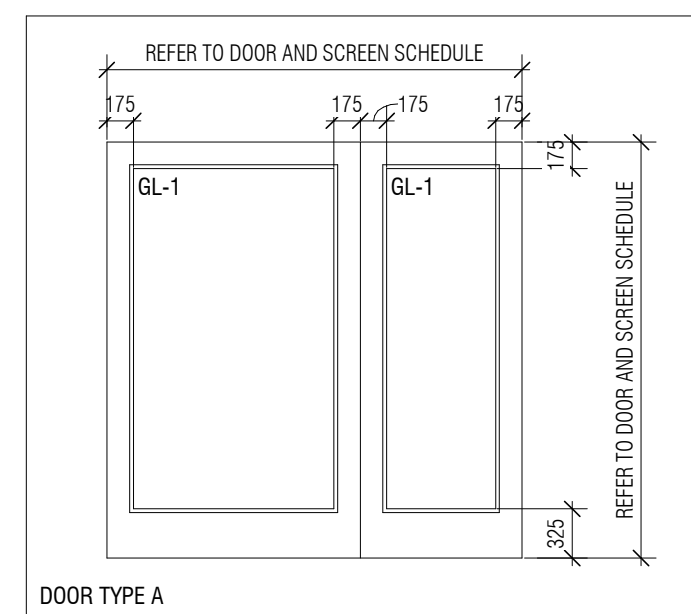

DOOR TYPE 6  
 1: 50 A11

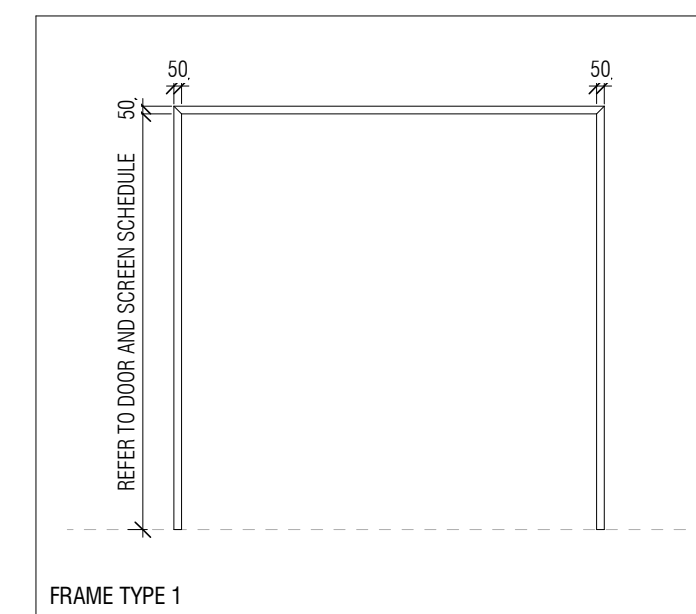

FRAME TYPE 7  
 1: 50 A11

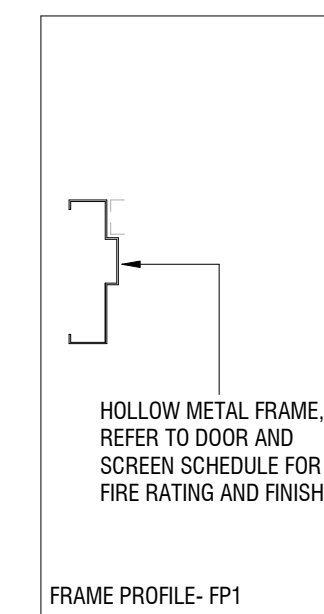

FRAME PROFILE 8  
 1: 10 A11

DOOR SCHEDULE

LEGEND

DOOR NO.	REBATE WIDTH	REBATE HEIGHT	DOOR TYPE	MAT'L	FINISH	GLASS	GRILLE	TYPE	MAT'L	FINISH	GLASS	PROFILE	DETAIL	FIRE RATING	NOTES
159-1	1675 / 1070	2750	A	HM	PT	GL-1	-	1	HM	PT	-	FP1	4/A1001, 5/A1001	-	HEAVY DUTY HOLLOW METAL DOOR, CARD READER
173-3	1675 / 1070	2750	A	HM	PT	GL-1	-	1	HM	PT	-	FP1	4/A1001, 5/A1001	-	HEAVY DUTY HOLLOW METAL DOOR, CARD READER

DOOR SCHEDULE 9  
 1: 50 A11