



Fisheries and Oceans
Canada

Pêches et Océans
Canada

Fence Replacement

CCG Ferndale NAVTEX

Ferndale, Bruce County, Ontario

MARITIME AND CIVIL INFRASTRUCTURE

Prepared by: AB

Approved by: AB

Revision: 0

File: 8055-491

Rev Date: November 11, 2016

Scope of work:

Canadian Coast Guard (CCG) has a requirement for the installation of 11 separate fence compounds with a total perimeter of 167 meters of fencing at the Ferndale NAVTEX Site.

Site Location and Accessibility

The fence replacement is to be completed at the Ferndale NAVTEX Site. The site coordinates are 44°56'13.55"N - 81°14'0.42"W (see Appendix A). Before tendering, Contractors should familiarize themselves with the location, site restrictions, and temporary measures (including snow clearing) if required for completing the work as specified.

Contractor should note that this work could be performed on the site of an existing operational tower where radio frequency transmission and reception is occurring.

Description of Work:

Work under this Contract includes but is not limited to the provision of all labour, materials, and equipment required to complete the following:

1. Removal and disposal of the existing fences (see Appendix B)
2. Installation of 11 new separate fence compounds with one entrance gate for each compound location

Fence Dimensions:

The inner and outer anchors require different fence arrangements (See Appendix C). The following is the arrangement for each:

- Inner anchors: three (8m x 2.5m), as shown in Appendix C.
- Outer anchors: eight (4m x 2.5m), as shown in Appendix C.

The fence clearance required (height above ground) shall be 1.350 meters, as per OPSS.

Material requirements for new fence:

- Fencing: as per OPSS.
- Posts: Wood or Steel & Wood combination (3:1 ratio), as per OPSS.
- Gate: one 2.40m total width or two adjacent 1.20m walk gates, as per OPSS.

Brace panels required:

- At all corners, 2 panels (as per OPSS).
- At all terminations (gate openings), 1 panel/termination (as per OPSS).

Work shall include site preparation and selective clearing as detailed in OPSS 540.

Copies of the above referenced OPSS may be obtained free of charge at www.raqsa.mto.gov.on.ca/techpubs/OPS.nsf/OPSHomepage. The following are provided as an additional reference.

General Requirements

Perform work in accordance with the National Building Code of Canada (NBCC) and any other code of provincial or local application. In the case of any conflict or discrepancy, the more stringent requirements will apply.

Health and Safety

The contractor must execute the works identified herein in strict conformance with the requirements set forth in the following:

- 1 Canadian Labour Code Part II – January 2008
- 2 Ontario Occupational Health and Safety Act and Regulations

The contractor must have an existing corporate health and safety policy and must be registered and in good standing with the Worker's Compensation and Insurance Board (WSIB).

Submittals and Deadlines

Bidders must provide the following:

- 1 Site Specific Safety Plan;
- 2 Schedule of field work.

Contractors shall provide the Canadian Coast Guard with notice 5 business days prior to requiring access to the sites. All work must be completed no later than March 31st, 2017.

Background information

Appendix A – Site Location

Appendix B – Photos

Appendix C – Drawings

**APPENDIX A:
Site Location**



Figure 1: Ferndale Navtex site (44°56'13.55"N - 81°14'0.42"W)

**APPENDIX B:
Site Photos**



Figure 2: Typical fencing compounds to be replaced

APPENDIX C:
Drawings

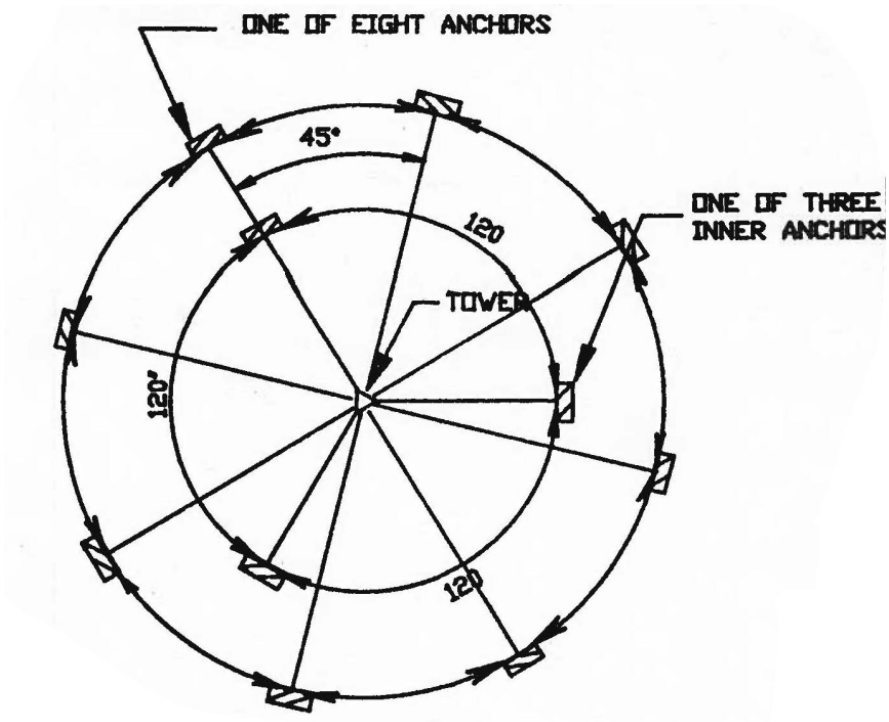
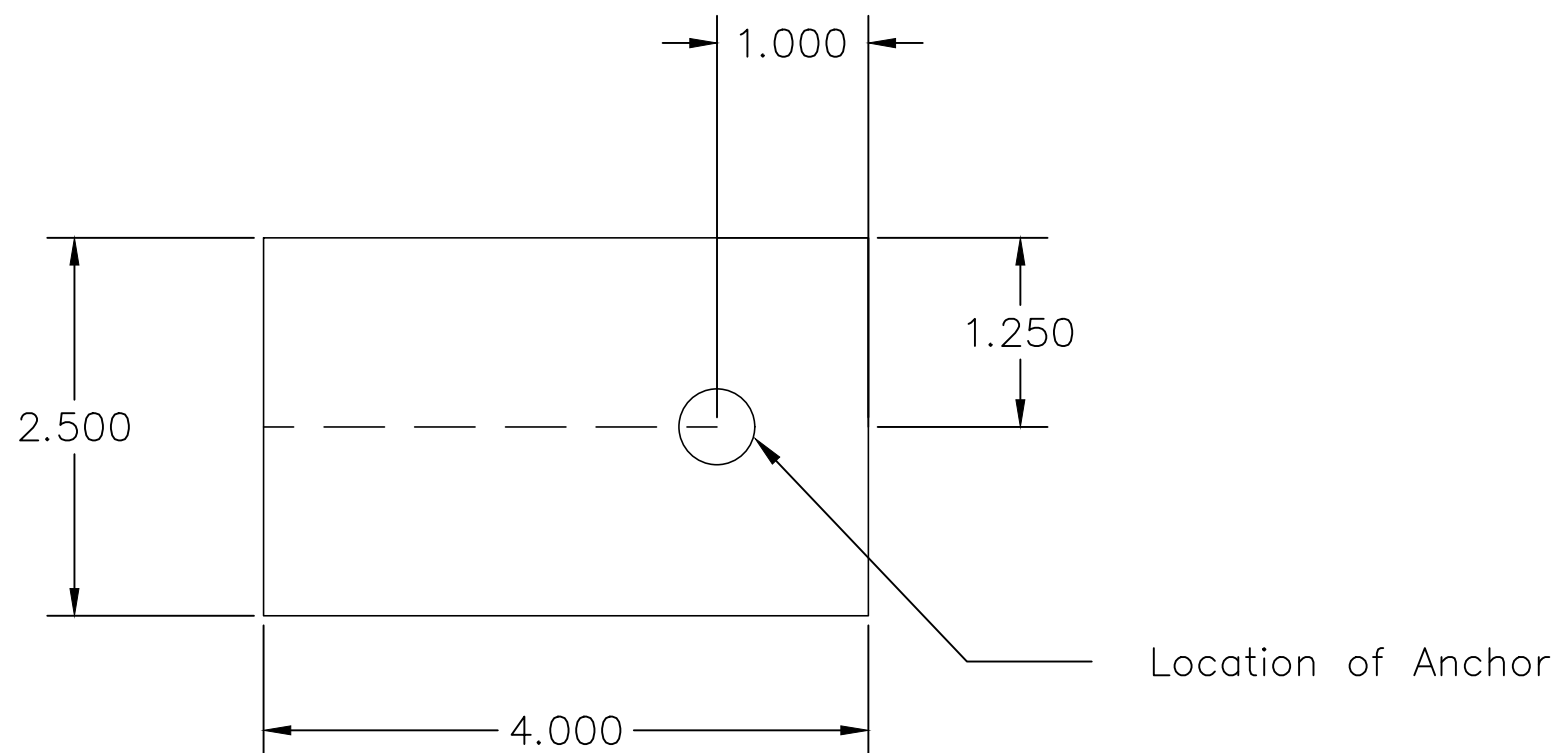
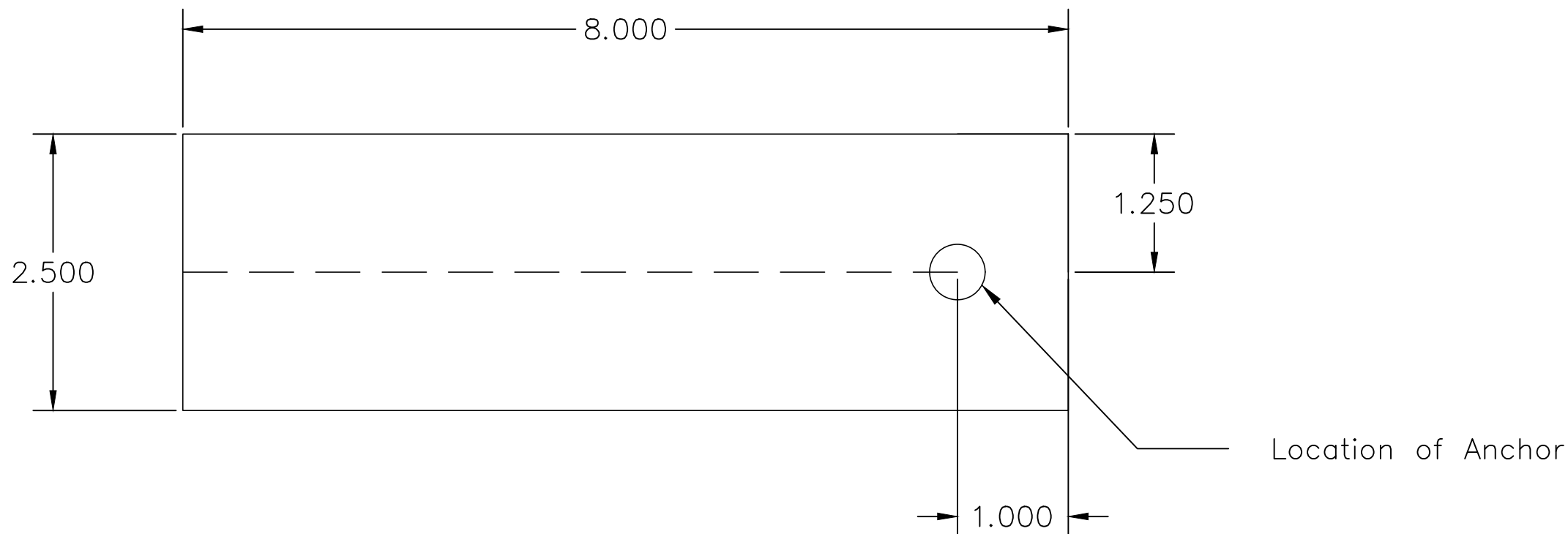

Figure 3: Inner and outer anchors to be re-fenced



Vendor / Sous-traitant

NOTES:

1. ALL DIMENSIONS ARE IN METERS UNLESS STATED OTHERWISE.
2. NOT TO BE USED TO DETAIL FENCE (REFER TO OSPD 971.101 FOR FENCE DETAIL).
3. ENTRANCE DOORS TO BE PLACED ON LONGER SPANS.

0	DESCRIPTION	AB	07-11-16
rev	description	by	date

Asset - Actif	Ferndale Fence Replacement		
---------------	---	--	--

Drawing - Dessin	FENCE DIMENSIONS		
------------------	-------------------------	--	--

designed - conception		date	
AB		2016-11-07	
drawn - dessiné		date	
AB		2016-11-07	
checked - vérifié		date	
AB		2016-11-07	
approved - approuvé		date	
AB		2016-11-07	

CCG ref. no. - no. réf. GCC	scale - échelle		
	NTS		
drawing no. - no. dessin	sheet-feuille	rev	
1		0	

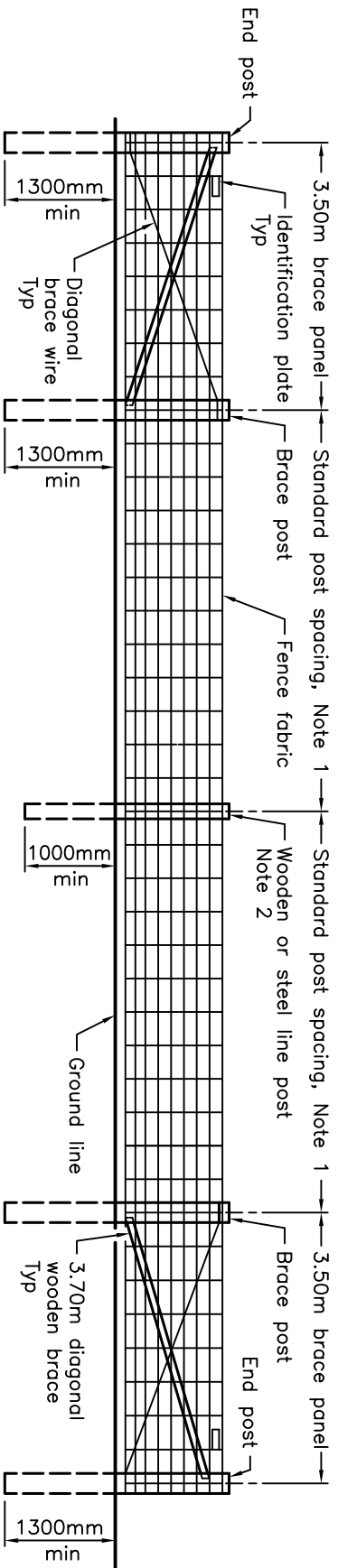

**HIGHWAY FENCE
IN EARTH, SHALE, LOOSE ROCK, OR FRIABLE ROCK**

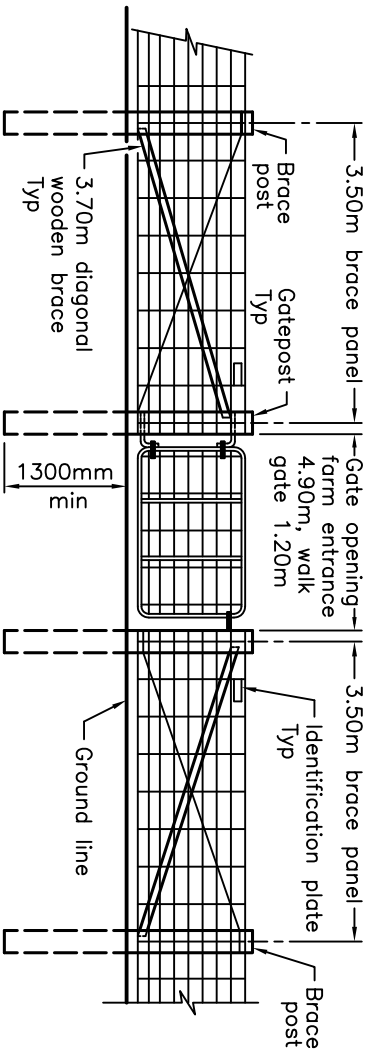

GATE DETAIL

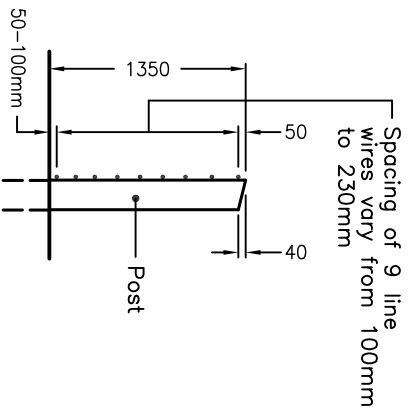

WIRE SPACING DETAIL

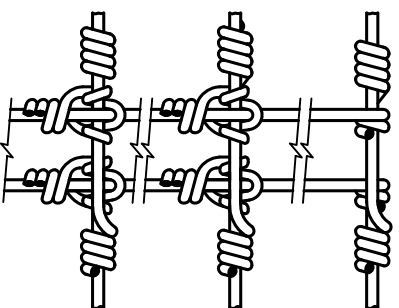

SPLICING DETAIL

NOTES:

- 1 Standard post spacing shall be 6.0m for wooden post to wooden post and 5.0m for steel post to steel or wooden post.
 - 2 Ratio of steel posts to wooden posts shall be 3:1.
- A All dimensions are in millimetres unless otherwise shown.

ONTARIO PROVINCIAL STANDARD DRAWING	Nov 2012	Rev 3
FENCE, HIGHWAY IN EARTH, SHALE, LOOSE ROCK, OR FRIABLE ROCK INSTALLATION		
OPSD 971.101		

