

COORDINATE WITH PRE-ENGINEERED
MODULAR STEEL BRIDGE SHOP DRAWINGS.

BRIDGE WORKING POINTS				
WORK-POINT (WP#)	STATIONS	ABUTMENT	NORTHING	EASTING
WP#1	0+051.73m	WEST	4910592.9771	5443771.4787
WP#2	0+091.12m	EAST	4910610.2377	5443806.8855

GENERAL NOTES:

- BRIDGE DESIGN IN ACCORDANCE WITH CAN/CSA-S6-06. CANADIAN HIGHWAY BRIDGE DESIGN CODE.
- DESIGN LIVE LOAD CL 625.

A. CL-625 TRUCK
LOADING

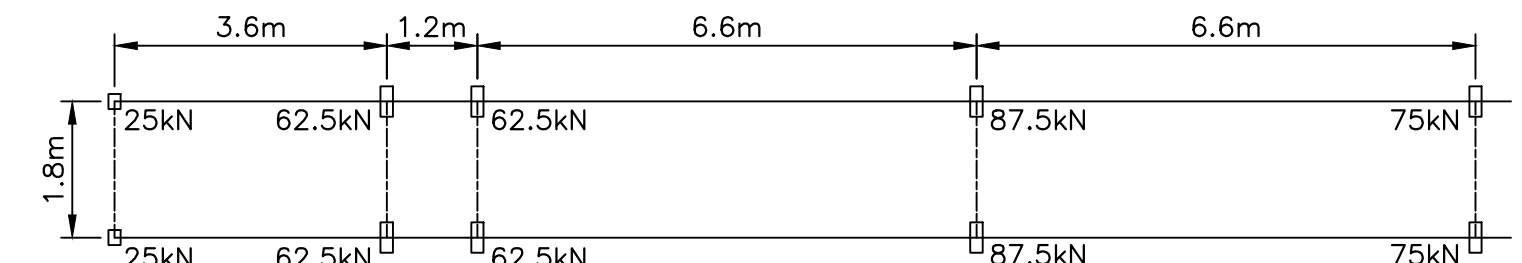

B. CL-625
LANE
LOADING

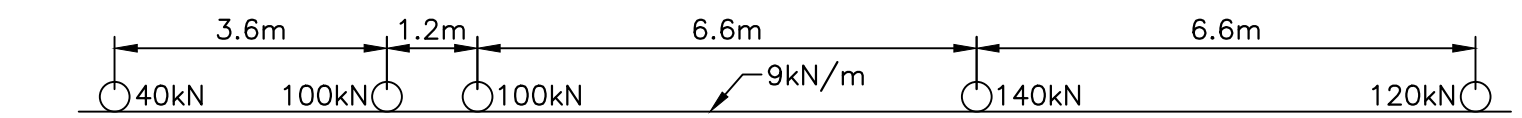

- CONSTRUCTION AND MATERIALS IN ACCORDANCE WITH NOVA SCOTIA DEPARTMENT OF TRANSPORTATION STANDARD SPECIFICATIONS FOR HIGHWAY CONSTRUCTION AND MAINTENANCE, WITH LATEST REVISIONS.
- HIGHWAY DESIGN IN ACCORDANCE WITH TRANSPORTATION ASSOCIATION OF CANADA MANUAL OF GEOMETRIC DESIGN STANDARDS FOR CANADIAN ROADS.
- ALL DIMENSIONS MILLIMETERS UNLESS OTHERWISE STATED.
- ALL ELEVATIONS AND STATIONS IN METERS.

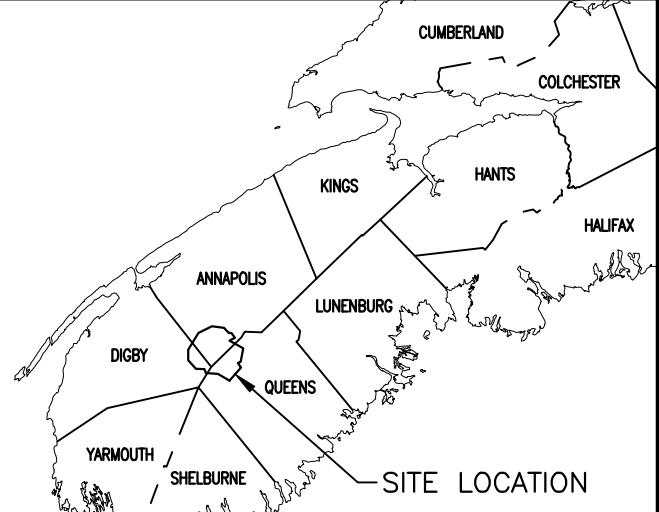

SCALE: N.T.S.



C01	ISSUED FOR TENDER	MAY 13 2016
revisions		date
project	MERSEY RIVER BRIDGE REPLACEMENT KEJIMKUJIK NATIONAL PARK, NOVA SCOTIA	
drawing	desain	

GENERAL ARRANGEMENT
PLAN & ELEVATIONS

designed TDB	conçu
date	
drawn TMB	dessiné
date	
approved NDL	approuvé
date	
Tender	Soumission
PWSC Project Manager	Administrateur de projets TPSGC
project number	no. du projet
R.007567.001	
drawing no.	no. du dessin
S02	