

LEGENDE

- A** MAIN ELECTRICAL VAULT
 - B** CHEMICAL STORAGE
 - C** STORAGE CAGE
 - D** UPS ROOM
 - E** SEPTIC SUMP PIT ROOM
 - F** WOMENS SHOWER
 - G** WOMENS WASHROOM
 - H** MENS WASHROOM
 - I** BOARD ROOM
 - J** BOARD ROOM
 - K** AIRCONDITIONER ROOM
 - L** STORE ROOM
 - M** OIL STORAGE ROOM #1
 - N** OIL STORAGE ROOM #2
 - TUNNEL**
- 1** BOILER #1 FD FAN
 - 2** BOILER #2 FD FAN
 - 3** BOILER #3 FD FAN
 - 4** HT EXPANSION TANK
 - 5** BLOW DOWN TANK
 - 6** HT STRAINER
 - 7** CW EXPANSION TANK
 - 8** #1 CONDENSER PUMP
 - 9** #2 CONDENSER PUMP
 - 10** #3 CONDENSER PUMP
 - 11** #4 CONDENSER PUMP
 - 12** #1 CW FILTER
 - 13** #2 CW FILTER
 - 14** CW STRAINER
 - 15** SMALL CONDENSER PUMP
 - 16** #1 AIR COMPRESSOR
 - 17** #2 AIR COMPRESSOR
 - 18** #3 AIR COMPRESSOR
 - 19** #4 AIR COMPRESSOR
 - 20** #1 AIR RECEIVER
 - 21** #2 AIR RECEIVER
 - 22** #1 OIL CIRCULATION PUMP
 - 23** #2 OIL CIRCULATION PUMP
 - 24** OIL UNLOADING PUMP
 - 25** #1 AND #2 OIL PUMPS FOR #4 BOILER
 - 26** WEST END SUMP PUMPS #1 AND #2
 - 27** CENTER SUMP PUMPS #1 AND #2
 - 28** EAST SUMP PUMP
 - 29** #1 OIL TANK
 - 30** #2 OIL TANK
 - 31** 500G DIESEL TANK
 - 32** 15 KVA SWITCH GEAR
 - 33** #2 SUB STATION
 - 34** 5 KVA SWITCH GEAR FOR CHILLERS
 - 35** MCC #1
 - 36** WEST END FRESH AIR HEATER
 - 37** EAST END FRESH AIR HEATER
 - 38** COOLING TOWER MCC

DRAWING NOTES:

1. PROPOSED CONCEPTUAL LOCATION FOR BIOMASS BOILER LTHW SUPPLY PIPING CONNECTION TO CHCP HEATING SUPPLY MAIN.
2. PROPOSED CONCEPTUAL LOCATION FOR BIOMASS BOILER LTHW RETURN PIPING CONNECTION TO CHCP HEATING RETURN MAIN.

IS	RE	DATE	DESCRIPTION
TITLE:			
CONFEDERATION HEIGHTS CHCP BIOMASS BOILER PILOT PLANT RFP CONCEPT DRAWINGS			
SHEET NUMBER:			
BASEMENT			
1 OF 3			
ISSUE:			REV #
CONCEPT DRAWING			0
DATE OF: MAY 2017			

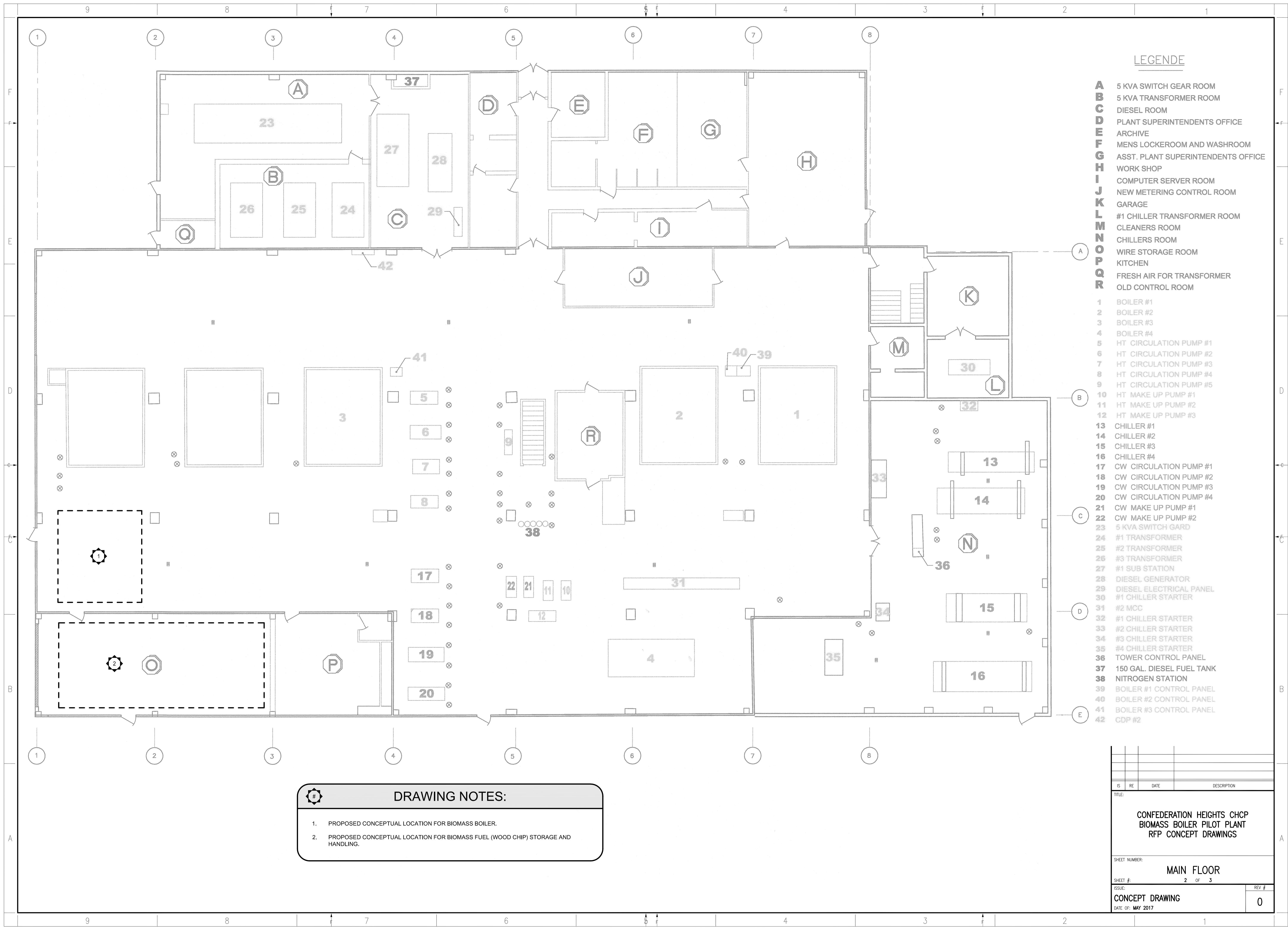

LEGENDE

- A** 5 KVA SWITCH GEAR ROOM
- B** 5 KVA TRANSFORMER ROOM
- C** DIESEL ROOM
- D** PLANT SUPERINTENDENTS OFFICE
- E** ARCHIVE
- F** MENS LOCKEROOM AND WASHROOM
- G** ASST. PLANT SUPERINTENDENTS OFFICE
- H** WORK SHOP
- I** COMPUTER SERVER ROOM
- J** NEW METERING CONTROL ROOM
- K** GARAGE
- L** #1 CHILLER TRANSFORMER ROOM
- M** CLEANERS ROOM
- N** CHILLERS ROOM
- O** WIRE STORAGE ROOM
- P** KITCHEN
- Q** FRESH AIR FOR TRANSFORMER
- R** OLD CONTROL ROOM
- 1** BOILER #1
- 2** BOILER #2
- 3** BOILER #3
- 4** BOILER #4
- 5** HT CIRCULATION PUMP #1
- 6** HT CIRCULATION PUMP #2
- 7** HT CIRCULATION PUMP #3
- 8** HT CIRCULATION PUMP #4
- 9** HT CIRCULATION PUMP #5
- 10** HT MAKE UP PUMP #1
- 11** HT MAKE UP PUMP #2
- 12** HT MAKE UP PUMP #3
- 13** CHILLER #1
- 14** CHILLER #2
- 15** CHILLER #3
- 16** CHILLER #4
- 17** CW CIRCULATION PUMP #1
- 18** CW CIRCULATION PUMP #2
- 19** CW CIRCULATION PUMP #3
- 20** CW CIRCULATION PUMP #4
- 21** CW MAKE UP PUMP #1
- 22** CW MAKE UP PUMP #2
- 23** 5 KVA SWITCH GARD
- 24** #1 TRANSFORMER
- 25** #2 TRANSFORMER
- 26** #3 TRANSFORMER
- 27** #1 SUB STATION
- 28** DIESEL GENERATOR
- 29** DIESEL ELECTRICAL PANEL
- 30** #1 CHILLER STARTER
- 31** #2 MCC
- 32** #1 CHILLER STARTER
- 33** #2 CHILLER STARTER
- 34** #3 CHILLER STARTER
- 35** #4 CHILLER STARTER
- 36** TOWER CONTROL PANEL
- 37** 150 GAL. DIESEL FUEL TANK
- 38** NITROGEN STATION
- 39** BOILER #1 CONTROL PANEL
- 40** BOILER #2 CONTROL PANEL
- 41** BOILER #3 CONTROL PANEL
- 42** CDP #2

DRAWING NOTES:

1. PROPOSED CONCEPTUAL LOCATION FOR BIOMASS BOILER.
2. PROPOSED CONCEPTUAL LOCATION FOR BIOMASS FUEL (WOOD CHIP) STORAGE AND HANDLING.

IS	RE	DATE	DESCRIPTION
TITLE:			
CONFEDERATION HEIGHTS CHCP BIOMASS BOILER PILOT PLANT RFP CONCEPT DRAWINGS			
SHEET NUMBER:			
MAIN FLOOR			
SHEET #:			
2 OF 3			
ISSUE:			REV #
CONCEPT DRAWING			0
DATE OF: MAY 2017			

LEGENDE

- 1 #1 BOILER BREACHING
- 2 #2 BOILER BREACHING
- 3 #3 BOILER BREACHING
- 4 #4 BOILER CHIMNEY
- 5 #1 BOILER ID FAN
- 6 #2 BOILER ID FAN
- 7 #3 BOILER ID FAN
- 8 HT MAKE UP TANK
- 9 CW MAKE UP TANK
- 10 WEST AIR INTAKE
- 11 EST AIR INTAKE
- 12 MCC #3
- 13 EMERGENCY LADDERS

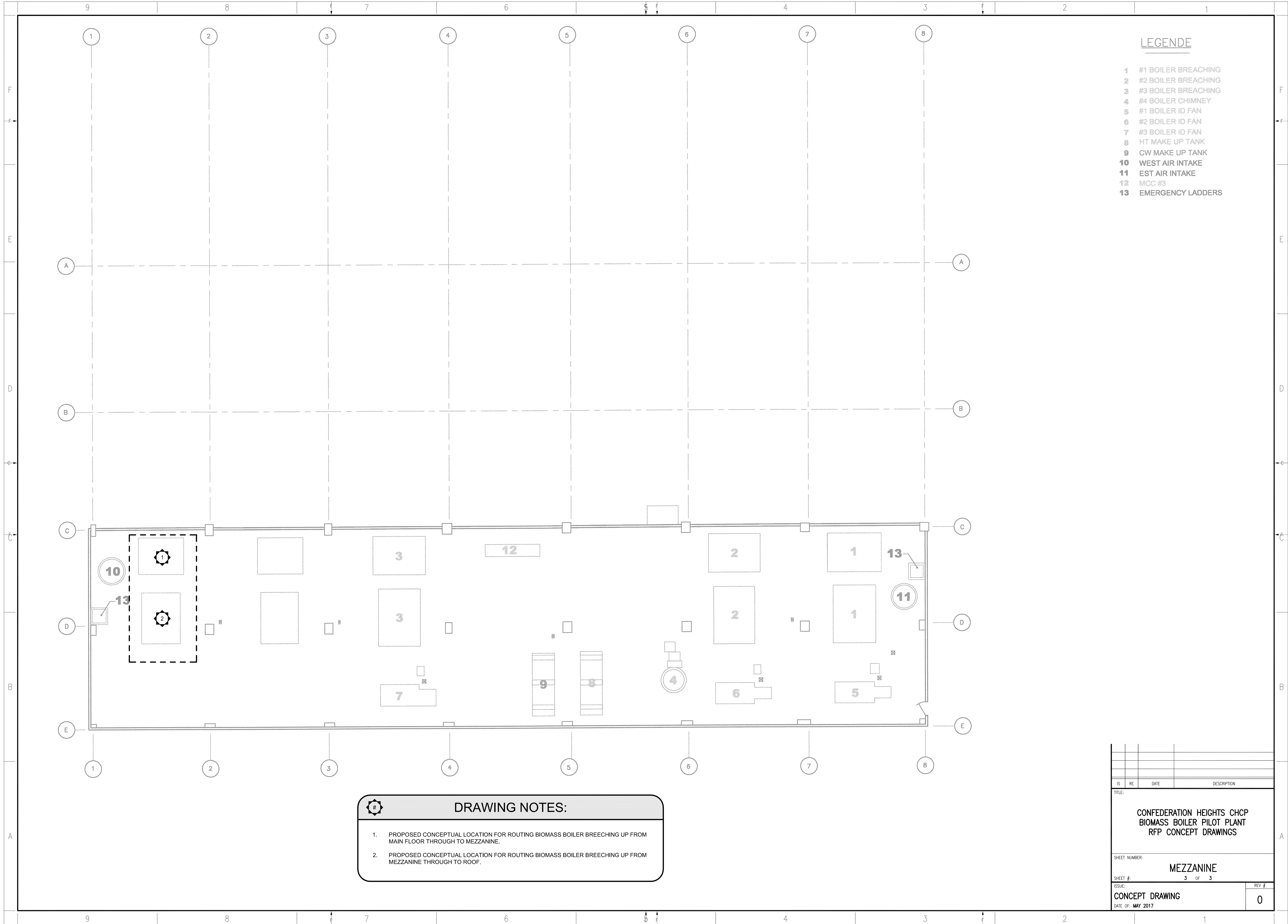

DRAWING NOTES:

1. PROPOSED CONCEPTUAL LOCATION FOR ROUTING BIOMASS BOILER BREECHING UP FROM MAIN FLOOR THROUGH TO MEZZANINE.
2. PROPOSED CONCEPTUAL LOCATION FOR ROUTING BIOMASS BOILER BREECHING UP FROM MEZZANINE THROUGH TO ROOF.

IS	RE	DATE	DESCRIPTION
TITLE:			
CONFEDERATION HEIGHTS CHCP BIOMASS BOILER PILOT PLANT RFP CONCEPT DRAWINGS			
SHEET NUMBER:			
MEZZANINE			
SHEET #:			REV #
CONCEPT DRAWING			0
DATE OF: MAY 2017			