



Public Works and
Government Services
Canada

Travaux publics et Services
Gouvernementaux
Canada

Pacific Region

TRANSPORT CANADA
VANCOUVER, BC

PORT HARDY AIRPORT
ODAL 29 FEEDER REPLACEMENT
PWGSC #R.083360.001

Public Works and
Government Services
Canada

REAL PROPERTY SERVICES
Pacific Region
SERVICES IMMOBILIERS
Région de Pacifique



CONSULTANT

ELECTRICAL ENGINEER:
WSP CANADA INC.

Drawing No.

Drawing Title

E00	TITLE SHEET
E01	ELECTRICAL KEY PLAN AND DETAILS
E02	PARTIAL SITE PLAN AND POWER HOUSE FLOOR PLAN

ABBREVIATIONS:

IPU - INTERRUPTIBLE POWER UNIT (GENERATOR)
ATS - AUTOMATIC TRANSFER SWITCH
AFLC - AIRFIELD LIGHTING CONTROL
ASLC - AIRFIELD SERIES LIGHTING CABLE
RPVC - RIGID POLY VINYL CHLORIDE
ODAL - OMNI DIRECTIONAL APPROACH LIGHTING
FRE - FIBREGLASS REINFORCED CONDUIT
PWR - POWER
COMM - COMMUNICATIONS
ATB - AIR TERMINAL BUILDING
FSS - FIELD SERVICE CENTRE
FEC - FIELD ELECTRICAL CENTRE
ASLC - AIRFIELD SERIES LIGHTING CABLE

4		
3		
2		
1		
0	ISSUED FOR TENDER	17/04/19

Revision/ Révision	Description/Description	Date/Date
-----------------------	-------------------------	-----------

Client/client

TRANSPORT CANADA
VANCOUVER, BC
800 BURNARD ST.

Project title/Titre du projet
PORT HARDY, BRITISH COLUMBIA
3675 BYNG ROAD

PORT HARDY AIRPORT
ODAL 29
FEEDER REPLACEMENT

Consultant Signature Only

Designed by/Concept par
John den Boer

Drawn by/Dessiné par
Paolo Parapan

PWGSC Project Manager/Administrateur de Projets TPSCG
Jimmy Wong

Regional Manager, Architectural and Engineering Services
Gestionnaire régionale, Services d'architectural et de génie, TPSCG

Drawing title/Titre du dessin

TITLE SHEET

Project No./No. du projet R.083360.001	Sheet/Feuille E00 OF 03	Revision no./ La Révision no. 0
--	-------------------------------	--

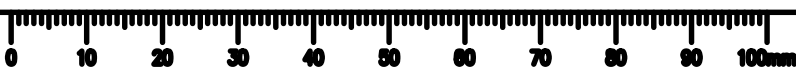

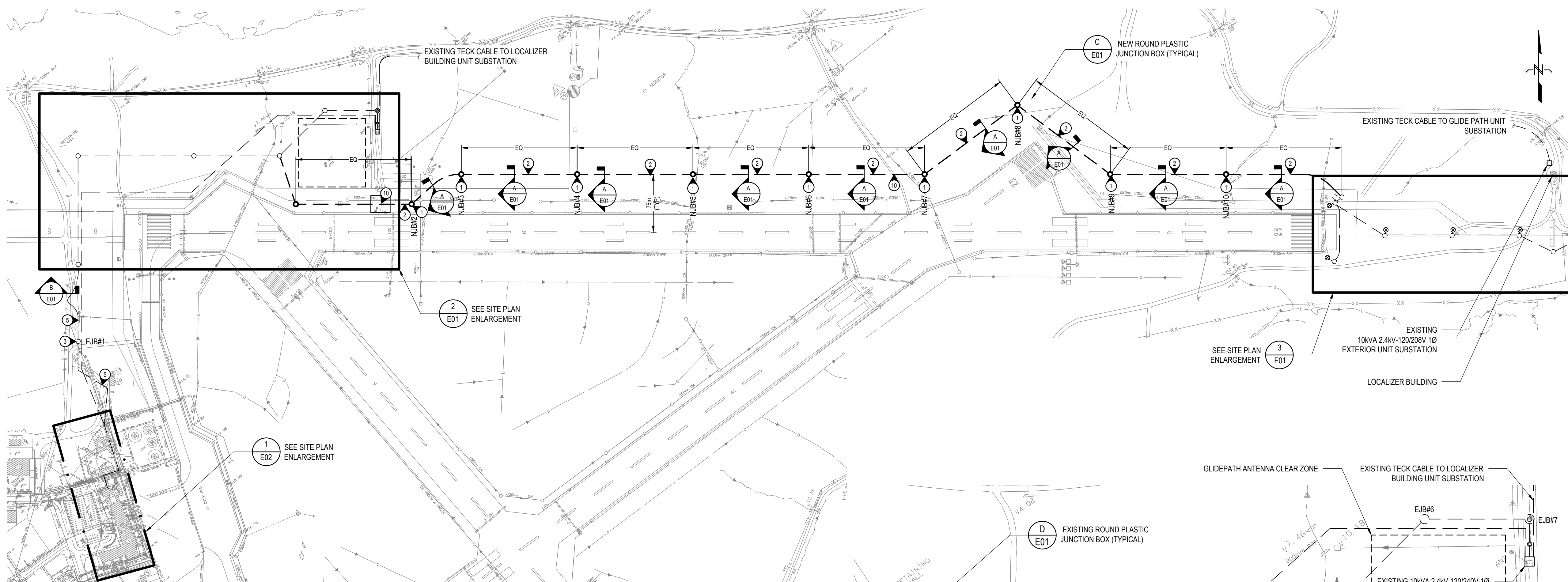

1
E01
ELECTRICAL SITE PLAN
SCALE 1:3000

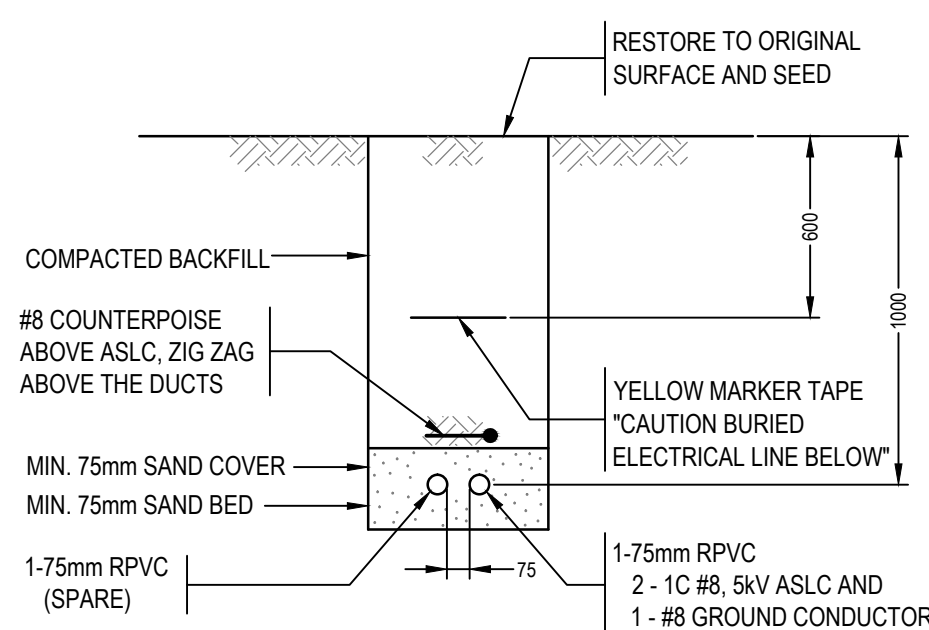

A
E01
NEW TRENCH DETAIL
N.T.S.

NOTES:

1. SAND BED AND COVER AS PER SPECIFICATIONS.
2. COMPACTION AS PER SPECIFICATIONS.
3. TRENCH WIDTH AS REQUIRED.

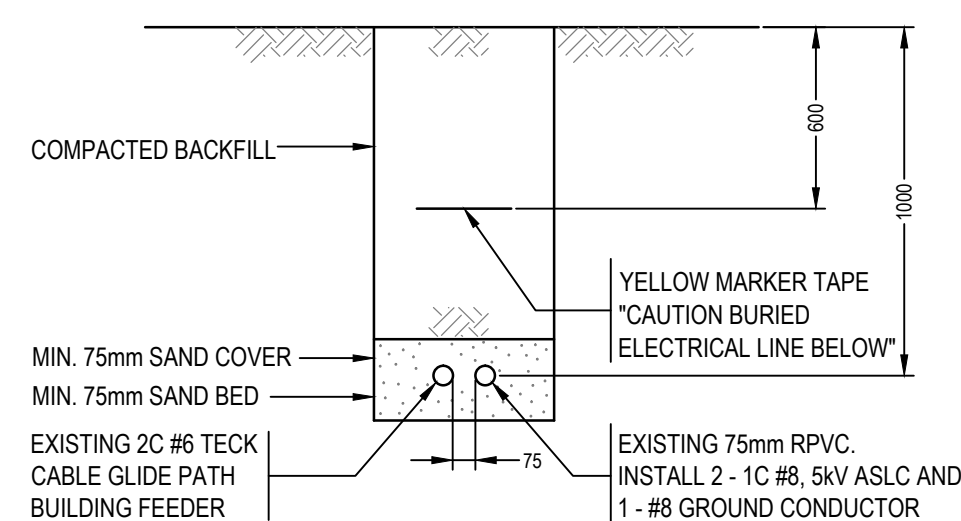

B
E01
EXISTING TRENCH DETAIL
N.T.S.

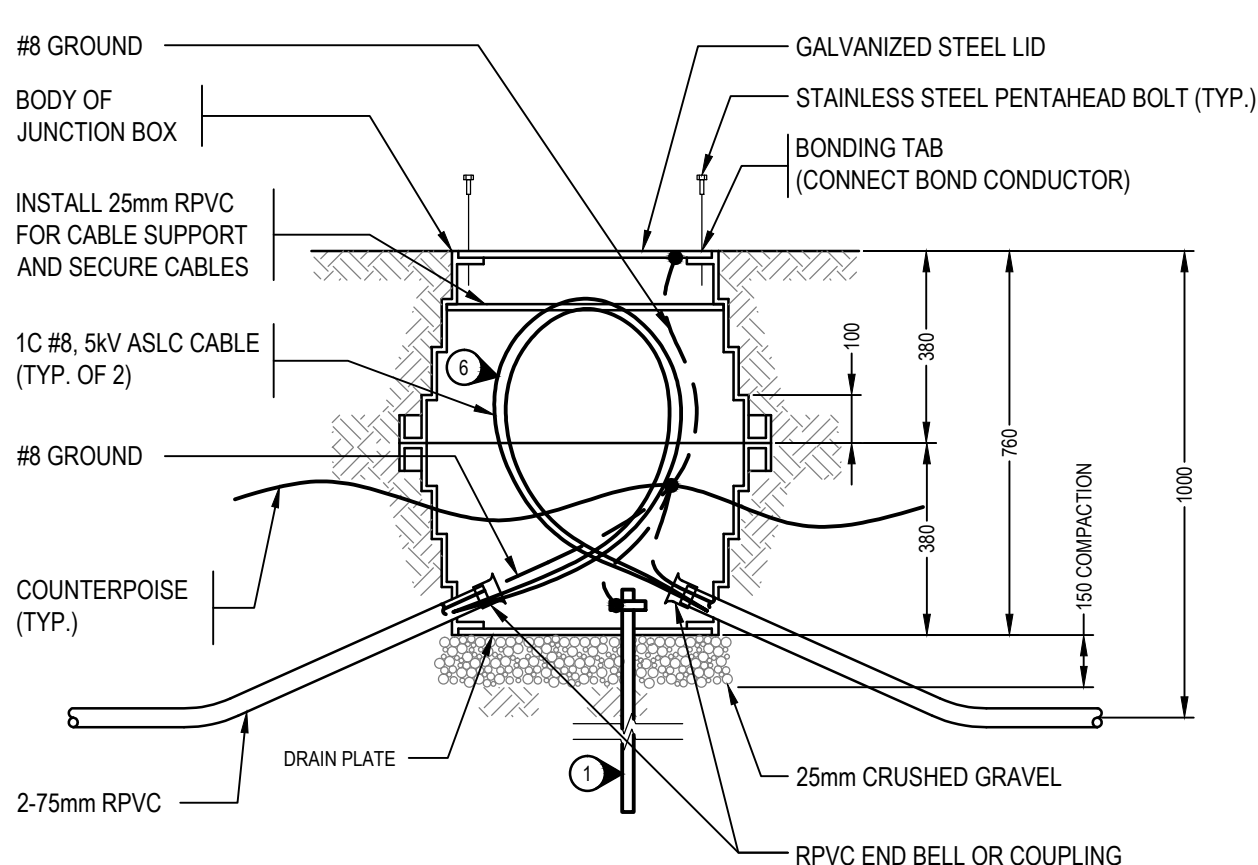

C
E01
NEW ROUND PLASTIC JUNCTION BOX - SIDE VIEW
N.T.S.

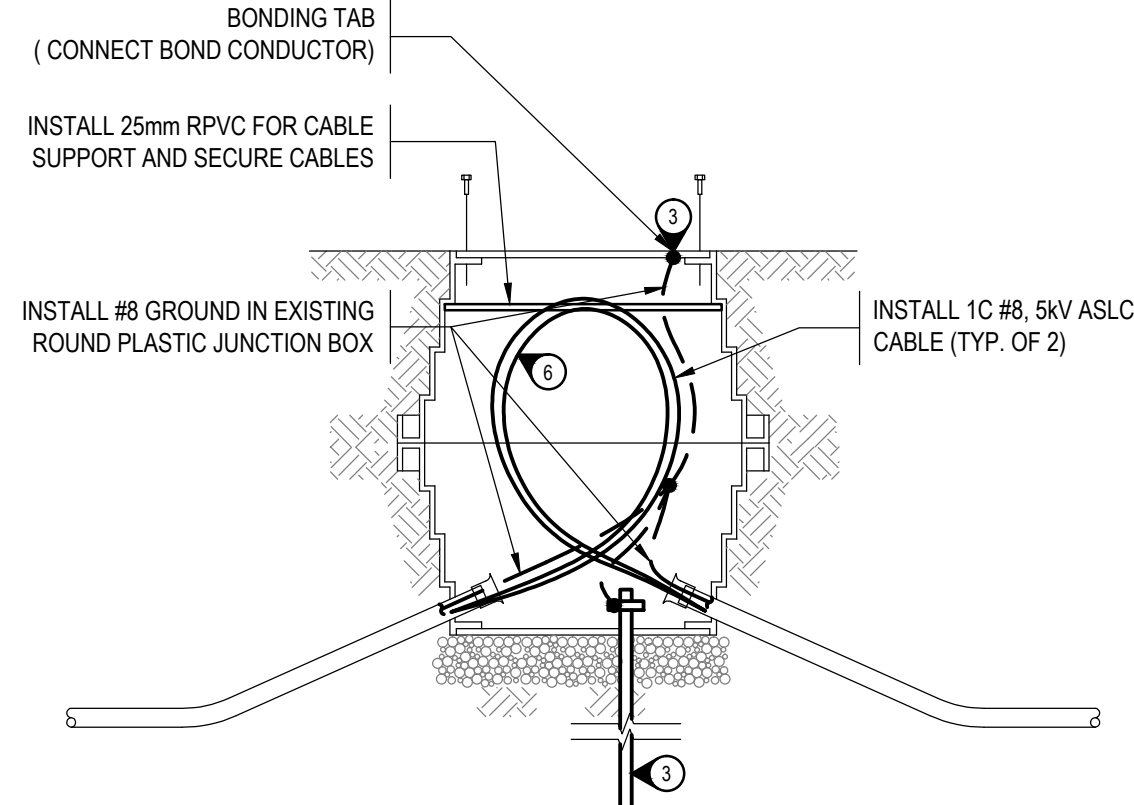

D
E01
EXISTING ROUND PLASTIC JUNCTION BOX - SIDE VIEW
N.T.S.

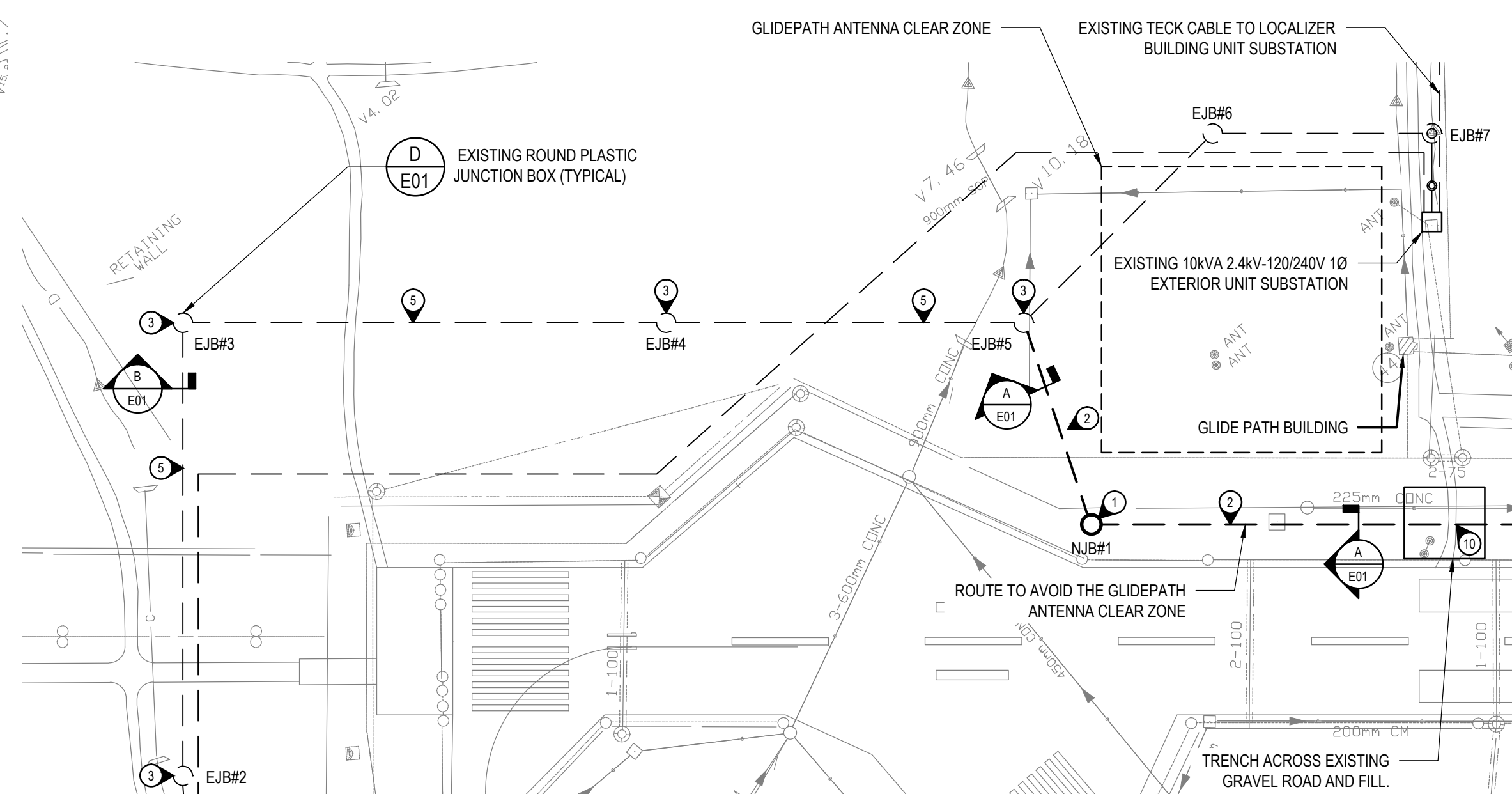

2
E01
ENLARGED SITE PLAN
SCALE 1:1500

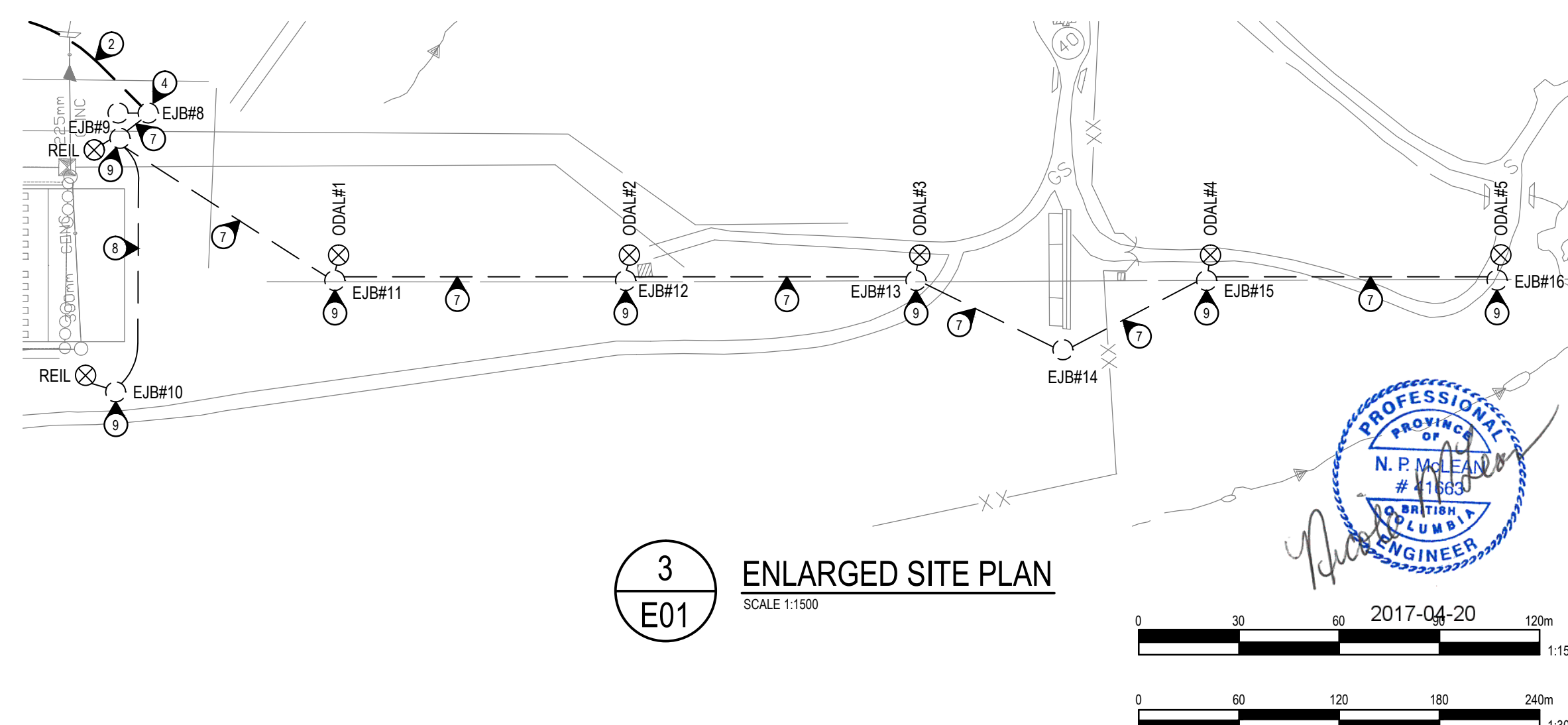

3
E01
ENLARGED SITE PLAN
SCALE 1:1500

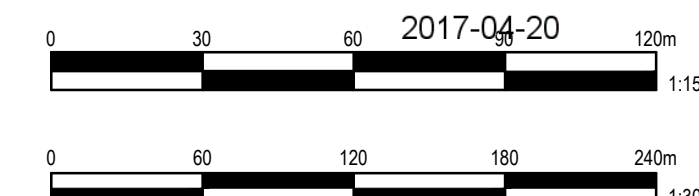

LEGEND:

- NEW JUNCTION BOX #1 (NJB#1)
- EXISTING JUNCTION BOX #1 (EJB#1)

KEYNOTES:

1. NEW ROUND PLASTIC JUNCTION BOX. INSTALL NEW 19mmØ X 3m COPPER CLAD GROUND ROD AND CONNECT TO GROUND CONDUCTOR
2. 1-75mm RPVC
2-1C #8, 5kV ASLC AND
1-#8 GROUND CONDUCTOR
1-75mm RPVC
(SPARE) - INSTALL PULL CORD
3. EXISTING JUNCTION BOX. BOND EXISTING JUNCTION BOX COVERPLATE. INSTALL NEW 19mmØ x 3m COPPER CLAD GROUND ROD AND CONNECT TO GROUND CONDUCTOR
4. CONNECT NEW CONDUIT TO EXISTING JUNCTION BOX.
5. EXISTING 1-75mm RPVC (EMPTY)
INSTALL
2-1C #8, 5kV ASLC AND
1-#8 GROUND CONDUCTOR
EXISTING 1-75mm RPVC
1-5kV TECK CABLE (GLIDE PATH FEEDER).
6. INSTALL PLASTIC LABEL (BLACK LETTERING WITH WHITE BACKGROUND) WRAPPED TO ALL CONDUCTORS WITHIN JB'S WITH WORDING "ODAL 29."
7. REPLACE EXISTING
2-1C #8 ASLC WITH NEW
2-1C #8 ASLC CABLE
8. REPLACE EXISTING
4-1C #8 ASLC WITH NEW
4-1C #8 ASLC CABLE
9. REPLACE EXISTING 300W ISOLATING TRANSFORMER WITH NEW. THE EXISTING PULLPITS ARE FILLED WITH SOLIDIFIED PROTEULATE POWDER. TAKE EXTREME CARE WHEN REMOVING TO ACCESS EXISTING ISOLATING TRANSFORMERS.
10. TRENCH ACROSS EXISTING MILLED ASPHALT ROAD. RESURFACE WITH WELL COMPACTED GRAVEL.

4		
3		
2		
1		
0	ISSUED FOR TENDER	17/04/19

Revision/	Description/Description	Date/Date
Client/client		

TRANSPORT CANADA
VANCOUVER, BC
800 BURNARD ST.

Project title/Titre du projet
PORT HARDY, BRITISH COLUMBIA
3675 BYNG ROAD

PORT HARDY AIRPORT
ODAL 29
FEEDER REPLACEMENT

Consultant Signature Only

Designed by/Concept par
John den Boer

Drawn by/Dessiné par
Paolo Parapan

PWGSC Project Manager/Administrateur de Projets TPSGC
Jimmy Wong

Regional Manager, Architectural and Engineering Services
Gestionnaire régionale, Services d'architectural et de génie, TPSGC

Drawing title/Titre du dessin

ELECTRICAL KEY
PLAN AND DETAILS

Project No./No. du
projet
R.083360.001

Sheet/Feuille
E01
OF 03

Revision no./
La Révision
no.
0

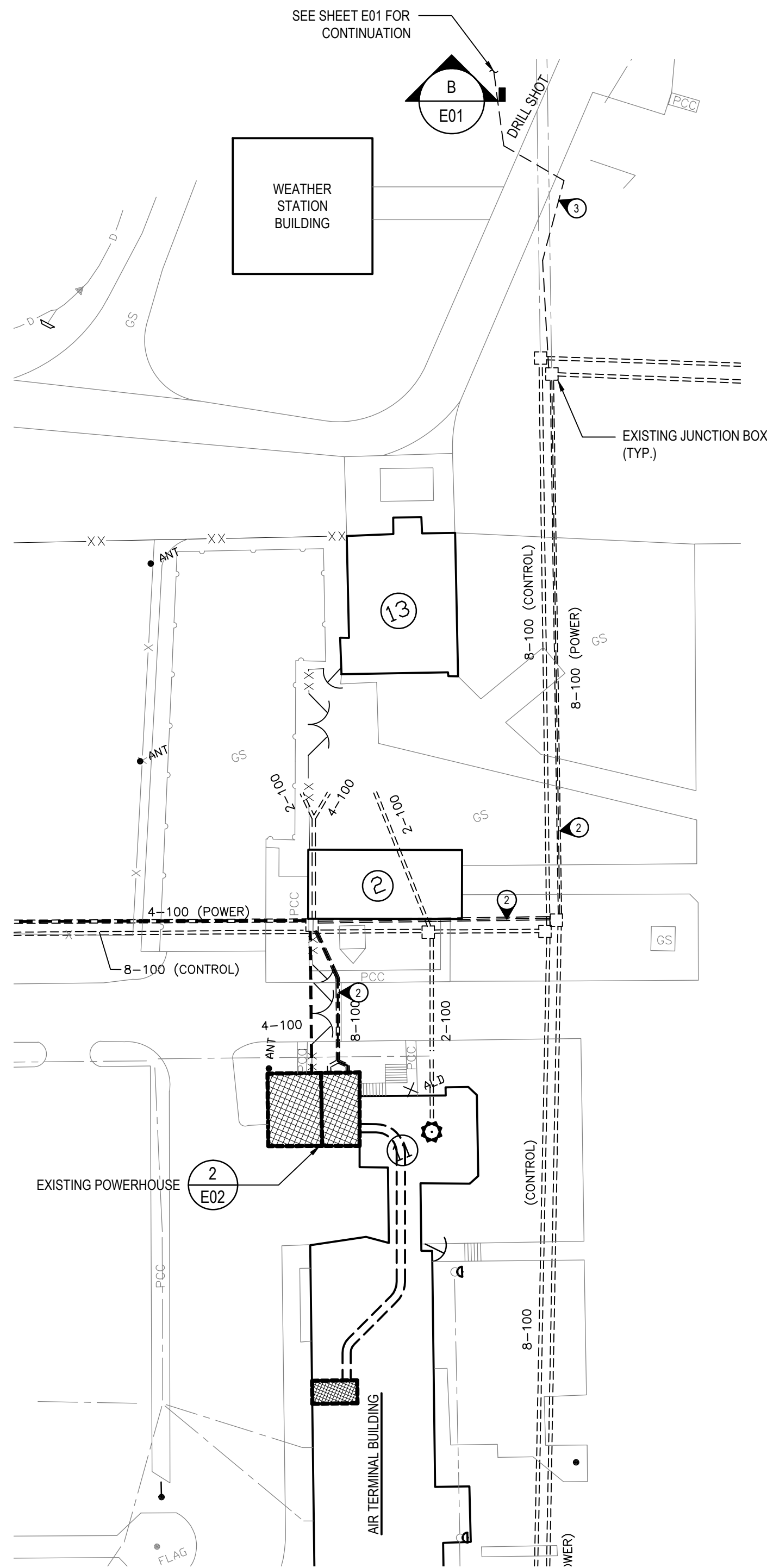

1
E02
SCALE 1:500

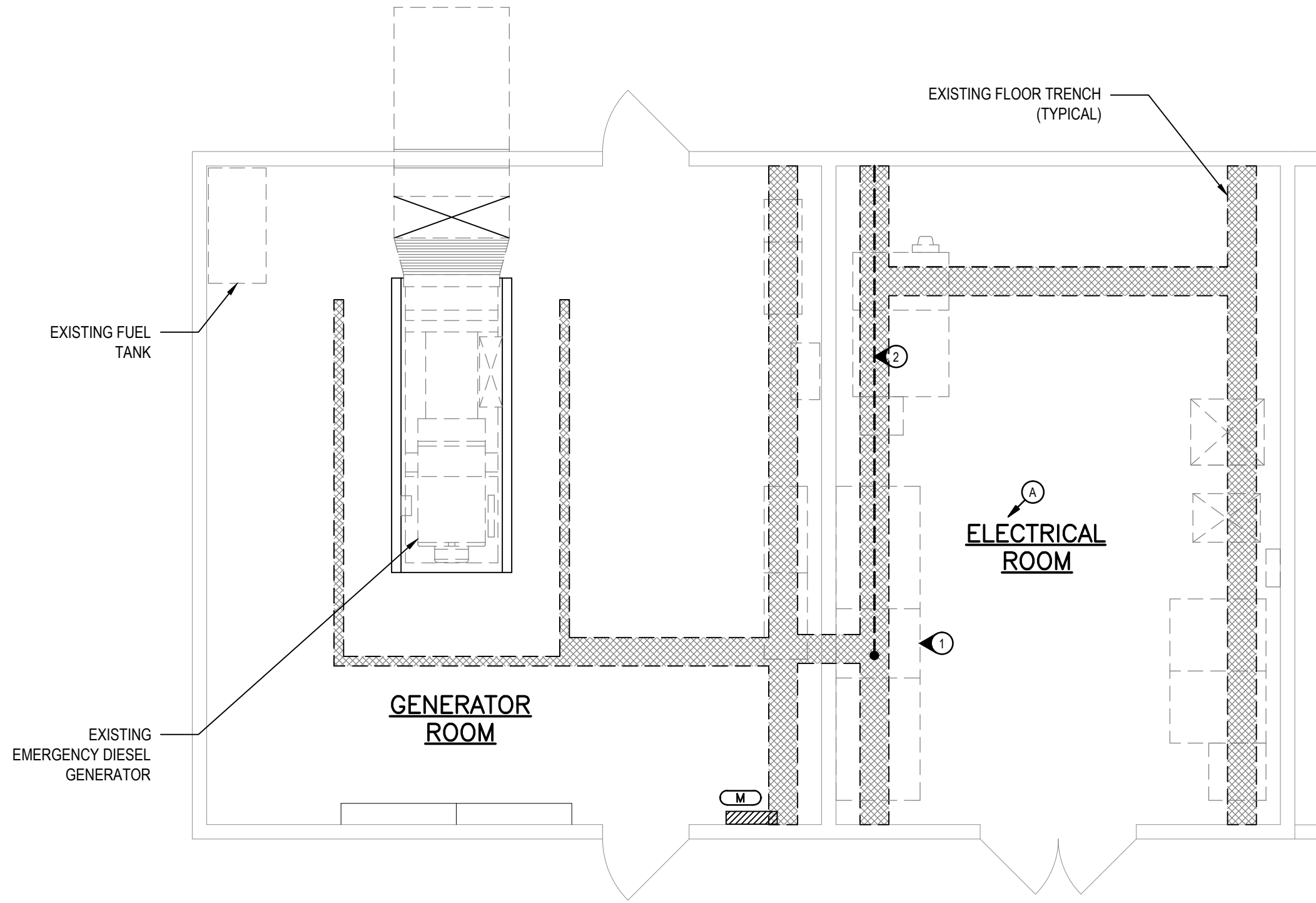

2
E02
SCALE 1:50



A
E02
N.T.S.

KEYNOTES:

- EXISTING ODAL 29 CONSTANT CURRENT REGULATOR.
 - REPLACE EXISTING 2 - 1C #8, 5KV ASLC AND 1 - #8 GROUND CONDUCTOR WITH NEW. REMOVE REDUNDANT CONDUCTORS.
 - INSTALL NEW 2 - 1C #8, 5KV ASLC AND 1 - #8 GROUND CONDUCTOR IN EXISTING SPARE 75mm RPVC.
 - DISCONNECT EXISTING 2-1C#8, 5KV ASLC CABLES AND 1-#8 GROUND CONDUCTOR. CONNECT NEW 2-1C#8, 5KV ASLC CABLES AND 1-#8 GROUND CONDUCTOR.
- NOTE:
NOTIFY AND RECEIVE APPROVAL FROM TRANSPORT CANADA 5 DAYS IN ADVANCE OF FEEDER TRANSFER.

GENERAL NOTES:

- PUMP OUT EXISTING JUNCTION BOXES AND MANHOLES OF WATER PRIOR TO ACCESS.
- COORDINATE ALL WORK WITHIN THE POWERHOUSE WITH OTHER TRADES WHICH MAY BE PERFORMING A SEISMIC UPGRADE AT THE TIME OF EXECUTING THIS CONTRACT.



LEGEND:

- A PHOTOGRAPH
1 KEYNOTE

4		
3		
2		
1		
0	ISSUED FOR TENDER	17/04/19

Revision/Revisión	Description/Description	Date/Date
Client/client		

TRANSPORT CANADA
VANCOUVER, BC
800 BURNARD ST.

Project title/Titre du projet
PORT HARDY, BRITISH COLUMBIA
3675 BYNG ROAD

PORT HARDY AIRPORT
ODAL 29
FEEDER REPLACEMENT

Consultant Signature Only

Designed by/Concept par
John den Boer

Drawn by/Dessiné par
Paolo Parapanan

PWSC Project Manager/Administrateur de Projets TPSGC
Jimmy Wong

Regional Manager, Architectural and Engineering Services
Gestionnaire régionale, Services d'architectural et de génie, TPSGC

Drawing title/Titre du dessin

PARTIAL SITE PLAN, POWER
HOUSE FLOOR PLAN AND
ELECTRICAL DETAILS

Project No./No. du projet	Sheet/Feuille	Revision no./La Révision no.
R.083360.001	E02 OF 03	0

