

32 5 9 FENDER (TYPE 1) CONNECTION ELEVATION  
SCALE: 1:20

NOTE:  
1) SALVAGED TIRE FENDERS TO BE PLACED ALONG NEW SSP WALL STARTING AT STATION 0+002 AND SPACED @ 4877mm C/C.

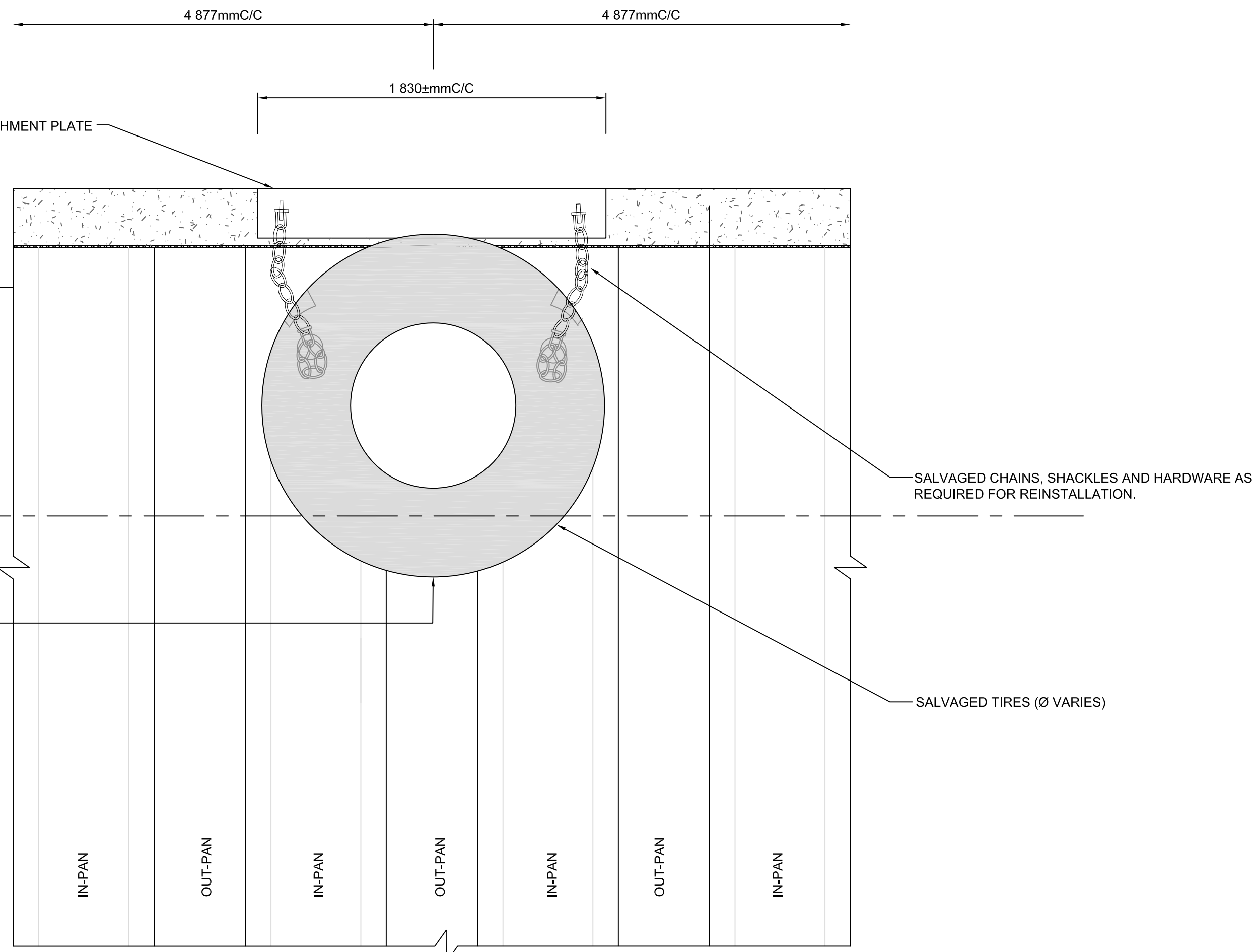

32 5 9 FENDER (TYPE 2) CONNECTION ELEVATION  
SCALE: 1:20

NOTE:  
1) SALVAGED TIRE FENDERS TO BE PLACED ALONG NEW SSP WALL STARTING AT STATION 0+002 AND SPACED @ 4877mm C/C.

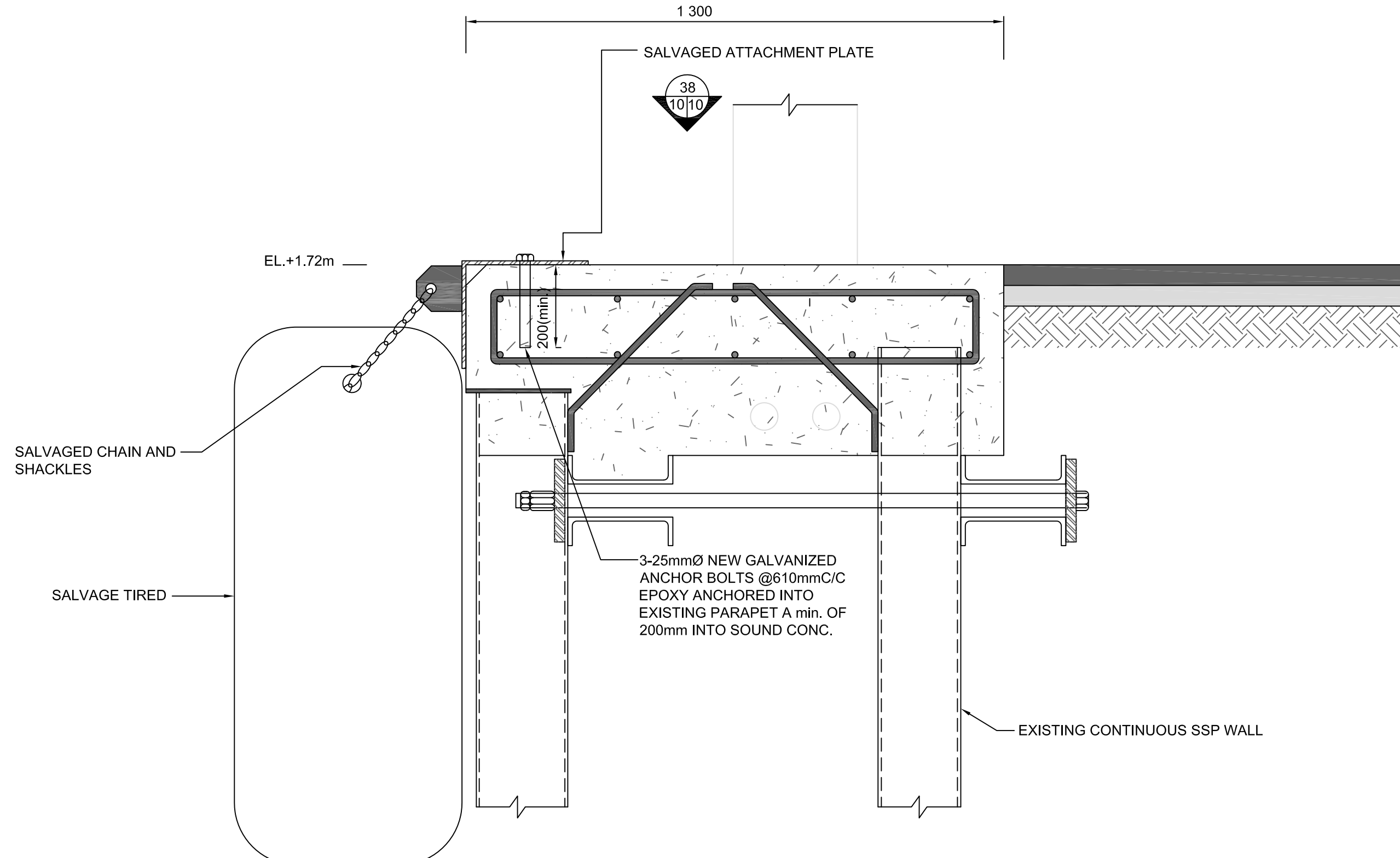

37 4 10 TYP. CONC. PARAPET DETAIL (0+000 TO 0+144.4) @ SSP OUT-PAN  
SCALE: 1:10

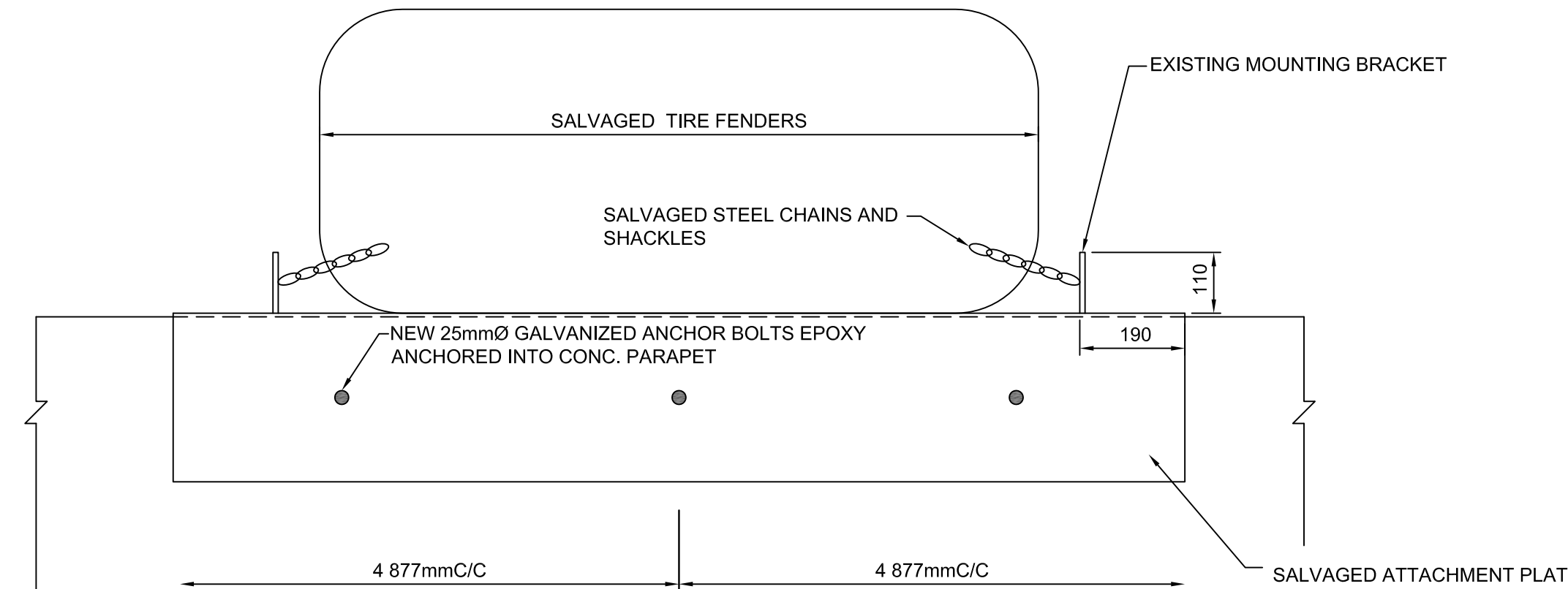

38 10 10 TYPE 3 FENDER REPAIR PLAN  
SCALE: 1:10

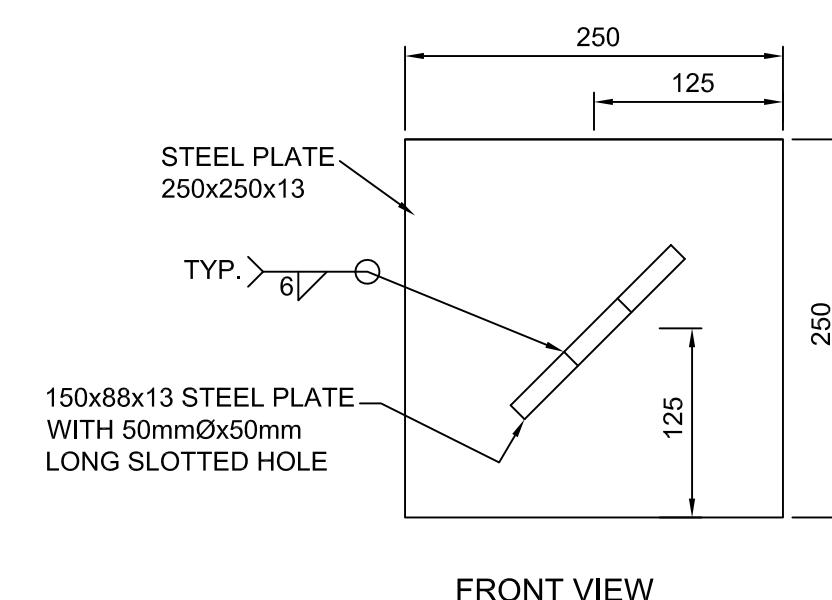

FRONT VIEW

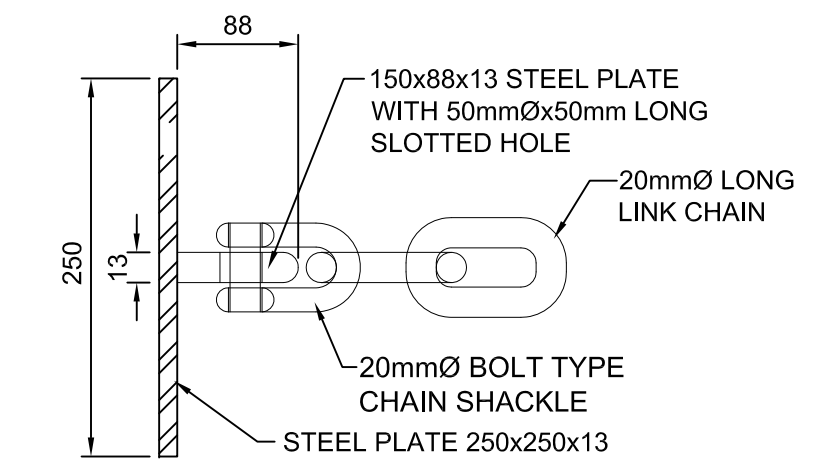

PLAN VIEW

NOTE:  
THIS FENDER BRACKET DETAIL IS DESIGNED BASED ON AN EXISTING SALVAGED CHAIN SIZE OF 20mmØ. IF THE EXISTING CHAIN SIZE IS DIFFERENT THAT 20mmØ CONTACT THE DESIGN ENGINEER FOR A REVISED DETAIL TO ACCOMMODATE THE EXISTING SALVAGED HARDWARE .

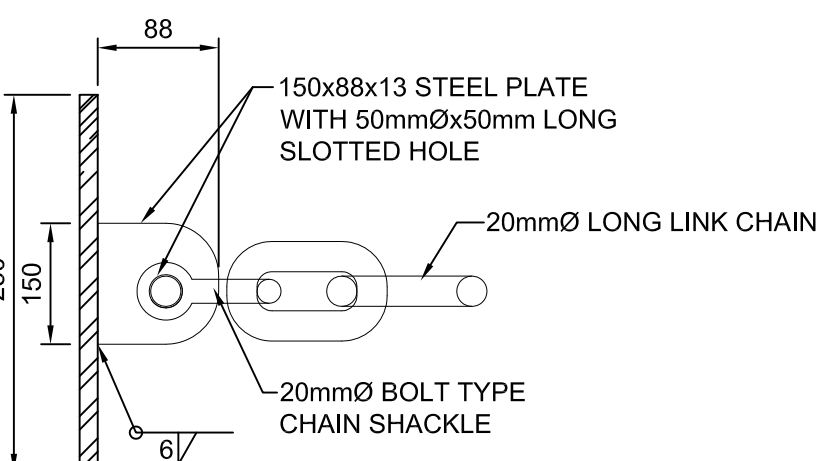

SIDE VIEW

36 10 10 NEW TIRE FENDER BRACKET DETAIL  
SCALE: 1:5

SMALL CRAFT HARBOURS  
CENTRAL AND ARCTIC REGION

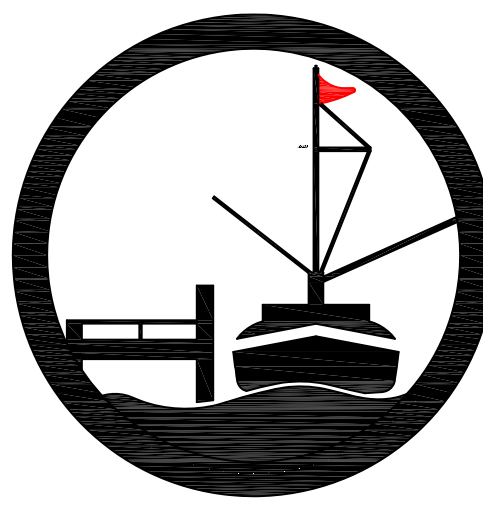

**RIGGS ENGINEERING**  
Riggs Engineering Ltd.  
1240 Commissioners Rd. W, Suite 205  
London, Ontario,  
N6K 1C7  
Tel: (519) 657-1040  
Fax: (519) 657 8631  
Website: [www.riggsengineering.com](http://www.riggsengineering.com)

- 1 Detail No.  
2 drawing no. - where detail required refers to MA--  
3 drawing no. - where detailed refers to MA--

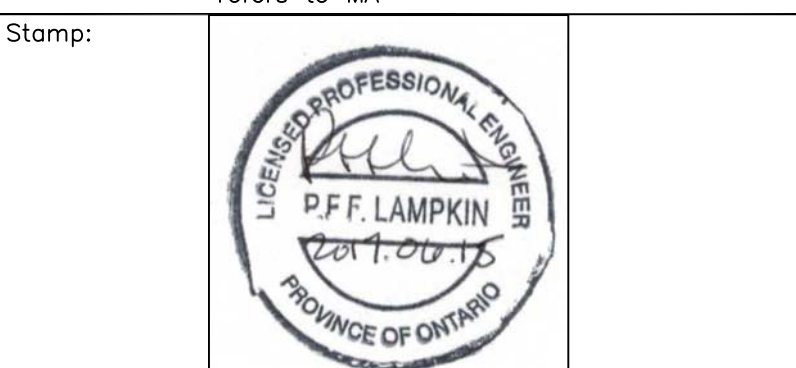

REVISIONS:		DATE:
1	ISSUED FOR TENDER	JUNE/23/2017

SCALE: AS NOTED  
CLASS:

PROJECT:  
  
2017 EAST HARBOUR WALL REPAIRS

DESCRIPTION:  
  
TYP. DETAILS

DRAWN: AV	APPROVED: PL
DATE: 2017-03-31	DATE: 2017-03-31

LOCATION:  
  
WHEATLEY, ONTARIO

DRAWING NO.: MA-10	LOCATOR CODE: F2930-160026
--------------------	----------------------------