

SMALL CRAFT HARBOURS
CENTRAL AND ARCTIC REGION

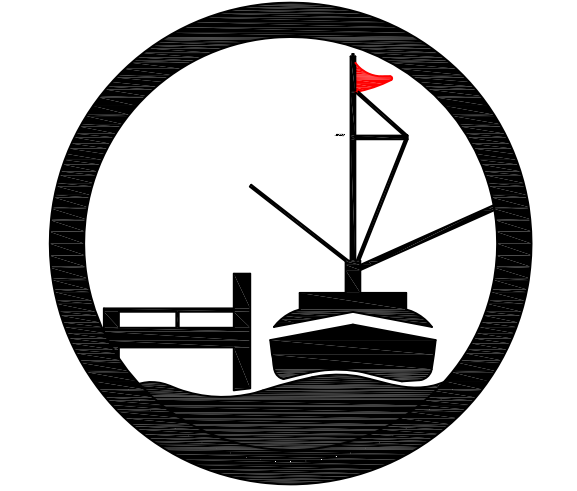

RIGGS
ENGINEERING
Riggs Engineering Ltd.
1240 Commissioners Rd. W, Suite 205
London, Ontario,
N6K 1C7
Tel: (519) 657-1040
Fax: (519) 657 8631
Website: www.riggsengineering.com

- 1 Detail No.
2 drawing no. — where detail required refers to MA—
3 drawing no. — where detailed refers to MA—

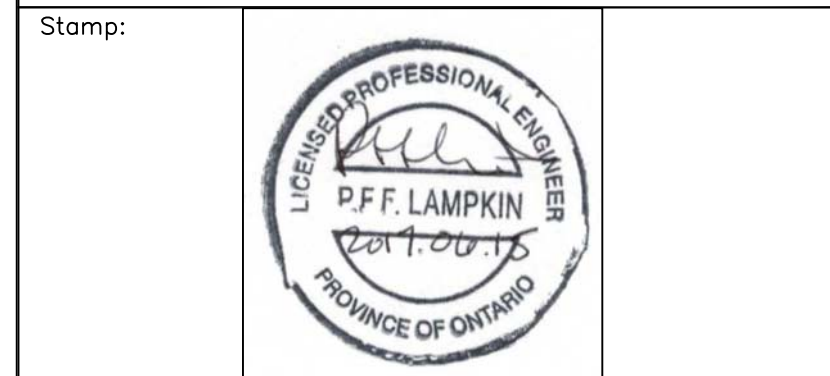

NOTES:

REVISIONS:	DATE:
1 ISSUED FOR TENDER	JUNE/23/2017

SCALE:	CLASS:
AS NOTED	

PROJECT:

2017 EAST HARBOUR WALL
REPAIRS

DESCRIPTION:

TYP. PAVING DETAILS

DRAWN:	APPROVED:
AV	PL
DATE:	DATE:
2017-03-31	2017-03-31

LOCATION:

WHEATLEY, ONTARIO

DRAWING NO.:	LOCATOR CODE:
MA-11	F2930-160026

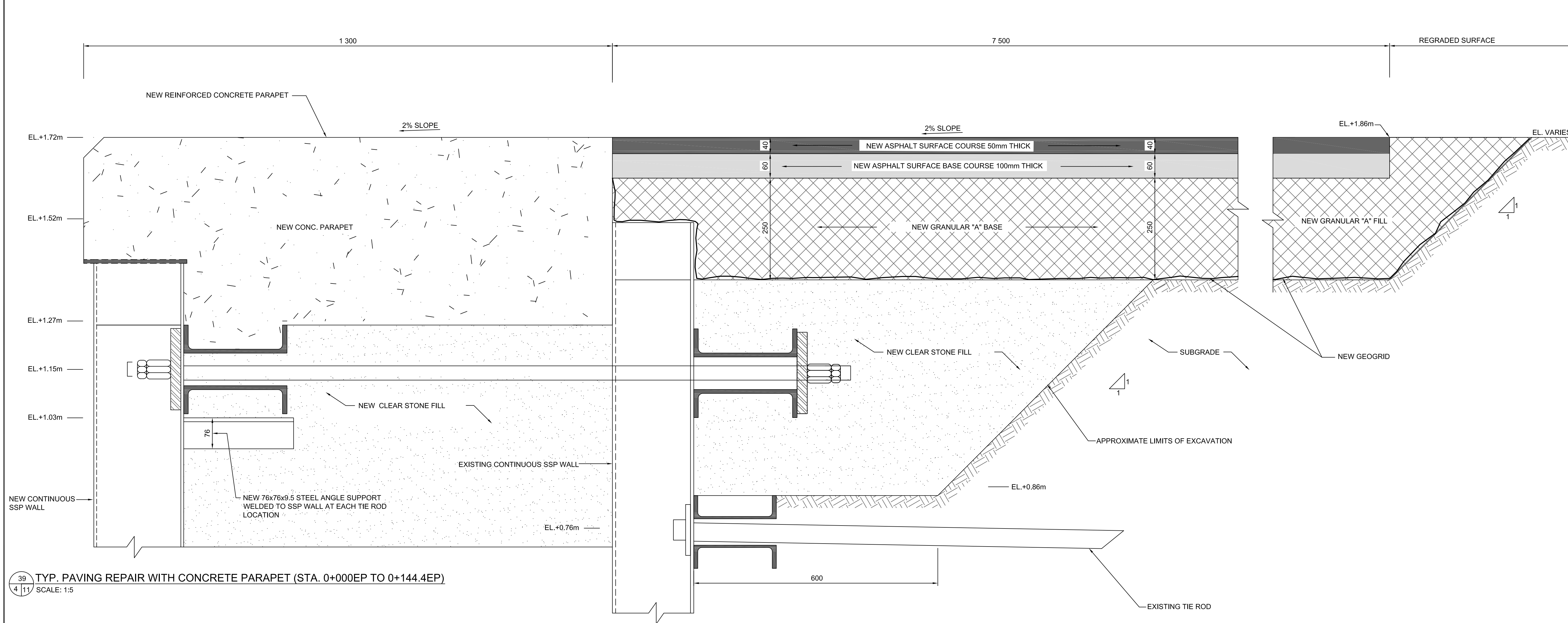

39 TYP. PAVING REPAIR WITH CONCRETE PARAPET (STA. 0+000EP TO 0+144.4EP)
4 11 SCALE: 1:5

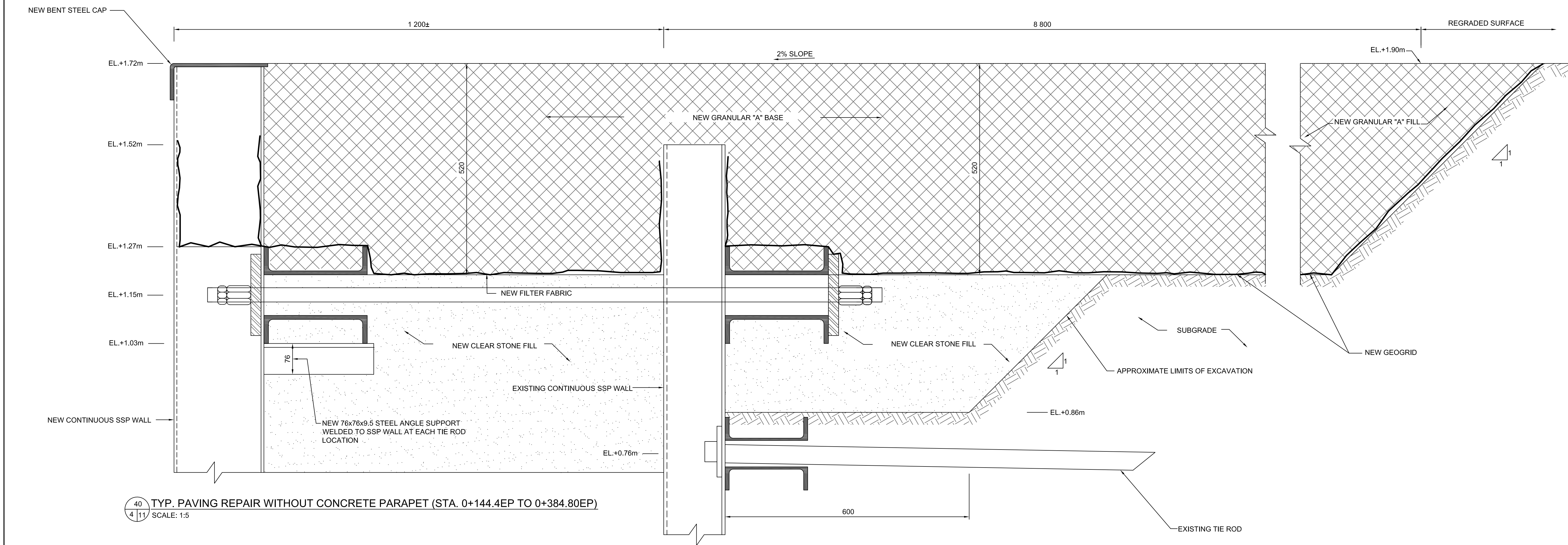

40 TYP. PAVING REPAIR WITHOUT CONCRETE PARAPET (STA. 0+144.4EP TO 0+384.80EP)
4 11 SCALE: 1:5