

**NATIONAL CAPITAL COMMISSION
COMMISSION DE LA CAPITALE NATIONALE**

REQUEST FOR PROPOSAL

Goods - Fabrication of permanent exterior interpretation display bases - Garden of the Provinces and Territories, Ottawa

Page 1 of 3

NCC TENDER FILE #

AL1710

<p>ADDRESS INQUIRIES TO: Allan Lapensée, Sr. Contract Officer allan.lapensee@ncc-ccn.ca</p>	<p>BID CLOSING/CLÔTURE DE L'OFFRE: August 11, 2017 at 3pm EDT</p>
<p>Submit to: → National Capital Commission Procurement Services 40 Elgin Street 2nd floor Security Centre Ottawa, ON K1P 1C7 Reference tender file #AL1710</p>	

ADDENDUM ACKNOWLEDGEMENT: I/We acknowledge receipt of the following addenda

(Bidder to enter number of addenda issued, if any) and have included for the requirement of it/them in my/our tendered price.

<p>We hereby OFFER to sell and/or supply to the National Capital Commission upon the terms and conditions set out herein, the goods and/or services listed and on any attached sheets at the submitted price(s).</p>		
<p>Supplier's Name & Address:</p>	<p>Print Name:</p>	<p>Date:</p>
<p>Tel: Fax: Email:</p>	<p>Signature:</p>	

REQUEST FOR PROPOSAL

Goods - Fabrication of permanent exterior interpretation display bases - Garden of the Provinces and Territories, Ottawa

Page 2 of 3

NCC TENDER FILE #:

AL1710

1. Submit a completed/signed page 1 of these RFP instructions, four (4) duplicate copies of your technical proposal and one price envelope to supply & deliver goods for the National Capital Commission (referred to as the "Commission" or the "NCC") according to the Statement of Work document attached herewith. You may submit your proposal in English or French.
2. Enquiries regarding this bid solicitation must be submitted in writing to the following: Sr. Contract Officer, Allan Lapensée e-mail address – allan.lapensee@ncc-ccn.ca as early as possible within the solicitation period. Enquiries should be received no later than seven (7) calendar days prior to the date set for solicitation closing to allow sufficient time to provide a response. Enquiries received after that time may result in an answer not being provided. To ensure consistency and quality of the information provided to Bidders, the Sr. Contract Officer shall examine the content of the enquiry and shall decide whether or not to issue an amendment. All enquiries and other communications related to this tender sent throughout the solicitation period are to be directed ONLY to the Sr. Contract Officer named above. Non-compliance with this requirement during the solicitation period can, for that reason alone, result in disqualification of a tender.
3. The technical proposal is to include all information as stated in the Mandatory & Rated Requirements of the Statement of Work.
4. The fee proposal (see 4.3 Pricing Matrix in the Statement of Work) must be in a sealed envelope and submitted separately from the proposal documents.
5. The selection of the successful bidder shall be made on the basis of technical merit and price. All mandatory requirements must be met and proposals obtaining a total minimum score of 70 pts out of 100 pts (70%) of the technical component will be considered as technically admissible. Fee proposal (see 4.3 Pricing Matrix in the Statement of Work) must be submitted in a separate sealed envelope and will be opened only for all technically admissible proposals. The fee proposal will be weighed with the technical evaluation score for the basis of award. The fee proposal considered in the evaluation of proposals must include all costs for the fabrication & delivery FOB destination and other related expenses and disbursements. The selected proposal will be the one that presents the highest overall value between technical and price. The overall best value will be based on a weighted factor of 60% for technical and a weighted factor of 40% for price including taxes.
6. A debriefing of a Bidder's Technical Proposal will be provided, if requested to the NCC's Project Manager identified in the letter of notification of contract award, within 15 days of receipt of this notice. The debriefing will include an outline of the reasons the submission was not successful.
7. Page 1 of this RFP document is to be dated, signed, and returned. By doing so, the bidder acknowledges having read, understood and accepted the Request for Proposal which includes the Statement of Work, the General Terms & Conditions for Goods, and any/all other attachments or addenda to the Request for Proposal documents.
8. The NCC is a Federal Crown Corporation subject to the Federal Goods and Services Tax (GST), the Ontario Harmonized Sales Tax (OHST), and the Quebec Sales Tax (QST). The successful firm will be required to indicate separately, with the request for payment, the amount of GST, OHST and QST, to the extent applicable, that the Commission will pay. These amounts will be paid to the successful Contractor who will be required to make the appropriate remittances to Revenue Canada and the respective provincial governments.

REQUEST FOR PROPOSAL

Goods - Fabrication of permanent exterior interpretation display bases - Garden of the Provinces and Territories, Ottawa

Page 3 of 3

NCC TENDER FILE #:

AL1710

9. The attached General Terms & Conditions for Goods will also form part of the resulting contract.
10. In order to avoid any misunderstanding and be fair to all firms, please note that proposals received after the closing time and date will not be accepted.
11. The Commission reserves the right to not accept the lowest or any of the proposals submitted, to cancel the Request for Proposal, and/or to reissue the Request for Proposal in its original or revised form. The Commission also reserves the right to negotiate with the successful bidder and/or any/all bidders.
12. Facsimile transmittal of proposals will not be accepted.
13. Proposals will be held in the strictest confidence. There will not be a public opening of the proposals submitted for this Request for Proposal. Notwithstanding the foregoing, bidders are advised that as a Crown Corporation, the Commission is subject to the provisions of the *Access to Information Act*. Information submitted by third parties will only be exempted from disclosure if the records or part of them qualify for an exemption under the *Access to Information Act*.
14. The substantive requirements of the laws of the Province of Ontario shall apply to the Subject Matter, subject to any applicable federal laws.
15. The Commission shall not be obligated to reimburse or compensate any bidder, its sub-contractors or manufacturers for any costs incurred in connection with the preparation of a response to this Request for Proposal. All copies of proposals submitted in response to this Request for Proposal shall become the property of the Commission and will not be returned.
16. This Request for Proposal and all supporting documentation have been prepared by the Commission and remain the sole property of the Commission, Ottawa, Canada. The information is provided to the bidder solely for its use in connection with the preparation of a response to this Request for Proposal and shall be considered to be the proprietary and confidential information of the Commission. These documents are not to be reproduced, copied, loaned or otherwise disclosed directly or indirectly, to any third party except those of its employees having a need to know for the preparation of the Contractor's response, and the Contractor further agrees not to use them for any purpose other than that for which they are specifically furnished.
17. The successful Contractor shall indemnify and save harmless the Commission from and against all claims, damages, costs and expenses sustained or incurred by the Commission resulting from any action or legal proceeding on infringement, made, sustained, brought, prosecuted, threatened to brought or prosecuted, by any person that was under the direction and control of the Contractor during the term of the resulting contract and which person is claiming or claims a moral right, as set out under the Copyright Act. The obligation to indemnify under this clause survives termination of the resulting contract and will remain in force for the duration of the copyright in the work created under the resulting contract. This obligation to indemnify relative to alleged moral rights infringement(s) is in addition to the Contractor's other obligations to indemnify and save harmless which are set out in the Commission's General Conditions.

GOODS CONTRACTS

General Conditions

1. This order, including these general terms and conditions, forms the entire contract between the Commission and the contractor and no variation thereof, irrespective of the wording or terms of the contractor's acceptance, will be effective unless specifically agreed to in writing by the Commission. No local, general or trade customs shall be deemed to vary the terms thereof. Where the context requires, the word "goods" is to be read as including services.
2. Goods will be received by the Commission subject to final inspection and acceptance by the consignee, specified in this order and if not so specified, by any person authorized by the Commission. Goods found to be defective or not in compliance with the specifications may be returned to the contractor at the contractor's expense.
3. In supplement of and not by way of substitution for the terms of the specifications or any warranty stipulated or implied by law and notwithstanding prior acceptance by the Commission the contractor shall at any time within its standard warranty period, at its own expense replace any goods which are or become defective as a result of faulty or inefficient manufacture, materials or workmanship. The contractor shall state its standard warranty period and related terms and conditions at the time of delivery.
4. The contractor warrants that it has the right to use and sell any patented devices or parts used in the goods purchases and agrees to indemnify the Commission against any claims for royalties, license fees and other claims or demands by reason of the use or sale thereof, whether or not any such devices or parts are specified by the Commission or used by the contractor in the goods purchases without such specifications.
5. The goods shall be at the risk of the contractor who shall bear all loss or damage, from whatsoever cause arising which may occur to the goods, or any part thereof, until delivered to the Commission. The Commission reserves the right to change the place of delivery at any time prior to the actual shipment provided that the contractor shall be entitled to be reimbursed for any actual increased costs, or shall reduce the prices to the extent of any decrease cost arising out of such change.
6. Goods must be new and unused unless specified otherwise herein and delivered strictly in accordance with the quantities, specifications, terms and conditions of this order. Time shall be of the essence of this order.
7. The charges are F.O.B. destination and include all charges for packing, loading, unloading and transportation unless otherwise specified herein. Should the contractor prepay transportation charges which are payable by the Commission under the terms of this contract these charges are to be shown as a separate item on the invoice.
8. If carload shipment, shipping notices must be sent immediately to the Commission showing car number, initial and routing. Car service will be deducted from all cars that reach the Commission without shipping notice.
9.
 - i) The Chairman may, by giving notice to the Contractor, terminate or suspend the goods/services to be supplied with respect to all or any part or parts not completed/received.
 - ii) All goods/services completed/received by the Contractor to the satisfaction of the commission before the giving of such notice shall be paid for by the Commission in accordance with the provisions of the contract and, for all goods/services not completed/received before the giving of such notice, the Commission shall pay the Contractor's costs as determined under the provisions of the contract and, in addition, an amount representing a fair and reasonable fee in respect of such goods/services.

GOODS CONTRACTS
General Conditions

- iii) The Commission reserves the right to cancel or purchase elsewhere, any portion of this order that is not delivered by the date required by this order.

- 10. Unless otherwise specified in this order, payment will only be made in Canadian funds within 30 days following presentation of invoices or progress claims forms or within 30 days of delivery of the goods, whichever is later. Discounts will be calculated from the date when both the goods and acceptable invoices or progress claims forms are received by the Commission.

- 11. The total dollar amount shown on this order is final and unless otherwise specified herein includes all applicable Taxes (GST and PST) and duties.

- 12. No member of the House of Commons of Canada shall be admitted to any share or part of this contract or any benefits to arise therefrom.

- 13. This agreement shall ensure to the benefit of, and shall be binding upon the successors and assigns of the Commission and the contractor respectively, provided that the contractor shall not assign this agreement or any part of the development without prior written consent of the Commission, and any assignment made without such consent shall be of no effect.

- 14. All specifications, drawings, samples, patterns and dies furnished to the contractor by the Commission for use in respect of the order shall be deemed to be owned by the Commission and shall be returned to the Commission at the expense of the contractor when required.

- 15. WHMIS Regulations apply to Controlled Products.

Supplier No. / N° du fournisseur

New supplier / Nouveau fournisseur Update / Mise à jour

**SUPPLIER-DIRECT DEPOSIT PAYMENT AND TAX INFORMATION FORM
FOURNISSEUR-FORMULAIRE DE PAIEMENT PAR DÉPÔT DIRECT ET RENSEIGNEMENTS AUX FINS DE L'IMPÔT**

For NCC use only / À l'usage de la CCN seulement

PART 'A' - IDENTIFICATION / PARTIE 'A' - IDENTIFICATION

Legal name of entity or individual / Nom légal de l'entité ou du particulier	Operating name of entity or individual (if different from Legal Name) / Nom commercial de l'entité ou du particulier (s'il diffère du nom légal)
--	--

Former Public Servant in receipt of a PSSA Pension / Ancien fonctionnaire qui reçoit une pension en vertu de la LPPF	<input type="checkbox"/> Yes / Oui	<input type="checkbox"/> No / Non
An entity, incorporated or sole proprietorship, which was created by a Former Public Servant in receipt of a PSSA pension or a partnership made of former public servants in receipt of PSSA pension or where the affected individual has a controlling or major interest in the entity. / Une entité, constituée en société ou à propriétaire unique, créée par un ancien fonctionnaire touchant une pension en vertu de la LPPF, ou un partenariat formé d'anciens fonctionnaires touchant une pension en vertu de la LPPF, où les entités dans lesquelles ils détiennent le contrôle ou un intérêt majoritaire.	<input type="checkbox"/> Yes / Oui	<input type="checkbox"/> No / Non

Address / Adresse	Telephone No. / N° de téléphone :	Fax No. / N° de télécopieur :
Postal code / Code postal	()	()

**PART 'B' - STATUS OF SUPPLIER / PARTIE 'B' - STATUT DU FOURNISSEUR
IMPORTANT : CHOOSE ONLY ONE OF THE FOLLOWING/CHOISIR SEULEMENT UNE DES OPTIONS SUIVANTES:**

(1) Sole proprietor / Propriétaire unique <input type="checkbox"/>	If sole proprietor, provide: / Si propriétaire unique, indiquez :	Last Name / Nom de famille	First name / Prénom	Initial / Initiale
(2) Partnership / Société de personnes <input type="checkbox"/>	(3) Corporation / Société <input type="checkbox"/>			

Business No. (BN) / N° de l'entreprise (NE) -	OR / OU	SIN / NAS -
---	----------------	-------------

GST/HST / TPS et TVH	QST / TVQ (Québec)
Number / Numéro : Not registered / non inscrit <input type="checkbox"/>	Number / Numéro : Not registered / non inscrit <input type="checkbox"/>

Type of contract / Genre de contrat	Contract for services only / Contrat de services seulement <input type="checkbox"/>	Contract for mixed goods & services / Contrat de biens et services <input type="checkbox"/>	Contract for goods only / Contrat de biens seulement <input type="checkbox"/>
Type of goods and/or services offered / Genre de biens et / ou services rendus :			

PART 'C' - FINANCIAL INSTITUTION / PARTIE 'C' - RENSEIGNEMENTS SUR L'INSTITUTION FINANCIÈRE

Please send a void cheque with this form / Veuillez, s.v.p., envoyer un spécimen de chèque avec ce formulaire

Branch Number / N° de la succursale	Institution No. / N° de l'institution :	Account No. / N° de compte :
Institution name / Nom de l'institution :	Address / Adresse :	Postal Code / Code postal :

PART 'D' - DIRECT DEPOSIT PAYMENT NOTIFICATION / PARTIE 'D' - AVIS DE PAIEMENT PAR DÉPÔT DIRECT

E-mail address / Adresse courriel :

PART 'E' - EMAIL ADDRESS TO SEND CONTRACTS / PARTIE 'E' - ADRESSE COURRIEL POUR ENVOYER LES CONTRATS

E-mail address / Adresse courriel :

PART 'F' - CERTIFICATION / PARTIE 'F' - CERTIFICATION

I certify that I have examined the information provided above and it is correct and complete, and fully discloses the identification of this supplier.	Je déclare avoir examiné les renseignements susmentionnés et j'atteste qu'ils sont exacts et constituent une description complète, claire et véridique de l'identité de ce fournisseur.		
Where the supplier identified on this form completes part C, he hereby requests and authorizes the National Capital Commission to directly deposit into the bank account identified in part C, all amounts payable to the supplier.	Lorsque le fournisseur indiqué sur ce formulaire remplit la partie C, par la présente, il demande et autorise la Commission de la capitale nationale à déposer directement dans le compte bancaire indiqué à la partie C, tous les montants qui lui sont dus.		
Name of authorized person / Nom de la personne autorisée	Title / Titre	Signature	Date
Telephone number of contact person / Numéro de téléphone de la personne ressource : ()			

IMPORTANT

Please fill in and return to the National Capital Commission with one of your business cheque unsigned and marked « VOID » (for verification purposes).	Veillez remplir ce formulaire et le retourner à la Commission de la capitale nationale avec un spécimen de chèque de votre entreprise non signé et portant la mention « ANNULÉ » (à des fins de vérification).
Mail or fax to: Procurement Services National Capital Commission 202-40 Elgin Street Ottawa, ON K1P 1C7 Fax: (613) 239-5007	Poster ou télécopier à : Services de l'approvisionnement Commission de la capitale nationale 40, rue Elgin, pièce 202 Ottawa (Ontario) K1P 1C7 Télécopieur : (613) 239-5007

SUPPLIER – DIRECT DEPOSIT PAYMENT AND TAX INFORMATION FORM

FOURNISSEUR – FORMULAIRE DE PAIEMENT PAR DÉPÔT DIRECT ET RENSEIGNEMENTS AUX FINS DE L'IMPÔT

Supplier Tax Information

Pursuant to paragraph 221(1) (d) of the *Income Tax Act*, NCC must declare form T-1204, contractual payments of government for services, all payments made to suppliers during the calendar year in accordance to related service contracts (including contracts for mixed goods and services).

The paragraph 237(1) of the *Income Tax Act* and the article 235 of the Income Tax Regulations require the supplier to provide all necessary information below to the organization who prepares the fiscal information forms.

Questions: Sylvie Monette, Accounts Payable Supervisor
(613) 239-5678 ext. 5156 or sylvie.monette@ncc-ccn.ca

Direct deposit payment information

All amounts payable by NCC to the supplier will be deposited directly into the account you identified in part C. A NCC payment advice notice will also be sent to you by e-mail detailing the particularities of the payment to the address identified in part D.

Until we process your completed form, we will still pay you by check.

You must notify the NCC of any changes to your financial institution, branch or account number. You will then have to complete a new form.

The account you identified has to hold Canadian funds at a financial institution in Canada.

The advantages of direct deposit payment

Direct deposit payment is a convenient, dependable, safe and timesaving way to receive your invoice payment. Direct deposit payment is completely confidential.

There are fewer risks of direct deposit payment being lost, stolen, or damaged as may happen with cheques.

Funds made by direct deposit payment will be available in your bank account on the same day that we would have mailed your cheque.

Renseignements sur les fournisseurs aux fins de l'impôt

En vertu de l'alinéa 221(1) (d) de la *Loi de l'impôt sur le revenu*, la CCN est tenu de déclarer, à l'aide du formulaire T-1204, Paiements contractuels de services du gouvernement, tous paiements versés aux fournisseurs pendant une année civile en vertu de marchés de services pertinents (y compris les marchés composés à la fois de biens et de services).

Le paragraphe 237 (1) de la *Loi de l'impôt sur le revenu* et l'article 235 du Règlement de l'impôt sur le revenu obligent les fournisseurs à fournir toutes les informations demandées ci-dessous à l'organisme qui prépare les formulaires de renseignements fiscaux.

Questions : Sylvie Monette, Superviseure aux comptes payable
(613) 239-5678 poste 5156 ou sylvie.monette@ncc-ccn.ca

Renseignements sur le paiement par dépôt direct

Tous les montants versés par la CCN au fournisseur seront déposés directement dans le compte identifié à la partie C. Un avis de paiement de la CCN détaillant les particularités du paiement par dépôt direct vous sera envoyé par courriel à l'adresse courriel identifiée à la partie D.

Nous continuerons à vous payer par chèque jusqu'à ce que nous ayons traité votre formulaire.

Vous devez aviser la CCN de tout changement d'institution financière, de succursale ou de numéro de compte. Vous devrez donc remplir un nouveau formulaire.

Le compte que vous désignez doit être un compte en monnaie canadienne, détenu dans une institution financière au Canada.

Avantages du paiement par dépôt direct

Le paiement par dépôt direct est une méthode pratique, fiable et sécuritaire, qui permet de gagner du temps dans la réception de vos paiements de factures. Le paiement par dépôt direct est entièrement confidentiel.

Avec les paiements par dépôt direct, il y a moins de risques de perte, de vol ou de dommage, comme cela peut se produire dans le cas des chèques.

Les paiements effectués par paiement par dépôt direct sont versés dans votre compte le jour même où nous aurions posté votre chèque.

STATEMENT OF WORK

Specifications for the fabrication of permanent exterior interpretation display bases

Garden of the Provinces and Territories, Ottawa

June 29, 2017

TABLE OF CONTENTS

1	INTRODUCTION.....	3
1.1	PROJECT DESCRIPTION.....	3
1.2	BACKGROUND	3
1.3	OBJECTIVE.....	3
1.4	OPPORTUNITY	3
1.5	COMPLETION DATE.....	3
2	DEFINITION OF TERMS	4
3	PROJECT REQUIREMENTS	5
3.1	MANDATORY REQUIREMENT.....	5
3.2	RATED REQUIREMENTS.....	5
4	SCOPE OF WORK.....	6
4.1	FUNCTIONAL EXPERTISE	6
4.2	DELIVERABLES	7
4.3	PRICING MATRIX	7
4.4	PROJECT MANAGEMENT.....	7
4.5	DESCRIPTION OF WORK	8
4.6	LOCATION OF WORK	8
5	EVALUATION AND BASIS OF AWARD.....	8
6	SCHEDULE.....	9
7	EXECUTION OF CONTRACT	9
7.1	SUCCESSFUL CONTRACTOR'S RESPONSIBILITIES	9
7.2	SERVICES TO BE PROVIDED BY THE NCC.....	10
8	QUALITY MANAGEMENT	10
8.1	SYSTEM DESCRIPTION AND SPECIFICATIONS PACKAGE	10
8.2	QUALITY ASSURANCE MONITORING & AUDITS	10
8.3	QUALITY CONTROL OF FABRICATION AND INSTALLATIONS	11
8.4	WARRANTY STATEMENTS.....	11
9	CONTACT INFORMATION.....	12
9.1	CONTRACTING AUTHORITY DURING TENDER PERIOD.....	12
9.2	PROJECT MANAGER ONCE CONTRACT IS AWARDED	12
9.3	PROJECT COORDINATOR AND DESIGN DEVELOPMENT ONCE CONTRACT IS AWARDED	13
10	APPENDICES.....	13

1 INTRODUCTION

1.1 Project description

The National Capital Commission (NCC) wishes to engage the services of an experienced manufacturer of permanent exterior interpretation display bases with significant expertise in product development, processing sheet metal, metal parts fabrication, welded assemblies and finishing for the Garden of the Provinces and Territories located in Ottawa, Ontario.

Unless otherwise specified, this project will include project management, finalizing the development of permanent exterior interpretation display bases as well as the complete fabrication, finishing and delivery of the permanent exterior display bases.

1.2 Background

This project is part of the rehabilitation and enhancement of plantings at the Garden of the Provinces and Territories and corresponds to the objectives of the NCC Capital Floral Vision (2009) as well as the sustainability objectives of the NCC's environmental strategy.

1.3 Objective

This initiative is meant to create a floral experience of national significance in the hearth of the national capital.

1.4 Opportunity

As part of a proposed interpretation and information program, opportunities have been identified to highlight the plant selection, planting design, site architecture and landscape.

1.5 Completion Date

Permanent exterior interpretation display bases shall be completed by the September 30th, 2017 and delivered to the site for installation by the landscaping contractor. The NCC will confirm the delivery date two (2) weeks prior to installation.

2 Definition of Terms

For the purpose of this Tender the following terms within this document will be defined as follows:

Wherever the terms “**or equal**”, or “**approved equivalent**” appear after specific types of materials and items throughout this specification, they shall be interpreted to mean as being equal in the opinion of the Design Manager, in material content, workmanship and quality to that designated as being the minimum acceptable standard, and that written approval must be obtained from the Design Manager prior to submitting an alternative, five (5) days before close of tender.

Contracting Authority refers to that person designated by the NCC to coordinate all matters pertaining to contract administration.

Control sample refers to the approved samples of work from the successful Tenderer, which is retained for comparison purposes as part of the Quality Assurance procedure.

Design Manager refers to that person designated by the NCC to act as liaison between itself and the successful Tenderer and to coordinate the administration of the program of work.

Invitation to Tender refers to this entire package of information which specifies the terms and conditions and also provides the specifications of the signs that are required.

Portfolio Manager refers to the NCC employee responsible for the tactical management of NCC lands which are organized into separate geographical regions or portfolios.

Successful contractor refers to the Tenderer who is awarded the resulting contract and who is responsible for all its agents, carriers, representatives, sub-contractors and all others involved in providing the specified work.

Tender refers to the offer of a bid for this contract and supplemental mandatory information submitted by a Tenderer in response to the Invitation to Tender issued by the NCC.

Tenderer refers to a contractor who puts forth or submits a Tender.

3 Project Requirements

3.1 Mandatory Requirement

The tenderer must clearly demonstrate his expertise in project management, product development, processing sheet metal, metal parts fabrication, welded assemblies and finishing of permanent exterior interpretation display bases by meeting the following mandatory requirements:

- The tenderer must have a minimum of three (3) years' experience providing similar work. The information must be submitted by filling out the mandatory requirement form provided in Appendices A.
- The tenderer must provide three (3) project examples on paper of similar function, complexity and manufacturing process implemented in the last five (5) years, including description, pictures after implementation, client name and contact information and year of implementation for references.

The tenderer must also assign all of the following qualified personnel to the project and provide personal resumes and professional certifications as well as the paint and finishing sub-contractor's personnel resumes and certifications, if paint and finishing is sub-contracted. In order to qualify:

- a certified structural or mechanical engineer must be appointed as project manager;
- an industrial design technologist must be appointed for 3D CAD modeling and technical drawing tasks;
- Canadian certified machinists and welders must be appointed to the project;
- A Qualified Painter or Paint and Finishing sub-contractor.

3.2 Rated Requirements

RATED REQUIREMENTS		Points Allotted
1	<p>Tenderer's experience in providing similar work within the past ten (10) years. Points awarded:</p> <p>Three (3) years' experience and under = 0 pts From Three (3) to five (5) years' experience = 20 pts From five (5) to eight (8) years' experience = 30 pts Eight (8) years' experience and over = 40 pts</p>	/40

2	<p>Project examples implemented in the last five (5) years, of similar function, complexity and manufacturing process, including client's name, address and contact for referencing. Points awarded:</p> <p>No good examples of projects = 0pts One (1) good example of projects = 20pts Two (2) good examples of projects = 40pts Three (3) good examples of projects = 60pts</p>	/60
Total		/100

4 SCOPE OF WORK

The resulting contract will include the project management, the development, the fabrication, the finishing, temporary storage, the packing and delivery of the permanent exterior display bases described in the technical drawings and notes provided in Appendices B and C.

4.1 Functional expertise

The following functional expertise is required to successfully execute the scope of work:

- Project management, development and production coordination
- Structural engineering
- 3D CAD modeling and Technical Drafting
- processing sheet metal, metal parts fabrication, welded assemblies and finishing
- Quality Control

4.2 Deliverables

Deliverables for the work identified in this tender is comprised of all of the following items:

- Meeting notes
- Project schedule
- As built technical drawing of all parts, sub-assemblies and assemblies including views, sections, dimensions, welding and finishing specifications, tolerances, in both official languages in PDF format
- Up to three (3) color paint samples, including primer and finish, painted on a 100mm x 150mm metal sheet and delivery costs to NCC headquarters
- Display bases fully finished and ready for installation, four (4) total:
 - Three (3) as per drawing IP04 in Appendices
 - One (1) as per drawing IP05 in Appendices
- Protective wrapping and packaging of displays for storage, handling and transportation
- Warranty statement

4.3 Pricing Matrix

Description	All-inclusive Lump Sum Price (excluding taxes)
Project management and coordination including delivery	\$
Design development including deliverables	\$
Fabrication and Finishing	\$
Packing, Storage and delivery to Garden of the Provinces and Territories (Ottawa, Ontario)	\$
HST	\$
TOTAL PRICE	\$

4.4 Project management

The successful contractor is expected to assign an experienced project manager who will be a single point of contact for the contract. This individual must be fully aware of all aspects of the contract and is responsible to ensure that all project tasks are sequenced and scheduled to ensure final delivery as per approved schedule, on budget and of highest quality fit and finish.

This project manager is expected to proactively anticipate project challenges and to provide recommendations to mitigate challenges that may arise. It is expected that

the assigned project manager will frequently communicate with the NCC Design Manager and will constantly monitor and communicate project progress verbally and in writing.

Any proposed schedule modifications, change orders and/or actions that may have an impact on product quality must be requested in writing to the NCC manager and must receive written approval from the NCC before they are adopted.

The contractor's project manager will be expected to review all the fabrication drawings, parts, assemblies and finishes of deliverables and develop a comprehensive work schedule ensuring that all required materials, sub-contracted services, fabrication and delivery can be completed while respecting the NCC's quality standards and project milestones.

4.5 Description of work

Tenderer must refer himself to Appendices B and C for the description of work.

4.6 Location of work

All meetings will be held in the National Capital Region. Start-up meeting will be held at NCC's headquarters at 40 Elgin Street, Ottawa, Ontario. Up to three (3) other meetings during the project at development fabrication and finishing phases are to be organized by the successful contractor's project manager.

No travel time, travel or accommodation fees will be paid for this project.

5 EVALUATION AND BASIS OF AWARD

The evaluation process will involve two stages, as followed:

- a) The **first stage** is an assessment of the technical proposal by the NCC of the capabilities and qualifications of the proponent and proposed personnel including project examples and client references. All proposals shall be evaluated and rated according to the evaluation criteria and rated requirements described at paragraph 3.2. The technical evaluation is based on a total of 100 points. The minimum required is 70 points. The score will then be converted in percentage. Only the financial proposals of the proponents that qualify at the technical proposal stage (i.e. 70% or over), shall be opened.

- b) The **second stage** will consist of an assessment of the proponent's fee proposal. The lowest overall fee will receive 40 points, the maximum score a proponent can achieve under the Fee Proposal evaluation. Other overall fee proposal will be awarded points on a proportional basis.

This will be determined by a weight factor of **60 percent for the technical component and 40 percent for the price.**

6 SCHEDULE

It is a condition of this contract that the successful contractor must fabricate and ready for installation of the display bases identified herein before **September 30th, 2017.**

Payments are made net 30 days following the receipt of an acceptable invoice at payables@ncc-ccn.ca.

The NCC will hold back 10% of all invoices for all work until good are delivered, inspected and approved, and all ancillary deliverables have been received, including the commissioning items.

7 EXECUTION OF CONTRACT

7.1 Successful Contractor's Responsibilities

The successful contractor is expected to execute the tasks in this tender package with the utmost excellence and professionalism.

The successful contractor, by commencing the work identified herein assumes the overall responsibility to assure that all assemblies, components and parts shown or required comply with the supplied specifications.

All product and work is subject to NCC inspection and approval. Unacceptable product or workmanship and damage will not be accepted. Payment for the entire contract will be withheld until substandard issues are completed to the high standards expected.

The NCC will schedule inspections based on the successful contractor's schedule once approved by the NCC. The successful contractor will be required to provide an updated schedule to the Project Manager/Design Manager every week for the duration of the contract unless the latest schedule is being maintained.

The successful contractor is expected to maintain a well-organized project file and proactively provide the NCC Design Manager with copies of all receipts for materials procured in order to ensure that all specifications have been adhered to.

7.2 Services to be provided by the NCC

A representative of the NCC (Project or Design Manager) will provide liaison for all approvals and technical inquiries after the contract is awarded and for approvals of shop drawings (as required).

The NCC Design Manager, Project manager or the Portfolio Manager will provide final approval on fabrication drawings, paint samples and all fabricated and finished displays bases.

8 QUALITY MANAGEMENT

The overall quality of the permanent exterior display bases is the shared responsibility of the NCC and the successful contractor and is managed via a set of integrated procedures as follows:

- Description & Specifications package
- Quality Assurance monitoring & audits
- Fabrication inspections and approvals prior to finishing and following finishing
- Packing, Storage and delivery
- Warranty Statements

8.1 System Description and Specifications Package

Comprehensive documents describing the permanent exterior interpretation display bases have been made available as part of this contract. This document includes all required information for the development and fabrication as well as for their graphic panels and proper installation. It is the responsibility of the successful contractor to understand and adhere to the specifications contained therein.

The successful contractor must check and verify all dimensions and details on drawings before proceeding with the work. Any discrepancy between these drawings and specifications are to be promptly reported in writing to the NCC Design Manager.

8.2 Quality Assurance Monitoring & Audits

The NCC is, ultimately, responsible for ongoing quality assurance functions, either directly or through 3rd parties engaged by it to fulfill its obligations.

AUDITING: Throughout the various phases of the project, Quality Assurance Audits will be conducted by the NCC Design Manager, Portfolio Manager and/or a contracted representative of the NCC via both random and systematic sampling methods.

8.3 Quality Control of Fabrication and Installations

All quality control functions related to the design development, fabrication, manipulation, storage and transportation will be the responsibility of the successful contractor.

ADHERENCE TO SPECIFICATIONS: Responsibility for verification of adherence to the detailed specifications for fabrication of all parts, sub-assemblies and final assembly lies with the successful contractor. Prior to commencing fabrication, copies of official receipts for all materials must be made available to the NCC Design Manager to ensure that specified materials are being used.

DAMAGE PRIOR TO INSTALLATION: Any damage sustained before products are installed will be the responsibility of the successful contractor. Contractor is expected to fabricate and provide appropriate crates, palettes and protective covering while transporting both unfinished and finished materials.

DAMAGE DURING WARRANTY PERIOD: successful contractor shall not be held responsible for damage incurred to display bases as a result of vandalism or for abnormal or accidental abuse of the components occurring after the beginning of the guarantee period.

8.4 Warranty Statements

GUARANTEE OF WORKMANSHIP: The successful contractor shall guarantee their workmanship and material defects for a period of five (5) years after final acceptance of work and, at no additional cost, the successful contractor shall promptly repair or replace, to the NCC's satisfaction, any components thereof which in the opinion of the NCC are defective in materials or workmanship under normal operating conditions.

The Contractor shall provide in writing an extended warranty of 5 years on all finishes in accordance with the following requirements (see table below). This warranty will take effect following the acceptance and installation date of display bases. It is the contractor's responsibility to record the installation date of permanent exterior display bases and to submit a reference log to the NCC at the end of the contract. Should the installation date not be properly recorded, or in the case of any

disputes on the warranty start date, the date of the contract's Certificate of Final Completion will be assigned as start date.

Characteristic Covered	Warranty on finishes				
	1 st Year	2 nd Year	3 rd Year	4 th Year	5 th Year
Color retention	100%	100%	90%	70%	60%
Gloss retention	100%	100%	90%	70%	60%
Corrosion resistance	100%	100%	100%	90%	80%
Adherence	100%	100%	100%	80%	70%

Final coating system application must meet the following performance specification.

Salt spray	1500 hours	ASTM B-117
Humidity resistance	1500 hours	ASTM D-2247
Adherence		ASTM D-3359-4B
Hardness		ASTM D-3363- 2H
Impact	Direct 160 in.-lb	ASTM D-2794
Color retention		ASTM D-2244

9 CONTACT INFORMATION

9.1 Contracting Authority during tender period

Allan Lapensée
 Senior Contract Officer
 Finance and Procurement Services
 National Capital Commission
allan.lapensee@ncc-ccn.ca
 Tel. 613-239-5678 x 5051

9.2 Project Manager once contract is awarded

Sylvie Lagueux
 Senior Landscape Architect
 Design & Construction Branch (DC)
 National Capital Commission
sylvie.lagueux@ncc-ccn.ca
 Tel. 613-239-5678 x5076

9.3 Project coordinator and design development once contract is awarded

Steven Sdraulig
Senior Industrial Designer
Design & Construction Branch (DC)
National Capital Commission
steven.sdraulig@ncc-ccn.ca
Tel. 613-239-5678 x5480

10 APPENDICES

- A. Mandatory Requirement Form
- B. Garden of the Provinces and Territories, Interpretation panels - Structure and infrastructure Plans, 07-06-2017 Issue
- C. Technical Addendum 1 – Painting and Finishing

© NATIONAL CAPITAL COMMISSION (NCC). ALL RIGHTS RESERVED.
 THIS DOCUMENT CONTAINS INFORMATION WHICH IS PROPRIETARY AND CONFIDENTIAL TO THE NCC. THIS INFORMATION MAY NOT BE USED, DISCLOSED OR COPIED, IN WHOLE OR IN PART, WITHOUT THE PRIOR WRITTEN PERMISSION OF THE NCC.

© COMMISSION DE LA CAPITALE NATIONALE (CCN). TOUS DROITS RÉSERVÉS.
 CE DOCUMENT CONTIENT DES INFORMATIONS CONFIDENTIELLES ET EXCLUSIVES À LA CCN. CETTE INFORMATION NE PEUT ÊTRE UTILISÉ, COMMUNIQUÉ OU REPRODUITE, EN TOTALITÉ OU EN PARTIE, SANS L'ACCORD ÉCRIT DE LA CCN.

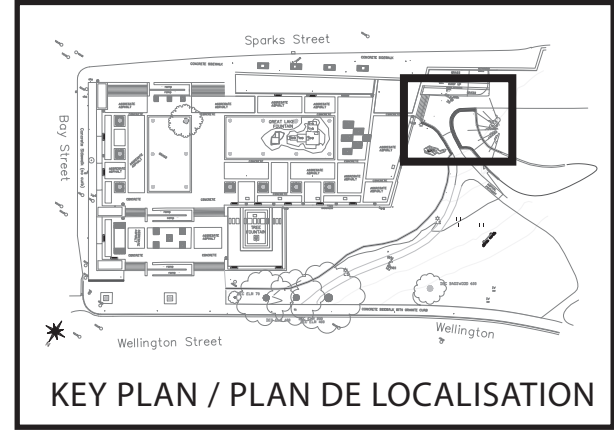
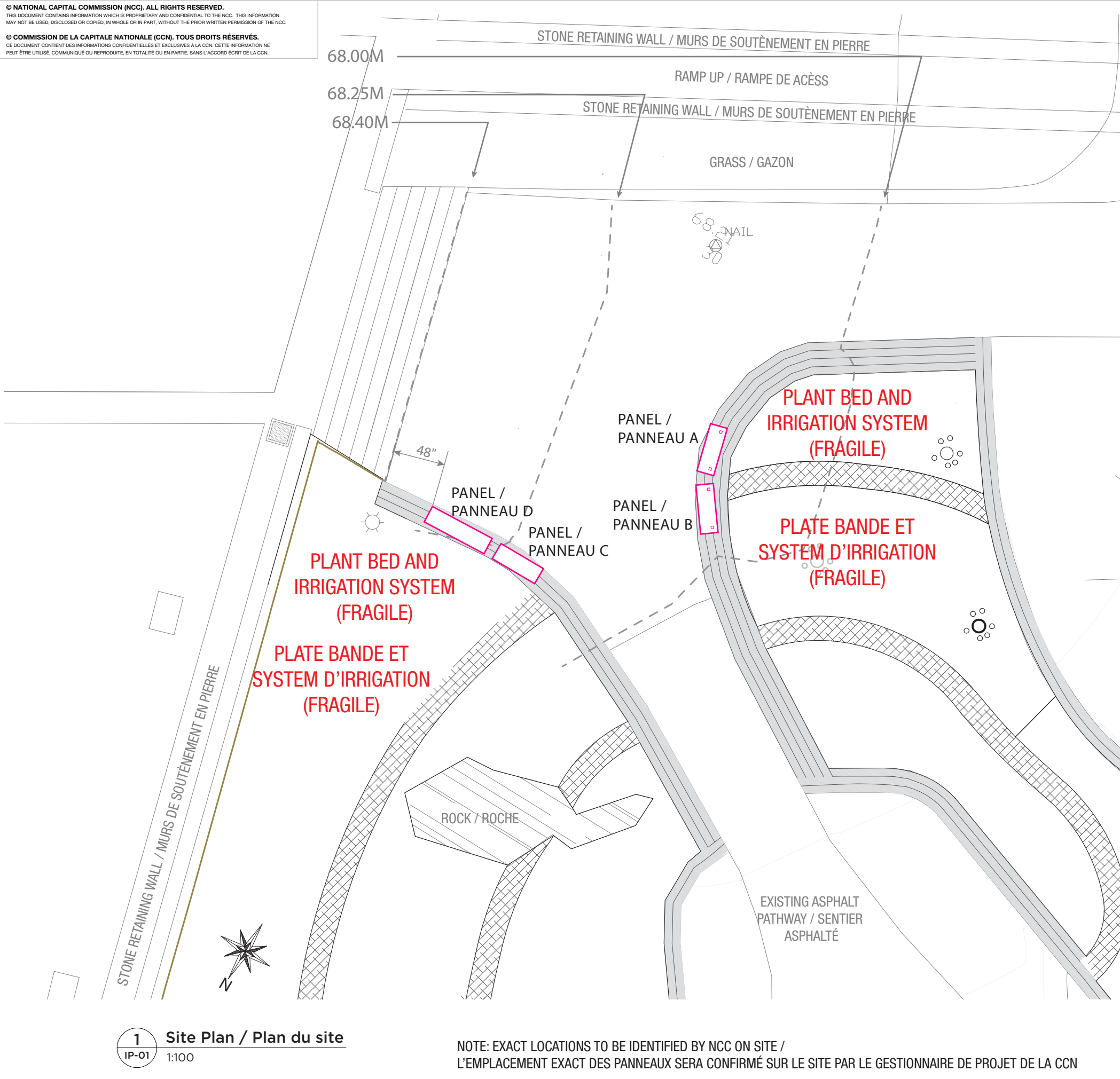

2	07-06-2017	SB		
	Final Design - 100% / Développement à 100%			
1	30-03-2017	SB		
	Final Design - 100% / Développement à 100%			
0	11-01-2017	SB		
	Final Design - 90% / Développement à 90%			
REV	DATE	BY/PAR	CHKD/VÉR	EA/RG
RÉV	DESCRIPTION			



Capital Planning and Real Asset Management Branch
 Direction de l'aménagement de la capitale et gestion de l'immobilier

Design and Construction Division
 Division design et construction

director - Claude Robert - directeur

INDUSTRIAL DESIGN / DESIGN INDUSTRIEL		DATE DD-MM-YYYY JJ-MM-AAAA
CREATED BY / CRÉÉ PAR	SB	11-01-2017
CHECKED BY / VÉRIFIÉ PAR		
ENGINEERING AUTH. / RESP. DU GÉNIE		

PROJECT / PROJET	GARDEN OF THE PROVINCES AND TERRITORIES / JARDIN DES PROVINCES ET DES TERRITOIRES	REV
NCC ID		RÉV

TITLE / TITRE: SITE PLAN / PLAN DU SITE

IP-01

SCALE / ÉCHELLE	AS NOTED / TELS QU'INDIQUÉ	SHEET / FEUILLE	1 OF 8 / DE 8
-----------------	----------------------------	-----------------	---------------

USED ON / UTILISÉ SUR:

TOLERANCES

UNLESS OTHERWISE SPECIFIED ALL DIMENSIONS ARE IN INCHES. SAUF SI SPÉCIFICATIONS CONTRAIRE DIMENSIONS SONT EN POUÇES.

FRACTIONS PART ± 1/32" ASSEM. ± 1/8" ANGLES ± 1° CONFORMS TO / CONFORME À CSA B78.2

1 Site Plan / Plan du site
 IP-01 1:100

NOTE: EXACT LOCATIONS TO BE IDENTIFIED BY NCC ON SITE / L'EMPLACEMENT EXACT DES PANNEAUX SERA CONFIRMÉ SUR LE SITE PAR LE GESTIONNAIRE DE PROJET DE LA CCN

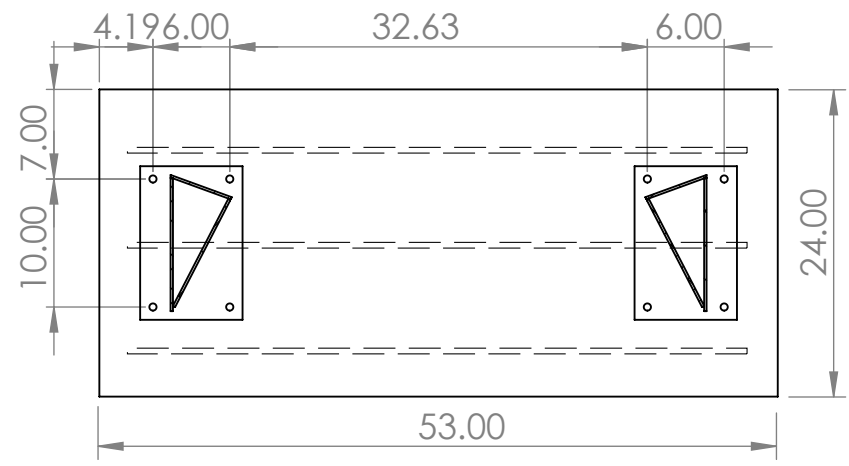

1 Horizontal Section / Section Horizontale
 IP-02 1:15

ANCHORS TO BE HILTI
 HEAVY DUTY EXPANSION ANCHORS
 HSL-3 M12/25
 WITH THREADED ROD,
 WASHERS AND NUTS /
 ANCRAGE DE TYPE HILTI HEAVY DUTY
 EXPANSION ANCHORS HSL-3 M12/25,
 INCLURE TIGES FILETÉES, RONDELLES
 D'ESPACEMENT ET ÉCROUS

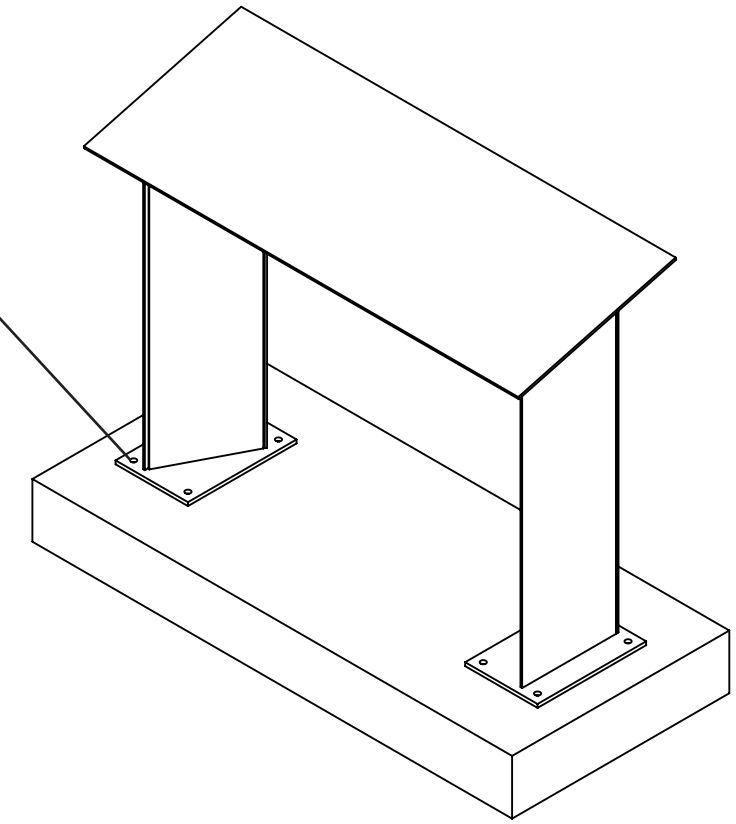

3 Isometric View - Structure & Footing /
 Vue isométrique—Structure et fondation
 IP-02 1:15

LINE OF GARDEN BED - DO NOT EXCAVATE INTO GARDEN / LIGNE DE DÉMARCATIION DU JARDIN—NE PAS ESCAVER DANS LE JARDIN

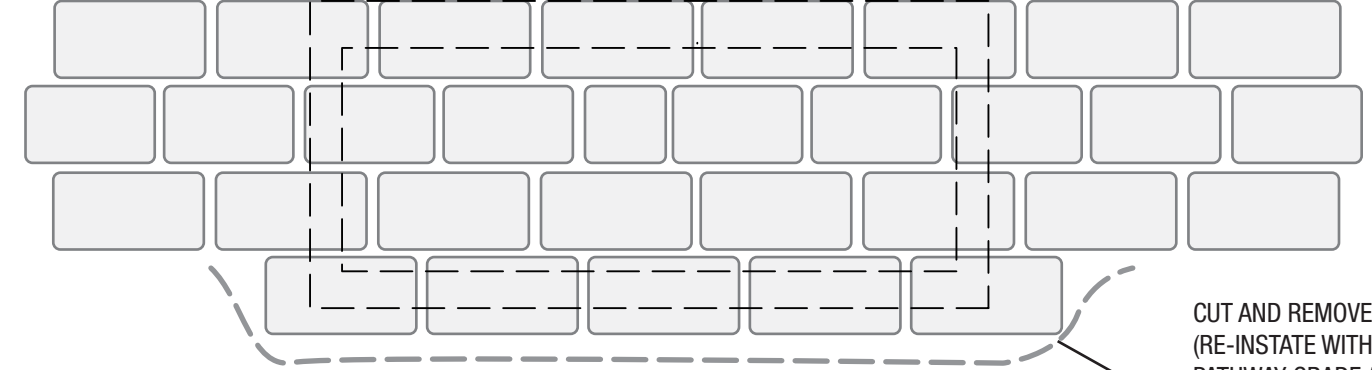

2 Typical Installation Plan / Plan d'installation type
 IP-02 1:15

CUT AND REMOVE EXISTING ASPHALT AS REQUIRED
 (RE-INSTALL WITH NEW COBBLESTONES TO MATCH EXISTING
 PATHWAY GRADE AFTER PLACING FOOTING) /
 COUPER ET RETIRER L'ASPHALTE EXISTANT AU
 BESOIN ET INSTALLER DE NOUVELLES PIERRES DE PAVÉ
 UNE FOIS LES TRAVAUX TERMINÉS.

INSTALLER DE NOUVELLES PIERRES DE PAVÉ

1	30-03-2017	SB		
	Final Design - 100% / Développement à 100%			
0	11-01-2017	SB		
	Final Design - 90% / Développement à 90%			
REV	DATE	BY/PAR	CHKD/VÉR	EA/RG
RÉV	DESCRIPTION			



Capital Planning and Real Asset Management Branch
 Direction de l'aménagement de la capitale et gestion de l'immobilier
 Design and Construction Division
 Division design et construction
 director - Claude Robert - directeur

INDUSTRIAL DESIGN / DESIGN INDUSTRIEL		DATE DD-MM-YYYY JJ-MM-AAAA
CREATED BY CRÉÉ PAR	SB	11-01-2017
CHECKED BY VÉRIFIÉ PAR		
ENGINEERING AUTH. RESP. DU GÉNIE		

USED ON / UTILISÉ SUR:	
TOLERANCES	
UNLESS OTHERWISE SPECIFIED ALL DIMENSIONS ARE IN INCHES. SAUF SI SPÉCIFICATIONS CONTRAIRE DIMENSIONS SONT EN POUÇES.	
FRACTIONS PART ± 1/32" ASSEM. ± 1/8"	ANGLES ± 1° CONFORMS TO/ CONFORME À CSA B78.2

PROJECT PROJET	GARDEN OF THE PROVINCES AND TERRITORIES / JARDIN DES PROVINCES ET DES TERRITOIRES	REV RÉV
NCC ID		
TITLE TITRE	PANELS A & B INSTALLATION DETAIL / DÉTAIL D'INSTALLATION DES PANNEAUX A ET B	
SCALE ÉCHELLE	AS NOTED / TELS QU'INDIQUÉ	SHEET FEUILLE
		2 OF DE 8

IP-02

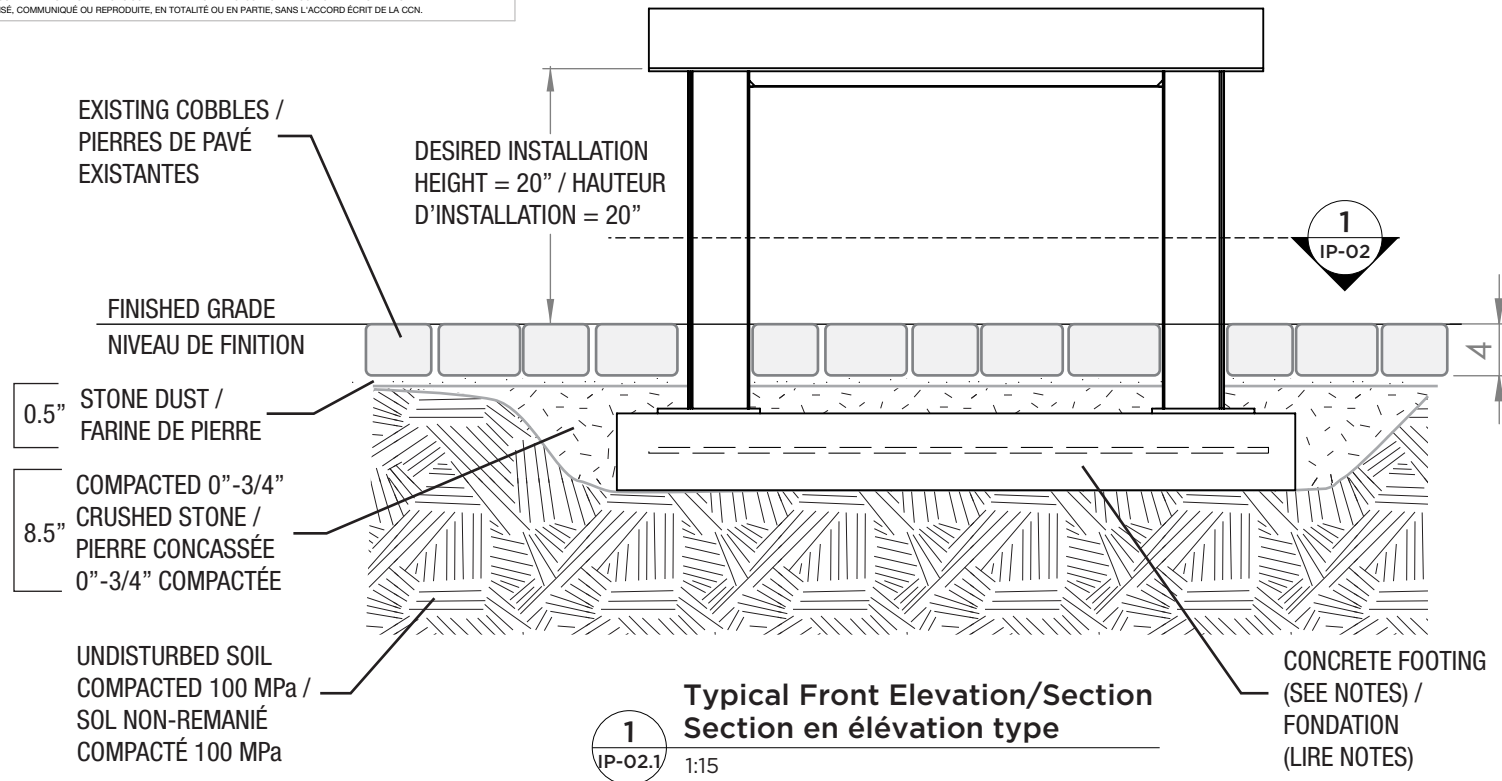

1
 IP-02.1 1:15
Typical Front Elevation/Section
Section en élévation type

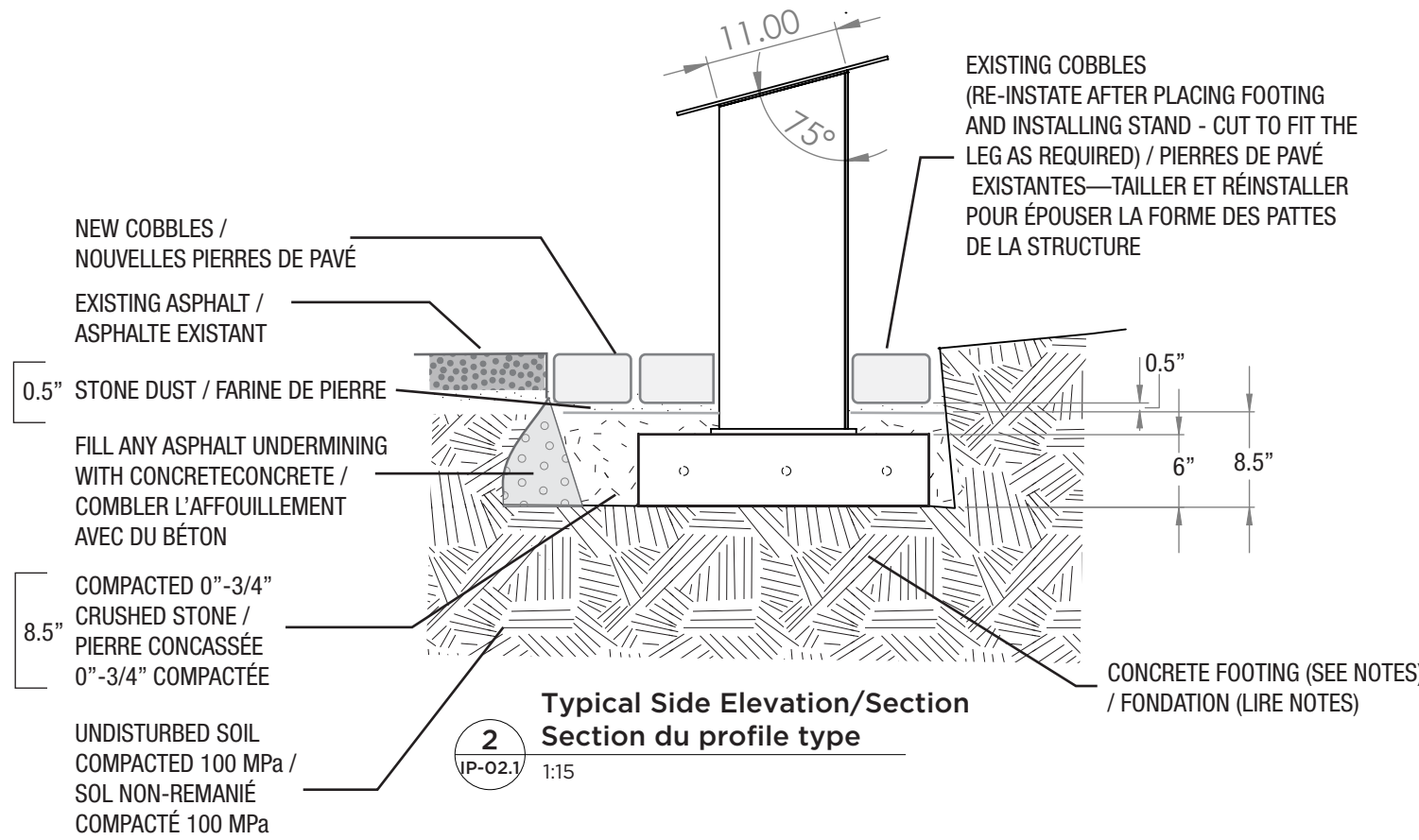

2
 IP-02.1 1:15
Typical Side Elevation/Section
Section du profile type

NOTES
 1.) Concrete shall be 25MPa with 6% - 8% air entrainment and 75mm slump / Béton 25 MPa, entraînement par air 6% à 8%, affaissement 75mm.
 2.) Provide 3X 15M reinforcing bar / inclure trois (3) barres d'armature 15M

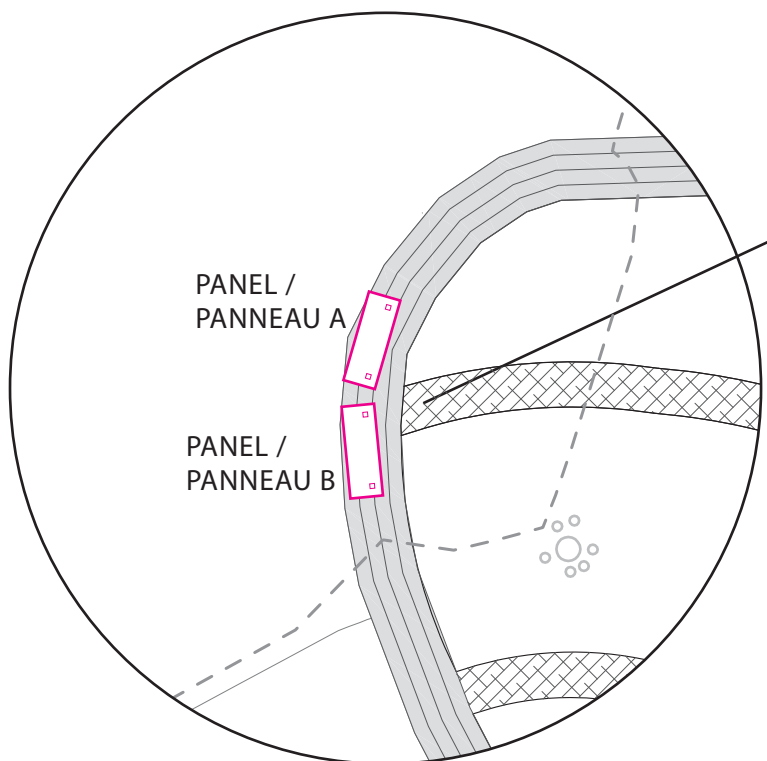

PUSH BACK MAINTENANCE PATH GRAVEL PRIOR TO EXCAVATION AND PUT GRAVEL BACK IN PLACE UPON COMPLETION OF WORK / DÉGAGER LE GRAVIER DU SENTIER AVANT D'ESCAVER ET LE REMETTRE EN PLACE UNE FOIS LES TRAVAUX COMPLÉTÉS

USED ON / UTILISÉ SUR:	
TOLERANCES	
UNLESS OTHERWISE SPECIFIED ALL DIMENSIONS ARE IN INCHES. SAUF SI SPÉCIFICATIONS CONTRAIRE DIMENSIONS SONT EN POUCHES.	
FRACTIONS PART ± 1/32"	ANGLES ASSEMB. ± 1°
CONFORMS TO/ CONFORME À CSA B78.2	

1	30-03-2017	SB		
	Final Design - 100% / Développement à 100%			
0	11-01-2017	SB		
	Final Design - 90% / Développement à 90%			
REV	DATE	BY/PAR	CHKD/VÉR	EA/RG
RÉV	DESCRIPTION			



Capital Planning and Real Asset Management Branch
 Direction de l'aménagement de la capitale et gestion de l'immobilier
 Design and Construction Division
 Division design et construction
 director - Claude Robert - directeur

INDUSTRIAL DESIGN / DESIGN INDUSTRIEL		DATE DD-MM-YYYY JJ-MM-AAAA
CREATED BY / CRÉÉ PAR	SB	11-01-2017
CHECKED BY / VÉRIFIÉ PAR		
ENGINEERING AUTH. / RESP. DU GÉNIE		
PROJECT / PROJET	GARDEN OF THE PROVINCES AND TERRITORIES / JARDIN DES PROVINCES ET DES TERRITOIRES	
NCC ID		REV / RÉV
TITLE / TITRE	PANELS A & B INSTALLATION DETAIL / DÉTAIL D'INSTALLATION DES PANNEAUX A ET B	
SCALE / ÉCHELLE	AS NOTED / TELS QU'INDIQUÉ	SHEET / FEUILLE 3 OF / DE 8

IP-02.1

© NATIONAL CAPITAL COMMISSION (NCC). ALL RIGHTS RESERVED.
 THIS DOCUMENT CONTAINS INFORMATION WHICH IS PROPRIETARY AND CONFIDENTIAL TO THE NCC. THIS INFORMATION
 MAY NOT BE USED, DISCLOSED OR COPIED, IN WHOLE OR IN PART, WITHOUT THE PRIOR WRITTEN PERMISSION OF THE NCC.

© COMMISSION DE LA CAPITALE NATIONALE (CCN). TOUS DROITS RÉSERVÉS.
 CE DOCUMENT CONTIENT DES INFORMATIONS CONFIDENTIELLES ET EXCLUSIVES À LA CCN. CETTE INFORMATION NE
 PEUT ÊTRE UTILISÉ, COMMUNIQUÉ OU REPRODUITE, EN TOTALITÉ OU EN PARTIE, SANS L'ACCORD ÉCRIT DE LA CCN.

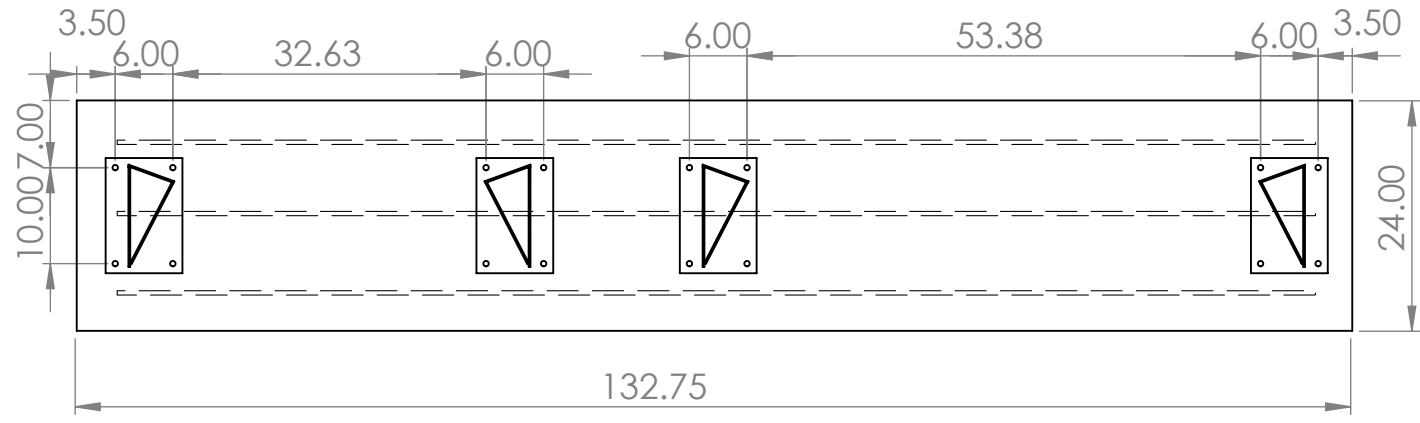

1 Horizontal Section / Section Horizontale
 IP-03 1:20

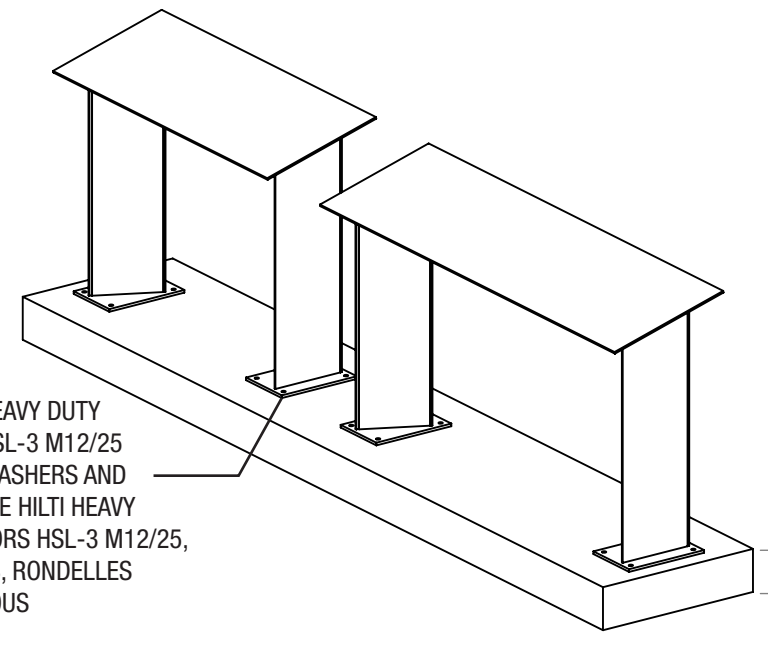

ANCHORS TO BE HILTI HEAVY DUTY EXPANSION ANCHORS HSL-3 M12/25 WITH THREADED ROD, WASHERS AND NUTS / ANCRAGE DE TYPE HILTI HEAVY DUTY EXPANSION ANCHORS HSL-3 M12/25, INCLURE TIGES FILETÉES, RONDELLES D'ESPACEMENT ET ÉCROUS

4 Isometric View - Structure & Footing /
 Vue isométrique—Structure et fondation
 IP-03 1:20

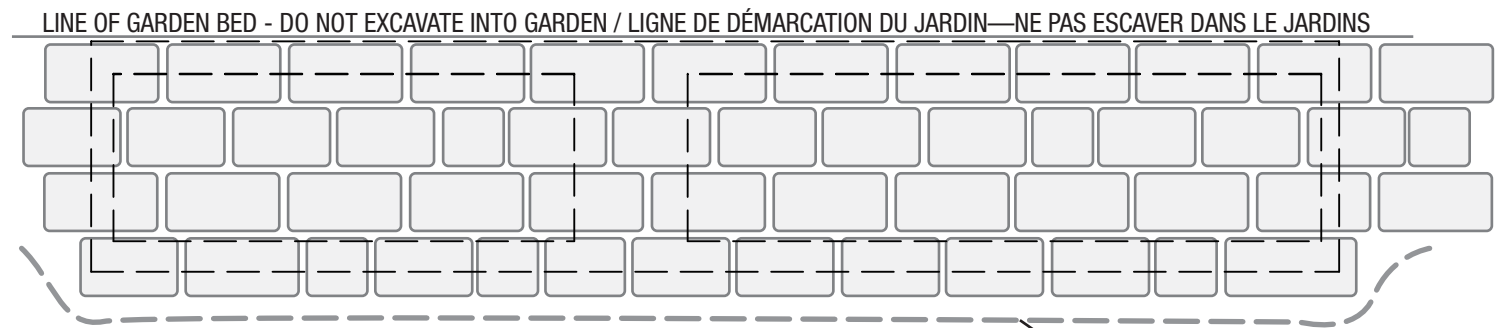

2 Typical Installation Plan / Plan d'installation type
 IP-03 1:20

CUT AND REMOVE EXISTING ASPHALT AS REQUIRED (RE-INSTATE WITH NEW COBBLESTONES TO MATCH EXISTING PATHWAY GRADE AFTER PLACING FOOTING) / COUPER ET RETIRER L'ASPHALTE EXISTANT AU BESOIN ET INSTALLER DE NOUVELLES PIERRES DE PAVÉ UNE FOIS LES TRAVAUX TERMINÉS.

REV / RÉV	DATE	BY/PAR	CHKD/VÉR	EA/RG
DESCRIPTION				



Capital Planning and Real Asset Management Branch
 Direction de l'aménagement de la capitale et gestion de l'immobilier

Design and Construction Division
 Division design et construction

director - Claude Robert - directeur

INDUSTRIAL DESIGN / DESIGN INDUSTRIEL		DATE DD-MM-YYYY JJ-MM-AAAA
CREATED BY / CRÉÉ PAR	SB	11-01-2017
CHECKED BY / VÉRIFIÉ PAR		
ENGINEERING AUTH. / RESP. DU GÉNIE		

PROJECT / PROJET	GARDEN OF THE PROVINCES AND TERRITORIES / JARDIN DES PROVINCES ET DES TERRITOIRES
NCC ID	REV / RÉV

TITLE / TITRE	PANELS C & D INSTALLATION DETAIL / DÉTAIL D'INSTALLATION DES PANNEAUX C ET D
IP-03	

SCALE / ÉCHELLE	AS NOTED / TELS QU'INDIQUÉ	SHEET / FEUILLE	4 OF / DE 8
-----------------	----------------------------	-----------------	-------------

USED ON / UTILISÉ SUR:

TOLERANCES
 UNLESS OTHERWISE SPECIFIED ALL DIMENSIONS ARE IN INCHES. SAUF SI SPÉCIFICATIONS CONTRAIRE DIMENSIONS SONT EN POUÇES.

FRACTIONS PART ± 1/32" ASSEM. ± 1/8"	ANGLES ± 1°	CONFORMS TO/ CONFORME À CSA B78.2
--	----------------	---

© NATIONAL CAPITAL COMMISSION (NCC), ALL RIGHTS RESERVED.
 THIS DOCUMENT CONTAINS INFORMATION WHICH IS PROPRIETARY AND CONFIDENTIAL TO THE NCC. THIS INFORMATION MAY NOT BE USED, DISCLOSED OR COPIED, IN WHOLE OR IN PART, WITHOUT THE PRIOR WRITTEN PERMISSION OF THE NCC.

© COMMISSION DE LA CAPITALE NATIONALE (CCN), TOUS DROITS RÉSERVÉS.
 CE DOCUMENT CONTIENT DES INFORMATIONS CONFIDENTIELLES ET EXCLUSIVES À LA CCN. CETTE INFORMATION NE PEUT ÊTRE UTILISÉ, COMMUNIQUÉ OU REPRODUITE, EN TOTALITÉ OU EN PARTIE, SANS L'ACCORD ÉCRIT DE LA CCN.

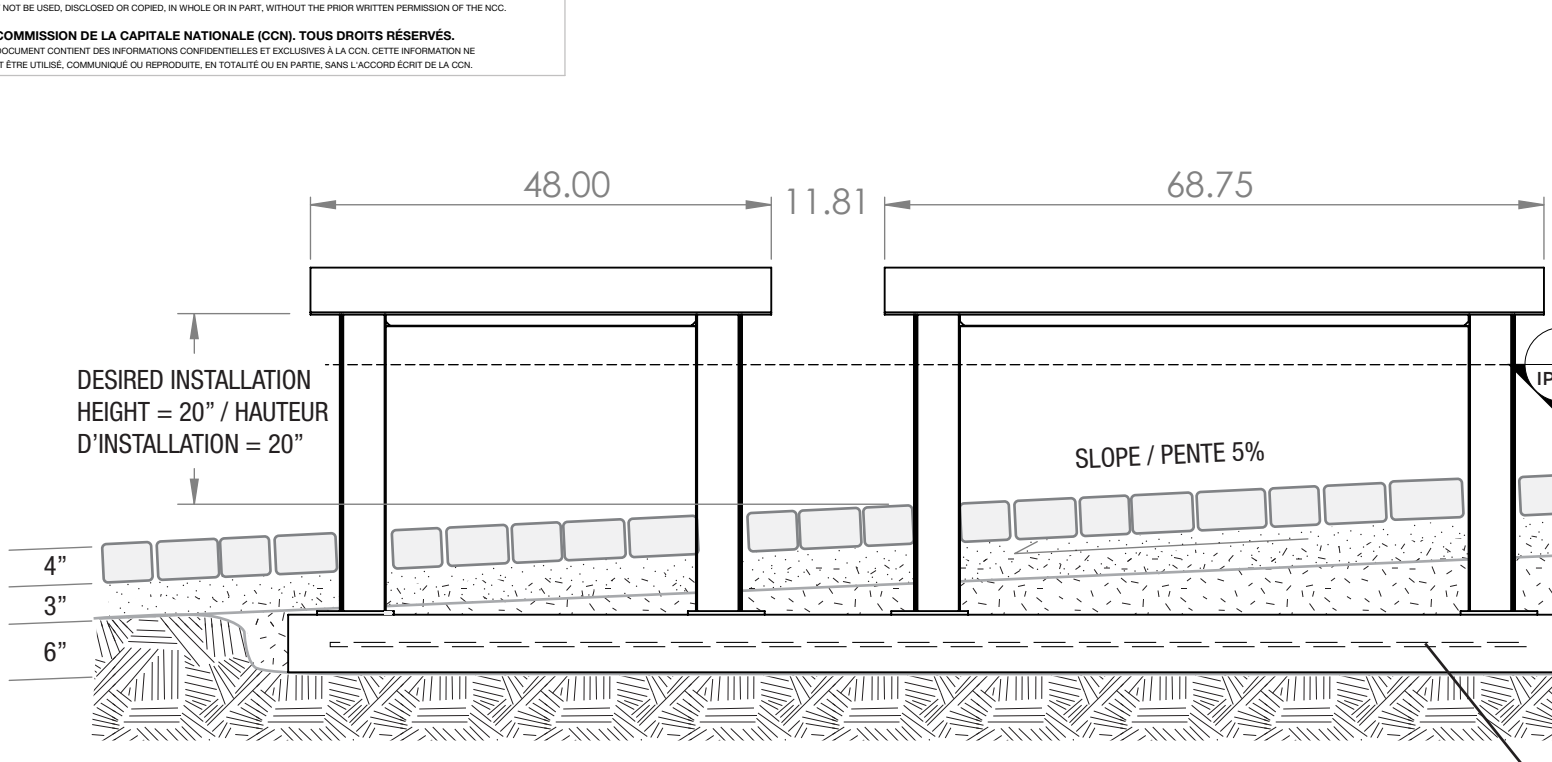

3 Front Elevation Plan/Section
 IP-03.1 1:20

EXISTING COBBLES (RE-INSTATE AFTER PLACING FOOTING AND INSTALLING STAND - CUT TO FIT THE LEG AS REQUIRED) / PIERRES DE PAVÉ EXISTANTES—TAILLER ET RÉINSTALLER POUR ÉPOUSER LA FORME DES PATTES DE LA STRUCTURE

NEW COBBLESTONES / NOUVELLES PIERRES DE PAVÉ

EXISTING ASPHALT / ASPHALTE EXISTANT

STONE DUST / FARINE DE PIERRE

FILL ANY ASPHALT UNDERMINING WITH CONCRETE / COMBLER L'AFFOUILLEMENT AVEC DU BÉTON

COMPACTED 0"-3/4" CRUSHED STONE / PIERRE CONCASSÉE 0"-3/4" COMPACTÉE

UNDISTURBED SOIL COMPACTED 100 MPa / SOL NON-REMANIÉ COMPACTÉ 100 MPa

CONCRETE FOOTING (SEE NOTES) / FONDATION (LIRE NOTES)

5 Typical Side Elevation/Section
 IP-03.1 1:15

- NOTES**
- 1.) Concrete shall be 25MPa with 6% - 8% air entrainment and 75mm slump / Béton 25 MPa, entrainement par air 6% à 8%, affaissement 75mm.
 - 2.) Provide 3X 15M reinforcing bar / inclure trois (3) barres d'armature 15M

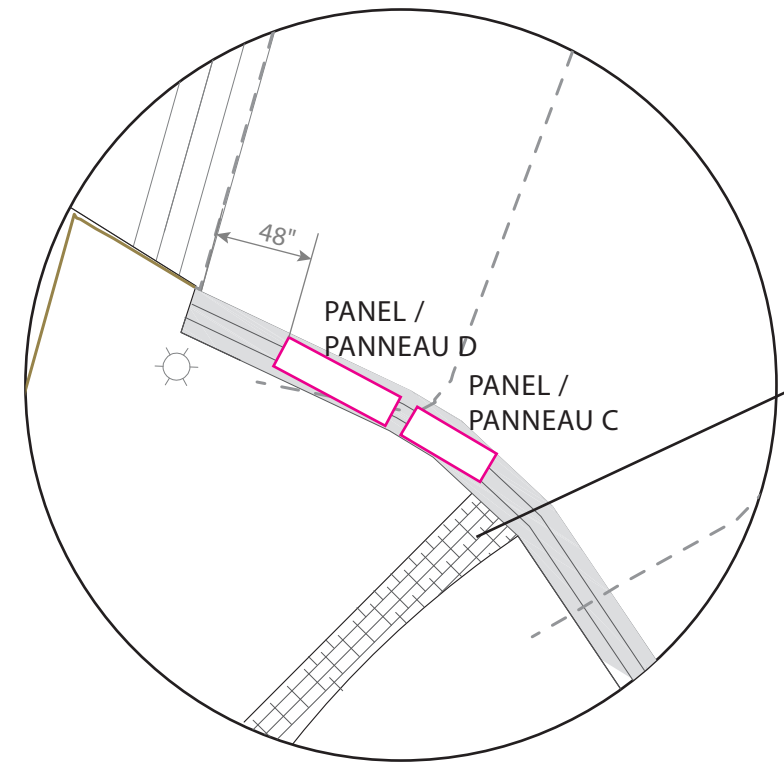

PUSH BACK MAINTENANCE PATH GRAVEL PRIOR TO EXCAVATION AND PUT GRAVEL BACK IN PLACE UPON COMPLETION OF WORK / DÉGAGER LE GRAVIER DU SENTIER AVANT D'ESCAVER ET LE REMETTRE EN PLACE UNE FOIS LES TRAVAUX COMPLÉTÉS

2	07-06-2017	SB		
	Final Design - 100% / Développement à 100%			
1	30-03-2017	SB		
	Final Design - 100% / Développement à 100%			
0	11-01-2017	SB		
	Final Design - 90% / Développement à 90%			
REV	DATE	BY/PAR	CHKD/VÉR	EA/RG
RÉV	DESCRIPTION			



Capital Planning and Real Asset Management Branch
 Direction de l'aménagement de la capitale et gestion de l'immobilier

Design and Construction Division
 Division design et construction

director - Claude Robert - directeur

INDUSTRIAL DESIGN / DESIGN INDUSTRIEL		DATE DD-MM-YYYY JJ-MM-AAAA
CREATED BY CRÉÉ PAR	SB	11-01-2017
CHECKED BY VÉRIFIÉ PAR		
ENGINEERING AUTH. RESP. DU GÉNIE		

USED ON / UTILISÉ SUR:	
TOLERANCES	
UNLESS OTHERWISE SPECIFIED ALL DIMENSIONS ARE IN INCHES. SAUF SI SPÉCIFICATIONS CONTRAIRE DIMENSIONS SONT EN POUCHES.	
FRACTIONS PART ± 1/32" ASSEM. ± 1/8"	ANGLES ± 1°
CONFORMS TO/ CONFORME À CSA B78.2	

PROJECT PROJET	GARDEN OF THE PROVINCES AND TERRITORIES / JARDIN DES PROVINCES ET DES TERRITOIRES
NCC ID	REV RÉV
TITLE TITRE	PANELS C & D INSTALLATION DETAIL / DÉTAIL D'INSTALLATION DES PANNEAUX C ET D
SCALE ÉCHELLE	AS NOTED / TELS QU'INDIQUÉ
SHEET FEUILLE	5 OF 8 DE 8

IP-03.1

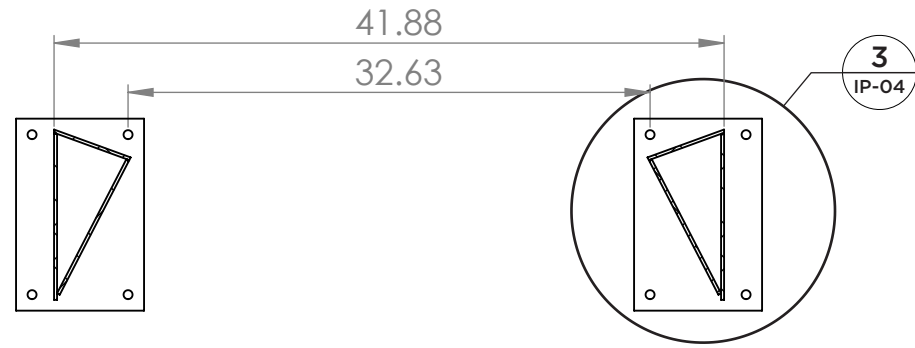

1 Horizontal Section / Section horizontale
 IP-04 1:12

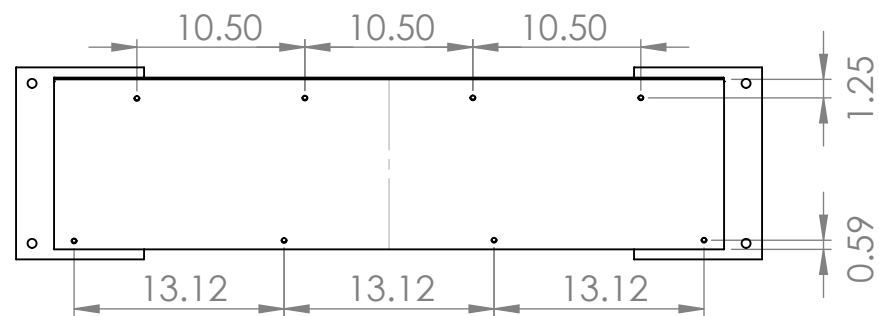

2 Top View / Vue de dessus
 IP-04 1:12

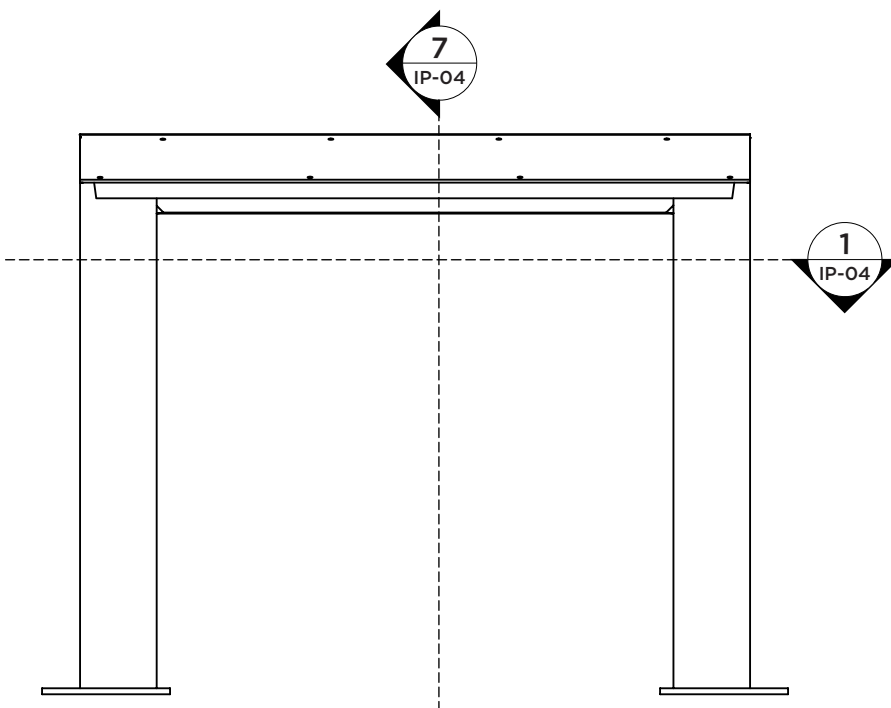

5 Front View / Vue de face
 IP-04 1:12

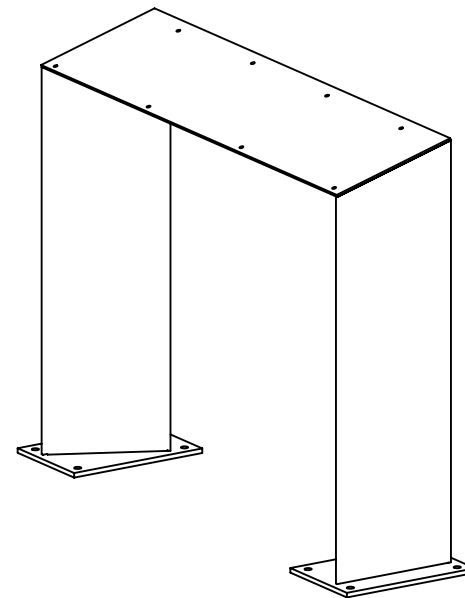

4 Isometric View /
 Vue isométrique
 IP-04 nts

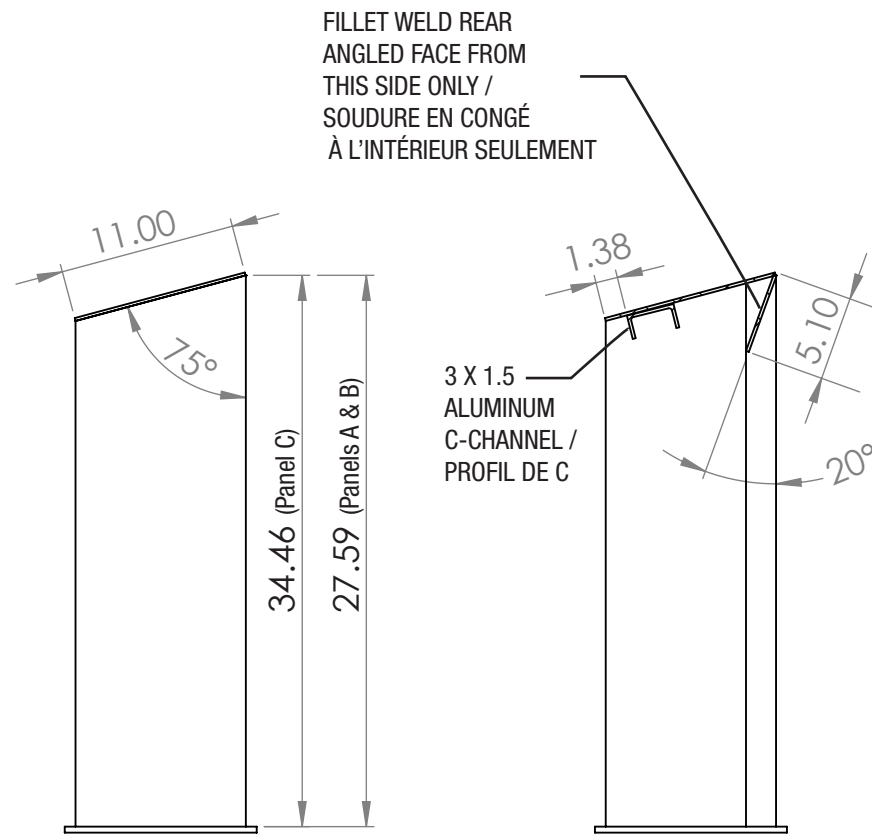

6 Side View /
 Vue de côté
 IP-04 1:12

7 Vertical Section /
 Section verticale
 IP-04 1:12

NOTES:
 - THESE NOTES APPLY TO DRAWINGS IP-04 & IP-05
 - THIS ASSEMBLY WAS DESIGNED IN SOLIDWORKS.
 - WITH THE PERMISSION OF THE NCC, INTU WILL PROVIDE
 NATIVE SOLIDWORKS OR OTHER FORMAT FILES TO THE
 CONTRACTOR.
 - ALL PARTS IN THIS WELDED ASSEMBLY ARE 3/16"
 ALUMINUM SHEET EXCEPT FOR THE BASEPLATES, WHICH ARE
 3/8" ALUMINUM.
 - ALL OUTSIDE CORNER JOINTS ARE TO BE FILLED WITH
 CONTINUOUS FILLET WELD THEN GROUND TO A SMOOTH
 CORNER, WITH A ~0.063 RADIUS.
 - REAR HORIZONTAL ANGLED FACE TO HAVE A WELL FIT
 MITRED EDGE, AND IS TO BE WELDED FROM THE INSIDE
 SURFACE TO PRESERVE A CRISP INNER CORNER.
 - ALL VISIBLE SURFACES TO BE PAINT FINISHED USING
 MATTHEWS ACRYLIC POLYURETHANE FINISH. SURFACES TO
 BE PREPPED AS PER SSPC-SP10, 2 COATS OF EPOXY PRIMER
 AND TWO TOP COATS OF ACRYLIC POLYURETHANE AS PER
 MANUFACTURER'S SPECIFICATIONS. PAINT COLOUR IS A
 STANDARD MATTHEWS NON-METALLIC - TBD.

NOTES:
 - LES NOTES SUIVANTES S'APPLIQUES AUX DESSINS IP-04 ET
 IP-05
 - CET ASSEMBLAGE A ÉTÉ CONÇU AVEC LE LOGICIEL SOLIDWORKS
 - AVEC LA PERMISSION DE LA CCN, INTU FOURNIRA LES FICHIERS
 ÉLECTRONIQUES DES STRUCTURES AU CONTRACTEUR
 SEULEMENT
 - TOUTES LES PIÈCES DE LA STRUCTURE SONT EN ALUMINIUM ET
 ONT UNE ÉPAISSEUR DE 3/16" À L'EXCEPTION DE LA PLAQUE DE
 MONTAGE QUI EST D'UNE ÉPAISSEUR DE 3/8" EN ALUMINIUM
 - TOUS LES JOINTS EXTÉRIEURS DOIVENT ÊTRE REMPLIS D'UN
 CORDON DE SOUDURE CONTINU, PONCÉES ET POUR FORMER DES
 SURFACES LISSES ET DES ARRÊTES ARRONDIES D'UN FILET
 UNIFORME ET CONSTANT DE RAYON DE 0.063"
 - LA FACE ARRIÈRE À ANGLE DE LA PIÈCE HORIZONTALE DEVRA
 ÊTRE SOUDÉE DE L'INTÉRIEUR ET ÊTRE ASSEMBLÉE
 PARFAITEMENT À ONGLET DE FAÇON À ÉPOUSER LA FORME DES
 PATTES FINITION :
 - TOUTES LES SURFACES VISIBLES SERONT FINIES AVEC DE LA
 PEINTURE POLYURÉTHANE ACRYLIQUE DE MARQUE MATTHEWS.
 PRÉPARATION DES SURFACE SELON LES SPÉCIFICATIONS
 SSPC-SP10, DU MANUFACTURIER. DEUX (2) COUCHES D'APPRÊT
 EPOXY ET DEUX (2) COUCHES DE FINITION REQUISES. COULEUR À
 DÉTERMINER.

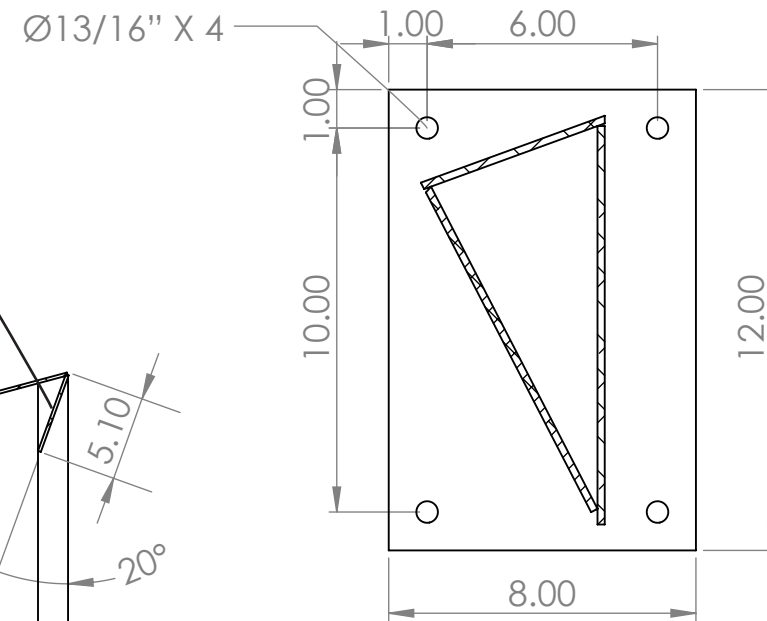

3 Detail - Baseplate /
 Plaque de montage
 IP-04 1:5

SEE IP-05, DETAIL 3 FOR LEG PROFILE /
 VOIR DESSIN IP-05 POUR LES DÉTAILS DE LA PATTE

USED ON / UTILISÉ SUR:	
TOLERANCES	
UNLESS OTHERWISE SPECIFIED ALL DIMENSIONS ARE IN INCHES. SAUF SI SPÉCIFICATIONS CONTRAIRE DIMENSIONS SONT EN POUÇES.	
FRACTIONS PART ± 1/32" ASSEM. ± 1/8"	ANGLES ± 1°
CONFORMS TO/ CONFORME À CSA B78.2	

1	30-03-2017	SB		
	Final Design - 100% / Développement à 100%			
0	11-01-2017	SB		
	Final Design - 90% / Développement à 90%			
REV	DATE	BY/PAR	CHKD/VÉR	EA/RG
RÉV	DESCRIPTION			



Capital Planning and Real Asset Management Branch
 Direction de l'aménagement de la capitale et gestion de l'immobilier

Design and Construction Division
 Division design et construction

director - Claude Robert - directeur

INDUSTRIAL DESIGN / DESIGN INDUSTRIEL		DATE DD-MM-YYYY JJ-MM-AAAA
CREATED BY CRÉÉ PAR	SB	11-01-2017
CHECKED BY VÉRIFIÉ PAR		
ENGINEERING AUTH. RESP. DU GÉNIE		
PROJECT PROJET	GARDEN OF THE PROVINCES AND TERRITORIES / JARDIN DES PROVINCES ET DES TERRITOIRES	
NCC ID		REV RÉV
TITLE TITRE	PANELS A, B & C SUPPORT STRUCTURE / STRUCTURE PANNEAUX A,B ET C	
SCALE ÉCHELLE	AS NOTED / TELS QU'INDIQUÉ	SHEET FEUILLE
		6 OF DE 8

IP-04



1 Horizontal Section / Section horizontale
 IP-05 1:12

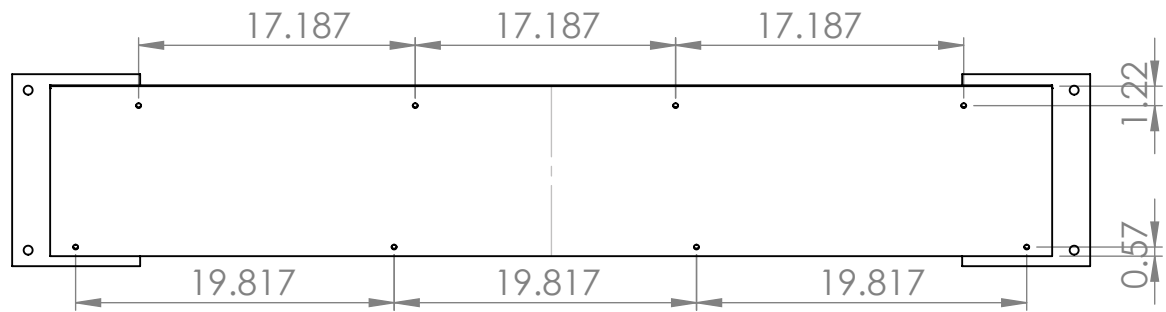

2 Top View / Vue de dessus
 IP-05 1:12

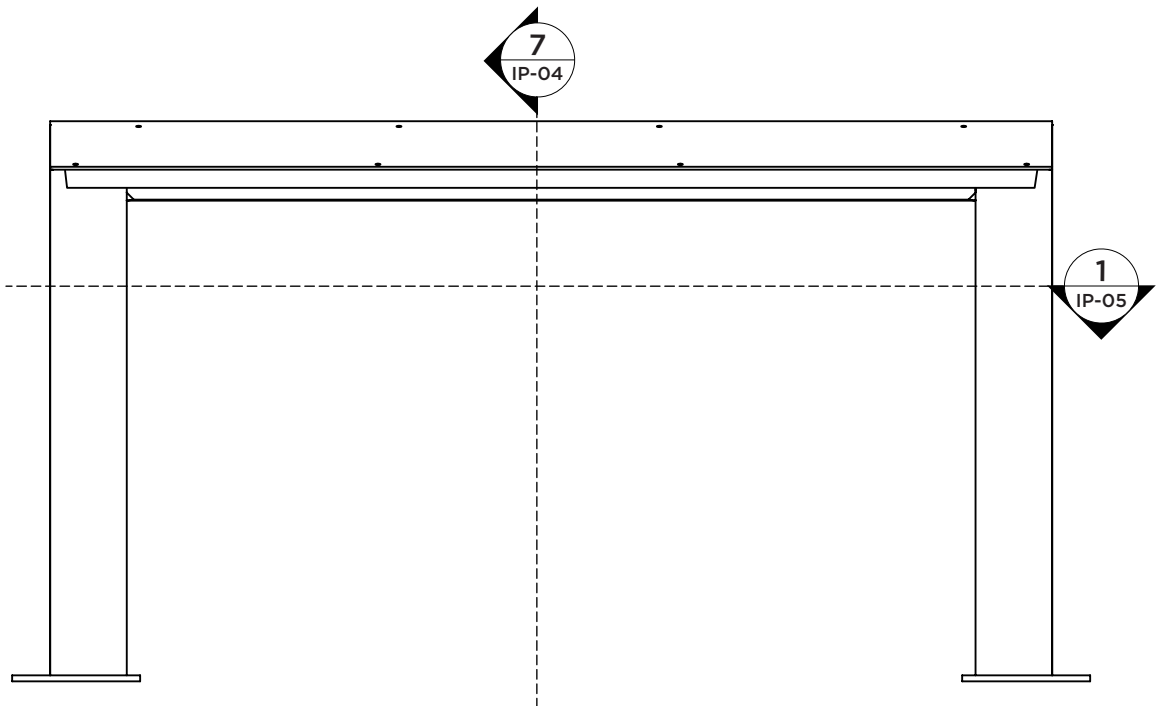

5 Front View / Vue de face
 IP-05 1:12

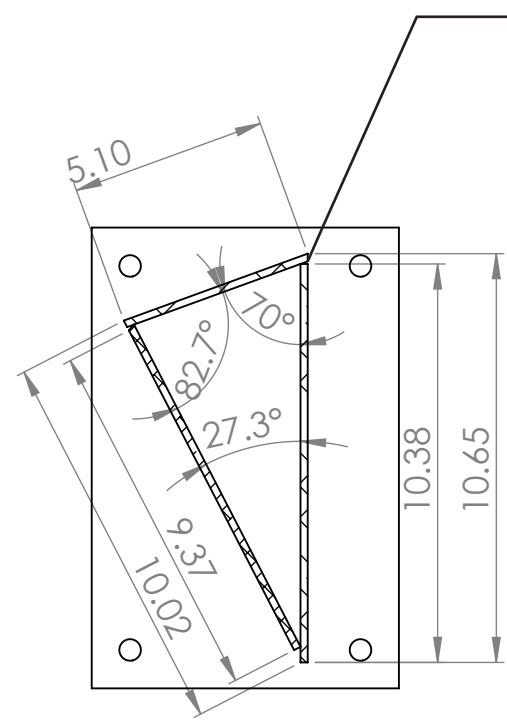

3 Detail - Leg Profile /
 Détail-Profil de la patte
 IP-05 1:5

SEE IP-04, DETAIL 3 FOR BASEPLATE DETAILS / VOIR DESSIN IP-04,
 DÉTAIL NO 3, POUR LES DÉTAILS DE LA PLAQUE DE MONTAGE

SEE NOTES ON IP-04 FOR DETAILS ON MATERIALS, FINISHES AND PROCESSES / VOIR DESSIN IP-04,
 NOTES, POUR LE DÉTAIL DES MATÉRIAUX, DU PROCÉDÉ D'ASSEMBLAGE ET DE FINITION

CONTINUOUS FILLET WELD, GRIND AND
 FILL FOR SMOOTH CORNER, WITH A
 ~0.0625 RADIUS - ALL OUTER CORNERS /
 TOUS LES JOINTS EXTÉRIEURS DOIVENT
 ÊTRE REMPLIS D'UN CORDON DE SOUDURE
 À CONGÉ CONTINU, PONCÉES ET POUR FORMER
 DES SURFACES LISSES ET DES ARRÊTES
 ARRONDIES D'UN FILET UNIFORME ET
 CONSTANT DE RAYON DE 0.063"

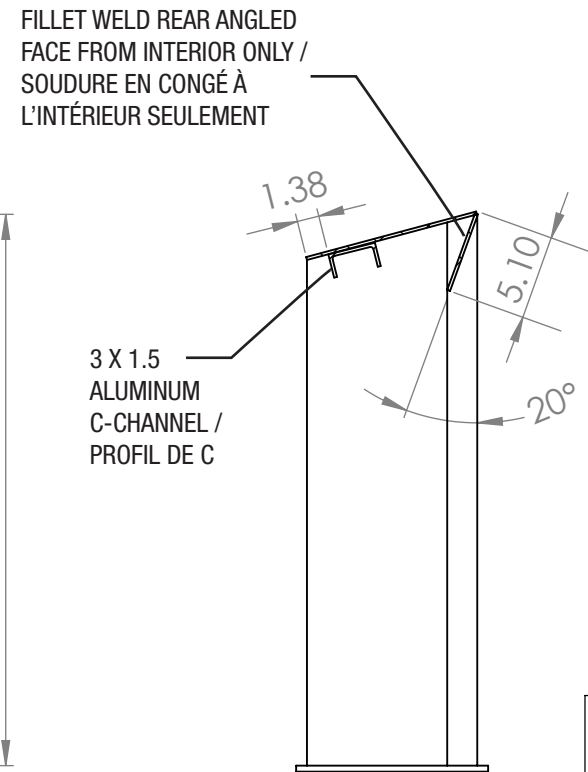

6 Side View /
 Vue de côté
 IP-05 1:12

7 Vertical Section /
 Section verticale
 IP-05 1:12

FILLET WELD REAR ANGLED
 FACE FROM INTERIOR ONLY /
 SOUDURE EN CONGÉ À
 L'INTÉRIEUR SEULEMENT

USED ON / UTILISÉ SUR:

TOLERANCES

UNLESS OTHERWISE SPECIFIED ALL DIMENSIONS ARE IN INCHES.
 SAUF SI SPÉCIFICATIONS CONTRAIRE DIMENSIONS SONT EN POUÇES.

FRACTIONS	ANGLES	CONFORMS TO/ CONFORME À CSA B78.2
PART ± 1/32"	± 1°	
ASSEM. ± 1/8"		

SCALE / ÉCHELLE AS NOTED / TELS QU'INDIQUÉ

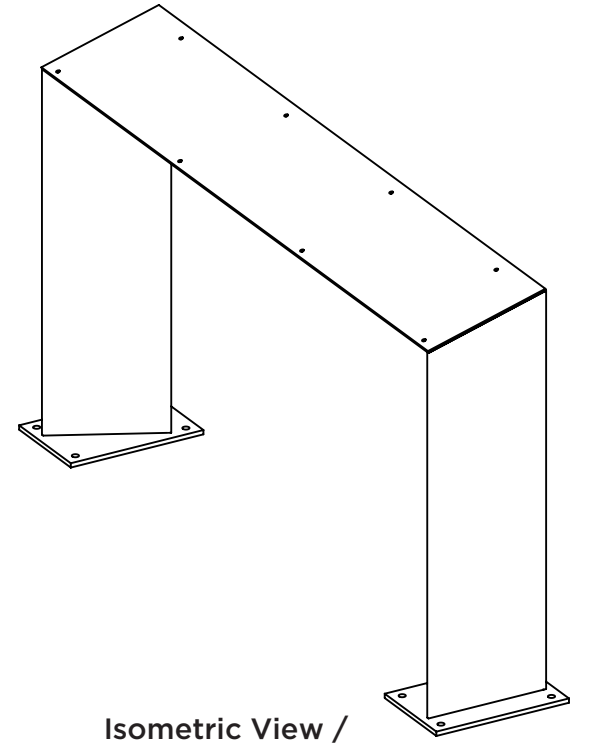

4 Isometric View /
 Vue isométrique
 IP-05 nts

2	07-06-2017	SB		
	Final Design - 100% / Développement à 100%			
1	30-03-2017	SB		
	Final Design - 100% / Développement à 100%			
0	11-01-2017	SB		
	Final Design - 90% / Développement à 90%			
REV	DATE	BY/PAR	CHKD/VÉR	EA/RG
RÉV	DESCRIPTION			

**NCC
CCN**

Capital Planning and Real Asset Management Branch
 Direction de l'aménagement de la capitale et gestion de l'immobilier

Design and Construction Division
 Division design et construction

director - Claude Robert - directeur

INDUSTRIAL DESIGN / DESIGN INDUSTRIEL		DATE DD-MM-YYYY JJ-MM-AAAA
CREATED BY CRÉÉ PAR	SB	11-01-2017
CHECKED BY VÉRIFIÉ PAR		
ENGINEERING AUTH. RESP. DU GÉNIE		
PROJECT PROJET	GARDEN OF THE PROVINCES AND TERRITORIES / JARDIN DES PROVINCES ET DES TERRITOIRES	
NCC ID		REV RÉV

TITLE TITRE	PANEL D SUPPORT STRUCTURE / STRUCTURE PANNEAU D	
IP-05		
SCALE ÉCHELLE	AS NOTED / TELS QU'INDIQUÉ	SHEET FEUILLE
		7 OF DE 8

© NATIONAL CAPITAL COMMISSION (NCC). ALL RIGHTS RESERVED.
 THIS DOCUMENT CONTAINS INFORMATION WHICH IS PROPRIETARY AND CONFIDENTIAL TO THE NCC. THIS INFORMATION
 MAY NOT BE USED, DISCLOSED OR COPIED, IN WHOLE OR IN PART, WITHOUT THE PRIOR WRITTEN PERMISSION OF THE NCC.
 © COMMISSION DE LA CAPITALE NATIONALE (CCN). TOUS DROITS RÉSERVÉS.
 CE DOCUMENT CONTIENT DES INFORMATIONS CONFIDENTIELLES ET EXCLUSIVES À LA CCN. CETTE INFORMATION NE
 PEUT ÊTRE UTILISÉ, COMMUNIQUÉ OU REPRODUITE, EN TOTALITÉ OU EN PARTIE, SANS L'ACCORD ÉCRIT DE LA CCN.

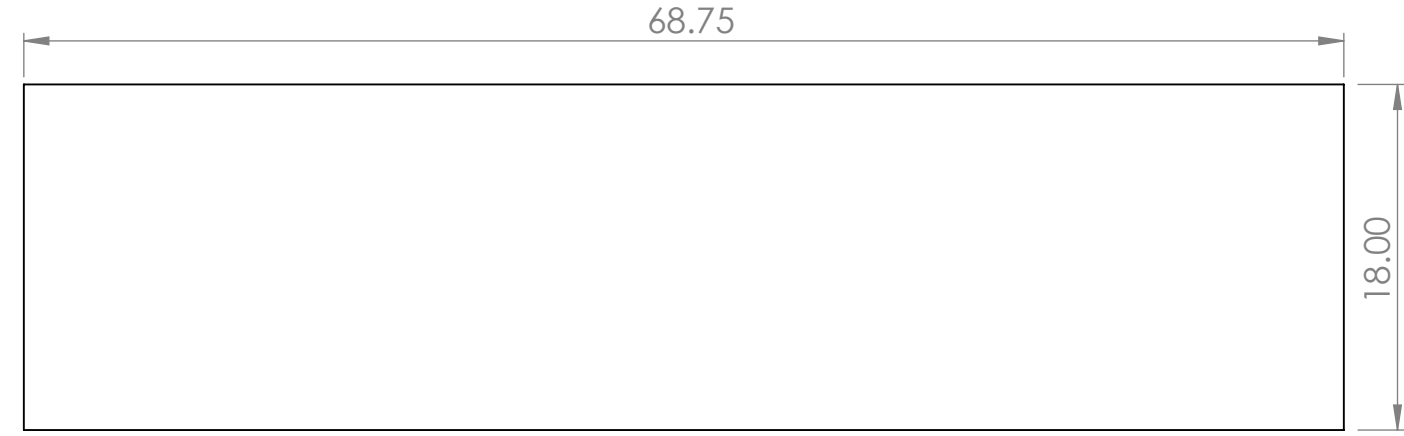
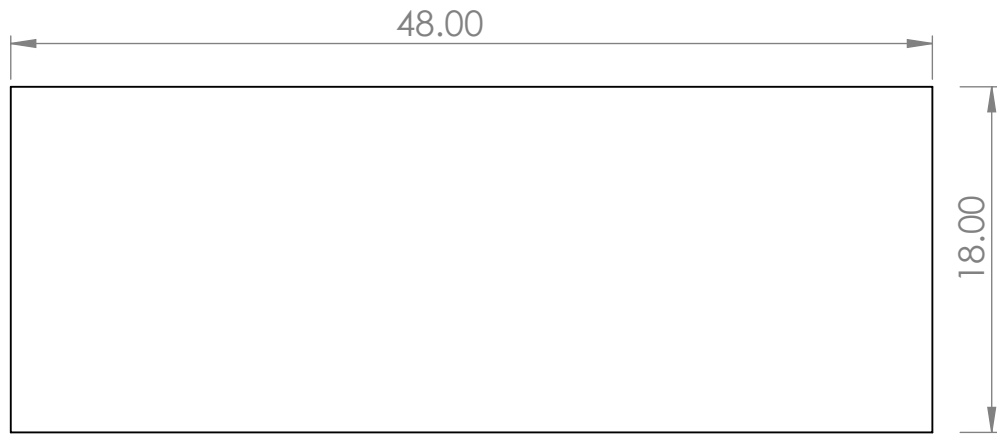

1
 IP-06 1:10
**Small Panel - Top View /
 Petit panneau—Vue de dessus**

3
 IP-06 1:10
**Large Panel - Top View /
 Panneau large—Vue de dessus**

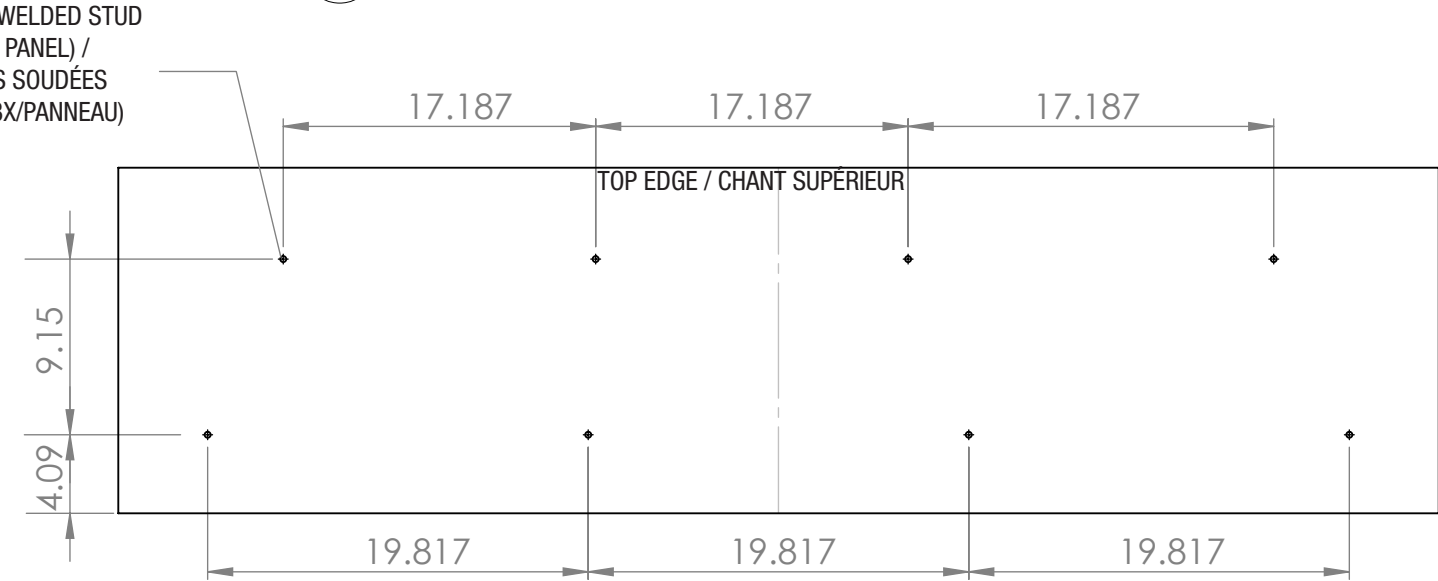
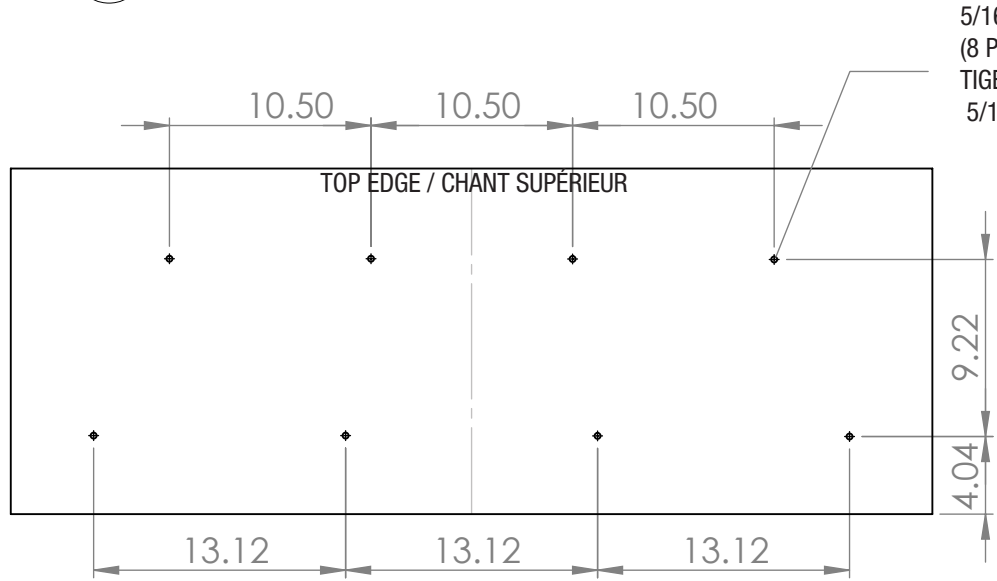

2
 IP-06 1:10
**Small Panel - Bottom View /
 Panneau large—Vue de dessous**

4
 IP-06 1:10
**Large Panel - Bottom View /
 Panneau large—Vue de dessous**

5/16"-18 X 1" WELDED STUD
 (8 PLACES PER PANEL) /
 TIGES FILETÉES SOUDÉES
 5/16"-18X1"(8X/PANNEAU)

PANELS TO BE CUSTOM ALTO GRAPHIC, AS PRODUCED BY
 SYSTEME HUNTINGDON INC.(DYE-SUBLIMATION ON POWDER-COAT)
 GRAPHICS TO WRAP EDGE
 FINISH: TEXTURED & UV RESISTANT
 UNDERLAY: WHITE, ONE FRONT SIDE IMAGE BACKS:FUMED

 SUBSTRATE: 3/8" ALUMINUM - TOP AND BOTTOM EDGES
 RADIUSED 0.0625" ALL AROUND, CORNERS RADIUSED 0.375".

 WELDED STUDS 5/16"-18 X 1" AND ANTI-VANDAL NUTS (8 PLACES)

 NCC TO PROVIDE ALL GRAPHIC FILES
 AS NATIVE AI FILES OR HI-RES PDF.

PANNEAUX GRAPHIQUES DE TYPE ALTO TELS QUE PRODUITS PAR SYSTÈME
 HUNTINGDON INC. (IMPRESSION PAR SUBLIMATION SUR PEINTURE
 ÉLECTROSTATIQUE EN POUDRE)
 LE GRAPHIQUE DOIT RECOUVRIR ENTIÈREMENT LES CHANTS DU PANNEAU
 FINI TEXTURÉ ET RÉSISTANT AU RAYON U.V.
 COUCHE D'ASSISE BLANCHE SUR LA FACE DE DESSUS
 FANAGE SUR LA SURFACE DE DESSOUS

 PANNEAUX D'ALUMINIUM 3/8", RAYON DE 0.063" SUR TOUTES LES
 ARRÊTES DU CHANT SUPÉRIEUR ET INFÉRIEUR, RAYONS DES COINS 0.375"

 SOUDÉES 5/16"-18X1" AVEC ÉCROUS INVOLABLES (8X/PANNEAU)

 LA CCN FOURNIRA LES FICHIERS À IMPRIMER

**PANELS ARE BY OTHERS /
 PANNEAUX PAR D'AUTRES**

USED ON / UTILISÉ SUR:	
TOLERANCES	
UNLESS OTHERWISE SPECIFIED ALL DIMENSIONS ARE IN INCHES. SAUF SI SPÉCIFICATIONS CONTRAIRE DIMENSIONS SONT EN POUCHES.	
FRACTIONS PART ± 1/32" ASSEM. ± 1/8"	ANGLES ± 1°
CONFORMS TO/ CONFORME À CSA B78.2	

3	07-06-2017	SB		
	Final Design - 100% / Développement à 100%			
2	12-04-2017	SB		
	Final Design - 100% / Développement à 100%			
1	30-03-2017	SB		
	Final Design - 100% / Développement à 100%			
0	11-01-2017	SB		
	Final Design - 90% / Développement à 90%			
REV	DATE	BY/PAR	CHKD/VÉR	EA/RG
REV	DESCRIPTION			



Capital Planning and Real Asset Management Branch
 Direction de l'aménagement de la capitale et gestion de l'immobilier

Design and Construction Division
 Division design et construction

director - Claude Robert - directeur

INDUSTRIAL DESIGN / DESIGN INDUSTRIEL		DATE DD-MM-YYYY JJ-MM-AAAA
CREATED BY CRÉÉ PAR	SB	11-01-2017
CHECKED BY VÉRIFIÉ PAR		
ENGINEERING AUTH. RESP. DU GÉNIE		
PROJECT PROJET	GARDEN OF THE PROVINCES AND TERRITORIES / JARDIN DES PROVINCES ET DES TERRITOIRES	
NCC ID		REV RÉV
TITLE TITRE	GRAPHIC PANELS / PANNEAUX GRAPHIQUES	
SCALE ÉCHELLE	AS NOTED / TELS QU'INDIQUÉ	SHEET FEUILLE
		8 OF DE 8

IP-06

Technical Addendum 1 - SURFACE PREPARATION & PAINTING

1. Surface Preparation

- a. All parts and assemblies, steel or aluminum, shall be brush-off blast cleaned according to SSPC-SP10 (NACE NO.2) commercial blast cleaning as a minimal unless otherwise noted or requested by the paint supplier.
- b. All parts and assemblies surfaces to be washed, rinsed and pre-treated with a ZINC PHOSPHATE coating applied by spray as per industry standards within four (4) hours of blast cleaning.
- c. Final coating system application must meet the following performance specification.

Salt spray	1500 hours	ASTM B-117
Humidity resistance	1500 hours	ASTM D-2247
Adherence		ASTM D-3359-4B
Hardness		ASTM D-3363- 2H
Impact	Direct 160 in.-lb	ASTM D-2794
Colour retention		ASTM D-2244

d. References

- .1 SSPC-Steel Structures Painting Council.
- .2 NACE-National Association of Corrosion Engineers.

2. Coating System Specifications

- a. Provide color samples on metal to the NCC for approval prior to any painting.
- b. Any recommended equivalent coating systems must be submitted to the NCC for approval prior to tender closing.
- c. The following coating system specifications have been developed for this project. All surfaces shall be painted using the following **Evotech** coating system specifications.

Low cure two coat liquid system with clear coat

- (a) Evopox 577-670 with hardener 576-108 epoxy primer. Apply dry film thickness as per coating specification (2.0 mils minimum-4.0 mils maximum)
 - (b) Acrythane 585 with hardener 581-044 acrylic urethane enamel topcoat applied at 1.5-2.0 mils dry film thickness.
 - (c) Acrythane Transpo 587-005 Clear coat with hardener 581-044 applied at 1.5-2.0 mils dry film thickness.
 - (d) The Contractor must provide samples for approval.
-
- d. The liquid coatings selected for this system, are two component materials and can be cured at ambient temperature or forced cured at temperatures of 38° - 60°C (100-140°F).
 - e. The coating system applied as part of this contract will have to be endorsed in writing by the paint Manufacturer prior to any painting.
 - f. An audit of the painting application process will have be provided to the NCC before installation on site which must confirm that the coating system was applied to the Manufacturer's satisfaction.
 - g. Color to be confirmed

3. Touch-up Paint Kit & Maintenance Manual

- a. Provide to the Engineer a complete sample touch up paint kit for on-site repairs for each of the four (4) colors.