

**1.0 GENERAL**

- THE GENERAL CONTRACTOR WILL FAMILIARIZE HIMSELF WITH THE CONTENT OF ALL RELEASED DOCUMENTS, SUCH AS (BUT NOT LIMITED TO):
  - THE TENDER FORM AND APPENDICES;
  - THE INSTRUCTIONS TO BIDDERS;
  - THE GENERAL PROVISIONS OF THE CONTRACT.
- THE WORK FOR THIS CONTRACT IS NOT LIMITED TO THE INDICATIONS SHOWN ON THE PLANS. THE GENERAL CONTRACTOR WILL MAKE THE NECESSARY VERIFICATIONS TO MAKE SURE THAT THE WORK WILL COMPLY WITH TRADE PRACTICES, AS WELL AS THE VARIOUS APPLICABLE STANDARDS. THE GENERAL CONTRACTOR MUST PROVIDE COMPLETE AND OPERATIONAL STRUCTURES.
- THE GENERAL CONTRACTOR WILL VERIFY ON SITE ALL OF THE DIMENSIONS, OBSTACLES OR CONDITIONS THAT MAY AFFECT WORK AND WILL NOTIFY THE ENGINEER OF ANY ANOMALY.
- A SITE VISIT WILL HAVE TAKEN PLACE PRIOR TO BEGINNING WORK IN ORDER TO BECOME FAMILIAR WITH THE ACTUAL SITE CONDITIONS.
- THE GENERAL CONTRACTOR WILL VERIFY ALL OF THE ELEVATIONS, DIMENSIONS AND LEVELS SHOWN ON THE PLANS, AS WELL AS THE ARCHITECTURE PLANS AND THOSE OF THE OTHER SPECIALTIES INVOLVED IN THE CONTRACT (OR TO COME), AND WILL NOTIFY THE ENGINEER OF ANY DISCREPANCY. THE GENERAL CONTRACTOR WILL BE RESPONSIBLE FOR ANY ERROR OR OMISSION CAUSED BY A LACK OF COORDINATION.
- THE GENERAL CONTRACTOR WILL VERIFY THE LOCATION OF ALL PUBLIC UTILITIES THAT MAY BE ON SITE (WATER SYSTEMS, SEWERS, POWER, TELEPHONE, GAS, ETC.) PRIOR TO BEGINNING WORK. HE WILL ALSO PROVIDE EFFECTIVE PROTECTION DURING EXCAVATION WORK. HE WILL ALSO BE LIABLE FOR ANY DAMAGES THAT MAY INCUR TO PUBLIC UTILITIES.
- THESE PLANS WILL NOT BE USED FOR CONSTRUCTION UNLESS THEY ARE ISSUED AS SUCH AND SIGNED AND STAMPED BY THE ENGINEER.
- AT THE END OF THE WORK AND PRIOR TO FINAL ACCEPTANCE, ALL OF THE SCAFFOLDS, WASTE AND TEMPORARY STRUCTURES WILL BE REMOVED FROM THE SITE AND THE SITE WILL BE CLEANED TO THE OWNER'S SATISFACTION. UNLESS OTHERWISE INDICATED IN THESE SPECIFICATIONS, THE LATEST VERSION OF THE STANDARDS OR CODES AT THE TIME OF THE AWARDED OF THE CONTRACT WILL BE USED.
- THE NO. 1809-300/2004 (R 2007) STANDARD DOCUMENT, AS WELL AS THE "CAHIER DES CHARGES ET DEVIS GÉNÉRAUX" OR CC06, ARE AN INTEGRAL PART OF THE PLAN NOTES. THESE DOCUMENTS ARE AVAILABLE FROM THE "BUREAU DES PUBLICATIONS DU QUÉBEC".
- THE GENERAL CONTRACTOR WILL TAKE INTO ACCOUNT THAT CIVIL ENGINEERING WORK WILL BE EXECUTED IN ACCORDANCE WITH THE GENERAL SPECIFICATIONS OF THESE REFERENCE DOCUMENTS. THE LIMITATIONS AND SCOPE OF THESE REFERENCE DOCUMENTS ARE HOWEVER DESCRIBED IN THE SPECIFIC PROVISIONS OF THE PLAN NOTES.
- WHEN NECESSARY, THE REQUIREMENTS OF THE 2010 NATIONAL BUILDING CODE (NBC) WILL APPLY TO THIS PROJECT.
- STORMWATER RETENTION REQUIRES RESPECTING THE ELEVATIONS AND GEOMETRY OF THE PARKING LOTS INDICATED ON THE PLANS.
- ASTERISKS (\*) ON THE PLANS INDICATE THAT THE INFORMATION IN QUESTION IS NOT AVAILABLE OR THAT IT WAS UNRELIABLE WHEN THE PLANS WERE DRAFTED. CONSULT THE ARCHITECTURE, MECHANICAL ENGINEERING AND ELECTRICITY PLANS, IF NECESSARY, OR THE PLANS OF ANY OTHER SPECIALTY.
- FOR ANY WORK THAT MAY DISTURB THE NORMAL ACTIVITIES TAKING PLACE IN THE BUILDING, THE GENERAL CONTRACTOR WILL PROVIDE THE OWNER WITH A WRITTEN REQUEST TO PROCEED, WHICH WILL INCLUDE THE NATURE OF THE WORK TO BE EXECUTED.

- 1.1. LABORATORY**
- THE SPECIFIC REQUIREMENTS RELATED TO THE INSPECTIONS AND TESTING THAT WILL BE CARRIED OUT BY THE LABORATORY DESIGNATED BY THE OWNER ARE DESCRIBED IN VARIOUS SECTIONS.
  - IF INSPECTIONS OR TESTING BY THE LABORATORY REVEAL THAT THE WORK DOES NOT COMPLY WITH THE REQUIREMENTS OF THE CONTRACT, THE GENERAL CONTRACTOR WILL PAY FOR THE ADDITIONAL TESTING THAT MAY BE REQUIRED BY THE ENGINEER IN ORDER TO VERIFY THE ACCEPTABILITY OF THE CORRECTIVE ACTIONS.
  - THE GENERAL CONTRACTOR WILL COORDINATE THE VISITS FROM LABORATORY REPRESENTATIVES WITHIN A REASONABLE TIMEFRAME IN ORDER TO ENSURE THAT THE LABORATORY'S STAFF IS AVAILABLE AT THE OPPORTUNE TIME.

- 1.2. OWNER**
- THE DEPARTMENTAL REPRESENTATIVE WILL SECURE ALL OF THE RIGHTS-OF-WAY AND LAND ACQUISITIONS REQUIRED FOR THE EXECUTION OF THE WORK.

**2.0 SCOPE OF WORK**

- ANY INFORMATION NOT SHOWN ON THE PLANS, BUT NECESSARY FOR THE EXECUTION OF THE WORK, WILL BE INCLUDED IN THE GENERAL CONTRACTOR'S GLOBAL PRICE.

**3.0 SHOP DRAWINGS, SUBSTITUTIONS AND EQUIVALENCES**

- THE SHOP DRAWINGS, PRODUCT DESCRIPTIONS AND PRESCRIBED SAMPLES WILL BE SUBMITTED TO THE ENGINEER FOR COMMENTS. THE SHOP DRAWINGS AND/OR TECHNICAL DATA SHEETS WILL BE PROVIDED TO THE ENGINEER BY EMAIL IN PDF FORMAT SO THAT HE CAN STAMP THEM.
- THE SHOP DRAWING CONTROL PROCEDURE ONLY AIMS TO ALLOW THE ENGINEER TO FAMILIARIZE HIMSELF WITH THE GENERAL CONFORMITY OF THE WORK VERSUS THE CONTRACTUAL REQUIREMENTS. THE COMMENTS AND/OR CORRECTIONS MADE REGARDING THESE DRAWINGS DO NOT RELEASE THE GENERAL CONTRACTOR FROM HIS OBLIGATION TO COMPLY WITH ALL OF THE CONTRACTUAL REQUIREMENTS, NOR DO THEY CONSTITUTE A CAUTION OR APPROVAL SHOULD THERE BE A DEROGATION OF THE REQUIREMENTS.
- THE GENERAL CONTRACTOR IS NOT RELEASED FROM HIS RESPONSIBILITY REGARDING ERRORS OR OMISSIONS IN THE SUBMITTED DOCUMENTS, EVEN IF THE ENGINEER VERIFIES THE SAID DOCUMENTS.
- UNDERTAKING WORK FOR WHICH THE SHOP DRAWINGS, SAMPLES AND PRODUCT DESCRIPTIONS HAVE NOT BEEN RETURNED AND COMMENTED BY THE ENGINEER IS AT THE GENERAL CONTRACTOR'S OWN RISK.
- NEW SHOP DRAWINGS WILL BE SUBMITTED PRIOR TO MAKING ANY MODIFICATION FROM SHOP DRAWINGS PREVIOUSLY STAMPED.
- THE ENGINEER WILL RETURN THE SHOP DRAWINGS SENT TO HIM, WITH OR WITHOUT ANNOTATIONS, WITHIN FIVE (5) BUSINESS DAYS FOLLOWING THE RECEPTION OF SAID DRAWINGS.
- EXECUTION AND ASSEMBLY DRAWINGS WILL SHOW THE CONFIGURATION AND DIMENSIONS OF THE EQUIPMENT, AS WELL AS ALL OF THE TECHNICAL DETAILS THAT WILL ALLOW THE ASSESSMENT OF THE QUALITY AND PERFORMANCE OF THE EQUIPMENT SUBMITTED. THE DRAWINGS WILL SHOW ONLY THE EQUIPMENT SPECIFICALLY REQUIRED FOR THIS CONTRACT.
- THE SHOP DRAWINGS RELATED TO STRUCTURES WHICH REQUIRED ENGINEERING CALCULATIONS IN ORDER TO BE BUILT WILL BE SIGNED AND STAMPED BY AN ENGINEER CERTIFIED BY THE "ORDRE DES INGÉNIEURS DU QUÉBEC". ANY REQUEST FOR MATERIAL SUBSTITUTION OR EQUIVALENCY WILL BE SUBMITTED TO THE ENGINEER. WHEN SUCH A REQUEST IS MADE BY THE GENERAL CONTRACTOR, THE LATTER WILL PROVE THAT THE MATERIAL IS INDEED EQUIVALENT AND PAY FOR THE COSTS.

**4.0 ENVIRONMENT PROTECTION**

- 4.1. GENERAL**
- AT ALL TIMES, THE GENERAL CONTRACTOR WILL HAVE AT HAND AN EMERGENCY KIT FOR THE RECOVERY OF PETROLEUM PRODUCTS, WHICH WILL INCLUDE CONFINEMENT SAUSAGES, ABSORBENT ROLLS, SPHAGNUM MOSS, AS WELL AS CONTAINERS AND RELATED ACCESSORIES (GLOVES, ETC.) ESSENTIAL TO ADDRESS SMALL SCALE ACCIDENTAL SPILLS AND TO ENSURE THE RECOVERY AND STORAGE OF SOILED MATERIAL AND THE MANAGEMENT OF CONTAMINATED SOIL AND MATERIALS.
  - THE GENERAL CONTRACTOR WILL NOT THROW AWAY, SPILL OR RELEASE ORGANIC OR INORGANIC MATERIALS, INCLUDING PETROLEUM PRODUCTS AND BY-PRODUCTS (ANTIFREEZE OR SOLVENTS), IN THE SOIL OR WATER COURSES. THESE SUBSTANCES WILL BE RECOVERED AT THE SOURCE AND ELIMINATED IN ACCORDANCE WITH THE POLICES AND REGULATIONS OF THE "MINISTÈRE DU DÉVELOPPEMENT DURABLE, DE L'ENVIRONNEMENT ET DE LA LUTTE CONTRE LES CHANGEMENTS CLIMATIQUES" OR MDDELCC (THE QUEBEC GOVERNMENT AUTHORITY ON THE ENVIRONMENT) AND AS APPROVED BY THE CLIENT.
  - THE MANAGEMENT AND DISPOSAL OF WASTE WILL BE CONDUCTED IN ACCORDANCE WITH THE REGULATION ON SOLID WASTE, THE REGULATION ON THE BURIAL AND INCINERATION OF RESIDUAL MATERIALS, THE REGULATION ON HAZARDOUS MATERIALS, THE POLICY FOR THE PROTECTION OF RIVER BANKS AND FLOOD PLAINS, IF APPLICABLE, AND THE ENVIRONMENT QUALITY ACT (L.R.Q. C. 92).
  - SHOULD CONTAMINATED SOILS BE DISCOVERED AT THE WORK SITE, WORK WILL BE STOPPED IMMEDIATELY AND THE ENGINEER WILL BE NOTIFIED WITHOUT DELAY SO THAT HE MAY PROVIDE THE GENERAL CONTRACTOR WITH A PROCEDURE FOR THE MANAGEMENT OF THESE SOILS, IN ACCORDANCE WITH THE SOIL PROTECTION AND CONTAMINATED LAND REHABILITATION POLICY, AS WELL AS THE REGULATION ON LAND PROTECTION AND REHABILITATION.
  - IN EVERY CASE OF ENVIRONMENTAL EMERGENCIES, THE "URGENCE-ENVIRONNEMENT" EMERGENCY INTERVENTION TEAM WILL BE NOTIFIED VIA THE FOLLOWING TOLL FREE NUMBER: **1 866 694-5454**
  - FIRES AND THE BURNING OF WASTE AT THE CONSTRUCTION SITE IS STRICTLY PROHIBITED.
  - ALL OF THE PERMITS REQUIRED FOR OPERATION AND THROUGH CONTRACTUAL OBLIGATION WILL BE OBTAINED. WORK WILL NOT TAKE PLACE IN THE RIPARIAN STRIPS UNLESS AUTHORIZED BY THE MDDELCC.

**5.0 DEMOLITION WORK**

- REFER TO THE CONTRACTUAL DOCUMENTS TO ASCERTAIN THE EXTENT OF THE DEMOLITION WORK.
- REMOVED EQUIPMENT AND ACCESSORIES THAT WILL NOT BE REUSED WILL BE PRESENTED TO THE OWNER. SHOULD THE LATTER DECIDE NOT TO KEEP THEM, THEY WILL BECOME THE PROPERTY OF THE GENERAL CONTRACTOR, WHO WILL REMOVE THEM FROM THE SITE AND DISPOSE OF THEM IN APPROPRIATE LOCATIONS. IF THEY CAN BE REUSED BUT THE OWNER DOES NOT WISH TO USE THEM, THEY WILL BE CONSIDERED AS WASTE AND WILL BE ELIMINATED.
- A VIDEO SURVEY OF SITE CONDITIONS WILL BE MADE PRIOR TO BEGINNING WORK. THE GENERAL CONTRACTOR WILL PROVIDE THREE (3) COPIES OF THE VIDEO SURVEY NO MORE THAN THREE DAYS AFTER THE RECORDING, I.E. THE CLIENT WILL BE PROVIDED WITH ONE (1) COPY AND THE ENGINEER WILL BE PROVIDED WITH TWO (2) COPIES.
- ALL OF THE NECESSARY MEASURES TO AVOID ANY DISPLACEMENT OR COLLAPSE OF THE STRUCTURES, SERVICES, ALLEYS, PAVEMENTS OR PARTS OF ADJACENT BUILDINGS WILL BE TAKEN. THE DEVICES REQUIRED FOR REINFORCEMENT AND SHORING AND TO EXECUTE UNDERPINNING WORK WILL BE PROVIDED AND INSTALLED, IF REQUIRED. DAMAGED STRUCTURES WILL BE REPAIRED AND THE GENERAL CONTRACTOR WILL TAKE RESPONSIBILITY FOR PERSONAL INJURIES THAT MAY BE CAUSED BY DEMOLITION WORK.

**6.0 EXCAVATION AND FILL WORK**

- 6.1. GENERAL**
- PROVIDE THE LABOUR, EQUIPMENT AND MATERIAL NECESSARY FOR ALL OF THE EXCAVATION AND FILL WORK REQUIRED FOR THE COMPLETION OF THE WORK DESCRIBED IN THE TENDER DOCUMENTS.
  - EXECUTE THE EXCAVATION AND FILL WORK IN ACCORDANCE WITH ARTICLE 9 OF THE NO. 1809-300 STANDARD.
- 6.2. SITE CHARACTERISATION**
- THE GENERAL CONTRACTOR WILL BE HELD ENTIRELY RESPONSIBLE FOR THE USE OR INTERPRETATION OF THE GEOTECHNICAL STUDY REPORT.
- 6.3. PUBLIC UTILITIES AND NETWORKS**
- KNOWN PUBLIC UTILITIES NETWORKS, BURIED OR NOT (WATER SYSTEMS, SEWERS, POWER, TELEPHONE, GAS, ETC.) WILL BE INDICATED ON THE PLANS. HOWEVER, THE ACCURACY OF THEIR LOCATION IS NOT GUARANTEED, AND NEITHER IS THE INFORMATION RELATING TO THE TOTALITY OF THE NETWORKS. AT HIS OWN EXPENSE, THE GENERAL CONTRACTOR WILL UNDERTAKE ALL OF THE PRE-EXCAVATION WORK REQUIRED TO CONFIRM THE LOCATION OF THE EXISTING PUBLIC UTILITIES PRIOR TO THE BEGINNING OF THE EXCAVATION WORK.
  - REFER TO SPECIFIC SERVICE SUPPLIERS FOR SPECIFIC PROTECTION METHODS, IF APPLICABLE.
  - WATER SYSTEMS AND SEWERS WILL REMAIN OPERATIONAL FOR THE ENTIRE DURATION OF THE WORK. SERVICE INTERRUPTIONS REQUIRE A WRITTEN AUTHORISATION FROM THE OWNER OF THE SERVICE.
  - THE EXISTING NETWORKS THAT MUST REMAIN OPERATIONAL, AS INDICATED ON THE PLANS, WILL BE PRESERVED, MOVED AND RECOMMISSIONED. ALL OF THE EXPENSES RELATED TO THIS WORK WILL BE PAID BY THE GENERAL CONTRACTOR.
  - ANY PUBLIC UTILITIES NETWORK DAMAGED DURING THE WORK WILL BE REPAIRED AND THE EXPENSE WILL BE PAID FOR BY THE GENERAL CONTRACTOR. THE LATTER WILL MAKE SURE THAT THE OWNER OF THE SERVICE (CITY, PRIVATE COMPANY, ETC.) WILL ACCEPT THE REPAIR WORK.

**6.4. MATERIAL**

- ALL MATERIALS MUST COME FROM AUTHORIZED SITES AS PER THE "RÈGLEMENT SUR LES CARRIÈRES ET SABLIERES" (QUEBEC REGULATION ON QUARRIES AND SAND PITS) AT ALL TIMES. THE GENERAL CONTRACTOR WILL COMPLY WITH THE ENVIRONMENT QUALITY ACT (L.R.Q. C. 92) AND WITH THE "RÈGLEMENT SUR LES CARRIÈRES ET SABLIERES" (QUEBEC REGULATION ON QUARRIES AND SAND PITS).
- GRANULAR MATERIAL (CG-14, CG-56) FOR CUSHION LAYERS, COATING, SEPARATION LAYERS AND FILTERING LAYERS FOR CONDUITS AND CIVIL ENGINEERING STRUCTURES WILL COMPLY WITH THE NO. 2560-114 STANDARD, PART II, FROM THE "BUREAU DE NORMALISATION DU QUÉBEC".
- GEOTEXTILE MEMBRANE FOR CUSHION LAYER (BED); NON WOVEN SYNTHETIC FIBER FABRIC CONSISTING OF POLYPROPYLENE OR POLYESTER.
- CLASS "B" GRANULAR BORROW MATERIAL FOR COMPLEMENTARY TRENCH EMBANKMENT AND THE FILLING OF TRANSITION ZONES AND OVEREXCAVATION UNDER THE INFRASTRUCTURE, IN ACCORDANCE WITH THE FOLLOWING GRANULOMETRY:
 

SEIVE	% PASSING
200 MM	100
112 MM	80-100
5 MM 35-70	
80 µm	0-12

 FOR THE LAST 300 MM UNDER THE INFRASTRUCTURE'S LINE, 100% OF THE GRANULAR BORROW MATERIAL MUST PASS THROUGH THE 112 MM SIEVE.
- UNSHRINKABLE FILL WILL HAVE THE FOLLOWING CHARACTERISTICS:
  - CEMENT TYPE: 10 WITH SUPPLEMENTARY CEMENTING MATERIAL (GUB OR GU-SF)
  - COMPRESSION STRENGTH AT 28 DAYS: 1.0 MPA MAXIMUM
  - MAXIMUM CEMENT CONTENT: 25 KG/M<sup>3</sup> (1% OF THE VOLUME)

**6.5. EXECUTION**

- AT HIS OWN EXPENSE, THE GENERAL CONTRACTOR WILL ESTABLISH THE PROFILES AND ALIGNMENTS REQUIRED TO COMPLETE THE WORK. IF THE INFORMATION ON THE PLANS DO NOT PERMIT THE IDENTIFICATION OF THE LOCATIONS, ENQUIRE ABOUT THE MARKS AND REFERENCES TO BE USED.
- THE GENERAL CONTRACTOR WILL TAKE ALL OF THE NECESSARY ACTIONS TO AVOID ANY DISPLACEMENT OR COLLAPSE OF THE STRUCTURES, SERVICES, ALLEYS, PAVEMENTS, TREES, LANDSCAPING, SOILS AND ADJACENT BUILDINGS. PROVIDE AND INSTALL THE EQUIPMENT REQUIRED FOR REINFORCEMENT AND SHORING AND TO EXECUTE UNDERPINNING WORK IF REQUIRED. THE GENERAL CONTRACTOR WILL REPAIR THE DAMAGED STRUCTURES AND TAKE RESPONSIBILITY FOR PERSONAL INJURIES THAT MAY BE CAUSED BY THE DEMOLITION, EXCAVATION AND FILLING WORK.
- UP UNTIL THE END OF THE WORK, THE GENERAL CONTRACTOR WILL PROVIDE AND IMPLEMENT ALL OF THE PROTECTION MEASURES REQUIRED TO AVOID THE FREEZING OF THE SOIL AND OF THE FILLING UNDER THE FOUNDATIONS, FUTURE AND/OR TO BE BUILT SLABS-ON-GRADE AND OTHER STRUCTURES.

**6.6. SITE PREPARATION**

- REMOVE OBSTACLES, SNOW AND ICE FROM THE EXCAVATION AREA.
- REMOVE THE TOP SOIL FROM THE CONSTRUCTION AREAS.
- REGARDING DRY MATERIALS (PAVEMENT, CONCRETE, PIPES, STUMPS, TREES, SHRUBS, ETC.), COMPLY WITH ARTICLES 4 AND 9.1.10 OF THE NO. 1809-300 STANDARD.
- PLACE THE FILLING MATERIAL AND THE TOP SOIL THAT MAY BE REUSED IN PILES. STOCKPILE THE GRANULAR MATERIAL IN SUCH A WAY AS TO AVOID SEGREGATION. PROTECT THE PILES OF MATERIAL AGAINST ANY CONTAMINATION AND/OR SEGREGATION.

**6.7. EXCAVATION**

- COMPLY WITH THE REQUIREMENTS OF ARTICLE 9.1.3 OF THE NO. 1809-300 STANDARD REGARDING THE SLOPES OF ALL EXCAVATIONS, NOT ONLY TRENCHES. THE SLOPES OF THE EXCAVATIONS MUST COMPLY WITH THE REQUIREMENTS OF THE "COMMISSION DES NORMES, DE L'ÉQUITÉ, DE LA SANTÉ ET DE LA SÉCURITÉ DU TRAVAIL DU QUÉBEC" (CNESST).
- THE BOTTOM OF THE EXCAVATIONS WILL BE LEVELLED AND CONSIST OF DRY UNDISTURBED SOIL FREE OF LOOSE ORGANIC MATERIAL, ICE OR SNOW. PROVIDE, INSTALL AND MAINTAIN THE OPERATION OF TEMPORARY DRAINS AND PUMP WATER WHEN REQUIRED.
- DO NOT DISTURB THE 45° WEDGE-SHAPED SOIL UNDER THE FOOTINGS.
- THE GENERAL CONTRACTOR WILL TAKE RESPONSIBILITY FOR THE CONTROL AND EVACUATION OF RUNOFF WATER, SNOW MELT, GROUND WATER, SEWER WATER OR WATER FROM ANY OTHER SOURCE AT THE CONSTRUCTION SITE IN ORDER TO ALLOW THE EXECUTION OF WORK. AT HIS OWN EXPENSE, THE GENERAL CONTRACTOR WILL REPAIR ANY DAMAGES CAUSED BY WATER, NO MATTER THE SOURCE.
- WHEN THE SOIL AT THE BOTTOM OF THE EXCAVATIONS HAS BEEN DISTURBED BUT REMAINS STABLE, COMPACT THE BOTTOM OF THE EXCAVATIONS OR THE EXCAVATED MATERIAL TO A VOLUME MASS AT LEAST EQUAL TO THAT OF UNDISTURBED SOIL.
- WHEN THE MATERIAL AT THE BOTTOM OF THE EXCAVATIONS HAS BEEN DISTURBED BUT IS UNSTABLE, REPLACE THE UNSTABLE MATERIAL WITH THAT WHICH IS DESCRIBED IN THE SUB-SECTION PERTAINING TO FILL WORK.
- IF THE EXCAVATION IS TOO DEEP OR IF THE BOTTOM IS UNEVEN, LEVEL THE BOTTOM AND FILL WITH THE MATERIAL DESCRIBED IN THE SUB-SECTION ON FILL WORK IN ORDER TO OBTAIN THE LEVELS REQUIRED IN THE TENDER DOCUMENTS.

**6.8. FILL WORK**

- THE GRANULAR FILL TO BE CREATED WILL COMPLY WITH ARTICLE 9.2 OF THE NO. 1809-300 STANDARD.
- AT HIS OWN EXPENSE, THE GENERAL CONTRACTOR WILL PROVIDE THE LABORATORY HIRED BY THE OWNER WITH A RECENT SIEVE ANALYSIS CONDUCTED BY A RECOGNIZED LABORATORY FOR EACH PROPOSED BORROWED MATERIAL.
- ANTICIPATE A MINIMUM DELAY OF ONE (1) WEEK FOR THE LABORATORY TO APPROVE OF THE BORROWED FILLING MATERIAL AND AGGREGATES.
- THE SURFACES TO FILL WILL BE FREE OF DEBRIS, SNOW, ICE, WATER, STRAW OR FROZEN SOIL. THE FILLING MATERIAL WILL NOT CONTAIN FROZEN ELEMENTS, ICE, SNOW OR DEBRIS.
- FILLING IS TO TAKE PLACE SIMULTANEOUSLY ON BOTH SIDES OF WALLS OR OTHER STRUCTURAL ELEMENTS IN ORDER TO ENSURE THAT THE PRESSURES ON BOTH SIDES WILL CANCEL EACH OTHER.
- EXECUTE FILL WORK IN ACCORDANCE WITH THE LEVELS, PROFILES AND ALIGNMENTS INDICATED, WHILE TAKING INTO CONSIDERATION THE TYPE OF WORK TO BE CARRIED OUT AT THE SURFACE AND THE DEPTH OF THE FOUNDATION MATERIAL UNDER THE STRUCTURE.
- AT THE END OF FILL WORK, IF TESTS SHOW THAT THE MATERIAL DOES NOT COMPLY WITH THE REQUIREMENTS OF THESE SPECIFICATIONS, THE UNACCEPTABLE MATERIAL IS TO BE REMOVED AND REPLACED, AT NO ADDITIONAL COST, AND TESTED AGAIN.
- WHEN EXCAVATION IS COMPLETE, ALL OF THE BANKS MUST BE STABILIZED DURING AND AFTER THE EXECUTION OF THIS CONTRACT.
- SOODED OR CULTIVATED LAND WILL BE SUBJECTED TO THE PROVISIONS OF ARTICLE 9.2.4.1 (NO. 1809-300 STANDARD), WITH THE EXCEPTION OF COMPACTION, THE REQUIREMENTS OF WHICH AIM TO AVOID COLLAPSE AFTER FILLING WORK CAUSED BY THE COMPACTION OF THE FIRST METER OF MATERIAL ABOVE PIPES BY CONSTRUCTION MACHINERY.
- FOR BUILDING FOUNDATION SITTING DIRECTLY ON ROCK, INSTALL A 150MM THICK LAYER OF GRANULAR MATERIAL SPECIFIED AT SECTION 2.1.3 COMPACTED AT 98% OF ITS MAXIMUM DRY VOLUMINAL MASS. AT LOCATION WHERE THE DISTANCE BETWEEN THE ROCK ELEVATION AND THE BOTTOM OF FOUNDATION IS LOWER THAN 150MM, FILL THE GAP WITH LEAN CONCRETE.
- FOR BUILDING FOUNDATION AND SLAB ON GRADE NOT SITTING ON THE ROCK, FILL UP TO 150MM UNDER WORKS WITH A GRANULAR MATERIAL SPECIFIED AT SECTION 2.1.3 BY MAXIMUM SUCCESSIVE LAYERS OF 300MM COMPACTED AT 98% OF ITS MAXIMUM DRY VOLUMINAL MASS.
- FOR WORK UNDER EXISTING STRUCTURES (CONCRETE BANKS, ETC.) WHERE COMPACTION CANNOT TAKE PLACE, BUILD AN UNSHRINKABLE BACKFILL IN ACCORDANCE WITH ARTICLE 2.1.7 AND WITH THE SPECIFICATIONS O OF ARTICLE 9.2.6.2 OF THE NO. 1809-300 STANDARD.

**6.9. CLEANING AND SITE RESTORATION**

- ANY WASTE AND SURPLUS MATERIAL FROM THE WORK WILL BE REMOVED FROM THE SITE ON A REGULAR BASIS IN ORDER TO AVOID ACCUMULATION. AT THE END OF THE WORK, THE SITE WILL BE CLEAN.

**2. INASMUCH AS POSSIBLE, THE GENERAL CONTRACTOR WILL KEEP THE STREETS HE WILL USE TO REMOVE WASTE, RECEIVE MATERIAL OR SATISFY ANY OF HIS CONSTRUCTION SITE NEEDS, AS CLEAN AS POSSIBLE. IF REQUIRED BY THE CITY AND/OR THE ENGINEER, HE WILL CARRY OUT DAILY CLEANING IN DUSTY AREAS, HE WILL APPLY A DUST CONTROL LIQUID REGULARLY IN ORDER TO REDUCE INCONVENIENCE TO NEARBY RESIDENTS OR NEAR THE ROADS USED BY HIS VEHICLES.**

- ALL OF THE STRUCTURES AND ELEMENTS (DITCH, DRIVEWAY ENTRANCES, LANDSCAPING, CURBS, SIDEWALKS, ETC.) AFFECTED BY THE WORK WILL BE REPAIRED AND RESTORED.

**Canada**

Parcs Canada Parks Canada

Gestion des biens et réalisation de projets Asset Management and Project Delivery

Région du Québec Quebec Region



03	ISSUED FOR TENDER	21-07-2017
02	99% - POUR COMMENTAIRES	07-07-2017
01	50% - POUR COMMENTAIRES	26-05-2017
révisions	description	date

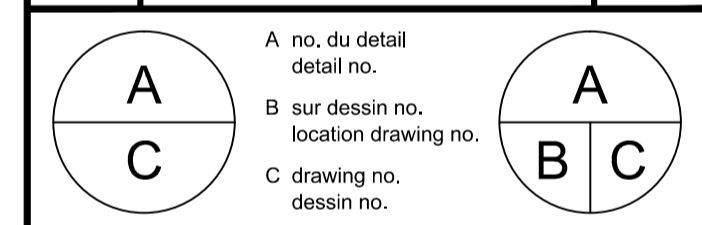

Projet *Project*

**PARK CANADA**  
FORILLON NATIONAL PARK  
GRANDE-GRAVE REGION

**REFECTION OF**  
**BLANCHETTE ENSEMBLE**

Dessin *Drawing*

**CIVIL**

**GENERAL NOTES**

Conçu par	V. CANTIN	Designed By
Date		(yyyy/mm/dd)
Dessiné par	G. BOURGAULT	Drawn By
Date		(yyyy/mm/dd)
Examiné par	F. GAMACHE	Reviewed By
Date		(yyyy/mm/dd)
Approuvé par	M. BOUCHARD	Approved By
Date		(yyyy/mm/dd)

No. du projet	1413-4	<i>Project no.</i>
APC		<i>PCA</i>
No. du dessin	C01	<i>Drawing no.</i>
C01-GL-NOT-1413-4.DWG		C01

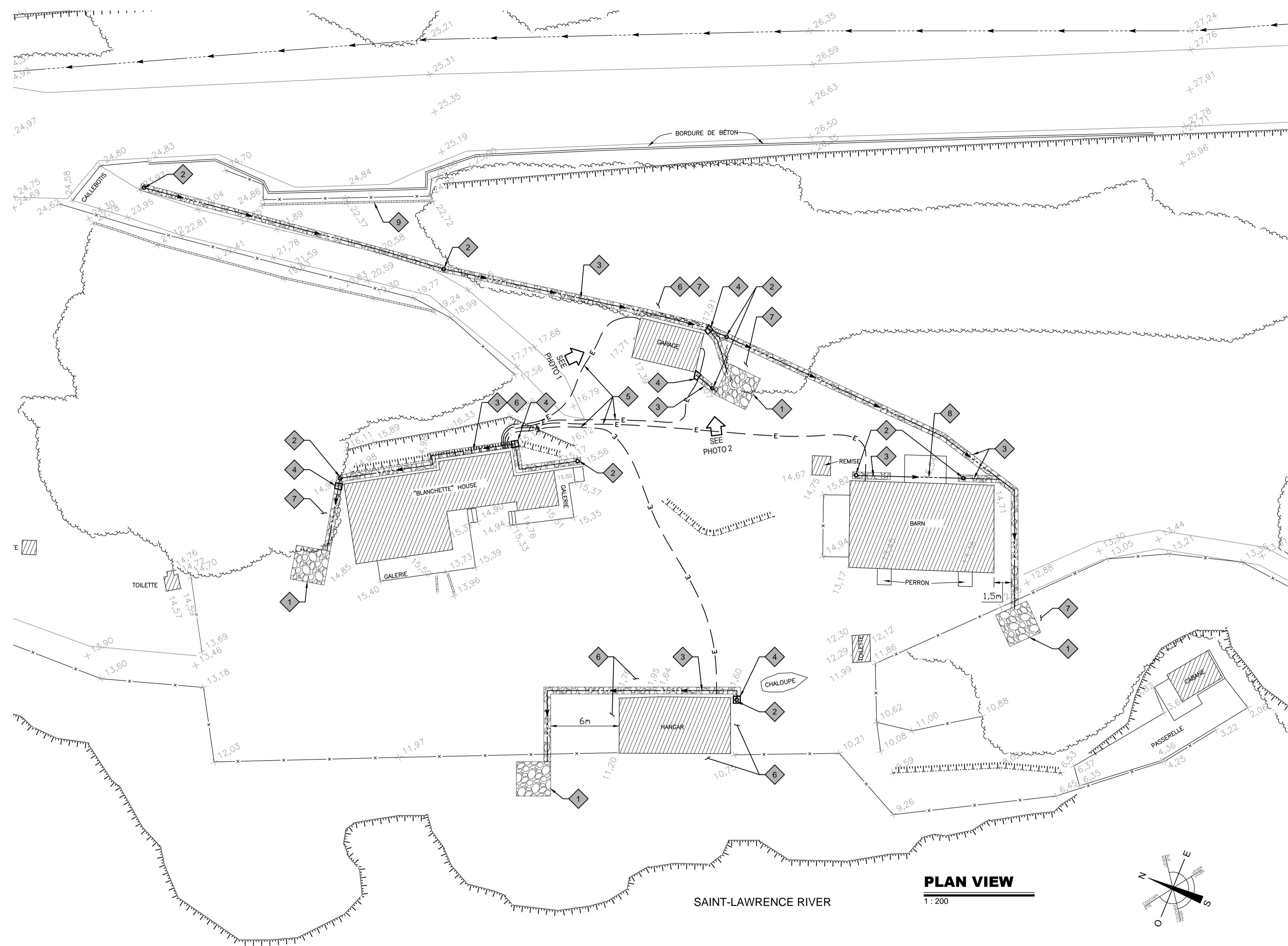

**PLAN VIEW**  
1 : 200

SAINT-LAWRENCE RIVER

**LEGEND**  
**EXISTING ELEMENTS**

- LAND LOT
- PERMANENT RIGHT-OF-WAY
- + 56,000 ELEVATION OF THE NATURAL TERRAIN
- SUMP
- P --- MANHOLE AND STORMWATER SEWER PIPE
- F --- PERFORATED DRAIN PIPE
- S --- MANHOLE AND SANITARY SEWER PIPE
- A --- DRINKING WATER PIPE
- ⊗ GATE
- ⊙ POST-TYPE HYDRANT
- ⊗ GATE
- C --- MANHOLE AND COMBINED SEWER PIPE
- ▨ DITCH
- INFILTRATION / DRAINAGE BRANCH
- TOP OF BANK
- BOTTOM OF BANK
- RETAINING WALL
- OVERHEAD POWER / TELEPHONE LINE
- E --- UNDERGROUND POWER / TELEPHONE LINE
- POWER TRANSMISSION / TELEPHONE POLE
- FENCE
- EDGE OF WOOD
- CURB
- ▨ EXISTING BUILDINGS

**NEW ELEMENTS**

- ◀ XX.XX ELEVATION OF THE FINISHED GRADE
- ⊗ CONCRETE MANHOLE / SUMP
- CONCRETE SUMP
- P --- MANHOLE AND STORMWATER SEWER PIPE
- F --- PERFORATED DRAIN
- A --- DRINKING WATER PIPE
- ⊗ GATE
- S --- MANHOLE AND SANITARY SEWER PIPE
- ▨ DITCH
- TRENCH / BRANCH
- TOP OF BANK
- BOTTOM OF BANK
- ▨ FUTUR BUILDING
- OVERHEAD POWER / TELEPHONE LINE
- E --- UNDERGROUND POWER / TELEPHONE LINE
- ▨ ROCK BALLAST
- ▨ GRAVEL
- GRASS AREA SEE ARCH.

**SPECIFIC NOTES - CONSTRUCTION**

- 1 INFILTRATION BASIN 3000x3000x600, SEE DETAIL SHEET C03
- 2 CLEAN OUT DRAIN, SEE DETAIL SHEET C03
- 3 DRAINAGE DITCH, SEE DETAIL SHEET C03. INSTALL DRAIN WITH MIN. 1% SLOPE LEADING TO INFILTRATION BASIN.
- 4 ±800x800 GUTTER CAPTATION BASIN (CONTINUITY OF DRAINAGE DITCH), SEE TYPICAL DETAIL.
- 5 TRENCH FOR ELECTRIC CONDUITS, SEE TYPICAL DETAIL, LOCATION SEE SHEET E01.
- 6 AJUST GROUND LEVEL AREA IN ORDER TO INSTALL THE DRAINAGE DITCH AND CLEAR THE BOTTOM OF THE BUILDING EXTERIOR FINISH (SEE ARCHITECTURE).
- 7 WOODED AREA TO DEMOLISH FOR THE INSTALLATION OF THE DRAINAGE DITCH AND INFILTRATION BASIN. REPAIR THE AREA WITH TURF AND SOIL.
- 8 Ø150mm UNPERFORATED DRAIN TO CONNECT TO INFILTRATION DITCH PERFORATED DRAIN IN THE GROUND RAISED AREA (SEE ARCHITECTURE).
- 9 DAMAGED DRY STONE RETAINING WALL TO PROTECT. THE CONTRACTOR SHALL PUT IN PLACE A SHORING METHOD SIGNED AND SEALED BY AN ENGINEER FOR WORKS DURATIONS.

\* EXCEPT INDICATED OTHERWISE, REPAIR EVERY EXCAVATED AND GROUND AREAS WITH A MINIMUM OF 150mm THICK SOIL AND TURF (INCLUDING DRAINAGE DITCH, EXCAVATION AROUND BUILDINGS, ANT TRANCHÉE DRAINANTE, EXCAVATION AU POURTOUR DES BÂTIEMENTS, REPROFILAGE, ETC.).

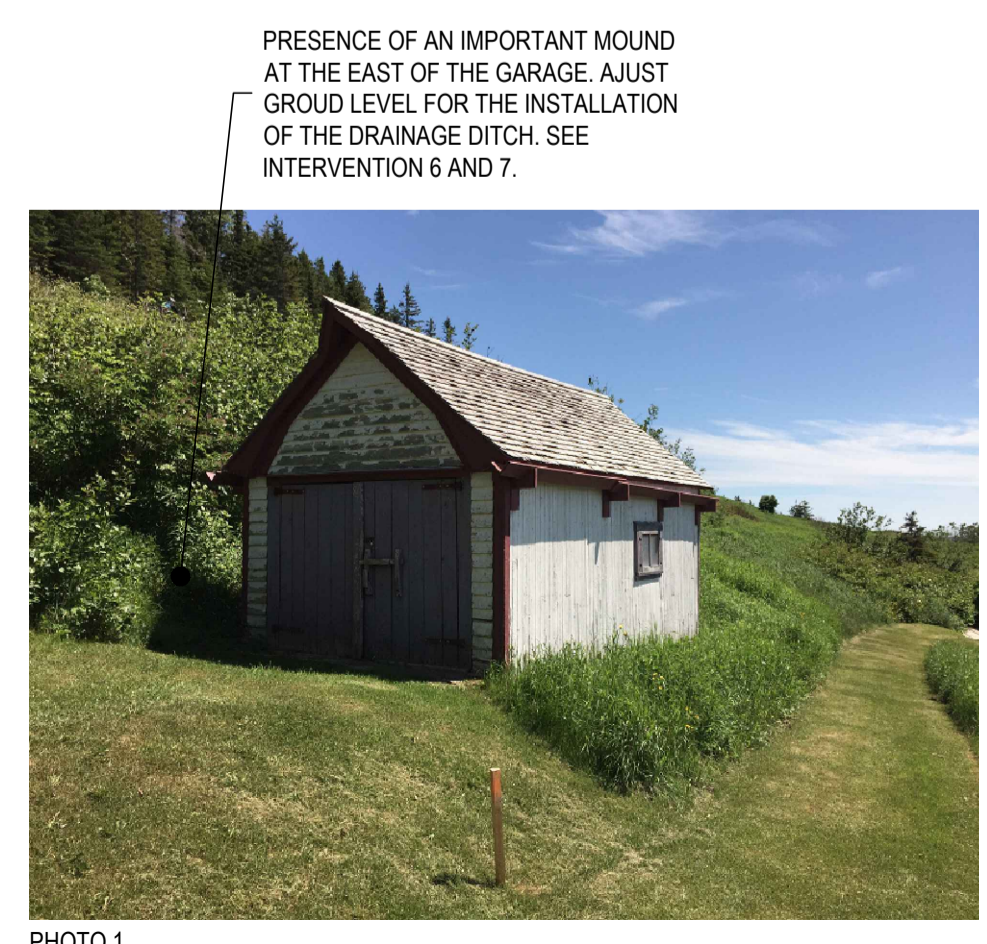

PHOTO 1

PRESENCE OF AN IMPORTANT MOUND AT THE EAST OF THE GARAGE. AJUST GROUND LEVEL FOR THE INSTALLATION OF THE DRAINAGE DITCH. SEE INTERVENTION 6 AND 7.



PHOTO 2

PRESENCE OF AN IMPORTANT MOUND AT THE EAST OF THE GARAGE. AJUST GROUND LEVEL FOR THE INSTALLATION OF THE DRAINAGE DITCH. SEE INTERVENTION 6 AND 7.

**Canada**

Parcs Canada Parks Canada  
Gestion des biens et réalisation de projets Asset Management and Project Delivery  
Région du Québec Quebec Region

03	ISSUED FOR TENDER	21-07-2017
02	99% - POUR COMMENTAIRES	07-07-2017
01	50% - POUR COMMENTAIRES	26-05-2017
révisions / revisions		
	description	date

A  
C

A  
B C

Projet **PARK CANADA FORILLON NATIONAL PARK GRANDE-GRAVE REGION**

REFECTION OF BLANCHETTE ENSEMBLE

Dessin **CIVIL** Drawing

**INTERVENTION PLAN**

Conçu par	V. CANTIN	Designed By
Date		(yyyy/mm/dd)
Dessiné par	G. BOURGAULT	Drawn By
Date		(yyyy/mm/dd)
Examiné par	F. GAMACHE	Reviewed By
Date		(yyyy/mm/dd)
Approuvé par	M. BOUCHARD	Approved By
Date		(yyyy/mm/dd)

No. du projet **1413-4** Project no.

APC **PCA**

No. du dessin **C02-GL-PLN-1413-4.DWG** Drawing no. **C02**

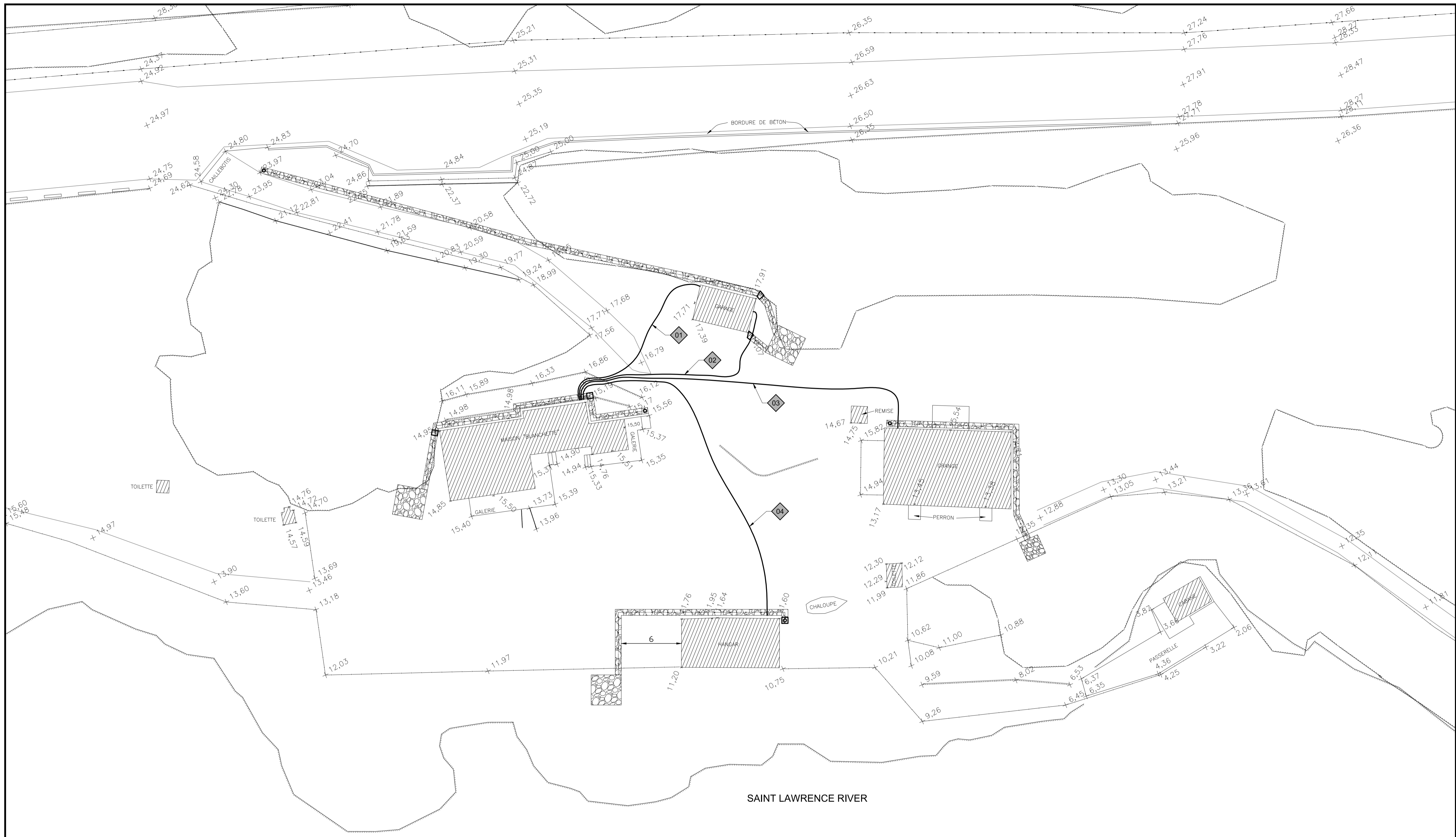

**PLAN VIEW**  
1:200

**SPECIFIC NOTES - DEMOLITION AND CONSTRUCTION**

- 01** REMOVE THE EXISTING POWER CABLE BETWEEN THE GARAGE AND THE HOUSE (EXACT LOCATION TO BE COORDINATED ON SITE). PROVIDE, INSTALL AND CONNECT A NEW 3#3 TECK90 ELECTRICAL CABLE BETWEEN THE GARAGE MAIN SECURITY SWITCH AND THE HOUSE DISTRIBUTION PANEL. THE LOCATION OF THE NEW CABLE IS APPROXIMATE AND SHOULD BE COORDINATED ON SITE BASED ON THE EXISTING CONSTRAINTS.
- 02** REMOVE THE EXISTING POWER CABLE BETWEEN THE HOUSE AND THE GARAGE (EXACT LOCATION TO BE COORDINATED ON SITE). PROVIDE, INSTALL AND CONNECT A NEW 2#12 TECK90 ELECTRICAL CABLE BETWEEN THE GARAGE ELECTRICAL RECEPTACLE AND THE HOUSE DISTRIBUTION PANEL. THE LOCATION OF THE NEW CABLE IS APPROXIMATE AND SHOULD BE COORDINATED ON SITE BASED ON THE EXISTING CONSTRAINTS.
- 03** REMOVE THE EXISTING POWER CORD BETWEEN THE HOUSE AND THE BARN (EXACT LOCATION TO BE COORDINATED ON SITE). PROVIDE, INSTALL AND CONNECT A NEW 2#3 TECK90 ELECTRICAL CABLE BETWEEN THE BARN DISTRIBUTION PANEL AND THE HOUSE DISTRIBUTION PANEL. THE LOCATION OF THE NEW CABLE IS APPROXIMATE AND SHOULD BE COORDINATED ON SITE BASED ON THE EXISTING CONSTRAINTS.
- 04** REMOVE THE EXISTING POWER CABLE BETWEEN THE HOUSE AND THE SHED (EXACT LOCATION TO BE COORDINATED ON SITE). PROVIDE, INSTALL AND CONNECT A NEW 2#12 TECK90 ELECTRICAL CABLE BETWEEN THE SHED ELECTRICAL SOCKET AND THE HOUSE DISTRIBUTION PANEL. THE LOCATION OF THE NEW CABLE IS APPROXIMATE AND SHOULD BE COORDINATED ON SITE BASED ON ALL EXISTING CONSTRAINTS.

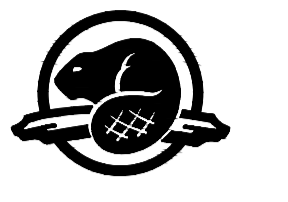

révisions / revisions	description	date
03	ISSUED FOR TENDER	21-07-2017
02	99% - POUR COMMENTAIRES	07-07-2017
01	50% - POUR COMMENTAIRES	26-05-2017

A	A no. du detail detail no.	A
C	B sur dessin no. location drawing no.	B
	C drawing no. dessin no.	C

Projet / Project  
**PARK CANADA  
FORILLON NATIONAL PARK  
GRANDE-GRAVE REGION**  
  
REFECTION OF  
BLANCHETTE ENSEMBLE

Dessin / Drawing  
**ELECTRICITY**  
  
**SITE PLAN  
INTERVENTION PLAN**

Conçu par / Designed By	M. ROUSSEL
Date / (yyyy/mm/dd)	
Dessiné par / Drawn By	M. ROUSSEL
Date / (yyyy/mm/dd)	
Examiné par / Reviewed By	S. BUJOLD
Date / (yyyy/mm/dd)	
Approuvé par / Approved By	S. BUJOLD
Date / (yyyy/mm/dd)	
No. du projet / Project no.	1413-4
APC / PCA	
No. du dessin / Drawing no.	E01-GL-PLN-1413-4
	E01

