

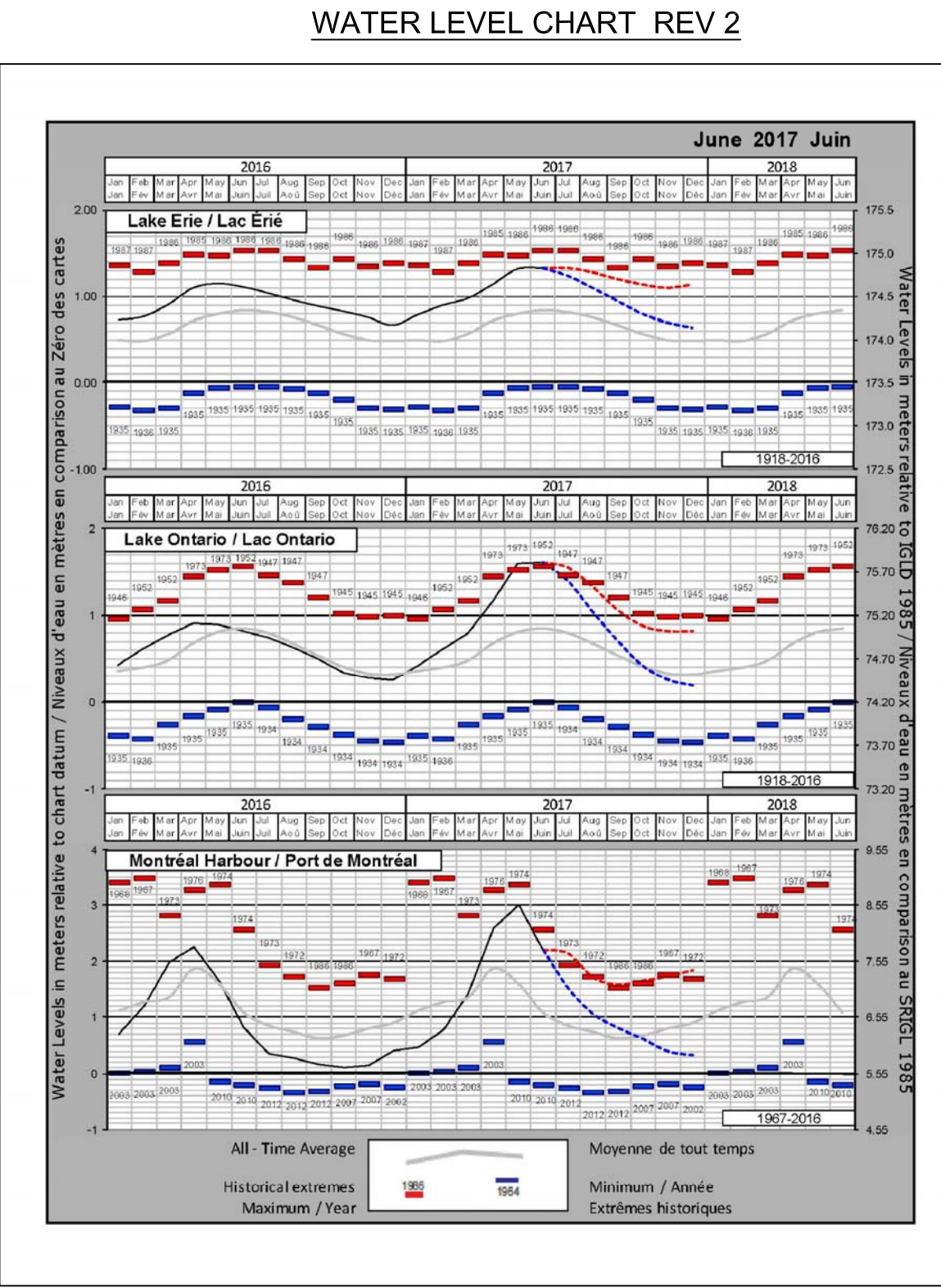

2017 EAST HARBOUR WALL REPAIRS
WHEATLEY, ONTARIO

DRAWING INDEX

- MA-00 - TITLE PAGE
- MA-01 - EXISTING SITE PLAN
- MA-02 - EXISTING CONDITIONS, REMOVALS AND NEW REPAIR LIMITS
- MA-03 - TYP. SECTIONS OF EXISTING CONDITIONS
- MA-04 - FINAL GRADING PLAN AND NEW STRUCTURE LAYOUT
- MA-05 - TYP. SECTION OF NEW WORK AREAS
- MA-06 - CLOSURE DETAILS
- MA-07 - TYP. STEEL DETAILS
- MA-08 - TYP. CONCRETE DETAILS
- MA-09 - TYP. DETAILS
- MA-10 - TYP. DETAILS
- MA-11 - TYP. PAVING DETAILS
- MA-12 - DRAIN DETAILS AND TABLES
- MA-13 - EAST SIDE ELECTRICAL SERVICE
- MA-14 - EAST SIDE ELECTRICAL SERVICE
- MA-15 - EAST SIDE ELECTRICAL SERVICE



INFORMATION OBTAINED FROM MONTHLY WATER LEVEL BULLETIN GREAT LAKES AND MONTREAL HARBOUR CANADIAN HYDROGRAPHIC SERVICE.
INFORMATION ALSO AVAILABLE AT THE FOLLOWING WEB SITE:
<http://www.waterlevels.gc.ca/C&A/bulletin-eng.html>

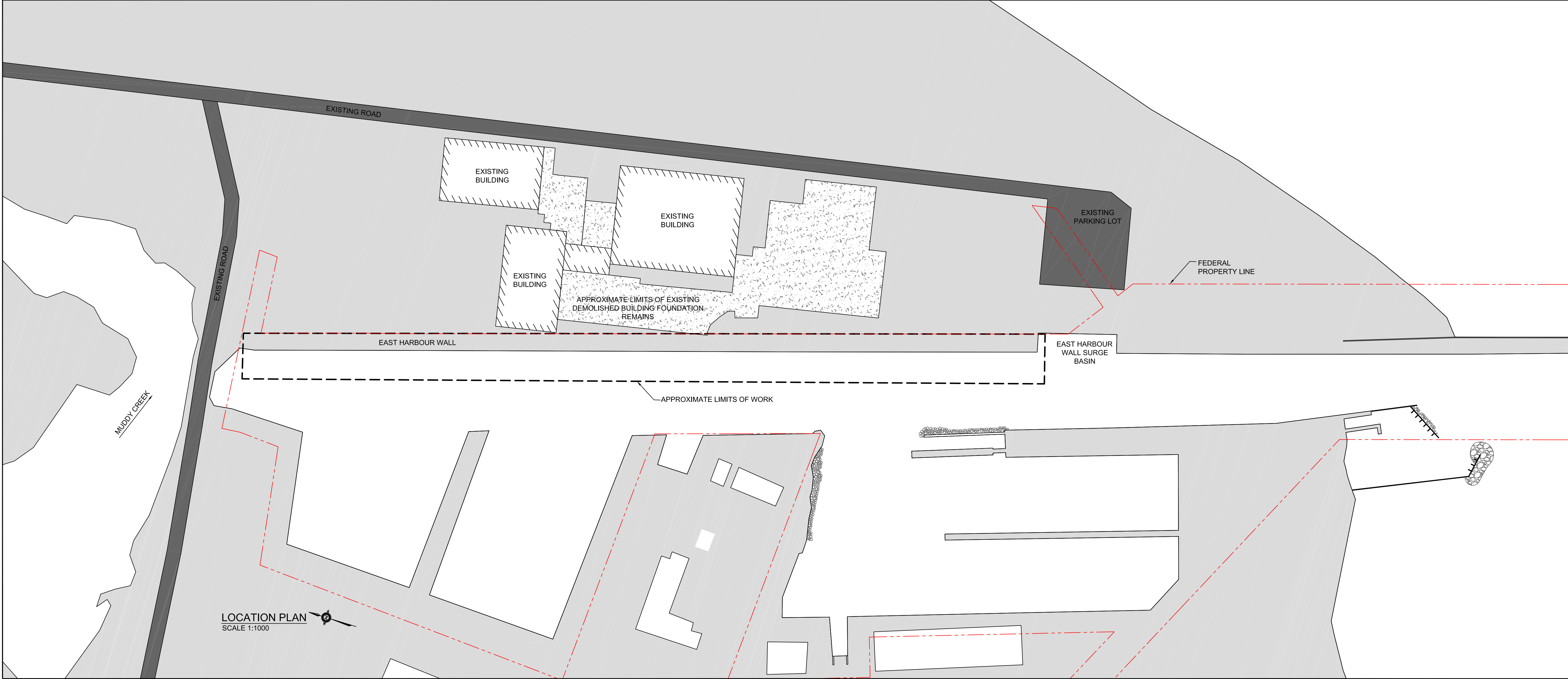

GOVERNMENT OF CANADA
FISHERIES AND OCEANS

GOUVERNEMENT DU CANADA
PÊCHES ET OCÉANS

SMALL CRAFT HARBOURS
CENTRAL AND ARCTIC REGION

Riggs Engineering Ltd.
1240 Commissioners Rd. W, Suite 205
London, Ontario,
N6K 1C7
Tel: (519) 657-1040
Fax: (519) 657 8631
Website: www.riggsengineering.com

1
2
3

Detail No.
drawing no. – where detail required
refers to MA–
drawing no. – where detailed
refers to MA–

Stamp:

NOTES:

REVISIONS:	DATE:
1 ISSUED FOR TENDER	JUNE/23/2017
2 REVISED DETAILS	JULY/25/2017

SCALE: AS NOTED

CLASS:

PROJECT:

2017 EAST HARBOUR
WALL REPAIRS

DESCRIPTION:

TITLE PAGE

DRAWN: AV

DATE: 2017-03-31

APPROVED: PL

DATE: 2017-03-31

LOCATION:

WHEATLEY, ONTARIO

DRAWING NO.: MA-00

LOCATOR CODE: F2930-160026