



**RETURN BIDS TO:**

**RETOURNER LES SOUMISSIONS À:**

Public Works and Government Services Canada  
ATB Place North Tower  
10025 Jasper Ave./10025 ave. Jaspe  
5th floor/5e étage  
Edmonton  
Alberta  
T5J 1S6  
Bid Fax: (780) 497-3510

**SOLICITATION AMENDMENT  
MODIFICATION DE L'INVITATION**

The referenced document is hereby revised; unless otherwise indicated, all other terms and conditions of the Solicitation remain the same.

Ce document est par la présente révisé; sauf indication contraire, les modalités de l'invitation demeurent les mêmes.

**Comments - Commentaires**

**Vendor/Firm Name and Address**  
**Raison sociale et adresse du**  
**fournisseur/de l'entrepreneur**

**Issuing Office - Bureau de distribution**  
Public Works and Government Services Canada  
ATB Place North Tower  
10025 Jasper Ave./10025 ave Jasper  
5th floor/5e étage  
Edmonton  
Alberta  
T5J 1S6

<b>Title - Sujet</b> Greenstone Yellowknife	
<b>Solicitation No. - N° de l'invitation</b> EW038-180666/A	<b>Amendment No. - N° modif.</b> 009
<b>Client Reference No. - N° de référence du client</b> PPSC - EW038-180666	<b>Date</b> 2017-08-18
<b>GETS Reference No. - N° de référence de SEAG</b> PW-\$PWU-023-11140	
<b>File No. - N° de dossier</b> PWU-7-40065 (023)	<b>CCC No./N° CCC - FMS No./N° VME</b>
<b>Solicitation Closes - L'invitation prend fin</b> <b>at - à 02:00 PM</b> <b>on - le 2017-08-22</b>	<b>Time Zone</b> <b>Fuseau horaire</b> Mountain Daylight Saving Time MDT
<b>F.O.B. - F.A.B.</b> <b>Plant-Usine:</b> <input type="checkbox"/> <b>Destination:</b> <input type="checkbox"/> <b>Other-Autre:</b> <input type="checkbox"/>	
<b>Address Enquiries to: - Adresser toutes questions à:</b> Taylor (RPC), Ian	<b>Buyer Id - Id de l'acheteur</b> pwu023
<b>Telephone No. - N° de téléphone</b> (780) 566-9487 ( )	<b>FAX No. - N° de FAX</b> (780) 497-3510
<b>Destination - of Goods, Services, and Construction:</b> <b>Destination - des biens, services et construction:</b>	

**Instructions: See Herein**

**Instructions: Voir aux présentes**

<b>Delivery Required - Livraison exigée</b>	<b>Delivery Offered - Livraison proposée</b>
<b>Vendor/Firm Name and Address</b> <b>Raison sociale et adresse du fournisseur/de l'entrepreneur</b>	
<b>Telephone No. - N° de téléphone</b> <b>Facsimile No. - N° de télécopieur</b>	
<b>Name and title of person authorized to sign on behalf of Vendor/Firm</b> <b>(type or print)</b> <b>Nom et titre de la personne autorisée à signer au nom du fournisseur/</b> <b>de l'entrepreneur (taper ou écrire en caractères d'imprimerie)</b>	
<b>Signature</b>	<b>Date</b>

**Part 1 General**

**1.1 ADDENDUM FORM**

- .1 This Addendum forms part of the Contract Documents and modifies the Bidding Documents dated 19 May 2017 with amendments and additions noted below.
- .2 Acknowledge receipt of this Addendum in the space provided in the Bid Form. Failure to do so may disqualify the Bidder at the Owner's discretion.
- .3 This addendum consists of three (3) pages plus the following list of drawings.

No.	Drawing Title	Issue Date
AD1.6	Acoustic Ceiling Baffle	August 16, 2017

**1.2 CHANGES TO ADDENDUM NUMBER 1 - ISSUED ON JUNE 9, 2017**

- .1 DOOR SCHEDULE
  - .1 Refer to Door Schedule; **revise** Door 432 material from hollow metal to wood, and finish from paint to stain.

**1.3 CHANGES TO PROJECT MANUAL**

- .1 SECTION 09 51 13 – ACOUSTIC PANEL CEILINGS
  - .1 **Add** Item 2.1.10 as follows:
    - .10 Acoustic units for ceiling clouds: High density fiberglass core; faces and edges fabric wrapped; concealed suspension fastening brackets mounted to upper portion of panel.
      - .1 Thickness: 25 mm (1 inch).
      - .2 NRC: 0.80.
      - .3 Core density: 96 to 112 kg/m<sup>3</sup> (6 to 7 lbs/ft<sup>3</sup>).
      - .4 Fabric: Polyester, acoustically transparent, Class 1 to ASTM E84, weight 16 oz/yard, colour white.

**1.4 CHANGES TO DRAWINGS**

- .1 DRAWING ID2.1 – 4<sup>th</sup> FLOOR CONSTRUCTION PLAN
  - .1 Refer to plan 3 on Sheet ID2.1 – Partial 4<sup>th</sup> Floor Reflected Ceiling Plan; revise according to acoustic ceiling baffle detail drawing AD1.6 as attached to this addendum. **Delete** Keynote 16 at all gridlines. Keynote 16 refers to the portion of the wall between grid line B and the exterior wall where the concrete ceiling height changes.

**1.5 CLARIFICATIONS**

- .1 Request clarification on achieving a flat drywall surface to corridors 410, 439 and 453? The walls types indicated are not of typical thickness, given the metal mesh required for some rooms. Refer to Drawing (ID2.2).
  - .1 Stud placement will need to be adjusted to suit mesh thickness.

- .2 Request for clarification in regards to the existing rolling storage shelving. Please provide the Manufacturer and Model information.
  - .1 Refer to Addendum 7.
- .3 Please clarify the scope of work, indicated as "Note 1" on drawings (ID2.2). "remove existing posts and turn over to owner for first right of refusal"
  - .1 Refer to Addendum 7.
- .4 On "GL 17" drawing ID2.2, The wall type is "P2a". On drawing ID3.1 elevation 13 indicates vinyl wrapped drywall. Is this a demountable wall assembly?
  - .1 Wall at grid GL17 is P2c. Vinyl wrapped gypsum to be on atrium side of wall.
- .5 Please clarify the fire rating if this is a demountable system.
  - .1 No fire rating is required.
- .6 Please confirm that the material type noted in Addendum #1 for the frame assemblies is in fact correct and to be priced as noted.
  - .1 One change made to Door 432 as indicated in this addendum; all other materials indicated are confirmed.
- .7 Can you confirm if the intent of "J" Junction Box under the Furniture locations is to be located under the raised flooring for the furniture connection or if we are to provide a Floor box to be mounted in the raised floor specifically for furniture connections.
  - .1 The junction box located under the furniture is to be a furniture feed thru floor box c/w flexible conduit whips to furniture for both power and data. Floor box to be as indicated in spec section 26 05 32 Item 2.5.
- .8 Can you confirm the approved manufacture of floor box for this contract as there seems to be a mix match in the building as it is from different contractors.? The spec is referencing a concrete tight floor box. Will the Legrand Wire mold Evolution series be adequate?
  - .1 Disregard specification 26 05 32 item 2.3. For raised floor floorbox, refer to section 26 05 00 item 2.13. No specific manufacturer is required provided they meet this specification.
- .9 Please provide additional description of the "clouds", including a basis of design system and/or products that are acceptable for the Fabric Facing and the Base Material.
  - .1 Refer to Item 1.3.1 in this addendum.
- .10 Wall type P1c calls for 13mm gypsum board but also refers to NBC S4c, which indicates 16mm gypsum board. Please clarify.
  - .1 The wall type is NBC S4, use 13 mm GWB.
- .11 Wall types P2b and P2c refer to NBC S4a. Should the reference be S8a?
  - .1 Wall type P2b is NBC S8a, wall type P2c is NBC S8.
- .12 Keynotes 16/ID2.1 calls for acoustic quilt above existing acoustic treatment. It appears that rooms 412-417 are exposed structure ceilings with one hanging cloud in each of them. Is the referenced note a discrepancy in regards room 412-417.
  - .1 See attached drawing revision.

- .13 Please refer to 09 81 00 items 2.2 (Blanket Insulation) and 2.3 (Insulation Quilts) and provide basis of design products and/or acceptable products for use?
  - .1 Refer to addendum 7. Government of Canada projects are specified on a performance basis.
- .14 Please refer to Addendum #5 Item 1.2.1.1 *"Add Item 1.6.3: A list of all staff anticipated to work on this project, with their birthdates, must accompany bid submissions."* Can the successful General Contractor provide this information after award?
  - .1 No.

**END OF ADDENDUM NUMBER NO. 8**

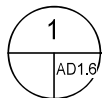
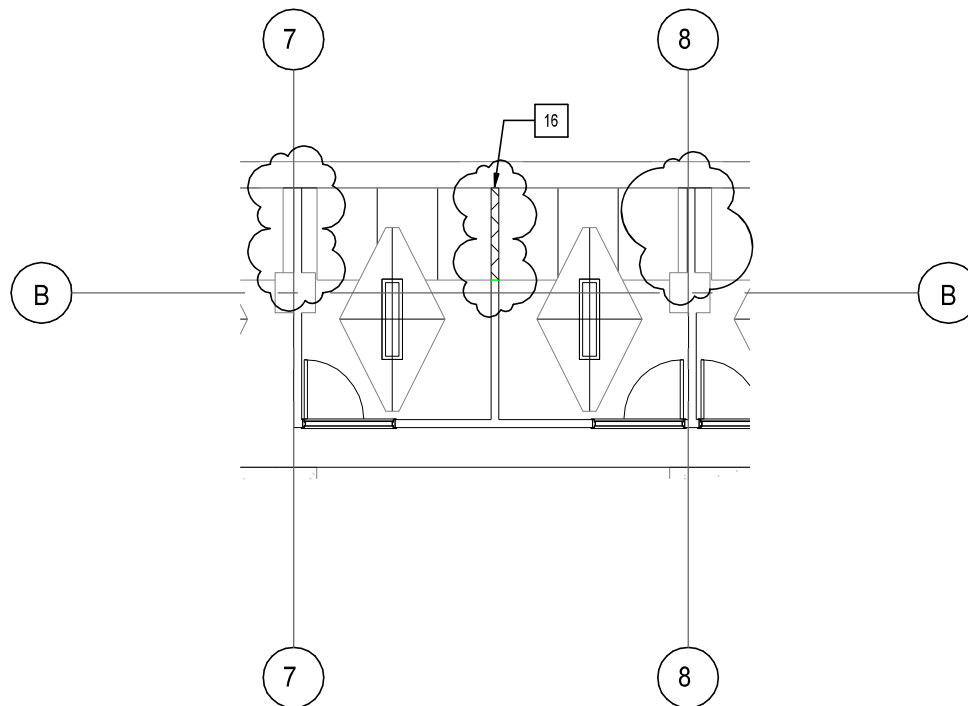

## BAFFLE DETAIL

1 : 100

Project Title

5101 50th Avenue, Yellowknife, NWT

Drawing Title

ACOUSTIC CEILING BAFFLE

Drawn By

TS

PWGSC Project Manager

Brenda Embury

Designed By

TS

Project no.

R.060383

Approved By

TS

Date

2017/08/16

Sheet

AD1.6

Revision

1