

LEGEND

-  Site Location
-  Site Boundary

NOTES

1. Original in colour.
2. Numerical scale reflects full-size print. Print scaling will distort this scale, however scale bar will remain accurate.
3. Intended for illustration purposes, accuracy has not been verified for construction or navigation purposes.



CLIENT NAME:
Public Works and Government
Services Canada

PROJECT LOCATION:
Muncho Lake
Alaska Highway, BC

**Muncho Lake Maintenance
Camp Site Location**

PROFESSIONAL
PROVINCE OF
D.A. FURSEVICH
42540
BRITISH COLUMBIA
GEO SCIENTIST



BY: PB
CHKD: MR

DATE: 2016-07-19
SCALE: 1:50,000

REF No: REV: **0**
635031-801

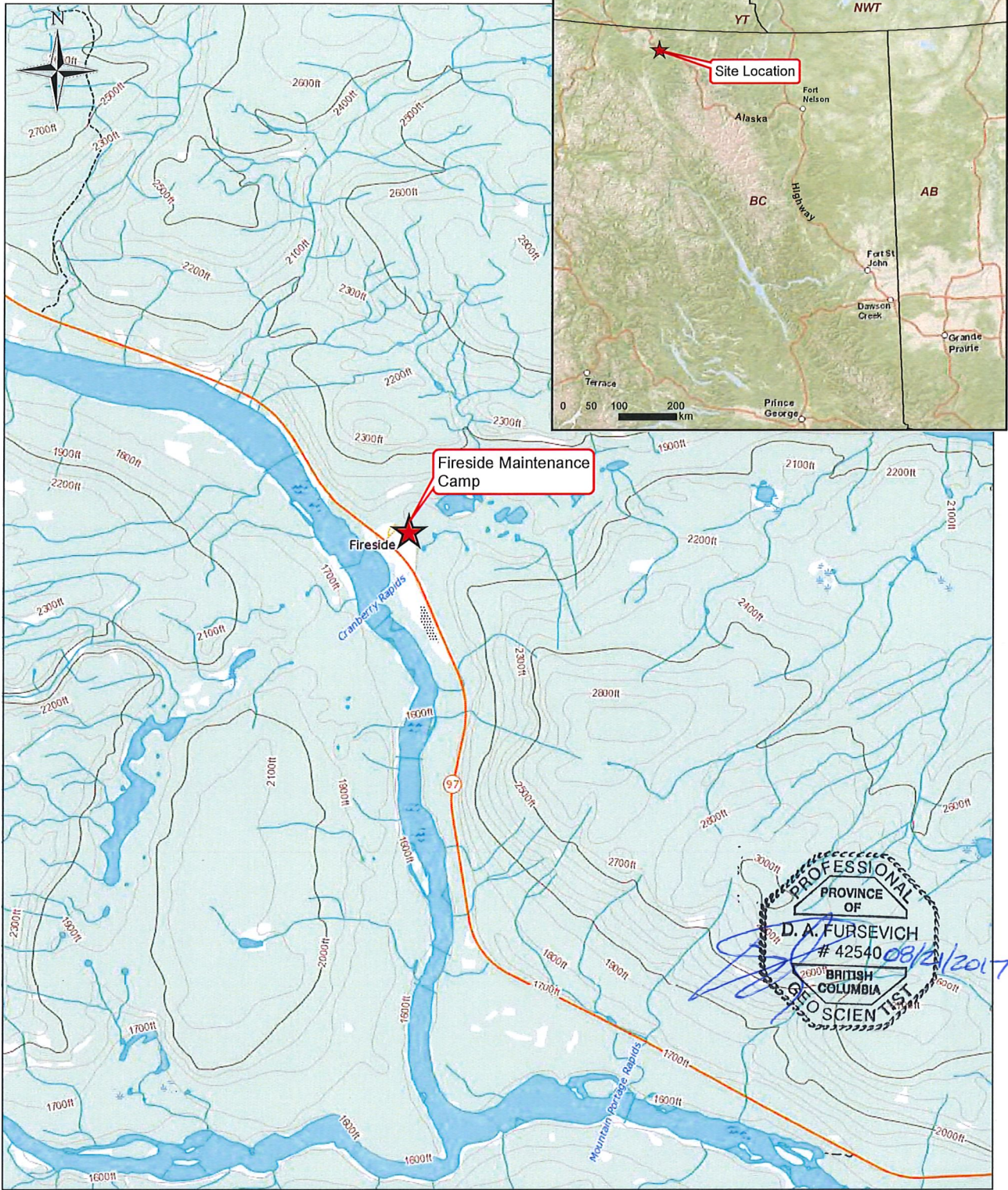

PROFESSIONAL
 PROVINCE OF
 D. A. FURSEVICH
 # 42540
 BRITISH COLUMBIA
 GEO SCIENTIST
 08/24/2017

LEGEND

★ Site Location

NOTES

1. Original in colour.
2. Numerical scale reflects full-size print. Print scaling will distort this scale, however scale bar will remain accurate.
3. Intended for illustration purposes, accuracy has not been verified for construction or navigation purposes.



SNC • LAVALIN

| | |
|--|--|
| CLIENT NAME: Public Services and Procurement Canada | PROJECT LOCATION: Fireside Maintenance Camp Alaska Highway, BC |
| <h3>Fireside Maintenance Camp Site Location</h3> | |



| | | | |
|----------|------------------|-------------------|--------|
| BY: PB | DATE: 2017-03-03 | REF No: | REV: 0 |
| CHKD: CS | SCALE: 1:50,000 | 636200-901 | |

MXD Path: P:\Current Projects\Public Works and Gov't Services Canada\623385 Fireside\4.0 Execution\4.5 GIS and Drawings (Secure)\GISMapSeries\623385-001.mxd

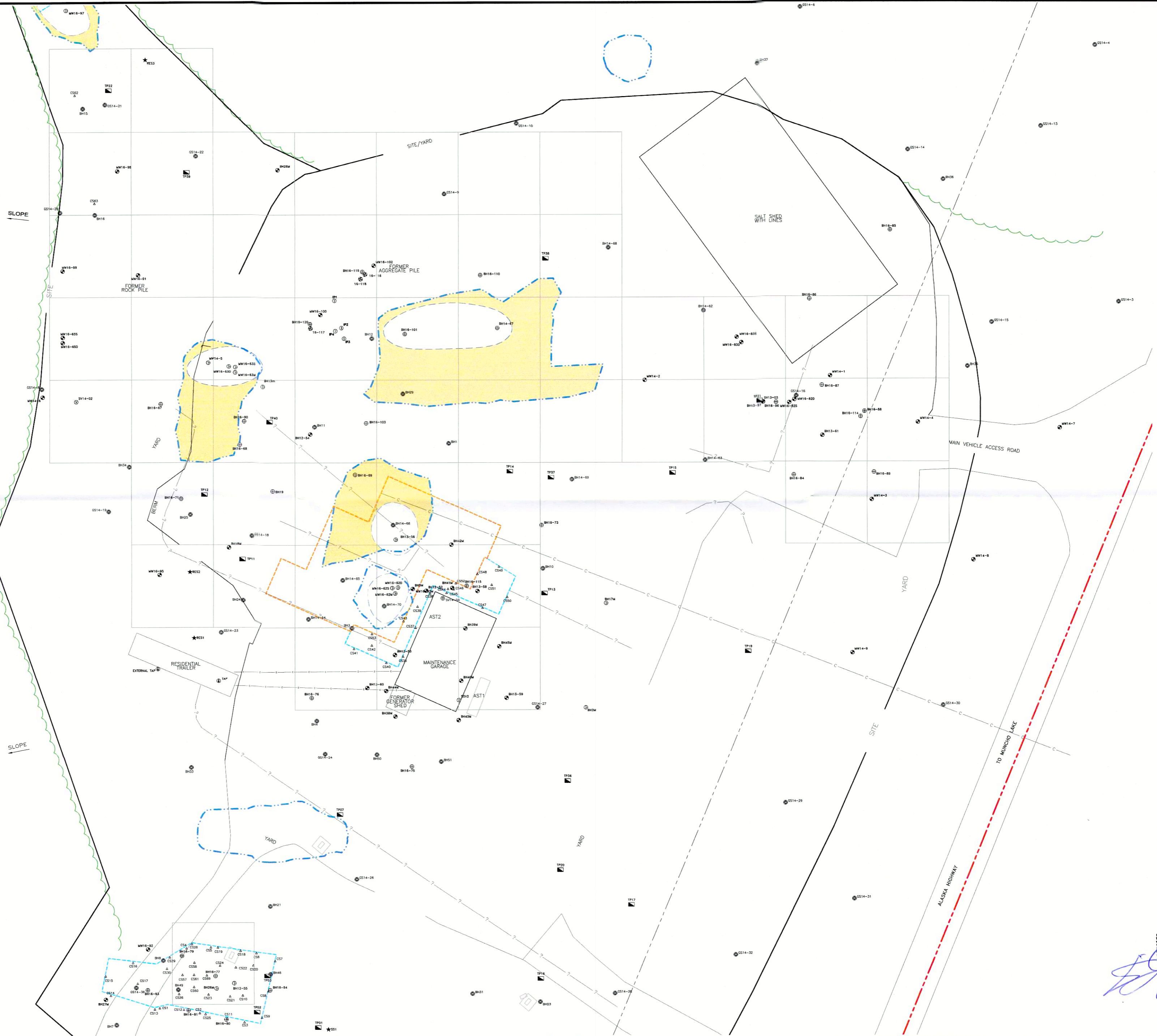

PROFESSIONAL
 PROVINCE OF
 D. A. FURSEVICH
 # 42540
 BRITISH COLUMBIA
 GEOLOGICAL SCIENCES

LEGEND

- SUBJECT PROPERTY LIMITS
- - - LOT LINE
- - - COMMUNICATIONS LINE
- - - ELECTRICAL LINE
- - - UNKNOWN UTILITY
- - - APPROXIMATE LIMITS OF 2003 EXCAVATION
- - - APPROXIMATE LIMITS OF 2004 EXCAVATION
- - - TREE LINE
- - - 2016 REMEDIAL EXCAVATION LIMITS
- ⊕ 2016 SURFACTANT AND CHEMOK WELLS (INSTALLED BY SNC-LAVALIN)
- ⊕ MONITORING WELL
- ⊕ BOREHOLE
- ⊕ BOREHOLE BY OTHERS
- ⊕ DESTROYED/DECOMMISSIONED
- ⊕ SURFACE SAMPLE
- ⊕ DRINKING WATER WELL OUTLET
- ⊕ TEST PIT
- ⊕ VAPOUR WELL
- ⊕ INJECTION WELL
- ⊕ FORMER AST
- ⊕ CONFIRMATORY SAMPLE

NOTES

1. ORIGINAL DRAWING IN COLOUR.
2. LOCATION OF EXISTING UTILITIES SHOWN ARE APPROXIMATE ONLY AND SHOULD BE CONFIRMED ON SITE. NOT ALL UTILITIES MAY BE SHOWN.

REFERENCE DRAWINGS

| DWG. NO. | DATE | DESCRIPTION | PRT | DF |
|------------------|------------|---------------------------|-----|-----|
| REVISIONS | | | | |
| 1 | 2017-08-18 | ISSUED TO CLIENT | PRT | DF |
| 0 | 2017-07-19 | ISSUED TO CLIENT AS DRAFT | PRT | DF |
| REV. | DATE | DESCRIPTION | BY | CHK |



CLIENT NAME: PUBLIC SERVICES AND PROCUREMENT CANADA
 PROJECT LOCATION: MUNCHO LAKE, ALASKA HIGHWAY, BC
 TITLE: **MUNCHO LAKE - LIF CHARACTERIZATION GRID**
 DWN BY: PRT SCALE: 1:500 DATE: 2017-07-17 DWG No: REV: 1
 CHK'D: CN PLOT: 20170818.1642 CADFILE: **635031-1305**

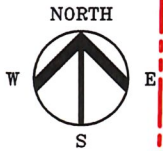

ALASKA HIGHWAY



NOTES

1. ORIGINAL DRAWING IN COLOUR.
2. LOCATION OF EXISTING UTILITIES SHOWN ARE APPROXIMATE ONLY AND SHOULD BE CONFIRMED PRIOR TO INTRUSIVE WORK. NOT ALL UTILITIES MAY BE SHOWN.

PROFESSIONAL
 PROVINCE OF
 D. A. FURSEVICH
 # 42540 08/21/2017
 BRITISH COLUMBIA
 GEO SCIENTIST

LEGEND



- SUBJECT PROPERTY LIMITS
- LOT BOUNDARY
- FIBER OPTIC LINE
- UNKNOWN UTILITY
- TREE LINE
- FENCE
- ⊕ BOREHOLE
- ⊙ MONITORING WELL
- ⊖ INJECTION WELL
- ⊕ SOIL VAPOUR WELL
- ⊖ TEST PIT LOCATION
- ★ SURFICIAL SOIL SAMPLE LOCATION
- SITE FEATURE
- GARDEN

REFERENCE DRAWINGS

| DWG. NO. | DATE | DESCRIPTION | BY | CHK |
|----------|------------|---------------------------|-----|-----|
| 1 | 2018-08-18 | ISSUED TO CLIENT | PRT | DF |
| 0 | 2017-07-19 | ISSUED TO CLIENT AS DRAFT | PRT | DF |
| REV. | DATE | DESCRIPTION | BY | CHK |



SNC • LAVALIN

CLIENT NAME: PUBLIC SERVICES AND PROCUREMENT CANADA
 PROJECT LOCATION: FIRESIDE MAINTENANCE CAMP ALASKA HIGHWAY, BC

FIRESIDE - LIF CHARACTERIZATION GRID

TITLE:
 DWN BY: PRT SCALE: 1:600 DATE: 2017-02-08 DWG No: REV: 1
 PLOT: 20170818.1647 CADFILE: 636200R14 **636200-802**