

CORRECTIONAL SERVICE CANADA (CSC)
SERVICE CORRECTIONNEL CANADA (SCC)

PLAN CLÉ / KEY PLAN

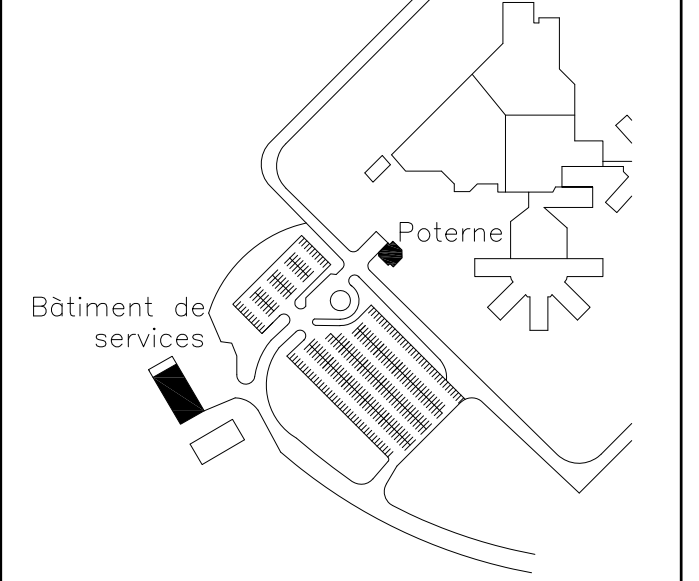

DRAWING LIST

ARCHITECTURE

- A00 OF 6 FRONT PAGE AND LOCATION PLAN
- A01 OF 6 PLAN AND PICTURES - SERVICES BUILDING - DEMOLITION / CONSTRUCTION
- A02 OF 6 DETAILS - SERVICES BUILDING - DEMOLITION / CONSTRUCTION
- A03 OF 6 PLAN AND PICTURES - POSTERN - DEMOLITION / CONSTRUCTION
- A04 OF 6 DETAILS - POSTERN - DEMOLITION
- A05 OF 6 DETAILS - POSTERN - CONSTRUCTION

ARCHITECTURE



SCEAU / SEAL

02	FOR TENDER	23/08/17
01	FOR COMMENTARY	18/08/17
révisions / revisions		date

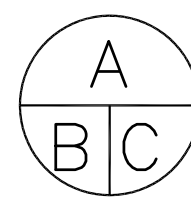
	A no. du détail / detail no
	B sur no de dessin / location drawing no
	C no de dessin / drawing no

Projet / Project
**DONNACONA INSTITUTION
 ROOF REHABILITATION
 SERVICES BUILDING AND
 POSTERN**
 1537, HIGHWAY 138,
 DONNACONA (QUEBEC) G3M 1C9

Dessin / Drawing
ARCHITECTURE
**FRONT PAGE AND
 LOCALISATION PLAN**

Conçu par / Designed by
 AUDREY BOUCHARD 18/08/2017
 Date

Dessiné par / Drawn by
 AUDREY BOUCHARD 18/08/2017
 Date

Approuvé par / Approved by
 CATHY DUMAS 18/08/2017
 Date

Soumission / Tender Gestionnaire de projet TPSCC /
 PWSCC project manager

No de projet / Project number 550-2-321-3703 TPSCC / PWSCC	No de projet / Project number QC17-1099 Client
---	---

Nom du fichier / File name	No de classement
----------------------------	------------------

No de plan ou dessin	No feuille / Sheet no A00/6
----------------------	---------------------------------------

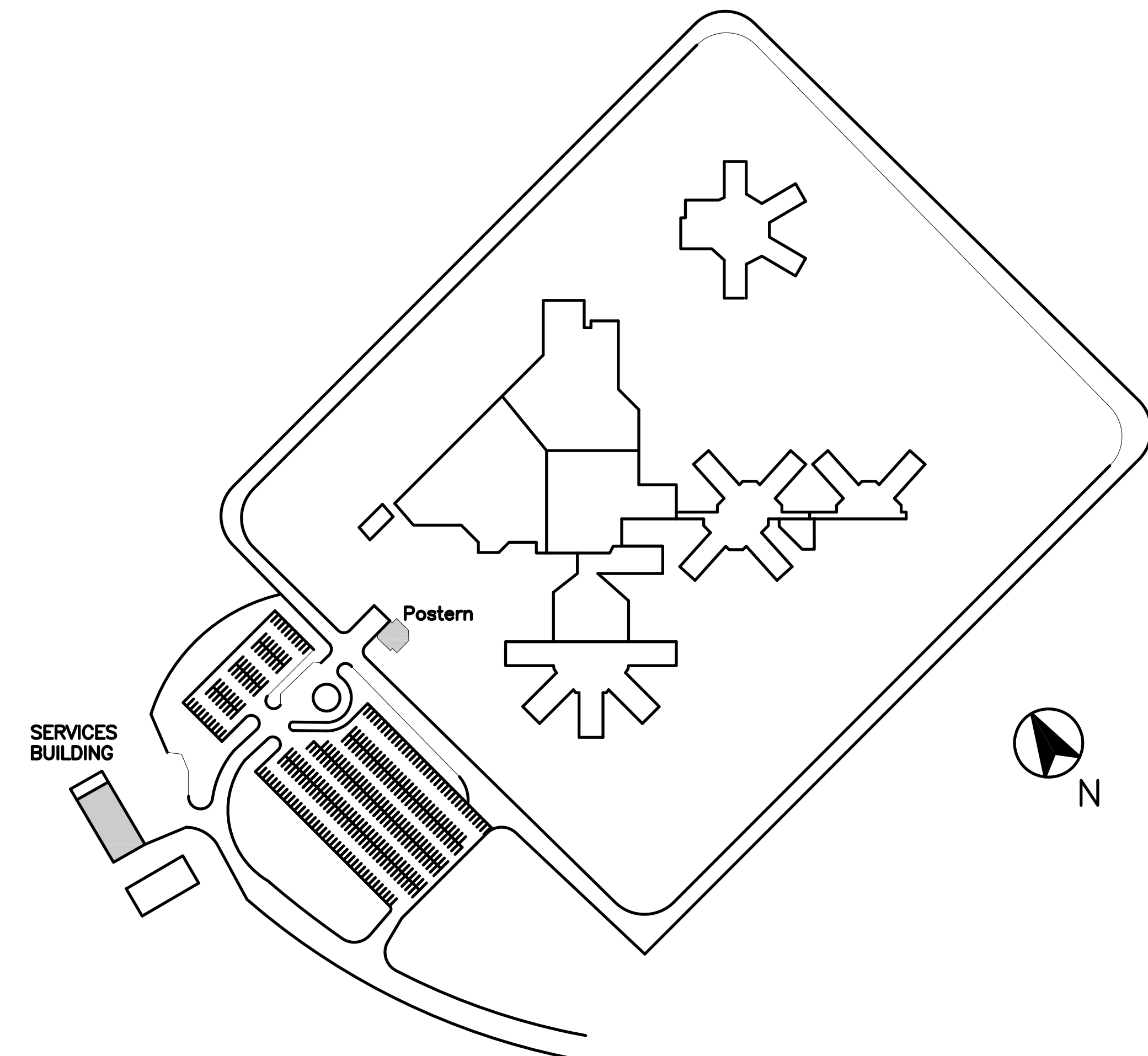

LOCATION PLAN



02 PICTURE - EXISTING GOOSENECK
SCALE: NONE



03 PICTURE - EXISTING ELECTRIC MAST
SCALE: NONE



04 PICTURE - OVERVIEW
SCALE: NONE



05 PICTURE - EXISTING CHIMNEY
SCALE: NONE



06 PICTURE - EXISTING MECHANICAL BASE
SCALE: NONE



07 PICTURE - OVERVIEW
SCALE: NONE

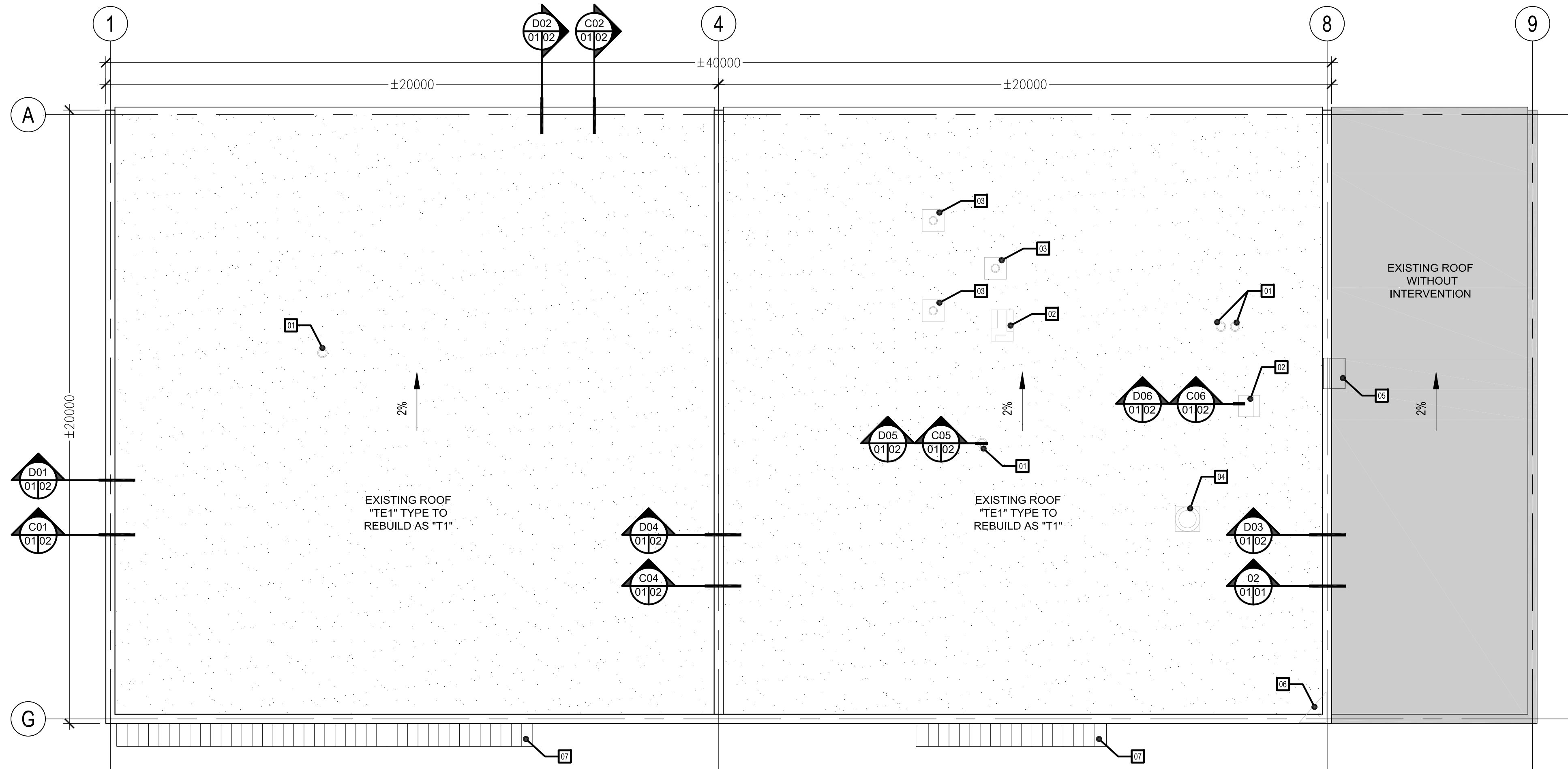

01 ROOF PLAN - SERVICES BUILDING
SCALE: 1:100

GRAPHIC LEGEND - PLAN

- 00 SPECIFIC NOTE
- XX DETAIL REFERENCE
- OUT OF MANDATE AREA
- 9 STRUCTURAL AXIS REFERENCE
- 2% EXISTING STRUCTURAL ROOF SLOPE

HATCH LEGEND

- EXISTING ROOF, WITHOUT INTERVENTION.
- EXISTING ROOF, TO REBUILD.

EXISTING COMPOSITIONS

TE1

- EXISTING BALLAST, TO REMOVE.
- EXISTING MEMBRANE, FELT 15 LBS AND ASPHALT, TO REMOVE.
- EXISTING WOOD FIBER PANEL, 13 mm THICK., TO REMOVE.
- EXISTING RIGID POLYISOCYANURATE INSULATION, 100 mm THICK. (R.30), TO PRESERVE.
- EXISTING VAPOR RETARDER MEMBRANE, TO PRESERVE.
- EXISTING STEEL DECK, TO PRESERVE.

TE1.1

- EXISTING BALLAST, TO REMOVE.
- EXISTING BITUMINOUS MEMBRANE, ±610 mm WIDE, TO REMOVE.
- EXISTING WOOD FIBER PANEL, 13 mm THICK., TO REMOVE.
- EXISTING RIGID POLYISOCYANURATE INSULATION, 100 mm THICK. R.30, TO PRESERVE.
- EXISTING VAPOR RETARDER MEMBRANE, TO PRESERVE.
- EXISTING STEEL DECK, TO PRESERVE.

NEW COMPOSITION

T1

- NEW MODIFIED BITUMINOUS MEMBRANE.
- NEW 15 mm THICK., HIGH DENSITY MINERAL FIBER BOARD LAMINATED WITH SBS MODIFIED BITUMEN BASE SHEET MEMBRANE.
- EXISTING RIGID POLYISOCYANURATE INSULATION, 100 mm THICK. (R.30), PRESERVED.
- EXISTING VAPOR RETARDER MEMBRANE, PRESERVED.
- EXISTING STEEL DECK, PRESERVED.

GENERALS NOTES

GN.1 THE CONTRACTOR IS RESPONSIBLE FOR THE VERIFICATION AND COORDINATION OF ALL DIMENSIONS.

GN.2 ALL THE DIMENSIONS HAVE TO BE VERIFIED ON SITE.

GN.3 PERFORM WORK IN ACCORDANCE WITH NATIONAL BUILDING CODE OF CANADA (NBC) INCLUDING AMENDMENTS UP TO TENDER CLOSING DATE AND OTHER PROVINCIAL OR LOCAL CODES.

GN.4 THE EXISTING ROOF COMPOSITION INDICATED ON THE PLANS ARE NON LIMITATIVE. THE CONTRACTOR SHOULD PERFORM NECESSARY DEMOLITION TO OBTAIN PERFECT EXECUTION OF WORK.

GN.5 ALL PLUMBING VENTS MUST BE REMOVED AND REPLACED.

GN.6 ALL METAL FLASHING AROUND MECHANICAL BASES, CHIMNEYS, GOOSENECKS, AND EVACUATORS MUST BE REMOVED. THE EQUIPMENT MUST BE REMOVE STORED AND REINSTALLED IN THEIR EXISTING PLACE.

SPECIFIC NOTES

- 01 PLUMBING VENT SLEEVE, TO REMOVE.
- 02 GOOSENECK, TO REMOVE, STORE AND REINSTALL.
- 03 CHIMNEY, TO REMOVE, STORE AND REINSTALL.
- 04 EVACUATOR, TO REMOVE, STORE AND REINSTALL.
- 05 EXISTING GOOSENECK, TO PRESERVE (WITHOUT INTERVENTION).
- 06 ELECTRICAL MAST, TO REMOVE, TEMPORARILY SUPPORT AND REINSTALL.
- 07 EXISTING LOWER ROOF, WITHOUT INTERVENTION.

Travaux publics et Services gouvernementaux Canada / Public Works and Government Services Canada

Direction générale des biens immobiliers / Real Property Branch

Région du Québec / Quebec region

Canada

CORRECTIONAL SERVICE CANADA (CSC) / SERVICE CORRECTIONNEL CANADA (SCC)

PLAN CLÉ / KEY PLAN

Bâtiment de services / Services Building

ARCHITECTURE

ABCP 300 RUE SAINT-PAUL, BUREAU 412 QUÉBEC, QC, CANADA G1K 7R1 T 418 649.7369

SCEAU / SEAL

Ordre des architectes du Québec / Order of Architects of Quebec

CATHY DUMAS ARCHITECTE

02	POUR SOUMISSION	23/08/17
01	POUR COMMENTAIRES	18/08/17

révisions / revisions

révisions / revisions	date

A no. du détail / detail no

B sur no de dessin / location drawing no

C no de dessin / drawing no

Projet / Project

DONNACONA INSTITUTION ROOF REHABILITATION SERVICES BUILDING AND POSTERN

1537, HIGHWAY 138, DONNACONA (QUEBEC) G3M 1C9

Dessin / Drawing

ARCHITECTURE

PLAN AND PICTURES SERVICES BUILDING DEMOLITION / CONSTRUCTION

Conçu par / Designed by
AUDREY BOUCHARD 18/08/2017 Date

Dessiné par / Drawn by
AUDREY BOUCHARD 18/08/2017 Date

Approuvé par / Approved by
CATHY DUMAS 18/08/2017 Date

Soumission / Tender

Gestionnaire de projet TPSGC / PWSC project manager

No de projet / Project number 550-2-321-3703 TPSGC / PWSC Client	No de projet / Project number QC17-1099 Client
--	--

Nom du fichier / File name

No de classement

No de plan ou dessin

No feuille / Sheet no
A01/6

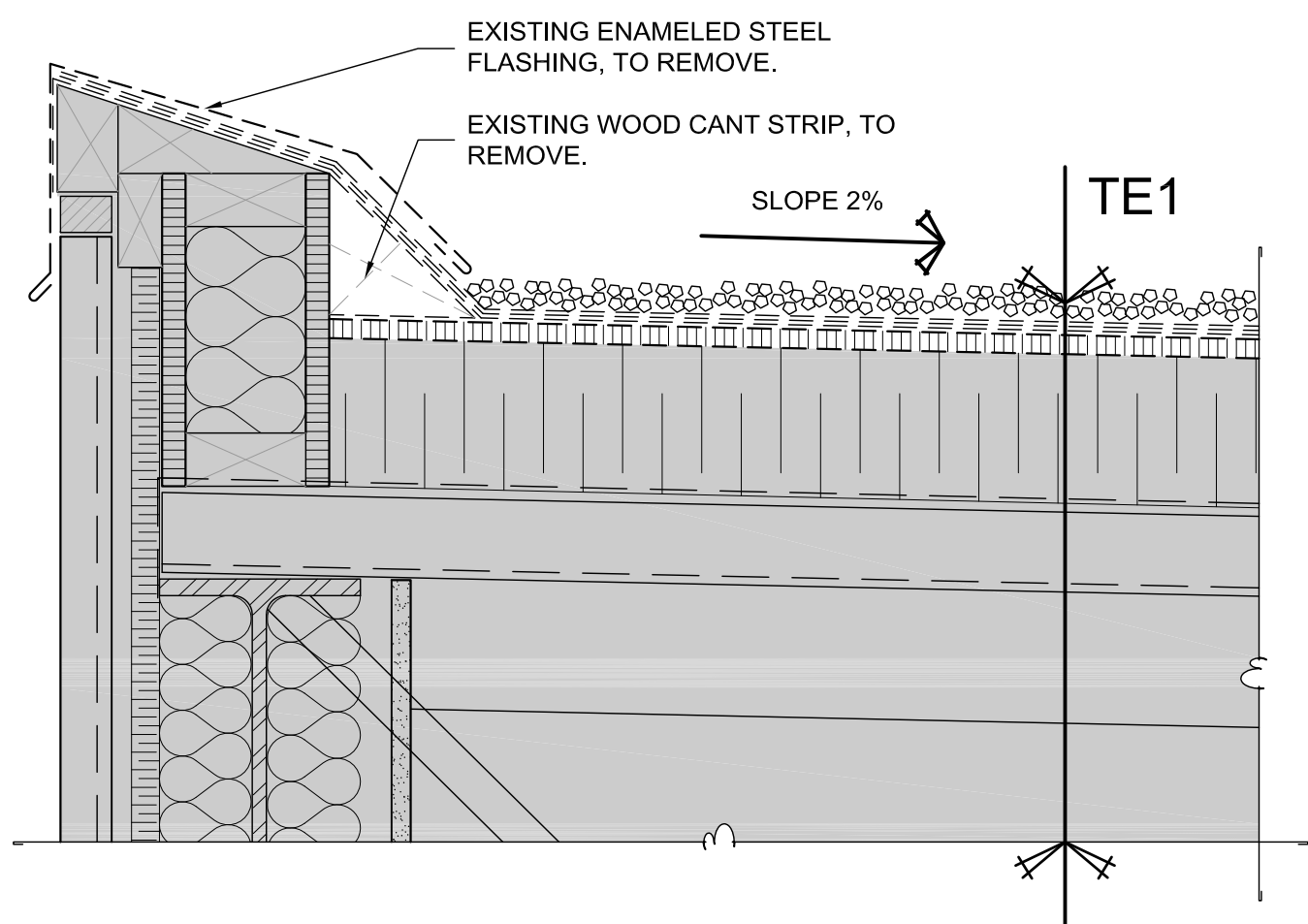

D01 DETAIL - EXISTING PARAPET - DEMOLITION
SCALE: 1:5

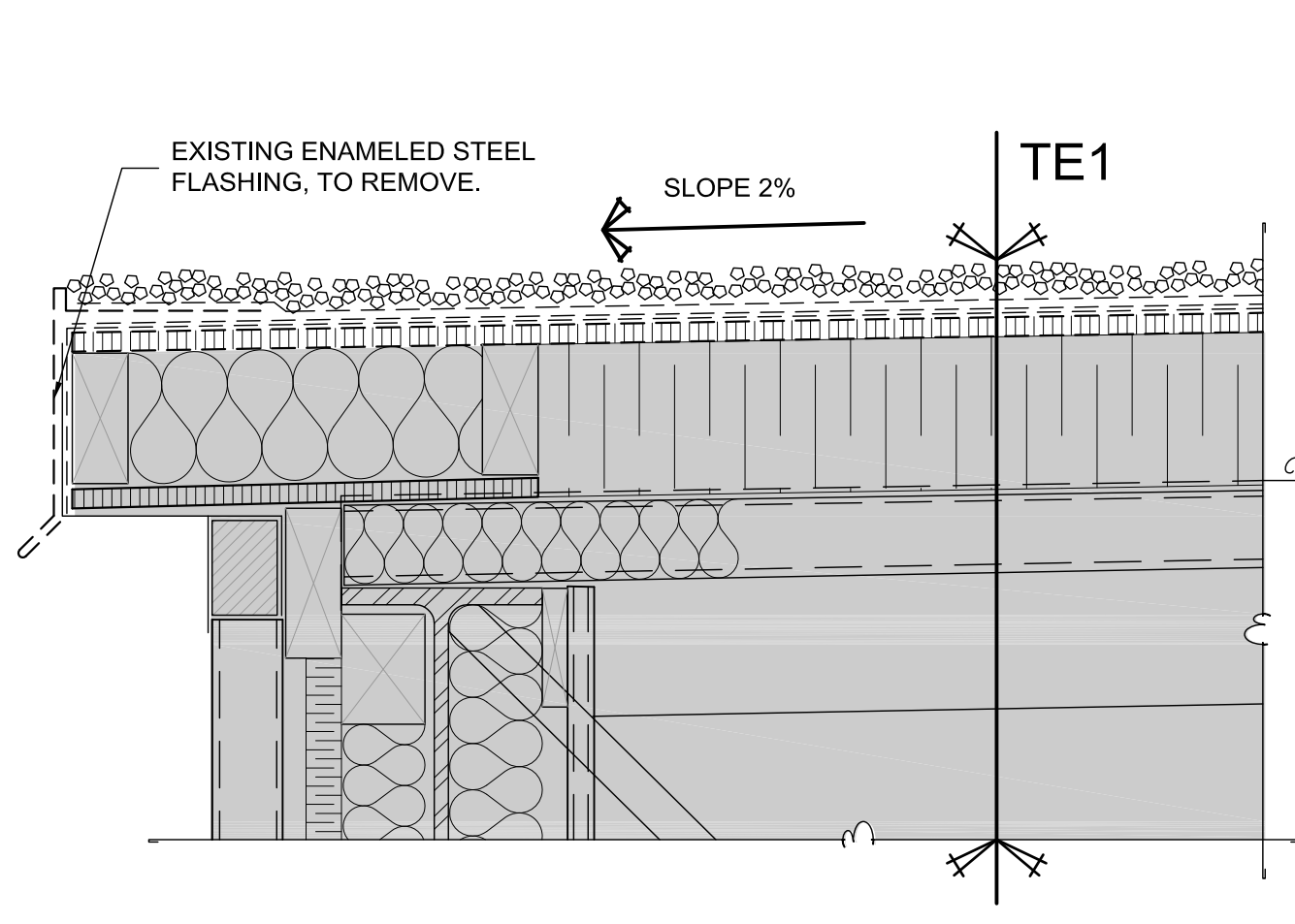

D02 DETAIL - EXISTING OVERHANG ROOF - DEMOLITION
SCALE: 1:5

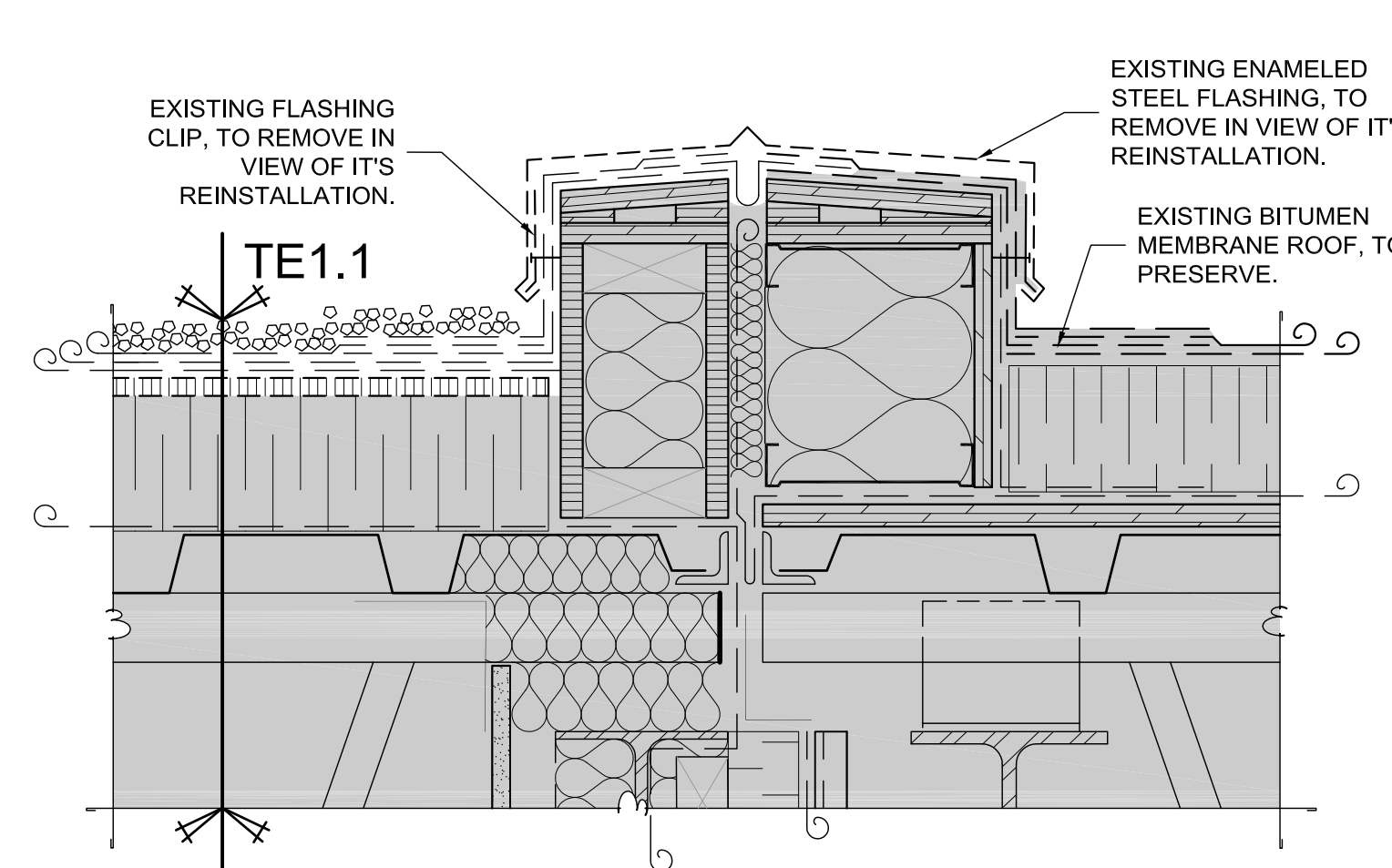

D03 DETAIL - PARAPET BETWEEN POND - DEMOLITION
SCALE: 1:5

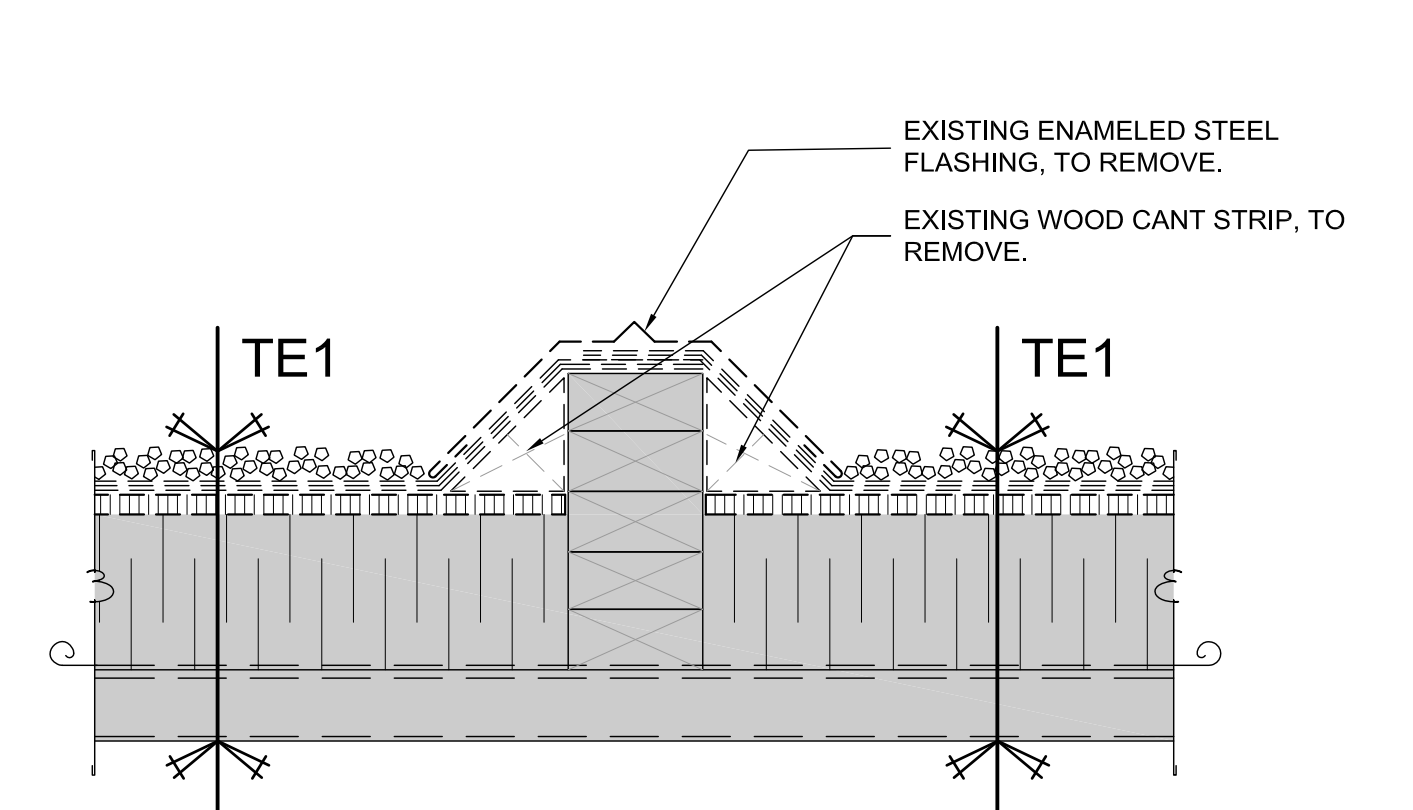

D04 DETAIL - PARAPET BETWEEN POND - DEMOLITION
SCALE: 1:5

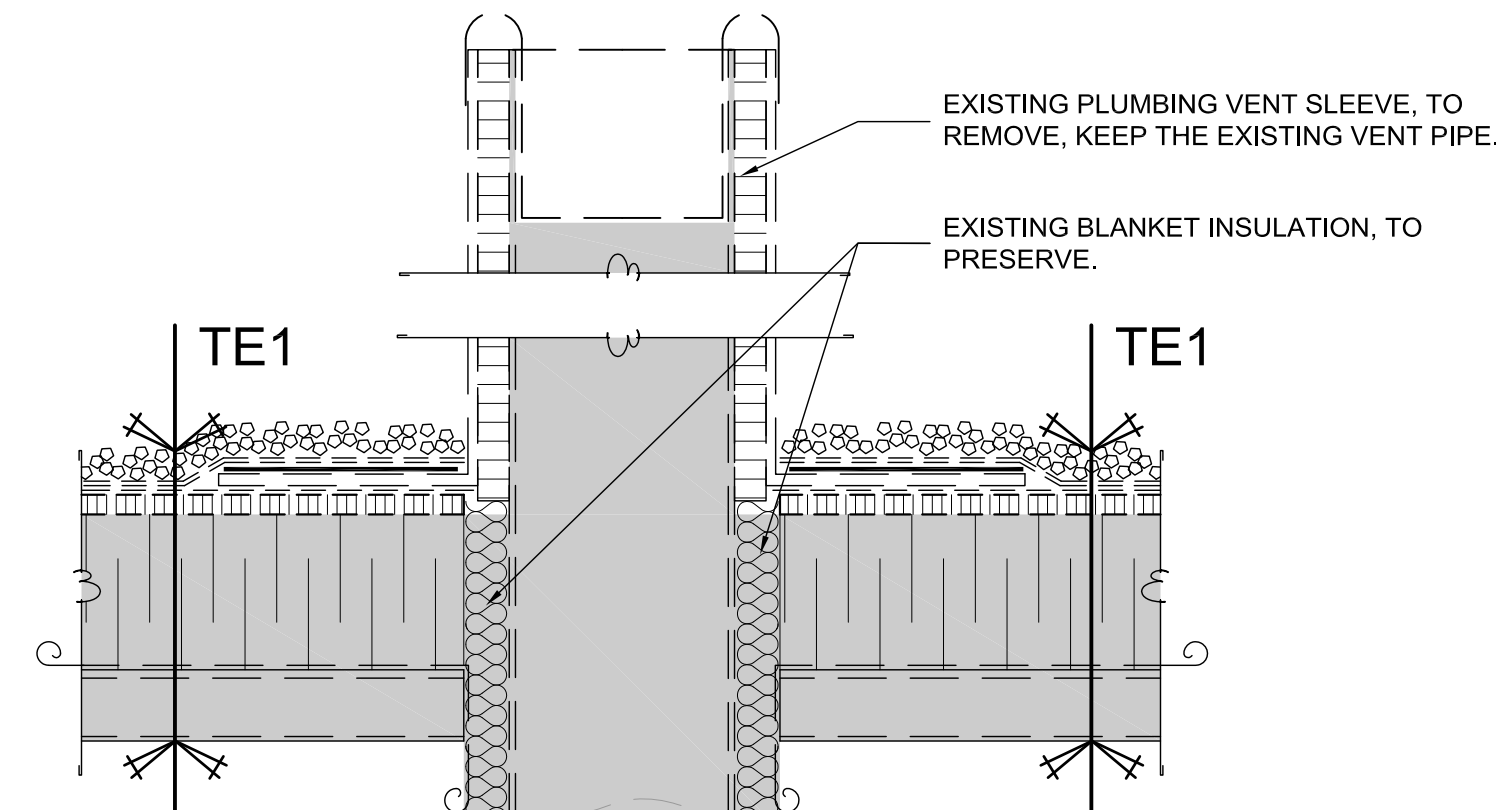

D05 DÉTAIL - EXISTING PLUMBING VENT - DEMOLITION
SCALE: 1:5

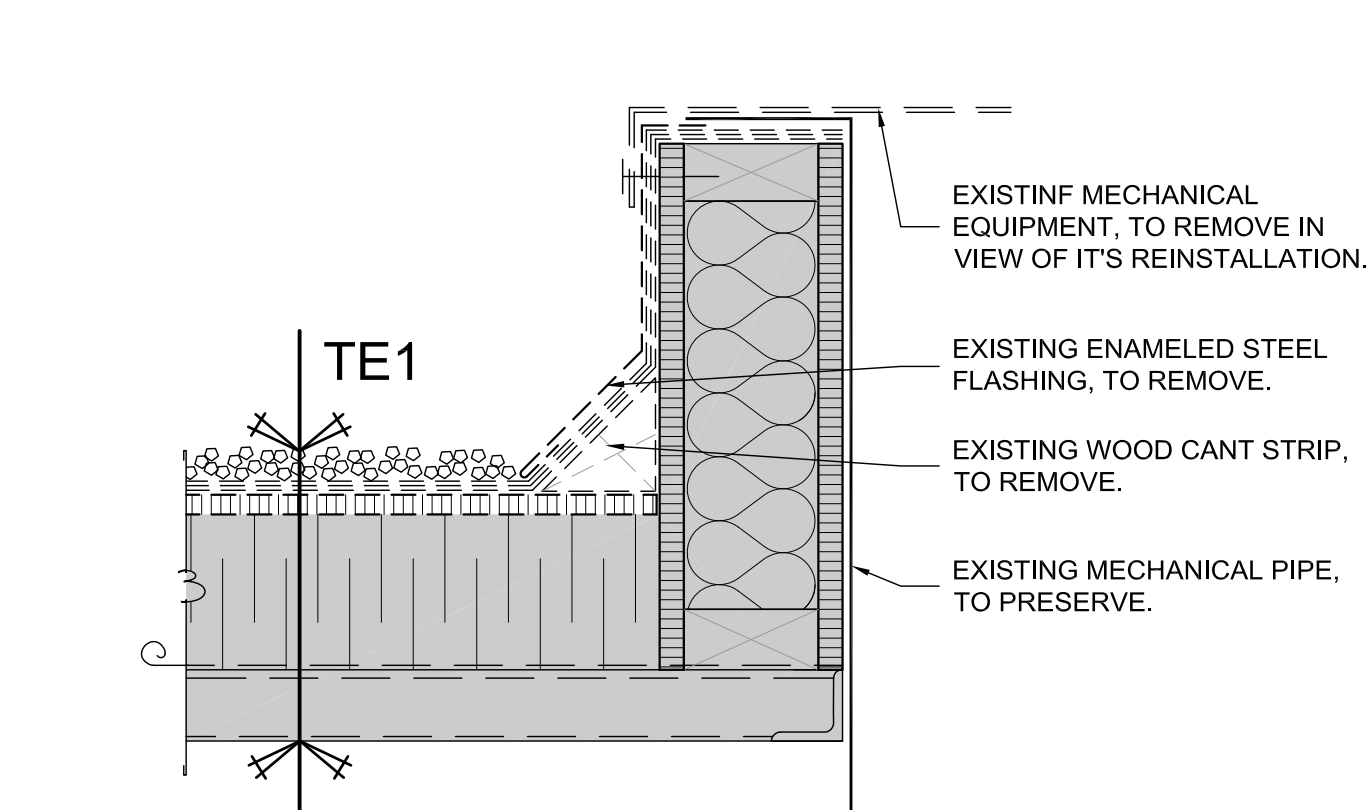

D06 DETAIL - EXISTING EQUIPMENT BASE - DEMOLITION
SCALE: 1:5

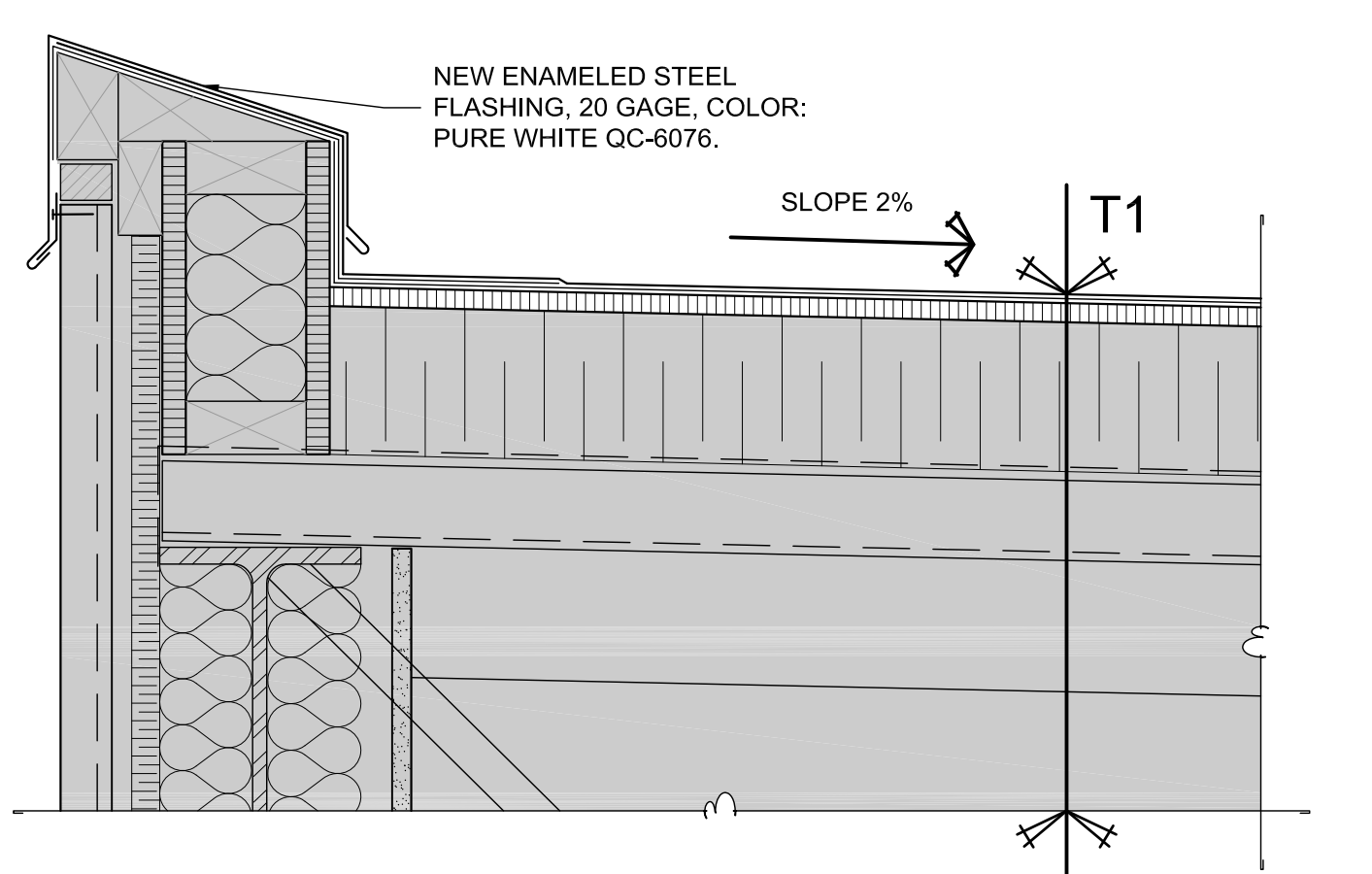

C01 DETAIL - EXISTING PARAPET - CONSTRUCTION
SCALE: 1:5

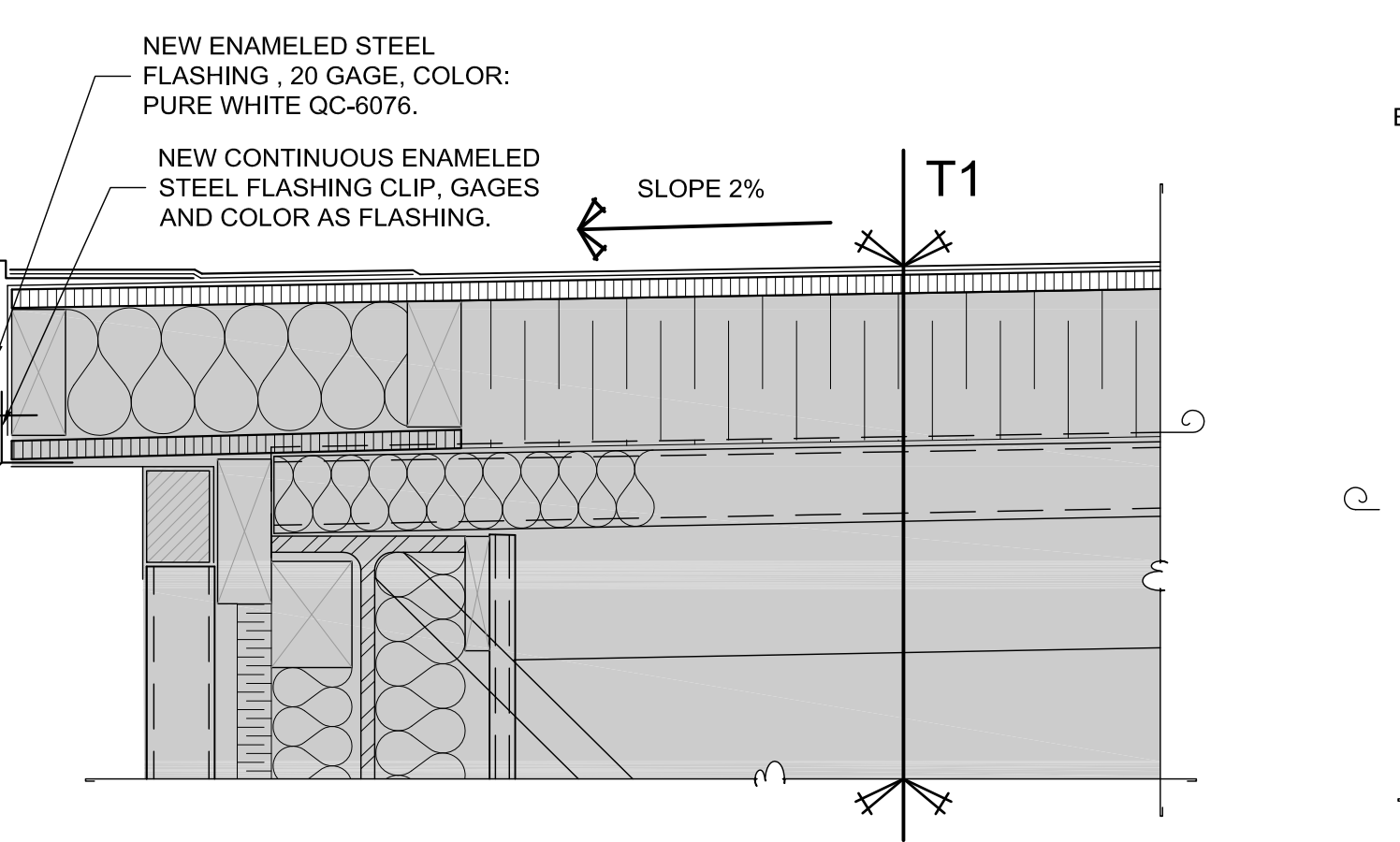

C02 DETAIL - EXISTING OVERHAND ROOF - CONSTRUCTION
SCALE: 1:5

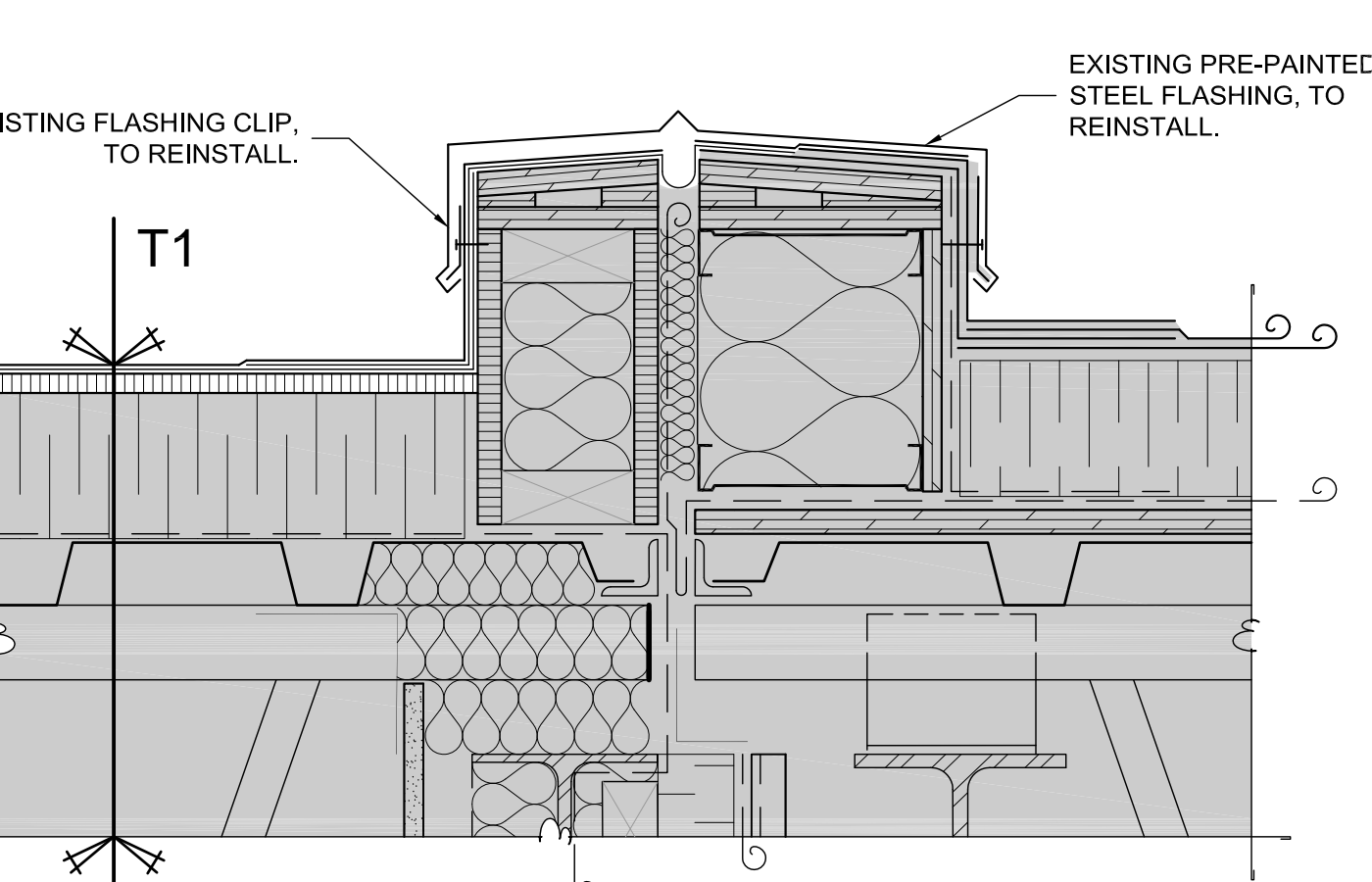

C03 DETAIL - PARAPET BETWEEN POND - CONSTRUCTION
SCALE: 1:5

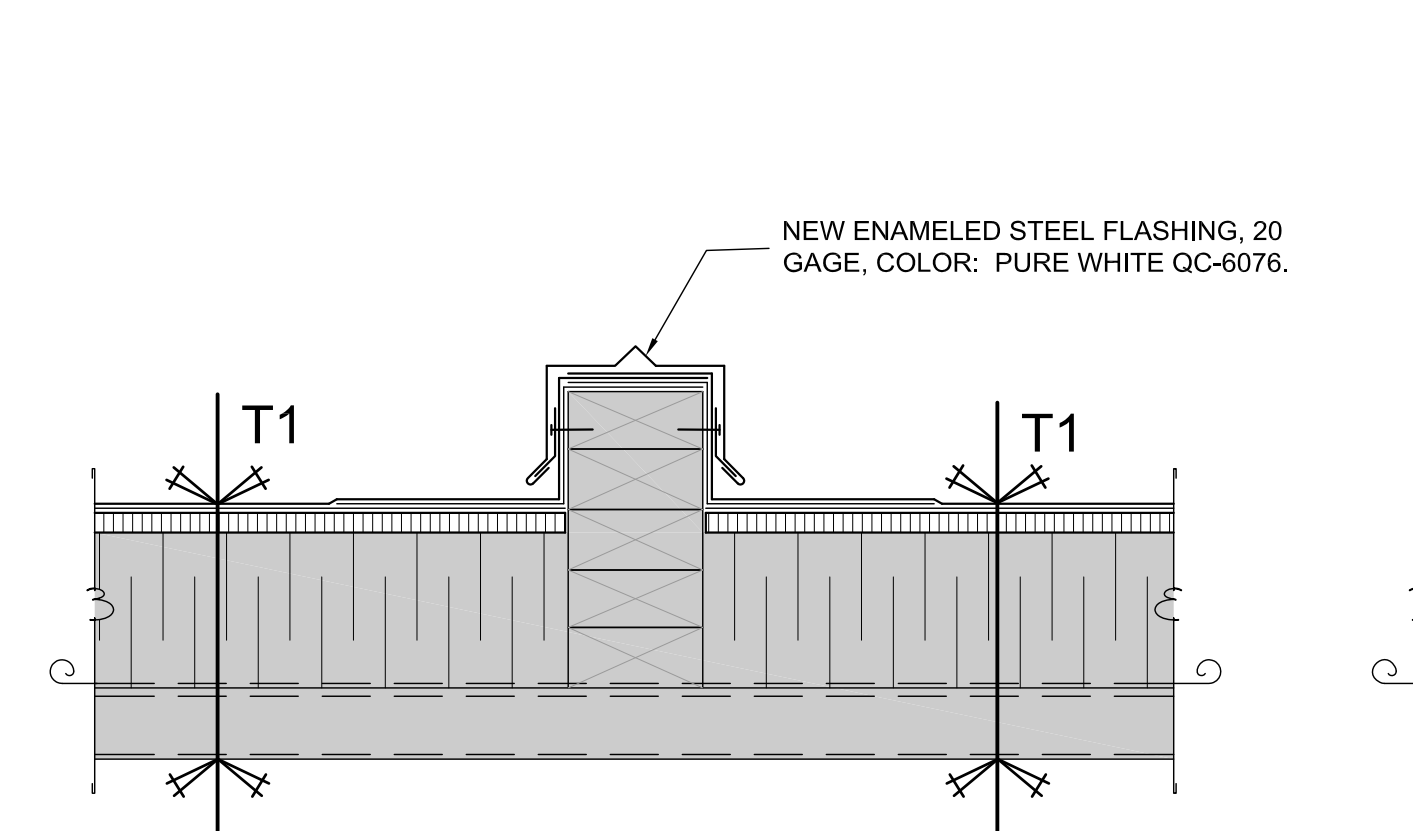

C04 DETAIL - PARAPET BETWEEN POND - CONSTRUCTION
SCALE: 1:5

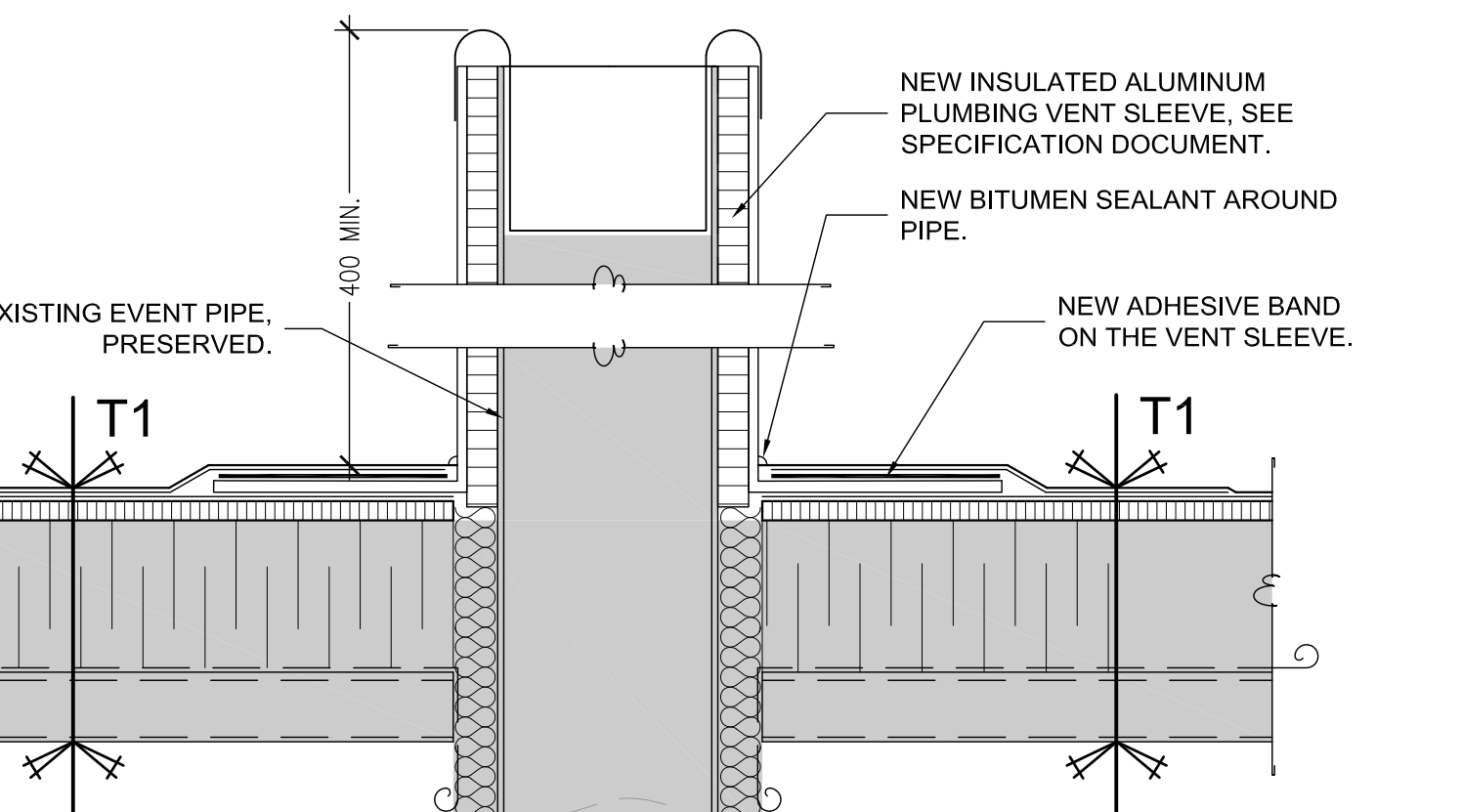

C05 DETAIL - EXISTING PLUMBING VENT - CONSTRUCTION
SCALE: 1:5

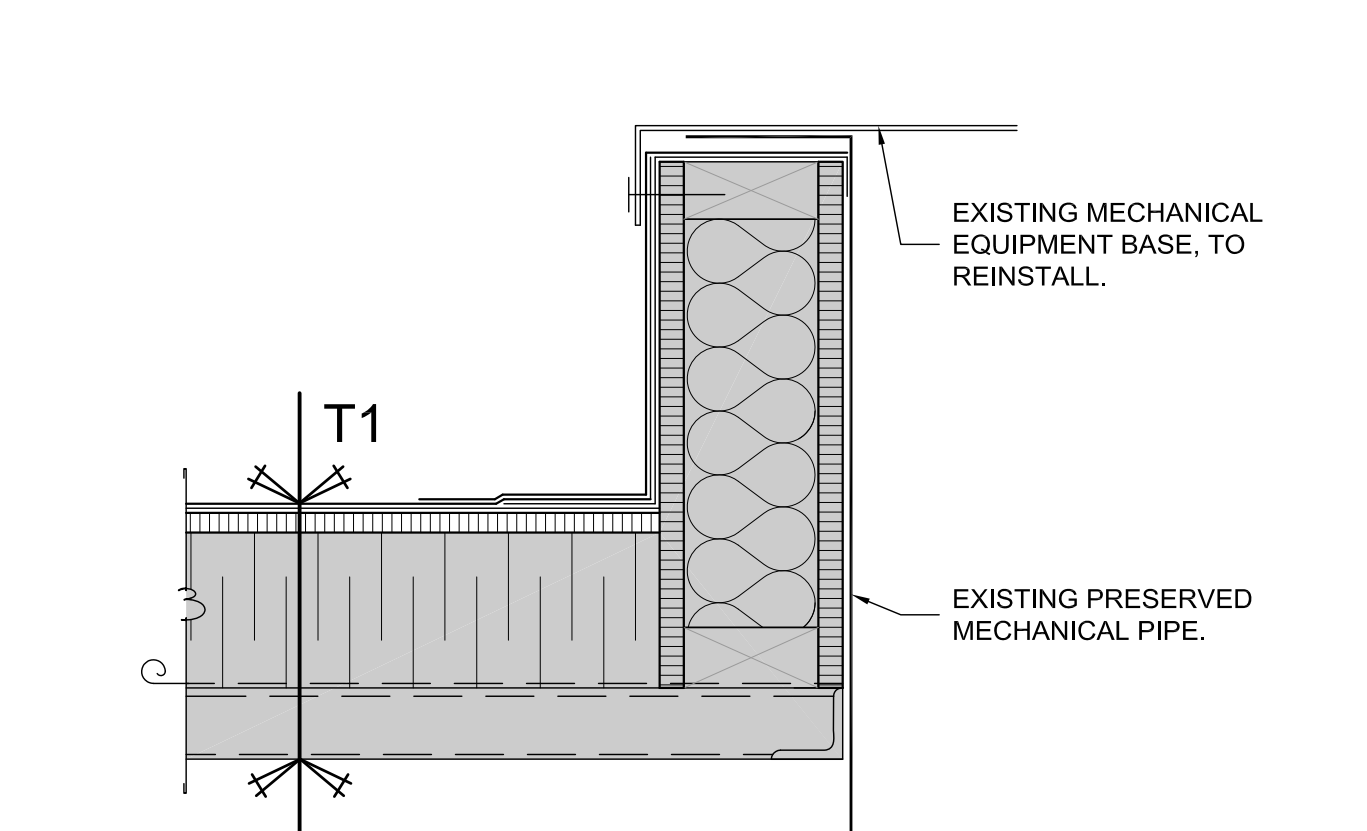

C06 DETAIL - EXISTING EQUIPMENT BASE - CONSTRUCTION
SCALE: 1:5

GRAPHIC LEGEND - PLAN

00 SPECIFIC NOTE
9 STRUCTURAL AXIS REFERENCE
XX/XXX DETAIL REFERENCE
2% EXISTING STRUCTURAL ROOF SLOPE
OUT OF MANDATE AREA

HATCH LEGEND

EXISTING ROOF, WITHOUT INTERVENTION.
EXISTING ROOF, TO REBUILD.

EXISTING COMPOSITIONS

TE1

- EXISTING BALLAST, TO REMOVE.
- EXISTING MEMBRANE, FELT 15 LBS AND ASPHALT, TO REMOVE.
- EXISTING WOOD FIBER PANEL, 13 mm THICK., TO REMOVE.
- EXISTING RIGID POLYISOCYANURATE INSULATION, 100 mm THICK. (R.30), TO PRESERVE.
- EXISTING VAPOR RETARDER MEMBRANE, TO PRESERVE.
- EXISTING STEEL DECK, TO PRESERVE.

TE1.1

- EXISTING BALLAST, TO REMOVE.
- EXISTING BITUMINOUS MEMBRANE, ±610 mm WIDE, TO REMOVE.
- EXISTING WOOD FIBER PANEL, 13 mm THICK., TO REMOVE.
- EXISTING RIGID POLYISOCYANURATE INSULATION, 100 mm THICK. R.30), TO PRESERVE.
- EXISTING VAPOR RETARDER MEMBRANE, TO PRESERVE.
- EXISTING STEEL DECK, TO PRESERVE.

NEW COMPOSITION

T1

- NEW MODIFIED BITUMINOUS MEMBRANE.
- NEW 15 mm THICK., HIGH DENSITY MINERAL FIBER BOARD LAMINATED WITH SBS MODIFIED BITUMEN BASE SHEET MEMBRANE.
- EXISTING RIGID POLYISOCYANURATE INSULATION, 100 mm THICK. (R.30), PRESERVED.
- EXISTING VAPOR RETARDER MEMBRANE, PRESERVED.
- EXISTING STEEL DECK, PRESERVED.

GENERALS NOTES

GN.1 THE CONTRACTOR IS RESPONSIBLE FOR THE VERIFICATION AND COORDINATION OF ALL DIMENSIONS.
GN.2 ALL THE DIMENSIONS HAVE TO BE VERIFIED ON SITE.
GN.3 PERFORM WORK IN ACCORDANCE WITH NATIONAL BUILDING CODE OF CANADA (NBC) INCLUDING AMENDMENTS UP TO TENDER CLOSING DATE AND OTHER PROVINCIAL OR LOCAL CODES.
GN.4 THE EXISTING ROOF COMPOSITION INDICATED ON THE PLANS ARE NON LIMITATIVE. THE CONTRACTOR SHOULD PERFORM NECESSARY DEMOLITION TO OBTAIN PERFECT EXECUTION OF WORK.
GN.5 ALL PLUMBING VENTS MUST BE REMOVED AND REPLACED.
GN.6 ALL METAL FLASHING AROUND MECHANICAL BASES, CHIMNEYS, GOOSENECKS, AND EVACUATORS MUST BE REMOVED. THE EQUIPMENT MUST BE REMOVE STORED AND REINSTALLED IN THEIR EXISTING PLACE.

Travaux publics et Services gouvernementaux Canada / Public Works and Government Services Canada
Direction générale des biens immobiliers / Real Property Branch
Région du Québec / Quebec region

Canada

CORRECTIONAL SERVICE CANADA (CSC) / SERVICE CORRECTIONNEL CANADA (SCC)

PLAN CLÉ / KEY PLAN

Bâtiment de services / Poterne

ARCHITECTURE

ABCP 300 RUE SAINT-PAUL, BUREAU 412 / QUÉBEC, QC, CANADA G1K 7R1 / T 418 649.7369

SCEAU / SEAL

Ordre des architectes du Québec / # 3549 / CATHY DUMAS / ARCHITECTE

02	POUR SOUMISSION	23/08/17
01	POUR COMMENTAIRES	18/08/17

révisions / revisions

A	A no. du détail / detail no.
B	B sur no de dessin / location drawing no.
C	C no de dessin / drawing no.

Projet / Project

DONNACONA INSTITUTION ROOF REHABILITATION SERVICES BUILDING AND POSTERN

1537, HIGHWAY 138, DONNACONA (QUEBEC) G3M 1C9

Dessin / Drawing

ARCHITECTURE

DETAILS

SERVICES BUILDING

DEMOLITION / CONSTRUCTION

Conçu par / Designed by
AUDREY BOUCHARD 18/08/2017 Date

Dessiné par / Drawn by
AUDREY BOUCHARD 18/08/2017 Date

Approuvé par / Approved by
CATHY DUMAS 18/08/2017 Date

Soumission / Tender
Gestionnaire de projet TPSGC / PWSC project manager

No de projet / Project number 550-2-321-3703 TPSGC / PWSC	No de projet / Project number QC17-1099 Client
---	--

Nom du fichier / File name / No de classement

No de plan ou dessin / No feuille / Sheet no
A02/6

AutoCAD 2017/09/05 Q:\2017-QC\QC17-1099 SCC_DONNACONA-TOUTURES\10_DESSIN\06_ARCHITECTURE\A-TO-CNT-550-2-321-3703 BS - EN.DWG



02 PICTURE - ROOF DRAIN
SCALE: NONE



03 PICTURE - ROOF MECHANICAL
SCALE: NONE



04 PICTURE - ROOF MECHANICAL
SCALE: NONE

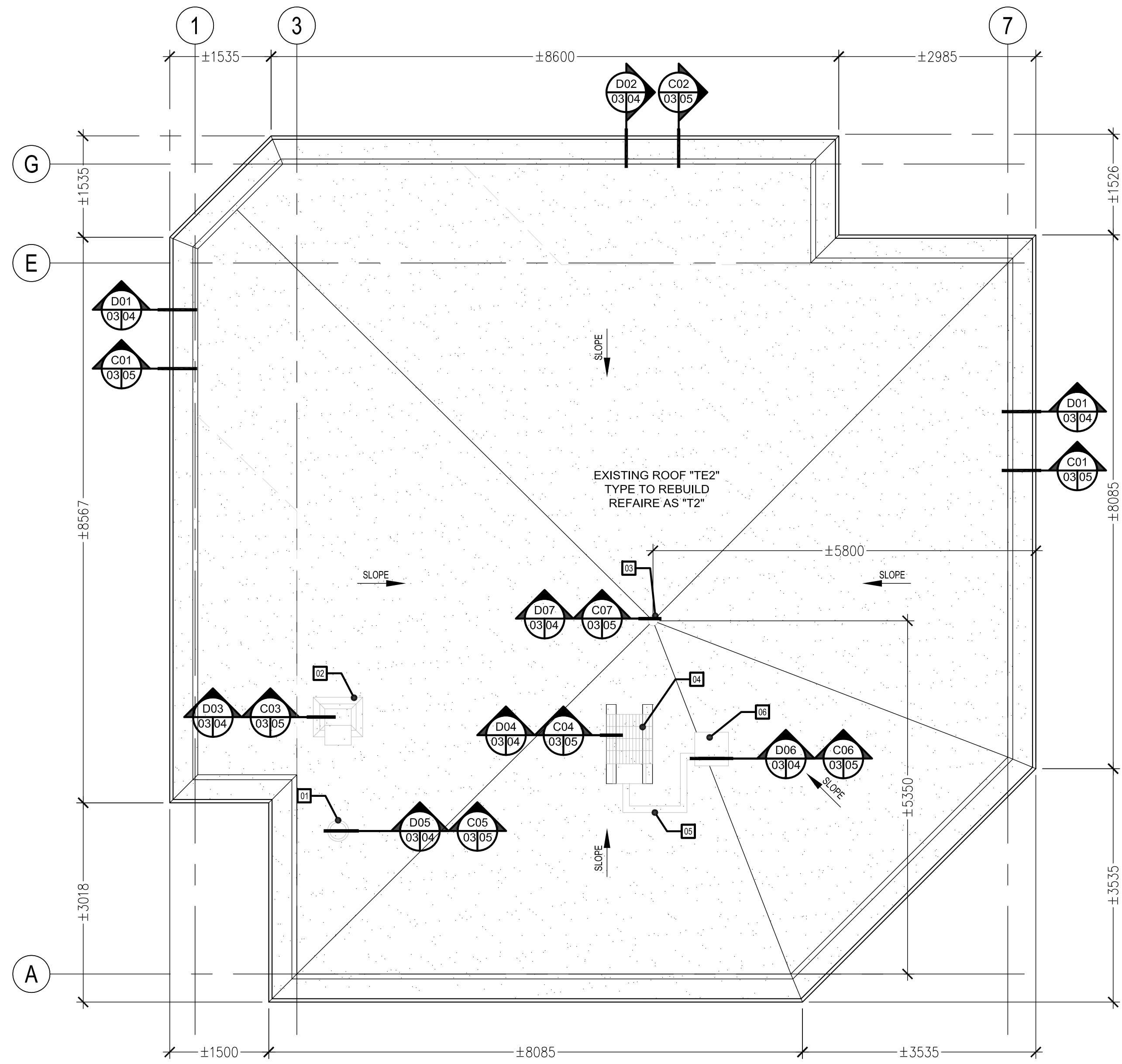

01 ROOF PLAN - POSTERN
SCALE: 1:50

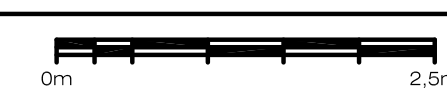

GRAPHIC LEGEND - PLAN

- 00 SPECIFIC NOTE
- 9 STRUCTURAL AXIS REFERENCE
- XX XXXX DETAIL REFERENCE
- 2% EXISTING STRUCTURAL ROOF SLOPE

HATCH LEGEND

- EXISTING ROOF, TO REBUILD.

EXISTING COMPOSITION

- TE2
- EXISTING BITUMINOUS GRANULED MEMBRANE, TO REMOVE.
 - EXISTING WOOD FIBER PANEL, 25 mm THICK., TO REMOVE.
 - EXISTING 2% SLOPE INSULATION, TO PRESERVE.
 - EXISTING RIGID INSULATION, 50 mm THICK., TO PRESERVE.
 - EXISTING VAPOR RETARDER MEMBRANE, TO PRESERVE.
 - EXISTING GYPSUM BOARD, 16 mm THICK., TO PRESERVE.
 - EXISTING STEEL DECK, TO PRESERVE.

NEW COMPOSITION

- T2
- NEW MODIFIED BITUMINOUS MEMBRANE.
 - NEW 15 mm THICK., HIGH DENSITY MINERAL FIBER BOARD LAMINATED WITH SBS MODIFIED BITUMEN BASE SHEET MEMBRANE.
 - EXISTING 2% SLOPE INSULATION, PRESERVED.
 - EXISTING RIGID INSULATION, 50 mm THICK., PRESERVED.
 - EXISTING VAPOR RETARDER MEMBRANE, PRESERVED.
 - EXISTING GYPSUM BOARD, 16 mm THICK., PRESERVED.
 - EXISTING STEEL DECK, PRESERVED.

GENERALS NOTES

- GN.1 THE CONTRACTOR IS RESPONSIBLE FOR THE VERIFICATION AND COORDINATION OF ALL DIMENSIONS.
- GN.2 ALL THE DIMENSIONS HAVE TO BE VERIFIED ON SITE.
- GN.3 PERFORM WORK IN ACCORDANCE WITH NATIONAL BUILDING CODE OF CANADA (NBC) INCLUDING AMENDMENTS UP TO TENDER CLOSING DATE AND OTHER PROVINCIAL OR LOCAL CODES.
- GN.4 THE EXISTING ROOF COMPOSITION INDICATED ON THE PLANS ARE NON LIMITATIVE. THE CONTRACTOR SHOULD PERFORM NECESSARY DEMOLITION TO OBTAIN PROPER EXECUTION OF WORK.
- GN.5 ALL PLUMBING VENTS MUST BE REMOVED AND REPLACED.
- GN.6 ALL METAL FLASHING AROUND MECHANICAL BASES, CHIMNEYS, GOOSENECKS, AND EVACUATORS MUST BE REMOVED. THE EQUIPMENT MUST BE REMOVE STORED AND REINSTALLED IN THEIR EXISTING PLACE.

SPÉCIFIC NOTES

- 01 PLUMBING EVENT SLEEVE, TO REMOVE.
- 02 GOOSENECK, TO REMOVE, STORE AND REINSTALL.
- 03 ROOF DRAIN, REMOVE.
- 04 CONDENSER, TO REMOVE, TEMPORARILY SUPPORT AND REINSTALL.
- 05 CONDENSER CONNECTION PIPE, TO TEMPORARILY SUPPORT, INSTALL 2 NEW PIPE BRACKES SUCH AS RTB-01-ROL-05 FROM ROOF TOP BLOX COMPANY.
- 06 CONDENSOR ELECTRICAL SUPPLY BOX, REBUILD SEALING MEMBRANE DETAIL.

PLAN CLÉ / KEY PLAN

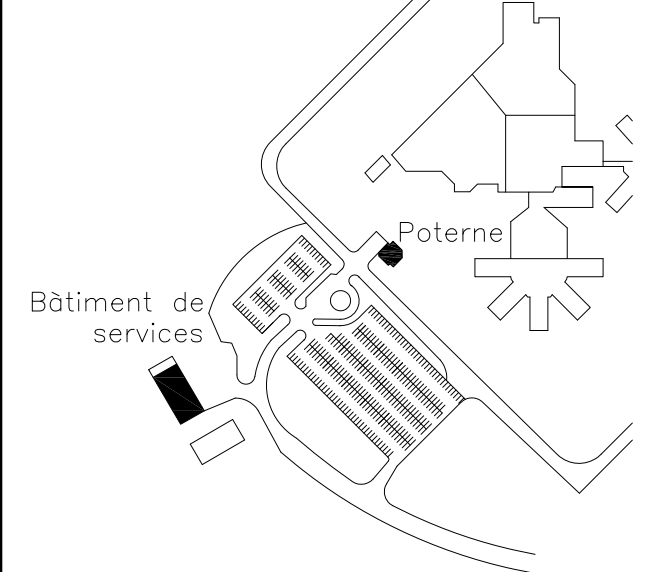

ARCHITECTURE



SCEAU / SEAL



02	FOR TENDER	23/08/17
01	FOR COMMENTARY	18/08/17
révisions		date

A	A no. du détail detail no
B	B sur no de dessin location drawing no
C	C no de dessin drawing no

Projet / Project
DONNACONA INSTITUTION ROOF REHABILITATION SERVICES BUILDING AND POSTERN
 1537, HIGHWAY 138, DONNACONA (QUEBEC) G3M 1C9

Dessin / Drawing
ARCHITECTURE PLAN AND PICTURES POSTERN DEMOLITION / CONSTRUCTION

Conçu par / Designed by AUDREY BOUCHARD	18/08/2017 Date
Dessiné par / Drawn by AUDREY BOUCHARD	18/08/2017 Date
Approuvé par / Approved by CATHY DUMAS	18/08/2017 Date
Soumission / Tender	Gestionnaire de projet TPSCC / PWSC project manager

No de projet / Project number 550-2-321-3703 TPSCC / PWSC	No de projet / Project number QC17-1099 Client
Nom du fichier / File name	No de classement

No de plan ou dessin	No feuille / Sheet no A03/6
----------------------	--------------------------------

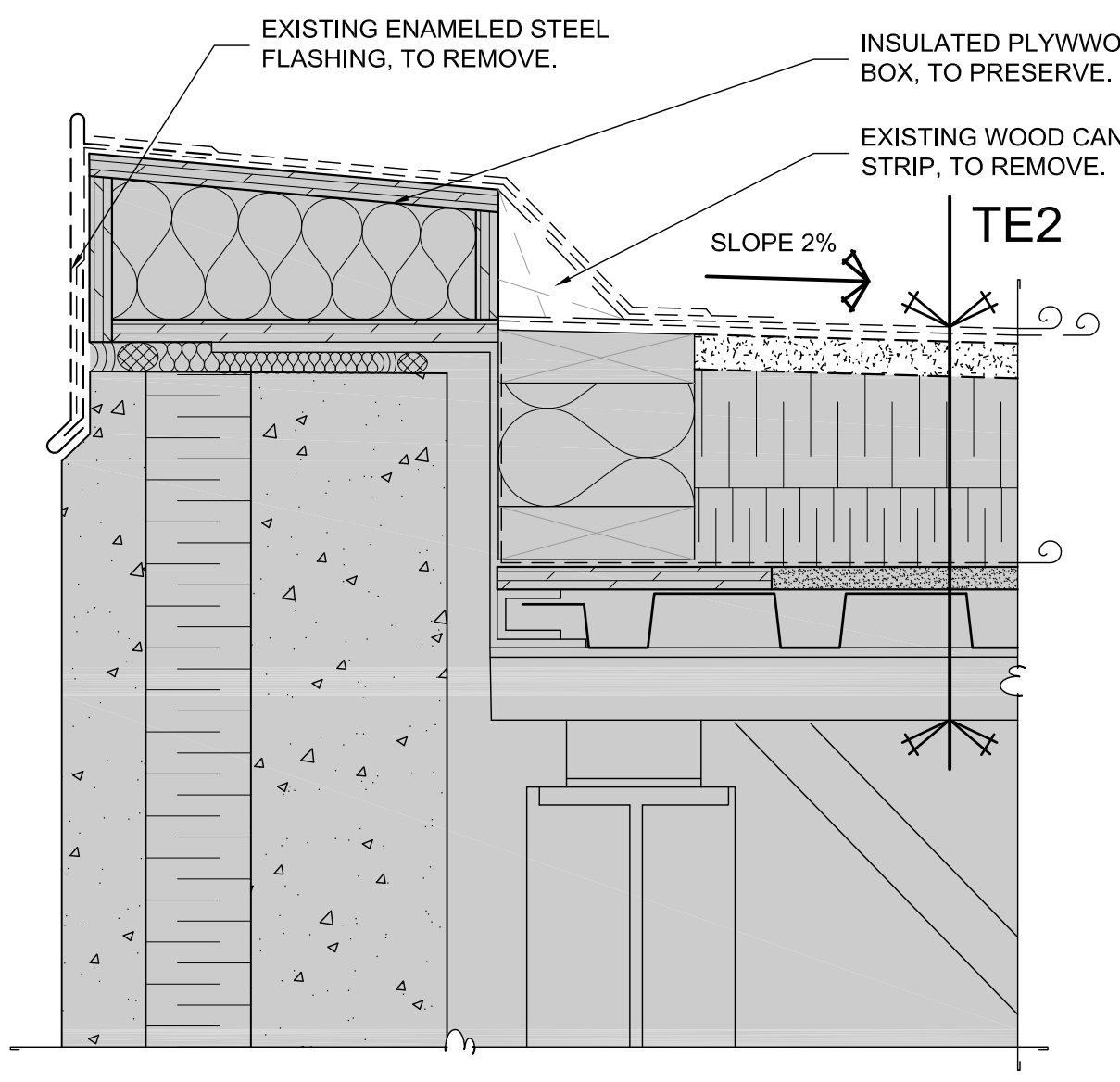

D01 DETAIL - EXISTING PARAPET - DEMOLITION
SCALE: 1:5

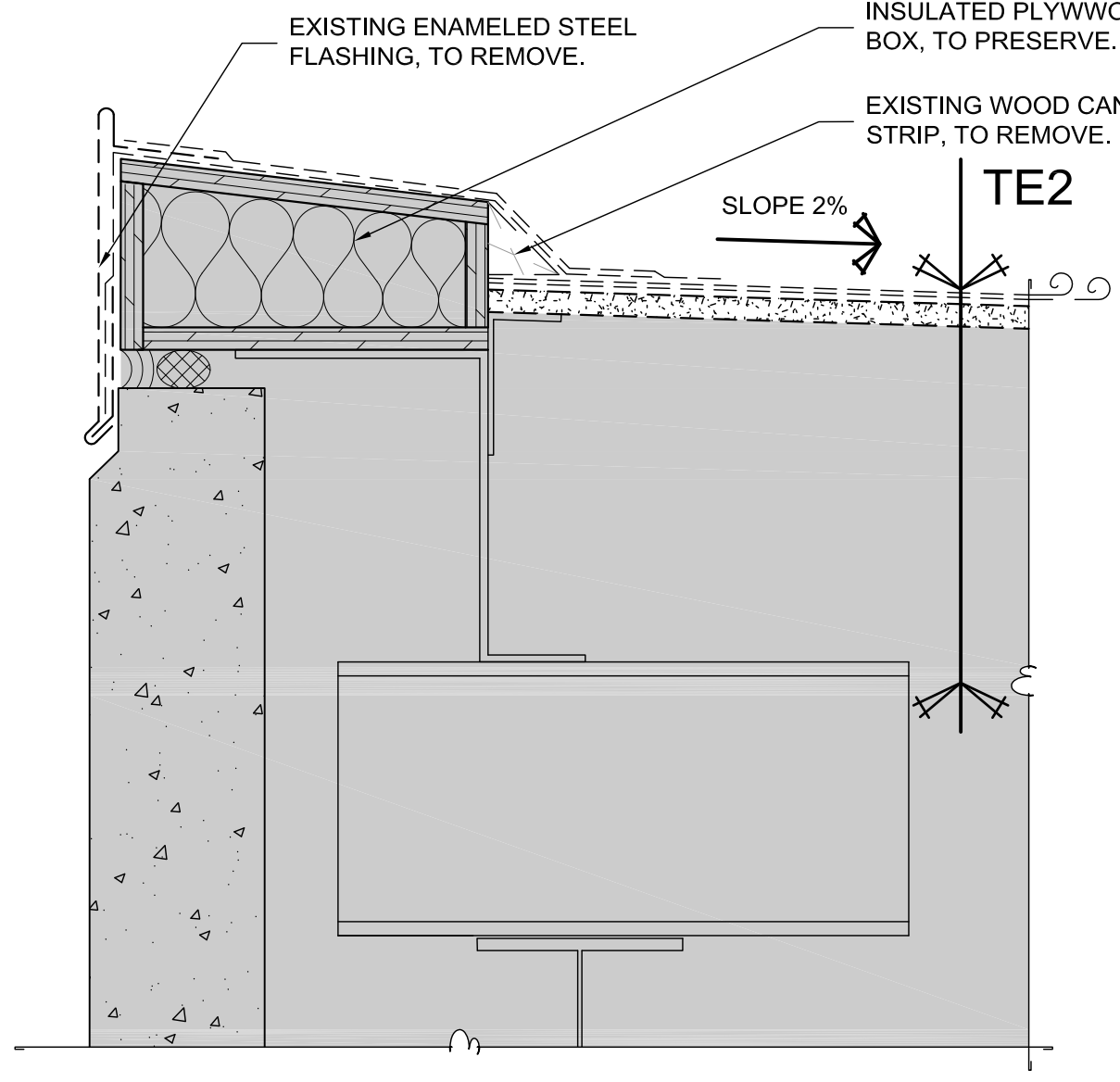

D02 DETAIL - EXISTING PARAPET - DEMOLITION
SCALE: 1:5

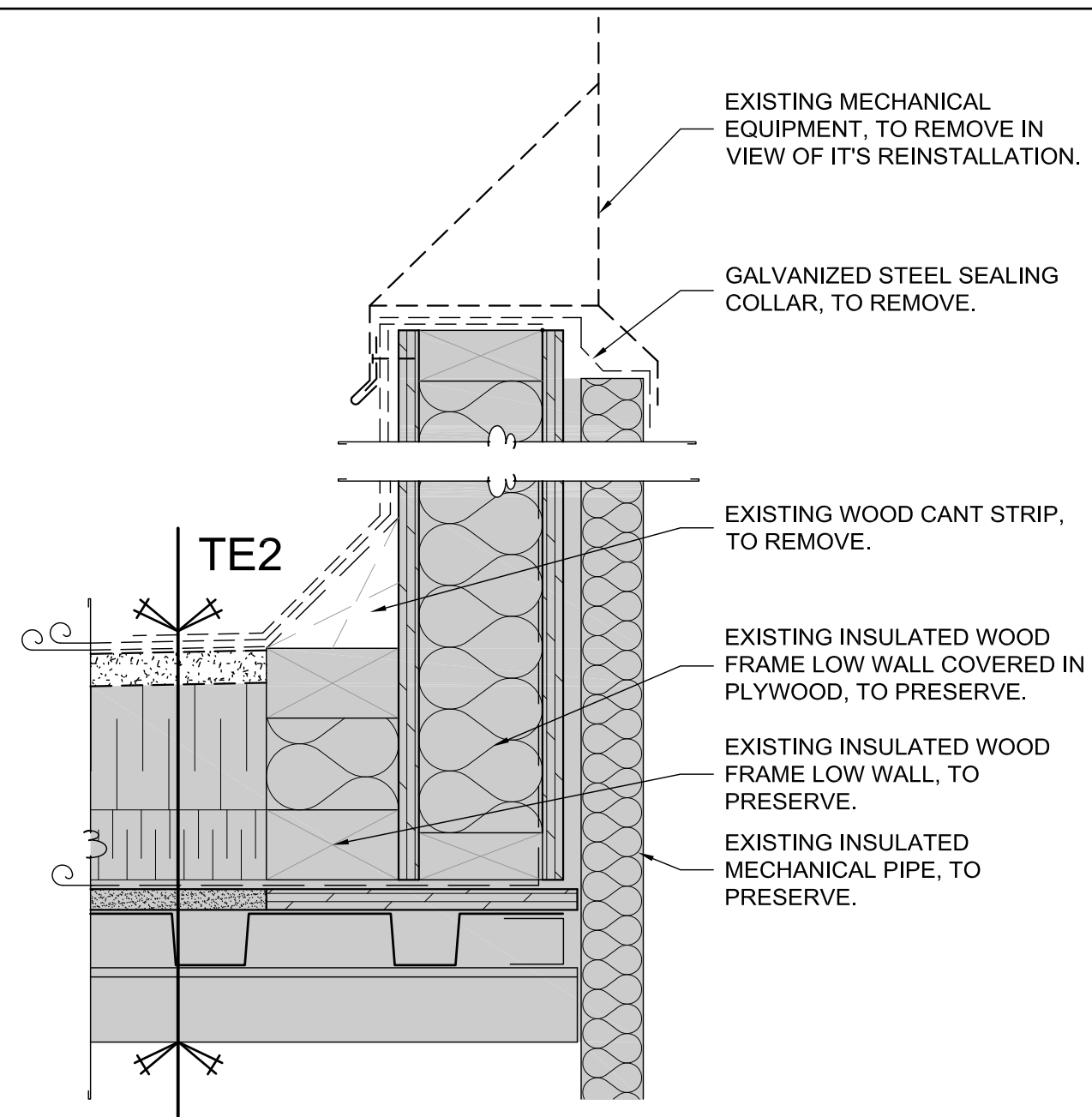

D03 DETAIL - GOOSENECK - DEMOLITION
SCALE: 1:5

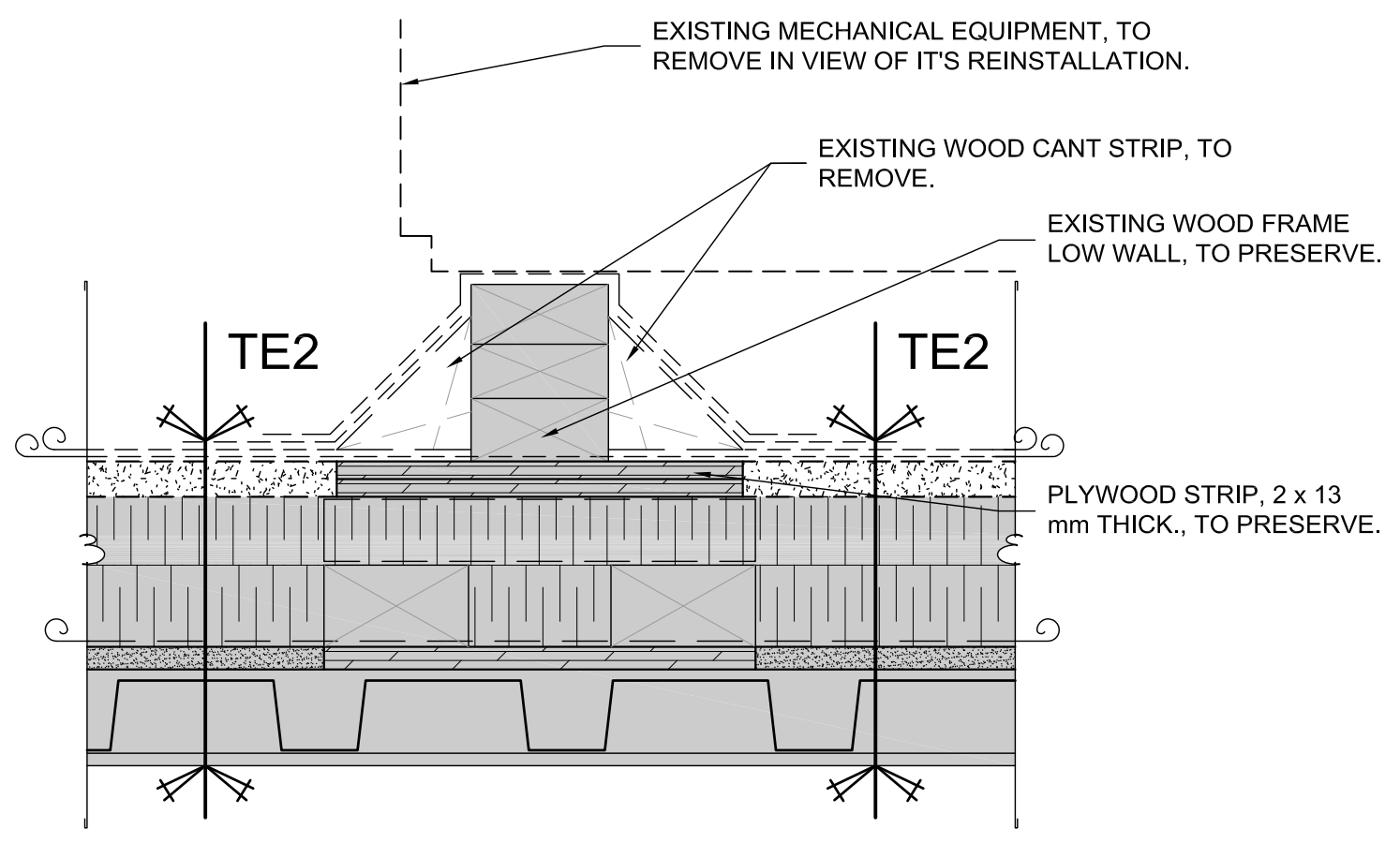
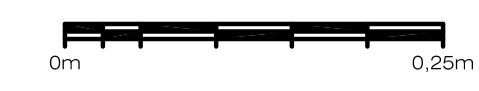

D04 DETAIL - MECHANICAL BASE - DEMOLITION
SCALE: 1:5

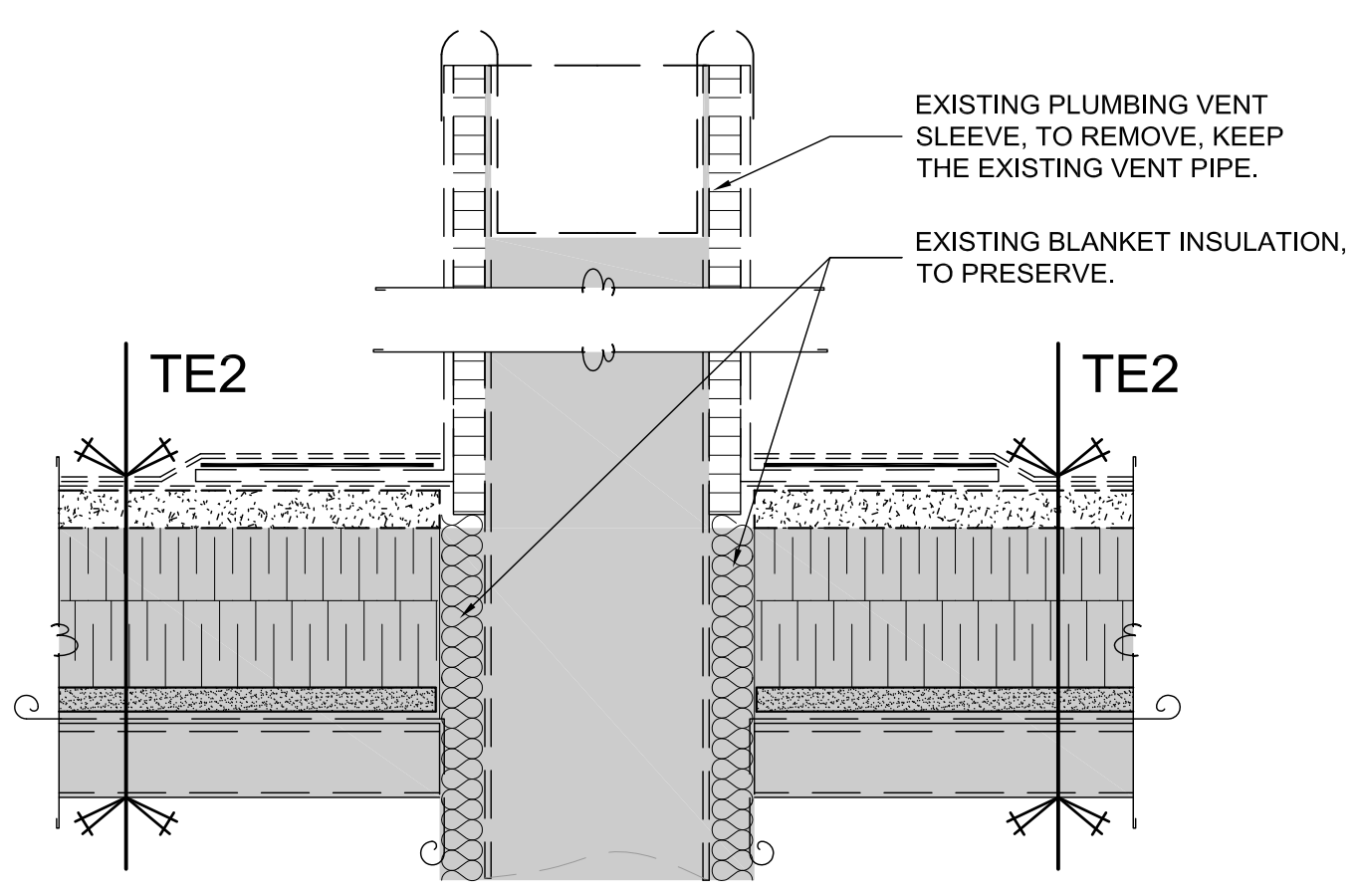

D05 DETAIL - PLUMBING VENT - DEMOLITION
SCALE: 1:5

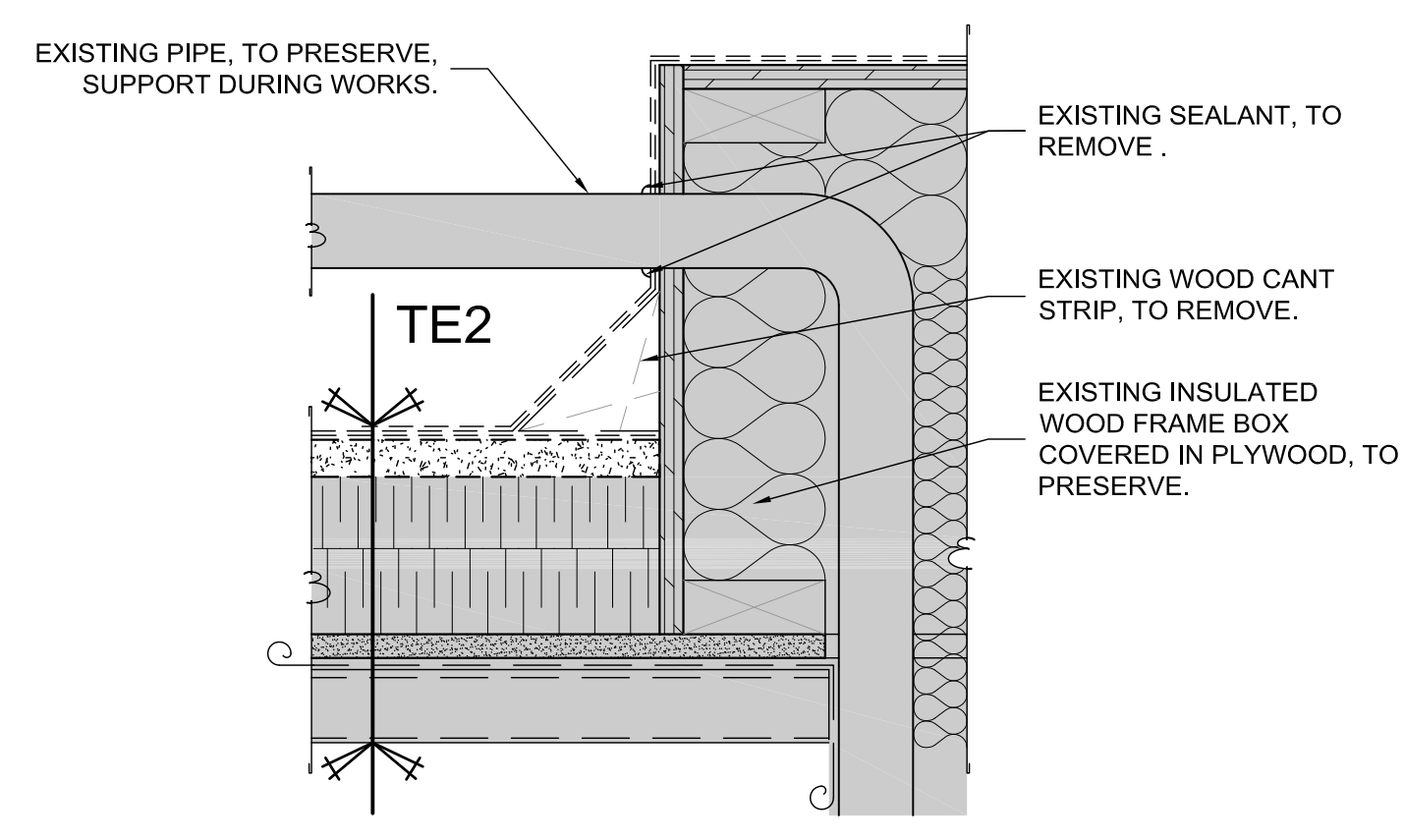
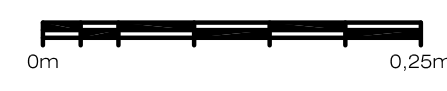

D06 DETAIL - SUPPLY BOX - DEMOLITION
SCALE: 1:5

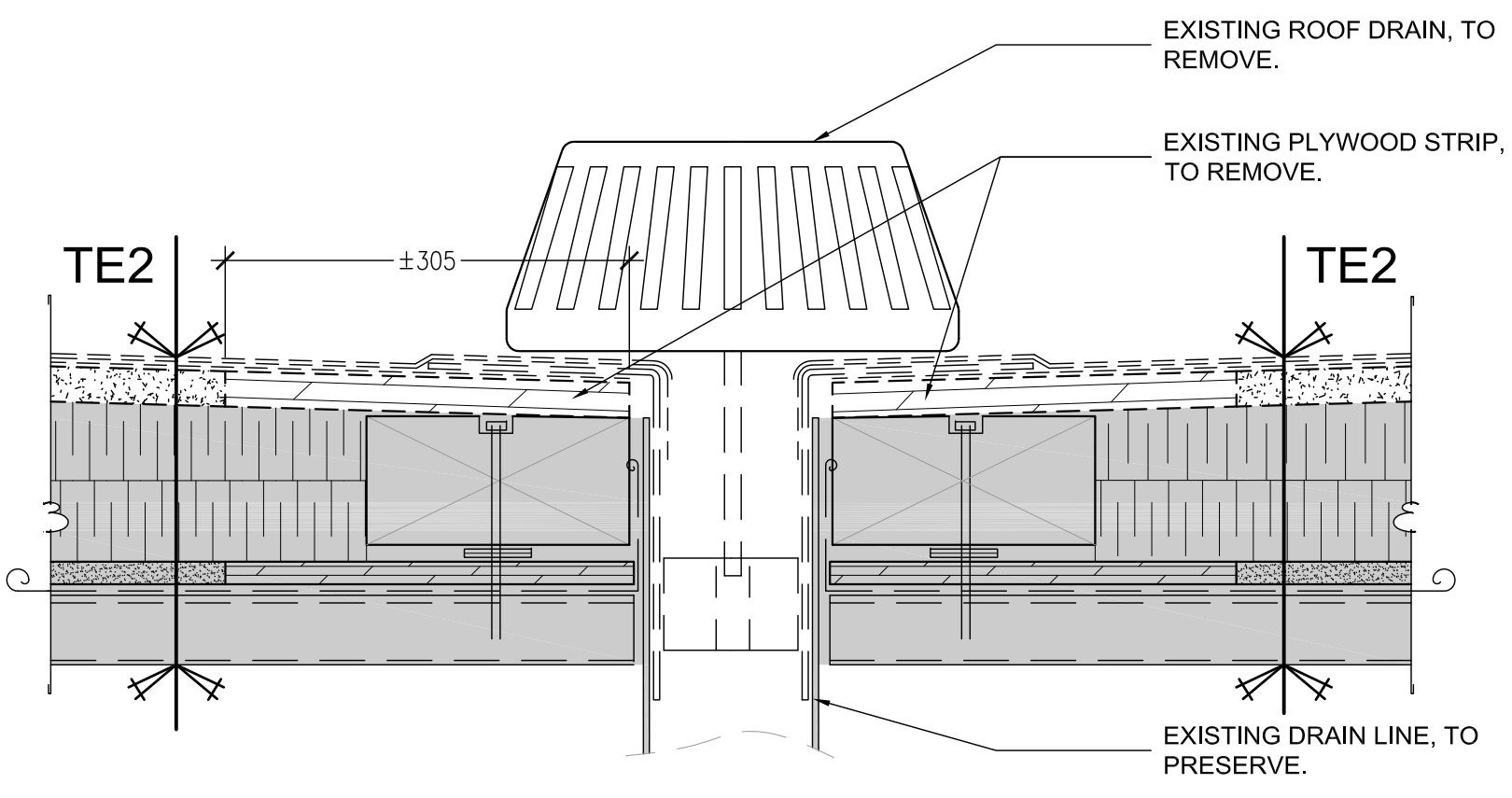
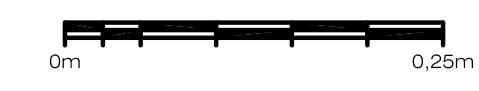

D07 DETAIL - EXISTING ROOF DRAIN - DEMOLITION
SCALE: 1:5

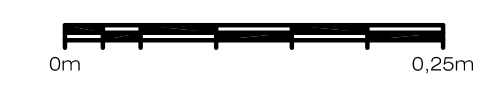

GRAPHIC LEGEND - PLAN

00 SPECIFIC NOTE
9 STRUCTURAL AXIS REFERENCE
2% EXISTING STRUCTURAL ROOF SLOPE

HATCH LEGEND

EXISTING ROOF, TO REBUILD.

EXISTING COMPOSITION

TE2

- EXISTING BITUMINOUS GRANULATED MEMBRANE, TO REMOVE.
- EXISTING WOOD FIBER PANEL, 25 mm THICK., TO REMOVE.
- EXISTING 2% SLOPE INSULATION, TO PRESERVE.
- EXISTING RIGID INSULATION, 50 mm THICK., TO PRESERVE.
- EXISTING VAPOR RETARDER MEMBRANE, TO PRESERVE.
- EXISTING GYPSUM BOARD, 16 mm THICK., TO PRESERVE.
- EXISTING STEEL DECK, TO PRESERVE.

NEW COMPOSITION

T2

- NEW MODIFIED BITUMINOUS MEMBRANE.
- NEW 15 mm THICK., HIGH DENSITY MINERAL FIBER BOARD LAMINATED WITH SBS MODIFIED BITUMEN BASE SHEET MEMBRANE.
- EXISTING 2% SLOPE INSULATION, PRESERVED.
- EXISTING RIGID INSULATION, 50 mm THICK., PRESERVED.
- EXISTING VAPOR RETARDER MEMBRANE, PRESERVED.
- EXISTING GYPSUM BOARD, 16 mm THICK., PRESERVED.
- EXISTING STEEL DECK, PRESERVED.

GENERALS NOTES

GN.1 THE CONTRACTOR IS RESPONSIBLE FOR THE VERIFICATION AND COORDINATION OF ALL DIMENSIONS.

GN.2 ALL THE DIMENSIONS HAVE TO BE VERIFIED ON SITE.

GN.3 PERFORM WORK IN ACCORDANCE WITH NATIONAL BUILDING CODE OF CANADA (NBC) INCLUDING AMENDMENTS UP TO TENDER CLOSING DATE AND OTHER PROVINCIAL OR LOCAL CODES.

GN.4 THE EXISTING ROOF COMPOSITION INDICATED ON THE PLANS ARE NON LIMITATIVE. THE CONTRACTOR SHOULD PERFORM NECESSARY DEMOLITION TO OBTAIN PERFECT EXECUTION OF WORK.

GN.5 ALL PLUMBING VENTS MUST BE REMOVED AND REPLACED.

GN.6 ALL METAL FLASHING AROUND MECHANICAL BASES, CHIMNEYS, GOOSENECKS, AND EVACUATORS MUST BE REMOVED. THE EQUIPMENT MUST BE REMOVE STORED AND REINSTALLED IN THEIR EXISTING PLACE.

Travaux publics et Services gouvernementaux Canada
Direction générale des biens immobiliers
Région du Québec

Public Works and Government Services Canada
Real Property Branch
Quebec region

Canada

CORRECTIONAL SERVICE CANADA (CSC) SERVICE CORRECTIONNEL CANADA (SCC)

PLAN CLÉ / KEY PLAN

Bâtiment de services

ARCHITECTURE

ABCP ARCHITECTURE
300 RUE SAINT-PAUL, BUREAU 412
QUÉBEC, QC, CANADA G1K 7R1
T 418 649.7369

SCEAU / SEAL

Ordre des architectes du Québec
CATHY DUMAS
3549
ARCHITECTE

02	FOR TENDER	23/08/17
01	FOR COMMENTARY	18/08/17

révisions / revisions

A no. du détail / detail no	location drawing no	date
A	B	C

Projet / Project

DONNACONA INSTITUTION ROOF REHABILITATION SERVICES BUILDING AND POSTERN

1537, HIGHWAY 138, DONNACONA (QUEBEC) G3M 1C9

Dessin / Drawing

ARCHITECTURE

DETAILS
POSTERN
DEMOLITION

Conçu par / Designed by
AUDREY BOUCHARD 18/08/2017 Date

Dessiné par / Drawn by
AUDREY BOUCHARD 18/08/2017 Date

Approuvé par / Approved by
CATHY DUMAS 18/08/2017 Date

Soumission / Tender Gestionnaire de projet TPSGC / PWSCC project manager

No de projet / Project number 550-2-321-3703 TPSGC / PWSCC	No de projet / Project number QC17-1099 Client
--	--

Nom du fichier / File name No de classement

No de plan ou dessin No feuille / Sheet no
A04/6

Q:\2017-QC\QC17-1099 SCC_DONNACONA-TORTURES\10_DESSIN\06_ARCHITECTURE\A-TO-CNT-550-2-321-3703 PO - EN.DWG AutoCAD 2017/09/05

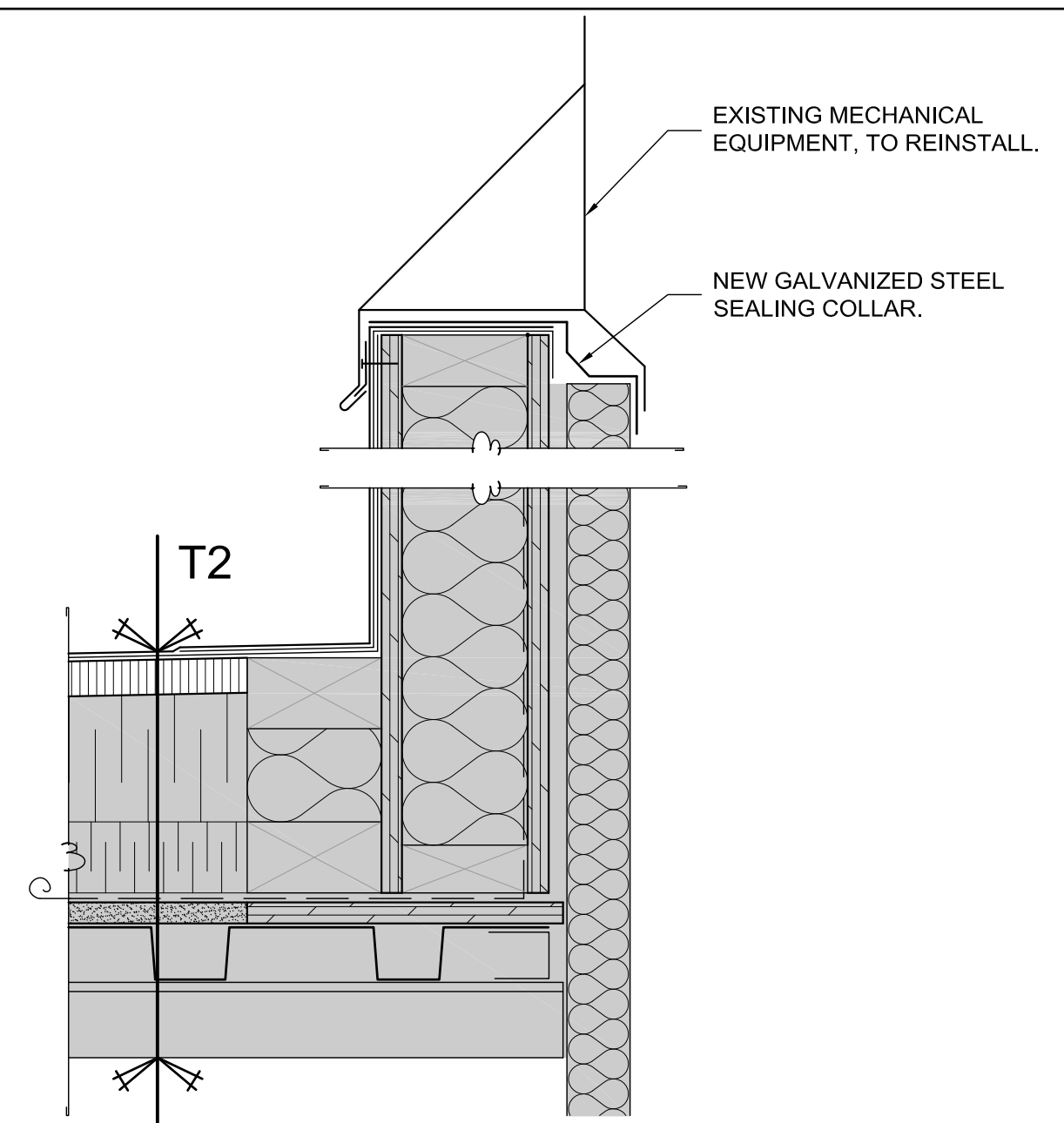
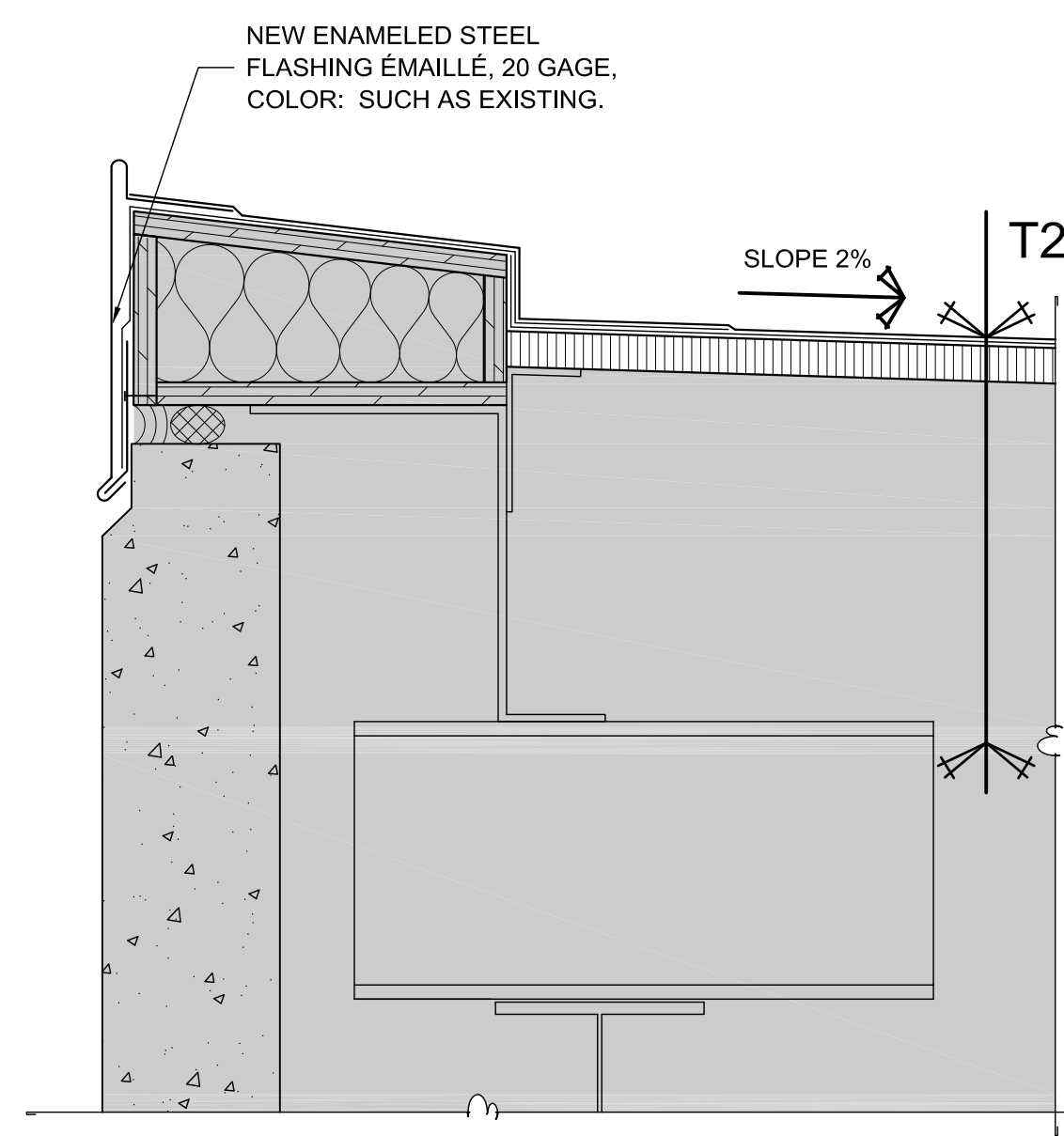
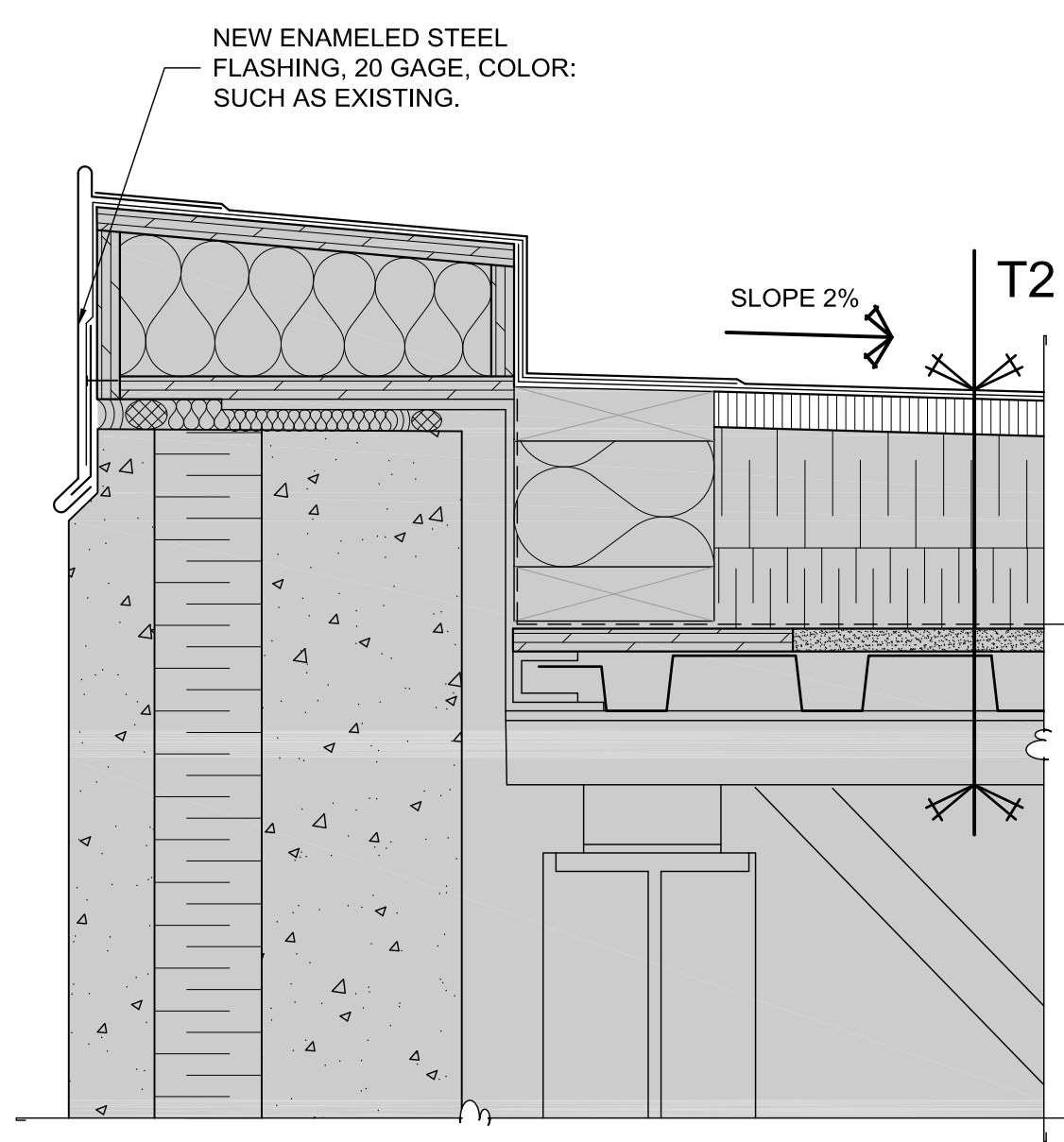

C01 DETAIL - EXISTING PARAPET - CONSTRUCTION
SCALE: 1:5

C02 DETAIL - EXISTING PARAPET - CONSTRUCTION
SCALE: 1:5

C03 DETAIL - GOOSENECK - CONSTRUCTION
SCALE: 1:5

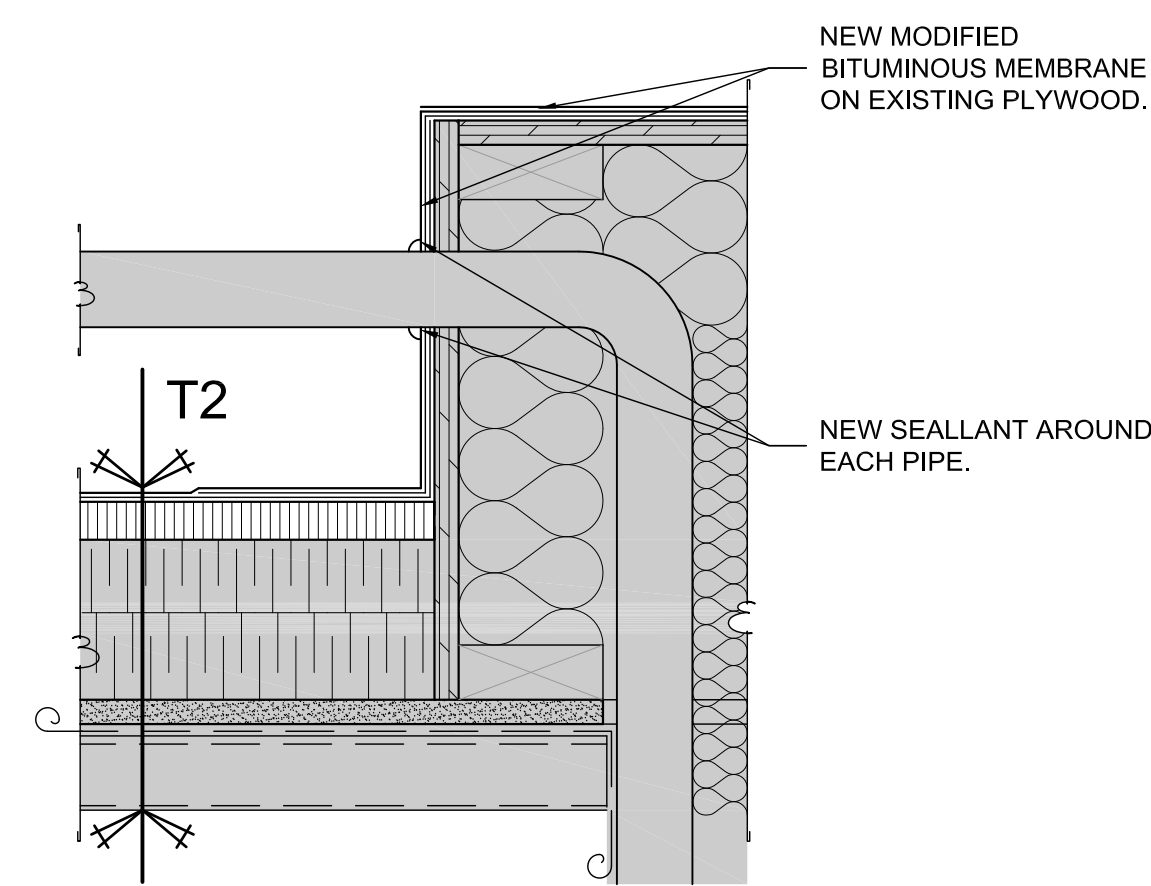
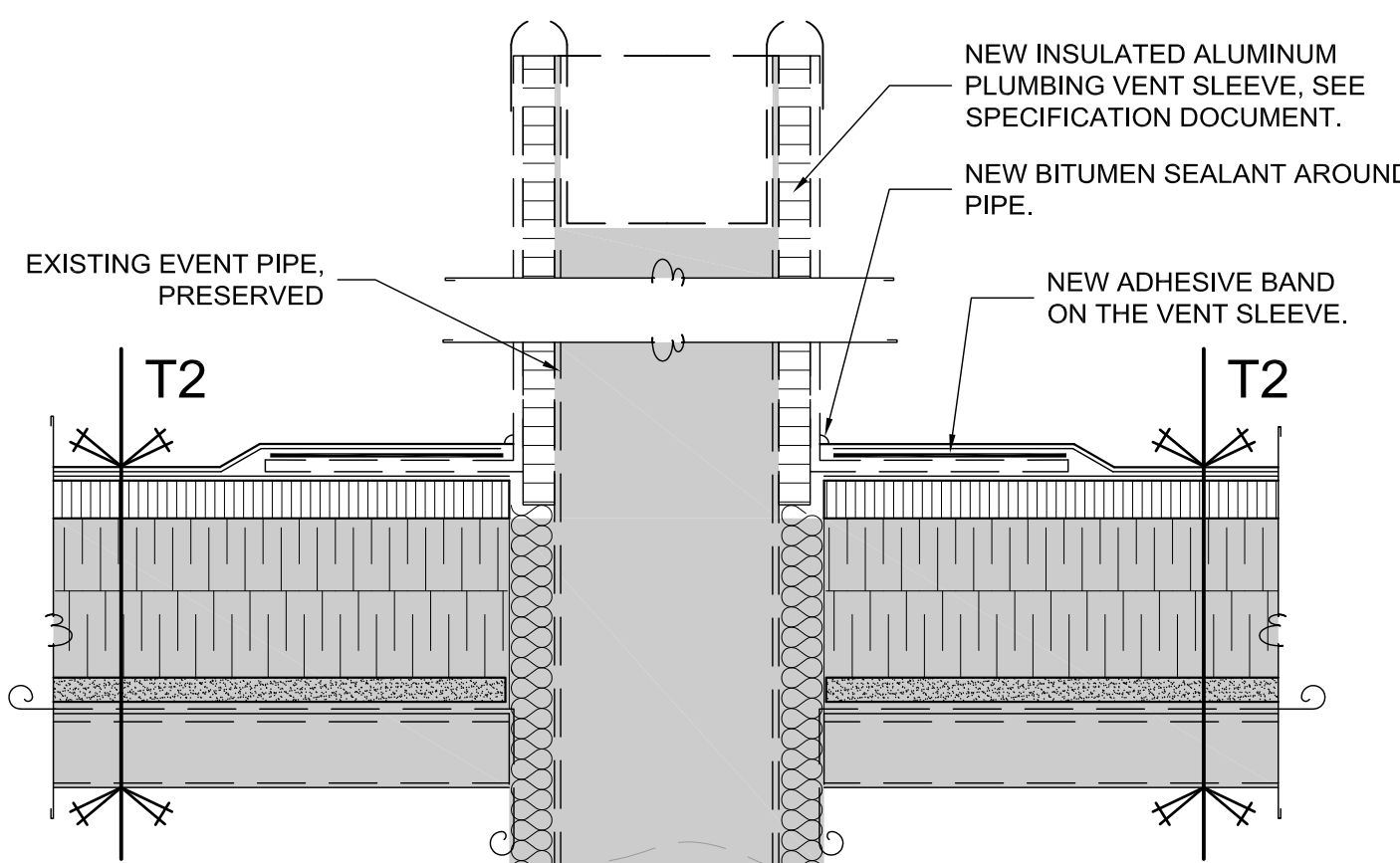
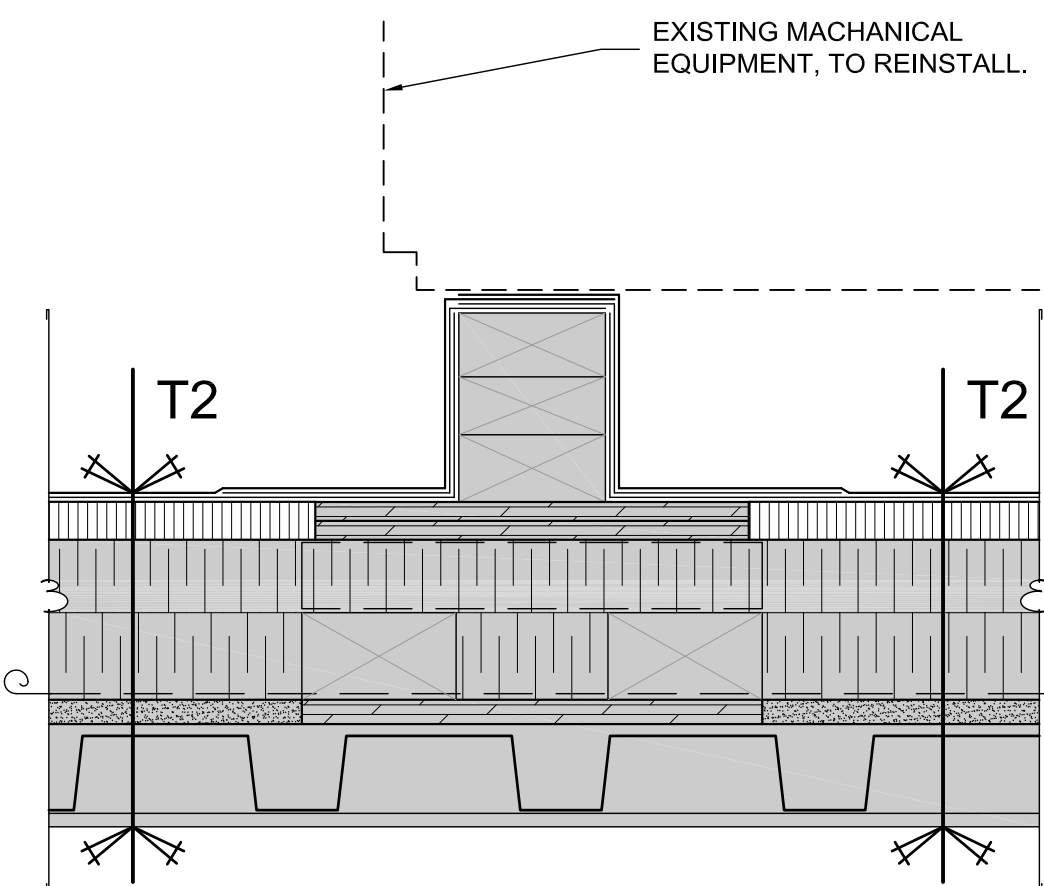

C04 DETAIL - MECHANICAL BASE - CONSTRUCTION
SCALE: 1:5

C05 DETAIL - PLUMBING VENT - CONSTRUCTION
SCALE: 1:5

C06 DETAIL - SUPPLY BOX - CONSTRUCTION
SCALE: 1:5

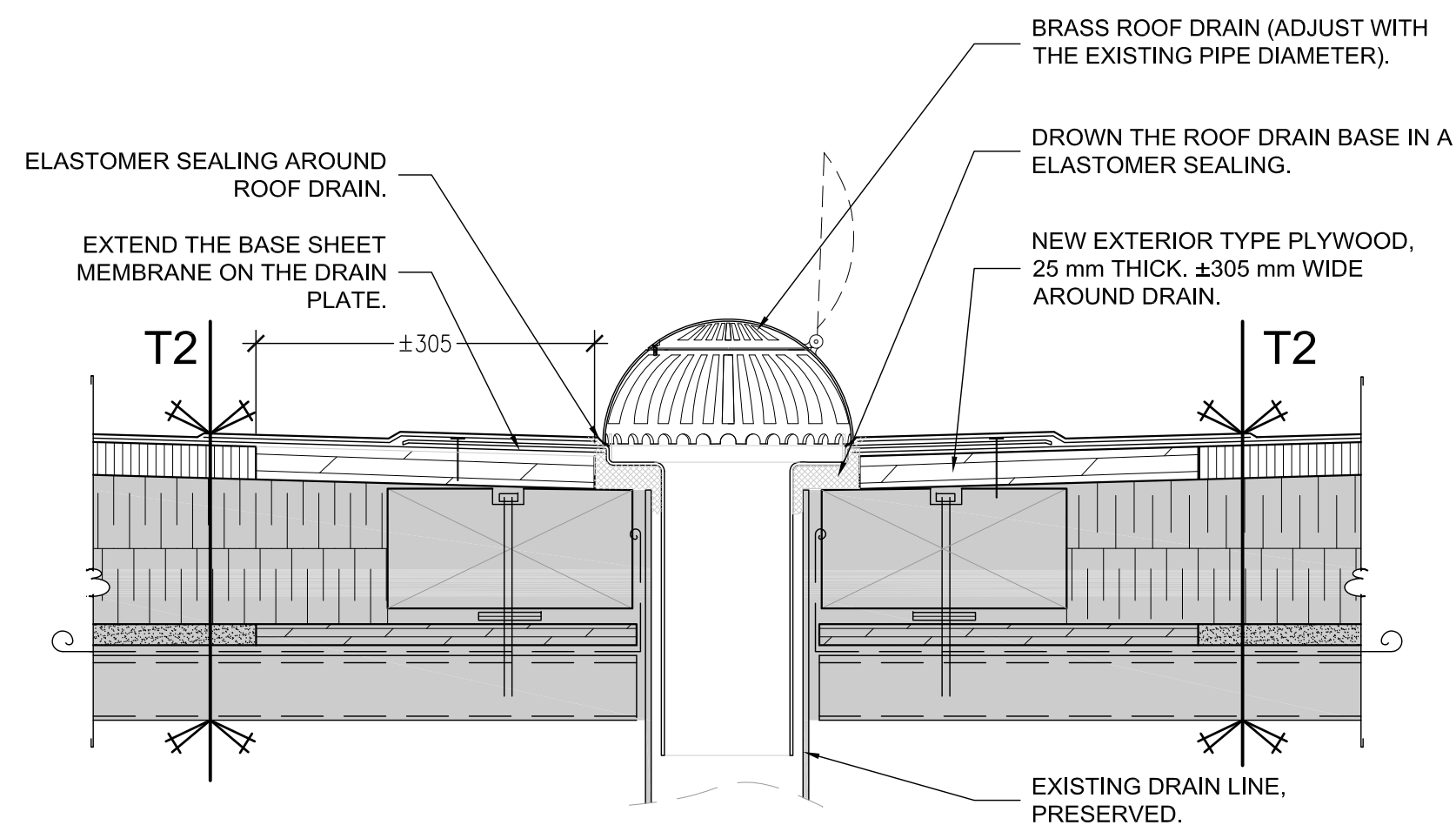

C07 DETAIL - ROOF DRAIN - CONSTRUCTION
SCALE: 1:5

GRAPHIC LEGEND - PLAN

00 SPECIFIC NOTE 9 STRUCTURAL AXIS REFERENCE

XX/XXX DETAIL REFERENCE 2% EXISTING STRUCTURAL ROOF SLOPE

HATCH LEGEND

EXISTING ROOF, TO REBUILD.

EXISTING COMPOSITION

TE2

- EXISTING BITUMINOUS GRANULED MEMBRANE, TO REMOVE.
- EXISTING WOOD FIBER PANEL, 25 mm THICK., TO REMOVE.
- EXISTING 2% SLOPE INSULATION, TO PRESERVE.
- EXISTING RIGID INSULATION, 50 mm THICK., TO PRESERVE.
- EXISTING VAPOR RETARDER MEMBRANE, TO PRESERVE.
- EXISTING GYPSUM BOARD, 16 mm THICK., TO PRESERVE.
- EXISTING STEEL DECK, TO PRESERVE.

NEW COMPOSITION

T2

- NEW MODIFIED BITUMINOUS MEMBRANE.
- NEW 15 mm THICK., HIGH DENSITY MINERAL FIBER BOARD LAMINATED WITH SBS MODIFIED BITUMEN BASE SHEET MEMBRANE.
- EXISTING 2% SLOPE INSULATION, PRESERVED.
- EXISTING RIGID INSULATION, 50 mm THICK., PRESERVED.
- EXISTING VAPOR RETARDER MEMBRANE, PRESERVED.
- EXISTING GYPSUM BOARD, 16 mm THICK., PRESERVED.
- EXISTING STEEL DECK, PRESERVED.

GENERALS NOTES

GN.1 THE CONTRACTOR IS RESPONSIBLE FOR THE VERIFICATION AND COORDINATION OF ALL DIMENSIONS.

GN.2 ALL THE DIMENSIONS HAVE TO BE VERIFIED ON SITE.

GN.3 PERFORM WORK IN ACCORDANCE WITH NATIONAL BUILDING CODE OF CANADA (NBC) INCLUDING AMENDMENTS UP TO TENDER CLOSING DATE AND OTHER PROVINCIAL OR LOCAL CODES.

GN.4 THE EXISTING ROOF COMPOSITION INDICATED ON THE PLANS ARE NON LIMITATIVE. THE CONTRACTOR SHOULD PERFORM NECESSARY DEMOLITION TO OBTAIN PERFECT EXECUTION OF WORK.

GN.5 ALL PLUMBING VENTS MUST BE REMOVED AND REPLACED.

GN.6 ALL METAL FLASHING AROUND MECHANICAL BASES, CHIMNEYS, GOOSENECKS, AND EVACUATORS MUST BE REMOVED. THE EQUIPMENT MUST BE REMOVE STORED AND REINSTALLED IN THEIR EXISTING PLACE.

Travaux publics et Services gouvernementaux Canada / Public Works and Government Services Canada

Direction générale des biens immobiliers / Real Property branch

Région du Québec / Quebec region

Canada

CORRECTIONAL SERVICE CANADA (CSC) / SERVICE CORRECTIONNEL CANADA (SCC)

PLAN CLÉ / KEY PLAN

Bâtiment de services

ARCHITECTURE

ABCP 300 RUE SAINT-PAUL, BUREAU 412 / QUÉBEC, QC, CANADA G1K 7R1 / T 418 649.7369

ARCHITECTURE

SCEAU / SEAL

Ordre des architectes du Québec

02	FOR TENDER	23/08/17
01	FOR COMMENTARY	18/08/17

révisions / revisions date

A no. du détail / detail no.
B sur no. de dessin / location drawing no.
C no. de dessin / drawing no.

Projet / Project

DONNACONA INSTITUTION ROOF REHABILITATION SERVICES BUILDING AND POSTERN

1537, HIGHWAY 138, DONNACONA (QUEBEC) G3M 1C9

Dessin / Drawing

ARCHITECTURE

DETAILS POSTERN CONSTRUCTION

Conçu par / Designed by
AUDREY BOUCHARD 18/08/2017
Date

Dessiné par / Drawn by
AUDREY BOUCHARD 18/08/2017
Date

Approuvé par / Approved by
CATHY DUMAS 18/08/2017
Date

Soumission / Tender Gestionnaire de projet TPSGC / PWSC project manager

No de projet / Project number 550-2-321-3703 TPSGC / PWSC	No de projet / Project number QC17-1099 Client
Nom du fichier / File name	No de classement
No de plan ou dessin	No feuille / Sheet no A05/6

AutoCAD 2017/09/05 Q:\2017-QC\QC17-1099 SCC_DONNACONA-TOITURES\10_DESSIN\06_ARCHITECTURE\A-TO-550-2-321-3703 PO - EN.DWG