



RETURN BIDS TO:

RETOURNER LES SOUMISSIONS À:

Bid Receiving Public Works and Government
Services Canada/Réception des soumissions
Travaux publics et Services gouvernementaux
Canada

Government of Canada Building

101 - 22nd Street East

Suite 110

Saskatoon

Saskatchewan

S7K 0E1

Bid Fax: (306) 975-5397

REQUEST FOR PROPOSAL DEMANDE DE PROPOSITION

**Proposal To: Public Works and Government
Services Canada**

We hereby offer to sell to Her Majesty the Queen in right
of Canada, in accordance with the terms and conditions
set out herein, referred to herein or attached hereto, the
goods, services, and construction listed herein and on any
attached sheets at the price(s) set out therefor.

**Proposition aux: Travaux Publics et Services
Gouvernementaux Canada**

Nous offrons par la présente de vendre à Sa Majesté la
Reine du chef du Canada, aux conditions énoncées ou
incluses par référence dans la présente et aux annexes
ci-jointes, les biens, services et construction énumérés
ici sur toute feuille ci-annexée, au(x) prix indiqué(s).

Comments - Commentaires

Vendor/Firm Name and Address

Raison sociale et adresse du

fournisseur/de l'entrepreneur

Issuing Office - Bureau de distribution

Public Works and Government Services Canada/Réception
des soumissions Travaux publics et Services gouvernementaux
Canada

Government of Canada Building

101 - 22nd Street East

Suite 110

Saskatoon

Saskatchewan

S7K 0E1

Title - Sujet Explosive Disposal Truck	
Solicitation No. - N° de l'invitation M5000-180775/A	Date 2017-09-26
Client Reference No. - N° de référence du client M5000-180775	
GETS Reference No. - N° de référence de SEAG PW-\$STN-201-5012	
File No. - N° de dossier STN-7-40020 (201)	CCC No./N° CCC - FMS No./N° VME
Solicitation Closes - L'invitation prend fin at - à 02:00 PM on - le 2017-11-06	Time Zone Fuseau horaire Central Standard Time CST
F.O.B. - F.A.B. Plant-Usine: <input type="checkbox"/> Destination: <input type="checkbox"/> Other-Autre: <input type="checkbox"/>	
Address Enquiries to: - Adresser toutes questions à: Marsland, Rina	Buyer Id - Id de l'acheteur stn201
Telephone No. - N° de téléphone (306) 241-5742 ()	FAX No. - N° de FAX (306) 975-5397
Destination - of Goods, Services, and Construction: Destination - des biens, services et construction: ROYAL CANADIAN MOUNTED POLICE D Division Post Garage 156 Seel Avenue Winnipeg MB R3T 4C6 Canada	

Instructions: See Herein

Instructions: Voir aux présentes

Delivery Required - Livraison exigée See Herein	Delivery Offered - Livraison proposée
Vendor/Firm Name and Address Raison sociale et adresse du fournisseur/de l'entrepreneur	
Telephone No. - N° de téléphone Facsimile No. - N° de télécopieur	
Name and title of person authorized to sign on behalf of Vendor/Firm (type or print) Nom et titre de la personne autorisée à signer au nom du fournisseur/ de l'entrepreneur (taper ou écrire en caractères d'imprimerie)	
Signature	Date

TABLE OF CONTENTS

PART 1 - GENERAL INFORMATION	2
1.1 REQUIREMENT	2
1.2 DEBRIEFINGS	2
1.3 TRADE AGREEMENTS	2
PART 2 - BIDDER INSTRUCTIONS	2
2.1 STANDARD INSTRUCTIONS, CLAUSES AND CONDITIONS	2
2.2 SUBMISSION OF BIDS.....	3
2.3 ENQUIRIES - BID SOLICITATION.....	3
2.4 APPLICABLE LAWS	3
PART 3 - BID PREPARATION INSTRUCTIONS.....	4
3.1 BID PREPARATION INSTRUCTIONS	4
PART 4 - EVALUATION PROCEDURES AND BASIS OF SELECTION	6
4.1 EVALUATION PROCEDURES.....	6
4.2 BASIS OF SELECTION.....	6
PART 5 – CERTIFICATIONS AND ADDITIONAL INFORMATION	7
5.1 CERTIFICATIONS REQUIRED WITH THE BID	7
5.2 CERTIFICATIONS PRECEDENT TO CONTRACT AWARD AND ADDITIONAL INFORMATION	7
PART 6 - RESULTING CONTRACT CLAUSES	8
6.1 SECURITY REQUIREMENTS	8
6.2 REQUIREMENT	8
6.3 STANDARD CLAUSES AND CONDITIONS.....	8
6.4 TERM OF CONTRACT	8
6.5 AUTHORITIES	9
6.6 PAYMENT	10
6.7 INVOICING INSTRUCTIONS	10
6.8 CERTIFICATIONS AND ADDITIONAL INFORMATION.....	10
6.9 APPLICABLE LAWS	10
6.10 PRIORITY OF DOCUMENTS	11
6.11 SACC MANUAL CLAUSES.....	11
6.12 GOVERNMENT SITE REGULATIONS.....	11
6.13 INSPECTION AND ACCEPTANCE.....	11
ANNEX "A"	12
REQUIREMENT	12
ANNEX "B"	35
BASIS OF PAYMENT	35
ANNEX "C" TO PART 3 OF THE BID SOLICITATION	37
ELECTRONIC PAYMENT INSTRUMENTS	37

PART 1 - GENERAL INFORMATION

1.1 Requirement

The requirement is detailed under Annex A, Requirement of the resulting contract clauses.

1.2 Debriefings

Bidders may request a debriefing on the results of the bid solicitation process. Bidders should make the request to the Contracting Authority within 15 working days from receipt of the results of the bid solicitation process. The debriefing may be in writing, by telephone or in person.

1.3 Trade Agreements

The requirement is subject to the provisions of the World Trade Organization Agreement on Government Procurement (WTO-AGP), the North American Free Trade Agreement (NAFTA), the Canada-European Union Comprehensive Economic and Trade Agreement (CETA), and the Canadian Free Trade Agreement (CFTA)

PART 2 - BIDDER INSTRUCTIONS

2.1 Standard Instructions, Clauses and Conditions

All instructions, clauses and conditions identified in the bid solicitation by number, date and title are set out in the [Standard Acquisition Clauses and Conditions Manual](https://buyandsell.gc.ca/policy-and-guidelines/standard-acquisition-clauses-and-conditions-manual) (<https://buyandsell.gc.ca/policy-and-guidelines/standard-acquisition-clauses-and-conditions-manual>) issued by Public Works and Government Services Canada.

Bidders who submit a bid agree to be bound by the instructions, clauses and conditions of the bid solicitation and accept the clauses and conditions of the resulting contract.

The [2003](#) (2017-04-27) Standard Instructions - Goods or Services - Competitive Requirements, are incorporated by reference into and form part of the bid solicitation.

Subsection 5.4 of [2003](#), Standard Instructions - Goods or Services - Competitive Requirements, is amended as follows:

Delete: 60 days

Insert: 120 days

2.1.1 SACC Manual Clauses

B3000T (2006-06-16), Equivalent Products

2.2 Submission of Bids

Bids must be submitted only to Public Works and Government Services Canada (PWGSC) Bid Receiving Unit by the date, time and place indicated on page 1 of the bid solicitation.

2.2.1 Improvement of Requirement during Solicitation Period

Should bidders consider that the specifications or Statement of Work contained in the bid solicitation could be improved technically or technologically, bidders are invited to make suggestions, in writing, to the Contracting Authority named in the bid solicitation. Bidders must clearly outline the suggested improvement as well as the reason for the suggestion. Suggestions that do not restrict the level of competition nor favour a particular bidder will be given consideration provided they are submitted to the Contracting Authority **at least fifteen (15) days** before the bid closing date. Canada will have the right to accept or reject any or all suggestions.

2.3 Enquiries - Bid Solicitation

All enquiries must be submitted in writing to the Contracting Authority no later than **seven (7) calendar days** before the bid closing date. Enquiries received after that time may not be answered.

Bidders should reference as accurately as possible the numbered item of the bid solicitation to which the enquiry relates. Care should be taken by Bidders to explain each question in sufficient detail in order to enable Canada to provide an accurate answer. Technical enquiries that are of a proprietary nature must be clearly marked "proprietary" at each relevant item. Items identified as "proprietary" will be treated as such except where Canada determines that the enquiry is not of a proprietary nature. Canada may edit the question(s) or may request that the Bidder do so, so that the proprietary nature of the question(s) is eliminated, and the enquiry can be answered to all Bidders. Enquiries not submitted in a form that can be distributed to all Bidders may not be answered by Canada.

2.4 Applicable Laws

Any resulting contract must be interpreted and governed, and the relations between the parties determined, by the laws in force in Manitoba.

Bidders may, at their discretion, substitute the applicable laws of a Canadian province or territory of their choice without affecting the validity of their bid, by deleting the name of the Canadian province or territory specified and inserting the name of the Canadian province or territory of their choice. If no change is made, it acknowledges that the applicable laws specified are acceptable to the Bidders.

PART 3 - BID PREPARATION INSTRUCTIONS

3.1 Bid Preparation Instructions

Canada requests that Bidders provide their bid in separately bound sections as follows:

Section I: Technical Bid (one (1) hard copy)

Section II: Financial Bid (one (1) hard copy)

Section III: Certifications (one (1) hard copy)

Prices must appear in the financial bid only. No prices must be indicated in any other section of the bid.

Canada requests that Bidders follow the format instructions described below in the preparation of their bid:

- (a) use 8.5 x 11 inch (216 mm x 279 mm) paper;
- (b) use a numbering system that corresponds to the bid solicitation.

In April 2006, Canada issued a policy directing federal departments and agencies to take the necessary steps to incorporate environmental considerations into the procurement process [Policy on Green Procurement](http://www.tpsgc-pwgsc.gc.ca/ecologisation-greening/achats-procurement/politique-policy-eng.html) (<http://www.tpsgc-pwgsc.gc.ca/ecologisation-greening/achats-procurement/politique-policy-eng.html>). To assist Canada in reaching its objectives, Bidders should:

- 1) use 8.5 x 11 inch (216 mm x 279 mm) paper containing fibre certified as originating from a sustainably-managed forest and containing minimum 30% recycled content; and
- 2) use an environmentally-preferable format including black and white printing instead of colour printing, printing double sided/duplex, using staples or clips instead of cerlox, duotangs or binders.

Section I: Technical Bid

In their technical bid, Bidders should explain and demonstrate how they propose to meet the requirements and how they will carry out the Work.

Section II: Financial Bid

Bidders must submit their financial bid in accordance with the Basis of Payment.



3.1.1 Electronic Payment of Invoices – Bid

If you are willing to accept payment of invoices by Electronic Payment Instruments, complete Annex “” Electronic Payment Instruments, to identify which ones are accepted.

If Annex “C” Electronic Payment Instruments is not completed, it will be considered as if Electronic Payment Instruments are not being accepted for payment of invoices.

Acceptance of Electronic Payment Instruments will not be considered as an evaluation criterion.

3.1.2 Exchange Rate Fluctuation Risk Mitigation

1. The Bidder may request Canada to assume the risks and benefits of exchange rate fluctuations. If the Bidder claims for an exchange rate adjustment, this request must be clearly indicated in the bid at time of bidding. The Bidder must submit form [PWGSC-TPSGC 450](#) , Claim for Exchange Rate Adjustments with its bid, indicating the Foreign Currency Component (FCC) in Canadian dollars for each line item for which an exchange rate adjustment is required.
2. The FCC is defined as the portion of the price or rate that will be directly affected by exchange rate fluctuations. The FCC should include all related taxes, duties and other costs paid by the Bidder and which are to be included in the adjustment amount.
3. The total price paid by Canada on each invoice will be adjusted at the time of payment, based on the FCC and the exchange rate fluctuation provision in the contract. The exchange rate adjustment will only be applied where the exchange rate fluctuation is greater than 2% (increase or decrease).
4. At time of bidding, the Bidder must complete columns (1) to (4) on form [PWGSC-TPSGC 450](#) , for each line item where they want to invoke the exchange rate fluctuation provision. Where bids are evaluated in Canadian dollars, the dollar values provided in column (3) should also be in Canadian dollars, so that the adjustment amount is in the same currency as the payment.
5. Alternate rates or calculations proposed by the Bidder will not be accepted for the purposes of this exchange rate fluctuation provision.

Section III: Certifications

Bidders must submit the certifications and additional information required under Part 5.

PART 4 - EVALUATION PROCEDURES AND BASIS OF SELECTION

4.1 Evaluation Procedures

- (a) Bids will be assessed in accordance with the entire requirement of the bid solicitation including the technical and financial evaluation criteria.
- (b) An evaluation team composed of representatives of Canada will evaluate the bids.

4.1.1 Technical Evaluation

4.1.1.1 Mandatory Technical Criteria

See Annex A, Requirement

Bidders must indicate compliance with all details of the specification by initialing all areas as indicated in the compliance columns and initialing each drawing. The written specification and the drawings are to be considered as one. Notation of an item in one, and not in the other, does not negate the need for the given item.

Bidders must provide pricing for all three sections in Annex B, Basis of Payment, for the initial purchase as well as for the two potential optional purchases as laid out in Annex B.

4.1.2 Financial Evaluation

SACC Manual Clause [A0220T](#) (2014-06-26), Evaluation of Price

4.2 Basis of Selection

4.2.1 Basis of Selection - Mandatory Technical Criteria

SACC Manual Clause [A0031T](#) (2010-08-16), Basis of Selection - Mandatory Technical Criteria

PART 5 – CERTIFICATIONS AND ADDITIONAL INFORMATION

Bidders must provide the required certifications and additional information to be awarded a contract.

The certifications provided by Bidders to Canada are subject to verification by Canada at all times. Unless specified otherwise, Canada will declare a bid non-responsive, or will declare a contractor in default if any certification made by the Bidder is found to be untrue whether made knowingly or unknowingly, during the bid evaluation period or during the contract period.

The Contracting Authority will have the right to ask for additional information to verify the Bidder's certifications. Failure to comply and to cooperate with any request or requirement imposed by the Contracting Authority will render the bid non-responsive or constitute a default under the Contract.

5.1 Certifications Required with the Bid

Bidders must submit the following duly completed certifications as part of their bid.

5.1.1 Integrity Provisions - Declaration of Convicted Offences

In accordance with the Integrity Provisions of the Standard Instructions, all bidders must provide with their bid, **if applicable**, the declaration form available on the [Forms for the Integrity Regime](http://www.tpsgc-pwgsc.gc.ca/ci-if/declaration-eng.html) website (<http://www.tpsgc-pwgsc.gc.ca/ci-if/declaration-eng.html>), to be given further consideration in the procurement process.

5.2 Certifications Precedent to Contract Award and Additional Information

The certifications and additional information listed below should be submitted with the bid, but may be submitted afterwards. If any of these required certifications or additional information is not completed and submitted as requested, the Contracting Authority will inform the Bidder of a time frame within which to provide the information. Failure to provide the certifications or the additional information listed below within the time frame provided will render the bid non-responsive.

5.2.1 Integrity Provisions – Required Documentation

In accordance with the section titled Information to be provided when bidding, contracting or entering into a real procurement agreement of the [Ineligibility and Suspension Policy](http://www.tpsgc-pwgsc.gc.ca/ci-if/politique-policy-eng.html) (<http://www.tpsgc-pwgsc.gc.ca/ci-if/politique-policy-eng.html>), the Bidder must provide the required documentation, as applicable, to be given further consideration in the procurement process.

5.2.2 Federal Contractors Program for Employment Equity - Bid Certification

By submitting a bid, the Bidder certifies that the Bidder, and any of the Bidder's members if the Bidder is a Joint Venture, is not named on the Federal Contractors Program (FCP) for employment equity "FCP Limited Eligibility to Bid" list available at the bottom of the page of the [Employment and Social Development Canada \(ESDC\) - Labour's](https://www.canada.ca/en/employment-social-development/programs/employment-equity/federal-contractor-program.html#) website (<https://www.canada.ca/en/employment-social-development/programs/employment-equity/federal-contractor-program.html#>).

Canada will have the right to declare a bid non-responsive if the Bidder, or any member of the Bidder if the Bidder is a Joint Venture, appears on the "FCP Limited Eligibility to Bid" list at the time of contract award.

PART 6 - RESULTING CONTRACT CLAUSES

The following clauses and conditions apply to and form part of any contract resulting from the bid solicitation.

6.1 Security Requirements

6.1.1 There is no security requirement applicable to the Contract.

6.2 Requirement

The Contractor must provide the items detailed under the "Requirement" at Annex "A".

6.3 Standard Clauses and Conditions

All clauses and conditions identified in the Contract by number, date and title are set out in the [Standard Acquisition Clauses and Conditions Manual](https://buyandsell.gc.ca/policy-and-guidelines/standard-acquisition-clauses-and-conditions-manual) (<https://buyandsell.gc.ca/policy-and-guidelines/standard-acquisition-clauses-and-conditions-manual>) issued by Public Works and Government Services Canada.

6.3.1 General Conditions

[2010A](#) (2016-04-04), General Conditions - Goods (Medium Complexity), apply to and form part of the Contract.

6.4 Term of Contract

6.4.1 Period of the Contract

The period of the Contract is from date of Contract to February 29, 2020, inclusive

6.4.2 Delivery Date

While delivery is requested by **February 28, 2018** the best delivery that could be offered is _____ (To be completed by Bidder.)

6.4.3 Delivery Points

Delivery of the requirement will be made to delivery point(s) specified at Annex "A" of the Contract.

6.4.4 Optional Goods and/or Services

The Contractor grants to Canada the irrevocable option to acquire the goods, services or both described at Annex A of the Contract under the same conditions and at the prices and/or rates stated in the Contract. The option may only be exercised by the Contracting Authority and will be evidenced, for administrative purposes only, through a contract amendment.

The Contracting Authority may exercise the option at any time before the expiry of the Contract by sending a written notice to the Contractor.

6.5 Authorities

6.5.1 Contracting Authority

The Contracting Authority for the Contract is:

Rina Marsland
Procurement Specialist
Public Works and Government Services Canada
Procurement Branch – Western Region
101 22nd St E, Suite 110
Saskatoon, SK S7K 0E1

Telephone: 306-241-5742
Facsimile: 306-975-5397
E-mail address: rina.marsland@pwgsc-tpsgc.gc.ca

The Contracting Authority is responsible for the management of the Contract and any changes to the Contract must be authorized in writing by the Contracting Authority. The Contractor must not perform work in excess of or outside the scope of the Contract based on verbal or written requests or instructions from anybody other than the Contracting Authority.

6.5.2 Technical Authority

The Technical Authority for the Contract is:

- **To be determined**

The Technical Authority named above is the representative of the department or agency for whom the Work is being carried out under the Contract and is responsible for all matters concerning the technical content of the Work under the Contract. Technical matters may be discussed with the Technical Authority, however the Technical Authority has no authority to authorize changes to the scope of the Work. Changes to the scope of the Work can only be made through a contract amendment issued by the Contracting Authority.

6.5.3 Contractor's Representative

(Offeror to complete)

Name: _____

Title: _____

Organization: _____

Address: _____

Telephone: _____

Facsimile: _____

E-mail address: _____

6.6 Payment

6.6.1 Basis of Payment

In consideration of the Contractor satisfactorily completing all of its obligations under the Contract, the Contractor will be paid a firm price as specified in Annex B" for a cost of **\$ to be determined**. Customs duties are included and Applicable Taxes are extra.

Canada will not pay the Contractor for any design changes, modifications or interpretations of the Work, unless they have been approved, in writing, by the Contracting Authority before their incorporation into the Work.

6.6.2 Single Payment

SACC Manual Clause H1000C (2008-05-12), Single Payment

6.6.3 SACC Manual Clauses

C2605C (2008-05-12), Canadian Customs Duties and Sales Tax - Foreign-based Contractor

6.6.5 Electronic Payment of Invoices – Contract

To Be Determined

6.7 Invoicing Instructions

1. The Contractor must submit invoices in accordance with the section entitled "Invoice Submission" of the general conditions. Invoices cannot be submitted until all work identified in the invoice is completed.
2. Invoices must be distributed as follows:
 - a. The original and one (1) copy must be forwarded to the address shown on page 1 of the Contract for certification and payment.
 - b. One (1) copy must be forwarded to the Contracting Authority identified under the section entitled "Authorities" of the Contract.

6.8 Certifications and Additional Information

6.8.1 Compliance

Unless specified otherwise, the continuous compliance with the certifications provided by the Contractor in its bid or precedent to contract award, and the ongoing cooperation in providing additional information are conditions of the Contract and failure to comply will constitute the Contractor in default. Certifications are subject to verification by Canada during the entire period of the Contract.

6.9 Applicable Laws

The Contract must be interpreted and governed, and the relations between the parties determined, by the laws in force in Manitoba.

6.10 Priority of Documents

If there is a discrepancy between the wording of any documents that appear on the list, the wording of the document that first appears on the list has priority over the wording of any document that subsequently appears on the list.

- (a) the Articles of Agreement;
- (b) the general conditions 2010A (2016-04-04), General Conditions - Goods (Medium Complexity);
- (c) Annex A, Requirement;
- (d) Annex B, Basis of Payment;
- (e) the Contractor's bid dated _____

6.11 SACC Manual Clauses

B1501C (2006-06-15), Electrical Equipment
B7500C (2006-06-16), Excess Goods

6.12 Government Site Regulations

SACC Manual Clause A9068C (2010-01-11), Government Site Regulations

6.13 Inspection and Acceptance

The **Technical** Authority is the Inspection Authority. All reports, deliverable items, documents, goods and all services rendered under the Contract are subject to inspection by the Inspection Authority or representative. Should any report, document, good or service not be in accordance with the requirements of the Statement of Work and to the satisfaction of the Inspection Authority, as submitted, the Inspection Authority will have the right to reject it or require its correction at the sole expense of the Contractor before recommending payment.

ANNEX "A"

REQUIREMENT

The Royal Canadian Mounted Police (RCMP), "D" Division, Explosive Disposal Unit (EDU), in Winnipeg, MB is mandated to provide Explosives Disposal and Chemical, Biological, Radiological, Nuclear and Explosives (CBRNE) support to the Province of Manitoba, to other police services within the Province, and the Winnipeg International Airport where they have reacquired the policing duties.

"D" Division is required to have the capacity for two independent teams to respond to EDU (either Explosives or Critical Incident) or CBRNE at any given time for the Province, police departments within the province, and the Winnipeg Airport.

This requirement is to purchase one (1) most recent model year in production Conventional – Crew Cab & Chassis with a custom manufactured box to allow for the inclusion of explosives magazines as well as remotely operated vehicles to be utilized by the EDU when required.

* There is an option to purchase one (1) additional truck with the same specs within a twenty four month period from award of contract, if exercised by the Contracting Authority.

Delivery is to be made to:

Royal Canadian Mounted Police
"D" Division Post Garage
1560 Seel Avenue
Winnipeg, MB R3T 4C6

Mandatory Explosive Disposal Truck Specifications			Indicate Compliance	
			YES	NO
A. General Requirements				
1.	Engine			
a.	Diesel			
b.	Minimum 8.3L engine			
c.	Minimum of 350 HP			
d.	Minimum of 1,000 LB/FT torque			
2.	Alternator	300 Amp minimum		
3.	Batteries	(3) 12 volt 2190 CCA		
4.	GVWR	Minimum 44,000 and maximum 46,000 lbs		
5.	Exhaust	Right hand Vertical tailpipe, which must extend at least a minimum of 5" and a maximum of 10" above the roof of the truck, C-Pillar mounted, Bright upper stack		
6.	Compressor	Engine driven		
7.	Block Heater	115 volt		
8.	Transmission	Allison 3000 EVS (<i>or equivalent</i>)		
9.	Cab Exterior			
a.	154" BBC High Roof Crew Cab			
b.	Walk through opening in back of cab without boot			
10.	Front Tires & Wheels			
a.	To meet GVWR, Hub piloted, 10 holes			
b.	22.5 Polished Aluminum, Disc			
11.	Rear Tires & Wheels			
a.	To meet GVWR, Hub piloted, 10 holes			
b.	22.5 Polished Aluminum, Disc			

12.	Brakes		
a.	Full air brakes, include dust shields, air dryer and engine brake		
b.	Fire and Emergency severe service non-asbestos brake linings		
13.	Front Axle & Suspension		
a.	Minimum 14,000 – maximum 16,000 lbs taper leaf front suspension		
b.	Drop single front axle		
14.	Rear Axle & Suspension		
a.	Dual wheels - single axle		
b.	Minimum 30,000 – maximum 35,000 lbs single rear axle		
c.	Hendrickson Firemaax EX (or equivalent) rated Min. 30,000 – Max. 35,000 lbs rear air suspension		
d.	Air ride suspension, dual height control valves with drains (must be factory installed, after-market installation is not acceptable)		
e.	Minimum 4.56 axle ratio, to allow a road speed of between 85 - 100MPH.		
f.	Driver controlled traction differential, installed in cab within easy reach of driver.		
g.	Manual dump valve for air suspension with gauge, installed in cab within easy reach of driver.		
15.	Wheelbase	Minimum 305 – maximum 310"	
16.	Cab to Axle	Minimum 190 - maximum 200"	
17.	Calculated Frame Length	Minimum 405 - maximum 420"	
18.	Truck Body Length	Minimum 300 - maximum 310"	
19.	Reinforcement	Minimum 120,000 lbs PSI steel to suit GVWR of truck	
20.	Tow Hooks	Front, frame mounted, standard factory tow hooks	
21.	Fuel Tanks		
a.	Minimum 60 Gallon RH rectangular polished aluminum tank		
b.	Minimum 100 Gallon LH rectangular polished aluminum tank		
22.	Diesel Exhaust	Minimum 13 gallon LH aluminum tank	

	Fluid Tank			
23.	Air Horn	Single 14" air horn under Left Hand deck		
24.	Mirrors	Bright finish heated mirrors with Left Hand & Right Hand remotes, 102" equipment width		
25.	Convex Mirrors	Bright finish Chrome Left Hand & Right Hand side		
26.	Exterior Sun Shade			
a.	Aerodynamic, painted same color as the roof,			
b.	includes integral LED clearance/marker lights			
27.	Bumper	Front, chromed steel Ali Arc(<i>or equivalent</i>) moose bars to match truck		
28.	Cab Interior	Cloth seating using darker colors (i.e. grey, black navy, charcoal, etc.)		
29.	Door Windows	Power electric		
30.	Insulation	Extreme cold climate package		
31.	Driver & Front Passenger Seats	High back air suspension seats with heat, air lumbar and adjustable shock		
32.	Rear Seats	High back air suspension seats		
33.	Lamps	Interior roof reading lamps		
34.	Instrument Panel & Controls			
a.	Coolant, transmission temperature, fuel and oil pressure gauges			
b.	Cruise control			
c.	Tilt and telescoping steering column			
d.	Backup alarm (See information in section E)			
e.	AM/FM/SIRIUSXM with CD player, Bluetooth and microphone.			
f.	Module for overhead switch mounting			
f.	Electric windshield wiper motor with delay and arctic type blades			

h.	Air Conditioning/heating, manual control		
35.	Paint		
a.	Cab and sun visor painted white		
b.	Chassis paint to be black, high solids Polyurethane		
B. GENERAL BOX SPECIFICATIONS:			
1.	Overall exterior dimensions		
a.	Length: Minimum 300 – maximum 310"		
b.	Width: 102"		
c.	Height: Minimum 150 – maximum 160". (from ground to top of A/C units)		
2.	Interior Dimensions		
a.	Length: Minimum 295 – maximum 305"		
b.	Width: Minimum 90 - maximum 100"		
c.	Height: Minimum 90 - maximum 100"		
3.	Aerodynamic Front		
a.	An aerodynamic over cab front must be attached to the box as a part of the box body construction.		
C. BOX BODY CONSTRUCTION:			
1.	The body framework must be assembled on a jig, and must be clamped together and squared. The framework must be electronically welded with digital pulse welders forming the integral superstructure.		
2.	The body frame rails must be constructed of 6061T6/6063-T6, 3" x 3" aluminum extrusions, with a wall thickness of 1/4".		
3.	The front cross member must be a heavy duty 3" x 3" x 1/4" aluminum extrusions providing maximum strength and durability.		
4.	The rear cross members must be heavy duty 3" x 3" x 1/4" aluminum extrusions providing maximum strength and durability at the rear section of the body.		
5.	These body cross members must extend the full width of the body. The cross members must provide support for the body side compartments and rear tailboard section.		

6.	The body sub frame and the chassis frame must be insulated and separated by a rubberized belt.		
7.	The body side compartments, both sides and the rear must be full frame constructed from heavy-duty aluminum extrusions 2" x 2" x 3/16".		
8.	The body must be mounted to the chassis frame rails with four side mounting plates. This must provide for maximum mounting strength and flexibility.		
9.	The upper body must feature six (6) roof mounted D ring tie down rings. Refer to drawings at end of document for placement.		
10.	There must be a full length walkway in the interior of the rescue body. The walkway must cover the body full length. The walkway must be covered in 3/16" NFPA slip restraint checker plate.		
a.	The side walls of the walkway must be trimmed in grey vinyl covered or a sanded aluminum finish.		
11.	The interior of the command center must be insulated utilizing a minimum of R 30 high density spray foam insulation. The walls, ceiling, and floor must be included in the insulation application areas.		
12.	All body components or attachments made from dissimilar metals must be fastened to the body utilizing an Ultra High Molecular Weight Polyethylene material to prevent metal-to-metal contact preventing dielectric corrosion.		
a.	All fasteners used in attaching or fastening aluminum panels must be installed with stainless steel hardware. Rivets are not acceptable. {No Exceptions}		
b.	All fasteners must be installed in a manner, which must involve drilling, tapping, and application of non-corrosive grease before the stainless steel bolts are installed. Self-tapping screws or screws without threads are not acceptable {No Exceptions} .		
13.	The whole frame / cross members / wheel well area / and inner body of the CBRNE Truck body must be thoroughly prepared and sprayed with Corashield® (or equivalent) that will help prevent rust and corrosion. A minimum of 8- maximum of 10 mils of Corashield® (or equivalent) must be sprayed. The bottom, sides and tops of the cross members must be fully covered with Corashield® (or equivalent).		
14.	The wheel well frame and construction method must allow for the wheel well fender to be easily removed for servicing of the suspension or axle.		
a.	The wheel well fender must be attached to the body sub frame with non-corrosive stainless steel fasteners.		
b.	The inner wheel lining must be constructed of 1/8" rust corrosion resistant aluminum. The lining must be attached to the wheel well framework.		
c.	The wheel well outer skin must be fabricated from 1/8" rust corrosion resistant aluminum and have a painted finish to match the body exterior.		
15.	Due to the environmental conditions where this vehicle will be required to operate, a set of On Spot automatic traction tire chains must be installed at the rear tires, by the box builder.		
a.	The automatic tire chain system must be air actuated from the chassis air system, and must be controlled with an activation switch located in the cab, in easy reach of the driver.		
D. DROP DOWN FRAME FOR ROBOT STORAGE			

1.	Chassis frame must be cut immediately after rear axle and extended with drop down frame that will support robot storage area.		
2.	The frame drop must be minimum 15" to allow easy exit for robots.		
3.	Drop frame must be sufficient to support body and robot's weights. A FEA (<i>Finite Element Analysis</i>) is required to be performed to proof the design, and must be supplied to the Contracting Authority and the RCMP no later than 10 days after the initial conference between the client and the successful bidder.		
4.	The minimum 7/8" grade 8 fasteners must be used to fasten drop frame to chassis frame rail.		
5.	Drop down frame must provide enough strength for mounting tow plates and receivers as required.		
6.	There must be one (1) Robot support platform installed in this area, able to support a 300 lb. robot.		
7.	The robot support platform must be powered (electrical or hydraulic).		
8.	The small robot must be stored on the platform above larger robot and located at the rear, centered inside of the truck body.		
9.	Platform must be deployable without moving larger robot. Larger robot must be deployable without moving the platform. There must be safety locks used when vehicle is in motion.		
E. BACK-UP ALARM/CAMERA:			
1.	A Federal Signal 107db (or equivalent) back up alarm must be installed at the rear of the CBRNE Truck body. This back up alarm must be activated when the chassis transmission is placed into reverse.		
2.	A back-up camera, Federal Signal model #CAMSET70-NTSC-4 (or equivalent) Camera/Monitor System must be installed by the box builder on the rear of the vehicle and a monitor must be installed in the cab area for use by the vehicle operator.		
a.	The system must consist of (1) 7.0" Color Monitor, (1) Standard Rearview Camera, (1) 4-input Control Box with keyboard, and (1) 65.5-foot Extension Cable		
2.1	Monitor		
a.	The monitor must be a minimum 7.0" to a maximum 10" TFT-LCD Color Monitor, and is intended for use in vehicle applications utilizing up to four cameras with split screen capability, installed in view of the driver.		
b.	The monitor must incorporate a built-in speaker, and a photo sensor for automatic brightness adjustment for low-light / no-light conditions.		
c.	Multi-voltage 12/24 VDC capable.		
2.2	Standard Rearview Camera		
a.	The camera must be a high-resolution Color CCD camera made from an anti-corrosion aluminum alloy housing.		
b.	The camera must feature a photo sensor and (16) infrared LEDs for		

	low-light / no-light conditions, a built-in microphone, and must have a 110-degree viewing angle.		
c.	Pixel resolution of the camera must be 510(H) x 492(V)		
d.	The camera must be IP68 rated for water and dust protection.		
e.	Multi-voltage 12/24 VDC capable		
2.3	Extension Cable		
a.	The camera-to-monitor Extension Cable must be installed in length that extends from the rearview camera to the monitor with a waterproof connector.		
2.4	4-Input Control Box		
a.	The camera system control box must consist of inputs for up to four cameras with independent trigger wires for each input.		
b.	An individual keyboard must be included for mode selection (individual camera view or split-screen multiple camera view).		
c.	Multi-voltage 12/24 VDC capable.		
F. MUD GUARDS:			
1.	Reinforced rubber/steel mudguards must be placed on both the front and rear of all wheels from floor to bottom of skirt.		
G. EXTERIOR CONFIGURATION:			
1.	The body compartments must be fabricated with 1/8" rust corrosion resistant aluminum panels. These panels must be non-corrosive, durable, and add strength and integrity to the body construction.		
2.	The following compartments must be provided on the CBRNE Truck body.		
a.	Compartment	Compartment Frame Dimensions	
i.	EL 1	48.25W x 32H x 28D	
ii.	EL 2	48.25W x 21H x 26D	
iii.	EL 3	48.25W x 21H x 26D	
iv.	EL 4	36W x 86H x 24D	
v.	ER 1	74W x 21H x 26D	
vi.	ER 2	74W x 21H x 26D	

vii	DOORWAY	31W x 90H		
3.	All compartments must have a 1" drop on the lower edge of the door opening to accommodate the door seal, and to stop moisture from entering the compartment.			
a.	All compartments must have sweep out floors.			
b.	All compartments must be weatherproof.			
4.	The exterior compartment pan doors must be flush fit and have an inner and outer pan design. The outer pan must be constructed in 1/8" smooth rust corrosion resistant aluminum plate with a 1" break on all four sides.			
a.	A 1/4" drain hole must be provided in the lower inner pan to allow for drainage of any accumulated moisture.			
b.	The door opening must have an extrusion installed around the inner perimeter. A custom designed hollow cell seal must be installed in the channel. The hollow cell seal must completely seal the door making it weatherproof.			
c.	The compartment doors must be bolted to a stainless steel polished hinge, utilizing gaskets and stainless steel bolts with washers and lock nuts.			
d.	The doors and all hardware must be prefitted to the body. The framework must be drilled and tapped. The door and all hardware must be removed prior to the painting process.			
e.	The compartment doors and all hardware must be installed to the body door opening frame only after the doors and the body has been painted.			
f.	The compartment door at the EL1 location must be a flush fit pan style door.			
g.	The compartment door at the EL2 location must be a flush fit pan style door.			
h.	The compartment door at the EL3 location must be a flush fit pan style door.			
i.	The compartment door at the EL4 location must be a flush fit pan style door.			
j.	The compartment door at the ER1 location must be a flush fit pan style door.			
k.	The compartment door at the ER2 location must be a flush fit pan style door.			
5.	All body compartments must have Amdor Luma (or equivalent) bar LED lights activated by a switch. The LED compartment lights must be flush mount and provide a consistent 120 degree wide beam pattern. There must be a minimum of two strip lights installed in each compartment.			
6.	Compartments ER1, ER2, EL2 and EL3 must each have a heavy duty ball bearing roll out tray installed.			
a.	The tray(s) must have two (2) side mounted, 500 lb. rated ball bearing roll out 18" travel sliding tracks and a 3/16" aluminum tray with up turned edges. The tray must be supplied with plastic floor matting and			

	corner drain holes.		
b.	The tray(s) must have a drop bar tray retainer to keep the tray secure in either the open or closed position.		
c.	All trays must come with rubber matting.		
7.	The interior of all compartments of the body must also be sealed and caulked. A textured finish of light gray urethane paint with a white and black spatter finish must be applied to all compartment interiors.		
8.	Three inch "C" channel aluminum rub rails must be bolted into place with nylon spacers on the lower framework below the CBRNE Truck body compartments. The rub rail will extend to the outside edges of the CBRNE Truck body for protection of the body from impact damage.		
H. Curbside Configuration			
1.	The rear curbside of the CBRNE Truck must have double box pan door to allow entry into the walk-in body area.		
a.	The door must be hung and mounted using full length heavy duty stainless steel piano hinges. The door opening must be a minimum of 31" W x 92" High.		
b.	The walk-in body floor area, which will be a minimum of 42" wide, along with the lower side walls must be covered with .125" aluminum checker plate and sealed against contaminants.		
c.	The upper body walls and ceiling must be covered with grey vinyl covered aluminum sheets. All corners and seams must be trimmed with plastic molding and sealed.		
d.	The walk-in body must have a minimum of 90" and a maximum of 92" high headroom in the walk way		
2.	There must be slide out step proportional to the size of the door opening less 1" on the curbside rear of the CBRNE Truck.		
a.	The step must come with a Slide Master, (<i>or equivalent</i>) air slider that is rated at between 600lbs – 650lbs and has an extension of 70% of its depth measurement.		
b.	A 3/16" 3003 H14 NFPA rated slip resistant checker plate must cover the top of the slider assembly.		
c.	The slider assembly must be closed out from the bottom with 1/8" rust corrosion resistant aluminum and tied to the CBRNE Truck door, switch in the body and the chassis parking brake to allow the step to stay open when the parking brake is activated.		
d.	All steps on the body must have adequate light for illumination. All step lights must be LED style.		
3.	There be an 88"W x 91" L command area level out on the curbside. This level out design consists of heavy duty USO mechanisms on each side of the room to move it in and out and a Platform Lift mechanism to move the room up and down a maximum of 3.500 inches. The level out system come with touch panel controlled stabilizing 12,000lb front and 12,000lb rear jack system capable of 16" of lift.		

4.	One (1) 18' Zipdee (or equivalent) Electric Awning complete with wind meter and automatic retraction feature will be installed on the top of the CBRNE Truck body between the rear of the level out and the back of the truck.		
5.	The chassis batteries must be relocated to ER1 compartment on a roll out tray for easy access.		
I. Rear Configuration			
1.	There must be one (1) rear fold down door installed on the rear body horizontally hinged, that will serve as robot ramp. The ramp frame must be sufficient to support up to 1,000 lbs.		
a.	Top of the ramp must be finished with nonslip aluminum material. Minimum length of the ramp must be 86" with a width of 38" between raised edges. There must be between a 3" – 4" high raised edge on both side of the ramp. Heavy duty, stainless steel hinge must be reinforced at both ends to prevent deformation.		
b.	The cable to raise the door must be attached between hinge and ½ of the length (or closer) of the ramp to prevent tripping. A spring of sufficient rate to help lift the door must be installed above the door. One person must be able to lift door without significant effort.		
c.	The door must be lockable from inside and have a handle installed outside to help with lifting. There must be a magnetic door ajar switch mounted inside the door with a LED indicator light in cab and Push button inside and outside of rear door with buzzer and LED light.		
2.	There must be a 12" wide Zico Quic-Ladder (or equivalent) provided on the rear of the CBRNE Truck for access to the roof of the CBRNE vehicle.		
a.	The ladder assembly must consist of a two-step fold-down with a 3 step straight section and the ladder will store parallel to the body.		
b.	There is a release mechanism with a locking handle so you can pull the ladder out to a comfortable climbing angle. The ladder automatically latches and will not retract until the scissor lock is raised.		
c.	Cast aluminum rungs must have a flat, non-skid surface to provide traction and safety. The handrails are 1¼" heavy-walled aluminum tubing, covered in a rough grip black powder coat.		
d.	There must be a railing package included to meet WCB for an over height vehicle.		
3.	There must be a receiver hitch installed on the rear of the CBRNE Truck. The receiver hitch must be rated at 10,000 lbs. Two (2) heavy-duty painted tow eyes must be bolted directly to the rear frame rails. These tow eyes must be easily accessible underneath the rear of the CBRNE Truck body.		
a.	There must be wiring installed for connection to the customer supplied trailer. The wiring must be wrapped in a weather resistant loom and be firmly secured to the CBRNE Truck body.		
J. Street Side Configuration			
1.	There must be an air outlet connection installed at the EL4 area and connected into the chassis air tank reservoir. The air fitting for this outlet must be hooked to the air reel.		
a.	A Hannay EF1516-17-18 (or equivalent) electric rewind air hose reel		

	must be mounted as per the RCMP specifications.		
b.	The hose reel must be plumbed to the chassis air tanks.		
c.	The air hose reels must come with stainless steel fairlead rollers.		
d.	The air hose reel must come with 150' of 3/8" air hose that is red in color and rated for minimums of 150 PSI and -50°C.		
2.	A Hannay ECR1600 (or equivalent) electric rewind cord reel must be supplied and installed on the CBRNE Truck. The cord reel must be powered by an electric motor and have the capacity to hold up to 200' of wire. The exterior of the reel must have a painted oven-cured enamel finish. The location of the cord reel must be at EL1 and be wired to the CBRNE Truck shore line system.		
a.	The reel must have a four way roller assembly installed on it to help guide and protect the cable.		
b.	150' of yellow 10/3 SOOW cabled wire must be supplied and installed with the cord reel.		
c.	A twist lock 20 amp male receptacle must be supplied on the wire.		
d.	A round cable stop must be provided on the wire.		
3.	A Kussmaul Pump Plus 2000 (or equivalent) combination battery charger, 12V air compressor, auto eject 20WP 20 amp automatic power line disconnect and remote bar graph indicator must be provided.		
a.	The output side of the battery charger must be connected to the chassis batteries, and the input side connected to the auto eject receptacle. The output side of the air pump must be connected into the chassis air system, and the input side connected to the auto eject receptacle.		
b.	A 110 volt, 30 amp Kussmaul Super Auto-Eject, (or equivalent) 3-prong, straight blade receptacle must be provided at the left cab door area. This receptacle must have a red hinged weatherproof cover.		
4.	There must be 2 Robot Antenna tubes installed on the road side of the body for installation of the robot antennas one at the front of the body and one at the rear of the body.		
5.	A Cummins Onan Quiet diesel series 12 Kw diesel generator complete with electric start must be provided on the completed vehicle. The generator must consist of a 3 cylinder Kubota D1503-M diesel engine, full frame, extra quiet - large muffler, 120/240 volts with multi receptacles, Full instrumentation featuring voltmeter, pilot lamp, fuel gauge, 120/240 volt switch and auto throttle which allows the engine to idle down under no load conditions.		
a.	Computer-controlled constant speed operation.		
b.	Unique sound-controlled housing encloses cooling system and muffler - simplifies installation.		
c.	Three-point, fully focalized internal mounting system reduces vibration.		
d.	Self-diagnostic capabilities simplify troubleshooting.		
e.	Service and maintenance points accessible through easy-latch side service door.		

f.	Convenient, top-mounted switches and coolant level check/fills.		
g.	Automatic glow plug eliminates preheat time uncertainty.		
h.	The generator starter must be wired into the chassis battery and fuel system and must be complete with electric start on the generator.		
i.	The generator must come equipped with an electric remote start module. The mounting location for the generator remote start must be at the discretion of the RCMP.		
j.	Stainless steel flexible tubing must be affixed to the generator exhaust system and routed out of the compartment and the Pan doors must be louvered for fresh air intake.		
6.	<p>One (1) Tundra (or equivalent) 12V Inverter(s) must be tied to the chassis batteries and mounted in a dry location on the CBRNE Truck as close as possible to the chassis battery system. A remote on/off switch must be installed in the chassis cab to turn the inverter on and off.</p> 		
a.	The inverter must be designed to deliver 3000 Watts or 10 amps at 120 Volts. The inverter must have a power surge capacity of 6000 Watts for one (1) second. The inverter must operate with input voltages between 11 and 15 volts DC. If the voltage drops lower than 11.5 volts, the low battery warning alarm will sound. The inverter must shut off if the voltage drops below 11 volts to protect the batteries from being discharged. The inverter must not restart until the input voltage exceeds 13.0 volts.		
b.	The inverter must come with two (2) 120V plugs.		
7.	Two (2) power switching relays must be provided and installed so that the when the generator is activated, the power supplied from the 120 volt shoreline receptacle to the breaker box/power accessory must be turned off, and when the generator is turned off the 120 volt power inverter must be activated.		
8.	A Federal Pioneer breaker box complete with the required circuit breakers for the 120 / 240 Volt electrical options must be provided and		

	installed in the body compartment located closest to the generator.		
K. Roof Configuration			
1.	There must be a 12"L x 4"D x 98"W antenna box with lid installed on the roof of the CBRNE truck body.		
2.	A Knight 2, manufactured by Command, (or equivalent) Light tower must be provided for installation on the CBRNE Truck. The location of the light tower and its controls must be installed according to instructions given by the customer and the requirements of the light tower manufacturer.		
a.	The light tower must extend a minimum of 87-1/2" above the mounting surface and must extend to full upright position in less than 15 seconds. The overall size of nested light tower must be approximately 30" wide x 47" long x 13" high and weigh approximately 165 pounds.		
b.	The light tower assembly must be of aluminum construction, with stainless steel shafts and bronze bushings for long life and low maintenance.		
c.	The electrically controlled unit must not require usage of the vehicle's air supply for operation, thereby eliminating the chance for air leaks in the vehicle braking system. <u>Hydraulic or pneumatic type floodlights are not acceptable alternatives to the specified all electric light tower.</u>		
d.	The light tower must be tested in wind conditions of 90 mph (150 kph) minimum. Other type floodlights that have not been tested to these conditions are not acceptable.		
e.	The light tower must be capable of overhanging the side or back of the vehicle to provide maximum illumination to the vicinity adjacent to the vehicle for the safety of emergency personnel in high traffic conditions. Any tower that is only capable of rotations at the top of a pole is not an acceptable alternative to the specified tower.		
f.	The light tower must be a two-stage articulating device with a lighting bank on top of the second stage capable of continuous 360 degree rotation. The light must be elevated by electric linear actuators, one (1) actuator must elevate the lower stage and one (1) actuator must adjust the light bank angle from 0 to 110 degrees. Power for the light bank must be supplied through power collecting rings thus allowing continuous 360 degree rotation in either direction.		
g.	The tower base must have a light that illuminates the envelope of motion during any movement of the light tower mast as required by NFPA1901.		
h.	The Command Light must be equipped with the following bank of floodlights: Floodlight manufacturer: FRC (or equivalent) Number of lamp heads: Six (6) FRC Spectra (or equivalent) Voltage: 12 volt Watts of each lamp head: 220 watts Total watts of light tower: 1320 watts Total Lumens of light tower: 120,000 lumens		

i.	The light heads must be mounted two (2) on each side of the light tower, giving two (2) vertical lines of two (2) when the lights are in the upright position.			
j.	The light tower must include a checker plate wind/brush guard mounted at the front of the command light.			
k.	Three (3) mounts for future antenna installation must be installed on the chassis cab roof. The antenna leads must be wired to the chassis cab dash area for future installation of a radio.			
L. Front Configuration				
1.	There must be a light bar kit supplied with the Ali Arc (or equivalent) Grill guard.			
a.	The light bar kit must consist of One (1) Rigid Industries E2 30" LED Combo light bar part # 13231 (or equivalent) and two (2) Rigid Industries SAE Fog lights Part # 50481. (or equivalent)			
2.	A red warning light for the door ajar system must be provided in the cab. This light must be activated when a compartment door on the CBRNE Truck body is open and the park brake is released. There must be a magnetic sensor switch located in the compartment that will indicate when a door has been opened.			
M. INTERIOR CONFIGURATION				
1.	A cab/body opening must be installed in between the chassis cab and the crew canopy area. The standard cab rear back wall must be removed and a new back wall must be installed with a walk thru area that must be made as large as possible, approx. 30"W x 75"H. A single heavy duty, locking sliding door must be installed that will be weather proof. The interior of the walk thru opening must be finished with a grey carpet type material. The RV Style aluminum Canopy must cover the roof cutout and must serve as the mounting location for the emergency and scene lights.			
2.	The command area level out must have installed a complete Aluminum work desk, three (3) slide out locking drawers with lower drawer to house a ScanX XRay developer with 120 volt receptacle mounted in it.			
a.	Two (2) fixed swivel chairs must be installed and mounted to the floor of the command desk area.			
3.	The storage areas must be manufactured from 3/16" 5052-H32 aluminum with a natural brushed finish.			
4.	The dimensions of the interior storage areas, starting from front to rear, must be:			
a.	Compartment	Compartment Frame Dimensions		
i.	IR1-IR8	15.5W x 44H x 26D		
ii.	IR9	15W x 45H x 26D		

iii.	IR10	60W x 35H x 26D		
iv.	IR11	63W x 45H x 26D		
v.	IL1	48.25W x 27H x 26D		
vi.	IL2	33W x 91H x 26D		
vii.	IL3	30.75W x 48.5H x 14D		
viii.	IL4	56W x 27H x 14D		
ix.	IL5	56W x 27H x 14D		
x.	IL6	30.75W x 39H x 26D		
xi.	IL7	37W x 41H x 26D		
xii.	IL8	60W x 29H x 26D		
xiii.	IL9	13W x 41H x 26D		
xiv.	IL10	36W x 17.5H x 24D		
xv.	IL11	27W x 50H x 24D		
xvi.	1L12	27W x 50H x 24D		
5.	Compartments IR1 thru IR9, IL3, IL9, IL10, pistol storage and the upper storage cupboard must be provided with single pan doors and must be flush fit design with locking D ring door openers.			
6.	The compartment doors must be bolted to a stainless steel polished hinge, utilizing gaskets and stainless steel bolts with washers and lock nuts.			
7.	The doors and all hardware must be prefitted to the body. The framework must be drilled and tapped. The door and all hardware must be removed prior to the painting process.			
8.	The compartment doors and all hardware must be installed to the body door opening frame only after the doors and the body has been painted.			
9.	One (1) ProtexPlo Inc. Mini-magazine will be installed in the IR7			

	compartments as per the RCMP requirements.		
10.	Compartments IR11 & IR10 must have single pan aluminum doors with a pull type latch system and have the fixed shelves previously noted in the specification.		
11.	Compartments IL1, IL4, IL5 must be installed in the framework of the body and be included with an aluminum door with a lift and two (2) lift and turn latches as per the drawing/specification attached with the specification with gas strut hold open devices.		
12.	There must be a three (3) section cupboard storage area with cargo netting installed under IL1 with a NorCold 12/120 volt refrigerator and Microwave next to this storage area.		
13.	An Aluminum radio compartment must be installed in the interior of the EOD/CBRN command center directly above the fridge/microwave area. The compartment must be manufactured from 1/8" aluminum with the approximate dimensions of 48.25" wide x 27" H x 26" D.		
a.	Four (4) 120 volt outlets must be installed in the tray for radio / accessory recharging. The outlets must be tied to a shoreline inlet at the chassis cab door.		
14.	Compartment IR6 must include four (4) slide out drawers with ball bearing sliders capable of 500 lbs each, the draws must be finished with checker plate and lift and turn latch closures.		
15.	Compartment IR8 must include two (2) slide out drawers with ball bearing sliders capable of 500 lbs each, the draws must be finished with checker plate and lift and turn latch closures.		
16.	There must be a heavy duty butcher block oak hard wood counter top with a varnished finish above compartments IL7, IL8, IL9. This must serve as a work bench for the CBRNE Truck and will not produce any type of spark. There must be 4 of the GFI duplex receptacles installed in this counter top area.		
17.	One (1) set(s) of four (4) aluminum unistrut (or equivalent) side tracks must be provided for installation of adjustable shelves in IL11.		
18.	Two (2) adjustable 3/16" aluminum compartment shelves with upturned edges must be provided in IL11. Each shelf must be provided with plastic matting.		
19.	Six (6) permanently installed 3/16" aluminum compartment shelves with upturned edges must be provided. Each shelf must be provided with plastic matting. The shelves must be installed in the interior IR10, IR11 and IL9 compartments with 2 shelves in each compartment.		
20.	The compartment door at the IL2 location must be Amdor (or equivalent) roll up style. This compartment must feature a 500lb roll out coat rod/rack capable of supporting the EOD Bomb disposal suit. This compartment must feature a fixed tray for the bomb suit helmet with 18" of usable space.		
21.	The compartment door at the IR11 location must be Amdor (or equivalent) roll up style.		
a.	The Amdor(or equivalent) roll up type doors mounted in IL11 and IL2 must include: <ul style="list-style-type: none"> - double wall aluminum box section slats with integral hinge joint and recessed slat seal, - reusable end shoes with snap-in securement, - double wall aluminum reinforced bottom rail with either Stainless Steel Lift Bar door latching system, - aluminum track with side frame, sill plate, and top gutter with non-marring top seal, side seals, bottom seal, with all wear component 		

	material to be Type 6 Nylon.		
b.	The slats must have a true box section with a flat interior surface to prevent equipment hang-up. The slats must have a face depth of 1.0 inches and a wall thickness of 0.045 inches. Each slat incorporates a recessed slat seal to weatherproof the compartment and reduce rattle between slats.		
c.	For every inch of height an integral continuous hinge joint spans the width of the door to provide superior strength.		
d.	The door glides on non-interlocked end shoes. Each end shoe is independent and positively secured by an exclusive snap-in device. Door slats can be easily removed and replaced when required.		
e.	The Stainless Steel Lift Bar system must be provided to keep the door securely closed. This system complements the superior strength of the bottom rail with bottom seal and integral reinforcing flange.		
f.	Wear components are constructed of Type 6 Nylon to provide maximum strength and durability. Type 6 Nylon is a naturally lubricating material, which provides exceptional temperature characteristics.		
g.	Each door is equipped with slat, top, bottom and side seals to keep moisture and dirt on the outside. The non-marring top seal provides a seal without marking the door surface.		
N. ELECTRICAL SYSTEM - MULTIPLEXED			
1.	The manufacturer must design the wiring system for the CBRNE Truck in accordance to the SAE, Society of Automobile Engineers.		
2.	The manufacturer must determine the circuit loads and designs the system to accommodate these loads with appropriate circuit routings and relays.		
3.	All wiring harnesses must be properly secured and routed. All passages required for routing must be grommited and sealed as required.		
4.	All wiring must be easily accessible for servicing.		
5.	All wiring must be SAE J1128 and SAE J1292 GXL type wire, as per industry standards.		
6.	All exposed wiring must be crimped and heat shrunk for added protection.		
7.	The wiring harnesses must be pre-engineered for correct circuit loading and must be custom made. The harnesses must be function, number, and color coded and must be fitted inside an automotive high temperature loom. All connections to the main panel box must be made with waterproof automotive style guided pin locking connectors {No Exceptions}		
8.	An enclosed main electrical distribution panel that provides protection against dirt, dust, oil, and water must be installed in the upper section of the truck body kick over.		
9.	All electrical connections to the panel must be made through positive locking environmentally sealed connectors. The panel features a solid state power distribution board(s) with visual diagnostics.		
10.	All circuits are protected by automatic resetting circuit breakers. All breakers must be properly sized to the circuit load and are direct plug in sockets.		

11.	All wiring must have a strain pull test on wiring connections of 40 pounds.		
12.	A 300 amp solenoid master battery switch must be installed in the cab within reach of the driver.		
13.	The inverter/charger supplied as part of the generator system must be able to charge the vehicle batteries from either an AC, generator or alternator power source, and provide AC power to equipment from the DC power source while the vehicle is in transit.		
O. ELECTRICAL RECEPTACLES			
1.	All of the 120 Volt dual plug receptacle mounted in the command center interior must be wired to the 30 Amp shore line, the generator and the power inverter using power switching relays. The receptacles must be tied to a shoreline receptacle mounted at the rear of the body.		
a.	Eleven (11) 120 volt / 15 amp duplex straight blade receptacle(s) must be provided and installed on the interior of the CBRNE truck. Location must be as per the interior drawing provided.		
b.	Four (4) 120 volt three prong, straight blade receptacle(s) must be provided in the cab/crew cab area.		
c.	Three (3) 120 volt / 15 amp duplex straight blade receptacle(s) must be provided and installed on the exterior of the CBRNE truck. The receptacle(s) must have a sealed weather proof cover to protect against the elements. Location must be at both side wheel wells and the rear road side of the body.		
P. INTERIOR & EXTERIOR LIGHTING			
1.	There must be a total of eight (8) hi/lo LED lights mounted along the interior walkway of the walk in CBRNE truck interior. Four (4) lights must be mounted along the walkway and four (4) lights must be mounted over the slide out command section.		
2.	Two (2) Fire Research model LED900-Q70 surface mount light(s) must be installed on the street side of the body. The light(s) must be mounted with four (4) screws to a flat surface. It must be 6 3/4" high by 9" wide and have a profile of less than 1 3/4" beyond the mounting surface. Wiring must extend from a weatherproof strain relief at the rear of the light.		
a.	The light(s) must have twenty-four (24) white LEDs that generate a rated 7000 lumens at 12 or 24 volts DC. The lens must redirect the light along the vehicle and out onto the working area. The light housing must be aluminum with chrome colored bezel.		
3.	Three (3) Fire Research, model LED900-Q70 (or equivalent) surface mount light(s) shall be installed on the curb side of the body. The light(s) must be mounted with four (4) screws to a flat surface. It must be a minimum 6 3/4" high by 9" wide and have a profile of less than 1 3/4" beyond the mounting surface. Wiring must extend from a weatherproof strain relief at the rear of the light.		
a.	The light(s) must have twenty-four (24) white LEDs that generate a rated 7000 lumens at 12 or 24 volts DC. The lens must redirect the light along the vehicle and out onto the working area. The light housing must be aluminum with chrome colored bezel.		
4.	Four (4) Fire Research model LED900-Q70 surface mount light(s) must		

	be installed on the front and the rear of the body. The light(s) must be mounted with four (4) screws to a flat surface. It must be 6 3/4" high by 9" wide and have a profile of less than 1 3/4" beyond the mounting surface. Wiring must extend from a weatherproof strain relief at the rear of the light.		
a.	The light(s) must have twenty-four (24) white LEDs that generate a rated 7000 lumens at 12 or 24 volts DC. The lens must redirect the light along the vehicle and out onto the working area. The light housing must be aluminum with chrome colored bezel.		
5.	There must be a total of six (6) Federal Signal Quadraflare 6x4 series (or equivalent) LED lights installed at the rear face of the CBRNE Truck body to be used as the Tail Light Assembly.		
a.	These lights must include, Federal Signal red stop/tail lights, amber "arrow" turn signal lights, and clear back up lights installed in two (2) vertically mounted four (4) light polished cast aluminum trim bezels.		
6.	There must be ten (10) Luma Bar H2O (or equivalent) 12" LED ground lights with outward facing angle brackets installed underneath the CBRNE Truck.		
a.	The ground lights must be activated by a switch installed in the chassis cab.		
b.	Ground lights that are directly underneath a door opening must turn on automatically when the door is opened.		
7.	One (1) 4" clear engine compartment light shall be installed in the engine compartment area and must be activated by a mercury switch.		
8.	All clearance / marker lights, reflectors must comply with department of transport motor vehicle safety standards. The clearance / marker lights must be LED type.		
a.	A set of LED (light emitting diode) front clearance lamps must be installed on the front of the body to comply with department of transport motor vehicle safety standards.		
b.	A set of LED (light emitting diode) mid body turn signals must be installed to comply with department of transport motor vehicle safety standards for vehicles over 30 feet in length.		
Q. EMERGENCY EQUIPMENT			
1.	One (1) Federal Signal Viper S2 P/N 329001-34 (or equivalent) intersection light must be installed. These lights must utilize high output Solaris (or equivalent) LED technology. The sixteen red/blue LED lights must be encapsulated in a waterproof housing. The lens color must be red/blue in color. The light mounting bezel must be black in color and mount in the middle of the front windshield at the roofline.		
2.	Two (2) Federal Signal Quadraflare (or equivalent) 6x4 intersection lights P/N QL64XF-A must be installed. These lights must utilize high output Solaris LED technology. (or equivalent) The light must come with amber LED lights and must be encapsulated in a waterproof housing. The lens color must be amber in color. The light mounting bezel must be chrome and be mounted at the upper rear of the body.		
3.	Twenty two (22) Federal Signal Quadraflare (or equivalent) 6x4 intersection lights P/N QL64SFC-RB must be installed. These lights must utilize high output Solaris LED technology. The light must come with a split LED red/blue in color and must be encapsulated in a		

	waterproof housing. The lens color must be clear in color. The light mounting bezel must be chrome and installed as per RCMP requirements.		
4.	There must be a Federal PA-300MCS (or equivalent) electronic siren, with microphone installed in the cab which features:		
a.	<ul style="list-style-type: none"> - 5 basic siren tones, - TAP II (horn-ring transfer), to allow for effective intersection traffic clearing capability without removing your hands from the steering wheel or your eyes from the road. - PA, - radio rebroadcast, air horn sound with siren override. 		
b.	- "Press-and-Hold" function, depressing and holding the horn ring will produce an alternate sound for as long as the operator keeps the horn ring circuit depressed.		
c.	<ul style="list-style-type: none"> - siren's PA volume level to be controlled with a Rotary gain switch located on the unit's backlit front panel, - radio rebroadcast volume to be adjustable via an easily accessible rotary pot 		
d.	<p>The PA300 (or equivalent)</p> <ul style="list-style-type: none"> - siren must also include a permanent noise-canceling microphone that produces high quality voice reproduction without feedback squeal, - microphone's push-to-talk switch must override any siren tone for instant PA use. 		
5.	There must be a Federal model BP200-EF / 200 watt (or equivalent) electronic siren speaker provided at the front bumper and connected into the electronic siren.		
R. DVR CAMERA/MONITOR SYSTEM			
1.	One (1) General Digital 24" SABER (or equivalent) standalone LCD monitor must be supplied and installed at the command desk area. This work station must be wired to the command light camera, DVR and both EOD robots.		
2.	One (1) General Digital TwoView2 (or equivalent) Dual flip down monitor display must be installed and mounted above the robot storage area and wired to the main command desk monitor/DVR system.		
3.	One (1) BOSCH PTZ CAMERA VEZ-423-EWCS PTZ (or equivalent) with pan, tilt and zoom must be installed on the command light tower and wired to the EOD/CBRN DVR and command desk via a Wireless 2.4 connection due to command light 355 degree rotation.		
4.	One (1) BOSCH RECORDER DVR-3000-04A100 4 CHANNEL ANALOG DVR (or equivalent) must be installed at the EOD/CBRN Command Desk, hooked to both EOD Robots and the light tower camera.		
S. FINISH AND PAINTING			
1.	The exterior of the body must be painted with Delfleet® Evolution		

	FBCH (or equivalent) high solids polyurethane paint using the manufacturer's recommended practices for the best possible finish.		
2.	Colour must match the cab.		
3.	The interior of all compartments of the body must also be sealed and caulked. A textured finish of light gray urethane paint with a white and black spatter finish must be applied to all compartment interiors.		
T. HEATING/COOLING			
1.	The canopy area must be fully air conditioned with dual 120 volt low profile air conditioning/heating systems with a 13,500 Btu cooling/heating package.		
a.	This air conditioning system must be connected into the diesel generator system with an evaporator installed in the CBRNE Truck roof.		
b.	This air conditioning evaporator must have an on/off control switch, heater switch along with a blower motor control switch.		
2.	Four (4) 17,500 BTU forced air heaters must be installed at the front & rear lower section of the canopy enclosure, and (2) at each side of the crew area. There must be a rotary on / off switch located in the command center interior.		
U. MISCELLANEOUS ITEMS			
1.	The CBRNE truck shall be supplied with a Road Safety Kit which must include:		
a.	One (1) 2.5 lb. ABC vehicle type fire extinguisher with mounting bracket.		
b.	One (1) standard First Aid Kit		
c.	One (1) set of three (3) dual faced triangular warning flares to meet the Department of Transportation's Motor Vehicle Safety Standards.		
2.	One (1) Truck based GPS must be installed and hard wired to the chassis dash using an adjustable RAM flexible mount.		
3.	There must be four (4) 12V DC "lighter plug" outlets with attached cap installed in the chassis cab and installed as per the RCMP requirements.		
4.	Four (4) 4" Coaxial Car Speakers must be installed in the cab.		
5.	One (1) vehicle alarm system with the following minimum specifications must be installed;		
a.	<ul style="list-style-type: none"> ○ Cab & Body security, all exterior doors on cab and body monitored when armed ○ One status LED ○ One valet switch ○ 2 way antenna ○ One 2 way LCD LC3 SST up to one mile range remote/Pager ○ One 1 way long range remote 		

	<ul style="list-style-type: none">○ Encryption for increased code hoping protection○ One shock sensor○ One 6-Tone Siren speaker mounted under chassis○ Keyless entry		
--	---	--	--

NOTES:

The Cab, Chassis and Box are to be considered as one unit and the subject of one tender.

Wherever actual brand or model names are referenced, equipment of equal or superior manufacture will be considered, if so indicated by the addition of **(or equivalent)** to the information.

Dimensions noted in the written specification and on the drawings provided can be considered as approximate and can be adjusted slightly **(by up to +/- 1")** to accommodate the manufacturing requirements on agreement of the RCMP and the successful bidder.

Bidders must indicate compliance with all details of the specification by initialing all areas as indicated in the compliance columns and initialing each drawing. The written specification and the drawings are to be considered as one, notation of an item in one, and not in the other, does not negate the need for the given item.

Bidders must indicate compliance with all details of the specification by initialing all areas as indicated in the compliance columns and initialing each drawing. The written specification and the drawings are to be considered as one. Notation of an item in one, and not in the other, does not negate the need for the given item.

The successful bidder must supply the RCMP with AC and DC wiring diagrams, Construction Estimator Certified (CEC), and Electrical Safety Authority (ESA) certification documentation, and Computer Aided Design (CAD) drawings of the unit(s) before the building phase begins and a final set with any amendments provided at time of delivery.

There will be a teleconference meeting held between PWGSC, the RCMP and the successful bidder prior to construction of this vehicle to ensure that all requirements are understood and will be met.

There will be a minimum of two inspections during the construction of the body portion of the vehicle and a third prior to acceptance of the vehicle on completion, to be arranged between the successful bidder and RCMP.

At time of delivery, the fabricator must provide detailed, hands on training on the mechanical/electrical workings of the entire vehicle.

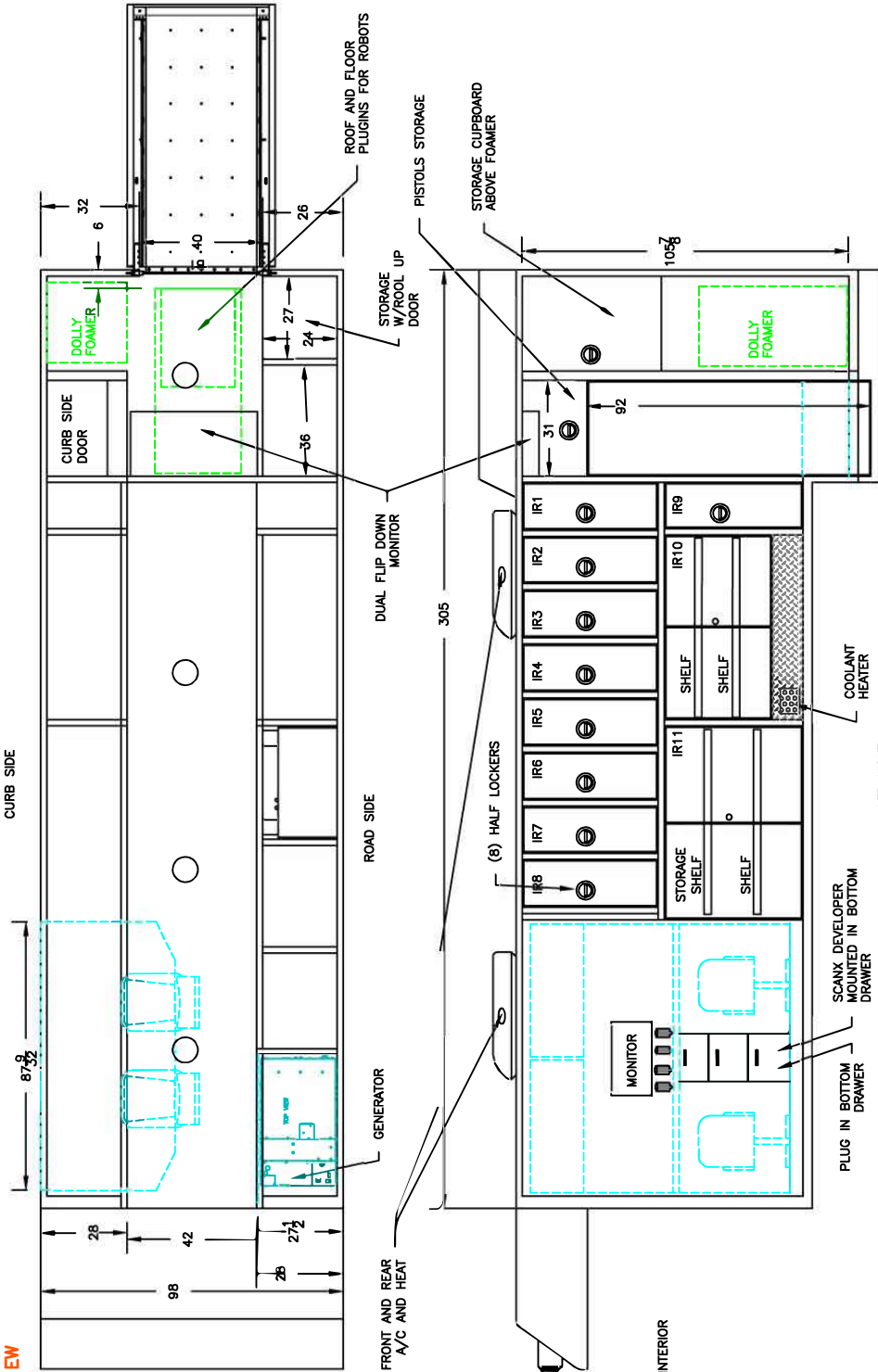

CURB SIDE INTERIOR

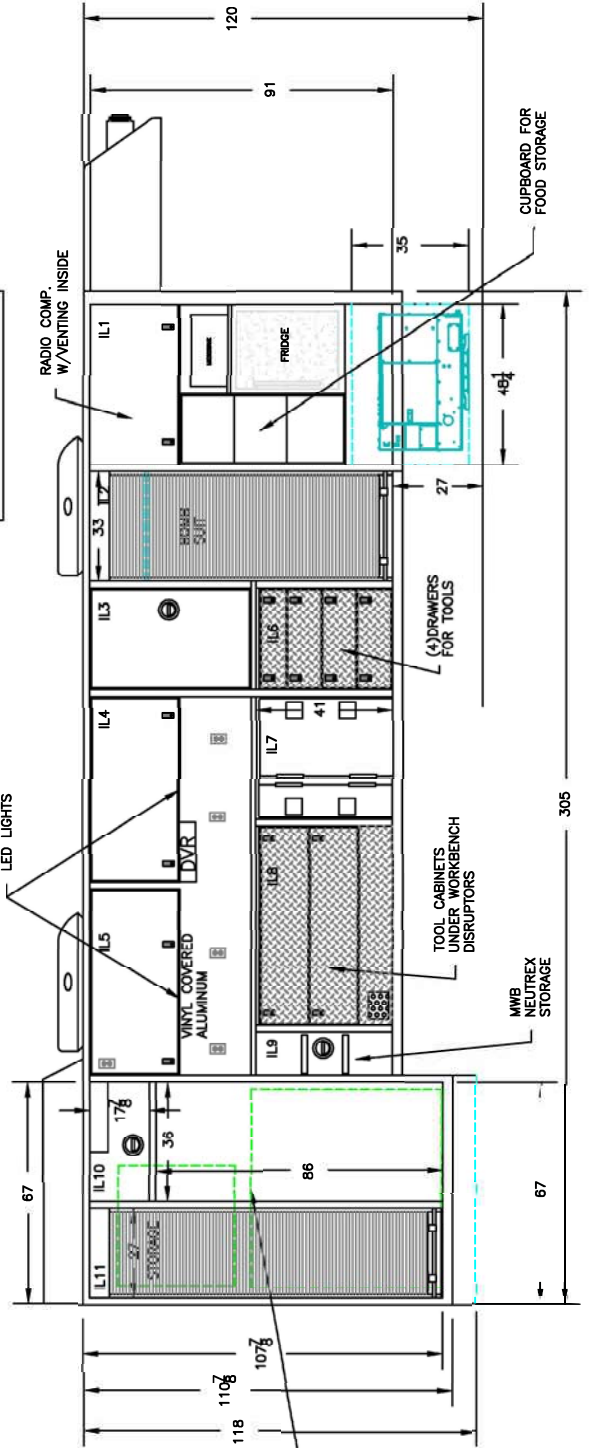

ROAD SIDE INTERIOR

DOUBLE STACK ROBOTS

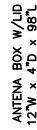

ANNEX "B"

BASIS OF PAYMENT

The Contractor must deliver one (1) Explosives Disposal and Chemical, Biological, Radiological, Nuclear and Explosives (CBRNE) Vehicle as described in Annex A, Requirement.

GST is to be extra to the price herein, and is to be shown on a separate line on the invoice.

There is an option to purchase one (1) additional truck as described in Annex A, Requirement, within a twenty four month period after contract award. This option to purchase could be exercised either in the first twelve (12) months after contract award or within months thirteen (13) to twenty four (24) after contract award when issued by the Contracting Authority.

Bidders must provide pricing for all three sections in Annex B, Basis of Payment, for Parts A.1., B.1., and B.2 to be considered compliant.

A. Initial Purchase

1. Purchase of Explosives Disposal and CBRNE Vehicle

Description	Quantity	Price
Firm Price for one Explosives Disposal and CBRNE Vehicle as described in Annex A, Requirement.	1	\$

**** In the instance where the RCMP wish to purchase another vehicle within the following periods, please provide the pricing each period as laid out below:**

B. Optional Purchase, only if exercised by the Contract Authority within the timeframes laid out below.

1. Option to purchase an additional Explosives Disposal and CBRNE Vehicle within one (1) to twelve (12) months from contract award:

Description	Quantity	Price
Firm Price for one Explosives Disposal and CBRNE Vehicle as described in Annex A, Requirement.	1	\$

2. Option to purchase an additional Explosives Disposal and CBRNE Vehicle within thirteen (13) to twenty four (24) months from contract award:

Description	Quantity	Price
Firm Price for one Explosives Disposal and CBRNE Vehicle as described in Annex A, Requirement.	1	\$

ANNEX "C" to PART 3 OF THE BID SOLICITATION

ELECTRONIC PAYMENT INSTRUMENTS

The Bidder accepts any of the following Electronic Payment Instrument(s):

- ☐ VISA Acquisition Card;
- ☐ MasterCard Acquisition Card;
- ☐ Direct Deposit (Domestic and International);
- ☐ Electronic Data Interchange (EDI);
- ☐ Wire Transfer (International Only);
- ☐ Large Value Transfer System (LVTS) (Over \$25M)