

ÉQUIPEMENT DE SAUVETAGE ET CHEMINS D'ÉVACUATION

LIFE SAVING EQUIPMENT AND EVACUATION ROUTES

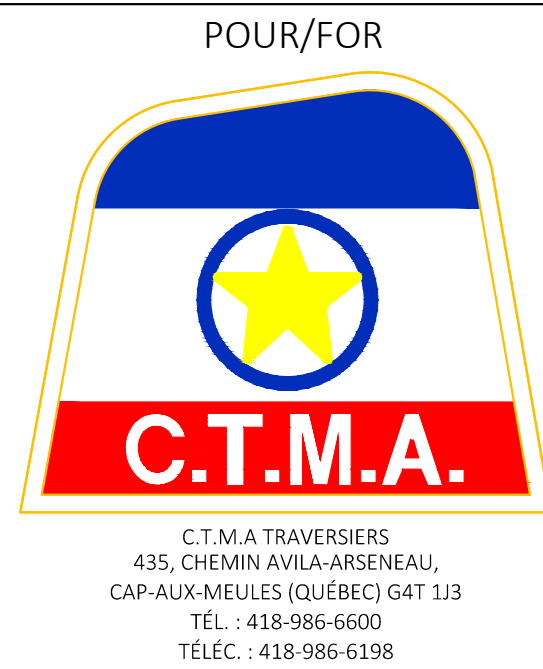

CARACTÉRISTIQUES PRINCIPALES PRINCIPAL PARTICULARS	NOTES	N.M. M.V.	"MADELEINE"
LONGUEUR HORS TOUT LENGTH OVER ALL	124.11 M (407' 2")	APPROBATION(S)/APPROVAL(S)	
LONGUEUR ENTRE PERPENDICULAIRES LENGTH BETWEEN PERPENDICULARS	112.00 M (367' 5")	PAR/BY	DATE
LARGEUR BREADTH	18.60 M (61' 0")	Transports Canada/Transport Canada	18-03-1999
CREUX (PONT D'EMBARQUEMENT) DEPTH (ENTRANCE DECK)	12.55 M (41' 2")	REVISION(S)	
CREUX (PONT PRINCIPAL) DEPTH (MAIN DECK)	7.29 M (23' 7")	NO	NATURE
PASSAGERS PASSENGERS	750 @ 768	Annotations par Transport Canada Notations by Transport Canada	24-03-1999 NAVTECH
EQUIPAGE CREW	32 @ 50	Annotations par Transport Canada Notations by Transport Canada	29-03-2016 CONCEPT NAVAL
TOTAL:	800		
TYPE DE VOYAGE: CAROTAGE CLASS I VOYAGE TYPE: HOME-TRADE CLASS I			

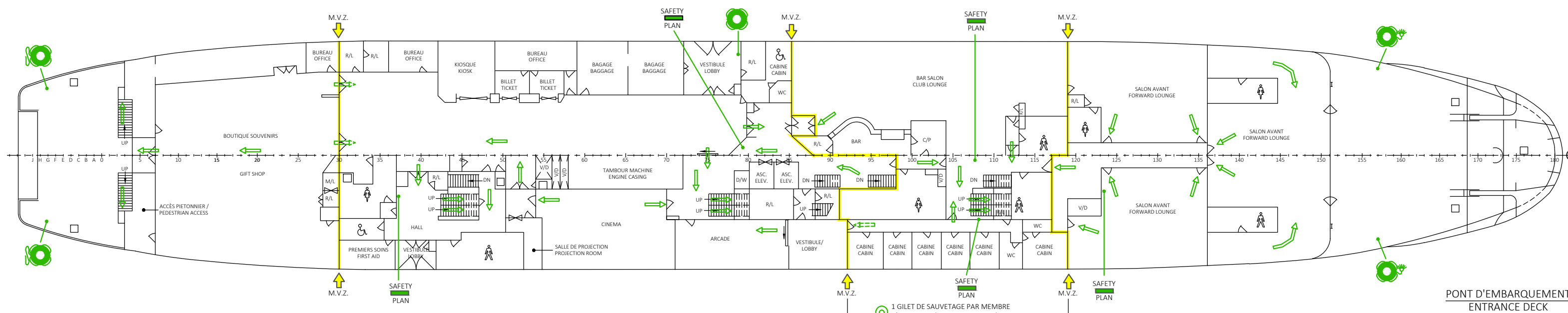
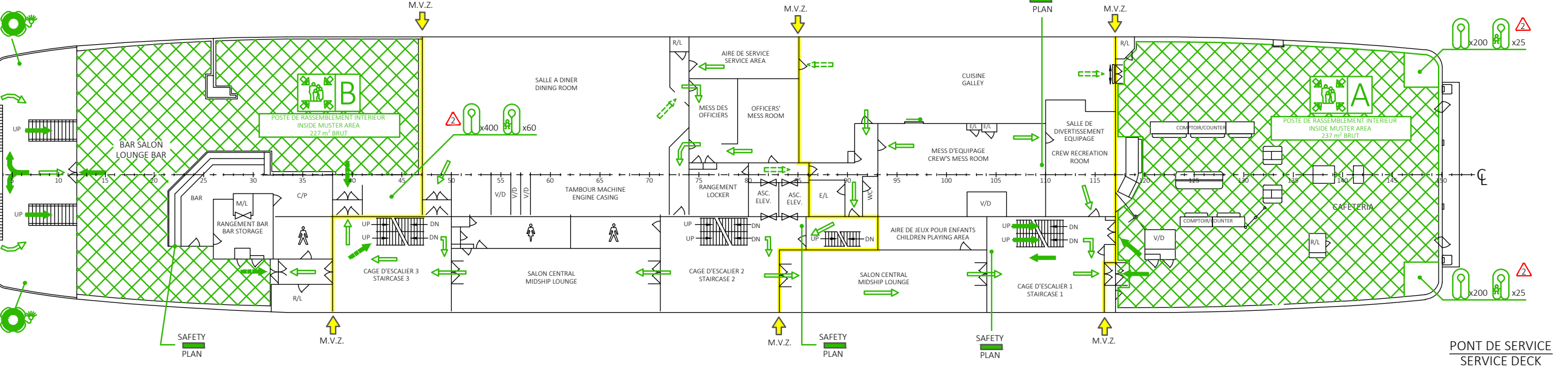
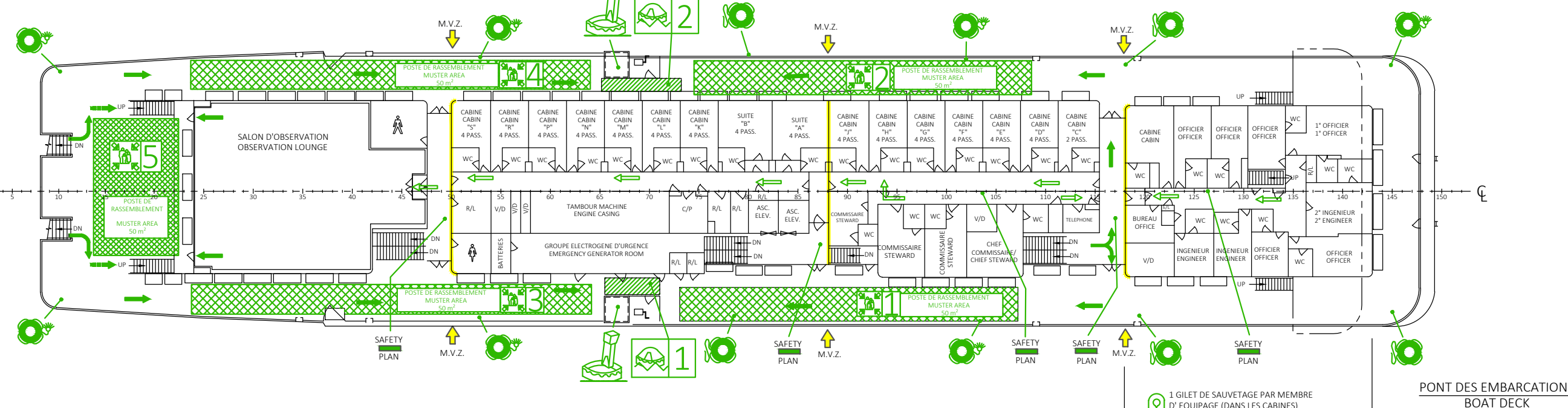
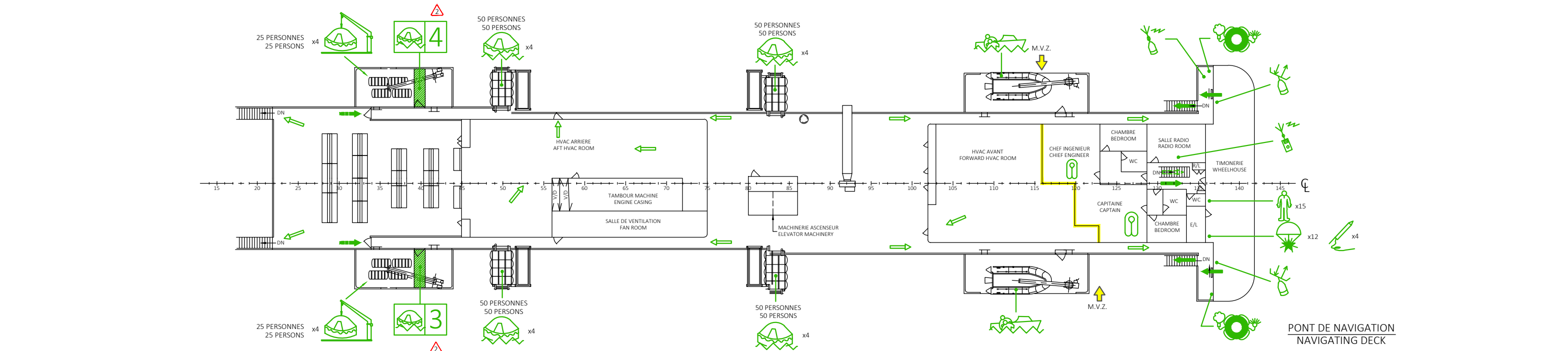
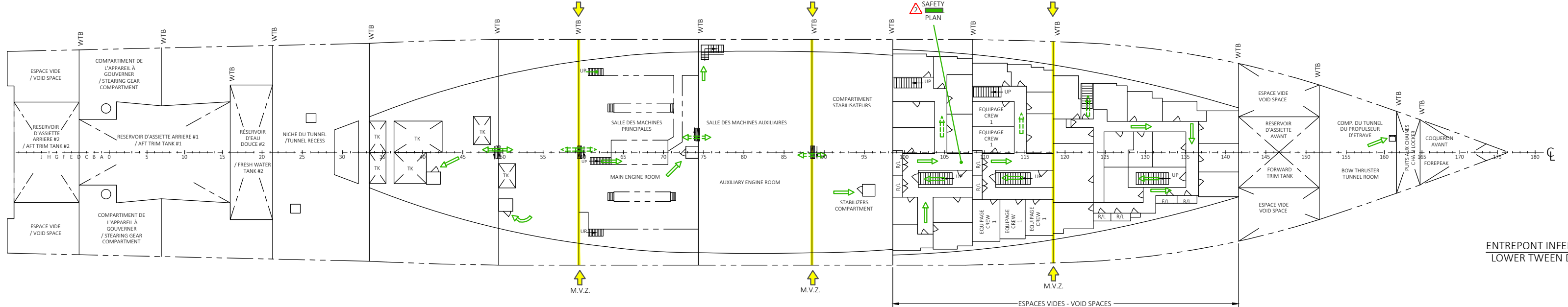
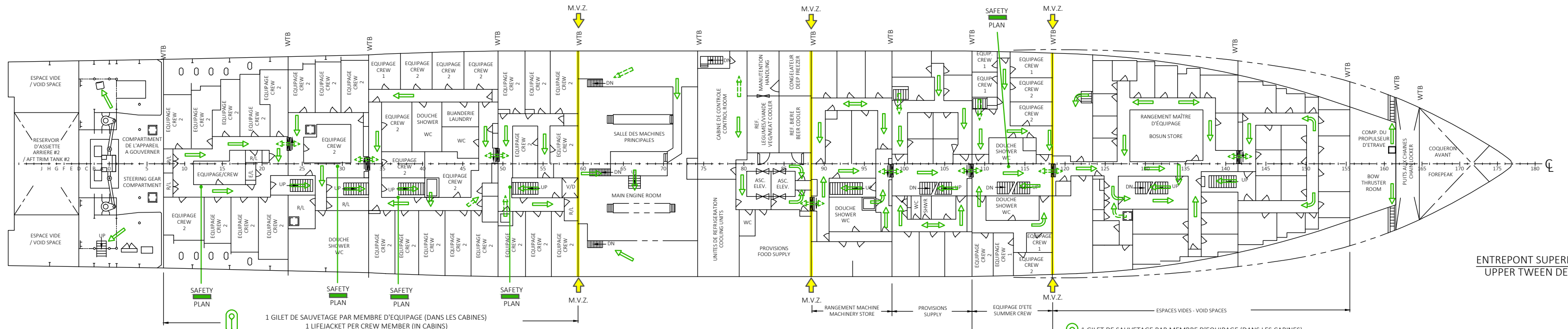
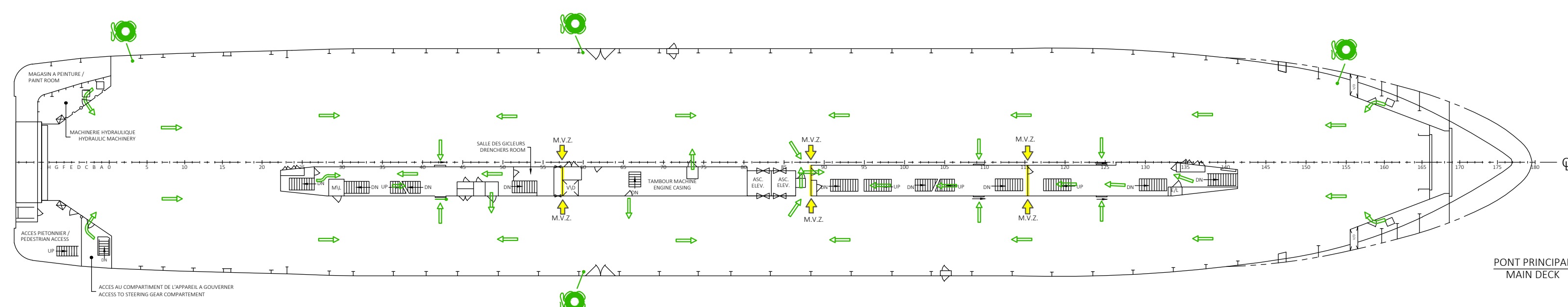
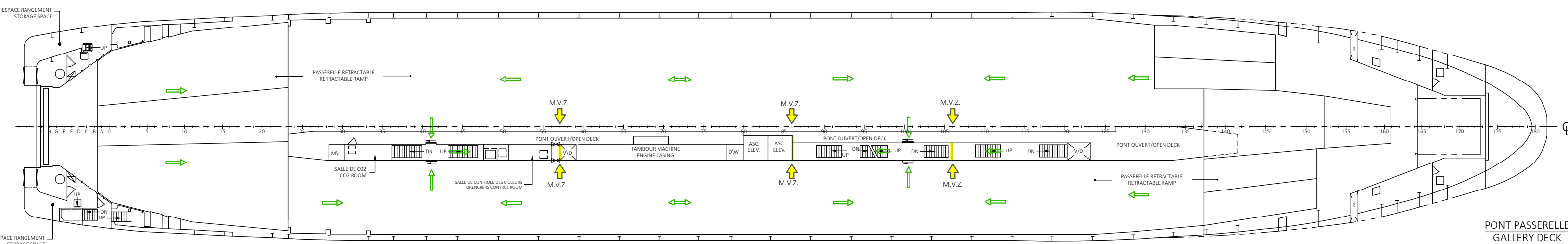
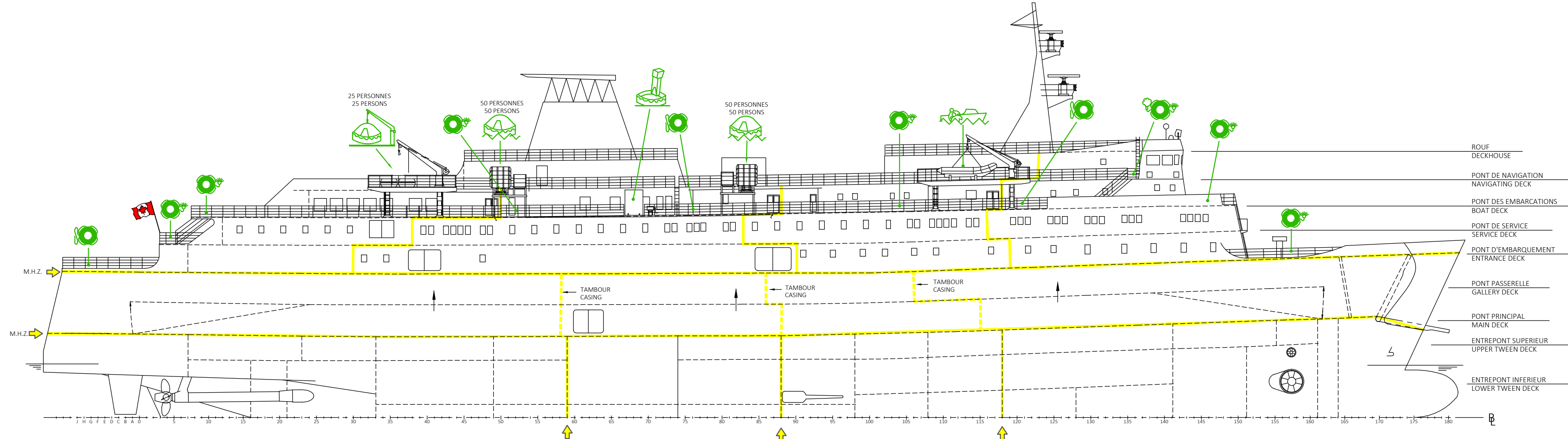

LÉGENDE-LEGEND		
	CANOT DE SECOURS RESCUE BOAT	
	RADEAU DE SAUVETAGE LARGEABLE THROW-OVERBOARD LIFE RAFT	
	RADEAU DE SAUVETAGE SOUS BOSSOIR DAVIT-LAUNCHED LIFE RAFT	
	CHUTE D'EVACUATION EVACUATION CHUTE	
	BOUEE DE SAUVETAGE LIFEBUOY	
	BOUEE DE SAUVETAGE AVEC LIGNE LIFEBUOY WITH LINE	
	BOUEE DE SAUVETAGE AVEC APPAREIL LUMINEUX LIFEBUOY WITH LIGHT	
	BOUEE DE SAUVETAGE AVEC APPAREIL LUMINEUX & FUMIGENE LIFEBUOY WITH LIGHT AND SMOKE	
	GILET DE SAUVETAGE POUR ADULTE ADULT LIFEJACKET	
	GILET DE SAUVETAGE POUR ENFANT CHILD LIFEJACKET	
	COMBINAISON D'IMMERSION IMMERSION SUIT	
	EMETTEUR-RECEPTEUR RADIO TELEPHONIQUE POUR EMBARCATION DE SAUVETAGE SURVIVAL CRAFT PORTABLE RADIO	
	RADIOBALISE DE LOCALISATION DES SINISTRES CLASS I CLASS I EPIRB B	
	TRANSPONDEUR RADAR RADAR TRANSPONDER	
	FUSEE A PARACHUTE ROCKET PARACHUTE FLARE	
	APPAREIL LANCÉ-AVAREE LINE-THROWING APPLIANCE	
	POSTE DE RASSEMBLEMENT MUSTER STATION	
	POSTE D'EMBARQUEMENT (RADEAU DE SAUVETAGE) EMBARCATION STATION (LIFE RAFT)	
	PLAN DE L'EQUIPEMENT DE SAUVETAGE ET D'EVACUATION LIFE SAVING EQUIPMENT AND EVACUATION PLAN	
	MOYEN D'EVACUATION PRINCIPAL PRIMARY MEANS OF ESCAPE	
	MOYEN D'EVACUATION SECONDAIRE SECONDARY MEANS OF ESCAPE	
	DIRECTION PRINCIPLE VERS POSTE DE RASSEMBLEMENT PRIMARY DIRECTION TO MUSTER STATION	
	DIRECTION SECONDAIRE VERS POSTE DE RASSEMBLEMENT SECONDARY DIRECTION TO MUSTER STATION	
	TRANCHE VERTICALE PRINCIPLE MAIN VERTICAL ZONE	
	TRANCHE HORIZONTALE PRINCIPLE MAIN HORIZONTAL ZONE	
ABREVIATIONS-ABBREVIATIONS		
ASC./ELEV.	ASCENSEUR-ELEVATOR	
C/P	CUISINETTE-PANTRY	
D/W	CHUTE A DECHET-WASTE TRUNK	
E/L	ARMOIRE ELECTRIQUE-ELECTRIC LOCKER	
M/L	MONTE-CHARGE-LIFT	
R/L	RANGEMENT-LOCKER	
TK	RESERVOIR TANK	
V/D	CONDUIT DE VENTILATION-VENTILATION DUCT	
WTB	CLOISON ETANCHE-WATERTIGHT BULKHEAD	
UP	VERS LE HAUT-GOING UP	
DN	VERS LE BAS-GOING DOWN	
SOMMAIRE - SUMMARY		
AIRES DES POSTES DE RASSEMBLEMENT MUSTER STATION AREAS		
INTERIEUR - INSIDE		
	CAFETERIA	237 m ²
	BAR SALON LOUNGE BAR	227 m ²
EXTERIEUR - OUTSIDE		
	1 AVANT TRIBORD FORWARD STARBOARD	50 m ²
	2 AVANT BARBORD FORWARD PORT	50 m ²
	3 ARRIERE TRIBORD AFT STARBOARD	50 m ²
	4 ARRIERE BARBORD AFT PORT	50 m ²
	5 ARRIERE CENTRE AFT CENTRE	50 m ²
AIRES DES POSTES D'EMBARQUEMENT EMBARCATION STATION AREAS		
	1 CENTRE TRIBORD CENTRE STARBOARD	4.0 m ²
	2 CENTRE BARBORD CENTRE PORT	4.0 m ²
	3 ARRIERE TRIBORD AFT STARBOARD	2.5 m ²
	4 ARRIERE BARBORD AFT PORT	2.5 m ²
REFERENCE(S)		
NO. DESIN/ DRAWING NO.	TITRE/TITLE	PAR/BY DATE
0704-01 SHEET 1 of 1 REV. 1	M.V. "MADELEINE" LIFE SAVING APPLIANCES PLAN	Longhew Vessel Engineering 22 JUNE 1997
266-010-01	FIRE PROTECTION PLAN	MARINE DESIGN GOTHENBURG 6-8-1998