

RETURN BIDS TO:**RETOURNER LES SOUMISSIONS A:**

See Section 1.
Voir Section 1.

STANDARD REQUEST FOR BID**INVITATION A SOUMISSIONNER - STANDARD**

The Bidder offers to provide to Canada the goods, services or both listed in the bid solicitation in accordance with the conditions set out in the bid solicitation and the prices set out in the bid.

This bid solicitation is issued in accordance with the conditions of the Supply Arrangement E60PQ-140003/.../PQ.

Le soumissionnaire offre de fournir au Canada les biens, services ou les deux énumérés dans la demande de soumissions aux conditions prévues dans la demande de soumissions et aux prix indiqués dans la soumission.

Cette demande de soumissions est émise conformément aux conditions de l'arrangement en matière d'approvisionnement E60PQ-140003/PQ

Solicitation No. - N° de la demande	Amendment No. - N° de modification
IC186570	

Solicitation closes – La demande prend fin :	File No. - N° de dossier
at – à See Section 1 Voir Section 1	
on – le See Section 1 Voir Section 1	

Date of Solicitation – Date de la demande

October 17, 2017

Address inquiries to – Adresser toute demande de renseignement à :

See Section 2, Article 4.1.**Voir Section 2, Article 4.1**

Destination

See Section 2, Annex A.**Voir Section 2, Annexe A.****Instructions:****Municipal taxes are not applicable.**

Unless otherwise specified in the bid solicitation, all prices quoted must be net prices in Canadian funds including Canadian customs duties, excise taxes, must be FOB, including all delivery charges to destination(s) as indicated. The amount for Applicable Taxes is to be shown as a separate item.

Instructions:**Les taxes municipales ne s'appliquent pas.**

Sauf indication contraire dans la demande de soumissions, tous les prix indiqués doivent être des prix nets, en dollars canadiens, comprenant les droits de douane canadiens, la taxe d'accise et doivent être FAB, y compris tous frais de livraison à la (aux) destination(s) indiqué(s). Le montant des taxes applicables doit apparaître séparément.

Supplier Name and Address – Nom et adresse du fournisseur**Telephone No. - N° de téléphone****Facsimile No. - N° de télécopieur****Name and title of person authorized to sign on behalf of supplier (type or print)****Nom et titre de la personne autorisée à signer au nom du fournisseur (caractère d'impression)**

Signature : _____ Date : _____

Annex E - Standard RFB

TABLE OF CONTENTS

Section 1 – Invitation and Instructions to Bidders

Section 2 – Resulting Contract including a list of required goods and services

SECTION 1 – INVITATION AND INSTRUCTIONS TO BIDDERS

Step 1. For Tier 2 and Tier 3 only (If Tier 1, skip this step and proceed with step 2)

Is this a Manufacturer Product Specific Procurement? If yes, the IU must complete and submit the Manufacturer Product Specific form to AB. If form approved, keep copy on file and proceed with the step 2.

Step 2. Competitive or Non-Competitive

For Competitive Requirements:

The Bidder must provide the following information AFTER bid closing, if requested to do so by Canada:

- One or more of the following price justifications:
 1. a current published price list indicating the percentage discount available to Canada; or
 2. a copy of paid invoices for the like quality and quantity of the goods, services or both sold to other customers; or
 3. a price breakdown showing the cost of direct labour, direct materials, purchased items, engineering and plant overheads, general and administrative overhead, transportation, etc., and profit; or
 4. any other supporting documentation as requested by Canada.

Step 3. General or PSAB

Terms of the RFB:

This RFB is issued pursuant to the Supplier's Furniture for Workspaces Supply Arrangement (SA) that forms part of the series of SAs issued by PWGSC with the number E60PQ-140003/PQ. The terms and conditions in the Supplier's SA apply to and form part of this RFB. Bidders who submit a bid agree to be bound by those terms and conditions as well as the terms and conditions in this RFB.

The Bidder must provide the following information **WITH** the bid:

- The information requested by Canada in Annex A herein.

RFB Issued by:	
Identified User's (IU) Department/Agency/Crown Corporation: Contact for this RFB:	See Section 2, article 4.1 below.
RFB Closing - Submit Bid: Bids must be submitted to the Contracting Authority on the date and at the time indicated below.	
By no later than date and time:	a. October 26, 2017 b. 2:00 PM
- To e-mail address	Jordan.Kearns@Canada.ca
RFB Enquiries	
Unless a different period is listed in the adjacent column, Bidders may submit enquires about the RFB to the Contracting Authority two business days prior to the RFB closing date. Enquiries received after the timeline indicated may not be answered.	<u>3 business days</u>

SECTION 2 - RESULTING CONTRACT CLAUSES

1.	Terms and Conditions of the Contract	
	The terms and conditions of Parts 6A and 6C of the Supplier's SA within the series E60PQ-140003/PQ apply to and form part of this Contract.	
2.	Security Requirement (Applies if article a. or b. is checked)	
2.1	The applicable security requirement(s) is (are) set out in the Security Requirement Check List attached as Annex B of this contract. The Contractor must fulfill the security requirements by meeting the terms below (the checked article applies).	
a.	<input checked="" type="checkbox"/>	Contractor may be escorted; possession of security clearance not required. Contractor personnel MAY NOT ENTER NOR PERFORM WORK ON sites where PROTECTED or CLASSIFIED information or assets are kept, without an escort provided by the department or agency for which the work is being performed.
b.	<input type="checkbox"/>	Possession of security clearance(s) is required. The Contractor must meet the security clearance requirements contained in the clausing in Annex B herein.
c.	<input type="checkbox"/>	There is no security requirement associated with this contract.
3.	Requirement	
3.1	The Contractor must perform the Work listed in Annex A herein.	
4.	Authorities	
4.1	Contracting Authority	
	Name:	Jordan Kearns
	Title:	Manager, Procurement and Asset Management
	Department/Agency/Crown Corporation:	Innovation, Science and Economic Development Canada
	Address:	235 Queen street, Ottawa ON K1A 0H5
	Telephone No.:	343-291-1268
	E-mail address:	Jordan.Kearns@Canada.ca
4.2	Project Authority [To be left blank for RFB. IU to complete only when awarding contract]	
	Name:	
	Title:	
	Department/Agency/Crown Corporation:	
	Address:	
	Telephone No.:	
	Facsimile No.:	
	E-mail address:	

4.3	Contractor's Representative
	As set out in Annex A, Table 10 below.
5.	Payment
	Method of Payment
	The checked box applies. If the Contractor's SA indicates acceptance for payment by credit card, that method may be used in conjunction with the following.
	<input type="checkbox"/> Single Payment
	<input checked="" type="checkbox"/> Multiple Payment
6.	Invoicing
	Further to the Invoicing terms of the WTCM document, the Contractor will deliver the original and one copy of the invoice to the following address for certification and payment:
	Name of the organization and contact:
	Address: Innovation, Science and Economic Development (ISED) BOPP Accounts Payable/Receivables 235 Queen Street, 238B Ottawa, ON K1A 0H5 Attn: Rock Gagnon
7.	Defence Contract. This clause applies if the box below is checked.
	<input type="checkbox"/> The Contract is a defence contract within the meaning of the Defence Production Act , R.S.C. 1985, c. D-1.

ANNEX A REQUIREMENT and BASIS OF PAYMENT

1. Category Selection

The requirement includes the following category (ies) of work

a. **Category 1 – Interconnecting Panels and Freestanding Systems**

RULE: Metal Storage

Identified Users may procure metal storage products forming part of Category 1 when combined with interconnecting panels and/or freestanding systems and if the total sum of metal storage products represents less than 20% of the requirement. If this rule does not apply to the requirement, Category 3 must be used for the metal storage products forming part of this category.

Category 1 Non-SA (NSA) products forming part of this requirement, refer to Annex D of this RFB (approval by AB required before adding to requirement)

b. **Category 2 – Freestanding Height Adjustable Desk / Table Products**

RULE: Category 1 and 2

Category 1 and 2 can be combined for tier 2 and tier 3 requirements when Category 2 surfaces comprise no more than 50% of the total sum of work surfaces.

Category 2 Non-SA (NSA) products forming part of this requirement, refer to Annex D of this RFB (approval by AB required before adding to requirement)

c. **Category 3 – Metal Filing and Storage Cabinets**

RULE: High Storage Products

Identifying the maximum height of the Personal Storage Towers, Wardrobes and Storage Cabinets is acceptable when the requirement is to match existing panel systems heights forming part of an existing inventory. Additional storage forming part of the same requirement not incorporated into an existing panel system workstation must not specify maximum heights and added as a separate line item at article 3 of this Annex.

Maximum Height for product #(s) ____ at article 3 of this Annex is ____.

Category 3 Non-SA (NSA) products forming part of this requirement, refer to Annex D of this RFB (approval by AB required before adding to requirement)

d. **Category 4 – Wood Veneer – Freestanding Products**

Category 4 Non-SA (NSA) products forming part of this requirement, refer to Annex D of this RFB (approval by AB required before adding to requirement)

e. **Category 5 – Ancillary and Lighting Products**

Category 5 Non-SA (NSA) products forming part of this requirement, refer to Annex D of this RFB (approval by AB required before adding to requirement)

f. **Category 6 - Support Space – Collaborative Furniture**

RULE 1: Category 6 can be further subdivided by space or like item in order to increase or allow competition. Space is defined as a location available for a particular purpose such as a meeting room space or a collaborative space. Like items are defined as products with similar design and construction.

RULE 2: Clients may exercise an option to upgrade products up to 15% of the Category 6 product total before applicable taxes after contract award for Category 6 products.

The Design Upgrade amount is used at the discretion of the Project Authority (PA). Within ten business days of the contract award, the PA will provide the Contractor with a written notice of Canada's Design Upgrade choices for each of the product(s) to be upgraded in Category 6, Annex A. The Contractor will provide the pricing of the upgraded product(s) to a maximum of 15% of Category 6 Product Total of Table 9 at Article 1. The Contracting Authority will issue an amendment to the contract with the Design Upgrades and pricing.

The Supplier certifies that all the Design Upgraded products offered will conform to all specifications and meet the testing requirements detailed in the Specifications of the Supply Arrangement.

Design Upgrade: is the process of replacing a product with a more innovative or enhanced version of the same product/series.

Category 6 Non-SA (NSA) products forming part of this requirement, refer to Annex D of this RFB (approval by AB required before adding to requirement)

g. Product Related Services

2. GoCUID identification and/or floor plan(s)

2.1 For Product Related Services requirements

2.2 For Categories 1-6:

Scenario a. does not include a floor plan – Category 5

Scenario b. Includes floor plan(s) WITH identification of product information in Annex C of this RFB. Categories

1 & 2

Floor plan(s) are used for information purposes

Refer to Annex A article 4 of the SA for Site inspection and Documentation instructions after contract award.

Site Inspection Date: _____ *(to be completed by IU at contract award)*

3. Product and Pricing Tables

Bidder to complete: Sections B of the tables identified by the IU in article 3 of this Annex as well as Tables 9 and 10. In a resulting contract, the term "Bid" means the Supplier's commitment, the term "Bidder" means "Contractor".

Product Category: 1 and 2

Table 1 – Product

Scenario B: Refer to Annex C for floor plan.

Table 2 - Delivery

Section A - IU REQUIREMENT				Section B – SUPPLIER'S BID		
Product Item # from Table 1	Location	Desired Date (Y/M/D)	Desired Time: Normal Business Hours (Normal) Or Outside Normal Business Hours (Outside)*	Supplier will deliver on the date and at the time below*	Firm Price \$	Extended Total (Qty x Firm Unit Price) \$
1	235 Queen ST, Ottawa. Ontario. Third floor, West Tower	2018-01-16	Normal	(Y) (M) (D)		
*If no dates and times are added by the Supplier, the Supplier agrees to deliver on the Desired Date and Time. [Normal Business Hours 8:00 – 17:00, as per SA, Annex A, article 5] Add more rows if necessary.				Delivery Total:		\$

Table 3 – Installation

Section A - IU REQUIREMENT				Section B – SUPPLIER'S BID		
Product Item # from Table 1	Location	Desired Date (Y/M/D)	Desired Time: Normal Business Hours (Normal) Or Outside Normal Business Hours (Outside)*	Supplier will install on the date and at the time below*	Firm Price \$	Extended Total (Qty x Firm Unit Price) \$
1	235 Queen ST, Ottawa. Ontario. Third floor, West Tower	2018-01-16	Normal & Outside	(Y) (M) (D)		
*If no dates and times are added by the Supplier, the Supplier agrees to install on the Desired Date and Time. [Normal Business Hours 8:00 – 17:00, as per SA, Annex A, article 5] Add more rows if necessary.				Installation Total:		\$

Table 8 – Standard Finishes and Canada's Facilities to Accommodate the Delivery and Certifications

1.	Standard Finishes	
1.1	IU is to consult the Supplier's Website identified in Part 6A of the SA to view the available finishes. Within ten business days of the contract award, the Contracting Authority will provide the Contractor with a written notice of Canada's finish choices for each of the product(s) in Annex A. The Contractor will deliver the products corresponding to Canada's choice of specific finishes(s). No additional charge will be applied to Canada.	
2.	Canada's Facilities to Accommodate the Delivery	
2.1	Loading Dock/Location	
A	Location	235 Queen Street
B	Dock	Yes (240 Sparks Street)
C	Lift	Ramp
D	Door	78"H x 38"W
2.2	Freight Elevator	Available
2.3	Other (specify, if any)	
	Continuance of Certifications	
	The Bidder certifies that by submitting a bid in response to the RFB, the Bidder, and any of the Bidder's members if the Bidder is a Joint Venture, continues to comply with all of the certifications listed in Parts 6A and 6B of the Bidder's SA for Work Spaces, as follows:	
3.1	Integrity Provisions	
3.2	Federal Contractor's Program for Employment Equity	
3.4	Product Conformance	
3.5	Price Certification (In accordance with the SA, Part 6B)	

Table 9 - Bid Evaluation and Contract Total (Canada may complete if not completed by the Bidder)

1	Product Total (Table 1) or Annex C Total	\$
2	Optional Product Total (Table 4)	\$
3	Delivery Total (Table 2)	\$
4	Optional Delivery Total (Table 5)	\$
5	Installation Total (Table 3)	\$
6	Optional Installation Total (Table 6)	\$
7	Product Related Services Total (if applicable) (Table 7)	\$
8	NSA Total (if applicable) refer to Annex D	\$
9	Hardware Total as per article 1.5 of Annex A-1 of SA (if applicable)	\$
10	Total Evaluated (Bid) Price* (1 + 2 + 3 + 4 + 5 + 6+ 7+8+9):	\$\$
11	Applicable Tax(es):	\$
12	Total Estimated Cost (10+11):	\$

Table 10 – Bidder's Authorized Representative

Table 6 – Bidder's Authorized Representative		
1.	Bidder's Authorized Representative for the Bid and the Contract	
	Name:	Telephone:
		E-Mail:
		Other:

*At contract award, "Total Evaluated (Bid) Price" becomes "Contract Price".

Product Category: 5

Table 1 – Product (Only applicable for Scenario A procurements)

Section A - IU REQUIREMENT				Section B – SUPPLIER'S BID		
#	GoCUID	Description of Product (optional field)	Qty	Supplier Part Number	Firm Price** \$	Extended Total [Qty x Price] \$
1	MASRM Line 20	Single Monitor, Panel Rail mount*	36			
2	MASME Line 19	Single Monitor, Edge clamp mount	30			
				Product Total		\$
**Must not exceed ceiling unit price in SA.						
NOTE:*Panel Rail mount to be compatible with furniture system.						

Table 2 - Delivery

Section A - IU REQUIREMENT				Section B – SUPPLIER'S BID		
Product Item # from Table 1	Location	Desired Date (Y/M/D)	Desired Time: Normal Business Hours (Normal) Or Outside Normal Business Hours (Outside)*	Supplier will deliver on the date and at the time below*	Firm Price \$	Extended Total (Qty x Firm Unit Price) \$
1	235 Queen street, Ottawa, Ontario	2018-01-16	Normal	(Y) (M) (D)		
*If no dates and times are added by the Supplier, the Supplier agrees to deliver on the Desired Date and Time. [Normal Business Hours 8:00 – 17:00, as per SA, Annex A, article 5] Add more rows if necessary.				Delivery Total:		\$

Table 3 – Installation

Section A - IU REQUIREMENT				Section B – SUPPLIER'S BID		
Product Item #	Location	Desired Date	Desired Time:	Supplier will install on the	Firm	Extended Total

from Table 1		(Y/M/D)	Normal Business Hours (Normal) Or Outside Normal Business Hours (Outside)*	date and at the time below*	Price \$	(Qty x Firm Unit Price) \$
1	235 Queen street, Ottawa, Ontario	2018-01-16	Normal	(Y) (M) (D)		
*If no dates and times are added by the Supplier, the Supplier agrees to install on the Desired Date and Time. [Normal Business Hours 8:00 – 17:00, as per SA, Annex A, article 5] Add more rows if necessary.				Installation Total:		\$

Table 8 – Standard Finishes and Canada’s Facilities to Accommodate the Delivery and Certifications

1.	Standard Finishes	
1.1	<p>IU is to consult the Supplier’s Website identified in Part 6A of the SA to view the available finishes.</p> <p>Within ten business days of the contract award, the Contracting Authority will provide the Contractor with a written notice of Canada’s finish choices for each of the product(s) in Annex A.</p> <p>The Contractor will deliver the products corresponding to Canada’s choice of specific finishes(s). No additional charge will be applied to Canada.</p>	
2.	Canada’s Facilities to Accommodate the Delivery	
2.1	Loading Dock/Location	
A	Location	235 Queen Street
B	Dock	Yes (240 Sparks Street)
C	Lift	Ramp
D	Door	78”H x 38”W
2.2	Freight Elevator	Available
2.3	Other (specify, if any)	
	Continuance of Certifications	
	<p>The Bidder certifies that by submitting a bid in response to the RFB, the Bidder, and any of the Bidder’s members if the Bidder is a Joint Venture, continues to comply with all of the certifications listed in Parts 6A and 6B of the Bidder’s SA for Work Spaces, as follows:</p>	
3.1	Integrity Provisions	
3.2	Federal Contractor’s Program for Employment Equity	
3.4	Product Conformance	
3.5	Price Certification (In accordance with the SA, Part 6B)	

Table 9 - Bid Evaluation and Contract Total (Canada may complete if not completed by the Bidder)

1	Product Total (Table 1) or Annex C Total	\$
2	Optional Product Total (Table 4)	\$
3	Delivery Total (Table 2)	\$
4	Optional Delivery Total (Table 5)	\$
5	Installation Total (Table 3)	\$
6	Optional Installation Total (Table 6)	\$
7	Product Related Services Total (if applicable) (Table 7)	\$
8	NSA Total (if applicable) refer to Annex D	\$
9	Hardware Total as per article 1.5 of Annex A-1 of SA (if applicable)	\$
10	Total Evaluated (Bid) Price* (1 + 2 + 3 + 4 + 5 + 6+ 7+8+9):	\$\$
11	Applicable Tax(es):	\$
12	Total Estimated Cost (10+11):	\$

Table 10 – Bidder’s Authorized Representative

Table 6 – Bidder’s Authorized Representative		
1.	Bidder’s Authorized Representative for the Bid and the Contract	
	Name:	Telephone:
		E-Mail:
		Other:

*At contract award, “Total Evaluated (Bid) Price” becomes “Contract Price”.

**ANNEX B
SECURITY REQUIREMENTS**

A. The security requirements set out in the attached Security Requirements Check List (SRCL) apply to and form part of the Contract.



Government of Canada / Gouvernement du Canada

Contract Number / Numéro du contrat
Security Classification / Classification de sécurité

**SECURITY REQUIREMENTS CHECK LIST (SRCL)
LISTE DE VÉRIFICATION DES EXIGENCES RELATIVES À LA SÉCURITÉ (LVERS)**

PART A - CONTRACT INFORMATION / PARTIE A - INFORMATION CONTRACTUELLE		
1. Originating Government Department or Organization / Ministère ou organisme gouvernemental d'origine ISED	2. Branch or Directorate / Direction générale ou Direction EM/CIO	
3. a) Subcontract Number / Numéro du contrat de sous-traitance	3. b) Name and Address of Subcontractor / Nom et adresse du sous-traitant	
4. Brief Description of Work / Brève description du travail DELIVERY & INSTALLATION OF FURNITURE WORKSTATIONS AT C.D HOWE, 3 WEST. (THIRD FLOOR/WEST TOWER).		
5. a) Will the supplier require access to Controlled Goods? Le fournisseur aura-t-il accès à des marchandises contrôlées?	<input checked="" type="checkbox"/> No / Non <input type="checkbox"/> Yes / Oui	
5. b) Will the supplier require access to unclassified military technical data subject to the provisions of the Technical Data Control Regulations? Le fournisseur aura-t-il accès à des données techniques militaires non classifiées qui sont assujetties aux dispositions du Règlement sur le contrôle des données techniques?	<input checked="" type="checkbox"/> No / Non <input type="checkbox"/> Yes / Oui	
6. Indicate the type of access required / Indiquer le type d'accès requis		
6. a) Will the supplier and its employees require access to PROTECTED and/or CLASSIFIED information or assets? Le fournisseur ainsi que les employés auront-ils accès à des renseignements ou à des biens PROTÉGÉS et/ou CLASSIFIÉS? (Specify the level of access using the chart in Question 7. c) (Préciser le niveau d'accès en utilisant le tableau qui se trouve à la question 7. c)	<input checked="" type="checkbox"/> No / Non <input type="checkbox"/> Yes / Oui	
6. b) Will the supplier and its employees (e.g. cleaners, maintenance personnel) require access to restricted access areas? No access to PROTECTED and/or CLASSIFIED information or assets is permitted. Le fournisseur et ses employés (p. ex. nettoyeurs, personnel d'entretien) auront-ils accès à des zones d'accès restreintes? L'accès à des renseignements ou à des biens PROTÉGÉS et/ou CLASSIFIÉS n'est pas autorisé.	<input type="checkbox"/> No / Non <input checked="" type="checkbox"/> Yes / Oui	
6. c) Is this a commercial courier or delivery requirement with no overnight storage? S'agit-il d'un contrat de messagerie ou de livraison commerciale sans entreposage de nuit?	<input checked="" type="checkbox"/> No / Non <input type="checkbox"/> Yes / Oui	
7. a) Indicate the type of information that the supplier will be required to access / Indiquer le type d'information auquel le fournisseur devra avoir accès		
Canada <input type="checkbox"/>	NATO / OTAN <input type="checkbox"/>	
Foreign / Étranger <input type="checkbox"/>		
7. b) Release restrictions / Restrictions relatives à la diffusion		
No release restrictions / Aucune restriction relative à la diffusion <input type="checkbox"/>	All NATO countries / Tous les pays de l'OTAN <input type="checkbox"/>	
Not releasable / À ne pas diffuser <input type="checkbox"/>		
Restricted to: / Limité à: <input type="checkbox"/>	Restricted to: / Limité à: <input type="checkbox"/>	
Specify country(ies): / Préciser le(s) pays:	Specify country(ies): / Préciser le(s) pays:	
7. c) Level of information / Niveau d'information		
PROTECTED A / PROTÉGÉ A <input type="checkbox"/>	NATO UNCLASSIFIED / NATO NON CLASSIFIÉ <input type="checkbox"/>	PROTECTED A / PROTÉGÉ A <input type="checkbox"/>
PROTECTED B / PROTÉGÉ B <input type="checkbox"/>	NATO RESTRICTED / NATO DIFFUSION RESTREINTE <input type="checkbox"/>	PROTECTED B / PROTÉGÉ B <input type="checkbox"/>
PROTECTED C / PROTÉGÉ C <input type="checkbox"/>	NATO CONFIDENTIAL / NATO CONFIDENTIEL <input type="checkbox"/>	PROTECTED C / PROTÉGÉ C <input type="checkbox"/>
CONFIDENTIAL / CONFIDENTIEL <input type="checkbox"/>	NATO SECRET / NATO SECRET <input type="checkbox"/>	CONFIDENTIAL / CONFIDENTIEL <input type="checkbox"/>
SECRET / SECRET <input type="checkbox"/>	COSMIC TOP SECRET / COSMIC TRÈS SECRET <input type="checkbox"/>	SECRET / SECRET <input type="checkbox"/>
TOP SECRET / TRÈS SECRET <input type="checkbox"/>		TOP SECRET / TRÈS SECRET <input type="checkbox"/>
TOP SECRET (SIGINT) / TRÈS SECRET (SIGINT) <input type="checkbox"/>		TOP SECRET (SIGINT) / TRÈS SECRET (SIGINT) <input type="checkbox"/>

TBS/SCT 350-103(2004/12)

Security Classification / Classification de sécurité



Government of Canada
Gouvernement du Canada

Contract Number / Numéro du contrat

Security Classification / Classification de sécurité

PART A (continued) / PARTIE A (suite)	
8. Will the supplier require access to PROTECTED and/or CLASSIFIED COMSEC information or assets? Le fournisseur aura-t-il accès à des renseignements ou à des biens COMSEC désignés PROTÉGÉS et/ou CLASSIFIÉS? If Yes, indicate the level of sensitivity: Dans l'affirmative, indiquer le niveau de sensibilité :	<input checked="" type="checkbox"/> No / Non <input type="checkbox"/> Yes / Oui
9. Will the supplier require access to extremely sensitive INFOSEC information or assets? Le fournisseur aura-t-il accès à des renseignements ou à des biens INFOSEC de nature extrêmement délicate? Short Title(s) of material / Titre(s) abrégé(s) du matériel : Document Number / Numéro du document :	<input checked="" type="checkbox"/> No / Non <input type="checkbox"/> Yes / Oui
PART B - PERSONNEL (SUPPLIER) / PARTIE B - PERSONNEL (FOURNISSEUR)	
10. a) Personnel security screening level required / Niveau de contrôle de la sécurité du personnel requis	
<input checked="" type="checkbox"/> RELIABILITY STATUS COTE DE FIABILITÉ	<input type="checkbox"/> CONFIDENTIAL CONFIDENTIEL
<input type="checkbox"/> TOP SECRET - SIGINT TRÈS SECRET - SIGINT	<input type="checkbox"/> NATO CONFIDENTIAL NATO CONFIDENTIEL
<input type="checkbox"/> SITE ACCESS ACCÈS AUX EMPLACEMENTS	<input type="checkbox"/> SECRET SECRET
	<input type="checkbox"/> NATO SECRET NATO SECRET
	<input type="checkbox"/> TOP SECRET TRÈS SECRET
	<input type="checkbox"/> COSMIC TOP SECRET COSMIC TRÈS SECRET
Special comments: Commentaires spéciaux : _____	
NOTE: If multiple levels of screening are identified, a Security Classification Guide must be provided. REMARQUE : Si plusieurs niveaux de contrôle de sécurité sont requis, un guide de classification de la sécurité doit être fourni.	
10. b) May unscreened personnel be used for portions of the work? Du personnel sans autorisation sécuritaire peut-il se voir confier des parties du travail? If Yes, will unscreened personnel be escorted? Dans l'affirmative, le personnel en question sera-t-il escorté?	<input type="checkbox"/> No / Non <input checked="" type="checkbox"/> Yes / Oui <input type="checkbox"/> No / Non <input checked="" type="checkbox"/> Yes / Oui
PART C - SAFEGUARDS (SUPPLIER) / PARTIE C - MESURES DE PROTECTION (FOURNISSEUR)	
INFORMATION / ASSETS / RENSEIGNEMENTS / BIENS	
11. a) Will the supplier be required to receive and store PROTECTED and/or CLASSIFIED information or assets on its site or premises? Le fournisseur sera-t-il tenu de recevoir et d'entreposer sur place des renseignements ou des biens PROTÉGÉS et/ou CLASSIFIÉS?	<input checked="" type="checkbox"/> No / Non <input type="checkbox"/> Yes / Oui
11. b) Will the supplier be required to safeguard COMSEC information or assets? Le fournisseur sera-t-il tenu de protéger des renseignements ou des biens COMSEC?	<input checked="" type="checkbox"/> No / Non <input type="checkbox"/> Yes / Oui
PRODUCTION	
11. c) Will the production (manufacture, and/or repair and/or modification) of PROTECTED and/or CLASSIFIED material or equipment occur at the supplier's site or premises? Les installations du fournisseur serviront-elles à la production (fabrication et/ou réparation et/ou modification) de matériel PROTÉGÉ et/ou CLASSIFIÉ?	<input checked="" type="checkbox"/> No / Non <input type="checkbox"/> Yes / Oui
INFORMATION TECHNOLOGY (IT) MEDIA / SUPPORT RELATIF À LA TECHNOLOGIE DE L'INFORMATION (TI)	
11. d) Will the supplier be required to use its IT systems to electronically process, produce or store PROTECTED and/or CLASSIFIED information or data? Le fournisseur sera-t-il tenu d'utiliser ses propres systèmes informatiques pour traiter, produire ou stocker électroniquement des renseignements ou des données PROTÉGÉS et/ou CLASSIFIÉS?	<input checked="" type="checkbox"/> No / Non <input type="checkbox"/> Yes / Oui
11. e) Will there be an electronic link between the supplier's IT systems and the government department or agency? Disposera-t-on d'un lien électronique entre le système informatique du fournisseur et celui du ministère ou de l'agence gouvernementale?	<input checked="" type="checkbox"/> No / Non <input type="checkbox"/> Yes / Oui

TBS/ECT 350-103(2004/H2)

Security Classification / Classification de sécurité

Canada



Contract Number / Numéro du contrat
Security Classification / Classification de sécurité

PART C - (continued) / PARTIE C - (suite)

For users completing the form **manually** use the summary chart below to indicate the category(ies) and level(s) of safeguarding required at the supplier's site(s) or premises.
 Les utilisateurs qui remplissent le formulaire **manuellement** doivent utiliser le tableau récapitulatif ci-dessous pour indiquer, pour chaque catégorie, les niveaux de sauvegarde requis aux installations du fournisseur.

For users completing the form **online** (via the Internet), the summary chart is automatically populated by your responses to previous questions.
 Dans le cas des utilisateurs qui remplissent le formulaire **en ligne** (par Internet), les réponses aux questions précédentes sont automatiquement saisies dans le tableau récapitulatif.

SUMMARY CHART / TABLEAU RÉCAPITULATIF

Category Catégorie	PROTECTED PROTÉGÉ			CLASSIFIED CLASSIFIÉ			NATO				COMSEC					
	A	B	C	CONFIDENTIAL CONFIDENTIEL	SECRET	TOP SECRET TRÈS SECRET	NATO RESTRICTED NATO DIFFUSION RESTREINTE	NATO CONFIDENTIAL NATO CONFIDENTIEL	NATO SECRET	COSMIC TOP SECRET COSMIC TRÈS SECRET	PROTECTED PROTÉGÉ			CONFIDENTIAL	SECRET	TOP SECRET TRÈS SECRET
											A	B	C			
Information / Assets Renseignements / Biens																
Production																
IT Media / Support TI																
IT Link / Lien électronique																

12. a) Is the description of the work contained within this SRCL PROTECTED and/or CLASSIFIED?
 La description du travail visé par la présente LVERS est-elle de nature PROTÉGÉE et/ou CLASSIFIÉE? No / Non Yes / Oui

If Yes, classify this form by annotating the top and bottom in the area entitled "Security Classification".
 Dans l'affirmative, classifiez le présent formulaire en indiquant le niveau de sécurité dans la case intitulée « Classification de sécurité » au haut et au bas du formulaire.

12. b) Will the documentation attached to this SRCL be PROTECTED and/or CLASSIFIED?
 La documentation associée à la présente LVERS sera-t-elle PROTÉGÉE et/ou CLASSIFIÉE? No / Non Yes / Oui

If Yes, classify this form by annotating the top and bottom in the area entitled "Security Classification" and indicate with attachments (e.g. SECRET with Attachments).
 Dans l'affirmative, classifiez le présent formulaire en indiquant le niveau de sécurité dans la case intitulée « Classification de sécurité » au haut et au bas du formulaire et indiquez qu'il y a des pièces jointes (p. ex. SECRET avec des pièces jointes).



Government of Canada
Gouvernement du Canada

Contract Number / Numéro du contrat

Security Classification / Classification de sécurité

PART D - AUTHORIZATION / PARTIE D - AUTORISATION

13. Organization Project Authority / Chargé de projet de l'organisme

Name (print) - Nom (en lettres moulées) Geneviève Gaiwin		Title - Titre planning & coordinator officer	Signature <i>Geneviève Gaiwin</i>
Telephone No. - N° de téléphone 613-866-3367	Facsimile No. - N° de télécopieur	E-mail address - Adresse courriel genevieve.gaiwin@canada.ca	Date 15 septembre 2017

14. Organization Security Authority / Responsable de la sécurité de l'organisme

Name (print) - Nom (en lettres moulées) Pierre Laurendeau-Fitzpatrick		Title - Titre security in contracting officer	Signature <i>Pierre L.F.</i>
Telephone No. - N° de téléphone 343-241-2749	Facsimile No. - N° de télécopieur	E-mail address - Adresse courriel Pierre.Laurendeau-Fitzpatrick@canada.ca	Date 15/09/2017

15. Are there additional instructions (e.g. Security Guide, Security Classification Guide) attached?
Des instructions supplémentaires (p. ex. Guide de sécurité, Guide de classification de la sécurité) sont-elles jointes?

No / Non Yes / Oui

16. Procurement Officer / Agent d'approvisionnement

Name (print) - Nom (en lettres moulées)		Title - Titre	Signature
Telephone No. - N° de téléphone	Facsimile No. - N° de télécopieur	E-mail address - Adresse courriel	Date

17. Contracting Security Authority / Autorité contractante en matière de sécurité

Name (print) - Nom (en lettres moulées)		Title - Titre	Signature
Telephone No. - N° de téléphone	Facsimile No. - N° de télécopieur	E-mail address - Adresse courriel	Date

ANNEX C FLOOR PLAN(s)

Instructions to Bidder(s):

For scenario B procurements Bidders must provide:

- a) completed floor plan(s) with proposed SA approved products;
- b) a product listing of proposed SA approved products offered at floor plan(s).

As a minimum the product listing must include the following information:

- Supplier part numbers;
- brief product descriptions;
- quantities;
- firm unit prices.

By submitting a bid, the Bidder certifies that their submission includes all components and quantities required and identified in the floor plan(s) in accordance with the product descriptions, the product configurations and panel matrices or workstation layouts stipulated at Annex C.

***At contract award, “By submitting a bid, the Bidder...” becomes “The Contractor...”.**

NSA products forming part of the requirement will be identified at Annex D of this RFB.

1) Floor Plan(s) in PDF or AutoCAD version

As a minimum, the IU must identify the following information on their approved floor plan provided as part of this RFB:

- a) *All and only the required furniture (sizes and dimensions must be accurate in the plan);*
- b) *Furniture location and critical dimensions required to ensure conformance with all applicable codes, standards and regulations;*
- c) *Workstations and room numbers;*
- d) *Indications of Panel Matrices (which panels are powered, non-powered, panels with glazed elements, etc) or include Workstation Layouts (in the form of Typical Data Sheets or 3 Dimensional drawings) for every station variances.*
- e) *Indications of power feed locations;*
- f) *Electrical outlet locations within workstations;*
- g) *Telecommunications/data symbols;*
- h) *Lighting components requirements;*
- i) *Clearly indicate which work surfaces are freestanding height adjustable and which surfaces are panel hung.*

2) Product Descriptions

As a minimum, the IU must identify the following product information below for requirements containing panel matrices or on the Workstation Layouts:

- a. *All required panel heights: Base Height, Work Surface Privacy Add-on Height, Seated Privacy Add-on Height;*
- b. *When power is required, whether the power is located below or above work surface height; should a grouping of workstation types include shared panels and one side is identified as powered and the other side is non powered, those panels affected must be powered.*
- c. *Type of power feed (either base feed or power poles).*

3) Product Configurations

As a minimum, the IU must identify the following product information below for requirements containing panel matrices or on the Workstation Layouts:

- a. Panel height: Work Surface Privacy Add-on Height, Seated Privacy Add-on Height (please refer to panel Matrix in section 4).
- b. Power is required below the work surface.
- c. Type of feed: ceiling feed / power poles. NOCOM Conversion must be included for 46 Power Poles.
- d. Ceiling Height (103") to be confirmed on site.
- e. Each electrical outlet showing on the Plan is Duplex Electrical Outlets.
- f. All 42" (and above) work surfaces must have one centered grommet or scallop.
- g. Electrical sit-stand must offer extended range height up to at least 48" high.

#	GoCUID	Description of Product
1	FSCAEA4824	Electrically assisted Sit/Stand Range Height Adjustable Work Surface
2	WSxxPMLHRxxxxxxxxx2424 WSxxPMLHRxxxxxxxxx6024	Work surfaces Panel mounted High pressure laminate Rectangular
3	WSSULPMxxxxxxxxxxxxxx	Work surfaces 4 Post Legs High pressure laminate Rectangular Surface of 24"x30"
4	ACPSMM	Accessories, Paper Sorter Panel mounted Metal Vertical organizer Legal size 1 per Workstation + 1 per printer area
5	ACBIPMM	Accessories Panel mounted Metal Binder Bin 1 per Workstation+ 1 per printer area
6	ACIOPMM	Accessories In-Out Trays Panel mounted Metal 1 per Workstation+ 1 per printer area

4) Workstation Layout(s) or Panel Matrix

a. Panel Matrix

Please note that the letters at the end of the measurement above each panel is the Panel Matrix:
 EX: 5148B (51 is the height- 48 is the width-B is the Panel Matrix (refer to below)

Panel Matrix

SEATED PRIVACY HEIGHT ADD-ON 51"HEIGHT / PANNEAU ADDITIONNEL POUR INTIMITÉ EN POSITION ASSISE 51" DE HAUT

Powered outlet(s) Below Work Surface / Prise(s) électrique(s) au dessous de la surface de travail

PANEL MATRIX A:

Upper Element 1 / Élément supérieur 1 Fabric / Tissu	Upper Element 2 / Élément supérieur 2 Fabric / Tissu
Lower Element 1 / Élément inférieur 1 Cut-outs for Power & Data, Fabric / Cavités (s) finies pour l'insertion de prises (s) électriques et informatiques, Tissu	Lower Element 2 / Élément inférieur 2 Fabric / Tissu

PANEL MATRIX B:

Upper Element 1 / Élément supérieur 1 Fabric / Tissu	Upper Element 2 / Élément supérieur 2 Fabric / Tissu
Lower Element 1 / Élément inférieur 1 Cut-outs for Power, Fabric / Cavités (s) finies pour l'insertion de prises électriques, Tissu	Lower Element 2 / Élément inférieur 2 Fabric / Tissu

PANEL MATRIX E:

Upper Element 1 / Élément supérieur 1 Accessory Rail / Rail d'accès soins	Upper Element 2 / Élément supérieur 2 Accessory Rail / Rail d'accès soins
Lower Element 1 / Élément inférieur 1 Cut-outs for Power & Data, Fabric / Cavités (s) finies pour l'insertion de prises électriques et informatiques, Tissu	Lower Element 2 / Élément inférieur 2 Cut-outs for Power & Data, Fabric / Cavités (s) finies pour l'insertion de prises électriques et informatiques, Tissu

PANEL MATRIX G:

Upper Element 1 / Élément supérieur 1 Fabric / Tissu	Upper Element 2 / Élément supérieur 2 Fabric / Tissu
Lower Element 1 / Élément inférieur 1 Fabric / Tissu	Lower Element 2 / Élément inférieur 2 Fabric / Tissu

PANEL MATRIX H:

Upper Element 1 / Élément supérieur 1 Accessory Rail / Rail d'accès soins	Upper Element 2 / Élément supérieur 2 Fabric / Tissu
Lower Element 1 / Élément inférieur 1 Cut-outs for Power & Data, Fabric / Cavités (s) finies pour l'insertion de prises (s) électriques et informatiques, Tissu	Lower Element 2 / Élément inférieur 2 Fabric / Tissu

PANEL MATRIX J:

Upper Element 1 / Élément supérieur 1 Accessory Rail / Rail d'accès soins	Upper Element 2 / Élément supérieur 2 Fabric / Tissu
Lower Element 1 / Élément inférieur 1 Fabric / Tissu	Lower Element 2 / Élément inférieur 2 Fabric / Tissu

PANEL MATRIX P:

Upper Element 1 / Élément supérieur 1 Frosted Glazed Cloisons vitrés givés	Upper Element 2 / Élément supérieur 2 Frosted Glazed Cloisons vitrés givés
Lower Element 1 / Élément inférieur 1 Fabric / Tissu	Lower Element 2 / Élément inférieur 2 Fabric / Tissu

PANEL MATRIX Q:

Upper Element 1 / Élément supérieur 1 Accessory Rail / Rail d'accès soins	Upper Element 2 / Élément supérieur 2 Fabric / Tissu
Lower Element 1 / Élément inférieur 1 Cut-outs for Power, Fabric / Cavités (s) finies pour l'insertion de prises (s) électriques, Tissu	Lower Element 2 / Élément inférieur 2 Fabric / Tissu

PANEL MATRIX T (66" HEIGHT/66" HAUTEUR):

Upper Element 1 / Élément supérieur 1 Frosted Glazed Cloisons vitrés givés	Upper Element 2 / Élément supérieur 2 Frosted Glazed Cloisons vitrés givés
Upper Element 1 / Élément supérieur 1 Accessory Rail / Rail d'accès soins	Upper Element 2 / Élément supérieur 2 Fabric / Tissu
Lower Element 1 / Élément inférieur 1 Cut-outs for Power & Data, Fabric / Cavités (s) finies pour l'insertion de prises (s) électriques et informatiques, Tissu	Lower Element 2 / Élément inférieur 2 Fabric / Tissu

PANEL MATRIX U (66" HEIGHT/66" HAUTEUR):

Upper Element 1 / Élément supérieur 1 Frosted Glazed Cloisons vitrés givés	Upper Element 2 / Élément supérieur 2 Frosted Glazed Cloisons vitrés givés
Upper Element 1 / Élément supérieur 1 Fabric / Tissu	Upper Element 2 / Élément supérieur 2 Fabric / Tissu
Lower Element 1 / Élément inférieur 1 Fabric / Tissu	Lower Element 2 / Élément inférieur 2 Fabric / Tissu

REFER TO THE PANEL MATRIX H, WITH AN ADD-ON OF FROSTED GLAZED

REFER TO THE PANEL MATRIX G, WITH AN ADD-ON OF FROSTED GLAZED

Legend / Légende

Work Surfaces Panel mounted / Surfaces de travail Monté sur cloison

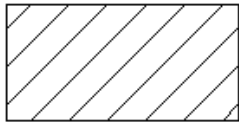

Electrically assisted Sit/Stand Range Height Adjustable Work Surface / Surface de travail à hauteur d'une plage de hauteurs en position assise ou debout à commande électrique



Power pole hardwire ceiling fed/ Pole électrique alimentée du plafond



Electrical outlet triplex or duplex/ Prise électrique duplex ou triplex



Data outlet (1 data,1 auxiliary)/ Prise voix/réseau (1 réseau, 1 auxilliare (data))

b. Workstation Layout(s)

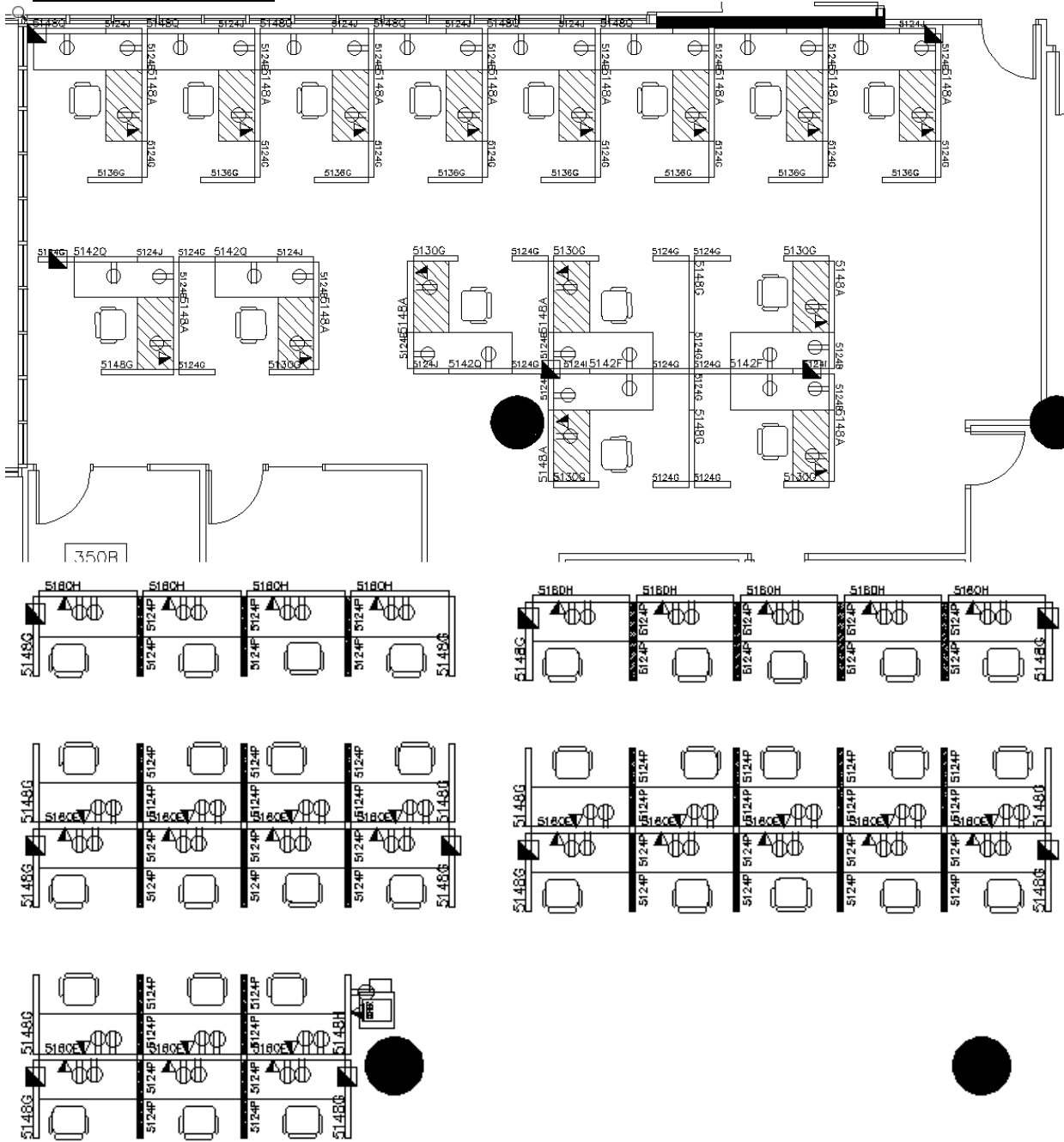

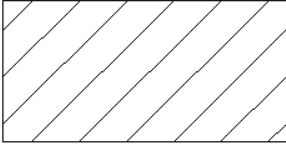

Electrically assisted Sit/Stand Range Height Adjustable Work Surface / Surface de travail à hauteur d'une plage de hauteurs en position assise ou debout à commande électrique

Please add **103** additional sit-stand on this project / S'il vous plait ajouter **103** surface de travail à hauteur d'une plage de hauteurs en position assise ou debout à commande électrique à ce projet

1. Product and Pricing

1	Product Total	INSERT \$ AT ANNEX A, ARTICLE 3, TABLE 9, LINE 1 FOR THE RESPECTIVE CATEGORY
2	Delivery Total	INSERT \$ AT ANNEX A, ARTICLE 3, TABLE 9, LINE 3 FOR THE RESPECTIVE CATEGORY
3	Installation Total	INSERT \$ AT ANNEX A, ARTICLE 3, TABLE 9, LINE 5 FOR THE RESPECTIVE CATEGORY

ANNEX D

Non Supply Arrangement (NSA) Products

This Annex includes the Specifications, Products and Pricing, Certifications associated with NSA products forming part of the requirement.

1. Specifications

IU to insert specifications of NSA products

2. Product and Pricing

Bidder to complete: Sections B of the tables identified by the IU below as well as Tables 9 and 10 of Annex A. In a resulting contract, the term "Bid" means the Supplier's commitment, the term "Bidder" means "Contractor".

(IU to insert either "firm unit" or "firm lot" or "firm price" Section B of each of Tables and make other corresponding adjustments.)

Product Category: 1B

Table 1 – NSA Products

Section A - IU REQUIREMENT			Section B – SUPPLIER'S BID		
#	Description of Product	Qty	Supplier Part Number	Firm Price** \$	Extended Total [Qty x Price] \$
1	Work surfaces/ Surface de travail Panel mounted/ Monté sur cloisons High pressure laminate/ Stratifié haute pression Rectangular/ Rectangulaire 24in x 66in / 24po x 66po	7			
2	Work surfaces/ Surface de travail Panel mounted/ Monté sur cloisons High pressure laminate/ Stratifié haute pression Rectangular/ Rectangulaire 24in x 72in / 24po x 72po	8			
Add more rows if necessary.			Product Total		\$

Table 2 - Delivery

Section A - IU REQUIREMENT				Section B – SUPPLIER'S BID		
Product Item # from Table 1	Location	Desired Date (Y/M/D)	Desired Time: Normal Business	Supplier will deliver on the date and at the time	Firm Price \$	Extended Total (Qty x Firm Unit Price)

			Hours (Normal) Or Outside Normal Business Hours (Outside)*	below*		\$
1	235 Queen ST, Ottawa. Ontario. Third floor, West Tower	2018-01-16	Normal	(Y) (M) (D)		
*If no dates and times are added by the Supplier, the Supplier agrees to deliver on the Desired Date and Time. [Normal Business Hours 8:00 – 17:00, as per SA, Annex A, article 5] Add more rows if necessary.				Delivery Total:		\$

Table 3 – Installation

Section A - IU REQUIREMENT				Section B – SUPPLIER'S BID		
Product Item # from Table 1	Location	Desired Date (Y/M/D)	Desired Time: Normal Business Hours (Normal) Or Outside Normal Business Hours (Outside)*	Supplier will install on the date and at the time below*	Firm Price \$	Extended Total (Qty x Firm Unit Price) \$
1	235 Queen ST, Ottawa. Ontario. Third floor, West Tower	2018-01-16	Normal & Outside	(Y) (M) (D)		
*If no dates and times are added by the Supplier, the Supplier agrees to install on the Desired Date and Time. [Normal Business Hours 8:00 – 17:00, as per SA, Annex A, article 5] Add more rows if necessary.				Installation Total:		\$

Table 8 – Standard Finishes and Canada's Facilities to Accommodate the Delivery and Certifications

1.	Standard Finishes
1.1	IU is to consult the Supplier's Website identified in Part 6A of the SA to view the available finishes. Within ten business days of the contract award, the Contracting Authority will provide the Contractor with a written notice of Canada's finish choices for each of the product(s) in Annex A. The Contractor will deliver the products corresponding to Canada's choice of specific finishes(s). No additional

	charge will be applied to Canada.	
2.	Canada's Facilities to Accommodate the Delivery	
2.1	Loading Dock/Location	
A	Location	235 Queen Street
B	Dock	Yes (240 Sparks Street)
C	Lift	Ramp
D	Door	78"H x 38"W
2.2	Freight Elevator	Available
2.3	Other (specify, if any)	
	Continuance of Certifications	
	The Bidder certifies that by submitting a bid in response to the RFB, the Bidder, and any of the Bidder's members if the Bidder is a Joint Venture, continues to comply with all of the certifications listed in Parts 6A and 6B of the Bidder's SA for Work Spaces, as follows:	
3.1	Integrity Provisions	
3.2	Federal Contractor's Program for Employment Equity	
3.4	Product Conformance	
3.5	Price Certification (In accordance with the SA, Part 6B)	

Table 9 - Bid Evaluation and Contract Total (Canada may complete if not completed by the Bidder)

1	Product Total (Table 1) or Annex C Total	\$
2	Optional Product Total (Table 4)	\$
3	Delivery Total (Table 2)	\$
4	Optional Delivery Total (Table 5)	\$
5	Installation Total (Table 3)	\$
6	Optional Installation Total (Table 6)	\$
7	Product Related Services Total (if applicable) (Table 7)	\$
8	NSA Total (if applicable) refer to Annex D	\$
9	Hardware Total as per article 1.5 of Annex A-1 of SA (if applicable)	\$
10	Total Evaluated (Bid) Price* (1 + 2 + 3 + 4 + 5 + 6+ 7+8+9):	\$\$
11	Applicable Tax(es):	\$
12	Total Estimated Cost (10+11):	\$

Table 10 – Bidder's Authorized Representative

Table 6 – Bidder's Authorized Representative		
1.	Bidder's Authorized Representative for the Bid and the Contract	
	Name:	Telephone:
		E-Mail:
		Other:

*At contract award, "Total Evaluated (Bid) Price" becomes "Contract Price".

1	Product Total	\$
2	Delivery Total	\$
3	Installation Total	\$
4	NSA Total (1+2+3)	INSERT \$ AT ANNEX A, ARTICLE 3, TABLE 9, LINE 8 FOR THE RESPECTIVE CATEGORY

3. Certification

NSA Product Conformance (Required precedent to Issuance of a contract)

The Supplier certifies that all the NSA products offered will conform to all specifications of, and meet the testing requirements detailed in Annex D of this RFB.

Supplier's Signature

Date

NSA Product Conformance Certification (applies after contract award)

The Supplier warrants that the NSA Product Conformance Certification submitted by the Supplier with its bid is accurate and complete. The Supplier must keep proper records and documentation relating to the NSA product conformance and the testing requirements in Annex D. The Supplier must not, without obtaining the prior written consent of the SAA, dispose of any such records or documentation until the expiration of the Contract or the expiry date of the Warranty, whichever is later. All such records and documentation must at all times during the retention period be open to audit, inspection and examination by the representatives of Canada, who may make copies and take extracts.

In addition, the Supplier must provide representatives of the SAA access to all locations where any part of the Work is being performed at any time during working hours. Representatives of the SAA may examine and test the Work as they see fit. The Supplier must provide all assistance and access to facilities, test pieces, samples and documentation that the representatives of the SAA may reasonably require for the carrying out of the inspection, which may also include the submission of test reporting documentation as listed in Annex D. The Supplier must forward such test pieces, samples and/or documentation that may also include letters of certification from the laboratories to such person or location as the representatives of the SAA specifies.

Contract First Page

Public Works and
Government Services
CanadaTravaux publics et
Services gouvernementaux
Canada

PURCHASING OFFICE - BUREAU DES ACHATS

CONTRACT – CONTRAT

Use "Canada accepts your bid" when you issued an RFB document, with Sections 1 and 2 completed, and the bidder has submitted a bid document.

Canada accepts your bid to provide to Canada the goods, services or both described in the Contract in accordance with the conditions and at the prices set out in the Contract.

Le Canada accepte votre soumission de fournir au Canada les biens, services ou les deux décrits dans le contrat conformément aux conditions et aux prix prévus au contrat.

Use "You are Requested" when you conducted a verbal solicitation, did not send a RFB document to the bidder with Section 2 completed, and you did not review terms and conditions of Section 2 with the bidder

You are requested to sell to the Majesty the Queen in right of Canada, in accordance with the terms and conditions set out herein, referred to herein or attached hereto, the supplies and services listed herein and on any attached sheets at the price or prices set out therefor.

Nous vous demandons de vendre à Sa Majesté la Reine du chef du Canada, aux conditions énoncées ou incluses par référence dans les présentes et aux annexes ci-jointes, les articles et les services énumérés dans les présentes et sur toute feuille ci-annexée, au(x) prix indiqué(s).

Supplier to sign for a "You are Requested" contract only.

The vendor hereby accepts this contract
Le fournisseur accepte le présent contrat

Name, title of person authorized to sign (type or print)
Nom et titre du signataire autorisé (caractère d'impression)

Signature

Date

Page

of
de

File No. – N° de dossier	
Date of Contract – Date du Contrat	
Contract No. - N° du contrat	Amendment No - N° de modification
Client Reference No. (optional) - N° du référence du client (facultatif)	
Financial Code(s) – Code(s) financier(s)	
Duty - Droits	GST - TPS/ HST – TVH
<input checked="" type="checkbox"/> Includ Inclus <input type="checkbox"/> Exclud Ensus	<input checked="" type="checkbox"/> Includ Inclus <input type="checkbox"/> Exclud En sus
FOB – FAB	
DESTINATION	
Destination See Section 2, Annex A. Voir Section 2, Annexe A.	
Invoices - Original and two copies must be completed and sent to: Factures – L'original et deux copies doivent être remplis et envoyés à : See Section 2, Article 6. Voir Section 2, Article 6.	
Address inquiries to : - Adresser toute demande de renseignements à : See Section 2, Article 4.1. Voir Section 2, Article 4.1.	
Area Code and Telephone No. Code régional et N° de téléphone	Facsimile No. N° de télécopieur
Total estimated cost – Coût total estimatif	
For the Minister – Pour le Ministre	