



RETURN BIDS TO:

RETOURNER LES SOUMISSIONS À:

Bid Receiving Public Works and Government
Services Canada/Réception des soumissions Travaux
publics et Services gouvernementaux Canada
800 Burrard Street, Room 219
800, rue Burrard, pièce 219
Vancouver
British Columbia
V6Z 0B9
Bid Fax: (604) 775-9381

SOLICITATION AMENDMENT MODIFICATION DE L'INVITATION

The referenced document is hereby revised; unless otherwise
indicated, all other terms and conditions of the Solicitation
remain the same.

Ce document est par la présente révisé; sauf indication contraire,
les modalités de l'invitation demeurent les mêmes.

Comments - Commentaires

Vendor/Firm Name and Address
Raison sociale et adresse du
fournisseur/de l'entrepreneur

Issuing Office - Bureau de distribution
Public Works and Government Services Canada - Pacific
Region
800 Burrard Street, Room 219
800, rue Burrard, pièce 219
Vancouver
British C
V6Z 0B9

Title - Sujet Building Envelope Rehabilitation	
Solicitation No. - N° de l'invitation F1700-174255/A	Amendment No. - N° modif. 006
Client Reference No. - N° de référence du client F1700-174255	Date 2017-10-20
GETS Reference No. - N° de référence de SEAG PW-\$PWY-022-8185	
File No. - N° de dossier PWY-7-40209 (022)	CCC No./N° CCC - FMS No./N° VME
Solicitation Closes - L'invitation prend fin at - à 02:00 PM on - le 2017-10-25	Time Zone Fuseau horaire Pacific Daylight Saving Time PDT
F.O.B. - F.A.B. Plant-Usine: <input type="checkbox"/> Destination: <input checked="" type="checkbox"/> Other-Autre: <input type="checkbox"/>	
Address Enquiries to: - Adresser toutes questions à: Arthur (PWY), Carolyn	Buyer Id - Id de l'acheteur pwy022
Telephone No. - N° de téléphone (604) 364-2752 ()	FAX No. - N° de FAX (604) 775-6633
Destination - of Goods, Services, and Construction: Destination - des biens, services et construction: DFO - Kitsilano Coast Guard Station - Vancouver, BC	

Instructions: See Herein

Instructions: Voir aux présentes

Delivery Required - Livraison exigée	Delivery Offered - Livraison proposée
Vendor/Firm Name and Address Raison sociale et adresse du fournisseur/de l'entrepreneur	
Telephone No. - N° de téléphone Facsimile No. - N° de télécopieur	
Name and title of person authorized to sign on behalf of Vendor/Firm (type or print) Nom et titre de la personne autorisée à signer au nom du fournisseur/ de l'entrepreneur (taper ou écrire en caractères d'imprimerie)	
Signature	Date

Solicitation No. - N° de l'invitation
F1700-174255/A
Client Ref. No. - N° de ref. du client

Amd. No. - N° de la modif
006
File No. - N° du dossier
PWY-7-40209

Buyer ID - Id de l'acheteur
pwy022
CCC No./N° CCC - FMS No./N° VME

LES DOCUMENTS FRANCAIS SERONT DISPONIBLES SUR DEMANDE

AMENDMENT 006

Amendment 006 has been raised to extend the closing date of the solicitation and incorporate Addendum No. 5 and No. 6.

All other terms and conditions remain unchanged.

Extension of Time
Building Envelope
Rehabilitation
Kitsilano Coast Guard Base
Vancouver, B.C.

F1700-174255/A

Notice is hereby given that the above information notice previously due at 2:00 p.m. PDST on October 23, 2017 is hereby extended to 2:00 p.m. PDST on October 25, 2017.

ADDENDUM 05

This Addendum is in addition to, and forms a part of the Contract. The cost, if any, of this revision(s) shall be included in the Contract price. All bidders shall acknowledge receipt and acceptance of this addendum by indicating Addendum number, date, and description, on the Tender Form provided. The revision(s) is as follows:

A- REFERENCE SPECIFICATIONS AS FOLLOWS:

1. 07 52 00 Modified Bituminous Membrane Roofing / 3.5 Roofing System Descriptions

.1 Delete:

- .1 Roof Assembly Type 'R-1" (Class A-Insulated)- entire assembly.

.2 Replace with:

- .1 Roof Assembly Type R1:
 - .1 Thoroughly prepare and prime steel decking;
 - .2 Fire Barrier Sheathing Board, per 2.2;
 - .3 Vapour Barrier, per 2.3;
 - .4 Min. R-17.7 continuous polyisocyanurate roof insulation, adhesive applied, factory-tapered at crickets & back-slopes (min. nom. 90mm);
 - .5 R-8.5 continuous mineral fiber insulation, adhesive-applied, with joints staggered from those of the previous layer (nom. 50mm);
 - .6 2 layers 6mm Protection Board, per 2.7;
 - .7 Base Sheet, per 2.6.2, torch-applied;
 - .8 Cap Sheet, per 2.6.4, torch-applied;
 - .9 Stripping and membrane flashing, granular-surfaced where exposed to view;
 - .10 Traffic deck, torch-applied.

.3 Add:

- .2 Deck Assembly Type D1:
 - .1 Thoroughly prepare and prime steel decking;
 - .2 Vapour Retarder, per 2.13 below;
 - .3 Min. R-25 continuous polyisocyanurate roof insulation, adhesive applied, factory-tapered at crickets & back-slopes;
 - .4 2 layers 6mm Protection Board, per 2.7;

- .5 Base Sheet, per 2.6.2, torch-applied;
- .6 Cap Sheet, per 2.6.4, torch-applied;
- .7 Stripping and membrane flashing, granular-surfaced where exposed to view;
- .8 2 layers 6mm Protection Board, per 2.7;
- .9 Concrete Pavers on pedestals (ref. Section 32 14 00 – Rooftop Unit Paving).

2. **07 52 00 Modified bituminous Membrane Roofing**

.1 Add:

2.13 Vapour Retarder

- .1 Description: Self-adhesive vapour barrier membrane composed of SBS modified bitumen and formulated especially for application over steel decking. Top surface: High-density polyethylene grid laminated between two layers of polyethylene film. Under face: Self-adhesive covered by silicone release plastic film.
- .2 Properties:

	MD	XD	
Thickness			0.8mm
Tensile Strength (kN/m)	11.3	15.4	
Ultimate Elongation (%)	15	24	
Tear Resistance (N)	375	400	
Water Absorption			0.1% Max.
Water Vapour Permeance			0.92(0.017 Perm)
Air Permeability			<0.007 L/Sec M ²
- .3 Accepted product: 'Sopravap R' by Soprema Waterproofing Inc.

B- REFERENCE DRAWINGS AS FOLLOWS:

1. **A0.01- Roof Assemblies R1:**

Delete description and replace with the revised 07 52 00 / 3.5.1 above

2. **A0.01- Deck Assemblies D1:**

Delete description and replace with the added 07 52 00 / 3.5.2 above

3. **Detail 2 of A6.20- Typical Guardrail transition**

Provide detail per ASK.001R1 attached.

END OF ADDENDUM

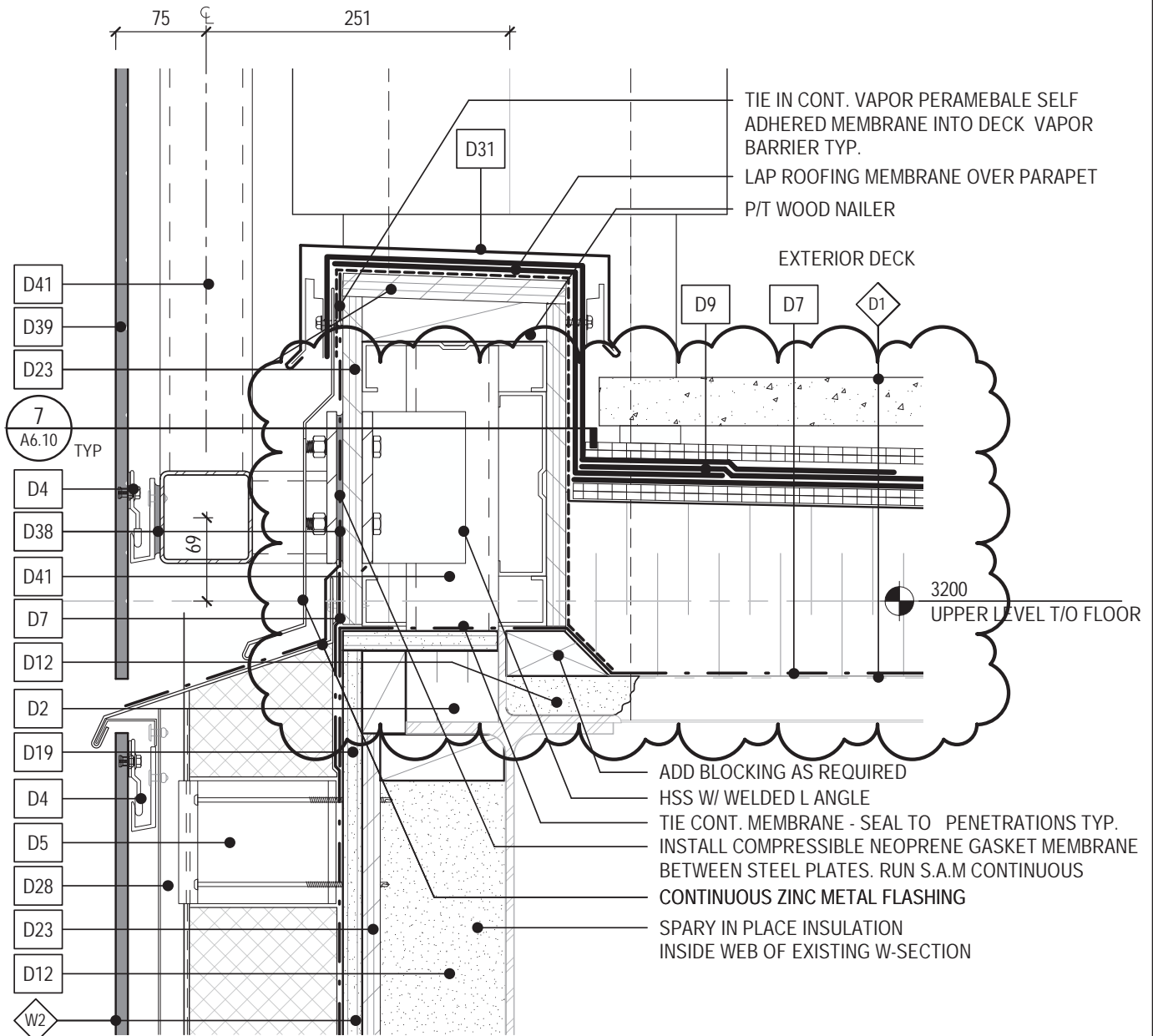

1

DETAIL - TYP. GUARDRAIL TRANSITION

A5.10

1 : 5

Project title/Titre du projet

1661 WHYTE AVE,
VANCOUVER, BC

KITSILANO COAST GUARD STATION
BUILDING ENVELOPE REHABILITATION

Drawing title/Titre du dessin

DETAIL - TYP. GUARDRAIL
TRANSITION

Consultant Signature Only

PWGC Project Manager/Administrateur de Projets TPSGC
P.G.

Scale/Echelle
1 : 5

Designed by/Concept par
RATIO

PWGC, Regional Manager, Architectural and Engineering Services/
Gestionnaire régionale, Services d'architecture et de génie, TPSGC
X

Date/Date
17/10/18

Drawn by/Dessine par
RATIO

Project No./No. du projet
9W740

RATIO
4056

Sheet/Feuille
ASK-001R1

Revision/Revision
2



ADDENDUM 06

This Addendum is in addition to, and forms a part of the Contract. The cost, if any, of this revision(s) shall be included in the Contract price. All bidders shall acknowledge receipt and acceptance of this addendum by indicating Addendum number, date, and description, on the Tender Form provided. The revision(s) is/are as follows:

A- REFERENCE SPECIFICATIONS AS FOLLOWS:

1. 01 11 55 – GENERAL REQUIREMENTS / 1.2 Description of Work

Add:

- .2 Extend or relocate exterior Electrical, Communication and/or Security fixtures, wiring devices, boxes etc. to suit new cladding configuration & dimensions, typical.
- .3 Remove and discard existing exterior hose bibs, extend lines and install new non freeze hose bibs to suit the new cladding systems. Extend ducts and vents to suit the new cladding. Coordinate with architectural details.

2. 01 11 55 – GENERAL REQUIREMENTS

Add:

1.32 Contractor's Options for Selection of Products

- .1 Products are specified by "Prescriptive" specifications: select any product meeting or exceeding specifications.
- .2 Products specified under "Acceptable Products": select any one of the indicated manufacturers, or any other manufacturer meeting or exceeding the Prescriptive specifications and indicated Products.
- .3 Products specified by performance and referenced standard: select any product meeting or exceeding the referenced standard.
- .4 Products specified to meet particular design requirements or to match existing materials: use only material specified Approved Product. Alternative products may be considered provided full technical data is received in writing by Consultant in accordance with Section 01 33 00- Submittal Procedures.
- .5 When products are specified by a referenced standard or by or Performance specifications, upon request of Consultant obtain from manufacturer an independent laboratory report showing that the product meets or exceeds the specified requirements.

3. 07 52 00- Modified Bituminous Membrane Roofing

2.10 Traffic Walkway & Roof Edge Danger Zone Marking

Add:

- .3 Provide Traffic Walkway in the following locations:
 - .1 min. 900mm wide around the roof hatch;
 - .2 min. 900mm wide around the antenna mast;
 - .3 min. 900mm wide path between the two above locations.
- .4 Provide 3048mm wide Roof Edge Danger Zone Marking around the perimeter of the roof.

B- REFERENCE DRAWINGS AS FOLLOWS:

1. A2.11- Upper Level Floor Plan

Add Note:

- 1. Provide 6 metal through-wall scuppers at the exterior deck guardrail upstand. Locations TBD. Refer to 07 62 00- Sheet Metal Flashing & Trim / 2.7.

2. A2.20- Roof Plan

Add Note:

- 1. Provide 6 metal through-parapet scuppers. Locations TBD. Refer to 07 62 00- Sheet Metal Flashing & Trim / 2.7.
- 2. Provide new metal flashing caps to exposed column terminations at the roof. Refer to 07 62 00- Sheet Metal Flashing & Trim. Tie in to roof assembly.

C- BIDDERS ENQUIRIES:

1. Questions:

- 1. Is this a LEED project ?
- 2. Deck assembly D1 (sheet A0.01)
 - a. Specification for filter fabric, XPS rigid insulation,
 - b. Specification for XPS rigid insulation for this assembly
 - c. Specification for 12.7mm drain mat
 - d. 2ply SBS roofing membrane. Must the cap sheet require to be SRI-rated when it will be underneath pavers?
 - e. Protection board. If EPS will be the tapered insulation, typically 2 layers of board is required on top of it. Please confirm this.

- f. Please confirm if tapered insulation for this assembly is EPS and if so which type?
 - g. How will the roof sheathing be attached to the steel deck, fastened or adhered?
- 3. Roof assembly R1(sheet A0.01)
 - a. Please confirm that 2 layers of protection board is required on top of mineral fibre insulation (bitumen impregnated upper surface).
 - b. Drawing indicated R8.5 while specs writes 102mm thick mineral fibre insulation. Please advice what is expected to be installed?
 - c. Drawing indicated R17.7 while specs writes 50mm + 75mm thick polyiso insulation. Please advice what is expected to be installed?
 - d. How will the roof sheathing be attached to the steel deck, fastened or adhered?
- 4. Section 075200 Item 2.4 - Roof insulation performance description does not exactly describe the acceptable product. Please advise if any revisions/changes will be done. Attached the product data for Sopraiso Plus
- 5. Section 075200 Item 2.6.4 – Cap sheet. Please confirm if an SRI-rated and also a fire-rated cap sheet is required.
- 6. Section 075200 Item 2.6.5 – Cap stripping. Please confirm if an white-granuled membrane and also a fire-rated cap sheet is required.
- 7. Ammendment#4 listed the existing roof assembly. Is the same assembly to be assumed at the upper level floor exterior deck (area designated in the Deck assembly D1) and only differs that pavers are currently above it? Are the existing pavers on pedestals, shims, or sand bedding?

2. Answers

- 1. Not a LEED project.
- 2. Deck assembly D1 (sheet A0.01)
 - a. Refer to Addendum 05
 - b. Refer to Addendum 05
 - c. Refer to Addendum 05
 - d. SRI-rated at exposed locations only
 - e. Refer to Addendum 05
 - f. Refer to Addendum 05
 - g. Fastened, per 2.2
- 3. Roof assembly R1(sheet A0.01)
 - a. Refer to Addendum 05
 - b. Refer to Addendum 05
 - c. Refer to Addendum 05

- d. Fastened, per 2.2
- 4. Refer to Addendum 06, part A2 above
- 5. Fire cap not required.
- 6. Fire cap not required.
- 7. The original as-built drawings show a conventional SBS-type roof with pavers over. Insulation is 3" thick max. There is no indication of the paver support, but it is likely pedestals or shims.

END OF ADDENDUM