

FORECASTLE DECK

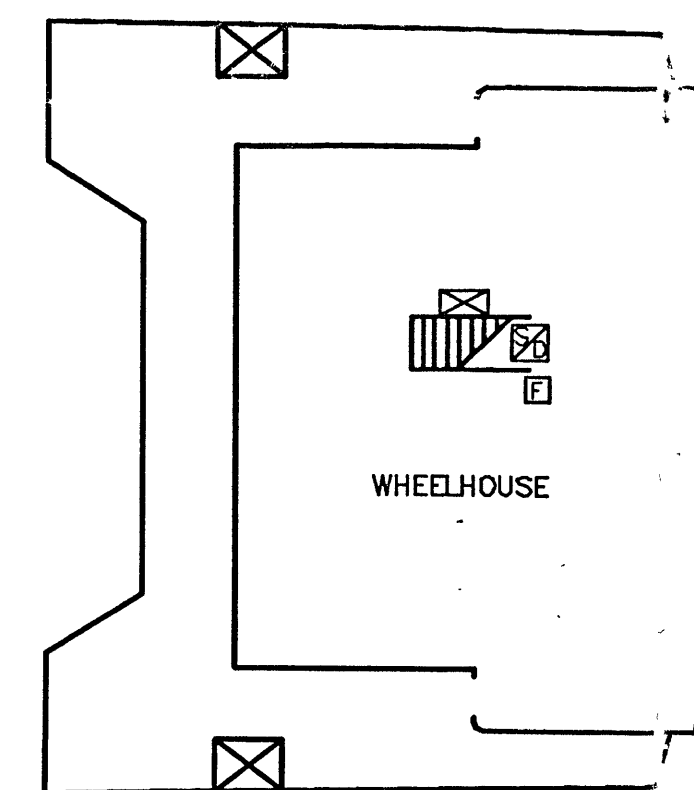

BRIDGE DECK

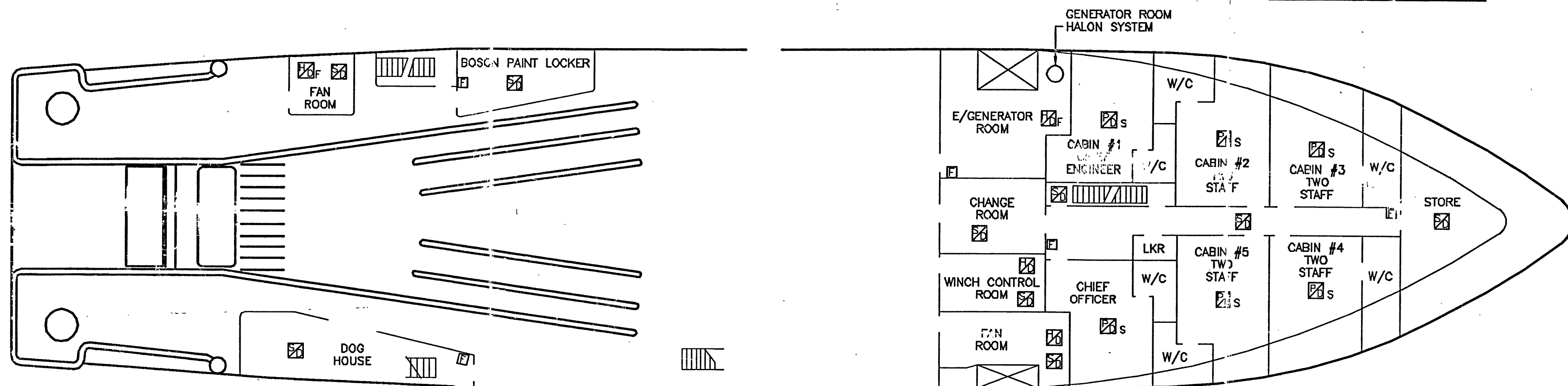

SHELTER DECK

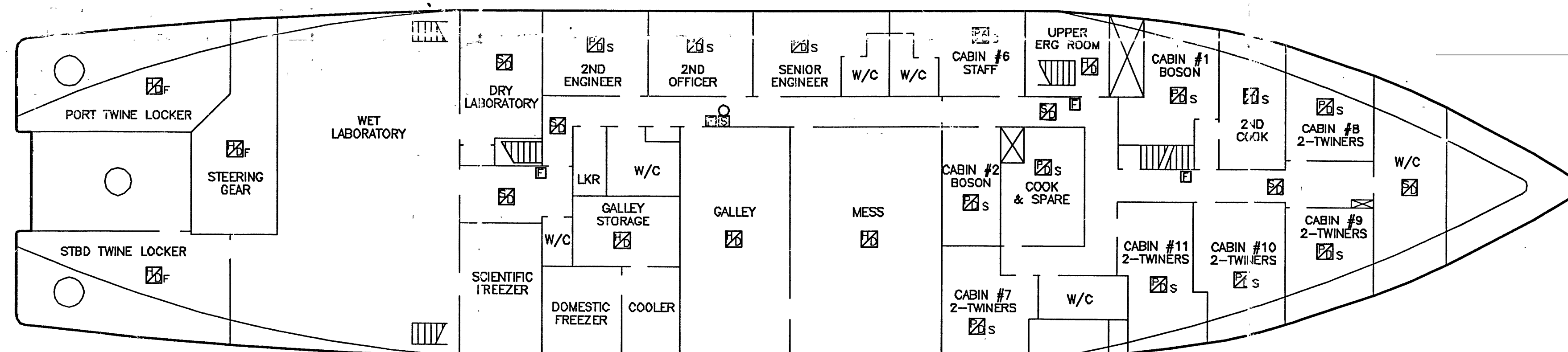

MAIN DECK

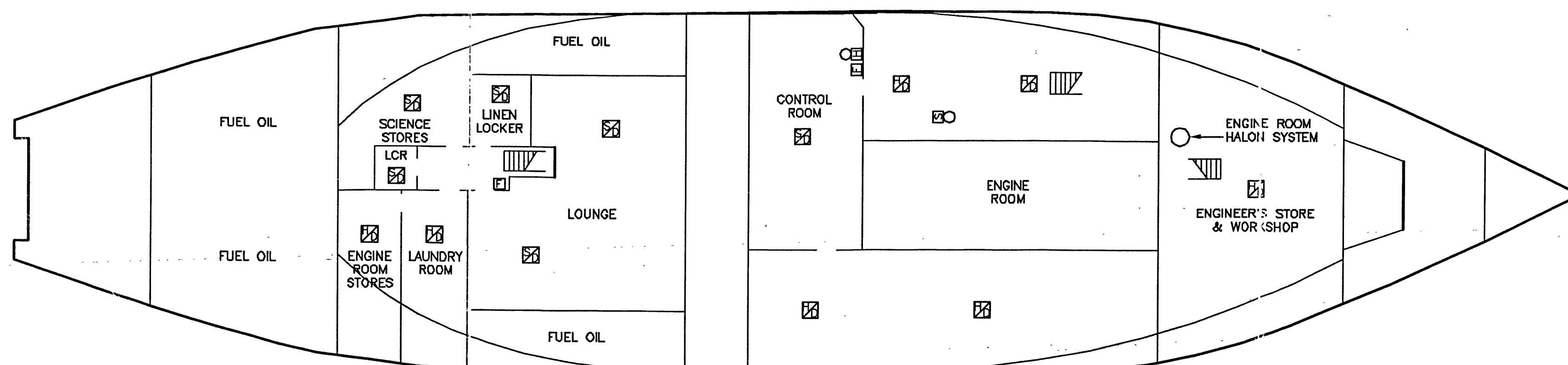

LOWER DECK

LEGEND

- ADDRESSABLE MANUAL FIRE ALARM PULL STATION #MPS-950B C/W MNX-101A ADDRESSABLE INTERFACE MODULE.
- ANALOG IONIZATION SENSOR #PX-551 C/W BX-501BA BASE
- ANALOG PHOTOELECTRIC SENSOR #SDX-551 C/W BA-501HA SOUNDER BASE.
- ANALOG THERMAL SENSOR #FLX-551 C/W BX-501BA BASE
- WEATHERPROOF THERMAL DETECTOR C/W MNX-101A ADDRESSABLE INTERFACE MODULE.
- FIRE ALARM STROBE LIGHT.
- MAIN FIRE ALARM CONTROL PANEL #AFP-200

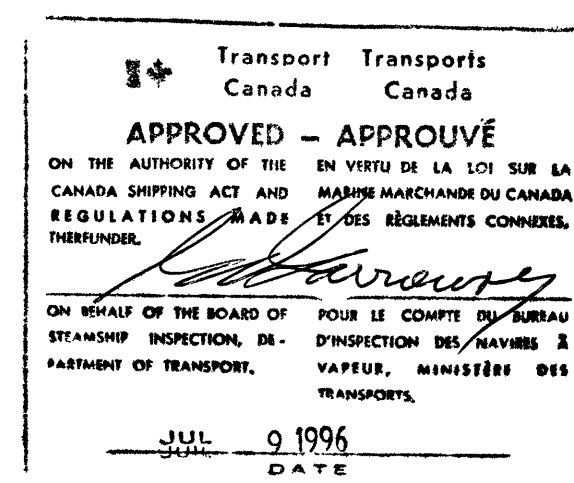

NOT TO BE COMPLETED BY THE INSTALLER
 TO BE COMPLETED BY THE STEAMSHIP INSPECTOR
 SUBJECT TO THE COMMISSIONER'S APPROVAL
 SOUS RÉSERVE QUE L'INSTALLATION A ÉTÉ APPROUVÉE PAR L'INSPECTEUR DES NAVIRES À VAPEUR

ATLANTIC ALARM and SOUND INC.			
PROJECT: C.C.S. ALFRED NEEDLER 165'-0" FISHERIES RESEARCH TRAWLER			
TITLE: FIRE ALARM RENOVATIONS			
DATE: 22/05/96	SCALE: N.T.S.	PROJECT NO: 9606	DWG. NO: E-1