

E1/E2

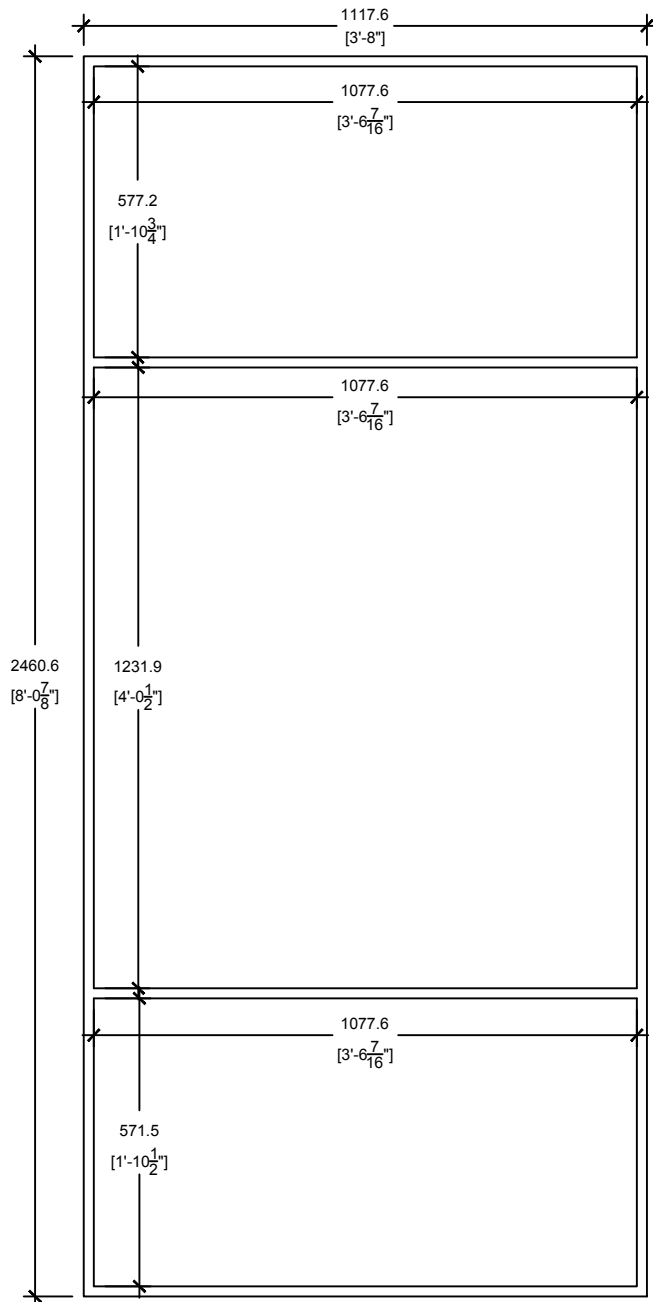

WINDOW FRAME
 - 44" X 96-7/8"
 - QTY: 1
 - THICKNESS: 20MM
 - ALUMINUM

- NOTE:**
- ALL MEASUREMENTS WILL BE RE-TAKEN BY THE SUPPLIER FOR PROPER SIZING WITH THERE ASSOCIATED PRODUCTS.
 - ALL GLAZING WILL BE MEDIUM DUTY HEAT TEMPERED GLASS, AND ALL WINDOWS WILL CONFORM TO MEDIUM DUTY STANDARDS
 - SLIDING OPERABLE WINDOWS (CAN-A440 RATINGS- A3, B7) (AAMA RATING HC-55)
 - LOW-E COATING
 - ARGON GAS FILLED BETWEEN GLAZING UNITS
 - TOTAL THICKNESS OF (25MM), EXTERIOR GLAZING (6MM) TEMPERED GLASS, INSULATING GAP (13MM) ARGON GAS FILLED, INTERIOR GLAZING (6MM) TEMPERED.

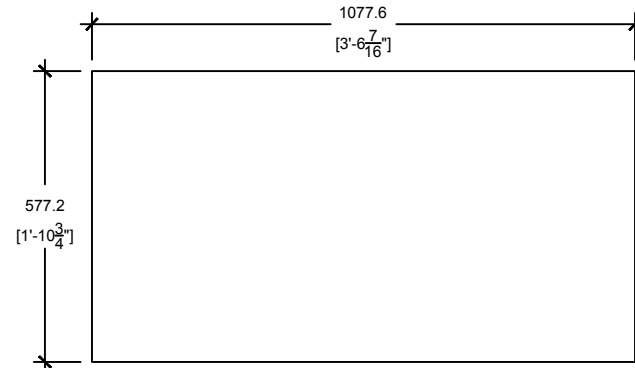

ALUMINUM INSULATED PANEL
 - 42-1/4" X 22-3/4"
 - QTY: 1

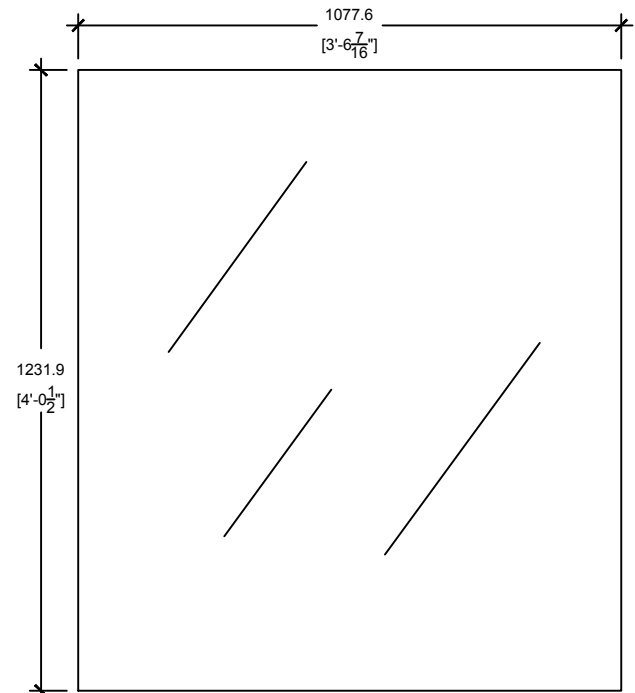

GLASS PANEL
 - 42-1/4" X 48-1/2"
 - QTY: 12

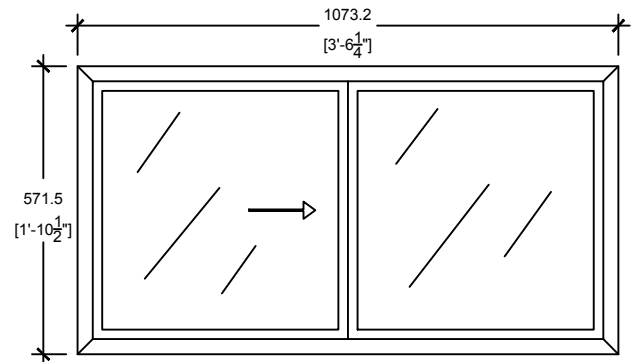

SLIDING UNIT
 - 42-1/4" X 22-1/2"
 - QTY: 12



WINDOW STOP (MULLION)
 - ALUMINUM RAIL SYSTEM
 - FOR 42-1/4" X 22-3/4" ALUMINUM INSULATED PANEL
 - QTY: 1

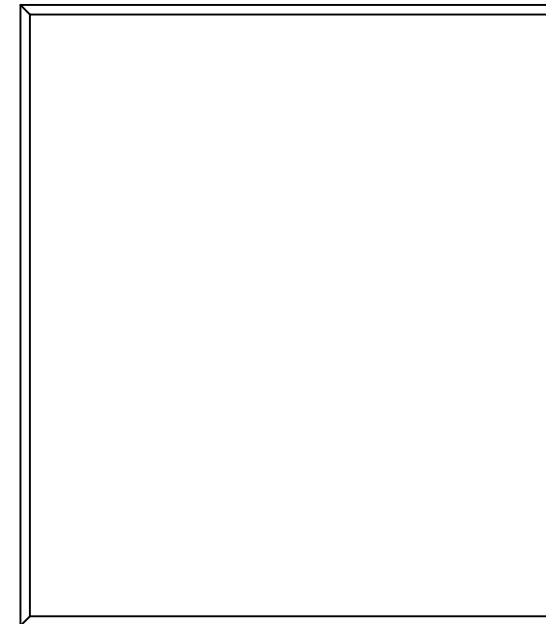

WINDOW STOP (MULLION)
 - ALUMINUM RAIL SYSTEM
 - FOR 42-1/4" X 48-1/2" GLASS PANE
 - QTY: 12

GENERAL NOTES

No.	DESCRIPTION	DD/MM/YY
1	Revision/Issue	Date

Firm Name and Address
 Z:\Corcon Drawings\CORCAN Logo New.tif
 CORCAN CONSTRUCTION
 Frontenac Institution
 Kingston, Ontario

THESE DRAWINGS AND SPECIFICATIONS ARE THE PROPERTY OF THE CORRECTIONAL SERVICE OF CANADA AND SHALL NOT BE REPRODUCED, COPIED, OR USED AS THE BASIS FOR THE CONSTRUCTION, MANUFACTURE, OR SALE OF ANY ARTICLE WITHOUT THE WRITTEN PERMISSION OF THE CORRECTIONAL SERVICE OF CANADA.

CES DESSIN ET SPECIFICATION SONT LES PROPRIETES DU SERVICE CORRECTIONNEL DU CANADA ET NE DOIVENT ETRE NI PRODUIT, NI COPIES, OU NI UTILISES POUR LA FABRICATION, CONSTRUCTION, OU LA VENTE D'ARTICLE SANS LA PERMISSION DU SERVICE CORRECTIONNEL DU CANADA

Project Name and Address
RANGE WINDOWS
 SASK PEN

E1/E2
 WINDOWS

Project	Sheet
Date: 2017-10-27	101
Scale: 1:15	

E1/E2

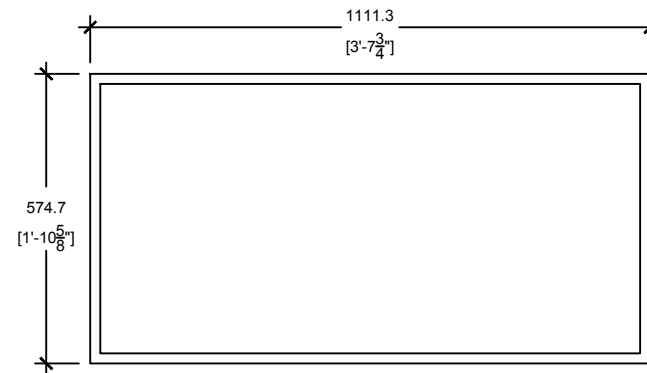

WINDOW FRAME
 - 22-5/8" X 43-3/4"
 - QTY: 2
 - THICKNESS: 20MM
 - ALUMINUM

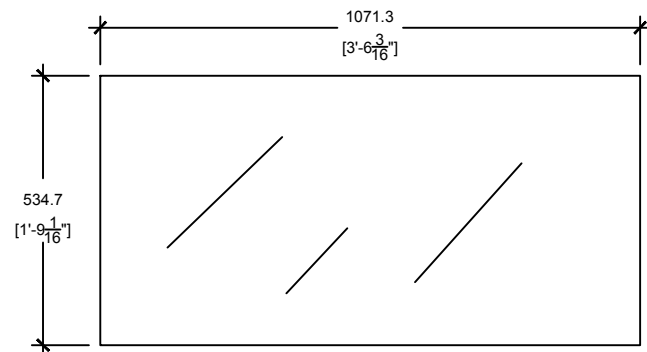

GLASS PANEL
 - 21-1/16" X 42-3/16"
 - QTY: 2

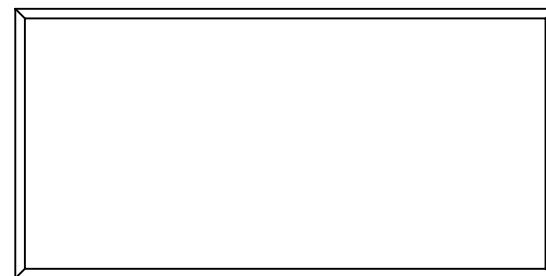

WINDOW STOP (MULLION)
 - ALUMINUM RAIL SYSTEM
 - FOR 21-1/16" X 42-3/16"
 - QTY: 2

NOTE:

- ALL MEASUREMENTS WILL BE RE-TAKEN BY THE SUPPLIER FOR PROPER SIZING WITH THERE ASSOCIATED PRODUCTS.
- ALL GLAZING WILL BE MEDIUM DUTY HEAT TEMPERED GLASS, AND ALL WINDOWS WILL CONFORM TO MEDIUM DUTY STANDARDS
- SLIDING OPERABLE WINDOWS (CAN-A440 RATINGS- A3, B7) (AAMA RATING HC-55)
- LOW-E COATING
- ARGON GAS FILLED BETWEEN GLAZING UNITS
- TOTAL THICKNESS OF (25MM), EXTERIOR GLAZING (6MM) TEMPERED GLASS, INSULATING GAP (13MM) ARGON GAS FILLED, INTERIOR GLAZING (6MM) TEMPERED.

GENERAL NOTES

No.	DESCRIPTION	DD/MM/YY
1		
No.	Revision/Issue	Date

Firm Name and Address
 Z:\Corcon Drawings\CORCAN Logo New.tif
 CORCAN CONSTRUCTION
 Frontenac Institution
 Kingston, Ontario

THESE DRAWINGS AND SPECIFICATIONS ARE THE PROPERTY OF THE CORRECTIONAL SERVICE OF CANADA AND SHALL NOT BE REPRODUCED, COPIED, OR USED AS THE BASIS FOR THE CONSTRUCTION, MANUFACTURE, OR SALE OF ANY ARTICLE WITHOUT THE WRITTEN PERMISSION OF THE CORRECTIONAL SERVICE OF CANADA.

CES DESSIN ET SPECIFICATION SONT LES PROPRIETES DU SERVICE CORRECTIONNEL DU CANADA ET NE DOIVENT ETRE NI PRODUIT, NI COPIES, OU NI UTILISES POUR LA FABRICATION, CONSTRUCTION, OU LA VENTE D'ARTICLE SANS LA PERMISSION DU SERVICE CORRECTIONNEL DU CANADA

Project Name and Address
RANGE WINDOWS
 SASK PEN

E1/E2
 WINDOWS

Project	Sheet
Date: 2017-10-27	101
Scale: 1:15	

E3/E4

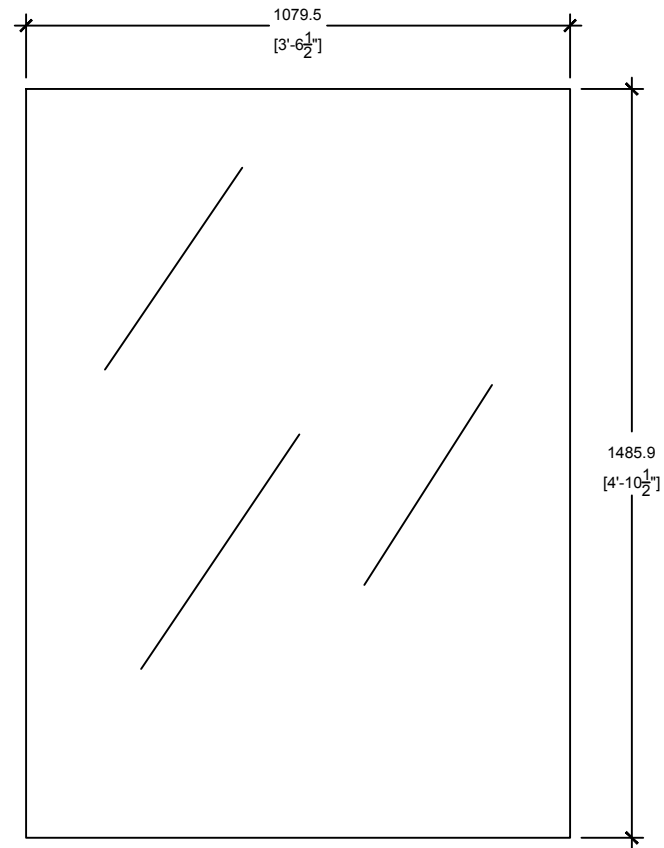

GLASS PANEL
- 42-1/4" X 58-1/2"
- QTY: 15

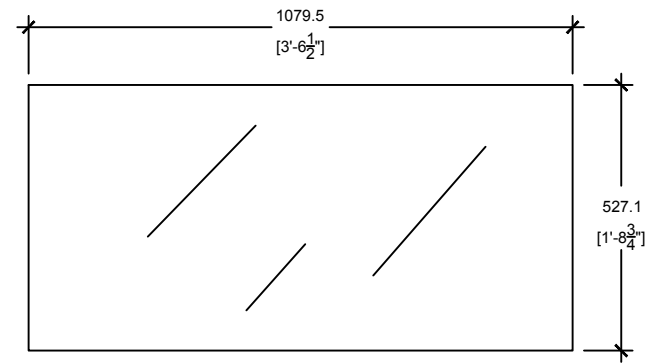

GLASS PANEL
- 42-1/4" X 20-3/4"
- QTY: 14

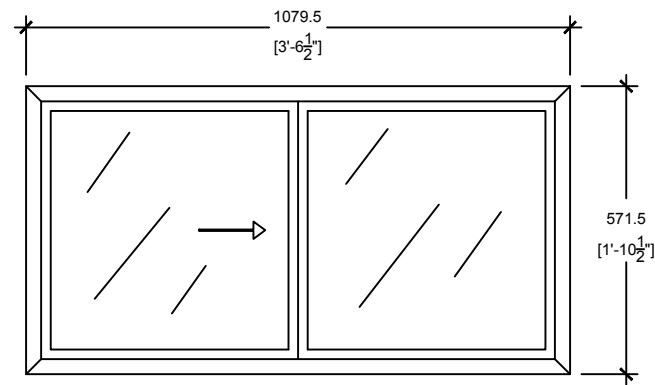

SLIDING UNIT
- 42-1/4" X 22-1/2"
- QTY: 15

NOTE:

- ALL MEASUREMENTS WILL BE RE-TAKEN BY THE SUPPLIER FOR PROPER SIZING WITH THERE ASSOCIATED PRODUCTS.
- ALL GLAZING WILL BE MEDIUM DUTY HEAT TEMPERED GLASS, AND ALL WINDOWS WILL CONFORM TO MEDIUM DUTY STANDARDS
- SLIDING OPERABLE WINDOWS (CAN-A440 RATINGS- A3, B7) (AAMA RATING HC-55)
- LOW-E COATING
- ARGON GAS FILLED BETWEEN GLAZING UNITS
- TOTAL THICKNESS OF (25MM), EXTERIOR GLAZING (6MM) TEMPERED GLASS, INSULATING GAP (13MM) ARGON GAS FILLED, INTERIOR GLAZING (6MM) TEMPERED.

GENERAL NOTES

No.	DESCRIPTION	DD/MM/YY
1	Revision/Issue	Date

Firm Name and Address

Z:\Corcon Drawings\CORCAN Logo New.tif

CORCAN CONSTRUCTION
Frontenac Institution
Kingston, Ontario

THESE DRAWINGS AND SPECIFICATIONS ARE THE PROPERTY OF THE CORRECTIONAL SERVICE OF CANADA AND SHALL NOT BE REPRODUCED, COPIED, OR USED AS THE BASIS FOR THE CONSTRUCTION, MANUFACTURE, OR SALE OF ANY ARTICLE WITHOUT THE WRITTEN PERMISSION OF THE CORRECTIONAL SERVICE OF CANADA.

CES DESSIN ET SPECIFICATION SONT LES PROPRIETES DU SERVICE CORRECTIONNEL DU CANADA ET NE DOIVENT ETRE NI PRODUIT, NI COPIES, OU NI UTILISES POUR LA FABRICATION, CONSTRUCTION, OU LA VENTE D'ARTICLE SANS LA PERMISSION DU SERVICE CORRECTIONNEL DU CANADA

Project Name and Address

RANGE WINDOWS
SASK PEN

E3/E4
WINDOWS

Project	Sheet
Date: 2017-10-27	101
Scale: 1:15	

F4

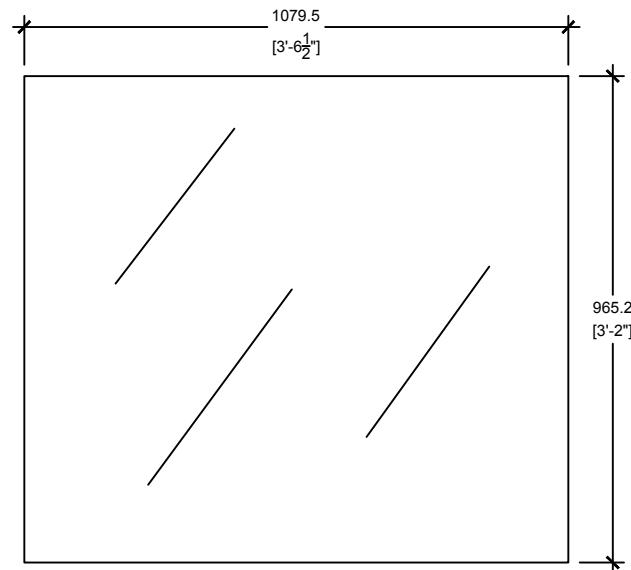

GLASS PANEL
- 42-1/4" X 38"
- QTY: 15

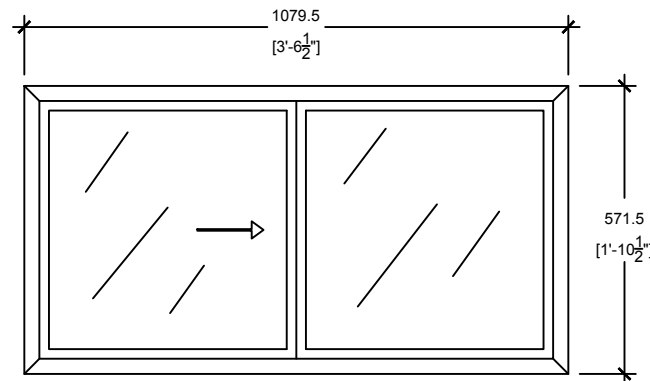

SLIDING UNIT
- 42-1/4" X 22-1/2"
- QTY: 14

NOTE:

- ALL MEASUREMENTS WILL BE RE-TAKEN BY THE SUPPLIER FOR PROPER SIZING WITH THERE ASSOCIATED PRODUCTS.
- ALL GLAZING WILL BE MEDIUM DUTY HEAT TEMPERED GLASS, AND ALL WINDOWS WILL CONFORM TO MEDIUM DUTY STANDARDS
- SLIDING OPERABLE WINDOWS (CAN-A440 RATINGS- A3, B7) (AAMA RATING HC-55)
- LOW-E COATING
- ARGON GAS FILLED BETWEEN GLAZING UNITS
- TOTAL THICKNESS OF (25MM), EXTERIOR GLAZING (6MM) TEMPERED GLASS, INSULATING GAP (13MM) ARGON GAS FILLED, INTERIOR GLAZING (6MM) TEMPERED.

GENERAL NOTES

No.	DESCRIPTION	DD/MM/YY
1	Revision/Issue	Date

Firm Name and Address

Z:\Corcon Drawings\CORCAN Logo New.tif
CORCAN CONSTRUCTION
Frontenac Institution
Kingston, Ontario

THESE DRAWINGS AND SPECIFICATIONS ARE THE PROPERTY OF THE CORRECTIONAL SERVICE OF CANADA AND SHALL NOT BE REPRODUCED, COPIED, OR USED AS THE BASIS FOR THE CONSTRUCTION, MANUFACTURE, OR SALE OF ANY ARTICLE WITHOUT THE WRITTEN PERMISSION OF THE CORRECTIONAL SERVICE OF CANADA.

CES DESSIN ET SPECIFICATION SONT LES PROPRIETES DU SERVICE CORRECTIONNEL DU CANADA ET NE DOIVENT ETRE NI PRODUIT, NI COPIES, OU NI UTILISES POUR LA FABRICATION, CONSTRUCTION, OU LA VENTE D'ARTICLE SANS LA PERMISSION DU SERVICE CORRECTIONNEL DU CANADA.

Project Name and Address

RANGE WINDOWS
SASK PEN

F4
WINDOWS

Project	Sheet
Date: 2017-10-27	101
Scale: 1:15	

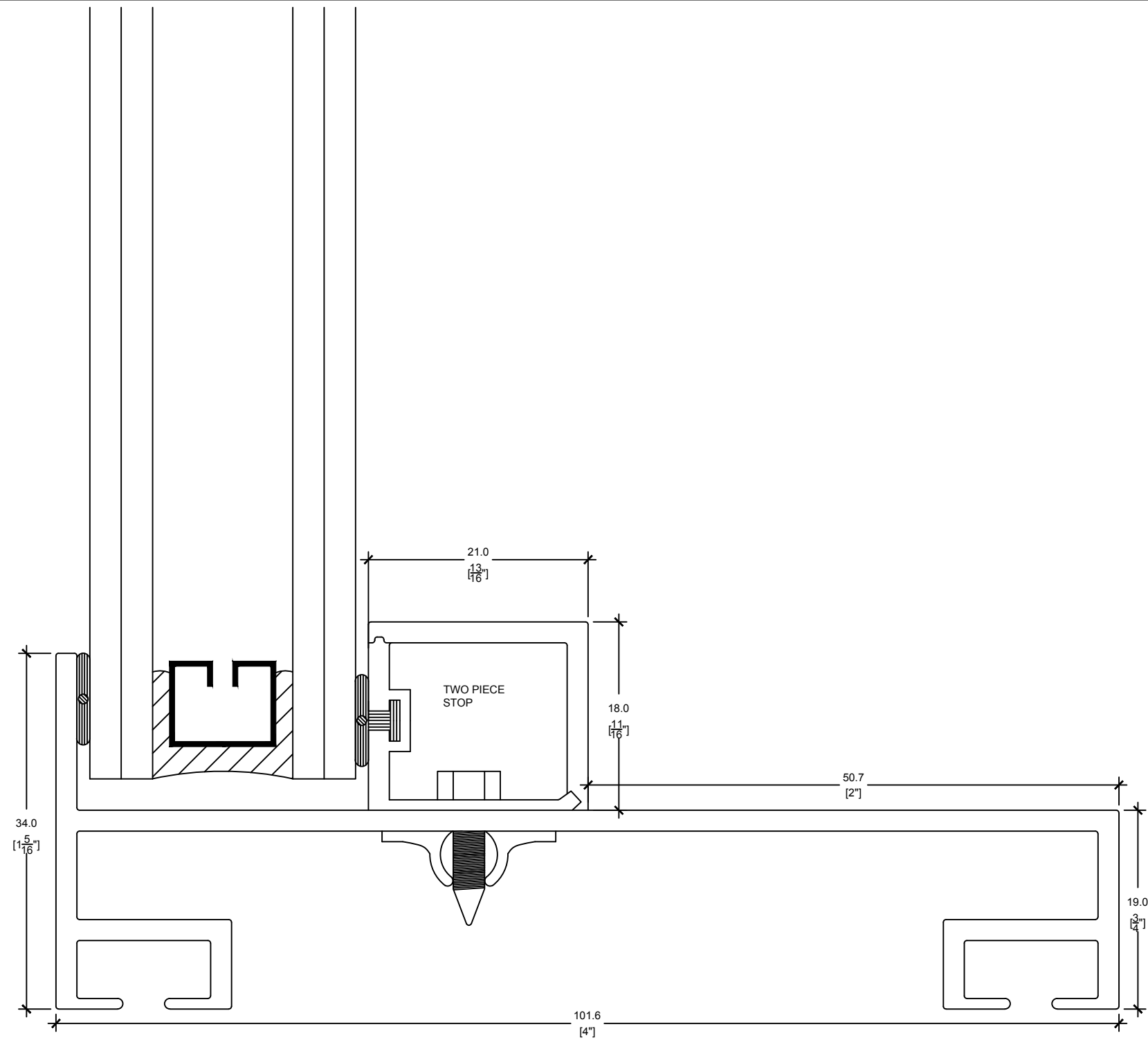

GENERAL NOTES

No.	DESCRIPTION	DD/MM/YY
1	Revision/Issue	Date

Firm Name and Address

Z:\Corcon Drawings\CORCAN Logo New.tif
 CORCAN CONSTRUCTION
 Frontenac Institution
 Kingston, Ontario

THESE DRAWINGS AND SPECIFICATIONS ARE THE PROPERTY OF THE CORRECTIONAL SERVICE OF CANADA AND SHALL NOT BE REPRODUCED, COPIED, OR USED AS THE BASIS FOR THE CONSTRUCTION, MANUFACTURE, OR SALE OF ANY ARTICLE WITHOUT THE WRITTEN PERMISSION OF THE CORRECTIONAL SERVICE OF CANADA.

CES DESSIN ET SPECIFICATION SONT LES PROPRIETES DU SERVICE CORRECTIONNEL DU CANADA ET NE DOIVENT ETRE NI PRODUIT, NI COPIES, OU NI UTILISES POUR LA FABRICATION, CONSTRUCTION, OU LA VENTE D'ARTICLE SANS LA PERMISSION DU SERVICE CORRECTIONNEL DU CANADA.

Project Name and Address

RANGE WINDOWS
 SASK PEN

FRAME SINGLE PANEL
 SECTION VIEW

Project	Sheet
Date: 2017-10-27	101
Scale: 1:15	

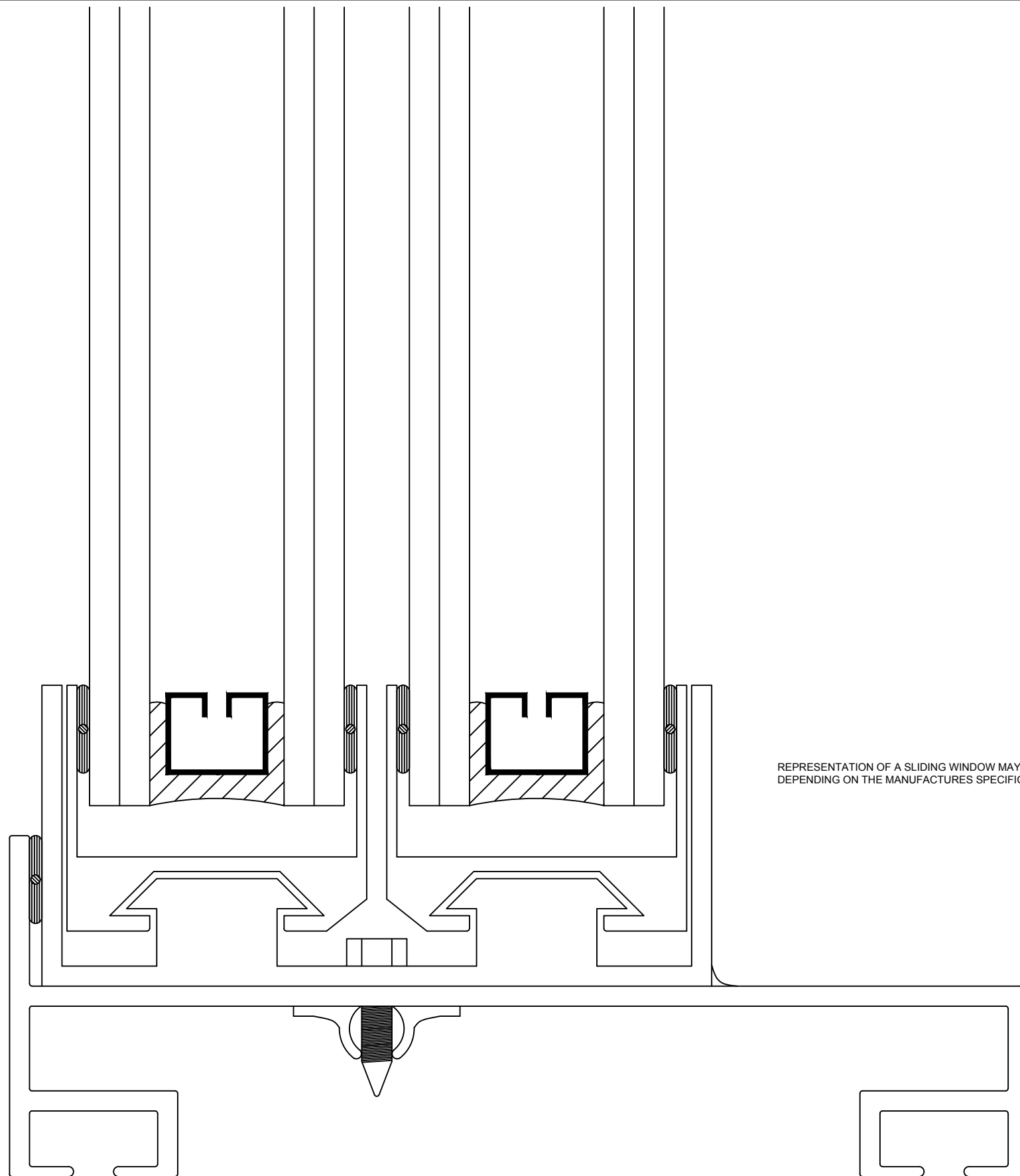

REPRESENTATION OF A SLIDING WINDOW MAY AND CAN VARY
 DEPENDING ON THE MANUFACTURES SPECIFICATIONS

GENERAL NOTES

No.	DESCRIPTION	DD/MM/YY
1	Revision/Issue	Date

Firm Name and Address
 Z:\Corcon Drawings\CORCAN Logo New.tif
 CORCAN CONSTRUCTION
 Frontenac Institution
 Kingston, Ontario

THESE DRAWINGS AND SPECIFICATIONS
 ARE THE PROPERTY OF THE
 CORRECTIONAL SERVICE OF CANADA
 AND SHALL NOT BE REPRODUCED,
 COPIED, OR USED AS THE BASIS FOR
 THE CONSTRUCTION, MANUFACTURE,
 OR SALE OF ANY ARTICLE WITHOUT THE
 WRITTEN PERMISSION OF THE
 CORRECTIONAL SERVICE OF CANADA.

CES DESSIN ET SPECIFICATION SONT
 LES PROPRIETES DU SERVICE
 CORRECTIONNEL DU CANADA ET NE
 DOIVENT ETRE NI PRODUIT, NI COPIES,
 OU NI UTILISES POUR LA FABRICATION,
 CONSTRUCTION, OU LA VENTE
 D'ARTICLE SANS LA PERMISSION DU
 SERVICE CORRECTIONNEL DU CANADA

Project Name and Address
 RANGE WINDOWS
 SASK PEN

FRAME SLIDING PANELS
 SECTION VIEW

Project	Sheet
Date: 2017-10-27	101
Scale: 1:15	

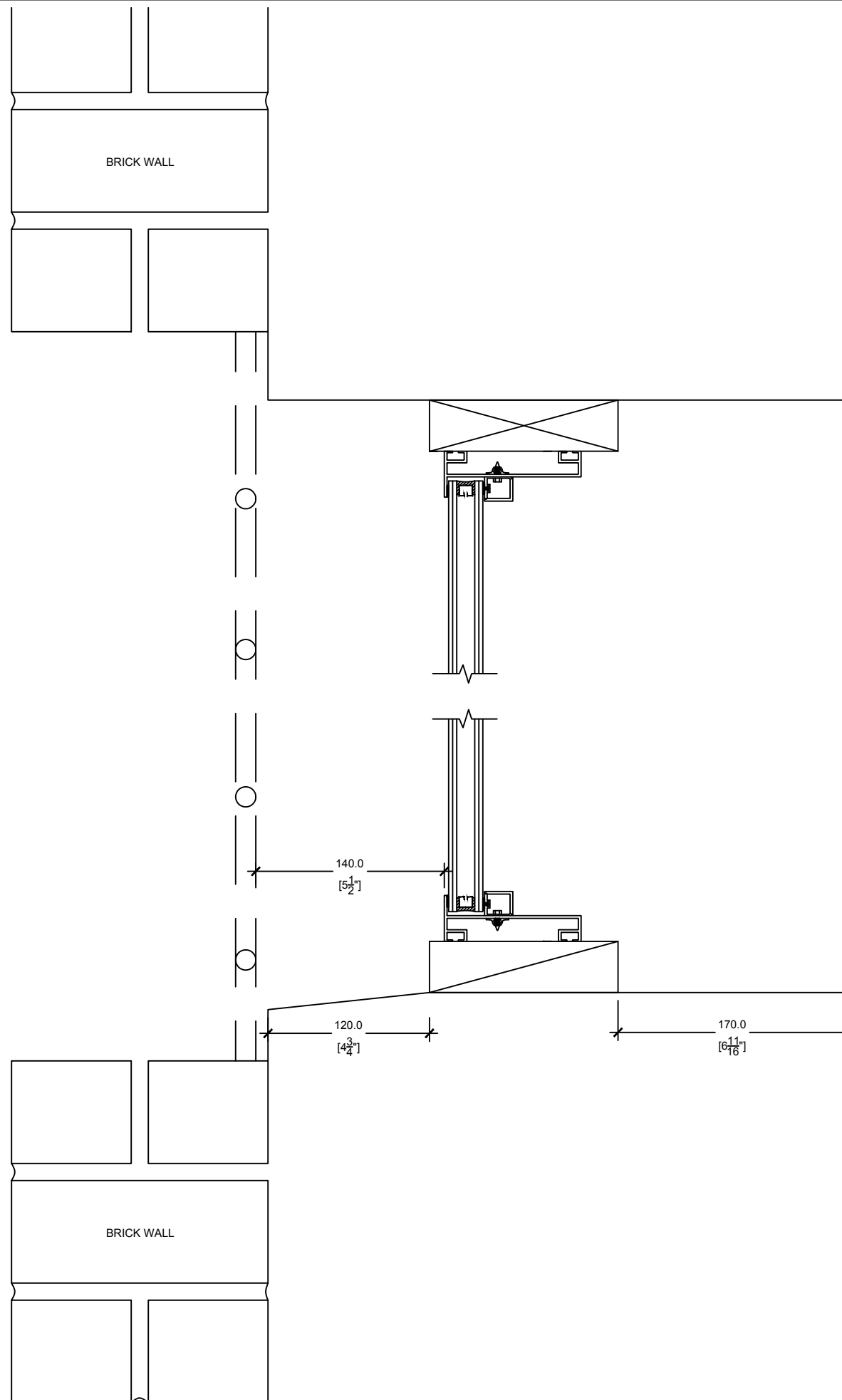

GENERAL NOTES

No.	DESCRIPTION	DD/MM/YY
1	Revision/Issue	Date

Firm Name and Address

Z:\Corcon Drawings\CORCAN Logo New.tif
 CORCAN CONSTRUCTION
 Frontenac Institution
 Kingston, Ontario

THESE DRAWINGS AND SPECIFICATIONS ARE THE PROPERTY OF THE CORRECTIONAL SERVICE OF CANADA AND SHALL NOT BE REPRODUCED, COPIED, OR USED AS THE BASIS FOR THE CONSTRUCTION, MANUFACTURE, OR SALE OF ANY ARTICLE WITHOUT THE WRITTEN PERMISSION OF THE CORRECTIONAL SERVICE OF CANADA.

CES DESSIN ET SPECIFICATION SONT LES PROPRIETES DU SERVICE CORRECTIONNEL DU CANADA ET NE DOIVENT ETRE NI PRODUIT, NI COPIES, OU NI UTILISES POUR LA FABRICATION, CONSTRUCTION, OU LA VENTE D'ARTICLE SANS LA PERMISSION DU SERVICE CORRECTIONNEL DU CANADA.

Project Name and Address

RANGE WINDOWS
 SASK PEN

FRAME SECTION VIEW

Project	Sheet
Date: 2017-10-27	101
Scale: 1:15	