

RFB

No of

Page/

N° de page

Public Works and  
Government Services  
CanadaTravaux publics et  
Services gouvernementaux  
Canada**RETURN BIDS TO:****RETOURNER LES SOUMISSIONS A:**

See Section 1.

Voir Section 1.

**STANDARD REQUEST FOR BID****INVITATION A SOUMISSIONNER - STANDARD**

The Bidder offers to provide to Canada the goods, services or both listed in the bid solicitation in accordance with the conditions set out in the bid solicitation and the prices set out in the bid.

This bid solicitation is issued in accordance with the conditions of the Supply Arrangement E60PQ-140003/.../PQ.

Le soumissionnaire offre de fournir au Canada les biens, services ou les deux énumérés dans la demande de soumissions aux conditions prévues dans la demande de soumissions et aux prix indiqués dans la soumission.

Cette demande de soumissions est émise conformément aux conditions de l'arrangement en matière d'approvisionnement E60PQ-140003/PQ

<b>Solicitation No. - N° de la demande</b>	Amendment No. - N° de modification
10171811	

<b>Solicitation closes – La demande prend fin :</b>	File No. - N° de dossier
at – à See Section 1 Voir Section 1	
on – le See Section 1 Voir Section 1	

Date of Solicitation – Date de la demande

Address inquiries to – Adresser toute demande de renseignement à :

See Section 2, Article 4.1.

Voir Section 2, Article 4.1

Destination

See Section 2, Annex A.

Voir Section 2, Annexe A.

**Instructions:****Municipal taxes are not applicable.**

Unless otherwise specified in the bid solicitation, all prices quoted must be net prices in Canadian funds including Canadian customs duties, excise taxes, must be FOB, including all delivery charges to destination(s) as indicated. The amount for Applicable Taxes is to be shown as a separate item.

**Instructions:****Les taxes municipales ne s'appliquent pas.**

Sauf indication contraire dans la demande de soumissions, tous les prix indiqués doivent être des prix nets, en dollars canadiens, comprenant les droits de douane canadiens, la taxe d'accise et doivent être FAB, y compris tous frais de livraison à la (aux) destination(s) indiqué(s). Le montant des taxes applicables doit apparaître séparément.

**Supplier Name and Address – Nom et adresse du fournisseur**

Telephone No. - N° de téléphone

Facsimile No. - N° de télécopieur

**Name and title of person authorized to sign on behalf of supplier (type or print)****Nom et titre de la personne autorisée à signer au nom du fournisseur (caractère d'impression)**

Signature : \_\_\_\_\_ Date : \_\_\_\_\_

**TABLE OF CONTENTS**

Section 1 – Invitation and Instructions to Bidders

Section 2 – Resulting Contract including a list of required goods and services

**SECTION 1 – INVITATION AND INSTRUCTIONS TO BIDDERS****Step 1. For Tier 2 and Tier 3 only (If Tier 1, skip this step and proceed with step 2)**

Is this a Manufacturer Product Specific Procurement? If yes, the IU must complete and submit the Manufacturer Product Specific form to AB. If form approved, keep copy on file and proceed with the step 2.

**Step 2.  Competitive or  Non-Competitive**

For Competitive Requirements:

The Bidder must provide the following information AFTER bid closing, if requested to do so by Canada:

- One or more of the following price justifications:
  1. a current published price list indicating the percentage discount available to Canada; or
  2. a copy of paid invoices for the like quality and quantity of the goods, services or both sold to other customers; or
  3. a price breakdown showing the cost of direct labour, direct materials, purchased items, engineering and plant overheads, general and administrative overhead, transportation, etc., and profit; or
  4. any other supporting documentation as requested by Canada.

For Non-Competitive Requirements:

The Bidder must provide the following information **WITH** the bid:

- The information requested by Canada in Annex A herein.
- One or more of the following price justifications:
  1. a current published price list indicating the percentage discount available to Canada; or
  2. a copy of paid invoices for the like quality and quantity of the goods, services or both sold to other customers; or
  3. a price breakdown showing the cost of direct labour, direct materials, purchased items, engineering and plant overheads, general and administrative overhead, transportation, etc., and profit; or
  4. any other supporting documentation as requested by Canada.

**Step 3.  General or  PSAB**

For PSAB procurement:

Canadian Content

The Supplier should propose conforming products(s) denoted as “Canadian Content” in the Supplier’s SA. Canada may preference all bids containing products(s) with this designation. (*Refer to WTCM for further information*)

---

**Terms of the RFB:**

This RFB is issued pursuant to the Supplier's Furniture for Workspaces Supply Arrangement (SA) that forms part of the series of SAs issued by PWGSC with the number E60PQ-140003/PQ. The terms and conditions in the Supplier's SA apply to and form part of this RFB. Bidders who submit a bid agree to be bound by those terms and conditions as well as the terms and conditions in this RFB.

This RFB has no security requirements.

The Bidder must provide the following information **WITH** the bid:

- The information requested by Canada in Annex A herein.

**Bid Evaluation**

An evaluation team composed of representatives of Canada will evaluate the bids.

<b>RFB Issued by:</b>	
Identified User's (IU) Department/Agency/Crown Corporation: Contact for this RFB:	See Section 2, article 4.1 below.
<b>RFB Closing - Submit Bid:</b>	
Bids must be submitted to the Contracting Authority on the date and at the time indicated below.	
By no later than date and time:	a. January 5 <sup>th</sup> , 2018 b. 14:00 Eastern Time (ET)
- To physical location (if applicable)	Mailroom / Bid Receiving Unit Department Canadian Heritage 2 <sup>nd</sup> Floor 15 Eddy, 15-2-C Gatineau, Qc K1A 0M5
<b>RFB Enquiries</b>	
Unless a different period is listed in the adjacent column, Bidders may submit enquires about the RFB to the Contracting Authority two business days prior to the RFB closing date. Enquiries received after the timeline indicated may not be answered.	

**SECTION 2 - RESULTING CONTRACT CLAUSES**

<b>1.</b>	<b>Terms and Conditions of the Contract</b>	
	The terms and conditions of Parts 6A and 6C of the Supplier's SA within the series E60PQ-140003/PQ apply to and form part of this Contract.	
<b>2.</b>	<b>Security Requirement</b> (Applies if article a. or b. is checked)	
2.1	The applicable security requirement(s) is (are) set out in the Security Requirement Check List attached as Annex B of this contract. The Contractor must fulfill the security requirements by meeting the terms below (the checked article applies).	
	a.	<b>X</b> <b>Contractor may be escorted; possession of security clearance not required.</b> Contractor personnel MAY NOT ENTER NOR PERFORM WORK ON sites where PROTECTED or CLASSIFIED information or assets are kept, without an escort provided by the department or agency for which the work is being performed.
	b.	<b>Possession of security clearance(s) is required.</b> The Contractor must meet the security clearance requirements contained in the clausing in Annex B herein.
	c.	<b>There is no security requirement associated with this contract.</b>
<b>3.</b>	<b>Requirement</b>	

3.1	The Contractor must perform the Work listed in Annex A herein.	
<b>4.</b>	<b>Authorities</b>	
<b>4.1</b>	<b>Contracting Authority</b>	
	Name:	<b>Eric Lanthier</b>
	Title:	<b>Material Management Specialist</b>
	Department/Agency/Crown Corporation:	<b>Canadian Heritage</b>
	Address:	<b>15 Eddy, 9<sup>th</sup> floor, Gatineau, QC, K1A 0M5</b>
	Telephone No.:	
	Facsimile No.:	
	E-mail address:	PCH.contrats-contracting.PCH@canada.ca
<b>4.2</b>	<b>Project Authority</b>	
	Name:	
	Title:	
	Department/Agency/Crown Corporation:	
	Address:	
	Telephone No.:	
	Facsimile No.:	
	E-mail address:	
<b>4.3</b>	<b>Contractor's Representative</b>	
	As set out in Annex A, Table 9 below.	
<b>5.</b>	<b>Payment</b>	
	Method of Payment	
	The checked box applies. If the Contractor's SA indicates acceptance for payment by credit card, that method may be used in conjunction with the following.	
	<input checked="" type="checkbox"/>	Single Payment
	<input type="checkbox"/>	Multiple Payment
<b>6.</b>	<b>Invoicing</b>	
	Further to the Invoicing terms of the WTCM document, the Contractor will deliver the original and one copy of the invoice to the following address for certification and payment:	
	Name of the organization and contact:	
	Address: <b>Canadian Heritage 41 Eddy, office 44 Gatineau, QC K1A 0M5</b>	
<b>7.</b>	<b>Defence Contract. This clause applies if the box below is checked.</b>	
	<input type="checkbox"/>	The Contract is a defense contract within the meaning of the <a href="#">Defence Production Act</a> , R.S.C. 1985, c. D-1.

**ANNEX A  
REQUIREMENT and BASIS OF PAYMENT**

- 
- 1. IU to complete an Annex A for each category with the exception of the rules specified herein.**  
**2. For Tier 2 and 3 competitive requirements, Conforming Suppliers must acquire the bid solicitation document from GETS and IUs are not to identify the Conforming Suppliers in the solicitation or NPP.**
- 

1. Category Selection

The requirement includes the following category (ies) of work:

- Category 1 – Interconnecting Panels and Freestanding Systems

**RULE: Metal Storage**

Identified Users may procure metal storage products forming part of Category 1 when combined with interconnecting panels and/or freestanding systems and if the total amount of metal storage products represent less than 20% of the value of the requirement. If this rule does not apply to the requirement, Category 3 must be used for the metal storage products forming part of this category.

- Category 2 – Freestanding Height Adjustable Desk / Table Products

**RULE: Category 1 and 2**

Category 1 and 2 can be combined for tier 2 and tier 3 requirements when Category 2 surfaces comprise no more than 50% of the total sum of work surfaces.

- Category 3 – Metal Filing and Storage Cabinets

**RULE: High Storage Products**

Identifying the maximum height of the Personal Storage Towers, Wardrobes and Storage Cabinets is acceptable when the requirement is to match existing panel systems heights. Additional storage forming part of the same requirement not incorporated into an existing panel system workstation must not specify maximum heights and added as a separate line item at article 3 of this Annex.

Maximum Height for product #(s) \_\_\_\_\_ at article 3 of this Annex is \_\_\_\_\_.

- Category 4 – Wood Veneer – Freestanding Products

- Category 5 – Ancillary and Lighting Products

- Category 6 - Support Space – Collaborative Furniture

- Product Related Services

## 2. GoCUID identification and/or floor plan(s)

2.1 For Product Related Services requirements

2.2 For Categories 1-6:

Scenario a.  Does not include a floor plan for Category 5 product.

Scenario b.  Includes floor plan(s) for Category 1 product WITH identification of product information in Annex C of this RFB.

Floor plan(s) are used for information purposes.

## 3. Product and Pricing Tables

Bidder to complete: Sections B of the tables identified by the IU in article 3 of this Annex as well as Tables 9 and 10. In a resulting contract, the term "Bid" means the Supplier's commitment, the term "Bidder" means "Contractor".

**Product Category: 1****Table 1 – Product**

Section A - IU REQUIREMENT				Section B – SUPPLIER'S BID		
#	GoCUID	Description of Product (optional field)	Qty	Supplier Part Number	Firm _____ Price** \$	Extended Total [Qty x Price] \$
1	BHNPxxxFAxxxFA36SAN PxxxFGxxxxx36	36" WIDE-SEATED PRIVACY HEIGHT NON- POWERED PANEL WITH FABRIC BOTH SIDE AND FROSTED GLAZED UPPER ELEMENT	11			
2	BHPBxxxFAxxxFA36SAN PxxxFGxxxxx36	36" WIDE-SEATED PRIVACY HEIGHT POWERED PANEL (OUTLETS LOCATED BELOW WORK SURFACE) WITH FABRIC BOTH SIDE AND FROSTED GLAZED UPPER ELEMENT	27			
3	BHNPxxxPLxxxFA36SAN PxxxFGxxxxx36	36" WIDE-SEATED PRIVACY HEIGHT NON- POWERED PANEL WITH FABRIC ONE SIDE, PLASTIC LAMINATE OTHER SIDE AND FROSTED GLAZED UPPER ELEMENT	16			
4	BHPBxxxPLxxxFA36SANP xxxFGxxxxx36	36" WIDE-SEATED PRIVACY HEIGHT POWERED PANEL (OUTLETS LOCATED BELOW WORK SURFACE) WITH FABRIC ONE SIDE, PLASTIC LAMINATE OTHER SIDE AND FROSTED GLAZED UPPER ELEMENT	27			
5	SPPTFSMxxLHFFCD6624 24	METAL CLOSED PERSONAL STORAGE TOWER (FILE, FILE), WARDROBE LEFT	15			
6	SPPTFSMxxRHFFCD6624 24	METAL CLOSED PERSONAL STORAGE TOWER (FILE, FILE), WARDROBE RIGHT	19			

7	SPLSSSLxRxxFFDOxx721 8	LAMINATE LOW STORAGE CREDENZA DRAWERS (BOX, FILE) - OPEN WITH CUSHION	27			
**Must not exceed ceiling unit price in SA.				Product Total		\$

**Table 2 - Delivery**

Section A - IU REQUIREMENT				Section B – SUPPLIER'S BID		
Product Item # from Table 1	Location	Desired Date (Y/M/D)	Desired Time: Normal Business Hours (Normal) Or Outside Normal Business Hours (Outside)*	Supplier will deliver on the date and at the time below*	Firm Price \$	Extended Total (Qty x Firm Unit Price) \$
1 to 9	Canadian Heritage 3 <sup>rd</sup> Floor 25 Eddy Street Gatineau, Quebec, K1A 0M5	2018/03/24	Saturday	(Y) (M) (D)		
*If no dates and times are added by the Supplier, the Supplier agrees to deliver on the Desired Date and Time.				Delivery Total:		\$



**Table 3 – Installation**

Section A - IU REQUIREMENT				Section B – SUPPLIER'S BID		
Product Item # from Table 1	Location	Desired Date (Y/M/D)	Desired Time: Normal Business Hours (Normal) Or Outside Normal Business Hours (Outside)*	Supplier will install on the date and at the time below*	Firm Price \$	Extended Total (Qty x Firm Unit Price) \$
1 to 9	Canadian Heritage 3 <sup>rd</sup> Floor 25 Eddy Street Gatineau, Quebec, K1A 0M5	2018/03/26- 2018/03/27	Normal	(Y) (M) (D)		
*If no dates and times are added by the Supplier, the Supplier agrees to install on the Desired Date and Time. [Normal Business Hours 8:00 – 17:00, as per SA, Annex A, article 5]				Installation Total:		\$

**Table 8 – Standard Finishes and Canada's Facilities to Accommodate the Delivery and Certifications**

<b>1.</b>	<b>Standard Finishes</b>	
1.1	IU is to consult the Supplier's Website identified in Part 6A of the SA to view the available finishes.  Within three business days of the contract award, the Contracting Authority will provide the Contractor with a written notice of Canada's finish choices for each of the product(s) in Annex A.  The Contractor will deliver the products corresponding to Canada's choice of specific finishes(s). No additional charge will be applied to Canada.	
<b>2.</b>	<b>Canada's Facilities to Accommodate the Delivery</b>	
2.1	Loading Dock/Location	
A	Location	2 Wellington, Gatineau, Qc, K1A 0H4
B	Dock	Standard size
C	Lift	yes
D	Door	
2.2	Freight Elevator	yes
2.3	Other (specify, if any)	Delivery of the furniture must be on the Saturday.
	<b>Continuance of Certifications</b>	
	The Bidder certifies that by submitting a bid in response to the RFB, the Bidder, and any of the Bidder's members if the Bidder is a Joint Venture, continues to comply with all of the certifications listed in Parts 6A and 6B of the Bidder's SA for Work Spaces, as follows:	
3.1	Integrity Provisions	
3.2	Federal Contractor's Program for Employment Equity	
3.4	Product Conformance	
3.5	Price Certification (In accordance with the SA, Part 6B)	

**Table 9 - Bid Evaluation and Contract Total (Canada may complete if not completed by the Bidder)**

1	Product Total (Table 1)	\$
2	<b>Optional</b> Product Total (Table 4)	\$ not applicable
3	Delivery Total (Table 2)	\$
4	<b>Optional</b> Delivery Total (Table 5)	\$ not applicable
5	Installation Total (Table 3)	\$
6	<b>Optional</b> Installation Total (Table 6)	\$ not applicable
7	Product Related Services Total (if applicable) (Table 7)	\$
8	Hardware Total as per article 1.5 of Annex A-1 of SA (if applicable)	\$
9	<b>Total Evaluated (Bid) Price* (1 + 2 + 3 + 4 + 5 + 6+ 7+8):</b>	\$
10	Applicable Tax(es):	\$
11	Total Estimated Cost (9+10):	\$

**Table 10 – Bidder’s Authorized Representative**

Bidder’s Authorized Representative for the Bid and the Contract		
1.	Name:	Telephone:
		E-Mail:
		Other:

**Product Category: 2****Table 1 – Product**

Section A - IU REQUIREMENT				Section B – SUPPLIER'S BID		
#	GoCUID	Description of Product (optional field)	Qty	Supplier Part Number	Firm Price** \$	Extended Total [Qty x Price] \$
1	FSCAEA5430	54X30 – ELECTRICALLY ASSISTED, SIT/STAND RANGE HEIGHT ADJUSTABLE WORK SURFACES	30			
2	FSCAEA5430	54X30 – ELECTRICALLY ASSISTED, SIT/STAND RANGE HEIGHT ADJUSTABLE WORK SURFACES	21			
3	FSCAEA5430	54X30 – ELECTRICALLY ASSISTED, SIT/STAND RANGE HEIGHT ADJUSTABLE WORK SURFACES	10			
**Must not exceed ceiling unit price in SA.				Product Total		\$

**Table 2 - Delivery**

Section A - IU REQUIREMENT				Section B – SUPPLIER'S BID		
Product Item # from Table 1	Location	Desired Date (Y/M/D)	Desired Time: Normal Business Hours (Normal) Or Outside Normal Business Hours (Outside)*	Supplier will deliver on the date and at the time below*	Firm Price \$	Extended Total (Qty x Firm Unit Price) \$
1	Canadian Heritage 25 Eddy Street	2018/3/24	Saturday	(Y) (M)		

	3rd floor Gatineau, QC, K1A 0M5			(D)		
2	Canadian Heritage 25 Eddy Street 10th floor Gatineau, QC, K1A 0M5	2018/3/24	Saturday	(Y) (M) (D)		
3	Canadian Heritage 41 Eddy Street Gatineau, QC, K1A 0M5	2018/3/24	Saturday	(Y) (M) (D)		
*If no dates and times are added by the Supplier, the Supplier agrees to deliver on the Desired Date and Time.					Delivery Total:	\$

Table 3 – Installation

Section A - IU REQUIREMENT				Section B – SUPPLIER'S BID		
Product Item # from Table 1	Location	Desired Date (Y/M/D)	Desired Time: Normal Business Hours (Normal) Or Outside Normal Business Hours (Outside)*	Supplier will install on the date and at the time below*	Firm Price \$	Extended Total (Qty x Firm Unit Price) \$
1	Canadian Heritage 25 Eddy Street 3rd floor Gatineau, QC, K1A 0M5	2018/03/26- 2018/03/27	Normal	(Y) (M) (D)		
2	Canadian Heritage 25 Eddy Street 10th floor Gatineau, QC, K1A 0M5	2018/03/26- 2018/03/27	Normal	(Y) (M) (D)		
3	Canadian Heritage 41 Eddy Street Gatineau, QC, K1A 0M5	2018/03/26- 2018/03/27	Normal	(Y) (M) (D)		
*If no dates and times are added by the Supplier, the Supplier agrees to install on the Desired Date and Time. [Normal Business Hours 8:00 – 17:00, as per SA, Annex A, article 5]				Installation Total:		\$

**Table 8 – Standard Finishes and Canada’s Facilities to Accommodate the Delivery and Certifications**

<b>1.</b>	<b>Standard Finishes</b>	
1.1	IU is to consult the Supplier’s Website identified in Part 6A of the SA to view the available finishes.  Within three business days of the contract award, the Contracting Authority will provide the Contractor with a written notice of Canada’s finish choices for each of the product(s) in Annex A.  The Contractor will deliver the products corresponding to Canada’s choice of specific finishes(s). No additional charge will be applied to Canada.	
<b>2.</b>	<b>Canada’s Facilities to Accommodate the Delivery</b>	
2.1	Loading Dock/Location	
A	Location	2 Wellington, Gatineau, Qc, K1A 0H4
B	Dock	Standard size
C	Lift	yes
D	Door	
2.2	Freight Elevator	Yes
2.3	Other (specify, if any)	Delivery must be on the Saturday
	<b>Continuance of Certifications</b>	
	The Bidder certifies that by submitting a bid in response to the RFB, the Bidder, and any of the Bidder’s members if the Bidder is a Joint Venture, continues to comply with all of the certifications listed in Parts 6A and 6B of the Bidder’s SA for Work Spaces, as follows:	
3.1	Integrity Provisions	
3.2	Federal Contractor’s Program for Employment Equity	
3.4	Product Conformance	
3.5	Price Certification (In accordance with the SA, Part 6B)	

**Table 9 - Bid Evaluation and Contract Total (Canada may complete if not completed by the Bidder)**

1	Product Total (Table 1)	\$
2	<b>Optional</b> Product Total (Table 4)	\$ not applicable
3	Delivery Total (Table 2)	\$
4	<b>Optional</b> Delivery Total (Table 5)	\$ not applicable
5	Installation Total (Table 3)	\$
6	<b>Optional</b> Installation Total (Table 6)	\$ not applicable
7	Product Related Services Total (if applicable) (Table 7)	\$
8	Hardware Total as per article 1.5 of Annex A-1 of SA (if applicable)	\$
9	<b>Total Evaluated (Bid) Price* (1 + 2 + 3 + 4 + 5 + 6+ 7+8):</b>	\$\$
10	Applicable Tax(es):	\$
11	Total Estimated Cost (9+10):	\$

**Table 10 – Bidder’s Authorized Representative**

<b>Table 6 – Bidder’s Authorized Representative</b>		
1.	Bidder’s Authorized Representative for the Bid and the Contract	
	Name:	Telephone:
		E-Mail:
		Other:

**Product Category: 3****Table 1 – Product**

Section A - IU REQUIREMENT				Section B – SUPPLIER'S BID		
#	GoCUID	Description of Product (optional field)	Qty	Supplier Part Number	Firm Price** \$	Extended Total [Qty x Price] \$
1	LLFC3DFDxxx1836xxxx	LATERAL METAL 3 FIXED FRONT DRAWERS CABINETS	20			
**Must not exceed ceiling unit price in SA.				Product Total		\$

**Table 2 - Delivery**

Section A - IU REQUIREMENT				Section B – SUPPLIER'S BID		
Product Item # from Table 1	Location	Desired Date (Y/M/D)	Desired Time: Normal Business Hours (Normal) Or Outside Normal Business Hours (Outside)*	Supplier will deliver on the date and at the time below*	Firm Price \$	Extended Total (Qty x Firm Unit Price) \$
1	Canadian Heritage 25 Eddy Street 3rd floor Gatineau, QC, K1A 0M5	2018/3/24	Saturday	(Y) (M) (D)		
*If no dates and times are added by the Supplier, the Supplier agrees to deliver on the Desired Date and Time.				Delivery Total:		\$

**Table 3 – Installation**

Section A - IU REQUIREMENT				Section B – SUPPLIER'S BID		
Product Item # from Table 1	Location	Desired Date (Y/M/D)	Desired Time: Normal Business Hours (Normal) Or Outside Normal Business Hours (Outside)*	Supplier will install on the date and at the time below*	Firm Price \$	Extended Total (Qty x Firm Unit Price) \$
1	Canadian Heritage 25 Eddy Street 3rd floor Gatineau, QC, K1A 0M5	2018/03/26- 2018/03/27	Normal	(Y) (M) (D)		
*If no dates and times are added by the Supplier, the Supplier agrees to install on the Desired Date and Time. [Normal Business Hours 8:00 – 17:00, as per SA, Annex A, article 5]				Installation Total:		\$

**Table 8 – Standard Finishes and Canada's Facilities to Accommodate the Delivery and Certifications**

<b>1.</b>	<b>Standard Finishes</b>	
1.1	IU is to consult the Supplier's Website identified in Part 6A of the SA to view the available finishes.  Within three business days of the contract award, the Contracting Authority will provide the Contractor with a written notice of Canada's finish choices for each of the product(s) in Annex A.  The Contractor will deliver the products corresponding to Canada's choice of specific finishes(s). No additional charge will be applied to Canada.	
<b>2.</b>	<b>Canada's Facilities to Accommodate the Delivery</b>	
2.1	Loading Dock/Location	
A	Location	2 Wellington, Gatineau, Qc, K1A 0H4
B	Dock	Standard size
C	Lift	yes
D	Door	
2.2	Freight Elevator	Yes
2.3	Other (specify, if any)	Delivery of furniture must be on Saturday
	<b>Continuance of Certifications</b>	
	The Bidder certifies that by submitting a bid in response to the RFB, the Bidder, and any of the Bidder's members if the Bidder is a Joint Venture, continues to comply with all of the certifications listed in Parts 6A and 6B of the Bidder's SA for Work Spaces, as follows:	

3.1	Integrity Provisions
3.2	Federal Contractor's Program for Employment Equity
3.4	Product Conformance
3.5	Price Certification (In accordance with the SA, Part 6B)

**Table 9 - Bid Evaluation and Contract Total (Canada may complete if not completed by the Bidder)**

1	Product Total (Table 1)	\$
2	<b>Optional</b> Product Total (Table 4)	\$ not applicable
3	Delivery Total (Table 2)	\$
4	<b>Optional</b> Delivery Total (Table 5)	\$ not applicable
5	Installation Total (Table 3)	\$
6	<b>Optional</b> Installation Total (Table 6)	\$ not applicable
7	Product Related Services Total (if applicable) (Table 7)	\$
8	Hardware Total as per article 1.5 of Annex A-1 of SA (if applicable)	\$
9	<b>Total Evaluated (Bid) Price* (1 + 2 + 3 + 4 + 5 + 6+ 7+8):</b>	\$\$
10	Applicable Tax(es):	\$
11	Total Estimated Cost (9+10):	\$

**Table 10 – Bidder's Authorized Representative**

Bidder's Authorized Representative for the Bid and the Contract		
1.	Name:	Telephone:
		E-Mail:
		Other:



**Product Category: 6****Table 1 – Product**

Section A - IU REQUIREMENT				Section B – SUPPLIER'S BID		
#	GoCUID	Description of Product (optional field)	Qty	Supplier Part Number	Firm _____ Price** \$	Extended Total [Qty x Price] \$
1	TRFTPTARNILTSLPCW6 0xxNILNIL30xx	30x60 LAMINATE FLIP- TOP TRAINING TABLES, T LEGS WITH CASTERS	5			
2	TTPCCPLHBPDTSSSED 72xx3642NIL36xx	36x72 LAMINATE BAR HEIGHT FULL TABLE DEPTH END GABLES, STRAIGHT EDGE PROFILE, NO POWER	1			
3	TTPCCPLHBPDTSSAED 96xx3642NIL36xx	36x96 LAMINATE BAR HEIGHT FULL TABLE DEPTH END GABLES, STRAIGHT EDGE PROFILE, WITH POWER	1			
4	MAPWAVPWTTANILSLNI L36xx66xxNIL24xx	24x36x66H LAMINATE 2 DOOR STORAGE CABINETS	2			
5	SCNTDTSBRPFSAWNIL NILPPNNILNILNILNIL	BAR HEIGHT NON- PERFORATED MOLDED SLED BASE STOOLS WITHOUT ARMS, FOOTREST	10			
**Must not exceed ceiling unit price in SA.				Product Total		\$

Table 2 - Delivery

Section A - IU REQUIREMENT				Section B – SUPPLIER'S BID		
Product Item # from Table 1	Location	Desired Date (Y/M/D)	Desired Time: Normal Business Hours (Normal) Or Outside Normal Business Hours (Outside)*	Supplier will deliver on the date and at the time below*	Firm Price \$	Extended Total (Qty x Firm Unit Price) \$
1	Canadian Heritage 25 Eddy Street 3rd floor Gatineau, QC, K1A 0M5	2018/3/24	Saturday	(Y) (M) (D)		
*If no dates and times are added by the Supplier, the Supplier agrees to deliver on the Desired Date and Time.				Delivery Total:		\$

Table 3 – Installation

Section A - IU REQUIREMENT				Section B – SUPPLIER'S BID		
Product Item # from Table 1	Location	Desired Date (Y/M/D)	Desired Time: Normal Business Hours (Normal) Or Outside Normal Business Hours (Outside)*	Supplier will install on the date and at the time below*	Firm Price \$	Extended Total (Qty x Firm Unit Price) \$
1	Canadian Heritage 25 Eddy Street 3rd floor Gatineau, QC, K1A 0M5	2018/03/26- 2018/03/27	Normal	(Y) (M) (D)		
*If no dates and times are added by the Supplier, the Supplier agrees to install on the Desired Date and Time. [Normal Business Hours 8:00 – 17:00, as per SA, Annex A, article 5]				Installation Total:		\$

**Table 8 – Standard Finishes and Canada’s Facilities to Accommodate the Delivery and Certifications**

<b>1.</b>	<b>Standard Finishes</b>	
1.1	IU is to consult the Supplier’s Website identified in Part 6A of the SA to view the available finishes.  Within three business days of the contract award, the Contracting Authority will provide the Contractor with a written notice of Canada’s finish choices for each of the product(s) in Annex A.  The Contractor will deliver the products corresponding to Canada’s choice of specific finishes(s). No additional charge will be applied to Canada.	
<b>2.</b>	<b>Canada’s Facilities to Accommodate the Delivery</b>	
2.1	Loading Dock/Location	
A	Location	2 Wellington, Gatineau, Qc, K1A 0H4
B	Dock	Standard size
C	Lift	yes
D	Door	
2.2	Freight Elevator	yes
2.3	Other (specify, if any)	
	<b>Continuance of Certifications</b>	
	The Bidder certifies that by submitting a bid in response to the RFB, the Bidder, and any of the Bidder’s members if the Bidder is a Joint Venture, continues to comply with all of the certifications listed in Parts 6A and 6B of the Bidder’s SA for Work Spaces, as follows:	
3.1	Integrity Provisions	
3.2	Federal Contractor’s Program for Employment Equity	
3.4	Product Conformance	
3.5	Price Certification (In accordance with the SA, Part 6B)	

**Table 9 - Bid Evaluation and Contract Total (Canada may complete if not completed by the Bidder)**

1	Product Total (Table 1)	\$
2	<b>Optional</b> Product Total (Table 4)	\$ not applicable
3	Delivery Total (Table 2)	\$
4	<b>Optional</b> Delivery Total (Table 5)	\$ not applicable
5	Installation Total (Table 3)	\$
6	<b>Optional</b> Installation Total (Table 6)	\$ not applicable
7	Product Related Services Total (if applicable) (Table 7)	\$
8	Hardware Total as per article 1.5 of Annex A-1 of SA (if applicable)	\$
9	<b>Total Evaluated (Bid) Price* (1 + 2 + 3 + 4 + 5 + 6+ 7+8):</b>	\$\$
10	Applicable Tax(es):	\$
11	Total Estimated Cost (9+10):	\$

**Table 10 – Bidder’s Authorized Representative**

1.	Bidder’s Authorized Representative for the Bid and the Contract	
	Name:	Telephone:
		E-Mail:
		Other:

## ANNEX C FLOOR PLANS(s)

*Typical cubicle layout:*

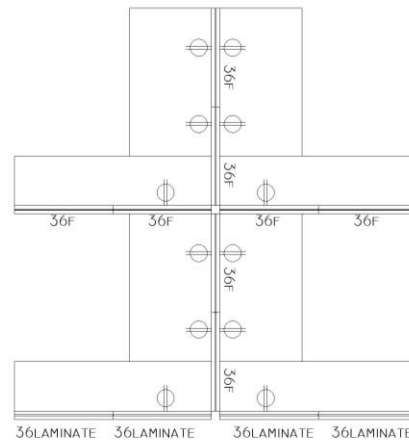

LAMINATE PANELS ON  
CORRIDOR SIDE

### 1) Product Descriptions

- a. All panels: Seated Privacy Add-on Height;
- b. Type of power feeds: must be ceiling feeds (power poles).

**36F** = 36" WIDE-SEATED PRIVACY HEIGHT WITH FABRIC BOTH SIDES AND FROSTED GLAZED UPPER ELEMENT

**36LAMINATE** = 36" WIDE-SEATED PRIVACY HEIGHT WITH FABRIC ONE SIDE, LAMINATE CORRIDOR SIDE AND FROSTED GLAZED UPPER ELEMENT

**NOTE:** ALL PANELS ARE 36" WIDE-SEATED PRIVACY HEIGHT WITH FRAMELESS FROSTED GLAZED UPPER ELEMENT.

**PLAN**

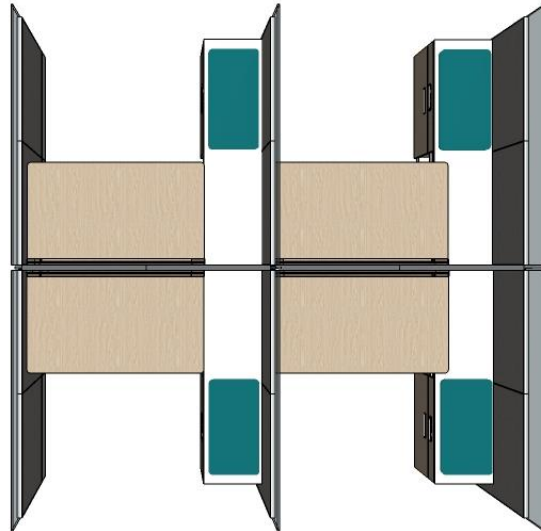

**PERSPECTIVE VIEW: CORRIDOR SIDE**

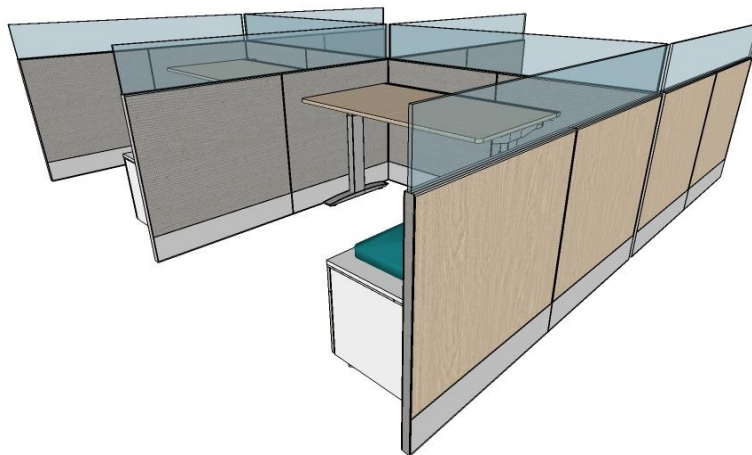

**PERSPECTIVE VIEW: SHOWING ELECTRICAL OUTLETS LOCATED BELOW WORK SURFACE**

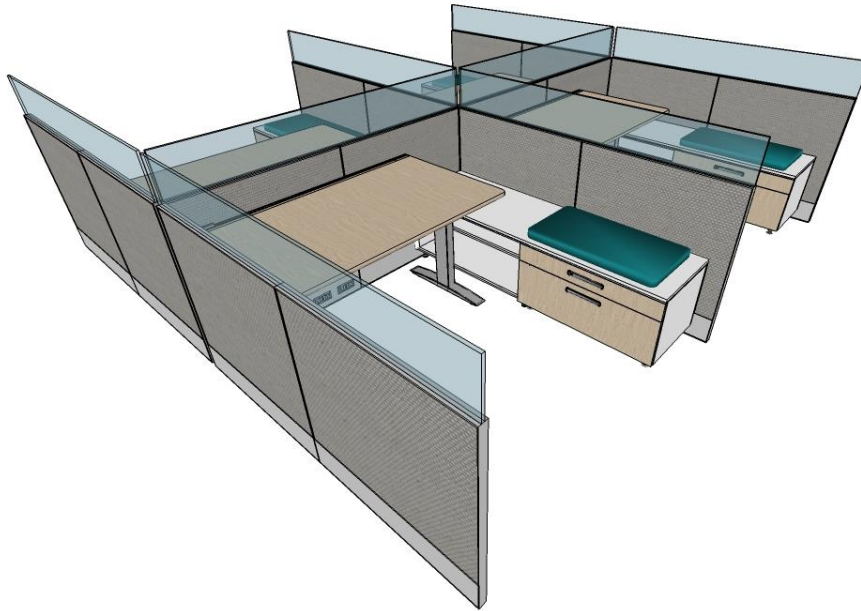

Floor plan:

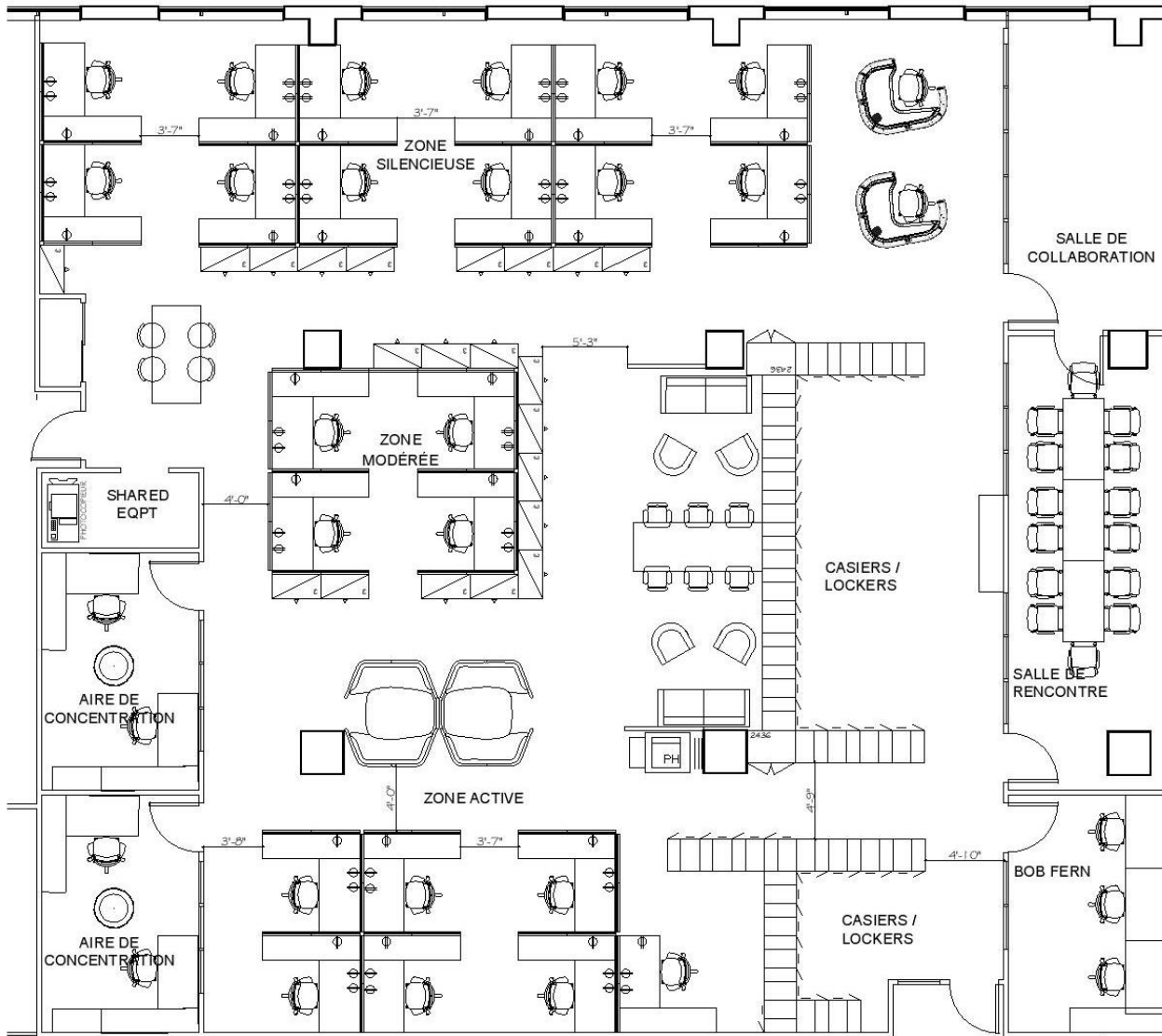

**Panel Matrix**

Panel Matrix A: Fabric both sides with frosted glazed upper element

Seated Privacy height non-powered panels:

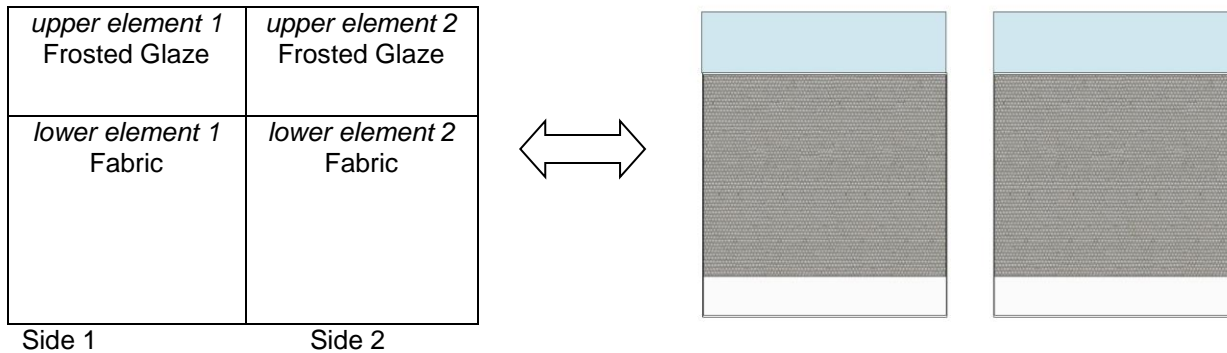

Panel Matrix B: Fabric both sides with frosted glazed upper element

Seated Privacy height powered panels one side:

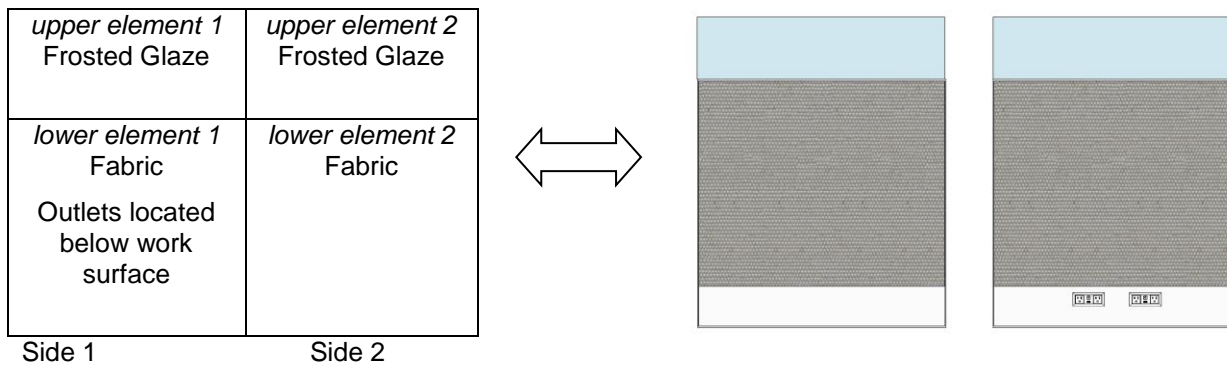

Panel Matrix C: Fabric both sides with frosted glazed upper element

Seated Privacy height powered panels on both sides:

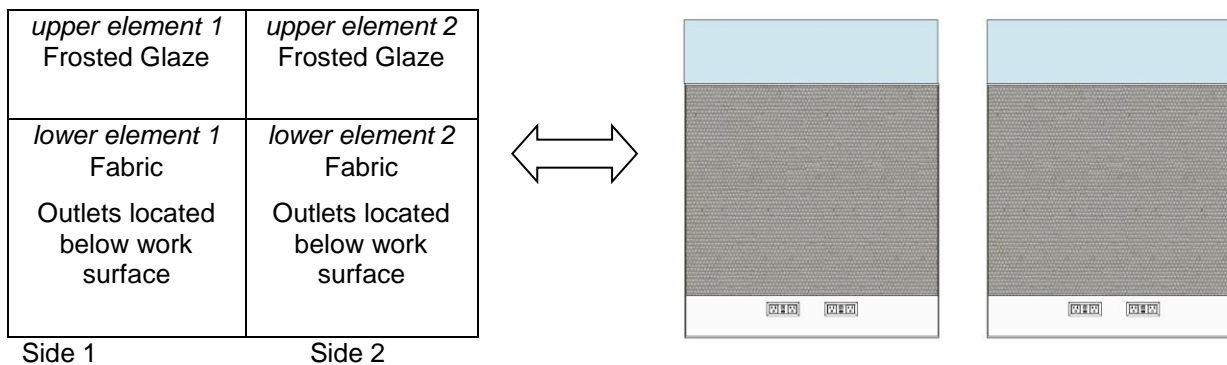



Panel Matrix D: Fabric on one side and Plastic Laminate on the other side.

Seated Privacy height non-powered panels:

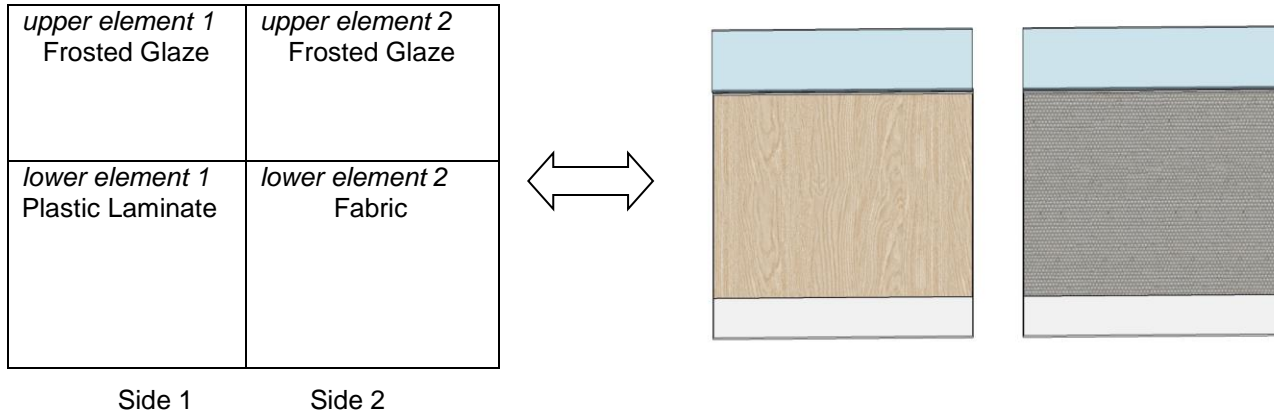

Panel Matrix E: Fabric on one side and Plastic Laminate on the other side.

Seated Privacy height powered panels:

