



**RETURN BIDS TO:**  
**RETOURNER LES SOUMISSIONS À:**

**Bid Receiving**  
**PWGSC**  
**33 City Centre Drive**  
**Suite 480C**  
**Mississauga**  
**Ontario**  
**L5B 2N5**  
**Bid Fax: (905) 615-2095**

**REQUEST FOR PROPOSAL**  
**DEMANDE DE PROPOSITION**

**Proposal To: Public Works and Government Services Canada**

We hereby offer to sell to Her Majesty the Queen in right of Canada, in accordance with the terms and conditions set out herein, referred to herein or attached hereto, the goods, services, and construction listed herein and on any attached sheets at the price(s) set out therefor.

**Proposition aux: Travaux Publics et Services Gouvernementaux Canada**

Nous offrons par la présente de vendre à Sa Majesté la Reine du chef du Canada, aux conditions énoncées ou incluses par référence dans la présente et aux annexes ci-jointes, les biens, services et construction énumérés ici sur toute feuille ci-annexée, au(x) prix indiqué(s).

**Comments - Commentaires**

**Vendor/Firm Name and Address**

**Raison sociale et adresse du fournisseur/de l'entrepreneur**

**Issuing Office - Bureau de distribution**

Public Works and Government Services Canada  
Ontario Region  
33 City Centre Drive  
Suite 480  
Mississauga  
Ontario  
L5B 2N5

<b>Title - Sujet</b> Office Furniture	
<b>Solicitation No. - N° de l'invitation</b> EQ754-182273/A	<b>Date</b> 2018-01-02
<b>Client Reference No. - N° de référence du client</b> EQ754-182273	
<b>GETS Reference No. - N° de référence de SEAG</b> PW-\$TOR-008-7453	
<b>File No. - N° de dossier</b> TOR-7-40129 (008)	<b>CCC No./N° CCC - FMS No./N° VME</b>
<b>Solicitation Closes - L'invitation prend fin</b> <b>at - à 02:00 PM</b> <b>on - le 2018-01-18</b>	<b>Time Zone</b> <b>Fuseau horaire</b> Eastern Standard Time EST
<b>F.O.B. - F.A.B.</b> <b>Plant-Usine:</b> <input type="checkbox"/> <b>Destination:</b> <input checked="" type="checkbox"/> <b>Other-Autre:</b> <input type="checkbox"/>	
<b>Address Enquiries to: - Adresser toutes questions à:</b> Leslie, Sandra	<b>Buyer Id - Id de l'acheteur</b> tor008
<b>Telephone No. - N° de téléphone</b> (905) 615-2069 ( )	<b>FAX No. - N° de FAX</b> ( ) -
<b>Destination - of Goods, Services, and Construction:</b> <b>Destination - des biens, services et construction:</b> DEPARTMENT OF PUBLIC WORKS AND GOVERNMENT SERVICES CANADA INAC 655 Bay Street Toronto Ontario M5G 1E5 Canada	

**Instructions: See Herein**

**Instructions: Voir aux présentes**

<b>Delivery Required - Livraison exigée</b> See Herein	<b>Delivery Offered - Livraison proposée</b>
<b>Vendor/Firm Name and Address</b> <b>Raison sociale et adresse du fournisseur/de l'entrepreneur</b>	
<b>Telephone No. - N° de téléphone</b> <b>Facsimile No. - N° de télécopieur</b>	
<b>Name and title of person authorized to sign on behalf of Vendor/Firm (type or print)</b> <b>Nom et titre de la personne autorisée à signer au nom du fournisseur/ de l'entrepreneur (taper ou écrire en caractères d'imprimerie)</b>	
<b>Signature</b>	<b>Date</b>

Sollicitation No. - N° de l'invitation  
EQ754-182273/A  
Client Ref. No. - N° de réf. du client  
EQ754-182273/A

Amd. No. - N° de la modif.  
File No. - N° du dossier  
TOR-7-40129

Buyer ID - Id de l'acheteur  
TOR008  
CCC No./N° CCC - FMS No./N° VME

## TABLE OF CONTENTS

Section 1 – Invitation and Instructions to Bidders

Section 2 – Resulting Contract including a list of required goods and services

### SECTION 1 – INVITATION AND INSTRUCTIONS TO BIDDERS

**NOTE: Only one contract may be awarded for each Product Category**

#### **Step 1. For Tier 2 and Tier 3 only (If Tier 1, skip this step and proceed with step 2)**

Is this a Manufacturer Product Specific Procurement? If yes, the IU must complete and submit the Manufacturer Product Specific form to AB. If form approved, keep copy on file and proceed with the step 2.

#### **Step 2. ☒ Competitive or ☐ Non-Competitive**

For Competitive Requirements:

The Bidder must provide the following information AFTER bid closing, if requested to do so by Canada:

- One or more of the following price justifications:
  - a current published price list indicating the percentage discount available to Canada; or
  - a copy of paid invoices for the like quality and quantity of the goods, services or both sold to other customers; or
  - a price breakdown showing the cost of direct labour, direct materials, purchased items, engineering and plant overheads, general and administrative overhead, transportation, etc., and profit; or
  - any other supporting documentation as requested by Canada.

#### **Step 3. ☐ General or ☒ PSAB**

##### **Terms of the RFB:**

This RFB is issued pursuant to the Supplier's Furniture for Workspaces Supply Arrangement (SA) that forms part of the series of SAs issued by PWGSC with the number E60PQ-140003/PQ. The terms and conditions in the Supplier's SA apply to and form part of this RFB. Bidders who submit a bid agree to be bound by those terms and conditions as well as the terms and conditions in this RFB.

The Bidder must provide the following information **WITH** the bid:

- The information requested by Canada in Annex A herein.

##### **Bid Evaluation**

RFB Issued by:		
Identified User's (IU) Department/Agency/Crown Corporation:	See Section 2, article 4.1 below.	
Contact for this RFB:		
RFB Closing - Submit Bid:		
Bids must be submitted to the Contracting Authority on the date and at the time indicated below.		
By no later than date and time:	See page 1 of solicitation	
- To physical location (if applicable)	See page 1 of solicitation	
RFB Enquiries		
Unless a different period is listed in the adjacent column, Bidders may submit enquires about the RFB to the Contracting Authority two business days prior to the RFB closing date. Enquiries received after the timeline indicated may not be answered.		5 business days

Sollicitation No. - N° de l'invitation  
EQ754-182273/A  
Client Ref. No. - N° de réf. du client  
EQ754-182273/A

Amd. No. - N° de la modif.  
File No. - N° du dossier  
TOR-7-40129

Buyer ID - Id de l'acheteur  
TOR008  
CCC No./N° CCC - FMS No./N° VME

## SECTION 2 - RESULTING CONTRACT CLAUSES

<b>1.</b>	<b>Terms and Conditions of the Contract</b>	
	The terms and conditions of Parts 6A and 6C of the Supplier's SA within the series E60PQ-140003/PQ apply to and form part of this Contract.	
<b>2.</b>	<b>Security Requirement</b> (Applies if article a. or b. is checked)	
2.1	The applicable security requirement(s) is (are) set out in the Security Requirement Check List attached as Annex B of this contract. The Contractor must fulfill the security requirements by meeting the terms below (the checked article applies).	
a.	<input type="checkbox"/>	<b>Contractor may be escorted; possession of security clearance not required.</b> Contractor personnel MAY NOT ENTER NOR PERFORM WORK ON sites where PROTECTED or CLASSIFIED information or assets are kept, without an escort provided by the department or agency for which the work is being performed.
b.	<input type="checkbox"/>	<b>Possession of security clearance(s) is required.</b> The Contractor must meet the security clearance requirements contained in the clausling in Annex B herein.
c.	<input checked="" type="checkbox"/>	<b>There is no security requirement associated with this contract.</b>
<b>3.</b>	<b>Requirement</b>	
3.1	The Contractor must perform the Work listed in Annex A herein.	
<b>4.</b>	<b>Authorities</b>	
4.1	<b>Contracting Authority</b>	
	Name:	<b>Sandra Leslie</b>
	Title:	<b>Supply Specialist</b>
	Department/Agency/Crown Corporation:	Public Works and Government Services Canada
	Address:	33 City Centre Drive, Suite 480C, Mississauga, ON. L5B 2N5
	Telephone No.:	905-615-2069
	E-mail address:	Sandra.Leslie2@pwgsc-tpsgc.gc.ca
4.2	<b>Project Authority [To be completed upon contract award]</b>	
	Name:	
	Title:	
	Department/Agency/Crown Corporation:	
	Address:	
	Telephone No.:	
	Facsimile No.:	
	E-mail address:	
4.3	<b>Contractor's Representative</b>	
	As set out in Annex A, Table 10 below.	
<b>5.</b>	<b>Payment</b>	
	Method of Payment	
	The checked box applies. If the Contractor's SA indicates acceptance for payment by credit card, that method may be used in conjunction with the following.	
	<input type="checkbox"/>	Single Payment
	<input checked="" type="checkbox"/>	Multiple Payment
<b>6.</b>	<b>Defence Contract. This clause applies if the box below is checked.</b>	
	<input type="checkbox"/>	The Contract is a defence contract within the meaning of the <a href="#">Defence Production Act</a> , R.S.C. 1985, c. D-1.

Sollicitation No. - N° de l'invitation  
EQ754-182273/A  
Client Ref. No. - N° de réf. du client  
EQ754-182273/A

Amd. No. - N° de la modif.  
File No. - N° du dossier  
TOR-7-40129

Buyer ID - Id de l'acheteur  
TOR008  
CCC No./N° CCC - FMS No./N° VME

**ANNEX A**  
**REQUIREMENT and BASIS OF PAYMENT**

---

**1. Category Selection**

The requirement includes the following category (ies) of work:

- a. ☒ Category 1 – Interconnecting Panels and Freestanding Systems

**RULE: Metal Storage**

Identified Users may procure metal storage products forming part of Category 1 when combined with interconnecting panels and/or freestanding systems and if the total sum of metal storage products represent less than 20% of the requirement. If this rule does not apply to the requirement, Category 3 must be used for the metal storage products forming part of this category.

☐ Category 1 Non-SA (NSA) products forming part of this requirement, refer to Annex C of this RFB  
(approval by AB required before adding to requirement)

- b. ☒ Category 2 – Freestanding Height Adjustable Desk / Table Products

**RULE: Category 1 and 2**

Category 1 and 2 can be combined for tier 2 and tier 3 requirements when Category 2 surfaces comprise no more than 50% of the total sum of work surfaces.

☐ Category 2 Non-SA (NSA) products forming part of this requirement, refer to Annex C of this RFB  
(approval by AB required before adding to requirement)

- c. ☒ Category 3 – Metal Filing and Storage Cabinets

**RULE: High Storage Products**

Identifying the maximum height of the Personal Storage Towers, Wardrobes and Storage Cabinets is acceptable when the requirement is to match existing panel systems heights forming part of an existing inventory. Additional storage forming part of the same requirement not incorporated into an existing panel system workstation must not specify maximum heights and added as a separate line item at article 3 of this Annex.

Maximum Height for product #(s) \_\_\_\_\_ at article 3 of this Annex is \_\_\_\_\_.

☐ Category 3 Non-SA (NSA) products forming part of this requirement, refer to Annex C of this RFB  
(approval by AB required before adding to requirement)

- d. ☒ Category 4 – Wood Veneer – Freestanding Products

☐ Category 4 Non-SA (NSA) products forming part of this requirement, refer to Annex C of this RFB  
(approval by AB required before adding to requirement)

- e. ☒ Category 5 – Ancillary and Lighting Products

☐ Category 5 Non-SA (NSA) products forming part of this requirement, refer to Annex C of this RFB  
(approval by AB required before adding to requirement)

- f. ☒ Category 6 - Support Space – Collaborative Furniture

Sollicitation No. - N° de l'invitation  
EQ754-182273/A  
Client Ref. No. - N° de réf. du client  
EQ754-182273/A

Amd. No. - N° de la modif.  
File No. - N° du dossier  
TOR-7-40129

Buyer ID - Id de l'acheteur  
TOR008  
CCC No./N° CCC - FMS No./N° VME

**RULE 1:** Category 6 can be further subdivided by space or like item in order to increase or allow competition. Space is defined as a location available for a particular purpose such as a meeting room space or a collaborative space. Like items are defined as products with similar design and construction.

**RULE 2:** Clients may exercise an option to upgrade products up to 15% of the Category 6 product total before applicable taxes after contract award for Category 6 products.

The Design Upgrade amount is used at the discretion of the Project Authority (PA). Within ten business days of the contract award, the PA will provide the Contractor with a written notice of Canada's Design Upgrade choices for each of the product(s) to be upgraded in Category 6, Annex A. The Contractor will provide the pricing of the upgraded product(s) to a maximum of 15% of Category 6 Product Total of Table 9 at Article 1. The Contracting Authority will issue an amendment to the contract with the Design Upgrades and pricing.

The Supplier certifies that all the Design Upgraded products offered will conform to all specifications and meet the testing requirements detailed in the Specifications of the Supply Arrangement.

Design Upgrade: is the process of replacing a product with a more innovative or enhanced version of the same product/series.

☐ Category 6 Non-SA (NSA) products forming part of this requirement, refer to Annex C of this RFB (approval by AB required before adding to requirement)

g. ☐ Product Related Services

## 2. GoCUID identification and/or floor plan(s)

2.1 For Product Related Services requirements

2.2 For Categories 1-6:

Scenario a. ☐ Does not include a floor plan – Category(ies) \_\_\_\_\_

Scenario b. ☒ Includes floor plan(s) WITH identification of product information in Annex C of this RFB. Category(ies) 1A, 1B, 2, 3, 4, 5, and 6.

Floor plan(s) are used for information purposes

Refer to Annex A article 4 of the SA for Site inspection and Documentation instructions after contract award.

Site Inspection Date: \_\_\_\_\_ (to be completed at contract award)

## 3. Product and Pricing Tables

**Bidder to complete:** Sections B of the tables identified by the IU in article 3 of this Annex as well as Tables 9 and 10. In a resulting contract, the term "Bid" means the Supplier's commitment, the term "Bidder" means "Contractor".

Sollicitation No. - N° de l'invitation  
EQ754-182273/A  
Client Ref. No. - N° de réf. du client  
EQ754-182273/A

Amd. No. - N° de la modif.  
File No. - N° du dossier  
TOR-7-40129

Buyer ID - Id de l'acheteur  
TOR008  
CCC No./N° CCC - FMS No./N° VME

**PRODUCT CATEGORY: 1A - INTERCONNECTING PANELS AND FREESTANDING SYSTEMS**

**Table 1 – Product (Only applicable for Scenario A procurements)**

Section A - IU REQUIREMENT				Section B – SUPPLIER'S BID		
#	GoCUI D	Description of Product (optional field)	Qty	Supplier Part Number	Firm _____ Price** \$	Extended Total [Qty x Price] \$
1		Seated Privacy Height Non Powered Lower Element 1 - Fabric Lower Element 2 - Fabric Upper Element 1 - Tackable Surface Upper Element 2 - Tackable Surface 610 mm (24 inch) Panel	405			
2		Seated Privacy Height Non Powered Lower Element 1 - Fabric Lower Element 2 - Fabric Upper Element 1 - Tackable Surface Upper Element 2 - Tackable Surface 914mm (36 inch) Panel	235			
3		Seated Privacy Height Non Powered Lower Element 1 - Fabric Lower Element 2 - Fabric Upper Element 1 - Tackable Surface Upper Element 2 - White Board 610 mm (24 inch) Panel	229			
4		Seated Privacy Height Non Powered Lower Element 1 - Fabric Lower Element 2 - Fabric Upper Element 1 - Tackable Surface Upper Element 2 - White Board 1219mm (48 inch) Panel	77			
5		Seated Privacy Height Powered Outlets Below the Work Surface Lower Element 1 - Cut-outs for Power & Data, Fabric Lower Element 2 - Fabric Upper Element 1 - Tackable Surface Upper Element 2 - White Board 1219 mm (48 inch) Panel	153			
6		Seated Privacy Height Powered Outlets Below the Work Surface Lower Element 1 - Cut-outs for Power & Data, Fabric Lower Element 2 - Fabric Upper Element 1 - Tackable Surface Upper Element 2 - Tackable Surface 914 mm (36 inch) Panel	3			

Sollicitation No. - N° de l'invitation  
EQ754-182273/A  
Client Ref. No. - N° de réf. du client  
EQ754-182273/A

Amd. No. - N° de la modif.  
File No. - N° du dossier  
TOR-7-40129

Buyer ID - Id de l'acheteur  
TOR008  
CCC No./N° CCC - FMS No./N° VME

7		Seated Privacy Height Powered Outlets Below the Work Surface Lower Element 1 - Cut-outs for Power & Data, Fabric Lower Element 2 - Fabric Upper Element 1 - Tackable Surface Upper Element 2 - Tackable Surface 1219 mm (48 inch) Panel	72			
8		Seated Privacy Height Powered Outlets Below the Work Surface Lower Element 1 - Fabric Lower Element 2 - Fabric Upper Element 1 - Cut-outs for Power & Data, Tackable Upper Element 2 - Tackable Surface 914 mm (36 inch) Panel	100			
9		Seated Privacy Height Powered Outlets Below the Work Surface Lower Element 1 - Fabric Lower Element 2 - Fabric Upper Element 1 - Cut-outs for Power & Data, Tackable Surface Upper Element 2 - Cut-outs for Power & Data, Tackable Surface 914 mm (36 inch) Panel	192			
10		Seated Privacy Height Powered Outlets Below the Work Surface Lower Element 1 - Cut-outs for Power & Data, Fabric Lower Element 2 - Cut-outs for Power & Data, Fabric Upper Element 1 - Tackable Surface Upper Element 2 - Tackable Surface 1219 mm (48 inch) Panel	16			
**Must not exceed ceiling unit price in SA.  Add more rows if necessary.				Product Total		\$

Goods must be ready by March 30<sup>th</sup> 2018

Goods must be securely stored at manufactures facilities until instructed to delivery and install to site by PSPC authority. Furniture is to be secured separately and available for inspection at any time between March 30<sup>th</sup> 2018 (the final completion date) and April 30<sup>th</sup> 2018 (the date of delivery).

Furniture remains the responsibility of the supplier while in manufacture's facility.

Sollicitation No. - N° de l'invitation  
EQ754-182273/A  
Client Ref. No. - N° de réf. du client  
EQ754-182273/A

Amd. No. - N° de la modif.  
File No. - N° du dossier  
TOR-7-40129

Buyer ID - Id de l'acheteur  
TOR008  
CCC No./N° CCC - FMS No./N° VME

**Table 2 - Delivery**

Section A - IU REQUIREMENT				Section B – SUPPLIER'S BID		
Product Item # from Table 1	Location	Desired Date (Y/M/D)	Desired Time: Normal Business Hours (Normal) Or Outside Normal Business Hours (Outside)*	Supplier will deliver on the date and at the time below*	Firm Price \$	Extended Total (Qty x Firm Unit Price) \$
1	9 <sup>th</sup> , 8 <sup>th</sup> , 7 <sup>th</sup> 3 <sup>rd</sup> Floors, 655 Bay Street, Toronto Ontario, ON, M5G 2K4	18-04-30	Normal Hours	(Y) (M) (D)		
*If no dates and times are added by the Supplier, the Supplier agrees to deliver on the Desired Date and Time. [Normal Business Hours 8:00 – 17:00, as per SA, Annex A, article 5] Add more rows if necessary.			Delivery Total:			\$

**Table 3 – Installation**

Section A - IU REQUIREMENT				Section B – SUPPLIER'S BID		
Product Item # from Table 1	Location	Desired Date (Y/M/D)	Desired Time: Normal Business Hours (Normal) Or Outside Normal Business Hours (Outside)*	Supplier will install on the date and at the time below*	Firm Price \$	Extended Total (Qty x Firm Unit Price) \$
1	9 <sup>th</sup> , 8 <sup>th</sup> , 7 <sup>th</sup> 3 <sup>rd</sup> Floors, 655 Bay Street, Toronto Ontario, ON, M5G 2K4	18-04-30	Normal Hours	(Y) (M) (D)		
*If no dates and times are added by the Supplier, the Supplier agrees to install on the Desired Date and Time. [Normal Business Hours 8:00 – 17:00, as per SA, Annex A, article 5] Add more rows if necessary.			Installation Total:			\$

**Table 4 – Optional Product** ☒ Not Applicable

**Table 5 – Optional Delivery** ☒ Not Applicable

**Table 6 – Optional Installation** ☒ Not Applicable

**Table 7 – Product Related Services** ☒ Not Applicable



Sollicitation No. - N° de l'invitation  
EQ754-182273/A  
Client Ref. No. - N° de réf. du client  
EQ754-182273/A

Amd. No. - N° de la modif.  
File No. - N° du dossier  
TOR-7-40129

Buyer ID - Id de l'acheteur  
TOR008  
CCC No./N° CCC - FMS No./N° VME

**Table 8 – Standard Finishes and Canada's Facilities to Accommodate the Delivery and Certifications**

<b>1.</b>	<b>Standard Finishes</b>	
1.1	<p>IU is to consult the Supplier's Website identified in Part 6A of the SA to view the available finishes.</p> <p>Within ten business days of the contract award, the Contracting Authority will provide the Contractor with a written notice of Canada's finish choices for each of the product(s) in Annex A.</p> <p>The Contractor will deliver the products corresponding to Canada's choice of specific finishes(s). No additional charge will be applied to Canada.</p>	
<b>2.</b>	<b>Canada's Facilities to Accommodate the Delivery</b>	
2.1	Loading Dock/Location	
A	Location	655 Bay Street, Toronto, ON, M5G 2K4
B	Dock	Yes
C	Lift	Standard Freight Elevator
D	Door	Standard Freight Elevator
2.2	Freight Elevator	Rear of Building
2.3	Other (specify, if any)	
	<b>Continuance of Certifications</b>	
	<p>The Bidder certifies that by submitting a bid in response to the RFB, the Bidder, and any of the Bidder's members if the Bidder is a Joint Venture, continues to comply with all of the certifications listed in Parts 6A and 6B of the Bidder's SA for Work Spaces, as follows:</p>	
3.1	Integrity Provisions	
3.2	Federal Contractor's Program for Employment Equity	
3.4	Product Conformance	
3.5	Price Certification (In accordance with the SA, Part 6B)	

**Table 9 - Bid Evaluation and Contract Total (Canada may complete if not completed by the Bidder)**

1	Product Total (Table 1) or Annex C Total	\$
2	<b>Optional</b> Product Total (Table 4)	\$
3	Delivery Total (Table 2)	\$
4	<b>Optional</b> Delivery Total (Table 5)	\$
5	Installation Total (Table 3)	\$
6	<b>Optional</b> Installation Total (Table 6)	\$
7	Product Related Services Total (if applicable) (Table 7)	\$
8	NSA Total (if applicable)	\$
9	Hardware Total as per article 1.5 of Annex A-1 of SA (if applicable)	\$
10	<b>Total Evaluated (Bid) Price* (1 + 2 + 3 + 4 + 5 + 6+ 7+8+9):</b>	\$\$
11	Applicable Tax(es):	\$
12	Total Estimated Cost (10+11):	\$

**Table 10 – Bidder's Authorized Representative**

<b>Table 6 – Bidder's Authorized Representative</b>		
1.	Bidder's Authorized Representative for the Bid and the Contract	
	Name:	Telephone:
		E-Mail:
		Other:

**\*At contract award, "Total Evaluated (Bid) Price" becomes "Contract Price".**

Sollicitation No. - N° de l'invitation  
EQ754-182273/A  
Client Ref. No. - N° de réf. du client  
EQ754-182273/A

Amd. No. - N° de la modif.  
File No. - N° du dossier  
TOR-7-40129

Buyer ID - Id de l'acheteur  
TOR008  
CCC No./N° CCC - FMS No./N° VME

**PRODUCT CATEGORY: 1B**

**Table 1 – Product (Only applicable for Scenario A procurements)**

Section A - IU REQUIREMENT				Section B – SUPPLIER'S BID		
#	GoCUID	Description of Product (optional field)	Qty	Supplier Part Number	Firm _____ Price** \$	Extended Total [Qty x Price] \$
1	PPTFSMxxLHFFCD542424	Storage Products Personal Storage Tower Freestanding Metal Hinged Left File, File Closed-Drawer 1371mm x 610mm x 610mm (54 inch x 24 inch x 24 inch)	140			
2	SPPTFSMxxRHFFCD542424	Storage Products Personal Storage Tower Freestanding Metal Hinged Right File, File Closed-Drawer 1371mm x 610mm x 610mm (54 inch x 24 inch x 24 inch)	115			
3	SPOSWMMxxxxxxSHxx2415	Storage Products Overhead Storage Wall Mounted Metal Shelves 610 mm ( 24 inch) x 381mm ( 15 inch)	8			
4	SPOSWMMxxxxxxSHxx4215	Storage Products Overhead Storage Wall Mounted Metal Shelves 1066 mm ( 42 inch) x 381mm ( 15 inch)	8			
5	SPOSWMMxxxxxxSHxx4815	Storage Products Overhead Storage Wall Mounted Metal Shelves 1219 mm ( 48 inch) x 381mm ( 15 inch)	8			
6	SPLSSLxRSLxxOC7218	Storage Products Low Storage - Credenza Unit Storage Supported	10			

Sollicitation No. - N° de l'invitation  
EQ754-182273/A  
Client Ref. No. - N° de réf. du client  
EQ754-182273/A

Amd. No. - N° de la modif.  
File No. - N° du dossier  
TOR-7-40129

Buyer ID - Id de l'acheteur  
TOR008  
CCC No./N° CCC - FMS No./N° VME

		Laminate Rectangular Sliding Open - Closed 1828mm x 457mm x 762mm (72 inch x 18 inch x 30 inch)				
7	SPOSWMMxxDDxxCxxx3015	Storage Products Overhead Storage Wall Mounted Metal Two Hinged Doors Closed Cupboard 762 mm x 381 mm ( 30 inch x 15 inch)	18			
8	SPOSWMMxxDDxxCxxx4815	Storage Products Overhead Storage Wall Mounted Metal Two Hinged Doors Closed Cupboard 1219 mm x 381 mm ( 48 inch x 15 inch)	4			
9	MTxxSCLxDxxxxxxxx30xx	Meeting Tables Star -Cross Base Laminate Round 762mm (30 Inch)	1			
10	SPPDWLMxxxxBFCSxxxx22	Storage Products Pedestals Locking Casters Metal Box, File Cushion Seat Depth 559mm (22 in.) work surface	242			

Non-SA (NSA) products forming part of this requirement not to exceed 20% of the firm quantity from the products above in this table.

The Supplier signs, and certifies that all the NSA products offered will conform to all specifications and meet the testing requirements detailed at Annex D.

	NON SA product (s)	Description of Non SA	QTY			
		Work Surfaces Panel Mounted High Pressure Laminate Rectangular Shape 1828mm x 610mm (72 inch x 24 inch)	240			
		Work Surfaces	10			

Sollicitation No. - N° de l'invitation  
EQ754-182273/A  
Client Ref. No. - N° de réf. du client  
EQ754-182273/A

Amd. No. - N° de la modif.  
File No. - N° du dossier  
TOR-7-40129

Buyer ID - Id de l'acheteur  
TOR008  
CCC No./N° CCC - FMS No./N° VME

		1 Half, 1 Full Gable (w/modesty) High Pressure Laminate Rectangular 1828mm x 610mm (72 inch x 24 inch) 762 mm( 30 inch) High				
		Common top for filing cabinets High Pressure Laminate Rectangular 952 mm x 1866 mm (37.5 inch x 73.5 inch) To be on top of 4 filing cabinets 914 mm x 457 mm (36 inch x 18 inch) back to back, with 19mm (3/4 inch) overhang	1			
<b>**Must not exceed ceiling unit price in SA.</b>  Add more rows if necessary.				Product Total		\$

Goods must be ready by March 30<sup>th</sup> 2018

Goods must be securely stored at manufactures facilities until instructed to delivery and install to site by PSPC authority. Furniture is to be secured separately and available for inspection at any time between March 30<sup>th</sup> 2018 (the final completion date) and April 30<sup>th</sup> 2018 (the date of delivery).

Furniture remains the responsibility of the supplier while in manufacture's facility.

**Table 2 - Delivery**

Section A - IU REQUIREMENT				Section B – SUPPLIER'S BID		
Product Item # from Table 1	Location	Desired Date (Y/M/D)	Desired Time: Normal Business Hours (Normal) Or Outside Normal Business Hours (Outside)*	Supplier will deliver on the date and at the time below*	Firm _____ Price \$	Extended Total (Qty x Firm Unit Price) \$
1	9 <sup>th</sup> , 8 <sup>th</sup> , 7 <sup>th</sup> 3 <sup>rd</sup> Floors, 655 Bay Street, Toronto Ontario, ON, M5G 2K4	18-04-30	Normal Hours	(Y) (M) (D)		
*If no dates and times are added by the Supplier, the Supplier agrees to deliver on the Desired Date and Time. [Normal Business Hours 8:00 – 17:00, as per SA, Annex A, article 5] Add more rows if necessary.				Delivery Total:		\$

Sollicitation No. - N° de l'invitation  
EQ754-182273/A  
Client Ref. No. - N° de réf. du client  
EQ754-182273/A

Amd. No. - N° de la modif.  
File No. - N° du dossier  
TOR-7-40129

Buyer ID - Id de l'acheteur  
TOR008  
CCC No./N° CCC - FMS No./N° VME

**Table 3 – Installation**

Section A - IU REQUIREMENT				Section B – SUPPLIER'S BID		
Product Item # from Table 1	Location	Desired Date (Y/M/D)	Desired Time: Normal Business Hours (Normal) Or Outside Normal Business Hours (Outside)*	Supplier will install on the date and at the time below*	Firm Price \$	Extended Total (Qty x Firm Unit Price) \$
1	9 <sup>th</sup> , 8 <sup>th</sup> , 7 <sup>th</sup> 3 <sup>rd</sup> Floors, 655 Bay Street, Toronto Ontario, ON, M5G 2K4	18-04-30	Normal Hours	(Y) (M) (D)		
*If no dates and times are added by the Supplier, the Supplier agrees to install on the Desired Date and Time. [Normal Business Hours 8:00 – 17:00, as per SA, Annex A, article 5] Add more rows if necessary.			Installation Total:			\$

**Table 4 – Optional Product** ☒ Not Applicable

**Table 5 – Optional Delivery** ☒ Not Applicable

**Table 6 – Optional Installation** ☒ Not Applicable

**Table 7 – Product Related Services** ☒ Not Applicable

**Table 8 – Standard Finishes and Canada's Facilities to Accommodate the Delivery and Certifications**

<b>1.</b>	<b>Standard Finishes</b>	
1.1	<p>IU is to consult the Supplier's Website identified in Part 6A of the SA to view the available finishes.</p> <p>Within ten business days of the contract award, the Contracting Authority will provide the Contractor with a written notice of Canada's finish choices for each of the product(s) in Annex A.</p> <p>The Contractor will deliver the products corresponding to Canada's choice of specific finishes(s). No additional charge will be applied to Canada.</p>	
<b>2.</b>	<b>Canada's Facilities to Accommodate the Delivery</b>	
2.1	Loading Dock/Location	
A	Location	655 Bay Street, Toronto, ON, M5G 2K4
B	Dock	Yes
C	Lift	Standard Freight Elevator
D	Door	Standard Freight Elevator
2.2	Freight Elevator	Rear of Building
2.3	Other (specify, if any)	
	<b>Continuance of Certifications</b>	
	<p>The Bidder certifies that by submitting a bid in response to the RFB, the Bidder, and any of the Bidder's members if the Bidder is a Joint Venture, continues to comply with all of the certifications listed in Parts 6A and 6B of the Bidder's SA for Work Spaces, as follows:</p>	
3.1	Integrity Provisions	
3.2	Federal Contractor's Program for Employment Equity	
3.4	Product Conformance	
3.5	Price Certification (In accordance with the SA, Part 6B)	

Sollicitation No. - N° de l'invitation  
EQ754-182273/A  
Client Ref. No. - N° de réf. du client  
EQ754-182273/A

Amd. No. - N° de la modif.  
File No. - N° du dossier  
TOR-7-40129

Buyer ID - Id de l'acheteur  
TOR008  
CCC No./N° CCC - FMS No./N° VME

**Table 9 - Bid Evaluation and Contract Total (Canada may complete if not completed by the Bidder)**

1	Product Total (Table 1) or Annex C Total	\$
2	<b>Optional</b> Product Total (Table 4)	\$
3	Delivery Total (Table 2)	\$
4	<b>Optional</b> Delivery Total (Table 5)	\$
5	Installation Total (Table 3)	\$
6	<b>Optional</b> Installation Total (Table 6)	\$
7	Product Related Services Total (if applicable) (Table 7)	\$
8	NSA Total (if applicable)	\$
9	Hardware Total as per article 1.5 of Annex A-1 of SA (if applicable)	\$
10	<b>Total Evaluated (Bid) Price* (1 + 2 + 3 + 4 + 5 + 6+ 7+8+9):</b>	\$
11	Applicable Tax(es):	\$
12	Total Estimated Cost (10+11):	\$

**Table 10 – Bidder's Authorized Representative**

Table 6 – Bidder's Authorized Representative		
1.	Bidder's Authorized Representative for the Bid and the Contract	
	Name:	Telephone:
		E-Mail:
		Other:

**\*At contract award, "Total Evaluated (Bid) Price" becomes "Contract Price".**

Sollicitation No. - N° de l'invitation  
EQ754-182273/A  
Client Ref. No. - N° de réf. du client  
EQ754-182273/A

Amd. No. - N° de la modif.  
File No. - N° du dossier  
TOR-7-40129

Buyer ID - Id de l'acheteur  
TOR008  
CCC No./N° CCC - FMS No./N° VME

**PRODUCT CATEGORY: 2 - Freestanding Height Adjustable Desk/Table Products**

**Table 1 – Product (Only applicable for Scenario A procurements)**

Section A - IU REQUIREMENT				Section B – SUPPLIER'S BID		
#	GoCUID	Description of Product (optional field)	Qty	Supplier Part Number	Firm Price** \$	Extended Total [Qty x Price] \$
1	FSCAEA4830	Sit/Stand Range Height Adjustable Work Surfaces Electrically Assisted 1219mm x 762mm (48 inch x 30 inch)	251			
	FSCAEA5430	Sit/Stand Range Height Adjustable Work Surfaces Electrically Assisted 1371mm x 762mm (54 inch x 30 inch)	15			
<p>Non-SA (NSA) products forming part of this requirement not to exceed 20% of the firm quantity from the products above in this table.</p> <p>The Supplier signs, and certifies that all the NSA products offered will conform to all specifications and meet the testing requirements detailed at Annex D.</p>						
	NON SA product(s)	Description of Non SA	QTY			
	NON SA	Laminate modesty panel , Mounted under Work Surface with cable tray 1219 mm x 381 mm - 431 mm (48 inch x 15-17 inch)	10			
<p>**Must not exceed ceiling unit price in SA.</p> <p>Add more rows if necessary.</p>				Product Total		\$

Goods must be ready by March 30<sup>th</sup> 2018

Goods must be securely stored at manufactures facilities until instructed to delivery and install to site by PSPC authority. Furniture is to be secured separately and available for inspection at any time between March 30<sup>th</sup> 2018 (the final completion date) and April 30<sup>th</sup> 2018 (the date of delivery).

Furniture remains the responsibility of the supplier while in manufacture's facility.

Sollicitation No. - N° de l'invitation  
EQ754-182273/A  
Client Ref. No. - N° de réf. du client  
EQ754-182273/A

Amd. No. - N° de la modif.  
File No. - N° du dossier  
TOR-7-40129

Buyer ID - Id de l'acheteur  
TOR008  
CCC No./N° CCC - FMS No./N° VME

**Table 2 - Delivery**

Section A - IU REQUIREMENT				Section B – SUPPLIER'S BID		
Product Item # from Table 1	Location	Desired Date (Y/M/D)	Desired Time: Normal Business Hours (Normal) Or Outside Normal Business Hours (Outside)*	Supplier will deliver on the date and at the time below*	Firm Price \$	Extended Total (Qty x Firm Unit Price) \$
1	9 <sup>th</sup> , 8 <sup>th</sup> , 7 <sup>th</sup> 3 <sup>rd</sup> Floors, 655 Bay Street, Toronto Ontario, ON, M5G 2K4	18-04-30	Normal Hours	(Y) (M) (D)		
*If no dates and times are added by the Supplier, the Supplier agrees to deliver on the Desired Date and Time. [Normal Business Hours 8:00 – 17:00, as per SA, Annex A, article 5] Add more rows if necessary.				Delivery Total:		\$

**Table 3 – Installation**

Section A - IU REQUIREMENT				Section B – SUPPLIER'S BID		
Product Item # from Table 1	Location	Desired Date (Y/M/D)	Desired Time: Normal Business Hours (Normal) Or Outside Normal Business Hours (Outside)*	Supplier will install on the date and at the time below*	Firm Price \$	Extended Total (Qty x Firm Unit Price) \$
1	9 <sup>th</sup> , 8 <sup>th</sup> , 7 <sup>th</sup> 3 <sup>rd</sup> Floors, 655 Bay Street, Toronto Ontario, ON, M5G 2K4	18-04-30	Normal Hours	(Y) (M) (D)		
*If no dates and times are added by the Supplier, the Supplier agrees to install on the Desired Date and Time. [Normal Business Hours 8:00 – 17:00, as per SA, Annex A, article 5] Add more rows if necessary.				Installation Total:		\$

**Table 4 – Optional Product** ☒ Not Applicable

**Table 5 – Optional Delivery** ☒ Not Applicable

**Table 6 – Optional Installation** ☒ Not Applicable

**Table 7 – Product Related Services** ☒ Not Applicable



Sollicitation No. - N° de l'invitation  
EQ754-182273/A  
Client Ref. No. - N° de réf. du client  
EQ754-182273/A

Amd. No. - N° de la modif.  
File No. - N° du dossier  
TOR-7-40129

Buyer ID - Id de l'acheteur  
TOR008  
CCC No./N° CCC - FMS No./N° VME

**Table 8 – Standard Finishes and Canada's Facilities to Accommodate the Delivery and Certifications**

<b>1.</b>	<b>Standard Finishes</b>	
1.1	<p>IU is to consult the Supplier's Website identified in Part 6A of the SA to view the available finishes.</p> <p>Within ten business days of the contract award, the Contracting Authority will provide the Contractor with a written notice of Canada's finish choices for each of the product(s) in Annex A.</p> <p>The Contractor will deliver the products corresponding to Canada's choice of specific finishes(s). No additional charge will be applied to Canada.</p>	
<b>2.</b>	<b>Canada's Facilities to Accommodate the Delivery</b>	
2.1	Loading Dock/Location	
A	Location	655 Bay Street, Toronto, ON, M5G 2K4
B	Dock	Yes
C	Lift	Standard Freight Elevator
D	Door	Standard Freight Elevator
2.2	Freight Elevator	Rear of Building
2.3	Other (specify, if any)	
	<b>Continuance of Certifications</b>	
	<p>The Bidder certifies that by submitting a bid in response to the RFB, the Bidder, and any of the Bidder's members if the Bidder is a Joint Venture, continues to comply with all of the certifications listed in Parts 6A and 6B of the Bidder's SA for Work Spaces, as follows:</p>	
3.1	Integrity Provisions	
3.2	Federal Contractor's Program for Employment Equity	
3.4	Product Conformance	
3.5	Price Certification (In accordance with the SA, Part 6B)	

**Table 9 - Bid Evaluation and Contract Total (Canada may complete if not completed by the Bidder)**

1	Product Total (Table 1) or Annex C Total	\$
2	<b>Optional</b> Product Total (Table 4)	\$
3	Delivery Total (Table 2)	\$
4	<b>Optional</b> Delivery Total (Table 5)	\$
5	Installation Total (Table 3)	\$
6	<b>Optional</b> Installation Total (Table 6)	\$
7	Product Related Services Total (if applicable) (Table 7)	\$
8	NSA Total (if applicable)	\$
9	Hardware Total as per article 1.5 of Annex A-1 of SA (if applicable)	\$
10	<b>Total Evaluated (Bid) Price* (1 + 2 + 3 + 4 + 5 + 6+ 7+8+9):</b>	\$\$
11	Applicable Tax(es):	\$
12	Total Estimated Cost (10+11):	\$

**Table 10 – Bidder's Authorized Representative**

<b>Table 6 – Bidder's Authorized Representative</b>		
1.	Bidder's Authorized Representative for the Bid and the Contract	
	Name:	Telephone:
		E-Mail:
		Other:

**\*At contract award, "Total Evaluated (Bid) Price" becomes "Contract Price".**

Sollicitation No. - N° de l'invitation  
EQ754-182273/A  
Client Ref. No. - N° de réf. du client  
EQ754-182273/A

Amd. No. - N° de la modif.  
File No. - N° du dossier  
TOR-7-40129

Buyer ID - Id de l'acheteur  
TOR008  
CCC No./N° CCC - FMS No./N° VME

**PRODUCT CATEGORY: 3 - Metal Filing and Storage Cabinets**

**Table 1 – Product (Only applicable for Scenario A procurements)**

Section A - IU REQUIREMENT				Section B – SUPPLIER'S BID		
#	GoCUID	Description of Product (optional field)	Qty	Supplier Part Number	Firm Price** \$	Extended Total [Qty x Price] \$
1	SCSC2DSCxxx20364454	Storage Cabinets Two - Door Storage Cabinet 508mm x 914mm x 1372mm (20 inch x 36 inch x54 inch)	15			
2	SCSCOPSCxxx18304454	Storage Cabinets Open Storage Cabinet 457mm (18 in.) x 762mm (30 in.) x From 1118mm (44 in./po) To (54 in./po) High	3			
	SCSCOPSCxxx18364454	Storage Cabinets Open Storage Cabinet 457mm (18 in.) x 914mm (36 in.) x From 1118mm (44 in./po) To (54 in./po) High	6			
**Must not exceed ceiling unit price in SA.  Add more rows if necessary.				Product Total		\$

Goods must be ready by March 30<sup>th</sup> 2018

Goods must be securely stored at manufactures facilities until instructed to delivery and install to site by PSPC authority. Furniture is to be secured separately and available for inspection at any time between March 30<sup>th</sup> 2018 (the final completion date) and April 30<sup>th</sup> 2018 (the date of delivery).

Furniture remains the responsibility of the supplier while in manufacture's facility.

Sollicitation No. - N° de l'invitation  
EQ754-182273/A  
Client Ref. No. - N° de réf. du client  
EQ754-182273/A

Amd. No. - N° de la modif.  
File No. - N° du dossier  
TOR-7-40129

Buyer ID - Id de l'acheteur  
TOR008  
CCC No./N° CCC - FMS No./N° VME

**Table 2 - Delivery**

Section A - IU REQUIREMENT				Section B – SUPPLIER'S BID		
Product Item # from Table 1	Location	Desired Date (Y/M/D)	Desired Time: Normal Business Hours (Normal) Or Outside Normal Business Hours (Outside)*	Supplier will deliver on the date and at the time below*	Firm Price \$	Extended Total (Qty x Firm Unit Price) \$
1	9 <sup>th</sup> , 8 <sup>th</sup> , 7 <sup>th</sup> 3 <sup>rd</sup> Floors, 655 Bay Street, Toronto Ontario, ON, M5G 2K4	18-04-30	Normal Hours	(Y) (M) (D)		
*If no dates and times are added by the Supplier, the Supplier agrees to deliver on the Desired Date and Time. [Normal Business Hours 8:00 – 17:00, as per SA, Annex A, article 5] Add more rows if necessary.			Delivery Total:			\$

**Table 3 – Installation**

Section A - IU REQUIREMENT				Section B – SUPPLIER'S BID		
Product Item # from Table 1	Location	Desired Date (Y/M/D)	Desired Time: Normal Business Hours (Normal) Or Outside Normal Business Hours (Outside)*	Supplier will install on the date and at the time below*	Firm Price \$	Extended Total (Qty x Firm Unit Price) \$
1	9 <sup>th</sup> , 8 <sup>th</sup> , 7 <sup>th</sup> 3 <sup>rd</sup> Floors, 655 Bay Street, Toronto Ontario, ON, M5G 2K4	18-04-30	Normal Hours	(Y) (M) (D)		
*If no dates and times are added by the Supplier, the Supplier agrees to install on the Desired Date and Time. [Normal Business Hours 8:00 – 17:00, as per SA, Annex A, article 5] Add more rows if necessary.			Installation Total:			\$

**Table 4 – Optional Product** ☒ Not Applicable

**Table 5 – Optional Delivery** ☒ Not Applicable

**Table 6 – Optional Installation** ☒ Not Applicable

**Table 7 – Product Related Services** ☒ Not Applicable

Sollicitation No. - N° de l'invitation  
EQ754-182273/A  
Client Ref. No. - N° de réf. du client  
EQ754-182273/A

Amd. No. - N° de la modif.  
File No. - N° du dossier  
TOR-7-40129

Buyer ID - Id de l'acheteur  
TOR008  
CCC No./N° CCC - FMS No./N° VME

**Table 8 – Standard Finishes and Canada's Facilities to Accommodate the Delivery and Certifications**

<b>1.</b>	<b>Standard Finishes</b>	
1.1	<p>IU is to consult the Supplier's Website identified in Part 6A of the SA to view the available finishes.</p> <p>Within ten business days of the contract award, the Contracting Authority will provide the Contractor with a written notice of Canada's finish choices for each of the product(s) in Annex A.</p> <p>The Contractor will deliver the products corresponding to Canada's choice of specific finishes(s). No additional charge will be applied to Canada.</p>	
<b>2.</b>	<b>Canada's Facilities to Accommodate the Delivery</b>	
2.1	Loading Dock/Location	
A	Location	655 Bay Street, Toronto, ON, M5G 2K4
B	Dock	Yes
C	Lift	Standard Freight Elevator
D	Door	Standard Freight Elevator
2.2	Freight Elevator	Rear of Building
2.3	Other (specify, if any)	
	<b>Continuance of Certifications</b>	
	<p>The Bidder certifies that by submitting a bid in response to the RFB, the Bidder, and any of the Bidder's members if the Bidder is a Joint Venture, continues to comply with all of the certifications listed in Parts 6A and 6B of the Bidder's SA for Work Spaces, as follows:</p>	
3.1	Integrity Provisions	
3.2	Federal Contractor's Program for Employment Equity	
3.4	Product Conformance	
3.5	Price Certification (In accordance with the SA, Part 6B)	

**Table 9 - Bid Evaluation and Contract Total (Canada may complete if not completed by the Bidder)**

1	Product Total (Table 1) or Annex C Total	\$
2	<b>Optional</b> Product Total (Table 4)	\$
3	Delivery Total (Table 2)	\$
4	<b>Optional</b> Delivery Total (Table 5)	\$
5	Installation Total (Table 3)	\$
6	<b>Optional</b> Installation Total (Table 6)	\$
7	Product Related Services Total (if applicable) (Table 7)	\$
8	NSA Total (if applicable)	\$
9	Hardware Total as per article 1.5 of Annex A-1 of SA (if applicable)	\$
10	<b>Total Evaluated (Bid) Price* (1 + 2 + 3 + 4 + 5 + 6+ 7+8+9):</b>	\$\$
11	Applicable Tax(es):	\$
12	Total Estimated Cost (10+11):	\$

**Table 10 – Bidder's Authorized Representative**

<b>Table 6 – Bidder's Authorized Representative</b>		
1.	Bidder's Authorized Representative for the Bid and the Contract	
	Name:	Telephone:
		E-Mail:
		Other:

**\*At contract award, "Total Evaluated (Bid) Price" becomes "Contract Price".**

Sollicitation No. - N° de l'invitation  
EQ754-182273/A  
Client Ref. No. - N° de réf. du client  
EQ754-182273/A

Amd. No. - N° de la modif.  
File No. - N° du dossier  
TOR-7-40129

Buyer ID - Id de l'acheteur  
TOR008  
CCC No./N° CCC - FMS No./N° VME

**PRODUCT CATEGORY: 4 - WOOD VENEER - FREESTANDING PRODUCTS**

**Table 1 – Product (Only applicable for Scenario A procurements)**

Section A - IU REQUIREMENT				Section B – SUPPLIER'S BID		
#	GoCUID	Description of Product (optional field)	Qty	Supplier Part Number	Firm Price** \$	Extended Total [Qty x Price] \$
1	WSRE1F1HxxxCH7224#2xx	Work Surfaces Rectangular, One full and one half gable & Modesty panel Cherry 1830mm (72 in.) x 610mm (24in.)-two grommets	3			
2	MTRTSBxxxxxCH0762xxxx	Meeting tables Round, Star base [Cross base] Cherry 762mm (30 in.)	3			
3	SPPSCRxxxxxCH2424xxxx	Storage Products Personal Storage Tower, Wardrobe One Side, 2 File Drawers at Bottom and Closed Cupboard Above, With Lock, Right Cherry 610mm (24 in.) Wide x 610mm (24 in.) Deep	2			
4	SPPSCLxxxxxCH2424xxxx	Storage Products Personal Storage Tower, Wardrobe One Side, 2 File Drawers at Bottom and Closed Cupboard Above, With Lock, Left Cherry 610mm (24 in.) Wide/Large x 610mm (24 in.) Deep	1			
5	SPLSCDO0457CH1830xxxx	Storage Product Low Storage (Credenza Units),Drawers & Open, 457mm (18 in.) in depth Cherry 1830mm (72 in.)	3			
<p>Non-SA (NSA) products forming part of this requirement not to exceed 20% of the firm quantity from the products above in this table.</p> <p>The Supplier signs, and certifies that all the NSA products offered will conform to all specifications and meet the testing requirements detailed at Annex D.</p>						
	NON SA product(s)	Description of Non SA	QTY			

Sollicitation No. - N° de l'invitation  
EQ754-182273/A  
Client Ref. No. - N° de réf. du client  
EQ754-182273/A

Amd. No. - N° de la modif.  
File No. - N° du dossier  
TOR-7-40129

Buyer ID - Id de l'acheteur  
TOR008  
CCC No./N° CCC - FMS No./N° VME

	Sit/Stand Range Height Adjustable Work Surfaces Electrically Assisted Cherry 1371mm x 762mm (54 inch x 30 inch) With cherry modesty panel Mounted under Work Surface and cable tray 1371 mm x 381 mm - 431 mm (54 inch x 15-17 inch)	3			
<b>**Must not exceed ceiling unit price in SA.</b>  Add more rows if necessary.			Product Total		\$

Goods must be ready by March 30<sup>th</sup> 2018

Goods must be securely stored at manufactures facilities until instructed to delivery and install to site by PSPC authority. Furniture is to be secured separately and available for inspection at any time between March 30<sup>th</sup> 2018 (the final completion date) and April 30<sup>th</sup> 2018 (the date of delivery).

Furniture remains the responsibility of the supplier while in manufacture's facility.

**Table 2 - Delivery**

Section A - IU REQUIREMENT				Section B – SUPPLIER’S BID		
Product Item # from Table 1	Location	Desired Date (Y/M/D)	Desired Time: Normal Business Hours (Normal) Or Outside Normal Business Hours (Outside)*	Supplier will deliver on the date and at the time below*	Firm _____ Price \$	Extended Total (Qty x Firm Unit Price) \$
1	9 <sup>th</sup> , 8 <sup>th</sup> , 7 <sup>th</sup> 3 <sup>rd</sup> Floors, 655 Bay Street, Toronto Ontario, ON, M5G 2K4	18-04-30	Normal Hours	(Y) (M) (D)		
*If no dates and times are added by the Supplier, the Supplier agrees to deliver on the Desired Date and Time. [Normal Business Hours 8:00 – 17:00, as per SA, Annex A, article 5] Add more rows if necessary.			Delivery Total:			\$

Sollicitation No. - N° de l'invitation  
EQ754-182273/A  
Client Ref. No. - N° de réf. du client  
EQ754-182273/A

Amd. No. - N° de la modif.  
File No. - N° du dossier  
TOR-7-40129

Buyer ID - Id de l'acheteur  
TOR008  
CCC No./N° CCC - FMS No./N° VME

**Table 3 – Installation**

Section A - IU REQUIREMENT				Section B – SUPPLIER'S BID		
Product Item # from Table 1	Location	Desired Date (Y/M/D)	Desired Time: Normal Business Hours (Normal) Or Outside Normal Business Hours (Outside)*	Supplier will install on the date and at the time below*	Firm Price \$	Extended Total (Qty x Firm Unit Price) \$
1	9 <sup>th</sup> , 8 <sup>th</sup> , 7 <sup>th</sup> 3 <sup>rd</sup> Floors, 655 Bay Street, Toronto Ontario, ON, M5G 2K4	18-04-30	Normal Hours	(Y) (M) (D)		
*If no dates and times are added by the Supplier, the Supplier agrees to install on the Desired Date and Time. [Normal Business Hours 8:00 – 17:00, as per SA, Annex A, article 5] Add more rows if necessary.			Installation Total:			\$

**Table 4 – Optional Product** ☒ Not Applicable

**Table 5 – Optional Delivery** ☒ Not Applicable

**Table 6 – Optional Installation** ☒ Not Applicable

**Table 7 – Product Related Services** ☒ Not Applicable

**Table 8 – Standard Finishes and Canada's Facilities to Accommodate the Delivery and Certifications**

<b>1.</b>	<b>Standard Finishes</b>	
1.1	<p>IU is to consult the Supplier's Website identified in Part 6A of the SA to view the available finishes.</p> <p>Within ten business days of the contract award, the Contracting Authority will provide the Contractor with a written notice of Canada's finish choices for each of the product(s) in Annex A.</p> <p>The Contractor will deliver the products corresponding to Canada's choice of specific finishes(s). No additional charge will be applied to Canada.</p>	
<b>2.</b>	<b>Canada's Facilities to Accommodate the Delivery</b>	
2.1	Loading Dock/Location	
A	Location	655 Bay Street, Toronto, ON, M5G 2K4
B	Dock	Yes
C	Lift	Standard Freight Elevator
D	Door	Standard Freight Elevator
2.2	Freight Elevator	Rear of Building
2.3	Other (specify, if any)	
	<b>Continuance of Certifications</b>	
	<p>The Bidder certifies that by submitting a bid in response to the RFB, the Bidder, and any of the Bidder's members if the Bidder is a Joint Venture, continues to comply with all of the certifications listed in Parts 6A and 6B of the Bidder's SA for Work Spaces, as follows:</p>	
3.1	Integrity Provisions	
3.2	Federal Contractor's Program for Employment Equity	
3.4	Product Conformance	
3.5	Price Certification (In accordance with the SA, Part 6B)	

Sollicitation No. - N° de l'invitation  
EQ754-182273/A  
Client Ref. No. - N° de réf. du client  
EQ754-182273/A

Amd. No. - N° de la modif.  
File No. - N° du dossier  
TOR-7-40129

Buyer ID - Id de l'acheteur  
TOR008  
CCC No./N° CCC - FMS No./N° VME

**Table 9 - Bid Evaluation and Contract Total (Canada may complete if not completed by the Bidder)**

1	Product Total (Table 1) or Annex C Total	\$
2	<b>Optional</b> Product Total (Table 4)	\$
3	Delivery Total (Table 2)	\$
4	<b>Optional</b> Delivery Total (Table 5)	\$
5	Installation Total (Table 3)	\$
6	<b>Optional</b> Installation Total (Table 6)	\$
7	Product Related Services Total (if applicable) (Table 7)	\$
8	NSA Total (if applicable)	\$
9	Hardware Total as per article 1.5 of Annex A-1 of SA (if applicable)	\$
10	<b>Total Evaluated (Bid) Price* (1 + 2 + 3 + 4 + 5 + 6+ 7+8+9):</b>	\$
11	Applicable Tax(es):	\$
12	Total Estimated Cost (10+11):	\$

**Table 10 – Bidder's Authorized Representative**

Table 6 – Bidder's Authorized Representative		
1.	Bidder's Authorized Representative for the Bid and the Contract	
	Name:	Telephone:
		E-Mail:
		Other:

**\*At contract award, "Total Evaluated (Bid) Price" becomes "Contract Price".**



Sollicitation No. - N° de l'invitation  
EQ754-182273/A  
Client Ref. No. - N° de réf. du client  
EQ754-182273/A

Amd. No. - N° de la modif.  
File No. - N° du dossier  
TOR-7-40129

Buyer ID - Id de l'acheteur  
TOR008  
CCC No./N° CCC - FMS No./N° VME

**PRODUCT CATEGORY: 5 - ANCILLARY AND LIGHTING PRODUCTS**

**Table 1 – Product (Only applicable for Scenario A procurements)**

Section A - IU REQUIREMENT				Section B – SUPPLIER'S BID		
#	GoCUID	Description of Product (optional field)	Qty	Supplier Part Number	Firm _____ Price** \$	Extended Total [Qty x Price] \$
1	MADME	Monitor Arms, Dual Monitor, Edge Clamp Mount	254			
2	TABLE LAMP	Task Light, Desk Base Type	4			
**Must not exceed ceiling unit price in SA.  Add more rows if necessary.				Product Total		\$

Goods must be ready by March 30<sup>th</sup> 2018

Goods must be securely stored at manufactures facilities until instructed to delivery and install to site by PSPC authority. Furniture is to be secured separately and available for inspection at any time between March 30<sup>th</sup> 2018 (the final completion date) and April 30<sup>th</sup> 2018 (the date of delivery).

Furniture remains the responsibility of the supplier while in manufacture's facility.

**Table 2 - Delivery**

Section A - IU REQUIREMENT				Section B – SUPPLIER'S BID		
Product Item # from Table 1	Location	Desired Date (Y/M/D)	Desired Time: Normal Business Hours (Normal) Or Outside Normal Business Hours (Outside)*	Supplier will deliver on the date and at the time below*	Firm _____ Price \$	Extended Total (Qty x Firm Unit Price) \$
1	9 <sup>th</sup> , 8 <sup>th</sup> , 7 <sup>th</sup> 3 <sup>rd</sup> Floors, 655 Bay Street, Toronto Ontario, ON, M5G 2K4	18-04-30	Normal Hours	(Y) (M) (D)		
*If no dates and times are added by the Supplier, the Supplier agrees to deliver on the Desired Date and Time. [Normal Business Hours 8:00 – 17:00, as per SA, Annex A, article 5] Add more rows if necessary.				Delivery Total:		\$

Sollicitation No. - N° de l'invitation  
EQ754-182273/A  
Client Ref. No. - N° de réf. du client  
EQ754-182273/A

Amd. No. - N° de la modif.  
File No. - N° du dossier  
TOR-7-40129

Buyer ID - Id de l'acheteur  
TOR008  
CCC No./N° CCC - FMS No./N° VME

**Table 3 – Installation**

Section A - IU REQUIREMENT				Section B – SUPPLIER'S BID		
Product Item # from Table 1	Location	Desired Date (Y/M/D)	Desired Time: Normal Business Hours (Normal) Or Outside Normal Business Hours (Outside)*	Supplier will install on the date and at the time below*	Firm Price \$	Extended Total (Qty x Firm Unit Price) \$
1	9 <sup>th</sup> , 8 <sup>th</sup> , 7 <sup>th</sup> 3 <sup>rd</sup> Floors, 655 Bay Street, Toronto Ontario, ON, M5G 2K4	18-04-30	Normal Hours	(Y) (M) (D)		
*If no dates and times are added by the Supplier, the Supplier agrees to install on the Desired Date and Time. [Normal Business Hours 8:00 – 17:00, as per SA, Annex A, article 5] Add more rows if necessary.			Installation Total:			\$

**Table 4 – Optional Product** ☒ Not Applicable

**Table 5 – Optional Delivery** ☒ Not Applicable

**Table 6 – Optional Installation** ☒ Not Applicable

**Table 7 – Product Related Services** ☒ Not Applicable

**Table 8 – Standard Finishes and Canada's Facilities to Accommodate the Delivery and Certifications**

<b>1.</b>	<b>Standard Finishes</b>	
1.1	<p>IU is to consult the Supplier's Website identified in Part 6A of the SA to view the available finishes.</p> <p>Within ten business days of the contract award, the Contracting Authority will provide the Contractor with a written notice of Canada's finish choices for each of the product(s) in Annex A.</p> <p>The Contractor will deliver the products corresponding to Canada's choice of specific finishes(s). No additional charge will be applied to Canada.</p>	
<b>2.</b>	<b>Canada's Facilities to Accommodate the Delivery</b>	
2.1	Loading Dock/Location	
A	Location	655 Bay Street, Toronto, ON, M5G 2K4
B	Dock	Yes
C	Lift	Standard Freight Elevator
D	Door	Standard Freight Elevator
2.2	Freight Elevator	Rear of Building
2.3	Other (specify, if any)	
	<b>Continuance of Certifications</b>	
	<p>The Bidder certifies that by submitting a bid in response to the RFB, the Bidder, and any of the Bidder's members if the Bidder is a Joint Venture, continues to comply with all of the certifications listed in Parts 6A and 6B of the Bidder's SA for Work Spaces, as follows:</p>	
3.1	Integrity Provisions	
3.2	Federal Contractor's Program for Employment Equity	
3.4	Product Conformance	
3.5	Price Certification (In accordance with the SA, Part 6B)	

Sollicitation No. - N° de l'invitation  
EQ754-182273/A  
Client Ref. No. - N° de réf. du client  
EQ754-182273/A

Amd. No. - N° de la modif.  
File No. - N° du dossier  
TOR-7-40129

Buyer ID - Id de l'acheteur  
TOR008  
CCC No./N° CCC - FMS No./N° VME

**Table 9 - Bid Evaluation and Contract Total (Canada may complete if not completed by the Bidder)**

1	Product Total (Table 1) or Annex C Total	\$
2	<b>Optional</b> Product Total (Table 4)	\$
3	Delivery Total (Table 2)	\$
4	<b>Optional</b> Delivery Total (Table 5)	\$
5	Installation Total (Table 3)	\$
6	<b>Optional</b> Installation Total (Table 6)	\$
7	Product Related Services Total (if applicable) (Table 7)	\$
8	NSA Total (if applicable)	\$
9	Hardware Total as per article 1.5 of Annex A-1 of SA (if applicable)	\$
10	<b>Total Evaluated (Bid) Price* (1 + 2 + 3 + 4 + 5 + 6+ 7+8+9):</b>	\$
11	Applicable Tax(es):	\$
12	Total Estimated Cost (10+11):	\$

**Table 10 – Bidder's Authorized Representative**

Table 6 – Bidder's Authorized Representative		
1.	Bidder's Authorized Representative for the Bid and the Contract	
	Name:	Telephone:
		E-Mail:
		Other:

**\*At contract award, "Total Evaluated (Bid) Price" becomes "Contract Price".**

Sollicitation No. - N° de l'invitation      Amd. No. - N° de la modif.  
EQ754-182273/A  
Client Ref. No. - N° de réf. du client      File No. - N° du dossier  
EQ754-182273/A      TOR-7-40129

Buyer ID - Id de l'acheteur  
TOR008  
CCC No./N° CCC - FMS No./N° VME

**PRODUCT CATEGORY: 6 - Tables & Meeting Room Furniture**

**Table 1 – Product (Only applicable for Scenario A procurements)**

Section A - IU REQUIREMENT				Section B – SUPPLIER'S BID		
#	GoCUID	Description of Product (optional field)	Qty	Supplier Part Number	Firm Price** \$	Extended Total [Qty x Price] \$
1	TTDAQPMFBPERSLNILN142124xxNIL	Table Side Table Four Metal Legs Self-Edge Round top Laminate 355 mm x 533 mm (14 inch -21 inch) Height 610 mm (24 inch) Diameter	12			
2	TTPSPQMPNILRSSNILN1L36xxNIL	Table Meeting room tables Four point metal base with glides Round top High Pressure Laminate top 914 mm (36 inch) Diameter	21			
3	TTPSQMPNILTSSPCC48xxNILN1L30xx	Table Meeting room tables Four post metal legs with glides Rectangular High Pressure Laminate top Center grommet 762mm ( 30 inch) x 1219mm ( 48 inch)	2			
4	MBCRAPWGDTPN1LSLPCD60xx42xxNIL20xx	Meeting Room Furniture Credenza With glides Two drawers, doors, ventilated Laminate Left and right grommet 508 mm ( 20 inch) x 1524 mm ( 60 inch) 1066 mm ( 42 inch) high	7			
5	MCMMRVPTTOON1LSN1L17362238NIL1624	Meeting Room Furniture Mobile Cart Lockable casters for carpet floors Open shelves Laminate	3			

Sollicitation No. - N° de l'invitation  
EQ754-182273/A  
Client Ref. No. - N° de réf. du client  
EQ754-182273/A

Amd. No. - N° de la modif.  
File No. - N° du dossier  
TOR-7-40129

Buyer ID - Id de l'acheteur  
TOR008  
CCC No./N° CCC - FMS No./N° VME

		482mm - 533mm (19-21 inch) x 863mm - 914mm (34-36 inch) 914 mm - 956mm( 36-38 inch) high				
6	MCMMRVPTTAPNILSLN11 7362238NIL1624	Meeting Room Furniture Mobile Cart Lockable casters for carpet floors Shelving with lockable doors Laminate 482mm - 533mm (19-21 inch) x 863mm - 914mm (34-36 inch) 914 mm - 956mm( 36-38 inch) High	3			
7	TTPSPACNILVSPDMQ144 xNILNIL60xx	Table Meeting room tables Wood Veneer panel base with wire access Oval top Wood Veneer Surface Two recessed box with 4 power and 4 data with a flexible casing 1524 mm x 3657 mm ( 60 inch x 144 inch)	2			
8	TTPSQMPNPNILOSSUEP72xx NILNIL42xx	Table Meeting room table sFour post metal legs with glides Racetrack top High Pressure Laminate top One recessed box with 4 power and 4 data with a flexible casing 1066 mm x 1828 mm (42 inch X 72 inch)	1			
9	TRFTPCVCNILTSLCED60xx NILNIL30xx	Table Flip-top C legs with lockable caster RectangularLaminate With cable and electrical-data connectivity762mm ( 30 inch) x 1524 mm ( 60 inch)	26			
<p>Non-SA (NSA) products forming part of this requirement not to exceed 20% of the firm quantity from the products above in this table.</p> <p>The Supplier signs, and certifies that all the NSA products offered will conform to all specifications and meet the testing requirements detailed at Annex D.</p>						
	NON SA product(s)	Description of Non SA	QTY			

Sollicitation No. - N° de l'invitation  
EQ754-182273/A  
Client Ref. No. - N° de réf. du client  
EQ754-182273/A

Amd. No. - N° de la modif.  
File No. - N° du dossier  
TOR-7-40129

Buyer ID - Id de l'acheteur  
TOR008  
CCC No./N° CCC - FMS No./N° VME

1	NON SA	NON SA ADD on for Flip Top Table With metal modesty panel 254mm x 406mm - 457 mm (16 inch-18 inch ) height With daisy chain connectivity and and cable tray	26			
2	NON SA	Meeting Room Furniture Credenza With glides Two drawers, doors, ventilated Laminate Left and right grommet 508 mm ( 20 inch) x 914 mm ( 36 inch) 914 mm (36 inch) high	2			
3	NON SA	Meeting Room Furniture CredenzaW ith glides Two drawers, doors, ventilated Laminate Left and right grommet 508 mm ( 20 inch) x 1524 mm ( 60 inch) 914 mm (36 inch) high	12			
	NON SA	Table C-Shaped Side Table Stainless Steel Frame Self-Edge Laminate 558 mm ( 22 inch) x 406 mm ( 16 inch) 482 mm x 660 mm ( 19 inch - 26 inch) High	30			
<p>**Must not exceed ceiling unit price in SA.</p> <p>Add more rows if necessary.</p>				Product Total		\$

Goods must be ready by March 30<sup>th</sup> 2018

Goods must be securely stored at manufactures facilities until instructed to delivery and install to site by PSPC authority. Furniture is to be secured separately and available for inspection at any time between March 30<sup>th</sup> 2018 (the final completion date) and April 30<sup>th</sup> 2018 (the date of delivery).

Furniture remains the responsibility of the supplier while in manufacture's facility.

Sollicitation No. - N° de l'invitation  
EQ754-182273/A  
Client Ref. No. - N° de réf. du client  
EQ754-182273/A

Amd. No. - N° de la modif.  
File No. - N° du dossier  
TOR-7-40129

Buyer ID - Id de l'acheteur  
TOR008  
CCC No./N° CCC - FMS No./N° VME

**Table 2 - Delivery**

Section A - IU REQUIREMENT				Section B – SUPPLIER'S BID		
Product Item # from Table 1	Location	Desired Date (Y/M/D)	Desired Time: Normal Business Hours (Normal) Or Outside Normal Business Hours (Outside)*	Supplier will deliver on the date and at the time below*	Firm _____ Price \$	Extended Total (Qty x Firm Unit Price) \$
1	9 <sup>th</sup> , 8 <sup>th</sup> , 7 <sup>th</sup> 3 <sup>rd</sup> Floors, 655 Bay Street, Toronto Ontario, ON, M5G 2K4	18-04-30	Normal Hours	(Y) (M) (D)		
*If no dates and times are added by the Supplier, the Supplier agrees to deliver on the Desired Date and Time. [Normal Business Hours 8:00 – 17:00, as per SA, Annex A, article 5] Add more rows if necessary.			Delivery Total:			\$

**Table 3 – Installation**

Section A - IU REQUIREMENT				Section B – SUPPLIER'S BID		
Product Item # from Table 1	Location	Desired Date (Y/M/D)	Desired Time: Normal Business Hours (Normal) Or Outside Normal Business Hours (Outside)*	Supplier will install on the date and at the time below*	Firm _____ Price \$	Extended Total (Qty x Firm Unit Price) \$
1	9 <sup>th</sup> , 8 <sup>th</sup> , 7 <sup>th</sup> 3 <sup>rd</sup> Floors, 655 Bay Street, Toronto Ontario, ON, M5G 2K4	18-04-30	<i>Normal Hours</i>	(Y) (M) (D)		
*If no dates and times are added by the Supplier, the Supplier agrees to install on the Desired Date and Time. [Normal Business Hours 8:00 – 17:00, as per SA, Annex A, article 5] Add more rows if necessary.			Installation Total:			\$

**Table 4 – Optional Product** ☒ Not Applicable

**Table 5 – Optional Delivery** ☒ Not Applicable

**Table 6 – Optional Installation** ☒ Not Applicable

**Table 7 – Product Related Services** ☒ Not Applicable

Sollicitation No. - N° de l'invitation  
EQ754-182273/A  
Client Ref. No. - N° de réf. du client  
EQ754-182273/A

Amd. No. - N° de la modif.  
File No. - N° du dossier  
TOR-7-40129

Buyer ID - Id de l'acheteur  
TOR008  
CCC No./N° CCC - FMS No./N° VME

**Table 8 – Standard Finishes and Canada's Facilities to Accommodate the Delivery and Certifications**

<b>1.</b>	<b>Standard Finishes</b>	
1.1	<p>IU is to consult the Supplier's Website identified in Part 6A of the SA to view the available finishes.</p> <p>Within ten business days of the contract award, the Contracting Authority will provide the Contractor with a written notice of Canada's finish choices for each of the product(s) in Annex A.</p> <p>The Contractor will deliver the products corresponding to Canada's choice of specific finishes(s). No additional charge will be applied to Canada.</p>	
<b>2.</b>	<b>Canada's Facilities to Accommodate the Delivery</b>	
2.1	Loading Dock/Location	
A	Location	655 Bay Street, Toronto, ON, M5G 2K4
B	Dock	Yes
C	Lift	Standard Freight Elevator
D	Door	Standard Freight Elevator
2.2	Freight Elevator	Rear of Building
2.3	Other (specify, if any)	
	<b>Continuance of Certifications</b>	
	<p>The Bidder certifies that by submitting a bid in response to the RFB, the Bidder, and any of the Bidder's members if the Bidder is a Joint Venture, continues to comply with all of the certifications listed in Parts 6A and 6B of the Bidder's SA for Work Spaces, as follows:</p>	
3.1	Integrity Provisions	
3.2	Federal Contractor's Program for Employment Equity	
3.4	Product Conformance	
3.5	Price Certification (In accordance with the SA, Part 6B)	

**Table 9 - Bid Evaluation and Contract Total (Canada may complete if not completed by the Bidder)**

1	Product Total (Table 1) or Annex C Total	\$
2	<b>Optional</b> Product Total (Table 4)	\$
3	Delivery Total (Table 2)	\$
4	<b>Optional</b> Delivery Total (Table 5)	\$
5	Installation Total (Table 3)	\$
6	<b>Optional</b> Installation Total (Table 6)	\$
7	Product Related Services Total (if applicable) (Table 7)	\$
8	NSA Total (if applicable)	\$
9	Hardware Total as per article 1.5 of Annex A-1 of SA (if applicable)	\$
10	<b>Total Evaluated (Bid) Price* (1 + 2 + 3 + 4 + 5 + 6+ 7+8+9):</b>	\$\$
11	Applicable Tax(es):	\$
12	Total Estimated Cost (10+11):	\$

**Table 10 – Bidder's Authorized Representative**

<b>Table 6 – Bidder's Authorized Representative</b>		
1.	Bidder's Authorized Representative for the Bid and the Contract	
	Name:	Telephone:
		E-Mail:
		Other:

**\*At contract award, "Total Evaluated (Bid) Price" becomes "Contract Price".**



Sollicitation No. - N° de l'invitation  
EQ754-182273/A  
Client Ref. No. - N° de réf. du client  
EQ754-182273/A

Amd. No. - N° de la modif.  
File No. - N° du dossier  
TOR-7-40129

Buyer ID - Id de l'acheteur  
TOR008  
CCC No./N° CCC - FMS No./N° VME

**PRODUCT CATEGORY: 6 - Collaborative Furniture**

**Table 1 – Product (Only applicable for Scenario A procurements)**

Section A - IU REQUIREMENT				Section B – SUPPLIER'S BID		
#	GoCUID	Description of Product (optional field)	Qty	Supplier Part Number	Firm _____ Price** \$	Extended Total [Qty x Price] \$
1	SREFRQRRDPATUNILOM CFFTFNILNILNIL	Soft Seating Lounge Chair Four casters with two locking Back handle, cup holder and shelf at base Universal Tablet Arm Metal frame Fixed cushions Fabric	34			
2	SREFRQPPNILAWANILOMC FFSINILNILNIL	Soft Seating Lounge Chair Four legs with glides for carpets With arms Metal frame Fixed cushions Leather-like	4			
3	SRESTQPANILAWANILOMC FFSINILNILNIL	Soft Seating Sofa for three adults Four legs with glides With arms Metal frame Fixed cushions Leather-like	6			
4	SREBMQPNSTDSAWUSOO BABCTF2535NIL1934	Seating Modular Benching Unit Four legs with non-marking adjustable glides Without Square Side Table Without arms one seat Solid Hardwood frame With Velcro attachment Fabric 482 mm x 876 mm (19 inch-34.5 inch)635 mm x 889 mm (25 inch-35 inch)	8			
5	SCNCCTSBNILSAWNILNLP PNNILNILNILNIL	Kitchenette Seating Kitchenette Chair Four Legs Without Arms	52			

Sollicitation No. - N° de l'invitation  
EQ754-182273/A  
Client Ref. No. - N° de réf. du client  
EQ754-182273/A

Amd. No. - N° de la modif.  
File No. - N° du dossier  
TOR-7-40129

Buyer ID - Id de l'acheteur  
TOR008  
CCC No./N° CCC - FMS No./N° VME

		Non-Perforated Molded Plastic or Polyamide				
<b>**Must not exceed ceiling unit price in SA.</b>  Add more rows if necessary.				Product Total		\$

Goods must be ready by March 30<sup>th</sup> 2018

Goods must be securely stored at manufactures facilities until instructed to delivery and install to site by PSPC authority. Furniture is to be secured separately and available for inspection at any time between March 30<sup>th</sup> 2018 (the final completion date) and April 30<sup>th</sup> 2018 (the date of delivery).

Furniture remains the responsibility of the supplier while in manufacture's facility.

**Table 2 - Delivery**

Section A - IU REQUIREMENT				Section B – SUPPLIER'S BID		
Product Item # from Table 1	Location	Desired Date (Y/M/D)	Desired Time: Normal Business Hours (Normal) Or Outside Normal Business Hours (Outside)*	Supplier will deliver on the date and at the time below*	Firm _____ Price \$	Extended Total (Qty x Firm Unit Price) \$
1	9 <sup>th</sup> , 8 <sup>th</sup> , 7 <sup>th</sup> 3 <sup>rd</sup> Floors, 655 Bay Street, Toronto Ontario, ON, M5G 2K4	18-04-30	Normal Hours	(Y) (M) (D)		
*If no dates and times are added by the Supplier, the Supplier agrees to deliver on the Desired Date and Time. [Normal Business Hours 8:00 – 17:00, as per SA, Annex A, article 5] Add more rows if necessary.				Delivery Total:		\$

**Table 3 – Installation**

Section A - IU REQUIREMENT				Section B – SUPPLIER'S BID		
Product Item # from Table 1	Location	Desired Date (Y/M/D)	Desired Time: Normal Business Hours (Normal) Or Outside Normal Business Hours (Outside)*	Supplier will install on the date and at the time below*	Firm _____ Price \$	Extended Total (Qty x Firm Unit Price) \$
1	9 <sup>th</sup> , 8 <sup>th</sup> , 7 <sup>th</sup> 3 <sup>rd</sup> Floors, 655 Bay Street, Toronto Ontario, ON, M5G 2K4	18-04-30	Normal Hours	(Y) (M) (D)		

Sollicitation No. - N° de l'invitation  
EQ754-182273/A  
Client Ref. No. - N° de réf. du client  
EQ754-182273/A

Amd. No. - N° de la modif.  
File No. - N° du dossier  
TOR-7-40129

Buyer ID - Id de l'acheteur  
TOR008  
CCC No./N° CCC - FMS No./N° VME

*If no dates and times are added by the Supplier, the Supplier agrees to install on the Desired Date and Time. [Normal Business Hours 8:00 – 17:00, as per SA, Annex A, article 5] Add more rows if necessary.	Installation Total:	\$
---	---------------------	----

**Table 4 – Optional Product** ☒ Not Applicable

**Table 5 – Optional Delivery** ☒ Not Applicable

**Table 6 – Optional Installation** ☒ Not Applicable

**Table 7 – Product Related Services** ☒ Not Applicable

**Table 8 – Standard Finishes and Canada's Facilities to Accommodate the Delivery and Certifications**

<b>1.</b>	<b>Standard Finishes</b>	
1.1	<p>IU is to consult the Supplier's Website identified in Part 6A of the SA to view the available finishes.</p> <p>Within ten business days of the contract award, the Contracting Authority will provide the Contractor with a written notice of Canada's finish choices for each of the product(s) in Annex A.</p> <p>The Contractor will deliver the products corresponding to Canada's choice of specific finishes(s). No additional charge will be applied to Canada.</p>	
<b>2.</b>	<b>Canada's Facilities to Accommodate the Delivery</b>	
2.1	Loading Dock/Location	
A	Location	655 Bay Street, Toronto, ON, M5G 2K4
B	Dock	Yes
C	Lift	Standard Freight Elevator
D	Door	Standard Freight Elevator
2.2	Freight Elevator	Rear of Building
2.3	Other (specify, if any)	
	<b>Continuance of Certifications</b>	
	<p>The Bidder certifies that by submitting a bid in response to the RFB, the Bidder, and any of the Bidder's members if the Bidder is a Joint Venture, continues to comply with all of the certifications listed in Parts 6A and 6B of the Bidder's SA for Work Spaces, as follows:</p>	
3.1	Integrity Provisions	
3.2	Federal Contractor's Program for Employment Equity	
3.4	Product Conformance	
3.5	Price Certification (In accordance with the SA, Part 6B)	

**Table 9 - Bid Evaluation and Contract Total (Canada may complete if not completed by the Bidder)**

1	Product Total (Table 1) or Annex C Total	\$
2	<b>Optional</b> Product Total (Table 4)	\$
3	Delivery Total (Table 2)	\$
4	<b>Optional</b> Delivery Total (Table 5)	\$
5	Installation Total (Table 3)	\$
6	<b>Optional</b> Installation Total (Table 6)	\$
7	Product Related Services Total (if applicable) (Table 7)	\$
8	NSA Total (if applicable)	\$
9	Hardware Total as per article 1.5 of Annex A-1 of SA (if applicable)	\$

Sollicitation No. - N° de l'invitation  
EQ754-182273/A  
Client Ref. No. - N° de réf. du client  
EQ754-182273/A

Amd. No. - N° de la modif.  
File No. - N° du dossier  
TOR-7-40129

Buyer ID - Id de l'acheteur  
TOR008  
CCC No./N° CCC - FMS No./N° VME

10	<b>Total Evaluated (Bid) Price* (1 + 2 + 3 + 4 + 5 + 6+ 7+8+9):</b>	\$ \$
11	Applicable Tax(es):	\$
12	Total Estimated Cost (10+11):	\$

**Table 10 – Bidder’s Authorized Representative**

Table 6 – Bidder’s Authorized Representative		
1.	Bidder’s Authorized Representative for the Bid and the Contract	
	Name:	Telephone:
		E-Mail:
		Other:

**\*At contract award, “Total Evaluated (Bid) Price” becomes “Contract Price”.**

Sollicitation No. - N° de l'invitation  
EQ754-182273/A  
Client Ref. No. - N° de réf. du client  
EQ754-182273/A

Amd. No. - N° de la modif.  
File No. - N° du dossier  
TOR-7-40129

Buyer ID - Id de l'acheteur  
TOR008  
CCC No./N° CCC - FMS No./N° VME

**ANNEX B**  
**FLOOR PLAN(s)**

**SEE ATTACHMENT**

Sollicitation No. - N° de l'invitation  
EQ754-182273/A  
Client Ref. No. - N° de réf. du client  
EQ754-182273/A

Amd. No. - N° de la modif.  
File No. - N° du dossier  
TOR-7-40129

Buyer ID - Id de l'acheteur  
TOR008  
CCC No./N° CCC - FMS No./N° VME

## ANNEX C

### Non Supply Arrangement (NSA) Products

This Annex includes the Specifications, Products and Pricing, Certifications associated with NSA products forming part of the requirement.

#### 1. Specifications

*As per Annex A Requirement and Basis of Payment*

#### 2. Product and Pricing

Bidder to complete: Table 1 at Sections B of the tables identified by the IU as well as Tables 9 and 10 of Annex A. In a resulting contract, the term "Bid" means the Supplier's commitment, the term "Bidder" means "Contractor".

#### 3. Certification

##### **NSA Product Conformance** (Required precedent to Issuance of a contract)

The Supplier certifies that all the NSA products offered will conform to all specifications of, and meet the testing requirements detailed in Annex D of this RFB.

---

Supplier's Signature

---

Date

##### **NSA Product Conformance Certification** (applies after contract award)

The Supplier warrants that the NSA Product Conformance Certification submitted by the Supplier with its bid is accurate and complete. The Supplier must keep proper records and documentation relating to the NSA product conformance and the testing requirements in Annex D. The Supplier must not, without obtaining the prior written consent of the SAA, dispose of any such records or documentation until the expiration of the Contract or the expiry date of the Warranty, whichever is later. All such records and documentation must at all times during the retention period be open to audit, inspection and examination by the representatives of Canada, who may make copies and take extracts.

In addition, the Supplier must provide representatives of the SAA access to all locations where any part of the Work is being performed at any time during working hours. Representatives of the SAA may examine and test the Work as they see fit. The Supplier must provide all assistance and access to facilities, test pieces, samples and documentation that the representatives of the SAA may reasonably require for the carrying out of the inspection, which may also include the submission of test reporting documentation as listed in Annex D. The Supplier must forward such test pieces, samples and/or documentation that may also include letters of certification from the laboratories to such person or location as the representatives of the SAA specifies.









INAC TORONTO  
655 BAY STREET  
PANEL MATRIX

HEIGHT ADD ON	
TAPOABLE	TAPOABLE
FABRIC	FABRIC
REF 1	REF 2

HEIGHT ADD-ON	
FIG. 1	FIG. 2

HEIGHT ADD ON	
ITEM 1	ITEM 2
TABLE	WHITE BOARD
CUT OUTS / FRAME	PAINT

HEIGHT ADD ON	
FIG. 1	FIG. 2

HEIGHT ADD-ON	
OUT GUTS / TACKABLE	TACKABLE
PAINTED	PAINTED

PANEL E	
OUT OUTS / TACKABLE	OUT OUTS / TACKABLE
FABRIC	FABRIC

PANEL F	
FIG. 1	FIG. 2
TACKABLE	TACKABLE
OUT OUTS / FASHING	OUT OUTS / FASHING
FIG. 3	FIG. 4

FIG. 5

## LEGEND

- ▶ PANEL OUTLETS ABOVE WORKSURFACE
- ▶ ELECTRICAL DUPLEX OR TRIPLEX OUTLET
- ▶ WORK-DATA OUTLET LOCATION

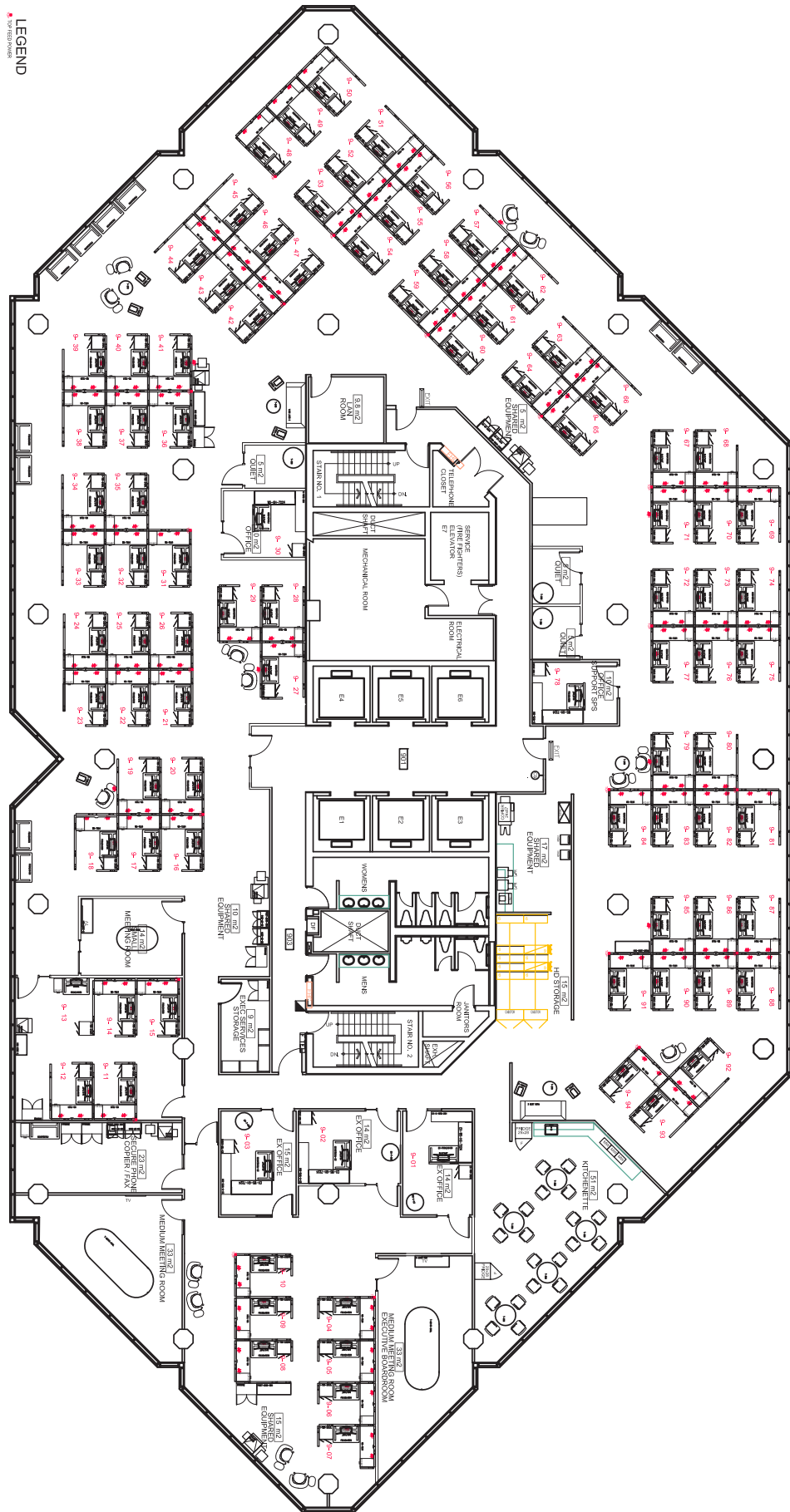

INAC TORONTO  
655 BAY STREET  
PANEL MATRIX

SEATED PRIVACY HEIGHT ADD ON	TACKABLE	TACKABLE
	FABRIC	FABRIC
	SIDE 1	SIDE 2

PANEL A

SEATED PRIVACY HEIGHT ADD ON	TACKABLE	WHITE BOARD
	FABRIC	FABRIC
	SIDE 1	SIDE 2

PANEL B

SEATED PRIVACY HEIGHT ADD ON	TACKABLE	WHITE BOARD
	CUT OUTS / FABRIC	FABRIC
	SIDE 1	SIDE 2

PANEL C

SEATED PRIVACY HEIGHT ADD ON	TACKABLE	TACKABLE
	CUT OUTS / FABRIC	FABRIC
	SIDE 1	SIDE 2

PANEL D

SEATED PRIVACY HEIGHT ADD ON	CUT OUTS / TACKABLE	TACKABLE
	FABRIC	FABRIC
	SIDE 1	SIDE 2

PANEL E



SEATED PRIVACY HEIGHT ADD ON	CUT OUTS / TACKABLE	CUT OUTS / TACKABLE
	FABRIC	FABRIC
	SIDE 1	SIDE 2

PANEL F

SEATED PRIVACY HEIGHT ADD ON	TACKABLE	TACKABLE
	CUT OUTS / FABRIC	CUT OUTS / FABRIC
	SIDE 1	SIDE 2

PANEL G

LEGEND

-  TOP
- TOP FEED POWER
-  PANEL OUTLETS ABOVE WORKSTATION
- 1 ELECTRICAL DUPLEX OR TRIPLEX OUTLET
- 1 VOICE-DATA OUTLET LOCATION
-  PANEL OUTLETS BELOW WORKSTATION
- 1 ELECTRICAL DUPLEX OR TRIPLEX OUTLET
- 1 VOICE-DATA OUTLET LOCATION

AS PER REVISED WORKPLACE 2.0 - 3 DUPLEX RECEPTACLES PER WORKSTATION OR 3 TRIPLEX RECEPTACLES PER WORKSTATION (1 CIRCUIT PER 3 WORKSTATIONS)  
1 IMAGE/VOICE/DATA OUTLET (NOTE: CLIENT TO PROVIDE ACTUAL CONNECTORS AND JACKS, TYPICALLY RJ45 WITH MULTIPLE JACKS)

INSIDE STORAGE  
RECORDS