



RETURN BIDS TO:

RETOURNER LES SOUMISSIONS Á:

**Parks Canada Agency**  
**1300 - 635 8 Ave SW**  
**Calgary, AB T2P3M3**  
**Bid Fax: 1-866-246-6893**

AMENDMENT / MODIFICATION

003

**Tender To: Parks Canada Agency**

We hereby offer to sell to Her Majesty the Queen in right of Canada, in accordance with the terms and conditions set out herein, referred to herein or attached hereto, the goods, services, and construction listed herein and on any attached sheets at the price(s) set out therefor.

**Soumission aux: l'Agence Parcs Canada**  
 Nous offrons par la présente de vendre à Sa Majesté la Reine du Chef du Canada, aux conditions énoncées ou incluses par référence dans la présente at aux annexes ci-jointes, les biens, services et construction énumérés ici et sur toute feuille ci-annexée, au(x) prix indiqué(s).

Comments - Commentaries

Vendor/Firm Name and Address  
 Raison sociale et adresse du fournisseur/de l'entrepreneur

Issuing Office - Bureau de distribution

**Parks Canada Agency**  
**Suite 1300**  
**635 – 8 Ave SW**  
**Calgary, AB T2P3M3**

<b>Title-Sujet</b> Logan Creek Bridge Construction – Pacific Rim National Park		
<b>Solicitation No. - No. de l'invitation</b> 5P420-17-5450/A	<b>Date:</b> January 26, 2018	
<b>GETS Reference No. – No de reference de SEAG</b> PW-18-00810188	<b>Amendment No. - N° de la modif.</b> PR00005	
<b>Solicitation Closes:</b>		
<b>at – á</b> 02:00 PM	<b>on – le</b> February 1, 2018	<b>Time Zone - Fuseau horaire</b> MST - HNR
<b>F.O.B. - F.A.B.</b> <b>Plant-Usine:</b> <input type="checkbox"/> <b>Destination:</b> <input checked="" type="checkbox"/> <b>Other-Autre:</b> <input type="checkbox"/>		
<b>Address Inquiries to: - Adresser toute demande de renseignements à :</b> Rebecca Chen		
<b>Telephone No. - No de téléphone</b> (403) 292-8509	<b>Fax No. – No de FAX:</b> 1-866-246-6893	
<b>Destination of Goods, Services, and Construction:</b> <b>Destinations des biens, services et construction:</b> See Herein – Voir ici		

**TO BE COMPLETED BY THE BIDDER (type or print)**

<b>Vendor/Firm Name</b>	
<b>Address - Adresse</b>	
<b>Name of person authorized to sign on behalf of the Vendor/Firm</b> <b>Nom de la personne autorisée a signer au nom du fournisseur/ de l'entrepreneur</b>	
<b>Titale - Titre</b>	
<b>Telephone No. - N° de telephone:</b>	_____
<b>Facsimile No. - N° de télécopieur:</b>	_____
<b>Signature</b>	<b>Date</b>

### Amendment 03

This amendment is being raised to extend the solicitation closing date and to distribute the presentation, attendees, meeting minutes, questions and answers from the bidder's conference.

#### A) BID CLOSING DATE

The closing date for tender 5P420-17-5450/A is extended from January 30, 2018 to **February 1, 2018 at 2:00PM Mountain Standard Time (MST)**.

The deadline for questions will remain the same: Friday, January 26 at 12PM PST.

#### B) PRESENTATION

See attached at the end of this document.

#### C) BIDDERS CONFERENCE ATTENDEES

Attendees at the conference:

	Vendor	Name
1	Kingston Construction	Ben Backman Jeremy Woodman
2	Robson Energy	Andreas Thoni
3	Online Constructors Ltd	Khalid Mohammed
4	Seismic 2000	Dave Lammers

Attendees via phone:

	Vendor	Name
1	PACIFIC Industrial & Marine Ltd	John Ellis Brian
2	Big Rock Construction Company Ltd	Tom Falladown
3	Rudskin Construction Ltd.	Brian Moore
4	CMF Construction Ltd	Carla
5	Expanse Inc/ Canadian Rescue	Steven Stanley Sean Alexander

Contact information for the attendees are available upon request and approval from the vendors.

## D) BIDDERS CONFERENCE - MEETING MINUTES

**Project:** Logan Creek Bridge Construction

**Date:** January 23, 2018 **Time:** 9:00am PST

**Meeting Location:** Library Square, Vancouver BC or teleconference

*Powerpoint presentation on Project Introduction, Scheduling, and Site Conditions is available as an attachment at the end of this document*

### DISCUSSION NOTES:

Patrick Lam & Shelly Zhao, CWMM

- Danger tree removal and site clearing need to be complete by March 12<sup>th</sup>
- Abutment location will be confirmed after site clearing and excavation
- The contractor will need to do a survey after site clearing and excavation is complete to confirm the exact abutment locations and bridge span
- New trail connections to be provided after the new bridge is constructed
- Differing site conditions will be dealt with through a change order
- The main control item for the bridge design is based on the pulling force at the back cables as per the contract drawings
- After bridge construction completion, the existing bridge including the main cable will need to be removed, however the main bridge anchors can stay
- All wood anchors and ladders need to be removed
- Temporary access to the existing Logan creek ladder system will need to be provided as per the contract documents and the existing unstable slope leading up to the existing abutment

### MEETING QUESTIONS AND FOLLOW UP ANSWERS:

Note: some questions asked and answered at the meeting were already submitted and are answered in amendment 2 Q&A's

**Q1** What would be appropriate for temporary access?

**A1** Temporary access needs to be provided for workers and consultants to safely access the site from Logan Creek and must satisfy work safe BC requirements.

**Q2** Please clarify the requirements of the camp site the contractor is to provide for the departmental representative and others. Would you consider removing this from the contract?

**A2** The Contractor's campsite must be set up in a manner that avoids additional disturbance to the campground (no additional clearing or removal of vegetation without Parks Canada's consent).

During the open season of the West Coast Trail, Parks Canada will work with the contractor to ensure adequate space at one of the camp sites and will be dependent on how many personnel will be on site (number of tents and facilities, ect). The contractor should present its camp site plans to Parks Canada to be reviewed. In addition to this discussion, the Contractor's is also responsible for adhering to the BARE campsite program – Appendix A of the EMP. The requirement remains part of the contract.

**Q3** Will the Park allow boat access, landing, and parking for construction? If yes, please clarify where. Discussion from contractors in boardroom warn that consistent boat access to the site will be very difficult.

**A3** Parks Canada does not recommend depending on boat access for this project and will not issue a Permit to access the site by boat.

**Q4** Will the Park allow the contractor to stage a barge off shore of Logan creek for disposal of materials?

**A4** Anchoring a barge off shore within the Park boundaries will require a Park permit. The Park will limit the permit to no overnight anchoring as well as other conditions such as cleanup of any lost materials from the barge.

**Q5** There are 18 site inspections that the contractor must supply helicopter transportation for. Can you please clarify inspection times that will require separate trips.

**A5** The contractor will need to provide helicopter transportation for inspections as per the specification such as upon completion of excavation and rebar placement, and rock anchor testing. Other inspections will be coordinated with the contractor and will be dependent on site conditions and inspection requirements.

**Q6** The specification seems very generic and some sections are not attainable for this project. Would it be possible for the consultant to go through the specification and remove these sections?

**A6** The specifications will be further reviewed and any revisions, if considered necessary, will be issued as addendum.

**Q7** How do you plan to pay for the drilling requirements for between the surface and bond?

**A7** The minimum bond length is specified on the drawings. Any differing site conditions will be addressed by change order

**Q8** In the danger tree assessment spiral pruning is recommended. Can you please clarify which tree's require pruning and how much pruning?

**A8** Spiral pruning should be used to windfirm the residual stand. This will entail pruning a third of the canopy in trees that border wind affected edges, usually 1-3 trees deep along the edge

**Q9** Will there be any trail closures allowed during flying materials to site?

**A9** Limited trail closures will be permitted by Parks during slinging operations upon approval from the Park. These will be limited to 30 minutes in duration and there must be 30 minutes between closures to allow hikers to pass through the area. The contractor must notify the Park 48 hours in advance of these closures and supply appropriate personnel to hold back any hikers until it is safe to continue on the trail.

**Q10** What exactly are we required to enclose with chain link fence? Exactly how many lineal feet is required? Could we use snow fencing or caution tape?

**A10** A fence should be in place to stop trail users from entering the construction zone. A snow fence will be acceptable instead of the specified chain link. The snow fence must be kept in good condition throughout the duration of the project. The length of fence required needs to be long enough to delineate the contractor's construction zone.

**Q11** Are we allowed to bring an excavator to site?

**A11** No – The work is to be undertaken using hand and power tools with no excavators or tracked machines to be used. Equipment may include, but not necessarily be limited to: drills, jack hammers, grinders, and power saws.

**Q12** How will the 5 year minimum experience be evaluated required in the specification, Division 05, Metal?

**A12** The tender will be evaluated on price only. After award, Parks Canada will verify with the successful contractor that they meet this requirement.

**Q13** After the trees are cleared, where can they be put?

**A13** Any cut trees are to be left on site to provide woody debris and habitat complexing for wildlife. The Environmental Monitor and Parks Canada can provide direction on suitable locations (e.g., away from the path and not on top of any sensitive vegetation or features such as the unnamed watercourse)

**Q14** Please clarify CDV volume?

**A14** As clarified in amendment 2, Q19, the drawing shows the area and depth required. Anything over and above this amount will be dealt with through and change order.

**Q15** Will there be adjustment on the cables considered through design changes on the I-bolt?

**A15** The consultant will consider design change proposals through a submission from the successful contractor. This should not affect bidding.

Solicitation No. - N° de l'invitation  
5P420-17-5450/A

Amd. No. - N° de la modif.  
003

Buyer - l'acheteur  
Rebecca Chen

Client Ref. No. - N° de réf. du client  
PR00005

File Name - Nom du dossier  
Logan Creek Bridge Construction – Pacific Rim National Park

---

**Q16** Will the geotechnical engineer be required to be on site for the testing of all rock anchors?

**A16** As per the contract specifications, the rock anchors must be proof tested by the contractor. The geotechnical engineer will test 2 anchors per side.

**Q17** How are the access points from Logan creek to the first platforms supposed to be controlled so that hikers do not use them to get to the creek, if they are a semi-permanent structure for the duration of the contract?

**A17** Access from the ladder platforms down to Logan creek should be blocked and signed to prevent hikers from using. Snow fencing would be appropriate to use.

**Q18** Can we run a trail in from the logging grounds and then reinstate it after contract completion? Alternatively this would provide an egress in case of a hiker emergency.

**A18** No, the Park will not allow a trail to be constructed.

**Q19** Can we modify the trail between job site and campsite if required?

**A19** Any modifications to the trail between the job site and camp site would have to first be approved by the Park. Modifications such as removing fallen logs across the trail would be permitted. Modifications such as building boardwalk on the trail would first go through a design review by Parks before being approved.

## **E) QUESTION AND ANSWERS SUBMITTED VIA EMAIL**

**Q1** Will there be a site visit permitted prior to tender closing? Either hike in with guide or Heli?

**A1** There will be no official site visit. If contractors wish to visit the site they must apply for a Park helicopter landing Permit through the contracting officer and make their own arrangements.

**Q2** Can we source water for drilling and grouting operations from Logan Creek?

**A2** Dependent upon the contractor's required quantity of water, a water draw permit may be required. Any containers used for withdrawal would also have to be clean and free of potential contaminants (e.g., concrete leachate). The contractor will be issued a restricted use permit for using small volumes of water from Logan Creek.

**Q3** When hole where dug on site did water build up in the excavations or did the water escape? Slowing? Please comment?

*Seepage conditions are anticipated to be variable and in general, manageable with conventional sump and pump / ditching techniques. Adverse groundwater seepage conditions could be encountered in an excavation in the vicinity of the existing watercourse shown on Figure 2.*

**A3** Text of report remains valid.

- Seepage did not dissipate or drain away
- seepage was worst near the drainage feature
- it is anticipated that if seepage can be intercepted at the perimeter it will not be a significant issue in the excavation middle (possible exception is drainage feature)
- seepage varied as some areas were sandier than others

**Q4** If the contractor is asked to provide and maintain their own walk in access to the sites, can you provide any information on the approximate time/man-hours per kilometer" that is has taken to open the trail in past years?

**A4** The distance between Walbran Creek campsite and Logan Creek is approximately 3km and the distance between Cullite Creek campsite and Logan Creek is approximately 2km. The West Coast Trail is a back country hiking trail. There are numerous ladders between the camp sites and Logan Creek and the trail conditions may vary. It is estimated that hiking from the campsites to the job site could take between 1 to 2 hours.

**Q5** As indicated in General Instructions, the contractor is to arrange multiple site visits via helicopter for the Departmental Representative and their staff. Please provide an approximate departure location for the site visits.

**A5** Nanaimo, BC.

**Q6** Are there any campsite requirements or amenities the Contractor is to provide to the Department Representative staff?

**A6** The Contractor's campsite must be set up in a manner that avoids additional disturbance to the campground (no additional clearing or removal of vegetation without Parks Canada's consent). During the open season of the West Coast Trail, Parks Canada will work with the contractor to ensure adequate space at one of the camp sites and will be dependent on how many personnel will be on site (number of tents and facilities, ect). The contractor should present its camp site plans to Parks Canada to be reviewed. In addition to this discussion, the Contractor's is also responsible for adhering to the BARE campsite program – Appendix A of the EMP.

**Q7** Will the Contractor's personnel be subjected to any permit and passes for overnight stays at the camp sites? Can Parks Canada Agency prioritize camp site reservation for the Contractor's personnel?

**A7** The Park will permit camping at the locations specified in the contract documents on the West Coast Trail for the duration of the contract. Individual camp sites are not reservable, however the Park will work with the contractor to ensure there is an adequate area for set up of the contractor's camp.

**Q8** Can helicopter landings be permitted at the camp sites?

**A8** Helicopter landings will be permitted at Cullite, Walbran, and Logan through the contractors Park helicopter landing permit. Landings could be limited by tides, weather, and other trail users.

**Q9** Is contact information available for the company that provided helicopter services for the previous site investigations?

**A9** West Coast Helicopters based out of Nanaimo.

**Q10** Our understanding of the final abutment location/layout will be confirmed by the Department Representative after clearing and excavation. If the final abutment location deviates from tender drawings will the Department at that point provide "issued for construction" drawings with revised dimensions of bridge and substructure components?

**A10** A set of drawings issued for construction can be provided once the final abutment locations are confirmed after clearing and excavation. Contractor will need to provide a survey to confirm the bridge span based on the finalized abutment locations to Departmental Representative for the preparation of construction set drawings.

**Q11** Could there a bonus if the project is completed by June 1 2018?

**A11** No.

**Q12** Can limbs and or trees be cut," without delaying surveyors once there on site" in order to provide adequate layout?

**A12** As outlined in the EMP, pre-clearance surveys (approximately 3 days) are required to be conducted within a 5 day advance period of clearing by the Environmental Monitor (Hemmera). Trees and vegetation within the work area may be cut if the Environmental Monitor has not identified active nests within the clearing area and provides approval for the works to commence. The works are to be scheduled with advance notice provided to the Environmental Monitor (preferably at least two weeks).

**Q13** Has the design Consultant considered provision for adjustment of the main cable profile by way of turnbuckle(s) or threaded rod system to be incorporated within the back stays? The current pin/pin/pin connections add far more difficulty in achieving the design cable profile during construction.

**A13** Using turnbuckles as needed to allow the achievement of the design cable profile is acceptable provided that the turnbuckle connection provided can develop the strength of the back cable and the back cable pulling force (tension force) bridge self-weight satisfies the specified 150kN.

**Q14** As shown on Drawing S302 – Site Plan, the drawing noted "Provide new trail access to new bridge, actual location to be confirmed on site by DR". Please clarify if the new trail access is intended to be included in the scope of work.

**A14** Yes. Contractor will need to provide new trail access connecting the existing trail to new bridge on both ends.

**Q15** As per section 1.13.1.12 of the General Instructions, the contractor is to provide access from the beach to the new abutments. Please clarify if the access is temporary or permanent and provide details of what needs to be constructed.

**A15** The access is temporary and should be removed and disposed from the site once the bridge installation is complete after a final site review by the Departmental Representative. The temporary access will be designed, supplied and installed by the contractor to satisfy the Worksafe BC requirements.

**Q16** Can as-built drawings of the existing bridge be provided? If drawings are not available can details of materials used be provided?

**A16** No existing as-built drawings are available. Please refer to the following information for details of existing bridge construction.

GPS Coordinates	Longitude (W)	Latitude (N)	Elev. MSL (m)
Centre of Bridge	124° 36.974'	48° 34.254'	37.0

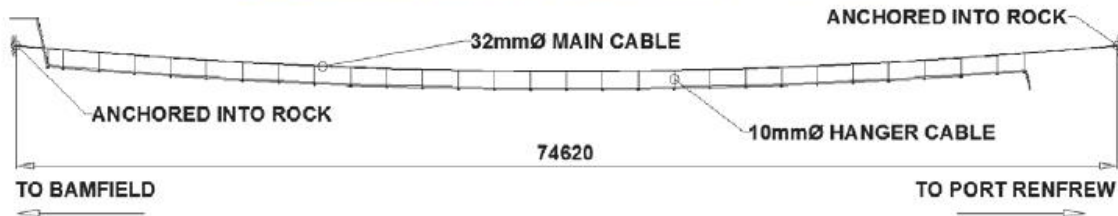

ELEVATION

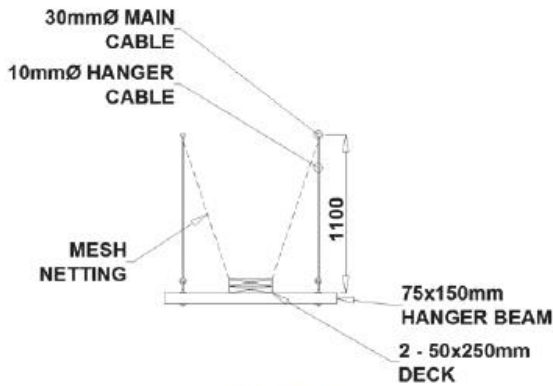

SECTION

Description:

1. Timber suspension main span with 32.0 mm diameter main steel cable
2. Ladder approaches at each end of main span
3. Timber plank decking
4. Rope mesh railing
5. Clearance to water level 20 m

All other terms and conditions remain unchanged.



Bidders' Conference Meeting

# **LOGAN CREEK BRIDGE CONSTRUCTION**

Jan 23, 2018

# Bidders Meeting Agenda

- Introduction
  - Scheduling
  - Site Conditions
- Project – Technical Info
  - Questions?

# **INTRODUCTION**

# Logan Creek Bridge

Logan Creek Bridge is located on the west coast of Vancouver Is, ~19km SW from the Gordon River Trail head on the West Coast Trail within the Pacific Rim National Park.



# Logan Creek Bridge

The current 75m Logan Creek Bridge had become a safety hazard due to the unstable rock conditions of the existing bridge and ladder anchoring system.

A new 113m span suspension bridge will be construction just upstream of the existing bridge.



# Project Scope

The construction of the new Logan Creek Bridge will involve the following items (generally):

- Clear site for new bridge construction.
- Supply & construct suspension bridge.
- Supply & construct access to bridge.
- Removal & disposal of existing bridge & ladder system.

# Document Changes and Amendments

This Bidders' Conference Meeting is for information purposes only. Items discussed here do not change any of the Contract Documents.

Bidders must rely on the published Addenda for official answers to questions that are raised during the meeting and not currently covered by the contract documents.

An Addenda will be posted with the questions and answers from this meeting.

# Invitation to Tender

The Invitation to Tender document contains all the information on the following contract items:

- Bid submittal requirements
- Special Instructions to Bidders
- General Instructions – Construction Services
- Bid Security Requirements
- Insurance Conditions
- Contract Documents
- Bid and Acceptance Form

Questions and clarifications with these or other items outside this meeting are to be directed to the Park Canada Contracting Officer, Rebecca Chen.



# Project Personnel

- Project Leader (Parks) – Jackie Hicks
- Contracting Officer (Parks) – Rebecca Chen
- Structure Engineers (CWMM) – Patrick Lam, Shelly Zhao
- Geotechnical Engineer – WSP
- Environmental – Hemmera
- Archeological - Millenia

# Scheduling

- **Jan 25<sup>rd</sup>**: Bid conference meeting questions and answers to be posted
- **Jan 26<sup>th</sup>**: Bid question deadline, 12pm PST
- **Jan 30<sup>th</sup>**: Bid closing, 2pm MST (mountain standard time)
- **Feb 7<sup>th</sup>**: Proposed contract award

Construction scheduling to be done after contract award. Work to be completed by Sept 30, 2018.

# **SITE CONDITIONS**

# Site Access

The Logan Creek Bridge is most easily accessed by helicopter.

There is a logging road ~6km away that may be used for access, subject to weather conditions.

The contractor must apply for a Business License and Park permit for helicopter landings before entering or working in the Park.



Bamfield

Pacific Rim  
National  
Park Reserve

Pachena Beach

Nitinat Lake

Clo-oose

Carmanah  
Walbran  
Provincial  
Park

Logan Creek  
West Coast Trail

Port Renfrew

14

Google



# Site Access





# Site Access – Helicopter





# Site Access – East Abutment





# Site Access – West Abutment





# Site Visit

There is no scheduled site visit. If contractor wants to visit the site they must apply for a Park Helicopter landing permit through the Parks contracting officer.





# Existing Logan Creek Bridge





# Camping

Camping is available at Cullite Creek or Walbran Creek

Walbran (km53) – Logan (km56): 3km

Cullite (km58) – Logan (km56) : 2km

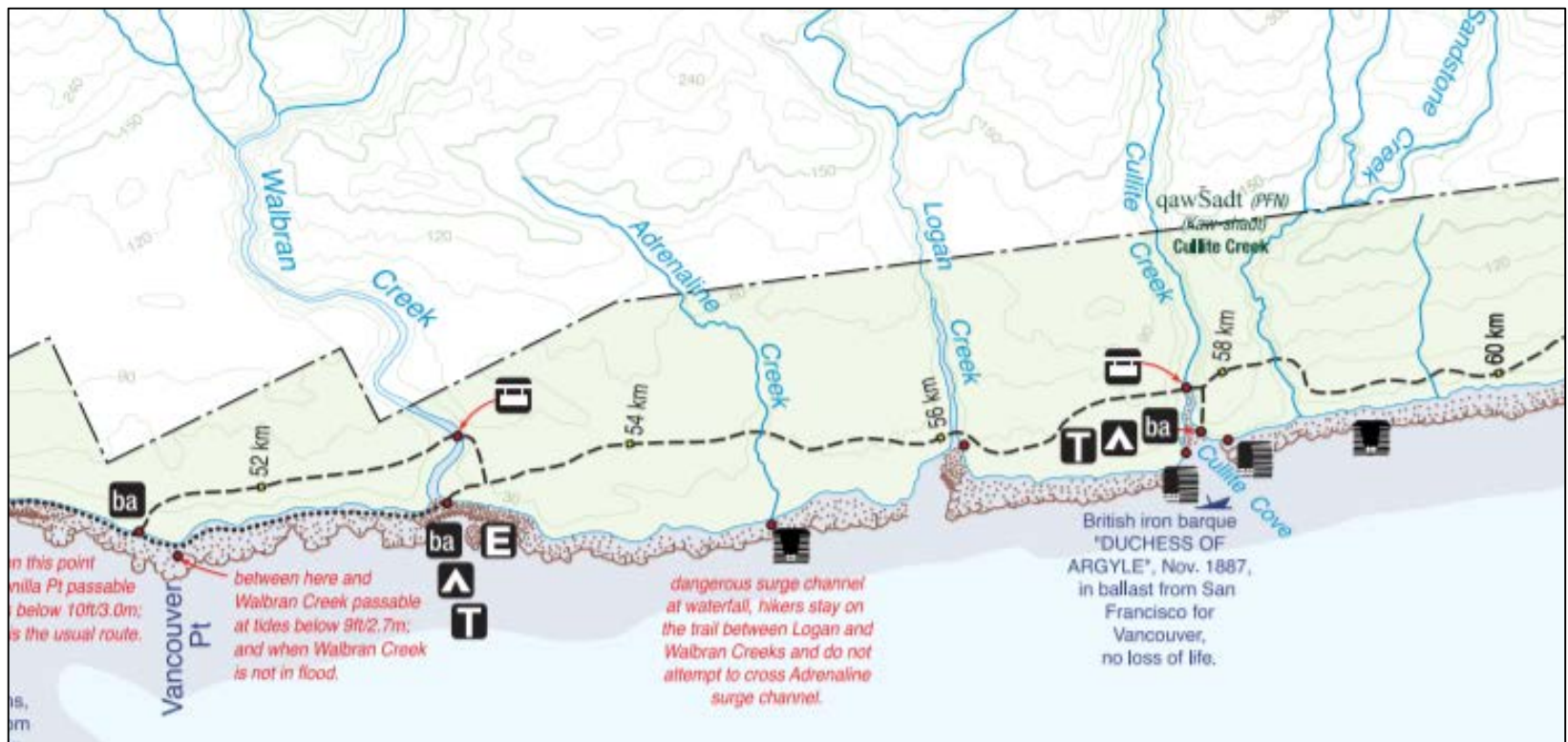

# Communications

There is no cell coverage on site.





# Site Water Supply

Water can be used from Logan creek. Based on quantity a water draw permit may be required. Any containers used for withdrawal must be clean and free of any potential contaminants (ex. concrete leachate)



# PROJECT – TECHNICAL INFO

## CWMM Engineering project comments.

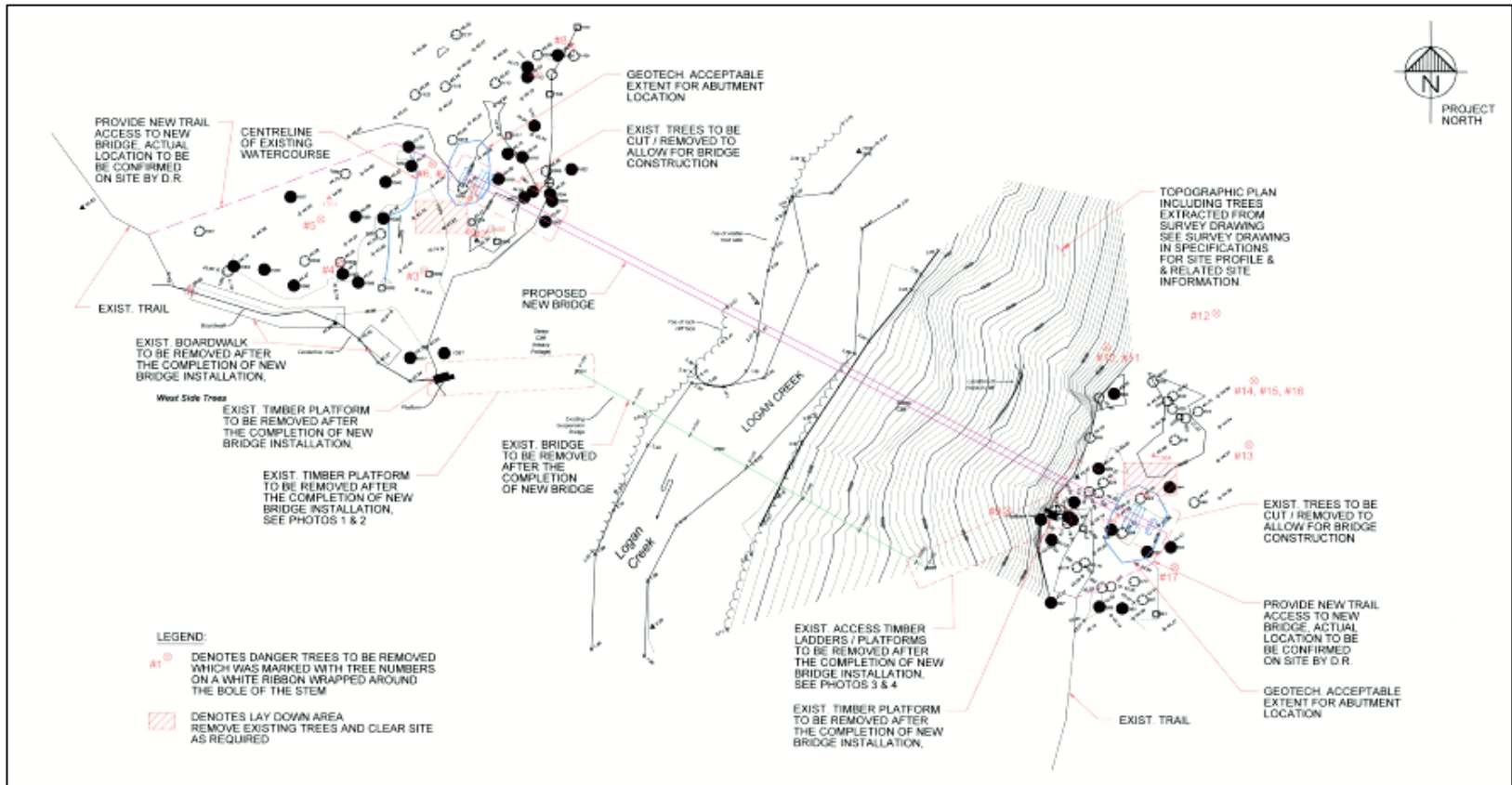

**QUESTIONS?**