



**RETURN BIDS TO:  
RETOURNER LES SOUMISSIONS À:**

**Bid Receiving  
PWGSC  
33 City Centre Drive  
Suite 480C  
Mississauga  
Ontario  
L5B 2N5  
Bid Fax: (905) 615-2095**

**REQUEST FOR PROPOSAL  
DEMANDE DE PROPOSITION**

**Proposal To: Public Works and Government  
Services Canada**

We hereby offer to sell to Her Majesty the Queen in right of Canada, in accordance with the terms and conditions set out herein, referred to herein or attached hereto, the goods, services, and construction listed herein and on any attached sheets at the price(s) set out therefor.

**Proposition aux: Travaux Publics et Services  
Gouvernementaux Canada**

Nous offrons par la présente de vendre à Sa Majesté la Reine du chef du Canada, aux conditions énoncées ou incluses par référence dans la présente et aux annexes ci-jointes, les biens, services et construction énumérés ici sur toute feuille ci-annexée, au(x) prix indiqué(s).

**Comments - Commentaires**

**Vendor/Firm Name and Address**

**Raison sociale et adresse du  
fournisseur/de l'entrepreneur**

**Issuing Office - Bureau de distribution**

Public Works and Government Services Canada  
Ontario Region  
33 City Centre Drive  
Suite 480  
Mississauga  
Ontario  
L5B 2N5

<b>Title - Sujet</b> Furniture SA – Cat 1,2 & 6 Stat CAN	
<b>Solicitation No. - N° de l'invitation</b> EQ754-182398/A	<b>Date</b> 2018-02-21
<b>Client Reference No. - N° de référence du client</b> EQ754-182398	
<b>GETS Reference No. - N° de référence de SEAG</b> PW-\$TOR-024-7489	
<b>File No. - N° de dossier</b> TOR-7-40150 (024)	<b>CCC No./N° CCC - FMS No./N° VME</b>
<b>Solicitation Closes - L'invitation prend fin at - à 02:00 PM on - le 2018-03-06</b>	<b>Time Zone Fuseau horaire</b> Eastern Daylight Saving Time EDT
<b>F.O.B. - F.A.B.</b> <b>Plant-Usine:</b> <input type="checkbox"/> <b>Destination:</b> <input type="checkbox"/> <b>Other-Autre:</b> <input type="checkbox"/>	
<b>Address Enquiries to: - Adresser toutes questions à:</b> Brewster, Shannon	<b>Buyer Id - Id de l'acheteur</b> tor024
<b>Telephone No. - N° de téléphone</b> (905) 615-2028 ( )	<b>FAX No. - N° de FAX</b> ( ) -
<b>Destination - of Goods, Services, and Construction: Destination - des biens, services et construction:</b> STATS CAN 2550 Victoria Park Ave 2nd Floor TORONTO Ontario M5J 5A9 Canada	

**Instructions: See Herein**

**Instructions: Voir aux présentes**

<b>Delivery Required - Livraison exigée</b> See Herein	<b>Delivery Offered - Livraison proposée</b>
<b>Vendor/Firm Name and Address</b> <b>Raison sociale et adresse du fournisseur/de l'entrepreneur</b>	
<b>Telephone No. - N° de téléphone</b> <b>Facsimile No. - N° de télécopieur</b>	
<b>Name and title of person authorized to sign on behalf of Vendor/Firm (type or print)</b> <b>Nom et titre de la personne autorisée à signer au nom du fournisseur/ de l'entrepreneur (taper ou écrire en caractères d'imprimerie)</b>	
<b>Signature</b>	<b>Date</b>



## STANDARD REQUEST FOR BID

The Bidder offers to provide to Canada the goods, services or both listed in the bid solicitation in accordance with the conditions set out in the bid solicitation and the prices set out in the bid.

This bid solicitation is issued in accordance with the conditions of the Supply Arrangement E60PQ-140003/PQ.

### INSTRUCTIONS:

Municipal taxes are not applicable.

Unless otherwise specified in the bid solicitation, all prices quoted must be net prices in Canadian funds including Canadian customs duties, excise taxes, must be FOB, including all delivery charges to destination(s) as indicated. The amount for Applicable Taxes is to be shown as a separate item.

## **TABLE OF CONTENTS**

Section 1: Invitation and Instructions to Bidders

Section 2: Resulting Contract, including a list of required goods and services

Annex A – Requirement and Basis of Payment

Annex B - Floor Plan(s) and Panel Matrix

Annex C – Non-Supply Arrangement (NSA) Product Description

## **SECTION 1 – INVITATION AND INSTRUCTIONS TO BIDDERS**

### **Step 1. ☒ Competitive or ☐ Non-Competitive**

For Competitive Requirements:

- 1.1 The Bidder must provide the following information AFTER bid closing, if requested to do so by Canada:
- One or more of the following price justifications:
    - (i) a current published price list indicating the percentage discount available to Canada;
    - (ii) a copy of paid invoices for the like quality and quantity of the goods, services or both sold to other customers;
    - (iii) a price breakdown showing the cost of direct labour, direct materials, purchased items, engineering and plant overheads, general and administrative overhead, transportation, etc., and profit; or
    - (iv) any other supporting documentation as requested by Canada.
- 1.2 Up to five (5) contracts may be awarded as a result of this bid solicitation.
- 1.3 Bidders may submit pricing for single or multiple Sections. The 5 Sections are:  
Section 1: Category 1 and 2 (SA and Non-SA items)  
Section 2: Category 6 (Group A) (SA items)  
Section 3: Category 6 (Group B) (SA and Add-ons items)  
Section 4: Category 6 (Group C) (SA items)  
Section 5: Category 6 (Group D) (SA items)
- 1.3 Each Section will be evaluated separately.
- 1.4 Further Instructions can be found at Annex B.

### **Step 2. ☒ General or ☐ PSAB**

#### **Step 3. Terms of the RFB:**

This RFB is issued pursuant to the Supplier's Furniture for Workspaces Supply Arrangement (SA) that forms part of the series of SAs issued by PWGSC with the number E60PQ-140003/PQ. The terms and conditions in the Supplier's SA apply to and form part of this RFB. Bidders who submit a bid agree to be bound by those terms and conditions as well as the terms and conditions in this RFB.

The Bidder must provide the following information WITH the bid:

- The information requested by Canada in Annex A herein.

#### **Step 4. Bid Evaluation**

An evaluation team composed of representatives of Canada will evaluate the bids.

<b>RFB Issued by:</b>	
Identified User's (IU) Department/Agency/Crown Corporation: Contact for this RFB:	<b>See Section 2, article 4.1 below.</b>
<b>RFB Closing - Submit Bid:</b> Bids must be submitted to the Bid Receiving Unit on the date and at the time indicated below.	
- By no later than date and time:	<b>a. March 06, 2018</b> <b>b. 2pm Eastern Standard Time (EST)</b>

- To physical location:	<b>Bid Receiving Unit 33 City Centre Drive, Suite 480C Mississauga, ON, L5B 2N5</b>
<b>RFB Enquiries</b>	
Unless a different period is listed in the adjacent column, Bidders may submit enquires about the RFB to the Contracting Authority two business days prior to the RFB closing date. Enquiries received after the timeline indicated may not be answered.	<b>5 business days</b>

**SECTION 2 - RESULTING CONTRACT CLAUSES**

<b>1.</b>	<b>Terms and Conditions of the Contract</b>	
	The terms and conditions of Parts 6A and 6C of the Supplier's SA within the series E60PQ-140003/PQ apply to and form part of this Contract.	
<b>2.</b>	<b>Security Requirement</b> (Applies if article a. or b. is checked)	
2.1	The applicable security requirement(s) is (are) set out in the Security Requirement Check List attached as Annex B of this contract. The Contractor must fulfill the security requirements by meeting the terms below (the checked article applies).	
a.		<b>Contractor may be escorted; possession of security clearance not required.</b> Contractor personnel MAY NOT ENTER NOR PERFORM WORK ON sites where PROTECTED or CLASSIFIED information or assets are kept, without an escort provided by the department or agency for which the work is being performed.
b.		<b>Possession of security clearance(s) is required.</b> The Contractor must meet the security clearance requirements contained in the clausling in Annex B herein.
c.	<input checked="" type="checkbox"/>	<b>There is no security requirement associated with this contract.</b>
<b>3.</b>	<b>Requirement</b>	
3.1	The Contractor must perform the Work listed in Annex A herein.	
<b>4.</b>	<b>Authorities</b>	
4.1	<b>Contracting Authority</b>	
	Name:	<b>Shannon Brewster</b>
	Title:	<b>Supply Specialist</b>
	Department/Agency/Crown Corporation:	<b>Department of Public Works and Government Services Canada / Procurement Directorate</b>
	Address:	<b>33 City Centre Drive, Suite 480C Mississauga, ON, L5B 2N5</b>
	Telephone No.:	<b>(905) 615-2028</b>
	Facsimile No.:	<b>N/A</b>
	E-mail address:	<b>shannon.brewster@pwgsc.gc.ca</b>
4.2	<b>Project Authority (to complete at Contract award)</b> The Project Authority (PA) is the representative of the department or agency for whom the Work is being carried out under the Contract and is responsible for all matters concerning the technical content of the Work under the Contract.  In addition, the PA is also responsible for ensuring that the Supplier's employees and subcontractors requiring access to the site adhere to the allocated time for the Supplier to access the site to deliver and install the furniture in accordance with the master schedule held by the General Contractor (a representative of Canada or a service provider(s) under contract with the Government of Canada).	

	Name:	
	Title:	
	Department/Agency/Crown Corporation:	
	Address:	
	Telephone No.:	
	Facsimile No.:	
	E-mail address:	
4.3	<b>Contractor's Representative (to be completed by Bidder with bid)</b>	
	Name:	
	Organization:	
	Address:	
	Telephone No.:	
	Facsimile No.:	
	E-mail address:	
	Procurement Business Number	
	SA #:	
5.	<b>Payment</b>	
	Method of Payment	
	The checked box applies. If the Contractor's SA indicates acceptance for payment by credit card, that method may be used in conjunction with the following.	
	<input checked="" type="checkbox"/>	Single Payment
	<input type="checkbox"/>	Multiple Payment
6.	<b>Invoicing</b>	
	Further to the Invoicing terms of the <b>WTCM document</b> , the Contractor will deliver the original and one copy of the invoice to the following address for certification and payment:	
	Name of the organization and contact: <b>(to complete at Contract award)</b>	
	Address: <b>(to complete at Contract award)</b>	
7.	<b>Defence Contract. This clause applies if the box below is checked.</b>	
	<input type="checkbox"/>	The Contract is a defence contract within the meaning of the <u><a href="#">Defence Production Act</a></u> , R.S.C. 1985, c. D-1.

## ANNEX A

### REQUIREMENT and BASIS OF PAYMENT

#### 1. Category Selection

1.1 The requirement includes the following categories of work:

- a. ☒ Category 1 – Interconnecting Panels and Freestanding Systems
- b. ☒ Category 1 Non-SA (NSA) products forming part of this requirement, refer to Annex C of this RFB
- c. ☒ Category 2 – Freestanding Height Adjustable Desk / Table Products
- d. ☒ Category 2 Non-SA (NSA) products forming part of this requirement, refer to Annex C of this RFB
- e. ☒ Category 6 – Support Space – Collaborative Furniture

*Clients may exercise an option to upgrade products up to 15% of the Category 6 product total before applicable taxes after contract award for Category 6 products.*

*The Design Upgrade amount is used at the discretion of the Project Authority (PA). Within ten business days of the contract award, the PA will provide the Contractor with a written notice of Canada's Design Upgrade choices for each of the product(s) to be upgraded in Category 6, Annex A. The Contractor will provide the pricing of the upgraded product(s) to a maximum of 15% of Category 6 Product Total. The Contracting Authority will issue an amendment to the contract with the Design Upgrades and pricing.*

*The Supplier certifies that all the Design Upgraded products offered will conform to all specifications and meet the testing requirements detailed in the Specifications of the Supply Arrangement.*

*Design Upgrade: is the process of replacing a product with a more innovative or enhanced version of the same product/series.*

- f. ☒ Category 6 Non-SA (NSA) products forming part of this requirement, refer to Article 3.3, Section 3, Table 1.

#### 2. GoCUID identification and/or floor plan(s)

Scenario b. ☒ Includes floor plan(s) WITH identification of product information in Annex B of this RFB. Categories 1 (a) (b), 2 and 6. Floor plan(s) are used for information purposes.

Refer to Annex A article 4 of the SA for Site inspection and Documentation instructions after contract award.

Site Inspection Date: \_\_\_\_\_ *(to be completed at contract award)*

#### 3. Product and Pricing Tables

**Bidder to complete:** Sections B – Supplier's Bid, of Tables 1 – 3 and Tables 5 and 6, for each applicable Section.

In a resulting contract, the term "Bid" means the Supplier's commitment, the term "Bidder" means "Contractor".

**3.1 Section 1: Category: 1 (a) (b) and 2 (SA Items)****Table 1 - Product**

Section A - IU REQUIREMENT					Section B – SUPPLIER'S BID		
#	AutoCAD Block	GoCUID	Description of Product	Estimated Qty	Supplier Part Number	Firm Price**	Extended Total [Qty x Price]
<b>CATEGORY 1: Interconnecting Panels and Freestanding Systems</b>							
<b>CATEGORY 1A</b>							
<b>Outlets in the base or raceway can be used in lieu of cut-outs in the lower element.</b>							
1	A-60		<ul style="list-style-type: none"> <li>• Seated Privacy Height</li> <li>• Powered Outlets Below the Work Surface</li> <li>• Lower Element 1 - Cut-outs for Power &amp; Data, Fabric</li> <li>• Lower Element 2 - Fabric</li> <li>• Upper Element 1 - Tackable Surface</li> <li>• Upper Element 2 - Tackable Surface</li> <li>• 1524mm (60 inch) Panel</li> </ul>	96		\$	\$
2	B-60		<ul style="list-style-type: none"> <li>• Seated Privacy Height</li> <li>• Powered Outlets Below the Work Surface</li> <li>• Lower Element 1 - Cut-outs for Power &amp; Data, Fabric</li> <li>• Lower Element 2 - Cut-outs for Power &amp; Data, Fabric</li> <li>• Upper Element 1 - Tackable Surface</li> <li>• Upper Element 2 - Tackable Surface</li> <li>• 1524mm (60 inch) Panel</li> </ul>	7		\$	\$
3	C-60		<ul style="list-style-type: none"> <li>• Seated Privacy Height</li> <li>• Powered Outlets Below the Work Surface</li> <li>• Lower Element 1 - Cut-outs for Power &amp; Data, Fabric</li> <li>• Lower Element 2 - Fabric</li> <li>• Upper Element 1 - Frosted Glazed (Includes Frame and Galzing)</li> <li>• Upper Element 2 - Frosted Glazed (Includes Frame and Galzing)</li> <li>• 1524mm (60 inch) Panel</li> </ul>	17		\$	\$



4	D-60		<ul style="list-style-type: none"><li>• Seated Privacy Height</li><li>• Powered Outlets Below the Work Surface</li><li>• Lower Element 1 - Cut-outs for Power &amp; Data, Fabric</li><li>• Lower Element 2 - Cut-outs for Power &amp; Data, Fabric</li><li>• Upper Element 1 - Frosted Glazed (Includes Frame and Galzing)</li><li>• Upper Element 2 - Frosted Glazed (Includes Frame and Galzing)</li><li>• 1524mm (60 inch) Panel</li></ul>	44		\$	\$
5	A-24		<ul style="list-style-type: none"><li>• Seated Privacy Height</li><li>• Powered Outlets Below the Work Surface</li><li>• Lower Element 1 - Cut-outs for Power &amp; Data, Fabric</li><li>• Lower Element 2 - Fabric</li><li>• Upper Element 1 - Tackable Surface</li><li>• Upper Element 2 - Tackable Surface</li><li>• 610mm (24 inch) Panel</li></ul>	1		\$	\$
6	B-24		<ul style="list-style-type: none"><li>• Seated Privacy Height</li><li>• Powered Outlets Below the Work Surface</li><li>• Lower Element 1 - Cut-outs for Power &amp; Data, Fabric</li><li>• Lower Element 2 - Cut-outs for Power &amp; Data, Fabric</li><li>• Upper Element 1 - Tackable Surface</li><li>• Upper Element 2 - Tackable Surface</li><li>• 610mm (24 inch) Panel</li></ul>	1		\$	\$
7	C-24		<ul style="list-style-type: none"><li>• Seated Privacy Height</li><li>• Powered Outlets Below the Work Surface</li><li>• Lower Element 1 - Cut-outs for Power &amp; Data, Fabric</li><li>• Lower Element 2 - Fabric</li><li>• Upper Element 1 - Frosted Glazed (Includes Frame and Galzing)</li></ul>	15		\$	\$

			<ul style="list-style-type: none"> <li>• Upper Element 2 - Frosted Glazed (Includes Frame and Galzing)</li> <li>• 610mm (24 inch) Panel</li> </ul>				
8	D-24		<ul style="list-style-type: none"> <li>• Seated Privacy Height</li> <li>• Powered Outlets Below the Work Surface</li> <li>• Lower Element 1 - Cut-outs for Power &amp; Data, Fabric</li> <li>• Lower Element 2 - Cut-outs for Power &amp; Data, Fabric</li> <li>• Upper Element 1 - Frosted Glazed (Includes Frame and Galzing)</li> <li>• Upper Element 2 - Frosted Glazed (Includes Frame and Galzing)</li> <li>• 610mm (24 inch) Panel</li> </ul>	45		\$	\$
<b>CATEGORY 1B</b>							
<b>Wire management required under fixed and adjustable work surfaces</b>							
9	I-TWR-2424L	SPPTFSMxx LHFFCD542 424	<ul style="list-style-type: none"> <li>• Storage Products</li> <li>• Personal Storage Tower</li> <li>• Freestanding</li> <li>• Metal</li> <li>• Hinged Left</li> <li>• File, File</li> <li>• Closed-Drawer</li> <li>• 1371mm x 610mm x 610mm (54 inch x 24 inch x 24 inch)</li> </ul>	54		\$	\$
10	I-TWR-2424R	SPPTFSMxx RHFFCD542 424	<ul style="list-style-type: none"> <li>• Storage Products</li> <li>• Personal Storage Tower</li> <li>• Freestanding</li> <li>• Metal</li> <li>• Hinged Right</li> <li>• File, File</li> <li>• Closed-Drawer</li> <li>• 1371mm x 610mm x 610mm (54 inch x 24 inch x 24 inch)</li> </ul>	54		\$	\$
11	WS-2460	WSxxPMLH Rxxxxxxx60 24	<ul style="list-style-type: none"> <li>• Work Surfaces</li> <li>• Panel Mounted</li> <li>• High Pressure Laminate</li> <li>• Rectangular Shape</li> <li>• 1524mm x 610mm (60 inch x 24 inch)</li> </ul>	103		\$	\$
12	T-30D	MTxxSCLxD xxxxxxx30x x	<ul style="list-style-type: none"> <li>• Meeting Tables</li> <li>• Star -Cross Base</li> <li>• Laminate</li> <li>• Round</li> </ul>	2		\$	\$

			• 762mm (30 Inch)				
13	T-36D	MTxxSCLxD xxxxxxxx36x x	<ul style="list-style-type: none"> <li>• Meeting Tables</li> <li>• Star -Cross Base</li> <li>• Laminate</li> <li>• Round</li> <li>• 914mm (36 Inch)</li> </ul>	3		\$	\$
14	WS-GG-3624	WSxxGGLH Rxxxxxxxx36 24	<ul style="list-style-type: none"> <li>• Work Surfaces</li> <li>• 2 Full Gable Ends(w/modesty)</li> <li>• High Pressure Laminate</li> <li>• Rectangular</li> <li>• 914mm x 610mm ( 36 inch x 24 Inch)</li> </ul>	5		\$	\$
15	WS-GG-4824	WSxxGGLH Rxxxxxxxx48 24	<ul style="list-style-type: none"> <li>• Work Surfaces</li> <li>• 2 Full Gable Ends(w/modesty)</li> <li>• High Pressure Laminate</li> <li>• Rectangular</li> <li>• 1219 mm x 610mm ( 48 inch x 24 Inch)</li> </ul>	2		\$	\$
16	WS-GG-6024	WSxxHHLH Rxxxxxxxx60 24	<ul style="list-style-type: none"> <li>• Work Surfaces</li> <li>• 2 Full Gable Ends(w/modesty)</li> <li>• High Pressure Laminate</li> <li>• Rectangular</li> <li>• 1524 mm x 610mm ( 60 inch x 24 Inch)</li> </ul>	4		\$	\$
17	SMCLC24	SPPDWLMx xxxBFCSxxx x22	<ul style="list-style-type: none"> <li>• Storage Products</li> <li>• Pedestals</li> <li>• Locking Casters</li> <li>• Metal</li> <li>• Box, File</li> <li>• Cushion Seat</li> <li>• Depth 559mm (22 in.) work surface</li> </ul>	108		\$	\$
18	WS-GH-4824	WSxxHGLH Rxxxxxxxx48 24	<ul style="list-style-type: none"> <li>• Work Surfaces</li> <li>• 1 Half, 1 Full Gable (w/ modesty)</li> <li>• High Pressure Laminate</li> <li>• Rectangular</li> <li>• 1219mm x 610mm (48 inch x 24 inch)</li> <li>• 762 mm( 30 inch) High</li> </ul>	2		\$	\$

**CATEGORY 2: Freestanding Height Adjustable Desk/Table Products****Wire management required under fixed and adjustable work surfaces**

19	FSCAEA6024	FSCAEA6024	<ul style="list-style-type: none"> <li>Sit/Stand Range Height Adjustable Work Surfaces</li> <li>Electrically Assisted</li> <li>1524mm x 610mm (60 inch x 24 inch)</li> </ul>	105		\$	\$
20	FSCAEA4824	FSCAEA4824	<ul style="list-style-type: none"> <li>Sit/Stand Range Height Adjustable Work Surfaces</li> <li>Electrically Assisted</li> <li>1219mm x 610mm (48 inch x 24 inch)</li> </ul>	3		\$	\$
**Must not exceed ceiling unit price in SA.						<b>Product Total</b>	<b>\$</b>

Table 2 - Delivery

Section A - IU REQUIREMENT				Section B – SUPPLIER’S BID	
Product Item from Table 1	Location	Desired Date (Y/M/D)	Desired Time: Outside Normal* Business Hours	Supplier will deliver on the date and at the time below*	Firm Price
1 – 20 along with associated hardware	Statistics Canada 2550 Victoria Park Ave. 2 <sup>nd</sup> Floor Toronto ON M5J 5A9	May 1 <sup>st</sup> , 2018	Outside Normal Business hours	(Y)	\$
				(M)	
				(D)	
*If no dates and times are added by the Supplier, the Supplier agrees to deliver on the Desired Date and Time. (Normal Business Hours 8:00 – 17:00)			Delivery Total:		\$

Table 3 – Installation

Section A - IU REQUIREMENT				Section B – SUPPLIER’S BID	
Product Item from Table 1	Location	Desired Date (Y/M/D)	Desired Time: Normal* Business Hours	Supplier will install on the date and at the time below*	Firm Price
1 – 20	Statistics Canada 2550 Victoria Park Ave. 2 <sup>nd</sup> Floor Toronto ON M5J 5A9	May 18 <sup>th</sup> , 2018	Normal Business hours	(Y)	\$
				(M)	
				(D)	
*If no dates and times are added by the Supplier, the Supplier agrees to deliver on the Desired Date and Time.(Normal Business Hours 8:00 – 17:00)			Installation Total:		\$

Table 4 – Standard Finishes and Canada's Facilities to Accommodate the Delivery and Certifications

<b>1.</b>	<b>Standard Finishes</b>
1.1	<p>IU is to consult the Supplier's Website identified in Part 6A of the SA to view the available finishes.</p> <p>Within ten business days of the contract award, the Contracting Authority will provide the Contractor with a written notice of Canada's finish choices for each of the product(s) in Annex A.</p> <p>The Contractor will deliver the products corresponding to Canada's choice of specific finishes(s). No additional charge will be applied to Canada.</p>

2.	<b>Canada's Facilities to Accommodate the Delivery:</b> The Project Authority will need to be contacted to set up access into the building for delivery and installation of equipment.	
2.1	Loading Dock/Location: <i>(Information with regards to booking deliveries will be provided at contract award)</i>	
A	Location	<b>2550 Victoria Park Ave., Toronto, Ontario</b>
B	Dock	<b>2 loading docks at rear of building</b>
C	Lift	<b>No</b>
D	Loading Dock Doors	<b>9'10" wide x 15' high</b>
2.2	Freight Elevator	<b>Yes – interior dimensions 124" x 76" x 55"; door opening 3'5" wide x 6'11" high</b>
2.3	Other (specify, if any)	<b>The distance from the loading dock to the freight elevator is approximately 25'. There is a narrow area of the corridor between the loading dock and the freight elevator. The narrow area is 3'2" wide. The door at the end of the corridor is 36" wide x 6'11" high.</b>
<b>Continuance of Certifications</b>		
	The Bidder certifies that by submitting a bid in response to the RFB, the Bidder, and any of the Bidder's members if the Bidder is a Joint Venture, continues to comply with all of the certifications listed in Parts 6A and 6B of the Bidder's SA for Work Spaces, as follows:	
3.1	Integrity Provisions	
3.2	Federal Contractor's Program for Employment Equity	
3.4	Product Conformance	
3.5	Price Certification (In accordance with the SA, Part 6B)	

**Table 5 - Bid Evaluation and Contract Total (Canada may complete if not completed by the Bidder)**

1	Product Total (Table 1, from Article 3.1, Section 1)	\$
2	Delivery Total (Table 2, from Article 3.1, Section 1)	\$
3	Installation Total (Table 3, from Article 3.1, Section 1)	\$
4	NSA Total, refer to Annex C	\$
5	Hardware Total as per article 1.5 of Annex A-1 of SA (if applicable)	\$
6	<b>Total Evaluated (Bid) Price for Section 1* (1 + 2 + 3 + 4 + 5):</b>	\$
7	Applicable Tax(es):	\$
8	Total Estimated Cost (6+7):	\$

**Table 6 – Bidder's Authorized Representative**

<b>Bidder's Authorized Representative</b>		
1.	Bidder's Authorized Representative for the Bid and the Contract	
	Name:	Telephone:
		E-Mail:
		Other:

**\*At contract award, "Total Evaluated (Bid) Price" becomes "Contract Price".**

**3.2 Section 2: Category 6 (Group A - SA items)****Table 1 - Product**

Section A - IU REQUIREMENT					Section B – SUPPLIER'S BID		
#	AutoCAD Block	GoCUID	Description of Product	Estimated Qty	Supplier Part Number	Firm Price**	Extended Total [Qty x Price]
1	BAR-36D	TTHBPCB CBPDRSL NILNIL414 336xxNIL	<ul style="list-style-type: none"> <li>Bar-Height Kitchenette Table</li> <li>Post legs with round pedestal base</li> <li>Straight Edge Profile</li> <li>Round top</li> <li>Laminate</li> <li>1041 mm - 1092 mm (41 inch -43 inch) Height</li> <li>914 mm (36 inch) Diameter</li> </ul>	3		\$	\$
2	T-2048	TTCCQPM FBPETS NIL48xx14 21NIL20xx	<ul style="list-style-type: none"> <li>Table</li> <li>Coffee Table</li> <li>Four Metal Legs</li> <li>Straight Edge Profile</li> <li>Rectangular</li> <li>Laminate</li> <li>508 mm x 1219 mm ( 20 Inch x 48 Inch)</li> <li>355 mm x 533 mm (14 inch -21 inch) Height</li> </ul>	1		\$	\$
3	T-3636	TTPSPQM PNILCSSNI L36xxNILNI L36xx	<ul style="list-style-type: none"> <li>Table</li> <li>Meeting room tables</li> <li>Four point metal base with glides</li> <li>Square</li> <li>High Pressure Laminate top</li> <li>914 mm x 914 mm (36 inch x 36 inch )</li> </ul>	5		\$	\$
4	MEDIA UNIT	TTSDHSC SPESDSS DMQ72xxN ILNIL60xx	<ul style="list-style-type: none"> <li>Table</li> <li>Multi-media table with Monitor Support Mount</li> <li>Seated Height with cable or wire management</li> <li>D-shaped top</li> <li>High Pressure Laminate top</li> <li>Two recessed box with 4 power and 4 data with a flexible casing</li> <li>1524 mm x 1828 mm (60 Inch x 72 Inch)</li> </ul>	1		\$	\$

5	T-2424	TTDAQPM FBPERSLN ILNIL14212 4xxNIL	<ul style="list-style-type: none"><li>• Table</li><li>• Side Table</li><li>• Four Metal Legs</li><li>• Self-Edge</li><li>• Round top</li><li>• Laminate</li><li>• 610 mm (24 Inch Diameter)</li><li>• 355 mm x 533 mm (14 inch -21 inch) Height</li></ul>	1		\$	\$
**Must not exceed ceiling unit price in SA.						Product Total	\$

Table 2 – Delivery

Section A - IU REQUIREMENT				Section B – SUPPLIER’S BID	
Product Item from Table 1	Location	Desired Date (Y/M/D)	Desired Time: Outside Normal* Business Hours	Supplier will deliver on the date and at the time below*	Firm Price
1 – 5 along with associated hardware	Statistics Canada 2550 Victoria Park Ave. 2nd Floor Toronto ON M5J 5A9	May 1 <sup>st</sup> , 2018	Outside Normal Business hours	(Y)	\$
				(M)	
				(D)	
*If no dates and times are added by the Supplier, the Supplier agrees to deliver on the Desired Date and Time. (Normal Business Hours 8:00 – 17:00)			Delivery Total:		\$

Table 3 – Installation

Section A - IU REQUIREMENT				Section B – SUPPLIER’S BID	
Product Item from Table 1	Location	Desired Date (Y/M/D)	Desired Time: Normal* Business Hours	Supplier will install on the date and at the time below*	Firm Price
1 – 5	Statistics Canada 2550 Victoria Park Ave. 2 <sup>nd</sup> Floor Toronto ON M5J 5A9	May 18 <sup>th</sup> , 2018	Normal Business hours	(Y)	\$
				(M)	
				(D)	
*If no dates and times are added by the Supplier, the Supplier agrees to deliver on the Desired Date and Time.(Normal Business Hours 8:00 – 17:00)			Installation Total:		\$

Table 4 – Standard Finishes and Canada's Facilities to Accommodate the Delivery and Certifications

1.	<b>Standard Finishes</b>
1.1	<p>IU is to consult the Supplier's Website identified in Part 6A of the SA to view the available finishes.</p> <p>Within ten business days of the contract award, the Contracting Authority will provide the Contractor with a written notice of Canada's finish choices for each of the product(s) in Annex A.</p> <p>The Contractor will deliver the products corresponding to Canada's choice of specific finishes(s). No additional charge will be applied to Canada.</p>

2.	<b>Canada's Facilities to Accommodate the Delivery:</b> The Project Authority will need to be contacted to set up access into the building for delivery and installation of equipment.	
2.1	Loading Dock/Location: <i>(Information with regards to booking deliveries will be provided at contract award)</i>	
A	Location	<b>2550 Victoria Park Ave., Toronto, Ontario</b>
B	Dock	<b>2 loading docks at rear of building</b>
C	Lift	<b>No</b>
D	Loading Dock Doors	<b>9'10" wide x 15' high</b>
2.2	Freight Elevator	<b>Yes – interior dimensions 124" x 76" x 55"; door opening 3'5" wide x 6'11" high</b>
2.3	Other (specify, if any)	<b>The distance from the loading dock to the freight elevator is approximately 25'. There is a narrow area of the corridor between the loading dock and the freight elevator. The narrow area is 3'2" wide. The door at the end of the corridor is 36" wide x 6'11" high.</b>
<b>Continuance of Certifications</b>		
	The Bidder certifies that by submitting a bid in response to the RFB, the Bidder, and any of the Bidder's members if the Bidder is a Joint Venture, continues to comply with all of the certifications listed in Parts 6A and 6B of the Bidder's SA for Work Spaces, as follows:	
3.1	Integrity Provisions	
3.2	Federal Contractor's Program for Employment Equity	
3.4	Product Conformance	
3.5	Price Certification (In accordance with the SA, Part 6B)	

**Table 5 - Bid Evaluation and Contract Total (Canada may complete if not completed by the Bidder)**

1	Product Total (Table 1, from Article 3.2, Section 2)	\$
2	Delivery Total (Table 2, from Article 3.2, Section 2)	\$
3	Installation Total (Table 3, from Article 3.2, Section 2)	\$
4	NSA Total (if applicable) refer to Annex C	\$ Not Applicable
5	Hardware Total as per article 1.5 of Annex A-1 of SA (if applicable)	\$
6	<b>Total Evaluated (Bid) Price for Section 2* (1 + 2 + 3 + 4 + 5):</b>	\$
7	Applicable Tax(es):	\$
8	Total Estimated Cost (6+7):	\$

**Table 6 – Bidder's Authorized Representative**

<b>Bidder's Authorized Representative</b>		
1.	Bidder's Authorized Representative for the Bid and the Contract	
	Name:	Telephone:
		E-Mail:
		Other:

**\*At contract award, "Total Evaluated (Bid) Price" becomes "Contract Price".**



**3.3 Section 3: Category 6 (Group B - SA and Non-SA items)****Table 1 - Product**

Section A - IU REQUIREMENT					Section B – SUPPLIER’S BID		
#	AutoCAD Block	GoCUID	Description of Product	Estimated Qty	Supplier Part Number	Firm Price**	Extended Total [Qty x Price]
1	T-12048-RACETRACK	TTPSPTA CNILOSSD MQ120xNIL LNIL48xx	<ul style="list-style-type: none"><li>• Table</li><li>• Meeting room tables</li><li>• Drum base with wire access</li><li>• Racetrack top</li><li>• High Pressure Laminate top</li><li>• Two recessed box with 4 power and 4 data with a flexible casing</li><li>• 1219 mm x 3048 mm (48 Inch x 120 Inch)</li></ul>	1		\$	\$
2	TR-2460	TRFTPCV CNILTSLC ED60xxNIL NIL24xx	<ul style="list-style-type: none"><li>• Table</li><li>• Flip-top</li><li>• C legs with lockable caster</li><li>• Rectangular</li><li>• Laminate</li><li>• With cable and electrical-data connectivity</li><li>• 610 mm x 1524 mm (24 Inch x 60 Inch)</li></ul>	12		\$	\$
3	Non-SA ADD ON for Flip Top Table (TR-2460)		<ul style="list-style-type: none"><li>• With metal privacy screen 254mm(10") height and wire management</li></ul>	12		\$	\$
**Must not exceed ceiling unit price in SA.					Product Total		\$

**Table 2 – Delivery**

Section A - IU REQUIREMENT				Section B – SUPPLIER’S BID	
Product Item from Table 1	Location	Desired Date (Y/M/D)	Desired Time: Outside Normal* Business Hours	Supplier will deliver on the date and at the time below*	Firm Price
1 – 3 along with associated hardware	Statistics Canada 2550 Victoria Park Ave. 2 <sup>nd</sup> Floor Toronto ON M5J 5A9	May 1 <sup>st</sup> , 2018	Outside Normal Business hours	(Y)	\$
				(M)	
				(D)	
*If no dates and times are added by the Supplier, the Supplier agrees to deliver on the Desired Date and Time. (Normal Business Hours 8:00 – 17:00)			Delivery Total:		\$

**Table 3 – Installation**

Section A - IU REQUIREMENT				Section B – SUPPLIER’S BID	
Product Item from Table 1	Location	Desired Date (Y/M/D)	Desired Time: Normal* Business Hours	Supplier will install on the date and at the time below*	Firm Price
1 – 3	Statistics Canada 2550 Victoria Park Ave. 2 <sup>nd</sup> Floor Toronto ON M5J 5A9	May 18 <sup>th</sup> , 2018	Normal Business hours	(Y)	\$
				(M)	
				(D)	
*If no dates and times are added by the Supplier, the Supplier agrees to deliver on the Desired Date and Time.(Normal Business Hours 8:00 – 17:00)			Installation Total:		\$

**Table 4 – Standard Finishes and Canada's Facilities to Accommodate the Delivery and Certifications**

1.	<b>Standard Finishes</b>	
1.1	<p>IU is to consult the Supplier's Website identified in Part 6A of the SA to view the available finishes.</p> <p>Within ten business days of the contract award, the Contracting Authority will provide the Contractor with a written notice of Canada's finish choices for each of the product(s) in Annex A.</p> <p>The Contractor will deliver the products corresponding to Canada's choice of specific finishes(s). No additional charge will be applied to Canada.</p>	
2.	<b>Canada's Facilities to Accommodate the Delivery:</b> The Project Authority will need to be contacted to set up access into the building for delivery and installation of equipment.	
2.1	Loading Dock/Location: <i>(Information with regards to booking deliveries will be provided at contract award)</i>	
A	Location	<b>2550 Victoria Park Ave., Toronto, Ontario</b>
B	Dock	<b>2 loading docks at rear of building</b>
C	Lift	<b>No</b>
D	Loading Dock Doors	<b>9'10" wide x 15' high</b>
2.2	Freight Elevator	<b>Yes – interior dimensions 124" x 76" x 55"; door opening 3'5" wide x 6'11" high</b>
2.3	Other (specify, if any)	<b>The distance from the loading dock to the freight elevator is approximately 25'. There is a narrow area of the corridor between the loading dock and the freight elevator. The narrow area is 3'2" wide. The door at the end of the corridor is 36" wide x 6'11" high.</b>
	<b>Continuance of Certifications</b>	
	The Bidder certifies that by submitting a bid in response to the RFB, the Bidder, and any of the Bidder's members if the Bidder is a Joint Venture, continues to comply with all of the certifications listed in Parts 6A and 6B of the Bidder's SA for Work Spaces, as follows:	
3.1	Integrity Provisions	
3.2	Federal Contractor's Program for Employment Equity	
3.4	Product Conformance	
3.5	Price Certification (In accordance with the SA, Part 6B)	

**Table 5 - Bid Evaluation and Contract Total (Canada may complete if not completed by the Bidder)**

1	Product Total (Table 1, from Article 3.3, Section 3)	\$
2	Delivery Total (Table 2, from Article 3.3, Section 3)	\$

3	Installation Total (Table 3, from Article 3.3, Section 3)	\$
4	NSA Total (not applicable) refer to Annex C	\$ Included in Table 1
5	Hardware Total as per article 1.5 of Annex A-1 of SA (if applicable)	\$
6	<b>Total Evaluated (Bid) Price for Section 3* (1 + 2 + 3 + 4 + 5):</b>	\$
7	Applicable Tax(es):	\$
8	Total Estimated Cost (6+7):	\$

**Table 6 – Bidder's Authorized Representative**

Bidder's Authorized Representative		
1.	Bidder's Authorized Representative for the Bid and the Contract	
	Name:	Telephone:
		E-Mail:
		Other:

\*At contract award, "Total Evaluated (Bid) Price" becomes "Contract Price".

**3.4 Section 4: Category 6 (Group C - SA items)****Table 1 - Product**

Section A - IU REQUIREMENT					Section B – SUPPLIER'S BID		
#	AutoCAD Block	GoCUID	Description of Product	Estimated Qty	Supplier Part Number	Firm Price**	Extended Total [Qty x Price]
1		MAPWAVP WTTANILSL NIL30xx72xx NIL24xx	<ul style="list-style-type: none"> <li>Meeting Room Furniture</li> <li>Storage Cabinet</li> <li>With glides</li> <li>Three adjustable shelves with lockable hinged doors</li> <li>Laminate</li> <li>610 mm x 762mm (24 Inch x 30 Inch)</li> <li>1828 mm (72 Inch) Height</li> </ul>	1		\$	\$
2		MAPWAVP WTTANILSL NIL36xx72xx NIL24xx	<ul style="list-style-type: none"> <li>Meeting Room Furniture</li> <li>Storage Cabinet</li> <li>With glides</li> <li>Three adjustable shelves with lockable hinged doors</li> <li>Laminate</li> <li>610 mm x 914mm (24 Inch x 36 Inch)</li> <li>1828 mm (72 Inch) Height</li> </ul>	3		\$	\$
**Must not exceed ceiling unit price in SA.					<b>Product Total</b>		<b>\$</b>

**Table 2 – Delivery**

Section A - IU REQUIREMENT				Section B – SUPPLIER’S BID	
Product Item from Table 1	Location	Desired Date (Y/M/D)	Desired Time: Outside Normal* Business Hours	Supplier will deliver on the date and at the time below*	Firm Price
1 – 2 along with associated hardware	Statistics Canada 2550 Victoria Park Ave. 2 <sup>nd</sup> Floor Toronto ON M5J 5A9	May 1 <sup>st</sup> , 2018	Outside Normal Business hours	(Y)	\$
				(M)	
				(D)	
*If no dates and times are added by the Supplier, the Supplier agrees to deliver on the Desired Date and Time. (Normal Business Hours 8:00 – 17:00)			Delivery Total:		\$

**Table 3 – Installation**

Section A - IU REQUIREMENT				Section B – SUPPLIER’S BID	
Product Item from Table 1	Location	Desired Date (Y/M/D)	Desired Time: Normal* Business Hours	Supplier will install on the date and at the time below*	Firm Price
1 – 2	Statistics Canada 2550 Victoria Park Ave. 2 <sup>nd</sup> Floor Toronto ON M5J 5A9	May 18 <sup>th</sup> , 2018	Normal Business hours	(Y)	\$
				(M)	
				(D)	
*If no dates and times are added by the Supplier, the Supplier agrees to deliver on the Desired Date and Time.(Normal Business Hours 8:00 – 17:00)			Installation Total:		\$

**Table 4 – Standard Finishes and Canada's Facilities to Accommodate the Delivery and Certifications**

<b>1.</b>	<b>Standard Finishes</b>	
1.1	<p>IU is to consult the Supplier's Website identified in Part 6A of the SA to view the available finishes.</p> <p>Within ten business days of the contract award, the Contracting Authority will provide the Contractor with a written notice of Canada's finish choices for each of the product(s) in Annex A.</p> <p>The Contractor will deliver the products corresponding to Canada's choice of specific finishes(s). No additional charge will be applied to Canada.</p>	
<b>2.</b>	<b>Canada's Facilities to Accommodate the Delivery:</b> The Project Authority will need to be contacted to set up access into the building for delivery and installation of equipment.	
2.1	Loading Dock/Location: <i>(Information with regards to booking deliveries will be provided at contract award)</i>	
A	Location	<b>2550 Victoria Park Ave., Toronto, Ontario</b>
B	Dock	<b>2 loading docks at rear of building</b>
C	Lift	<b>No</b>
D	Loading Dock Doors	<b>9'10" wide x 15' high</b>
2.2	Freight Elevator	<b>Yes – interior dimensions 124" x 76" x 55"; door opening 3'5" wide x 6'11" high</b>
2.3	Other (specify, if any)	<b>The distance from the loading dock to the freight elevator is approximately 25'.</b>

		<b>There is a narrow area of the corridor between the loading dock and the freight elevator. The narrow area is 3'2" wide. The door at the end of the corridor is 36" wide x 6'11" high.</b>
	<b>Continuance of Certifications</b>	
	The Bidder certifies that by submitting a bid in response to the RFB, the Bidder, and any of the Bidder's members if the Bidder is a Joint Venture, continues to comply with all of the certifications listed in Parts 6A and 6B of the Bidder's SA for Work Spaces, as follows:	
3.1	Integrity Provisions	
3.2	Federal Contractor's Program for Employment Equity	
3.4	Product Conformance	
3.5	Price Certification (In accordance with the SA, Part 6B)	

**Table 5 - Bid Evaluation and Contract Total (Canada may complete if not completed by the Bidder)**

1	Product Total (Table 1, from Article 3.4, Section 4)	\$
2	Delivery Total (Table 2, from Article 3.4, Section 4)	\$
3	Installation Total (Table 3, from Article 3.4, Section 4)	\$
4	NSA Total (if applicable) refer to Annex C	\$ Not Applicable
5	Hardware Total as per article 1.5 of Annex A-1 of SA (if applicable)	\$
6	<b>Total Evaluated (Bid) Price for Section 4* (1 + 2 + 3 + 4 + 5):</b>	\$
7	Applicable Tax(es):	\$
8	Total Estimated Cost (6+7):	\$

**Table 6 – Bidder's Authorized Representative**

Bidder's Authorized Representative		
1.	Bidder's Authorized Representative for the Bid and the Contract	
	Name:	Telephone:
		E-Mail:
		Other:

\*At contract award, "Total Evaluated (Bid) Price" becomes "Contract Price".

**3.5 Section 5: Category 6 (Group D - SA items)****Table 1 - Product**

Section A - IU REQUIREMENT					Section B – SUPPLIER'S BID		
#	AutoCAD Block	GoCUID	Description of Product	Estimated Qty	Supplier Part Number	Firm Price**	Extended Total [Qty x Price]
1		SREFRQR RPDPAUA NILOMCFF TFNILNILN IL (or) SREFRDR DPDPATG NILOBCFF	<ul style="list-style-type: none"> <li>Soft Seating</li> <li>Lounge Chair</li> <li>Four casters with two locking</li> <li>Back handle, cup holder and shelf at base</li> </ul>	12		\$	\$

		TFNILNILN IL	<ul style="list-style-type: none"> <li>• Universal Tablet Arm with the ability to move in and out</li> <li>• Metal frame</li> <li>• Fixed cushions</li> <li>• Fabric</li> </ul> <b>(or)</b> <ul style="list-style-type: none"> <li>• Soft Seating</li> <li>• Lounge Chair</li> <li>• Two casters and two legs with glides</li> <li>• Back handle, cup holder and shelf at base</li> <li>• Right Tablet Arm with the ability to move in and out and a Left Armrest</li> <li>• Solid Hardwood frame</li> <li>• Fixed cushions</li> <li>• Fabric</li> </ul>				
2	3 SEATER SOFA	SRESTQP ANILSAW NILOMCFF VINILNILN L	<ul style="list-style-type: none"> <li>• Soft Seating</li> <li>• Sofa for three adults</li> <li>• Four legs with glides</li> <li>• Without arms</li> <li>• Metal frame</li> <li>• Fixed cushions</li> <li>• Vinyl</li> </ul>	3		\$	\$
3	CH-BAR	SCNTDQP MRPFSAW NILNILPPM NILNILNIL NIL	<ul style="list-style-type: none"> <li>• Kitchenette Seating</li> <li>• Bar Stool</li> <li>• Four metal Legs</li> <li>• Footrest</li> <li>• Without Arms</li> <li>• Perforated Molded Plastic or Polyamide</li> </ul>	14		\$	\$
4	CH-SIDE	SCNCCQP FNILSAWN ILNILPPMN ILNILNILN L	<ul style="list-style-type: none"> <li>• Kitchenette Seating</li> <li>• Kitchenette Chair</li> <li>• Four Legs</li> <li>• Without Arms</li> <li>• Perforated Molded Plastic or Polyamide</li> </ul>	15		\$	\$
**Must not exceed ceiling unit price in SA.						<b>Product Total</b>	<b>\$</b>

Table 2 – Delivery

Section A - IU REQUIREMENT				Section B – SUPPLIER'S BID	
Product Item from Table 1	Location	Desired Date (Y/M/D)	Desired Time: Outside Normal* Business Hours	Supplier will deliver on the date and at the time below*	Firm Price
1 – 4 along with associated hardware	Statistics Canada 2550 Victoria Park Ave. 2 <sup>nd</sup> Floor Toronto ON M5J 5A9	May 1 <sup>st</sup> , 2018	Outside Normal Business hours	(Y)	\$
				(M)	

				(D)	
*If no dates and times are added by the Supplier, the Supplier agrees to deliver on the Desired Date and Time. (Normal Business Hours 8:00 – 17:00)				<b>Delivery Total:</b>	<b>\$</b>

**Table 3 – Installation**

Section A - IU REQUIREMENT				Section B – SUPPLIER’S BID	
Product Item from Table 1	Location	Desired Date (Y/M/D)	Desired Time: Normal* Business Hours	Supplier will install on the date and at the time below*	Firm Price
1 – 4	Statistics Canada 2550 Victoria Park Ave. 2 <sup>nd</sup> Floor Toronto ON M5J 5A9	May 18 <sup>th</sup> , 2018	Normal Business hours	(Y)	\$
				(M)	
				(D)	
*If no dates and times are added by the Supplier, the Supplier agrees to deliver on the Desired Date and Time.(Normal Business Hours 8:00 – 17:00)			Installation Total:		\$

**Table 4 – Standard Finishes and Canada's Facilities to Accommodate the Delivery and Certifications**

<b>1.</b>	<b>Standard Finishes</b>	
1.1	<p>IU is to consult the Supplier's Website identified in Part 6A of the SA to view the available finishes.</p> <p>Within ten business days of the contract award, the Contracting Authority will provide the Contractor with a written notice of Canada's finish choices for each of the product(s) in Annex A.</p> <p>The Contractor will deliver the products corresponding to Canada's choice of specific finishes(s). No additional charge will be applied to Canada.</p>	
<b>2.</b>	<b>Canada's Facilities to Accommodate the Delivery:</b> The Project Authority will need to be contacted to set up access into the building for delivery and installation of equipment.	
2.1	Loading Dock/Location: <i>(Information with regards to booking deliveries will be provided at contract award)</i>	
A	Location	<b>2550 Victoria Park Ave., Toronto, Ontario</b>
B	Dock	<b>2 loading docks at rear of building</b>
C	Lift	<b>No</b>
D	Loading Dock Doors	<b>9'10" wide x 15' high</b>
2.2	Freight Elevator	<b>Yes – interior dimensions 124" x 76" x 55"; door opening 3'5" wide x 6'11" high</b>
2.3	Other (specify, if any)	<b>The distance from the loading dock to the freight elevator is approximately 25'. There is a narrow area of the corridor between the loading dock and the freight elevator. The narrow area is 3'2" wide. The door at the end of the corridor is 36" wide x 6'11" high.</b>
	<b>Continuance of Certifications</b>	
	The Bidder certifies that by submitting a bid in response to the RFB, the Bidder, and any of the Bidder's members if the Bidder is a Joint Venture, continues to comply with all of the certifications listed in Parts 6A and 6B of the Bidder's SA for Work Spaces, as follows:	
3.1	Integrity Provisions	
3.2	Federal Contractor's Program for Employment Equity	
3.4	Product Conformance	

3.5	Price Certification (In accordance with the SA, Part 6B)
-----	--

**Table 5 - Bid Evaluation and Contract Total (Canada may complete if not completed by the Bidder)**

1	Product Total (Table 1, from Article 3.5, Section 5)	\$
2	Delivery Total (Table 2, from Article 3.5, Section 5)	\$
3	Installation Total (Table 3, from Article 3.5, Section 5)	\$
4	NSA Total (if applicable) refer to Annex C	\$ Not Applicable
5	Hardware Total as per article 1.5 of Annex A-1 of SA (if applicable)	\$
6	<b>Total Evaluated (Bid) Price for Section 5* (1 + 2 + 3 + 4 + 5):</b>	\$
7	Applicable Tax(es):	\$
8	Total Estimated Cost (6+7):	\$

**Table 6 – Bidder's Authorized Representative**

Bidder's Authorized Representative		
1.	Bidder's Authorized Representative for the Bid and the Contract	
	Name:	Telephone:
		E-Mail:
		Other:

**\*At contract award, "Total Evaluated (Bid) Price" becomes "Contract Price".**



---

## ANNEX B

### FLOOR PLAN(s) and PANEL MATRIX

---

**Send Request for AutoCAD to [shannon.brewster@pwgsc.gc.ca](mailto:shannon.brewster@pwgsc.gc.ca)**

#### **Instructions to Bidder(s):**

Bidders must provide:

- a) Completed floor plan(s) with proposed SA approved products and NON SA items;
- b) A product listing of proposed SA approved products offered at floor plan(s) as well as the NON SA items. As a minimum the product listing must include the following information:
  - Supplier part numbers;
  - Brief product descriptions;
  - Quantities;
  - Firm unit prices. **(For SA approved products only. Pricing for NON SA items are to inserted at Annex C and applicable tables only);** and
- c) 4 hard copies of the above.

By submitting a bid, the Bidder certifies that their submission includes all components and quantities required and identified in the floor plan(s) in accordance with the product descriptions, the product configurations and panel matrices or workstation layouts stipulated at Annex B.

**\*At contract award, "By submitting a bid, the Bidder..." becomes "The Contractor..."**

NSA products forming part of the requirement will be identified at Annex C of this RFB.

#### **1) Floor Plan(s) in PDF or AutoCAD version**

Floor Plans – see attachment at end of solicitation

#### **2) Workstation Layout(s) or Panel Matrix**

Panel Matrix – see attachment at end of solicitation

**\*\*It is the responsibility of the Bidder to review and ensure that all furniture quantities and locations are a reflection of the quantities and locations indicated on the Floor Plans. The quantities and locations indicated in Floor Plans are to take precedent.**

**ANNEX C****Non Supply Arrangement (NSA) Products**

This Annex includes the Specifications, Products and Pricing, Certifications associated with NSA products forming part of the requirement.

**1. Specifications**

Please refer to the Description of Product in Table 1 below and Annex B – Floor Plans.

**2. Product and Pricing**

Bidder to complete: Sections B of the tables identified in the table below as well as Tables 5 and 6 of Annex A. In a resulting contract, the term "Bid" means the Supplier's commitment, the term "Bidder" means "Contractor".

**Product Category: 1(b) and 2****Table 1 – NSA Products**

Section A - IU REQUIREMENT				Section B – SUPPLIER'S BID		
#	AutoCAD Block	Description of Product	Estimated Quantity	Supplier Part Number	Firm Price	Extended Total [Qty x Price]
Category 1B:						
1	S-36	<ul style="list-style-type: none"><li>Storage Products</li><li>Book Shelf</li><li>2 Full Gable Ends</li><li>Laminate</li><li>Rectangular</li><li>Open - Two Adjustable Shelves</li><li>Seated Privacy Height</li><li>914 mm x 305 mm - 381 mm ( 36 inch x 12 inch - 15 inch)</li></ul>	11		\$	\$
	Personal Tower S-36 - add ventilation holes in personal tower		108		\$	\$
Category 2:						
2	60 MODESTY	<ul style="list-style-type: none"><li>Laminate modesty panel , Mounted under Work Surface</li><li>with cable tray</li><li>1524 mm x 381 mm - 431 mm (60 inch x 15-17 inch)</li></ul>	2		\$	\$
Product Total:						\$

**Table 2 - Delivery**

Section A - IU REQUIREMENT				Section B – SUPPLIER'S BID	
Product Item from Table 1	Location	Desired Date (Y/M/D)	Desired Time: Outside Normal* Business Hours	Supplier will deliver on the date and at the time below*	Firm Price
1 – 2	Statistics Canada 2550 Victoria Park Ave.	May 1 <sup>st</sup> , 2018	Outside Normal Business hours	(Y)	\$

along with associated hardware	2 <sup>nd</sup> Floor Toronto ON M5J 5A9			(M)	
				(D)	
*If no dates and times are added by the Supplier, the Supplier agrees to deliver on the Desired Date and Time. (Normal Business Hours 8:00 – 17:00)				<b>Delivery Total:</b>	<b>\$</b>

**Table 3 – Installation**

Section A - IU REQUIREMENT				Section B – SUPPLIER'S BID	
Product Item from Table 1	Location	Desired Date (Y/M/D)	Desired Time: Normal* Business Hours	Supplier will install on the date and at the time below*	Firm Price
1 – 2	Statistics Canada 2550 Victoria Park Ave. 2 <sup>nd</sup> Floor Toronto ON M5J 5A9	May 18 <sup>th</sup> , 2018	Normal Business hours	(Y)	\$
				(M)	
				(D)	
*If no dates and times are added by the Supplier, the Supplier agrees to deliver on the Desired Date and Time. (Normal Business Hours 8:00 – 17:00)				<b>Installation Total:</b>	<b>\$</b>

**Table 4. NSA TOTAL**

1	Product Total (Table 1):	\$
2	Delivery Total (Table 2):	\$
3	Installation Total (Table 3):	\$
4	NSA Total (1+2+3):	INSERT \$ AT ANNEX A, ARTICLE 3.1, SECTION 1, TABLE 5, LINE 4 FOR THE RESPECTIVE CATEGORY

**3. Certification****NSA Product Conformance** (Required precedent to Issuance of a contract)

The Supplier certifies that all the NSA products offered will conform to all specifications of, and meet the testing requirements in this Annex, as applicable.

\_\_\_\_\_  
Supplier's Signature

\_\_\_\_\_  
Date

**NSA Product Conformance Certification** (applies after contract award)

The Supplier warrants that the NSA Product Conformance Certification submitted by the Supplier with its bid is accurate and complete. The Supplier must keep proper records and documentation relating to the NSA product conformance and the testing requirements in this Annex. The Supplier must not, without obtaining the prior written consent of the SAA, dispose of any such records or documentation until the expiration of the Contract or the expiry date of the Warranty, whichever is later. All such records and documentation must at all times during the retention period be open to audit, inspection and examination by the representatives of Canada, who may make copies and take extracts.

Solicitation No. - N° de l'invitation  
EQ754-182398/A

Amd. No. - N° de la modif.

Buyer ID - Id de l'acheteur  
tor024

Client Ref. No. - N° de réf. du client  
EQ754-182398

File No. - N° du dossier  
TOR-7-40150

CCC No./N° CCC - FMS No./N° VME

---

In addition, the Supplier must provide representatives of the SAA access to all locations where any part of the Work is being performed at any time during working hours. Representatives of the SAA may examine and test the Work as they see fit. The Supplier must provide all assistance and access to facilities, test pieces, samples and documentation that the representatives of the SAA may reasonably require for the carrying out of the inspection, which may also include the submission of test reporting documentation as listed in Annex D. The Supplier must forward such test pieces, samples and/or documentation that may also include letters of certification from the laboratories to such person or location as the representatives of the SAA specifies.

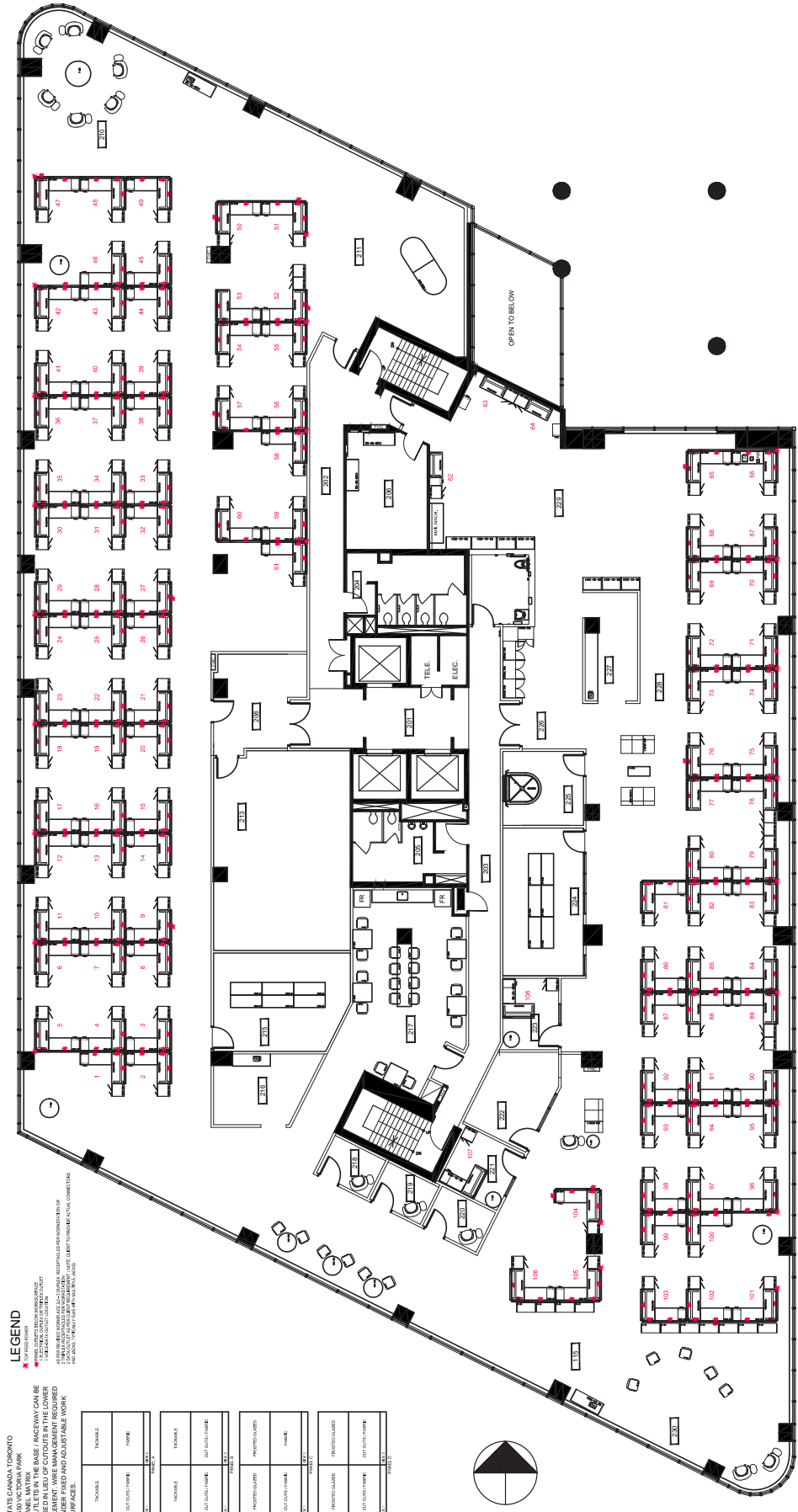

STATE CANADA TORONTO  
250 VICTORIA PARK  
PANEL WIRING

NOTE: BASE RACEWAY CAN BE USED IN LIEU OF OUTLETS IN THE LOWER ELEMENT. WIRE MANAGEMENT REQUIRED THROUGHOUT AND ADJUSTABLE WORK SURFACES.

LEGEND

- 1. OUTLETS
- 2. PANELS
- 3. BASE RACEWAY
- 4. BASE RACEWAY COVER
- 5. BASE RACEWAY COVER
- 6. BASE RACEWAY COVER
- 7. BASE RACEWAY COVER
- 8. BASE RACEWAY COVER
- 9. BASE RACEWAY COVER
- 10. BASE RACEWAY COVER
- 11. BASE RACEWAY COVER
- 12. BASE RACEWAY COVER
- 13. BASE RACEWAY COVER
- 14. BASE RACEWAY COVER
- 15. BASE RACEWAY COVER
- 16. BASE RACEWAY COVER
- 17. BASE RACEWAY COVER
- 18. BASE RACEWAY COVER
- 19. BASE RACEWAY COVER
- 20. BASE RACEWAY COVER
- 21. BASE RACEWAY COVER
- 22. BASE RACEWAY COVER
- 23. BASE RACEWAY COVER
- 24. BASE RACEWAY COVER
- 25. BASE RACEWAY COVER
- 26. BASE RACEWAY COVER
- 27. BASE RACEWAY COVER
- 28. BASE RACEWAY COVER
- 29. BASE RACEWAY COVER
- 30. BASE RACEWAY COVER
- 31. BASE RACEWAY COVER
- 32. BASE RACEWAY COVER
- 33. BASE RACEWAY COVER
- 34. BASE RACEWAY COVER
- 35. BASE RACEWAY COVER
- 36. BASE RACEWAY COVER
- 37. BASE RACEWAY COVER
- 38. BASE RACEWAY COVER
- 39. BASE RACEWAY COVER
- 40. BASE RACEWAY COVER
- 41. BASE RACEWAY COVER
- 42. BASE RACEWAY COVER
- 43. BASE RACEWAY COVER
- 44. BASE RACEWAY COVER
- 45. BASE RACEWAY COVER
- 46. BASE RACEWAY COVER
- 47. BASE RACEWAY COVER
- 48. BASE RACEWAY COVER
- 49. BASE RACEWAY COVER
- 50. BASE RACEWAY COVER
- 51. BASE RACEWAY COVER
- 52. BASE RACEWAY COVER
- 53. BASE RACEWAY COVER
- 54. BASE RACEWAY COVER
- 55. BASE RACEWAY COVER
- 56. BASE RACEWAY COVER
- 57. BASE RACEWAY COVER
- 58. BASE RACEWAY COVER
- 59. BASE RACEWAY COVER
- 60. BASE RACEWAY COVER
- 61. BASE RACEWAY COVER
- 62. BASE RACEWAY COVER
- 63. BASE RACEWAY COVER
- 64. BASE RACEWAY COVER
- 65. BASE RACEWAY COVER
- 66. BASE RACEWAY COVER
- 67. BASE RACEWAY COVER
- 68. BASE RACEWAY COVER
- 69. BASE RACEWAY COVER
- 70. BASE RACEWAY COVER
- 71. BASE RACEWAY COVER
- 72. BASE RACEWAY COVER
- 73. BASE RACEWAY COVER
- 74. BASE RACEWAY COVER
- 75. BASE RACEWAY COVER
- 76. BASE RACEWAY COVER
- 77. BASE RACEWAY COVER
- 78. BASE RACEWAY COVER
- 79. BASE RACEWAY COVER
- 80. BASE RACEWAY COVER
- 81. BASE RACEWAY COVER
- 82. BASE RACEWAY COVER
- 83. BASE RACEWAY COVER
- 84. BASE RACEWAY COVER
- 85. BASE RACEWAY COVER
- 86. BASE RACEWAY COVER
- 87. BASE RACEWAY COVER
- 88. BASE RACEWAY COVER
- 89. BASE RACEWAY COVER
- 90. BASE RACEWAY COVER
- 91. BASE RACEWAY COVER
- 92. BASE RACEWAY COVER
- 93. BASE RACEWAY COVER
- 94. BASE RACEWAY COVER
- 95. BASE RACEWAY COVER
- 96. BASE RACEWAY COVER
- 97. BASE RACEWAY COVER
- 98. BASE RACEWAY COVER
- 99. BASE RACEWAY COVER
- 100. BASE RACEWAY COVER
- 101. BASE RACEWAY COVER
- 102. BASE RACEWAY COVER
- 103. BASE RACEWAY COVER
- 104. BASE RACEWAY COVER

PANEL A		PANEL B		PANEL C		PANEL D	
PROPOSED	EXISTING	PROPOSED	EXISTING	PROPOSED	EXISTING	PROPOSED	EXISTING
1	2	3	4	5	6	7	8
9	10	11	12	13	14	15	16
17	18	19	20	21	22	23	24
25	26	27	28	29	30	31	32
33	34	35	36	37	38	39	40
41	42	43	44	45	46	47	48
49	50	51	52	53	54	55	56
57	58	59	60	61	62	63	64
65	66	67	68	69	70	71	72
73	74	75	76	77	78	79	80
81	82	83	84	85	86	87	88
89	90	91	92	93	94	95	96
97	98	99	100	101	102	103	104