

REFER TO DRAWING C01
FOR ADDITIONAL
REMOVALS INFORMATION

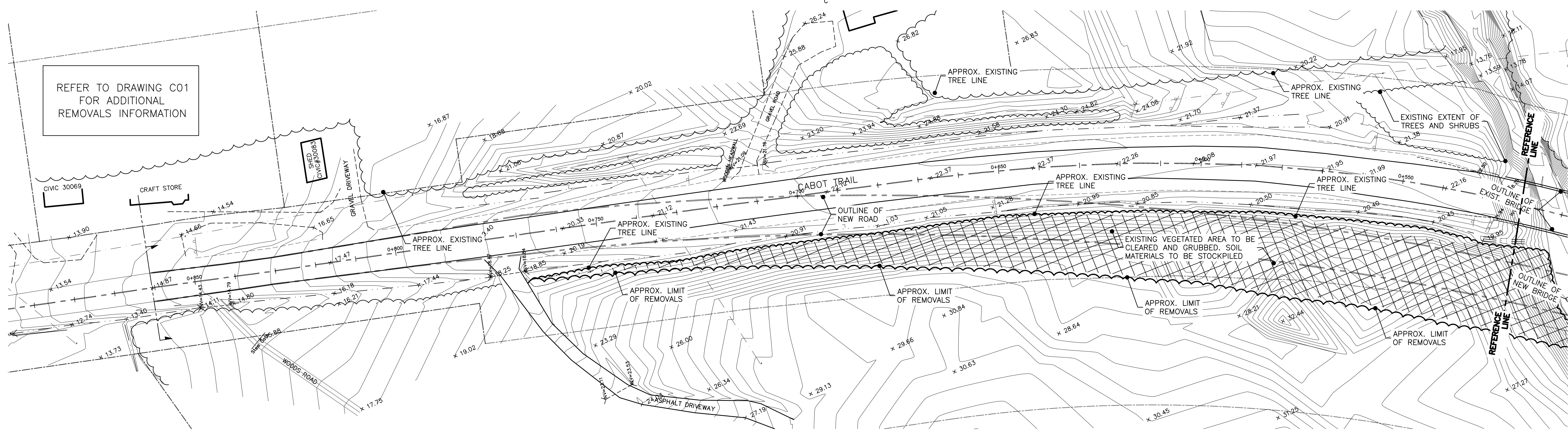

PLAN — EXISTING CONDITIONS AND REMOVALS 0+850 TO 0+530

SCALE: 1:500
0m 10m 20m 30m 40m 50m

LEGEND	
EXISTING	
	EDGE OF ASPHALT
	EDGE OF GRAVEL/SHOULDER
	GUIDERAIL
	TREELINE
	SHRUB/GRASS LINE
	TREE/SHRUB REMOVAL
	DITCHLINE
	SHORELINE/WATERCOURSE
	POWER POLE c/w GUYWIRE
	SIGN
	CULVERT
	OVERHEAD WIRE
	SPOT ELEVATION
	10.80 +



REFER TO DRAWING C01
FOR ADDITIONAL
REMOVALS INFORMATION



PLAN — EXISTING CONDITIONS AND REMOVALS 0+530 TO 0+160

SCALE: 1:500
0m 10m 20m 30m 40m 50m

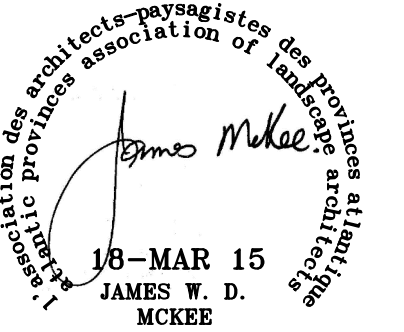

ISSUED FOR TENDER MAR 15 2018
revisions date
project EFFIE'S BROOK BRIDGE REPLACEMENT
HIGHLANDS NATIONAL PARK NOVA SCOTIA

drawing design
CABOT TRAIL EXISTING CONDITIONS AND REMOVALS

designed JAMES MCKEE conq
date MARCH 2018
drawn ANDI LO / JAMES MCKEE dessin
date MARCH 2018

approved approval
date
Tender Submission

PCA Project Manager Administrateur de projets PCA
project number no. du projet

drawing no. no. du dessin
L01

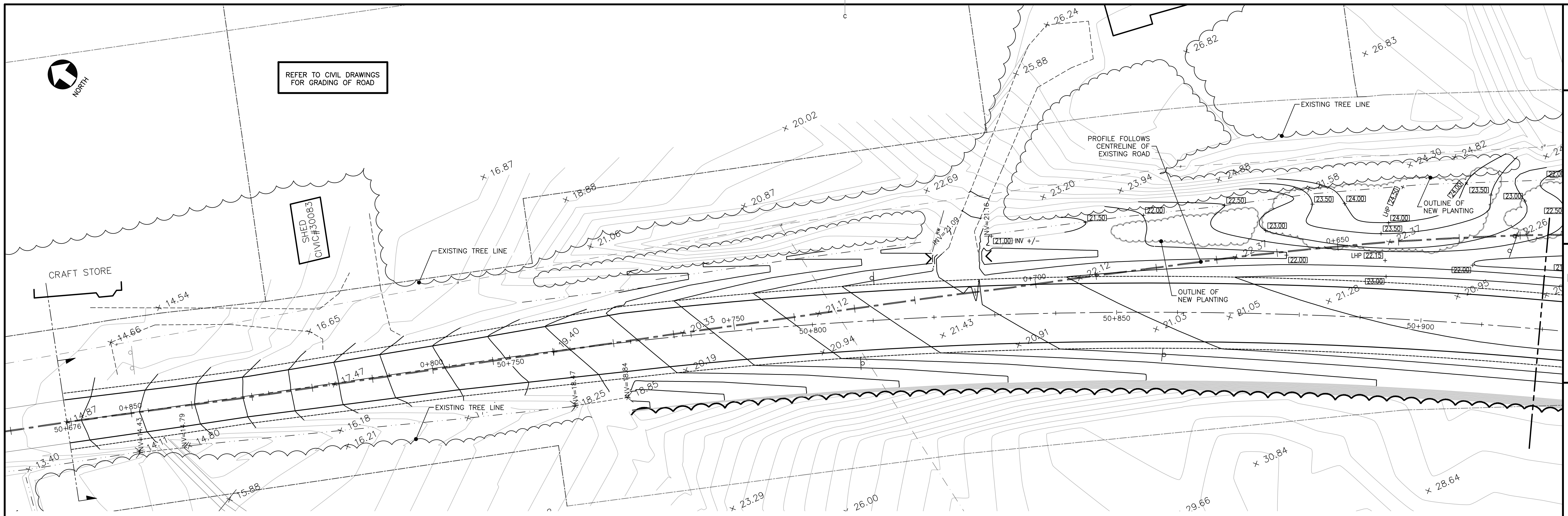

PLAN — GRADING 50+676 TO 50+920



EXISTING		LEGEND		PROPOSED	
	EDGE OF ASPHALT		EDGE OF GRAVEL/SHOULDER		GUIDERAIL
	TREELINE		SHRUB/GRASS LINE		LANDSCAPE TREATMENT 1
	LANDSCAPE TREATMENT 2		DITCHLINE		SHORELINE/WATERCOURSE
	POWER POLE c/w GUYWIRE		SIGN		CULVERT
	OVERHEAD WIRE		SPOT ELEVATION		

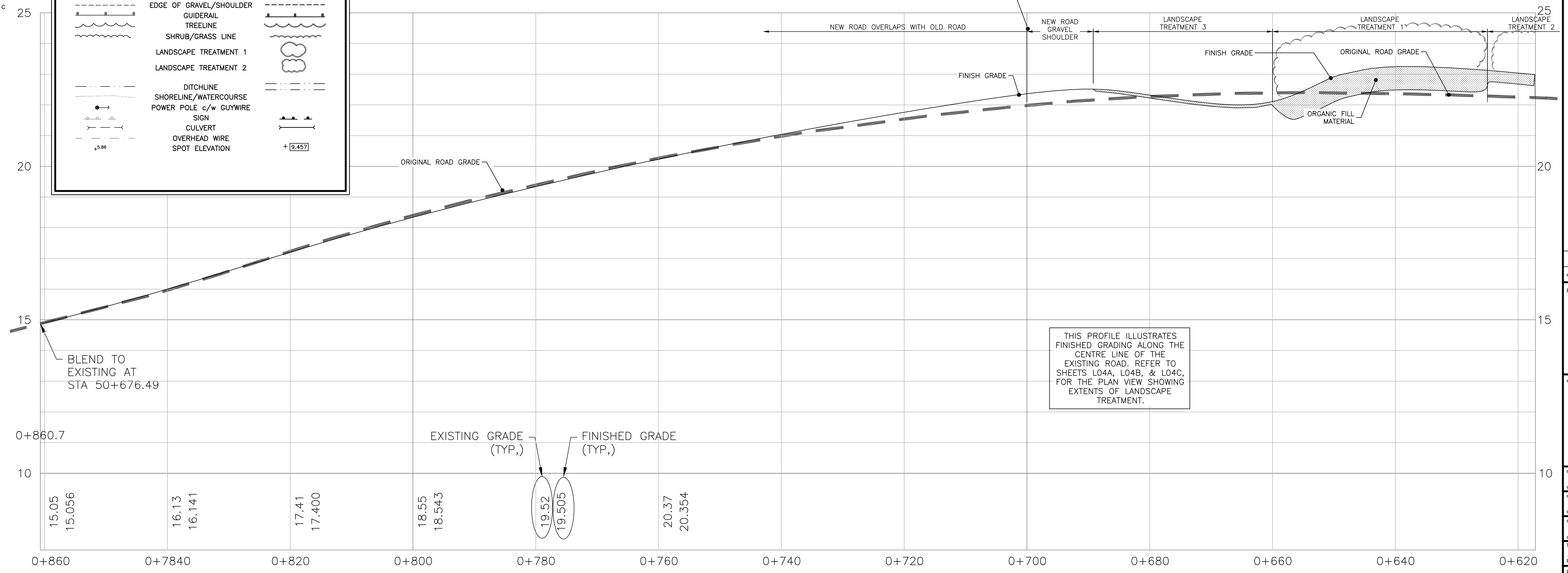

THIS PROFILE ILLUSTRATES FINISHED GRADING ALONG THE CENTRE LINE OF THE EXISTING ROAD, REFER TO SHEETS L04A, L04B, & L04C, FOR THE PLAN VIEW SHOWING EXTENTS OF LANDSCAPE TREATMENT.

PROFILE — CABOT TRAIL EXISTING ROAD 0+860 TO 0+620
HORIZONTAL SCALE : 1:300 VERTICAL SCALE : 1:60

18-MAR 15
JAMES W. D. MCKEE

ISSUED FOR TENDER	MAR 15 2018
revisions	date

project
EFFIE'S BROOK BRIDGE REPLACEMENT
HIGHLANDS NATIONAL PARK NOVA SCOTIA

drawing
CABOT TRAIL LANDSCAPE GRADING 50+676 TO 50+920

designed JAMES MCKEE	conçu
date MARCH 2018	date
drawn ANDI LO / JAMES MCKEE	dessiné
date MARCH 2018	date
approved	approuvé
date	date
Tender	Soumission
PCA Project Manager	Administrateur de projets PCA
project number	no. du projet
drawing no.	no. du dessin
L02A	



REFER TO CIVIL DRAWINGS FOR GRADING OF ROAD

LEGEND	
EXISTING	PROPOSED
	EDGE OF ASPHALT
	EDGE OF GRAVEL/SHOULDER
	GUIDERAIL
	TREELINE
	SHRUB/GRASS LINE
	LANDSCAPE TREATMENT 1
	LANDSCAPE TREATMENT 2
	DITCHLINE
	SHORELINE/WATERCOURSE
	POWER POLE c/w GUYWIRE
	SIGN
	CULVERT
	OVERHEAD WIRE
	SPOT ELEVATION

PLAN - GRADING WHITE POINT ROAD SCALE : 1:300

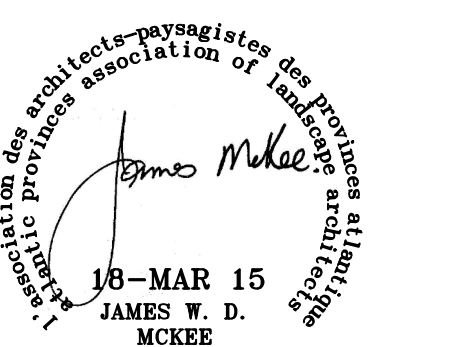
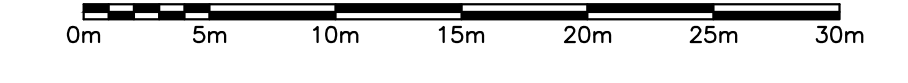

ISSUED FOR TENDER	MAR 15 2018
revisions	date

project EFFIE'S BROOK BRIDGE REPLACEMENT HIGHLANDS NATIONAL PARK NOVA SCOTIA

drawing design CABOT TRAIL LANDSCAPE GRADING WHITE POINT ROAD

designed JAMES MCKEE	conçu
date MARCH 2018	
drawn ANDI LO / JAMES MCKEE	dessiné
date MARCH 2018	
approved	approuvé
date	
Tender	Soumission

PCA Project Manager	Administrateur de projets PCA
project number	no. du projet

drawing no. LO2C no. du dessin

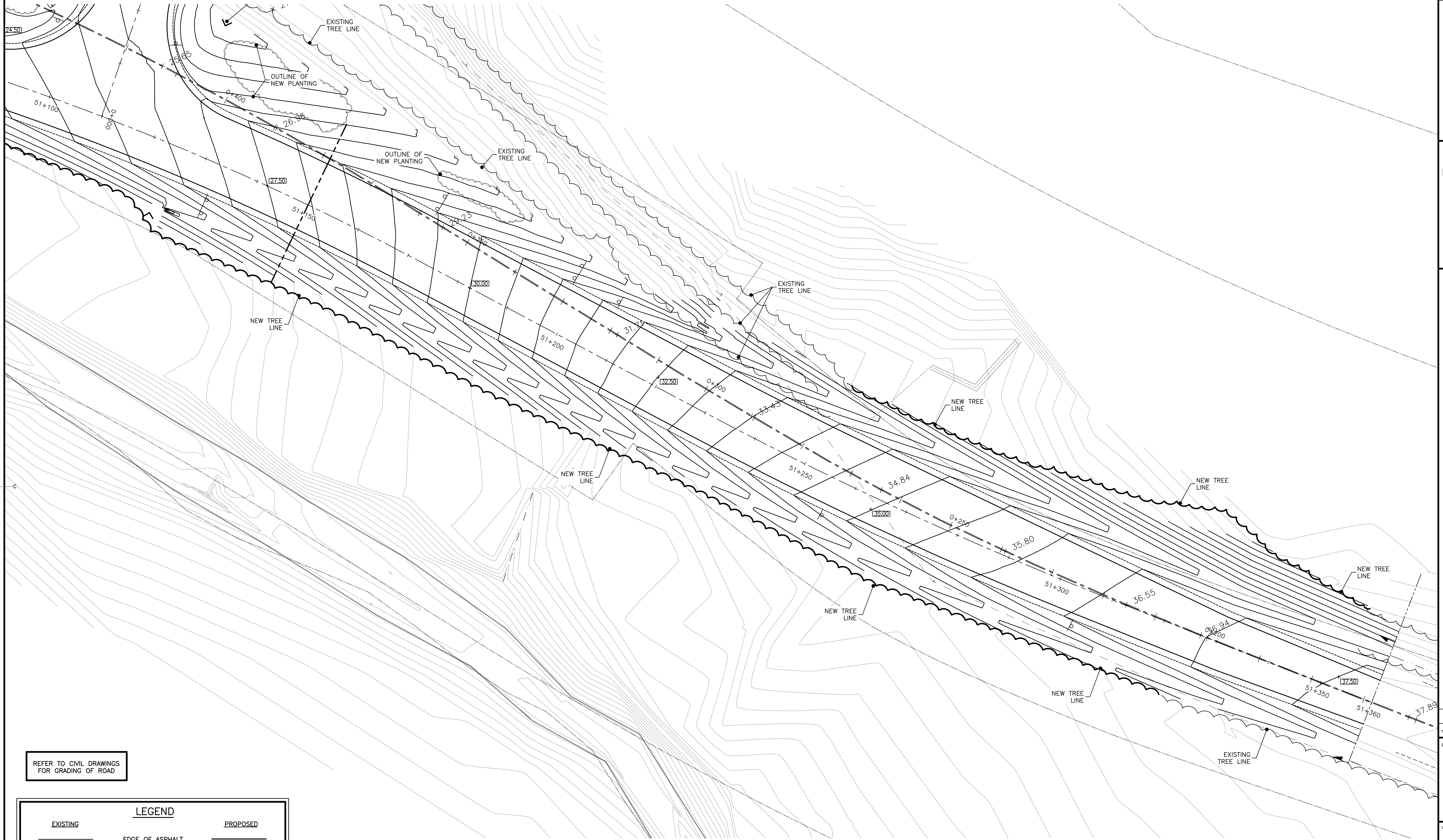

REFER TO CIVIL DRAWINGS FOR GRADING OF ROAD

LEGEND	
EXISTING	PROPOSED
	EDGE OF ASPHALT
	EDGE OF GRAVEL/SHOULDER
	GUIDERAIL
	TREELINE
	SHRUB/GRASS LINE
	LANDSCAPE TREATMENT 1
	LANDSCAPE TREATMENT 2
	DITCHLINE
	SHORELINE/WATERCOURSE
	POWER POLE c/w GUYWIRE
	SIGN
	CULVERT
	OVERHEAD WIRE
	SPOT ELEVATION

PLAN — GRADING 51+150 TO 51+360

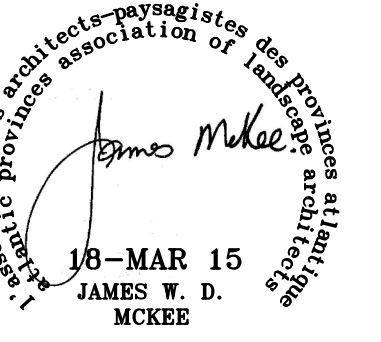
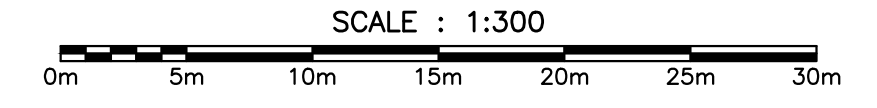

ISSUED FOR TENDER	MAR 15 2018
revisions	date

project project
EFFIE'S BROOK BRIDGE REPLACEMENT
HIGHLANDS NATIONAL PARK NOVA SCOTIA

drawing dessin
CABOT TRAIL LANDSCAPE GRADING 51+150 TO 51+360

designed JAMES MCKEE	conçu
date MARCH 2018	
drawn ANDI LO / JAMES MCKEE	dessiné
date MARCH 2018	
approved	approuvé
date	
Tender	Soumission
PCA Project Manager	Administrateur de projets PCA
project number	no. du projet

drawing no. no. du dessin
L02D

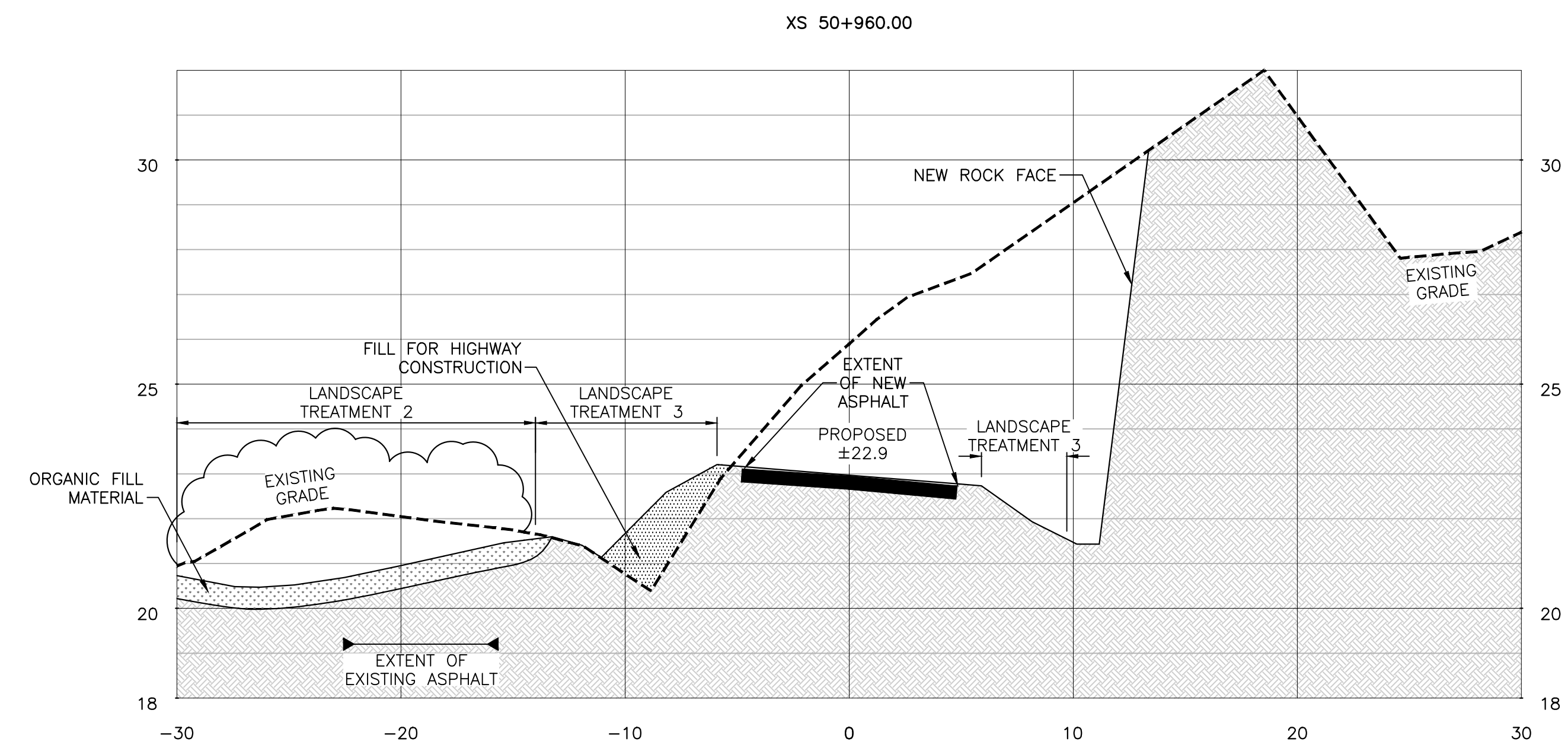
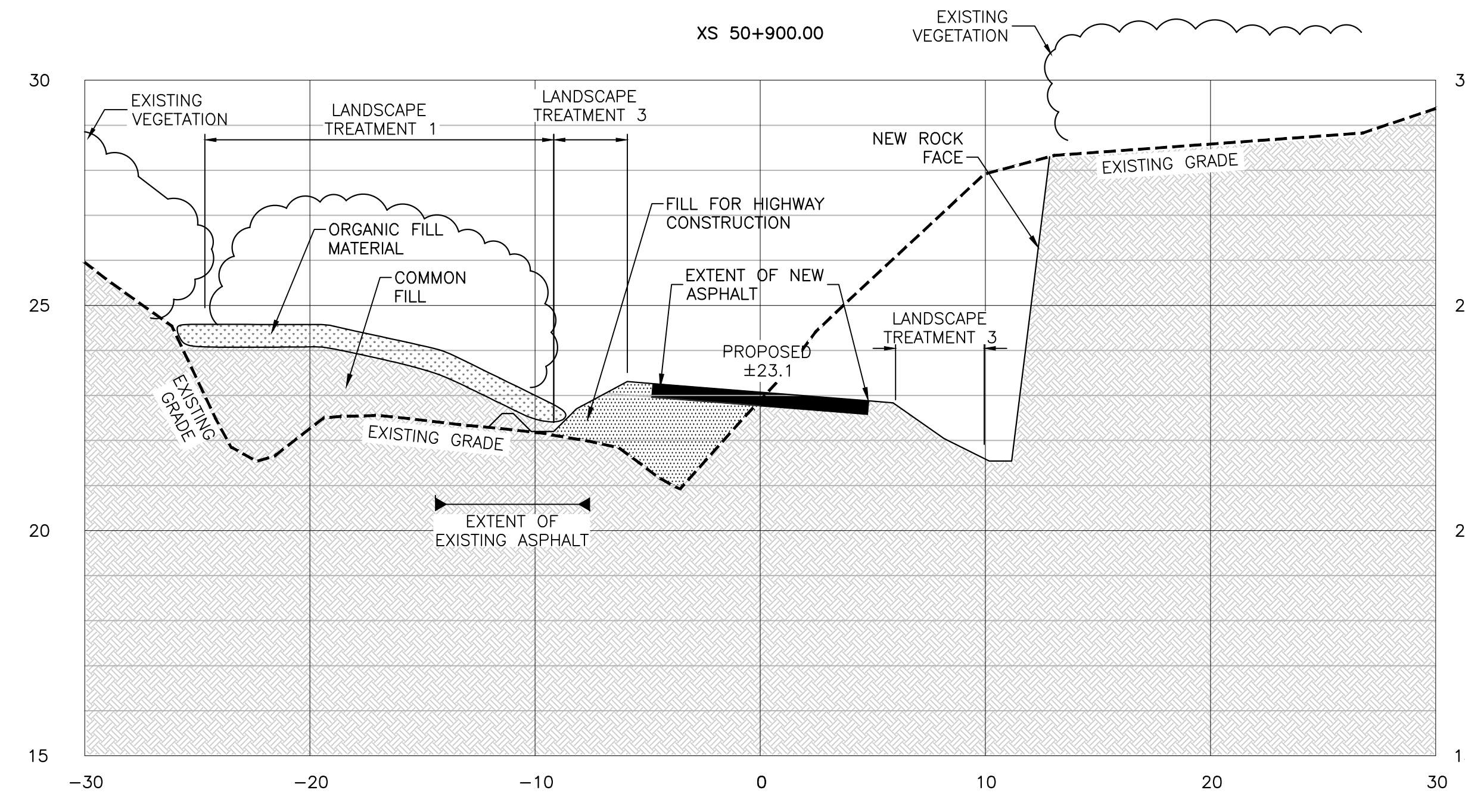
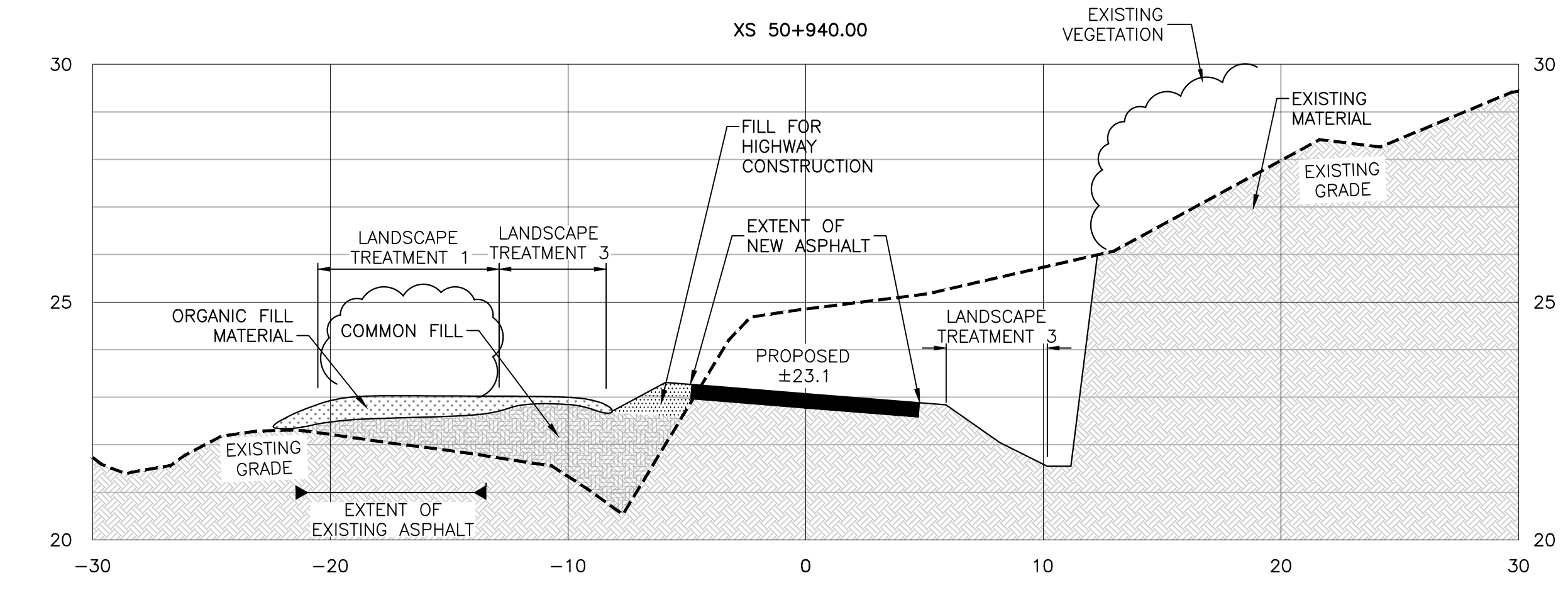
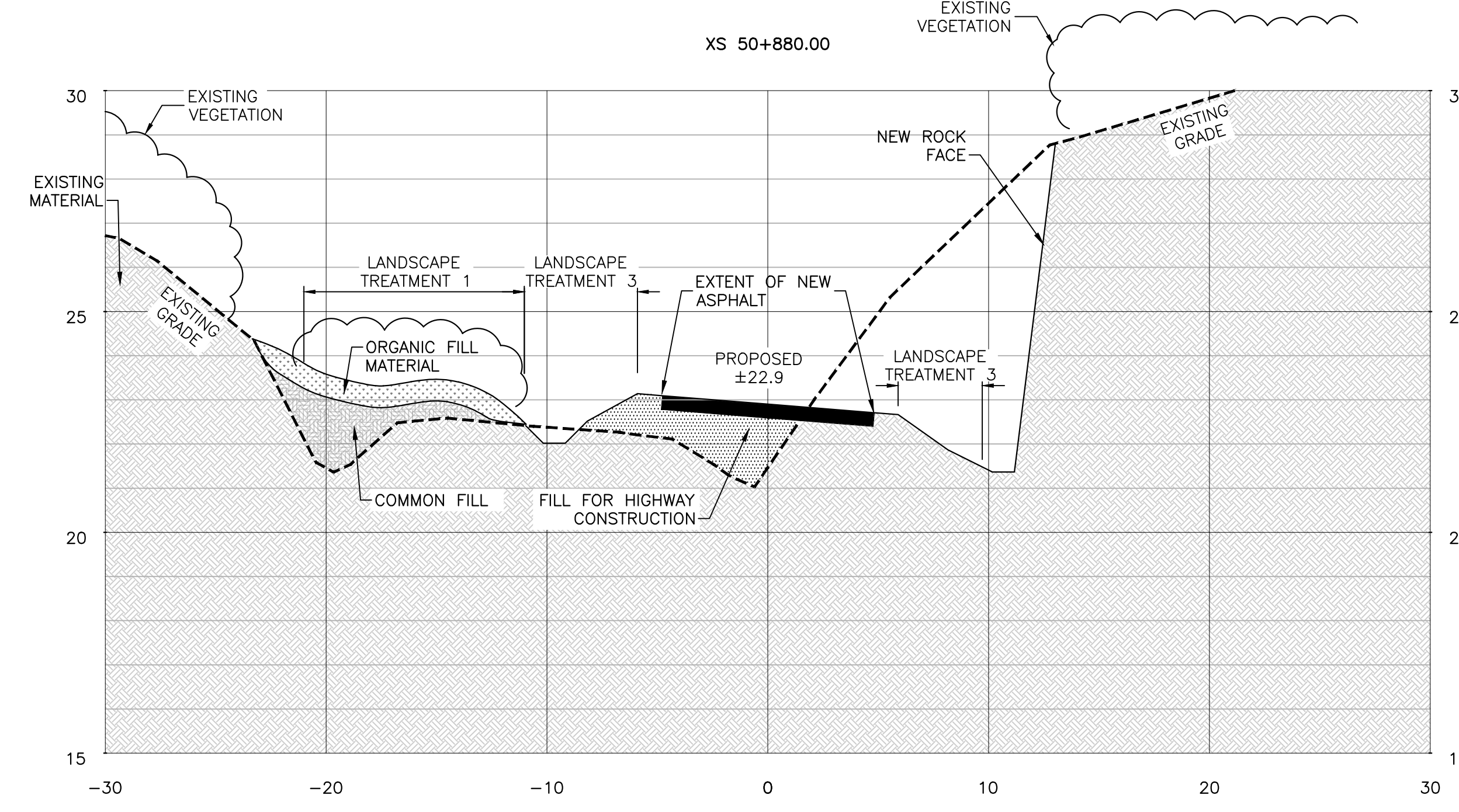
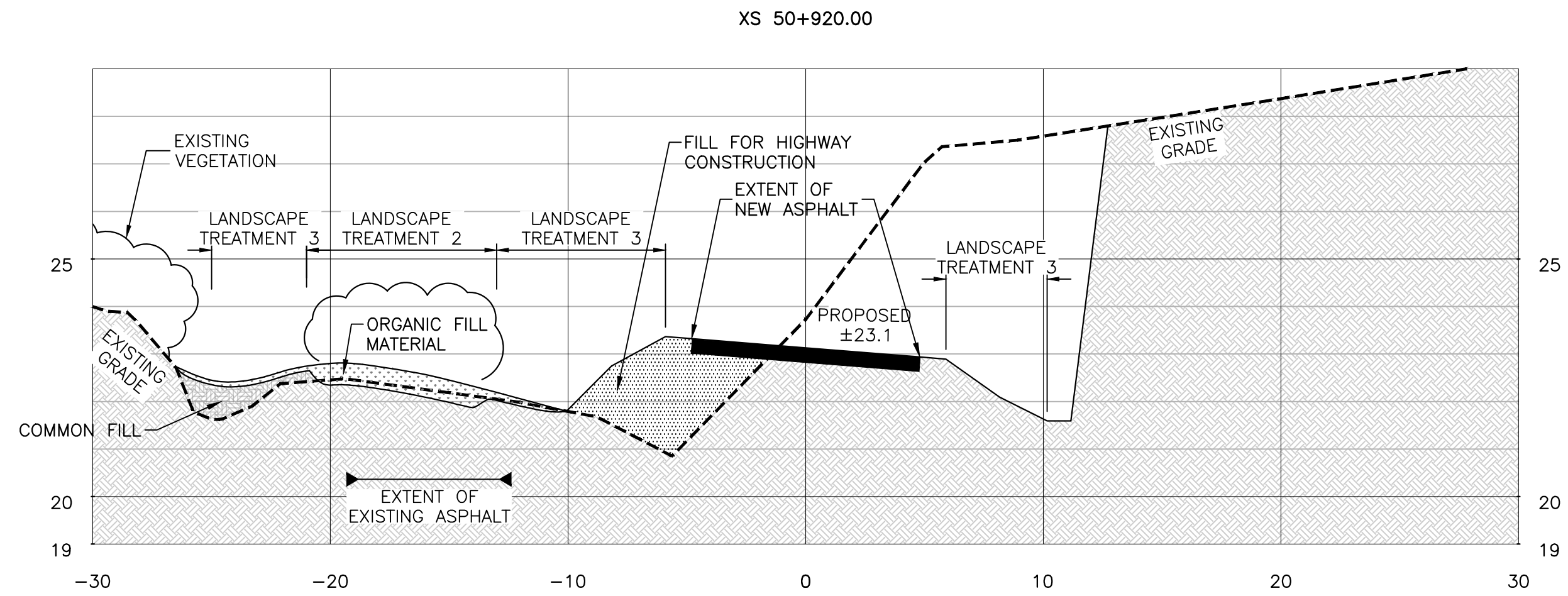
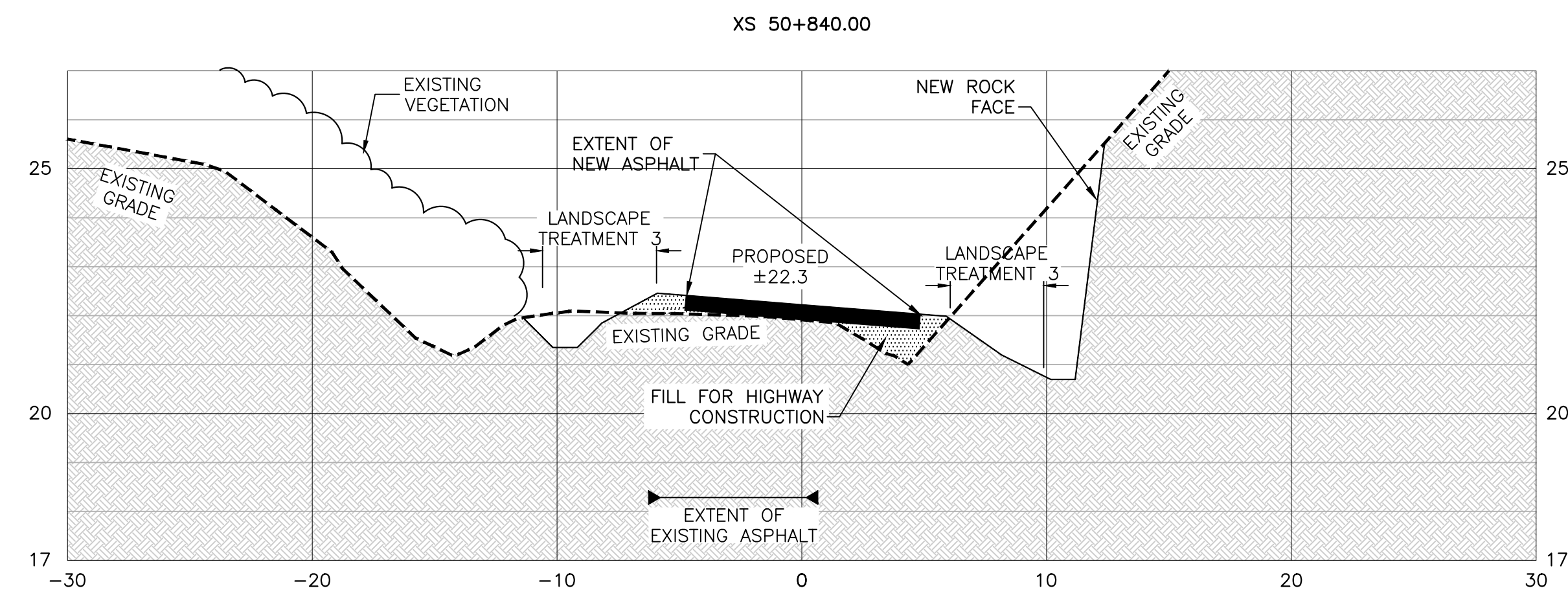

LEGEND

- EXISTING MATERIAL
- EXISTING GRADE
- EXISTING VEGETATION
- ORGANIC FILL MATERIAL
- HIGHWAY CONSTRUCTION FILL
- NEW ASPHALT
- NEW VEGETATION

SECTIONS CABOT TRAIL



LANDSCAPE TREATMENT 1 – REINSTATED TREE PLANTING
PLACE MINIMUM OF 750MM THICK OF STOCKPILED ORGANIC STRIPPING MATERIAL.
PLANT TREES IN PLANTING HOLES WITH NEW PLANTING SOIL.
PLANT TREES RANDOMLY FOLLOWING ROUGH SPACING INDICATED IN TABLE.
HYDROSEED EXPOSED SURFACE.

LANDSCAPE TREATMENT 2 – REINSTATED SHRUB PLANTING
PLACE MINIMUM OF 300MM THICK OF STOCKPILED ORGANIC STRIPPING MATERIAL.
PLANT TREES/SHRUBS IN PLANTING HOLES WITH NEW PLANTING SOIL. PLANT TREES/SHRUBS IN GROUPS OF 5 – 9 FOLLOWING ROUGH SPACING INDICATED IN TABLE.
HYDROSEED EXPOSED SURFACE.

LANDSCAPE TREATMENT 3 – HYDROSEEDING ONLY
PLACE MINIMUM OF 150MM THICK OF STOCKPILED ORGANIC STRIPPING MATERIAL.
HYDROSEED EXPOSED SURFACE.

18-MAR 15
JAMES W. D. MCKEE

ISSUED FOR TENDER	MAR 15 2018
revisions	date

project
EFFIE'S BROOK BRIDGE REPLACEMENT
HIGHLANDS NATIONAL PARK NOVA SCOTIA

drawing
CABOT TRAIL CROSS SECTIONS (SHEET 1 OF 2)

designed JAMES MCKEE	conçu
date MARCH 2018	
drawn ANDI LO / JAMES MCKEE	dessiné
date MARCH 2018	
approved	approuvé
date	
Tender	Soumission
PCA Project Manager	Administrateur de projets PCA
project number	no. du projet
drawing no.	no. du dessin
L03A	

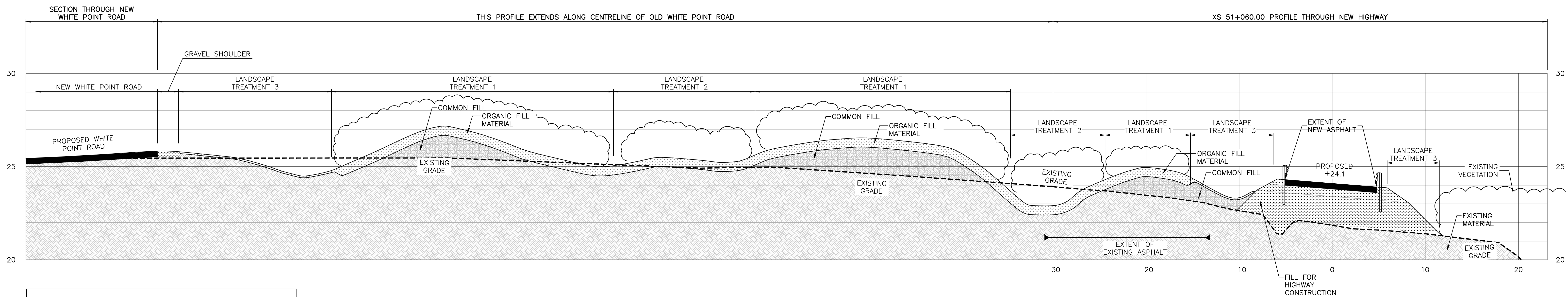
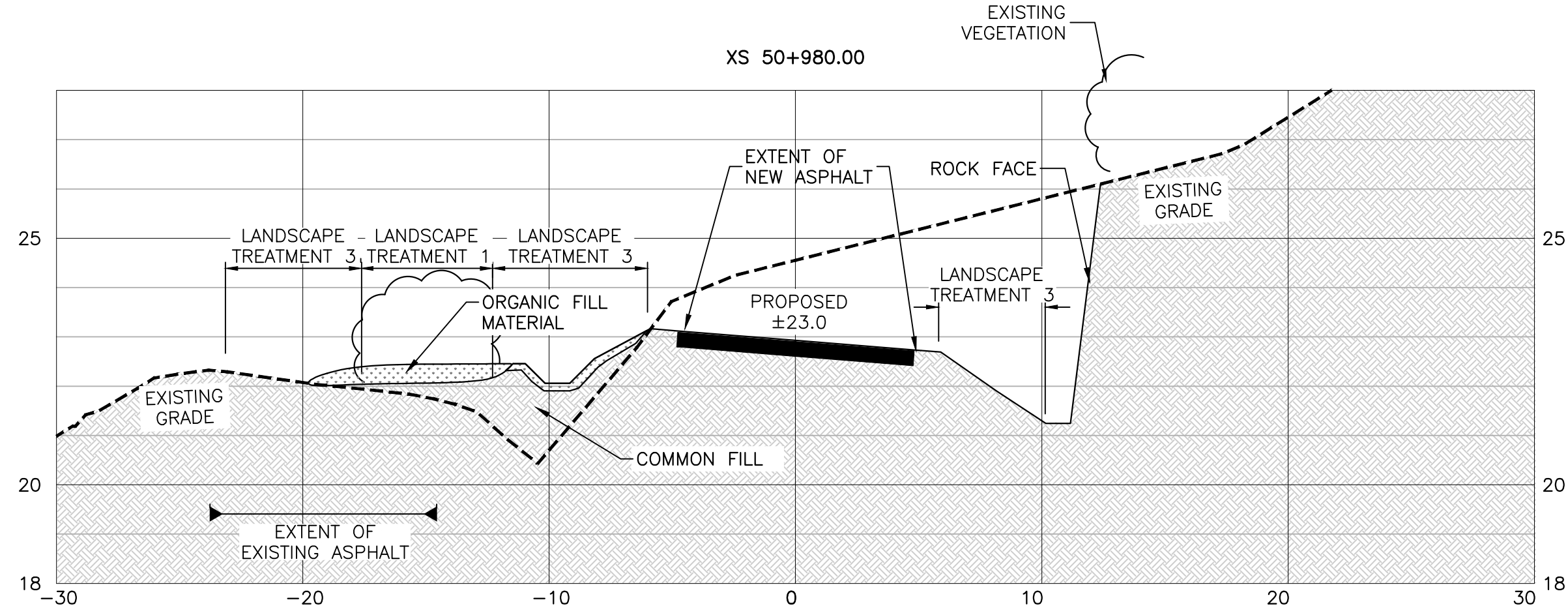

THIS PROFILE ILLUSTRATES FINISHED GRADING ALONG THE CENTRE LINE OF THE EXISTING WHITE POINT ROAD. REFER TO SHEETS L04A, L04B, & L04C, FOR THE PLAN VIEW SHOWING EXTENTS OF LANDSCAPE TREATMENT.

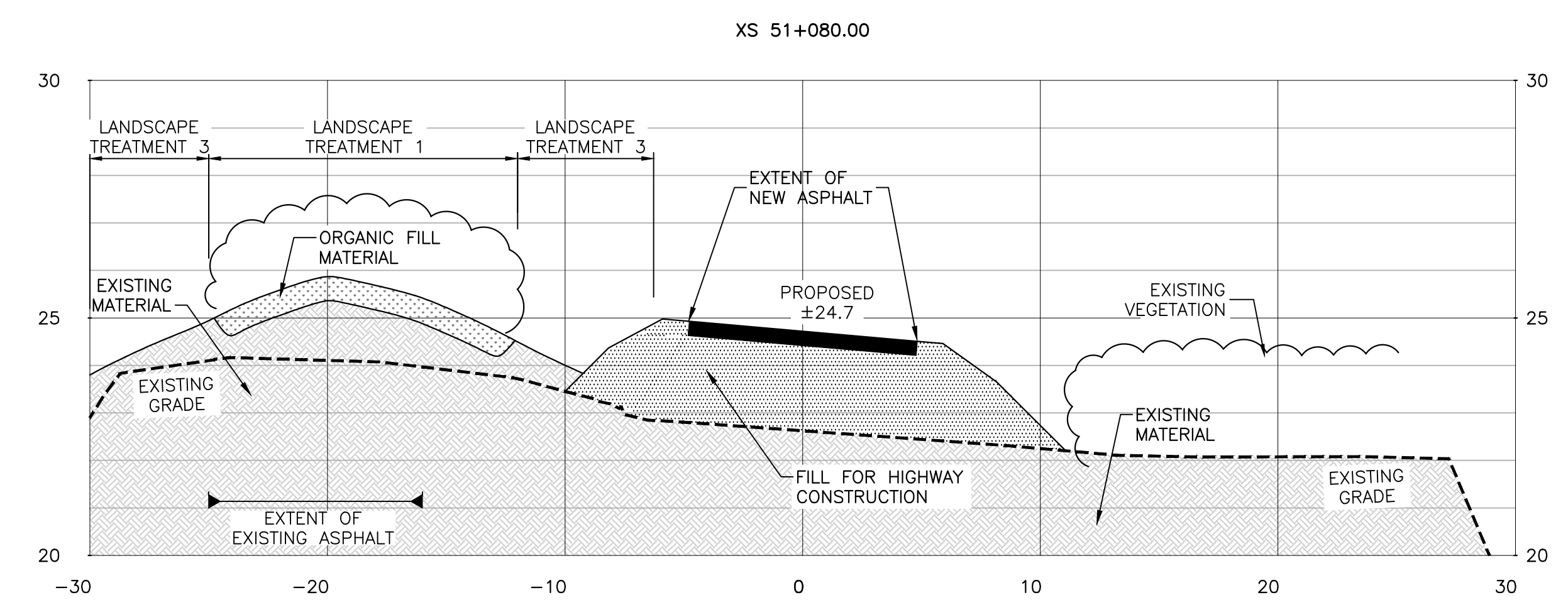

LANDSCAPE TREATMENT 1 – REINSTITATED TREE PLANTING
PLACE MINIMUM OF 750MM THICK OF STOCKPILED ORGANIC STRIPPING MATERIAL.
PLANT TREES IN PLANTING HOLES WITH NEW PLANTING SOIL. PLANT TREES RANDOMLY FOLLOWING ROUGH SPACING INDICATED IN TABLE.
HYDROSEED EXPOSED SURFACE.

LANDSCAPE TREATMENT 2 – REINSTITATED SHRUB PLANTING
PLACE MINIMUM OF 300MM THICK OF STOCKPILED ORGANIC STRIPPING MATERIAL.
PLANT TREES/SHRUBS IN PLANTING HOLES WITH NEW PLANTING SOIL. PLANT TREES/SHRUBS IN GROUPS OF 5 – 9 FOLLOWING ROUGH SPACING INDICATED IN TABLE.
HYDROSEED EXPOSED SURFACE.

LANDSCAPE TREATMENT 3 – HYDROSEEDING ONLY
PLACE MINIMUM OF 150MM THICK OF STOCKPILED ORGANIC STRIPPING MATERIAL.
HYDROSEED EXPOSED SURFACE.

LEGEND	
	EXISTING MATERIAL
	EXISTING GRADE
	EXISTING VEGETATION
	ORGANIC FILL MATERIAL
	HIGHWAY CONSTRUCTION FILL
	NEW ASPHALT
	NEW VEGETATION

SECTIONS CABOT TRAIL



18-MAR 15
JAMES W. D. MCKEE

ISSUED FOR TENDER	MAR 15 2018
revisions	date

project
EFFIE'S BROOK BRIDGE REPLACEMENT
HIGHLANDS NATIONAL PARK NOVA SCOTIA

drawing
CABOT TRAIL CROSS SECTIONS (SHEET 2 OF 2)

designed JAMES MCKEE	conçu
date MARCH 2018	date
drawn ANDI LO / JAMES MCKEE	dessiné
date MARCH 2018	date
approved	approuvé
date	date
Tender	Soumission
PCA Project Manager	Administrateur de projets PCA
project number	no. du projet
drawing no.	no. du dessin
L03B	



CODE	BOTANICAL NAME	COMMON NAME
ABA	Abies balsamiae	Balsam Fir
ARC	Acer rubrum 'Clump'	Clump Red Maple
ARU	Acer rubrum 'Whip'	Red Maple Whip
BPA	Betula papyrifera	Paper Birch
PGL	Picea glauca	White Spruce
PST	Pinus strobus	White Pine

NOTE: SUBSTITUTIONS TO PLANTS AS SPECIFIED ABOVE ARE NOT ACCEPTABLE UNLESS WRITTEN PERMISSION HAS BEEN OBTAINED FOR SPECIES / VARIETY, SIZE, QUANTITY &/OR CONDITION FROM DEPARTMENTAL REPRESENTATIVE



LANDSCAPE TREATMENT 1 - REINSTATED TREE PLANTING
PLACE MINIMUM OF 750MM THICK OF STOCKPILED ORGANIC STRIPPING MATERIAL.
PLANT TREES IN PLANTING HOLES WITH NEW PLANTING SOIL. PLANT TREES RANDOMLY FOLLOWING ROUGH SPACING INDICATED IN TABLE. HYDROSEED EXPOSED SURFACE.

LANDSCAPE TREATMENT 2 - REINSTATED SHRUB PLANTING
PLACE MINIMUM OF 300MM THICK OF STOCKPILED ORGANIC STRIPPING MATERIAL.
PLANT TREES/SHRUBS IN PLANTING HOLES WITH NEW PLANTING SOIL. PLANT TREES/SHRUBS IN GROUPS OF 5 - 9 FOLLOWING ROUGH SPACING INDICATED IN TABLE. HYDROSEED EXPOSED SURFACE.

LANDSCAPE TREATMENT 3 - HYDROSEEDING ONLY
PLACE MINIMUM OF 150MM THICK OF STOCKPILED ORGANIC STRIPPING MATERIAL.
HYDROSEED EXPOSED SURFACE.

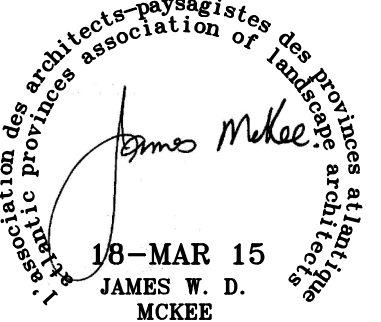

ISSUED FOR TENDER	MAR 15 2018
revisions	date

EFFIE'S BROOK BRIDGE REPLACEMENT
HIGHLANDS NATIONAL PARK NOVA SCOTIA

CABOT TRAIL LANDSCAPE FINISH TREATMENT PLAN WHITE POINT ROAD

designed JAMES MCKEE	conçu
date MARCH 2018	date
drawn ANDI LO / JAMES MCKEE	dessiné
date MARCH 2018	date
approved	approuvé
date	date
Tender	Submission

PCA Project Manager	Administrateur de projets PCA
project number	no. du projet
drawing no.	no. du dessin

L04B

EXISTING	LEGEND	PROPOSED
	EDGE OF ASPHALT	
	EDGE OF GRAVEL/SHOULDER	
	GUIDERAIL	
	TREELINE	
	SHRUB/GRASS LINE	
	LANDSCAPE TREATMENT 1	
	LANDSCAPE TREATMENT 2	
	LANDSCAPE TREATMENT 3	
	DITCHLINE	
	SHORELINE/WATERCOURSE	
	POWER POLE c/w GUYWIRE	
	SIGN	
	CULVERT	
	OVERHEAD WIRE	
	SPOT ELEVATION	

PLAN - LANDSCAPE FINISH WHITE POINT ROAD

SCALE: 1:300
0m 5m 10m 15m 20m 25m 30m

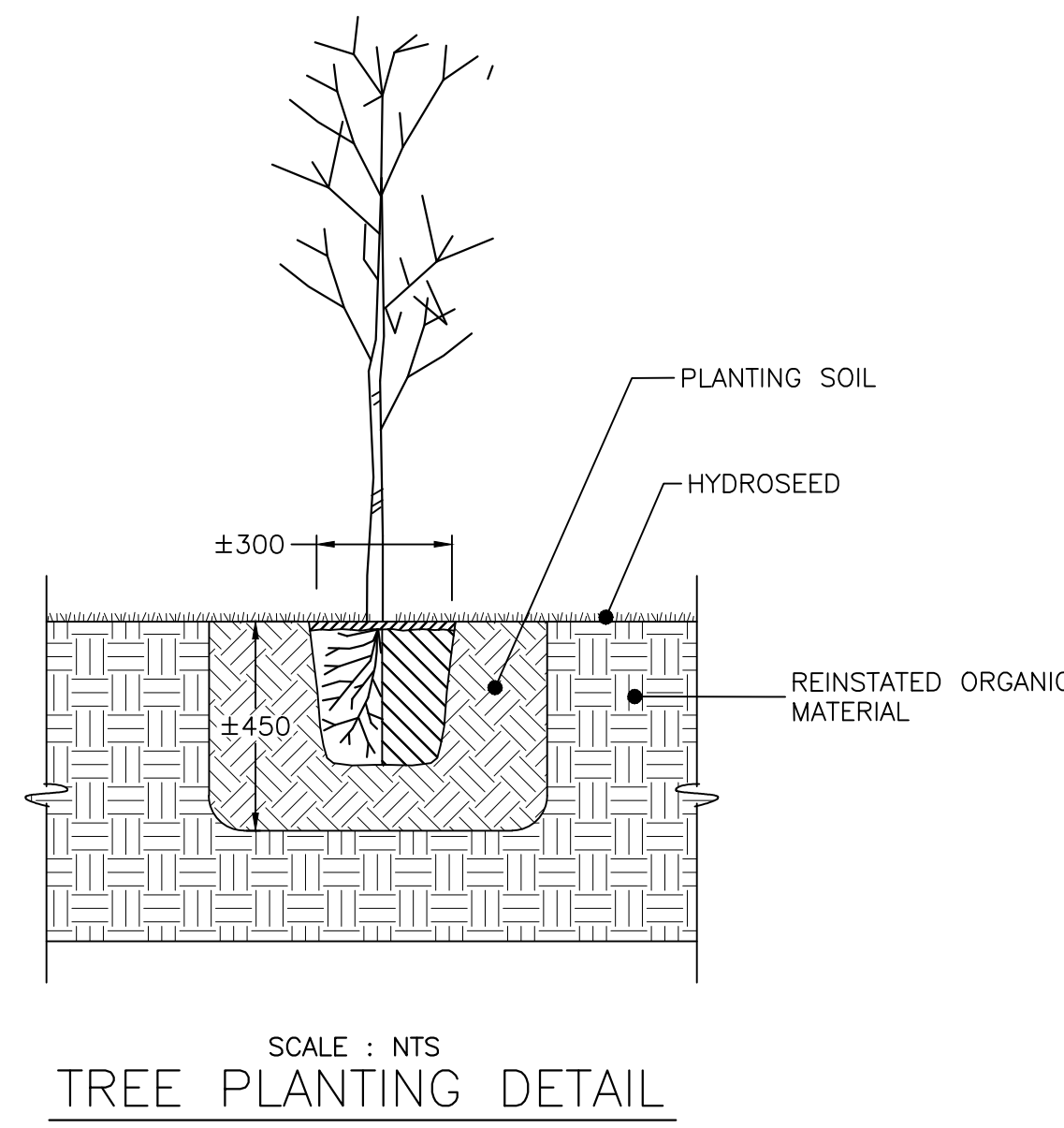
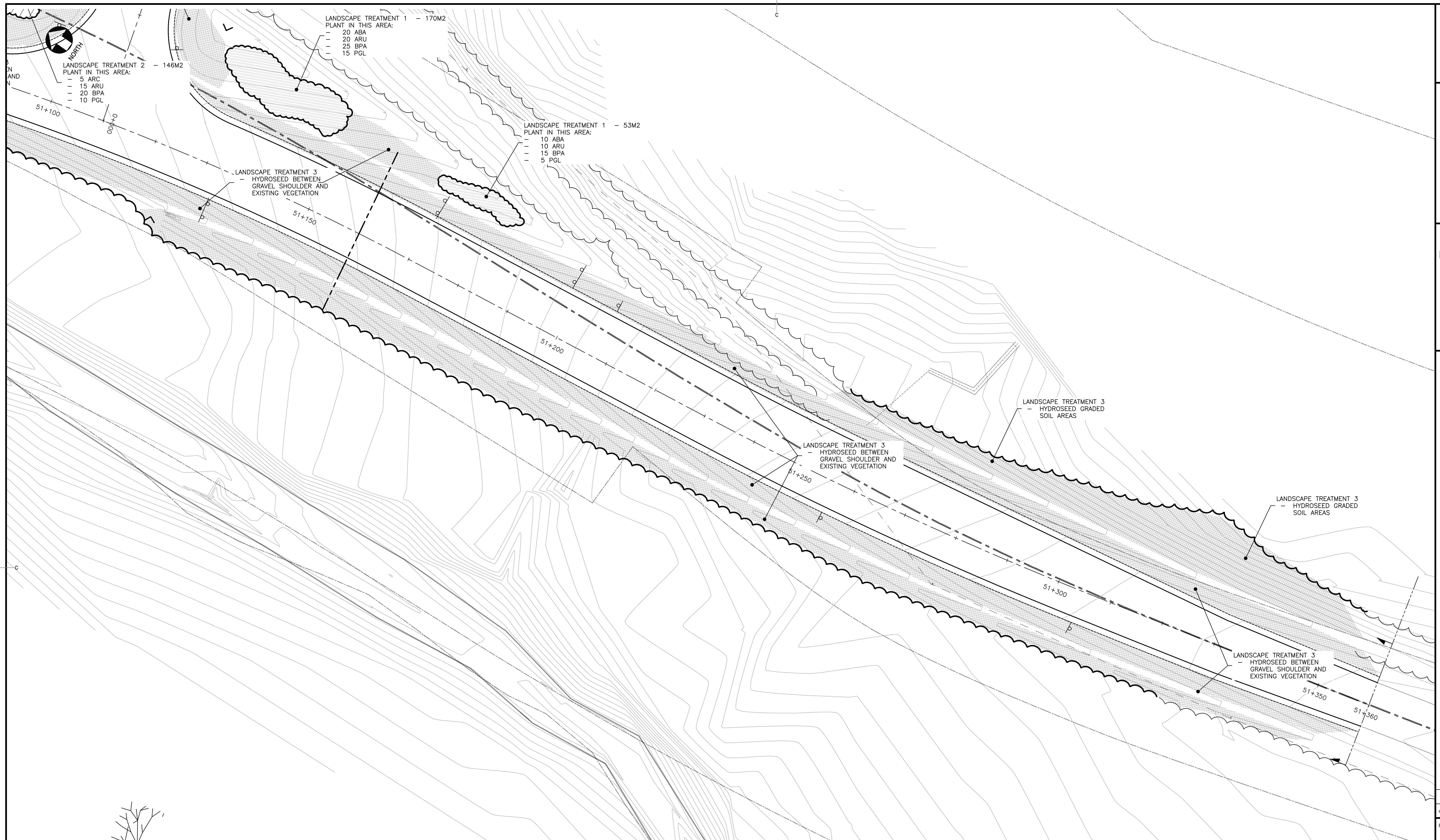

LANDSCAPE TREATMENT 1 - REINSTATED TREE PLANTING
PLACE MINIMUM OF 750MM THICK OF STOCKPILED ORGANIC STRIPPING MATERIAL.
PLANT TREES IN PLANTING HOLES WITH NEW PLANTING SOIL. PLANT TREES RANDOMLY FOLLOWING ROUGH SPACING INDICATED IN TABLE. HYDROSEED EXPOSED SURFACE.

LANDSCAPE TREATMENT 2 - REINSTATED SHRUB PLANTING
PLACE MINIMUM OF 300MM THICK OF STOCKPILED ORGANIC STRIPPING MATERIAL.
PLANT TREES/SHRUBS IN PLANTING HOLES WITH NEW PLANTING SOIL. PLANT TREES/SHRUBS IN GROUPS OF 5 - 9 FOLLOWING ROUGH SPACING INDICATED IN TABLE. HYDROSEED EXPOSED SURFACE.

LANDSCAPE TREATMENT 3 - HYDROSEEDING ONLY
PLACE MINIMUM OF 150MM THICK OF STOCKPILED ORGANIC STRIPPING MATERIAL.
HYDROSEED EXPOSED SURFACE.

PLAN - LANDSCAPE FINISH 51+150 TO 51+360
SCALE : 1:300

FULL PLANTING SCHEDULE								
CODE	QTY	BOTANICAL NAME	COMMON NAME	SIZE	COND.	SPACING	STAKING	REMARKS
ABA	280	Abies balsamiae	Balsam Fir	80cm	CG#3	1000 O.C.	-	Spaced randomly
ARC	75	Acer rubrum 'Clump'	Clump Red Maple	250cm	B&B	Random	-	Spaced randomly
ARU	231	Acer rubrum 'Whip'	Red Maple Whip	150cm	CG#5	1000 O.C.	-	Spaces randomly
BPA	370	Betula papyrifera	Paper Birch	150cm	CG#3	1000 o.c.	-	Spaced randomly
PGL	275	Picea glauca	White Spruce	80cm	CG#3	1000 o.c.	-	Spaced randomly
PST	50	Pinus strobus	White Pine	80cm	CG#3	1000 o.c.	-	Spaced randomly

NOTE: SUBSTITUTIONS TO PLANTS AS SPECIFIED ABOVE ARE NOT ACCEPTABLE UNLESS WRITTEN PERMISSION HAS BEEN OBTAINED FOR SPECIES / VARIETY, SIZE, QUANTITY &/OR CONDITION FROM DEPARTMENTAL REPRESENTATIVE

LEGEND

EXISTING		PROPOSED
—	EDGE OF ASPHALT	—
—	EDGE OF GRAVEL/SHOULDER	—
—	GUIDERAIL	—
—	TREELINE	—
—	SHRUB/GRASS LINE	—
—	LANDSCAPE TREATMENT 1	—
—	LANDSCAPE TREATMENT 2	—
—	LANDSCAPE TREATMENT 3	—
—	DITCHLINE	—
—	SHORELINE/WATERCOURSE	—
—	POWER POLE c/w GUYWIRE	—
—	SIGN	—
—	CULVERT	—
—	OVERHEAD WIRE	—
—	SPOT ELEVATION	+ [9.457]

18-MAR 15
JAMES W. D. MCKEE

ISSUED FOR TENDER MAR 15 2018
revisions date
project project
EFFIE'S BROOK BRIDGE REPLACEMENT
HIGHLANDS NATIONAL PARK NOVA SCOTIA

drawing design
CABOT TRAIL LANDSCAPE FINISH TREATMENT PLAN 51+150 TO 51+360
designed JAMES MCKEE conq
date MARCH 2018
drawn ANDI LO / JAMES MCKEE dessin
date MARCH 2018
approved approval
date
Tender Submission
PCA Project Manager Administrateur de projets PCA
project number no. du projet
drawing no. no. du dessin
L04C