

Watson MacEwen Teramura Architects

400-116 Leger Street
Ottawa ON K2P 0C2
1613.232.0330
1613.232.6253

Structural Engineers
Halsall Associates
4001-210 Gladstone Avenue
Kingston, Ontario K2P 0V6
613.237.2462

Mechanical / Electrical Eng.
Bouthillier Parizeau & Associates
100 - 1960 Robertson Road
Ottawa, ON K2H 5B9
613.596.6454

Civil Engineers
WSP Group
201-1224 Gardiners Road
Kingston, Ontario K7P 0G2
613.634.7373

IT-Telecommunications
The Attain Group
208-1680 Woodward Drive
Kingston, Ontario K2C 3R7
613.739.9424

key plan plan-06

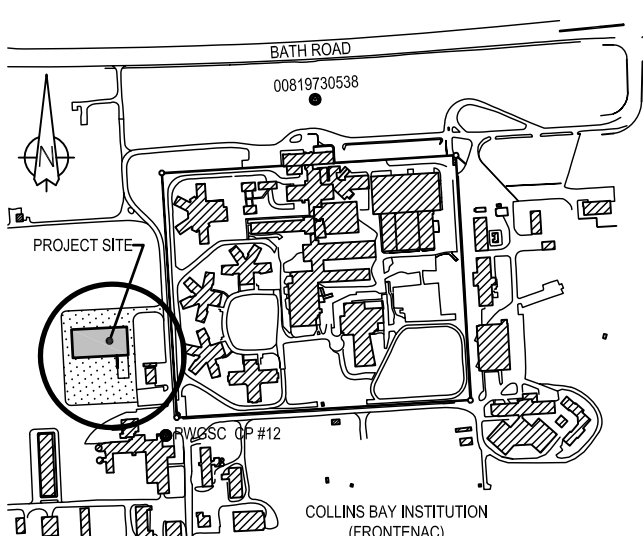

01	ISSUED FOR TENDER	15/03/26
revision	description	date

A	A detail no. n° du détail	A
B	B location drawing no. sur dessin n°	B
C	C drawing no. dessin n°	C

project project
CSC MULTI-PURPOSE BUILDING
CBI MINIMUM INSTITUTION (FRONTENAC)
KINGSTON, ONTARIO

drawing dessin

WALL SECTIONS

designed	Mackay-Lyons Sweetapple	compu
date	2012/01/01	(yyyy/mm/dd)
drawn	BML	dessiné
date	2012/11/16	(yyyy/mm/dd)
reviewed	DC / GF	examiné
date	2015/02/23	(yyyy/mm/dd)
approved	RM	approuvé
date	2015/03/12	(yyyy/mm/dd)
Tender	DUNCAN PARKER	Soumission

Project Manager Administrateur de projets
project no. no. du projet

R.055776.001

drawing no. no. du dessin
A501

- KEYNOTES**
- (R1) ROOF ASSEMBLY (±300mm OVERALL THICKNESS):**
 - PREFORMED STANDING SEAM PANEL WITH 22mm HIGH SEAM [07 61 00 - 2.1.4.1]
 - ±15mm AIR SPACE
 - WATERPROOF MEMBRANE [07 61 00 - 2.2.1]
 - 12mm SHEATHING [07 61 00 - 2.2.2]
 - ±200mm ZEE GIRTS [07 61 00 - 2.3.1]
 - C/Q 2 LAYERS ±100mm RIGID EXTRUDED POLYSTYRENE INSULATION RSI 7.04 [07 21 13 - 2.1.2]
 - VAPOR BARRIER MEMBRANE [07 61 00 - 2.2.4]
 - 12mm DECK SHEATHING [07 61 00 - 2.2.2]
 - 38mm STEEL DECKING [05 31 00 - 2.2.1]
 - (W1) WALL ASSEMBLY (±175mm OVERALL THICKNESS):**
 - 22mm EXTERIOR STEEL CLADDING PANELS [07 46 13 - 2.1.1]
 - ±25mm AIR SPACE
 - ±152mm VERTICAL ZEE GIRTS [07 46 13 - 2.4.2]
 - C/W HIGH DENSITY BATT INSULATION RSI 3.55 [07 21 16 - 2.1.2]
 - INTERIOR LINER PANEL [07 46 13 - 2.2]
 - (W3) FOUNDATION WALL ASSEMBLY:**
 - CAST-IN-PLACE CONCRETE WALL - SEE STRUCTURAL
 - 40mm RIGID EXTRUDED POLYSTYRENE INSULATION RSI 1.32 [07 21 13 - 2.1.2]
 - (W4) FOUNDATION WALL ASSEMBLY:**
 - 40mm RIGID EXTRUDED POLYSTYRENE INSULATION RSI 1.32 [07 21 13 - 2.1.2]
 - CAST-IN-PLACE CONCRETE WALL - SEE STRUCTURAL
 - 40mm RIGID EXTRUDED POLYSTYRENE INSULATION RSI 1.32 [07 21 13 - 2.1.2]
 - (W5) BULKHEAD ASSEMBLY (±130mm OVERALL THICKNESS):**
 - INTERIOR LINER PANEL [07 46 13 - 2.2]
 - ±127mm VERTICAL ZEE GIRTS [07 46 13 - 2.4.2]
 - C/W HIGH DENSITY BATT INSULATION RSI 3.55 [07 21 16 - 2.1.2]
 - INTERIOR LINER PANEL [07 46 13 - 2.2]
 - (F1) MAIN FLOOR ASSEMBLY:**
 - 125mm OR 200mm CAST-IN-PLACE CONCRETE SLAB - SEE STRUCTURAL
 - C/W IN-FLOOR HEATING SYSTEM - SEE MECHANICAL
 - UNDERSLAB VAPOR BARRIER [07 26 16 - 2.1]
 - 40mm RIGID EXTRUDED POLYSTYRENE INSULATION RSI 1.32 [07 21 13 - 2.1.3]
 - 400mm FILL COMPACTED AND LEVEL [31 23 10]
 - UNDISTURBED SOIL
 - (F2) MEZZANINE FLOOR ASSEMBLY (45 MINUTE FRR):**
 - 150mm CAST-IN-PLACE CONCRETE SLAB - SEE STRUCTURAL
 - 76mm STEEL - SEE STRUCTURAL
 - SUPPORTING STEEL STRUCTURE - SEE STRUCTURAL
 - SPRAY APPLIED FIRE RESISTIVE MATERIAL (SFRM) TO STEEL DECK AND SUPPORTING STEEL STRUCTURE [07 81 00 - 2.1.1]
 - SPRAYED INSULATION OVER SFRM OVER STEEL DECK AND SUPPORTING STEEL STRUCTURE [07 21 29.03 - 2.1]
 - SUSPENSION SYSTEM [09 51 13 - 2.1.2]
 - ACOUSTIC UNITS [09 51 13 - 2.1.1]
 - (F3) MEZZANINE FLOOR ASSEMBLY AT SOFFIT (45 MIN. FRR):**
 - 150mm CAST-IN-PLACE CONCRETE SLAB - SEE STRUCTURAL
 - 76mm STEEL - SEE STRUCTURAL
 - SUPPORTING STEEL STRUCTURE - SEE STRUCTURAL
 - SPRAY APPLIED FIRE RESISTIVE MATERIAL (SFRM) TO STEEL DECK AND SUPPORTING STEEL STRUCTURE [07 81 00 - 2.1.1]
 - SPRAYED INSULATION OVER SFRM OVER STEEL DECK AND SUPPORTING STEEL STRUCTURE [07 21 29.03 - 2.1]
 - 150mm STEEL STUDS @ 400mm OC SECURED INTO PERIMETER TRACKS [07 42 43 - 2.2.1]
 - 22mm FURRING CHANNELS @ 400mm OC SECURED TO STEEL STUDS [07 42 43 - 2.2.2]
 - 4mm COMPOSITE PANELS ±24mm DEEP [07 42 43 - 2.1]

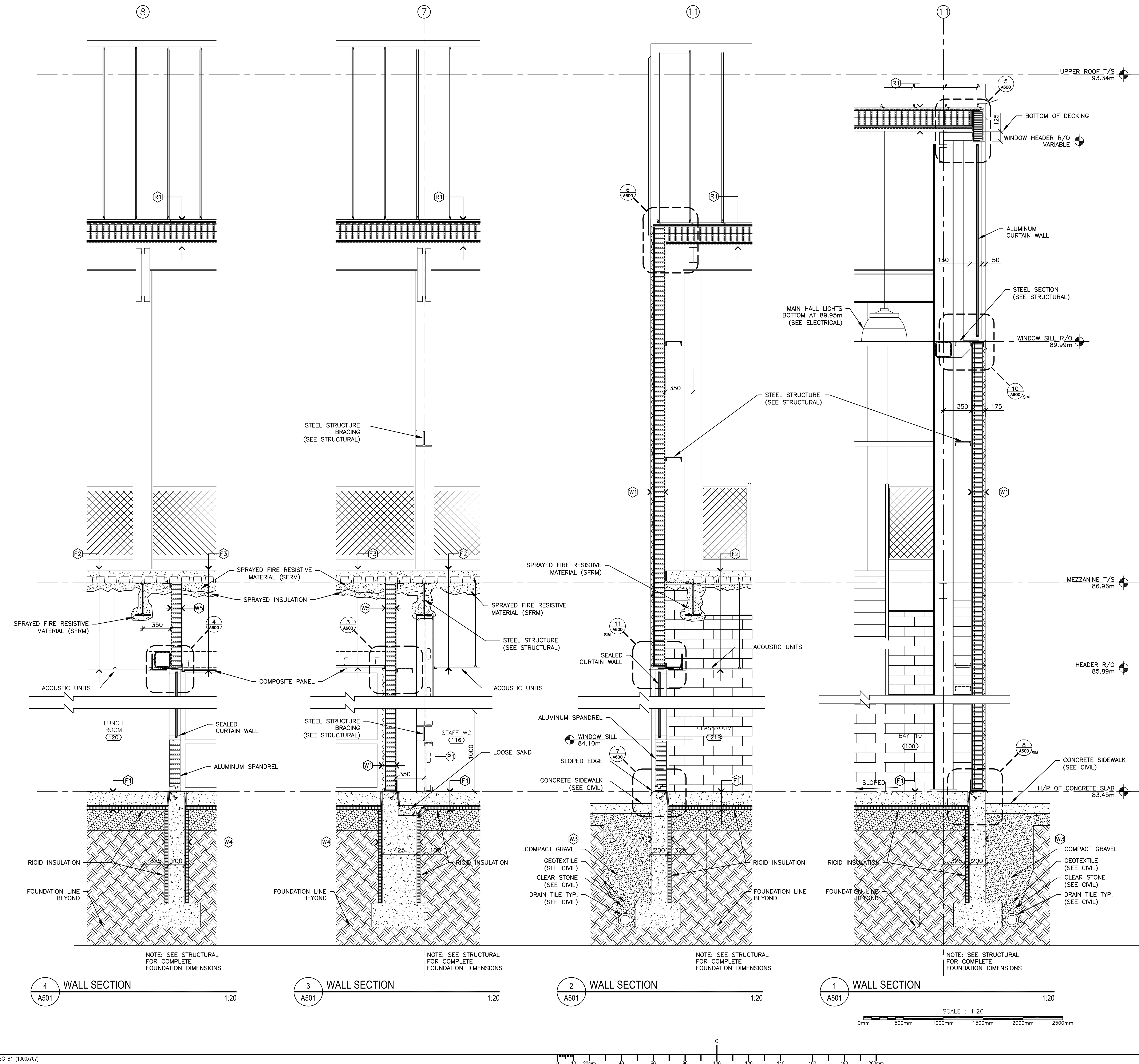

08.07.2014

1403-A500_A501 WallSection-003.dwg