



**RETURN BIDS TO:**

**RETOURNER LES SOUMISSIONS À:**

Bid Receiving Public Works and Government  
Services Canada/Réception des soumissions Travaux  
publics et Services gouvernementaux Canada  
800 Burrard Street, Room 219  
800, rue Burrard, pièce 219  
Vancouver  
British Columbia  
V6Z 0B9  
Bid Fax: (604) 775-9381

**SOLICITATION AMENDMENT  
MODIFICATION DE L'INVITATION**

The referenced document is hereby revised; unless otherwise  
indicated, all other terms and conditions of the Solicitation  
remain the same.

Ce document est par la présente révisé; sauf indication contraire,  
les modalités de l'invitation demeurent les mêmes.

**Comments - Commentaires**

**Vendor/Firm Name and Address**  
Raison sociale et adresse du  
fournisseur/de l'entrepreneur

**Issuing Office - Bureau de distribution**  
Public Works and Government Services Canada - Pacific  
Region  
800 Burrard Street, Room 219  
800, rue Burrard, pièce 219  
Vancouver  
British C  
V6Z 0B9

<b>Title - Sujet</b> Wells PWC-2 and TWC-1 Upgrades	
<b>Solicitation No. - N° de l'invitation</b> F1700-176142/A	<b>Amendment No. - N° modif.</b> 003
<b>Client Reference No. - N° de référence du client</b> F1700-176142	<b>Date</b> 2018-05-24
<b>GETS Reference No. - N° de référence de SEAG</b> PW-\$PWY-025-8345	
<b>File No. - N° de dossier</b> PWY-7-40395 (025)	<b>CCC No./N° CCC - FMS No./N° VME</b>
<b>Solicitation Closes - L'invitation prend fin</b> <b>at - à 02:00 PM</b> <b>on - le 2018-05-30</b>	<b>Time Zone</b> <b>Fuseau horaire</b> Pacific Daylight Saving Time PDT
<b>F.O.B. - F.A.B.</b> <b>Plant-Usine:</b> <input type="checkbox"/> <b>Destination:</b> <input checked="" type="checkbox"/> <b>Other-Autre:</b> <input type="checkbox"/>	
<b>Address Enquiries to: - Adresser toutes questions à:</b> Fung, Donna(PWY)	<b>Buyer Id - Id de l'acheteur</b> pwy025
<b>Telephone No. - N° de téléphone</b> (604) 671-9689 ( )	<b>FAX No. - N° de FAX</b> (604) 775-6633
<b>Destination - of Goods, Services, and Construction:</b> <b>Destination - des biens, services et construction:</b> DFO - Chehalis River Hatchery - Agassiz, BC	

**Instructions: See Herein**

**Instructions: Voir aux présentes**

<b>Delivery Required - Livraison exigée</b>	<b>Delivery Offered - Livraison proposée</b>
<b>Vendor/Firm Name and Address</b> <b>Raison sociale et adresse du fournisseur/de l'entrepreneur</b>	
<b>Telephone No. - N° de téléphone</b> <b>Facsimile No. - N° de télécopieur</b>	
<b>Name and title of person authorized to sign on behalf of Vendor/Firm</b> <b>(type or print)</b> <b>Nom et titre de la personne autorisée à signer au nom du fournisseur/</b> <b>de l'entrepreneur (taper ou écrire en caractères d'imprimerie)</b>	
<b>Signature</b>	<b>Date</b>

**Les documents français seront disponibles sur demande.**

This Amendment 003 is raised to:

- 1) extend the closing date of the solicitation, and
- 2) incorporate Addendum 2.

**Extension of Time**

Wells PWC-2 and TWC-1 Upgrades  
Chehalis River Hatchery, Agassiz, BC

**Solicitation No: F1700-176142/A**

Notice is hereby given that the time for reception of tenders previously due at  
2:00 p.m. on 25 May 2018 is hereby extended to  
2:00 p.m. on 30 May 2018.

Please see the attached Addendum 2.

**ALL OTHER TERMS AND CONDITIONS REMAIN UNCHANGED.**

## **Chehalis River Hatchery – Tender Questions – Addendum 2**

**2018-05-24**

1. Drawing #11-29-340: Shows the piping and works in the close proximity of “existing hydro kiosk”. There are 3 grown trees and existing remains of a tree trunk. These would have a large root mass. The trees and root mass to be removed?
  - The Contractor is responsible for the removal of all trees and root mass that are in the pipe alignment. The Contractor is permitted to leave the trees and root mass on site in a location as directed by the Departmental Representative.
2. Drawing #11-29-340: On the west end of both 300 dia. Ground and 300 dia. Water supply from the well connect onto existing piping. The location of the connection is in the close proximity of existing artesian water stream. How are we to accommodate the water encountered? Do you have any ground/ water/ geotechnical information?
  - It is not an actual artesian stream. There is no additional ground/water/geotechnical information available and the Contractor is responsible for all trench dewatering and pumping of groundwater encountered during excavation.
3. Drawing #11-29-343: Shows the need for a connection into the incubation water reservoir. Will the water be drained to allow for the works?
  - The water will not be drained to allow for the works. Please refer to Question 8 as well.
4. Drawing #11-29-342: Shows a detail for pipe insulation. Can you provide any information to show the limits?
  - Please refer to Questions 6 and 7.
5. Drawing #11-29-342: Shows the extruded curbed being keyed. Due to limits and curvature of the curbing, can we pin the new curb?
  - The Contractor is required to reinstate the existing curb to existing or better condition. The curb may be pin connected.
6. There is a detail on drawing 11-29-342 that shows an “Insulated pipe” detail and notes that any pipe under 1.5m cover to be insulated. On all of the drawings showing the pipework it seems that the cover will be 1 meter. Does all of the pipework under 1.5 meter cover actually need to be insulated or is the insulated pipe detail a mistake?
  - The pipework does not need to be insulated. Please disregard the insulated pipe detail. Please refer to Question 7 as well.

7. There is a detail on drawing 11-29-342 that shows an "Typical Common Trench" detail and notes that the pipework to be DR17 HDPE type pipe. On all of the drawings showing the pipework it indicates that the pipework to be C900 PVC pipe. Please verify what type of pipe is required for this project?
- All pipe work to be PVC C900 pipe. Please disregard the references to DR17 HDPE pipe. Please refer to Question 6 as well.
8. Drawing 11-29-343 shows a butterfly valve as part of the hot tap connection to the Aeration chamber, a Hot Tap cannot be performed through a butterfly valve, can we substitute the butterfly valve with a Resilient Seat gate valve as shown in other details of the drawings?
- Yes, the butterfly valve should be changed to a "Ductile Iron Epoxy Coated Resilient Seat Gate Valve Flange x Flange."
  - The Connection to the reservoir is to be made with a "JCM 6410-000 x 12 Wall Sleeve" (see attached Shop Drawing) supplied by Pacific Flow Control or approved equivalent
9. Drawing #11-29-342 shows a detail for pipe insulation. Can you provide any information to show the limits? The detail for "Insulated Pipe" states that it is for pipe under 1.5m of coverage. That would mean all the piping bases upon information from "Air Valve Chamber", "Well Flush out and self-draining Valve" details on the same drawing and "Well PWC2" detail on drawing #11-29-341. Please confirm as this is not standard in the industry in this area.
- Please refer to Questions 6 and 7 above. The piping does not need to be insulated, please disregard the insulation detail.
10. Drawing #11-29-344: identifies that all the fittings off the pump discharge are to be replaced. There is no specifications on these in the drawings or specifications. Assume all of these are to be stainless?
- Fittings are to be ductile iron.
11. Drawing #11-29-347: shows the Generator.
- a. Understand that this Generator and concrete is by others but our electrician must allow for the wiring up? The specifications can be read that our electrician is responsible for the commissioning, please comment. (Section #019113.13.3.2).
- All work related to the generator is excluded from this scope of work including supply and installation of the generator, concrete foundation, underground conduits, cables, wiring, testing, and commissioning. Contractor to note (as per the contract drawings) the conduits between the generator and the electrical room (including a portion of the well conduits) shall be supplied by others. This is identified in the drawings.

- b. Section #260510.1.1.1/ Section #260510/ covers a broad spectrum and can be read to include Client supplied equipment? Can this be adjusted to be for only Contractor supplied equipment?
  - The Contractor is responsible to assist DFO's engineers in the testing and commissioning of the well systems for PWC-2 and TWC-1 including the DFO supplied equipment. Programming and Configuration of the well control panels and VFD panels shall be by others.
  - c. Section #019113.13.3.5, reads that the Contractor is to ensure that your Engineered system operates as per his design?
  - The Contractor is responsible to install all equipment and materials as directed by the Drawings Package, Specifications Package, Addendums and any other instructions issued by the Departmental Representative.
  - The Contractor is responsible to assist DFO's engineers in the testing and commissioning of the well systems for PWC-2 and TWC-1 including the DFO supplied equipment. Programming and Configuration of the well control panels and VFD panels shall be by others.
- 12. Section #331101, Water mains:
  - a. Pipe and Fittings: Stainless specification for the pump discharge trees?
    - As per Question 10, fittings are to be ductile iron.
  - b. 2.6 Chlorine : Disinfection, is this allowed?
    - The watermains are not to be disinfected with Chlorine, see Question 12.d as well.
  - c. 3.1 Hydrostatic Testing: confirm the specifications?
    - Hydrostatic and Leakage test to be performed in Accordance with Section 33.11.01 – 3.11.
  - d. 3.12 Flushing & Disinfection?
    - No disinfection is to be performed on the watermains. Flushing specifications are to be performed.
- 13. Section #334001, There is a spec for Storm Sewers: Where?
  - For clarification, the 100mm PVC Flush Line is to be installed as per Section 33 11 01 – Watermains and the connection to the existing storm manhole is to be performed as per Section 33 44 01 – Manholes and Catchbasins. The Storm Sewers section is included for reference only.

**End of Addendum 2**

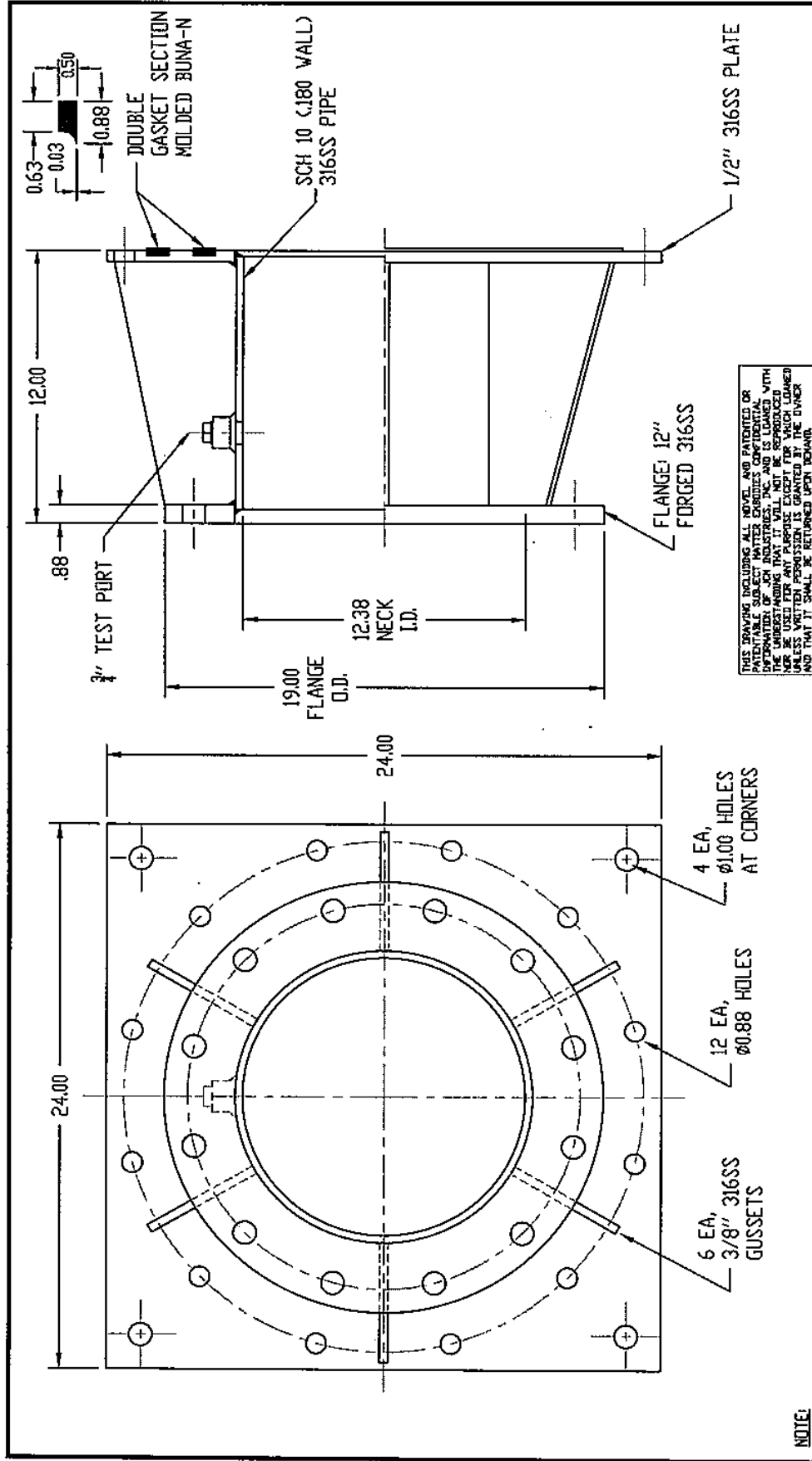

# NOTE:

- 1) ALL WELDS PER APPLICABLE AWSA STANDARDS.
- 2) FINISH: FULLY PASSIVATED 316SS
- 3) NO FASTENERS SUPPLIED
- 4) FULL SIZE CUTTER
- 5) PRESSURE: 150 PSI

**JCM**

JCM INDUSTRIES, INC. NASH, TX  
OFFICE: 409-221-2211  
FAX: 409-221-2212  
WWW.JCMINDUSTRIES.COM

6410-0000 x 12

REV.	DATE	BY	CHKD BY	APP'D BY	NO. SHEETS	SCALE	FIG. NO.	REV.
1	05/26/17	1	1	1	1	1	1	1
2								
3								
4								
5								
6								
7								
8								
9								
10								
11								
12								
13								
14								
15								
16								
17								
18								
19								
20								
21								
22								
23								
24								
25								
26								
27								
28								
29								
30								
31								
32								
33								
34								
35								
36								
37								
38								
39								
40								
41								
42								
43								
44								
45								
46								
47								
48								
49								
50								
51								
52								
53								
54								
55								
56								
57								
58								
59								
60								
61								
62								
63								
64								
65								
66								
67								
68								
69								
70								
71								
72								
73								
74								
75								
76								
77								
78								
79								
80								
81								
82								
83								
84								
85								
86								
87								
88								
89								
90								
91								
92								
93								
94								
95								
96								
97								
98								
99								
100								