



RETURN BIDS TO:

RETOURNER LES SOUMISSIONS À:

Travaux publics et Services gouvernementaux
Canada

Place Bonaventure, portail Sud-Oue

800, rue de La Gauchetière Ouest

7^e étage, suite 7300

Montréal

Québec

H5A 1L6

FAX pour soumissions: (514) 496-3822

REQUEST FOR PROPOSAL

DEMANDE DE PROPOSITION

**Proposal To: Public Works and Government
Services Canada**

We hereby offer to sell to Her Majesty the Queen in right of Canada, in accordance with the terms and conditions set out herein, referred to herein or attached hereto, the goods, services, and construction listed herein and on any attached sheets at the price(s) set out therefor.

**Proposition aux: Travaux Publics et Services
Gouvernementaux Canada**

Nous offrons par la présente de vendre à Sa Majesté la Reine du chef du Canada, aux conditions énoncées ou incluses par référence dans la présente et aux annexes ci-jointes, les biens, services et construction énumérés ici sur toute feuille ci-annexée, au(x) prix indiqué(s).

Comments - Commentaires

Vendor/Firm Name and Address

Raison sociale et adresse du

fournisseur/de l'entrepreneur

Issuing Office - Bureau de distribution

Travaux publics et Services gouvernementaux Canada

Place Bonaventure, portail Sud-Oue

800, rue de La Gauchetière Ouest

7^e étage, suite 7300

Montréal

Québec

H5A 1L6

Title - Sujet Presse-plieuse 200 tonnes	
Solicitation No. - N° de l'invitation W1985-186796/B	Date 2018-06-04
Client Reference No. - N° de référence du client W1985-18-6796	
GETS Reference No. - N° de référence de SEAG PW-\$MTA-309-14904	
File No. - N° de dossier MTA-7-40229 (309)	CCC No./N° CCC - FMS No./N° VME
Solicitation Closes - L'invitation prend fin at - à 02:00 PM on - le 2018-06-29	Time Zone Fuseau horaire Heure Avancée de l'Est HAE
F.O.B. - F.A.B. Plant-Usine: <input type="checkbox"/> Destination: <input checked="" type="checkbox"/> Other-Autre: <input type="checkbox"/>	
Address Enquiries to: - Adresser toutes questions à: Paradis, Mary	Buyer Id - Id de l'acheteur mta309
Telephone No. - N° de téléphone (514) 702-8173 ()	FAX No. - N° de FAX (514) 496-3822
Destination - of Goods, Services, and Construction: Destination - des biens, services et construction: MINISTERE DE LA DEFENSE NATIONALE 202 DÉPÔT D'ATELIER BÂTISSE 10 SUD - FET RÉCEPTION COMMERCIALE 6769, RUE NOTRE-DAME EST MONTRÉAL Québec H1N 2E9 Canada	

Instructions: See Herein

Instructions: Voir aux présentes

Delivery Required - Livraison exigée .	Delivery Offered - Livraison proposée
Vendor/Firm Name and Address Raison sociale et adresse du fournisseur/de l'entrepreneur	
Telephone No. - N° de téléphone Facsimile No. - N° de télécopieur	
Name and title of person authorized to sign on behalf of Vendor/Firm (type or print) Nom et titre de la personne autorisée à signer au nom du fournisseur/ de l'entrepreneur (taper ou écrire en caractères d'imprimerie)	
Signature	Date



Item Article	Description	Dest. Code Dest.	Inv. Code Fact.	Qty Qté	U. of I. U. de D.	Destination	Unit Price/Prix unitaire FOB/FAM	Plant/Usine	Delivery Req. Livraison Req.	Del. Offered Liv. offerte
1	Achat & livraison d'une presse-pli euse 200 tonne (US). Voir détails dans la Demande de la proposition.	W1985	W1985	1	lot	\$	XXXXXXXXXXXX			

TABLE OF CONTENTS

PART 1 - GENERAL INFORMATION	2
1.1 SECURITY REQUIREMENTS	2
1.2 STATEMENT OF REQUIREMENT	3
1.3 DEBRIEFINGS	3
1.4 TRADE AGREEMENTS	3
PART 2 - BIDDER INSTRUCTIONS	3
2.1 STANDARD INSTRUCTIONS, CLAUSES AND CONDITIONS	3
2.2 SUBMISSION OF BIDS	4
2.3 ENQUIRIES - BID SOLICITATION	4
2.4 APPLICABLE LAWS	4
PART 3 - BID PREPARATION INSTRUCTIONS	4
3.1 BID PREPARATION INSTRUCTIONS	4
PART 4 - EVALUATION PROCEDURES AND BASIS OF SELECTION	6
4.1 EVALUATION PROCEDURES	6
4.2 BASIS OF SELECTION	7
PART 5 - CERTIFICATIONS AND ADDITIONAL INFORMATION	7
5.1 CERTIFICATIONS REQUIRED WITH THE BID	8
5.2 CERTIFICATIONS PRECEDENT TO CONTRACT AWARD AND ADDITIONAL INFORMATION	8
PART 6 - RESULTING CONTRACT CLAUSES	8
6.1 SECURITY REQUIREMENTS	8
6.2 STATEMENT OF REQUIREMENT	9
6.3 STANDARD CLAUSES AND CONDITIONS	9
6.4 TERM OF CONTRACT	9
6.5 AUTHORITIES	10
6.6 PAYMENT	11
6.7 INVOICING INSTRUCTIONS	12
6.8 CERTIFICATIONS AND ADDITIONAL INFORMATION	12
6.9 APPLICABLE LAWS	12
6.10 PRIORITY OF DOCUMENTS	12
6.11 SACC MANUAL CLAUSES	12
ANNEX "A"	14
STATEMENT OF REQUIREMENT	14
ANNEX "B"	20
BASIS OF PAYMENT	20
ANNEX "C"	21
MANDATORY AND TECHNICAL EVALUATION CRITERIA	21
ANNEX " D " SECURITY REQUIREMENT CHECK LIST	25

REISSUE OF BID SOLICITATION

THIS BID SOLICITATION CANCELS AND SUPERSEDES PREVIOUS BID SOLICITATION NUMBER W1985-186796/A DATED 2018-01-10 WITH A CLOSING OF 2018-02-21 AT 14H00. A DEBRIEFING OR FEEDBACK SESSION WILL BE PROVIDED UPON REQUEST TO BIDDERS SUPPLIERS WHO BID ON THE PREVIOUS SOLICITATION.

PART 1 - GENERAL INFORMATION

1.1 Security Requirements

1.1.1 Security requirements

There are security requirements for this purchase.

1. Before award of a contract, the following conditions must be met:
 - (a) the Bidder must hold a valid organization security clearance as indicated in Part 6 - Resulting Contract Clauses;
 - (b) the Bidder's proposed individuals requiring access to classified or protected information, assets or sensitive work sites must meet the security requirements as indicated in Part 6 - Resulting Contract Clauses;
 - (c) the Bidder must provide the name of all individuals who will require access to classified or protected information, assets or sensitive work sites;
2. Bidders are reminded to obtain the required security clearance promptly. Any delay in the award of a contract to allow the successful Bidder to obtain the required clearance will be at the entire discretion of the Contracting Authority.
3. For additional information on security requirements, Bidders should refer to the [Contract Security Program](http://www.tpsgc-pwgsc.gc.ca/esc-src/introduction-eng.html) of Public Works and Government Services Canada (<http://www.tpsgc-pwgsc.gc.ca/esc-src/introduction-eng.html>) website.

Request for permission to visit for employees

Immediately following the award of the contract, the supplier will be obliged to obtain, without delay, visit clearance from ISS for each of its employees assigned to the contract.

A minimum lead time of 25 working days is required to obtain a visit clearance from ISS.

Without permits to visit, the supplier's employees will not have access to 202 Workshop, leaving the supplier liable for delays in delivery.

The form to Request permission to the facility at DND is available at the following link:

<http://www.tpsgc-pwgsc.gc.ca/esc-src/protection-safeguarding/visite-visit-eng.html#s4>

<http://www.tpsgc-pwgsc.gc.ca/esc-src/formulaires-forms/visite-visits-eng.html>

Once completed, please send it to our Industrial security department at the following address:

SSIVisites-.ISSVisits@tpsgc-pwgsc.gc.ca.

1.2 Statement of Requirement

Requirement - Bid

The requirement is detailed under Annex A – Statement of requirement.

1.3 Debriefings

Bidders may request a debriefing on the results of the bid solicitation process. Bidders should make the request to the Contracting Authority within 15 working days from receipt of the results of the bid solicitation process. The debriefing may be in writing, by telephone or in person.

1.4 Trade Agreements

"The requirement is subject to the provisions of the World Trade Organization Agreement on Government Procurement (WTO-AGP), Canada-European Union Comprehensive Economic and Trade Agreement (CETA), North American Free Trade Agreement (NAFTA), and the Canadian Free Trade Agreement (CFTA)."

PART 2 - BIDDER INSTRUCTIONS

2.1 Standard Instructions, Clauses and Conditions

All instructions, clauses and conditions identified in the bid solicitation by number, date and title are set out in the Standard Acquisition Clauses and Conditions Manual (<https://buyandsell.gc.ca/policy-and-guidelines/standard-acquisition-clauses-and-conditions-manual>) issued by Public Works and Government Services Canada.

Bidders who submit a bid agree to be bound by the instructions, clauses and conditions of the bid solicitation and accept the clauses and conditions of the resulting contract.

The 2003 (2017-04-27) Standard Instructions - Goods or Services - Competitive Requirements, are incorporated by reference into and form part of the bid solicitation.

Subsection 5.4 of 2003, Standard Instructions - Goods or Services - Competitive Requirements, is amended as follows:

Delete: 60 days
Insert: 120 days

2.1.1 SACC Manual Clauses

B1000T 2014-06-26 Condition of material – Bid

2.2 Submission of Bids

Bids must be submitted only to Public Works and Government Services Canada (PWGSC) Bid Receiving Unit by the date, time and place indicated on page 1 of the bid solicitation.

2.2.1 Improvement of Requirement During Solicitation Period

Should bidders consider that the specifications or Statement of Work contained in the bid solicitation could be improved technically or technologically, bidders are invited to make suggestions, in writing, to the Contracting Authority named in the bid solicitation. Bidders must clearly outline the suggested improvement as well as the reason for the suggestion. Suggestions that do not restrict the level of competition nor favour a particular bidder will be given consideration provided they are submitted to the Contracting Authority **at least 15 days** before the bid closing date. Canada will have the right to accept or reject any or all suggestions.

2.3 Enquiries - Bid Solicitation

All enquiries must be submitted in writing to the Contracting Authority no later than **7 calendar days** before the bid closing date. Enquiries received after that time may not be answered. Bidders should reference as accurately as possible the numbered item of the bid solicitation to which the enquiry relates. Care should be taken by Bidders to explain each question in sufficient detail in order to enable Canada to provide an accurate answer. Technical enquiries that are of a proprietary nature must be clearly marked "proprietary" at each relevant item. Items identified as "proprietary" will be treated as such except where Canada determines that the enquiry is not of a proprietary nature. Canada may edit the question(s) or may request that the Bidder do so, so that the proprietary nature of the question(s) is eliminated, and the enquiry can be answered to all Bidders. Enquiries not submitted in a form that can be distributed to all Bidders may not be answered by Canada.

2.4 Applicable Laws

Any resulting contract must be interpreted and governed, and the relations between the parties determined, by the laws in force in the **Province of Quebec**.

Bidders may, at their discretion, substitute the applicable laws of a Canadian province or territory of their choice without affecting the validity of their bid, by deleting the name of the Canadian province or territory specified and inserting the name of the Canadian province or territory of their choice. If no change is made, it acknowledges that the applicable laws specified are acceptable to the Bidders.

PART 3 - BID PREPARATION INSTRUCTIONS

3.1 Bid Preparation Instructions

Due to the nature of the bid solicitation, bids transmitted by epost Connect service will not be accepted.

Canada requests that bidders provide their bid in separately bound sections as follows:

- Section I: Technical Bid (2 hard copies)
- Section II: Financial Bid (1 hard copy)
- Section III: Certifications (1 hard copy)

If there is a discrepancy between the wording of the soft copy on electronic media and the hard copy, the wording of the hard copy will have priority over the wording of the soft copy.

Prices must appear in the financial bid only. No prices must be indicated in any other section of the bid.

Canada requests that bidders follow the format instructions described below in the preparation of hard copy of their bid:

- (a) use 8.5 x 11 inch (216 mm x 279 mm) paper;
- (b) use a numbering system that corresponds to the bid solicitation.

In April 2006, Canada issued a policy directing federal departments and agencies to take the necessary steps to incorporate environmental considerations into the procurement process [Policy on Green Procurement](https://www.tbs-sct.gc.ca/pol/doc-eng.aspx?id=32573) (<https://www.tbs-sct.gc.ca/pol/doc-eng.aspx?id=32573>). To assist Canada in reaching its objectives, bidders should:

- 1) use 8.5 x 11 inch (216 mm x 279 mm) paper containing fibre certified as originating from a sustainably-managed forest and containing minimum 30% recycled content; and
- 2) use an environmentally-preferable format including black and white printing instead of colour printing, printing double sided/duplex, using staples or clips instead of cerlox, duotangs or binders.

Section I: Technical Bid

In their technical bid, Bidders should explain and demonstrate how they propose to meet the requirements and how they will carry out the Work.

Section II: Financial Bid

Bidders must submit their financial bid in accordance with the Basis of Payment – Annex B.

3.1.1 Electronic Payment of Invoices – Bid

If you are willing to accept payment of invoices by Electronic Payment Instruments, complete the section below Electronic Payment Instruments, to identify which ones are accepted.

If the information below is not completed, it will be considered as if Electronic Payment Instruments are not being accepted for payment of invoices.

Acceptance of Electronic Payment Instruments will not be considered as an evaluation criterion.

ELECTRONIC PAYMENT INSTRUMENTS

The Bidder must identify which electronic payment instruments they are willing to accept for payment of invoices.

The Bidder accepts any of the following Electronic Payment Instrument(s):

- () VISA Acquisition Card;
- () MasterCard Acquisition Card;

- () Direct Deposit (Domestic and International);
- () Electronic Data Interchange (EDI);
- () Wire Transfer (International Only);
- () Large Value Transfer System (LVTS) (Over \$25M)

3.1.2 Exchange Rate Fluctuation

SACC Manual Clause C3011T 2013-11-06 Exchange Rate Fluctuation

Section III: Certifications

Bidders must submit the certifications and additional information required under Part 5.

PART 4 - EVALUATION PROCEDURES AND BASIS OF SELECTION

4.1 Evaluation Procedures

- (a) Bids will be assessed in accordance with the entire requirement of the bid solicitation including the technical and financial evaluation criteria.
- (b) An evaluation team composed of representatives of Canada will evaluate the bids.

4.1.1 Technical Evaluation

4.1.1.1 Mandatory Technical Criteria

- a. Bidder must be able to perform the full scope of the work described in Annex A-Statement of requirement.
- b. Conformity to the preselected mandatory technical criteria which are included in Annex 'C' – Mandatory and technical evaluation criteria.
- c. Acceptance of terms and conditions as mentioned in the bid solicitation.

4.1.1.2 Evaluation method for the mandatory technical criteria

- a. At the bid closing date, bids will be evaluated on the preselected mandatory technical criteria at Annex 'C'.

Note: The evaluation of all the criteria at Annex 'C' will be done on a pass /fail basis.

- b. To demonstrate that your products meet all preselected specifications at Annex C, bidders must submit with their bid, a copy of complete specifications and descriptive literature (technical documents such as data sheets, user manual or other) of the products offered.
- c. Canada will evaluate only the documentation provided with a bidder's bid.
- d. Canada will not evaluate information such as references to Website addresses where additional information can be found. Neither will it evaluate instruction manuals or technical manuals or brochures or other, not submitted with the bid.

Note 1:

To be considered, all these criterias have to be respected in order to facilitate evaluation of the next steps.

IN THE ABSENCE OF THIS INFORMATION, THE PROPOSAL WILL BE REJECTED.

Note 2:

Only those proposals that meet all the mandatory technical criteria in the table at Annexe C will be subject to further evaluation, which is the financial evaluation.

4.1.2 Financial Evaluation

4.1.2.1. Mandatory financial criteria

- a. Compliance with the methods for setting the proposed prices;
- b. Firm prices must be provided for all items listed on Annex 'B' – Basis of payment.

PROPOSALS THAT DO NOT MEET THESE REQUIREMENTS WILL BE REJECTED.

SACC Manual Clause [A0220T](#) 2014-05-26, Evaluation of Price – Bid

SACC Manual Clause [A0222T](#) 2014-06-26 Evaluation of Price – Canadian /Foreign bidders

4.1.3 Price evaluation

The prices at Annex 'B' – Basis of payment will be evaluated as follows:

Firm unit price x quantity of each item = Total price of each item.

Applies for items 1 to 4.

Total firm price of all items (1 to 4) = the total price of the contract (All applicable taxes are extra)

4.2 Basis of Selection

Basis of Selection - Mandatory Technical Criteria

A bid must comply with the requirements of the bid solicitation and meet all mandatory technical evaluation criteria to be declared responsive. The responsive bid with the lowest evaluated price will be recommended for award of a contract.

PART 5 – CERTIFICATIONS AND ADDITIONAL INFORMATION

Bidders must provide the required certifications and additional information to be awarded a contract.

The certifications provided by Bidders to Canada are subject to verification by Canada at all times. Unless specified otherwise, Canada will declare a bid non-responsive, or will declare a contractor in default if any certification made by the Bidder is found to be untrue whether made knowingly or unknowingly, during the bid evaluation period or during the contract period.

The Contracting Authority will have the right to ask for additional information to verify the Bidder's certifications. Failure to comply and to cooperate with any request or requirement imposed by the Contracting Authority will render the bid non-responsive or constitute a default under the Contract.

5.1 Certifications Required with the Bid

Bidders must submit the following duly completed certifications as part of their bid.

5.1.1 Integrity Provisions - Declaration of Convicted Offences

In accordance with the Integrity Provisions of the Standard Instructions, all bidders must provide with their bid, **if applicable**, the declaration form available on the [Forms for the Integrity Regime](http://www.tpsgc-pwgsc.gc.ca/ci-if/declaration-eng.html) website (<http://www.tpsgc-pwgsc.gc.ca/ci-if/declaration-eng.html>), to be given further consideration in the procurement process.

5.2 Certifications Precedent to Contract Award and Additional Information

The certifications and additional information listed below should be submitted with the bid, but may be submitted afterwards. If any of these required certifications or additional information is not completed and submitted as requested, the Contracting Authority will inform the Bidder of a time frame within which to provide the information. Failure to provide the certifications or the additional information listed below within the time frame provided will render the bid non-responsive.

5.2.1 Integrity Provisions – Required Documentation

In accordance with the section titled Information to be provided when bidding, contracting or entering into a real procurement agreement of the [Ineligibility and Suspension Policy](http://www.tpsgc-pwgsc.gc.ca/ci-if/politique-policy-eng.html) (<http://www.tpsgc-pwgsc.gc.ca/ci-if/politique-policy-eng.html>), the Bidder must provide the required documentation, as applicable, to be given further consideration in the procurement process.

5.2.2 Federal Contractors Program for Employment Equity - Bid Certification

By submitting a bid, the Bidder certifies that the Bidder, and any of the Bidder's members if the Bidder is a Joint Venture, is not named on the Federal Contractors Program (FCP) for employment equity "FCP Limited Eligibility to Bid" list available at the bottom of the page of the [Employment and Social Development Canada \(ESDC\) - Labour's](https://www.canada.ca/en/employment-social-development/programs/employment-equity/federal-contractor-program.html#) website (<https://www.canada.ca/en/employment-social-development/programs/employment-equity/federal-contractor-program.html#>).

Canada will have the right to declare a bid non-responsive if the Bidder, or any member of the Bidder if the Bidder is a Joint Venture, appears on the "FCP Limited Eligibility to Bid" list at the time of contract award.

PART 6 - RESULTING CONTRACT CLAUSES

The following clauses and conditions apply to and form part of any contract resulting from the bid solicitation.

6.1 Security Requirements

There are security requirements for this purchase.

6.1.1. The following security requirements (SRCL and related clauses provided by the Contract Security program) apply and form part of the Contract.

1. The Contractor/Offeror must, at all times during the performance of the Contract/Standing Offer, hold a valid Designated Organization Screening (DOS), issued by the Canadian Industrial Security Directorate (CISD), Public Works and Government Services Canada (PWGSC).
2. The Contractor/Offeror personnel requiring access to sensitive work site(s) must EACH hold a valid RELIABILITY STATUS, granted or approved by CISD/PWGSC.
3. Subcontracts which contain security requirements are NOT to be awarded without the prior written permission of CISD/PWGSC.
4. The Contractor/Offeror must comply with the provisions of the:
 - a. Security Requirements Check List and security guide (if applicable), attached at Annex D ;
 - b. Industrial Security Manual (Latest Edition).

6.2 Statement of Requirement

Requirement – Contract

The Contractor must provide the items detailed under the "Statement of Requirement" at Annex "A".

6.3 Standard Clauses and Conditions

All clauses and conditions identified in the Contract by number, date and title are set out in the [Standard Acquisition Clauses and Conditions Manual](https://buyandsell.gc.ca/policy-and-guidelines/standard-acquisition-clauses-and-conditions-manual) (https://buyandsell.gc.ca/policy-and-guidelines/standard-acquisition-clauses-and-conditions-manual) issued by Public Works and Government Services Canada.

6.3.1 General Conditions

[2010A](#) (2016-04-04), General Conditions - Goods (Medium Complexity), apply to and form part of the Contract.

6.4 Term of Contract

6.4.1 Delivery Date

All the deliverables must be received **within 4 months, if at all possible.**

6.4.2 Delivery Points

Delivery of the requirement will be made to delivery point(s) specified at Annex "A" of the Contract.

6.5 Authorities

6.5.1 Contracting Authority

The Contracting Authority for the Contract is:

Name: MARY PARADIS
Title: Acting, Supply specialist
Public Services and Procurement Canada
Acquisitions Branch
Directorate: Québec region
Address: 800 rue de la Gauchetière, ouest
Place Bonaventure
South West Portal
7th Floor, Suite 7300
Montreal, Québec

Telephone: 514-702-8173
Facsimile: 514-496-3822
E-mail address: mary.paradis@pwgsc.gc.ca

The Contracting Authority is responsible for the management of the Contract and any changes to the Contract must be authorized in writing by the Contracting Authority. The Contractor must not perform work in excess of or outside the scope of the Contract based on verbal or written requests or instructions from anybody other than the Contracting Authority.

6.5.2 Technical Authority

The Technical Authority for the Contract is: *(Will be announced at the contract phase)*

Name: _____
Title: _____
Organization: _____
Telephone: ____ - ____ - _____
Facsimile: ____ - ____ - _____
E-mail: _____

The Technical Authority named above is the representative of the department or agency for whom the Work is being carried out under the Contract and is responsible for all matters concerning the technical content of the Work under the Contract. Technical matters may be discussed with the Technical Authority, however the Technical Authority has no authority to authorize changes to the scope of the Work. Changes to the scope of the Work can only be made through a contract amendment issued by the Contracting Authority.

6.5.3 Contractor's Representative

Name: _____
Title: _____
Organization: _____
Address: _____
Telephone: _____
Facsimile: _____
E-mail address: _____

6.5.4 Contact at customer department:

For all information related to invoicing and /or payments you may communicate with:
(To be completed by Canada at the award phase of the contract)

Customer department: _____
Name: _____
Telephone: _____
Facsimile: _____
E-mail address: _____

6.6 Payment

6.6.1 Basis of Payment

Basis of Payment - Firm Price, Firm Unit Price(s) or Firm Lot Price(s)

In consideration of the Contractor satisfactorily completing all of its obligations under the Contract, the Contractor will be paid a firm unit price, as specified in Annex B for a cost of \$ _____ (The amount will be inserted at contract award). Customs duties are included and Applicable Taxes are extra.

Canada will not pay the Contractor for any design changes, modifications or interpretations of the Work, unless they have been approved, in writing, by the Contracting Authority before their incorporation into the Work.

6.6.2 Limitation of Price

SACC Manual clause C6000C (2011-05-16), Limitation of Price

6.6.3 SACC Manual Clauses

H1000C (2008-05-12) Single Payment

6.6.4 SACC Manual Clauses

C2000C 2007-11-30 Taxes –foreign-based Contractor

C2605C 2008-05-12 Canadian Customs Duties and Sales Tax – foreign-based contractor

6.6.5 Electronic Payment of Invoices – Contract

The Contractor accepts to be paid using any of the following Electronic Payment Instrument(s):

- a. ☐ Visa Acquisition Card;
- b. ☐ MasterCard Acquisition Card;
- c. ☐ Direct Deposit (Domestic and International);
- d. ☐ Electronic Data Interchange (EDI);
- e. ☐ Wire Transfer (International Only);
- f. ☐ Large Value Transfer System (LVTS) (Over \$25M)

6.7 Invoicing Instructions

1. The Contractor must submit invoices in accordance with the section entitled "Invoice Submission" of the general conditions. Invoices cannot be submitted until all work identified in the invoice is completed.
2. Invoices must be distributed as follows:
 - a. The original and one (1) copy must be forwarded to the address shown on page 1 of the Contract for certification and payment.

6.8 Certifications and Additional Information

6.8.1 Compliance

Unless specified otherwise, the continuous compliance with the certifications provided by the Contractor in its bid or precedent to contract award, and the ongoing cooperation in providing additional information are conditions of the Contract and failure to comply will constitute the Contractor in default. Certifications are subject to verification by Canada during the entire period of the Contract.

6.9 Applicable Laws

The Contract must be interpreted and governed, and the relations between the parties determined, by the laws in force in the _____ (*The name of the province or territory as specified by the Bidder in its bid, if applicable will be inserted here*).

6.10 Priority of Documents

If there is a discrepancy between the wording of any documents that appear on the list, the wording of the document that first appears on the list has priority over the wording of any document that subsequently appears on the list.

- (a) the Articles of Agreement;
- (b) the general conditions 2010A (2016-04-04);
- (c) Annex A, Statement of Requirement;
- (d) Annex B, Basis of payment;
- (e) Annex D, Security requirement check list;
- (f) the Contractor's bid dated _____, as clarified on _____ **or** as amended on _____.

6.11 SACC Manual Clauses

B7500C	2006-06-16	Excess goods
G1005C	2016-01-28	Insurance – No specific requirement
B1501C	2006-06-16	Electrical equipment
A9068C	2010-01-11	Government site regulation
A2000C	2006-06-16	Foreign Nationals (Canadian Contractor)
A2001C	2006-06-16	Foreign Nationals (Foreign Contractor)

6.12 Transport costs

The contractor must ship the goods prepaid via _____ (*insert the method of transportation*) including all delivery charges to (*The Department of National Defence, 6769 Notre Dame East, Building no. 10, Montreal, P.Q.*) . Prepaid Transportation costs must be shown as a separate item on the invoice, supported by a certified copy of the prepaid transportation bill of lading.

6.13 Shipping Instructions

Shipping Instructions – Delivery at destination

Goods must be consigned to the destination specified in the Contract and delivered:
Delivered Duty Paid (DDP) to (*The Department of National Defence, 6769 Notre Dame East, Building no. 10, Montreal, P.Q.*).
Incoterms 2000 for shipments from a commercial contractor.

ANNEX "A"

STATEMENT OF REQUIREMENT

Purchase and delivery of a Press brake of 200 tons (US)

1.0 SCOPE

1.1 OBJECTIVE

The 202 Workshop Depot wishes to acquire a hydraulic 200-ton press brake, to be used for forming and bending metal plates and sheets for the repair and modification of vehicles. This document states the technical specifications to be respected for the purchase of a high-precision hydraulic press brake.

2.0 BACKGROUND

The 202 Workshop Depot (202WD) is a Canadian Armed Forces repair unit that offers maintenance services. The unit's mandate is to ensure the repair and reconditioning of all Canadian Armed Forces (CAF) ground equipment as well as other equipment.

3.0 REQUIREMENT

Technical specifications

The press brake must meet following mandatory technical specifications:

Item no.	Description
	Mandatory technical specifications
3.1	The high-precision press brake must not be a prototype or an existing model requiring major modifications to comply with the requirements. The equipment must meet all the criteria during the proposal, and must use technology previously proven by the manufacturer. The names of two different companies in North America using a press brake of 200 US tons or more must be supplied to prove that equipment equivalent to that specified in the proposal are in use.
3.2	The press brake must have a minimum capacity of 200 US tons.
3.3	The press brake must be compatible with a power supply of 575 V, three phase at 60 Hz (connection to the infrastructure). If the press brake requires a different electrical power supply, a transformer must be supplied to be able to connect the press brake to the infrastructure.
3.4	The press brake must comply with the following standards: <ul style="list-style-type: none">- ANSI B11.3-2012 Safety Requirements for Power Press Brakes;- CSA Z142-10 (C2014) - Code for power press operation: Health, safety, and protection requirements.- CSA Z432-04 (R2014) – Protection of Machinery.- The transformer and electrical components must be certified by CSA.- The laser(s) installed on the press brake as well as their use must comply with these standards: ANSI Z136.1 – 2014 American Standard for Safe Use of Lasers and ANSI Z136.9 – 2013 American National Standard for Safe Use of Lasers in Manufacturing Environments.

3.5	The press brake and its components must have the following dimensions: - Width: maximum of 12 feet (<i>required to accommodate the work space that is available</i>) - Depth: maximum of 6 feet - Height: maximum of 11 feet
3.6	The press brake must have a frame, housings (or uprights), a table, and a bolted ram to be able to replace the parts, or adjust the assembly.
3.7	The distance between the housings must be a minimum of 100 in. (2540 mm) to easily accommodate the use of 96 in. (2413 mm) of sheet metal. The bench length must be at least 120 in. (3048 mm). The throat must be a minimum of 19.6 in. (500 mm).
3.8	The table of the press brake must be able to accommodate a die along its total length.
3.9	The press brake must have a minimum three-point vertically guided ram and the two main cylinders must be able to move independently.
3.10	The throat opening must be a minimum of 450 mm (17.7 in.) and a minimum ram stroke length of 300 mm (11.8 in.).
3.11	The press brake must have cylinders whose rod and pistons are forged and tempered.
3.12	The Supplier must ensure that the dimensions offered allow the bending of boxes (pan shaped) 10 in. (254 mm) high (variable thickness), taking into consideration the space already occupied by the anchoring system of the punch and the dies. Point 3.12 takes precedence over Point 3.11; if the dimensions proposed in Point 3.11 are insufficient, the Supplier must adapt the dimensions to respond to Point 3.12.
3.13	The press brake must be equipped with a dynamic, hydraulic bending compensation CNC (Crowning) numerical control system. The press must be able to compensate both in real time and automatically for the deflections of the punch and die.
3.14	The press brake must be equipped with a system guaranteeing the parallelism of the frame. Linear guides with an accuracy of at least 0.0005 in. (0.0127 mm) must compensate for the bending of the frame.
3.15	The press brake must be equipped with a quick, tool-free clamping system for the punches. The punches must be able to be inserted both vertically and laterally. A nominal space of 2 in. must be present between the clamping jaws of the punches. The jaws must also move laterally (a minimum lateral movement of 1 in. is required). The clamping system must be, at a minimum, compatible with American punches and <i>Wilson Tools</i> with and without notches. The clamping system must allow the use of gooseneck punches on both sides. The clamping system must not be pneumatic or hydraulic. We are looking for a manual clamping system. The Supplier must be able to provide a European clamping system in the event that 202 Workshop wishes to acquire this type of tool. Please note that we need a system of tightening which takes American and <i>Wilson tools</i> and which can also accommodate 'gooseneck punch'.
3.16	If present, the hydraulic system(s) must be equipped with a filter with a fineness of 3 microns.

3.17	The press brake must be equipped with two support arms at the front of the press. The support arms must be able to move along the linear guides. The support arms must be able to be placed at the end of the press brake so as to not interfere with the operator during operations which do not require support arms. The support arms must be graduated in millimeters.
3.18	The press brake must be equipped with a lighting system at the front and the rear of the press brake.
3.19	<p>The press brake must be equipped with a movable rear stop over six axes (the axes include the movement of the fingers).</p> <p>(Clarification is provided for this statement: It means that since the two fingers mounted on the rear stop must move independently, each finger would move left, right, forward, and backwards individually, so making up the first 4 axes, which is x1, x2, y1, y2 . Considering that the two fingers are mounted on the rear stop which needs to be able to move forward backward, and up and down, the rear stop will have an over X and Z, therefore six axes).</p> <p>The stop must be equipped with two independently movable fingers. The travel on the stop on the X-axis must be a minimum of 1.2 m. The fingers must be able to position themselves automatically via the control console according to the distance required by the bending plan. Manual adjustment with micrometric precision of the stop by the operators must be possible using the control console. A system (mechanical or software) must prevent accidental collisions between the fingers and the die and/or the table. Note: the standard run is 800mm, but with the 3rd support, it is possible to lean on a distance of 1.2m and this is acceptable for this requirement.</p>
3.20	The press brake must be equipped with an integrated control console, equipped with an LCD touch screen.
3.21	The press brake's computer must permit importing .DXF, .STP or .IPT file formats. The computer must allow the operator to correct bending parameters. The computer must be compatible with all press brake correction systems (bending compensation, parallelism, etc.) as well as with all control devices (adjustable stops, hydraulic tightening, etc.). A comptroller which allows to display in 3D or in 2D is acceptable.
3.22	The repositioning accuracy of the stops and the ram must be at least 0.005 in. (repeatability).

Source of Electricity

Manuals and Technical Documents

The supplier agrees provide, within two weeks of being awarded the contract, all of the technical documentation for all infrastructure resources necessary for the operation and installation of the equipment. These technical documents must state the types of supply resources necessary, as well as the values in metric or imperial units. The required specifications are:

- The current and supply voltage;
- The specific floor specifications for the area where the press brake is to be installed;
- A construction plan indicating all required dimensions for the installation of the supporting floor.

The Supplier must provide the Technical Authority with the following manuals:

- Operator Manual;
- Parts Manual;
- Maintenance manuals.

The manual must be in French and/or in English. As a minimum, two paper copies and one electronic copy in PDF format must be supplied for each document.

The supplier must provide an installation plan for the equipment and all of its components, based on the layout plan provided by the 202 Workshop Depot, in DWG version format (compatible with AutoCAD format, 2014 version or more recent). The installation plan must meet the following specifications:

- The diagram for the press brake according to the actual dimensions of all of its components;
- The entire press brake unit must be contained and represented on the plan;
- The plan must include as a minimum the overall dimensions of the press brake and its components.

Minimal Guarantee

Supply a full warranty on the press brake parts and workmanship for three years. The warranty period begins when the press brake has been correctly installed and is fully functional.

Deliverable and Installation

The quote must include the complete installation including: the installation and calibration of the machine, the start-up of the machine, a demonstration of the functionalities of the machine as well as the training.

Provide a specialized technician on site to perform the installation and complete the system start-up after installation.

A 'sketch' is being provided to demonstrate the dimensions of the doors and corridors (see at the end of this annex). This information will be useful to suppliers as it will enable them to estimate the right equipment required to fulfill this contract.

Training and After Sale Service

Operator Training: The submitted quote must include a training of the operators comprised of a minimum of three (3) days of on-site training, broken into security, the introduction of the machine, the usage of the machine, the operation of the digital control console, the operation of the tool restraint system, the operation of the bending system, and the preventive maintenance operations. This minimum ensures that the training adequately cover the material.

Preventive and Corrective Maintenance Training: The submitted quote must include a training provided on the preventive and corrective maintenance of the equipment.

The training must also include at least four (4) hours where the operators can test the control console and bend parts to their satisfaction in order to assess the capacities of the press brake, and to apply the elements presented during training. All documentation used during the training (videos, PowerPoint presentations, etc.) must be given to the Technical Authority in electronic format.

Responsibilities of the Department of National Defence

The installation of any plumbing and electrical connections required for the press brake will be assumed by the 202 Workshop.

4.0 SAFETY

- 4.1 The press brake must be equipped with a laser beam safety device for the bending die (Active Opto-electronic Protective Device (AOPD)). The device must allow the operator to use the press brake when his hands are close to the die. The device must be placed near

the punch, so that it can be used with different sheet metal thicknesses without adjustment. If required, various modes can be used for different specific applications. For example, a box mode may allow the laser device to be deactivated when the punch is within 6 mm of the metal sheet.

- 4.2 The press brake must be operated with a foot pedal so that the operator can hold the metal sheets during bending. The pedal must be a maintained-action control type. The press must be stopped automatically if the pedal is released or depressed to the maximum (dead man's switch).

5.0 DELIVERABLE PRODUCTS

Below are deliverable products and their associated timeline

Deliverable Products	Timeline
Start-up Meeting	1 week after the contract is awarded
Delivery of the manual and technical documents	2 weeks prior to the delivery of the equipment
Delivery of the hydraulic Press Brake of 200 tons (US)	At the latest within four months, if possible
Training for the operators as well as the persons in charge of the preventive and corrective maintenance	2 weeks after the delivery of the equipment

The payment will be processed once a receipt has been provided and after receiving all the deliverables mentioned above.

6.0 CONSTRAINTS

The Supplier must take into account the following:

- 6.1 Before any visit to the garrison, the Supplier must inform the Technical Authority at least 48 hours in advance with the names of those who will be present in order to obtain the necessary authorization.
- 6.2 The Supplier must provide the required equipment to move the equipment on the garrison grounds.
- 6.3 The Supplier must bring all materials and tools necessary for the start-up of the equipment to the installation area.

SKETCH

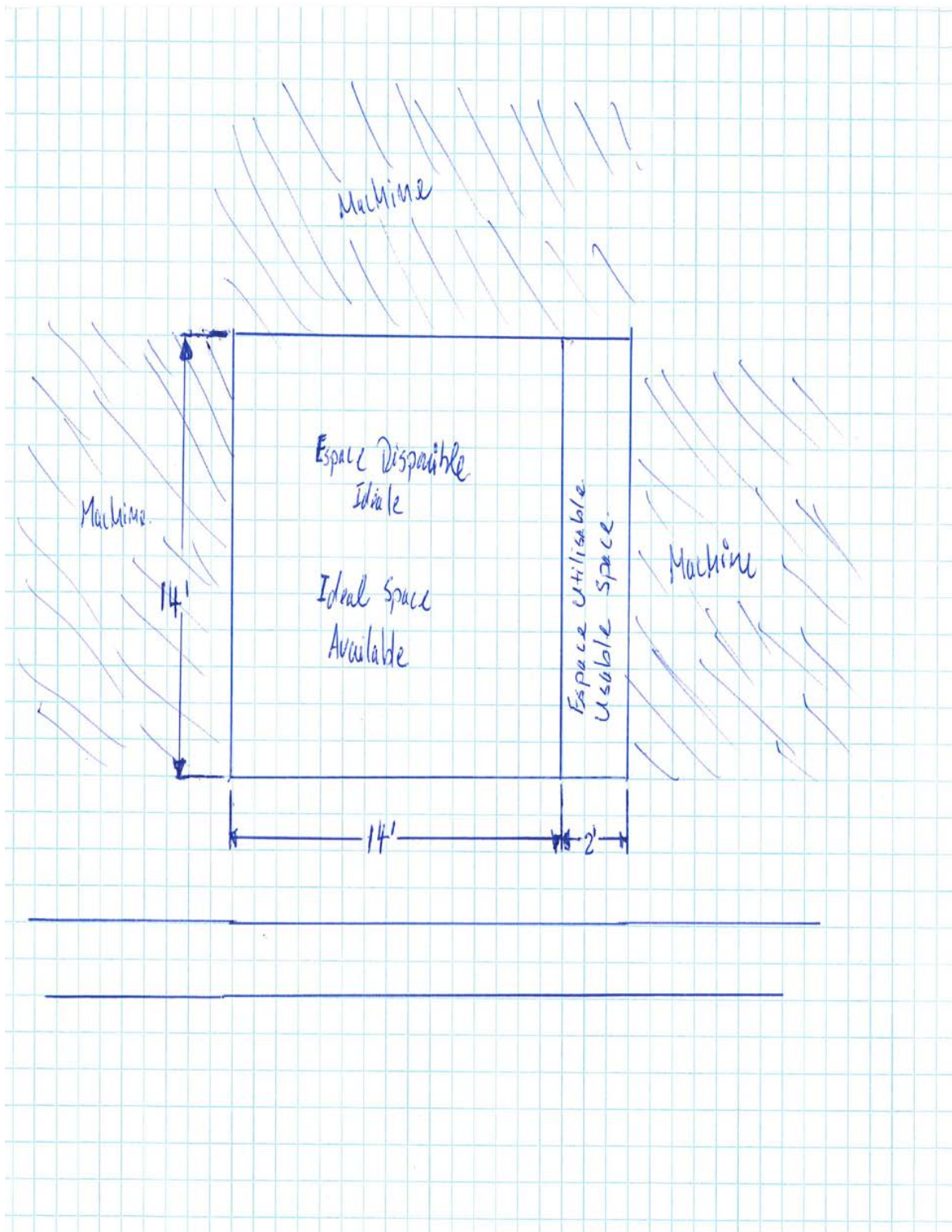

ANNEX "B"
BASIS OF PAYMENT

Notes to suppliers:

1. The purchase and delivery of a Press Brake of 200 US tons. For full description details consult Annex 'A' - Statement of Requirement).
2. Firm prices are required for all items in the table below.
3. The applicable taxes are all extra to the prices on the table below.

ITEM No.	QUANTITY	DESCRIPTION	FIRM PRICE	TOTAL
1	1	A press brake of 200 US tons. (See Annex A – Statement of requirement for further details)	\$ _____/each	\$ _____
2	1	The supplier must provide a specialized technician on site to perform the installation and complete the system start-up after installation. (Price to include labour, tooling, transport and all other costs for the complete execution of the needs required).	\$ _____/lot	\$ _____
3	1	The supplier must offer training in <u>French</u> to seven (7) persons by a specialist. The training must include maintenance, use and operation of the equipment. (See Annex A – Statement of requirement for further details)	\$ _____/lot (price to include min of a total of three, 8-hour days of training) \$ _____/lot (price to include at least four hours where operators can do testing)	\$ _____
4	1	Transport	\$ _____/lot	\$ _____
			GRAND TOTAL: (for items 1 to 4)	\$ _____

ANNEX "C"
MANDATORY AND TECHNICAL EVALUATION CRITERIA

TO BE COMPLETED BY SUPPLIERS - AT CLOSING DATE AND HOUR OF SOLICITATION:

The information that figures in the table below must be duly completed and submitted **at the closing date and hour of the solicitation**.

The proposals must cover all the subjects indicated in these tables in order to be considered.

In order to explain and demonstrate how the supplier meets the requirements of the bid, the suppliers must attach to their bid, a copy of the complete specifications and descriptive literature (Technical documents such as data sheets, user manual or other) of the products being offered.

Canada will only evaluate the documents that are sent along with the bids submitted by the supplier.

Canada will not evaluate information such as references to a web site address where supplementary information can be found. Neither will it evaluate instruction manuals or technical brochures that are not sent with the bid.

Only those proposals that meet all the mandatory technical criteria in the table below will be subject to further evaluation which is the financial evaluation.

The proposals that fail to meet all these conditions will be rejected.

The Department of National Defence, 202 Workshop, in Montreal, PQ needs to acquire a Press brake of 200 US tons.

MANDATORY TECHNICAL SPECIFICATIONS

THE FOLLOWING MANDATORY TECHNICAL CRITERIA MUST BE MET AT A MINIMUM.

Item no.	Description	Specify the area in the bid document or in the technical documents that describes the mandatory specifications needed
Mandatory Technical specifications		
1	The high-precision press brake must not be a prototype or an existing model requiring major modifications to comply with the requirements. The equipment must meet all the criteria during the proposal, and must use technology previously proven by the manufacturer. The names of two different companies in North America using a press brake of 200 US tons or more must be supplied to prove that equipment equivalent to that specified in the proposal are in use.	
2	The press brake must have a minimum capacity of 200 US tons.	

3	The press brake must be compatible with a power supply of 575 V, three phase at 60 Hz (connection to the infrastructure). If the press brake requires a different electrical power supply, a transformer must be supplied to be able to connect the press brake to the infrastructure.	
4	The press brake must comply with the following standards: - ANSI B11.3-2012 Safety Requirements for Power Press Brakes; - CSA Z142-10 (C2014) - Code for power press operation: Health, safety, and protection requirements. - CSA Z432-04 (R2014) – Protection of Machinery. - The transformer and electrical components must be certified by CSA. - The laser(s) installed on the press brake as well as their use must comply with these standards: ANSI Z136.1 – 2014 American Standard for Safe Use of Lasers and ANSI Z136.9 – 2013 American National Standard for Safe Use of Lasers in Manufacturing Environments.	
5	The press brake and its components must have the following dimensions: - Width: maximum of 12 feet (<i>required to accommodate the work space that is available</i>) - Depth: maximum of 6 feet - Height: maximum of 11 feet	
6	The press brake must have a frame, housings (or uprights), a table, and a bolted ram to be able to replace the parts, or adjust the assembly.	
7	The distance between the housings must be a minimum of 100 in. (2540 mm) to easily accommodate the use of 96 in. (2413 mm) of sheet metal. The bench length must be at least 120 in. (3048 mm). The throat must be a minimum of 19.6 in. (500 mm).	
8	The table of the press brake must be able to accommodate a die along its total length.	
9	The press brake must have a minimum three-point vertically guided ram and the two main cylinders must be able to move independently.	
10	The throat opening must be a minimum of 450 mm (17.7 in.) and a minimum ram stroke length of 300 mm (11.8 in.).	
11	The press brake must have cylinders whose rod and pistons are forged and tempered.	
12	The Supplier must ensure that the dimensions offered allow the bending of boxes (pan shaped) 10 in. (254 mm) high(variable thickness), taking into consideration the space already occupied by the anchoring system of the punch and the dies. Point 12 takes precedence over Point 11; if the dimensions proposed in Point 11 are insufficient, the Supplier must adapt the dimensions to respond to Point 12.	

13	The press brake must be equipped with a dynamic, hydraulic bending compensation CNC (Crowning) numerical control system. The press must be able to compensate both in real time and automatically for the deflections of the punch and die.	
14	The press brake must be equipped with a system guaranteeing the parallelism of the frame. Linear guides with an accuracy of at least 0.0005 in. (0.0127 mm) must compensate for the bending of the frame.	
15	The press brake must be equipped with a quick, tool-free clamping system for the punches. The punches must be able to be inserted both vertically and laterally. A nominal space of 2 in. must be present between the clamping jaws of the punches. The jaws must also move laterally (a minimum lateral movement of 1 in. is required). The clamping system must be, at a minimum, compatible with American punches and <i>Wilson Tools</i> with and without notches. The clamping system must allow the use of gooseneck punches on both sides. The clamping system must not be pneumatic or hydraulic. We are looking for a manual clamping system. The Supplier must be able to provide a European clamping system in the event that 202 Workshop wishes to acquire this type of tool. Please note that we need a system of tightening which takes American and <i>Wilson tools</i> and which can also accommodate 'gooseneck punch'.	
16	If present, the hydraulic system(s) must be equipped with a filter with a fineness of 3 microns.	
17	The press brake must be equipped with two support arms at the front of the press. The support arms must be able to move along the linear guides. The support arms must be able to be placed at the end of the press brake so as to not interfere with the operator during operations which do not require support arms. The support arms must be graduated in millimeters.	
18	The press brake must be equipped with a lighting system at the front and the rear of the press brake.	
19	<p>The press brake must be equipped with a movable rear stop over six axes (the axes include the movement of the fingers).</p> <p>(Clarification is provided for this statement: It means that since the two fingers mounted on the rear stop must move independently, each finger would move left, right, forward, and backwards individually, so making up the first 4 axes, which is x1, x2, y1, y2 . Considering that the two fingers are mounted on the rear stop which needs to be able to move forward backward, and up and down, the rear stop will have an over X and Z, therefore six axes).</p> <p>The stop must be equipped with two independently movable fingers. The travel on the stop on the X-axis must be a minimum of 1.2 m. The fingers must be able to position themselves</p>	

	automatically via the control console according to the distance required by the bending plan. Manual adjustment with micrometric precision of the stop by the operators must be possible using the control console. A system (mechanical or software) must prevent accidental collisions between the fingers and the die and/or the table. Note: the standard run is 800mm, but with the 3 rd support, it is possible to lean on a distance of 1.2m and this is acceptable for this requirement.	
20	The press brake must be equipped with an integrated control console, equipped with an LCD touch screen.	
21	The press brake's computer must permit importing .DXF, .STP or .IPT file formats. The computer must allow the operator to correct bending parameters. The computer must be compatible with all press brake correction systems (bending compensation, parallelism, etc.) as well as with all control devices (adjustable stops, hydraulic tightening, etc). A comptroller which allows to display in 3D or in 2D is acceptable.	
22	The repositioning accuracy of the stops and the ram must be at least 0.005 in. (repeatability).	

Solicitation No. - N° de l'invitation
W1985-186796/B
Client Ref. No. - N° de réf. du client
W1985-186796

Amd. No. - N° de la modif.
File No. - N° du dossier
MTA 7-40229

Buyer ID - Id de l'acheteur
MTA309
CCC No./N° CCC - FMS No./N° VME

ANNEX " D " SECURITY REQUIREMENT CHECK LIST



Government
of Canada

Gouvernement
du Canada

RECEIVED
NOV 29 2017

Contract Number / Numéro du contrat

W1985-186796

Security Classification / Classification de sécurité

SECURITY REQUIREMENTS CHECK LIST (SRCL)

LISTE DE VÉRIFICATION DES EXIGENCES RELATIVES À LA SÉCURITÉ (LVERS)

PART A - CONTRACT INFORMATION / PARTIE A - INFORMATION CONTRACTUELLE		
1. Originating Government Department or Organization / Ministère ou organisme gouvernemental d'origine		2. Branch or Directorate / Direction générale ou Direction 202 DÉPÔT D'ATELIER
3. a) Subcontract Number / Numéro du contrat de sous-traitance		3. b) Name and Address of Subcontractor / Nom et adresse du sous-traitant
4. Brief Description of Work / Brève description du travail Achat: Projet de Presse Plieuse 200T,		
5. a) Will the supplier require access to Controlled Goods? Le fournisseur aura-t-il accès à des marchandises contrôlées?		<input checked="" type="checkbox"/> No <input type="checkbox"/> Yes
5. b) Will the supplier require access to unclassified military technical data subject to the provisions of the Technical Data Control Regulations? Le fournisseur aura-t-il accès à des données techniques militaires non classifiées qui sont assujetties aux dispositions du Règlement sur le contrôle des données techniques?		<input checked="" type="checkbox"/> No <input type="checkbox"/> Yes
6. Indicate the type of access required / Indiquer le type d'accès requis		
6. a) Will the supplier and its employees require access to PROTECTED and/or CLASSIFIED information or assets? Le fournisseur ainsi que les employés auront-ils accès à des renseignements ou à des biens PROTÉGÉS et/ou CLASSIFIÉS? (Specify the level of access using the chart in Question 7. c) (Préciser le niveau d'accès en utilisant le tableau qui se trouve à la question 7. c)		<input checked="" type="checkbox"/> No <input type="checkbox"/> Yes
6. b) Will the supplier and its employees (e.g. cleaners, maintenance personnel) require access to restricted access areas? No access to PROTECTED and/or CLASSIFIED information or assets is permitted. Le fournisseur et ses employés (p. ex. nettoyeurs, personnel d'entretien) auront-ils accès à des zones d'accès restreintes? L'accès à des renseignements ou à des biens PROTÉGÉS et/ou CLASSIFIÉS n'est pas autorisé.		<input type="checkbox"/> No <input checked="" type="checkbox"/> Yes
6. c) Is this a commercial courier or delivery requirement with no overnight storage? S'agit-il d'un contrat de messagerie ou de livraison commerciale sans entreposage de nuit?		<input checked="" type="checkbox"/> No <input type="checkbox"/> Yes
7. a) Indicate the type of information that the supplier will be required to access / Indiquer le type d'information auquel le fournisseur devra avoir accès		
Canada <input type="checkbox"/>	NATO / OTAN <input type="checkbox"/>	Foreign / Étranger <input type="checkbox"/>
7. b) Release restrictions / Restrictions relatives à la diffusion		
No release restrictions Aucune restriction relative à la diffusion <input type="checkbox"/>	All NATO countries Tous les pays de l'OTAN <input type="checkbox"/>	No release restrictions Aucune restriction relative à la diffusion <input type="checkbox"/>
Not releasable À ne pas diffuser <input type="checkbox"/>	Restricted to: / Limité à: <input type="checkbox"/>	Restricted to: / Limité à: <input type="checkbox"/>
Specify country(ies): / Préciser le(s) pays:	Specify country(ies): / Préciser le(s) pays:	Specify country(ies): / Préciser le(s) pays:
7. c) Level of information / Niveau d'information		
PROTECTED A PROTÉGÉ A <input type="checkbox"/>	NATO UNCLASSIFIED NATO NON CLASSIFIÉ <input type="checkbox"/>	PROTECTED A PROTÉGÉ A <input type="checkbox"/>
PROTECTED B PROTÉGÉ B <input type="checkbox"/>	NATO RESTRICTED NATO DIFFUSION RESTREINTE <input type="checkbox"/>	PROTECTED B PROTÉGÉ B <input type="checkbox"/>
PROTECTED C PROTÉGÉ C <input type="checkbox"/>	NATO CONFIDENTIAL NATO CONFIDENTIEL <input type="checkbox"/>	PROTECTED C PROTÉGÉ C <input type="checkbox"/>
CONFIDENTIAL CONFIDENTIEL <input type="checkbox"/>	NATO SECRET NATO SECRET <input type="checkbox"/>	CONFIDENTIAL CONFIDENTIEL <input type="checkbox"/>
SECRET SECRET <input type="checkbox"/>	COSMIC TOP SECRET COSMIC TRÈS SECRET <input type="checkbox"/>	SECRET SECRET <input type="checkbox"/>
TOP SECRET TRÈS SECRET <input type="checkbox"/>		TOP SECRET TRÈS SECRET <input type="checkbox"/>
TOP SECRET (SIGINT) TRÈS SECRET (SIGINT) <input type="checkbox"/>		TOP SECRET (SIGINT) TRÈS SECRET (SIGINT) <input type="checkbox"/>

TBS/SCT 350-103(2004/12)

Security Classification / Classification de sécurité

Canada

Solicitation No. - N° de l'invitation
W1985-186796/B
Client Ref. No. - N° de réf. du client
W1985-186796

Amd. No. - N° de la modif.
File No. - N° du dossier
MTA 7-40229

Buyer ID - Id de l'acheteur
MTA309
CCC No./N° CCC - FMS No./N° VME



Government of Canada
Gouvernement du Canada

Contract Number / Numéro du contrat

W1985-186796

Security Classification / Classification de sécurité

Sm

PART A (continued) / PARTIE A (suite)

8. Will the supplier require access to PROTECTED and/or CLASSIFIED COMSEC information or assets?
Le fournisseur aura-t-il accès à des renseignements ou à des biens COMSEC désignés PROTÉGÉS et/ou CLASSIFIÉS? ☒ No ☐ Yes
Non ☐ Oui
- If Yes, indicate the level of sensitivity:
Dans l'affirmative, indiquer le niveau de sensibilité:
9. Will the supplier require access to extremely sensitive INFOSEC information or assets?
Le fournisseur aura-t-il accès à des renseignements ou à des biens INFOSEC de nature extrêmement délicate? ☒ No ☐ Yes
Non ☐ Oui
- Short Title(s) of material / Titre(s) abrégé(s) du matériel:
Document Number / Numéro du document:

PART B - PERSONNEL (SUPPLIER) / PARTIE B - PERSONNEL (FOURNISSEUR)

10. a) Personnel security screening level required / Niveau de contrôle de la sécurité du personnel requis
- | | | | |
|-----------------------------------------------------------------------------|-----------------------------------------------------------------|-----------------------------------------------------|------------------------------------------------------------------|
| <input checked="" type="checkbox"/> RELIABILITY STATUS
COTE DE FIABILITÉ | <input type="checkbox"/> CONFIDENTIAL
CONFIDENTIEL | <input type="checkbox"/> SECRET
SECRET | <input type="checkbox"/> TOP SECRET
TRÈS SECRET |
| <input type="checkbox"/> TOP SECRET - SIGINT
TRÈS SECRET - SIGINT | <input type="checkbox"/> NATO CONFIDENTIAL
NATO CONFIDENTIEL | <input type="checkbox"/> NATO SECRET
NATO SECRET | <input type="checkbox"/> COSMIC TOP SECRET
COSMIC TRÈS SECRET |
| <input type="checkbox"/> SITE ACCESS
ACCÈS AUX EMPLACEMENTS | | | |
- Special comments:
Commentaires spéciaux: _____
- NOTE: If multiple levels of screening are identified, a Security Classification Guide must be provided.
REMARQUE: Si plusieurs niveaux de contrôle de sécurité sont requis, un guide de classification de la sécurité doit être fourni.

10. b) May unscreened personnel be used for portions of the work?
Du personnel sans autorisation sécuritaire peut-il se voir confier des parties du travail? ☒ No ☐ Yes
Non ☐ Oui
- If Yes, will unscreened personnel be escorted?
Dans l'affirmative, le personnel en question sera-t-il escorté? ☒ No ☐ Yes
Non ☐ Oui

PART C - SAFEGUARDS (SUPPLIER) / PARTIE C - MESURES DE PROTECTION (FOURNISSEUR)

- INFORMATION / ASSETS / RENSEIGNEMENTS / BIENS
11. a) Will the supplier be required to receive and store PROTECTED and/or CLASSIFIED information or assets on its site or premises?
Le fournisseur sera-t-il tenu de recevoir et d'entreposer sur place des renseignements ou des biens PROTÉGÉS et/ou CLASSIFIÉS? ☒ No ☐ Yes
Non ☐ Oui
11. b) Will the supplier be required to safeguard COMSEC information or assets?
Le fournisseur sera-t-il tenu de protéger des renseignements ou des biens COMSEC? ☒ No ☐ Yes
Non ☐ Oui
- PRODUCTION
11. c) Will the production (manufacture, and/or repair and/or modification) of PROTECTED and/or CLASSIFIED material or equipment occur at the supplier's site or premises?
Les installations du fournisseur serviront-elles à la production (fabrication et/ou réparation et/ou modification) de matériel PROTÉGÉ et/ou CLASSIFIÉ? ☒ No ☐ Yes
Non ☐ Oui
- INFORMATION TECHNOLOGY (IT) MEDIA / SUPPORT RELATIF À LA TECHNOLOGIE DE L'INFORMATION (TI)
11. d) Will the supplier be required to use its IT systems to electronically process, produce or store PROTECTED and/or CLASSIFIED information or data?
Le fournisseur sera-t-il tenu d'utiliser ses propres systèmes informatiques pour traiter, produire ou stocker électroniquement des renseignements ou des données PROTÉGÉS et/ou CLASSIFIÉS? ☒ No ☐ Yes
Non ☐ Oui
11. e) Will there be an electronic link between the supplier's IT systems and the government department or agency?
Disposera-t-on d'un lien électronique entre le système informatique du fournisseur et celui du ministère ou de l'agence gouvernementale? ☒ No ☐ Yes
Non ☐ Oui

TBS/SCT 350-103(2004/12)

Security Classification / Classification de sécurité

Canada

Solicitation No. - N° de l'invitation
W1985-186796/B
Client Ref. No. - N° de réf. du client
W1985-186796

Amd. No. - N° de la modif.
File No. - N° du dossier
MTA 7-40229

Buyer ID - Id de l'acheteur
MTA309
CCC No./N° CCC - FMS No./N° VME



Government of Canada
Gouvernement du Canada

Contract Number / Numéro du contrat
W1985-186796

Security Classification / Classification de sécurité

PART C - (continued) / PARTIE C - (suite)

For users completing the form manually use the summary chart below to indicate the category(ies) and level(s) of safeguarding required at the supplier's site(s) or premises.

Les utilisateurs qui remplissent le formulaire manuellement doivent utiliser le tableau récapitulatif ci-dessous pour indiquer, pour chaque catégorie, les niveaux de sauvegarde requis aux installations du fournisseur.

For users completing the form online (via the Internet), the summary chart is automatically populated by your responses to previous questions.

Dans le cas des utilisateurs qui remplissent le formulaire en ligne (par Internet), les réponses aux questions précédentes sont automatiquement saisies dans le tableau récapitulatif.

SUMMARY CHART / TABLEAU RÉCAPITULATIF

Category Catégorie	PROTECTED PROTÉGÉ			CLASSIFIED CLASSIFIÉ			NATO				COMSEC					
	A	B	C	CONFIDENTIAL	SECRET	TOP SECRET	NATO RESTRICTED	NATO CONFIDENTIAL	NATO SECRET	COSMIC TOP SECRET	PROTECTED PROTÉGÉ			CONFIDENTIAL	SECRET	TOP SECRET
				CONFIDENTIEL		TRÈS SECRET	NATO DIFFUSION RESTREINTE	NATO CONFIDENTIEL			COSMIC TRÈS SECRET	A	B	C	CONFIDENTIEL	
Information / Assets Renseignements / Biens Production																
IT Media / Support TI																
IT Link / Lien électronique																

12. a) Is the description of the work contained within this SRCL PROTECTED and/or CLASSIFIED?

La description du travail visé par la présente LVERS est-elle de nature PROTÉGÉE et/ou CLASSIFIÉE?

☒ No ☐ Yes
Non Oui

If Yes, classify this form by annotating the top and bottom in the area entitled "Security Classification".
Dans l'affirmative, classifiez le présent formulaire en indiquant le niveau de sécurité dans la case intitulée « Classification de sécurité » au haut et au bas du formulaire.

12. b) Will the documentation attached to this SRCL be PROTECTED and/or CLASSIFIED?

La documentation associée à la présente LVERS sera-t-elle PROTÉGÉE et/ou CLASSIFIÉE?

☒ No ☐ Yes
Non Oui

If Yes, classify this form by annotating the top and bottom in the area entitled "Security Classification" and indicate with attachments (e.g. SECRET with Attachments).
Dans l'affirmative, classifiez le présent formulaire en indiquant le niveau de sécurité dans la case intitulée « Classification de sécurité » au haut et au bas du formulaire et indiquez qu'il y a des pièces jointes (p. ex. SECRET avec des pièces jointes).