

FISHERIES AND OCEANS



# C&P LOWER TERRA NOVA WAREHOUSE BOAT LAUNCH ANGLE BROOK ROAD

GLOVERTOWN, NL

PROJECT NO.: F6879-179019  
REVISED FOR TENDER

DATE: FEBRUARY 09, 2018

CLIENT/OWNER:  
DEPARTMENT OF FISHERIES & OCEANS,  
REAL PROPERTY, SAFETY & SECURITY

## DRAWING LIST:

C1 SITE PLAN AND BOAT LAUNCH DETAILS  
C2 BOAT LAUNCH SECTIONS AND DETAILS

PRIME CONSULTANTS:



62 CAMPBELL AVENUE TEL: (709) 368-1669  
ST. JOHN'S, NL FAX: (709) 368-0318  
A1E 2Z6 info@DynamicEngineering.ca

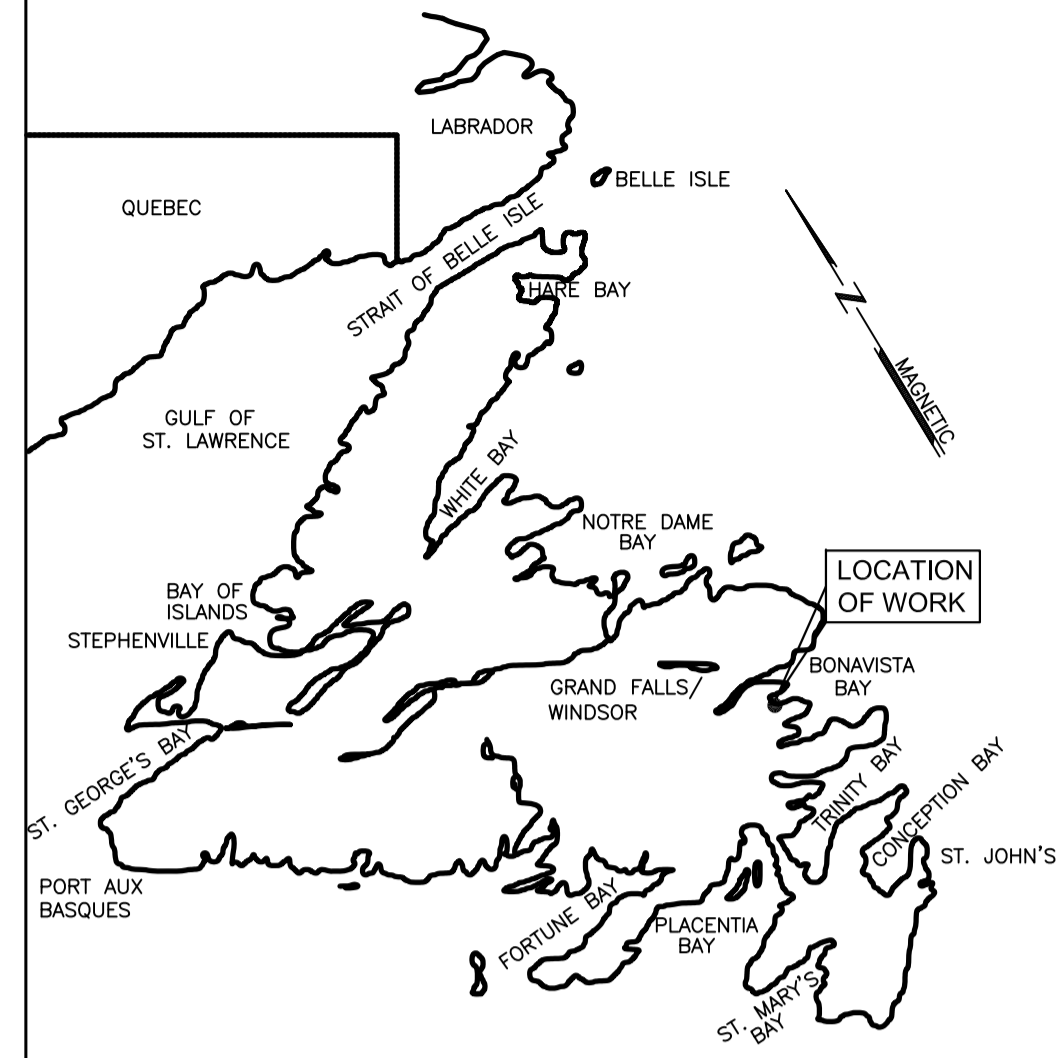

KEY LOCATION PLAN

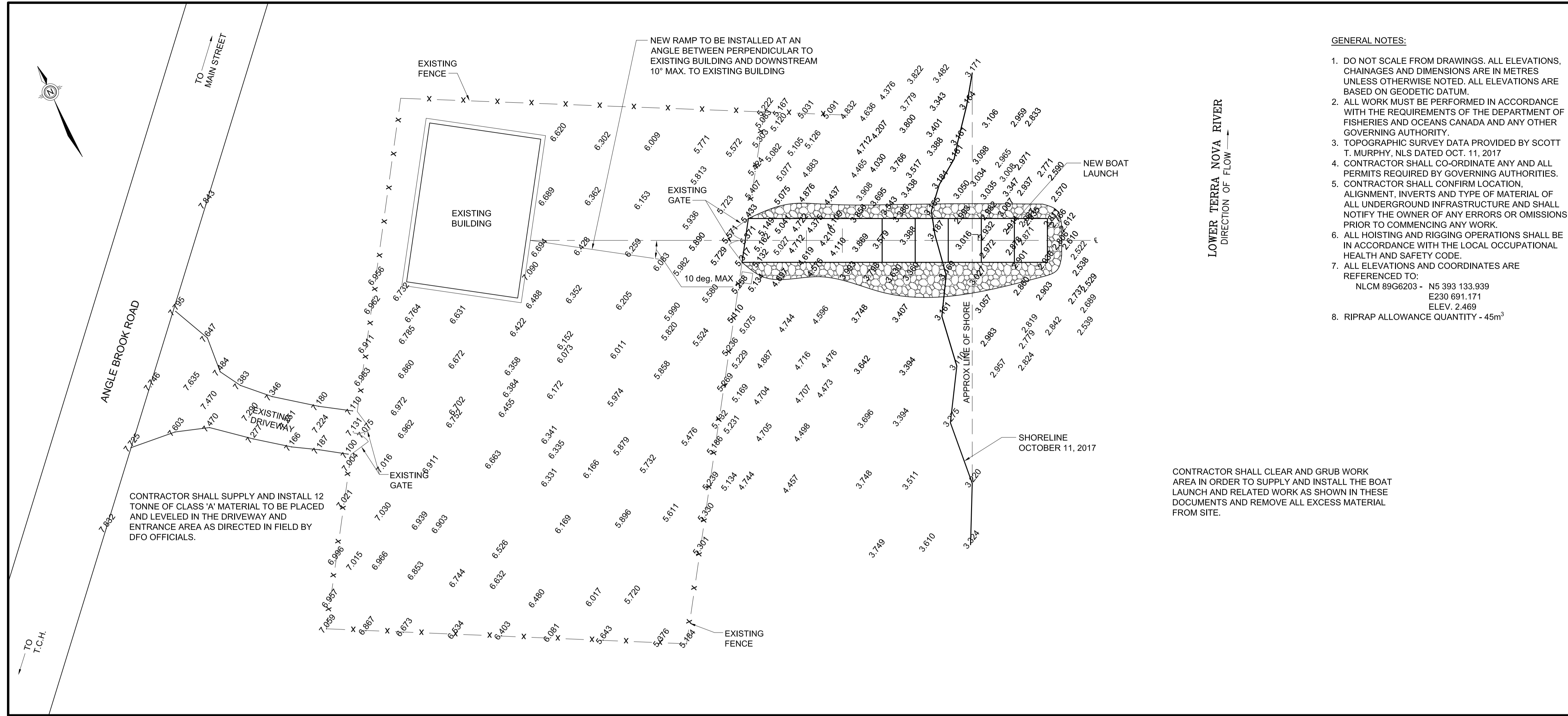

- GENERAL NOTES:**
- DO NOT SCALE FROM DRAWINGS. ALL ELEVATIONS, CHAINAGES AND DIMENSIONS ARE IN METRES UNLESS OTHERWISE NOTED. ALL ELEVATIONS ARE BASED ON GEODETIC DATUM.
  - ALL WORK MUST BE PERFORMED IN ACCORDANCE WITH THE REQUIREMENTS OF THE DEPARTMENT OF FISHERIES AND OCEANS CANADA AND ANY OTHER GOVERNING AUTHORITY.
  - TOPOGRAPHIC SURVEY DATA PROVIDED BY SCOTT T. MURPHY, NLS DATED OCT. 11, 2017
  - CONTRACTOR SHALL CO-ORDINATE ANY AND ALL PERMITS REQUIRED BY GOVERNING AUTHORITIES.
  - CONTRACTOR SHALL CONFIRM LOCATION, ALIGNMENT, INVERTS AND TYPE OF MATERIAL OF ALL UNDERGROUND INFRASTRUCTURE AND SHALL NOTIFY THE OWNER OF ANY ERRORS OR OMISSIONS PRIOR TO COMMENCING ANY WORK
  - ALL HOISTING AND RIGGING OPERATIONS SHALL BE IN ACCORDANCE WITH THE LOCAL OCCUPATIONAL HEALTH AND SAFETY CODE.
  - ALL ELEVATIONS AND COORDINATES ARE REFERENCED TO:  
 NLCM 89G203 - N5 393 133.939  
 E230 691.171  
 ELEV. 2.469
  - RIPRAP ALLOWANCE QUANTITY - 45m<sup>3</sup>

CONTRACTOR SHALL CLEAR AND GRUB WORK AREA IN ORDER TO SUPPLY AND INSTALL THE BOAT LAUNCH AND RELATED WORK AS SHOWN IN THESE DOCUMENTS AND REMOVE ALL EXCESS MATERIAL FROM SITE.

SITE PLAN  
 0 5 10m  
 Scale 1:200

1  
 C1

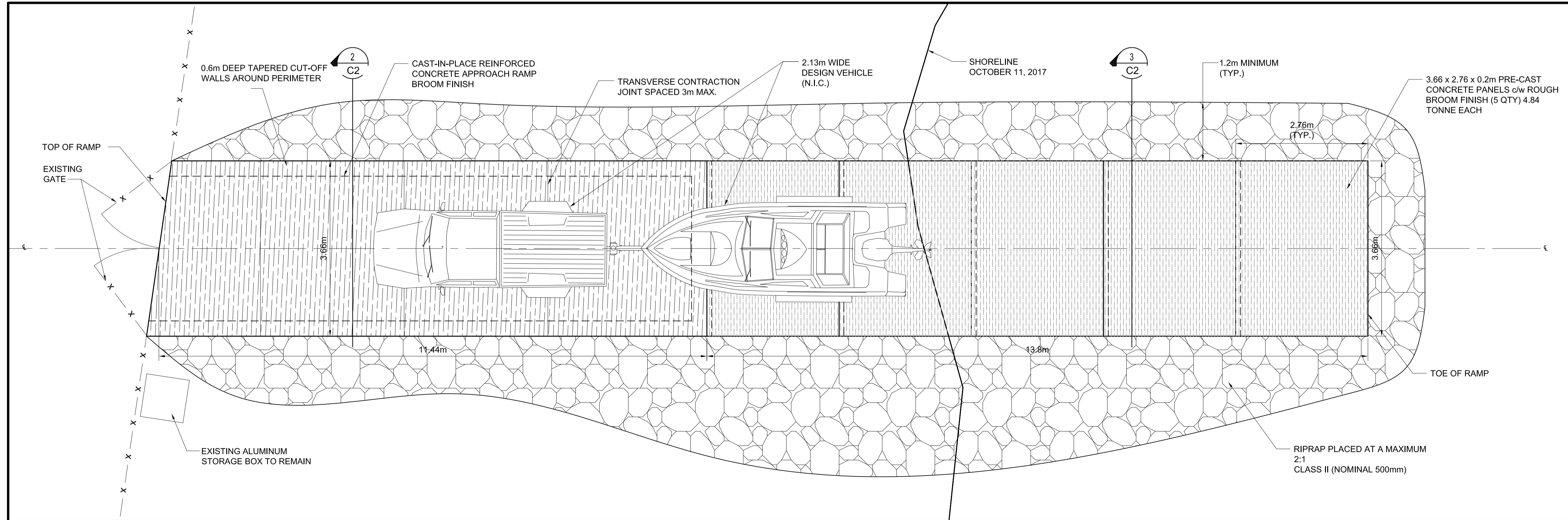

PROVINCE OF NEWFOUNDLAND AND LABRADOR  

**PERMIT HOLDER**  
 This Permit Allows  
**DYNAMIC ENGINEERING LTD.**  
 To practice Professional Engineering in Newfoundland and Labrador Permit No. as issued by PEG 10579 which is valid for the year 2018.



BOAT LAUNCH - PLAN VIEW  
 0 1 2m  
 Scale 1:50

2  
 C1

0	ISSUED FOR TENDER	09/02/18	D.J.M.	R.H.M.
no.	revision	date	by	approved
no.	revision	date	par	approve

Project - projet  
**C&P LOWER TERRA NOVA WAREHOUSE BOAT LAUNCH GLOVERTOWN, NL**

Drawing - dessin  
**SITE PLAN AND BOAT LAUNCH DETAILS**

drawn - dessine	D.J.M.	designed - dessine par	D.J.M.
date - date	OCTOBER 2017	checked - verifie	R.H.M.
scale - echelle	AS SHOWN	approved for tender - approuve pour l'offre	R.H.M.
project no. - projet no.	F6879-179019	drawing no. - no du dessin	02C1201F005C1
		sheet - feuille	C1



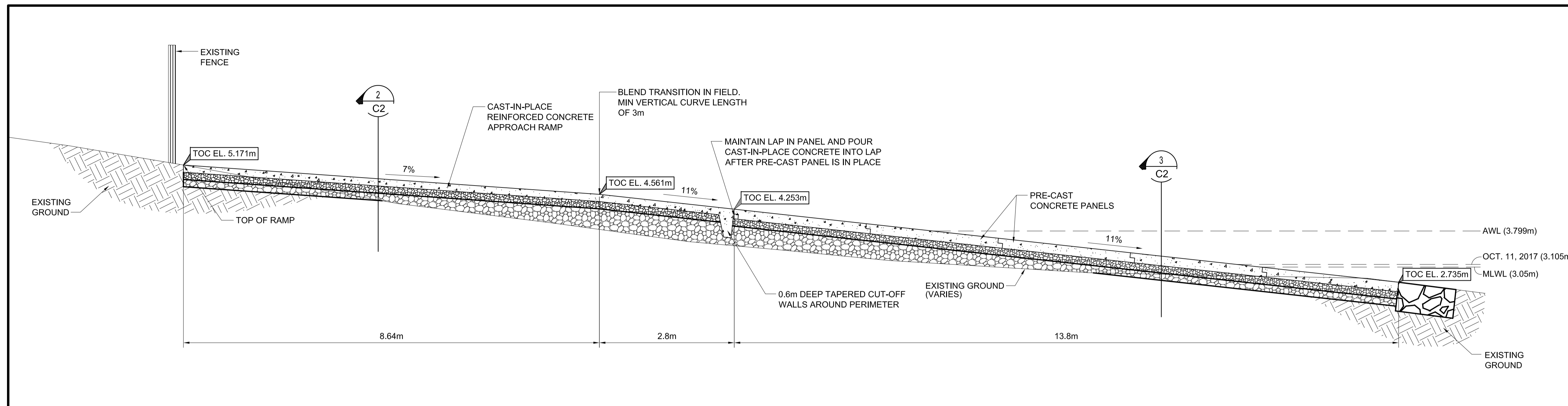

BOAT LAUNCH - CENTRELINE SECTION

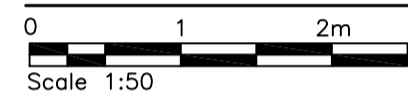

1  
C2

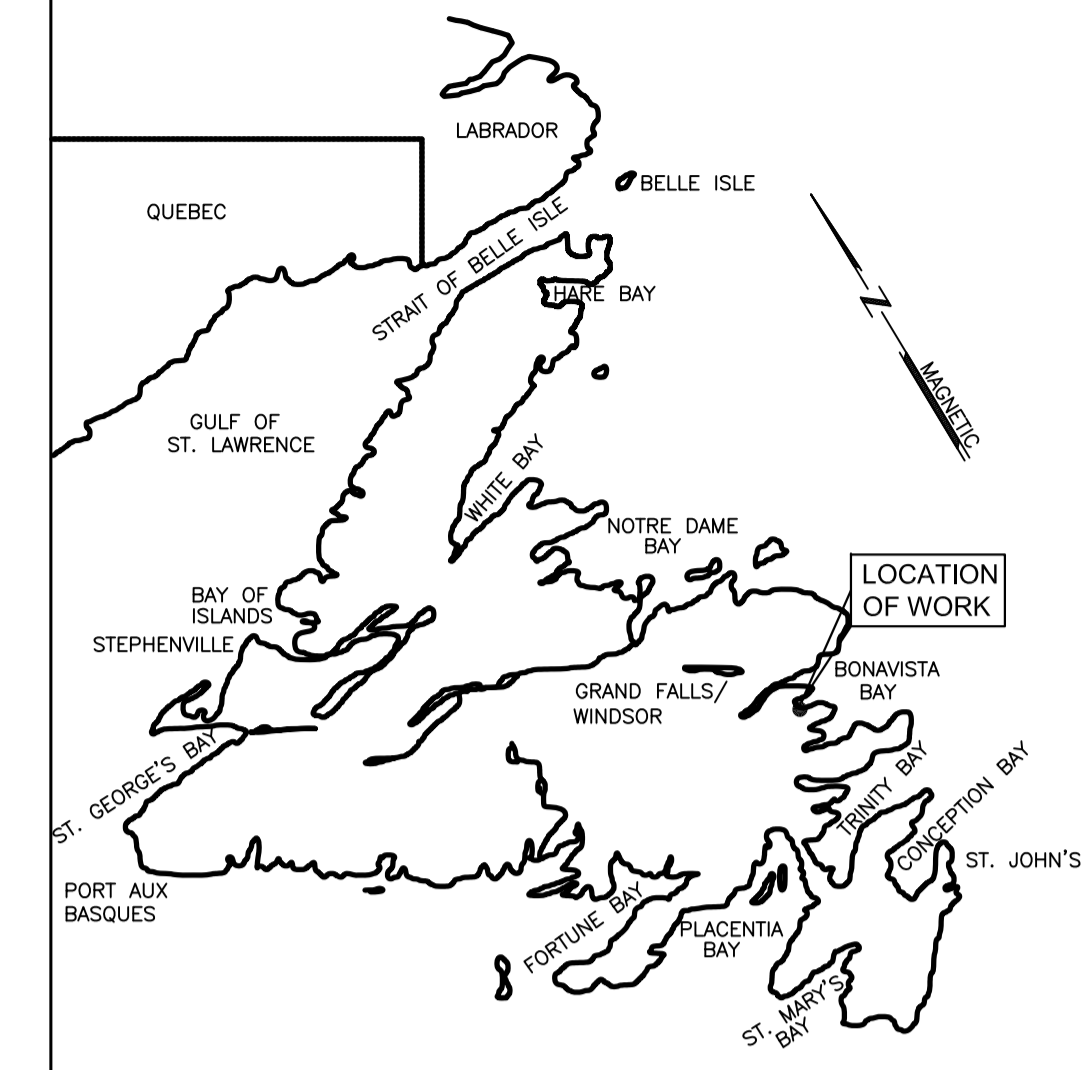

KEY LOCATION PLAN

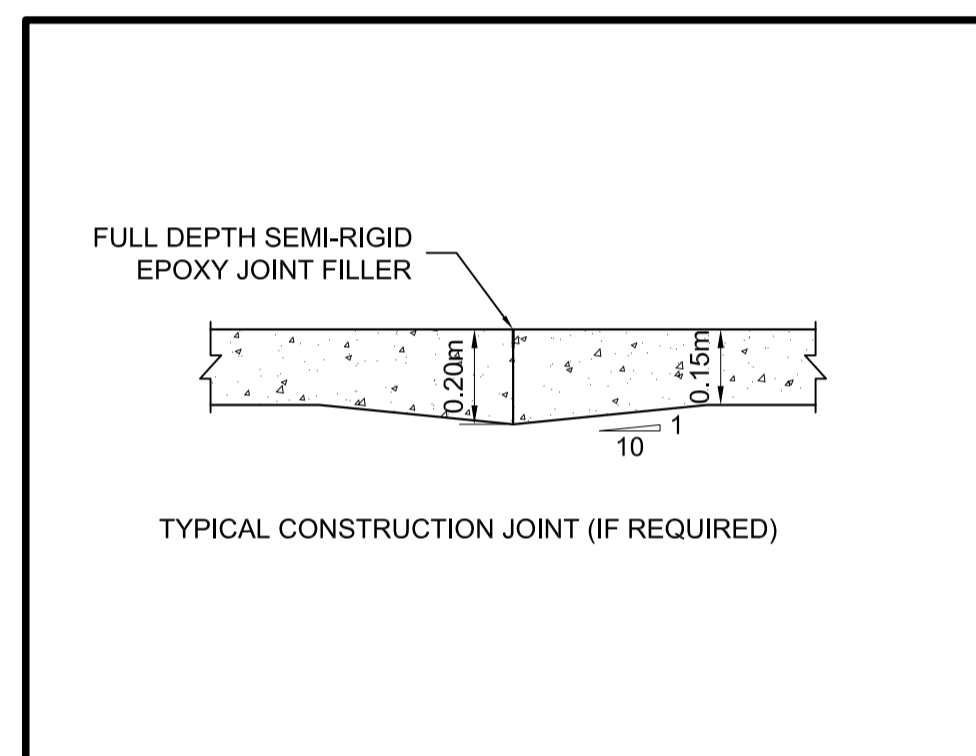

CONSTRUCTION JOINT DETAIL (TYP.)

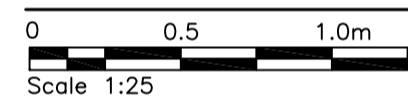

5  
C2

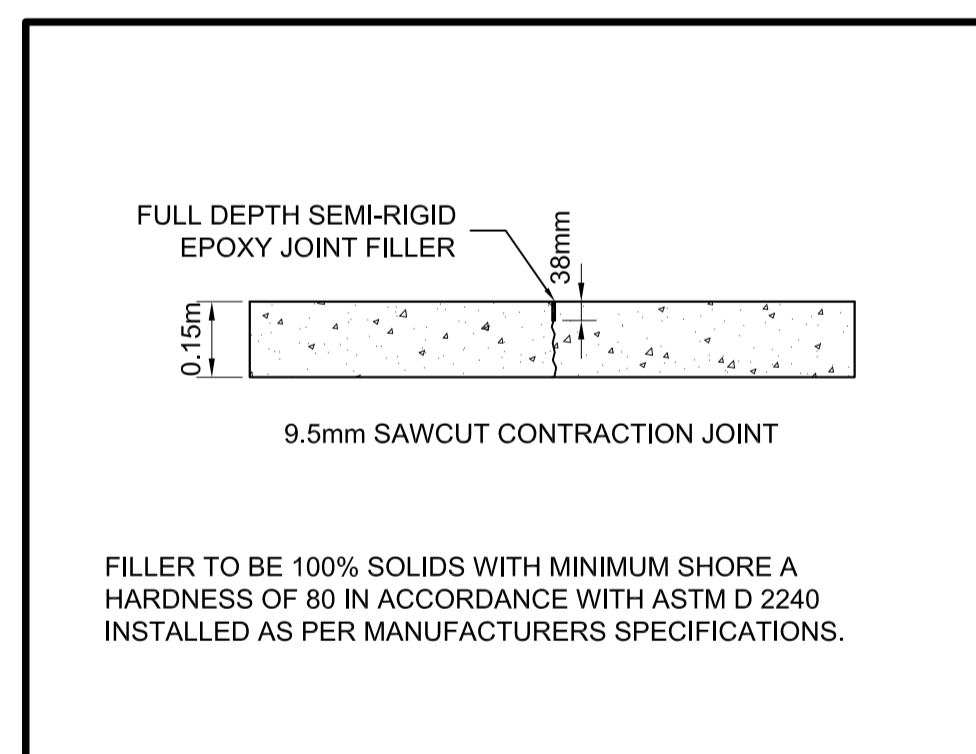

CONTRACTION JOINT DETAIL (TYP.)

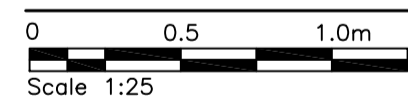

6  
C2

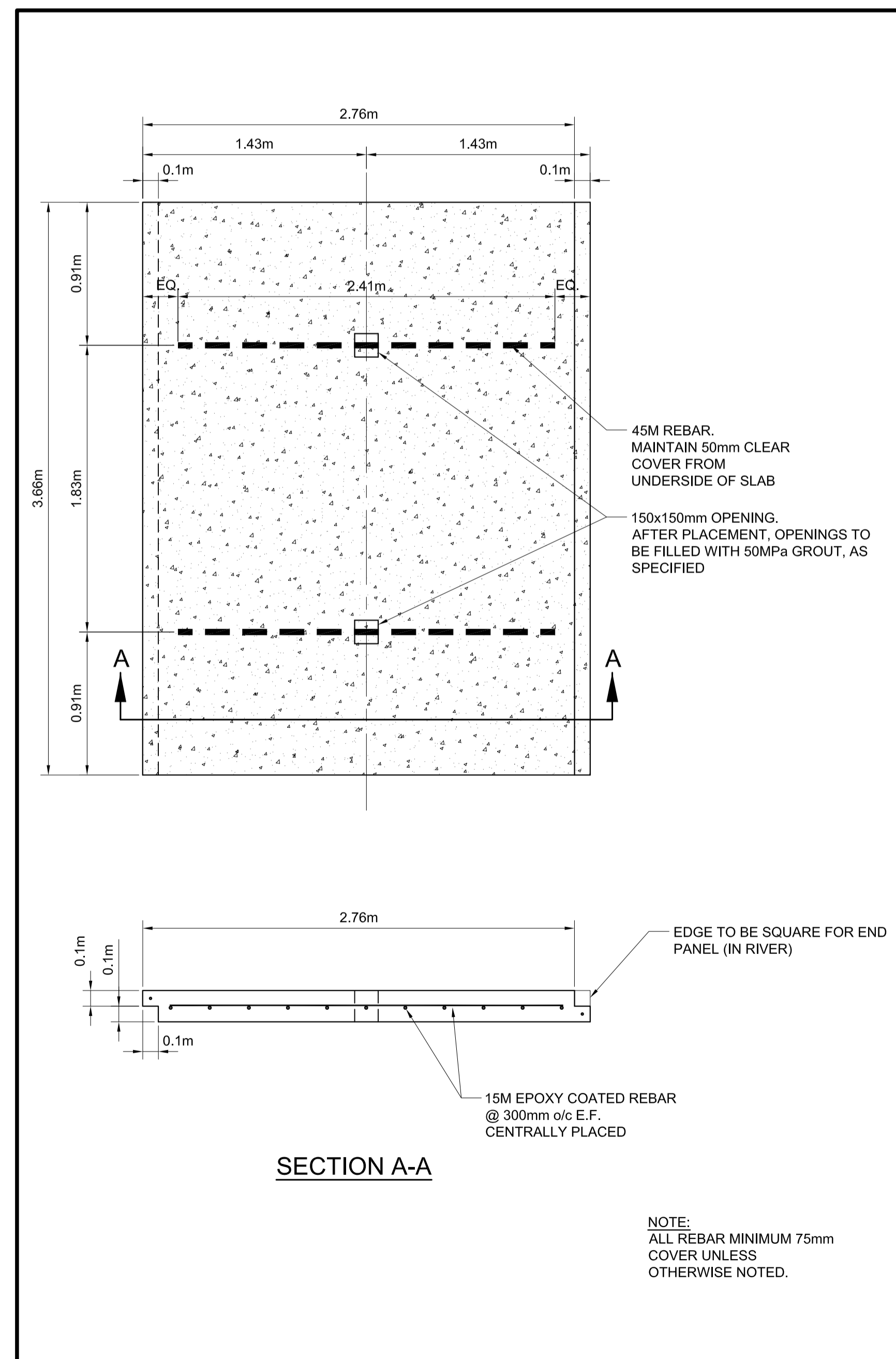

PRE-CAST CONCRETE PANEL DETAILS

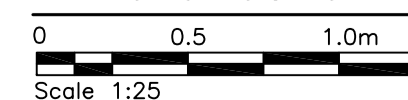

4  
C2

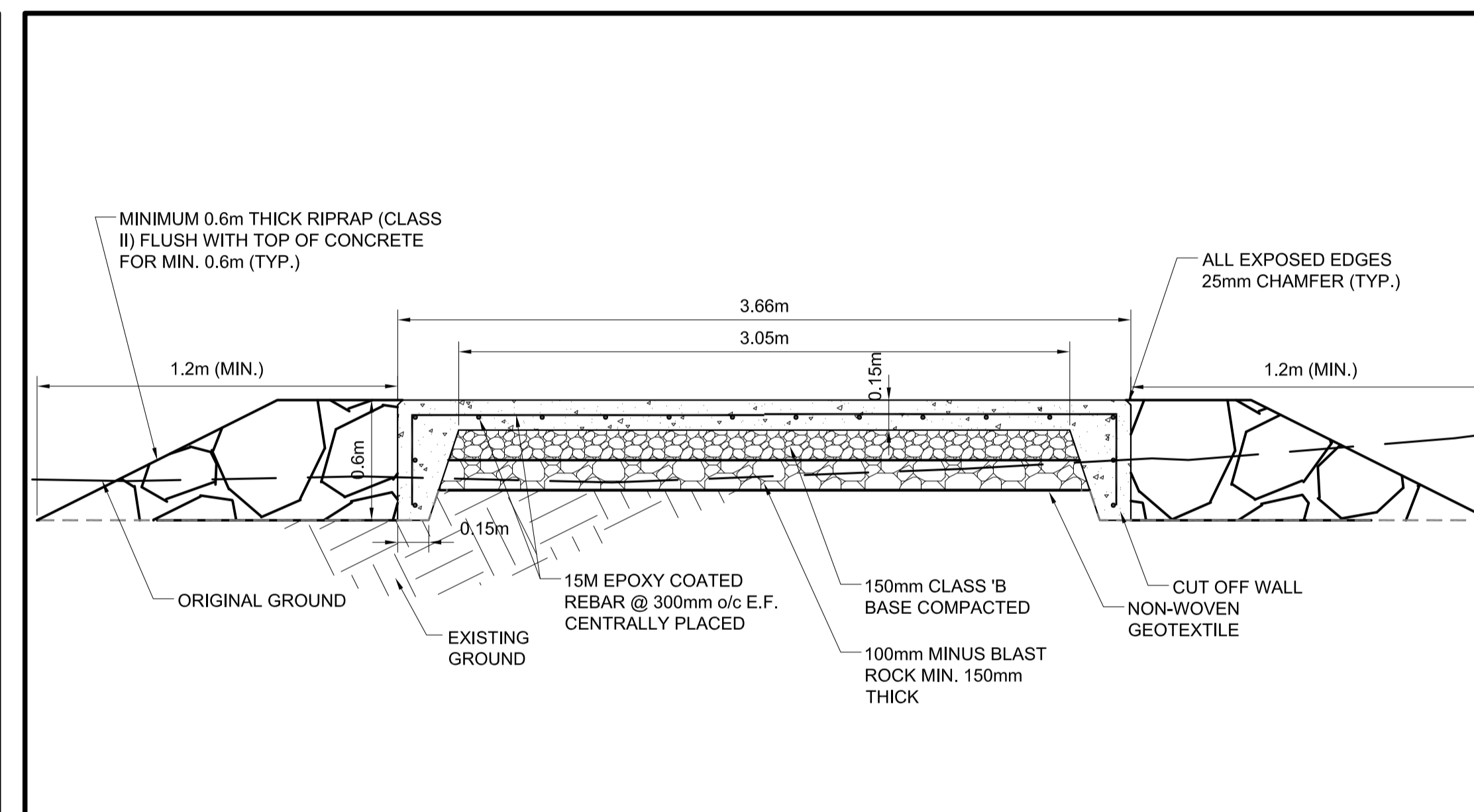

CAST-IN-PLACE APPROACH RAMP - SECTION

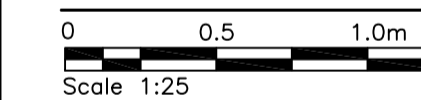

2  
C2

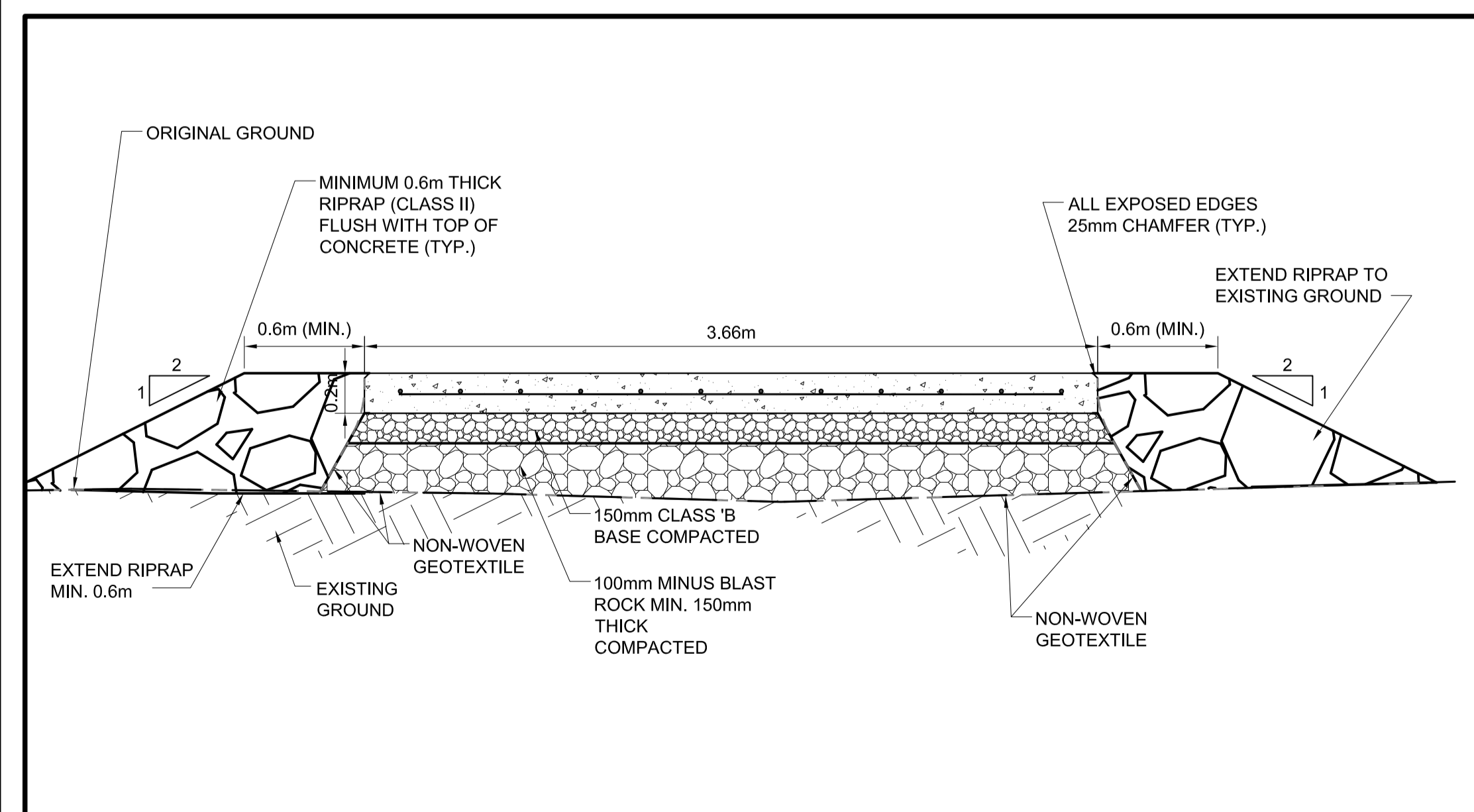

PRE-CAST CONCRETE PANEL - SECTION

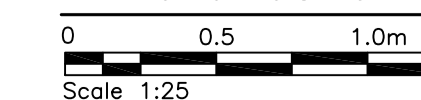

3  
C2

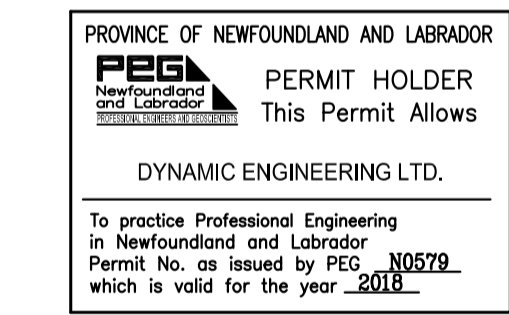
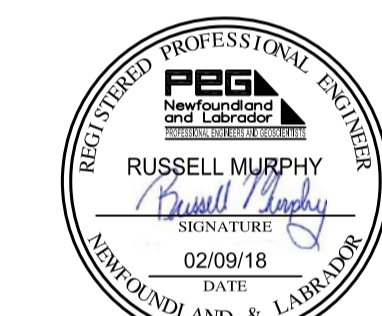

0	ISSUED FOR TENDER	09/02/18	D.J.M.	R.H.M.
no.	revision	date	by	approved
	revision	date	par	approve
Project - projet				
<b>C&amp;P LOWER TERRA NOVA WAREHOUSE BOAT LAUNCH GLOVERTOWN, NL</b>				
Drawing - dessin				
<b>BOAT LAUNCH SECTION AND DETAILS</b>				
drawn - dessine	D.J.M.	designed - dessine par	D.J.M.	
date - date	OCTOBER 2017	checked - verifie	R.H.M.	
scale - echelle	AS SHOWN	approved for tender - approuve pour l'offre	R.H.M.	
project no. - projet no.	F6879-179019	drawing no. - no du dessin	02C1201F005C2	sheet - feuille C2