

# NATIONAL RESEARCH COUNCIL CANADA SUSSEX DRIVE CAMPUS

## BUILDING S-77 FRONT ENTRANCE STEPS REHABILITATION

DRAWING LIST

DRAWING No.

COVER SHEET

5547-CS1

GENERAL

PARTIAL SITE PLAN, DETAILS, EXISTING CONDITIONS

5547-G01

PARTIAL SITE PLAN, DETAILS, NEW WORK

5547-G02

REFERENCE DETAILS





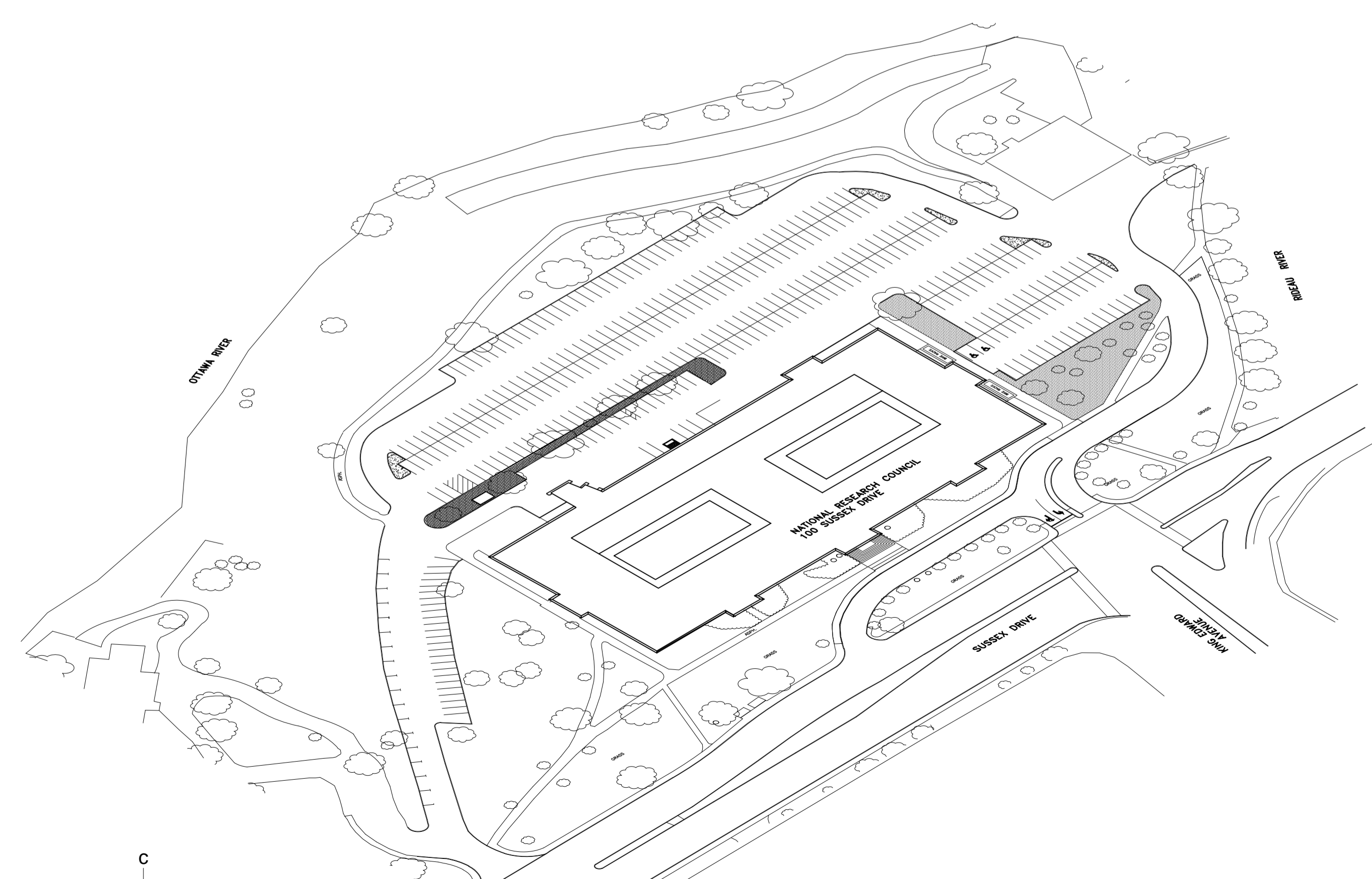

5547-G03

REFERENCE DETAILS

5547-G04



**SYMBOL LEGEND (for project)**

-  NOTE NUMBER
-  ROOM NUMBER
-  WINDOW TYPE NUMBER
-  DETAIL NUMBER
-  ELEVATION NUMBER
-  SECTION NUMBER
-  NEW OR EXIST. ELEVATION OR LEVEL

**KEY PLAN**

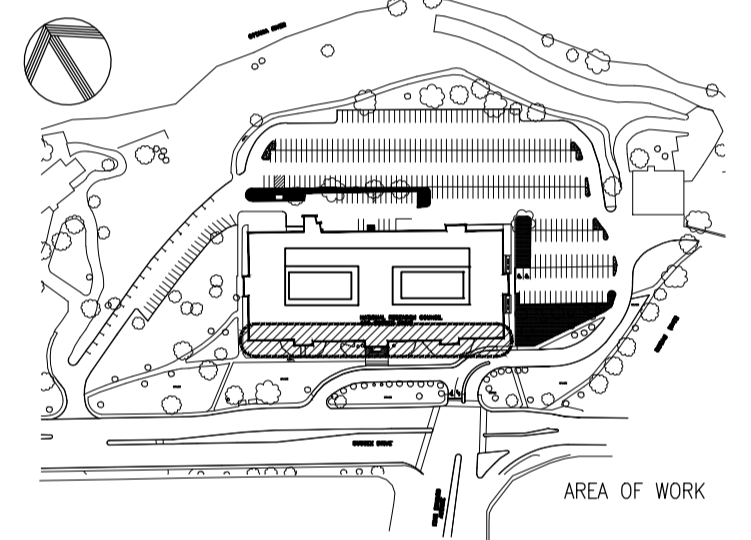

No.	Date	Revision	By: / Par:
0	JUNE 2018	ISSUED FOR TENDER	JL

- o Verify all dimensions and site conditions and be responsible for same
- o Vérifier toutes les dimensions et l'état des lieux et en assumer la responsabilité

A	A Detail no. No. du détail	A
B	B Location drawing no. sur dessin no.	B C
C	C Drawing no. dessin no.	

project **S-77 FRONT ENTRANCE STEPS REHABILITATION** projet

**SUSSEX DRIVE CAMPUS**

drawing **COVER SHEET** dessin

designed **CE** conçu date **MAY 2018** date

drawn **CE** dessiné scale **NTS** échelle

checked **SWH** vérifié sheet **1** of/de **5** feuille

approved **AS** approuvé W.O.no. D.T.no.

dwg.no. **5547-CS01** dessin no.

**GENERAL NOTES**

- CONTRACTORS TO CHECK AND VERIFY ALL DIMENSIONS ON SITE PRIOR TO DEMOLITION OR CONSTRUCTION AND REPORT ANY ERRORS OR OMISSIONS TO DEPARTMENTAL REPRESENTATIVE.
- CONTRACTORS MUST VISIT THE SITE & FULLY FAMILIARIZE THEMSELVES WITH THE SCOPE OF THE WORK.
- PREVENT THE SPREAD OF DUST & DEBRIS BEYOND THE WORK AREA AND CLEAN ALL SURFACES AT COMPLETION.
- MAKE GOOD ALL SURFACES AFFECTED BY THIS WORK.
- COORDINATE ALL SHUTDOWNS WITH THE DEPARTMENTAL REPRESENTATIVE.
- PROVIDE ALL LABOUR AND MATERIAL REQUIRED TO FORM A COMPLETE, FUNCTIONAL SYSTEM AS DESCRIBED ON DRAWINGS.

**DRAWING NOTES — SHEET G01**  
 THESE NOTES APPLY TO DRAWING SHEET G01 ONLY

- EXISTING GRANITE STEPS TO BE REMOVED AND STORED WHERE DIRECTED BY NRC DEPARTMENTAL REPRESENTATIVE.
- EXISTING BRONZE HANDRAILS TO BE REMOVED AND STORED FOR REINSTALLATION TO SAME LOCATION. SEE DETAIL 3/G01.
- EXISTING PRECAST PLANTERS TO BE REMOVED AND STORED FOR REINSTALLATION TO SAME LOCATION AT COMPLETION OF WORK.
- EXISTING PRECAST LIGHT STANDARDS TO REMAIN PROTECTED AND UNAFFECTED BY THE WORK.
- DENOTES PROPOSED LINE OF SITE PROTECTION AND HOARDING. CONTRACTOR TO SUBMIT HOARDING AND SITE PLAN FOR NRC REVIEW PRIOR TO FABRICATION.
- SOFT LANDSCAPING WITHIN AND ADJACENT TO WORK SITE TO BE PROTECTED FROM THE WORK. WHERE DISTURBED, RESTORE TO ORIGINAL CONDITION TO THE SATISFACTION OF NRC DEPARTMENTAL REPRESENTATIVE; SPECIES FOR SPECIES, LIKE FOR LIKE.
- EXISTING SIDEWALK TO REMAIN UNAFFECTED BY THE WORK.
- REMOVABLE BRONZE POST SLEEVE.
- CONCRETE SLEEVE TO BE CHIPPED OUT TO ALLOW HANDRAIL REMOVAL. EXISTING OPENING TO BE RE-USED FOR REINSTALLATION.
- DENOTES LINE OF CONCRETE FOUNDATION BELOW.
- CONTRACTOR TO ALLOW FOR SAW-CUTTING AND REMOVING A PORTION OF THE EXISTING ASPHALT SIDEWALK TO FACILITATE THE REMOVAL OF THE GRANITE STEPS. PORTION TO BE REINSTATED AS ORIGINAL.
- WHERE STEPS ARE REMOVED, REMOVE EXISTING 38mm +/- SETTING BED AND COMPACT FILL TO ACCOMMODATE NEW 38mm MORTAR BED AND TYPE 1 FILL.
- THIS STONE TO REMAIN.

**NOTE:**

EXISTING GRANITE STEP SLAB COURSE AND DIMENSIONS ARE REPRESENTATIVE OF LAYOUT ONLY. CONTRACTOR SHALL MEASURE AND PROVIDE FIELD VERIFIED DRAWING SHOWING EXISTING LAYOUT AND REINSTALLED LAYOUT FOR NRC DEPARTMENTAL REPRESENTATIVES' REVIEW PRIOR TO COMMENCING THE WORK.

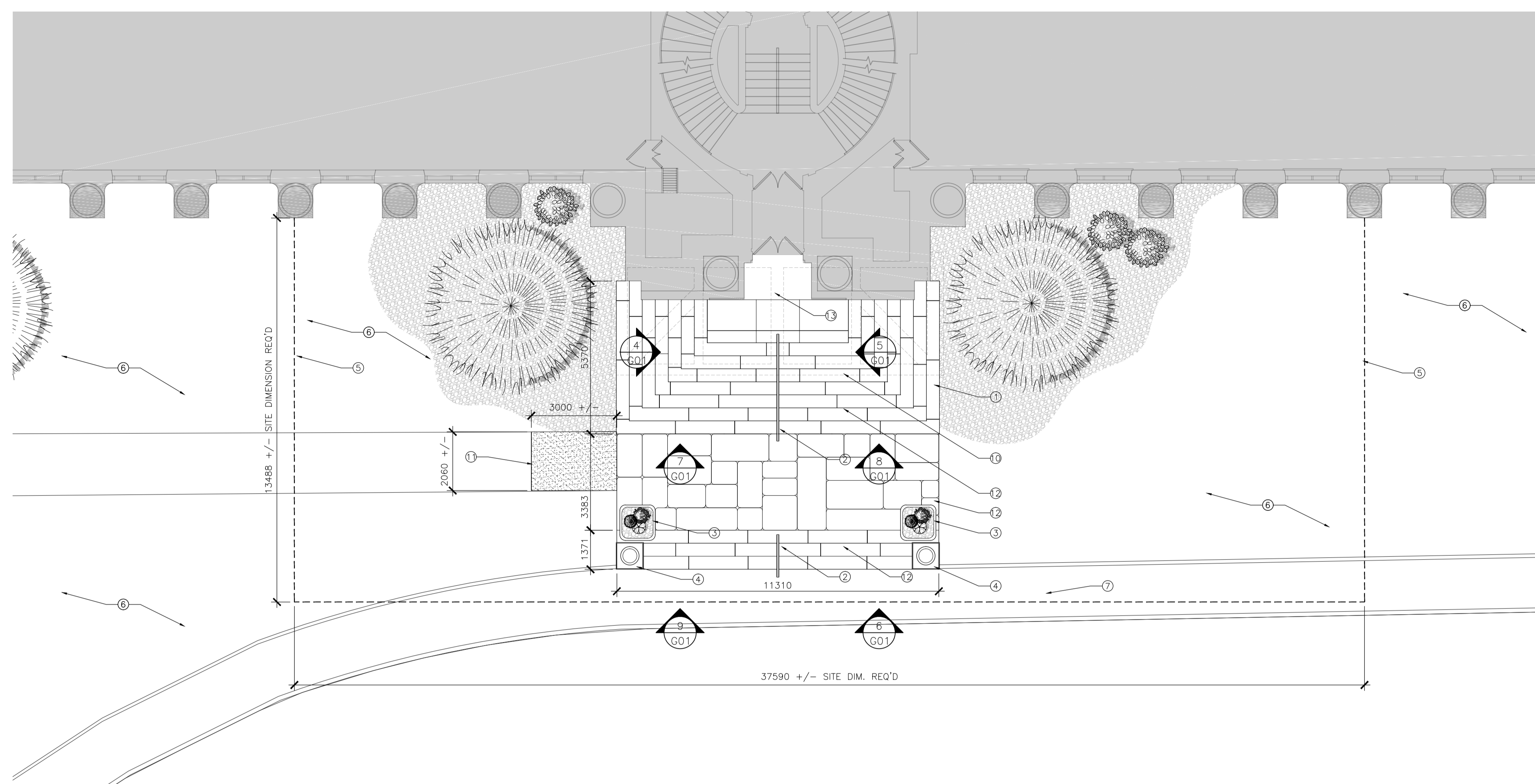

**1 G01** PARTIAL PLAN — EXISTING CONDITIONS @ ENTRANCE STEPS  
 SCALE = 1:100

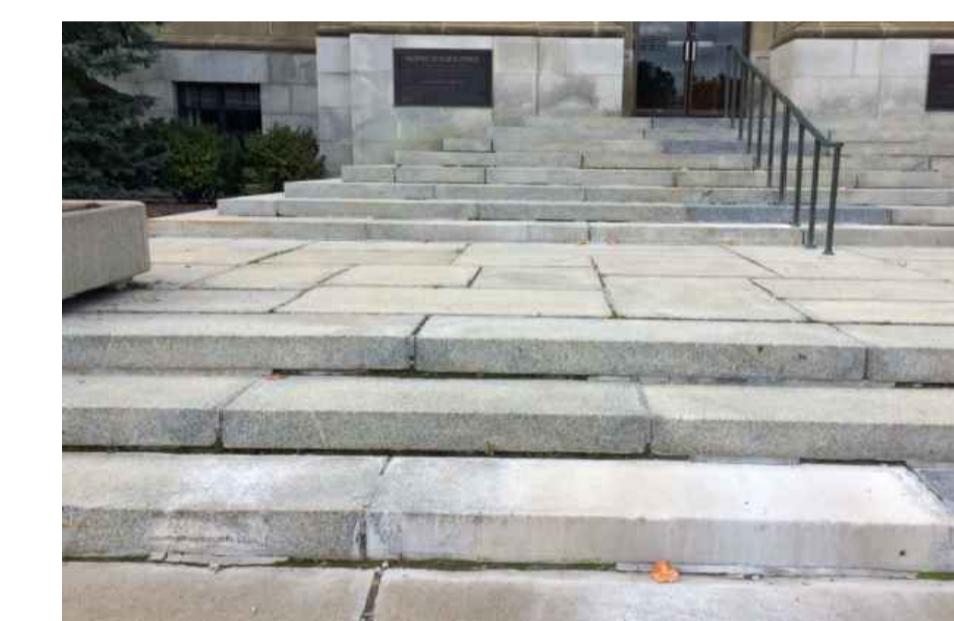

**2 G01** EXISTING VIEW @ FRONT STEPS  
 SCALE = N.T.S.

**KEY PLAN**

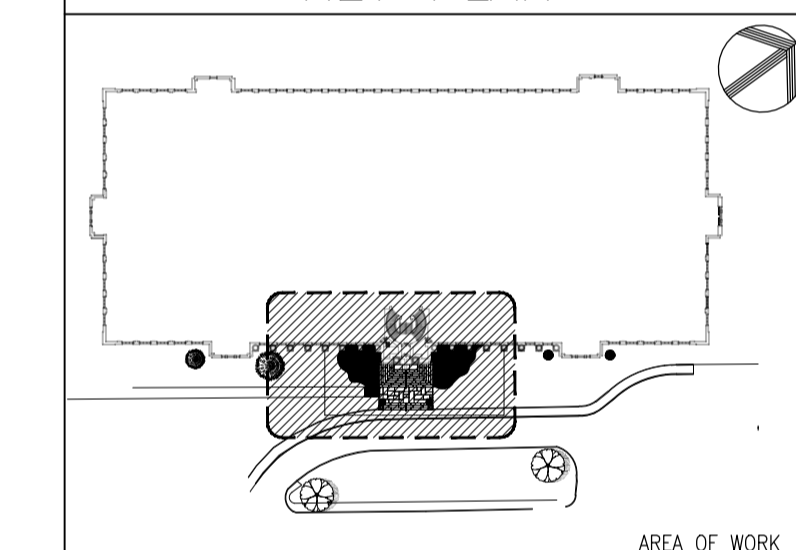

No.	Date	Revision	By: Parr.
0	JUNE 2018	ISSUED FOR TENDER	JL

Date Printed: \_\_\_\_\_ Date imprimée: \_\_\_\_\_

- Verify all dimensions and site conditions and be responsible for same
- Vérifier toutes les dimensions et l'état des lieux et en assumer la responsabilité

A	A Detail no. No. du détail	A
B	B Location drawing no. sur dessin no.	B
C	C Drawing no. dessin no.	C

project **S-77 FRONT STEPS REHABILITATION** projet

SUSSEX DRIVE CAMPUS  
 drawing PARTIAL SITE PLAN, DETAILS EXISTING CONDITIONS dessin

designed <b>CE</b>	conçu	date <b>MAY 2018</b>	date
drawn <b>CE</b>	dessiné	scale <b>AS NOTED</b>	échelle
checked <b>BL</b>	vérifié	sheet <b>2</b> of/de <b>5</b>	feuille
approved <b>AS</b>	approuvé	W.O.no.	D.T.no.

dwg.no. **5547-G01** dessin no.

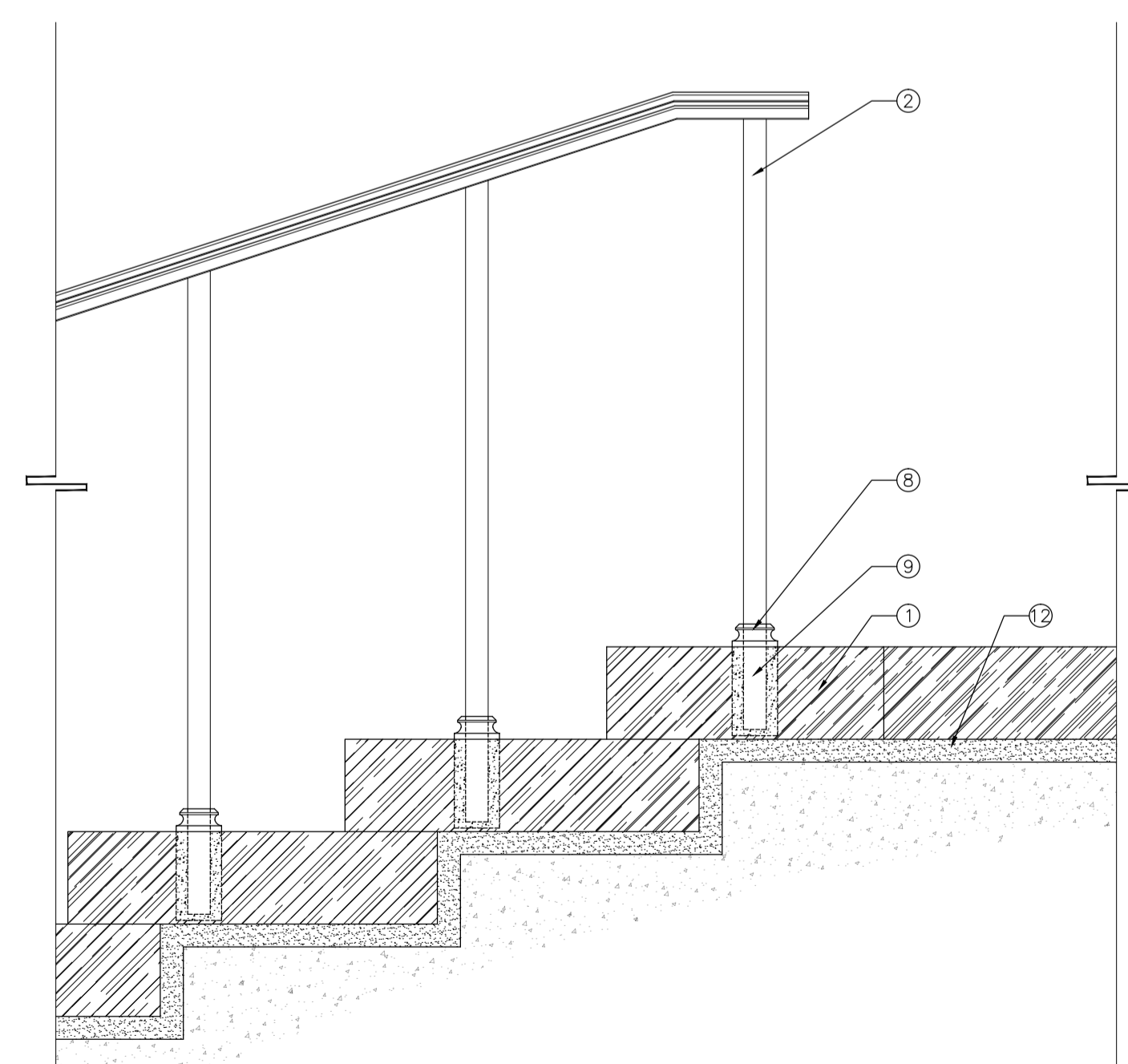

**3 G01** SECTION @ EXISTING STEP BLOCKS AND HANDRAIL  
 SCALE = 1:10



**4 G01** EXISTING VIEW @ FRONT STEPS  
 SCALE = N.T.S.



**5 G01** EXISTING VIEW @ FRONT STEPS  
 SCALE = N.T.S.



**6 G01** EXISTING VIEW @ FRONT STEPS  
 SCALE = N.T.S.



**7 G01** EXISTING VIEW @ FRONT STEPS  
 SCALE = N.T.S.



**8 G01** EXISTING VIEW @ FRONT STEPS  
 SCALE = N.T.S.



**9 G01** EXISTING VIEW @ FRONT STEPS  
 SCALE = N.T.S.

**GENERAL NOTES**

- CONTRACTORS TO CHECK AND VERIFY ALL DIMENSIONS ON SITE PRIOR TO DEMOLITION OR CONSTRUCTION AND REPORT ANY ERRORS OR OMISSIONS TO DEPARTMENTAL REPRESENTATIVE.
- CONTRACTORS MUST VISIT THE SITE & FULLY FAMILIARIZE THEMSELVES WITH THE SCOPE OF THE WORK.
- PREVENT THE SPREAD OF DUST & DEBRIS BEYOND THE WORK AREA AND CLEAN ALL SURFACES AT COMPLETION.
- MAKE GOOD ALL SURFACES AFFECTED BY THIS WORK.
- COORDINATE ALL SHUTDOWNS WITH THE DEPARTMENTAL REPRESENTATIVE.
- PROVIDE ALL LABOUR AND MATERIAL REQUIRED TO FORM A COMPLETE, FUNCTIONAL SYSTEM AS DESCRIBED ON DRAWINGS.

**DRAWING NOTES — SHEET G02**  
 THESE NOTES APPLY TO DRAWING SHEET G02 ONLY

- EXISTING GRANITE STEPS REINSTALLED TO EXISTING LOCATION ON NEW MANUFACTURED SAND AND MORTAR LEVELING BED. GRANITE STEP SECTIONS TO BE CLEANED AFTER INSTALLATION. REFER TO SPECIFICATIONS FOR MORE INFORMATION.
- EXISTING HANDRAIL RE-INSTALLED TO EXISTING LOCATION. HANDRAIL POSTS TO BE EMBEDDED IN CONCRETE PER ORIGINAL INSTALLATION. HAND WIPE CLEAN ALL BRONZE ELEMENTS; DO NOT REMOVE PATINA.
- EXISTING REINSTALLED PLANTER TO SAME LOCATION AS ORIGINAL.
- LIGHT STANDARD TO REMAIN. STONE BASE OF LIGHT STANDARD TO BE RE-POINTED PER SPECIFICATIONS.
- DENOTES LINE OF EXISTING CONCRETE FOUNDATION BELOW. ADJACENT SOFT LANDSCAPING TO BE RESTORED TO ORIGINAL CONDITION TO THE SATISFACTION OF NRC DEPARTMENTAL REPRESENTATIVE. SPECIES FOR SPECIES, LIKE FOR LIKE. RESTORATION TO INCLUDE RE-SODDING OF AREAS WITHIN WORK AREA AS REQUIRED.
- NEW ASPHALT SIDEWALK TO MATCH EXISTING REMOVED SECTION c/w NEW100MM MIN. GRANULAR B TYPE 2 COMPACTED TO 98% AGGREGATE FILL. ENSURE SMOOTH TRANSITION FROM NEW TO EXISTING SURFACES.
- NEW 38mm MORTAR BED.
- EXISTING CONCRETE FOUNDATION AND FILL.
- EXISTING STONE TO REMAIN.
- EXISTING GRANITE PAVERS REINSTALLED TO EXISTING LOCATION ON NEW MANUFACTURED SAND AND MORTAR LEVELING BED. GRANITE STEP SECTIONS TO BE CLEANED AFTER INSTALLATION. REFER TO SPECIFICATIONS FOR MORE INFORMATION.

**NOTE:**  
 EXISTING GRANITE STEP SLAB COURSE AND DIMENSIONS ARE REPRESENTATIVE OF LAYOUT ONLY. CONTRACTOR SHALL MEASURE AND PROVIDE FIELD VERIFIED DRAWING SHOWING EXISTING LAYOUT AND REINSTALLED LAYOUT FOR NRC DEPARTMENTAL REPRESENTATIVES' REVIEW PRIOR TO COMMENCING THE WORK.

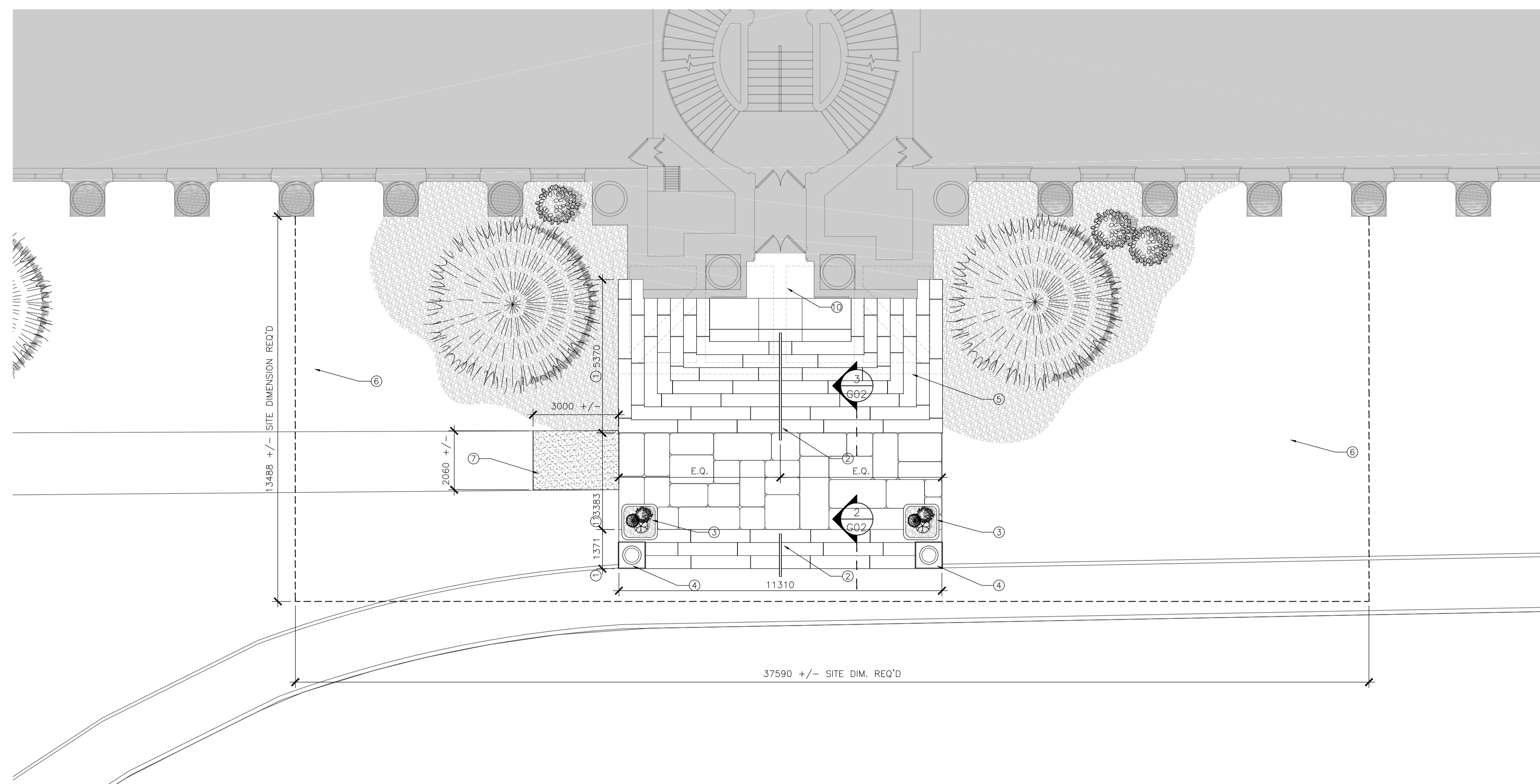

**1 PARTIAL PLAN — REINSTALLED ENTRANCE STEPS**  
 SCALE = 1:100

**KEY PLAN**

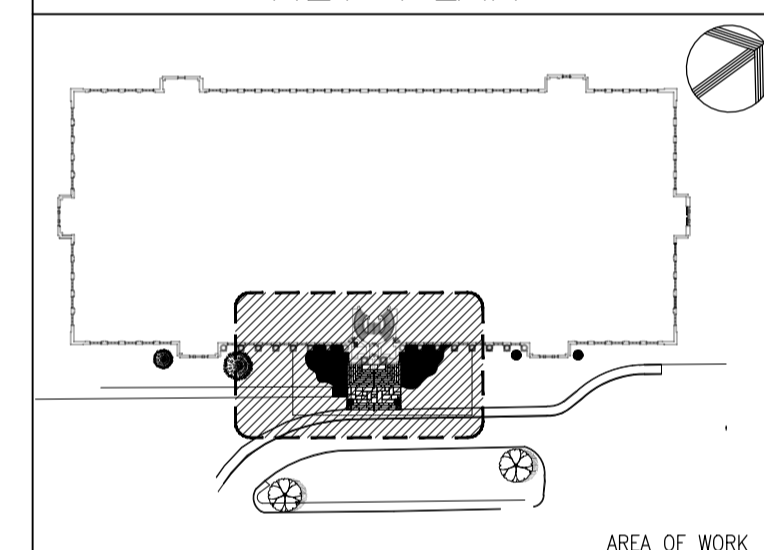

No.	Date	Revision	By: Parr.
0	JUNE 2018	ISSUED FOR TENDER	JL

Date Printed: \_\_\_\_\_ Date imprimée: \_\_\_\_\_

- Verify all dimensions and site conditions and be responsible for same
- Vérifier toutes les dimensions et l'état des lieux et en assumer la responsabilité

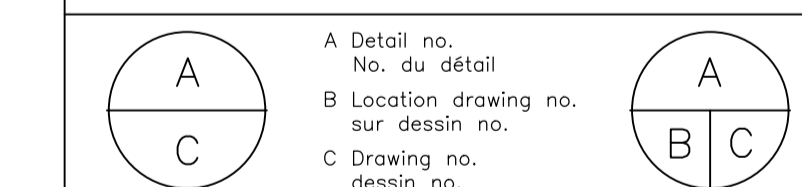

project **S-77 FRONT STEPS REHABILITATION** projet

SUSSEX DRIVE CAMPUS  
 drawing **PARTIAL SITE PLAN, DETAILS NEW WORK** dessin

designed <b>CE</b>	conçu	date <b>MAY 2018</b>	date
drawn <b>CE</b>	dessiné	scale <b>AS NOTED</b>	échelle
checked <b>BL</b>	vérifié	sheet <b>3</b> of/de <b>5</b>	feuille
approved <b>AS</b>	approuvé	W.O.no.	D.T.no.

dwg.no. **5547-G02** dessin no.

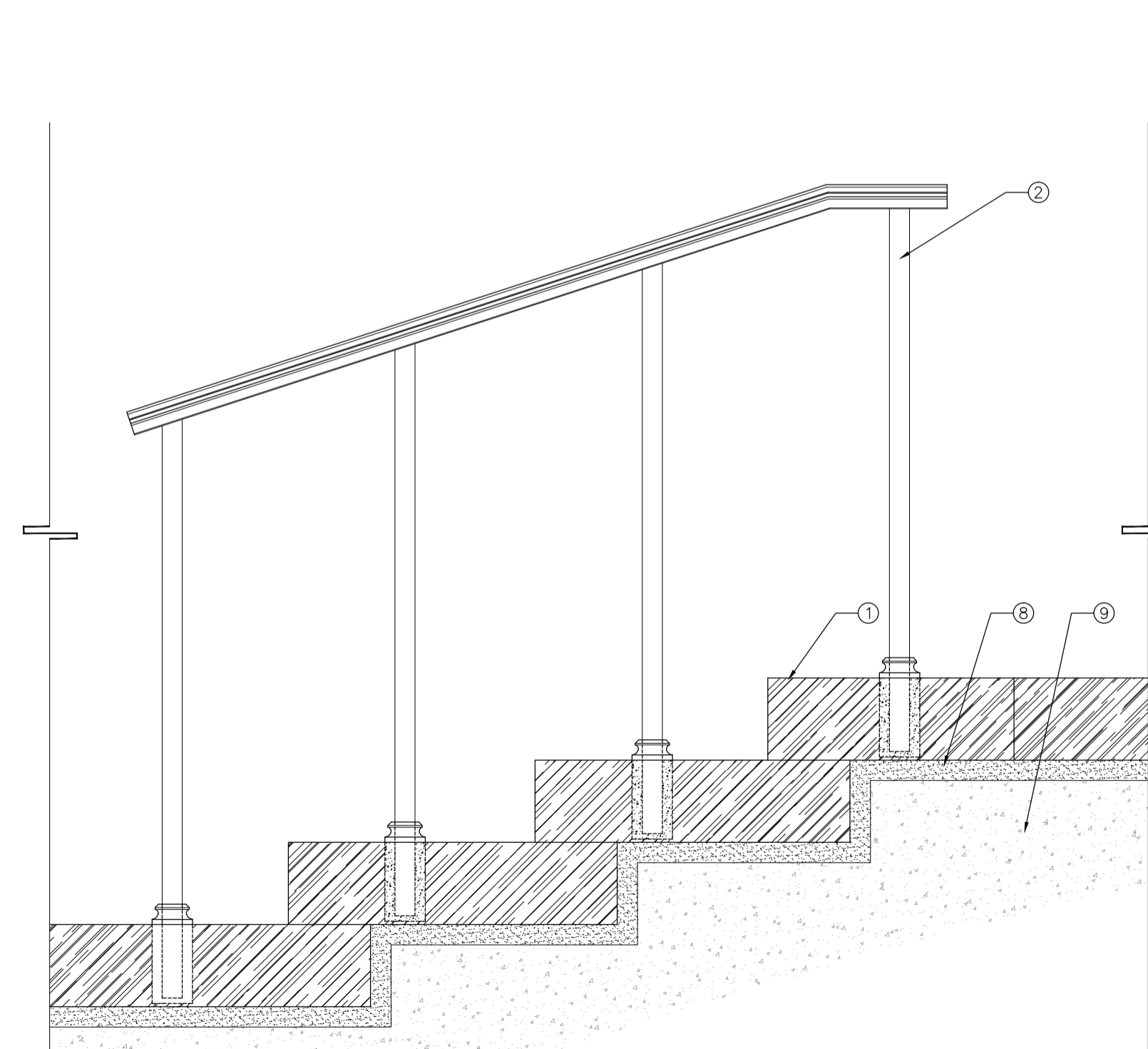

**2 SECTION @ RE-INSTALLED STEP BLOCKS AND HANDRAIL — LOWER LEVEL**  
 SCALE = 1:10

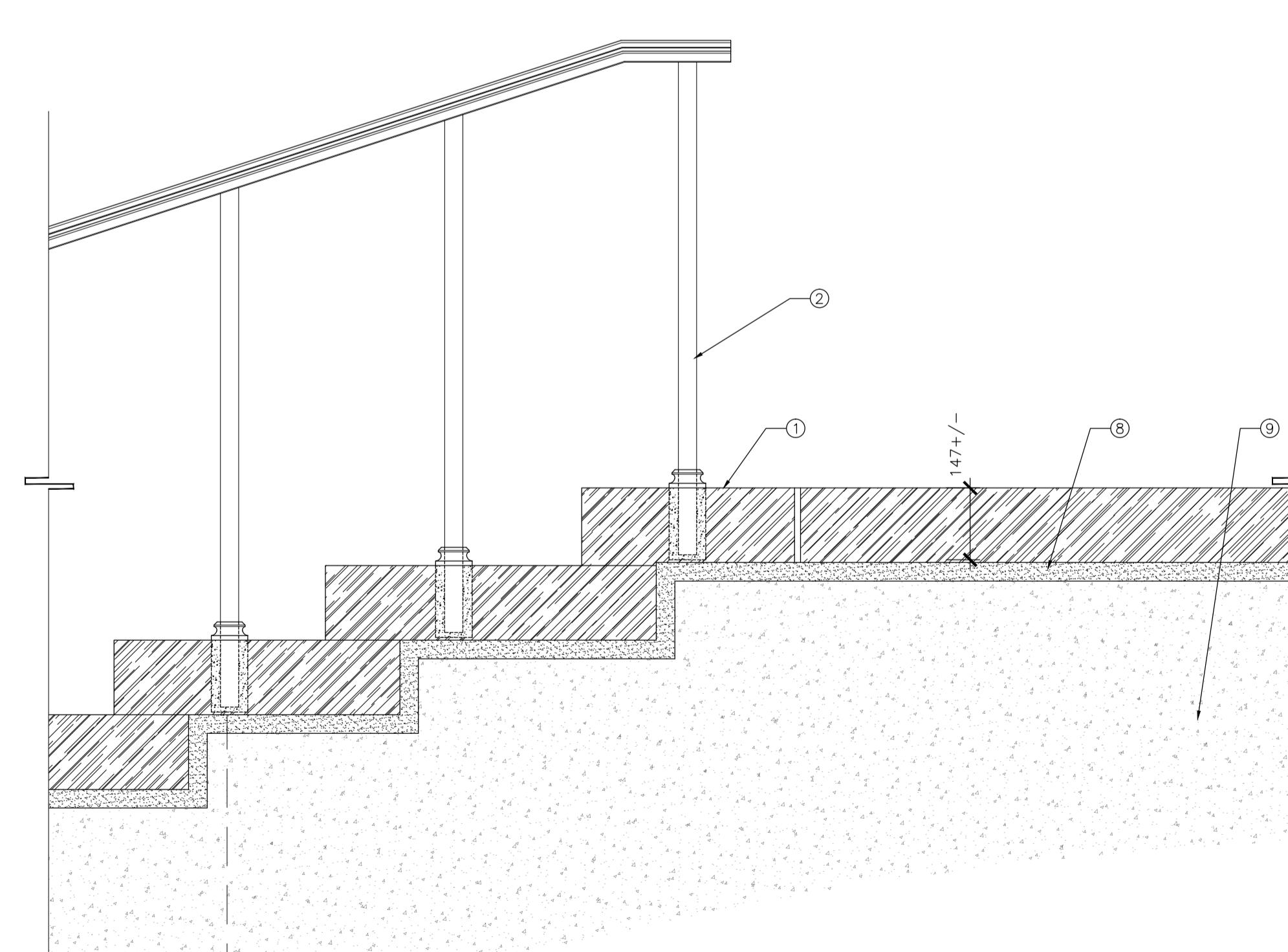

**3 SECTION @ RE-INSTALLED STEP BLOCKS AND HANDRAIL — UPPER LEVEL ON FOUNDATION**  
 SCALE = 1:10

C

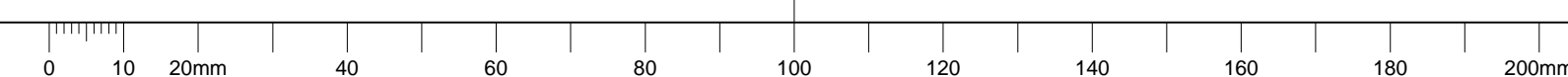

**GENERAL NOTES**

- CONTRACTORS TO CHECK AND VERIFY ALL DIMENSIONS ON SITE PRIOR TO DEMOLITION OR CONSTRUCTION AND REPORT ANY ERRORS OR OMISSIONS TO DEPARTMENTAL REPRESENTATIVE.
- CONTRACTORS MUST VISIT THE SITE & FULLY FAMILIARIZE THEMSELVES WITH THE SCOPE OF THE WORK.
- PREVENT THE SPREAD OF DUST & DEBRIS BEYOND THE WORK AREA AND CLEAN ALL SURFACES AT COMPLETION.
- MAKE GOOD ALL SURFACES AFFECTED BY THIS WORK.
- COORDINATE ALL SHUTDOWNS WITH THE DEPARTMENTAL REPRESENTATIVE.
- PROVIDE ALL LABOUR AND MATERIAL REQUIRED TO FORM A COMPLETE, FUNCTIONAL SYSTEM AS DESCRIBED ON DRAWINGS.

**KEY PLAN**

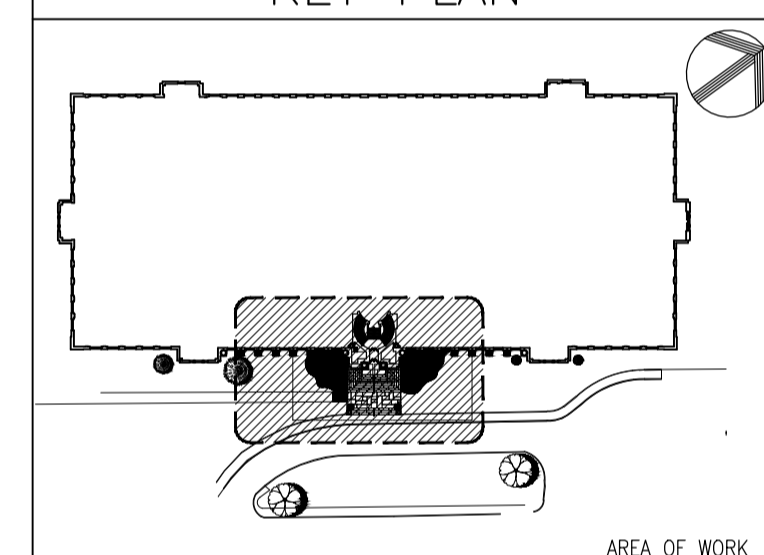

No.	Date	Revision	By: / Par:
0	JUNE 2018	ISSUED FOR TENDER	JL

Date Printed / Date imprimée

- Verify all dimensions and site conditions and be responsible for same
- Vérifier toutes les dimensions et l'état des lieux et en assumer la responsabilité

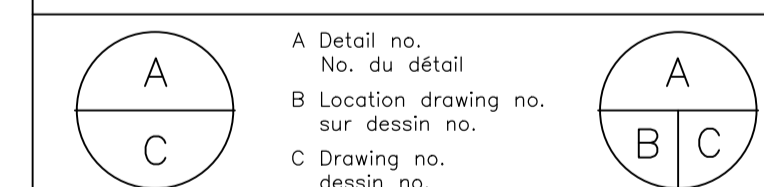

project / projet  
**S-77 FRONT STEPS REHABILITATION**

SUSSEX DRIVE CAMPUS / dessin

REFERENCE DETAILS

designed / conçu	date / date	<b>MAY 2018</b>	date / date
drawn / dessiné	scale / échelle	<b>AS NOTED</b>	échelle / échelle
checked / vérifié	sheet / feuille	<b>4 of/de 5</b>	feuille / feuille
approved / approuvé	W.O.no. / D.T.no.	<b>AS</b>	D.T.no. / D.T.no.

dwg.no. / dessin no.  
**5547-G03**

**GENERAL NOTES:**

- G.1 THE CONTRACTOR IS RESPONSIBLE TO VERIFY ALL DIMENSIONS AND SITE CONDITIONS. ADVISE THE ENGINEER OF ANY CONFLICT AND/OR OMISSIONS.
- G.2 ALL DIMENSIONS ARE IN MILLIMETERS UNLESS NOTED OTHERWISE. DO NOT SCALE THE DRAWINGS.
- G.3 ENTRANCE TO REMAIN ACCESSIBLE DURING NORMAL WORK HOURS. WORK TO BE CARRIED OUT IN TWO PHASES AS NOTED. WORK DIRECTLY IN FRONT OF ENTRANCE DOORS MUST BE CARRIED OUT OUTSIDE NORMAL WORK HOURS.

**STAIR NOTES:**

- ST.1 ELEVATIONS SHOWN ON THE DRAWINGS ARE TO BE VERIFIED ON SITE AT THE TIME OF CONSTRUCTION. RESET STEP STONES TO A CONSTANT RISE (AND RUN) IN ACCORDANCE WITH THE NATIONAL BUILDING CODE.
- ST.2 SLOPE TOP OF CONCRETE TOPPING AND ALL STONES WITH A 0.5% SLOPE AS SHOWN ON THE PLAN. PERFORM A DRAINAGE TEST AFTER CONCRETE TOPPING IS POURED TO ENSURE NO PONDING. PERFORM A SECOND DRAINAGE TEST AFTER STONE INSTALLATION IS COMPLETE. CONTRACTOR TO RESLOPE CONCRETE TOPPING AND/OR RESET STONES AS REQUIRED TO AVOID ANY PONDING.
- ST.3 THE UNDERSIDE OF THE STEP STONES ARE CUT STRAIGHT AND THE UNDERSIDE OF THE LANDING STONES ARE ROUGH CUT. THE MINORAL BEDDING MORTAR THICKNESS IS 38mm.
- ST.4 UNLESS OTHERWISE NOTED, ALL NEW STONE JOINTS ARE 8mm WIDE. SOME STONES MAY REQUIRE TO BE CUT TO FIT. SEE TABLE OF ADDITIONAL REPAIR FOR THE QUANTITIES OF STONE TO BE CUT TO BE INCLUDED IN THE CONTRACT. STONE CUTTING QUANTITY TO BE ADJUSTED AS NEEDED WITH UNIT RATES.
- ST.5 EXISTING HANDRAILS TO BE REMOVED CAREFULLY AND REINSTALLED AS DETAILED.

**CONCRETE NOTES:**

- C.1 ASSUME AVERAGE THICKNESS OF EXISTING CONCRETE REMOVAL IS 50mm. OVER THE WHOLE CONCRETE BASE.
- C.2 ASSUME AVERAGE THICKNESS OF CONCRETE NEW TOPPING TO BE 125mm ON THE WHOLE CONCRETE BASE. CONCRETE QUANTITY TO BE ADJUSTED AS NEEDED WITH UNIT RATES.
- C.3 IN AREAS WHERE THE CONCRETE TOPPING IS LESS THAN 65mm, SUBSTITUTE THE CONCRETE FOR POLYMER MODIFIED REPAIR MORTAR. CONCRETE AND POLYMER MODIFIED REPAIR MORTAR QUANTITIES TO BE ADJUSTED AS NEEDED WITH UNIT RATES.

**ELECTRICAL NOTES:**

- E.1 CONTRACTOR TO COORDINATE REPLACEMENT OF ORIGINAL WIRES AND CONDUITS FOR THE TWO LIGHT STANDARDS WITH THE DEPARTMENTAL REPRESENTATIVE.

**SODDING NOTES:**

- SO.1 LAY NEW SOD IN ALL AREAS AFFECTED BY THE WORK, INCLUDING STORAGE AREA.
- SO.2 PROTECT ALL PLANTS AND SHRUBS.

**ADDITIONAL REPAIRS (BEYOND WHAT IS SHOWN ON THE PLANS, ELEVATIONS AND DETAILS)**

- 1. FOR PRICING, ALLOW FOR THE ADDITIONAL QUANTITIES:
  - 1. REINFORCING STEEL REPLACEMENT, 20 LINEAR METERS OF 20M EPOXY COATED. SEE DETAIL D/S2.
  - 2. FRACTURE REPAIRS: 20 REPAIRS. ONE REPAIR CONSISTS OF TWO PINS AND HAS A STONE SURFACE DIMENSIONS OF 530mm WIDE BY 146mm HIGH.
  - 3. STONE CUTTING (NOTE S.4): 50 STONES. ONE STONE IS 530mm WIDE BY 146mm HIGH.
  - 4. STONE REPLACEMENT: 5 STEP STONES (1800mm x 530mm x 146mm) 5 LANDING STONES (1200mm x 1000mm x 146mm)

**GENERAL PROCEDURES:**

- GP.1 PROVIDE HOARDING AND PREPARE SITE FOR START OF WORK.
- GP.2 LABEL ALL THE STONES, AND NOTE LOCATION OF ALL HANDRAILS, PLANTERS, LIGHT STANDARDS, ETC. TO ALLOW RE-INSTALLATION AT THE SAME LOCATIONS AS EXISTING.
- GP.3 REMOVE THE TWO HANDRAILS, THE TWO PLANTERS, THE TWO LIGHT STANDARDS, AND THE TWO BASES FOR THE LIGHTS. DISCONNECT THE ELECTRICAL WIRES FOR THE LIGHTS. COORDINATE WITH DEPARTMENTAL REPRESENTATIVE TO DISCONNECT WIRES FROM INSIDE THE BUILDING.
- GP.4 REMOVE ALL STONES. USE CARE NOT TO DAMAGE THE STONE. NOTIFY DEPARTMENTAL REPRESENTATIVE IMMEDIATELY IF STONES ARE DAMAGED. STONE DAMAGED BY THE CONTRACTOR MUST BE REPLACED AT CONTRACTOR'S COST.
- GP.5 REMOVE AND DISPOSE OF THE EXISTING BEDDING MATERIAL. BEDDING MATERIAL CONSISTS MAINLY OF MORTAR REDUCED TO SAND. APPROXIMATE THICKNESS OF BEDDING MATERIAL IS 75mm. IF CONDUITS AND WIRES FOR THE LIGHT STANDARDS ARE EXPOSED, REMOVE THEM AND DISPOSE OF THEM.
- GP.6 REMOVE AND DISPOSE OF ALL UNSOUND CONCRETE ON THE EXISTING CONCRETE BASE STRUCTURE. ASSUME AVERAGE DEPTH OF CONCRETE REMOVAL TO BE 50MM ON THE WHOLE CONCRETE BASE STRUCTURE. CLEAN ALL EXPOSED REBAR AND PER DETAIL D/S2. ALLOW FOR REPLACING DETERIORATED REINFORCING STEEL. SEE TABLE OF ADDITIONAL REPAIR FOR THE QUANTITY OF REINFORCING STEEL REPLACEMENT TO BE INCLUDED IN THE CONTRACT.
- GP.7 DETERMINE LAYOUT, PROFILE, SLOPE AND ELEVATION OF THE NEW CONCRETE TOPPING AND CURBS.
- GP.8 INSTALL NEW CONDUIT AND WIRES FOR THE LIGHT STANDARDS.
- GP.9 APPLY BONDING AGENT, AS PER MANUFACTURER'S INSTRUCTIONS ON THE WHOLE CONCRETE STRUCTURE PRIOR TO POURING THE CONCRETE TOPPING.
- GP.11 POUR CONCRETE TOPPING AND CURBS. WET CURE FOR 7 DAYS MINIMUM.
- GP.12 EXCAVATE AND INSTALL FOUNDATION FOR LIGHT STANDARD AS DETAILED.
- GP.13 RESET STONES, BACKPOINT AND FINISH POINT.
- GP.14 RE-INSTALL THE TWO HANDRAILS, THE TWO PLANTERS, THE TWO BASES FOR THE LIGHTS AND THE TWO LIGHT STANDARDS. RECONNECT THE WIRES FOR THE LIGHT STANDARDS.
- GP.15 CLEAN SITE.
- GP.16 REMOVE FENCE AND REOPEN THE MAIN ENTRANCE.

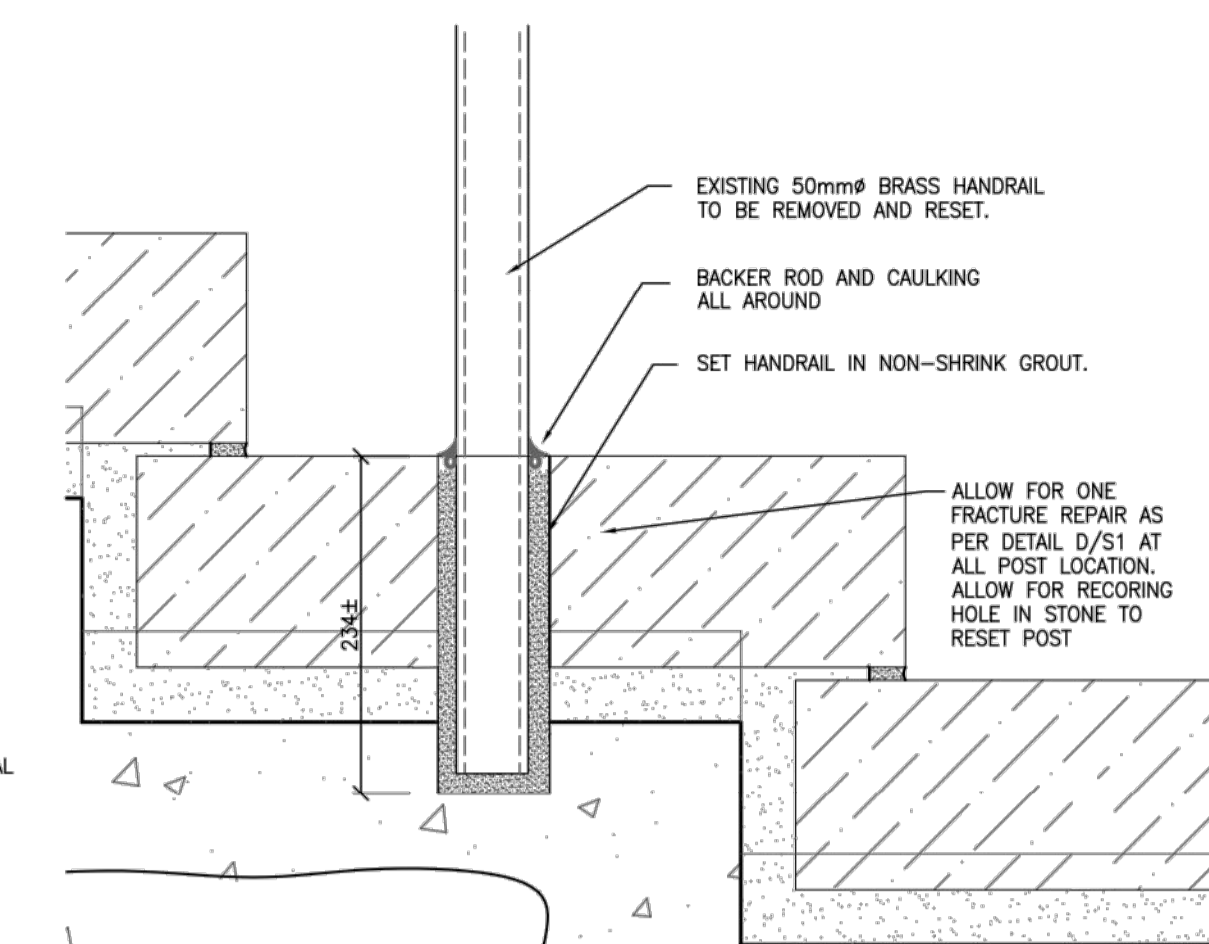
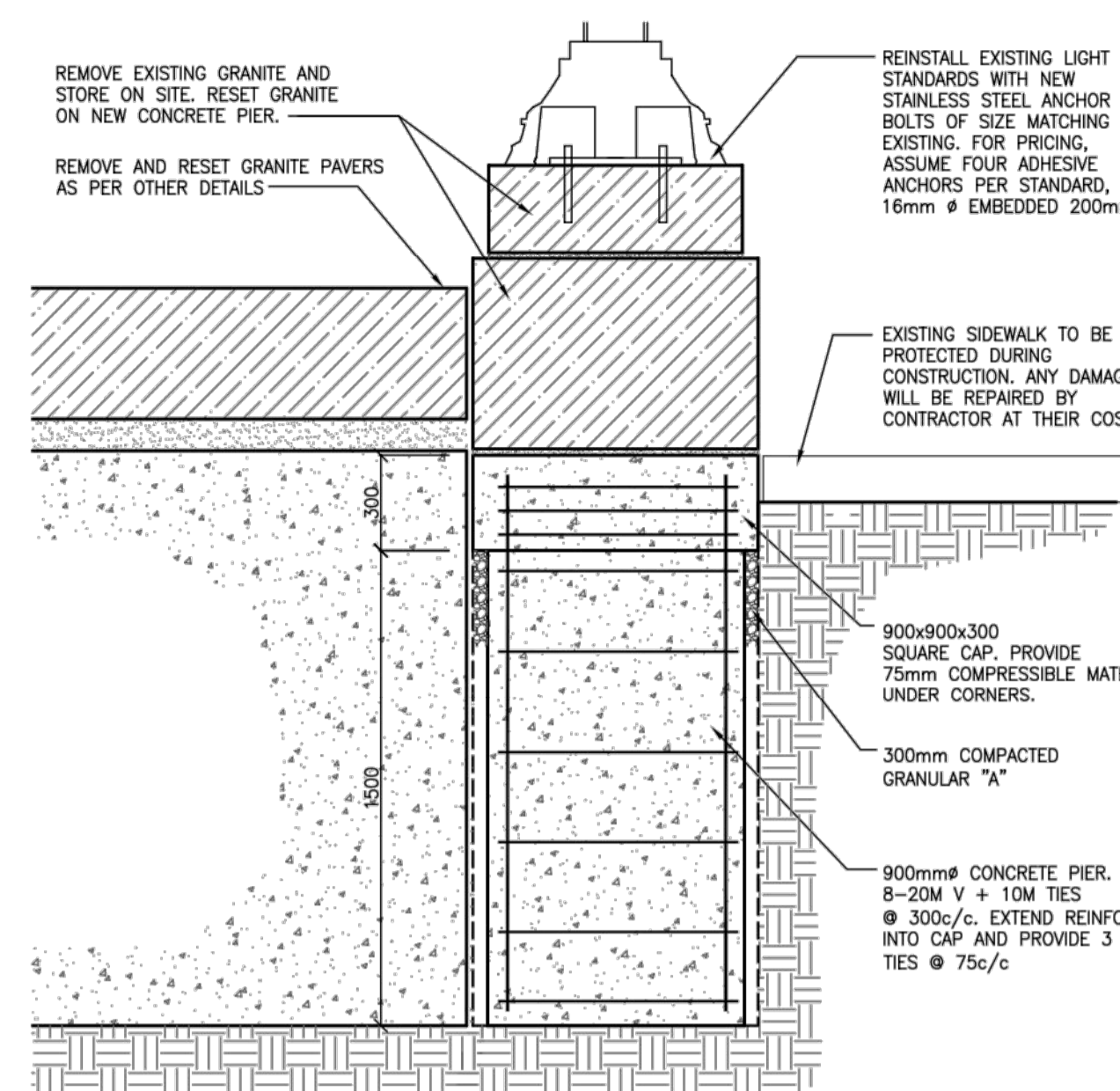

**DETAIL B**  
 S1 SCALE: 1:5

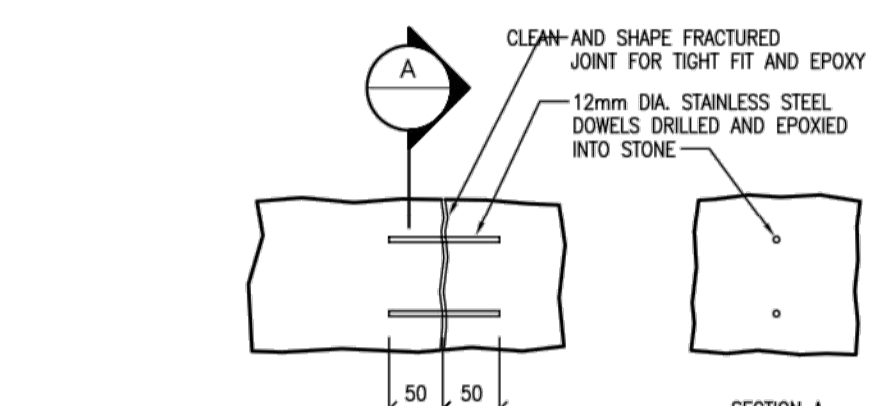

- FRACTURED STONE REPAIR PROCEDURE:**
- REMOVE FRACTURED STONE WITHOUT LOSING PIECES OR WORSENING DAMAGE OR DAMAGING ADJACENT UNITS
  - DRILL 13mm Ø HOLES, 60mm LONG IN EACH SECTION, SPACED AT 300 O.C. MAXIMUM. HOLES MUST BE CENTRED IN STONE THICKNESS.
  - INSERT 12mm Ø STAINLESS STEEL DOWELS, 100mm LONG AND APPLY EPOXY ADHESIVE. GLUE STONE FACES TOGETHER USING EPOXY ADHESIVE, OR APPROVED GROUT. LET SET FOR 24 HOURS MAXIMUM.
  - REINSTATE REPAIRED STONE INTO WORK AND REPOINT WITH SPECIFIED MORTAR TO WITHIN 50mm OF POINTING SURFACE. ALLOW MORTAR TO SET 24 HOURS. POINT TO SURFACE IN TWO LAYERS.
  - GROUT SOLID ALL VOIDS BEHIND STONE USING SPECIFIED GROUT.
  - REPAIR SURFACE OF FRACTURE AS SPECIFIED TO MATCH THE SURROUNDING STONE, AND TOOL FOR TEXTURE.

**DETAIL C**  
 S1 SCALE: 1:5

**DETAIL D FRACTURED STONE REPAIR**  
 S1 NTS

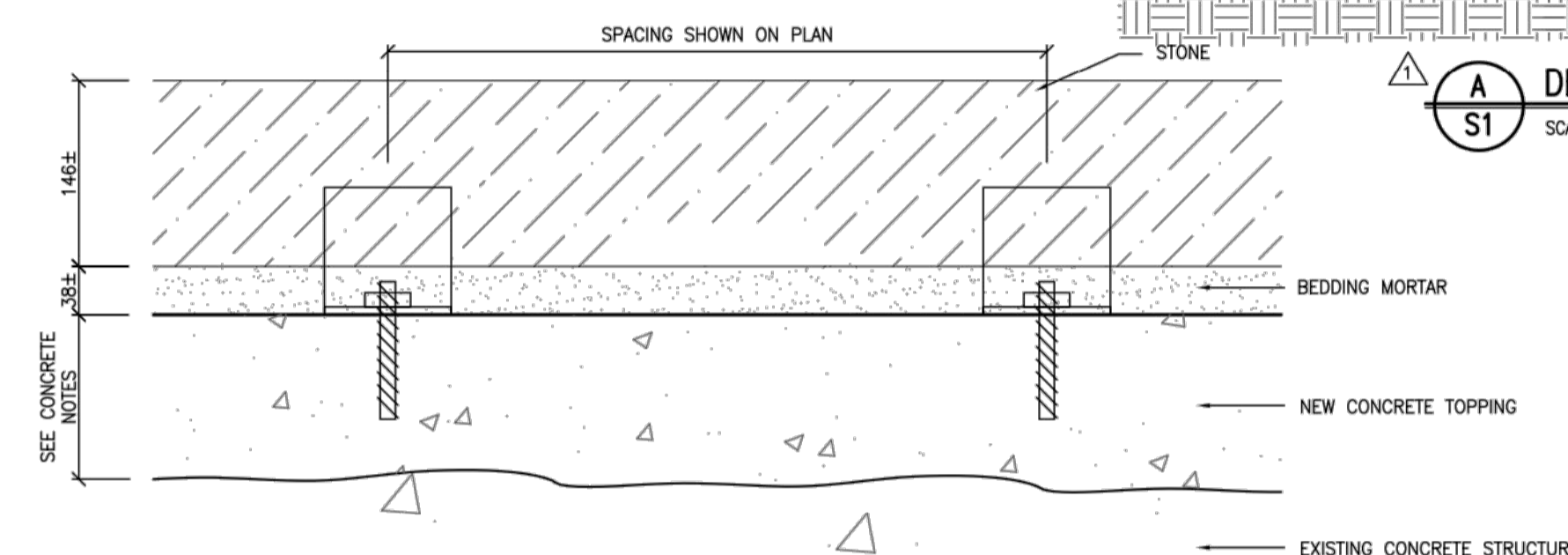

**DETAIL A**  
 S1 SCALE: 1:20

**DETAIL C**  
 S1 SCALE: 1:5

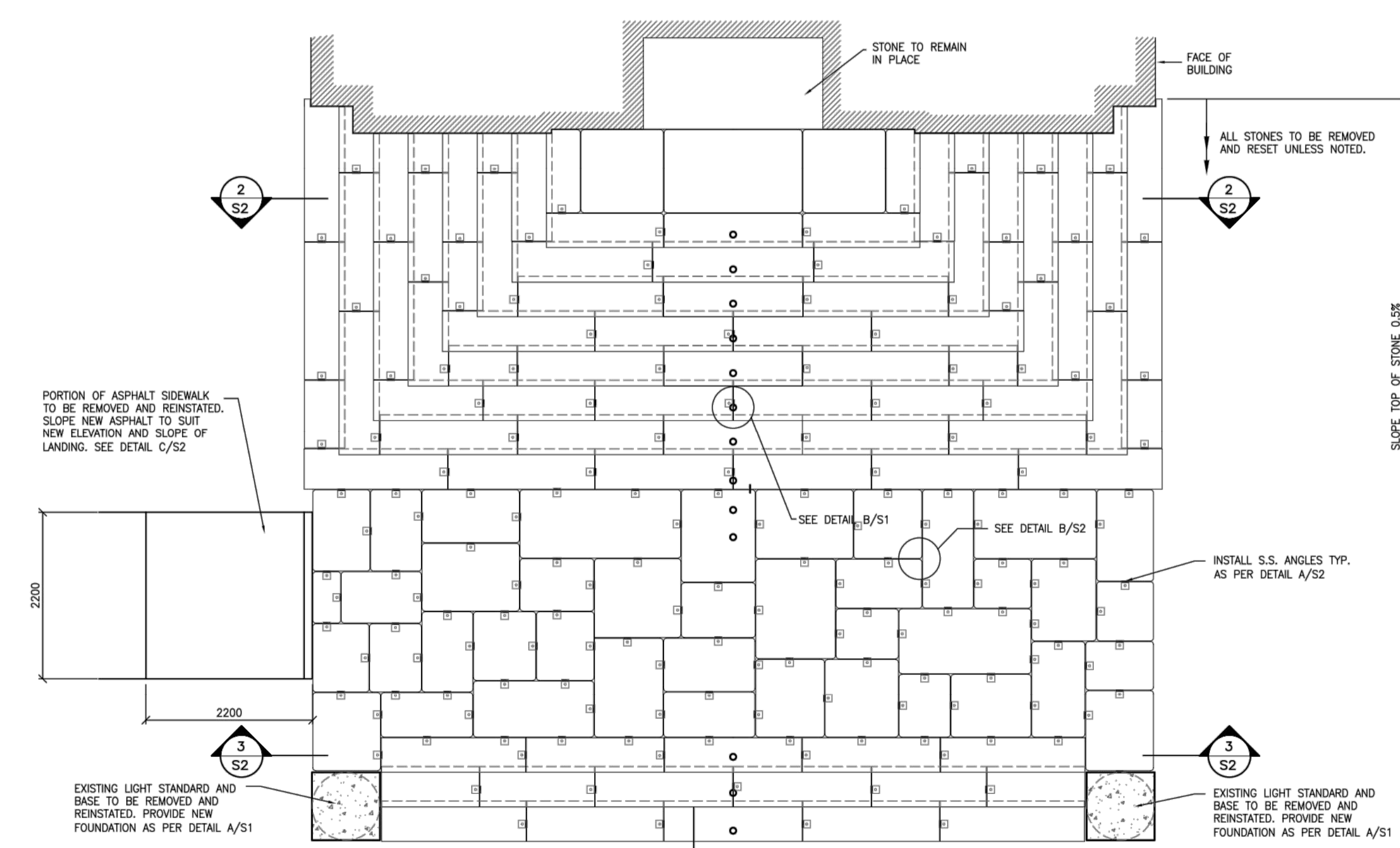

**1 PLAN - STONE**  
 S1 SCALE: 1:50

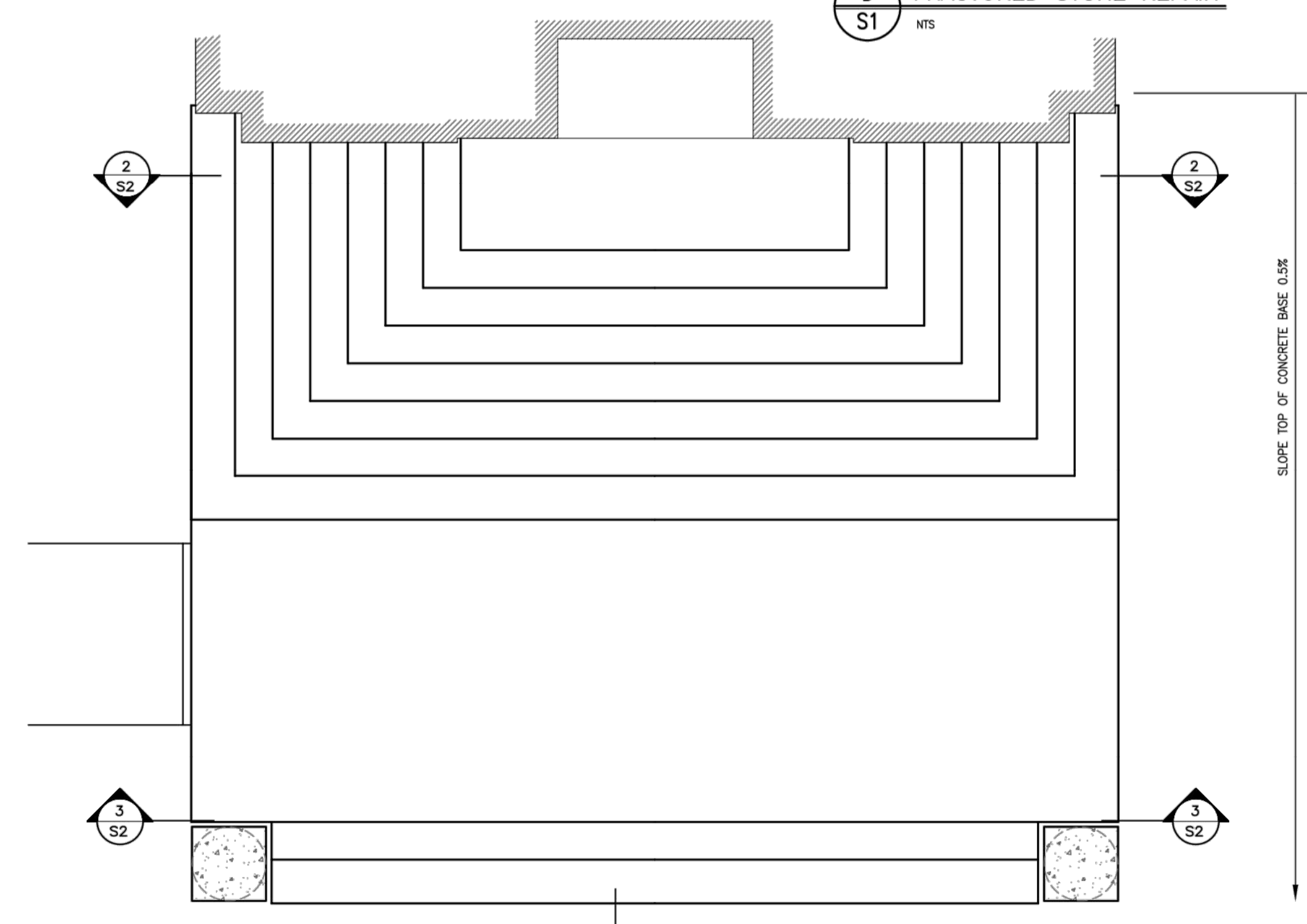

**2 PLAN - CONCRETE BASE**  
 S1 SCALE: 1:50

**NOTE:**  
 THIS DRAWING IS OF PREVIOUS CONSTRUCTION AND IS MEANT TO BE USED FOR REFERENCE ONLY.

**GENERAL NOTES**

- CONTRACTORS TO CHECK AND VERIFY ALL DIMENSIONS ON SITE PRIOR TO DEMOLITION OR CONSTRUCTION AND REPORT ANY ERRORS OR OMISSIONS TO DEPARTMENTAL REPRESENTATIVE.
- CONTRACTORS MUST VISIT THE SITE & FULLY FAMILIARIZE THEMSELVES WITH THE SCOPE OF THE WORK.
- PREVENT THE SPREAD OF DUST & DEBRIS BEYOND THE WORK AREA AND CLEAN ALL SURFACES AT COMPLETION.
- MAKE GOOD ALL SURFACES AFFECTED BY THIS WORK.
- COORDINATE ALL SHUTDOWNS WITH THE DEPARTMENTAL REPRESENTATIVE.
- PROVIDE ALL LABOUR AND MATERIAL REQUIRED TO FORM A COMPLETE, FUNCTIONAL SYSTEM AS DESCRIBED ON DRAWINGS.

**KEY PLAN**

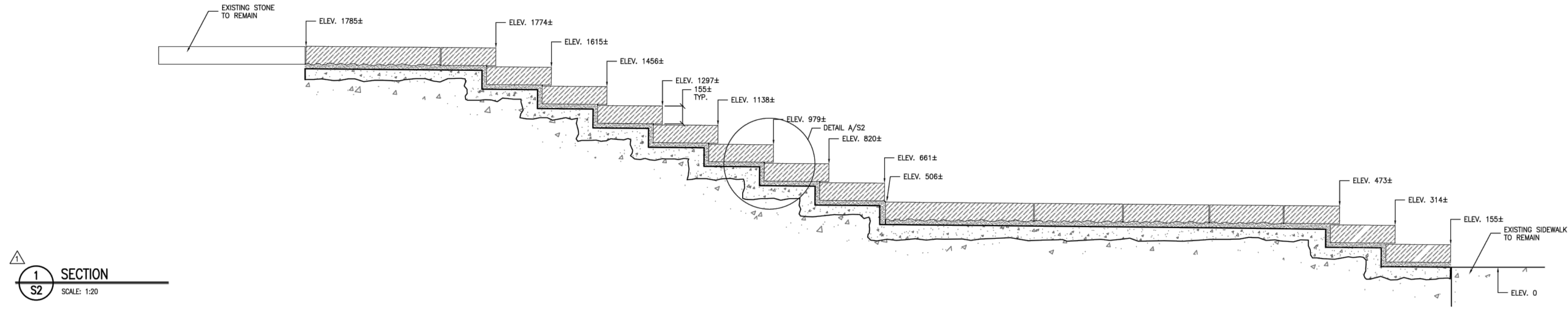
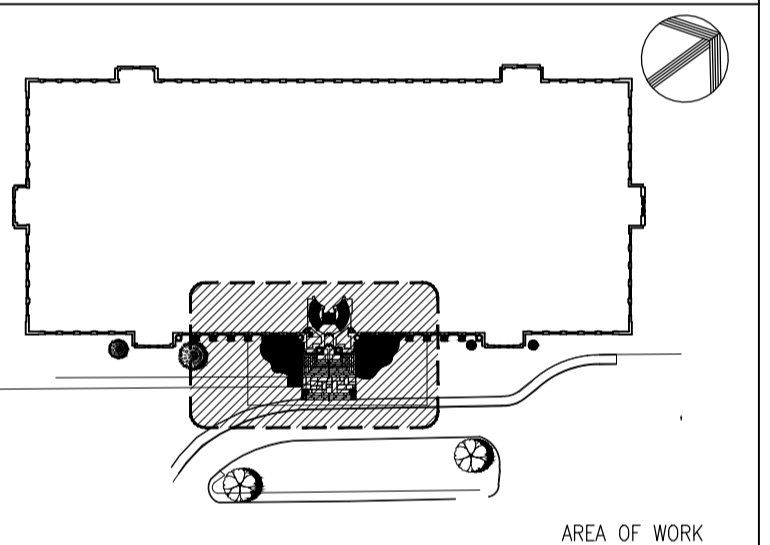

**SECTION 1**  
SCALE: 1:20

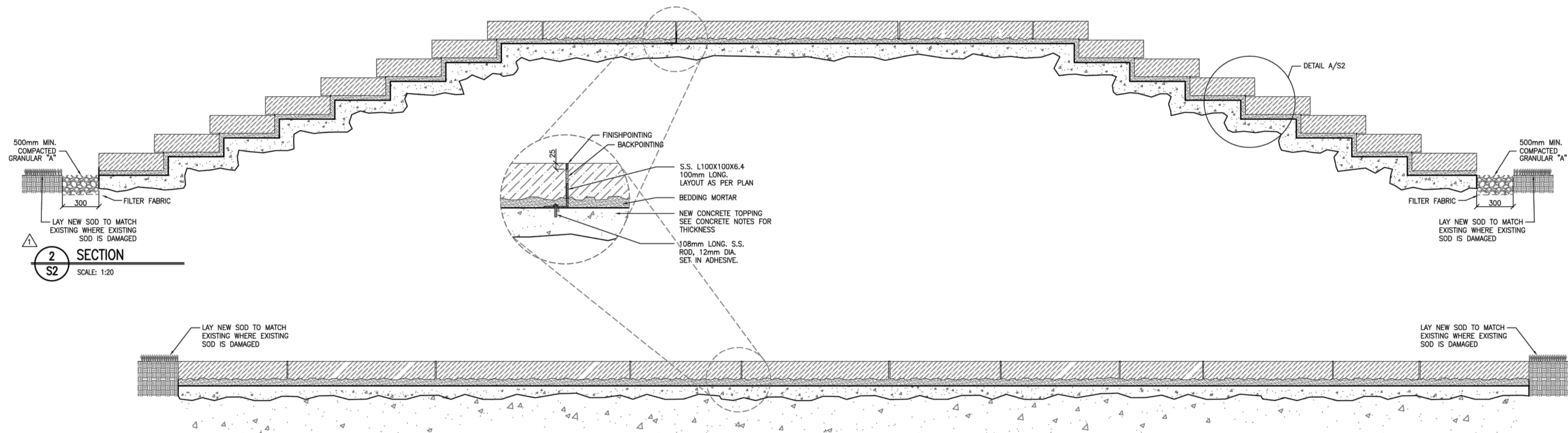

**SECTION 2**  
SCALE: 1:20

**SECTION 3**  
SCALE: 1:20

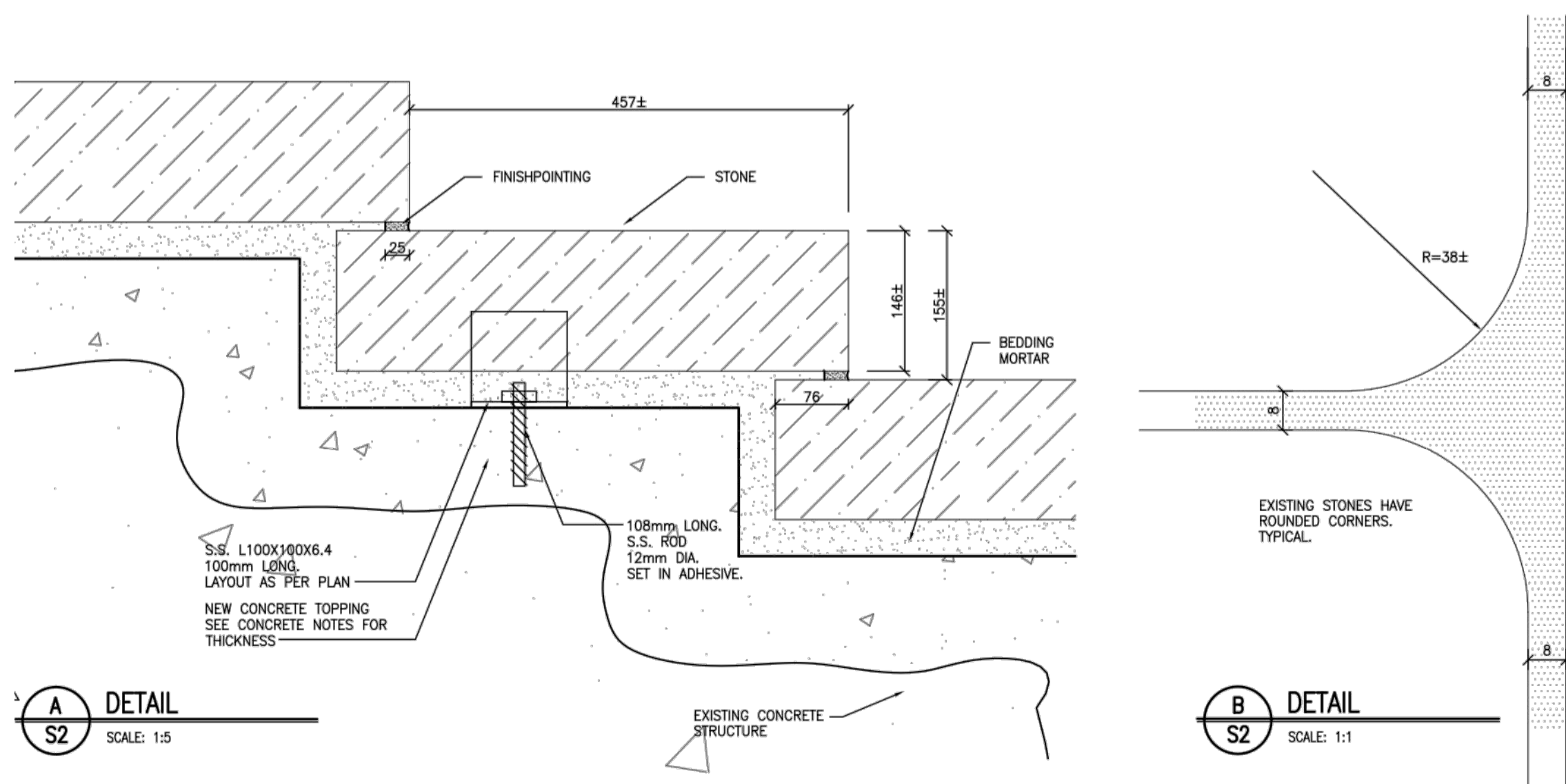

**DETAIL A**  
SCALE: 1:5

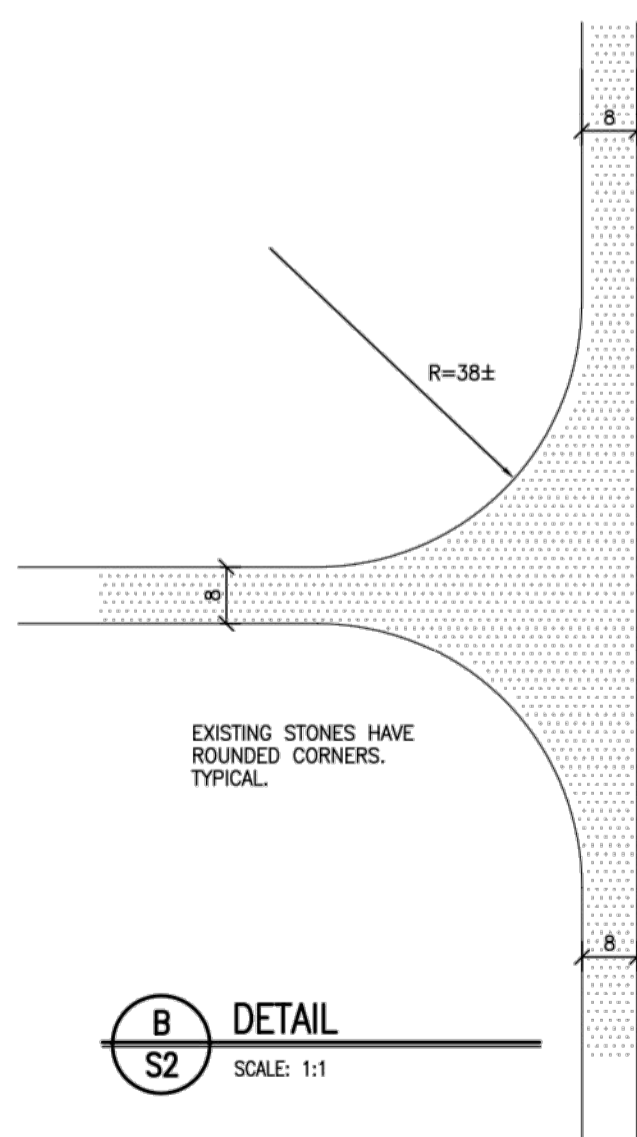

**DETAIL B**  
SCALE: 1:1

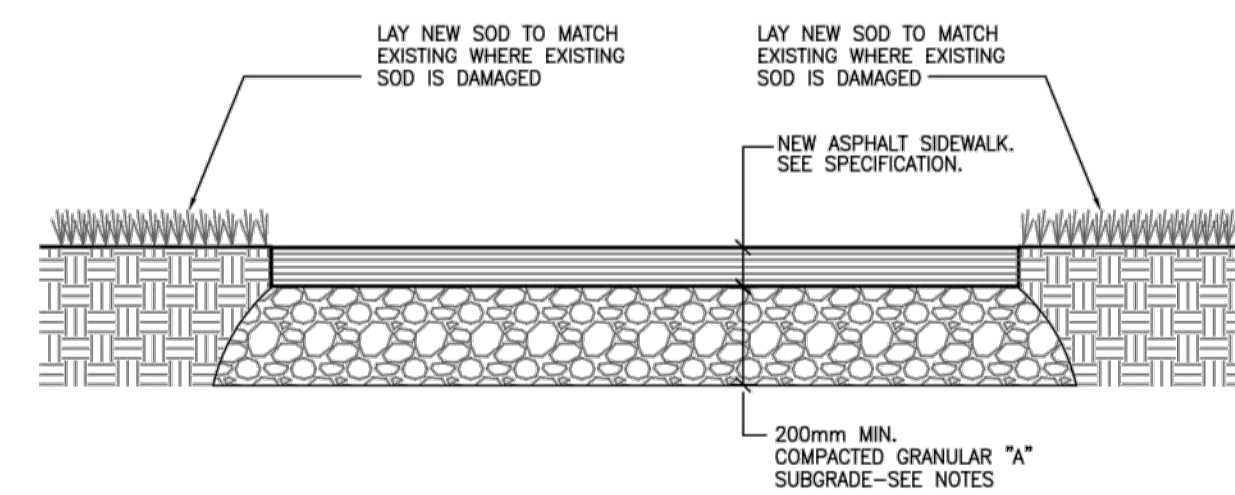

**DETAIL C**  
SCALE: N.T.S.

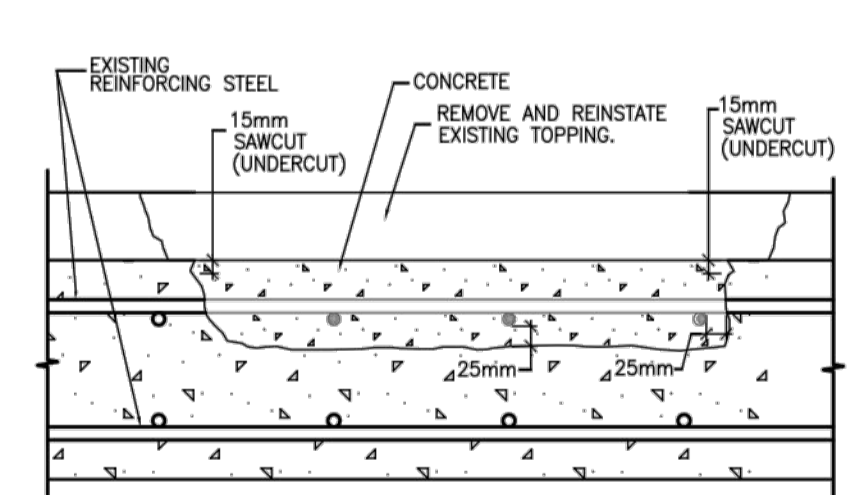

**DETAIL D**  
SCALE: N.T.S.

- NOTES**
- ALL UNDERGROUND SERVICES MUST BE LOCATED AND MARKED PRIOR TO STARTING THE WORK. ALL EXPOSED SERVICES MUST BE ADEQUATELY PROTECTED UNTIL WORK IS COMPLETE.
  - REMOVE EXISTING ASPHALT SIDEWALK FOR FULL DEPTH, WHERE REQUIRED TO PERFORM THE WORK. DISPOSE OF MATERIAL OFF SITE.
  - CONFIRM EXISTING GRANULAR SUB-GRADE TYPE AND DEPTH. ALLOW FOR REMOVAL OF EXISTING SUB-GRADE AND INSTALLATION OF 200mm Dp. GRANULAR "A" SUB-GRADE COMPACTED TO 95% S.P.D.
  - PLACE ASPHALT AS PER SPECIFICATION. INSTALL 12mm ASPHALT IMPREGNATED FIBREBOARD WHERE NEW ASPHALT IS ADJACENT TO STONE MASONRY
  - CONTRACTOR MUST ENSURE PEDESTRIAN SAFETY DURING THE WORK. ERECT AND MAINTAIN SUITABLE BARRICADES AT EACH END OF THE WORK AND LEAVE IN PLACE UNTIL CURING PROCESS IS COMPLETE.

- NOTES:**
- SAWCUT PERIMETER OF THE REPAIR AREA. (DO NOT CUT EXISTING BARS)
  - REMOVE ALL LOOSE & UNSOUND CONCRETE IN THE DELAMINATED AREA TO A UNIFORM MINIMUM DEPTH OF 25mm BELOW THE LOWER LAYER OF TOP REINFORCING STEEL. BEGIN REMOVAL IN THE MIDDLE OF REPAIR AREA. NOTIFY DEPARTMENTAL REPRESENTATIVE IF MORE THAN 50% OF SLAB THICKNESS HAS TO BE REMOVED. EXPOSE EXISTING REINFORCING AT LEAST 50mm BEYOND POINT AT WHICH BARS ARE FREE OF ANY CORROSION.
  - RE-TIE OR WELD EXPOSED REINFORCING STEEL AS DIRECTED BY THE ENGINEER.
  - REINFORCE BADLY CORRODED OR DAMAGED REINFORCING STEEL AS DIRECTED BY THE DEPARTMENTAL REPRESENTATIVE.
  - GRIT-BLAST THE CONCRETE SUBSTRATE AND EXPOSED REINFORCING STEEL TO REMOVE ALL RUST DEPOSITS FROM THE REINFORCING STEEL, & ALL LOOSE OR FRACTURED CONCRETE FROM THE CONCRETE SUBSTRATE.
  - CLEAN AREA OF REPAIR. REQUEST INSPECTION BY DEPARTMENTAL REPRESENTATIVE.
  - COAT CONCRETE AND EXPOSED REINFORCING STEEL WITH BONDING AGENT
  - SUPPLY AND PLACE CONCRETE OR POLYMER MODIFIED REPAIR MORTAR AS NOTED
  - FINISH AND WET CURE FOR 7 DAYS.

**NOTE:**  
THIS DRAWING IS OF PREVIOUS CONSTRUCTION AND IS MEANT TO BE USED FOR REFERENCE ONLY.

0	JUNE 2018	ISSUED FOR TENDER	JL
No.	Date	Revision	By: Parr

Date Printed: \_\_\_\_\_ Date imprimée: \_\_\_\_\_

- Verify all dimensions and site conditions and be responsible for same
- Vérifier toutes les dimensions et l'état des lieux et en assumer la responsabilité

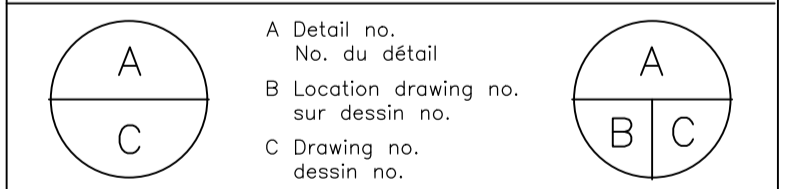

project: **S-77 FRONT STEPS REHABILITATION**

drawing: **SUSSEX DRIVE CAMPUS**

REFERENCE DETAILS

designed	conçu	date	<b>MAY 2018</b>	date
drawn	dessiné	scale	<b>AS NOTED</b>	échelle
checked	vérifié	sheet	<b>5 of/de 5</b>	feuille
approved	approuvé	W.O.no.		D.T.no.
	<b>AS</b>			
dwg.no.	<b>5547-G04</b>			dessin no.