



RETURN BIDS TO:

RETOURNER LES SOUMISSIONS À:

**Bid Receiving - PWGSC / Réception des soumissions -
TPSGC**

11 Laurier St. / 11, rue Laurier

Place du Portage, Phase III

Core 0B2 / Noyau 0B2

Gatineau, Québec K1A 0S5

Bid Fax: (819) 997-9776

**SOLICITATION AMENDMENT
MODIFICATION DE L'INVITATION**

The referenced document is hereby revised; unless otherwise indicated, all other terms and conditions of the Solicitation remain the same.

Ce document est par la présente révisé; sauf indication contraire, les modalités de l'invitation demeurent les mêmes.

Comments - Commentaires

THIS DOCUMENT CONTAINS A SECURITY
REQUIREMENT / DOCUMENT CONTIENT DES
EXIGENCES RELATIVES À LA SÉCURITÉ

Vendor/Firm Name and Address

**Raison sociale et adresse du
fournisseur/de l'entrepreneur**

Issuing Office - Bureau de distribution

Electrical & Electronics Products Division
11 Laurier St./11, rue Laurier
7B3, Place du Portage, Phase III
Gatineau, Québec K1A 0S5

Title - Sujet Audio-Visual Technology	
Solicitation No. - N° de l'invitation W8474-197662/A	Amendment No. - N° modif. 002
Client Reference No. - N° de référence du client 6000436037	Date 2018-07-09
GETS Reference No. - N° de référence de SEAG PW-\$\$HN-331-74963	
File No. - N° de dossier hn331.W8474-197662	CCC No./N° CCC - FMS No./N° VME
Solicitation Closes - L'invitation prend fin at - à 02:00 PM on - le 2018-07-24	Time Zone Fuseau horaire Eastern Daylight Saving Time EDT
F.O.B. - F.A.B. Plant-Usine: <input type="checkbox"/> Destination: <input checked="" type="checkbox"/> Other-Autre: <input type="checkbox"/>	
Address Enquiries to: - Adresser toutes questions à: Turner, Louie	Buyer Id - Id de l'acheteur hn331
Telephone No. - N° de téléphone (873) 469-3342 ()	FAX No. - N° de FAX () -
Destination - of Goods, Services, and Construction: Destination - des biens, services et construction:	

Instructions: See Herein

Instructions: Voir aux présentes

Delivery Required - Livraison exigée	Delivery Offered - Livraison proposée
Vendor/Firm Name and Address Raison sociale et adresse du fournisseur/de l'entrepreneur	
Telephone No. - N° de téléphone Facsimile No. - N° de télécopieur	
Name and title of person authorized to sign on behalf of Vendor/Firm (type or print) Nom et titre de la personne autorisée à signer au nom du fournisseur/ de l'entrepreneur (taper ou écrire en caractères d'imprimerie)	
Signature	Date

Amendment # 2 is issued to answer potential bidder's questions which included the site visit questions.

Question # 1:

Please provide further information regarding the new desks being provided.

Answer # 1:

Please see updated Appendix B to Annex B – Drawing Package with additional information showing the latest desk and floor conceptual design. Enclosed herein are specs of the desks provided by CANADA.

Stationary Console Linear HD



Description

The Focus Series Stationary Consoles HD are built for control room applications with a great quantity of IT equipment. The heavy-duty back wall system allows to support workspaces while offering maximum knee space to the users. All accessories such as monitor arms, task lamps, shelves, and monuments are supported on the 36" high slabwall, offering a clutter-free workspace. The Focus Series Stationary Consoles HD are equipped with CPU cabinets, offering all the necessary space to house CPUs side by side on a sliding shelf. Built to offer maximum modularity, the Focus System will allow management of a great quantity of IT equipment, cables and monitors.

Technical Specifications Configuration List Downloads

- ✓ Heavy-duty Wall system Structure
- ✓ Ergonomic console for maximum user satisfaction
- ✓ Computer enclosure with sliding shelf (front and back of the wall system)
- ✓ Integrated cable management for easy access
- ✓ Low and high voltage cable separation
- ✓ Equipped to support LCD Arms on the Statwall system
- ✓ HPL workspaces with reinforced metal studs
- ✓ Tool less removable panels at the back or front of the station
- ✓ Modular System allowing future reconfiguration
- ✓ Customizable to your needs
- ✓ Wide variety of workspaces edgings
- ✓ Wide variety of colors and finishes
- ✓ Optional Retractable Monument for easy and quick access

Stationary Console Linear HD



• • •

Description

Les consoles fixes de la série Focus sont conçues pour les applications de salles de contrôle et de sécurité à haute teneur informatique. Le système de muret en acier arrière hyper résistant permet de supporter les surfaces de travail tout en offrant une liberté de déplacement latérale sans obstacles pour les utilisateurs. Tous les accessoires tels que les supports pour moniteurs, les lampes de tâche, les étagères et les monuments sont fixés sur le panneau rainuré en aluminium du muret de 38 po de hauteur, offrant ainsi une surface de travail sans encombrement. Le muret offre une circulation continue des câbles entre toutes les stations positionnées côte-à-côte. Les consoles fixes de la série Focus HD sont équipées de cabinets avec tablette coulissante pour ordinateurs, offrant tout l'espace nécessaire à l'entretien et au nettoyage. Conçu pour offrir une modularité maximale, le système Focus permet de gérer une grande quantité d'équipements informatiques, de câbles et d'espace.

Technical Specifications

Liste des configurations

Téléchargements

- Structure murale en acier robuste
- Console ergonomique pour une satisfaction maximale des utilisateurs
- Boîtiers pour ordinateurs (Sont positionnés à l'avant et à l'arrière du mur)
- Gestion intégrée des câbles avec un accès facile
- Séparation des câbles basse et haute tension
- Équipé pour soutenir les supports ACL sur le panneau rainuré (système Statwall)
- Surfaces de travail en stratifié haute pression avec renforts métalliques
- Panneaux amovibles sans outils à l'arrière ou/et à l'avant de la station
- Système modulaire permettant une reconfiguration future
- Adaptable à vos besoins
- Large gamme de bordures de travail
- Grande variété de couleurs et de finitions
- Monument rétractable en option pour un accès facile et rapide

Solicitation No. - N° de l'invitation
W8474-197662/A
Client Ref. No. - N° de réf. du client
W8474-197662

Amd. No. - N° de la modif.
002
File No. - N° du dossier
hn331.W8474-197662

Buyer ID - Id de l'acheteur
hn331
CCC No./N° CCC - FMS No./N° VME

Stationary Console Linear HD



Description

The Focus Series Stationary Consoles HD are built for control room applications with a great quantity of IT equipment. The heavy-duty back wall system allows to support workspaces while offering maximum knee space to the users. All accessories such as monitor arms, task lamps, shelves, and monuments are supported on the 36" high slatwall, offering a clutter-free workspace. The Focus Series Stationary Consoles HD are equipped with CPU cabinets, offering all the necessary space to house CPUs side by side on a sliding shelf. Built to offer maximum modularity, the Focus System will allow management of a great quantity of IT equipment, cables and monitors.

Technical Specifications

Configuration List

Downloads

Linear Console

Foot print	Width -	Depth -	Max LCD (22")	Min-Max CPU	SKU	LIST
42"x38"	36"	45"	2	1-4		click here
48"x38"	48"	45"	2	1-4		click here
60"x38"	60"	45"	3	1-5		click here
72"x38"	72"	45"	3	1-7		click here

Stationary Console Linear HD



Description

Les consoles fixes de la série Focus sont conçues pour les applications de salles de contrôle et de sécurité à haute teneur informatique. Le système de mur en acier anti-rayon hyporésistant permet de supporter les surfaces de travail tout en offrant une liberté de déplacement latérale sans obstacles pour les utilisateurs. Tous les accessoires tels que les supports pour moniteurs, les lampes de tâche, les étagères et les monuments sont fixés sur le panneau rainuré en aluminium du mur de 36 po de hauteur, offrant ainsi une surface de travail sans encombrement. Le mur offre une circulation continue des câbles entre toutes les stations positionnées côte-à-côte. Les consoles fixes de la série Focus HD sont équipées de cabinets avec tablette coulissante pour ordinateurs, offrant tout l'espace nécessaire à l'entretien et au nettoyage. Conçu pour offrir une modularité maximale, le système Focus permet de gérer une grande quantité d'équipements informatiques, de câbles et d'espace.

Technical Specifications

Liste des configurations

Téléchargements

Console Lineaire

Dimensions	Largeur -	Profondeur -	Max LCD (22")	Min-Max CPU	SKU	LISTE
36"x38"	42"	45"	2	1-4		click here
48"x38"	48"	45"	2	1-4		click here
60"x38"	60"	45"	3	1-5		click here
72"x38"	72"	45"	3	1-7		click here

Question # 2:

How and from where is the clock to be mounted, and are there other controls or programming required by the contractor?

Answer # 2:

- As the RFP states, the Contractor is to supply a Digital Clock based on recommendation in the Appendix E to Annex B - Equipment List
- CANADA is to provide mounting hardware required to fix the digital clock at the ceiling slab and thru the suspended ceiling
- Once solicitation is awarded and the digital clock model/brand has been confirmed (based on recommendation in Appendix E to Annex B - Equipment List) CANADA will acquire the mounting hardware which is compatible with it.
- The Contractor is to install Digital Clock using CANADA furnished mounting gear; see updated Appendix B to Annex B – Drawing Package for location
- No programming required

Question # 3:

Is the contractor be required to supply an Uninterrupted Power Supply (UPS) ?

Answer # 3:

Please note 2nd City does furnish UPS in their communication room, this will secure most of the equipment should power failure occurs. As a standard, JSCSS does install their own UPS in the audio-visual rack when it comes to secure installation. Therefore we do require the contractor to supply 2 UPS units (see Appendix E to Annex B Equipment list) which will be secured and be connected to the Matrix Switches.

Question # 4:

Within Annex B (Statement of Work) section 21. It states that "The Contractor must provide warranty coverage and support services as per Public Services and Procurement Canada standard clauses" Can PWGSC provide the clause which relates specifically to this requirement so that the correct Warranty and Support Services are provided.

Answer # 4:

PSPC standard warranty clause is in General Conditions 2010A 09 as follows and the bidder must provide additional warranty coverage as per Annex B, Section 21 and 22

2010A 09 (2014-09-25) Warranty

1. Despite inspection and acceptance of the Work by or on behalf of Canada and without restricting any provisions of the Contract or any condition, warranty or provision imposed by law, the Contractor, if requested by Canada to do so, must replace, repair or correct, at its own option and expense any work that becomes defective or fails to conform to the requirements of the Contract, where applicable. The warranty period will be 12 months after delivery and acceptance of the Work or the length of the Contractor's or manufacturer's standard warranty period, whichever is longer.
2. Canada must pay the transportation cost associated with returning the Work or any part of the Work to the Contractor's plant for replacement, repair or making good, and the Contractor must pay the transportation cost associated with forwarding the replacement or returning the Work or part of the Work when rectified to the delivery point specified in the Contract or to another location as directed by Canada. If, in the opinion of Canada, it is not expedient to remove the Work from

its location, the Contractor must carry out any necessary repair or making good of the Work at that location and will be reimbursed its reasonable travel and living expenses.

3. The warranty period is automatically extended by the duration of any period or periods where the Work is unavailable for use or cannot be used because of a defect or non-conformance during the original warranty period. The warranty applies to any part of the Work replaced, repaired or corrected pursuant to subsection 1, for the greater of:
 - a. the warranty period remaining, including the extension, or
 - b. 90 days or such other period as may be specified for that purpose by agreement between the Parties.

Question # 5:

Within Annex B (Statement of Work) section 22. - Can DND confirm if they are asking for on-site technical service in conjunction with the Manufacturer's extended Warranty?

Answer # 5:

DND's requirement is to have the warranty as described in, *SACC 2010A 09 (2014-09-25) Warranty*, extended for up to three additional one year periods:

1. Despite inspection and acceptance of the Work by or on behalf of Canada and without restricting any provisions of the Contract or any condition, warranty or provision imposed by law, the Contractor, **if requested by Canada to do so, must replace, repair or correct, at its own option and expense any work that becomes defective or fails to conform to the requirements of the Contract, where applicable.** The warranty period will be 12 months after delivery and acceptance of the Work or the length of the Contractor's or manufacturer's standard warranty period, whichever is longer.
2. Canada must pay the transportation cost associated with returning the Work or any part of the Work to the Contractor's plant for replacement, repair or making good, and the Contractor must pay the transportation cost associated with forwarding the replacement or returning the Work or part of the Work when rectified to the delivery point specified in the Contract or to another location as directed by Canada. **If, in the opinion of Canada, it is not expedient to remove the Work from its location, the Contractor must carry out any necessary repair or making good of the Work at that location and will be reimbursed its reasonable travel and living expenses.**
3. The warranty period is automatically extended by the duration of any period or periods where the Work is unavailable for use or cannot be used because of a defect or non-conformance during the original warranty period. The warranty applies to any part of the Work replaced, repaired or corrected pursuant to subsection 1, for the greater of:
 - a. the warranty period remaining, including the extension, or
 - b. 90 days or such other period as may be specified for that purpose by agreement between the Parties.

Question # 6:

Page 40 Section 2.e) & Page 43 Section 4 b) 5&6

Please confirm the preferred mounting solution for each of the GFE supplied 70" and 55" displays, there was a discussion during the Mandatory site visit around either a floor or wall solution, can you please verify which method will be accepted

Answer # 6:

The Mounting hardware is GFE. 2nd City has agreed to use the existing floor to ceiling poles. CANADA will provide the necessary mounting kit to be fixed to the poles.

Question # 7:

Page 41 Section 3 EQT_1 (3)

Please confirm the make and model of the HD Cable Tuner. Also are these to be considered GFE provided by Canada.

Answer # 7:

To be advised

Question # 8:

Section 3 EQT_1 (9)

Are all of the UPS units in the racks to be provided by the Contractor or Canada?

Answer # 8:

We do require the contractor to supply two (2) UPS units (see Appendix E to Annex B Equipment list) which will be secured and be connected to the Matrix Switches. CANADA does provide UPS for general purpose in the communication room; 2nd City does furnish UPS in their communication room, this will secure most of the equipment should power failure occur.

Question # 9:

Page 47

Section II) Audio

Please clarify how the audio is to work within the proposed design.

Answer # 9:

Any audio from signals pushed to the wall displays can be routed to the speakers. The last source sent being the one being heard in the room. If the user wants to hear a different source he must then select another signal which will then be the last one being pushed.

Question # 10:

Page 65 part a)

Grounding practices

Clarification required:

It was stated during the site meeting that only equipment that has a ground lug on the device will need to be grounded via a connection to the GFE ground bus system supplied in each GFE rack can this be confirmed.

Answer # 10:

Yes only equipment equipped with ground lug.

Question # 11:

Page 114

BoM list

Item 14 and 15

Crestron Control processors?

Which of the two listed do you want systemized into the rooms?

Answer # 11:

ITEM 14 PRO 3

Question # 12:

Item 16:

Are all the Crestron TP gunits to be desk units? Are not some to be mounted in a wall? We shall assume black is that OK?

Answer # 12:

All panels to be desk unit, TS-1542-TILT-B (B for Black)

Question # 13:

Appendix F, Section M1 has a discrepancy [I have noted in bold] and requires clarification. It states:
"The bidder must provide **three reference projects** performed in the last ten years that demonstrate the firm's experience in the overall Project management and accountability to develop and deliver project similar to the one described in Annex B, Statement of work (SOW). To be considered, the projects must have been of a greater value than \$500,000.00 and at least one of the projects must have been in a Government of Canada environment. The experience of the firm **in five similar projects** (similar scope, value, environment and size) should be clearly identified by providing the following information for each reference project:"

Would you please clarify if three or five project references are required?

Answer # 13:

The bidder must provide three reference projects.

Note:

Delete

Appendix B to Annex B – Drawing Package in Solicitation RFP posted June 11, 2018

Insert:

Appendix B to Annex B – Drawing Package as attached to amendment #2

All other terms and conditions remain the same.

APPENDIX B TO ANNEX B – STATEMENT OF WORK

DRAWING PACKAGE

July 6th, 2018

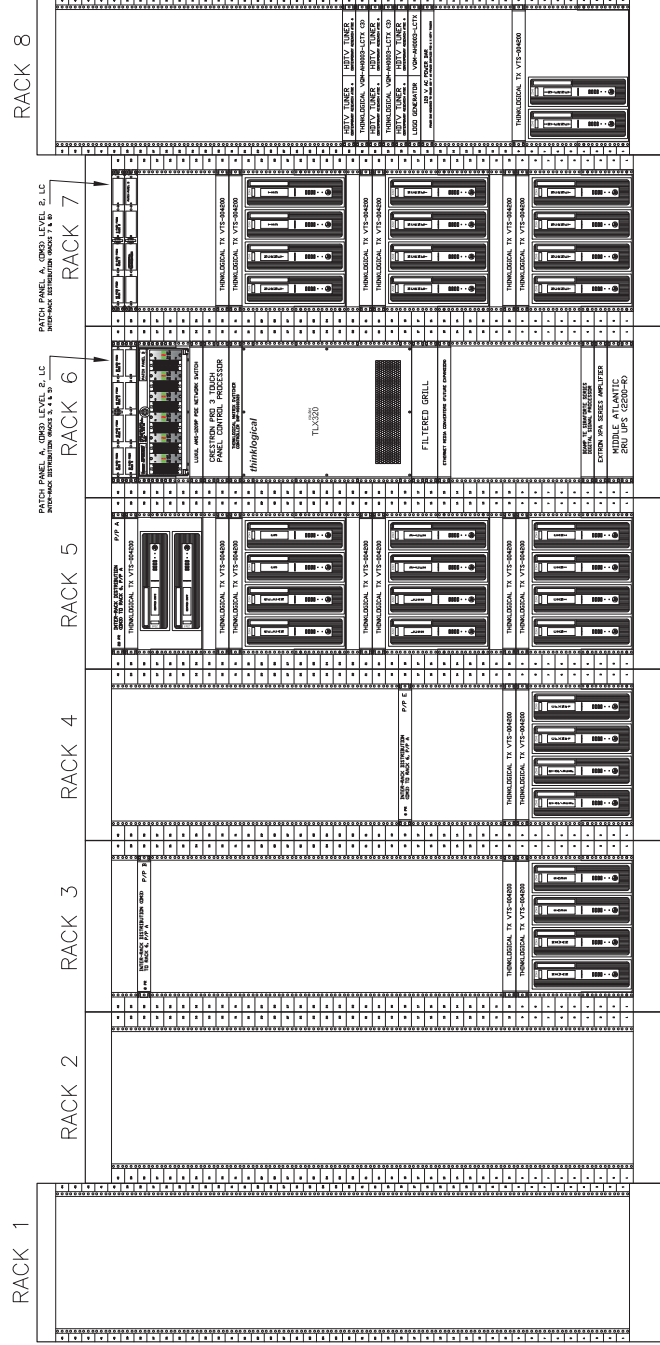

DATE	DESCRIPTION		NAME
REVISONS			
DRAWN BY:	CHECKED BY:	APPROVAL:	
XXX	XXX		
TITLE			
GENERAL ARRANGEMENT			
THINKLOGICAL AV RACK			
2ND CITY / EQT_1			
DRAWING No	SCALE		
XXXX	1/1	N/T'S	
SHEET	1	OF	1



National
Défense
Defence
nationale

DND - NOTICE

THIS CONFIGURATION SHALL NOT BE ALTERED UNLESS AUTHORIZED BY JSCSS-SND OR DESIGNATED DESIGN CONSULTANT. FINAL DESIGN MUST BE APPROVED BY DEPARTMENT OF NATIONAL DEFENCE.

REVISION - REVISION

REV	DATE	REVISION / DESCRIPTION	DATE	REV
P1	03/2018	PROJ DIR: 00017ELS RFP PROPOSAL	03/18	LI

PROPOSAL-P1
07/MAR/2018

COMPLIANCE
COMPLIANCE

PROJ # DT017EL05

D C41 FD / AVC2

SITE LOCATION
2ND CITY WATCH-FLOOR
OTTAWA NCR

SUBJECT
FIBER MATRIX EQUIPMENT RACK
THINK LOGICAL SYSTEM
COMPUTER & VIDEO DISTRIBUTION

DESIGNER	ELARVIERE	DATE	07/MAR/2018
CLIENT	NAME	SCALE	NTS
PROJECT	NAME	DATE	03/18

FILE REFERENCE NO	REF#45692, DT017EL05
NO. OF REVISIONS TO DESIGN	1
REVISION NO	1

CLASSIFICATION
UNCLASSIFIED

2ND-CITY-RK5-THINKGL-FIB



HDTV TUNER RACK
FRONT VIEW-40U

THINKLOGICAL TLX 320 RK
FRONT VIEW-40U

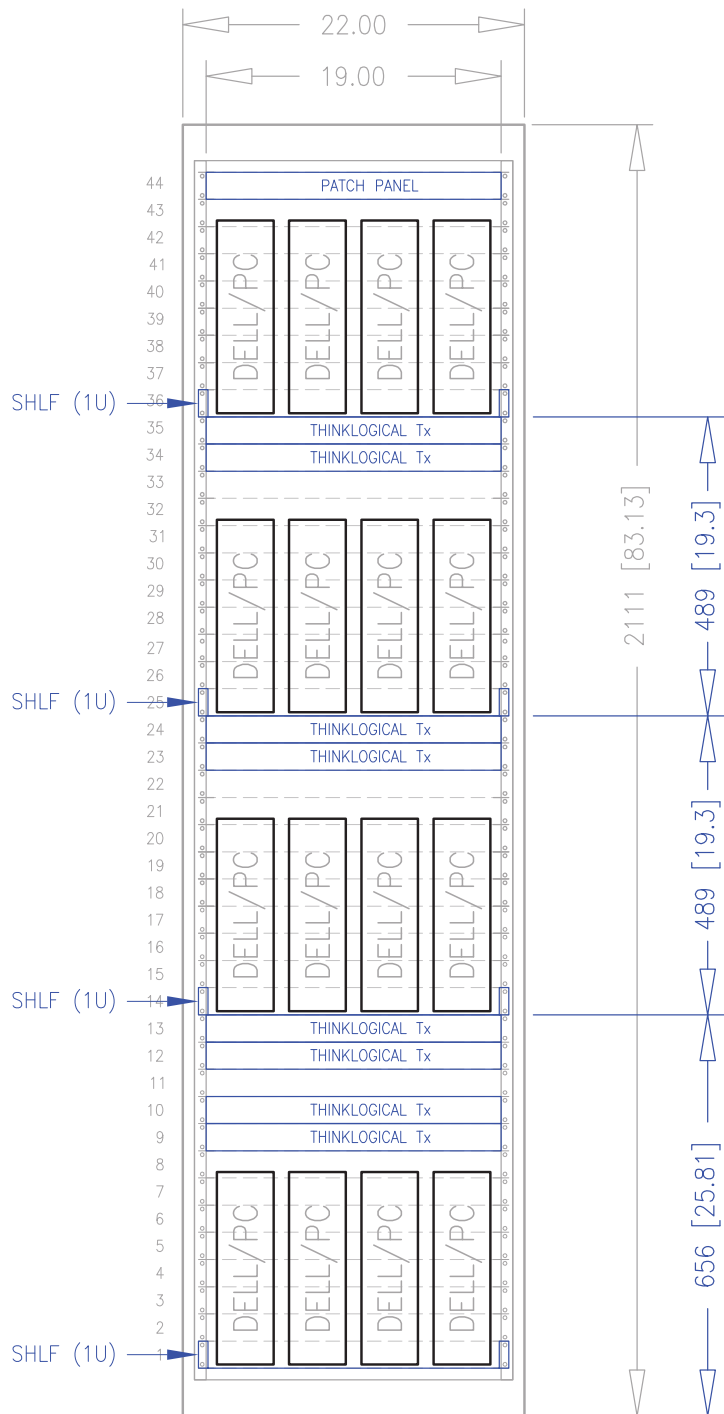

TYPE-PC:

DELL OPTIPLEX 760

CHASSIS: SMALL FORM FACTOR

MIDDLE ATLANTIC
VRK-44-31.5"

LEGEND

DELL PC
PROPOSED EQUIPMENT

-	XX	XX	A.S.
NO.	DESCRIPTION	DATE	INIT.
REVISIONS			
DRAWN BY:	JW.DIXON	DATE:	12/02/2018
DESIGN AUTHORITY:		D C4I FD/AVC2	
TITLE:		DRAWN NO:	
SMALL FACTOR PC RACK LAYOUT		16-DELLPC-RK44U	
16 DELL PC		SCALE:	
2ND CITY WATCH FLOOR		NTS	
		SHEET 1 OF 1	



National
Defence

Red Installation Technical Authority

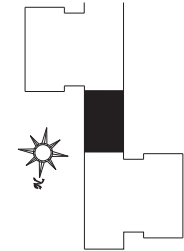

KEYPLAN
LEGEND:

- RDS Installation (see note 4 below)
- RDS Secure Phone (see note 4 below)
- RDS Printer (see note 4 below)
- RDS Full Box (see note 3 below)
- RDS Outlet
- RDS Cable
- RDS Communication Pig-Tape
- RDS Support Structure
- RDS Elevation Change

NOTE:

- Unless stated, all RDS cable support structure is 1-inch (M).
- Dimensions are in feet and inches (Ft-In).
- All full boxes installed are without knockouts where "x" indicates a knockout is required. (E.g. 24"x48"x10'7" & (E-35"x35"x10'7" & (E-16"x16"x6'5").
- "x" identifies associated network (C=CSNI).

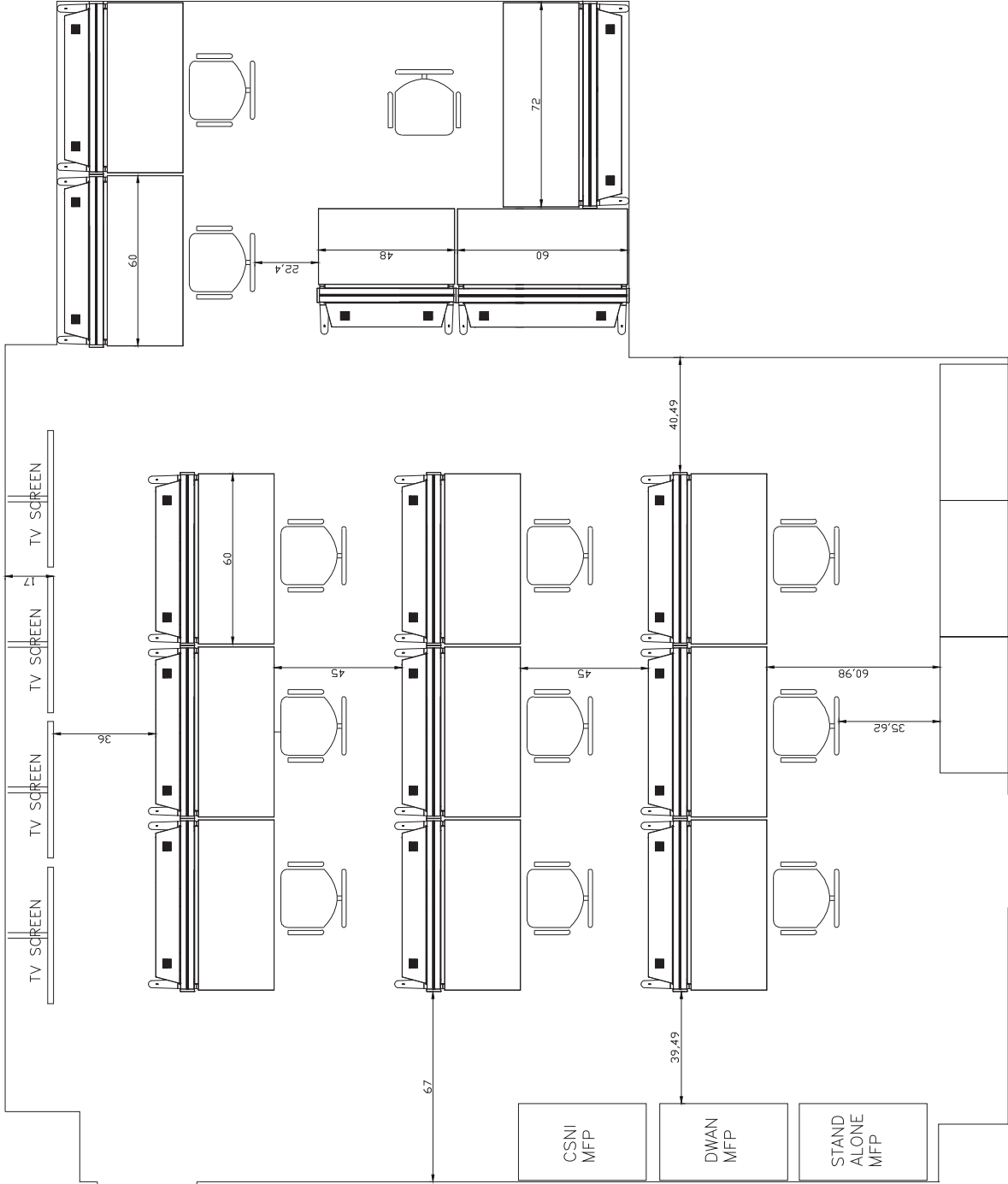

Apr 18	RDS 12' on DEC & 30'5 to 12th & 13th D1017154 - Proposed
26 Jan 18	RDS Removal, Peoples D1017157 - Proposed
Dec 17	RISER From 30'5 to Floors 12 Thru 19 W/ As-Built D1017177
DEC 17	AIMPeel Drop Relocation - 13CBN H001 D1017153 - AS BUILT CFCH00
DEC 17	RDS Expansion - 13CBN D1017159 - AS BUILT CFCH00
DEC 17	Red Drop Relocations - 13CBS D1017055 - AS BUILT CFCH00
DEC 17	AIMPeel Drop Relocation - 13CBN H001 D1017153 - Proposed
DEC 17	RDS Expansion - 13CBN D1017159 - Proposed
DEC 17	RDS Expansion - 13INT D1017098 - AS BUILT CFCH00
DEC 17	RFC 837660 removes CSNI From 13CBN D008
DEC 17	RFC 837559 Removes SIGNET C5 From 1405 NT
NOV 17	RDS Expansion - 13INT D1017098 - PROPOSED
DATE	DESCRIPTION

REVISIONS	
DRAWN BY: Mr. R.U. Hirm	DATE: DD MM
MGEN G.R. PEARKES BLC 13th FLOOR PLAN RED DISTRIBUTION SYST	
SKETCH NO. 050-101-FLOOR 13	SCALE NTS
	SHEET 3