

**ELEVATION SECTION X**

**90 DEG THRUST BLOCK DETAIL 1**  
1:25

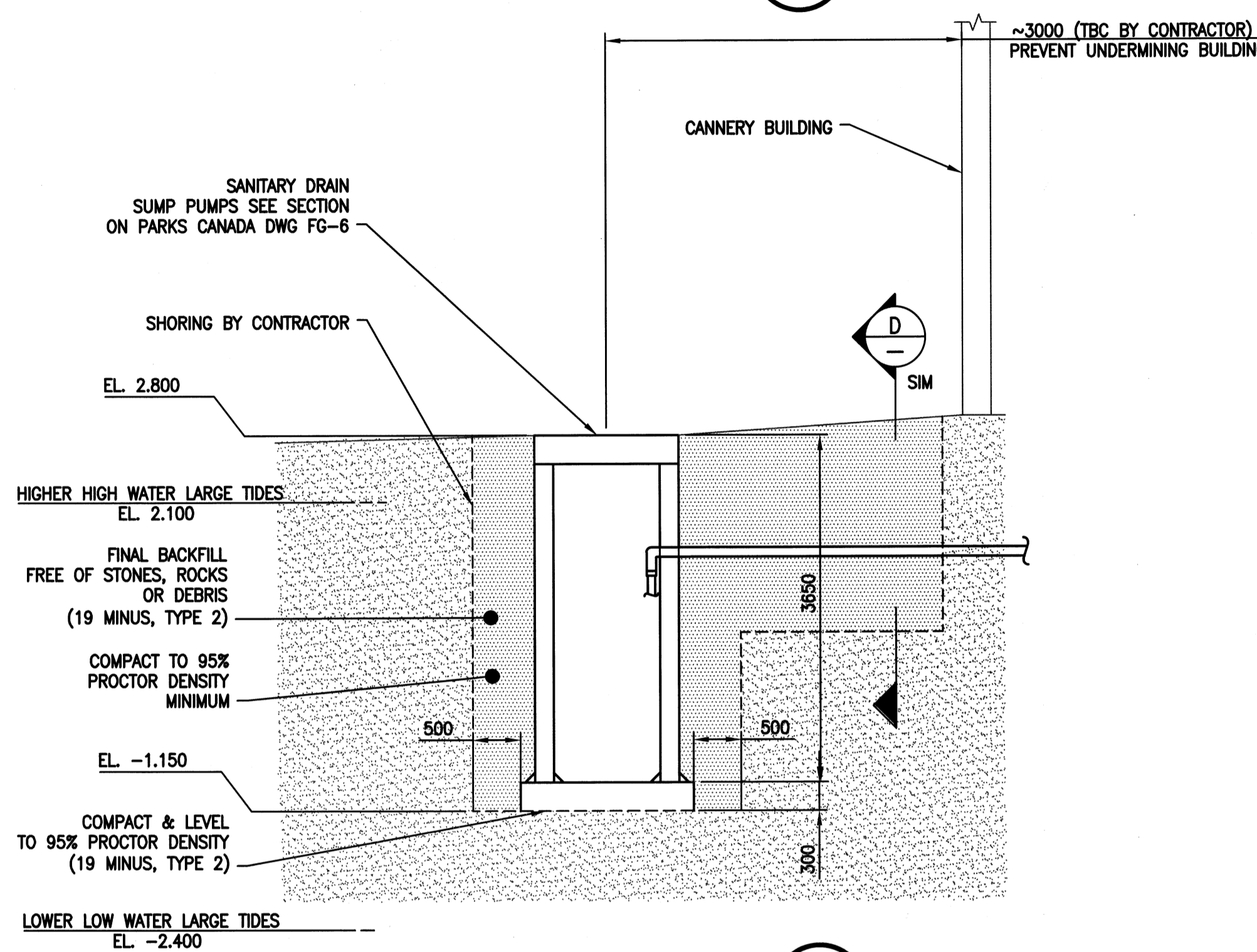

**DRAIN SUMP EXCAVATION E**  
1:50

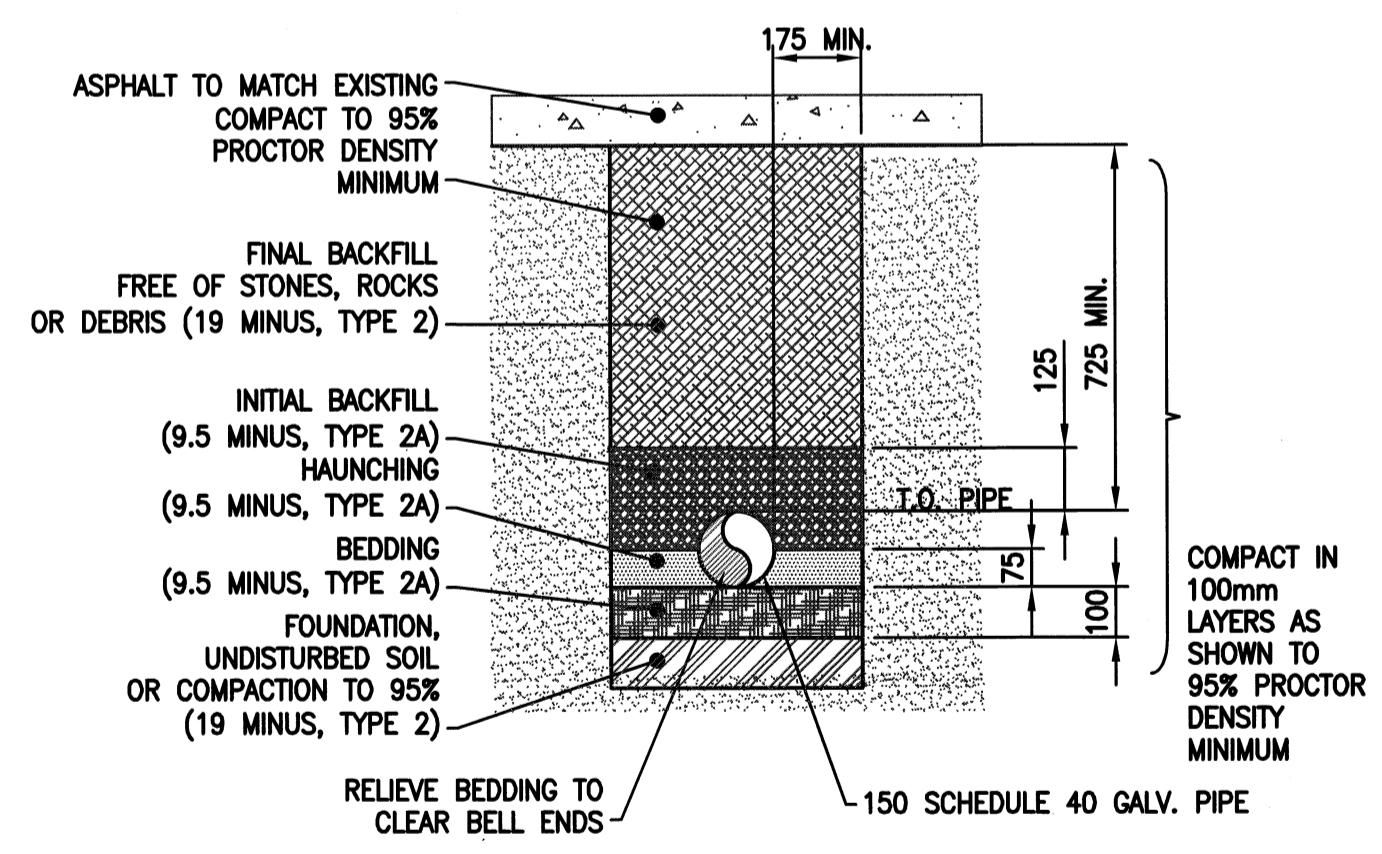

**DISCHARGE STANDPIPE EXCAVATION D**  
1:15

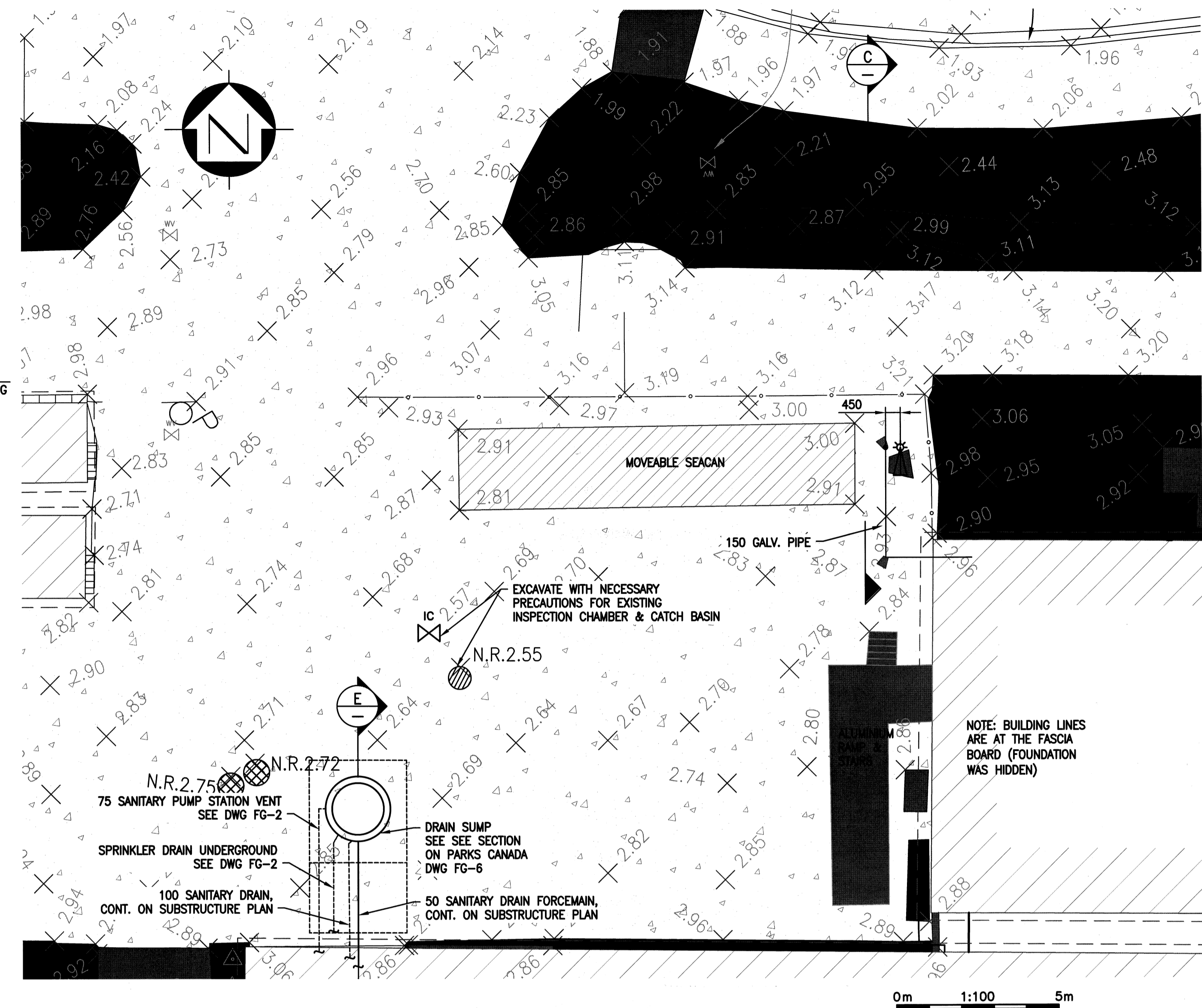

**TOPOGRAPHIC PLAN OF GULF OF GEORGIA CANNERY** (EXCERPT FROM PUBLIC WORKS & GOVERNMENT SERVICES OF CANADA DWG NO. SK #5640.00)  
1:100

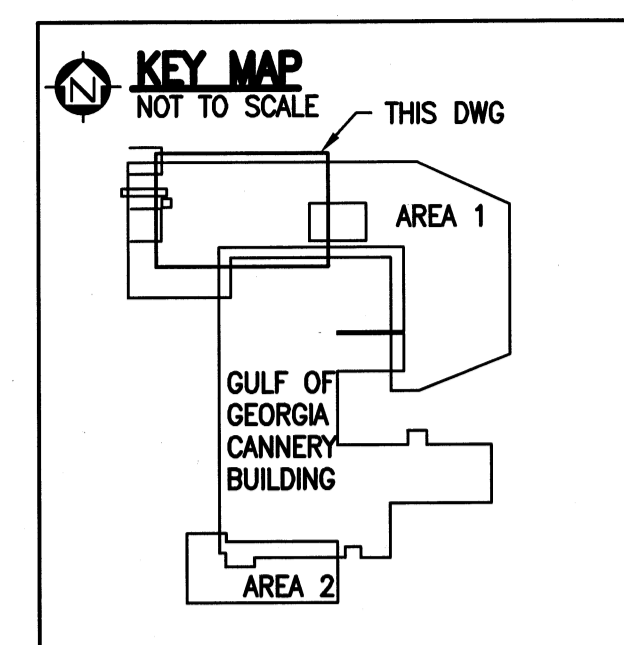

- LEGEND:**
- MANHOLE
  - CATCH BASIN ROUND #0.60m
  - MANHOLE STORM
  - POWER POLE
  - BOLLARD
  - WATER VALVE
  - INSPECTION CHAMBER #0.20m
  - LAMP STANDARD
  - ANTENNA
  - FIRE HYDRANT
  - FLAGPOLE
  - GUY WIRE
  - THRUST BLOCK

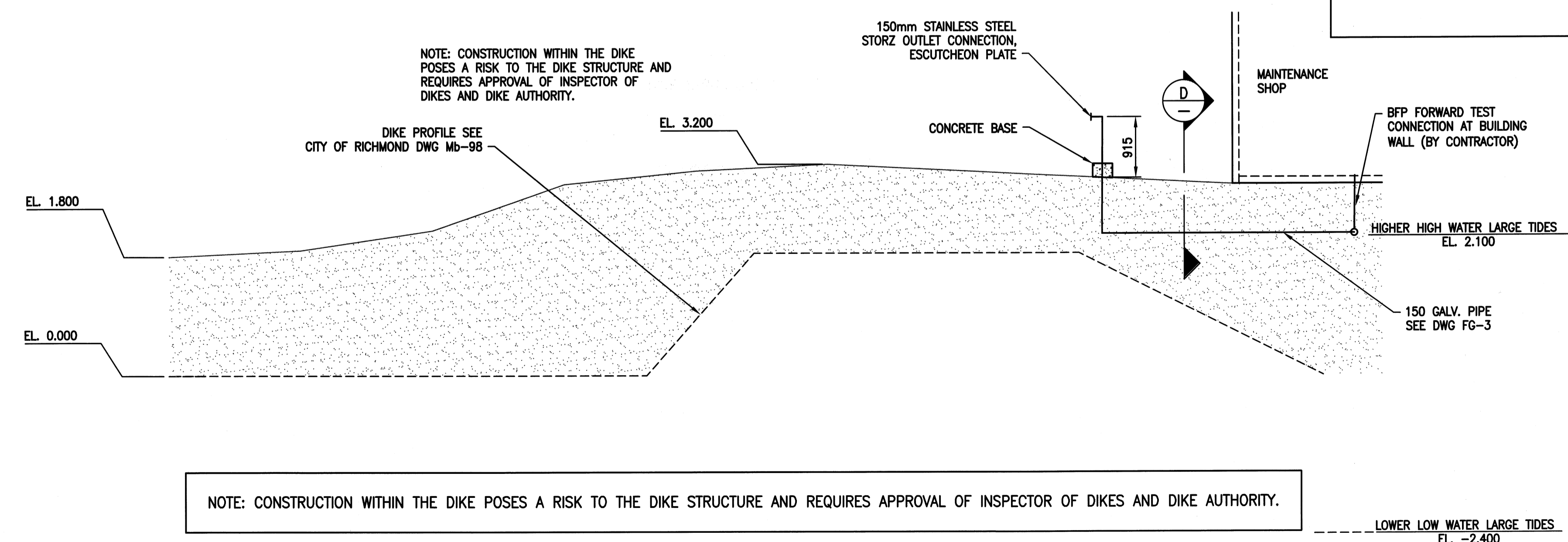

**DISCHARGE STANDPIPE PROFILE C**  
1:50

- NOTES:**
- ALL DIMENSIONS IN MILLIMETRES (mm)
  - ELEVATIONS ARE IN METRES (m)
  - ELEVATIONS ARE ORTHOMETRIC (CGVD28GVRD) AND DERIVED FROM THE M.A.S.C.O.T. PUBLISHED ELEVATION OF GCM#549162 (TABLET MARKING 77H838), PUBLISHED ELEVATION OF GCM#549162 = 1.561m
  - EXCAVATION & SLOPING ACCORDING TO WSBC 20.81
  - ALL EXCAVATED SOIL IS ASSUMED TO BE CONTAMINATED. PLACE EXCAVATED MATERIAL INTO ONE TONNE SOIL BAGS, LABEL AND IMMEDIATELY REMOVE FROM SITE AND STORE AT AN OFF-SITE STOCKPILE AREA, DESIGNATED BY DEPARTMENTAL REPRESENTATIVE. REFER TO DETAILED SPECIFICATIONS SECTION 31 23 33 01 - EXCAVATION, TRENCHING AND BACKFILLING.
  - REFER TO SPECIFICATION SECTION 31 23 33 01 AND CITY DRAWING NO. Mb-98 TYPICAL CROSS SECTION RIVER DIKE UPGRADE FOR SOIL TYPES & EXCAVATION REQUIREMENTS.
  - SHORED TRENCH DESIGN TO BE PROVIDED BY CONTRACTOR WHERE REQ'D.

Revision/Revision	Description/Description	Date/Date
P6	ISSUED FOR TENDER	18/07/18
P5	ISSUED FOR TENDER	18/07/18
P4	ISSUED FOR TENDER	18/07/08
P3	ISSUED FOR TENDER REVIEW	18/05/30
P2	RE-ISSUED FOR REVIEW	18/05/15
P1	ISSUED FOR REVIEW	18/04/24

**PARKS CANADA**

Project title/Titre du projet  
12138 FOURTH AVENUE  
RICHMOND, BC V7E 3J1

**FIRE SPRINKLER REHABILITATION  
GULF OF GEORGIA CANNERY**

Consultant Approval Box Only  
DGZ  
Designed by/Concept par  
GJS  
Drawn by/Dessiné par  
NEI  
PWGSC Project Manager/Administrateur de Projets TPSGC  
TOM DUNPHY  
PWGSC Regional Manager, Architectural and Engineering Services/  
Gestionnaire régionale, Services d'architecture et de génie, TPSGC  
PREEPTIPAL PAUL

**Drawing title/Titre du dessin  
FIREWATER UNDERGROUND PIPING  
LOCATION & EXCAVATION  
DETAIL**

Project No./No. du projet	Sheet/Feuille	Revision no./ La Révision no.
R.089515.001	1 OF 1	P6