

Part 1 General

1.1 ADDENDUM FORM

- .1 This Addendum forms part of the Contract Documents and modifies the Bidding Documents dated 22 May 2018, with amendments and additions noted below.
- .2 Acknowledge receipt of this Addendum in the space provided in the Bid Form. Failure to do so may disqualify the Bidder at the Owner's discretion.
- .3 This addendum consists of one (1) page plus the following:

No.	Drawing Title	Issue Date
	RA-1 Extent of Chair Rail	June 29, 2018

1.2 CHANGES TO THE PROJECT MANUAL

- .1 Specifications - appended to this addendum, to be added to the Project Manual.
 - .1 Refer to Section 05 50 00 - Metal Fabrications. **ADD** sentence 2.5.4 Metal handrails to receive two (2) coat of semi-gloss finish paint. Colour as selected by consultant.
 - .2 Refer to Section – 09 00 01 Finishes Schedule. Revise finishes in RM 101. Existing wall surfaces to be painted.

1.3 CHANGES TO DRAWINGS

- .1 Drawings - appended to this addendum, to be added to the Project Manual.
 - .1 **ADD** RA-1 Extent of Chair Rail
 - .2 Refer to A3.1, Finishes Notes. **REVISE** Note A to read: All walls and drywall ceilings to be painted. Surface mounted ducting and radiators to be painted to match adjacent surface.
 - .3 Refer to A3.1 Finishes Notes. **REVISE** Note B to read: All doors and hollow metal door/window frames to be painted.
 - .4 Refer to A3.1 Finishes Notes. **ADD** Note D: New chair rail to be painted. Colour to be selected by Consultant.

1.4 CLARIFICATIONS/RESPONSES TO QUERRIES

- .1 Please confirm whether or not the new 38x184 reinforcing (not in dormers) need to be one piece (30') or may they be two pieces with an 8' piece on the other side (covering for the splice)?
 - .1 Response: They do not need to be one piece. What they have proposed is acceptable.
- .2 The west exterior window between Grid F & G isn't there.
 - .1 Response: This 'window' is actually a louvre. Delete note referring to roller shades in this location.
- .3 Dormer windows are approximately 40"W x 52"H.
- .4 Stair 1 walls to be painted on all levels. Stair 2 walls to be painted on all levels (including walls from main floor to crawlspace).
- .5 Refer to 1/A2.1, Note 4. Window sizes for film: 2 x 40"W x 40"H, 2 x 40"W x 32"H.

- .6 Refer to 2/A2.1, Note 2. Window sizes for horizontal blinds: 45"W x 80"H, 2 x 36"W x 80"H, 32"W x 80"H.
- .7 Refer to S1.1. Electrical Contractor shall detach the electrical conduits from the structural members being modified in crawlspace. Provide temporary support for the conduits during structural modifications. Re-attach conduits upon completion of structural modifications. Electrical Contractor to coordinate the electrical conduits requirement temporary support with the Structural Contractor to accommodate the structural scope of work.

END OF ADDENDUM NUMBER NO. 2

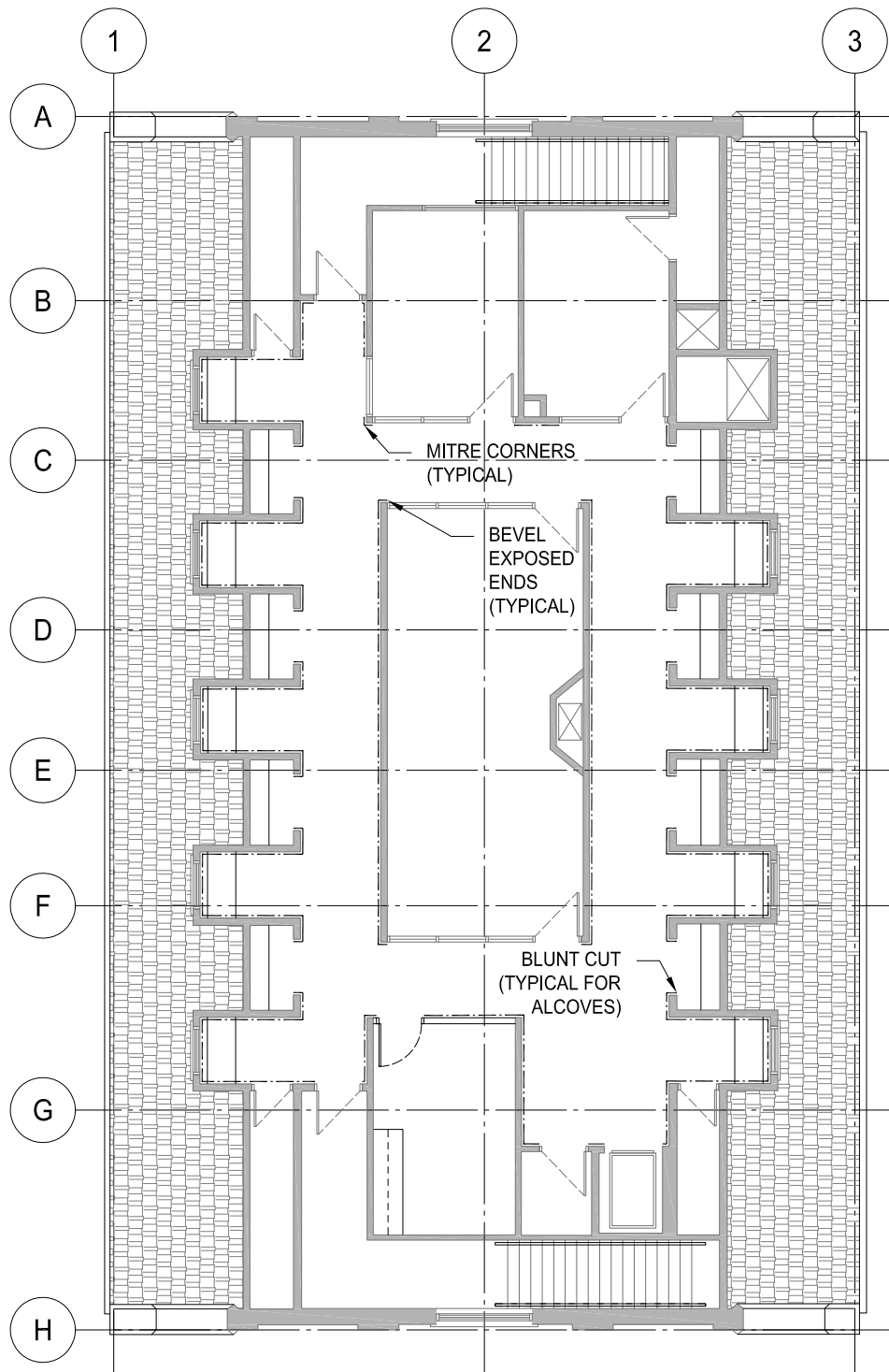

1 EXTENT OF CHAIR RAIL
 RA-1 SCALE: 1:150

--- NEW CHAIR RAIL