



FISHERIES AND OCEANS  
CANADA

WHARF REPAIRS  
PORT AU CHOIX  
NEWFOUNDLAND AND LABRADOR

PROJECT No. 722592  
ISSUED FOR TENDER



SMALL CRAFT HARBOURS

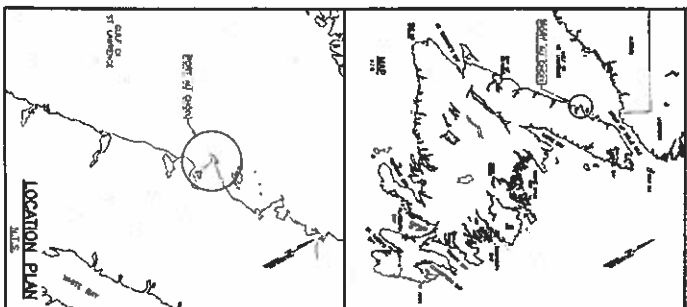

LIST OF DRAWINGS:

- C1 OF 5 SOUNDING AND TOPOGRAPHIC SURVEY
- C2 OF 5 AREA 1
- C3 OF 5 AREA 2
- C4 OF 5 AREA 3
- C5 OF 5 AREA 4

**NOTES**

THIS PLAN WAS PREPARED BY THE SURVEYING AND MAPPING DIVISION OF THE DEPARTMENT OF LAND AND FORESTRY, GOVERNMENT OF SASKATCHEWAN, CANADA. THE PLAN IS A PART OF A LARGER PLAN.

DATE OF SURVEY: 1972  
 DATE OF PUBLICATION: 1973  
 SCALE: 1:50,000  
 PROJECTION: UTM  
 DATUM: NAD 83  
 COORDINATE SYSTEM: UTM  
 UNIT: METERS

ALL DIMENSIONS ARE IN METERS UNLESS OTHERWISE SPECIFIED.

THE PLAN IS A PART OF A LARGER PLAN.

**LEGEND**

- 1. BOUNDARY
- 2. ROAD
- 3. RAILROAD
- 4. CANAL
- 5. DRAINAGE
- 6. POWER LINE
- 7. TELEPHONE LINE
- 8. FENCE
- 9. CONCRETE
- 10. BRICK
- 11. WOOD
- 12. ASPHALT
- 13. GRAVEL
- 14. SAND
- 15. CLAY
- 16. ROCK
- 17. WATER
- 18. SWAMP
- 19. VEGETATION
- 20. CULTIVATED LAND
- 21. UNCULTIVATED LAND
- 22. OPEN SPACE
- 23. BUILDING
- 24. TOWER
- 25. MONUMENT
- 26. BENCH MARK
- 27. CONTROL POINT
- 28. TRIP STAKE
- 29. SPOT ELEVATION
- 30. INTERSECTION
- 31. END OF LINE
- 32. POINT OF BEGINNING
- 33. POINT OF TERMINATION
- 34. POINT OF ADJUSTMENT
- 35. POINT OF OBSERVATION
- 36. POINT OF MEASUREMENT
- 37. POINT OF CONNECTION
- 38. POINT OF REFERENCE
- 39. POINT OF INTEREST
- 40. POINT OF NOTE
- 41. POINT OF WARNING
- 42. POINT OF DANGER
- 43. POINT OF CAUTION
- 44. POINT OF INFORMATION
- 45. POINT OF SERVICE
- 46. POINT OF FACILITY
- 47. POINT OF AMENITY
- 48. POINT OF COMFORT
- 49. POINT OF CONVENIENCE
- 50. POINT OF ACCESS
- 51. POINT OF EGRESS
- 52. POINT OF ENTRY
- 53. POINT OF EXIT
- 54. POINT OF DEPARTURE
- 55. POINT OF ARRIVAL
- 56. POINT OF DEPARTURE
- 57. POINT OF ARRIVAL
- 58. POINT OF DEPARTURE
- 59. POINT OF ARRIVAL
- 60. POINT OF DEPARTURE
- 61. POINT OF ARRIVAL
- 62. POINT OF DEPARTURE
- 63. POINT OF ARRIVAL
- 64. POINT OF DEPARTURE
- 65. POINT OF ARRIVAL
- 66. POINT OF DEPARTURE
- 67. POINT OF ARRIVAL
- 68. POINT OF DEPARTURE
- 69. POINT OF ARRIVAL
- 70. POINT OF DEPARTURE
- 71. POINT OF ARRIVAL
- 72. POINT OF DEPARTURE
- 73. POINT OF ARRIVAL
- 74. POINT OF DEPARTURE
- 75. POINT OF ARRIVAL
- 76. POINT OF DEPARTURE
- 77. POINT OF ARRIVAL
- 78. POINT OF DEPARTURE
- 79. POINT OF ARRIVAL
- 80. POINT OF DEPARTURE
- 81. POINT OF ARRIVAL
- 82. POINT OF DEPARTURE
- 83. POINT OF ARRIVAL
- 84. POINT OF DEPARTURE
- 85. POINT OF ARRIVAL
- 86. POINT OF DEPARTURE
- 87. POINT OF ARRIVAL
- 88. POINT OF DEPARTURE
- 89. POINT OF ARRIVAL
- 90. POINT OF DEPARTURE
- 91. POINT OF ARRIVAL
- 92. POINT OF DEPARTURE
- 93. POINT OF ARRIVAL
- 94. POINT OF DEPARTURE
- 95. POINT OF ARRIVAL
- 96. POINT OF DEPARTURE
- 97. POINT OF ARRIVAL
- 98. POINT OF DEPARTURE
- 99. POINT OF ARRIVAL
- 100. POINT OF DEPARTURE

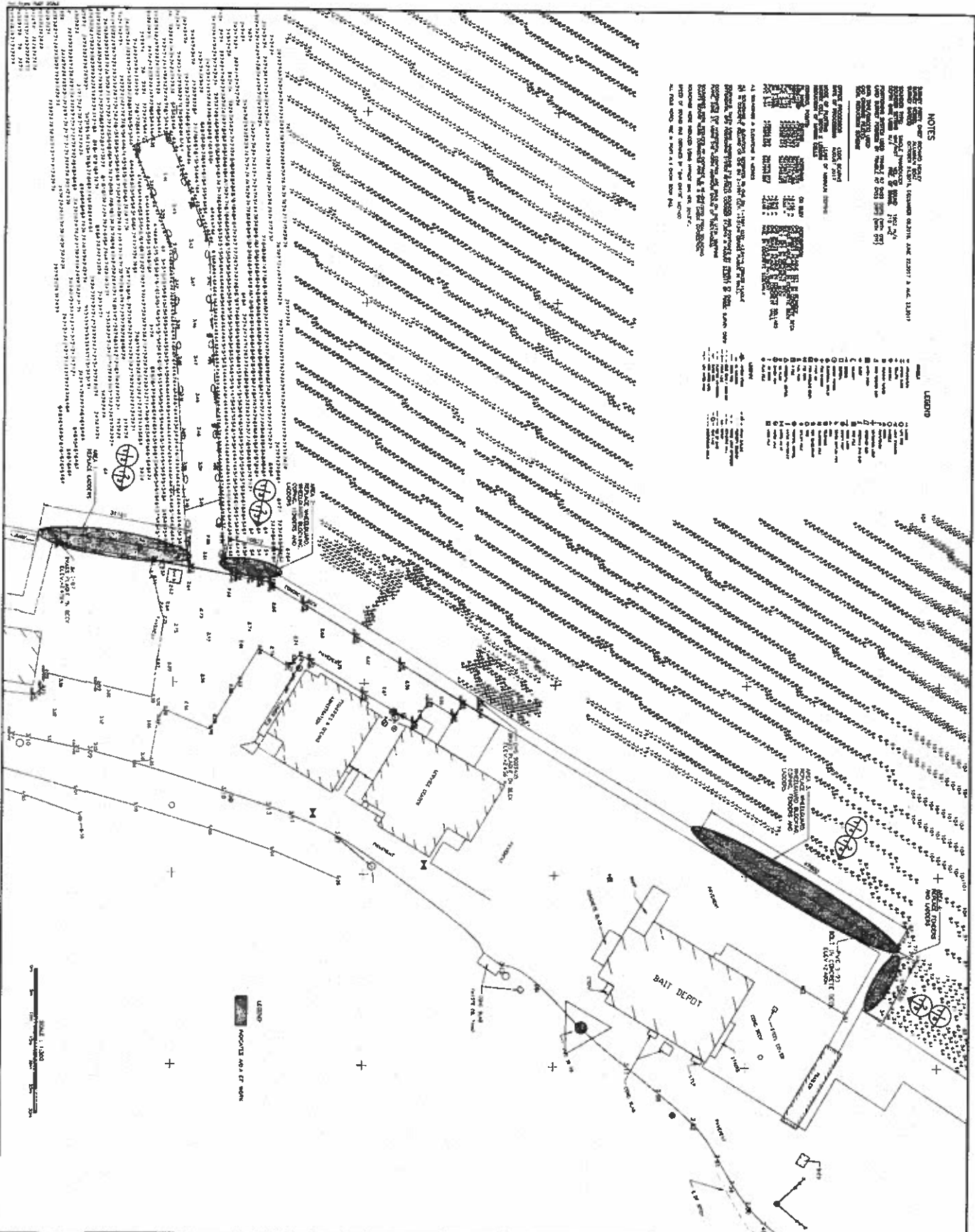

<p><b>SMALL CRAFT HARBOURS</b></p>	
<p><b>WHARF REPAIRS PORT AU CHOIX, NL</b></p>	
<p><b>SOUNDING AND TOPOGRAPHIC SURVEY</b></p>	
<p>DATE: MAY 15, 1972</p>	<p>SCALE: 1:50,000</p>
<p>PROJECT NO.: 722592</p>	<p>MAP NO.: C1</p>



NOTES:  
 1. ALL DIMENSIONS ARE IN FEET AND INCHES UNLESS OTHERWISE SPECIFIED.  
 2. UNLESS OTHERWISE SPECIFIED, ALL MATERIALS SHALL BE AS SHOWN.

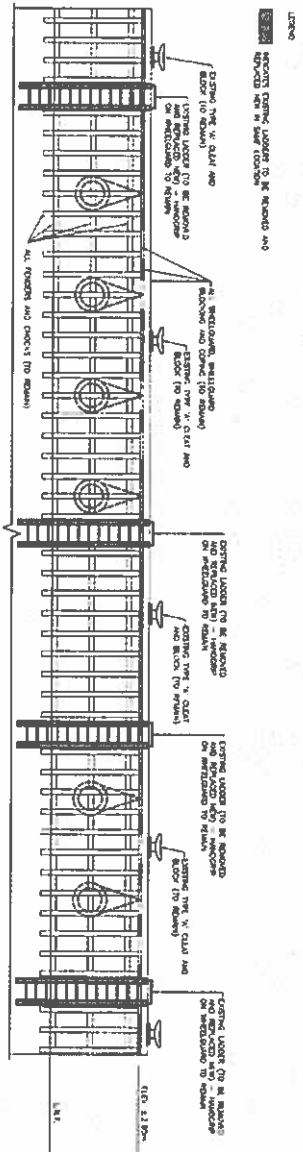

ELEVATION - EXISTING  
 SCALE: 1/8" = 1'-0"

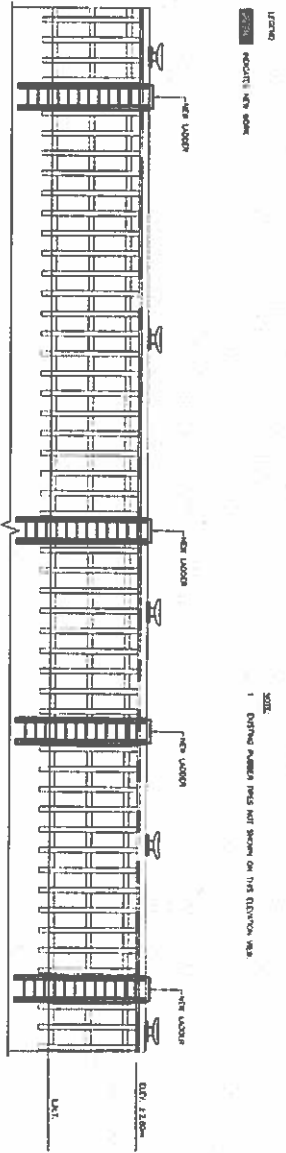

ELEVATION - NEW  
 SCALE: 1/8" = 1'-0"

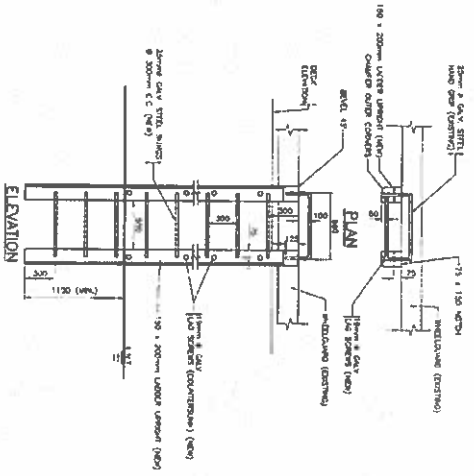

NEW LADDER  
 SCALE: 1/8" = 1'-0"

STATE OF NEW JERSEY  
 DEPARTMENT OF TRANSPORTATION  
 PORT AUTHORITY  
 100 EAST WASHINGTON STREET  
 NEWARK, NJ 07102  
 TEL: 973-530-3000  
 FAX: 973-530-3001

NO.	REVISION	DATE	BY	CHKD.
1	ISSUED FOR BIDDING	04/11/13		
2	REVISED FOR RECORD	04/11/13		

PROJECT: WHARF REPAIRS  
 PORT AU CHOK, NJ

AREA 1

DATE: 04/11/13  
 DRAWN BY: JAY L. BIRD  
 CHECKED BY: JAY L. BIRD  
 PROJECT NUMBER: 722982

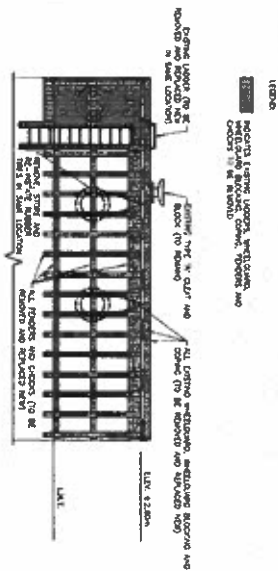

ELEVATION - EXISTING  
SCALE: 1/8" = 1'-0"

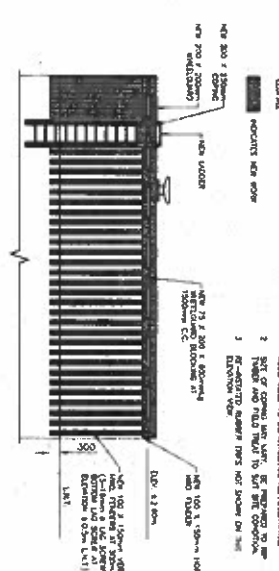

ELEVATION - NEW  
SCALE: 1/8" = 1'-0"

- NOTES**
1. EXISTING OF ALL SYSTEMS IN THIS AREA IS TO BE MAINTAINED UNLESS OTHERWISE NOTED. ALL DIMENSIONS AND SPACING TO BE AS SHOWN ON THIS DRAWING.
  2. ALL DIMENSIONS AND SPACING TO BE AS SHOWN ON THIS DRAWING.
  3. EXISTING TO REMAIN PARTS NOT SHOWN ON THIS DRAWING.

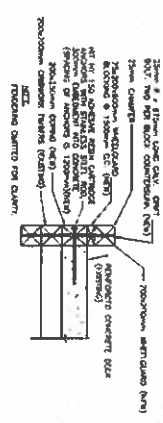

WHEELGUARD AND COPING DETAIL  
SCALE: 1/2" = 1'-0"

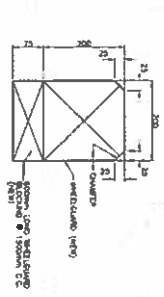

WHEELGUARD SECTION  
SCALE: 1/2" = 1'-0"

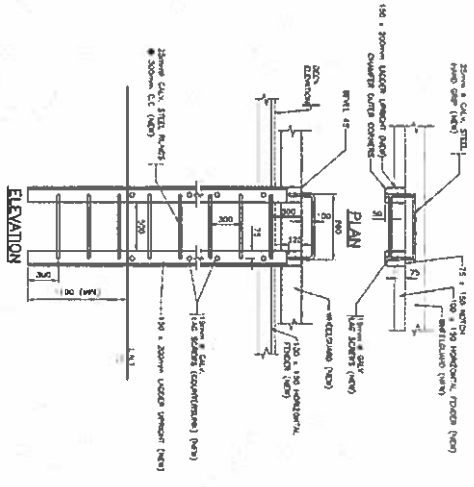

NEW LADDER DETAIL  
SCALE: 1/2" = 1'-0"

**SMALL CRAFT HARBOURS**

1. ALL DIMENSIONS AND SPACING TO BE AS SHOWN ON THIS DRAWING.  
2. ALL DIMENSIONS AND SPACING TO BE AS SHOWN ON THIS DRAWING.

**PORT GUARD**

1. ALL DIMENSIONS AND SPACING TO BE AS SHOWN ON THIS DRAWING.  
2. ALL DIMENSIONS AND SPACING TO BE AS SHOWN ON THIS DRAWING.

**AREA 2**

**WHARF REPAIRS**  
**PORT AU CHOK, N.L.**

NO.	DESCRIPTION	DATE	BY
1	WHARF REPAIRS	1/1/11	...
2	WHARF REPAIRS	1/1/11	...

722592

C3

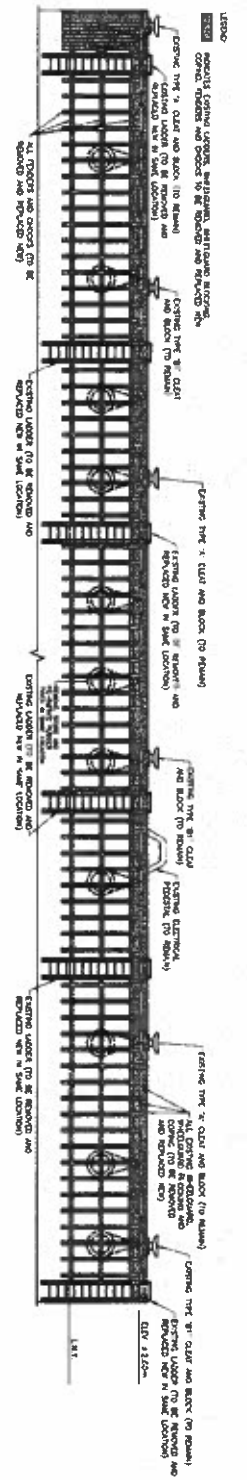

ELEVATION - EXISTING  
SCALE: 1/8" = 1'-0"

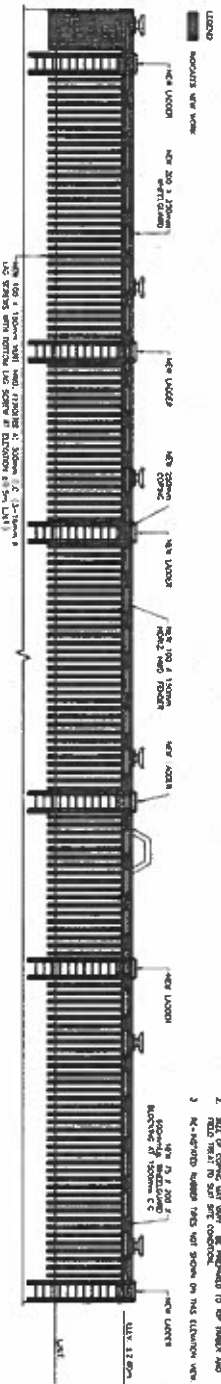

ELEVATION - NEW  
SCALE: 1/8" = 1'-0"

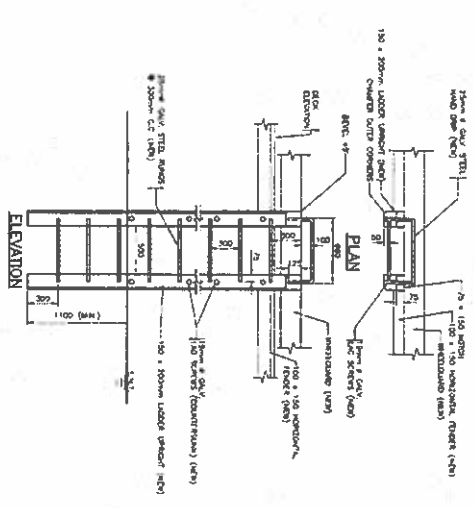

NEW LADDER DETAIL  
SCALE: 1/8" = 1'-0"

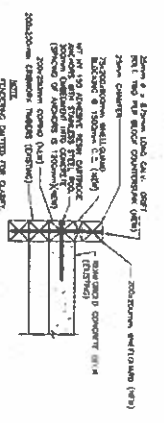

WHEELGUARD AND COPING DETAIL  
SCALE: 1/8" = 1'-0"

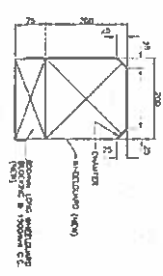

WHEELGUARD SECTION  
SCALE: 1/8" = 1'-0"



SMALL CRAFT HARBOURS



1 ALL MATERIALS AND METHODS TO BE USED SHALL BE APPROVED BY THE DISTRICT ENGINEER, PORT AU CHOIX, N.L.



NO.	REVISION	DATE
1	ISSUED FOR BIDDING	12/11/11
2	REVISED FOR PERMIT	12/11/11

AREA 3

DATE: 12.11.2011  
 DRAWN BY: RJS  
 CHECKED BY: RJS  
 PROJECT NO: 722892  
 SHEET NO: C4

