

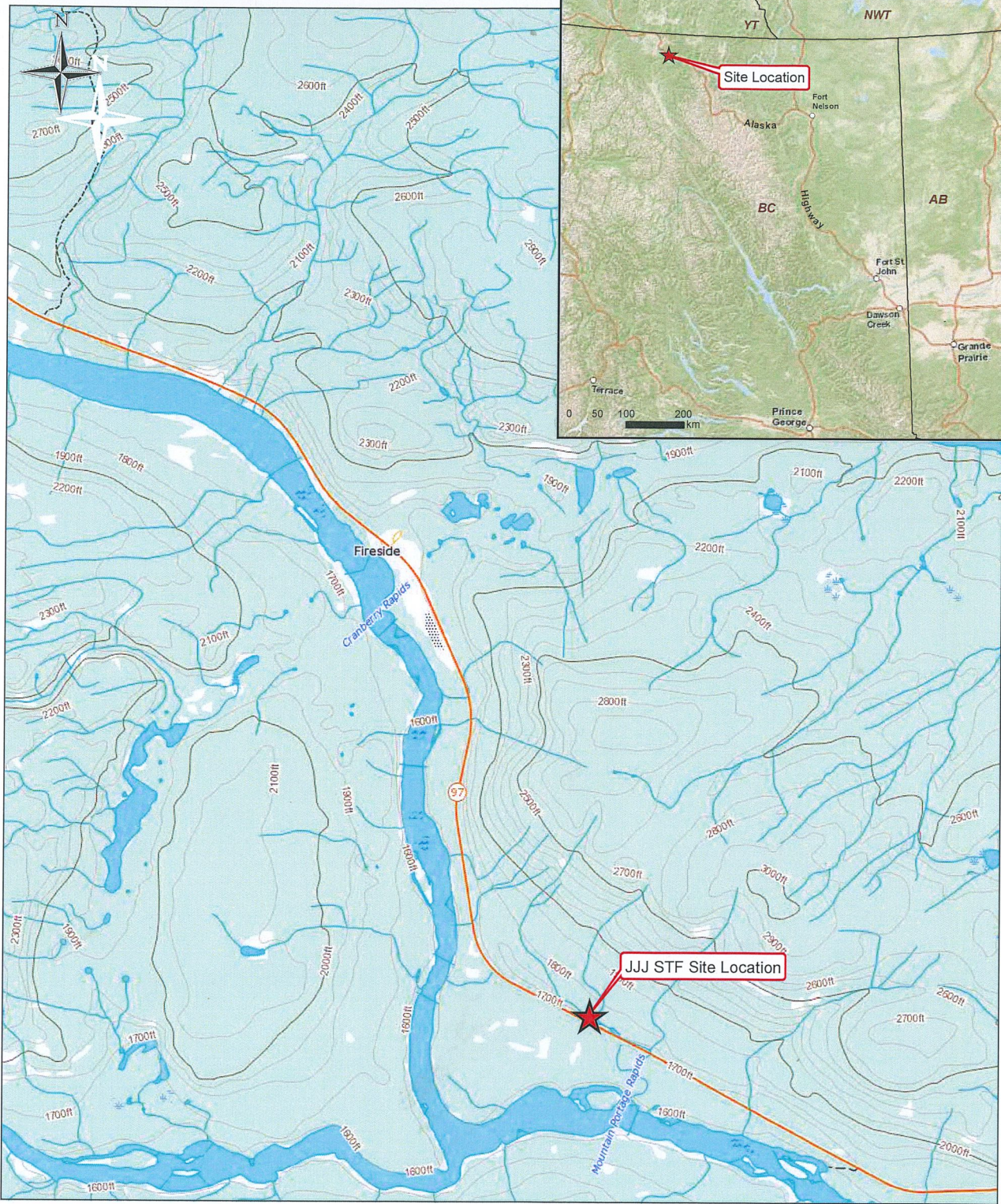

Drawing No. Drawing Title

JJJ Gravel Pit

636200-1008	JJJ STF Site Location
636200-1009	Site Plan – JJJ Gravel Pit
636200-1010	Soil Treatment #4 Design Specifications (similar construction details for all cells on site)



LEGEND



Site Location



NOTES

1. Original in colour.
2. Numerical scale reflects full-size print. Print scaling will distort this scale, however scale bar will remain accurate.
3. Intended for illustration purposes, accuracy has not been verified for construction or navigation purposes.

Handwritten signature and date: May 25/18



SNC • LAVALIN

CLIENT NAME:
Public Works and Government
Services Canada

PROJECT LOCATION:
J.J.J. STF
Alaska Highway, BC

J.J.J. STF Site Location

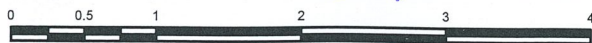

BY PB

DATE: 2017-03-03

REF No: REV: 0

CHK'D: CS

SCALE: 1:50,000

636200-1008

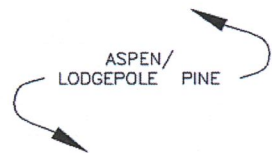
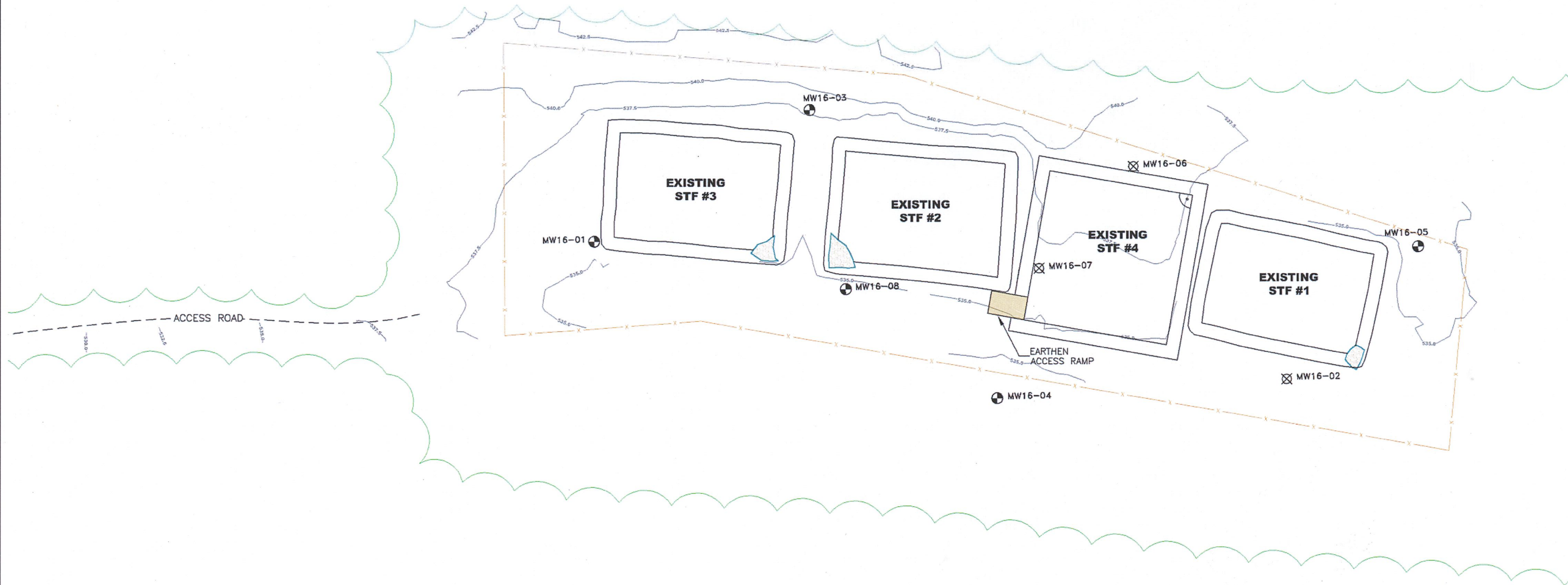

M. A. Guest
May 25/18

LEGEND		NOTES		REFERENCE DRAWINGS		SNC • LAVALIN							
	TREE LINE (APPROX.)		LEACHATE COLLECTION SYSTEM	1. ORIGINAL DRAWING IN COLOUR.	IMAGERY	1969	GOOGLE EARTH	CLIENT NAME: PUBLIC SERVICES AND PROCUREMENT CANADA		PROJECT LOCATION: JJJ GRAVEL PIT KM 839 ALASKA HIGHWAY, FIRESIDE, B.C.			
	MONITORING WELL LOCATION		TOPOGRAPHICAL LINE AND ELEVATION (masl)	2. LOCATION OF EXISTING UTILITIES SHOWN ARE APPROXIMATE ONLY AND SHOULD BE CONFIRMED PRIOR TO INTRUSIVE WORK. NOT ALL UTILITIES MAY BE SHOWN.	DWG. NO.	DATE	DESCRIPTION	TITLE: SITE PLAN - JJJ GRAVEL PIT		DWN BY: PES	SCALE: 1:1,500	DATE: 2018-03-16	DWG No: REV.: 1
	MONITORING WELL TO BE DECOMMISSIONED				REVISIONS					CHK'D: CS	PLOT: 20180525.1030	CADFILE: 636200R18	636200-1009
	DECOMMISSIONED MONITORING WELL												
	FENCE				1	2018-05-25	ISSUED TO CLIENT	PES	MG				
	SOIL BERM				0	2018-03-26	ISSUED TO CLIENT AS DRAFT	PES	CS				
	SOIL FILE				REV.	DATE	DESCRIPTION	BY	CHK				

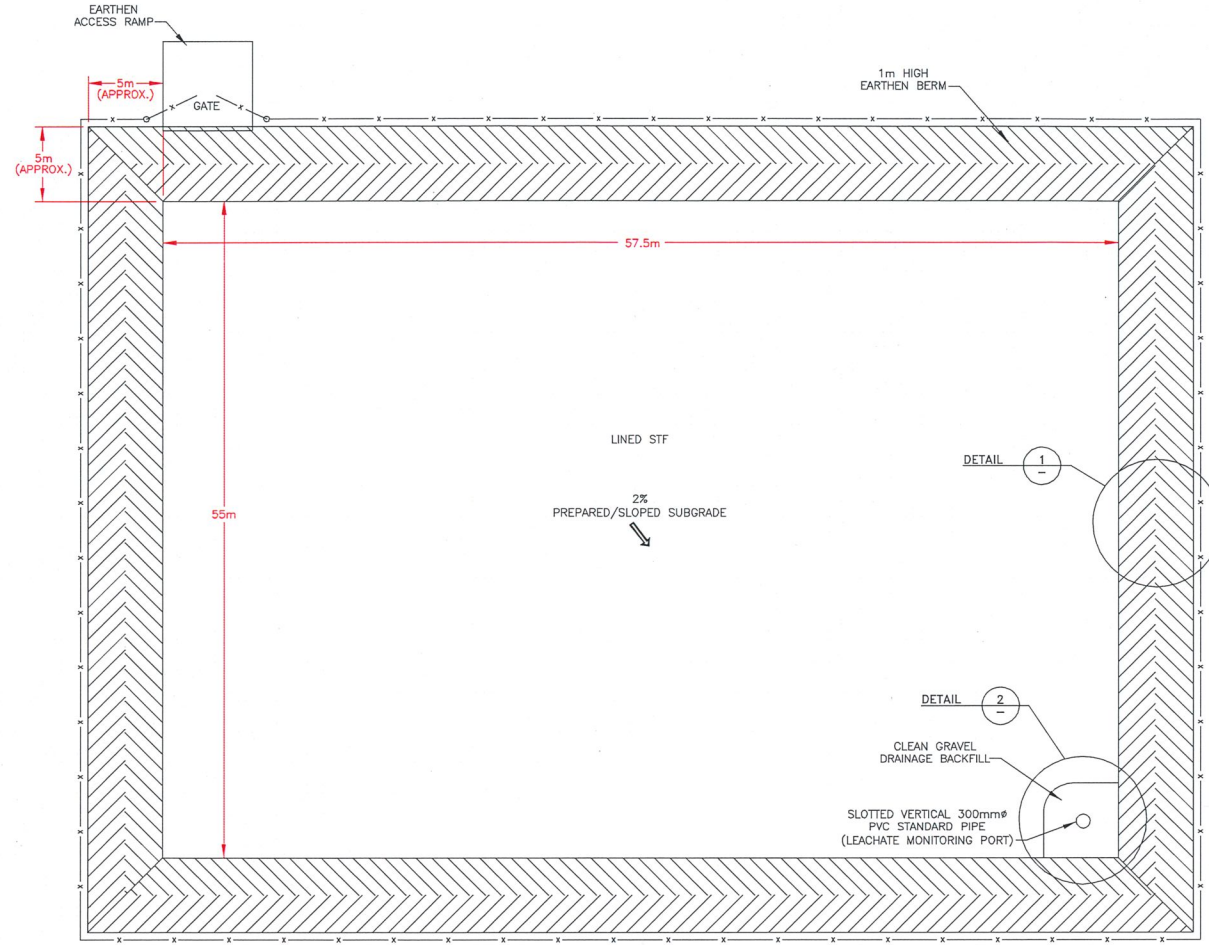

— x — 2m HIGH CHAIN LINK PERIMETER FENCING

NOTES:
 1) PREPARED SUBGRADE TO BE FREE OF PROTRUSIONS (ANGULAR COARSE FRAGMENTS, DEBRIS, ETC.) PRIOR TO CONSTRUCTION OF STF.
 2) DESIGN SPECIFICATIONS APPLY TO ALL THREE PROPOSED STFS. ORIENTATION OF STFS TO REFLECT SITING CONSIDERATIONS. LEACHATE COLLECTION SYSTEM LOCATION TO BE CONSTRUCTED IN MOST SUITABLE CORNER IN CONSIDERATION OF SITE PREPARATION AND TOPOGRAPHY.
 SECOND NOTE: EARTHEN ACCESS RAMP AND GATE LOCATIONS TO BE CONSTRUCTED TO PROVIDE EASE OF ACCESS AND TO MINIMIZE INTERFERENCE WITH EXISTING ROADWAYS AND IF NECESSARY, RE-LOCATED ROADWAYS.

PROFESSIONAL ENGINEER
 PROVINCE OF
M. A. GUEST
 #27328
 19871944
 COLUMBIA
 ENGINEER

M. A. Guest
 May 25/18

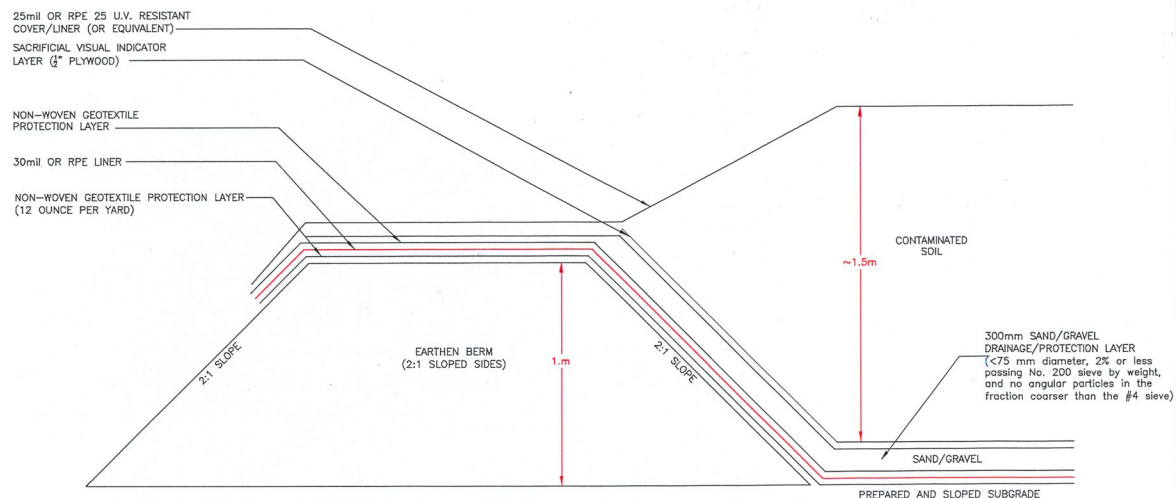

DETAIL 1
N.T.S.

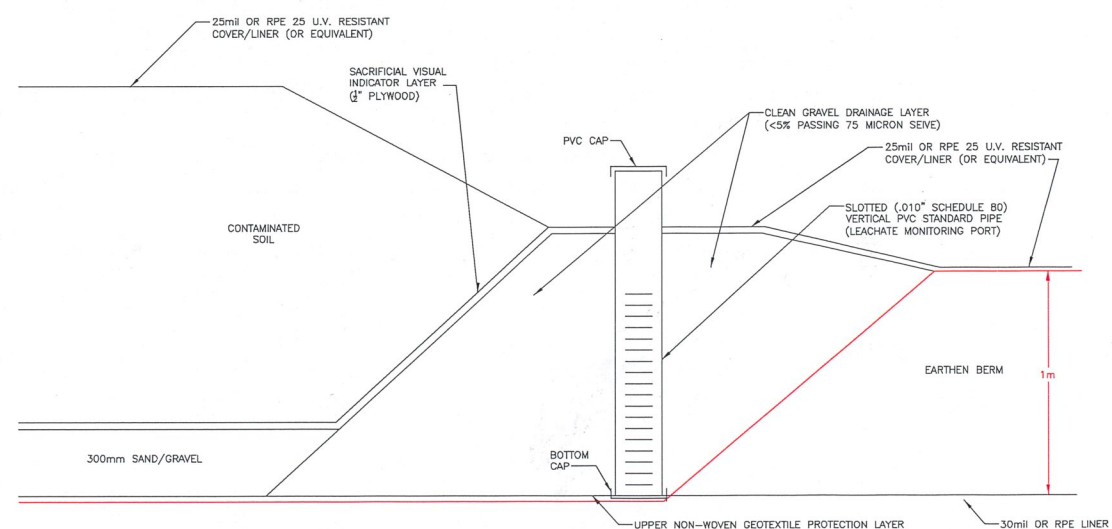

DETAIL 2
N.T.S.

LEGEND

NOTES

- 1. ORIGINAL DRAWING IN COLOUR.
- 2. SCALE IS APPROXIMATE.

REFERENCE DRAWINGS

DWG. NO.	DATE	DESCRIPTION	BY	CHK'D
REVISIONS				
1	2018-05-25	ISSUED TO CLIENT	PES	MG
0	2018-03-26	ISSUED TO CLIENT AS DRAFT	PES	CS
REV.	DATE	DESCRIPTION	BY	CHK



CLIENT NAME: PUBLIC WORKS AND GOVERNMENT SERVICES CANADA	PROJECT LOCATION: J.J. GRAVEL PT km839 ALASKA HIGHWAY, FRESIDE, B.C.
TITLE: SOIL TREATMENT FACILITY #4 DESIGN SPECIFICATIONS	
DWN BY: PES	SCALE: AS SHOWN
DATE: 2018-03-16	DWG NO: REV: 1
CHK'D: CS	PLOT: 20180525.1032
CADFILE: 636200R18	636200-1010



Km 713 Gravel Pit

635031-1001 Muncho Lake and Km 713 Gravel Pit, Alaska Highway, BC
(location map)

635031-LET10 Soil Treatment Facility Layout, Km 713 Gravel Pit

635031-LET11 Soil Treatment Facility Configuration, Km 713 Gravel Pit

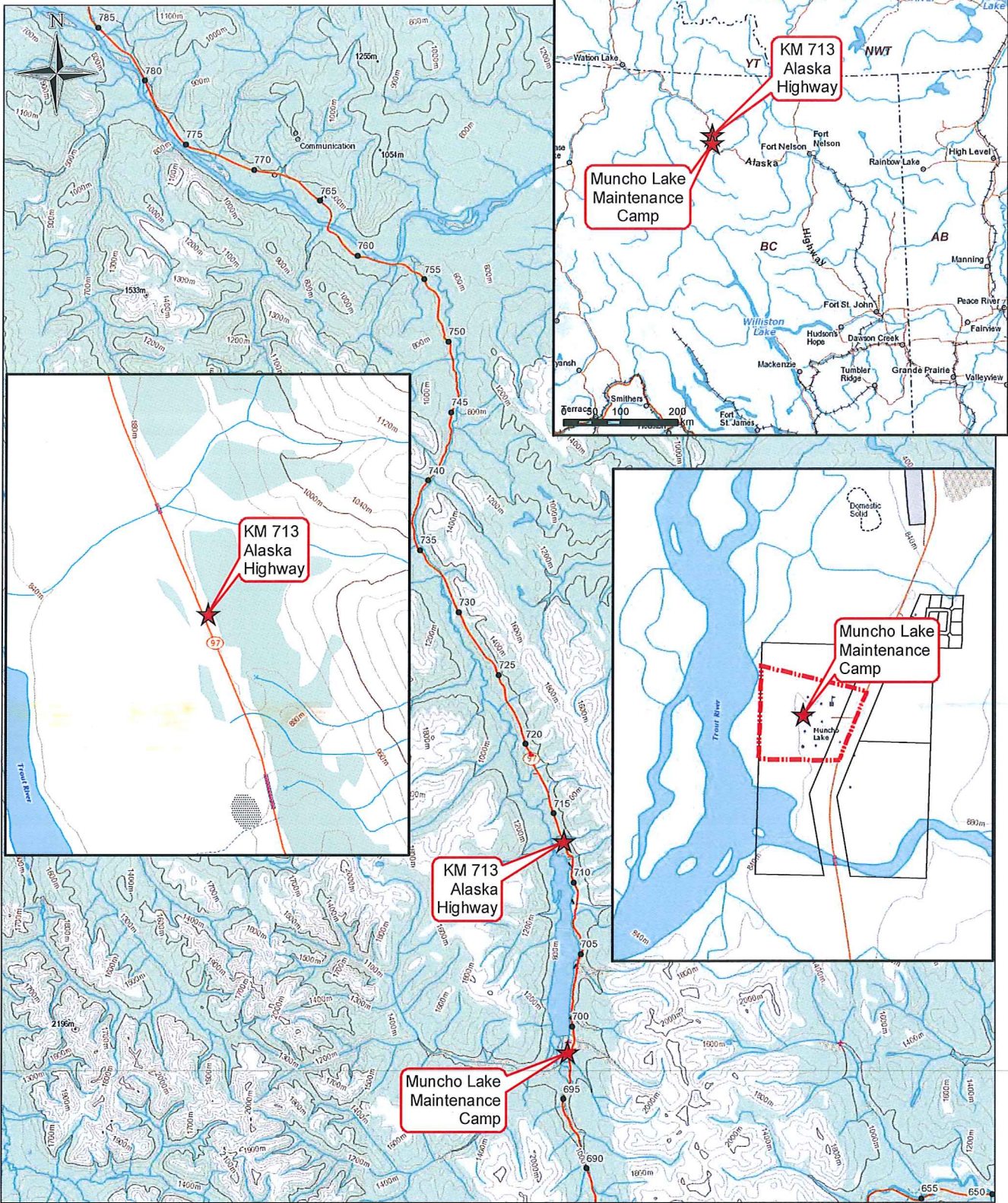

- LEGEND**
- KM Markers
 - ★ Site Location
 - ▭ Site Boundary

NOTES

1. Original in colour.
2. Numerical scale not at full-size print. Print scaling will distort the scale, however scale bar will remain accurate.
3. Intended for illustration purposes, accuracy has not been verified for construction or navigation purposes.

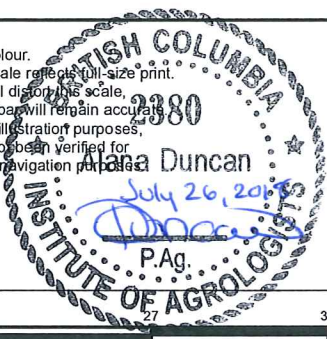

CLIENT NAME: Public Works and Government Services Canada	PROJECT LOCATION: Muncho Lake Alaska Highway, BC
--	--

**Muncho Lake and km 713 Gravel Pit
Alaska Highway, BC**



BY: DM	DATE: 2017-03-31	REF No: REV: 0
CHKD: SJWM	SCALE: 1:20,000	635031-1001

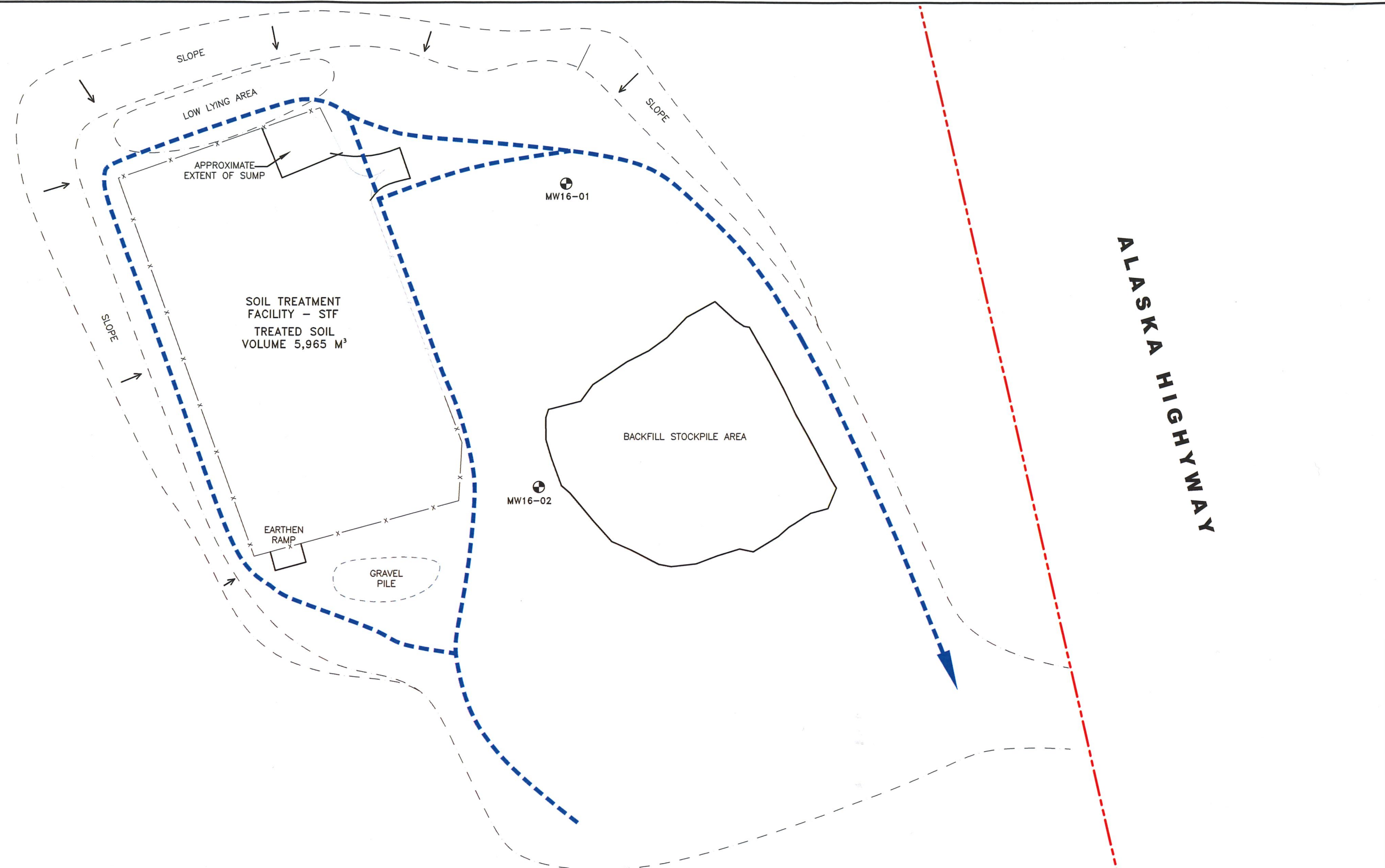
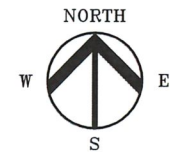

LEGEND

- PROPERTY BOUNDARY
- x EXISTING FENCE
- EXISTING ACCESS ROAD
- SLOPE/EDGE OF CLEARING (APPROX.)
- MONITORING WELL



NOTES

1. ORIGINAL DRAWING IN COLOUR.

REFERENCE DRAWINGS

DWG. NO.	DATE	DESCRIPTION
REVISIONS		



CLIENT NAME: PUBLIC SERVICES AND PROCUREMENT CANADA		PROJECT LOCATION: KM 713 GRAVEL PIT ALASKA HIGHWAY, B.C.	
TITLE: SOIL TREATMENT FACILITY LAYOUT KM 713 GRAVEL PIT			
DWN BY: PRT	SCALE: 1:1,000	DATE: 2018-05-25	DWG No: 635031-LET10 REV: 0
REV. 0	DATE 2018-05-25	DESCRIPTION ISSUED TO CLIENT	BY PRT CHK BH
CHK'D: TM	PLOT: 20180524.1631	CADFILE: 635031-LET10	635031-LET10

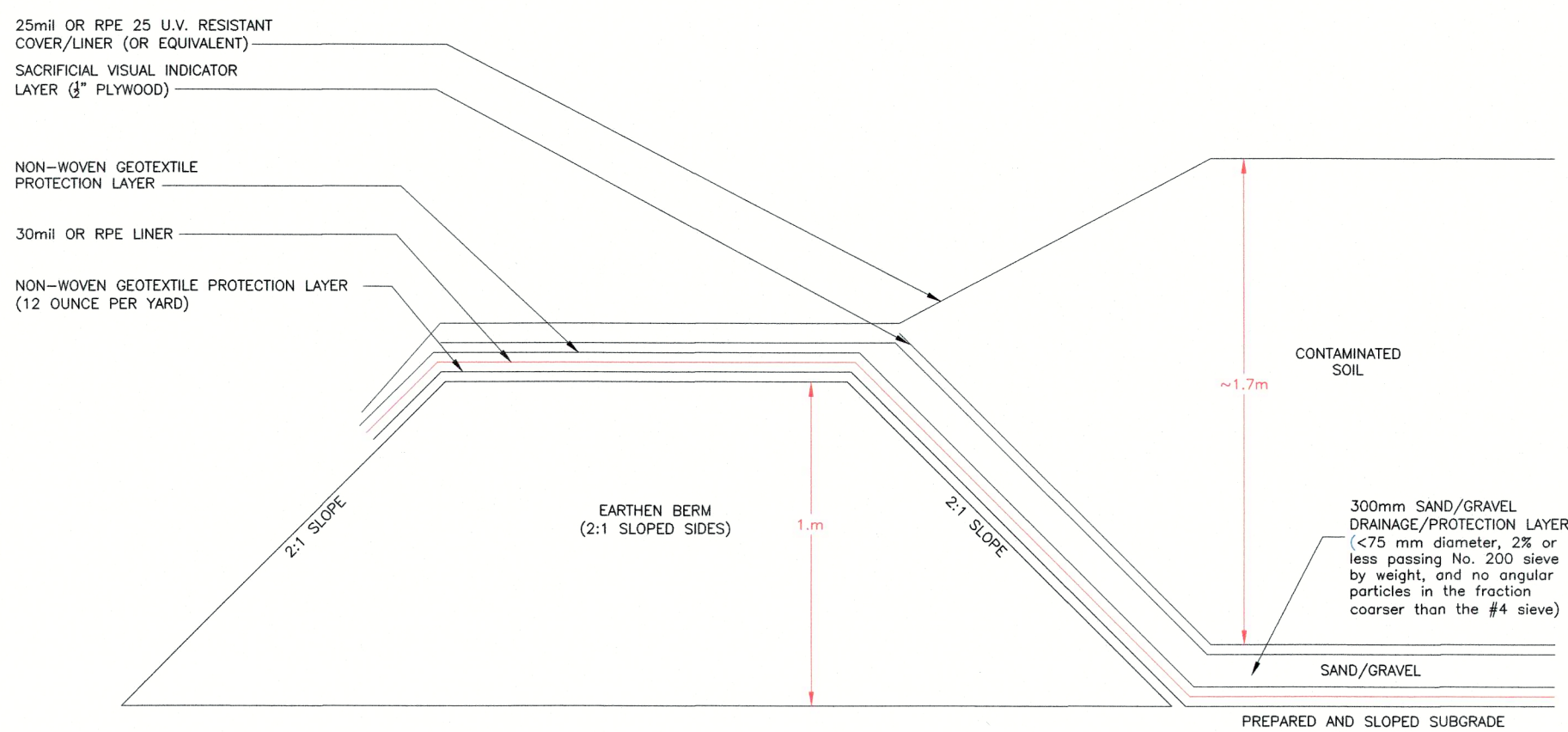
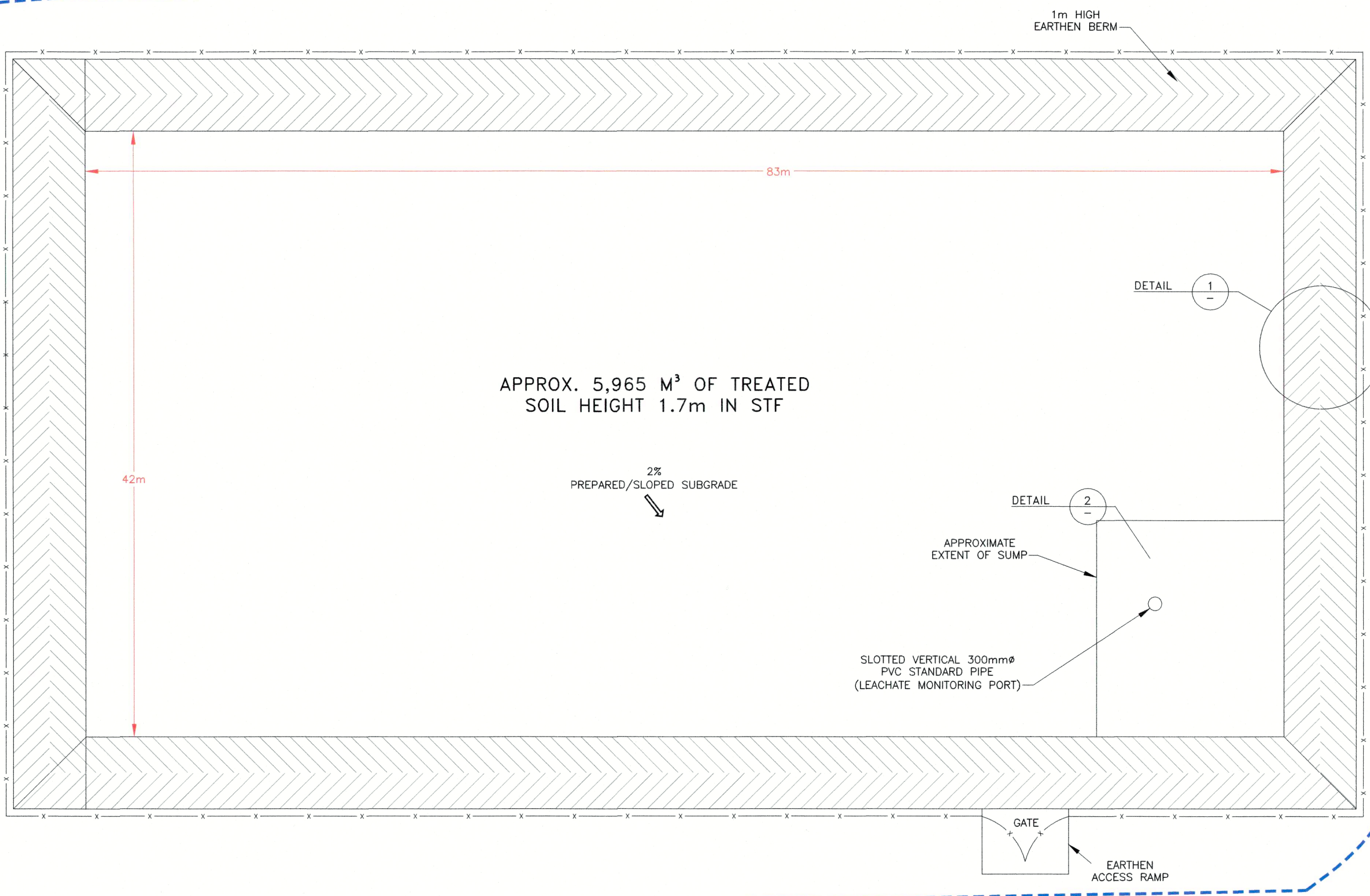

DETAIL 1
N.T.S.

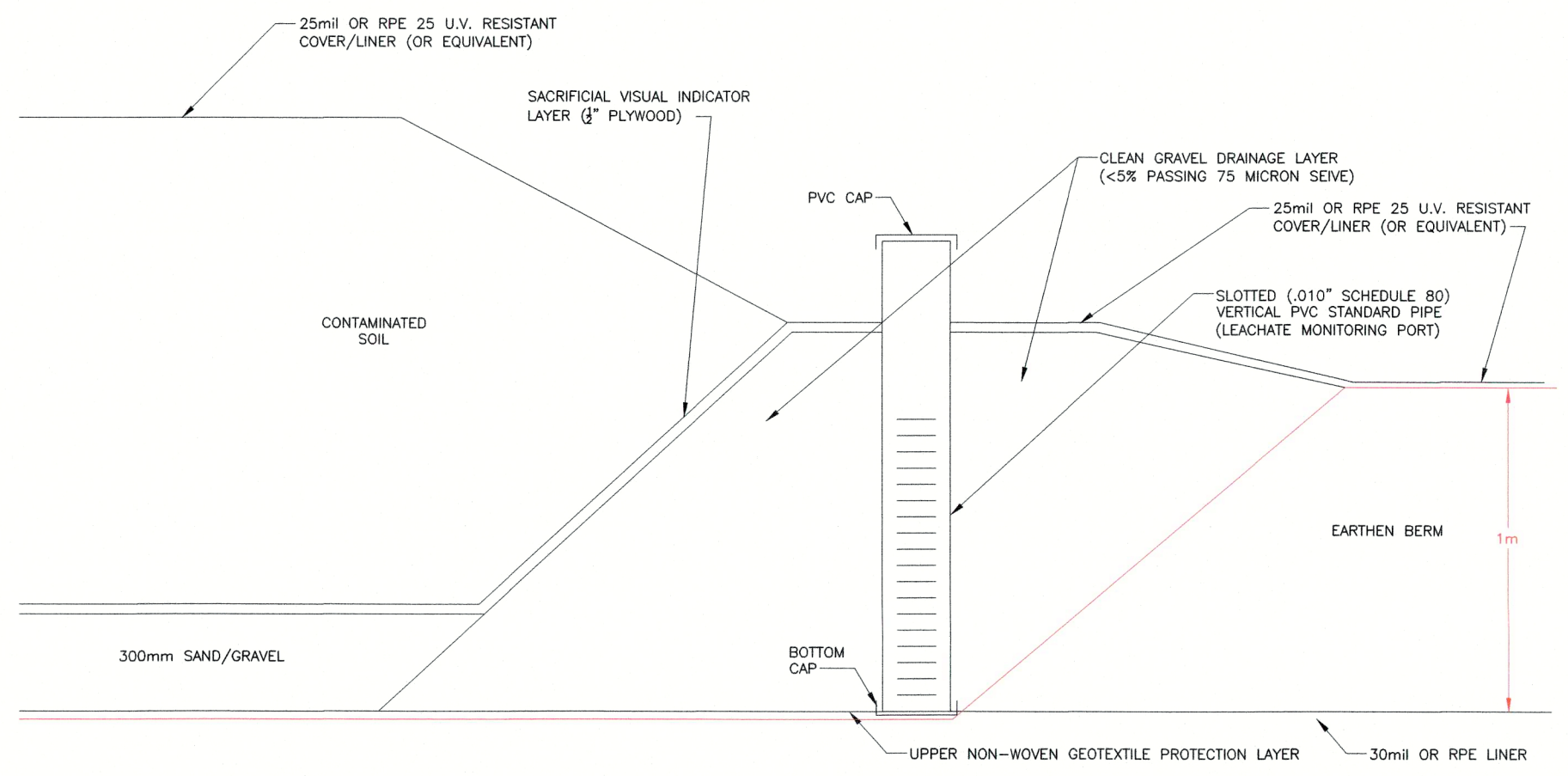

DETAIL 2
N.T.S.

LEGEND

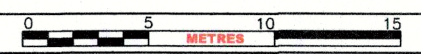

NOTES

1. ORIGINAL DRAWING IN COLOUR.
2. LOCATION OF EXISTING UTILITIES SHOWN ARE APPROXIMATE ONLY AND SHOULD BE CONFIRMED ON SITE. NOT ALL UTILITIES MAY BE SHOWN.

REFERENCE DRAWINGS

DWG. NO.	DATE	DESCRIPTION	BY	CHK
REVISIONS				
0	2018-05-25	ISSUED TO CLIENT	PRT	BH
REV.	DATE	DESCRIPTION	BY	CHK

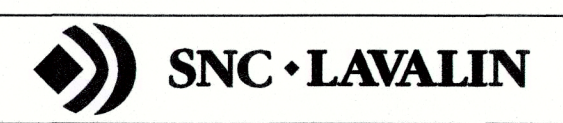

CLIENT NAME: PUBLIC SERVICES AND PROCUREMENT CANADA
 PROJECT LOCATION: KM 713 GRAVEL PIT ALASKA HIGHWAY, B.C.
 TITLE: **SOIL TREATMENT FACILITY CONFIGURATION KM 713 GRAVEL PIT**

DWN BY: DM SCALE: AS SHOWN DATE: 2016-07-05 DWG No: REV: 0
 CHK'D: SJWM PLOT: 20180524.1629 CADFILE: 635031-LET11

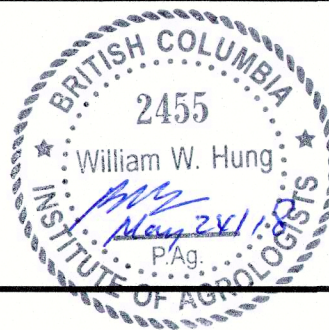



Stringer Creek Gravel Pit

635734-006 Stringer Creek Gravel Pit Site Location

635734-405 Stringer Creek Site Plan

635734-406 Soil Treatment Facility As-Built-Stringer Creek Pit (prior to soil removal in 2017)

CAN-AM - As-Built Plan Showing Stringer Creek Treatment Site
20172426 (following soil removal in 2017)

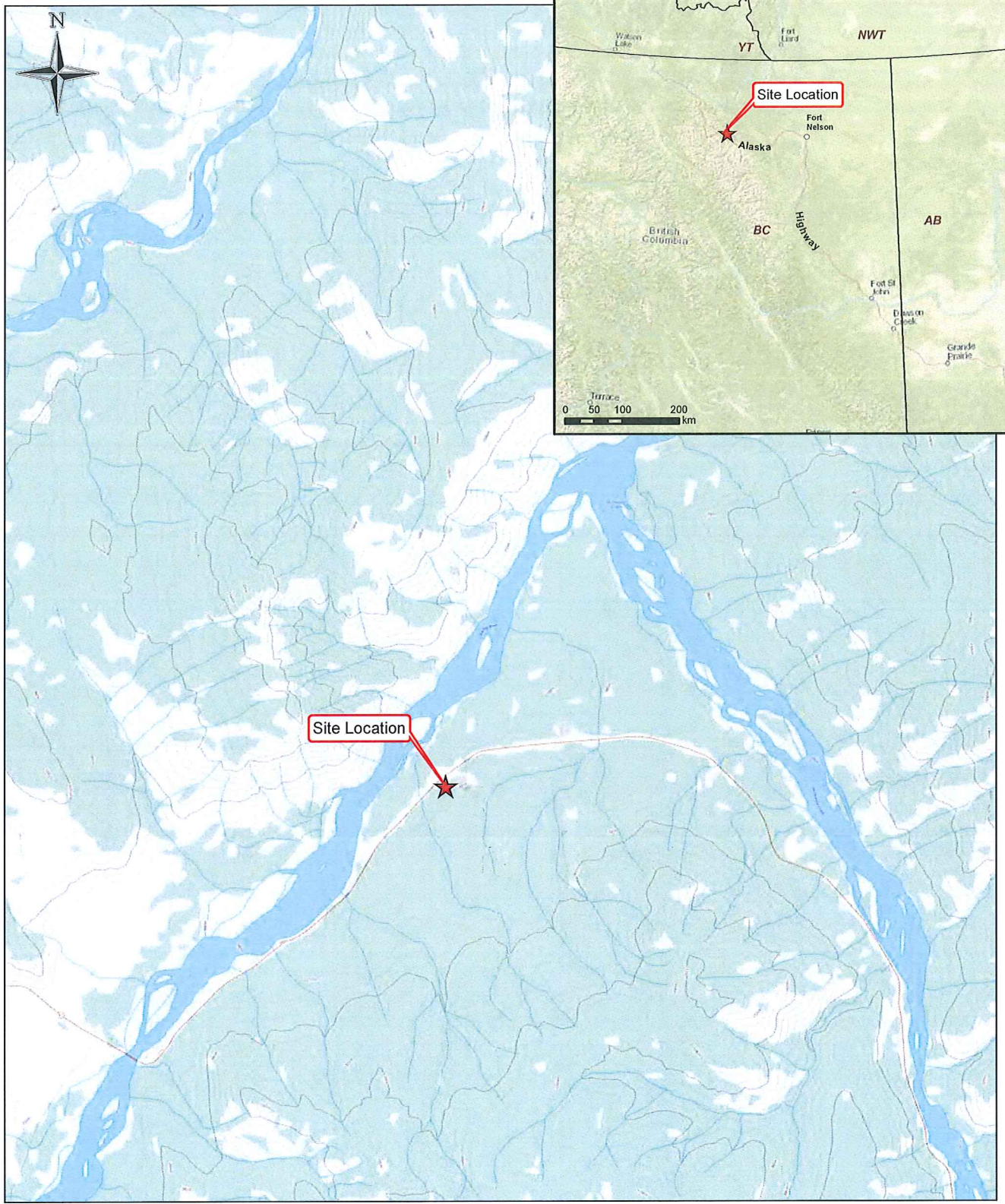

LEGEND

★ Site Location

2380

Alana Duncan

Alana Duncan

P.Ag.

INSTITUTE OF AGROLOGISTS

NOTES

1. Original in colour.
2. Numerical scale reflects full-size print. Print scaling will distort this scale, however scale bar will remain accurate.
3. Intended for illustration purposes, accuracy has not been verified for construction or navigation purposes.

May 25, 2018

SNC • LAVALIN

<p>CLIENT NAME:</p>  <p>Public Services and Procurement Canada</p>	<p>PROJECT LOCATION:</p> <p>Stringer Creek Gravel Pit Alaska Highway, BC</p>
<p>Stringer Creek Gravel Pit Site Location</p>	
<p>BY: JS</p> <p>CHK'D: MR</p>	<p>DATE: 2017-03-31</p> <p>SCALE: 1:10,000,000</p>
<p>REF No: 635734-006</p> <p>REV: 0</p>	

0 1 2 3 4 Kilometers

MXD Path: P:\Current Projects\PWGSC\635734-Toad River\4.0 Execution\4.5 GIS and Drawings\GIS\635734-404.mxd

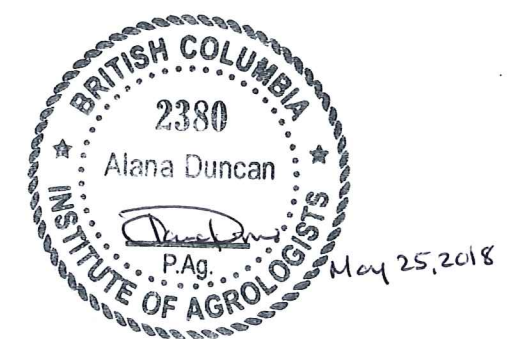

LEGEND

0 5 10 50 METRES

- TOE SLOPE/EDGE OF CLEARING (APPROX.)
- APPROXIMATE LOCATION OF GRAVEL PILE (w/ HEIGHT)
- ~ TREE LINE (APPROX.)
- x- FENCE

NOTES

1. ORIGINAL DRAWING IN COLOUR.
2. LOCATION OF EXISTING UTILITIES SHOWN ARE APPROXIMATE ONLY AND SHOULD BE CONFIRMED PRIOR TO INTRUSIVE WORK. NOT ALL UTILITIES MAY BE SHOWN.
3. GRAVEL PILE LOCATIONS AND SIZE ARE APPROXIMATE ONLY.
4. CONTRACTOR TO EVALUATE ACCESS CONSTRAINTS TO STF PRESENTED BY EXISTING GRAVEL PILE.

REFERENCE DRAWINGS

IMAGERY	DATE	DESCRIPTION
-		BING AERIAL IMAGERY

REVISIONS

REV.	DATE	DESCRIPTION	BY	CHK
1	2016-08-09	ISSUED TO CLIENT	BB	AD



CLIENT NAME: PUBLIC SERVICES AND PROCUREMENT CANADA
 PROJECT LOCATION: STRINGER CREEK GRAVEL PIT, KM 638.7 ALASKA HIGHWAY, B.C.

STRINGER CREEK SITE PLAN

TITLE: **STRINGER CREEK SITE PLAN**

DWN BY: DRB/BB SCALE: 1:1,000 DATE: 2017-01-30 DWG No: REV: **1**
 CHK'D: DF PLOT: 20170314.1008 CADFILE: 635734R8 **635734-405**

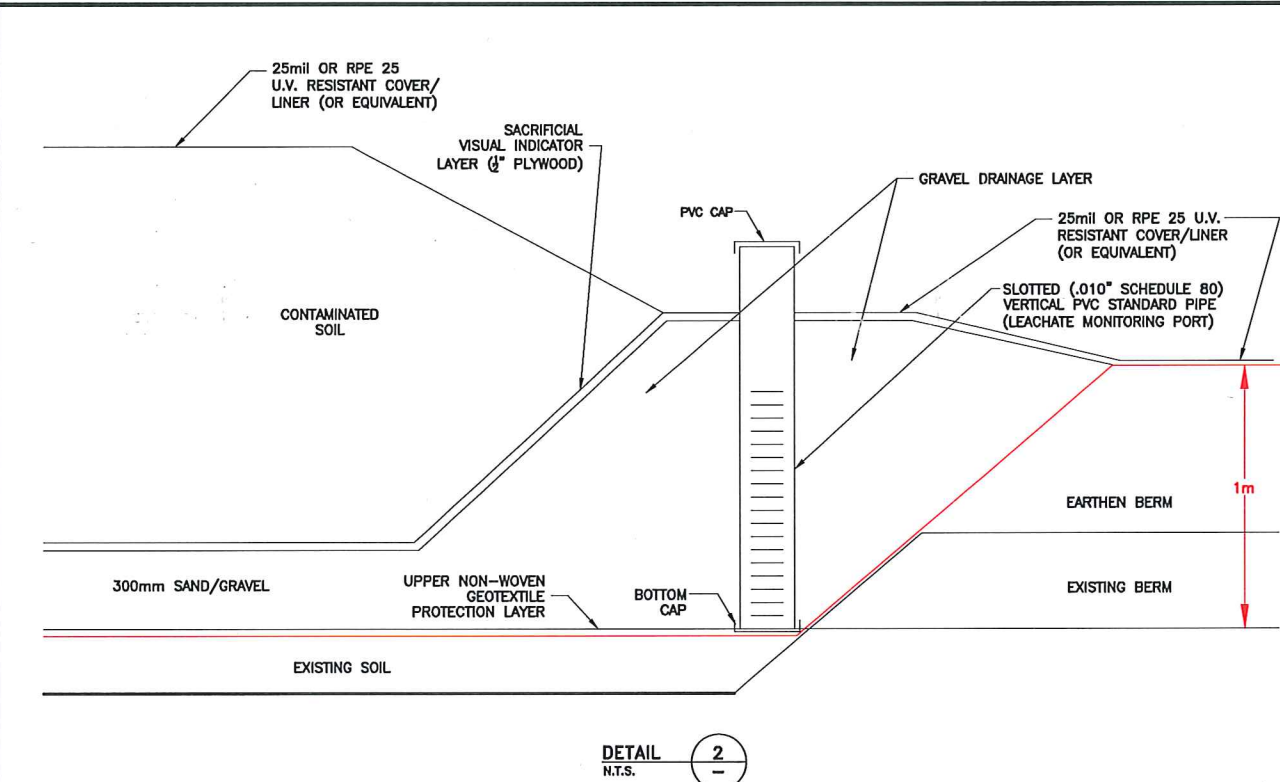
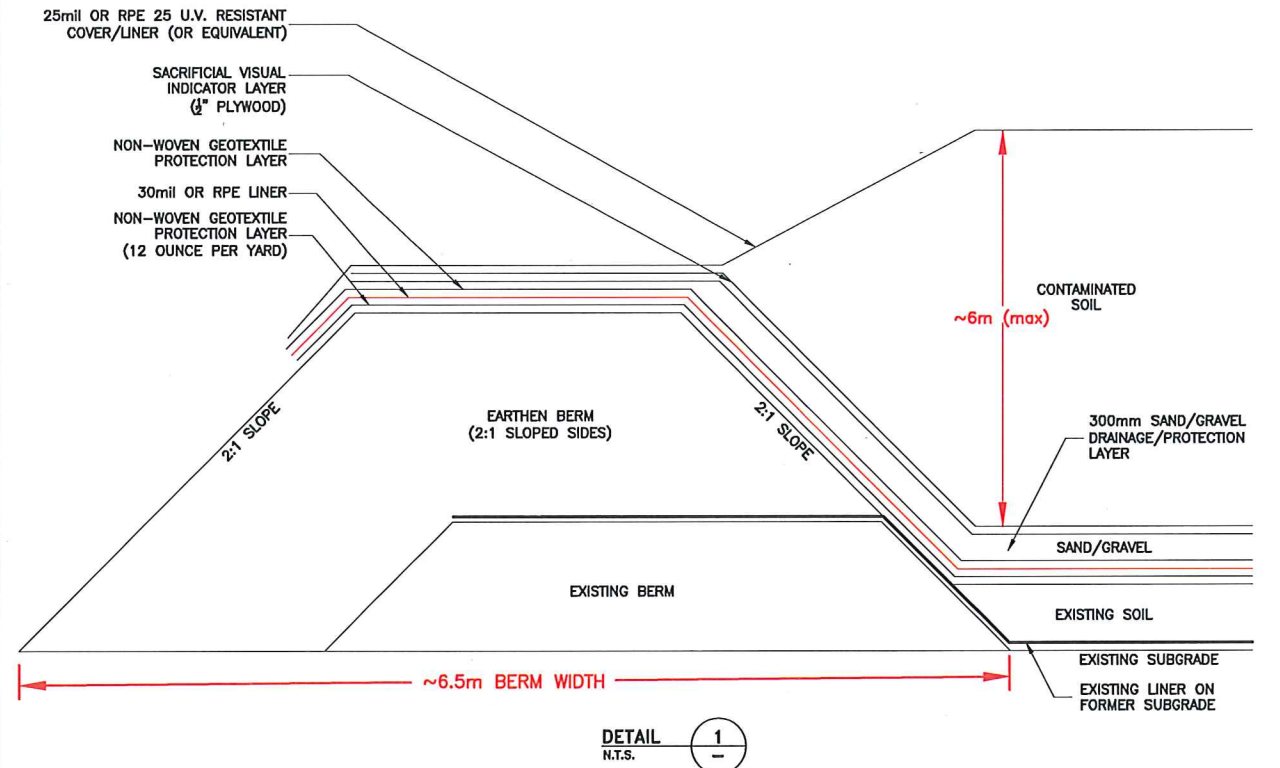
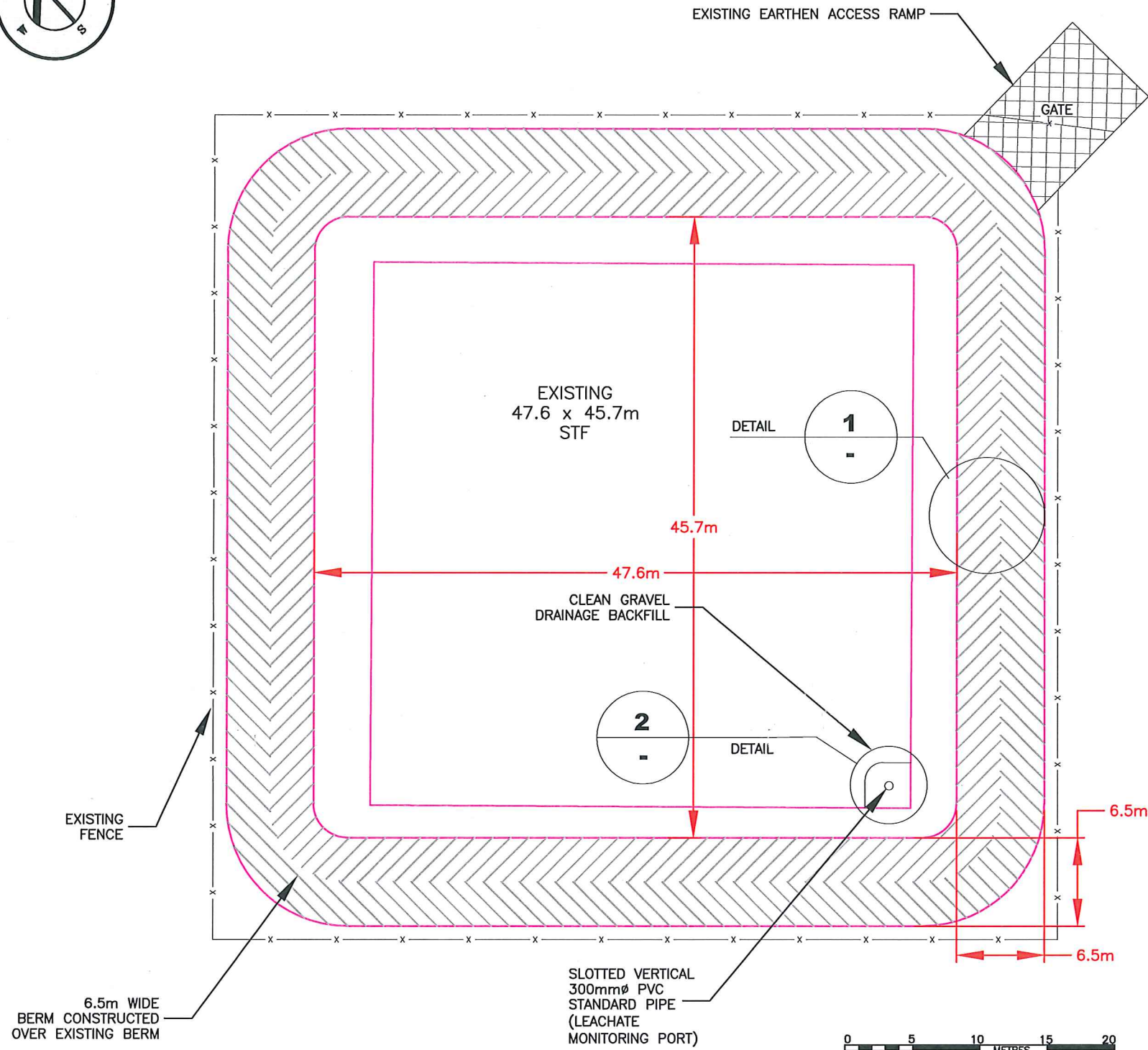

LEGEND

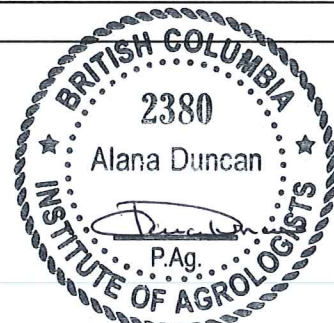

May 25, 2018

NOTES

1. ORIGINAL DRAWING IN COLOUR.
2. SUBGRADE SLOPE AND POSITION OF LEACHATE COLLECTION SYSTEM TO BE DETERMINED IN FIELD BASED ON TOPOGRAPHY.

REFERENCE DRAWINGS

DWG. NO.	DATE	DESCRIPTION	BY	CHK
0				
REVISIONS				



CLIENT NAME: PUBLIC SERVICES AND PROCUREMENT CANADA	PROJECT LOCATION: STRINGER CREEK GRAVEL PIT, KM 638.7 ALASKA HIGHWAY, B.C.		
SOIL TREATMENT FACILITY AS BUILT - STRINGER CREEK PIT			
DWN BY: BB	SCALE: 1:400	DATE: 2017-01-30	SERIES No: REV: 0
CHK'D: DF	PLOT: 20170314.1008	CADFILE: 635734R8	635734-406

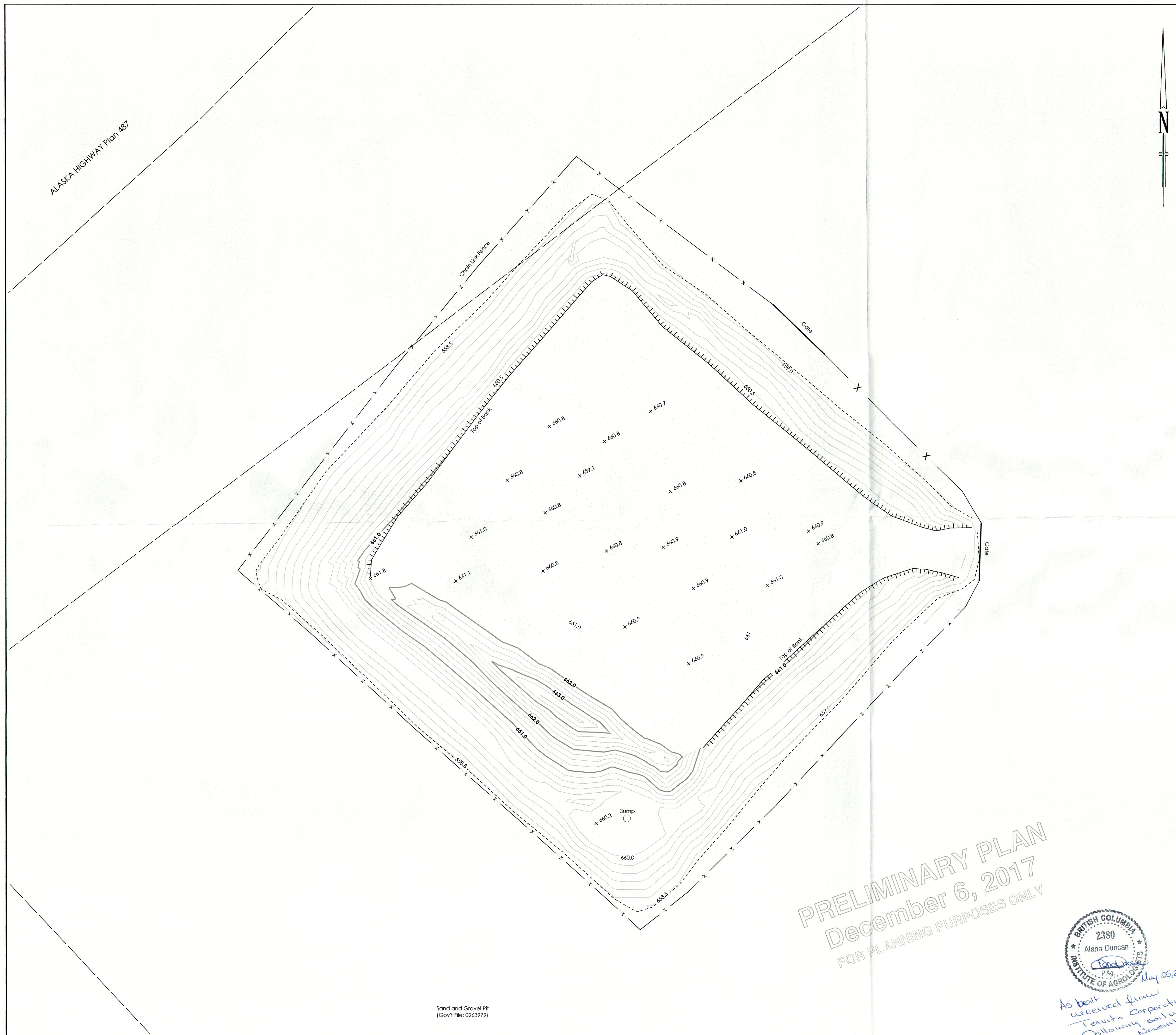

ALASKA HIGHWAY Plan 487



PRELIMINARY PLAN
December 6, 2017
FOR PLANNING PURPOSES ONLY

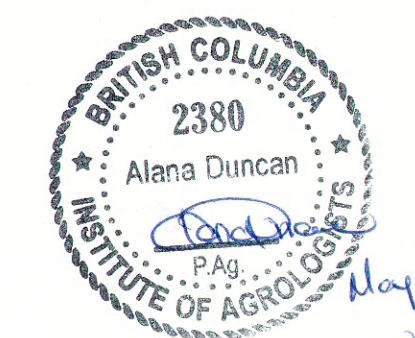

As built received from Tervita Corporation following soil sampling November 2017

Sand and Gravel Pit (Gov'l File: 0263979)

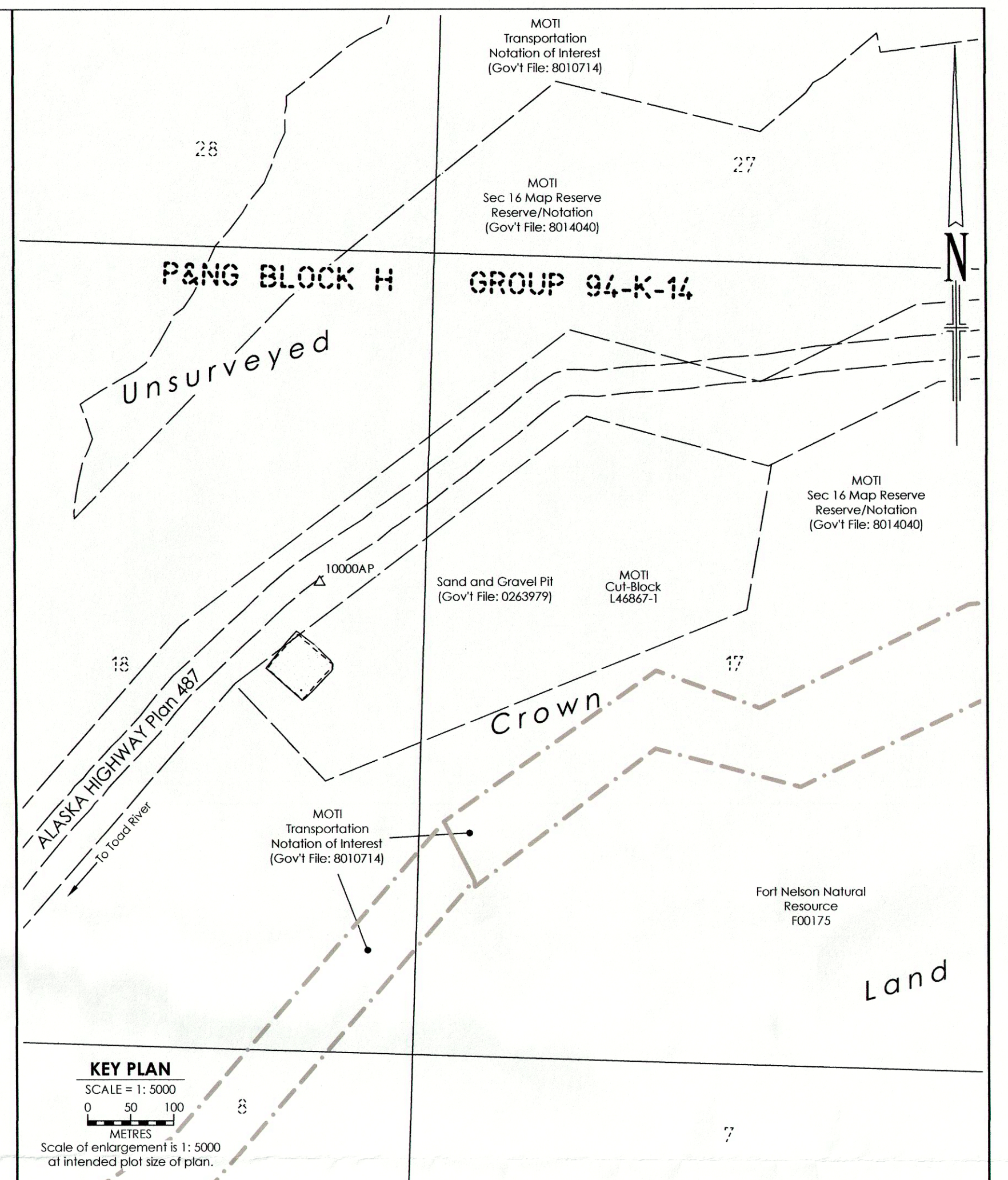

KEY PLAN
SCALE = 1: 5000
0 50 100
METRES
Scale of enlargement is 1: 5000 at intended plot size of plan.

NOTES:
All underground facilities shown were located with electronic locators and may be subject to error. Actual locations should be verified independently by the contractor in field prior to any crossings.

The field survey represented by this plan was completed on the 25th day of November, 2017.
Elevations are derived from: 10000AP; N.6524830.698, E.379335.297
Elevation = 685.065 m
Datum: NAD83 (CSRS)2002.0 CGVD28
Elevation = m
Contour Interval = 0.25m
Major Contour: 661.0
Minor Contour: 661.25

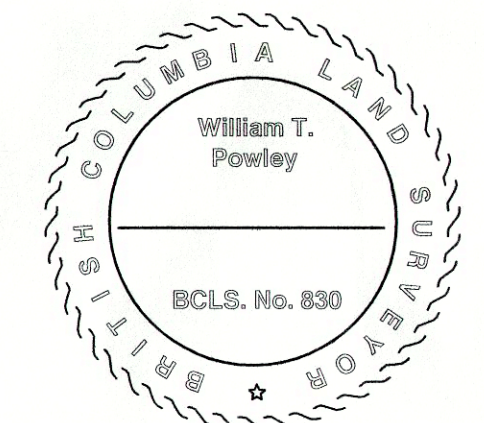

LEGEND:

Abandoned Well	⊕	Fence line	- x - x -
Well Head	⊙	A.L.R. boundary	- A.L.R. -
Well Location	○	Cul block boundary	- - - - -
Texas Gate	⊢	Top of bank/break in slope	- / - / - / - / -
Culvert	⊢	Bush Line	- - - - -
Crossing Numbers	①	Stream	- ~ - ~ - ~ - ~ -
Diameter	⊙	Seismic Line	- - - - -
Riser	⊙	Vegetation Change	- - - - -
Blind/End of Signal	⊢	Buried Cable	- C - C -
Above ground pipe	- - - - -	Buried Telephone Cable	- T - T -
Buried Pipe	- - - - -	Overhead Powerlines	- P - P -

APPROVED BY

PROJECT ENGINEER

No.	REVISIONS	BY	DATE (YY/MM/DD)	CKD
0	Original Plan Issued	SJR	17/12/06	TC

TERVITA CORPORATION		
AS BUILT PLAN SHOWING STRINGER CREEK TREATMENT SITE (a-18-H, 94-K-14)		
FIELD:		CAN-AM FILE: 20172426
CLIENT FILE:		
BCGS 94K.085	SCALE = 1 : 200	AFE No.:
2 0 4 8 12 METRES		CAD FILE: 20172426A_B_0
SHEET 1 OF 1		LAND FILE:
can-am geomatics		DATE: 17/12/06
REVISION		0

Sikanni Chief Biocell

--	Cover Page
ID-001	Index & Location Plan
EG-001	Original Ground
FG-001	As-Built Biocell #1 & #2
CS-001	Biocell #1 – Cross Section and Volume
CS-002	Biocell #2 – Cross Section and Volume



Public Works and Government Services Canada

SIKANNI CHIEF BIOCELL REMEDIATION

CONTRACT FOR THE REMEDIATION OF
SIKANNI CHIEF BIOCELL #1 & #2
IN THE PROVINCE OF BRITISH COLUMBIA

BIOCELL #1 & #2 - AS-BUILT SUBMISSION SET
ISSUED: NOVEMBER 2, 2017

SITE

SIKANNI CHIEF BIOCELL AS-BUILT DRAWING INDEX

COVER & INDEX

COVER	SHEET 1 OF 9	COVER PAGE
ID-001	SHEET 2 OF 9	SHEET INDEX & KEY PLAN

BIOCELL #1 & #2 AS-BUILT DRAWINGS

EG-001	SHEET 3 OF 9	ORIGINAL GROUND
FG-001	SHEET 4 OF 9	AS-BUILT BIOCELL #1 & #2
CS-001	SHEET 5 OF 9	BIOCELL #1 - CROSS SECTION & VOLUME
CS-002	SHEET 6 OF 9	BIOCELL #2 - CROSS SECTION & VOLUME



B LOCATION PLAN
SCALE NTS

LEGEND:

NOTES:

1) THIS DRAWING IS PROVIDED FOR INFORMATIONAL PURPOSES ONLY AND REPRESENTS AS-BUILT SURVEY DATA THAT WAS COLLECTED BETWEEN OCTOBER AND NOVEMBER OF THE YEAR 2016 AS WELL AS DATA COLLECTED BETWEEN OCTOBER AND NOVEMBER OF THE YEAR 2017. SITE ENERGY SERVICES WILL NOT BE HELD ACCOUNTABLE FOR ANY DIFFERENCE BETWEEN THE DATA SHOWN AND ANY DATA COLLECTED BEFORE OR AFTER THE DATES OUTLINED ABOVE.

2) ALL DIMENSIONS ARE IN METERS UNLESS OTHERWISE SPECIFIED

△4				
△3				
△2				
△1				

No.	DESCRIPTION	DATE	BY	APP'D
-----	-------------	------	----	-------

CONSULTANT:



APPROVED FOR	BY	DATE
-	-	-
AS-BUILT	JMZ	01/11/2017
COORDINATE SYSTEM	UTM NAD83 - ZONE 10 NORTH	
GEOID MODEL	CANADA GEOID MODEL HT2_0	

SCALE: NTS

	BY	DATE
SURVEYED	WSP & RAYMAC	VARIES
DRAWN	JMZ	01/11/2017
CHECKED	JMZ	01/11/2017



**Public Works and
Government Services
Canada**

PROJECT:

CONTRACT FOR THE REMEDIATION OF
SIKANNI CHIEF BIOCELL
IN THE PROVINCE OF BRITISH COLUMBIA

SHEET TITLE:

SIKANNI CHIEF BIOCELL REMEDIATION

INDEX & LOCATION PLAN

CONTRACT NO.:

EZ897-181206/001/PWY

FILE NO.	SITE PROJECT NO.
-	53-17-EI555
MICROFILM NO.	DRAWING NO.
-	ID-001

K:\2017 PROJECTS\62 NW ALBERTA\62-17-SIKANNI CHIEF BIOCELL\16_Civil_3D\AS-BUILT\EG-001.DWG, 2017-11-02 2:42:12 PM, ANSI FULL BLEED B (11.00 x 17.00 INCHES)

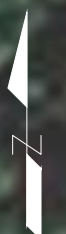

LEGEND:

PLAN VIEW

- EXISTING BIOCELL MAJOR CONTOUR (1.0M INTERVAL)
- EXISTING BIOCELL MINOR CONTOUR (0.2M INTERVAL)
- EXISTING BIOCELL BERM TOE
- EXISTING BIOCELL BERM CREST
- ▨ EXISTING BIOCELL AREA
- 488.857 EXISTING BIOCELL MAJOR CONTOUR LABEL
- ⊕488.850 EXISTING BIOCELL SPOT ELEVATION

NOTES:

1) THIS DRAWING IS PROVIDED FOR INFORMATIONAL PURPOSES ONLY AND REPRESENTS AS-BUILT SURVEY DATA THAT WAS COLLECTED BETWEEN OCTOBER AND NOVEMBER OF THE YEAR 2016 AS WELL AS DATA COLLECTED BETWEEN OCTOBER AND NOVEMBER OF THE YEAR 2017. SITE ENERGY SERVICES WILL NOT BE HELD ACCOUNTABLE FOR ANY DIFFERENCE BETWEEN THE DATA SHOWN AND ANY DATA COLLECTED BEFORE OR AFTER THE DATES OUTLINED ABOVE.

2) ALL DIMENSIONS ARE IN METERS UNLESS OTHERWISE SPECIFIED

No.	DESCRIPTION	DATE	BY	APP'D

CONSULTANT:



APPROVED FOR	BY	DATE
-	-	-
AS-BUILT	JMZ	01/11/2017
COORDINATE SYSTEM	UTM NAD83 - ZONE 10 NORTH	
GEOID MODEL	CANADA GEOID MODEL HT2_0	
SCALE:		
	BY	DATE
SURVEYED	WSP	VARIES
DRAWN	JMZ	01/11/2017
CHECKED	JMZ	01/11/2017



PROJECT:
 CONTRACT FOR THE REMEDIATION OF
 SIKANNI CHIEF BIOCELL
 IN THE PROVINCE OF BRITISH COLUMBIA

SHEET TITLE:
 SIKANNI CHIEF BIOCELL REMEDIATION
 ORIGINAL GROUND

CONTRACT NO. EZ897-181206/001/PWY	
FILE NO. -	SITE PROJECT NO. 53-17-EI555
MICROFILM NO. -	DRAWING NO. EG-001

K:\2017 PROJECTS\62 NW ALBERTA\62-17-SIKANNI CHIEF BIOCELL\6. CIVIL\3D\AS-BUILT\FG-001.DWG, 2017-11-02 2:44:16 PM, ANSI FULL BLEED B (11.00 x 17.00 INCHES)



K:\2017 PROJECTS\62 NW ALBERTA\62-17-SIKANNI CHIEF BIOCELL\6 - CIVIL 3D\AS-BUILT\CS-001.DWG, 2017-11-02 2:38:53 PM, ANSI FULL BLEED B (0.00 x 17.00 INCHES)

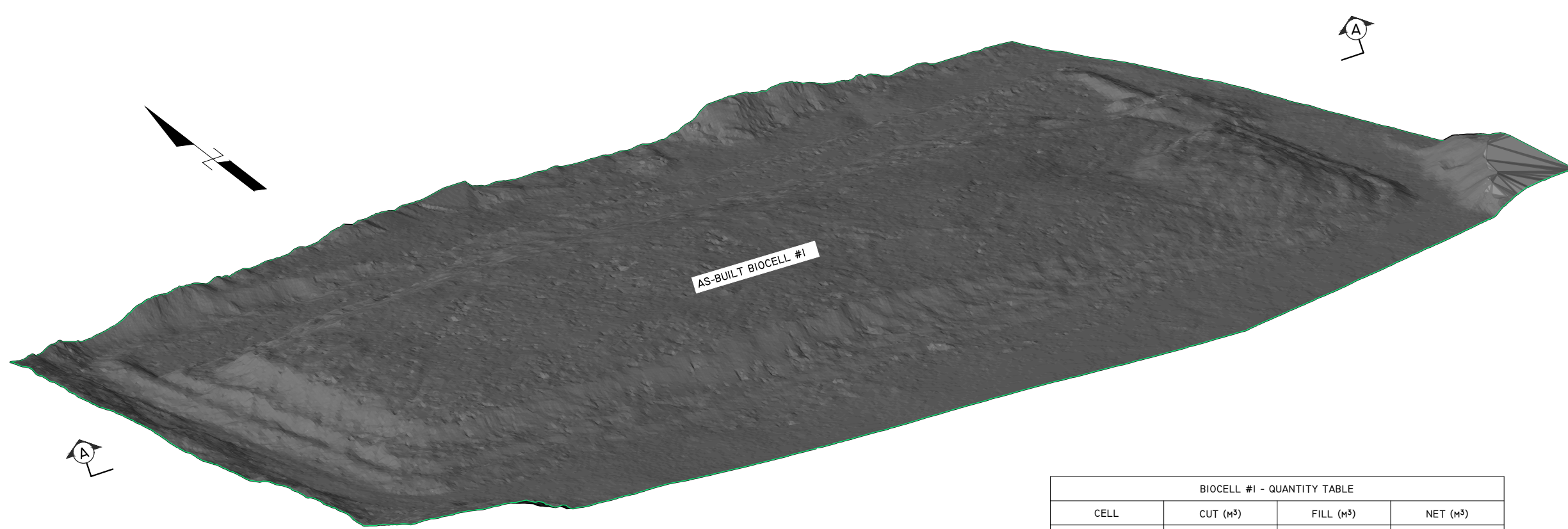

TERRAIN VIEW
SCALE H 1:400

BIOCELL #1 - QUANTITY TABLE			
CELL	CUT (m ³)	FILL (m ³)	NET (m ³)
BIOCELL #1	5592.550	1283.880	4108.670 CUT

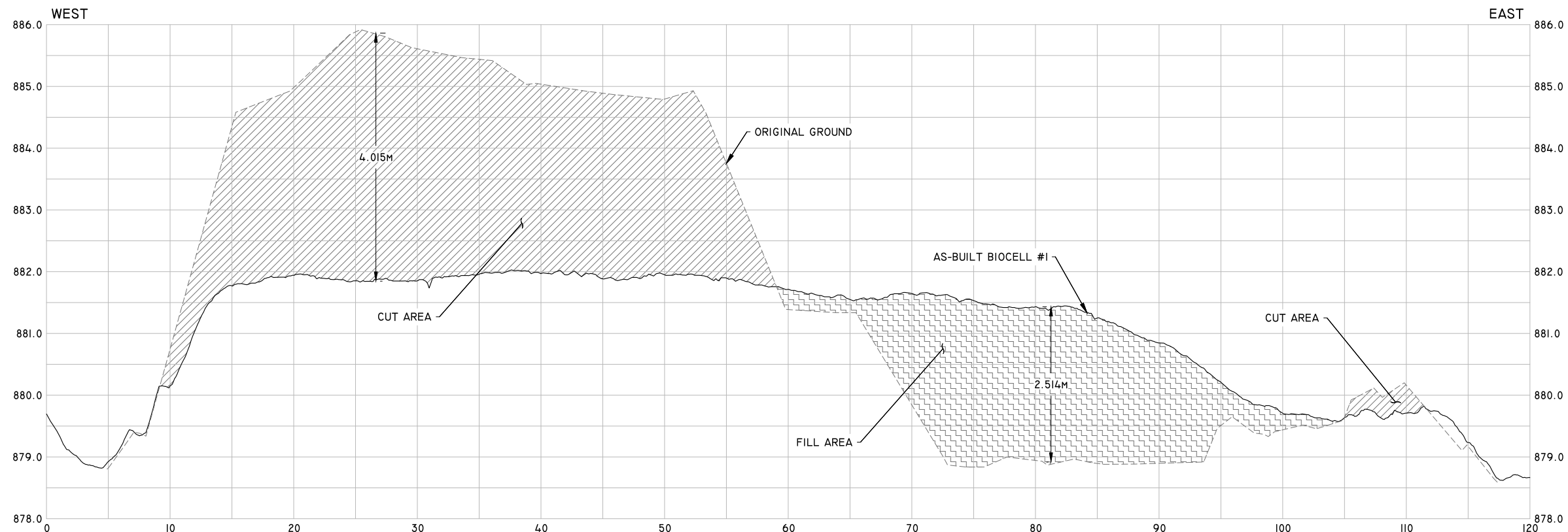

SECTION A
SCALE H 1:400 - V 5x

LEGEND:

- SECTION VIEW
- AS-BUILT BIOCELL
- ORIGINAL GROUND
- CUT AREA
- FILL AREA

NOTES:

1) THIS DRAWING IS PROVIDED FOR INFORMATIONAL PURPOSES ONLY AND REPRESENTS AS-BUILT SURVEY DATA THAT WAS COLLECTED BETWEEN OCTOBER AND NOVEMBER OF THE YEAR 2016 AS WELL AS DATA COLLECTED BETWEEN OCTOBER AND NOVEMBER OF THE YEAR 2017. SITE ENERGY SERVICES WILL NOT BE HELD ACCOUNTABLE FOR ANY DIFFERENCE BETWEEN THE DATA SHOWN AND ANY DATA COLLECTED BEFORE OR AFTER THE DATES OUTLINED ABOVE.

2) ALL DIMENSIONS ARE IN METERS UNLESS OTHERWISE SPECIFIED

△				
△				
△				
△				
No.	DESCRIPTION	DATE	BY	APP'D

CONSULTANT:



APPROVED FOR	BY	DATE
-	-	-
AS-BUILT	JMZ	01/11/2017
COORDINATE SYSTEM	UTM NAD83 - ZONE 10 NORTH	
GEOID MODEL	CANADA GEOID MODEL HT2_0	
SCALE:		
	BY	DATE
SURVEYED	WSP & RAYMAC	VARIES
DRAWN	JMZ	01/11/2017
CHECKED	JMZ	01/11/2017



Public Works and Government Services Canada

PROJECT:
CONTRACT FOR THE REMEDIATION OF SIKANNI CHIEF BIOCELL IN THE PROVINCE OF BRITISH COLUMBIA

SHEET TITLE:
SIKANNI CHIEF BIOCELL REMEDIATION
BIOCELL #1 - CROSS SECTION & VOLUME

CONTRACT NO.:
EZ897-181206/001/PWY

FILE NO.: - **SITE PROJECT NO.:** 53-17-EI555

MICROFILM NO.: - **DRAWING NO.:** CS-001

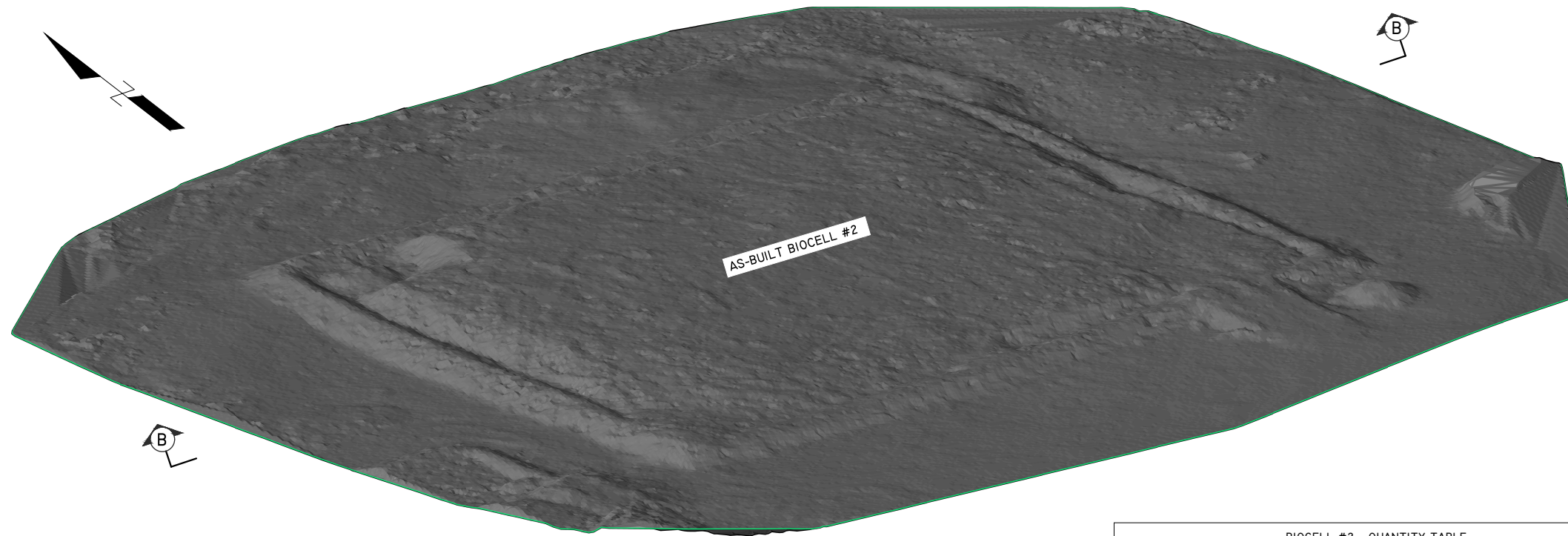

TERRAIN VIEW
SCALE H 1:400

BIOCELL #2 - QUANTITY TABLE			
CELL	CUT (m ³)	FILL (m ³)	NET (m ³)
BIOCELL #2	134.850	5935.070	3800.220 CUT

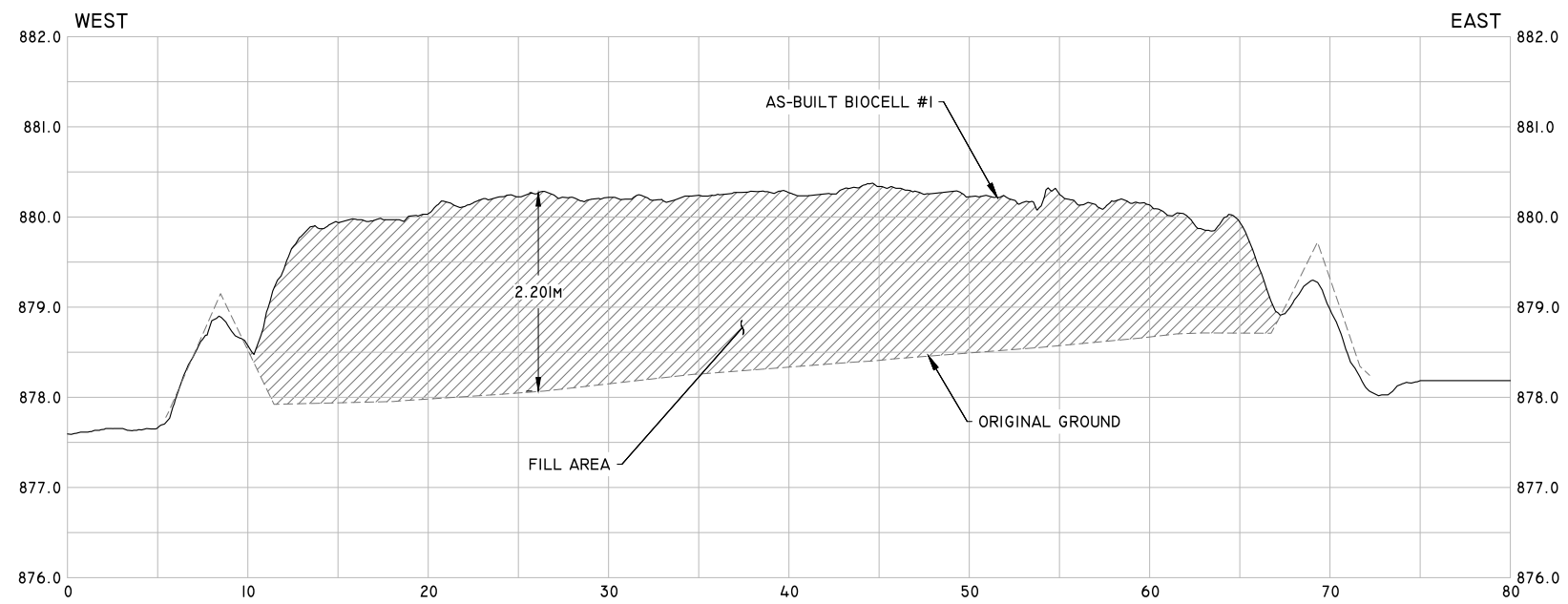

SECTION B
SCALE H 1:400 - V 5x

LEGEND:

- SECTION VIEW
- AS-BUILT BIOCELL
- ORIGINAL GROUND
- CUT AREA

NOTES:

1) THIS DRAWING IS PROVIDED FOR INFORMATIONAL PURPOSES ONLY AND REPRESENTS AS-BUILT SURVEY DATA THAT WAS COLLECTED BETWEEN OCTOBER AND NOVEMBER OF THE YEAR 2016 AS WELL AS DATA COLLECTED BETWEEN OCTOBER AND NOVEMBER OF THE YEAR 2017. SITE ENERGY SERVICES WILL NOT BE HELD ACCOUNTABLE FOR ANY DIFFERENCE BETWEEN THE DATA SHOWN AND ANY DATA COLLECTED BEFORE OR AFTER THE DATES OUTLINED ABOVE.

2) ALL DIMENSIONS ARE IN METERS UNLESS OTHERWISE SPECIFIED

△				
△				
△				
△				
No.	DESCRIPTION	DATE	BY	APP'D

CONSULTANT:



APPROVED FOR	BY	DATE
-	-	-
AS-BUILT	JMZ	01/11/2017
COORDINATE SYSTEM	UTM NAD83 - ZONE 10 NORTH	
GEOID MODEL	CANADA GEOID MODEL HT2_0	
SCALE:		
	BY	DATE
SURVEYED	WSP & RAYMAC	VARIES
DRAWN	JMZ	01/11/2017
CHECKED	JMZ	01/11/2017



**Public Works and
Government Services
Canada**

PROJECT:

**CONTRACT FOR THE REMEDIATION OF
SIKANNI CHIEF BIOCELL
IN THE PROVINCE OF BRITISH COLUMBIA**

SHEET TITLE:

**SIKANNI CHIEF BIOCELL REMEDIATION

BIOCELL #2 - CROSS SECTION & VOLUME**

CONTRACT NO.

EZ897-181206/001/PWY

FILE NO.

-

SITE PROJECT NO.

53-17-EI555

MICROFILM NO.

-

DRAWING NO.

CS-002