

203 WELLMAN CRESCENT
SASKATOON, SASKATCHEWAN, CANADA S7T 0J1
TEL : 306-665-6223 | FAX : 306-665-6559 | WWW.WSP.COM

LEGEND
ELEVATION MARKER

PROPOSED
EXISTING

GENERAL NOTES:

1. REMOVE EXISTING CONCRETE ENTRANCE SLAB AND CONCRETE PAVING STONES FROM WORK AREA.
2. REMOVE EXISTING GRASS AND TOPSOIL FROM CONCRETE SLAB AREA.
3. REMOVE SUBGRADE TO 500mm BELOW PROPOSED UNDERSIDE OF SLAB ELEVATION.
4. REFER TO STRUCTURAL FOR FURTHER INSTRUCTION.
5. PROVIDE ONE YEAR WARRANTY PERIOD FROM DATE OF PROJECT COMPLETION ON ALL MATERIALS AND WORKMANSHIP.

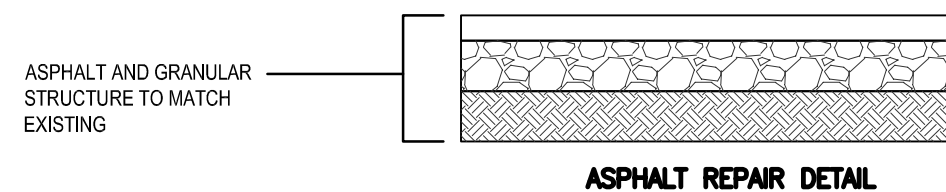

ASPHALT REPAIR DETAIL

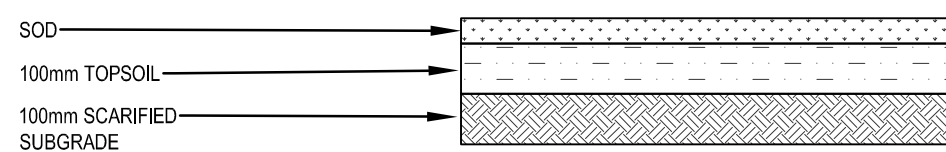

SOD REPAIR DETAIL

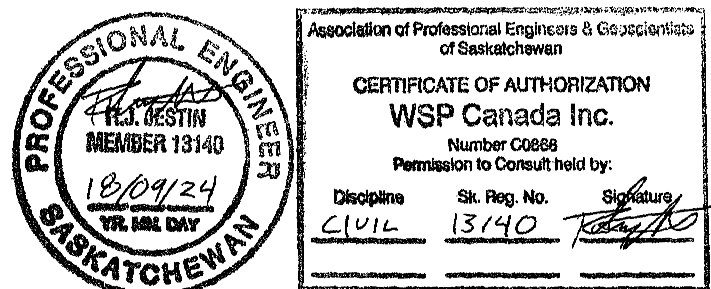

PWGSC WESTERN REGION

Project
CSC-RHQ REGIONAL PSYCHIATRIC CENTRE
2520 CENTRAL AVENUE NORTH
SASKATOON, SASKATCHEWAN

CHURCHILL UNIT
REDEVELOPMENT

Designed by
R.J.J.
Checked by
M.R.L.
Reviewed by
R.J.J.
PWGSC - Project Manager
Administrateur de Projets TPISQ

CIVIL

EXISTING AND PROPOSED
GRADING PLANS

R.07945.001

C-1

0

1 OF 1

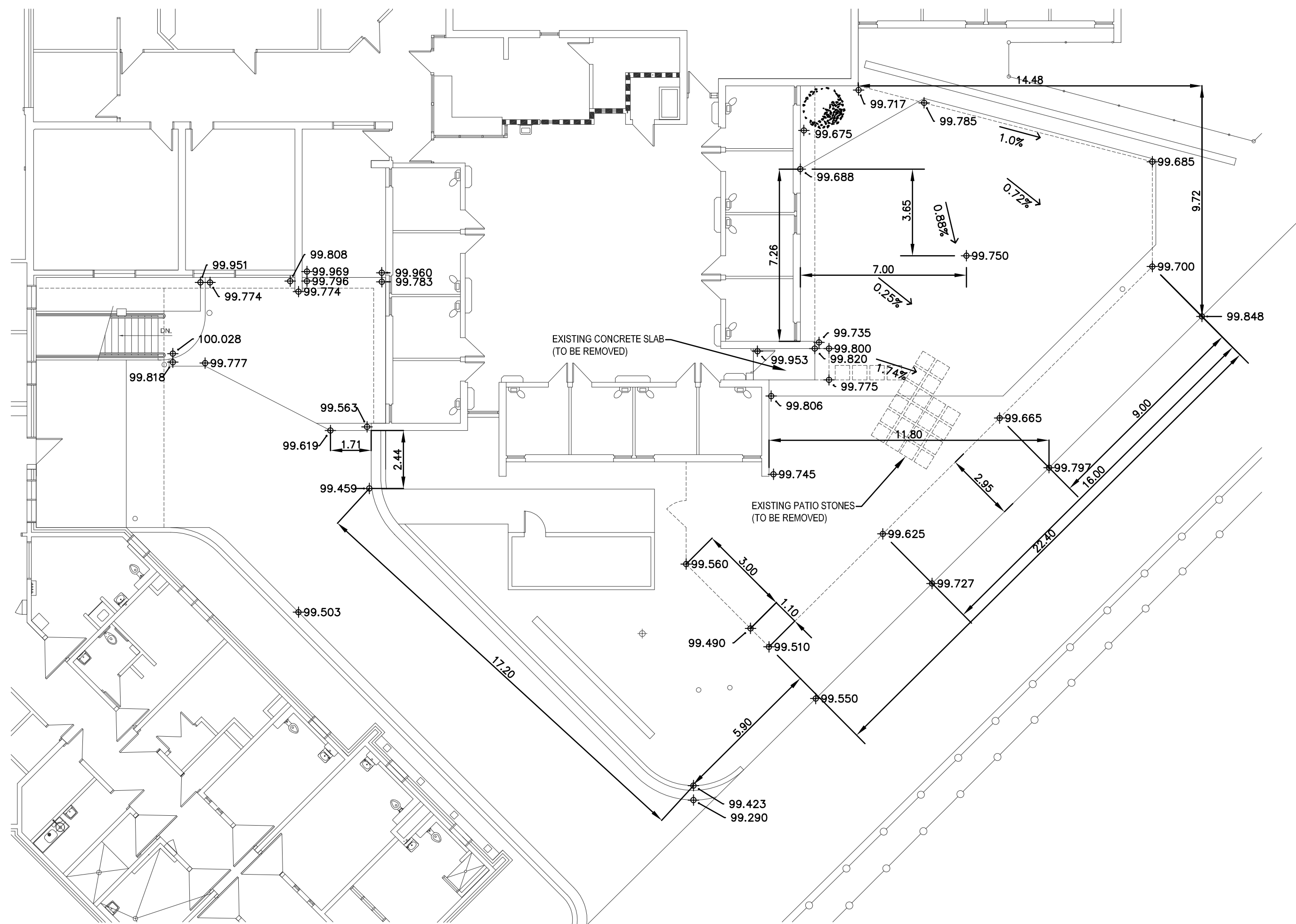

1 EXISTING GRADING PLAN
1:100

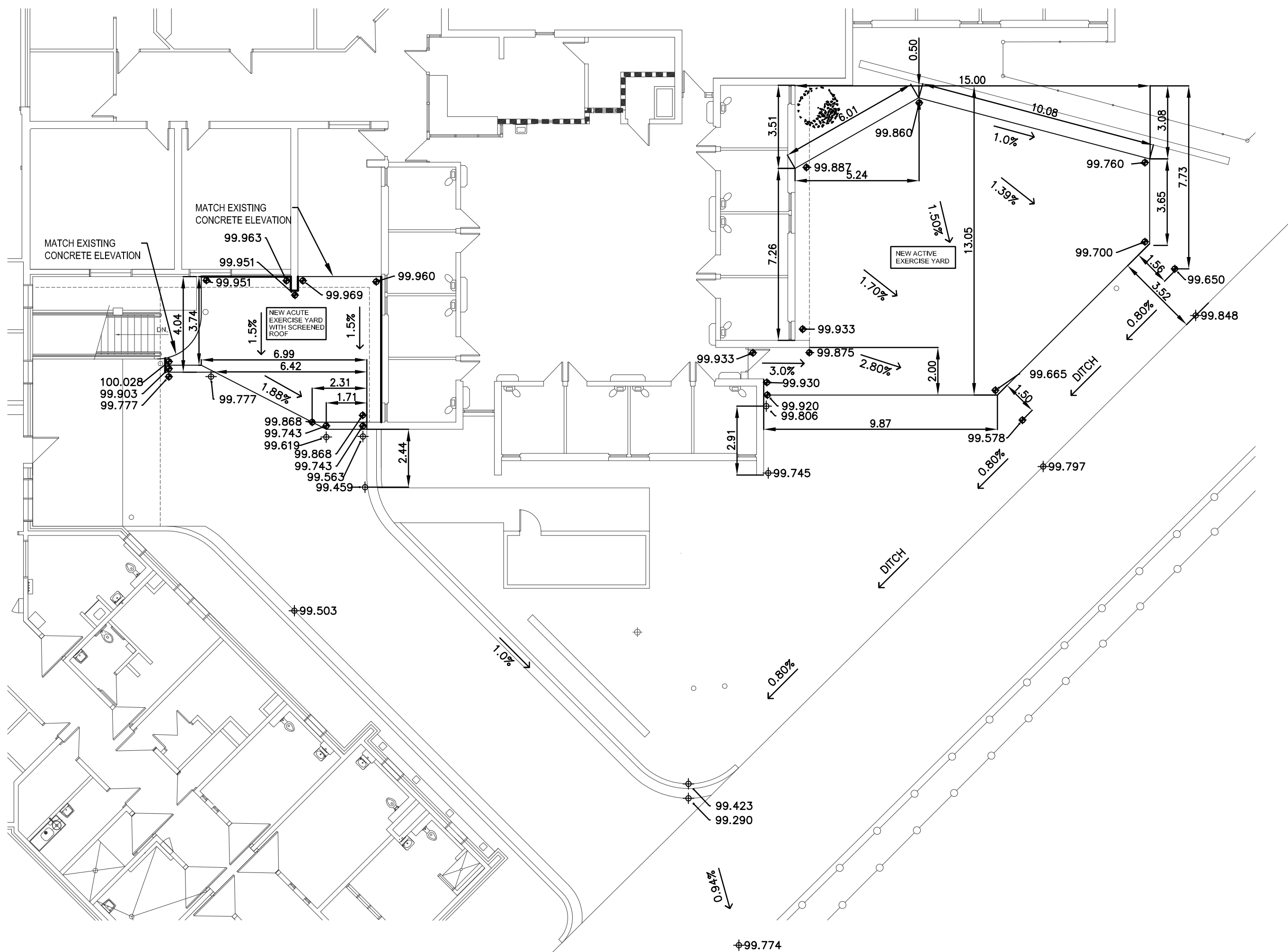

2 PROPOSED GRADING PLAN
1:100

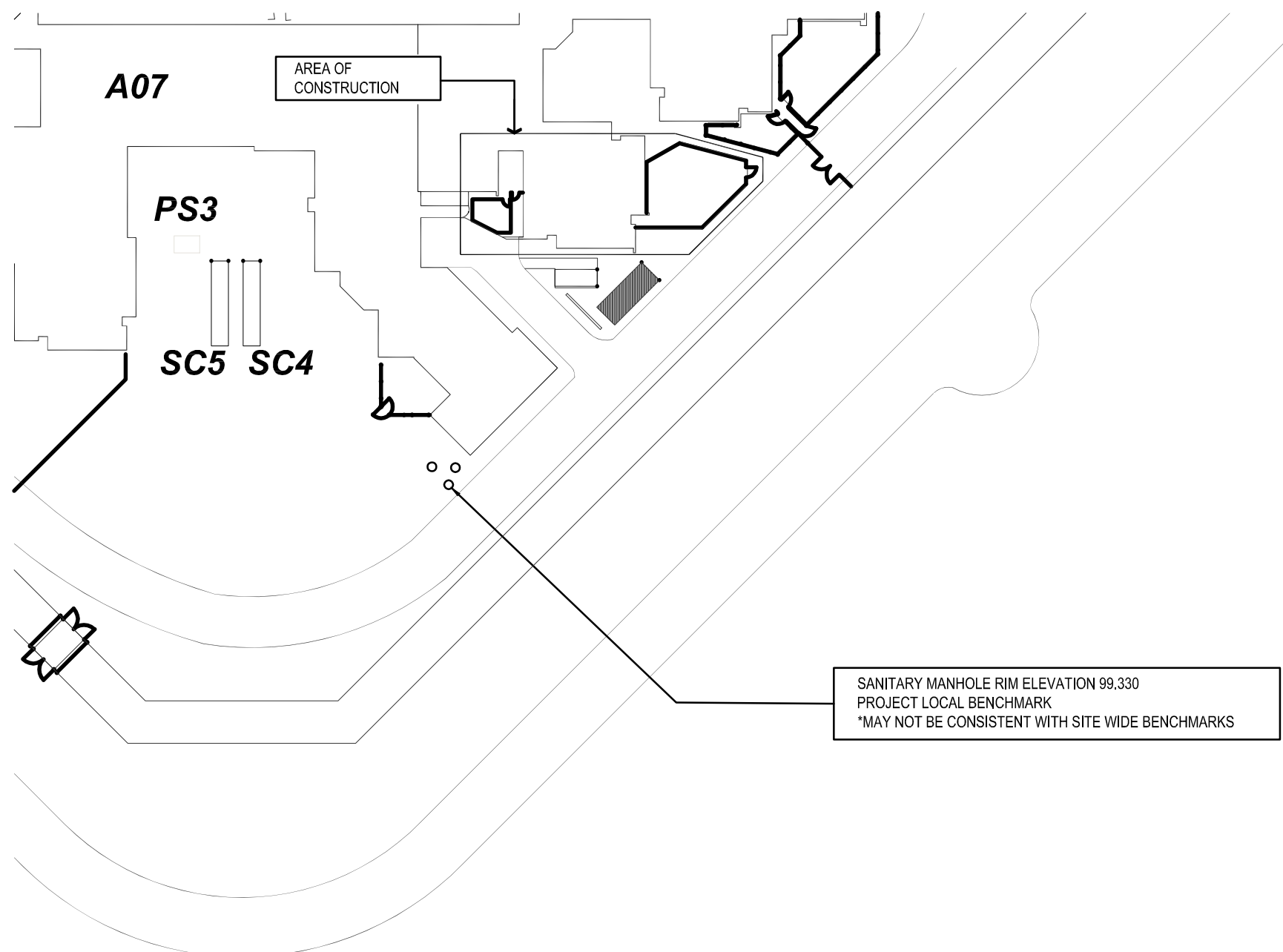

3 LOCAL BENCHMARK
N.T.S.

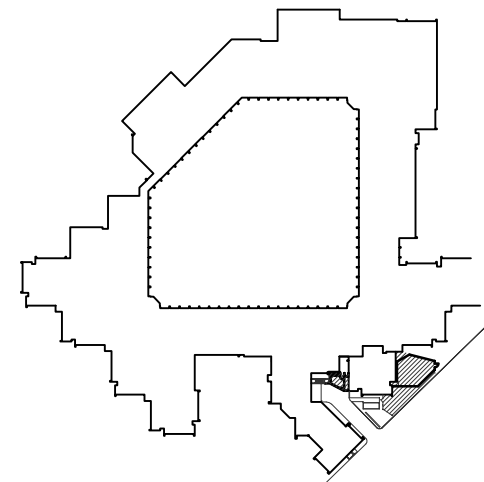

KEY PLAN