

ADDENDUM NUMBER: ONE

ISSUED BY: SEPW Architecture Inc.
109 – 3725 Pasqua St., Regina, SK. S4S 6W8
PH. (306) 569-2255

**PROJECT: INTERIOR RENOVATION
PROJECT #42/17
REGINA, SASKATCHEWAN**

This Addendum forms part of the Contract Documents and amends the original Drawings and Specifications dated 2018-07-13, previous Addenda if applicable and as noted below. This Addendum consists of 2 pages plus attached Specifications and Attachments as listed below. Ensure that all parties are aware of all items included in this Addendum.

The following revised or additional Attachments accompany and form an integral part of this Addendum:

Attachment
Drawing SKE-2.0

A-1-1 REF. DRAWING E2.0 ELECTRICAL POWER & SYSTEMS & LIGHTING PLANS & SPECIFICATIONS 26 52 00 EMERGENCY LIGHTING.

1. The emergency remote head noted as Note #6 shall be the following:

Fixture type 'E-R2' – Emergency remote light fixture powered from fixture type 'E-MA', 'as indicated, 2 x 5 watt **12 volt** MR16 LED lamps, fully gasketed cast aluminium back plate in white finish, clear polycarbonate cover. Subscript shall designate battery in remote which remote is connected to.

Emergi-Lite – Survive-All NXM - EF-40 series
Ready-Lite - #TUF-NM Series

A-1-2 REF. DRAWING SKE2.0 CONDUIT ROUTING FOR UPS CIRCUITRY.

1. Provide conduit and wiring from Room 123.03 to Room 102.02 as indicated on attached drawing SKE-2.0.

A-1-3 REF. GENERAL QUESTIONS

1. Q: *The is a small vinyl wallcovering infill that needs to be done in the corridor associated with this project. Is there any maintenance stock that we can use at F-Division for this infill? It may be difficult to find something that matches the existing wallcovering. All we should need is approximately 16 yards, which is roughly half a bolt of wallcovering.*

A: There is no maintenance stock available to infill the vinyl wallcovering in the corridor.

END OF ADDENDUM 1

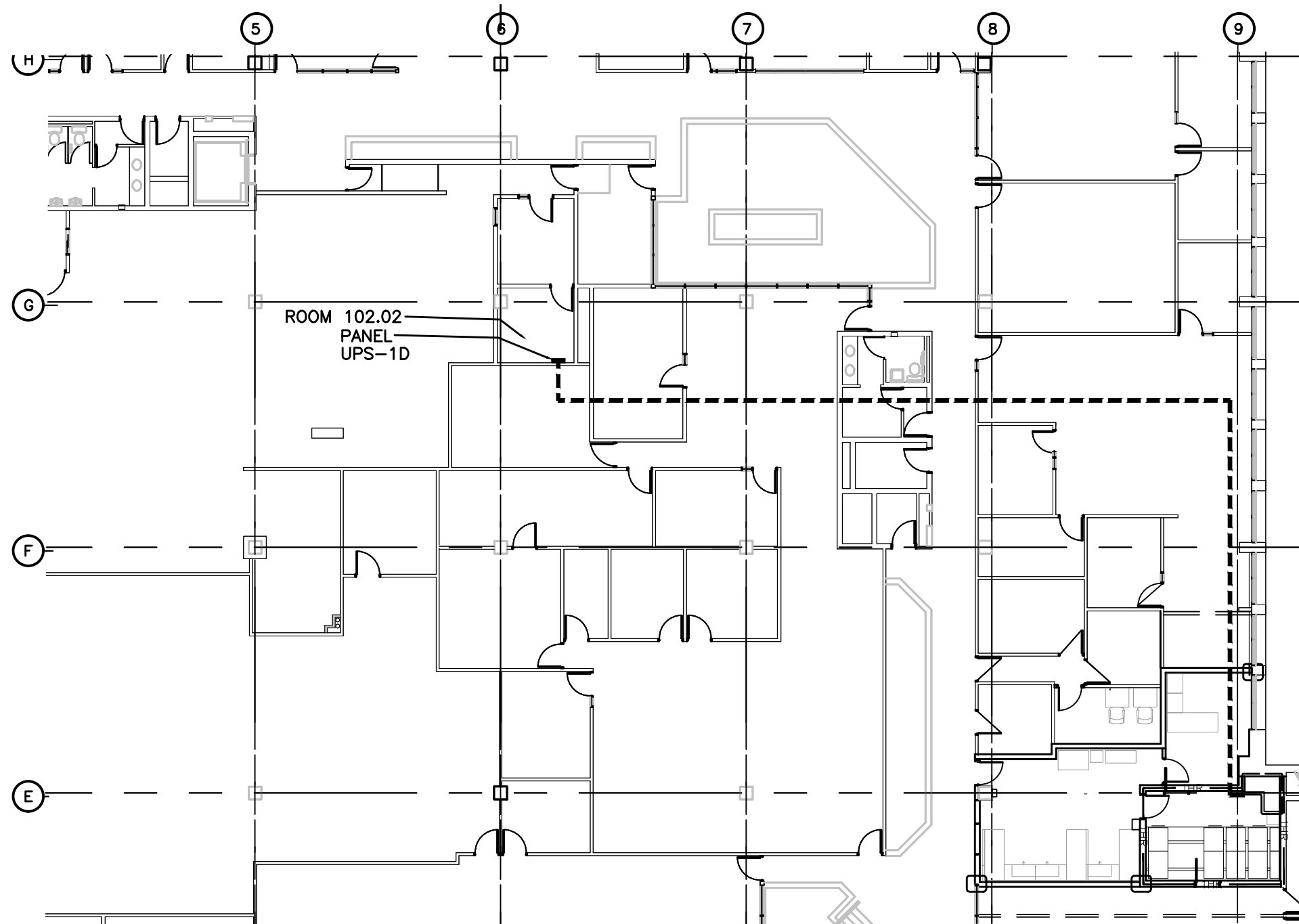

1
SKE2.0

UPS FEEDER ROUTING PLAN

1:200

NOTE:

THE CONTRACTOR SHALL STUB EMT CONDUIT FOR THE UPS CIRCUITS IN ROOM 123.03 SHOWN AS UPS1C 18 & 20, DOWN THROUGH THE FLOOR INTO THE PARKING GARAGE BELOW. RUN CONDUIT TIGHT TO THE UNDERSIDE OF THE CEILING DECK TO THE LOCATION OF THE UPS ROOM ON THE MAIN FLOOR AND STUB UP INTO ROOM 102.02 (APPROXIMATELY 50 METERS) AND CONNECT THE CONDUITS TO THE EXISTING PANEL UPS-1D. PROVIDE TWO NEW 15 AMP CIRCUIT BREAKERS IN THE EXISTING PANEL.



Ritenburg & Associates Ltd
Consulting Electrical Engineers

#200-2222 Albert Street, Regina, SK S4P 2V2
P: (306) 569-1303 F: (306) 569-1307
Email: ral@ritenburg.com

PROJECT TITLE
HSU INTERIOR RENOVATION
REGINA SASKATCHEWAN

DRAWING TITLE
CONDUIT ROUTING FOR UPS
CIRCUITRY

PROJECT NO: 42/17

DATE: SEPTEMBER 27, 2018

DRAWN: GTK

DRAWING: SKE-2.0