

GENERAL NOTES FOR ROOM 122:

1. PROVIDE ALL LOCKABLE CABINETS AND DRAWERS.
2. PROVIDE 25MM RADIUS FOR ALL OUTSIDE CORNERS.

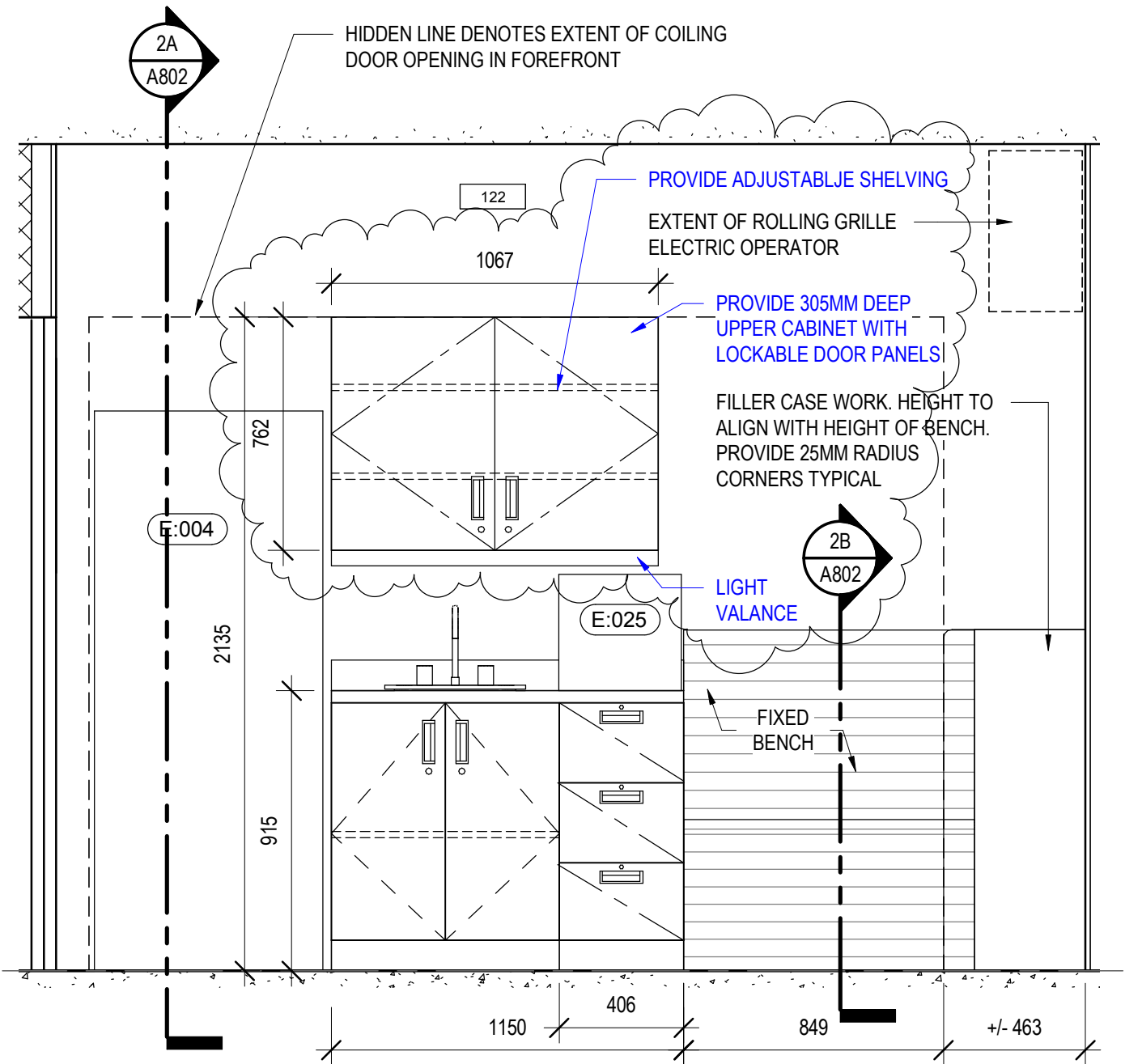

INTERIOR ELEVATION - RM 122

SCALE : 1:20



1
A802_2.1

<p>Government of Canada / Gouvernement du Canada</p>	<p>Drawing title / Titre du dessin</p> <p>INTERIOR ELEVATION - RM 122_REVISÉ</p>		<p>designed / conçu</p> <p>C.H.H.</p>	<p>date</p> <p>10/24/18</p>
	<p>project</p> <p>GOCB Bay D'Espoir</p>		<p>drawn / dessiné</p> <p>C.R.R.</p>	<p>date</p> <p>10/24/18</p>
<p>project number</p> <p>1005744</p>		<p>no. du projet</p> <p>1005744</p>	<p>approved / approuvé</p> <p>C.H.H.</p>	<p>date</p> <p>10/24/18</p>
<p>Bay D'Espoir, NL</p>		<p>ISSUED FOR ADDENDUM 2018-10-24</p>	<p>drawing no.</p> <p>A802_2.1</p>	<p>no. du dessin</p> <p>A802_2.1</p>