

## RETURN BIDS TO:

## RETOURNER LES SOUMISSIONS À:

See Section 1.

Voir Section 1.

## SOLICITATION AMENDMENT

## MODIFICATION DE L'INVITATION

The referenced document is hereby revised; unless otherwise indicated, all other terms and conditions of the Solicitation remain the same.

Ce document est par la présente révisé; sauf indication contraire, les modalités de l'invitation demeurent les mêmes.

Solicitation No. - N° de la demande  10064676/A	Amendment No. - N° de modification  001
---	---

Solicitation closes – La demande prend fin :  at – à See Section 1 Voir Section 1 on – le See Section 1 Voir Section 1	File No. - N° de dossier  10064676
---	--

No of  
Page/  
N° de page

10

Date of Solicitation – Date de la demande

**2018-10-25**

Address inquiries to – Adresser toute demande de renseignement à :

See Section 2, Article 4.1.

Voir Section 2, Article 4.1

Destination

See Section 2, Annex A.

Voir Section 2, Annexe A.

Instructions:

Unless otherwise specified in the bid solicitation, all prices quoted must be net prices in Canadian funds including Canadian customs duties, excise taxes, must be FOB, including all delivery charges to destination(s) as indicated. The amount for Applicable Taxes is to be shown as a separate item.

Instructions:

Sauf indication contraire dans la demande de soumissions, tous les prix indiqués doivent être des prix nets, en dollars canadiens, comprenant les droits de douane canadiens, la taxe d'accise et doivent être FAB, y compris tous frais de livraison à la (aux) destination(s) indiqué(s). Le montant des taxes applicables doit apparaître séparément.

Supplier Name and Address – Nom et adresse du fournisseur

Telephone No. - N° de téléphone

Facsimile No. - N° de télécopieur

Name and title of person authorized to sign on behalf of supplier (type or print)

Nom et titre de la personne autorisée à signer au nom du fournisseur (caractère d'impression)

Signature : \_\_\_\_\_ Date : \_\_\_\_\_

This **amendment # 001** is raised to modify **solicitation #10064676** as follows:

1. Refer to page 11 of 11, Annex C Floor Plans:

**Delete:** Floor plan Attachments

**Insert:** Floor plan attachment pdf

**ALL OTHER TERMS AND CONDITIONS REMAIN THE SAME**

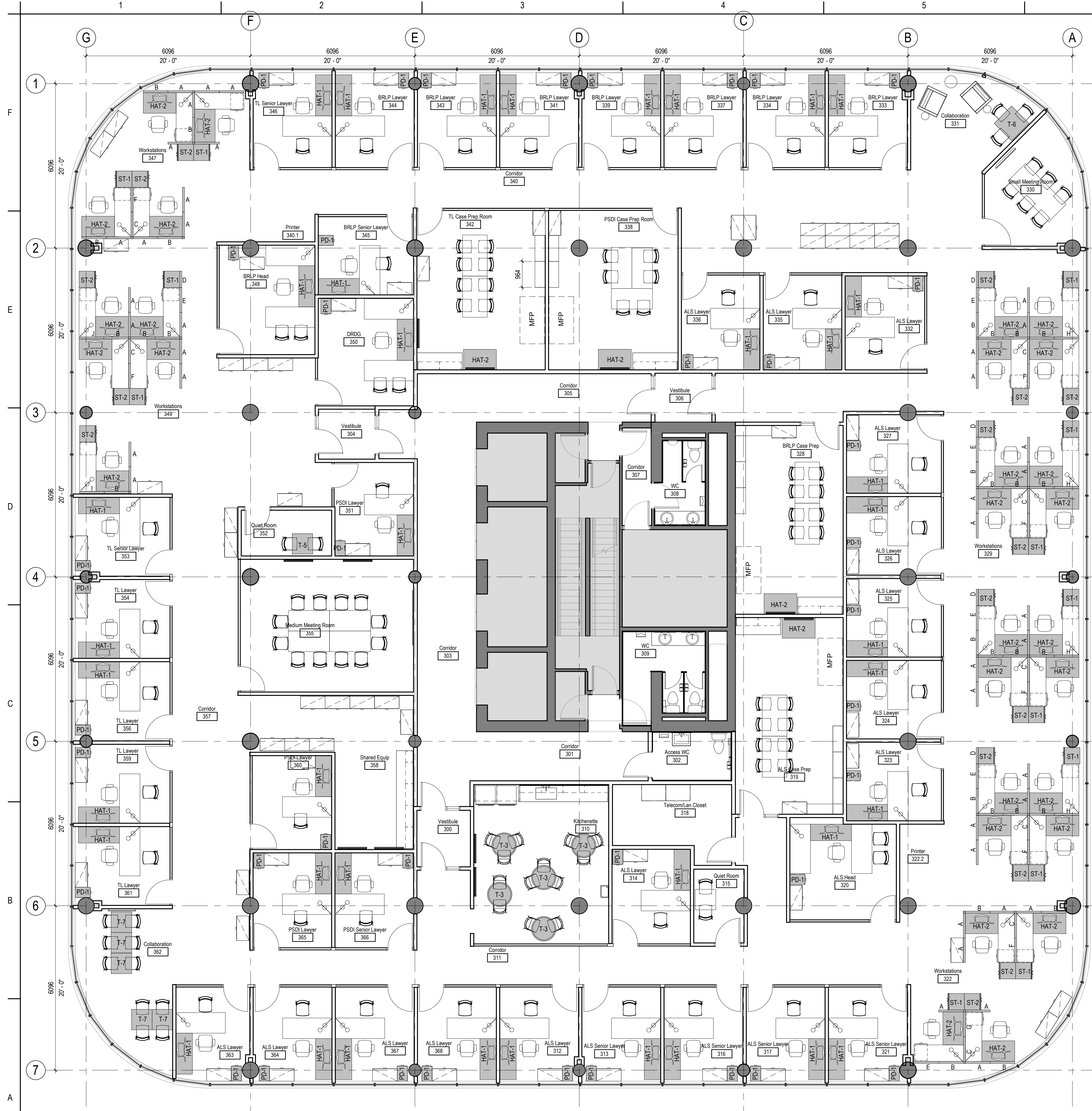

FURNITURE TENDER-LEVEL 3-CAT1&2						
QTY	CODE	GOUCID	ITEM #	LINE #	ITEM	CATEGORY
40	A			450	Type A - Seated Privacy Height. Fabric upper and lower element. Non-powered on both sides. 914mm wide.	CAT1A
28	B			5842	Type B - Seated Privacy Height. Fabric upper and lower element. Powered one side and non-powered on one side. 914mm wide. Outlets on upper element.	CAT1A
8	C			5854	Type C - Seated Privacy Height. Fabric upper and lower element. Powered both sides on upper element. 914mm wide.	CAT1A
5	D			424	Type D - Seated Privacy Height. Fabric upper and lower element. Non-powered on both sides. 610mm wide.	CAT1A
6	E			447	Type E - Seated Privacy Height. Fabric upper and lower element. Accessory rail on upper element, one side. Non-powered on both sides. 914mm wide.	CAT1A
7	F			446	Type F - Seated Privacy Height. Fabric lower element. Accessory rail on upper element, both sides. Non-powered on both sides. 914mm wide.	CAT1A
1	G			5838	Type G - Seated Privacy Height. Fabric upper element one side, powered. Accessory rail upper one side. Fabric lower element, both sides. Outlets on upper elements. 914mm wide.	CAT1A
4	H			4892	Type H - Seated Privacy Height. Accessory rail on upper element, both sides. Fabric lower element, powered both sides. Outlets below the work surface. 914mm wide.	CAT1A
1	I			6765	Type I - Seated Privacy Height. Accessory rail on upper element one side. Fabric upper element one side. Fabric lower element powered one side. Fabric lower element non-powered one side. Outlets above the work surface. 914mm wide.	CAT1A
1	J			4893	Type J - Seated Privacy Height. Fabric upper element one side. Accessory rail on upper element one side. Fabric lower element, powered both sides. Outlets below the work surface. 914mm wide.	CAT1A
39	PD-1	SPPDWLxxxx2Fxxxxx22	612		Pedestal - Locking - N casters. Metal. Box/boxfile. 22" depth	CAT1B
13	ST-1	SPPTFSMoxLHFC542424	1988		Storage Tower - Left. 54"x24"x24"w. 2 file drawers at bottom. Freestanding. Metal. Hinged left.	CAT1B
16	ST-2	SSPTFSMoxRHFC542424	1992		Storage Tower - Right. 54"x24"x24"w. 2 file drawers at bottom. Freestanding. Metal. Hinged right.	CAT1B
5	T-3	MTxxSCLvDxxxxxx36xx	470		Meeting Table - 36" dia. Laminated. Star cross base.	CAT1B
1	T-6	MTxxSCLvSxxxxxx3636	461		Meeting Table - Square 36"x36". Laminated. Star cross base.	CAT1B
5	T-7	MTxxSCLvSxxxxxx3636	460		Meeting Table - Square 30"x30". Laminated. Star cross base.	CAT1B
39	HAT-1	FSCAE46024			Height Adjustable Table. Sit/stand. Electrically assisted.	CAT2
33	HAT-2	FSCAE4630			Height Adjustable Table. Sit/stand. Electrically assisted.	CAT2

**GENERAL NOTES - CATEGORY 1 & 2**

- FURNITURE SUPPLIER TO PROVIDE POWER / VOICE / DATA IN SYSTEMS FURNITURE AS PER ELECTRICAL DRAWINGS.
- CONTRACTOR TO COORDINATE ELECTRICAL POWER / VOICE / DATA TO SYSTEMS FURNITURE AND FURNITURE AS PER ELECTRICAL DRAWINGS.
- ONLY FURNITURE LABELED APPLIES TO CATEGORY 1 & 2
- REFER TO DRAWING F03 & F04 FOR WORKSTATION ACCESSORIES

**FURNITURE IN CONTRACT**



**FURNITURE PANEL LEGEND**

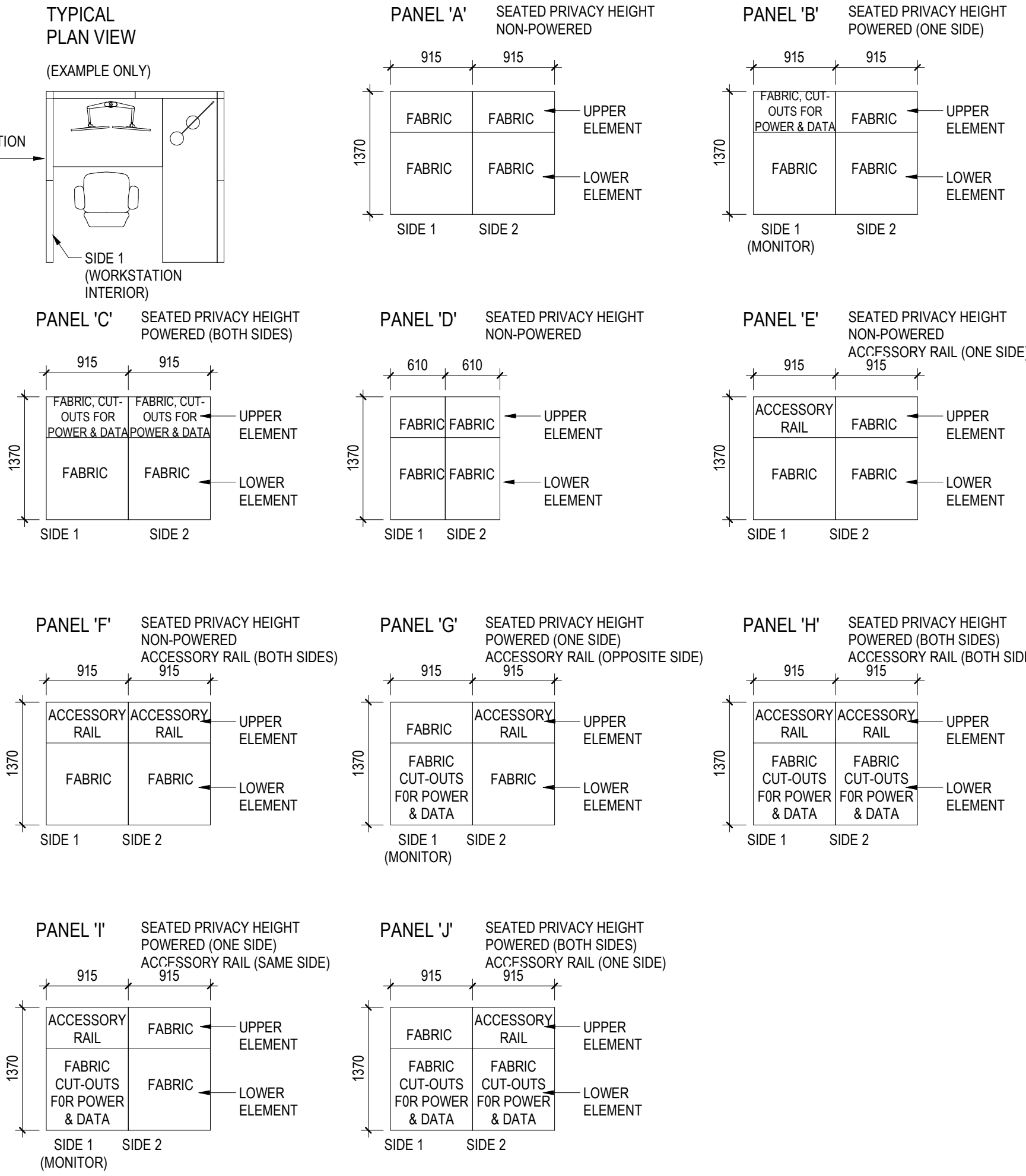

**FURNITURE TENDER - LEVEL 3 - CATEGORY 1 & 2**

F01 1:75

Consultant

NO.	DATE	BY	APP'D	REVISION
1				ISSUE FOR PERMIT
2				ISSUE FOR PERMIT
3				ISSUE FOR PERMIT
4				ISSUE FOR PERMIT
5				ISSUE FOR PERMIT
6				ISSUE FOR PERMIT
7				ISSUE FOR PERMIT
8				ISSUE FOR PERMIT
9				ISSUE FOR PERMIT
10				ISSUE FOR PERMIT
11				ISSUE FOR PERMIT
12				ISSUE FOR PERMIT
13				ISSUE FOR PERMIT
14				ISSUE FOR PERMIT
15				ISSUE FOR PERMIT
16				ISSUE FOR PERMIT
17				ISSUE FOR PERMIT
18				ISSUE FOR PERMIT
19				ISSUE FOR PERMIT
20				ISSUE FOR PERMIT



Client/Project: DREAM  
 OGD RENOVATIONS SASKATOON SQUARE  
 410 22nd Street East  
 Saskatoon, SK

Project No.: 144401558  
 File Name: N/A  
 Scale: As indicated  
 Author: Designer: Checker:  
 Dwn. Dgn. Chk. YYYYMMDD  
 Title: FURNITURE TENDER LEVEL 3 CATEGORY 1 & 2  
 Revision: 1  
 Drawing No.

**F01**

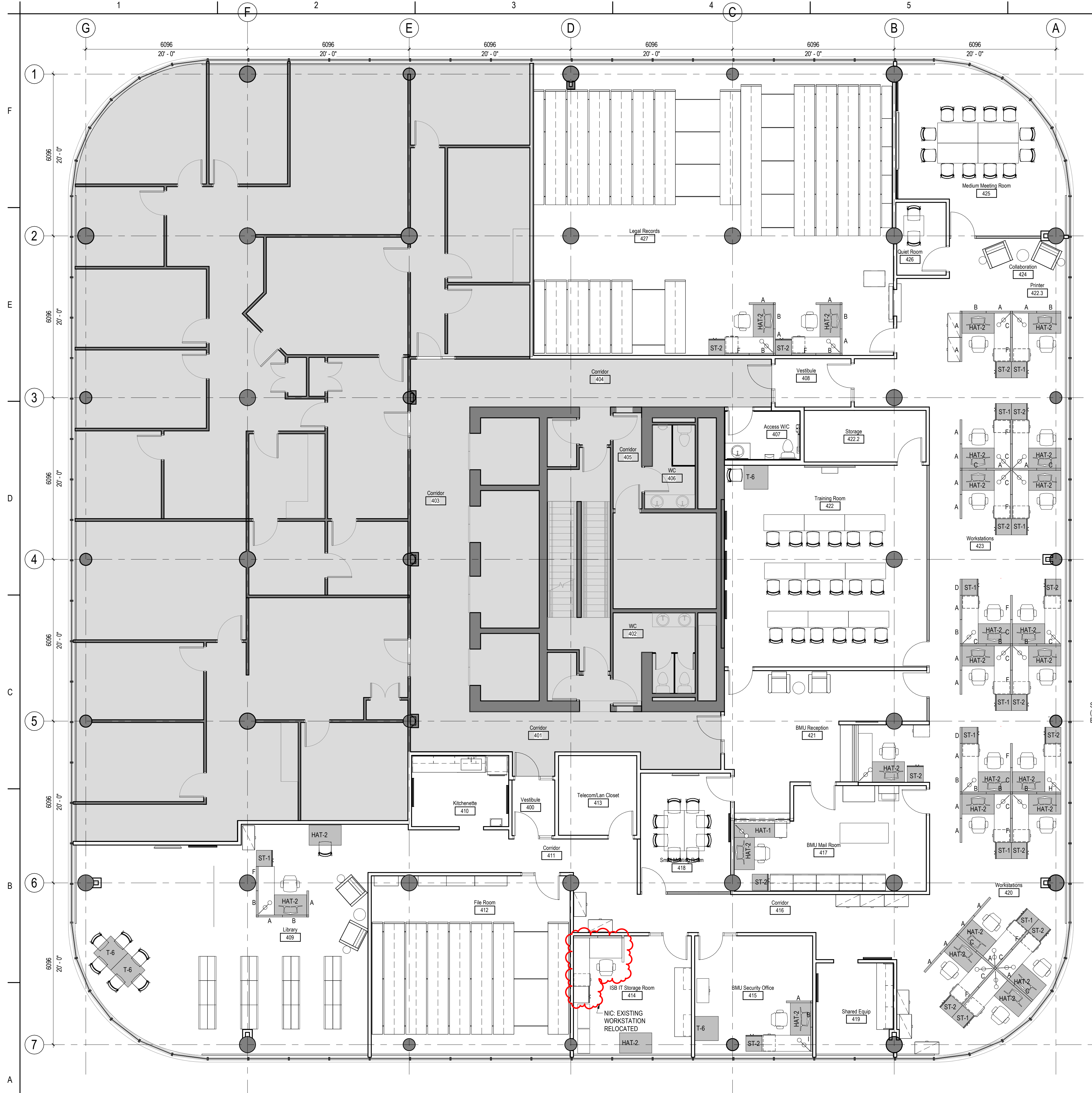

QTY	CODE	GOCUID	ITEM #	LINE #	ITEM DESCRIPTION	CATEGORY
29	A		450		Type A - Seated Privacy Height. Fabric upper and lower element. Non-powered on both sides. 914mm wide.	CAT1A
16	B		5842		Type B - Seated Privacy Height. Fabric upper and lower element. Powered one side and non-powered on the other. 914mm wide. Outlets on upper element.	CAT1A
15	C		5854		Type C - Seated Privacy Height. Fabric upper and lower element. Powered both sides on upper element. 914mm wide.	CAT1A
2	D		424		Type D - Seated Privacy Height. Fabric upper and lower element. Non-powered on both sides. 610mm wide.	CAT1A
12	F		446		Type F - Seated Privacy Height. Fabric lower element. Accessory rail on upper element, both sides. Non-powered on both sides. 914mm wide.	CAT1A
1	H		4892		Type H - Seated Privacy Height. Accessory rail on upper element, both sides. Fabric lower element, powered both sides. Outlets below the work surface. 914mm wide.	CAT1A
1	I		6765		Type I - Seated Privacy Height. Accessory rail on upper element one side. Fabric upper element one side. Fabric lower element powered one side. Fabric lower element non-powered one side. Outlets above the work surface. 914mm wide.	CAT1A
10	ST-1	SPPTFSMxxLHFFCD542424	1988		Storage Tower - Left. 54"x24"x24"w. 2 file drawers at bottom. Freestanding. Metal. Hinged left.	CAT1B
14	ST-2	SSPTFSMxxRHFFCD542424	1992		Storage Tower - Right. 54"x24"x24"w. 2 file drawers at bottom. Freestanding. Metal. Hinged right.	CAT1B
4	T-6	MTxxSCLSxxxxxxxx3636	461		Meeting Table. Square 36"x36". Laminate. Star cross base.	CAT1B
1	HAT-1	FSCAE6024			Height Adjustable Table. Sit/stand. Electrically assisted.	CAT2
26	HAT-2	FSCAE4830			Height Adjustable Table. Sit/stand. Electrically assisted.	CAT2

### GENERAL NOTES - CATEGORY 1 & 2

- 1. FURNITURE SUPPLIER TO PROVIDE POWER / VOICE / DATA IN SYSTEMS FURNITURE AS PER ELECTRICAL DRAWINGS.
- 2. CONTRACTOR TO COORDINATE ELECTRICAL POWER / VOICE / DATA TO SYSTEMS FURNITURE AND FURNITURE AS PER ELECTRICAL DRAWINGS.
- 3. ONLY FURNITURE LABELED APPLIES TO CATEGORY 1 & 2
- 4. REFER TO DRAWING F03 & F04 FOR WORKSTATION ACCESSORIES

### FURNITURE IN CONTRACT



### FURNITURE PANEL LEGEND

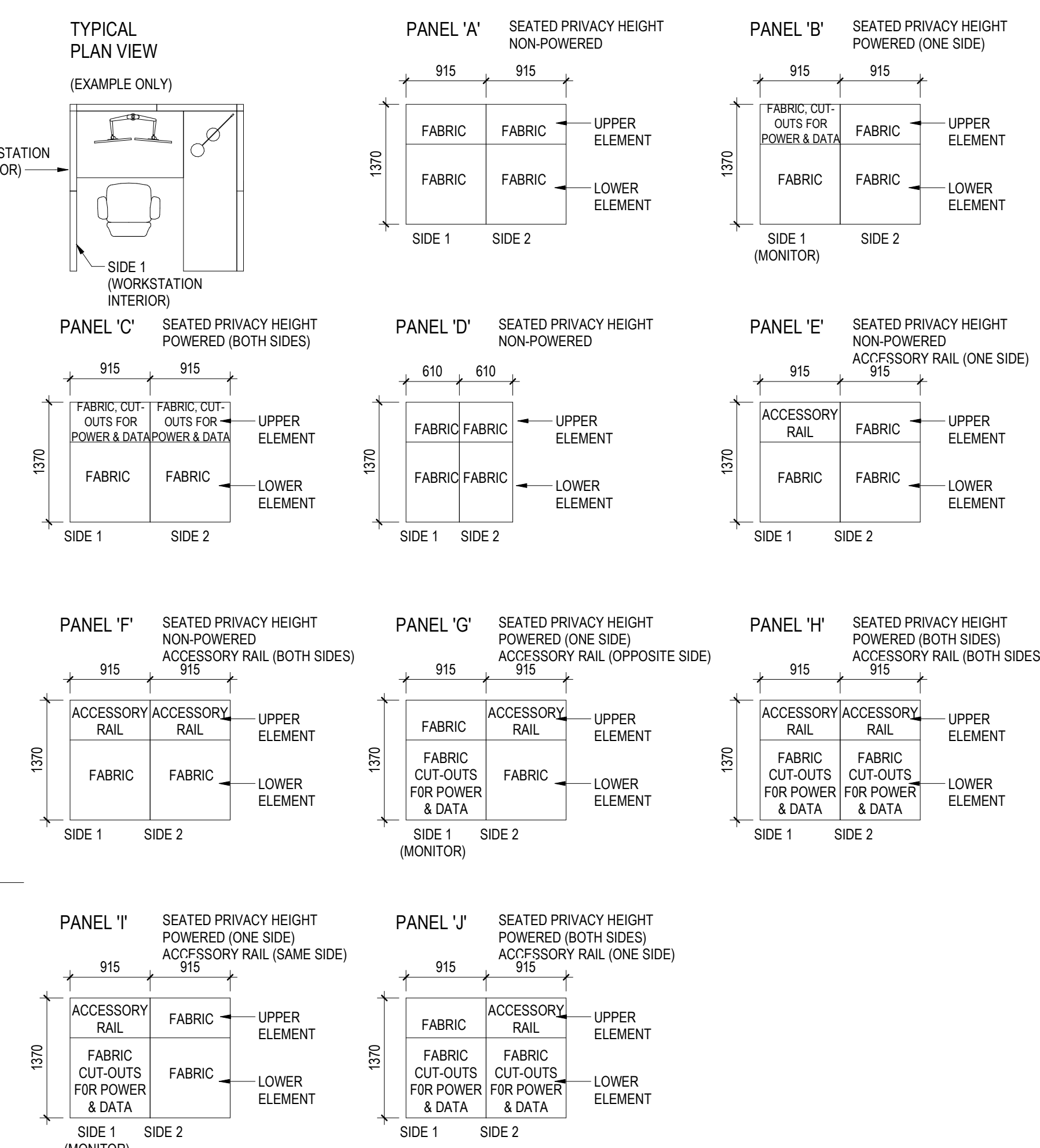

**FURNITURE TENDER - LEVEL 4 - CATEGORY 1 & 2**  
1 F02 1:75

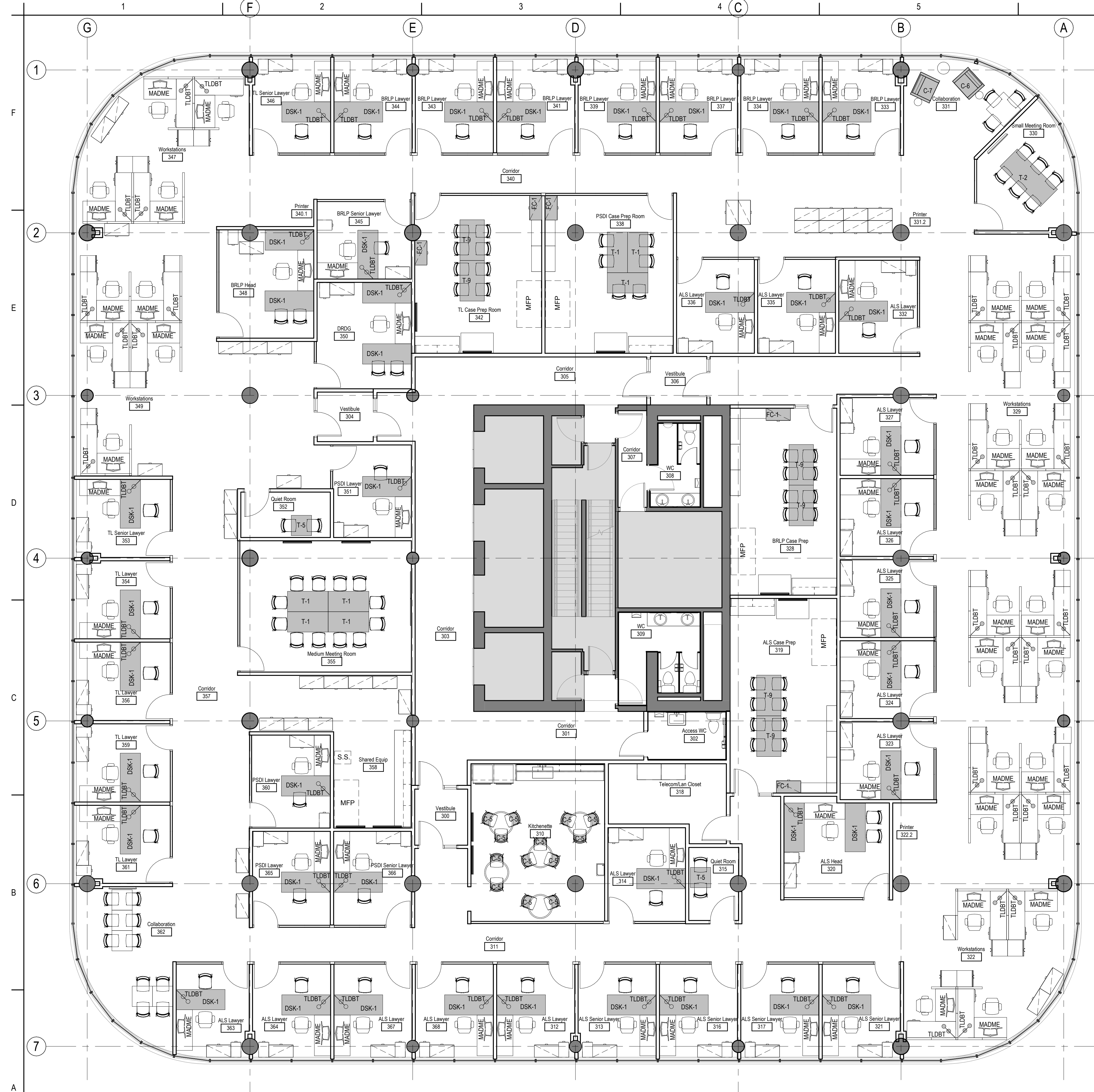

QTY	CODE	GOUCID	ITEM #	ITEM DESCRIPTION	CATEGORY
5	FC-1	LLFC4DFDxxx1836xxxx		Lateral File Cabinet 4H. Locking. 36"wx18". Fixed front drawers.	CAT3
42	DSK-1	WSRE2F0HxxxWA7230F2xx		Work Surface. Two full gable & modesty panel. Walnut veneer. 30"x72".	CAT4
2	T-5	MTSTS8xxxxWA0762xxxx		Meeting table. 30' square. Walnut veneer. Star cross base.	CAT4
68	MADME	MADME		Dual Monitor Arm. Edge clamp mount.	CAT5
68	TLDBT	TLDBT		LED Task Light. Desk base type.	CAT5
13	C-5	SNCCQPPNLSAWNILNLPNNILNINIL		Kitchen Chairs: 4 legs. Without arms. Non-perforated molded plastic or plyamide.	CAT6
1	C-6	SREFRORPPDPAAGNLMCF7FNILNINIL		Lounge chair. Soft seating. 4 casters, 2 locking. Back handle. Cup holder. Shelf at base. Left table & arm write ability to move in and out and a right armrest. Metal frame. Fixed cushions. Fabric.	CAT6
1	C-7	SREFRORPPDPATANILMCF7FNILNINIL		Lounge chair. Soft seating. 4 casters, 2 locking. Back handle. Cup holder. Shelf at base. Right table & arm write ability to move in and out and a left armrest. Metal frame. Fixed cushions. Fabric.	CAT6
7	T-1	TTPSPFLCNILTSUEP60xxNILN130xx		Small and Medium Meeting Room Tables: 30'wx60". Laminate. Laminate panel base with wire access. One recessed box with 4 power and 4 data with a flexible casing.	CAT6
1	T-2	TTPSPFLCNILTSUEP64xxNILN130xx		Small Meeting Room Tables: 36'wx84". Laminate. Laminate panel base with wire access. One recessed box with 4 power and 4 data with a flexible casing.	CAT6
6	T-9	TTPRTPAPNLTSSPCW600xxNIL36xx		Training Room Tables: 36'wx60". Laminate. T-legs w/glides. With grommet.	CAT6

**FURNITURE IN CONTRACT**



**1 FURNITURE TENDER - LEVEL 3 - CATEGORY 3, 4, 5, & 6**

F03 1:75

Consultant

DATE	BY	REVISION
2018.06.27	JAD	ISSUE FOR PERMIT
2018.06.27	JAD	ISSUE FOR PERMIT
2018.06.27	JAD	ISSUE FOR PERMIT

Permit/Seal

**FINALIZED FURNITURE TENDER DOCUMENTS**  
 June 27, 2018

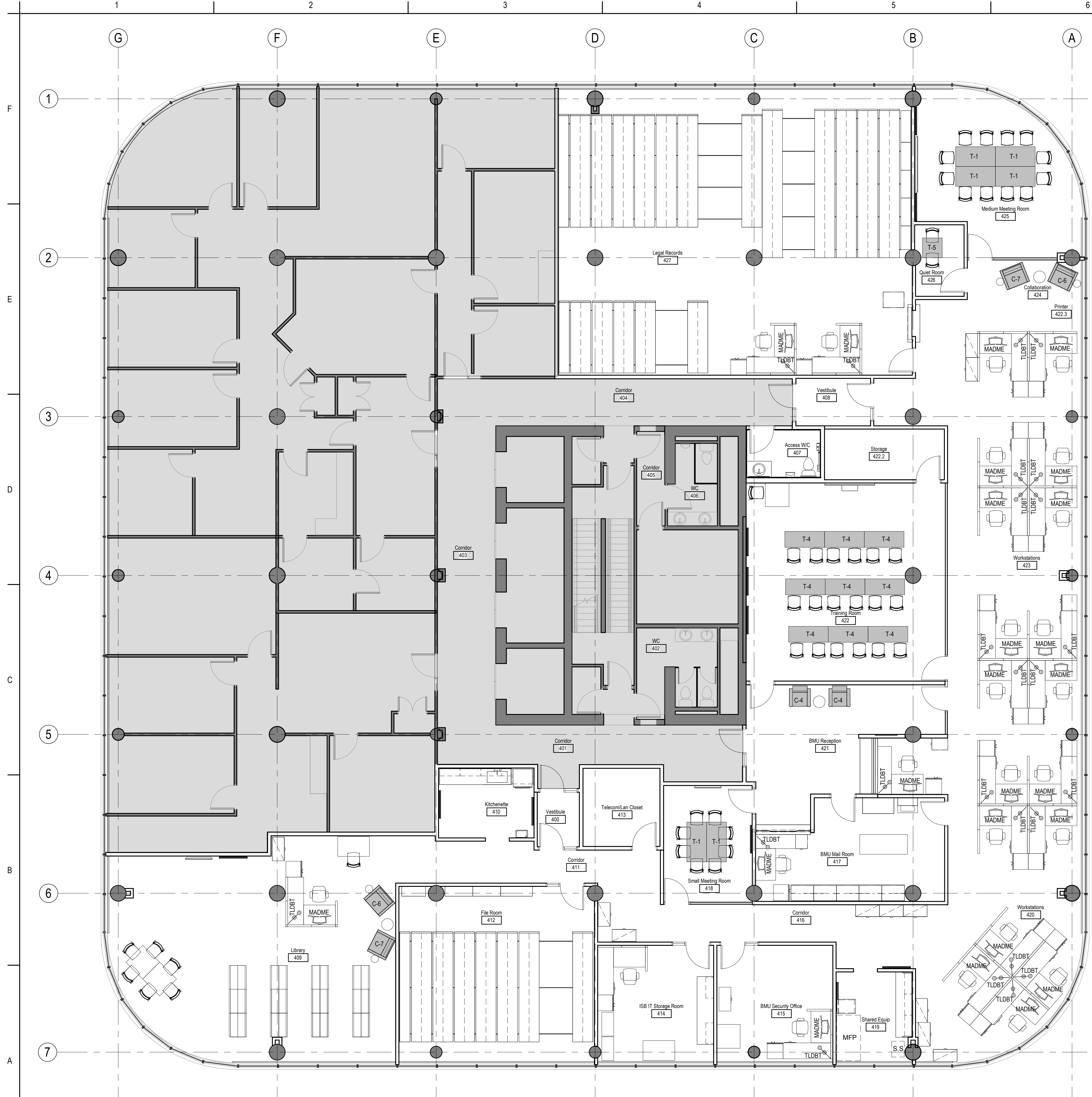

LEVEL 4 - CATEGORIES 3-6					
QTY	CODE	GOGUID	ITEM #	ITEM DESCRIPTION	CATEGORY
1	T-5	MTSTSxxxxxWA0762xxxx		Meeting table, 30" square. Walnut veneer. Star cross base.	CAT4
24	MADME	MADME		Dual Monitor Arm. Edge clamp mount.	CAT5
24	TLDBT	TLDBT		LED Task Light. Desk base type.	CAT5
2	C-4	SREFRORPPPAWANILOMCFFFNILNIL		Loung chair. Soft seating. 4 legs with glides for carpet. Metal frame. Fixed cushions. With arms. Fabric.	CAT6
2	C-6	SREFRORPPPAWANILOMCFFFNILNIL		Lounge chair. Soft seating. 4 casters, 2 locking. Back handle. Cup holder. Shelf at base. Left table & arm with the ability to move in and out and a right armrest. Metal frame. Fixed cushions. Fabric.	CAT6
2	C-7	SREFRORPPPAWANILOMCFFFNILNIL		Lounge chair. Soft seating. 4 casters, 2 locking. Back handle. Cup holder. Shelf at base. Right table & arm with the ability to move in and out and a left armrest. Metal frame. Fixed cushions. Fabric.	CAT6
6	T-1	TTPSPPLNLTSSUEP60xxNILN130xx		Small and Medium Meeting Room Tables: 30"x60". Laminate. Laminate panel base with wire access. One recessed box with 4 power and 4 data with a flexible casing.	CAT6
9	T-4	TRFTPCVNILTSLCED60xxNILN124xx		Flip-top tables. 24"x60". C-legs with lockable casters. Laminate. With cable and electrical connectivity.	CAT6

**FURNITURE IN CONTRACT**

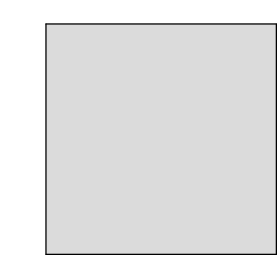

FURNITURE IN CONTRACT

Consultant

DATE	BY	REVISION
2018.06.27	JMM	1111111111
	CC	
	By	
	ADP	
	ISSUED FOR P&C ACQUISITION	
	ISSUED FOR REVISION	

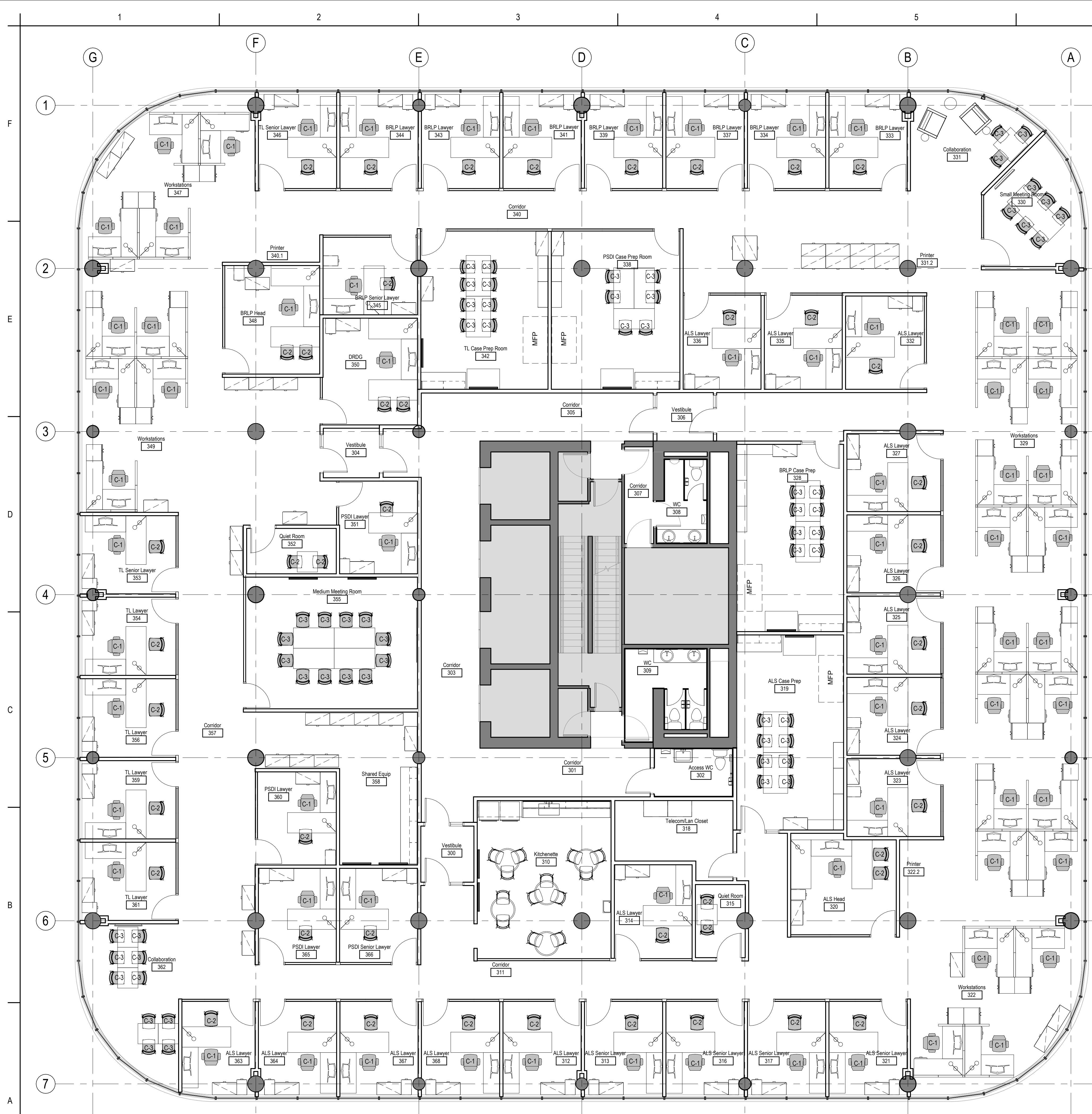

LEVEL 3 GENERAL ROTARY SEATING					
QTY	CODE	GOUID	ITEM #	ITEM DESCRIPTION	CATEGORY
68	C-1			Task Chair: Type: Rotary Office Chair, Stream: General, Headrest: Not included, Back rest Height: High OR Standard back. Lumbar support: Adjustable, Arm rests: height/width/swivel adjustable "T" arms. Seat depth: adjustable, Seat and backrest locks: Lockable or stoppable in multiple positions. Tilt mechanism: Concurrently, Upholstery: Dual breathable, Green Chair Recognition: Yes.	RS
46	C-2			Type: Side Chair, Stream: General, Four legs, With arms, Stackable, Dual fabric, Green chair recognition.	RS
61	C-3			Task Chair: Type: Rotary Office Chair, Stream: General, Headrest: Not included, Back rest Height: Standard/mid back, Lumbar support: Fixed, Armrests: Fixed "T" arm, Seat depth: Medium fixed, Seat and backrest locks: Lockable & stoppable in multiple positions, Tilt mechanism: Concurrently, Upholstery: Back breathable & fabric seat, Green Chair Recognition: Yes.	RS

**1 FURNITURE TENDER - LEVEL 3 - GENERAL ROTARY SEATING**

F05 1:75

Consultant

NO.	DATE	BY	REVISION

Permit/Seal

**FINALIZED FURNITURE TENDER DOCUMENTS**

1, 2018

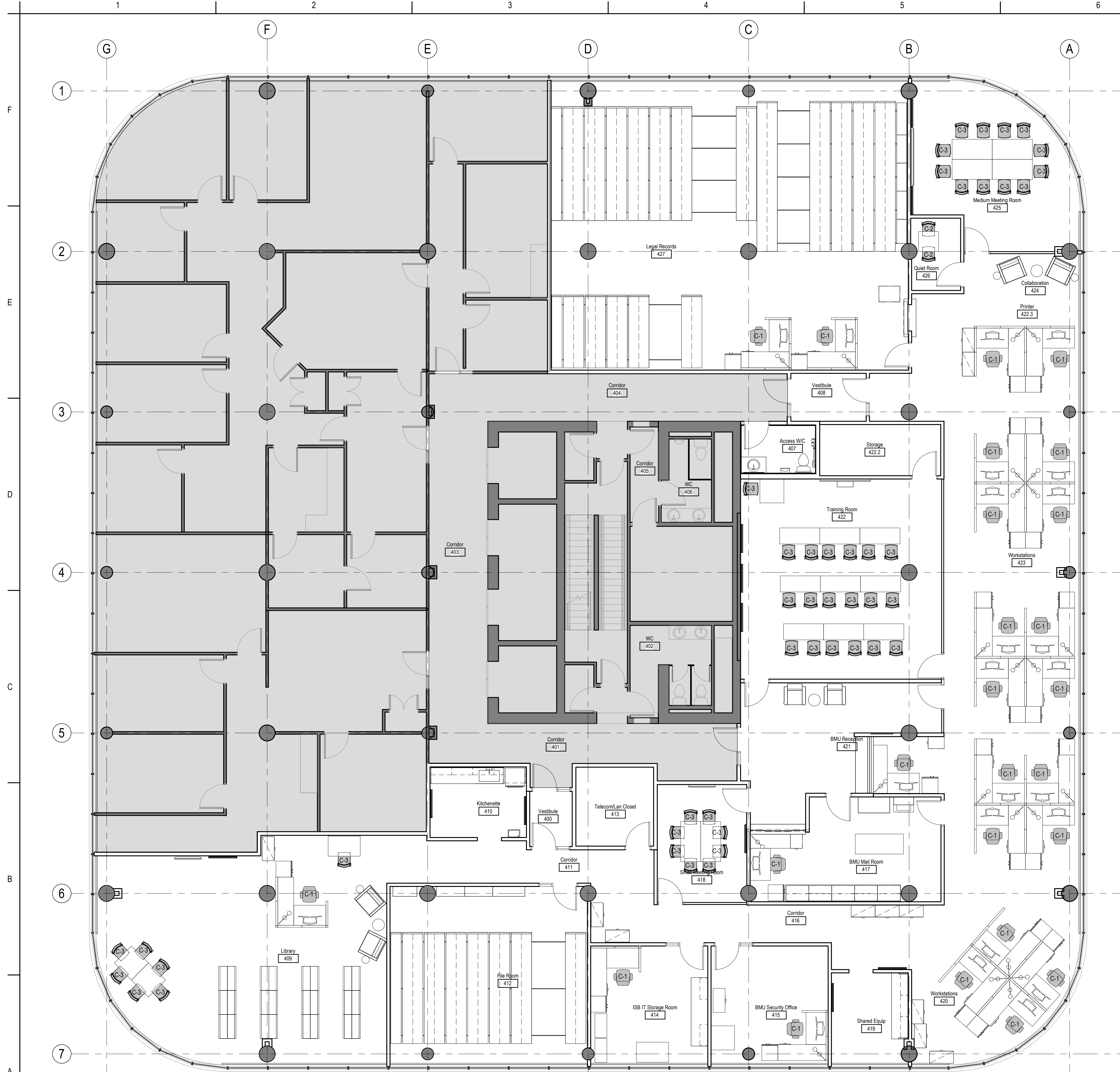

LEVEL 4 - GENERAL ROTARY SEATING					
QTY	CODE	GOCLID	ITEM #	ITEM DESCRIPTION	CATEGORY
25	C-1			Task Chair. Type: Rotary Office Chair, Stream: General, Headrest: Not included, Back rest Height: High OR Standard back, Lumbar support: Adjustable, Arm rests: height/width/level adjustable ** arms, Seat depth: adjustable, Seat and backrest locks, Lockable or stoppable in multiple positions, Tilt mechanism: Concurrently, Upholstery: Dual breathable, Green Chair Recognition: Yes.	RS
2	C-2			Type: Side Chair, Stream: General, Four legs. With arms, Stackable, Dual fabric, Green chair recognition.	RS
46	C-3			Task Chair. Type: Rotary Office Chair, Stream: General, Headrest: Not included, Back rest Height: Standard/mid back, Lumbar support: Fixed, Armrests: Fixed ** arm, Seat depth: Medium fixed, Seat and backrest locks: Lockable & stoppable in multi positions, Tilt mechanism: Concurrently, Upholstery: Back breathable & fabric seat, Green Chair Recognition: Yes.	RS

**FURNITURE TENDER - LEVEL 4 - GENERAL ROTARY SEATING**

F06 1 : 75

04/14/2018 1:06:22 PM

ORIGINAL SHEET - ARCH D

**Stantec**  
 Stantec Architecture Ltd.  
 10075 24th Street East  
 Saskatoon, SK, S7K 0K3  
 Tel: (306) 667-2400 • www.stantec.com

Consultant

ISSUED FOR PROCEEDINGS  
 By: JML  
 2018.08.27  
 YYYMMDD

Permit/Seal

**FINALIZED FURNITURE TENDER DOCUMENTS**  
 2018

Client/Project  
 DREAM

OGD RENOVATIONS  
 SASKATOON SQUARE  
 410 22nd Street East  
 Saskatoon, SK

Project No.: 144401558  
 File Name: N/A  
 Scale: 1 : 75

Author	Designer	Checker
Dwn.	Disgn.	Chkd.
		YYYYMMDD

Title  
 FURNITURE TENDER  
 LEVEL 4 - GENERAL  
 ROTARY SEATING

Revision: 1  
 Drawing No.  
**F06**



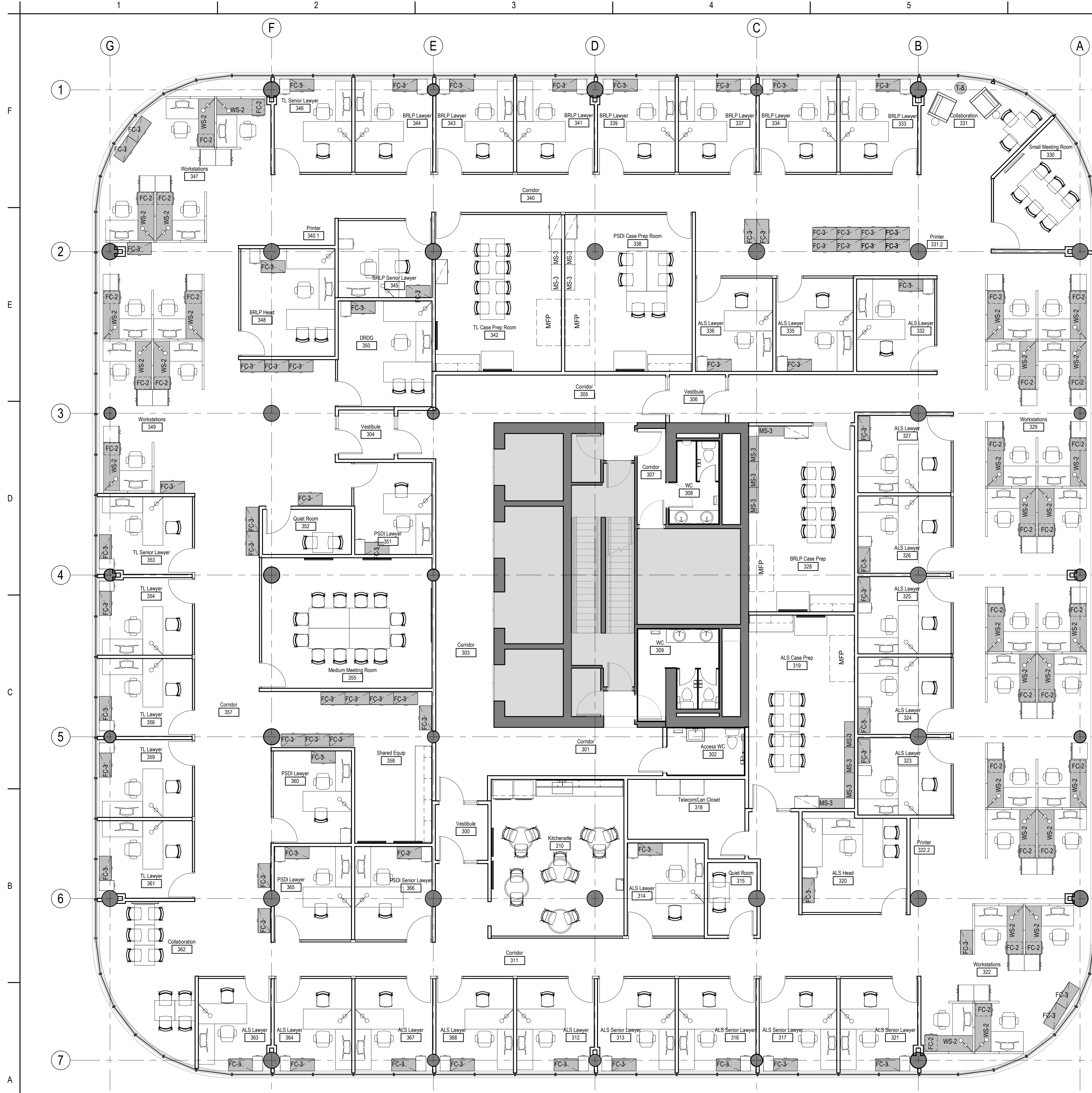

LEVEL 3 - NON-NSMA					
QTY	CODE	GOUCID	ITEM #	ITEM DESCRIPTION	CATEGORY
29	FC-2			Secure dial combination fire cabinet. 18"wx24"dx27"h. Metal.	STANDING OFFER
72	FC-3			Secure dial combination fire cabinet. 36"wx18"dx4h. Metal.	STANDING OFFER
12	MS-3			15"dx36"wx5"high. Metal.	NSMA
1	T-8			18" dia. Coffee table/side table. Drum style. Walnut veneer.	NSMA
29	WS-2			Frestanding workurface. Laminate. PVC Edge. 4 post leg or T-base. 24"dx72"w. Sitting height.	NSMA

**FURNITURE IN CONTRACT**

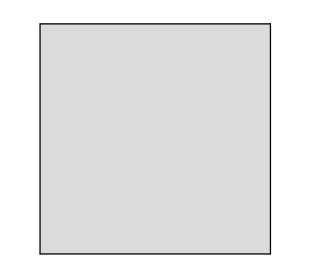

FURNITURE IN CONTRACT

Consultant

NO.	DATE	BY	APP'D	ISSUE/REVISION

Permit/Seal

**FINALIZED FURNITURE TENDER DOCUMENTS**  
 11, 2018

**1 FURNITURE TENDER - LEVEL 3 - NON-NMSA (See Specifications)**

F07 1:75

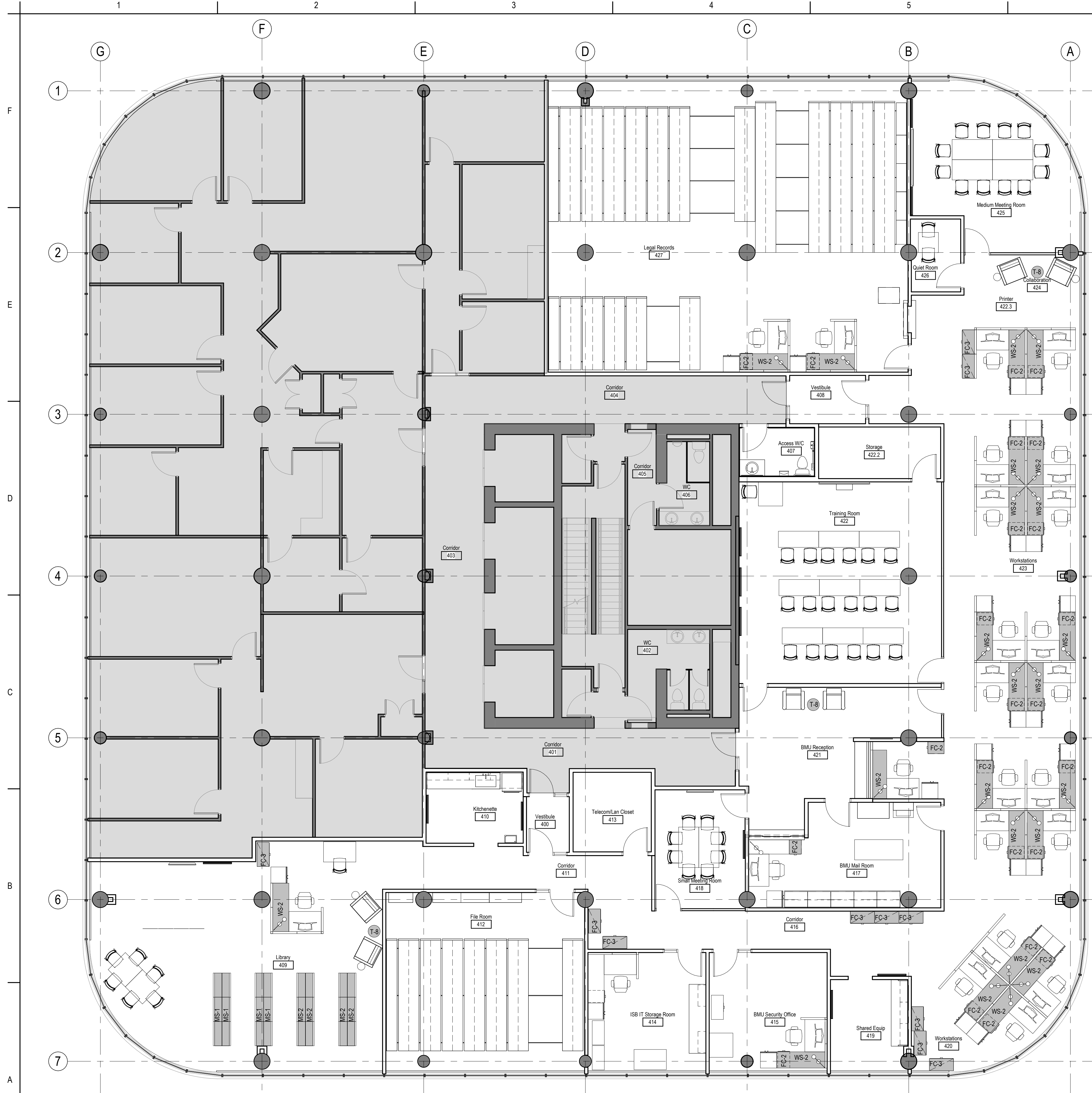

LEVEL 4 - NON-NSMA					
QTY	CODE	GOUCID	ITEM #	ITEM DESCRIPTION	CATEGORY
23	FC-2			Secure dial combination file cabinet. 18"x24"x27". Metal.	STANDING OFFER
11	FC-3			Secure dial combination fire cabinet. 36"x18"x4"high. Metal.	STANDING OFFER
4	MS-1			Metal open shelving. 5 high. 13"x36"w. 3 units back to back.	NSMA
4	MS-2			Metal open shelving. 3 high. 13"x36"w. 3 units back to back.	NSMA
3	T-8			18" dia. Coffee table/side table. Drum style. Walnut veneer.	NSMA
23	WS-2			Freestanding worksurface. Laminate. PVC Edge. 4 post leg or T-base. 24"x72"w. Sitting height.	NSMA

**FURNITURE IN CONTRACT**

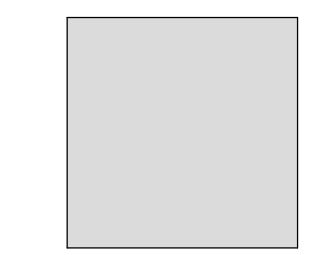

FURNITURE IN CONTRACT

**1 FURNITURE TENDER - LEVEL 4 - NON-NSMA (See Specifications)**  
F08 1:75

Consultant

NO.	DATE	BY	REVISION
1	2018.06.27	JMM	11/1/18/18/20
2	2018.06.27	JMM	11/1/18/18/20
3	2018.06.27	JMM	11/1/18/18/20
4	2018.06.27	JMM	11/1/18/18/20
5	2018.06.27	JMM	11/1/18/18/20
6	2018.06.27	JMM	11/1/18/18/20
7	2018.06.27	JMM	11/1/18/18/20
8	2018.06.27	JMM	11/1/18/18/20
9	2018.06.27	JMM	11/1/18/18/20
10	2018.06.27	JMM	11/1/18/18/20
11	2018.06.27	JMM	11/1/18/18/20
12	2018.06.27	JMM	11/1/18/18/20
13	2018.06.27	JMM	11/1/18/18/20
14	2018.06.27	JMM	11/1/18/18/20
15	2018.06.27	JMM	11/1/18/18/20
16	2018.06.27	JMM	11/1/18/18/20
17	2018.06.27	JMM	11/1/18/18/20
18	2018.06.27	JMM	11/1/18/18/20
19	2018.06.27	JMM	11/1/18/18/20
20	2018.06.27	JMM	11/1/18/18/20
21	2018.06.27	JMM	11/1/18/18/20
22	2018.06.27	JMM	11/1/18/18/20
23	2018.06.27	JMM	11/1/18/18/20
24	2018.06.27	JMM	11/1/18/18/20
25	2018.06.27	JMM	11/1/18/18/20
26	2018.06.27	JMM	11/1/18/18/20
27	2018.06.27	JMM	11/1/18/18/20
28	2018.06.27	JMM	11/1/18/18/20
29	2018.06.27	JMM	11/1/18/18/20
30	2018.06.27	JMM	11/1/18/18/20

Permit/Seal

**FINALIZED FURNITURE TENDER DOCUMENTS**  
1, 2018