

|  |  |  |                                      |   |   |           |
|--|--|--|--------------------------------------|---|---|-----------|
| Client/client<br><br>CORRECTIONAL SERVICE CANADA | Project title/Titre du projet<br>MISSION MEDIUM INSTITUTION<br>8751 STAVE LAKE STREET, MISSION, BC<br><br>BUILDING A-K FLOORING REPLACEMENT<br>ROOM 102, 103, 104, 121 | Drawing title/Titre du dessin<br><br>SITE PLAN | Consultant Signature & Date Only     | PWGSC Project Manager/Administrateur de Projets TPSCG<br>PAUL RITHALER  | Project No./No. du projet<br>R.097979.001 | Rev<br>Ke |
|  |  |  | Designed by/Concept par<br>MAX CHENG | PWGSC, Regional Manager, Architectural and Engineering Services/<br>Gestionnaire régionale, Services d'architectural et de génie, TPSCG<br>PREETIPAL PAUL |   |           |
|  |  |  | Drawn by/Dessine par<br>MAX CHENG    | Date/Date<br>2018-07-31   | Sheet/Feuille<br><br>A01<br><br>OF        |           |
|  |  |  |                                      |   |   |           |



GENERAL NOTES

1. ENTIRE SCOPE WORK SHALL BE IMPLEMENTED IN VARIOUS PHASES IN ORDER TO ACCOMMODATING CSC OPERATIONAL REQUIREMENTS AND SCHEDULES.
2. REMOVE EXISTING KITCHEN EQUIPMENT AND FURNITURE FOR FLOOR DEMOLITION AND NEW FLOOR FINISH INSTALLATION. RE-INSTALL KITCHEN EQUIPMENT AND FURNITURE BACK ITS ITS ORIGINAL CONDITION AFTER NEW FLOOR WORK. RETAIN KITCHEN EQUIPMENT SPECIALIST TO ENSURE KITCHEN EQUIPMENT WILL FUNCTION SAME AS BEFORE. KITCHEN SPECIALIST SHALL VERIFY ELECTRICAL AND MECHANICAL CONNECTION TO THE RE-INSTALLED KITCHEN EQUIPMENT AND PROVIDE FIELD VERIFICATION REPORT BEFORE OCCUPANCY.
3. DEMOLISH AND DISPOSE EXISTING FLOOR FINISHES WITHIN IN THE SCOPE BOUNDARY LINES.
4. PREPARE FLOOR SUBSTRATE PER NEW FLOOR FINISH PRODUCT SPECIFICATION.
5. APPLY NEW METHYL-METHACRYLATE ACRYLIC (MMA) LIQUID-APPLIED FLOOR FINISH FOR THE SCOPE AREAS.

LEGEND

- 1 TYP. RE & RE EXISTING KITCHEN EQUIPMENT, FURNITURE FOR FLOOR RE-SURFACING WORK. DISCONNECT AND RECONNECT ELECTRICAL & MECHANICAL SERVICE LINES TO THE EQUIPMENT

➡ PHOTO VIEWING DIRECTION

# PHOTO NUMBER LISTED ON A04 TO A10

EXISTING CERAMIC FLOOR TILE FOR DEMOLITION.

EXISTING VINYL FLOOR TILE FOR DEMOLITION

EXISTING STAINLESS STEEL TRENCH DRAIN OR DRAIN PEN TO REMAIN

PAINTED / WATERPROOF COATED FLOOR FINISHE  
TO BE RE-SUFACED WITH NEW MMA

SCOPE BOUNDARY LINES  
TOTAL FLOOR RE-SURFACING  
AREA = +- 575M<sup>2</sup>

1 EXISTING FLOOR FINISH

Scale: 1:200

2 EXISTING KITCHEN EQUIPMENT AND FURNITURE

Scale: 1:200

Client/client

CORRECTIONAL SERVICE CANADA

Project title/Titre du projet

MISSION MEDIUM INSTITUTION  
8751 STAVE LAKE STREET, MISSION, BC  
BUILDING A-K FLOORING REPLACEMENT  
ROOM 102, 103, 104, 121

Drawing title/Titre du dessin

EXISTING FLOOR FINISH PLAN  
EXISTING EQUIPMENT AND FURNITURE PLAN

Consultant Signature & Date Only

Designed by/Concept par  
MAX CHENG

Drawn by/Dessine par  
MAX CHENG

PWGSC Project Manager/Administrateur  
de Projets TPSGC PAUL RITHALER

PWGSC, Regional Manager, Architectural and Engineering Services/  
Gestionnaire régionale, Services d'architectural et de génie, TPSGC  
PREETIPAL PAUL

Date/Date  
2018-07-31

Project No./No. du  
projet R.097979.001

Sheet/Feuille  
A02  
OF

Revision/  
Revision  
0

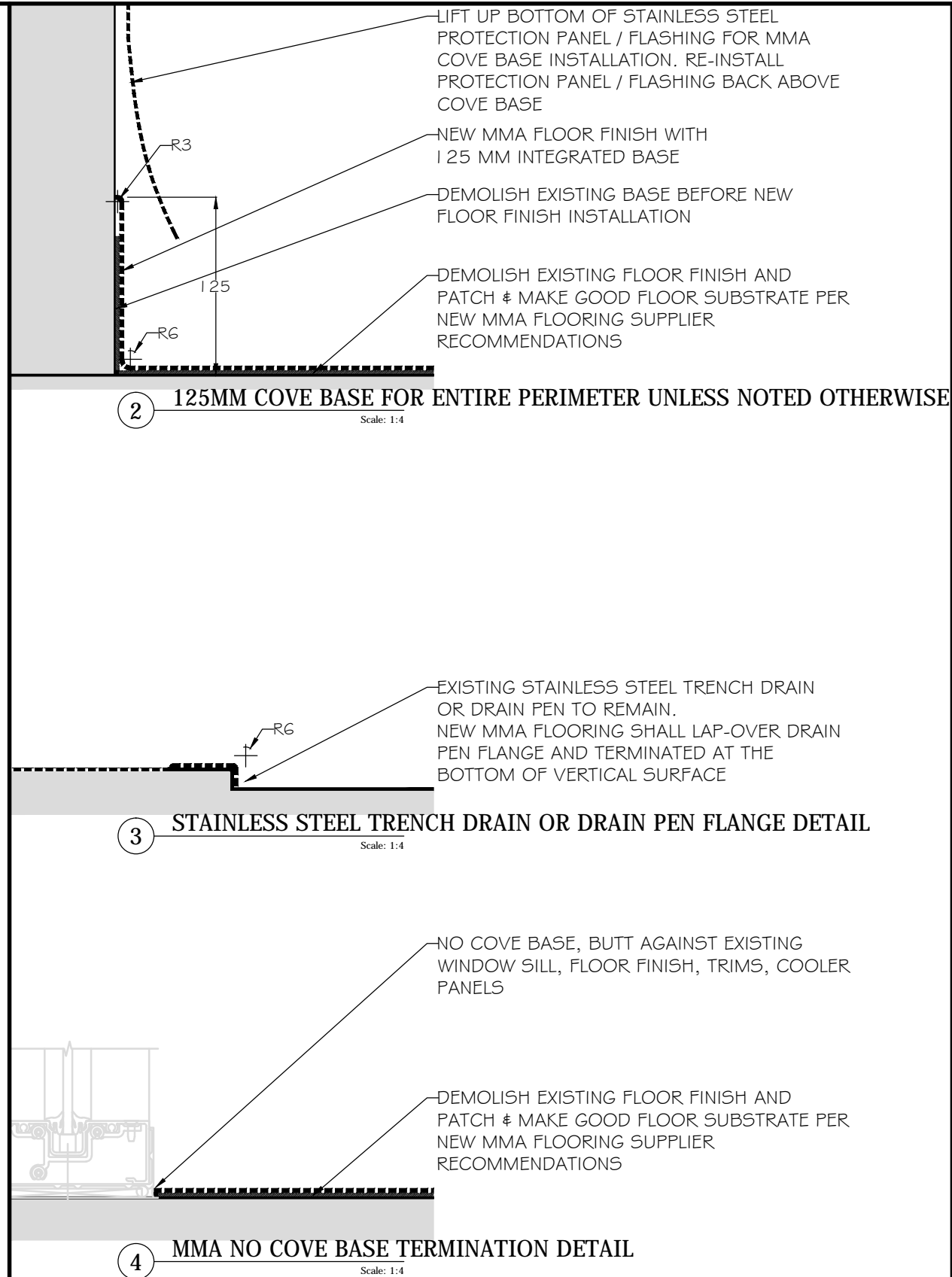
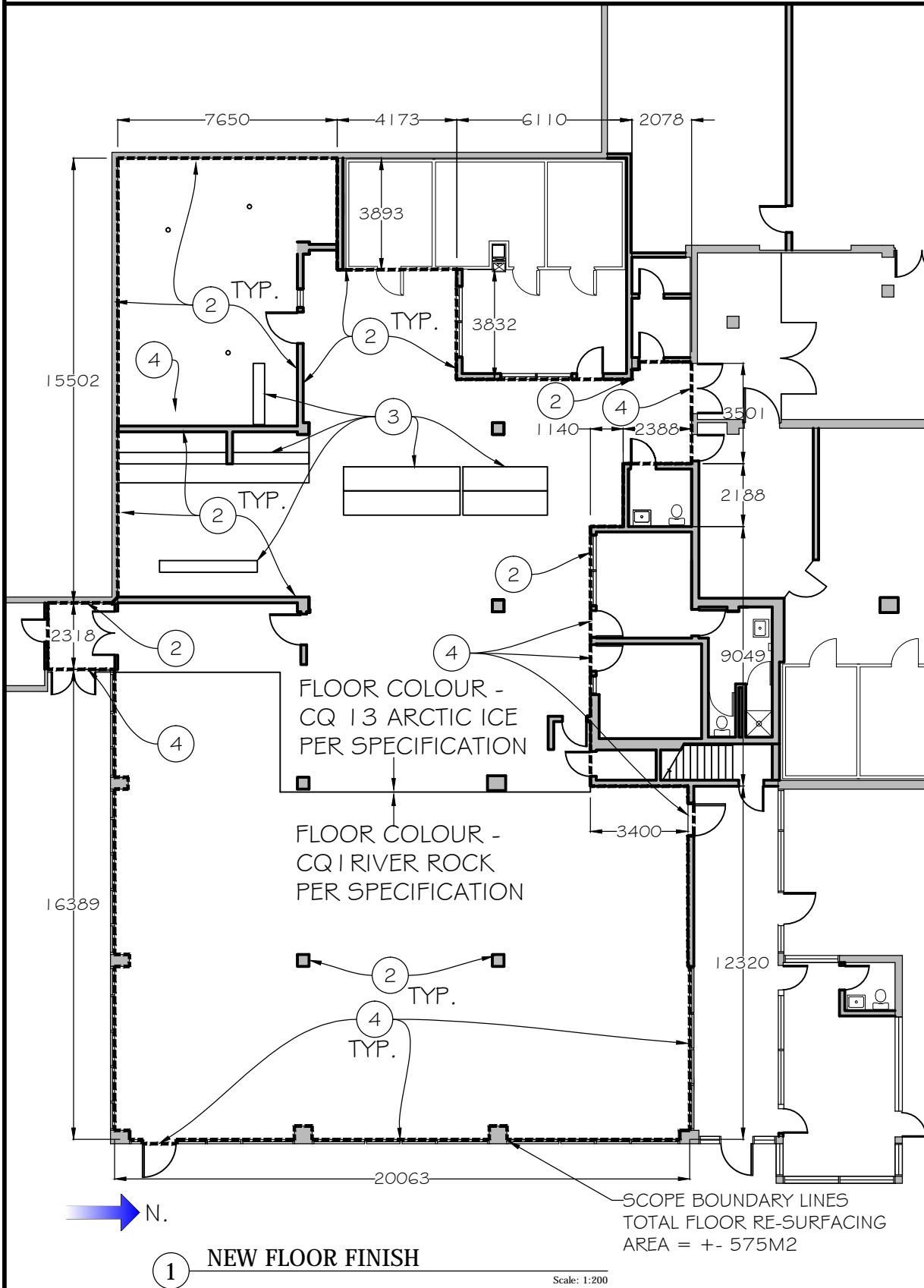

#### GENERAL NOTES

1. ENTIRE SCOPE WORK SHALL BE IMPLEMENTED IN VARIOUS PHASES IN ORDER TO ACCOMMODATING CSC OPERATIONAL REQUIREMENTS AND SCHEDULES.
2. REMOVE EXISTING KITCHEN EQUIPMENT AND FURNITURE FOR FLOOR DEMOLITION AND NEW FLOOR FINISH INSTALLATION. RE-INSTALL KITCHEN EQUIPMENT AND FURNITURE BACK ITS ITS ORIGINAL CONDITION AFTER NEW FLOOR WORK. RETAIN KITCHEN EQUIPMENT SPECIALIST TO ENSURE KITCHEN EQUIPMENT WILL FUNCTION SAME AS BEFORE. KITCHEN SPECIALIST SHALL VERIFY ELECTRICAL AND MECHANICAL CONNECTION TO THE RE-INSTALLED KITCHEN EQUIPMENT AND PROVIDE FIELD VERIFICATION REPORT BEFORE OCCUPANCY.
3. DEMOLISH AND DISPOSE EXISTING FLOOR FINISHES WITHIN IN THE SCOPE BOUNDARY LINES.
4. PREPARE FLOOR SUBSTRATE PER NEW FLOOR FINISH PRODUCT SPECIFICATION.
5. APPLY NEW METHYL-METHACRYLATE ACRYLIC (MMA) LIQUID-APPLIED FLOOR FINISH FOR THE SCOPE AREAS.

|  |  |   |                                      |   |   |                                |
|--|--|---|--------------------------------------|---|---|--------------------------------|
| Client/client<br><br>CORRECTIONAL SERVICE CANADA | Project title/Titre du projet<br>MISSION MEDIUM INSTITUTION<br>8751 STAVE LAKE STREET, MISSION, BC<br><br>BUILDING A-K FLOORING REPLACEMENT<br>ROOM 102, 103, 104, 121 | Drawing title/Titre du dessin<br><br>NEW FLOOR FINISH PLAN<br>DETAILS | Consultant Signature & Date Only     | PWGSC Project Manager/Administrateur<br>de Projets TPSGC PAUL RITHALER  | Project No./No. du<br>projet R.097979.001 |                                |
|  |  |   | Designed by/Concept par<br>MAX CHENG | PWGSC, Regional Manager, Architectural and Engineering Services/<br>Gestionnaire régionale, Services d'architectural et de génie, TPSGC<br>PREETIPAL PAUL | Sheet/Feuille<br><br>A03<br><br>OF        | Revision/<br>Revision<br><br>0 |
|  |  |   | Drawn by/Dessine par<br>MAX CHENG    | Date/Date<br>2018-07-31   |   |                                |







1 PHOTO OF EXISTING CONDITION

Scale: N.T.S.



2 PHOTO OF EXISTING CONDITION

Scale: N.T.S.



3 PHOTO OF EXISTING CONDITION

Scale: N.T.S.



4 PHOTO OF EXISTING CONDITION

Scale: N.T.S.

- LEGEND
- 1

RE & RE EXISTING KITCHEN EQUIPMENT, FURNITURE FOR FLOOR RE-SURFACING WORK. DISCONNECT AND RECONNECT ELECTRICAL & MECHANICAL SERVICE LINES TO THE EQUIPMENT
- 2

DEMOLISH EXISTING FLOOR FINISH PATCH AND MAKE GOOD FLOOR SLAB AND INSTALL NEW MMA FLOOR FINISH
- 3

NEW FLOORING TERMINATION - COVE BASE PER DETAIL #2/A03
- 4

NEW FLOORING TERMINATION - LAP OVER EXISTING FLOOR FINISH OR DRAINS PER DETAIL #3/A03
- 5

NEW FLOORING TERMINATION - NO BASE #4/A03
- 6

EXISTING TO REMAIN

Client/client  
**CORRECTIONAL SERVICE CANADA**

Project title/Titre du projet  
**MISSION MEDIUM INSTITUTION  
8751 STAVE LAKE STREET, MISSION, BC  
BUILDING A-K FLOORING REPLACEMENT  
ROOM 102, 103, 104, 121**

Drawing title/Titre du dessin  
**PHOTOS OF EXISTING CONDITION**

Consultant Signature & Date Only  
Designed by/Concept par  
**MAX CHENG**  
Drawn by/Dessiné par  
**MAX CHENG**

PWGSC Project Manager/Administrateur  
de Projets TPSGC  
**PAUL RITHALER**  
PWGSC, Regional Manager, Architectural and Engineering Services/  
Gestionnaire régionale, Services d'architecture et de génie, TPSGC  
**PREETIPAL PAUL**  
Date/Date  
**2018-07-31**

Project No./No. du projet  
**R.097979.001**  
Sheet/Feuille  
**A04**  
OF  
Revision/Revision  
**0**





5 PHOTO OF EXISTING CONDITION

Scale: N.T.S.



6 PHOTO OF EXISTING CONDITION

Scale: N.T.S.



7 PHOTO OF EXISTING CONDITION

Scale: N.T.S.



8 PHOTO OF EXISTING CONDITION

Scale: N.T.S.

LEGEND

- 1RE & RE EXISTING KITCHEN  
EQUIPMENT, FURNITURE FOR  
FLOOR RE-SURFACING WORK.  
DISCONNECT AND RECONNECT  
ELECTRICAL & MECHANICAL  
SERVICE LINES TO THE EQUIPMENT
- 2DEMOLISH EXISTING FLOOR FINISH  
PATCH AND MAKE GOOD FLOOR  
SLAB AND INSTALL NEW MMA  
FLOOR FINISH
- 3NEW FLOORING TERMINATION -  
COVE BASE PER DETAIL #2/A03
- 4NEW FLOORING TERMINATION - LAP  
OVER EXISTING FLOOR FINISH OR  
DRAINS PER DETAIL #3/A03
- 5NEW FLOORING TERMINATION - NO  
BASE #4/A03
- 6EXISTING TO REMAIN

|                             |
|-----------------------------|
| Client/client               |
| CORRECTIONAL SERVICE CANADA |

|   |
|---|
| Project title/Titre du projet                                     |
| MISSION MEDIUM INSTITUTION<br>8751 STAVE LAKE STREET, MISSION, BC |
| BUILDING A-K FLOORING REPLACEMENT<br>ROOM 102, 103, 104, 121      |

|                               |
|-------------------------------|
| Drawing title/Titre du dessin |
| PHOTOS OF EXISTING CONDITION  |

|                                      |
|--------------------------------------|
| Consultant Signature & Date Only     |
| Designed by/Concept par<br>MAX CHENG |
| Drawn by/Dessine par<br>MAX CHENG    |

|   |
|---|
| PWGSC Project Manager/Administrateur<br>de Projets TPSCGPAUL RITHALER   |
| PWGSC, Regional Manager, Architectural and Engineering Services/<br>Gestionnaire régionale, Services d'architectural et de génie, TPSCG<br>PREETIPAL PAUL |
| Date/Date<br>2018-07-31   |

|                              |
|------------------------------|
| Project No./No. du<br>projet |
| R.097979.001                 |
| Sheet/Feuille                |
| A05<br>OF                    |

|                       |
|-----------------------|
| Revision/<br>Revision |
| 0                     |







9 PHOTO OF EXISTING CONDITION

Scale: N.T.S.



10 PHOTO OF EXISTING CONDITION

Scale: N.T.S.



11 PHOTO OF EXISTING CONDITION

Scale: N.T.S.



12 PHOTO OF EXISTING CONDITION

Scale: N.T.S.

LEGEND

- 1 RE & RE EXISTING KITCHEN EQUIPMENT, FURNITURE FOR FLOOR RE-SURFACING WORK. DISCONNECT AND RECONNECT ELECTRICAL & MECHANICAL SERVICE LINES TO THE EQUIPMENT
- 2 DEMOLISH EXISTING FLOOR FINISH PATCH AND MAKE GOOD FLOOR SLAB AND INSTALL NEW MMA FLOOR FINISH
- 3 NEW FLOORING TERMINATION - COVE BASE PER DETAIL #2/A03
- 4 NEW FLOORING TERMINATION - LAP OVER EXISTING FLOOR FINISH OR DRAINS PER DETAIL #3/A03
- 5 NEW FLOORING TERMINATION - NO BASE #4/A03
- 6 EXISTING TO REMAIN

|                             |
|-----------------------------|
| Client/client               |
| CORRECTIONAL SERVICE CANADA |

|   |
|---|
| Project title/Titre du projet   |
| MISSION MEDIUM INSTITUTION<br>8751 STAVE LAKE STREET, MISSION, BC<br>BUILDING A-K FLOORING REPLACEMENT<br>ROOM 102, 103, 104, 121 |

|                               |
|-------------------------------|
| Drawing title/Titre du dessin |
| PHOTOS OF EXISTING CONDITION  |

|                                      |
|--------------------------------------|
| Consultant Signature & Date Only     |
| Designed by/Concept par<br>MAX CHENG |
| Drawn by/Dessine par<br>MAX CHENG    |

|  |
|--|
| PWGSC Project Manager/Administrateur<br>de Projets TPSGC<br>PAUL RITHALER  |
| PWGSC, Regional Manager, Architectural and Engineering Services/<br>Gestionnaire régionale, Services d'architecture et de génie, TPSGC<br>PREETIPAL PAUL |
| Date/Date<br>2018-07-31  |

|  |
|--|
| Project No./No. du<br>projet<br>R.097979.001 |
| Sheet/Feuille<br>A06<br>OF                   |
| Revision/<br>Revision<br>0                   |







13 PHOTO OF EXISTING CONDITION

Scale: N.T.S.



14 PHOTO OF EXISTING CONDITION

Scale: N.T.S.



15 PHOTO OF EXISTING CONDITION

Scale: N.T.S.



16 PHOTO OF EXISTING CONDITION

Scale: N.T.S.

- LEGEND
- 1 RE # RE EXISTING KITCHEN EQUIPMENT, FURNITURE FOR FLOOR RE-SURFACING WORK. DISCONNECT AND RECONNECT ELECTRICAL & MECHANICAL SERVICE LINES TO THE EQUIPMENT
  - 2 DEMOLISH EXISTING FLOOR FINISH PATCH AND MAKE GOOD FLOOR SLAB AND INSTALL NEW MMA FLOOR FINISH
  - 3 NEW FLOORING TERMINATION - COVE BASE PER DETAIL #2/A03
  - 4 NEW FLOORING TERMINATION - LAP OVER EXISTING FLOOR FINISH OR DRAINS PER DETAIL #3/A03
  - 5 NEW FLOORING TERMINATION - NO BASE #4/A03
  - 6 EXISTING TO REMAIN

Client/client  
**CORRECTIONAL SERVICE CANADA**

Project title/Titre du projet  
**MISSION MEDIUM INSTITUTION  
8751 STAVE LAKE STREET, MISSION, BC  
BUILDING A-K FLOORING REPLACEMENT  
ROOM 102, 103, 104, 121**

Drawing title/Titre du dessin  
**PHOTOS OF EXISTING CONDITION**

Consultant Signature & Date Only  
Designed by/Concept par  
**MAX CHENG**  
Drawn by/Dessine par  
**MAX CHENG**

PWGSC Project Manager/Administrateur  
de Projets TPSGC  
**PAUL RITHALER**  
PWGSC, Regional Manager, Architectural and Engineering Services/  
Gestionnaire régionale, Services d'architecture et de génie, TPSGC  
**PREETIPAL PAUL**  
Date/Date  
**2018-07-31**

Project No./No. du projet  
**R.097979.001**  
Sheet/Feuille  
**A07**  
OF  
Revision/Revision  
**0**







17 PHOTO OF EXISTING CONDITION

Scale: N.T.S.



18 PHOTO OF EXISTING CONDITION

Scale: N.T.S.



19 PHOTO OF EXISTING CONDITION

Scale: N.T.S.



20 PHOTO OF EXISTING CONDITION

Scale: N.T.S.

- LEGEND
- 1 RE # RE EXISTING KITCHEN EQUIPMENT, FURNITURE FOR FLOOR RE-SURFACING WORK. DISCONNECT AND RECONNECT ELECTRICAL & MECHANICAL SERVICE LINES TO THE EQUIPMENT
  - 2 DEMOLISH EXISTING FLOOR FINISH PATCH AND MAKE GOOD FLOOR SLAB AND INSTALL NEW MMA FLOOR FINISH
  - 3 NEW FLOORING TERMINATION - COVE BASE PER DETAIL #2/A03
  - 4 NEW FLOORING TERMINATION - LAP OVER EXISTING FLOOR FINISH OR DRAINS PER DETAIL #3/A03
  - 5 NEW FLOORING TERMINATION - NO BASE #4/A03
  - 6 EXISTING TO REMAIN

|                             |
|-----------------------------|
| Client/client               |
| CORRECTIONAL SERVICE CANADA |

|   |
|---|
| Project title/Titre du projet   |
| MISSION MEDIUM INSTITUTION<br>8751 STAVE LAKE STREET, MISSION, BC<br>BUILDING A-K FLOORING REPLACEMENT<br>ROOM 102, 103, 104, 121 |

|                               |
|-------------------------------|
| Drawing title/Titre du dessin |
| PHOTOS OF EXISTING CONDITION  |

|                                      |
|--------------------------------------|
| Consultant Signature & Date Only     |
| Designed by/Concept par<br>MAX CHENG |
| Drawn by/Dessine par<br>MAX CHENG    |

|   |
|---|
| PWGSC Project Manager/Administrateur<br>de Projets TPSGC<br>PAUL RITHALER   |
| PWGSC, Regional Manager, Architectural and Engineering Services/<br>Gestionnaire régionale, Services d'architectural et de génie, TPSGC<br>PREETIPAL PAUL |
| Date/Date<br>2018-07-31   |

|  |
|--|
| Project No./No. du<br>projet<br>R.097979.001 |
| Sheet/Feuille<br>A08<br>OF                   |
| Revision/<br>Revision<br>0                   |







21 PHOTO OF EXISTING CONDITION

Scale: N.T.S.



22 PHOTO OF EXISTING CONDITION

Scale: N.T.S.



23 PHOTO OF EXISTING CONDITION

Scale: N.T.S.



24 PHOTO OF EXISTING CONDITION

Scale: N.T.S.

- LEGEND
- 1 RE & RE EXISTING KITCHEN EQUIPMENT, FURNITURE FOR FLOOR RE-SURFACING WORK. DISCONNECT AND RECONNECT ELECTRICAL & MECHANICAL SERVICE LINES TO THE EQUIPMENT
  - 2 DEMOLISH EXISTING FLOOR FINISH PATCH AND MAKE GOOD FLOOR SLAB AND INSTALL NEW MMA FLOOR FINISH
  - 3 NEW FLOORING TERMINATION - COVE BASE PER DETAIL #2/A03
  - 4 NEW FLOORING TERMINATION - LAP OVER EXISTING FLOOR FINISH OR DRAINS PER DETAIL #3/A03
  - 5 NEW FLOORING TERMINATION - NO BASE #4/A03
  - 6 EXISTING TO REMAIN

Client/client  
**CORRECTIONAL SERVICE CANADA**

Project title/Titre du projet  
**MISSION MEDIUM INSTITUTION  
8751 STAVE LAKE STREET, MISSION, BC  
BUILDING A-K FLOORING REPLACEMENT  
ROOM 102, 103, 104, 121**

Drawing title/Titre du dessin  
**PHOTOS OF EXISTING CONDITION**

Consultant Signature & Date Only  
Designed by/Concept par  
MAX CHENG  
Drawn by/Dessine par  
MAX CHENG

PWGSC Project Manager/Administrateur  
de Projets TPSGC  
PAUL RITHALER  
PWGSC, Regional Manager, Architectural and Engineering Services/  
Gestionnaire régionale, Services d'architectural et de génie, TPSGC  
PREETIPAL PAUL  
Date/Date  
2018-07-31

Project No./No. du projet  
**R.097979.001**  
Sheet/Feuille  
**A09**  
OF  
Revision/Revision  
**0**







- LEGEND
- 1 RE & RE EXISTING KITCHEN EQUIPMENT, FURNITURE FOR FLOOR RE-SURFACING WORK. DISCONNECT AND RECONNECT ELECTRICAL & MECHANICAL SERVICE LINES TO THE EQUIPMENT
  - 2 DEMOLISH EXISTING FLOOR FINISH PATCH AND MAKE GOOD FLOOR SLAB AND INSTALL NEW MMA FLOOR FINISH
  - 3 NEW FLOORING TERMINATION - COVE BASE PER DETAIL #2/A03
  - 4 NEW FLOORING TERMINATION - LAP OVER EXISTING FLOOR FINISH OR DRAINS PER DETAIL #3/A03
  - 5 NEW FLOORING TERMINATION - NO BASE #4/A03
  - 6 EXISTING TO REMAIN

25 PHOTO OF EXISTING CONDITION

Scale: N.T.S.

26 PHOTO OF EXISTING CONDITION

Scale: N.T.S.



27 PHOTO OF EXISTING CONDITION

Scale: N.T.S.

28 PHOTO OF EXISTING CONDITION

Scale: N.T.S.

Client/client  
**CORRECTIONAL SERVICE CANADA**

Project title/Titre du projet  
**MISSION MEDIUM INSTITUTION  
8751 STAVE LAKE STREET, MISSION, BC  
BUILDING A-K FLOORING REPLACEMENT  
ROOM 102, 103, 104, 121**

Drawing title/Titre du dessin  
**PHOTOS OF EXISTING CONDITION**

Consultant Signature & Date Only

PWGSC Project Manager/Administrateur  
de Projets TPSGC  
**PAUL RITHALER**

Project No./No. du  
projet  
**R.097979.001**

Designed by/Concept par  
**MAX CHENG**

PWGSC, Regional Manager, Architectural and Engineering Services/  
Gestionnaire régionale, Services d'architecture et de génie, TPSGC  
**PREETIPAL PAUL**

Sheet/Feuille  
**A10**

Revision/  
Revision  
**0**

Drawn by/Dessiné par  
**MAX CHENG**

Date/Date  
**2018-07-31**

**OF**

