

SPECIFICATIONS

- SCOPE OF WORK:  
WORK SHALL INCLUDE BUT NOT BE LIMITED TO THE FOLLOWING:
  - REMOVAL OF EXISTING EQUIPMENT BUILDING ELECTRICAL SERVICE.
  - REMOVAL OF EXISTING ELECTRICAL SERVICE GROUNDING.
  - REMOVAL OF EXISTING EQUIPMENT BUILDING AND ASSOCIATED CONCRETE PAD, INCLUDING HAZARDOUS MATERIALS ABATEMENT AND REMEDIATION.
  - REMOVAL OF EXISTING UNDERGROUND CABLES TO FOG HORN AND LIGHT STATION.
  - INSTALLATION OF NEW CONCRETE PAD AS PER STRUCTURAL DRAWINGS.
  - ENSURE FINISH GRADE SLOPES AWAY FROM NEW ENCLOSURE ON ALL SIDES.
  - TRANSPORT OWNER SUPPLIED FIBERGLASS ENCLOSURE FROM DFO WAREHOUSE SITE IN BISHOP'S FALLS TO SITE, INSTALL ON NEW CONCRETE PAD AND CONNECT ALL SERVICES.
  - INSTALLATION OF NEW ELECTRICAL SERVICE AS INDICATED ON DRAWINGS.
  - INSTALLATION OF NEW ELECTRICAL SERVICE GROUNDING SYSTEM.
  - INSTALLATION OF NEW UNDERGROUND CONDUITS TO FOGHORN, FOG SENSOR AND LIGHT STATION AS INDICATED. CABLES TO BE PULLED BY CANADIAN COAST GUARD ONCE CONSTRUCTION IS COMPLETED.
  - BONDING OF ALL METAL PARTS OF NEW FIBERGLASS ENCLOSURE.
  - ENTIRE SITE IS TO BE GRUBBED TO 1m OUTSIDE OF THE FENCE. BACKFILL WITH TYPE 2 AND CAP WITH 150mm TYPE 1 TO BLEND WITH EXISTING.
- THE COMPLETE ELECTRICAL INSTALLATION SHALL CONFORM TO THE LATEST EDITION OF THE CANADIAN ELECTRICAL CODE AND LOCAL BY LAWS CURRENTLY IN FORCE IN THE PROVINCE AND MUNICIPALITY.
- ALL WORK SHALL BE PERFORMED BY PERSONS HAVING QUALIFICATIONS AS REQUIRED BY ANY AUTHORITY HAVING JURISDICTION AND WHO ARE COMPETENT IN THEIR TRADE.
- ALL WORK SHALL BE SUBJECT TO INSPECTION BY LOCAL INSPECTION AUTHORITY, THE OWNER OR HIS REPRESENTATIVE. CORRECT DEFICIENCIES AS REQUIRED BY INSPECTION AUTHORITY WITHOUT CHARGE TO OWNER.
- PAYMENT FOR PERMITS AND DEPOSITS FOR THE WORK SHALL BE INCLUDED.
- BEFORE SUBMITTING A PROPOSAL FOR THE WORK COVERED BY THE SPECIFICATIONS, EACH BIDDER SHALL VISIT AND INSPECT THE SITE IN ORDER THAT HE MAY BE THOROUGHLY FAMILIAR WITH THE SITE AND LOCAL CONDITIONS, WITH THE CHARACTER AND DETAILS OF THE CONSTRUCTION AND WITH ALL MATTERS WHICH CAN, IN ANY WAY, AFFECT THE WORK COVERED BY THE SPECIFICATIONS. NO CLAIM WILL BE ENTERTAINED OR ALLOWED FOR ANY LABOUR, MATERIALS OR OTHER EXTRAS THAT MAY BE REQUIRED FOR THE PROPER EXECUTION AND COMPLETION OF THE CONTRACT, WHICH COULD HAVE BEEN DETERMINED BY SITE EXAMINATION.
- ANY MATERIALS AND EQUIPMENT SUPPLIED BY CONTRACTOR SHALL BE NEW AND BEAR CSA APPROVAL.
- CONDUIT: THE MINIMUM SIZE OF CONDUIT SHALL BE 21mm $\phi$ . ALL CONDUIT RUN INSIDE SHALL BE EMT. ALL EXTERIOR AND UNDERGROUND CONDUIT SHALL BE RIGID PVC.
- WIRE: ALL WIRING SHALL BE RW90 COPPER. ALL CONDUCTORS SHALL BE 1000V, PROPERLY COLOUR CODED.
- GUARANTEE: THIS CONTRACTOR SHALL GUARANTEE ALL NEW MATERIALS AND WORKMANSHIP FOR A PERIOD OF ONE YEAR FROM DATE OF COMPLETION OF THE WORK AND FINAL ACCEPTANCE.
- A HAZARDOUS BUILDING MATERIAL ASSESSMENT REPORT HAS BEEN COMPLETED FOR THE EXISTING EQUIPMENT BUILDING. CONTRACTOR TO REFER TO SPECIFICATIONS ATTACHED TO TENDER DOCUMENTS AND FOLLOW ALL REMEDIATION AND ABATEMENT PROCEDURES AND RECOMMENDATIONS OF REMOVAL AND WASTE DISPOSAL PRIOR TO START OF DEMOLITION WORK.

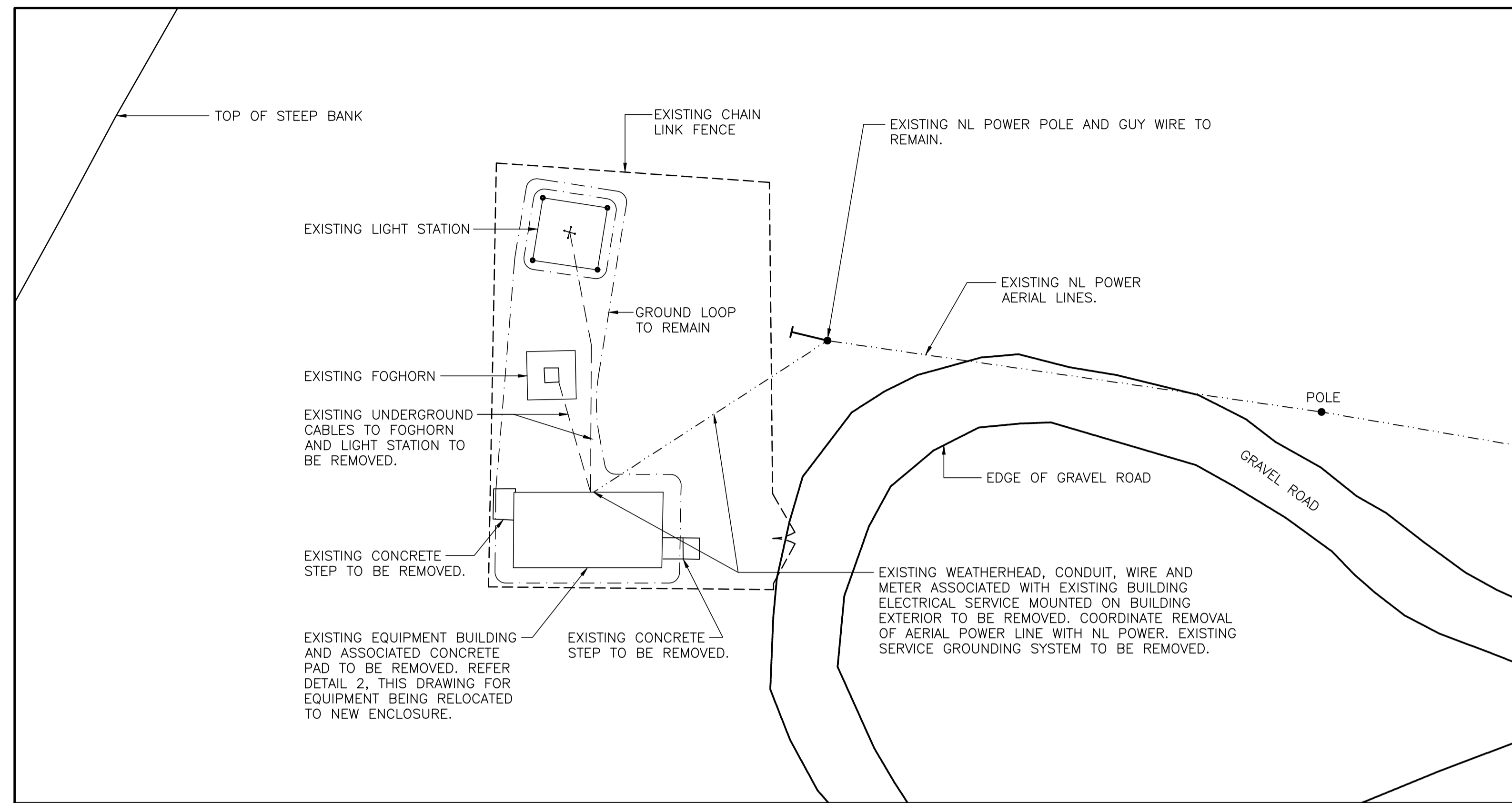

**1** DEMOLITION SITE PLAN  
E01 1:200

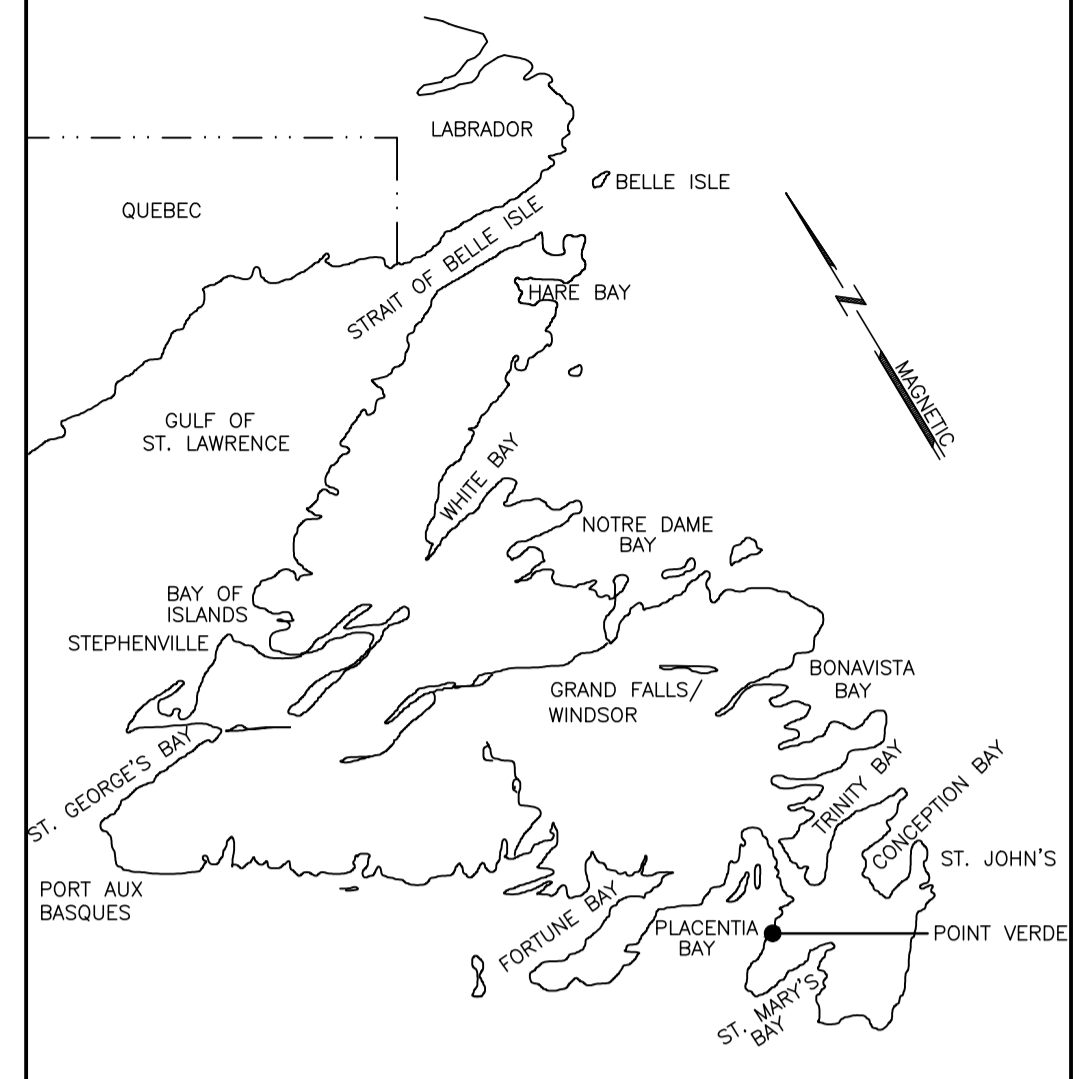
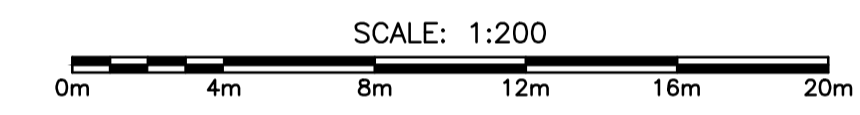

KEY LOCATION PLAN

LEGEND

- EXISTING BASEBOARD HEATER TO BE REMOVED.
- EXISTING LIGHT FIXTURE TO BE REMOVED.
- EXISTING LIGHT FIXTURE TO BE REMOVED.
- EXISTING THERMOSTAT TO BE REMOVED.
- EXISTING TIMER SWITCH TO BE REMOVED.
- EXISTING SERVICE DISCONNECT TO BE REMOVED.
- EXISTING RECEPTACLE TO BE REMOVED.
- EXISTING TELEPHONE OUTLET TO BE REMOVED.
- EXISTING ELECTRICAL PANEL TO BE REMOVED.

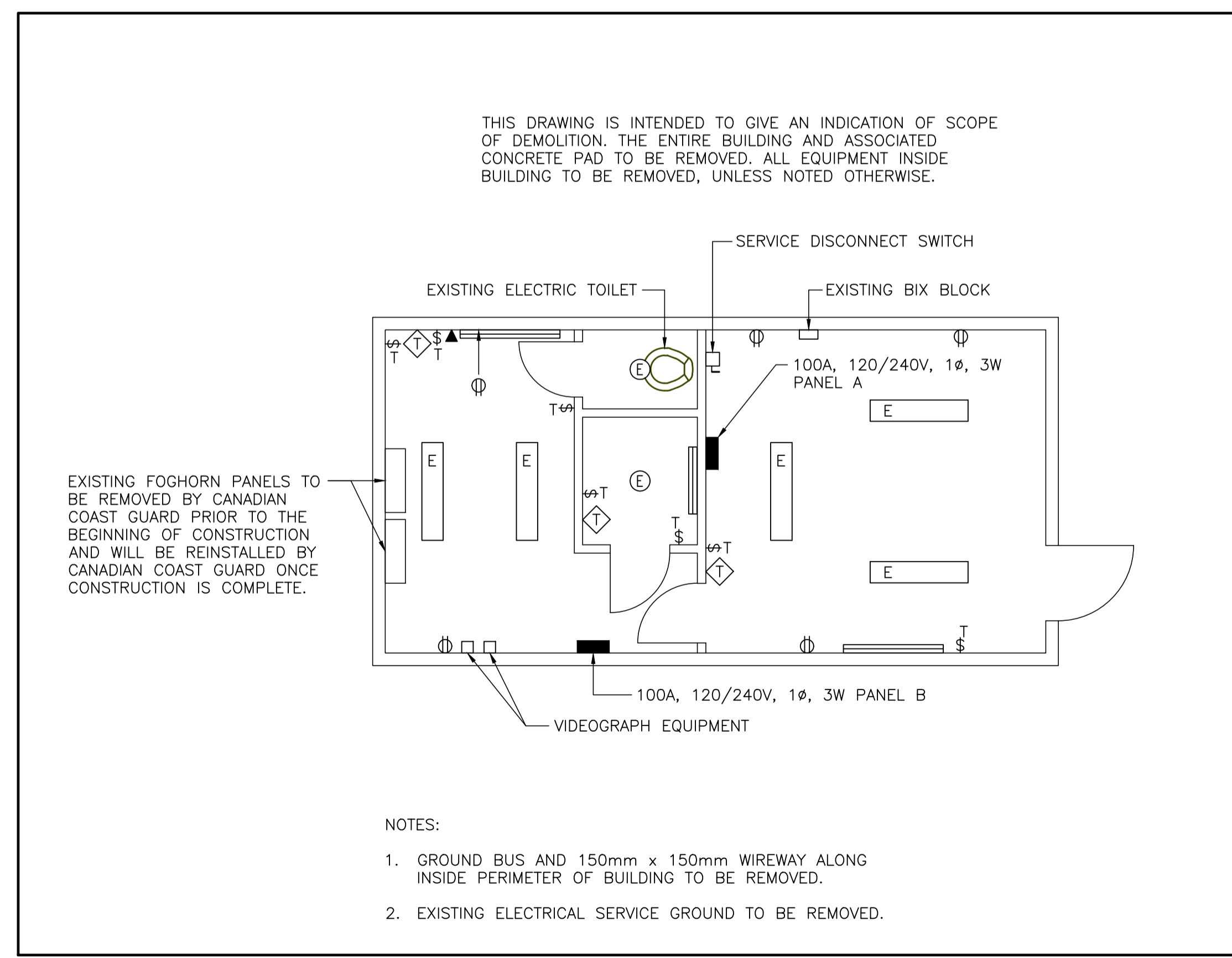

**2** DEMOLITION FLOOR PLAN - EQUIPMENT BUILDING  
E01 1:50

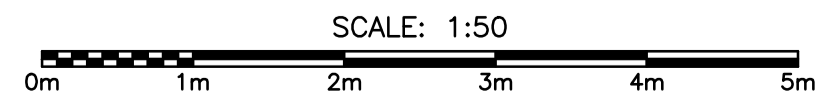

PROVINCE OF NEWFOUNDLAND AND LABRADOR  
**PEG** PROFESSIONAL ENGINEER  
 REGISTERED PROFESSIONAL ENGINEER  
 2018.09.21  
 DATE

PERMIT HOLDER  
 This Permit Allows  
**JEWEL BAILEY CONSULTANTS LTD.**  
 MIRC: *[Signature]*  
 To practice Professional Engineering in Newfoundland and Labrador, Permit No. as issued by PEG N0540 which is valid for the year 2018.

0	ISSUED FOR TENDER	2018.09.21	RG	DC
B	ISSUED FOR REVIEW	2018.08.14	RG	DC
A	ISSUED FOR REVIEW	2018.07.13	RG	DC
no. no.	revision revision	date date	by par	approved approve

Project - projet  
**POINT VERDE FIBERGLASS ENCLOSURE**  
 Drawing - dessin  
**ELECTRICAL SPECIFICATIONS AND DEMOLITION PLANS**  
 drawn - dessiné: **R. GREEN** designed - dessiné par: **D. COLE**  
 date - date: **2018.05.21** checked - vérifié: **D. COLE**  
 scale - échelle: **AS SHOWN** approved - approuvé:  
 project no. - projet no.: **F6879-184006** drawing no. - no du dessin: **01M0101A005E01** sheet - feuille: **0**