

SMALL CRAFT HARBOURS
 CENTRAL AND ARCTIC REGION

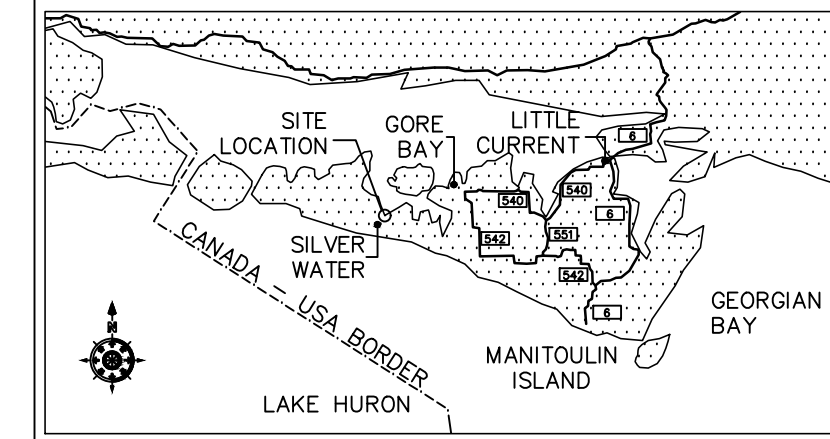

- NOTES:
1. ALL SOUNDINGS ARE SHOWN IN METERS BELOW CHART DATUM.
 2. SURVEY POINTS ARE UPDATED AS OF JUNE 13 2018
 3. CHART DATUM FOR GEORGIAN BAY IS 176.0m ABOVE SEA LEVEL.
 4. WATER LEVEL AT THE TIME OF SURVEY WAS 0.85 ABOVE CHART DATUM (ON SITE)
 5. COORDINATES FOR HORIZONTAL CONTROL ARE GIVEN ON THE U.T.M. MAPPING PLANE, ZONE 17, USING THE NORTH AMERICAN DATUM OF 1983 (NAD83)
 6. CONTROL POINT (NAIL) LOCATED ON SPAN 2 OF WHARF:
 -EASTING: 360380.1950
 -NORTHING: 5082359.4090
 -ELEVATION: 177.410



LEGEND

- SITE CONTROL POINT
- EXISTING FEDERAL PROPERTY LIMITS
- LIMITS OF REPAIRS
- FAILED SECTION OF STRUCTURE

REVISIONS:

NO.	DESCRIPTION

SCALE:	CLASS:
VARIES	

PROJECT:
APPROACH AND STONE RETEMENT REPAIRS

DESCRIPTION:
 EXISTING SITE AND STRUCTURE CONDITIONS

DRAWN:	APPROVED:
SCH	SCH

DATE:	DATE:
NOV 2018	NOV 2018

LOCATION:
 SILVER WATER, ONTARIO

DRAWING NO.:	LOCATOR CODE:
MA-01	4816

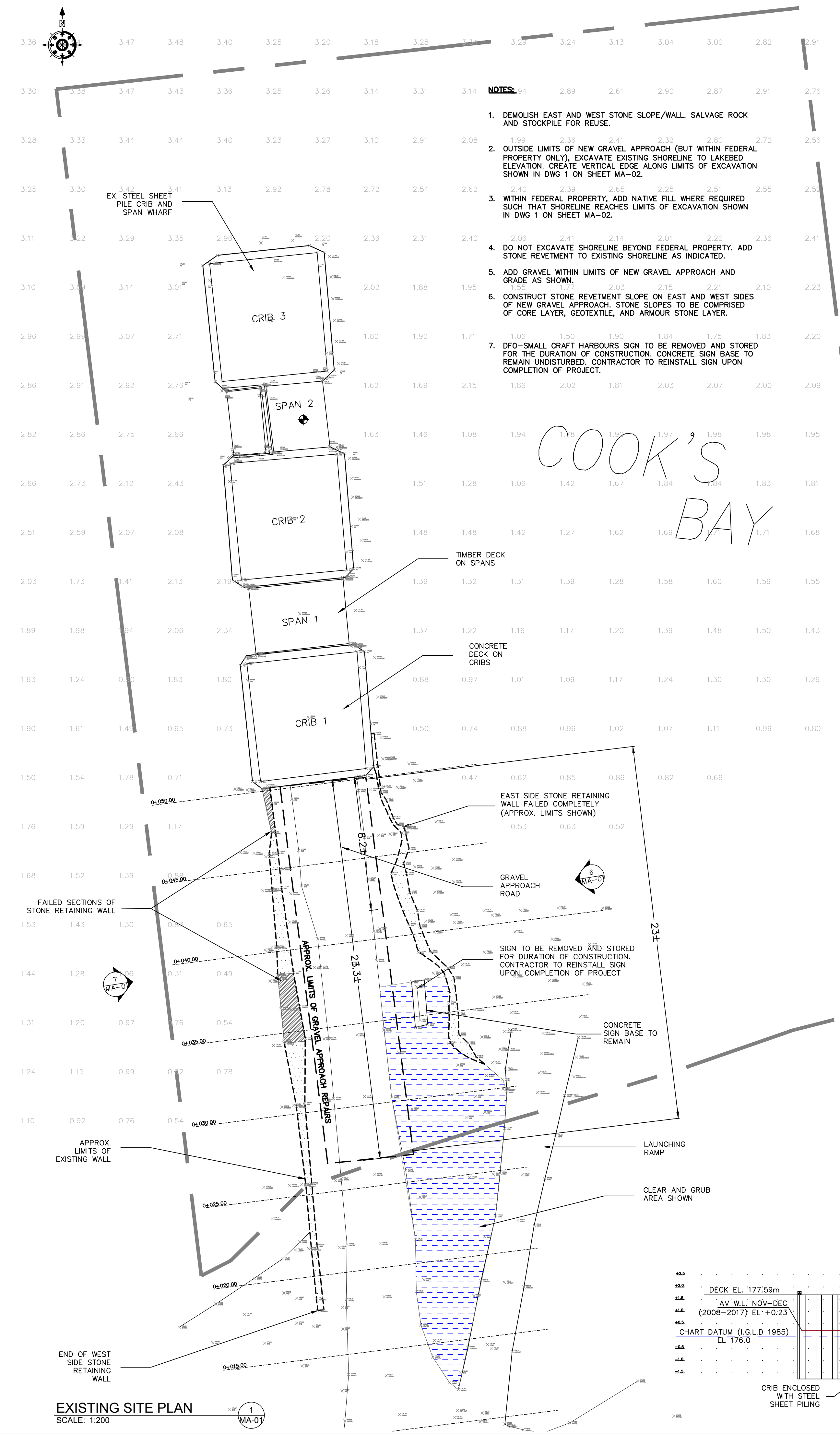
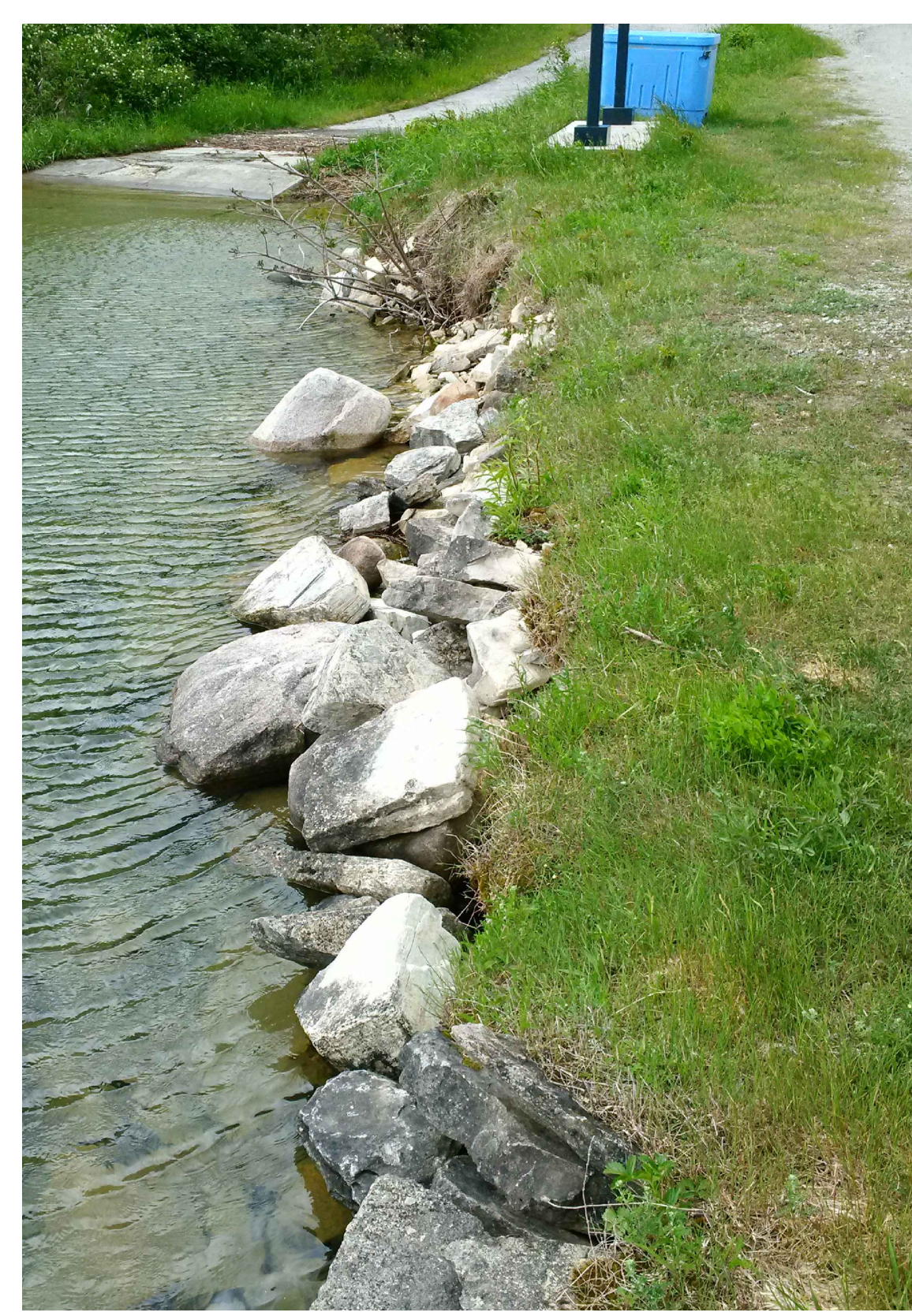

- NOTES:**
1. DEMOLISH EAST AND WEST SLOPE/WALL. SALVAGE ROCK AND STOCKPILE FOR REUSE.
 2. OUTSIDE LIMITS OF NEW GRAVEL APPROACH (BUT WITHIN FEDERAL PROPERTY ONLY), EXCAVATE EXISTING SHORELINE TO LAKEBED ELEVATION. CREATE VERTICAL EDGE ALONG LIMITS OF EXCAVATION SHOWN IN DWG 1 ON SHEET MA-02.
 3. WITHIN FEDERAL PROPERTY, ADD NATIVE FILL WHERE REQUIRED SUCH THAT SHORELINE REACHES LIMITS OF EXCAVATION SHOWN IN DWG 1 ON SHEET MA-02.
 4. DO NOT EXCAVATE SHORELINE BEYOND FEDERAL PROPERTY. ADD STONE RETEMENT TO EXISTING SHORELINE AS INDICATED.
 5. ADD GRAVEL WITHIN LIMITS OF NEW GRAVEL APPROACH AND GRADE AS SHOWN.
 6. CONSTRUCT STONE RETEMENT SLOPE ON EAST AND WEST SIDES OF NEW GRAVEL APPROACH. STONE SLOPES TO BE COMPRISED OF CORE LAYER, GEOTEXTILE, AND ARMOUR STONE LAYER.
 7. DFO-SMALL CRAFT HARBOURS SIGN TO BE REMOVED AND STORED FOR THE DURATION OF CONSTRUCTION. CONCRETE SIGN BASE TO REMAIN UNDISTURBED. CONTRACTOR TO REINSTALL SIGN UPON COMPLETION OF PROJECT.

COOK'S BAY

FAILED SECTIONS OF WEST STONE WALL
 SCALE: NTS

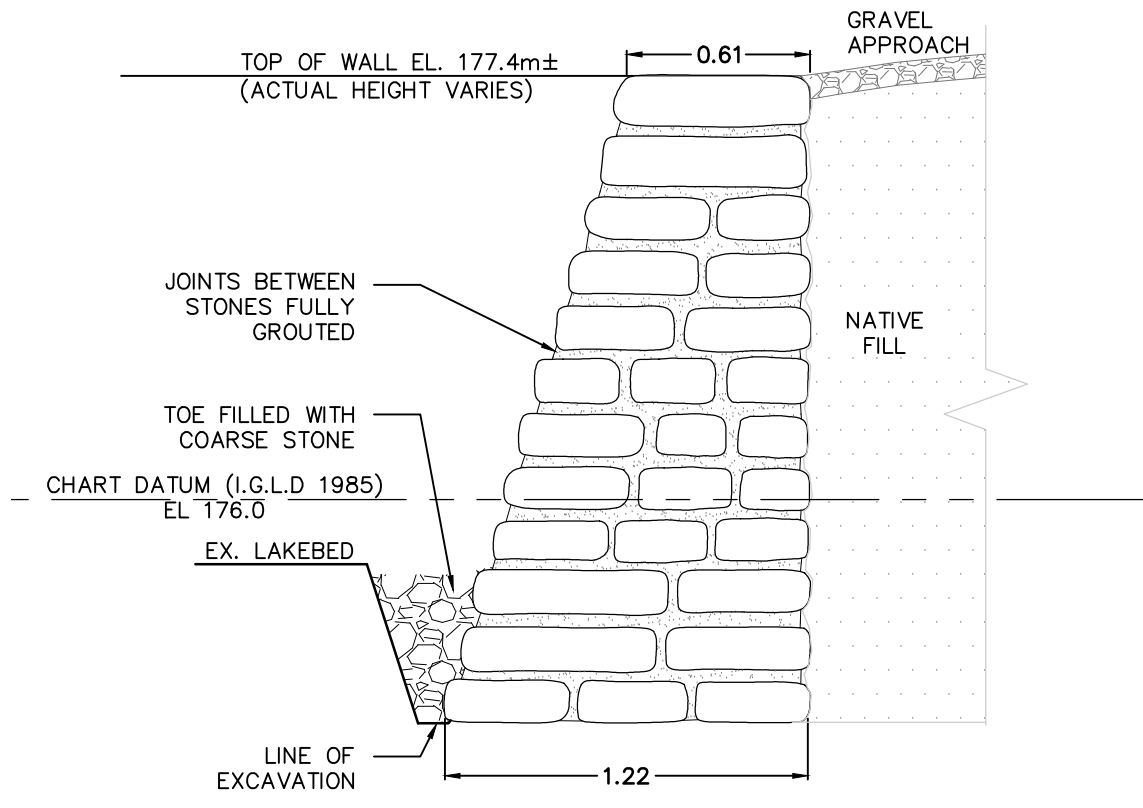

EX. WEST RETAINING WALL SECTION
 SCALE: 1:25

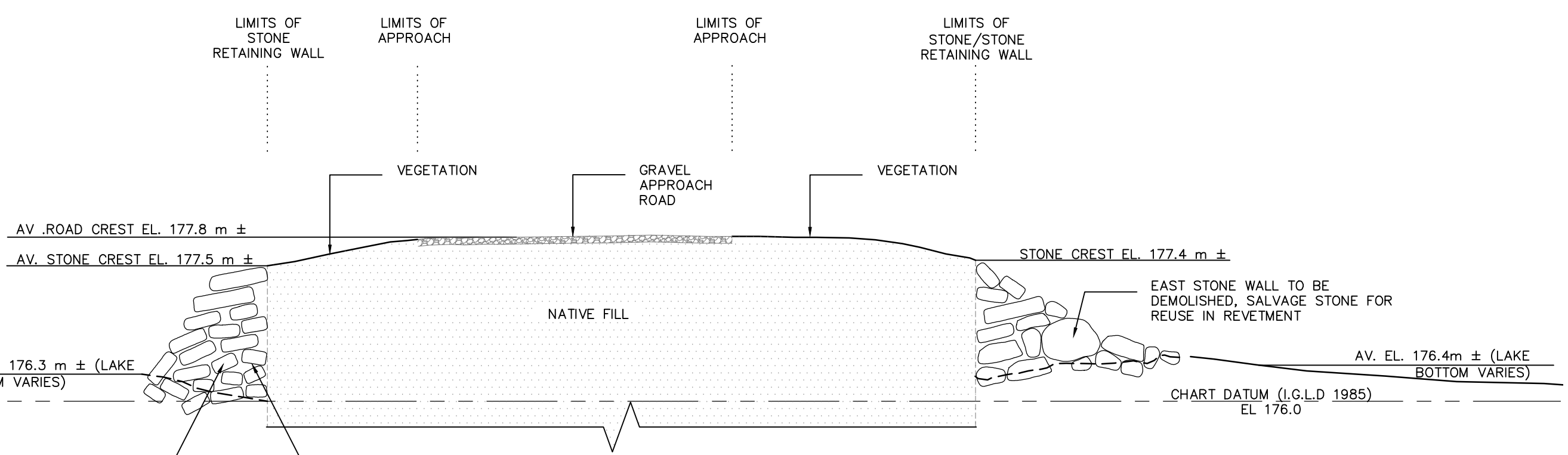

TYP. EXISTING APPROACH SECTION
 SCALE: 1:50

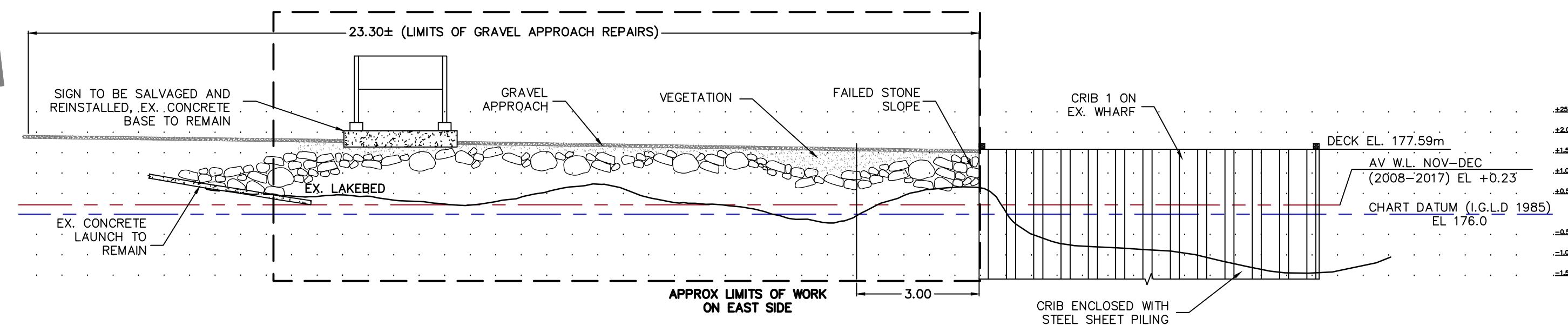

EAST STONE SLOPE ELEVATION
 SCALE: 1:100

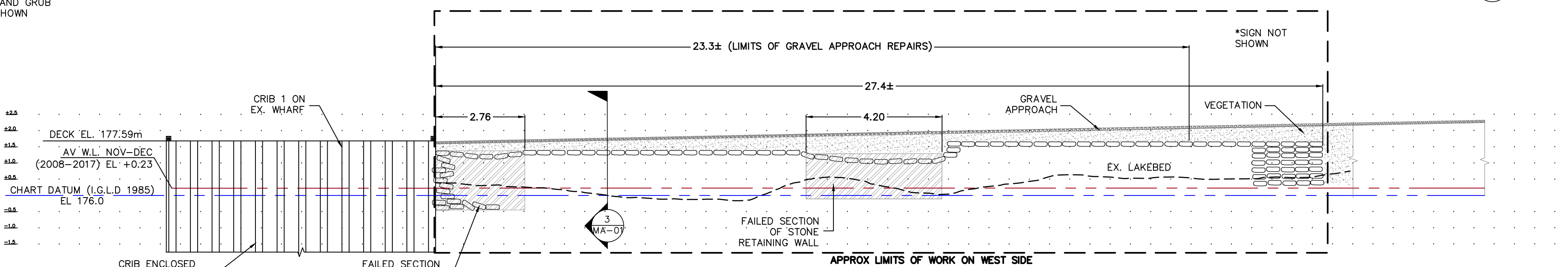

WEST STONE RETAINING WALL ELEVATION
 SCALE: 1:100