

EXISTING PLAN VIEW OF PILE LAYOUT
N.T.S.

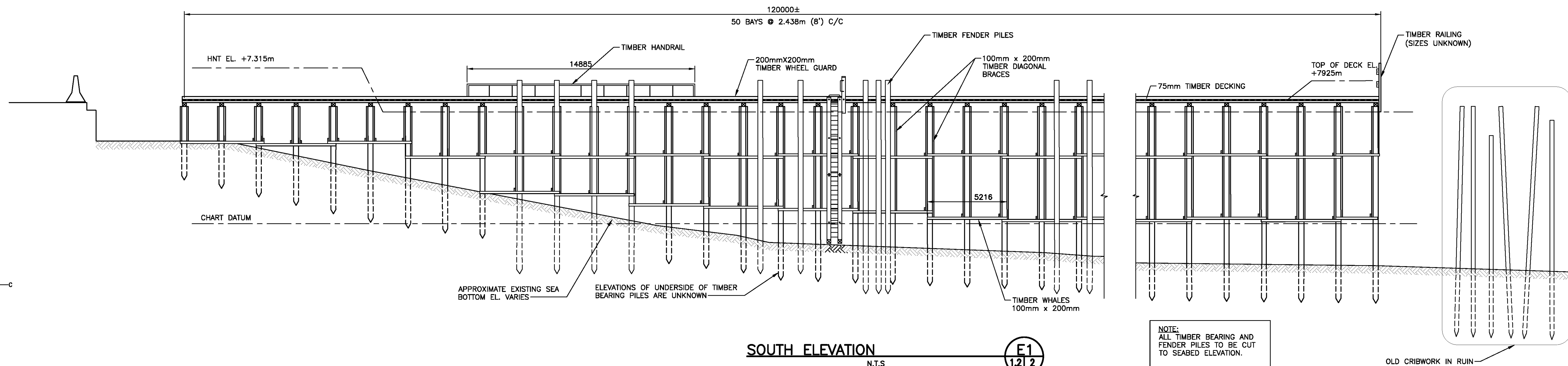

SOUTH ELEVATION
N.T.S.

NOTE:
ALL TIMBER BEARING AND
FENDER PILES TO BE CUT
TO SEABED ELEVATION.

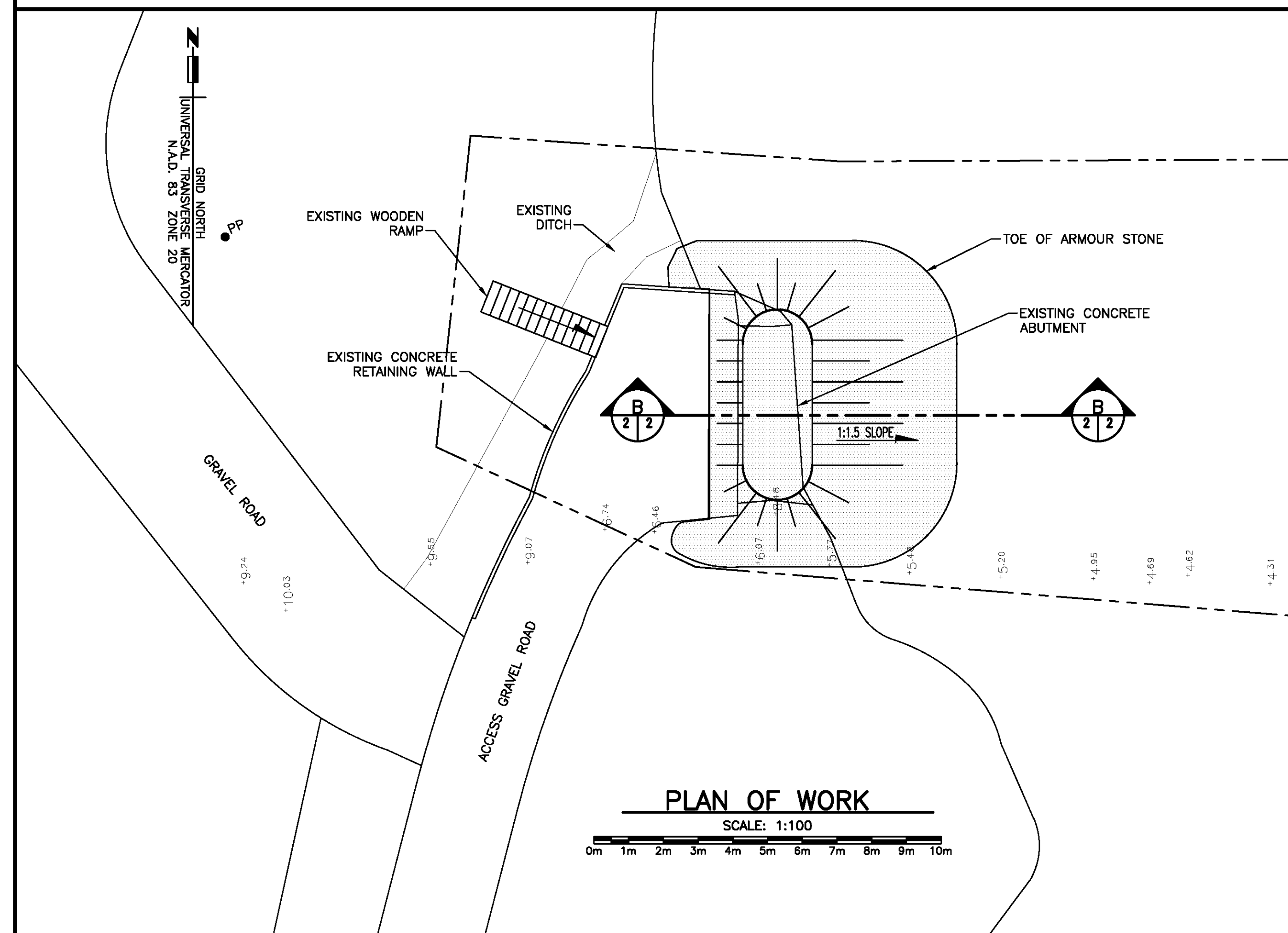

PLAN OF WORK
SCALE: 1:100

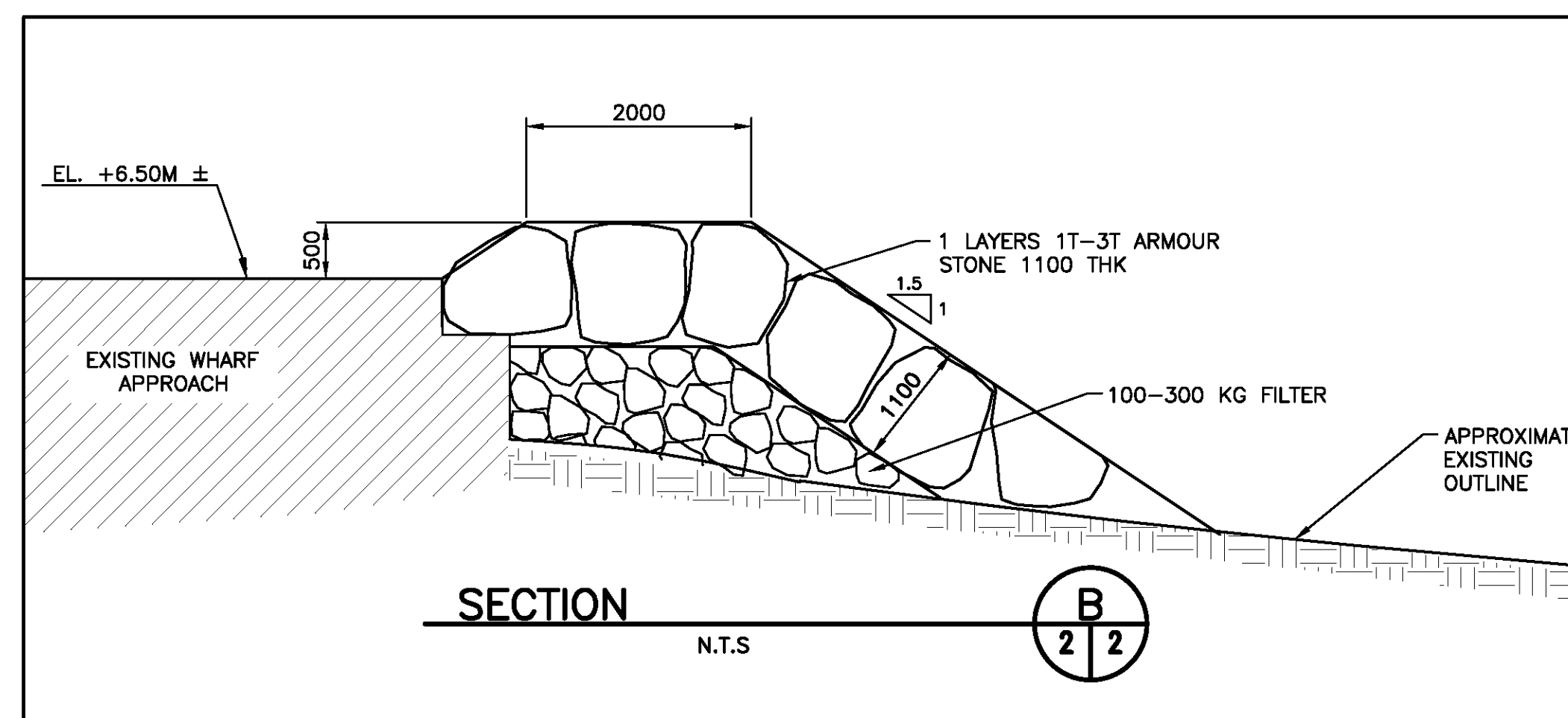

SECTION
N.T.S.

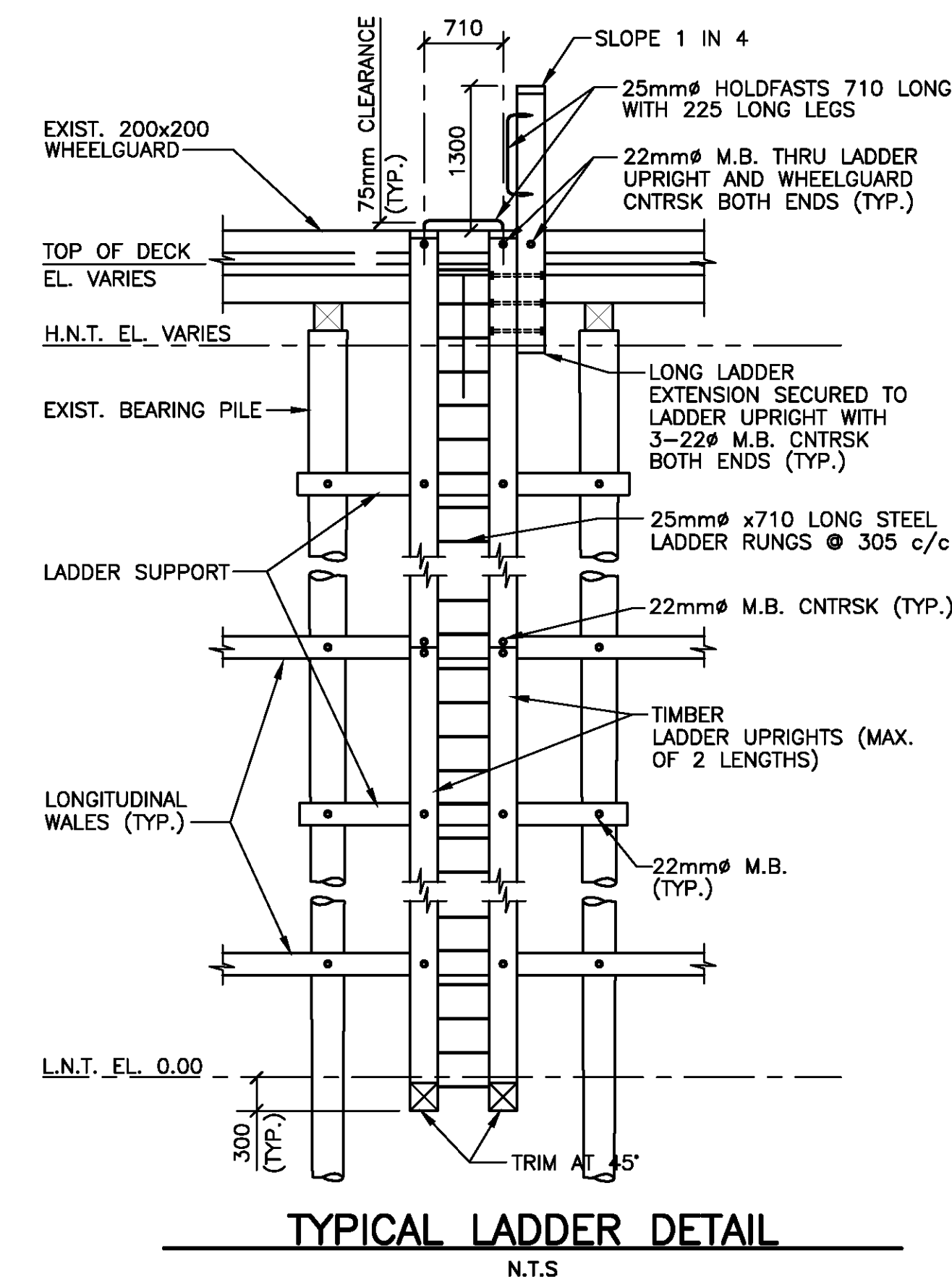

TYPICAL LADDER DETAIL
N.T.S.

1	ISSUED FOR TENDER	DEC 04 2018
revisions		date
project	WHARF REMOVAL AND DISPOSAL	
project	CHOCOLATE COVE DEER ISLAND, NB	
drawing	PLAN, ELEVATION, AND SECTION	
desain		
designed	PWGSC	conçu
date	SEPTEMBER 2018	
drawn	G. ALLAIN	dessiné
date	NOVEMBER 26, 2018	
approved		approuvé
date		
Tender		Soumission
PWGSC Project Manager	Administrateur de projets TPSC	
project number	R.101030.001	
no. du projet		
drawing no.	M2 of M2	
no. du dessin		