

ACRONYMS:
Seated Privacy height (SPH)
Worksurface Privacy Height (WSPH)
Base Height (BH)

FLOOR PLAN LEGEND

BF BASE FEED

PP POWER POLE

DP DUPLEX POWER OUTLET

DO DATA OUTLET

PANEL MATRIX

Panel 1A-1: Element 1: accessory rail		Element 2: accessory rail	Panel 1A-2: Element 1: accessory rail		Element 2: accessory rail	Panel 1A-3: Element 1: fabric		Element 2: fabric	Panel 1A-4: Element 1: fabric		Element 2: fabric							
SPH:		Cut outs for power & Data Fabric	SPH:		Cut outs for power & Data Fabric	SPH:		Cut outs for power & Data Fabric	SPH:		Cut outs for power & Data Fabric							
BH:		610	610	BH:		1219	1219	BH:		610	610	BH:		1219	1219			
Panel 1A-5: Element 1: fabric		Element 2: fabric	Panel 1A-6: Element 1: fabric		Element 2: fabric													
WSPH:		Cut outs for power & Data Fabric	WSPH:		Cut outs for power & Data Fabric													
BH:		1067	1067	BH:		1067	1067											

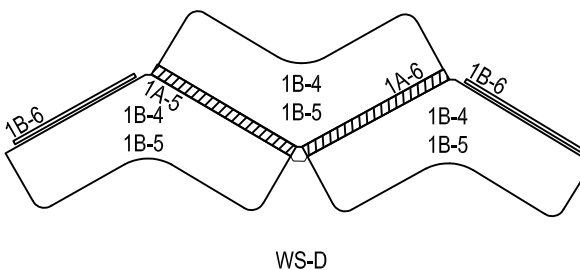
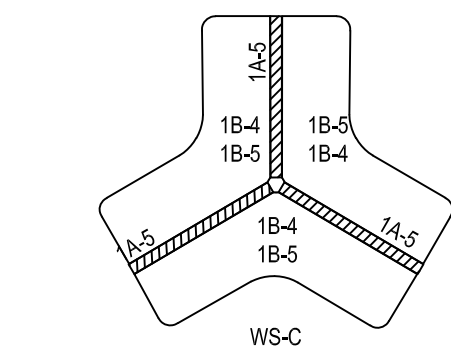
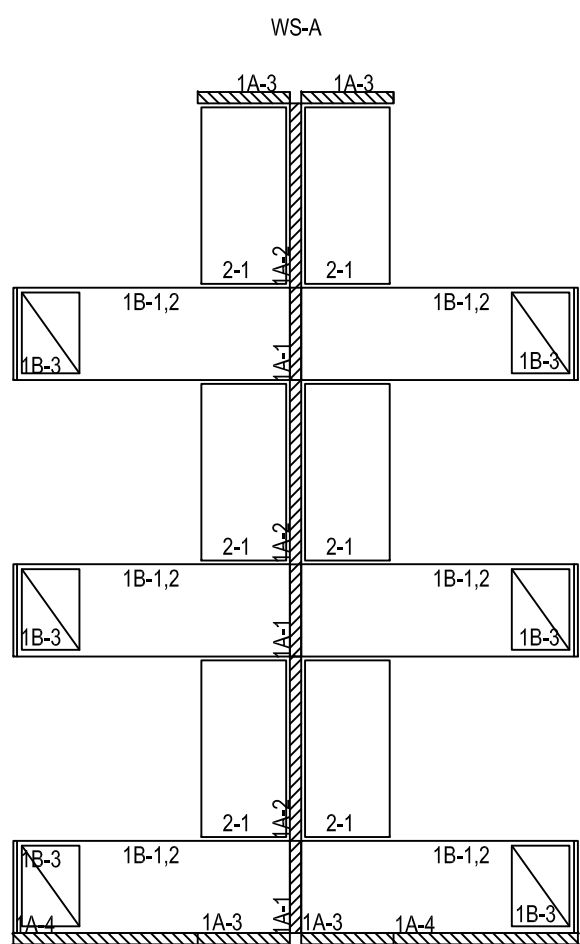

Panel 1A-1:
Seated privacy height add-on
Powered below the worksurface
Lower element 1 (inside): Cut outs for power & Data Fabric
Lower element 2 (outside): Cut outs for power & Data Fabric
Upper element 1 (inside): accessory rail
Upper element 2 (outside): accessory rail
Width: 610mm

Panel 1A-2:
Seated privacy height add-on
Powered: powered outlets below the worksurface
Lower element 1 (inside): Cut outs for power & Data Fabric
Lower element 2 (outside): Cut outs for power & Data Fabric
Upper element 1 (inside): accessory rail
Upper element 2 (outside): accessory rail
Width: 1219mm
NOTE: Power connected to a panel type 1A-2

Panel 1A-3:
Seated privacy height add-on
non-powered
Lower element 1 (inside): Fabric
Lower element 2 (outside): Fabric
Upper element 1 (inside): Fabric
Upper element 2 (outside): Fabric
Width: 610mm

Panel 1A-4:
Seated privacy height add-on
non-powered
Lower element 1 (inside): Fabric
Lower element 2 (outside): Fabric
Upper element 1 (inside): Fabric
Upper element 2 (outside): Fabric
Width: 1219mm

Panel 1A-5:
Worksurface privacy height add on
Powered: powered outlets above the worksurface
Lower element 1 (inside): Cut outs for power & Data Fabric
Lower element 2 (outside): fabric
Upper element 1 (inside): fabric
Upper element 2 (outside): fabric
Width: 1067mm

Worksurface 1B-1:
Nil
Panel mounted
High pressure laminate
Rectangular
Width: 72, Depth: 24
Worksurface Support 1B-2:
Gable end
High pressure laminate
Rectangular
Depth: 24
Storage Product 1B-3:
Pedestal, Freestanding
Laminate
Box, 18e
Depth: 22
Worksurface 2-1:
Sit-stand range height adjustable worksurface
gilles
Electrically assisted
1219mm x 610 (mm)

Worksurface 1B-5:
Panel mounted
High pressure laminate
120 degree
1067mm x 1067mm x 610 mm
Worksurface support 1B-4:
Post leg
metal

Panel 1A-6:
Worksurface privacy height add on
Powered: powered outlets above the worksurface
Lower element 1 (inside): Cut outs for power & Data Fabric
Lower element 2 (outside): fabric
Upper element 1 (inside): fabric
Upper element 2 (outside): fabric
Width: 1067mm

Panel 1A-8:
Worksurface privacy height add on
Powered: powered outlets above the worksurface
Lower element 1 (inside): Cut outs for power & Data Fabric
Lower element 2 (outside): Cut outs for power & Data Fabric
Upper element 1 (inside): fabric
Upper element 2 (outside): fabric
Width: 1067mm

Worksurface 1B-5:
Panel mounted
High pressure laminate
120 degree
1067mm x 1067mm x 610 mm
Worksurface support 1B-4:
Post leg
metal

Accessories 1B-6:
Privacy Screen
Work surface mounted
Fabric
Rectangular
Height: 22
Width: 36

Public Services and Procurement Canada

Services publics et Approvisionnement Canada

Contractor to verify all dimensions & conditions on site and immediately notify the departmental representative of all discrepancies.

03	REVIEW	1 AU 2018
02	PSPC PROCUREMENT - REVIEW	28 JN 2018
01	99% review	15 JN 2018

revisions	description	date
A	A detail no. no. du detail	
B	B location drawing no. sur dessin no.	
C	C drawing no. dessin no.	

project

1611 (RUE) MAIN ST.
VANCOUVER, B.C.
ABW SHOWCASE
ESPACE POUR
DEMONSTRATION MTA

project

drawing

CATEGORIES 1A, 1B, 2
CATÉGORIES 1A, 1B, 2

dessin

Designed By	Lindsay Peace	Conçu par	
Date		Nov 2018	
Drawn By	Lindsay Peace	Dessiné par	
Date		Nov 2018	
Reviewed By	Lindsay Peace	Examiné par	
Date		Nov 2018	
Approved By		Approuvé par	
Date		(yyyy/mm/dd)	
Tender		Soumission	
Project Manager	Administrateur de projets	No. du projet	
Project no.	R.094914.001		
Drawing no.	10	No. du dessin	