



RETURN BIDS TO:

RETOURNER LES SOUMISSIONS Á:

**Parks Canada Agency  
National Contracting Service  
Bid Receiving Unit  
111 Water St. East  
Cornwall ON K6H 6S2**

**AMENDMENT No.2**

INVITATION TO TENDER

APPEL D'OFFRES

**Tender To: Parks Canada Agency**

We hereby offer to sell to Her Majesty the Queen in right of Canada, in accordance with the terms and conditions set out herein, referred to herein or attached hereto, the goods, services, and construction listed herein and on any attached sheets at the price(s) set out therefor.

**Soumission aux: l'Agence Parcs Canada**

Nous offrons par la présente de vendre à Sa Majesté la Reine du Chef du Canada, aux conditions énoncées ou incluses par référence dans la présente at aux annexes ci-jointes, les biens, services et construction énumérés ici et sur toute feuille ci-annexée, au(x) prix indiqué(s).

Comments - Commentaries

Vendor/Firm Name and Address

Raison sociale et adresse du fournisseur/de l'entrepreneur

Issuing Office - Bureau de distribution

**Parks Canada Agency  
National Contracting Services  
111 Water St.  
Cornwall, ON K6H 6S2**

<b>Title-Sujet</b> Rocky Barachois Bridge Replacement – Gros Morne NP		
<b>Solicitation No. - No. de l'invitation</b> 5P201-18-0213/A		<b>Date:</b> January 29, 2019
<b>GETS Reference No. – No de reference de SEAG</b> PW-19-00859693		<b>Client Ref. No. – No. de réf du client.</b> 1845
<b>Solicitation Closes – L'invitation prend fin :</b>		
<b>at – à</b> 2:00 PM	<b>on – le</b> February 5, 2019	<b>Time Zone - Fuseau horaire</b> EST - HNE
<b>F.O.B. - F.A.B.</b>		
<b>Plant-Usine:</b> <input type="checkbox"/>	<b>Destination:</b> <input checked="" type="checkbox"/>	<b>Other-Autre:</b> <input type="checkbox"/>
<b>Address Inquiries to: - Adresser toute demande de renseignements à :</b>		
<b>Michel Marleau</b> michel.marleau@canada.ca		
<b>Telephone No. - No de téléphone</b> (613) 938-5822		<b>Fax No. – No de FAX:</b>
<b>Destination of Goods, Services, and Construction:</b> <b>Destinations des biens, services et construction:</b>		
See Herein – Voir aux présentes		

**TO BE COMPLETED BY THE BIDDER (type or print)  
À ÊTRE COMPLÉTER PAR LE SOUMISSIONNAIRE (taper ou écrire en caractères d'imprimerie)**

<b>Vendor/Firm Name – Nom du fournisseur/de l'entrepreneur</b>	
<b>Address - Adresse</b>	
<b>Name of person authorized to sign on behalf of the Vendor/Firm Nom de la personne autorisée à signer au nom du fournisseur/ de l'entrepreneur</b>	
<b>Titale - Titre</b>	
<b>Telephone No. - N° de téléphone:</b> _____	
<b>Facsimile No. - N° de télécopieur:</b> _____	
<b>Signature</b>	<b>Date</b>

## **AMENDMENT No.2**

### **THE PURPOSE OF THIS AMENDMENT IS TO GIVE EFFECT TO THE FOLLOWING CHANGE;**

1 – Annex 1 “Combined Price Form” of the Invitation to Tender is to be deleted and replaced by:

*(The new Price Table is attached to the end of this amendment)*

2 – Item 11 “Borrow (Rock)” from Section 01 29 10 “Measurement and Payment” of the Specifications is to be deleted and replaced by:

- 11. Borrow (Rock)
  - .1 Unit of Measurement is Tonne (t)
  - .2 This item includes supply, loading, transportation, placement and compacting of approved borrow material from areas off site, required for construction of embankments or for other portions of work, to lines and elevations indicated.

3 – Item 44 “Armour Rip Rap (Place Only)” from Section 01 29 10 “Measurement and Payment of the Specifications is to be deleted and replaced by:

- 44. Armour Rip Rap (Place Only)
  - .1 Unit of Measurement is Cubic Meter (m<sup>3</sup>)
  - .2 This item includes placement where indicated and as directed by the Departmental Representative. Supply of material for placement under this item is available to Contractor on-site. This item also includes the supply and installation of geotextile material beneath the armour rip rap. Measurement shall be based on Contract Drawings.

4 – Revisions to multiple Drawings. The following drawings are to be deleted and replaced by:

REMOVE and REPLACE:

Drawing S1 - General Arrangement Sheet 1 of 2, Revision 1, Issued for Addendum, 01/24/2019.

REMOVE and REPLACE:

Drawing S7 – Box Girder Layout Plan and Sections, Revision 1, Issued for Addendum, 01/24/2019.

REMOVE and REPLACE:

Drawing S17 - Bridge Excavation and Fill Quantities, Revision 1, Issued for Addendum, 01/24/2019.

*(The new Drawings are attached to the end of this amendment)*

5 - You will find below Questions and Answers # 1 to # 3

Q1. Request that a ‘dimple type coupler’ be considered as an approved joint type for the corrugated steel pipe in this tender under Section 33 42 13, Sub-Section 2.2.2.

The dimple type coupler, like the annular coupler is 600mm in width and extends 360 degrees around the pipe and

fastens with bolts. The “Dimple Type Coupler” is widely accepted and commonly used in all major highway systems in Newfoundland and Labrador.

A1. Dimple coupler is an accepted alternative.

.....

Q2. In drawings S7, on the Girder layout plan, the bottom plate of Girder No. 2, South Side is shown at 25mm thick, while on section B at the bottom of the page it is shown at 20mm thick, could you confirm the thickness of the bottom plate?

A2. See attached drawing S7 with revision 1 noted to correct steel thickness.

.....

Q3. Do we have the option of using other acceptable products other than those listed on the NEPCOAT A list because there is only one system listed?

A3. Each product must be listed as a qualified product by NEPCOAT.

.....

**ALL OTHER TERMS AND CONDITIONS REMAIN UNCHANGED.**

## APPENDIX 1 - COMBINED PRICE FORM (REVISED 29/01/2019)

- 1) The prices per unit shall govern in establishing the Total Extended Amount. Any arithmetical errors in this Appendix will be corrected by Canada.
- 2) Canada may reject the bid if any of the prices submitted do not reasonably reflect the cost of performing the part of the work to which that price applies.

### LUMP SUM TABLE

The Total Lump Sum Amount designates Work to which a Lump Sum Arrangement applies. Bidders are reminded that it is their responsibility to include in their bid all work as described in the drawings and specifications. Pricing for work not accounted for in the Unit Price Table is to be included in the Lump Sum Amount.

Item	Specification Reference	Class of Labour, Plant or Material	Unit of Measurement	Estimated Total Price HST Extra
1	01 25 20	Mobilization / Demobilization	Lump Sum	
2	01 52 00	Construction Facilities	Lump Sum	
3	02 41 16	Structure Demolition	Lump Sum	
4	03 20 00	Concrete Reinforcing Galvanized	Lump Sum	
5	05 12 33	Structural Steel for Bridges	Lump Sum	
6	07 19 10	Concrete Coating	Lump Sum	
7	31 23 33.02	Foundation Excavation Bridge	Lump Sum	
8	31 62 16.13	Temporary Retaining Walls	Lump Sum	
9	32 17 23	Painted Traffic Lines and Markings	Lump Sum	
10		Other Items Not Included in the Unit Price Table	Lump Sum	
<b>TOTAL LUMP SUM AMOUNT (LSA)</b>				
Excluding applicable tax(es)				

### UNIT PRICE TABLE

- 1) The unit price table designates the Work to which a Unit Price Arrangement applies
  - (a) The Price per Unit and the Price must be entered for each Item Listed
  - (b) Work included in each item is as described in the referenced specification section

Item	Specification Reference	Class of Labour, Plant or Material	Unit of Measurement	Estimated Quantity	Price/Unit HST Extra	Estimated Total Price HST Extra
1	03 30 00	Cast-in-Place Reinforced Concrete	m <sup>3</sup>	437		
2	05 50 00	Galvanized Armour Angles	Each	2		
3	05 50 00	Galvanized Membrane Drains	Each	2		
4	07 15 00	Bridge Deck Waterproofing	m <sup>2</sup>	612		
5	07 92 00	Concrete Joint Sealant	m	49		
6	07 95 10	Expansion Joint System	m	42		
7	31 11 00	Clearing	ha	0.4		
8	31 11 00	Grubbing	ha	0.4		
9	31 22 13	Rough Grading	m <sup>2</sup>	3,400		
10	31 24 13	Unclassified Excavation Roadway and Drainage	m <sup>3</sup>	7,000		
11	31 24 13	Borrow (Rock)	t	20,400		
12	31 24 14	Fill Against Structure	t	6,000		

File Name - Nom du dossier : Rocky Barachois Bridge Replacement – Gros Morne NP

Item	Specification Reference	Class of Labour, Plant or Material	Unit of Measurement	Estimated Quantity	Price/Unit HST Extra	Estimated Total Price HST Extra
13	31 37 00	Armour Rip Rap	m <sup>3</sup>	1,100		
14	31 37 20	Clear Stone	t	400		
15	31 62 16.16	Steel Pipe Piles – Supply	m	445		
16	31 62 16.16	Steel Pipe Piles - Install	m	445		
17	32 01 16	Asphalt Removal	m <sup>2</sup>	7,100		
18	32 11 16.01	Granular Sub-Base (Granular B)	t	7,000		
19	32 11 23	Aggregate Base Course (Granular A)	t	3,000		
20	32 12 16	Asphalt Mix Type: Base Course	t	1,450		
21	32 12 16	Asphalt Mix Type: Surface Course	t	1,350		
22	32 92 19.16	Hydraulic Seeding	m <sup>2</sup>	13,500		
23	32 92 19.17	Dry Mulch	m <sup>2</sup>	13,500		
24	33 42 13	CSP – 600 mm diameter	m	6		
25	33 42 13	HDPE Pipe – 600 mm diameter	m	14		
26	34 71 13.25	Steel W-Beam Guide Rail - Bridge Approach	m	64		
27	34 71 13.25	Steel W-Beam Guide Rail	m	580		
28	34 71 13.25	Steel W-Beam Guide Rail Remove	m	400		
29	34 71 15	Galvanized Steel Barrier and Metal Railings for Structures	m	111.7		
30	34 80 00	Sign and Signpost Relocation, Type C-ID-3 (Rocky Barachois)	Each	2		
31	34 80 00	Sign and Signpost Relocation, Type RA-1	Each	1		
32	34 80 00	Sign and Signpost Installation, Type A-WA 36 (Marker Signs)	Each	4		
33	34 80 00	Sign and Signpost Relocation, Type WA-3L w/50 km/hr WA-7S	Each	1		
34	34 80 00	Sign and Signpost Installation, Type WC-8L w/WA-30S	Each	1		
35	34 80 00	Sign and Signpost Relocation, Type WC-8R w/WA-30S	Each	1		
36	34 80 00	Sign and Signpost Installation, WC23 w/WC-23T	Each	2		
37	34 80 00	Sign and Signpost Relocation, RB-87	Each	2		
38	34 80 00	Sign and Signpost Relocation, Hydro	Each	2		
39	34 80 00	Sign and Signpost Removal, WA-3L	Each	1		
40	34 80 00	Sign and Signpost Removal, WA-3R	Each	1		
41	32 93 10	Landscape Treatment 1	m <sup>2</sup>	2,300		
42	32 93 10	Landscape Treatment 2	m <sup>2</sup>	1,500		
43	32 93 10	Landscape Treatment 3	m <sup>2</sup>	6,200		
44	31 37 00	Armour Rip Rap (Place Only)	m <sup>3</sup>	400		
<b>TOTAL EXTENDED AMOUNT (TEA)</b>						
Excluding applicable tax(es)						

<b>TOTAL BID AMOUNT (LSA + TEA)</b> Excluding applicable tax(es)
---

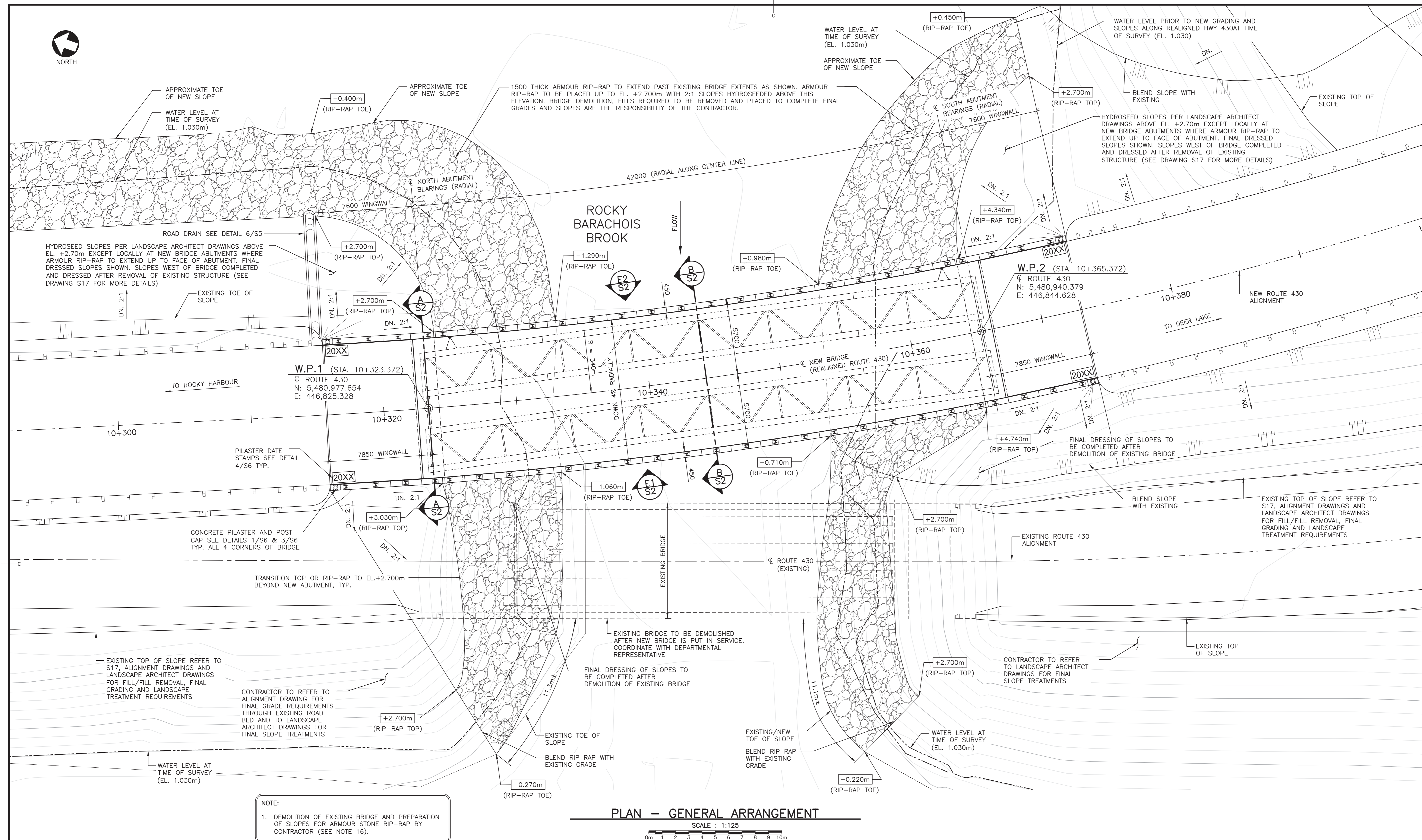

PLAN - GENERAL ARRANGEMENT

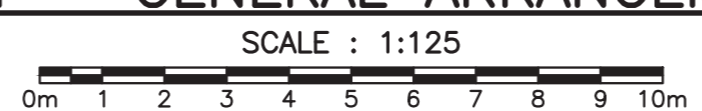

**NOTE:**  
1. DEMOLITION OF EXISTING BRIDGE AND PREPARATION OF SLOPES FOR ARMOUR STONE RIP-RAP BY CONTRACTOR (SEE NOTE 16).

**GENERAL NOTES:**

1. GENERAL REQUIREMENTS GOVERNING DESIGN, MATERIALS, AND CONSTRUCTION ARE AS FOLLOWS:
  - A) LOADING AND GENERAL DESIGN TO CAN/CSA - S6 - 14, WITH LATEST REVISIONS, LIVE LOAD CL-625.

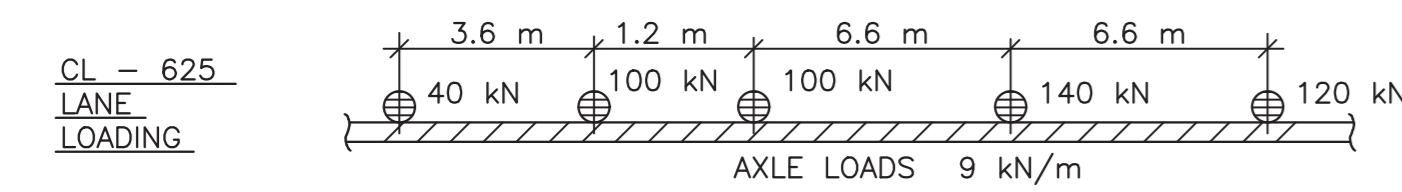
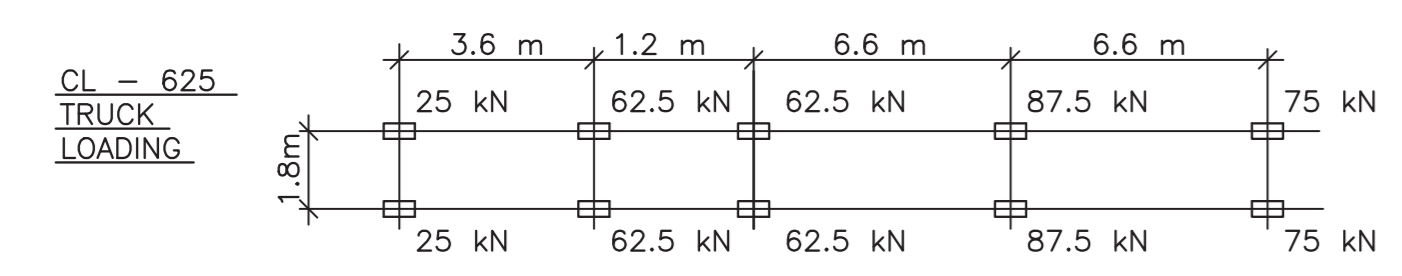

- B) CONCRETE MATERIALS AND METHODS OF CONSTRUCTION TO CAN/CSA-A23.1 AND METHODS OF TEST FOR CONCRETE TO CAN/CSA-A23.2.
- C) REFERENCE DRAWING S3 FOR CONCRETE AND REINFORCING NOTES.
- D) REFERENCE DRAWING S3 FOR PILE NOTES.
- E) REFERENCE DRAWING S7 FOR STRUCTURAL STEEL NOTES.
- F) REFERENCE DRAWING S15 FOR MISCELLANEOUS METALS NOTES.

- G) REFERENCE SPECIFICATIONS FOR FURTHER DETAILS/REQUIREMENTS SURROUNDING EXISTING BRIDGE REMOVAL AT END OF CONSTRUCTION.
- H) REFERENCE EP DRAWINGS FOR CONSTRUCTION PHASING. REFERENCE AG DRAWINGS FOR TEMPORARY FILL/EXCAVATION REQUIREMENTS AT EACH ABUTMENT FOR CONSTRUCTION. REFERENCE TW DRAWINGS FOR TEMPORARY RETAINING WALL AT NORTH ABUTMENT.
- I) REFERENCE DRAWING S17, ALIGNMENT DRAWINGS C1 TO C15 AND LANDSCAPE ARCHITECT DRAWINGS FOR FINAL FILL/FILL REMOVAL, FINAL GRADING AND LANDSCAPE TREATMENTS.
2. ALL DIMENSIONS SHOWN IN MILLIMETRES (mm) ALL ELEVATIONS IN METERS (m).
3. ALL STANDARDS AND SPECIFICATION NOTES TO REFLECT THE "LATEST EDITION" AT TIME OF TENDER.
4. FOUNDATION DESIGN BASED ON INFORMATION PROVIDED IN HARBORSIDE GEOTECHNICAL REPORT No.16354S, DATED AUG. 31, 2017.
5. ALIGNMENT INFORMATION AS PER HARBORSIDE TRANSPORTATION CONSULTANTS CIVIL DRAWINGS. SURVEY INFORMATION PROVIDED BY DESIGN POINT ENGINEERING AND SURVEYING. SURVEY REFERENCED HORIZONTALLY TO UTM ZONE 21 NORTH NAD83 (CSRS) AND VERTICALLY TO CGVD28 (HTV2.0 GEOID MODEL) CONTROL IS DERIVED FROM MULTIPLE STATIC GPS OBSERVATIONS ON NAIL 1000 HAVING CO-ORDINATES OF:  
N=5481239.613M  
E=446748.809M  
EL=9.53M.
6. ANY DISCREPANCIES BETWEEN DRAWINGS AND FIELD CONDITIONS SHALL BE BROUGHT TO THE ATTENTION OF THE DEPARTMENTAL REPRESENTATIVE PRIOR TO PROCEEDING WITH CONSTRUCTION.
7. REFERENCE CIVIL DRAWINGS FOR ROAD ALIGNMENT OVER BRIDGE STRUCTURE AND CONSTRUCTION HORIZONTALLY TO UTM ZONE 21 NORTH NAD83 (CSRS) AND VERTICALLY TO CGVD28 (HTV2.0 GEOID MODEL) CONTROL IS DERIVED FROM MULTIPLE STATIC GPS OBSERVATIONS ON NAIL 1000 HAVING CO-ORDINATES OF:  
N=5481239.613M  
E=446748.809M  
EL=9.53M.
8. CONSTRUCTION SHALL BE CARRIED OUT AS PER CAN/CSA-S6-14.
9. BRIDGE CLASSIFIED AS AN "EMERGENCY-ROUTE BRIDGE" FOR THE PURPOSE OF SEISMIC ANALYSIS AS PER CAN/CSA-S6-14.
10. BRIDGE BARRIERS AND ANCHORAGES CONFORM TO TL-4 CRASH TEST REQUIREMENTS AS PER CAN/CSA-S6-14.
11. BRIDGE QUANTITIES IN SPECIFICATIONS ARE BASED ON THE FOLLOWING EXTENTS:  
LONGITUDINALLY : MEASURED FROM END OF WINGWALL TO END OF WINGWALL  
TRANSVERSELY : MEASURED FROM TOE OF FINISHED SIDE SLOPE TO TOE OF FINISHED SIDE SLOPE
12. FULL WIDTH OF EXISTING STRUCTURE AND APPROACHES TO REMAIN IN-SERVICE (EXCEPT AS NOTED ON CONSTRUCTION PHASING DRAWINGS) UNTIL THE END OF CONSTRUCTION WHEN TRAFFIC DIVERTED ONTO THE NEW STRUCTURE (REFERENCE PROJECT SPECIFICATIONS).
13. CONTRACTOR TO PROVIDE EROSION AND SEDIMENTATION CONTROL PLAN TO THE DEPARTMENT REPRESENTATIVE AT THE START OF THE PROJECT FOR ALL PHASES OF WORK AND MAINTAIN CONTROLS THROUGHOUT CONSTRUCTION.
14. EACH PHASE OF WORK TO BE INSPECTED AND APPROVED BY DEPARTMENTAL REPRESENTATIVE PRIOR TO PROCEEDING TO NEXT PHASE OF WORK.
15. WATER ELEVATIONS INDICATED BASED ON DESIGN POINT FINAL HYDROLOGY REPORT No. 16-084 DATED MAY 9, 2018.
16. DEMOLITION OF EXISTING BRIDGE TO BE UNDERTAKEN AFTER TRAFFIC IS DIVERTED TO NEW STRUCTURE AND WRITTEN APPROVAL TO PROCEED IS PROVIDED BY DEPARTMENTAL REPRESENTATIVE. CONTRACTOR IS RESPONSIBLE FOR BRIDGE DEMOLITION DESIGN (REFER TO PROJECT SPECIFICATIONS FOR REQUIREMENTS). ALL EXISTING FOUNDATIONS TO BE REMOVED TO A MINIMUM 1000mm BELOW FINISHED GRADE. CONTRACTOR TO COORDINATE AND OBTAIN APPROVAL OF DEMOLITION PLAN FROM DEPARTMENTAL REPRESENTATIVE AND DFO PRIOR TO INITIATING DEMOLITION ACTIVITIES. CONTRACTOR ALSO RESPONSIBLE FOR EXCAVATION, BACKFILLING, AND SLOPE PREPARATION FOR ARMOUR RIP-RAP, FILLS AND HYDROSEEDING IN DEMOLITION AREA AS INDICATED ON DRAWING S1, S2 AND S17. REFERENCE PROJECT SPECIFICATIONS.

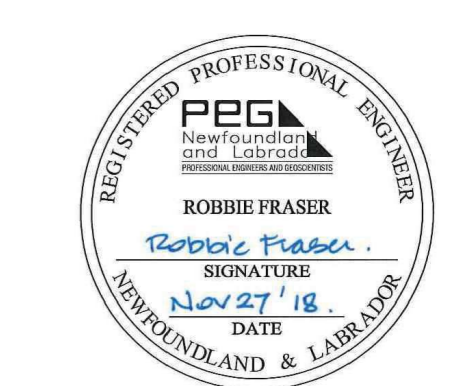

PROVINCE OF NEWFOUNDLAND AND LABRADOR  
EG PERMIT HOLDER  
This Permit Allows  
HARBORSIDE ENGINEERING CONSULTANTS  
To practice Professional Engineering in Newfoundland and Labrador. Permit No. as issued by PEG 30324 which is valid for the year 2018.

1	ISSUED FOR ADDENDUM	01/24/2019
0	ISSUED FOR TENDER	11/27/2018
revisions		date

project  
**ROCKY BARCHOIS BRIDGE ROUTE 430**

**GROS MORNE NATIONAL PARK**

drawing design

**GENERAL ARRANGEMENT SHEET 1 of 2**

designed SARAH HARDY	conçu
date JULY 2017	
drawn WAYNE MORROW	dessiné
date JULY 2017	
approved ROBBIE FRASER	approuvé
date	
Tender	Soumission
IPWSC Project Manager	Administrateur de projets IPWSC
project number	no. du projet
<b>1845</b>	
drawing no.	no. du dessin
<b>S1</b>	

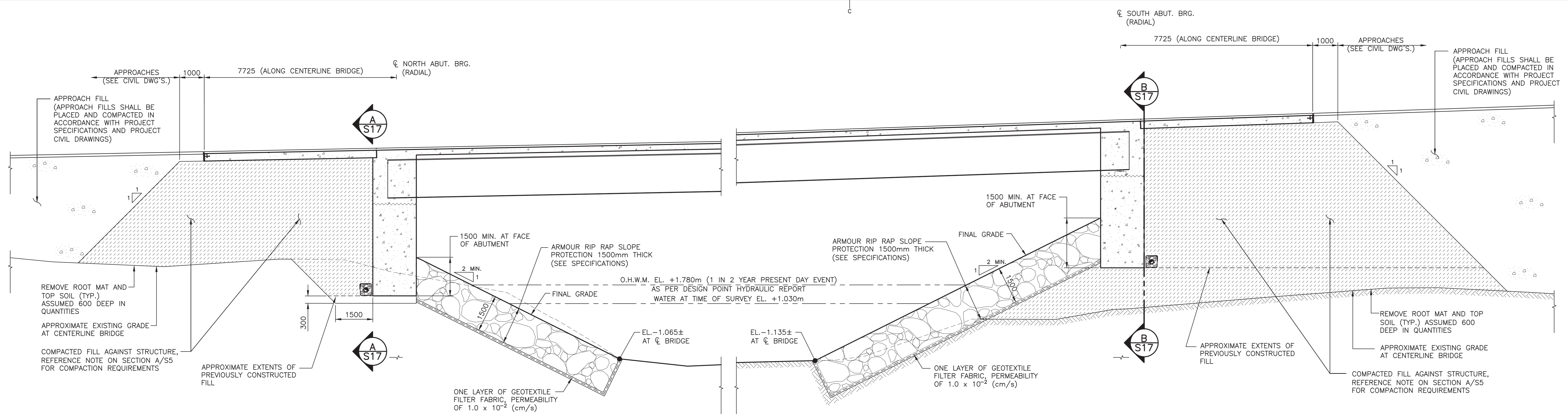

DETAIL - FILL AGAINST STRUCTURE/ RIP RAP DIAGRAMS 1 S1

SCALE : 1:75

NOTE:  
1. THIS DRAWING IS PROVIDED FOR ILLUSTRATIVE PURPOSES ONLY. SLOPES VARY, REFER TO DRAWING S1 AND S2 FOR MORE INFORMATION.

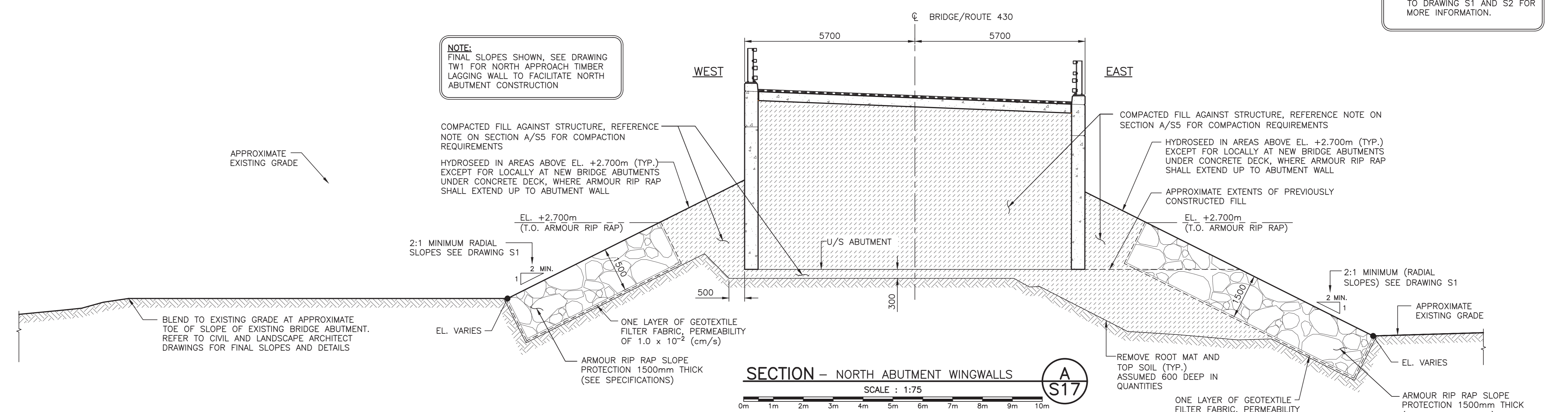

SECTION - NORTH ABUTMENT WINGWALLS A S17

SCALE : 1:75

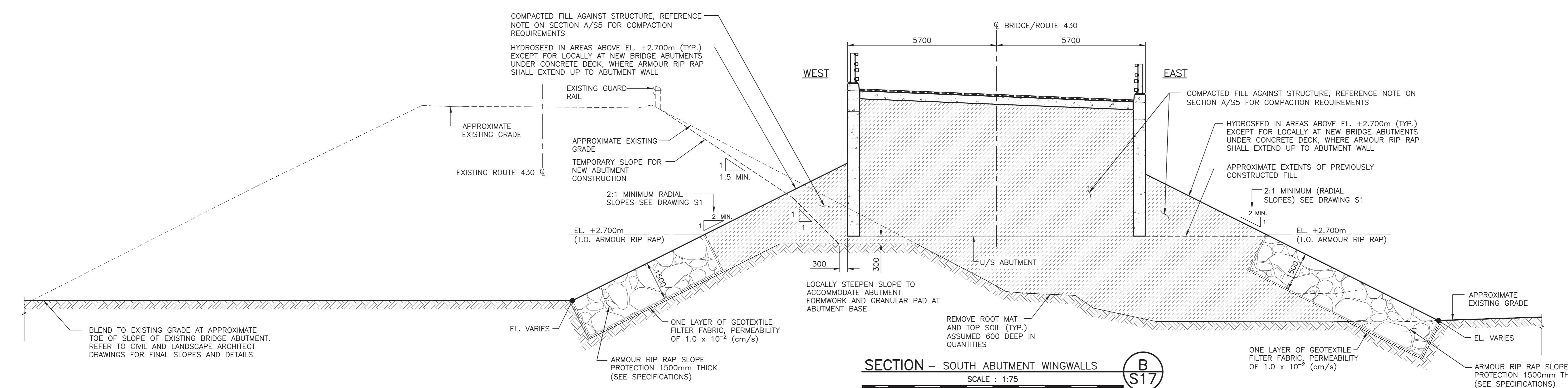

SECTION - SOUTH ABUTMENT WINGWALLS B S17

SCALE : 1:75

NOTE:  
FINAL SLOPES SHOWN, SEE DRAWING TW1 FOR NORTH APPROACH TIMBER LAGGING WALL TO FACILITATE NORTH ABUTMENT CONSTRUCTION

NOTE:  
COMPACTED FILL AGAINST STRUCTURE, REFERENCE NOTE ON SECTION A/S5 FOR COMPACTION REQUIREMENTS

NOTE:  
HYDROSEED IN AREAS ABOVE EL. +2.700m (TYP.) EXCEPT FOR LOCALLY AT NEW BRIDGE ABUTMENTS UNDER CONCRETE DECK, WHERE ARMOUR RIP RAP SHALL EXTEND UP TO ABUTMENT WALL

NOTE:  
COMPACTED FILL AGAINST STRUCTURE, REFERENCE NOTE ON SECTION A/S5 FOR COMPACTION REQUIREMENTS

NOTE:  
HYDROSEED IN AREAS ABOVE EL. +2.700m (TYP.) EXCEPT FOR LOCALLY AT NEW BRIDGE ABUTMENTS UNDER CONCRETE DECK, WHERE ARMOUR RIP RAP SHALL EXTEND UP TO ABUTMENT WALL

BLEND TO EXISTING GRADE AT APPROXIMATE TOE OF SLOPE OF EXISTING BRIDGE ABUTMENT. REFER TO CIVIL AND LANDSCAPE ARCHITECT DRAWINGS FOR FINAL SLOPES AND DETAILS

NOTE:  
COMPACTED FILL AGAINST STRUCTURE, REFERENCE NOTE ON SECTION A/S5 FOR COMPACTION REQUIREMENTS

NOTE:  
HYDROSEED IN AREAS ABOVE EL. +2.700m (TYP.) EXCEPT FOR LOCALLY AT NEW BRIDGE ABUTMENTS UNDER CONCRETE DECK, WHERE ARMOUR RIP RAP SHALL EXTEND UP TO ABUTMENT WALL

NOTE:  
COMPACTED FILL AGAINST STRUCTURE, REFERENCE NOTE ON SECTION A/S5 FOR COMPACTION REQUIREMENTS

NOTE:  
HYDROSEED IN AREAS ABOVE EL. +2.700m (TYP.) EXCEPT FOR LOCALLY AT NEW BRIDGE ABUTMENTS UNDER CONCRETE DECK, WHERE ARMOUR RIP RAP SHALL EXTEND UP TO ABUTMENT WALL

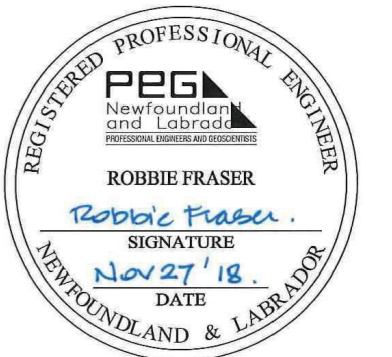

PROVINCE OF NEWFOUNDLAND AND LABRADOR  
EG PERMIT HOLDER  
Newfoundland and Labrador  
REGULATED UNDER THE ENGINEERS ACT  
HARBORSIDE ENGINEERING CONSULTANTS  
To practice Professional Engineering in Newfoundland and Labrador, Permit No. as issued by PEG 30324 which is valid for the year 2018.

1	ISSUED FOR ADDENDUM	01/24/2019
0	ISSUED FOR TENDER	11/27/2018
revisions		date

project  
**ROCKY BARACHOIS BRIDGE ROUTE 430**  
**GROS MORNE NATIONAL PARK**

drawing  
**BRIDGE EXCAVATION AND FILL QUANTITIES**  
design

designed	SARAH HARDY	conçu
date	MAY 2017	
drawn	WAYNE MORROW	dessiné
date	MAY 2017	
approved	ROBBIE FRASER	approuvé
date		
Tender		Soumission
PWSC Project Manager	Administrateur de projets TPSC	
project number	1845	no. du projet
drawing no.	S17	no. du dessin

