

CONSTRUCTION GROUND TYPES		LENGTH
0+000 to 0+210	ROCK BALLAST	210m
0+210 to 0+240	TOE ROCK	30m
0+240 to 0+335	ROCK BALLAST	95m
0+335 to 0+380	TOE ROCK	45m
0+380 to 0+405	ROCK BALLAST	25m
0+405 to 0+478	MEDIUM ROCK	73m
0+478 to 0+521	TOE ROCK	43m

ROAD DESIGN SPECIFICATIONS

K-VALUE: Minimum 2.0
 HORIZONTAL CURVES: 20m Radius U.N.O.
 ROAD WIDTH: 5.5m
 CAPPING DEPTH: 30cm
 CAPPING MATERIAL: Gravel or Rock <15cm dia., no fines or organics

designed - conception SANDY WHITE drawn - dessiné BRENDEN GANSNER CCG ref. no. - no. réf. GCC 8B200	date 2018-11-07	checked - vérifié CLINT HOFFMAN approved - approuvé CLINT HOFFMAN scale - échelle 1:750	date 2018-12-10			Asset - Actif CCG RADAR MAIN ACCESS ROAD FS1705 180136	Drawing - Dessin OPP RADAR PROJECT SEYMOUR NARROWS drawing no. - no. dessin WM XXX - 001	sheet-feuille 01/07	rev 1
--	--------------------	--	--------------------	--	--	--	--	------------------------	----------

1	ISSUED FOR REVIEW	CRH	2018-12-10
rev	description	by par	Date

1	
---	--

ROCK BALLAST

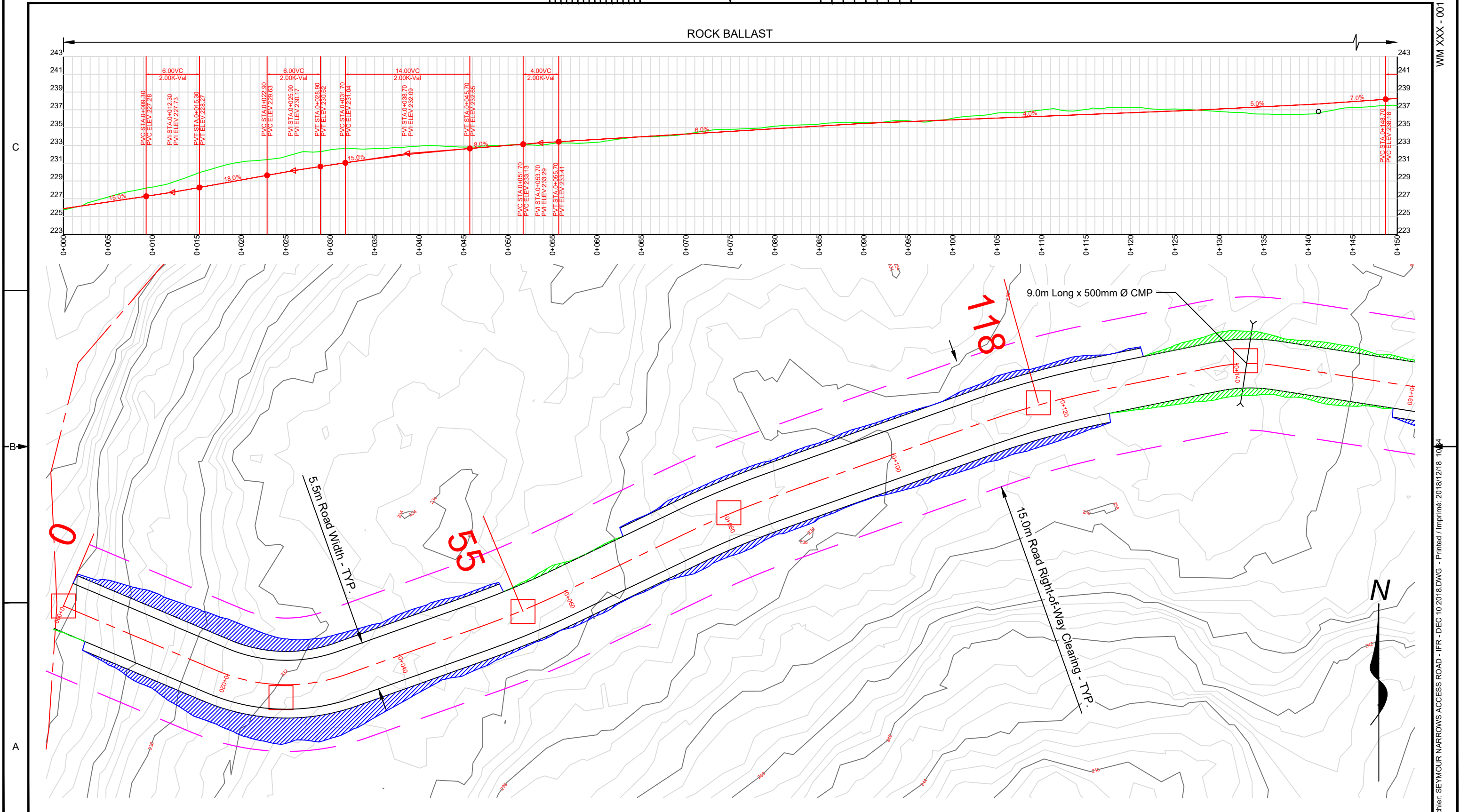

<p>Fisheries and Oceans Canada Canadian Coast Guard</p>	<p>Pêches et Océans Canada Garde côtière Canadienne</p>

designed - conception SANDY WHITE	date 2018-11-07	checked - vérifié CLINT HOFFMAN	date 2018-12-10
drawn - dessiné BRENDEN GANSNER	date 2018-11-07	approved - approuvé CLINT HOFFMAN	date TBD
CCG ref. no. - no. réf. GCC 8B200		scale - échelle 1:400	

Asset - Actif	CCG RADAR MAIN ACCESS ROAD
	FS1705 180136

Drawing - Dessin	
OPP RADAR PROJECT SEYMOUR NARROWS	
drawing no. - no. dessin WM XXX - 001	sheet-feuille 02/07
rev 1	

WM XXX - 001

WM XXX - 001

ANSI B File / Fichier: SEYMOUR NARROWS ACCESS ROAD - IFR - DEC 10 2018.DWG - Printed / Imprimé: 2018/12/18 10:34

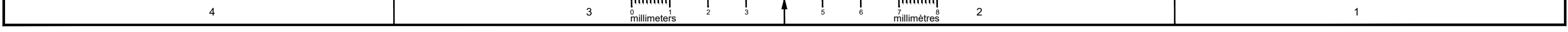

ROCK BALLAST

TOE ROCK

ROCK BALLAST

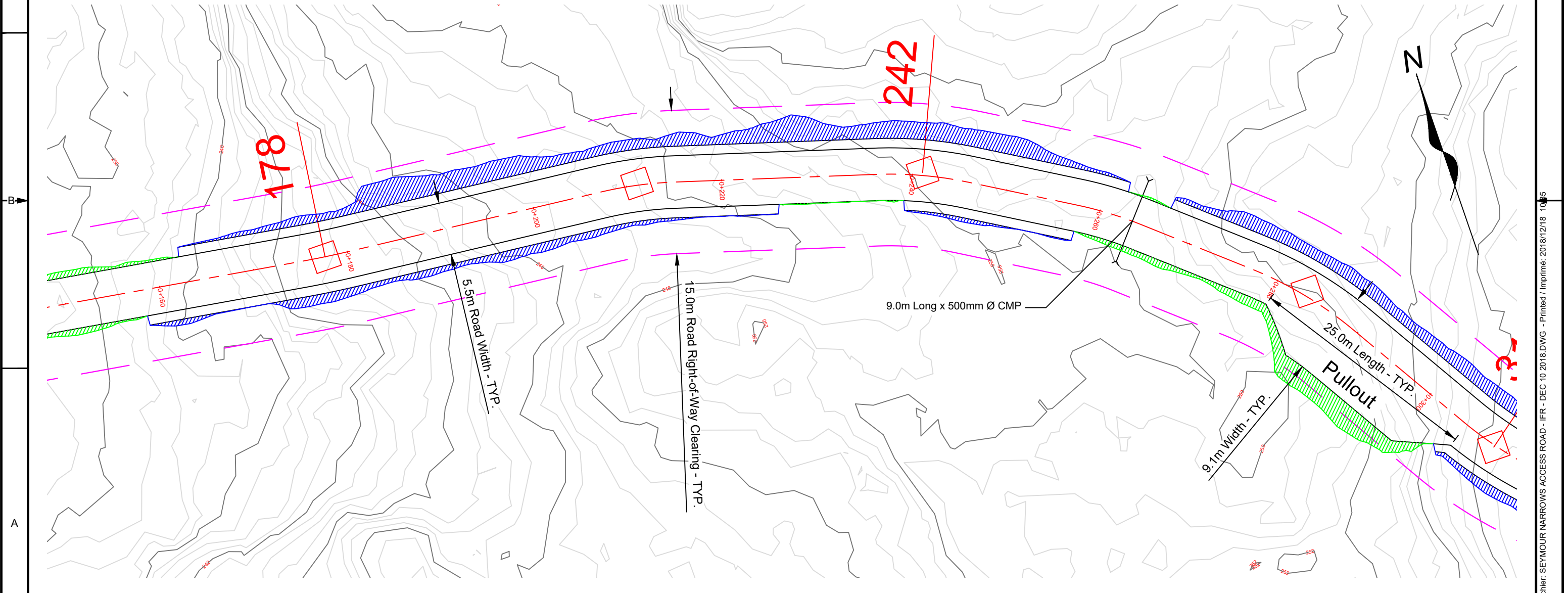
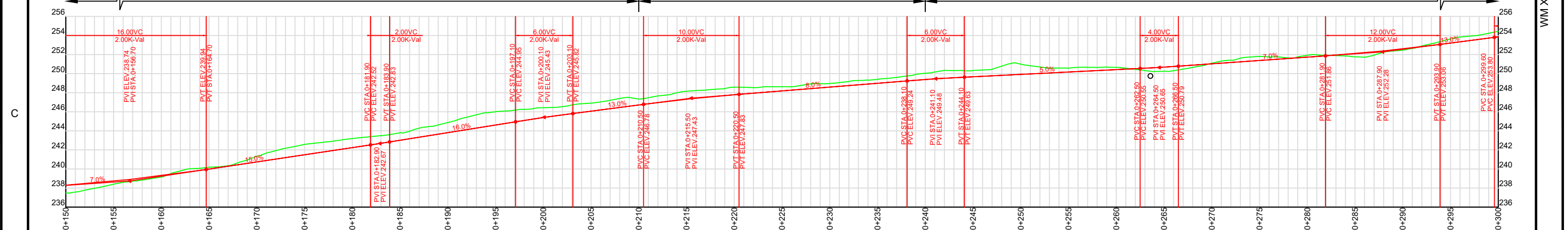

	Fisheries and Oceans Canada	Pêches et Océans Canada
	Canadian Coast Guard	Garde côtière Canadienne

designed - conception	date	checked - vérifié	date
SANDY WHITE	2018-11-07	CLINT HOFFMAN	2018-12-10
drawn - dessiné	date	approved - approuvé	date
BRENDEN GANSNER	2018-11-07	CLINT HOFFMAN	TBD
CCG ref. no. - no. réf. GCC	scale - échelle	rev	description
8B200	1:400		

Asset - Actif	by par	Date
CCG RADAR MAIN ACCESS ROAD	CH	2018-12-10
FS1705 180136		

Drawing - Dessin	sheet-feuille	rev
OPP RADAR PROJECT SEYMOUR NARROWS	03/07	1

drawing no. - no. dessin	sheet-feuille	rev
WM XXX - 001	03/07	1

WM XXX - 001

ANSI B

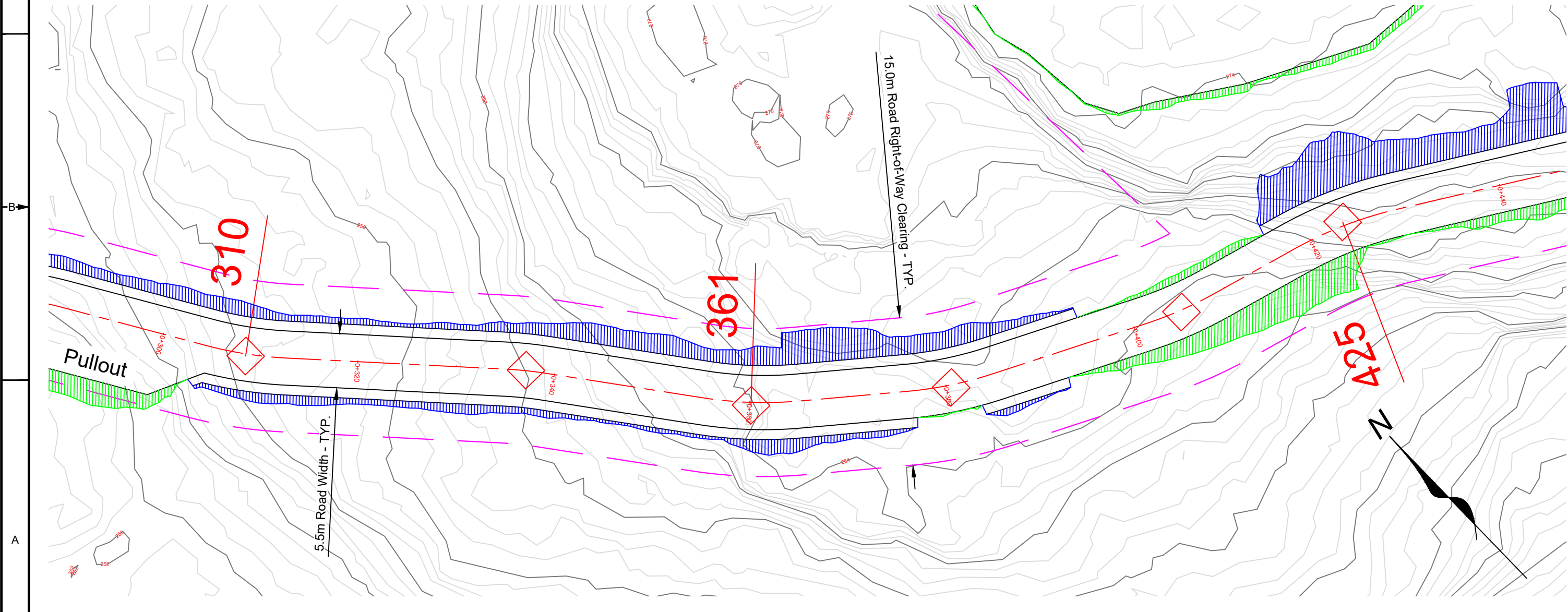
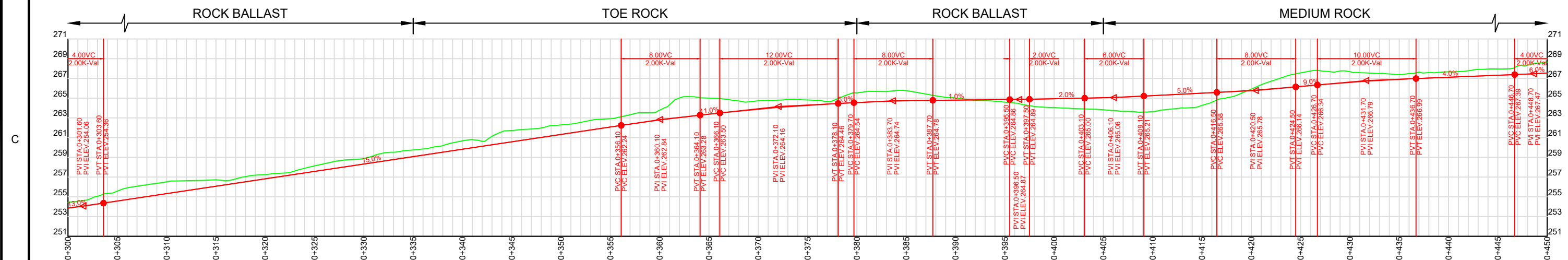

WM XXX - 001

	Fisheries and Oceans Canada	Pêches et Océans Canada
	Canadian Coast Guard	Garde côtière Canadienne

designed - conception SANDY WHITE date 2018-11-07	checked - vérifié CLINT HOFFMAN date 2018-12-10	Asset - Actif
drawn - dessiné BRENDEN GANSNER date 2018-11-07	approved - approuvé CLINT HOFFMAN date TBD	1 ISSUED FOR REVIEW
CCG ref. no. - no. réf. GCC 8B200	scale - échelle 1:400	CH 2018-12-10
rev	description	by par Date

CCG RADAR MAIN ACCESS ROAD
FS1705 180136

Drawing - Dessin	
OPP RADAR PROJECT SEYMOUR NARROWS	
drawing no. - no. dessin WM XXX - 001	sheet-feuille 04/07
rev 1	

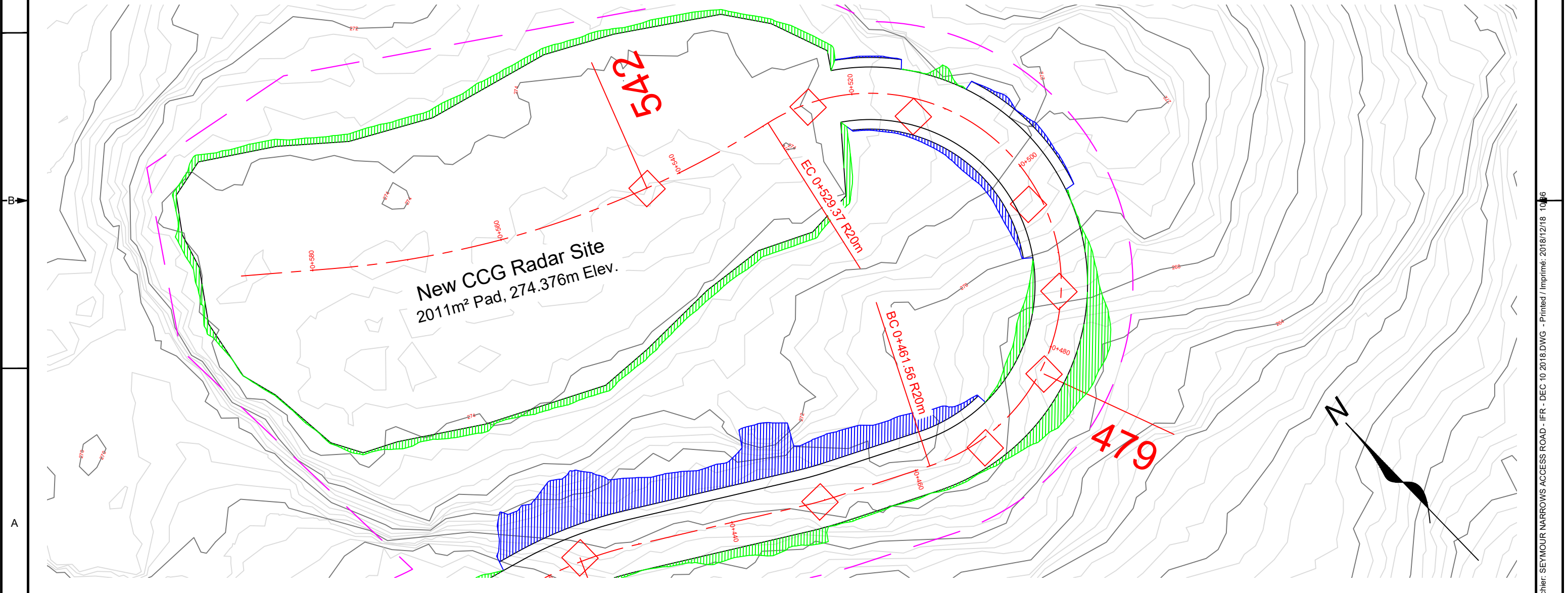
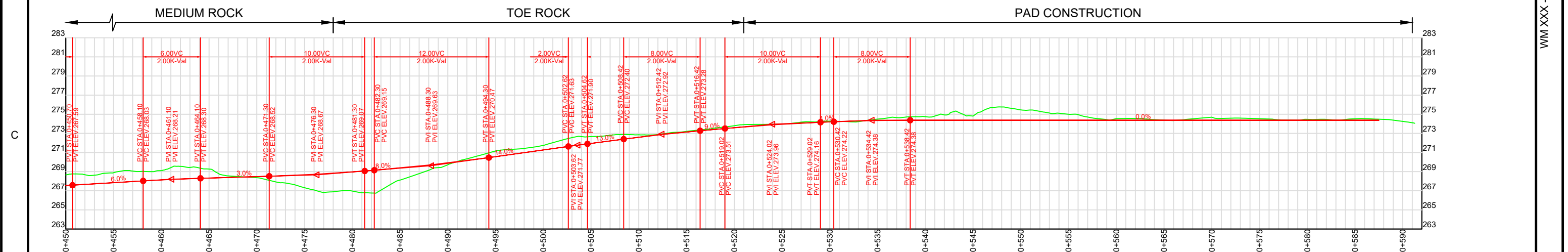

Fisheries and Oceans Canada
 Pêches et Océans Canada
 Canadian Coast Guard
 Garde côtière Canadienne

designed - conception SANDY WHITE drawn - dessiné BRENDEN GANSNER CCG ref. no. - no. réf. GCC 8B200	date 2018-11-07 date 2018-11-07	checked - vérifié CLINT HOFFMAN approved - approuvé CLINT HOFFMAN scale - échelle 1:400	date 2018-12-10 date TBD	1	ISSUED FOR REVIEW	CH	2018-12-10
rev		description		by	par	Date	

Asset - Actif
CCG RADAR MAIN ACCESS ROAD
 FS1705 180136

Drawing - Dessin
**OPP RADAR PROJECT
SEYMOUR NARROWS**
 drawing no. - no. dessin
 WM XXX - 001
 sheet-feuille
 05/07
 rev
 1

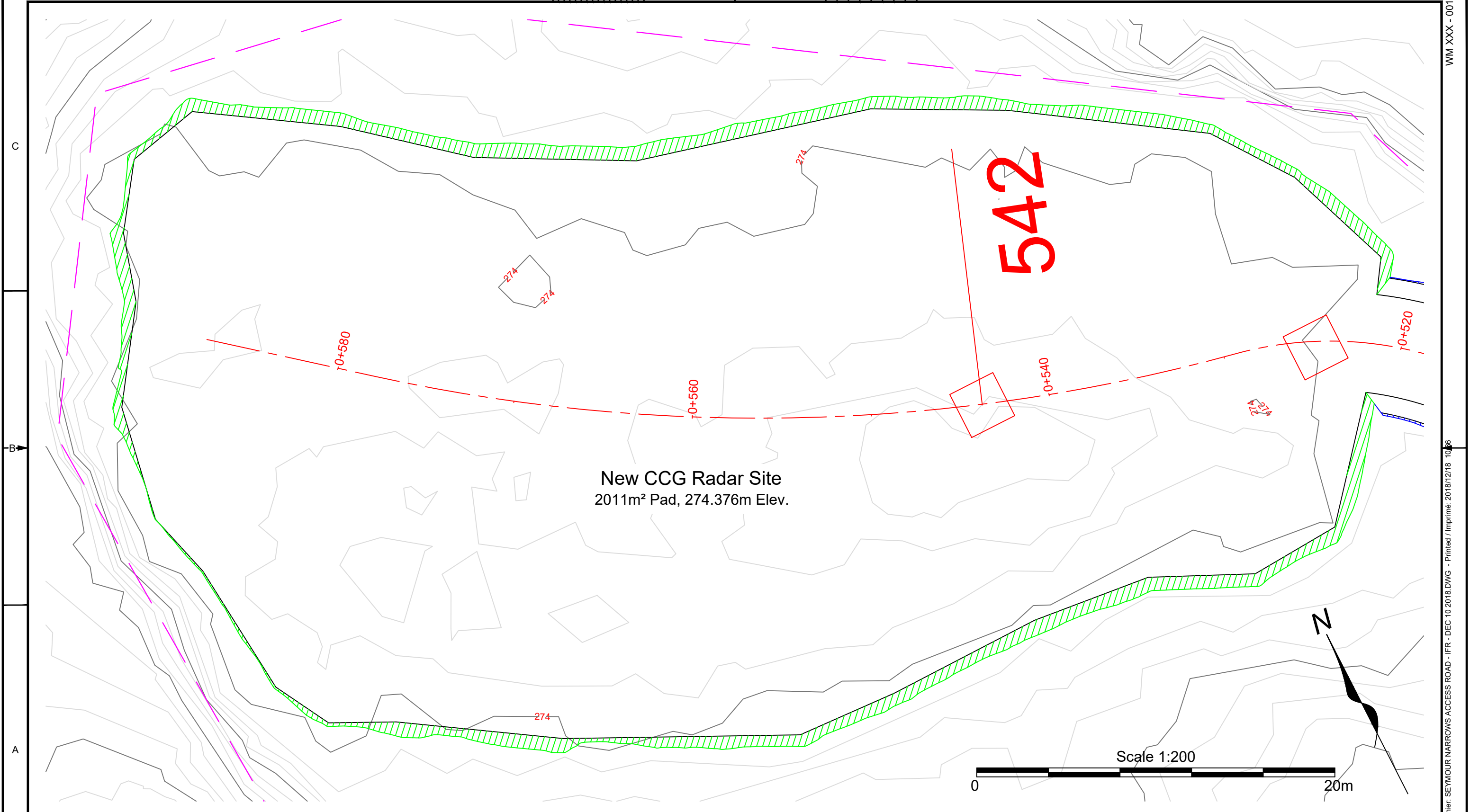

New CCG Radar Site
2011m² Pad, 274.376m Elev.

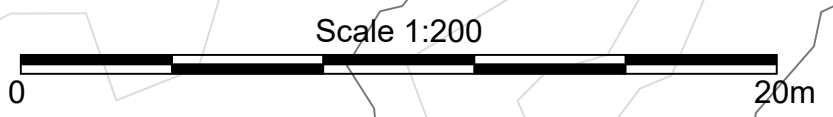

WM XXX - 001

Fisheries and Oceans Canada
Pêches et Océans Canada
Canadian Coast Guard
Garde côtière Canadienne

designed - conception	date	checked - vérifié	date						
SANDY WHITE	2018-11-07	CLINT HOFFMAN	2018-12-10						
drawn - dessiné	date	approved - approuvé	date						
BRENDEN GANSNER	2018-11-07	CLINT HOFFMAN	TBD	1	ISSUED FOR REVIEW	CH	2018-12-10		
CCG ref. no. - no. réf. GCC		scale - échelle		rev	description	by par	Date		
8B200		1:200							

Asset - Actif
CCG RADAR MAIN ACCESS ROAD
FS1705 180136

Drawing - Dessin
OPP RADAR PROJECT SEYMOUR NARROWS
drawing no. - no. dessin: WM XXX - 001
sheet-feuille: 06/07
rev: 1

C

B

A

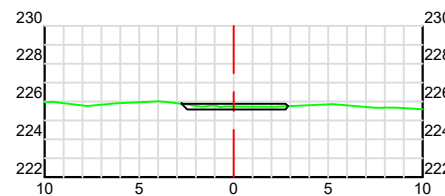

0+000

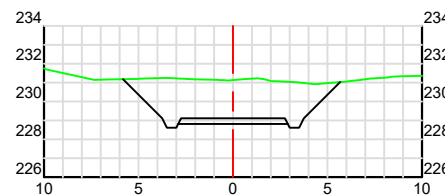

0+020

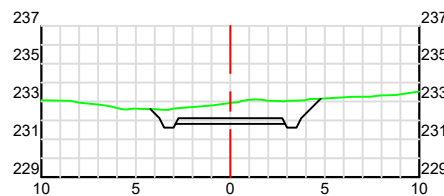

0+040

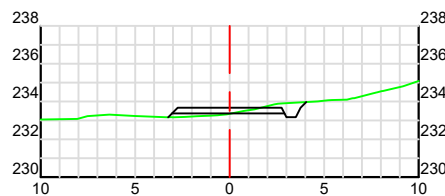

0+060

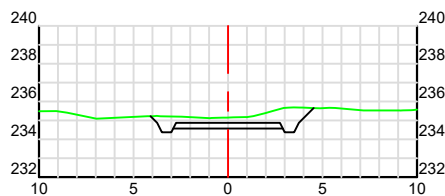

0+080

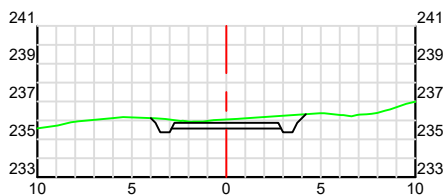

0+100

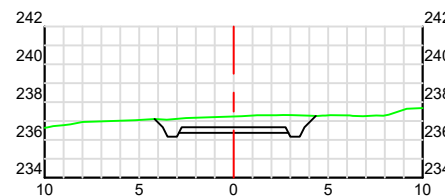

0+120

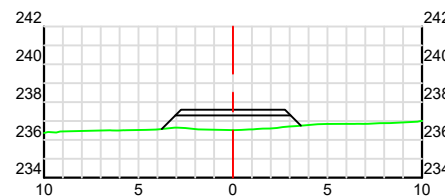

0+140

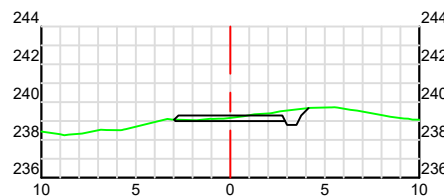

0+160

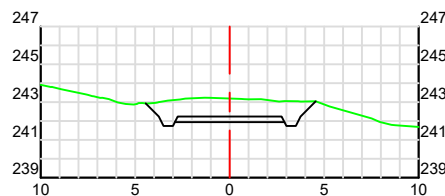

0+180

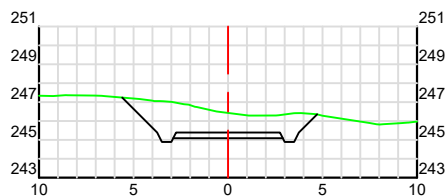

0+200

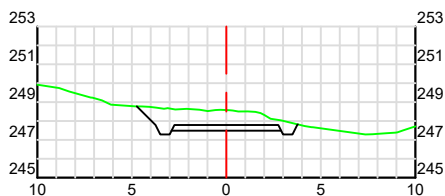

0+220

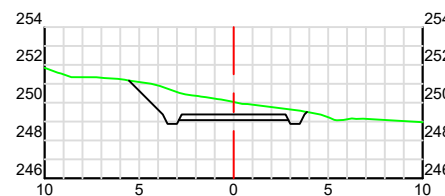

0+240

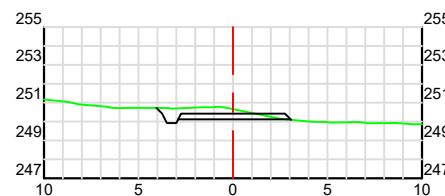

0+260

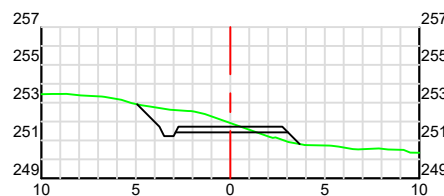

0+280



0+300

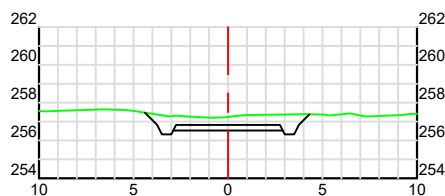

0+320

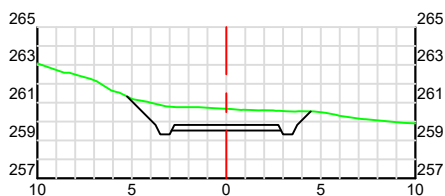

0+340



0+360

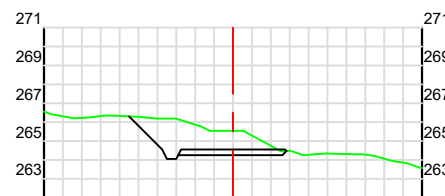

0+380



0+400

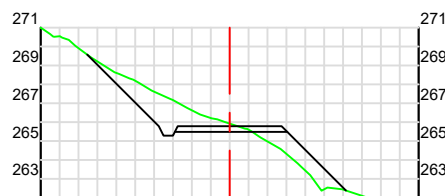

0+420

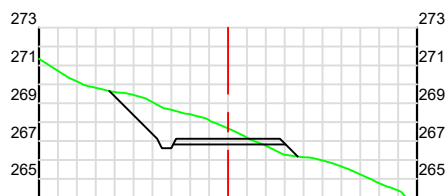

0+440

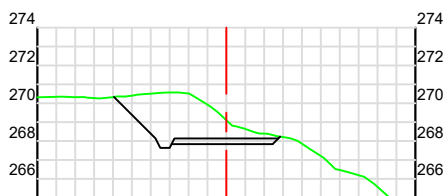

0+460

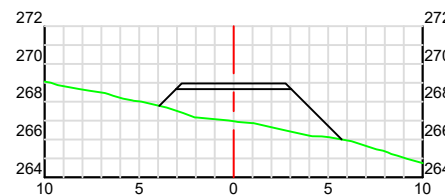

0+480

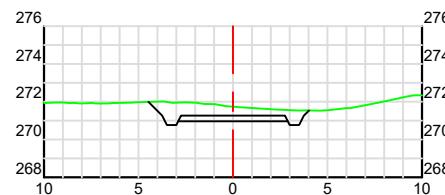

0+500

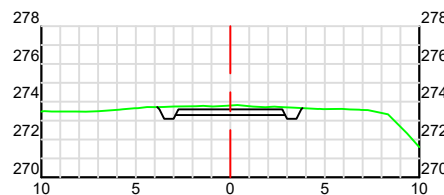

0+520

WM XXX - 001

File / Fichier: SEYMOUR NARROWS ACCESS ROAD - IFR - DEC 10 2018.DWG - Printed / Imprimé: 2018/12/18 10:07

ANSI B

WM XXX - 001

	Fisheries and Oceans Canada	Pêches et Océans Canada
	Canadian Coast Guard	Garde côtière Canadienne

designed - conception SANDY WHITE	date 2018-11-07	checked - vérifié CLINT HOFFMAN	date 2018-12-10
drawn - dessiné BRENDEN GANSNER	date 2018-11-07	approved - approuvé CLINT HOFFMAN	TBD
CCG ref. no. - no. réf. GCC 8B200		scale - échelle 1:400	

1	ISSUED FOR REVIEW	CH	2018-12-10
rev	description	by par	Date

Asset - Actif
CCG RADAR MAIN ACCESS ROAD
FS1705 180136

Drawing - Dessin OPP RADAR PROJECT SEYMOUR NARROWS		
drawing no. - no. dessin WM XXX - 001	sheet-feuille 07/07	rev 1

4

3



2

3

5

6

7

8



2

1